

model no. 299-5512-2

**Mastercraft®**

## PARTS WASHER

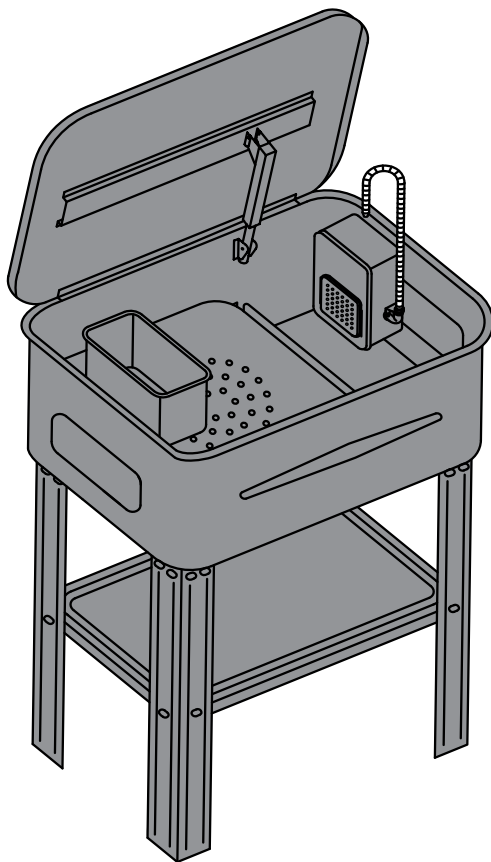

**IMPORTANT:**

Please read this manual carefully before running this parts washer and save it for reference.

**INSTRUCTION  
MANUAL**

TABLE OF CONTENTS

SPECIFICATIONS	4
SAFETY GUIDELINES	5
KEY PARTS DIAGRAM	9
SETUP	10
OPERATING INSTRUCTIONS	12
MAINTENANCE	13
TROUBLESHOOTING	14
PARTS LIST	15
WARRANTY	17

NOTE:

If any parts are missing or damaged, or if you have any questions, please call our toll-free helpline at 1-800-689-9928.



SAVE THESE INSTRUCTIONS

This manual contains important safety and operating instructions. Read all instructions and follow them with use of this product.

SPECIFICATIONS

AC power for pump	120 V 60 Hz 0.25 A
Tank capacity	20 U.S. gallons (75.7 L)
Solvent capacity	12 U.S. gallons (45.4 L)
Flow rate	1 U.S. gallon (3.5 L) per minute
Power cord	72", 18 AWG x 3C (3 prong with ground)
Dimensions (H x L x W)	34 1/2 x 30 1/2 x 21" (87.6 x 77.5 x 53.3 cm)
Net weight	52 lb 14 oz (24 kg)

SAFETY GUIDELINES

WORK AREA SAFETY WARNINGS

- **Keep guards in place and in working order.**
- **Keep the work area clean, well ventilated and well lighted.** Cluttered or dark areas increase the risks of electric shock, fire, and injury to persons.
- **Do not use in dangerous environment.** Don't use this equipment in damp or wet locations, or expose to rain.
- **Keep bystanders, children, and visitors away while operating this equipment.** Distractions can cause you to lose control.

GROUNDING POWER TOOL SAFETY WARNINGS

- **Grounded power tools must be plugged into an outlet properly installed and grounded in accordance with all codes and ordinances. Never remove the grounding prong or modify the plug in any way. Do not use any adapter plugs. Check with a qualified electrician if you are in doubt whether the outlet is properly grounded.** If the tool should electrically malfunction or break down, grounding provides a low resistance path to carry electricity away from the users.
- **Do not abuse the power cord. Never use the power cord to carry the tool or pull the plug from an outlet. Keep the power cord away from heat, oil, sharp edges, or moving parts. Replace damaged power cord immediately.** Damaged power cords increase the risk of electric shock.
- **Avoid body contact with grounded surfaces such as pipes, radiators, and refrigerators.** There is an increased risk of electric shock if your body is grounded.
- **Do not expose power tools to rain or wet conditions.** Water entering a power tool will increase the risk of electric shock.
- **When operating a power tool outside, use an outdoor extension cord marked "W-A" or "W".** These extension cords are rated for outdoor use, and reduce the risk of electric shock.
- **Always keep the power extension cord away from moving parts on the tool.**

PERSONAL SAFETY WARNINGS

- **Stay alert. Watch what you are doing and use common sense when operating a power tool. Do not use a power tool while tired or under the influence of drugs, alcohol, or medication.** A moment of inattention while operating power tools may result in serious personal injury.
- **Dress properly. Do not wear loose clothing or jewellery. Contain long hair. Keep hair, clothing, and gloves away from moving parts.** Loose clothes, jewellery, or long hair increases the risk of personal injury as a result of being caught in moving parts.
- **Avoid unintentional starting. Make sure that the power switch is off before plugging in.** Plugging in power tools with the power switch on invites accidents.
- **Do not overreach. Keep proper footing and balance at all times.** Proper footing and balance enables better control of power tool in unexpected situations.

- **Use safety equipment.** Always wear splash-resistant eye protection and rubber gloves. Dust mask, non-skid safety shoes, or hard hat must be used for the appropriate conditions.

### TOOL USE & CARE SAFETY WARNINGS

- **Use proper cleaning solutions.** Clean parts with water or household detergents only. Never use highly volatile flammable solvents such as gasoline, toluene, diesel fuel, methyl ethyl ketone (MEK), or 1,1,1-trichloroethane. Read and understand all information concerning cleaning solvents before using.
- **Do not use or store near open flames, pilot lights in stoves or heaters, or any other ignition source.** Solvents are highly flammable. Use in well-ventilated area. Do not smoke during use.
- **Avoid intake of solvents.** Materials used with cleaning and debris removed by cleaning may be harmful or fatal if inhaled or swallowed.
- **Do not force the tool.** The tool will do the work better and safer at the speed and capacity for which it was designed.
- **Do not use the power tool if the power switch does not turn it on or off.** Any tool that cannot be controlled with the power switch is dangerous and must be replaced.
- **Disconnect the power cord plug from the power source before making any adjustments, changing accessories or storing the tool.** Such preventative safety measures reduce the risk of starting the tool accidentally.
- **Store idle tools out of reach of children and other untrained persons.** Tools are dangerous in the hands of untrained users.
- **Maintain tools with care and keep them clean.** Properly maintained tools are less likely to bind and are easier to control. Do not use a damaged tool.
- **Check for misalignment or binding of moving parts, breakage of parts, and any other condition that affects the tool's operation.** If damaged, have the tool serviced before using. Many accidents are caused by poorly maintained tools.
- **Use only accessories that are recommended by the manufacturer for your model.** Accessories that may be suitable for one tool may become hazardous when used on another tool.
- **CA PROP 65:** This product contains or, when used, produces chemicals known to the state of California to cause cancer and birth defects or other reproductive harm. Wash hands after handling.

### TOOL SERVICE SAFETY WARNINGS

- **Tool service must be performed only by qualified repair personnel.** Service or maintenance performed by unqualified personnel could result in a risk of injury.
- **When servicing the tool, use only identical replacement parts.** Use of unauthorized parts or failure to follow maintenance instructions may create a risk of electric shock or injury.

### SPECIFIC SAFETY WARNINGS

- **Maintain labels and/or nameplates on the tool.** These carry important information. If unreadable or missing, have them replaced.
- **Make sure to read and understand all instructions and safety warnings in this manufacturer's manual.**

- **Avoid unintentional starting.** Make sure that you are prepared to begin work before turning on the tool.
- **Never leave the tool unattended when it is plugged into an electric outlet.** Turn off the tool, and unplug it from its electrical outlet before leaving.
- **Always unplug the tool from its electrical outlet before performing any inspection, maintenance, or cleaning procedures.**

### GROUING INSTRUCTIONS

#### 110-120 V~ GROUNDED TOOLS: TOOLS WITH THREE PRONG PLUGS

**IN THE EVENT OF AN ELECTRICAL MALFUNCTION OR BREAKDOWN,** grounding provides a path of least resistance for electric current to reduce the risk of electric shock. This tool is equipped with an electric cord having a grounding plug. The plug must be plugged into a matching outlet that is properly installed and grounded in accordance with all local codes and ordinances.

**DO NOT MODIFY THE PLUG PROVIDED** – if it will not fit the outlet, have the proper outlet installed by a qualified electrician.

**YOUR GROUNDING PRONG** in the plug is connected through the green wire inside the cord to the grounding system in the tool. The green wire in the cord must be the only wire connected to the tool's grounding system and must never be attached to an electrically "live" terminal.

**Check** with a qualified electrician or service personnel if the grounding instructions are not completely understood, or if in doubt as to whether the tool is properly grounded.

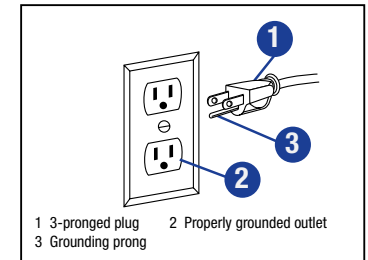

**USE ONLY 3-WIRE EXTENSION CORDS** that have 3-prong grounding plugs and 3-pole receptacles that accept the tool's plug.

Repair or replace damaged or worn cord immediately.



#### WARNING!

Read all safety warnings and instructions before attempting to install or operate this product. Failure to follow the warnings and instructions may result in personal injury and property damage.

#### CAUTION!

The warnings, precautions, and instructions discussed in this instruction manual cannot cover all possible conditions and situations that may occur. It must be understood by the operator that common sense and caution are factors which cannot be built into this product, but must be supplied by the operator.

This tool is intended for use on a circuit that has an outlet that looks like the one illustrated above: a **120 V~3-Prong Outlet**. The tool has a grounding plug that looks like the plug illustrated: a **120 V~3-Prong Plug**.

The outlet must be properly installed and grounded in accordance with all codes and ordinances.

Do not use an adapter to connect this tool to a different outlet.

GUIDELINES FOR USING EXTENSION CORDS

Verify that the extension cord is in good condition. When using an extension cord, be sure to use one that is heavy enough to carry the current that the tool will draw. An undersized cord will cause a drop in line voltage, which will result in loss of power and overheating. The table below shows the correct size to use according to cord length and the amperage rating on the tool's nameplate. When in doubt, use the next heavier gauge. The smaller the gauge number, the heavier the cord.

Amperage rating of the tool (120 V circuit only)		Total length of the extension cord			
		25' (7.6 m)	50' (15.2 m)	100' (30.4 m)	150' (45.7 m)
More than	Not more than	Minimum gauge for the extension cord (AWG)			
0	6	18	16	16	14
6	10	18	16	14	12
10	12	16	16	14	12
12	16	14	12	Do not use	

Verify that the extension cord is properly wired and in good condition. Always replace a damaged extension cord, or have it repaired by a qualified electrician before using it. Keep extension cords away from sharp objects, excessive heat, and damp or wet areas.



WARNING!

TO PREVENT ELECTRIC SHOCK AND DEATH FROM INCORRECT GROUNDING WIRE CONNECTION:

- Check with a qualified electrician if you are in doubt as to whether the outlet is properly grounded.
- Do not modify the power cord plug provided with the tool.
- Never remove the grounding prong from the plug. Do not use the tool if the power cord or plug is damaged. If damaged, have it repaired by a service facility before use. If the plug will not fit the outlet, have a proper outlet installed by a qualified electrician.
- This tool must be grounded while in use in order to protect the operator from electric shock.



KEY PARTS DIAGRAM

No.	Description	No.	Description
A	Lid	H	Leg
B	Fusible link	I	Drain plug (invisible herein)
C	Flexible tube	J	Bolts, washers and nuts
D	Pump	K	Storage shelf
E	Switch box	L	Work shelf
F	Switch	M	Tub
G	Power cord and plug	N	Parts basket

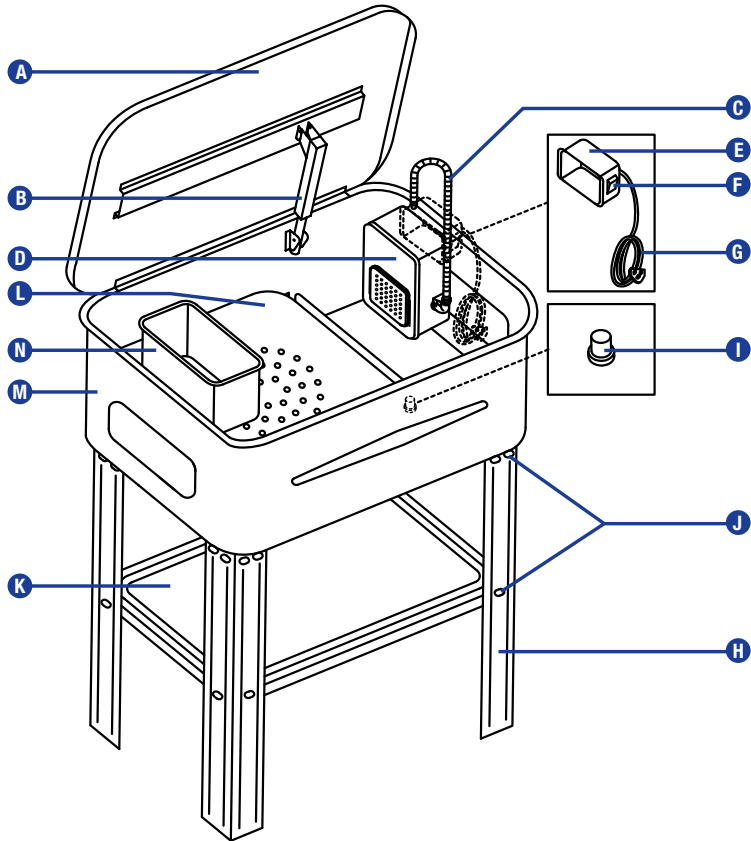

WARNING!

If any part is missing or damaged, do not use the product until the missing or damaged part has been replaced.

## SETUP

## ASSEMBLY OF PARTS WASHER

1. Lay the tub (1) upside down. Attach the legs (2) to the tub (1) using the bolts, washers and nuts. (Fig. 1)

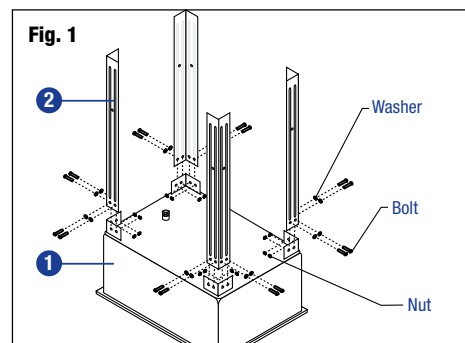

2. Attach the storage shelf (3) to the legs (2) using the bolts, washers and nuts. (Fig. 2)

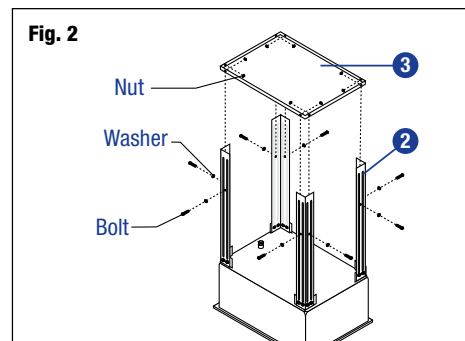

3. Turn the tub over and place in a level, stable, and well-ventilated area.

4. Place the work shelf and parts basket into place inside the tub.

5. Place the filter (4) inside the filter cover (5). Slide the filter cover with filter into place on pump housing cover (6). (Fig. 3)

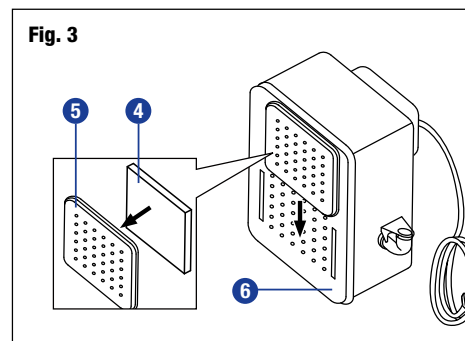

6. Connect the flexible tube (7) to the elbow (8). (Fig. 4)

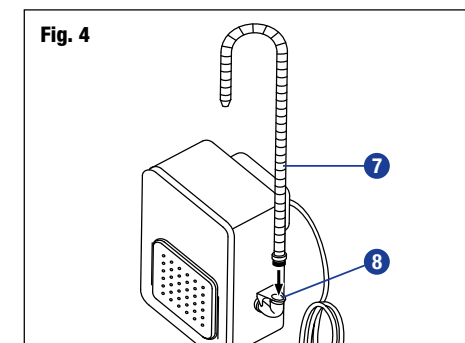

7. Place the pump housing (9) inside the tub (1) so that the switch box (10) hangs outside the tub and slide it down into position securely. (Fig. 5)

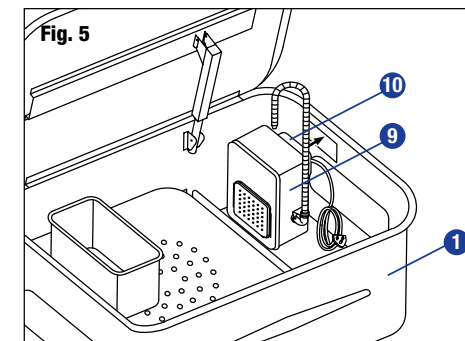

## FILLING THE TUB

Fill the tub with the proper solution just below the crease line inside the tub. Do not allow the level of liquid in the parts washer to fall below the pump inlet. This could damage the pump.

**IMPORTANT:** Know your solvents. Do not use any highly volatile, flammable or combustible solvents, or fuels such as gasoline, diesel, or toluene. Only use noncorrosive water-based solvents.

**IMPORTANT:** Chlorinated solvents, such as 1-1-1-trichloroethane and methylene chloride (also known as methyl chloride) can chemically react with aluminum and may explode. Do not use these solvents. Many tools and pieces of equipment contain aluminum.

**IMPORTANT:** Immerse the pump in liquid while operating. Fluid should be replaced, and parts washer should be cleaned on a regular basis to avoid hazardous conditions. Avoid solvent contact with skin and eyes.

## SET UP OF WORKPIECE AND WORK AREA

1. Designate a work area that is clean and well lit. The work area must not allow access by children or pets to prevent distraction and injury.
2. Route the power cord along a safe route to reach the work area without creating a tripping hazard or exposing the power cord to possible damage. The power cord must reach the work area with enough extra length to allow free movement while working.
3. There must not be objects, such as utility lines, nearby that will present a hazard while working.

## OPERATING INSTRUCTIONS

1. Turn the power switch to the OFF ("O") position.
  2. Plug the power cord into a grounded, GFCI-protected, 120 V electrical outlet.
- IMPORTANT:** If the work area is not equipped with a permanently installed Ground Fault Circuit Interrupter outlet (GFCI), use a plug-in GFCI between the power tool or extension cord and the power receptacle.
3. Place object(s) to be cleaned into the cleaning solution.
  4. Turn the power switch to the ON ("I") position and begin cleaning object(s).
  5. When the object(s) is clean, turn the power switch to the OFF position, and remove the object(s) from the cleaning fluid and air dry or wipe with clean shop towel.
  6. Close the lid of the parts washer.



### WARNING!

- Parts being cleaned may contain and leave flammable or combustible residue or fluids in the parts washer. Check for solvent fumes to verify non-flammability and non-toxicity. Use in a well-ventilated area. Do not smoke.
- Non-water based solvents may also expel fumes that are hazardous to your health, and must not be used at any time. Keep away from ignition sources.

## MAINTENANCE

### GENERAL CARE

1. Before each use, inspect the general condition of the parts washer. Check for loose hardware, misalignment or binding of moving parts, cracked or broken parts, damaged electrical wiring, and any other condition that may affect its safe operation.
2. After use, wipe the external surfaces of the parts washer with clean cloth. Store the parts washer in a dry location out of reach of children.

### REPLACING CLEANING SOLUTION

1. Replace the cleaning solution when it has become dirty.
2. Place an empty container on the storage shelf that is larger enough to hold all of the liquid which is in the tub.
3. Remove the drain plug from the bottom of the tub. The fluid should drain into the empty container on the shelf below.
4. Dispose of the used cleaning solution properly. Do not drain the cleaning solution into the street drains, hose drains, or into the earth. Contact local waste management officials for proper disposal methods.
5. Replace the drain plug, then refill the tub with new cleaning solution.

### CLEANING THE TUBE AND IMPELLER

**IMPORTANT:** When the cleaning solution flow is reduced or stopped, it may be necessary to clean the flexible tube.

1. Make certain that the indicator light on the switch box is on.
2. Turn the switch to the OFF position.
3. Unplug the power cord from the electrical outlet.
4. Remove the flexible tube from the elbow. Drain the pipe, inspect its interior for debris. Use compressed air to blow clean.
5. Remove the pump housing cover, then clear and remove any foreign matter from the impeller.
6. Reattach the flexible tube to the elbow, and replace the pump housing cover.



### WARNING!

- Turn the power switch of the parts washer off and unplug from its electrical outlet before performing maintenance.
- To prevent serious injury from parts washer failure, do not use damaged equipment. If abnormal noise or vibration occurs, have the problem corrected before further use.
- If the supply cord of this parts washer is damaged, it must be replaced only a qualified service technician.







No.	Description	Qty.	No.	Description	Qty.
1	Lid	1	19	Screw	6
2	Fusible link	1	20	Power switch	1
3	Hinge	1	21	Switch box	1
4	Work shelf	1	22	Cushion	1
5	Parts basket	1	23	Flexible tube	1
6	Tub	1	24	Pump housing	1
7	Leg	4	25	Bracket	1
8	Storage shelf	1	26	Elbow	1
9	Bolt	25	27	Spring washer	6
10	Nut	25	28	Nut	6
11	Drain plug	1	29	Cord cover	1
12	O-ring	1	30	O-ring	1
13	Pin	4	31	Connector	1
14	Gasket	4	32	O-ring	1
15	Pin	1	33	Pump	1
16	Pin	3	34	Pump cover	1
17	Power cord and plug	1	35	Filer cover	1
18	Cord tie	1	36	Filter	1

3-Year Limited Warranty

This Mastercraft product is guaranteed for a period of **three (3) years** from the date of original retail purchase, against defects in materials and workmanship.

Subject to the conditions and limitations described below, this product, if returned to us with proof of purchase within the stated warranty period and if covered under this warranty, will be repaired or replaced (with the same model, or one of equal value or specification), at our option. We will bear the cost of any repair or replacement and any costs of labour relating thereto.

These warranties are subject to the following conditions and limitations

- a) a bill of sale verifying the purchase and purchase date must be provided;
- b) this warranty will not apply to any product or part thereof which is worn or broken or which has become inoperative due to abuse, misuse, accidental damage, neglect or lack of proper installation, operation or maintenance (as outlined in the applicable owner's manual or operating instructions) or which is being used for industrial, professional, commercial or rental purposes;
- c) this warranty will not apply to normal wear and tear or to expendable parts or accessories that may be supplied with the product which are expected to become inoperative or unusable after a reasonable period of use;
- d) this warranty will not apply to routine maintenance and consumable items such as, but not limited to, fuel, lubricants, vacuum bags, blades, belts, sandpaper, bits, fluids, tune-ups or adjustments;
- e) this warranty will not apply where damage is caused by repairs made or attempted by others (i.e. persons not authorized by the manufacturer);
- f) this warranty will not apply to any product that was sold to the original purchaser as a reconditioned or refurbished product (unless otherwise specified in writing);
- g) this warranty will not apply to any product or part thereof if any part from another manufacturer is installed therein or any repairs or alterations have been made or attempted by unauthorized persons;
- h) this warranty will not apply to normal deterioration of the exterior finish, such as, but not limited to, scratches, dents, paint chips, or to any corrosion or discolouring by heat, abrasive and chemical cleaners; and
- i) this warranty will not apply to component parts sold by and identified as the product of another company, which shall be covered under the product manufacturer's warranty, if any.

NOTE:

The manufacturer and/or distributor has provided the parts list and assembly diagram in this manual as a reference tool only. Neither the manufacturer nor distributor makes any representation or warranty of any kind to the buyer that he or she is qualified to make any repairs to the product, or that he or she is qualified to replace any parts of the product. In fact, the manufacturer and/or distributor expressly states that all repairs and parts replacements should be undertaken by certified and licensed technicians, and not by the buyer. The buyer assumes all risk and liability arising out of his or her repairs to the original product or replacement parts thereto, or arising out of his or her installation of replacement parts thereto.

### **Additional Limitations**

This warranty applies only to the original purchaser and may not be transferred. Neither the retailer nor the manufacturer shall be liable for any other expense, loss or damage, including, without limitation, any indirect, incidental, consequential or exemplary damages arising in connection with the sale, use or inability to use this product.

### **Notice to Consumer**

This warranty gives you specific legal rights, and you may have other rights, which may vary from province to province. The provisions contained in this warranty are not intended to limit, modify, take away from, disclaim or exclude any statutory warranties set forth in any applicable provincial or federal legislation.

Made in China

Imported by

Mastercraft Canada Toronto, Canada M4S 2B8