

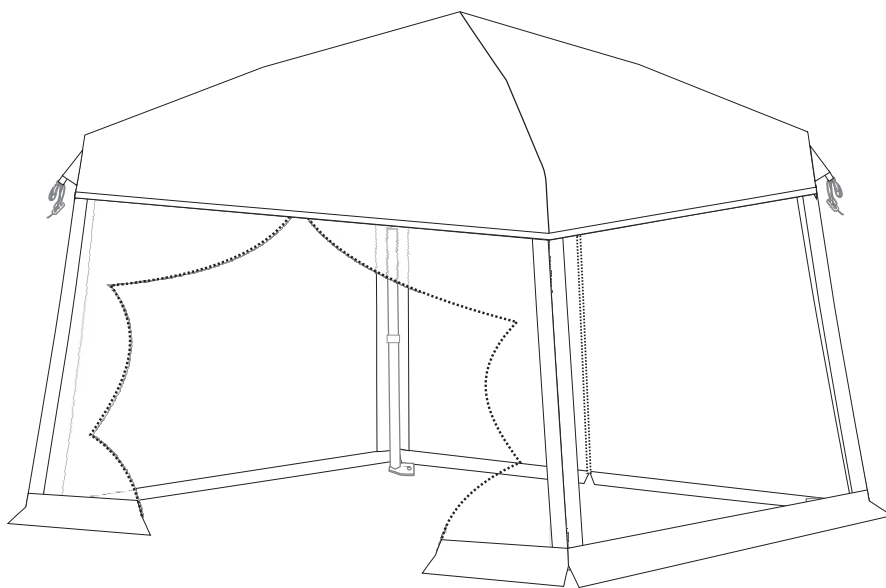

10' x 10' QUICK-SET SCREEN HOUSE

Model No.: 299-2939-6



SAFETY

PLEASE READ CAREFULLY TO ENSURE YOUR SAFETY:

WARNING: KEEP ALL FLAME AND HEAT SOURCES AWAY FROM THIS FABRIC.

This shelter meets the flame-resistant requirements of CPAI-84. It is not fireproof. The fabric will burn if left in continuous contact with any flame source. The application of any foreign substance to the fabric may render the flame-resistant properties ineffective.

1. DO NOT pitch shelter near an open flame.
2. DO NOT leave campfires unattended. Always extinguish campfire before leaving area.
3. DO NOT allow CHILDREN or ADULTS to use lighted candles, matches or other flame sources in or near shelter.
4. DO NOT use heating, lighting or cooking equipment with open flames in or near shelter.
5. DO NOT use other-than-recommended water-repellent compounds on your shelter.
6. DO NOT spray the shelter with insecticide.
7. EXTREME CAUTION: Never use any fuel-burning, oxygen-consuming devices (i.e., heaters, lanterns, or other flame sources), or any device that produces fumes/flames (i.e., stoves, candles, hibachis, etc.) in or around your shelter. Inhalation of fumes may result in carbon monoxide poisoning, injury and/or death.
8. Exercise care when using electricity and lighting in or near shelter.
9. Disassemble and store shelter properly after camping to ensure the shelter's longevity.
10. Always use a hammer/mallet when driving stakes into the ground.

CARE INSTRUCTIONS:

Your shelter is made of durable polyester fabric. No shelter fabric can withstand prolonged exposure to the sun's ULTRAVIOLET (UV) light and polyester fabric will quickly degrade with constant, long-term exposure to sunlight. Take your shelter down and store when not in use.

STRUCTURE INTEGRITY: Although our shelters are constructed to rigid specifications, periods of wind or rain soaking the ground may loosen the stakes and guy lines. This will weaken the rigidity of the overall structure. If the unit is not assembled taut, water pockets may also form in the roof, the weight of which may cause broken frames and torn fabric.

STORAGE: Never roll up or pack a shelter that is damp, as mildew will form. Allow shelter to dry completely before rolling and storing.

SCREEN HOUSE PARTS LIST

PART NO.	DESCRIPTION	QTY.
GSS-01	Fabric roof	1
GSS-02	Fabric screen house	1
GSS-03	Frame	1
GSS-04	Carry bag	1
GSS-05	Peg bag	1
GSS-06	Stakes	10

ASSEMBLY INSTRUCTIONS

THIS RECREATIONAL PRODUCT REQUIRES TWO ADULTS TO ASSEMBLE.

- Make sure ground surface is free from debris and rocks that could damage frame.
- Unless otherwise specified all instructions will be given assuming the assembler is facing the front opening of the screen house.
- Do not drop or bounce carry bag; these actions may damage parts.

STEP 1: Verify package contents

Verify package contents by emptying contents and confirming all parts are included and undamaged.

⚠ Note: Find the stakes in their pocket on the inside of the carry bag. Verify all contents are present before you leave on your trip.

STEP 2: Pull and extend the frame

A) Select a smooth, level site for your screen house.

B) With two people on diagonal corners of the structure, each grab a leg and have one person stand in place while the other walks the frame out. Slide the roof lock mechanisms, located on each leg, up toward roof corners, two legs at a time. Listen for lock to “click” into place. Stop adjusting frame legs at mid-level (half-way mark) and proceed to the next step.

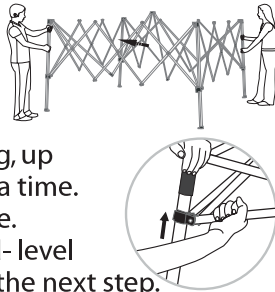

STEP 3: Cover the frame with fabric shell

A) Lay the fabric over the roof.

B) Line up all corners, adjusting from opposite sides. Fabric will fit snugly.



C) Locate the nylon fasteners on the underside of fabric body. Attach to roof frame. Pay careful attention to the corners and inside the roof line.

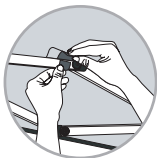
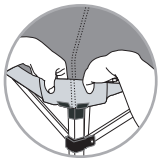

STEP 4: Extend the legs

Step on frame leg base. Working from opposite sides, slide the roof lock mechanisms (located on upper leg portion) upwards until they lock into place. The amount of force necessary will be much less if you ensure the leg segment remains in its slanted position. (Do not try and straighten the legs as this could damage the frame.)

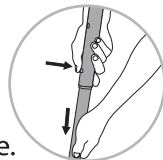

🔧 TIP: You will hear and feel a click when the roof lock is correctly secured at each position.

STEP 5: Stake screen house

A) Stake the screen house by driving stakes through the holes at the foot of each leg.

🔧 Tip: Use additional weights (sand bags, other heavy objects) on each foot or place legs 12" (30 cm) down into sand to help secure set up for beach use. Stakes alone will not secure gazebo in sand or soft soil.

B) To secure guy lines, find the guy line plastic slider and look for portion of the line opposite the knot. Pull this portion, forming a loop (works like a slip knot). Extend guy line to ground and stake. Repeat with remaining guy lines.

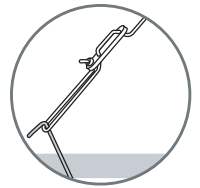
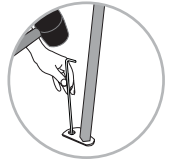

STEP 6: Install the screen walls

A) Fasten hooks on top end of screen house to the corners of frame.

B) Wrap remaining hooks around frame and secure them to their corresponding loops.

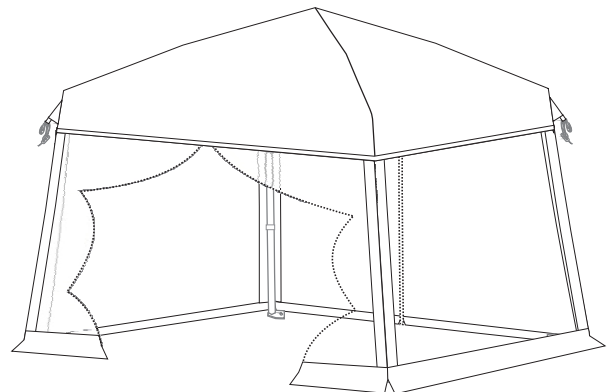
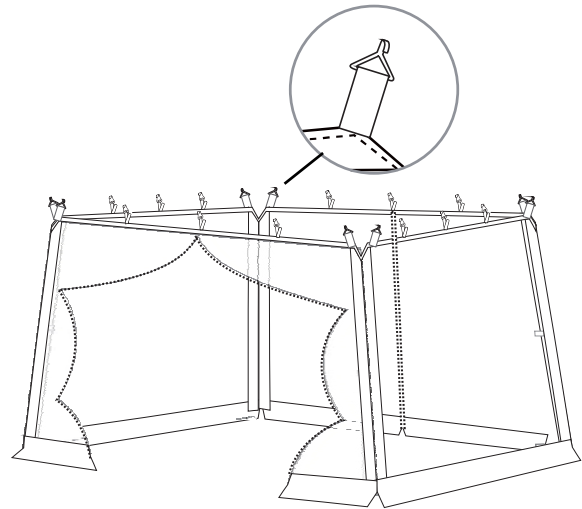

DISASSEMBLY INSTRUCTIONS

- Store all poles and stakes in their corresponding bags to prevent possible tearing or damage to fabric.

STEP 1: Remove the stakes

- A)** Carefully remove stakes that hold down the guy lines.
B) Remove nail stakes from metal base of legs. Remove excess soil from stakes and put into storage bag.
C) Remove stakes from webbing loops at base of wind wall.

STEP 2: Take down the screen walls

- A)** Take down screen walls. Detach hooks on the tops of the screen walls from the frame.
B) Unfasten other hooks on screen house from corresponding loops.
C) Remove screen walls and fold for storage.

STEP 3: Taking down the frame

- A)** Press the push button located in the middle of each leg, and carefully lower two legs at a time. Continue in this manner until frame legs are again at mid-level (half-way mark).
B) Remember the fasteners are inside roof line, on side scissors bars, and at corners. Detach all fasteners and remove fabric shell completely off frame and fold for storing.

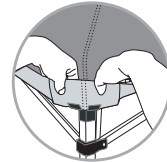
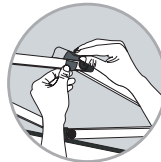
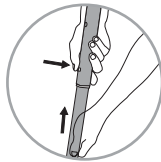

⚠ NEVER STORE FABRIC ON FRAME. YOU MAY DAMAGE FABRIC, FRAME, OR BOTH.

- C)** Press the buttons found on each leg at each upper corner of frame, making sure that all sides are detached from button. Slowly slide roof line downward while walking in. This should collapse frame completely.

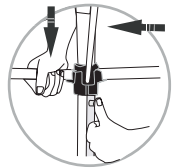

STEP 4: Store in carry bag

- A)** To prolong the use of your screen house you will want to store it correctly. After folding, place frame inside the carry bag.
B) Return stakes to their bag.

TROUBLESHOOTING GUIDE

PROBLEM	SOLUTION
MILDEW	To avoid mildew, never store your product wet or damp. However, if mildew occurs, use a soft-bristle brush or sponge with mild soap to clean. Let dry in the sunlight and apply seam-sealer compound on inside seams.
REPAIRING A TEAR	For small tears use a self-adhesive patch kit. We recommend a repair shop for larger tears.
FAULTY ZIPPER	All of our tents come with self-repairing nylon coil zippers. If the zipper separates, you can move the slider to the beginning of the zipper tape and rework the zipper. Local awning and upholstery repair shops may be able to assist you.

1 year limited warranty

Made in China

Imported by Trileaf Distribution Trifeuil Toronto, Canada M4S 2B8