

CANVAS^{TM/MC}

COPENHAGEN CONSOLE/DESK

MODEL NO. 168-0001-0

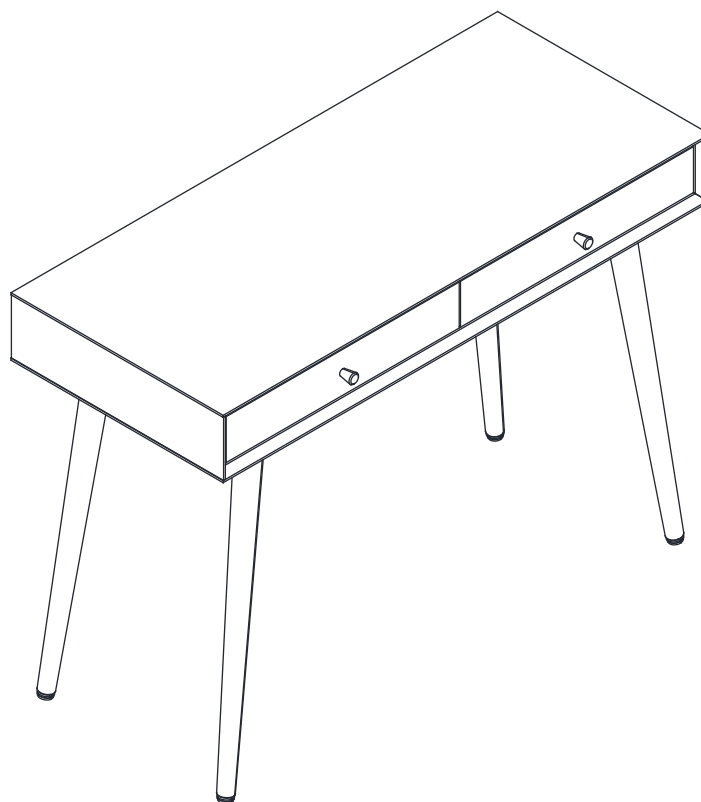

ASSEMBLY INSTRUCTIONS

Toll-free: 1-888-670-6684

IMPORTANT: Please read and understand this manual before beginning assembly of the product, and make sure all parts are present. Compare parts with packaging contents list. If any part is missing, or if you have any questions, contact the service centre at 1-888-670-6684 (toll free).

Made in China

Imported by Trileaf Distribution Trifeuil Toronto, Canada M4S 2B8

Table of Contents	3
Important Safety Instructions	3
Parts List	4
Assembly	6
Technical Specifications	18
Warranty	18



Warning! To reduce the risk of serious injury, read the following safety instructions before assembling and using this product.

- This product is intended for indoor use.
- The product should be placed on flat, horizontal ground.
- Any assembly or maintenance of the product must be carried out by adults only.
- Plastic bags can be dangerous. To avoid danger of suffocation keep all bags away from babies and children.

IMPORTANT: Retain for future reference, and read carefully.

4 MODEL NO. 168-0001-0

1

Divider - 1

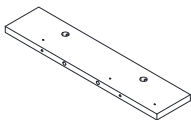

2

Left side panel - 1

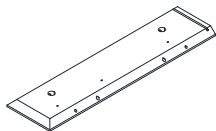

3

Right side panel - 1

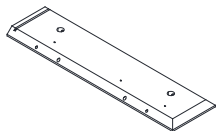

4

Top - 1

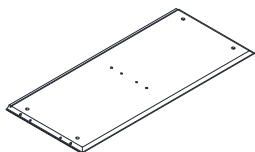

5

Bottom strip 1 - 1

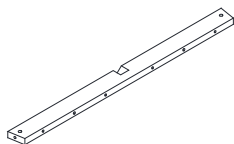

6

Bottom strip 2 - 1

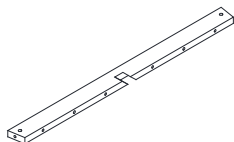

7

Bottom - 1

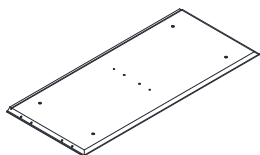

8

Support feet - 4

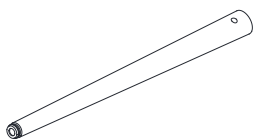

9

Back panel - 1

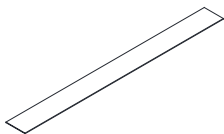

10

Left drawer side - 2

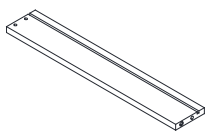

11

Right drawer side - 2

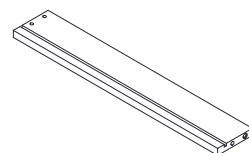

12

Drawer back - 2

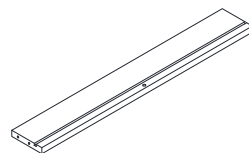

13

Drawer bottom support - 2

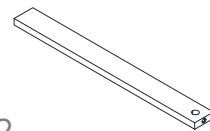

14

Drawer bottom - 2

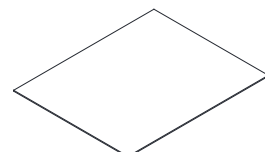

15

Left drawer face - 1

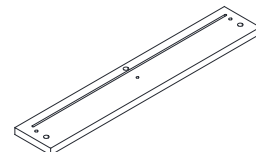

16

Right drawer face - 1

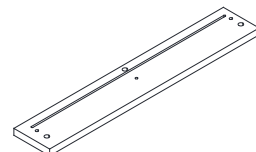

A

Rail track (left) - 2

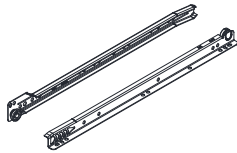
**B**

Rail track (right) - 2

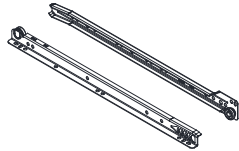
**C**

Screw 3.5 x 12 mm - 24

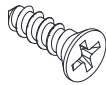
**D**

Wood dowel 7.8 x 30 mm - 8

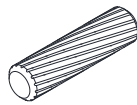
**E**

Cam bolt (large) - 2

**F**

Connecting rod - 4

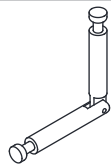
**G**

Cam (large) - 10

**H**

Screw 6 x 65 mm - 8

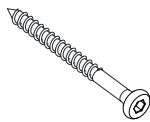
**I**

Bolt M6 x 60 mm - 4

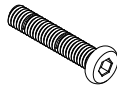
**J**

Crosshead nut - 4

**K**

Bolt M6 x 35 mm - 4

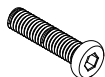
**L**

Screw 5 x 50 mm - 6

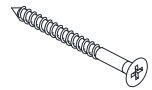
**M**

Wood dowel 5.8 x 30 mm - 12

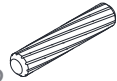
**N**

Screw 3.8 x 35 mm - 10

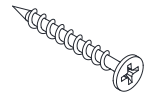
**O**

Cam bolt (small) - 6

**P**

Cam (small) - 6

**Q**

Screw 4 x 35 mm - 2

**R**

Handle - 2

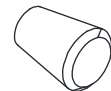
**S**

Drawer connector - 8

**T**

Screw 3 x 16 mm - 8

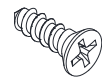
**U**

Hex wrench - 1

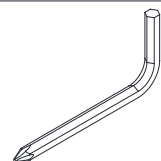
**V**

Glue - 2



6 MODEL NO. 168-0001-0

- Read each section carefully before starting. It is very important that each step is performed in the correct order. If these steps are not followed in sequence, assembly difficulties will occur.
- Make sure all parts are included. Most board parts are labelled or stamped on the raw edge.
- Work in a spacious area, preferably on a carpet, near the place the unit will be located.
- Do not use power tools to assemble your furniture. Power tools may strip or damage the parts.

HELPFUL HINTS

- Identify, sort and count the parts before beginning assembly.
- Compression dowels should be tapped in with a rubber mallet.
- Slides have a lip on the right side only.
- Back panels provide stability and support. Unit may collapse without the back panel installed.
- Clean the product with your choice of furniture polish and a soft cloth. **DO NOT USE** harsh chemicals nor abrasive cleaners.
- Move your new furniture carefully. Two people are needed to lift and carry the unit to its new location.
- Never push nor drag your furniture (especially on a carpet).

These illustrations show how the cam fastening system works.

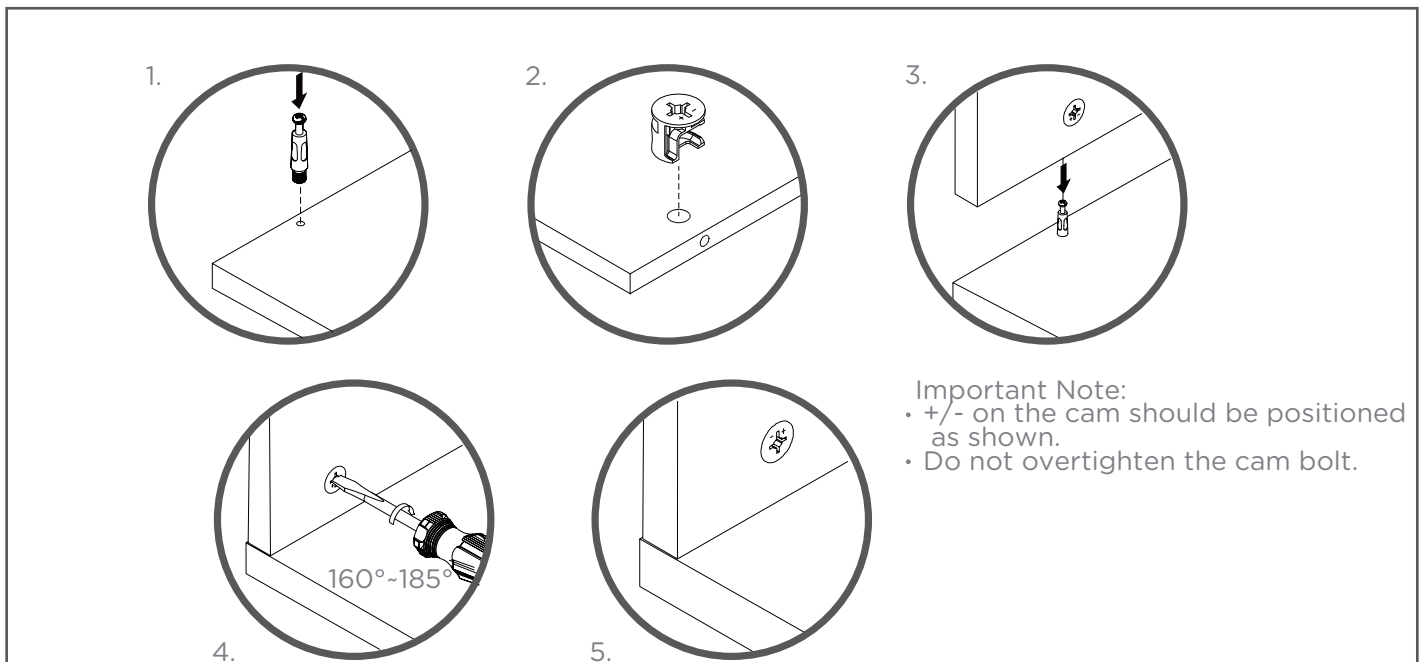

Needed for assembly:



Star-head
screwdriver



Flat-head
screwdriver

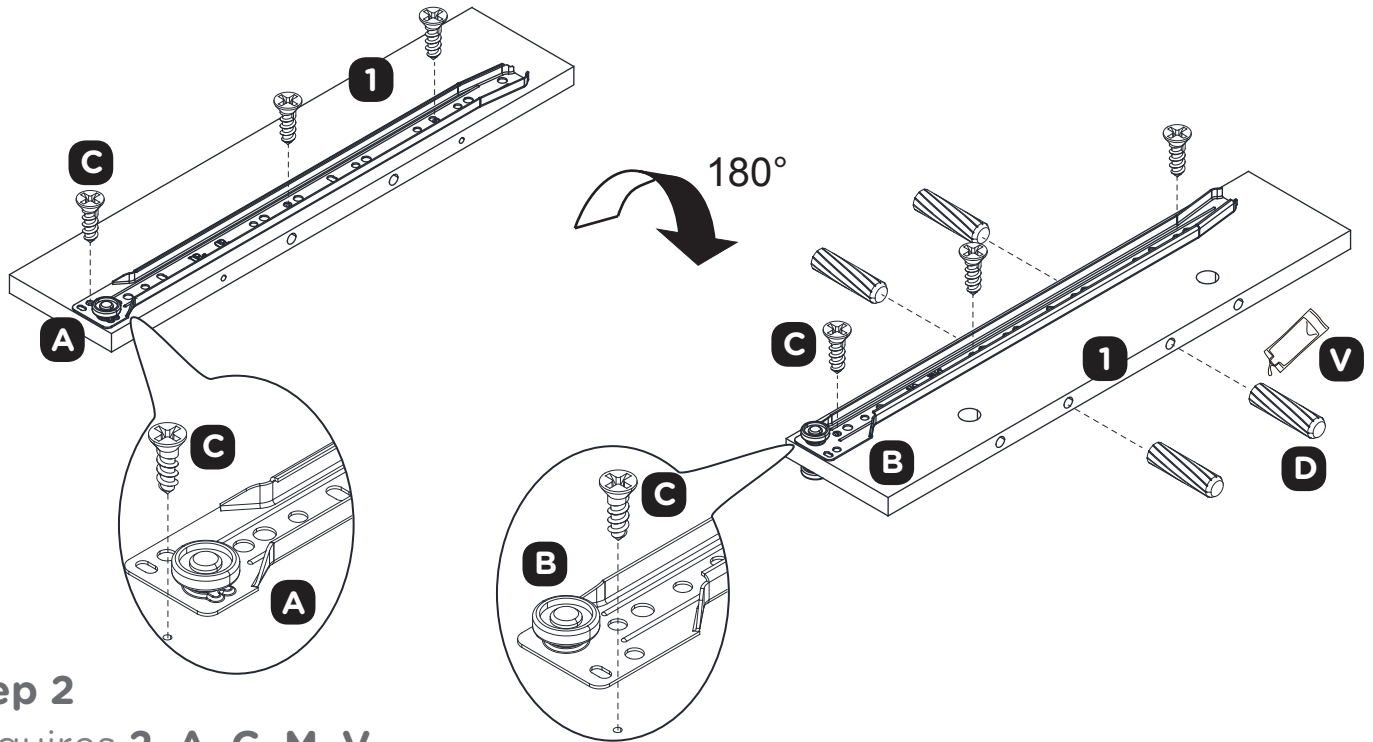
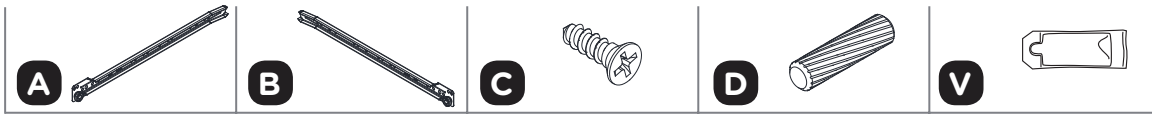
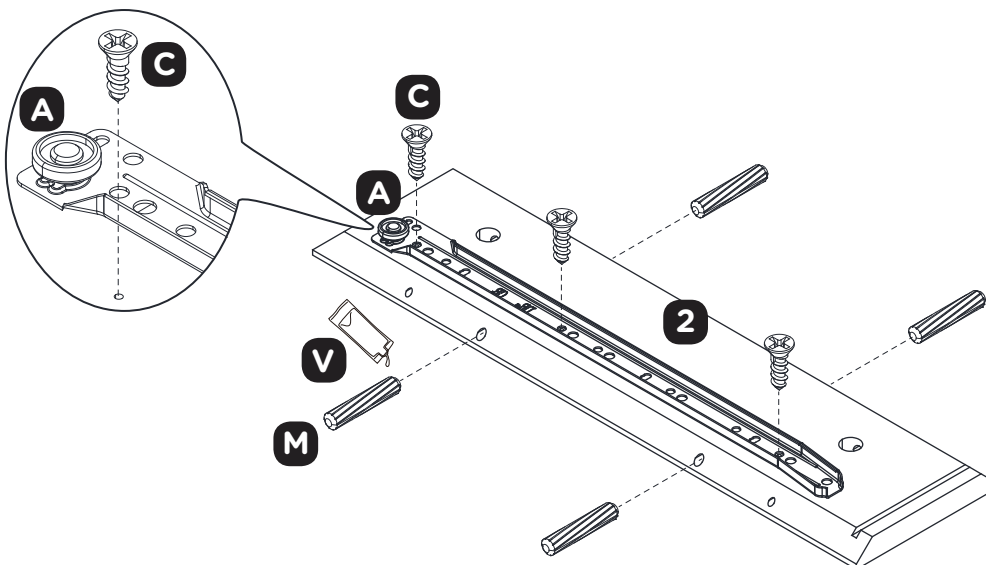

2 people

Step 1Requires **1, A, B, C, D, V****Step 2**Requires **2, A, C, M, V**

8 MODEL NO. 168-0001-0

Step 3

Requires **3, B, C, M, V**

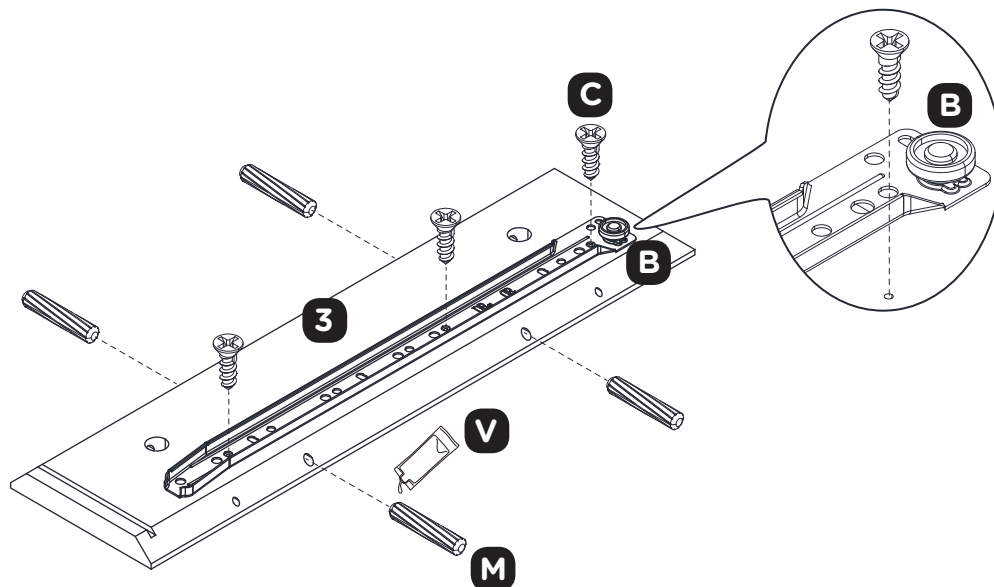

Step 4

Requires **4, E, F, G**

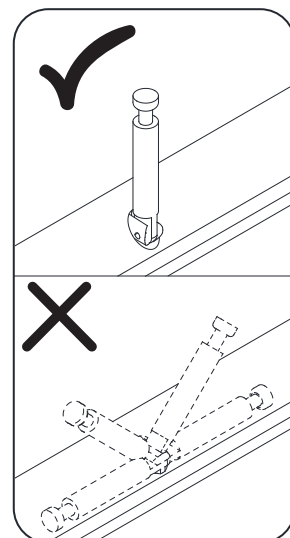
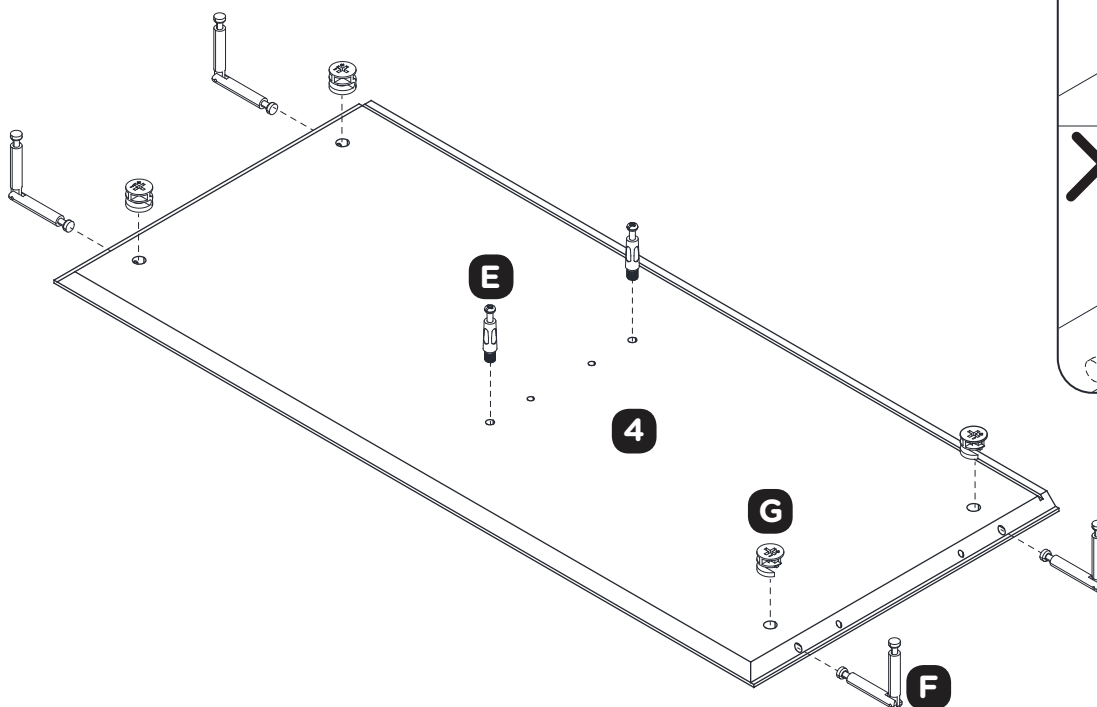
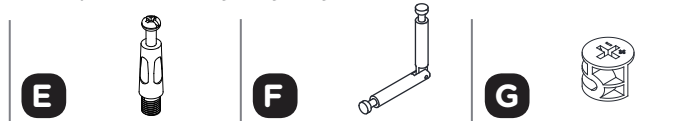

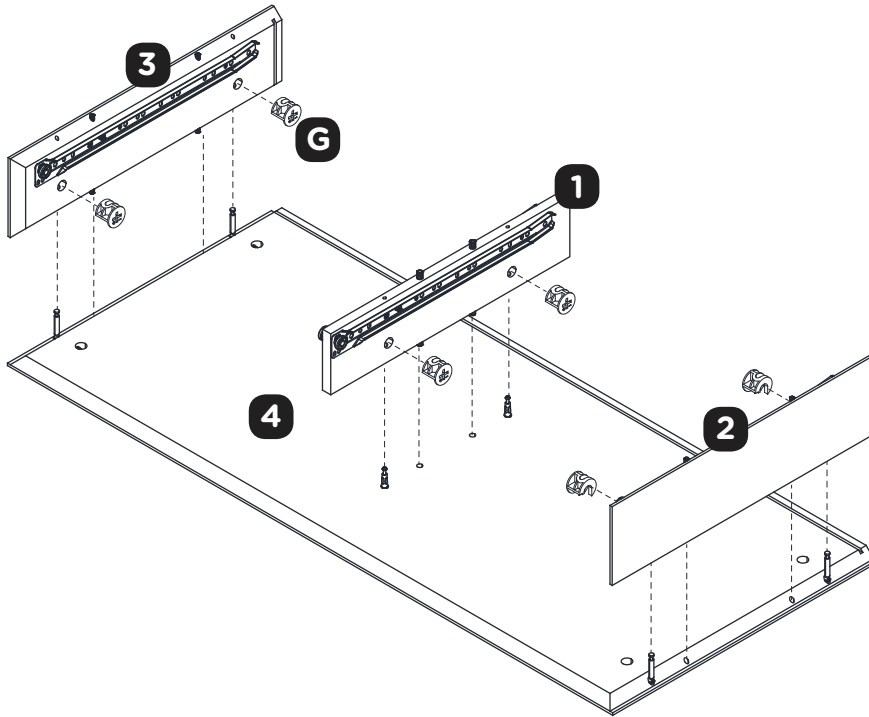
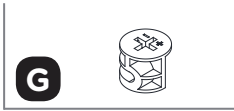
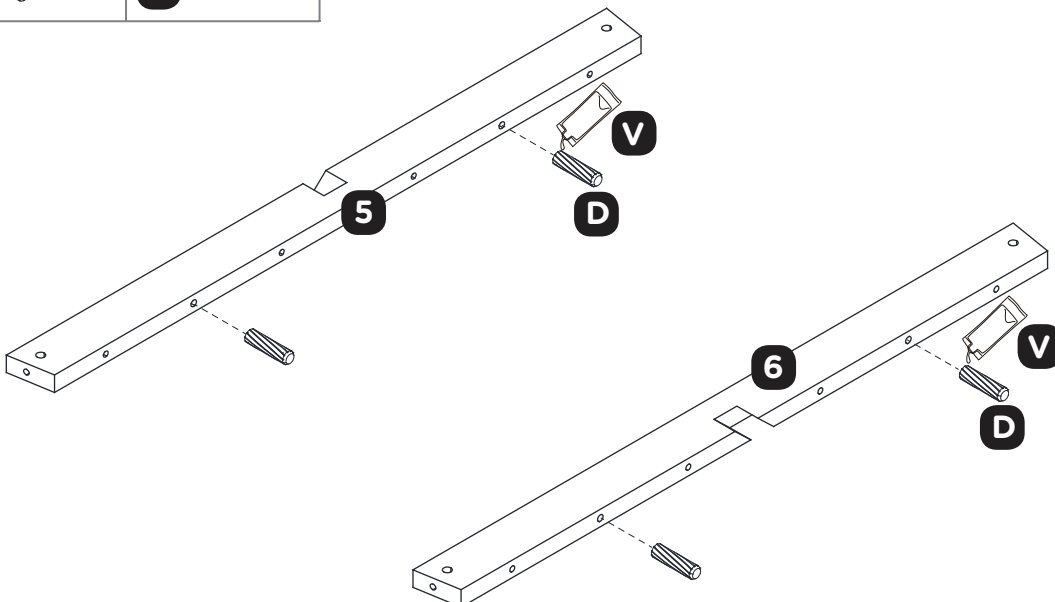
Step 5Requires **1, 2, 3, 4, G****Step 6**Requires **5, 6, D, V**

10 MODEL NO. 168-0001-0

Step 7

Requires **5**, **7**, **H**, **U**

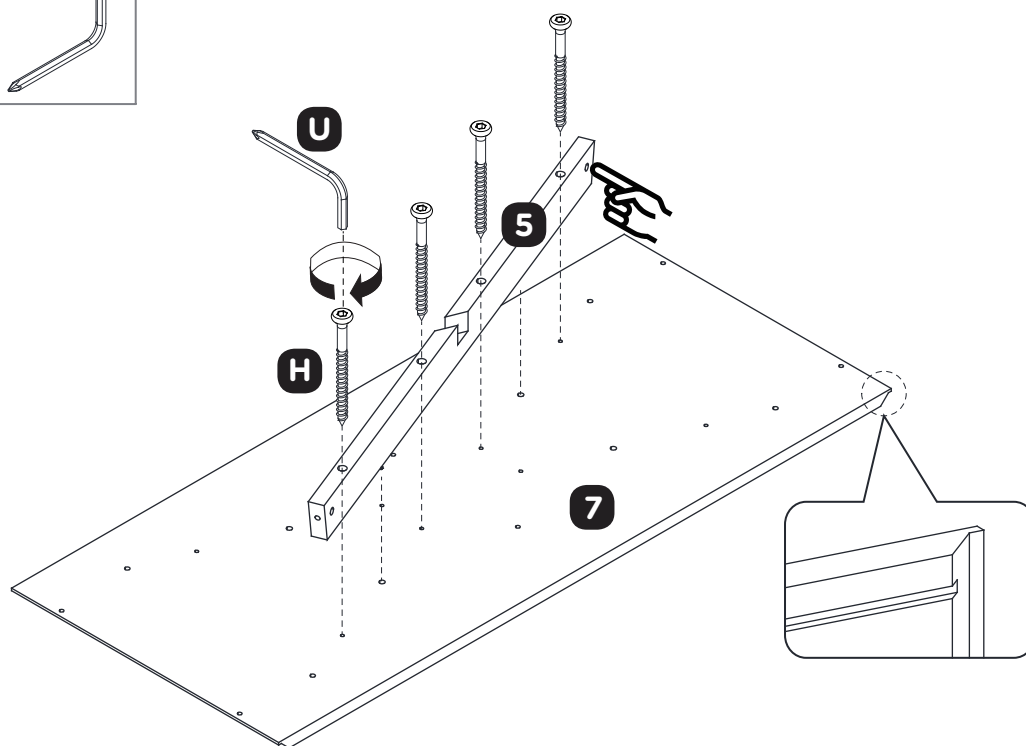

Step 8

Requires **6**, **7**, **H**, **U**

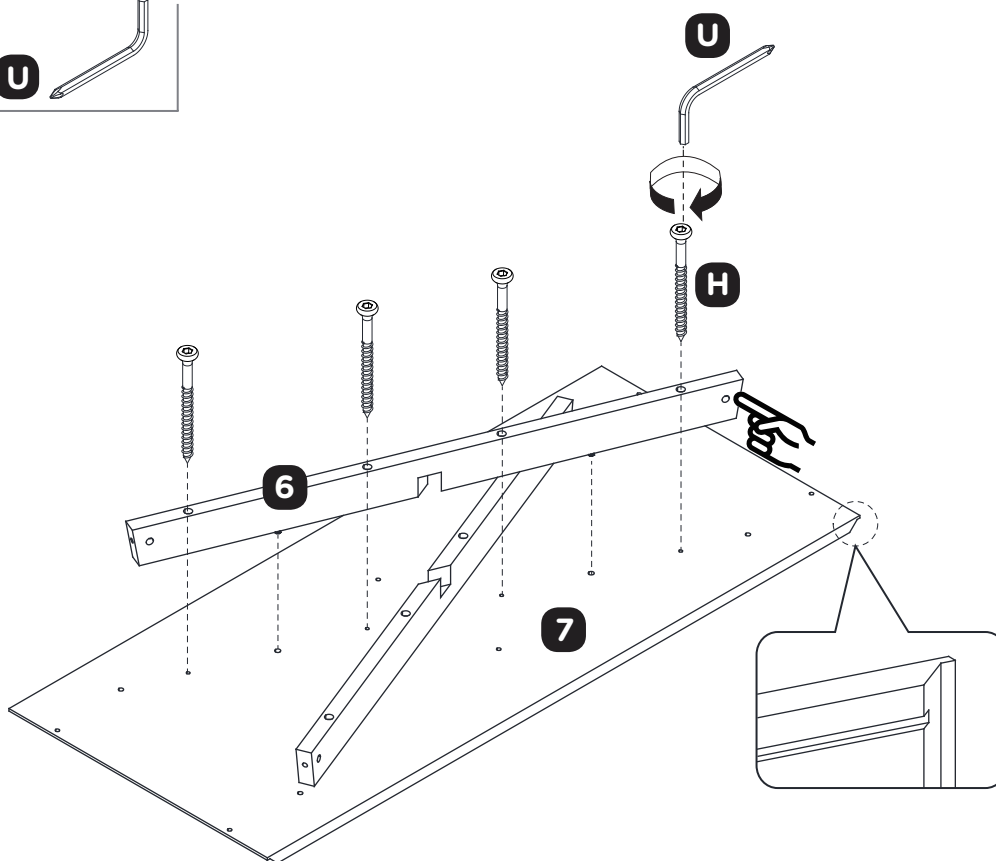

Step 9Requires **7, 8, I, J, U**

Warning: Before completely fastening the parts in Step 9, make sure the parts in Step 10 are fastened in position.

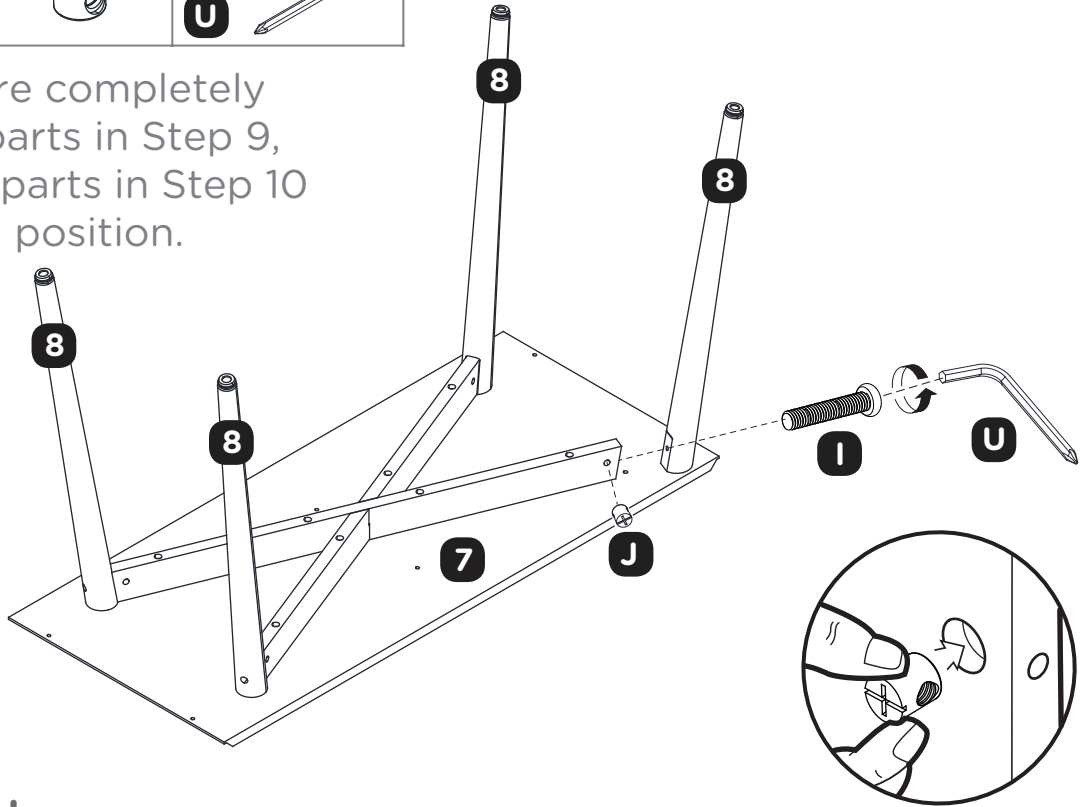
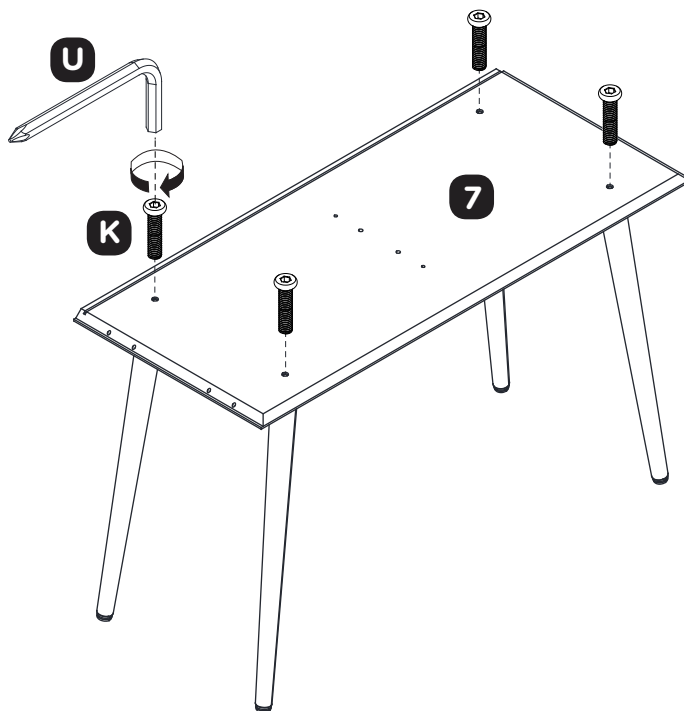
**Step 10**Requires **7, K, U**

12 MODEL NO. 168-0001-0

Step 11

Requires **9**

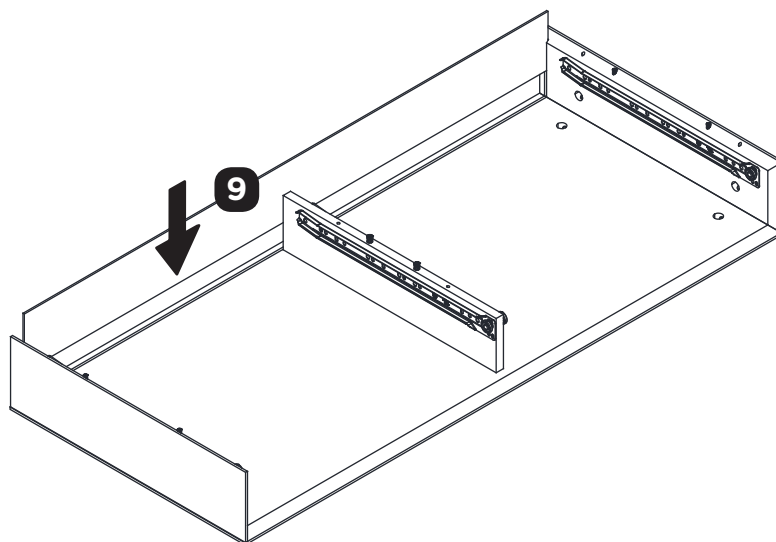

Step 12

Requires **7, L**

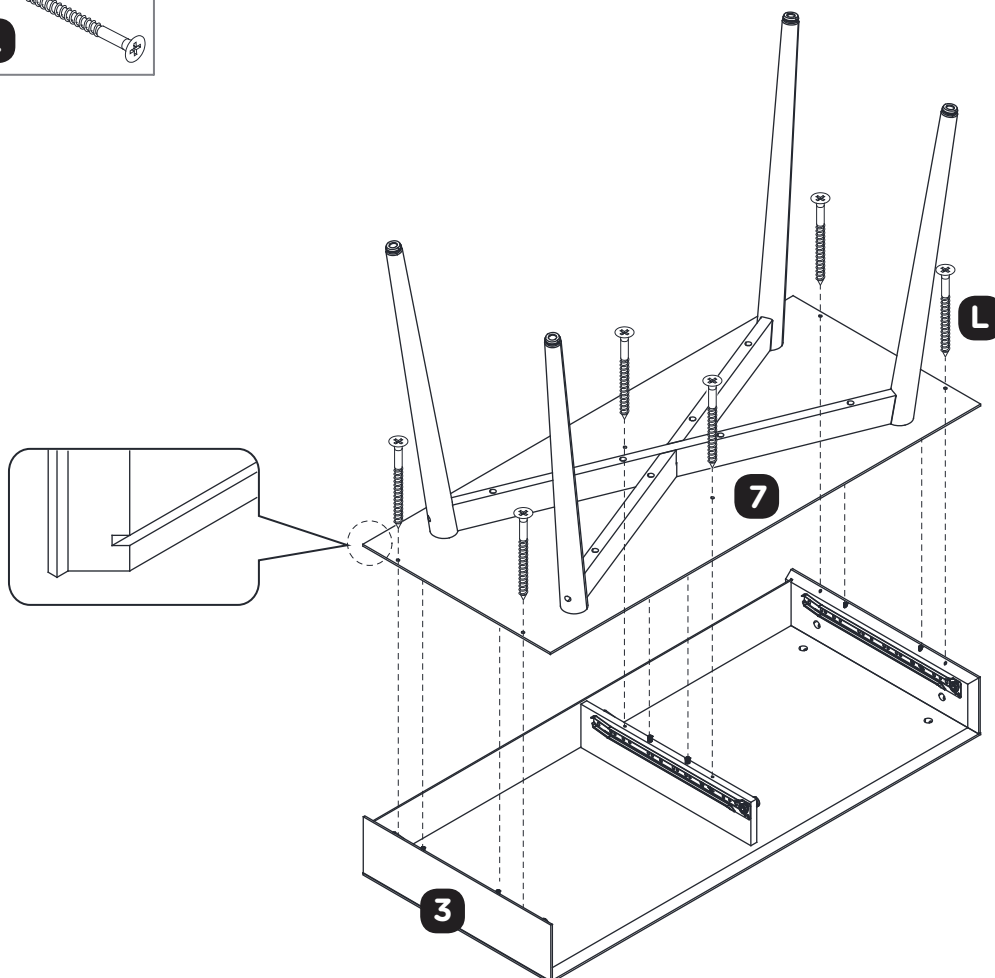

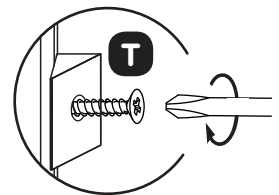
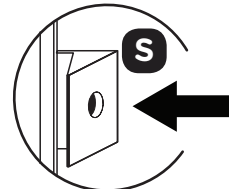
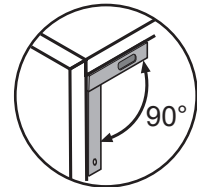
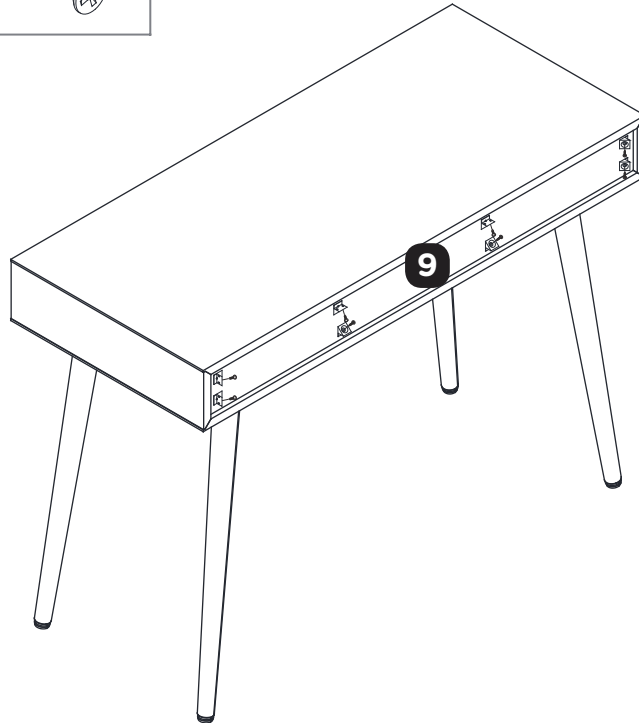
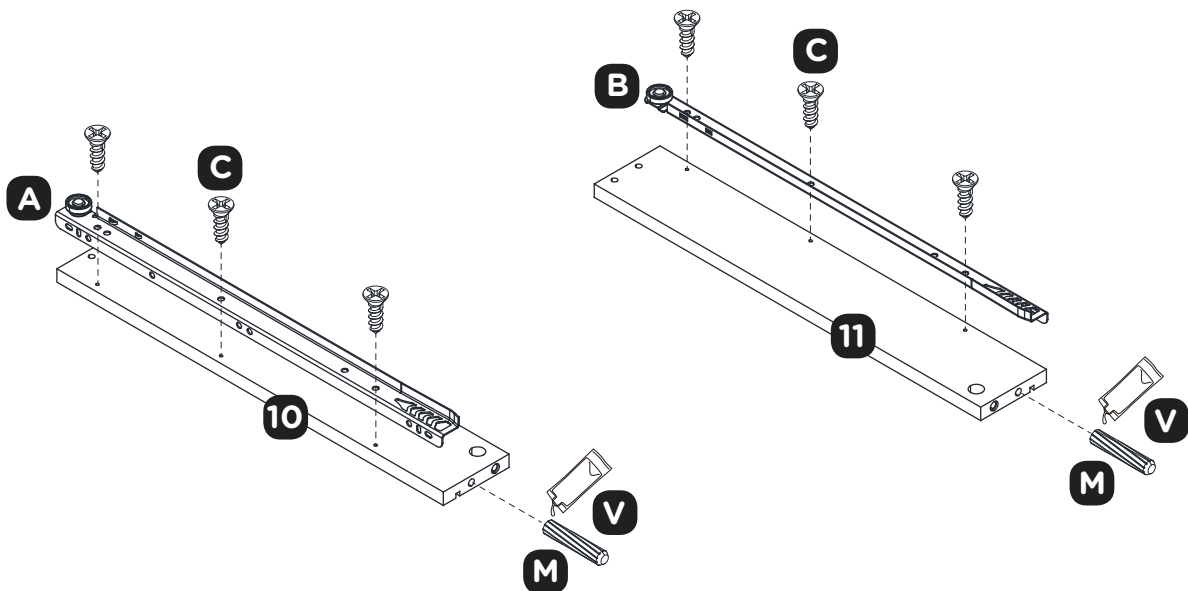
Step 13Requires **S**, **T****Step 14 x 2**Requires **10**, **11**, **A**, **B**, **C**, **M**, **V**

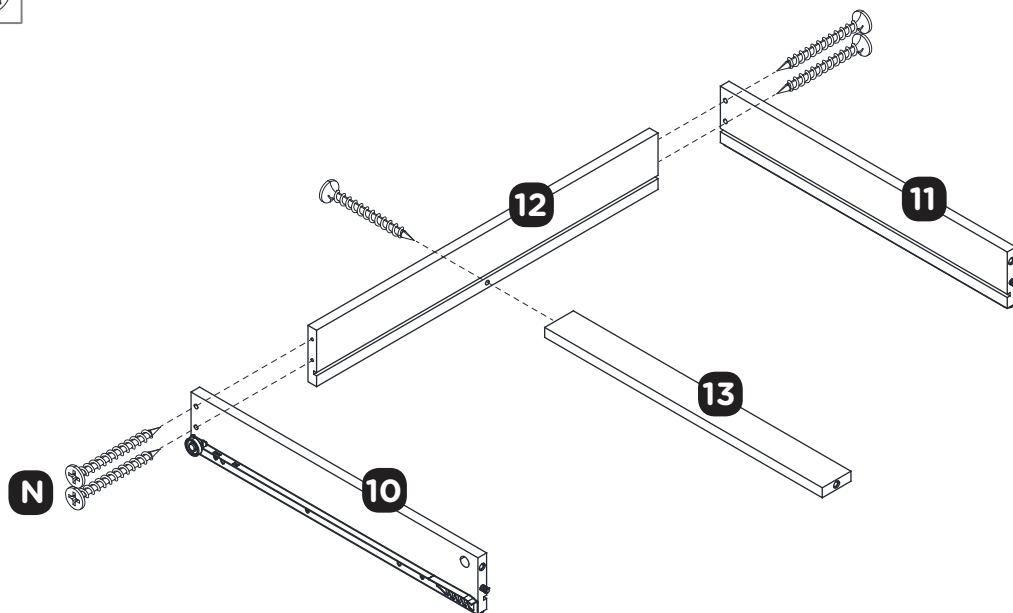
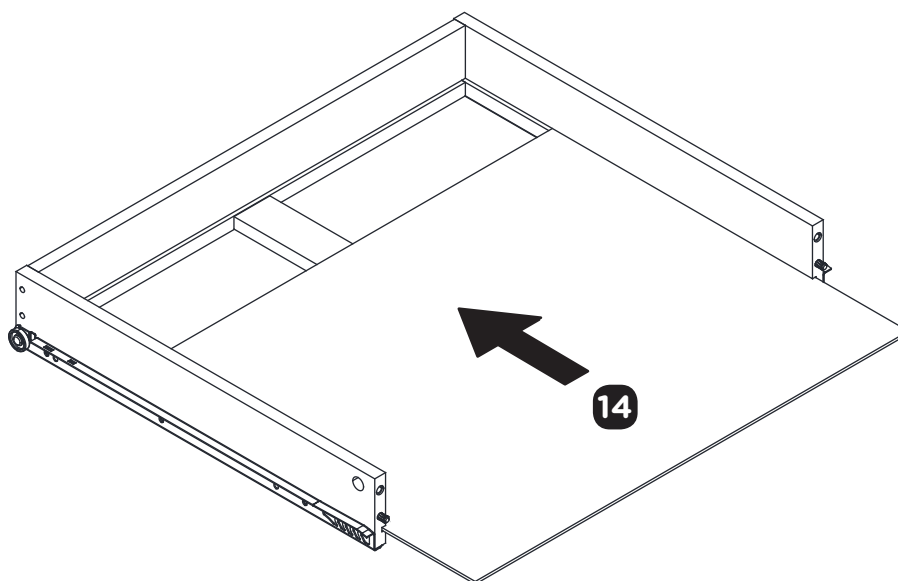
14 MODEL NO. 168-0001-0**Step 15 x 2**Requires **10, 11, 12, 13, N****Step 16 x 2**Requires **14**

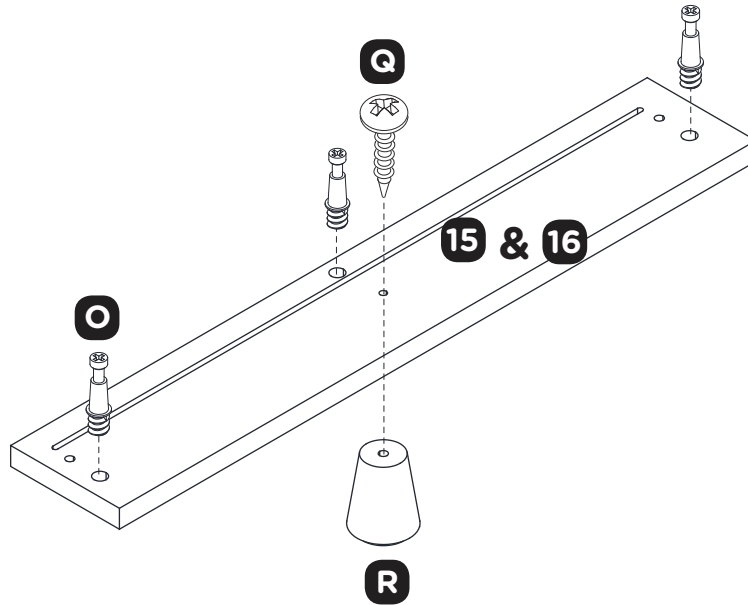
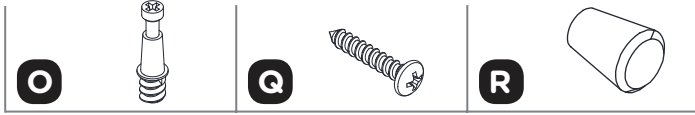
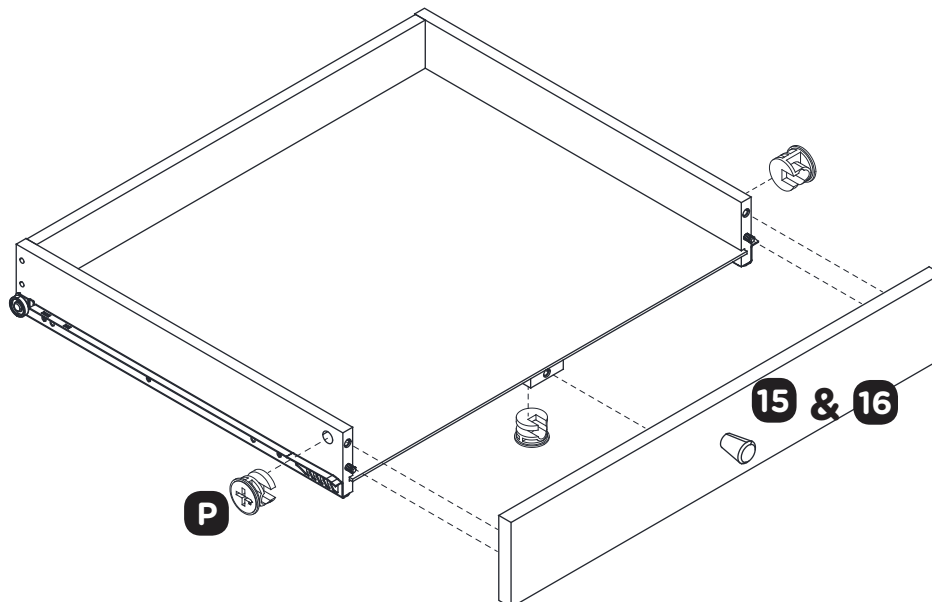
Step 17 x 2Requires **15, 16, O, Q, R****Step 18 x 2**Requires **15, 16, P**

16 MODEL NO. 168-0001-0

Step 19

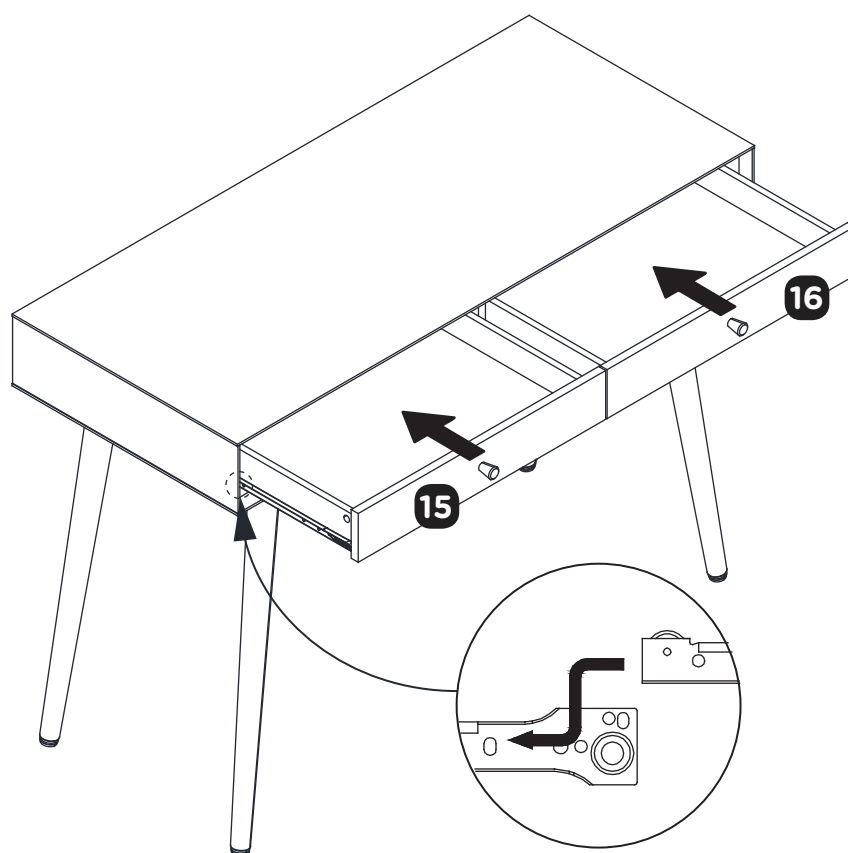

Step 20

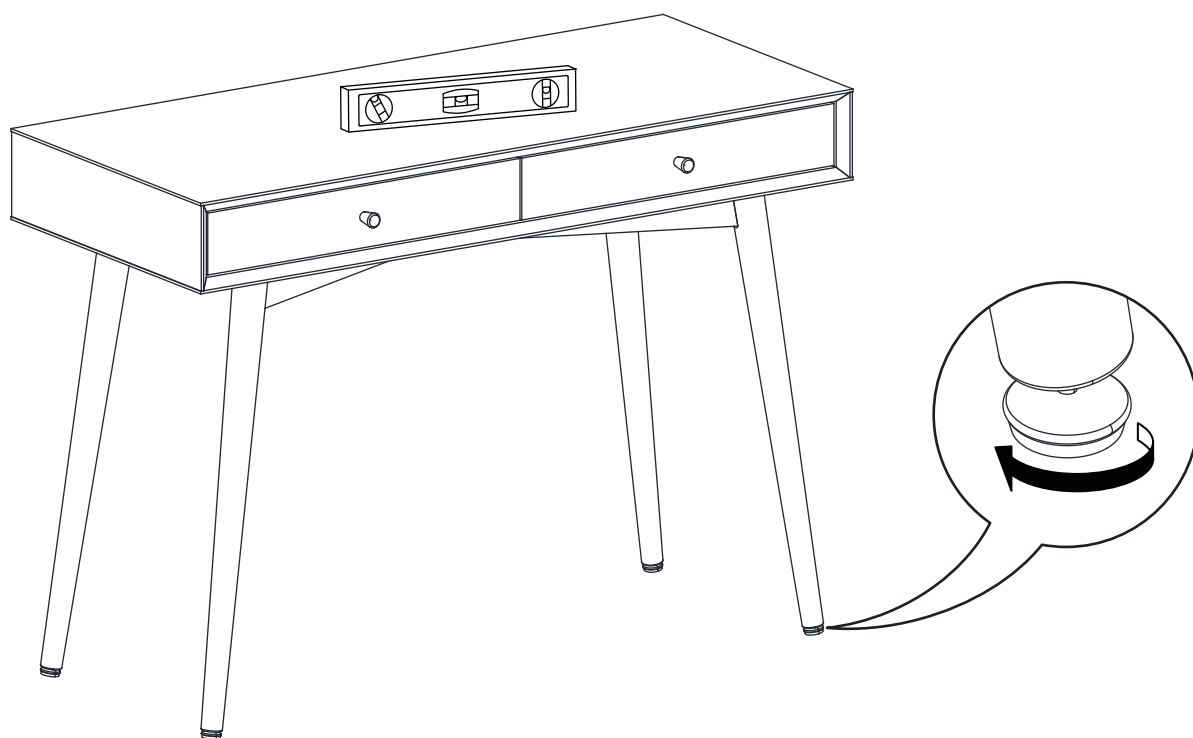

Step 21 Enjoy your furniture

WEIGHT LIMITS

This unit has been designed to support the maximum loads shown. Exceeding these load limits could cause sagging, instability, product collapse, and/or serious injury.

Please make sure that all objects are removed before moving the assembled unit.

The unit must be lifted by more than one person, not dragged nor pushed. Failure to do so will cause product damage, instability, product collapse, and/or serious injury.

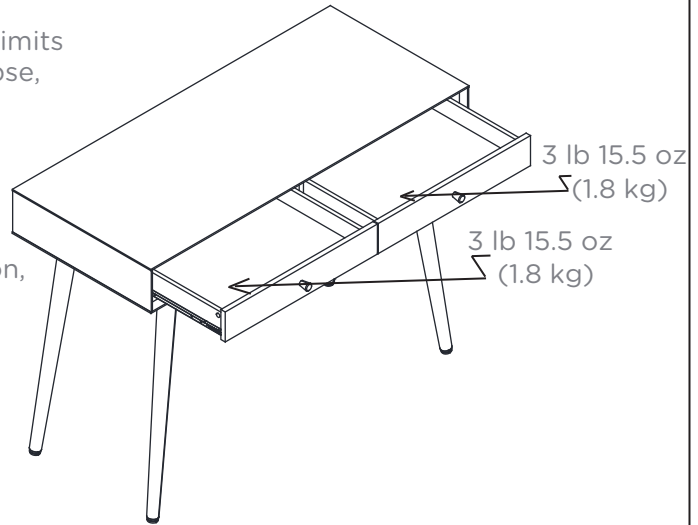

Dimensions (H x W x D)	17 3/4 x 41 3/4 x 14 1/4"
	45 x 106 x 36 cm
Product weight	56 lb
	25.4 kg

This CANVAS™ product carries a one (1) year warranty against defects in workmanship and materials. Trileaf Distribution agrees to replace a defective product free of charge within the stated warranty period, when returned by the original purchaser with proof of purchase. This product is not guaranteed against wear or breakage due to misuse and/or abuse.

CANVAS^{TM/MC}

CONSOLE/BUREAU COPENHAGEN

N° DE MODÈLE : 168-0001-0

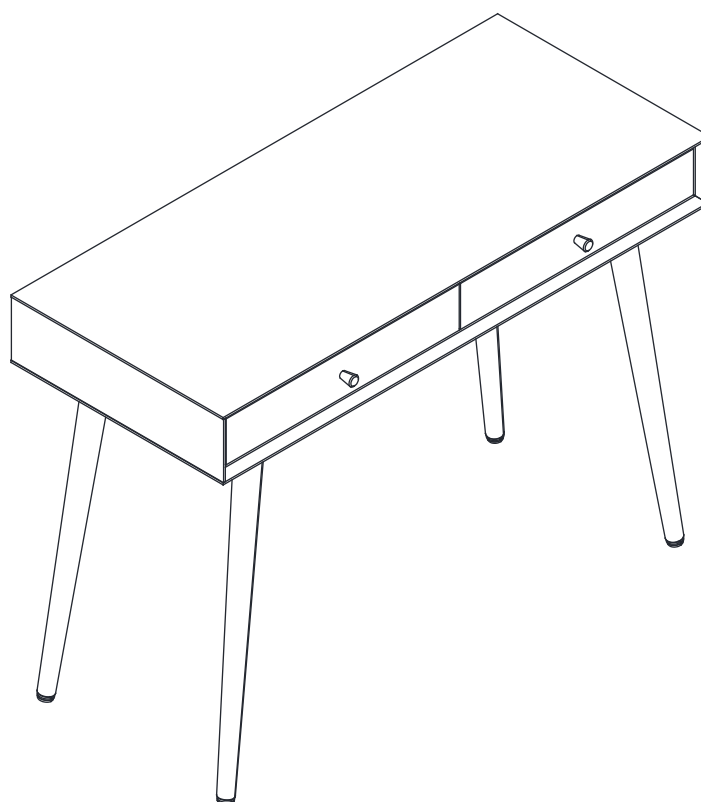

INSTRUCTIONS D'ASSEMBLAGE

Numéro sans frais : 1 888 670-6684

IMPORTANT : Veuillez lire attentivement et bien comprendre le présent guide avant de commencer l'assemblage, assurez-vous que toutes les pièces sont présentes. Comparez les pièces à la liste de contenu de l'emballage. S'il manque des pièces, ou si vous avez des questions, communiquez avec le service d'assistance téléphonique au 1 888 670-6684 (numéro sans frais).

Fabriqué en Chine

Importé par Trileaf Distribution Trifeuil, Toronto, Canada M4S 2B8

Table des matières	3
Consignes de sécurité importantes	3
Liste des pièces	4
Assemblage	6
Fiche technique	18
Garantie	18



Avertissement! Pour réduire le risque de blessures graves, lisez les consignes de sécurité suivantes avant d'assembler et d'utiliser ce produit.

- Ce produit est destiné à une utilisation à l'intérieur.
- Le produit doit être placé horizontalement sur le plancher.
- Tout montage ou entretien du produit doit être effectué par un adulte.
- Les sacs en plastique peuvent être dangereux. Pour éviter le risque de suffocation, conservez ce sac hors de la portée des enfants.

IMPORTANT : Conservez ce guide à des fins de consultation ultérieure et lisez-le attentivement.

4 N° DE MODÈLE : 168-0001-0

1

Séparateur - 1

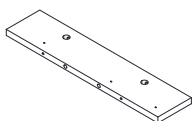

2

Panneau latéral gauche - 1

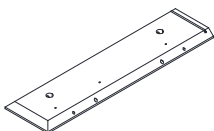

3

Panneau latéral droit - 1

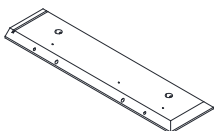

4

Panneau supérieur - 1

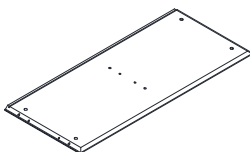

5

Bande inférieure 1 - 1

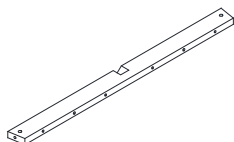

6

Bande inférieure 2 - 1

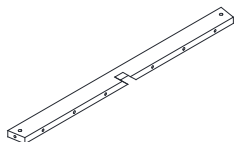

7

Fond - 1

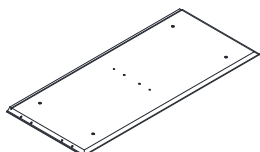

8

Pied de support - 4

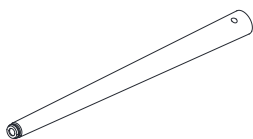

9

Panneau arrière - 1

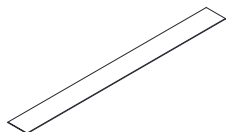

10

Côté du tiroir gauche - 2

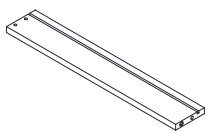

11

Côté du tiroir droit - 2

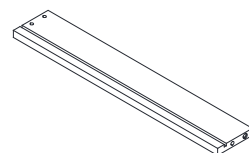

12

Arrière de tiroir - 2

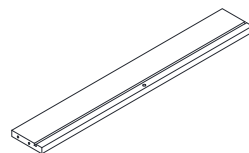

13

Traverse de support du fond du tiroir - 2



14

Fond du tiroir - 2

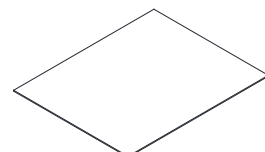

15

Le devant du tiroir gauche - 1

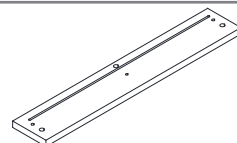

16

Le devant du tiroir droit - 1

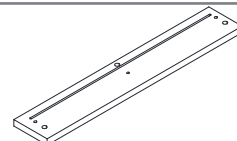

A

Rail (gauche) - 2

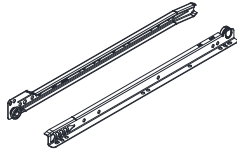
**B**

Rail (droit) - 2

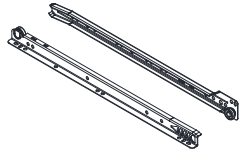
**C**

Vis 3,5 x 12 mm - 24

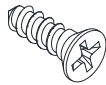
**D**

Goujon de bois 7,8 x 30 mm - 8

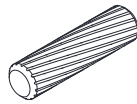
**E**

Boulon à came (gros) - 2

**F**

Biellette - 4

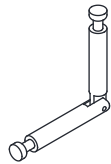
**G**

Came (gros) - 10

**H**

Vis 6 x 65 mm - 8

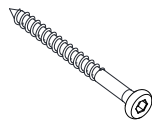
**I**

Boulon M6 x 60 mm - 4

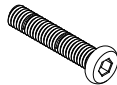
**J**

Écrou traverse - 4

**K**

Boulon M6 x 35 mm - 4

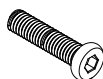
**L**

Vis 5 x 50 mm - 6

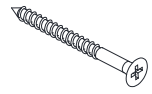
**M**

Goujon de bois 5,8 x 30 mm - 12

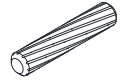
**N**

Vis 3,8 x 35 mm - 10

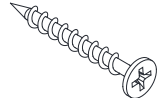
**O**

Boulon à came (petit) - 6

**P**

Came (petit) - 6

**Q**

Vis 4 x 35 mm - 2

**R**

Poignée - 2

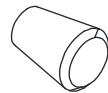
**S**

Connecteur de tiroir - 8

**T**

Vis 3 x 16 mm - 8

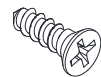
**U**

Clé hexagonale - 1

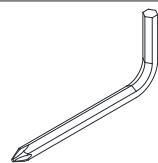
**V**

Colle - 2



6 N° DE MODÈLE : 168-0001-0

- Lisez chaque section attentivement avant de commencer l'assemblage. Il est très important que chaque étape soit effectuée dans le bon ordre. Sinon, vous risquez de rencontrer des difficultés lors de l'assemblage.
- Assurez-vous que toutes les pièces sont présentes. La plupart des pièces en bois sont étiquetées ou identifiées sur le bord non fini.
- Travaillez dans un endroit spacieux, de préférence sur un tapis, près de l'endroit où le meuble sera situé.
- N'utilisez pas des outils électriques pour assembler le meuble, car ils peuvent endommager les pièces.

CONSEILS UTILES

- Identifiez, séparez et vérifiez les pièces avant de commencer l'assemblage.
- Insérez les goujons de compression à l'aide d'un maillet en caoutchouc.
- Les glissières sont dotées d'un rebord seulement sur le côté droit.
- Les panneaux arrières stabilisent et soutiennent le meuble. Sans le panneau arrière, le meuble peut s'écrouler.
- Nettoyez l'article avec de la matière à polir ou un linge doux de votre choix.
N'UTILISEZ PAS de nettoyeurs chimiques puissants ou abrasifs.
- Déplacez votre nouveau meuble avec précaution avec l'aide d'une autre personne et portez-le jusqu'à son nouvel emplacement.
- Ne poussez pas et ne traînez jamais votre meuble (surtout sur un tapis).

Cette illustration montre comment fonctionne le système de fixation à came.

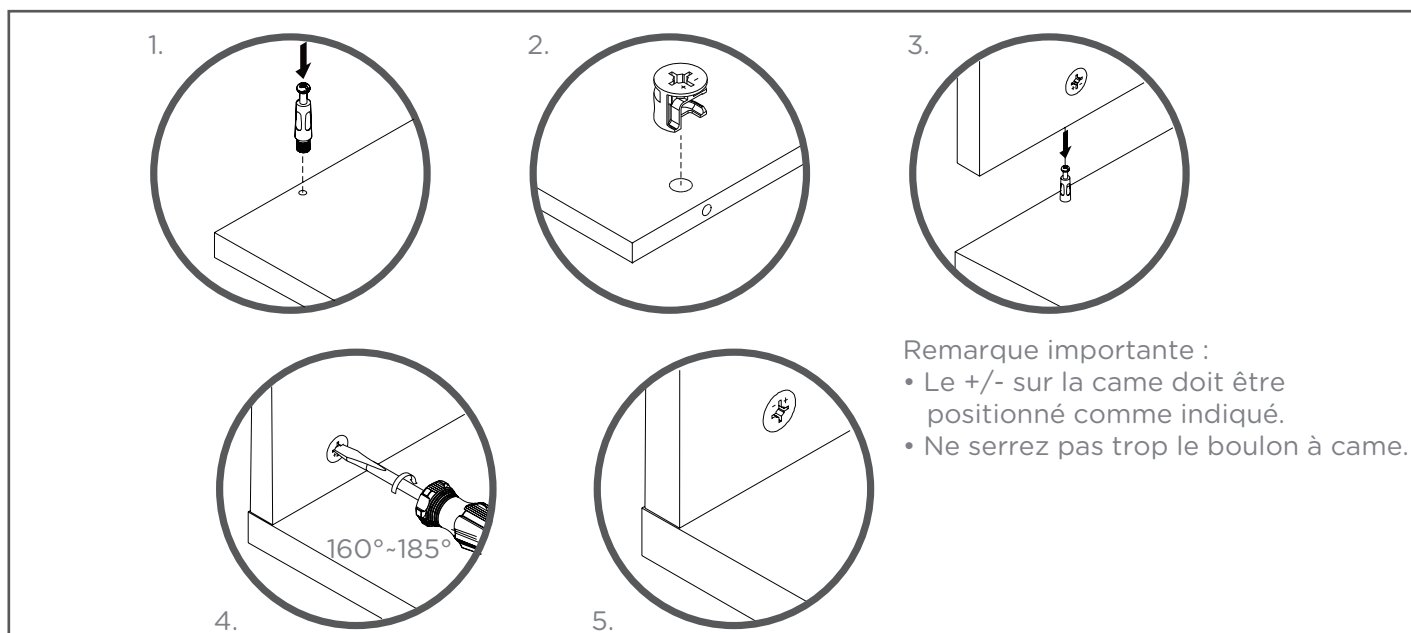

Requis pour l'assemblage :



Tournevis
cruciforme



Tournevis à tête
plate

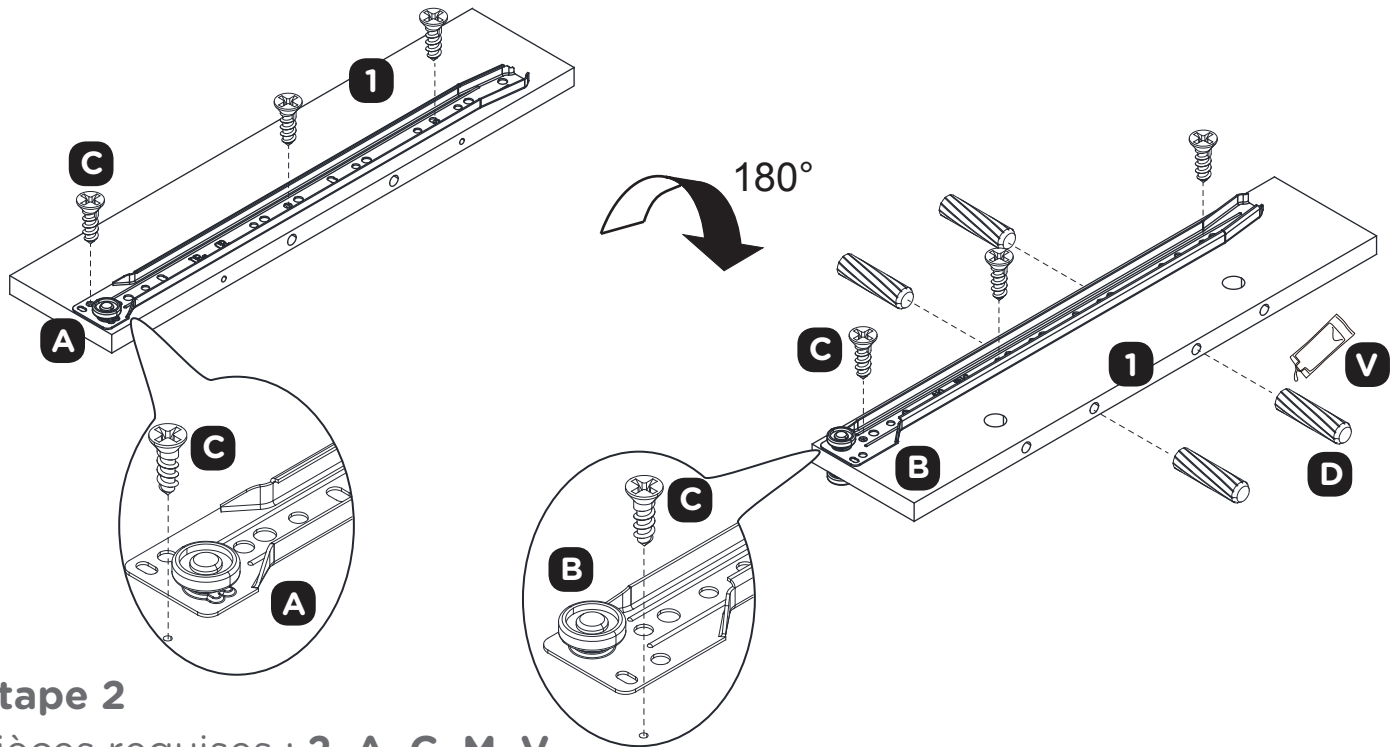
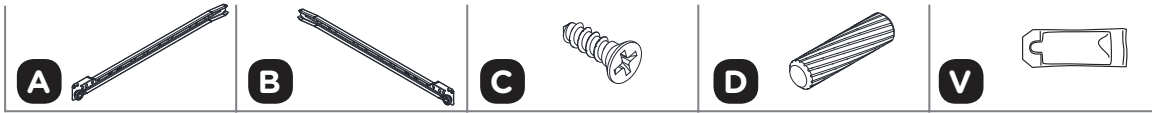
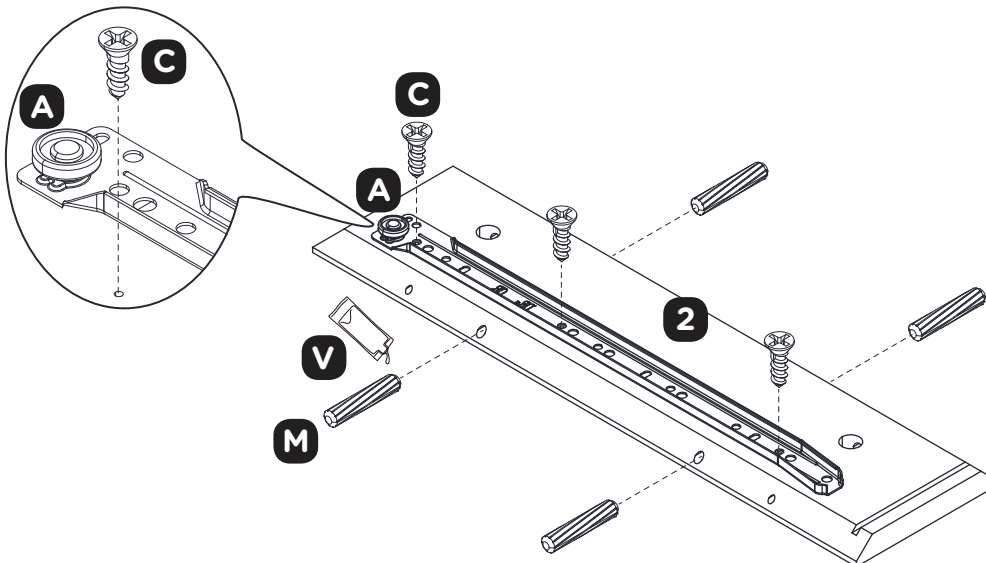

2 personnes

Étape 1Pièces requises : **1, A, B, C, D, V****Étape 2**Pièces requises : **2, A, C, M, V**

Étape 3

Pièces requises : **3, B, C, M, V**

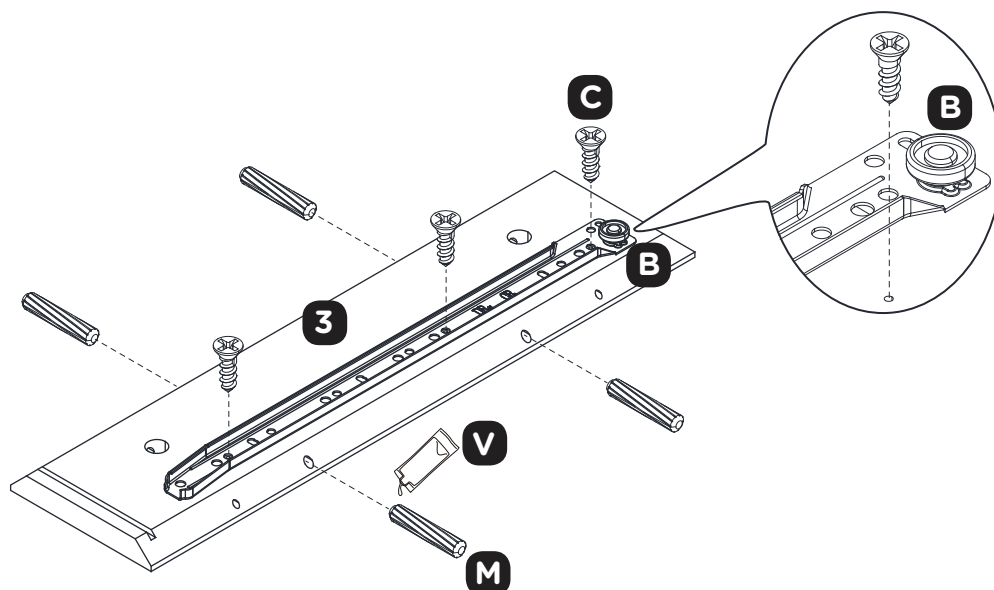

Étape 4

Pièces requises : **4, E, F, G**

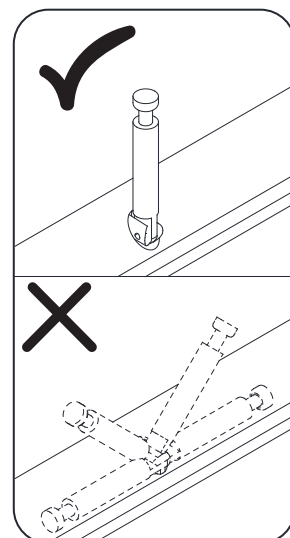
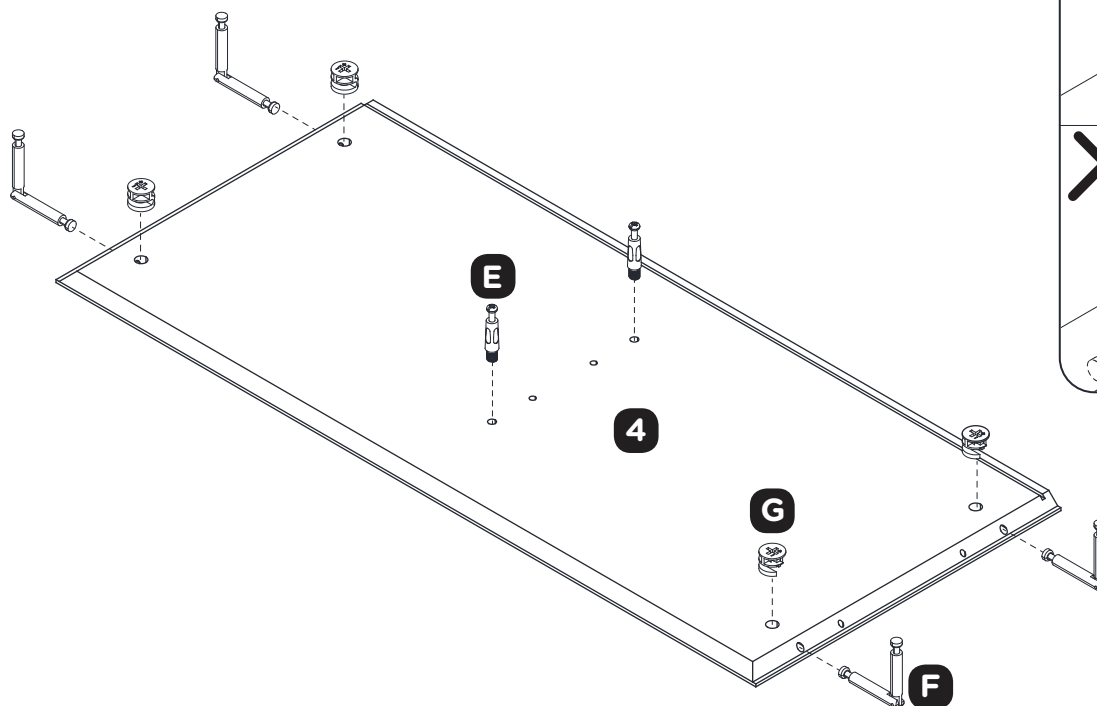

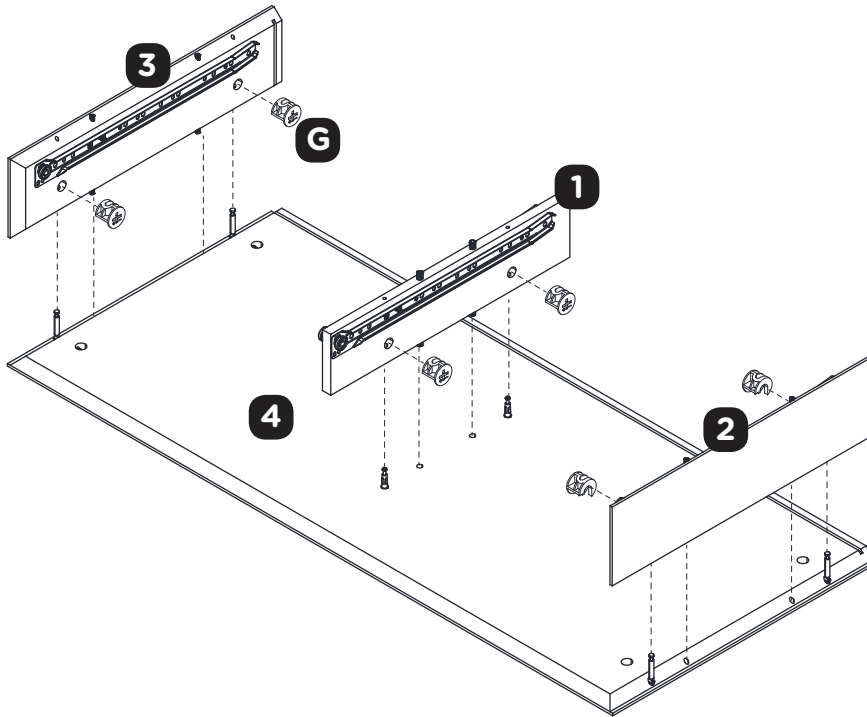
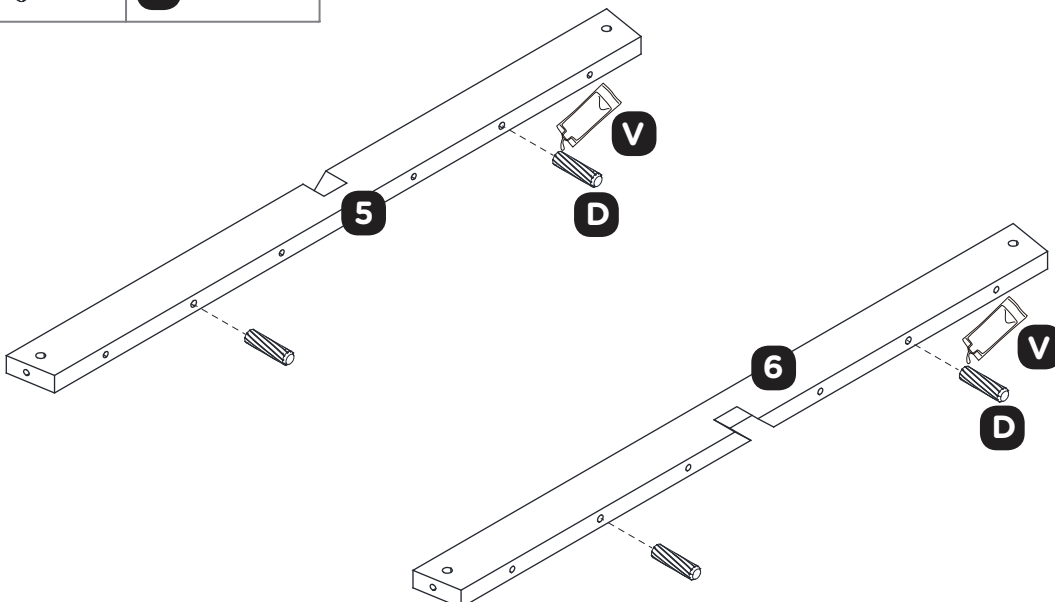
Étape 5Pièces requises : **1, 2, 3, 4, G****Étape 6**Pièces requises : **5, 6, D, V**

10 N° DE MODÈLE : 168-0001-0

Étape 7

Pièces requises : **5**, **7**, **H**, **U**

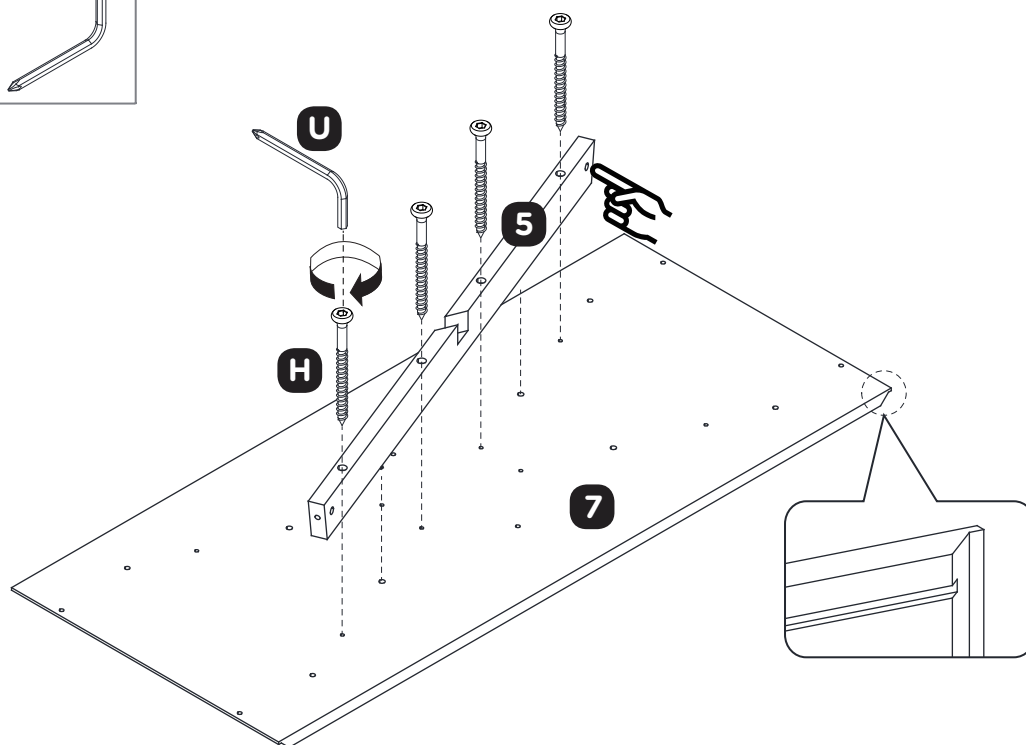
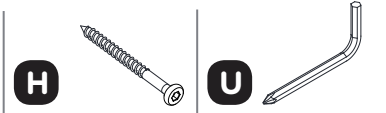

Étape 8

Pièces requises : **6**, **7**, **H**, **U**

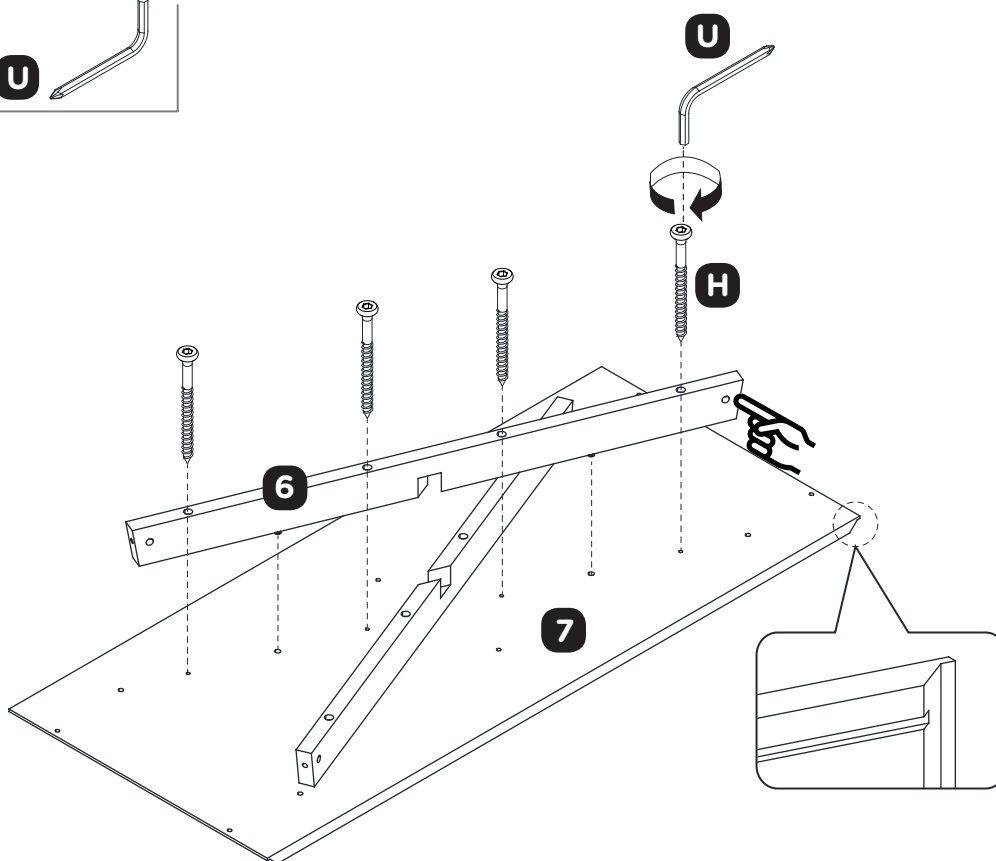

Étape 9

Pièces requises : 7, 8, I, J, U

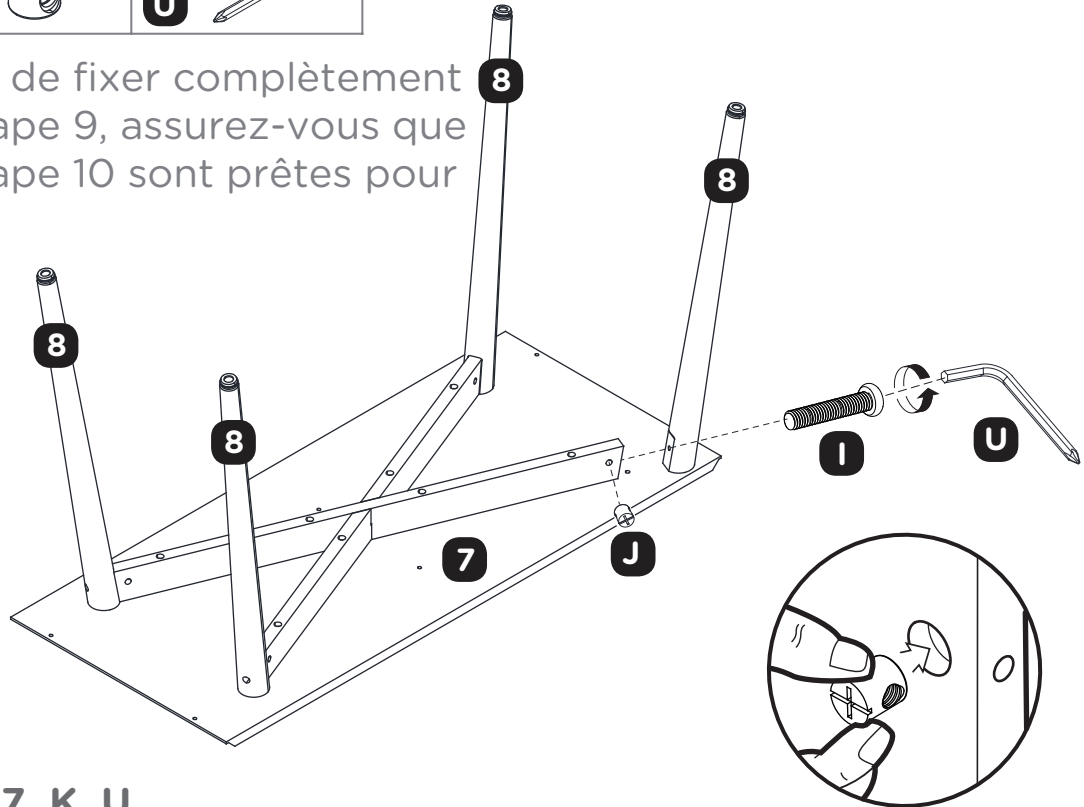

Attention : Avant de fixer complètement les pièces de l'Étape 9, assurez-vous que les pièces de l'Étape 10 sont prêtes pour l'assemblage.

**Étape 10**

Pièces requises : 7, K, U

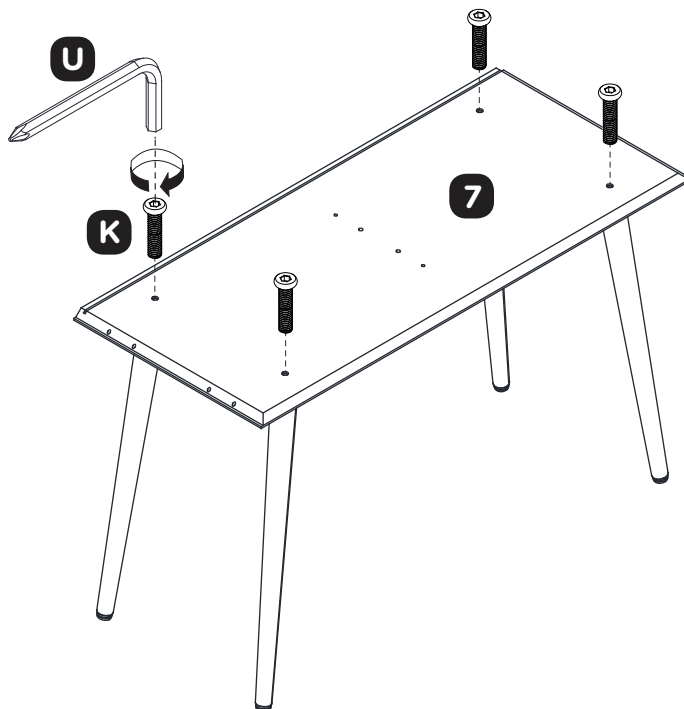

Étape 11

Pièce requise : **9**

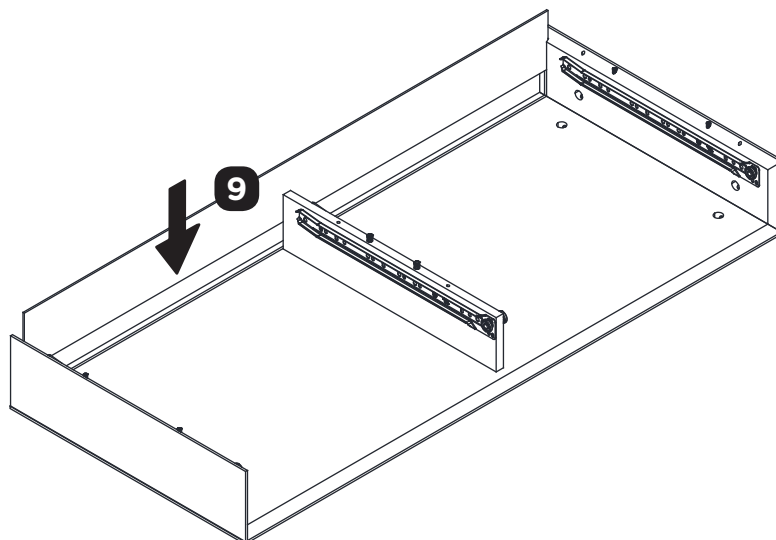

Étape 12

Pièces requises : **7, L**

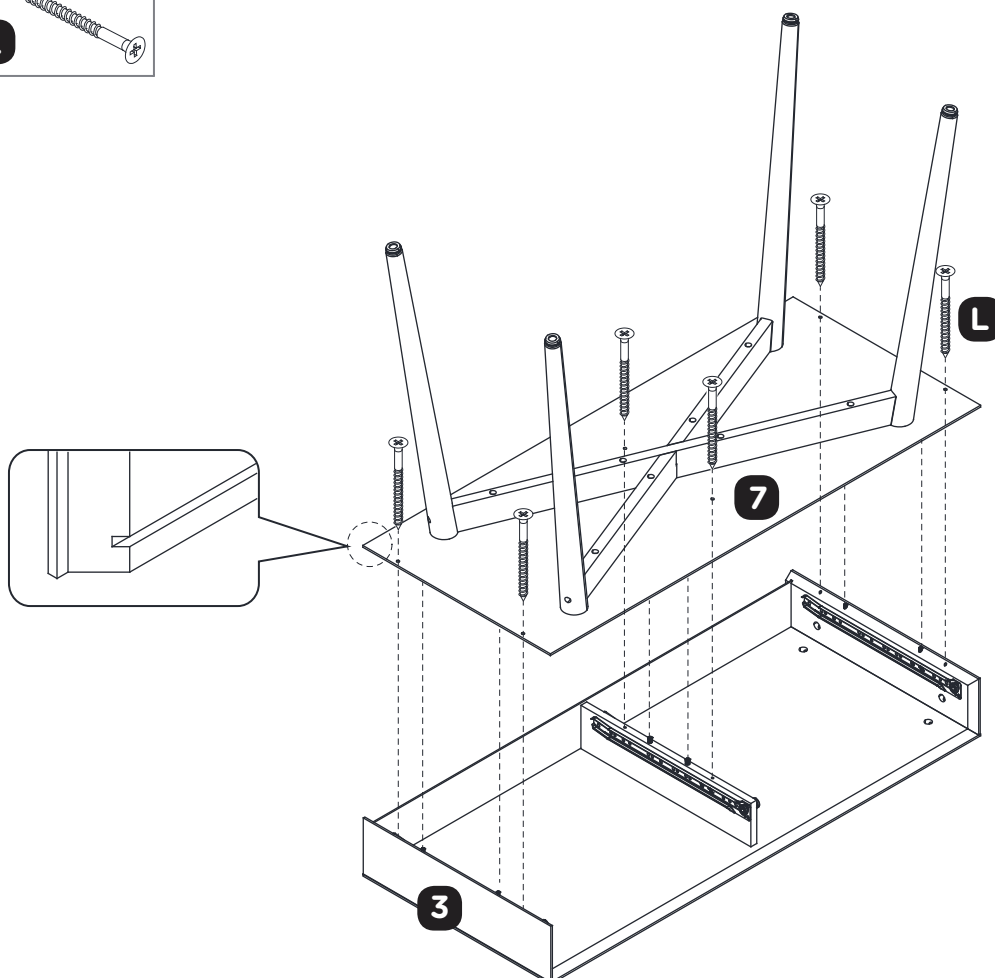
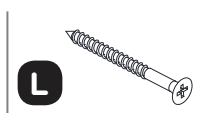

Étape 13

Pièces requises : S, T

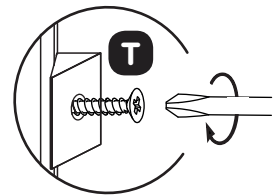
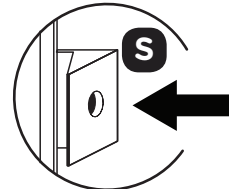
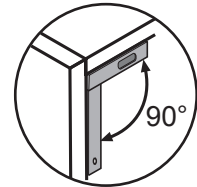
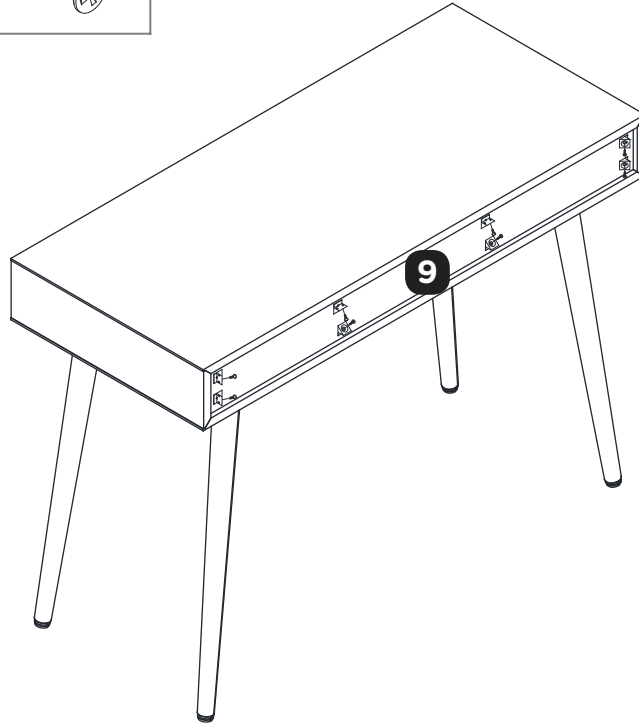

Étape 14 x 2

Pièces requises : 10, 11, A, B, C, M, V

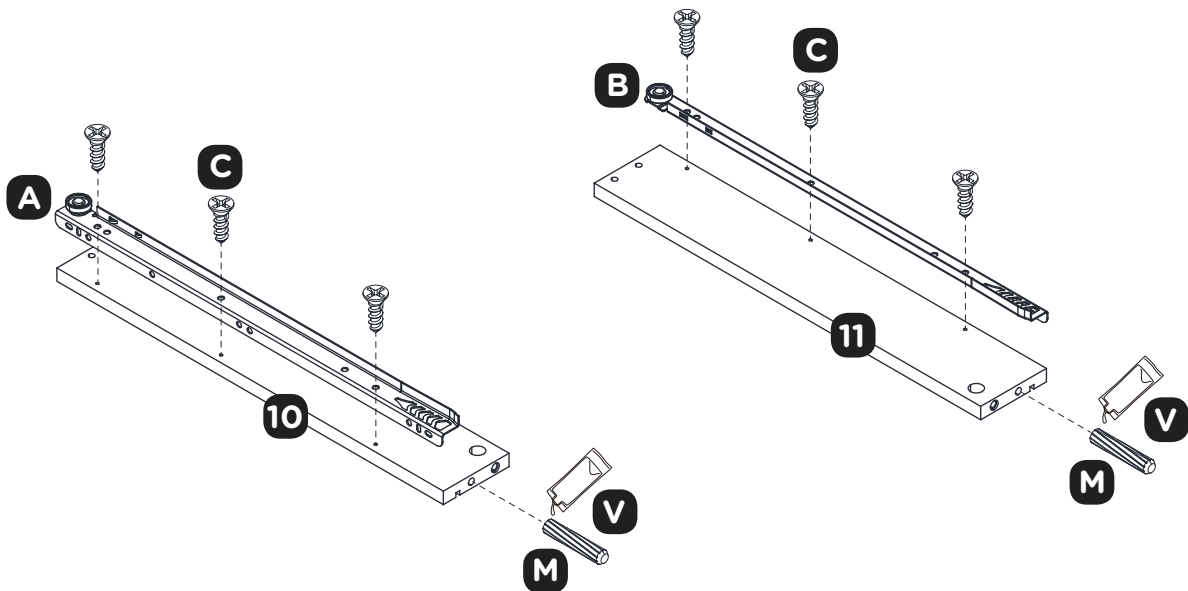

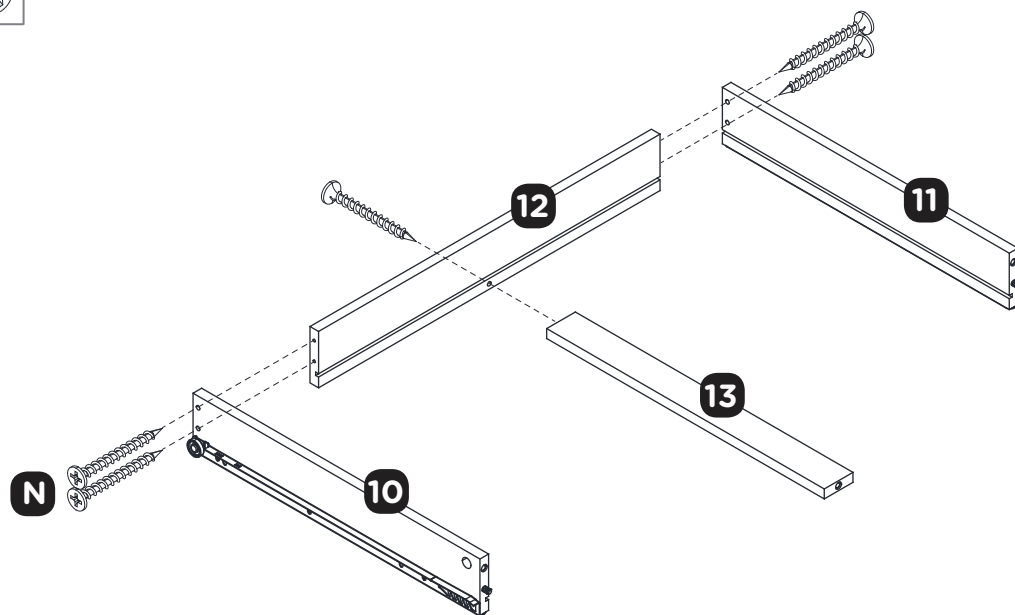
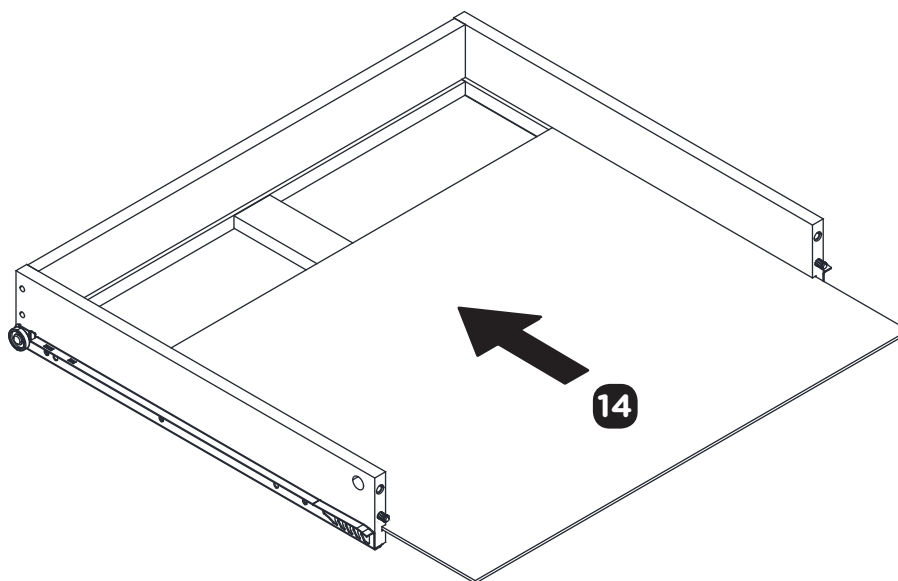
14 N° DE MODÈLE : 168-0001-0**Étape 15 x 2**Pièces requises : **10, 11, 12, 13, N****Étape 16 x 2**Pièce requise : **14**

Étape 17 x 2

Pièces requises : 15, 16, O, Q, R

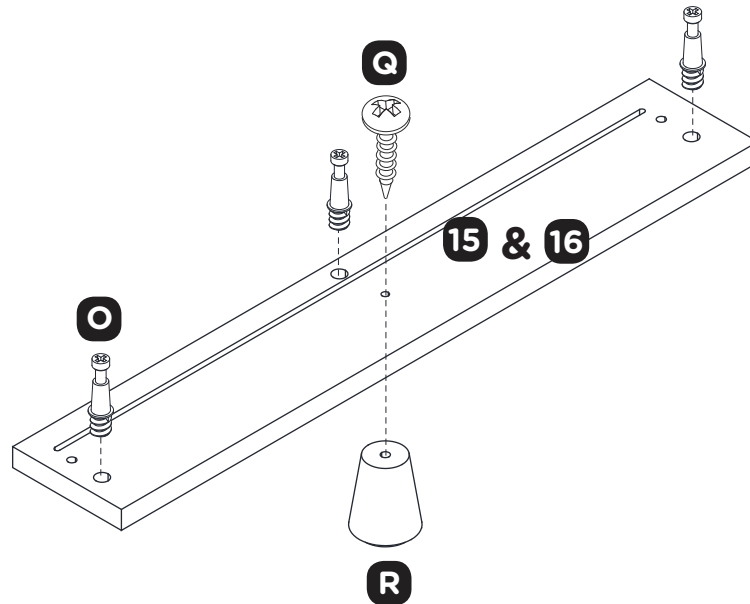
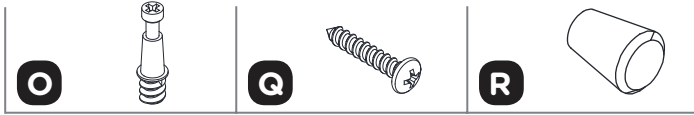
**Étape 18 x 2**

Pièces requises : 15, 16, P

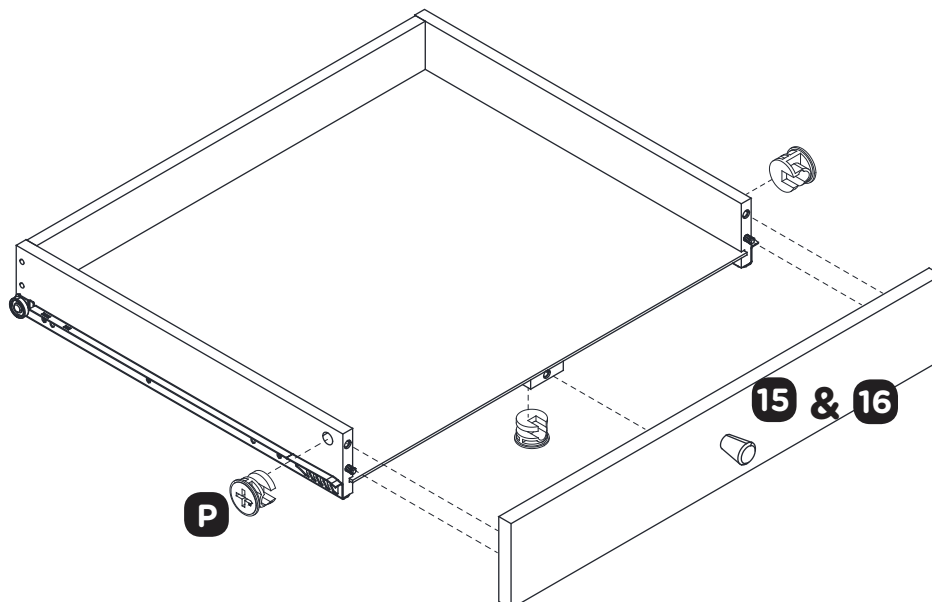

16 N° DE MODÈLE : 168-0001-0

Étape 19

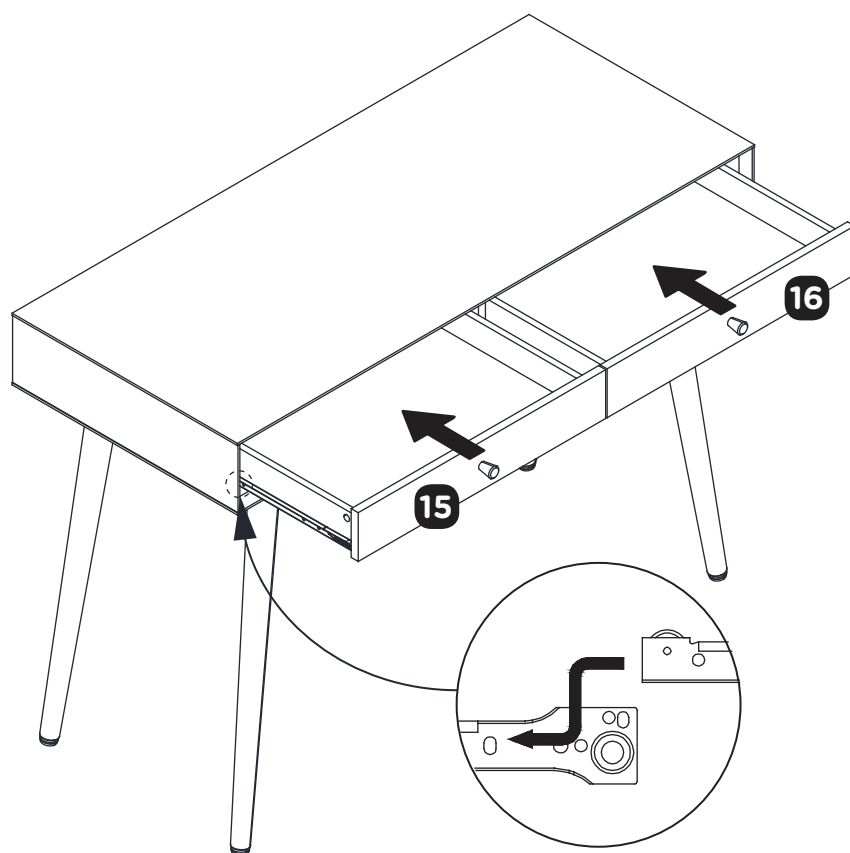

Étape 20

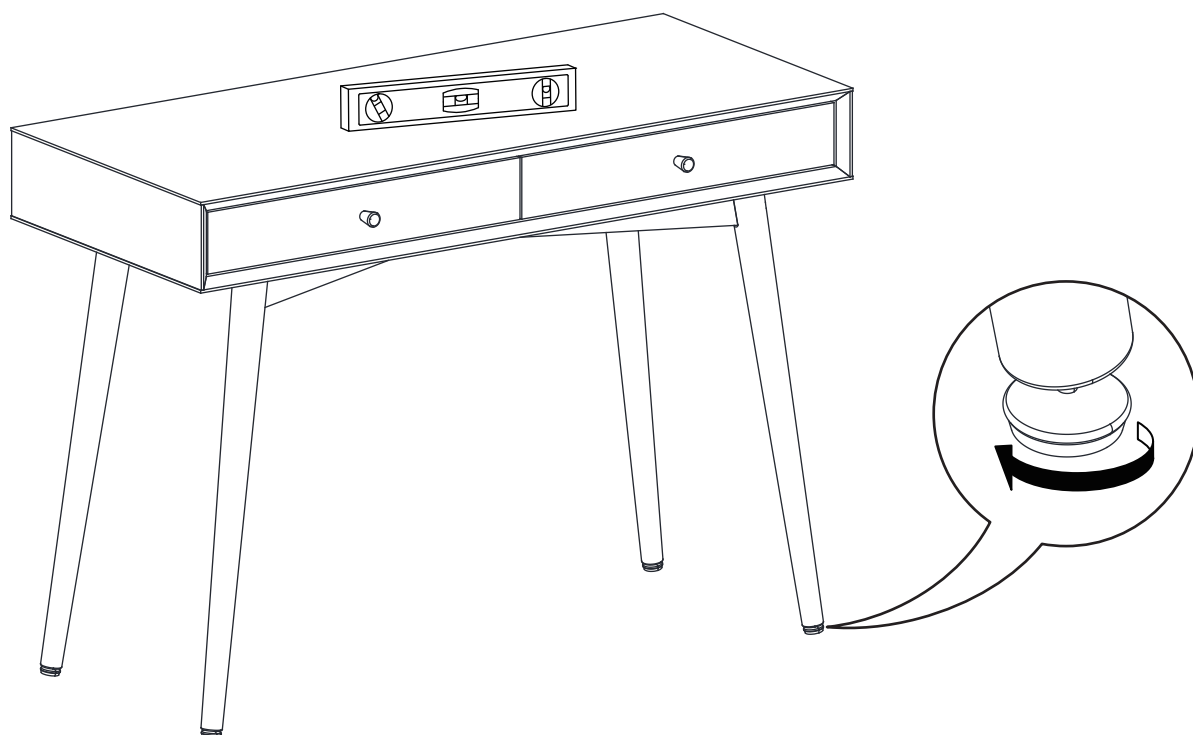

Étape 21 Profitez de votre mobilier

LIMITES DE POIDS

Ce meuble a été conçu pour soutenir les charges maximales indiquées. Si ces limites sont dépassées, le meuble peut fléchir, devenir instable, s'effondrer et causer des blessures graves.

Assurez-vous d'enlever tous les objets du meuble avant de le déplacer.

Le meuble doit être soulevé par plus d'une personne et ne doit pas être traîné ou poussé. Si cette directive n'est pas respectée, le meuble peut se briser, devenir instable, s'effondrer et entraîner des blessures graves.

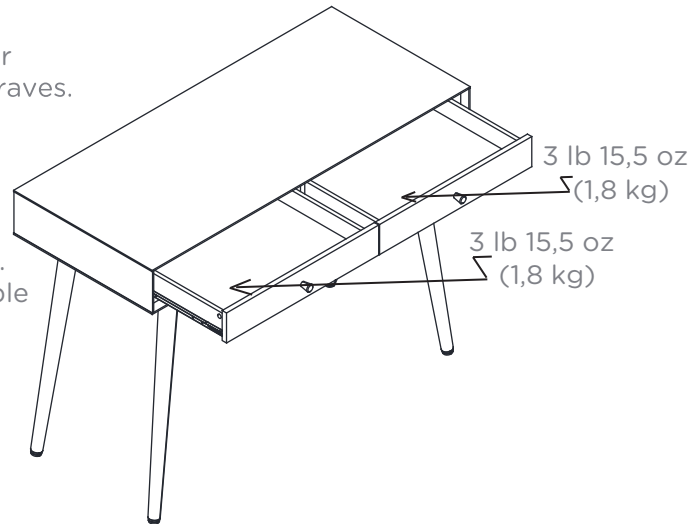

18 N° DE MODÈLE : 168-0001-0

Dimensions (H. x l. x P.)	17 3/4 x 41 3/4 x 14 1/4 PO
	45 x 106 x 36 cm
Poids du produit	56 lb
	25,4 kg

Ce produit CANVAS^{MC} comporte une garantie d'un (1) an contre les défauts de fabrication et de matériaux. Distribution Trifeuil consent à remplacer l'article défectueux sans frais lorsqu'il est retourné, accompagné de la preuve d'achat, par l'acheteur original au cours de la période de garantie convenue. Ce produit n'est pas garanti contre l'usure ou le bris causé par un usage abusif ou inapproprié.