

MAXIMUM™

42" (106.8 cm) W

Tall Cabinet



model no. 068-7098-6

IMPORTANT

Please read this manual carefully before assembling and using this cabinet and save it for reference

INSTRUCTION MANUAL

Due to continuing improvements, the actual product may differ slightly from the product described herein.

TABLE OF CONTENTS

SAFETY	3
MAINTENANCE	3
EXPLODED VIEW / PART LIST	4
ASSEMBLY INSTRUCTIONS	5
COORDINATING PRODUCTS	10
WARRANTY	11

NOTE

If any parts are missing or damaged, or if you have any questions, please call 1-888-670-6682 and have the product number, cash register receipt and the date of purchase available when you call. **DO NOT SHIP YOUR PRODUCT BACK TO THE STORE, UNLESS WE SEND YOU WRITTEN INSTRUCTIONS FOR RETURN.**



SAVE THESE INSTRUCTIONS

This manual contains important safety and operating instructions. Read all instructions and follow them carefully with use of this products

SAFETY

To reduce the risk of serious injury, read and follow the safety instructions below before assembling and using this product.

- This product is intended for indoor use only.
- This product is not designed for commercial nor industrial usage.
- Keep the product on level surfaces. The product could become unstable and it may tip over if stored or moved on an uneven surface, which may cause personal injury, death or product damage.
- Any assembly or maintenance of the cabinet must be carried out by adults only.
- Use at least two people to move, assemble or install this cabinet. Failure to do so can result in personal injury or product damage.
- Check all nuts and bolts periodically for tightness. When required, tighten them.
- Close and lock the doors before moving this cabinet.
- DO NOT alter this product in any manner. For example, do not weld external bar locks or attach electrical equipment. This may cause product damage or personal injury.
- DO NOT stand on the cabinet and do not use it as scaffold.
- DO NOT leave children unattended near this product. Cabinets may tip over if improperly opened.
- DO NOT exceed the following weight limits for this product.
 - Maximum load: 1324 lb (600 kg)
 - Maximum load for each shelf: 265 lb (120 kg)
 - Maximum load for bottom panel: 529 lb (240 kg)

MAINTENANCE

- Periodically clean the door fronts, shelves and other surfaces with a soft rag and water.
- Grease and oil can be removed with most standard cleaning fluids. For safety, use a nonflammable cleaning fluid.

EXPLODED VIEW / PART LIST

No.	Description	Qty
1	Top Panel	1
2	M6 x 12 Phillips Pan Head Screw *	57
3	Right Back Panel	1
4	Right Side Panel	1
5	Bottom Panel	1
6	Adjustable Foot	4
7	Screwdriver	1
8	Key	2
9	Right Door	1

No.	Description	Qty
10	Left Door	1
11	Lock	1
12	Locking Hook	1
13	Hinge	6
14	Left Side Panel	1
15	Shelf	3
16	Shelf Bracket	12
17	M6 x 65 Hex Tapping Screw	2
18	Left Back Panel	1
19	Magnet	2

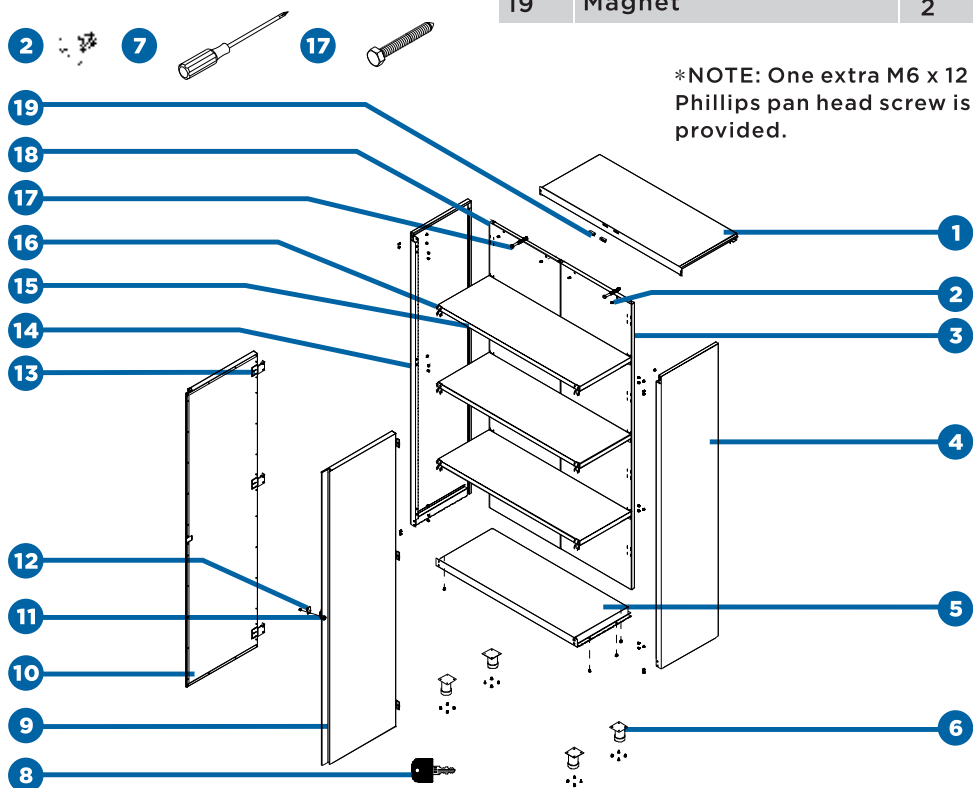
**NOTE:**

Replacement keys may be ordered. Call our toll-free number. The code which appears on the lock will be required.

TOOLS REQUIRED FOR ASSEMBLY

- Screwdriver (7)
- Power drill (not included)

IMPORTANT

All arrows on part labels should be followed when assembling this product.

STEP 1

Lay down the two back panels (3 & 18) on their backs with a soft mat underneath. Attach the right back panel (3) and left back panel (18) by sliding the left back panel's (18) edge into the groove of the right back panel (3).

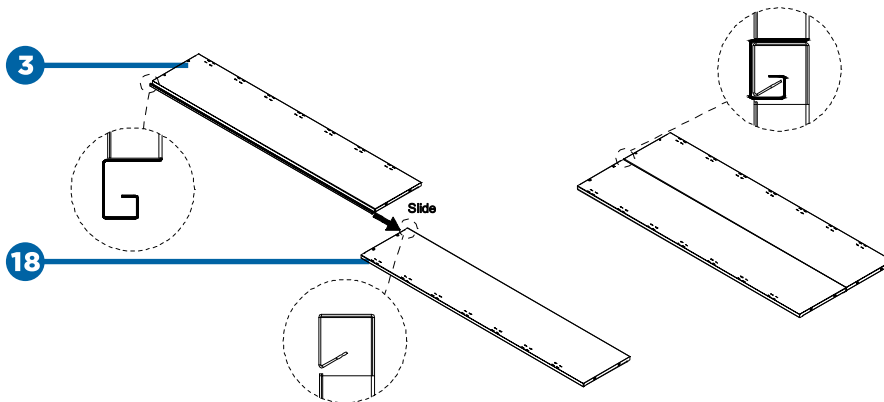

STEP 2

Attach the left side panel (14) to the left back panel (18) by sliding the left back panel's (18) edge into the groove of the left side panel (14). Repeat the same procedure to attach the right side panel (4) to the right back panel (3).

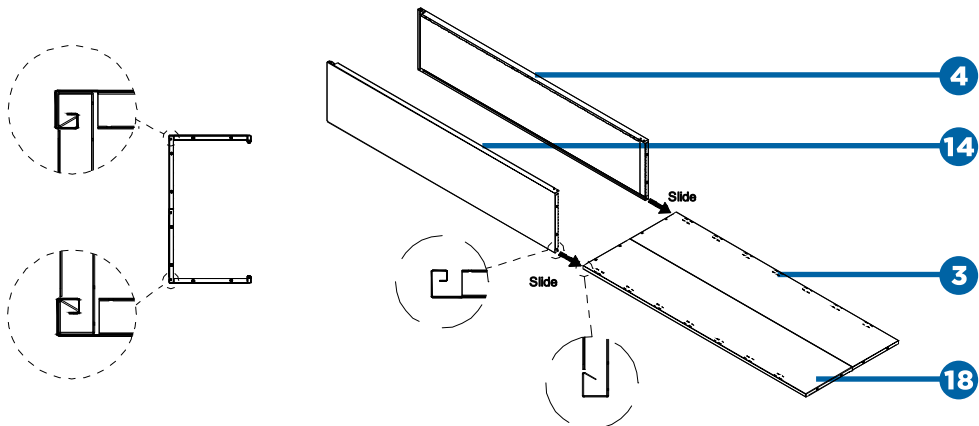

STEP 3

Attach the bottom panel (5) to the back panels (3 & 18) and the side panels (4 & 14). Tighten securely with 12 PCS of M6 x 12 Phillips pan head screws (2).

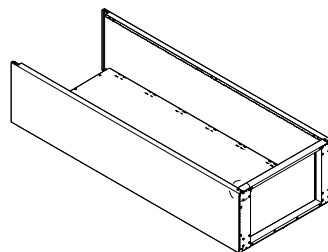
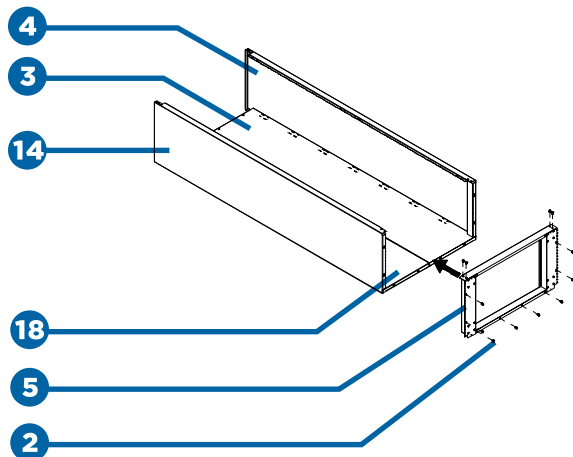
**STEP 4**

Attach the top panel (1) to the unit. Slide the top panel's (1) edges into the grooves of the side panels (4 & 14).

Tighten securely with 10 PCS of M6 x 12 Phillips pan head screws (2).

Make sure the magnets (19) are located at the front of the cabinet.

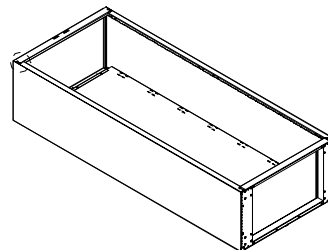
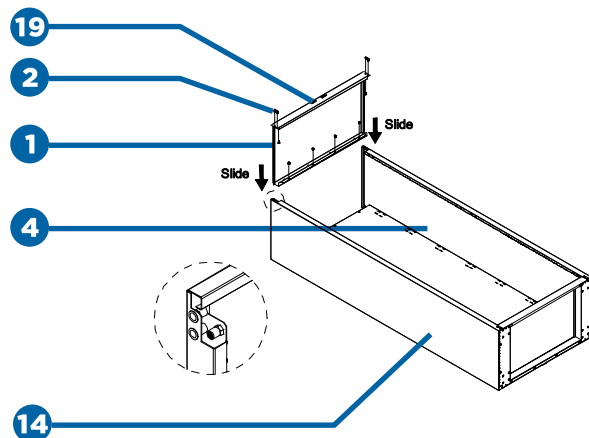

STEP 5

Install the adjustable feet (6) to the cabinet bottom. Make sure the A sides of the adjustable feet are facing either towards the back or the front of the cabinet. Tighten securely with 16 PCS of M6 x 12 Phillips pan head screws (2).

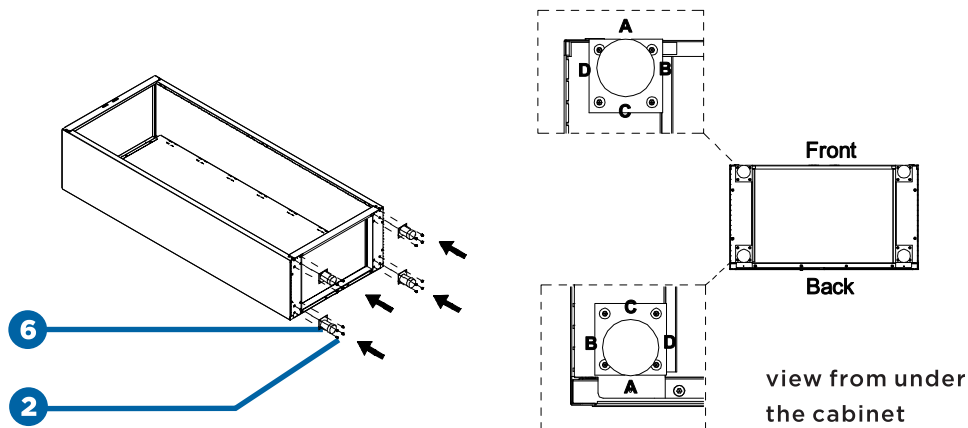

STEP 6

Bring up the tall cabinet on its feet.

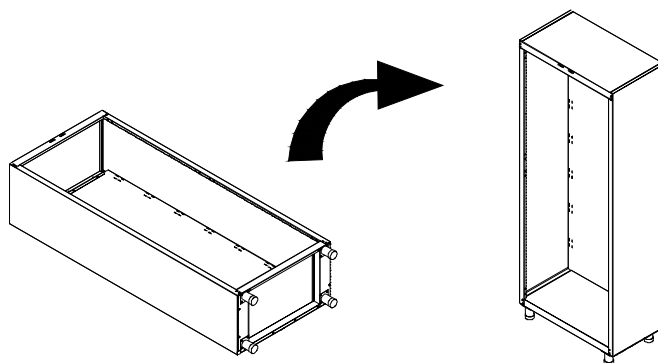

STEP 7

Insert the hanging hooks of the left door's (10) hinges (13) into the slots on the inside of the left side panel's front edge. Tighten securely with 9 PCS of M6 x 12 Phillips pan head screws (2). Repeat the same procedure to install the right door (9).

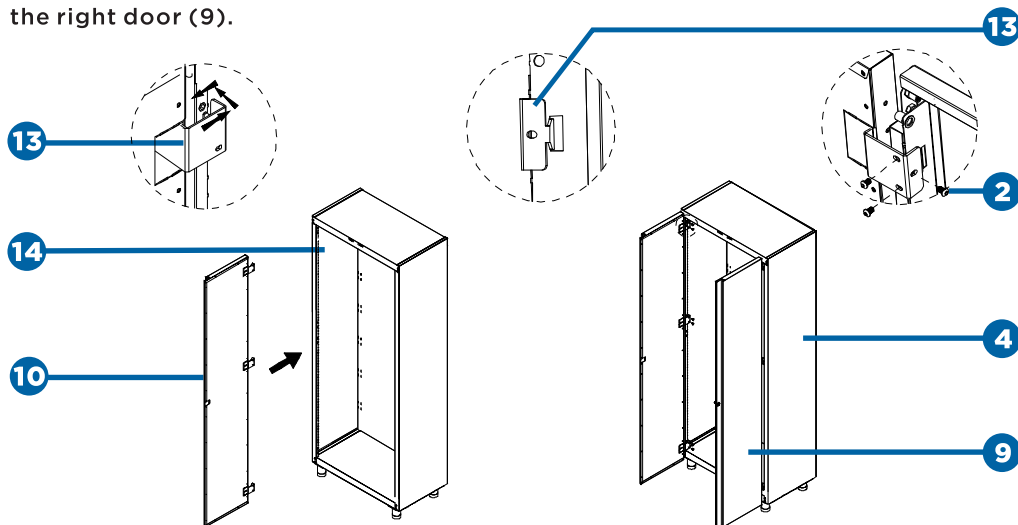
**STEP 8**

Release the nut from the lock's (11) back end. Attach the locking hook (12) to the lock's (11) back end. Make sure the straight part of the locking hook (12) is upright (as shown below), and the key code stays on the top area of the lock face. Tighten securely with the nut you previously removed from the lock's back end.

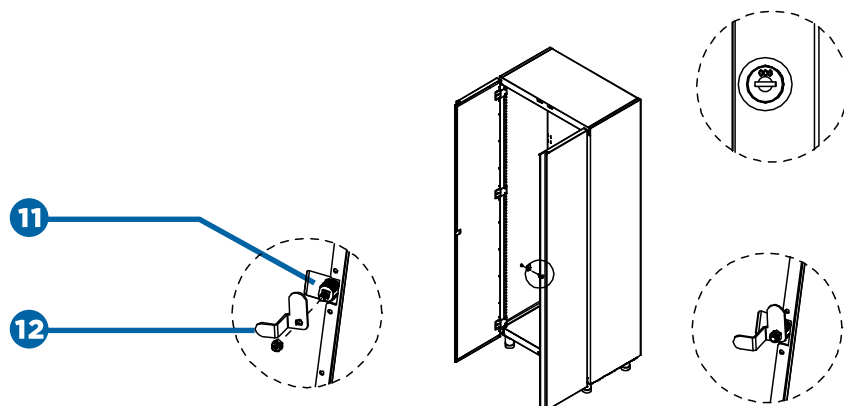

STEP 9

Insert 12 shelf brackets (16) into the slots on the back panels (3 & 18) and the side panels (4 & 14) at the desired heights. Make sure the four brackets (16) for each shelf are at the same height. Place the shelves (15) over the shelf brackets (16), and push them down onto the shelf brackets. Make sure the shelves (15) are properly and safely locked by the shelf brackets' upright hooks.

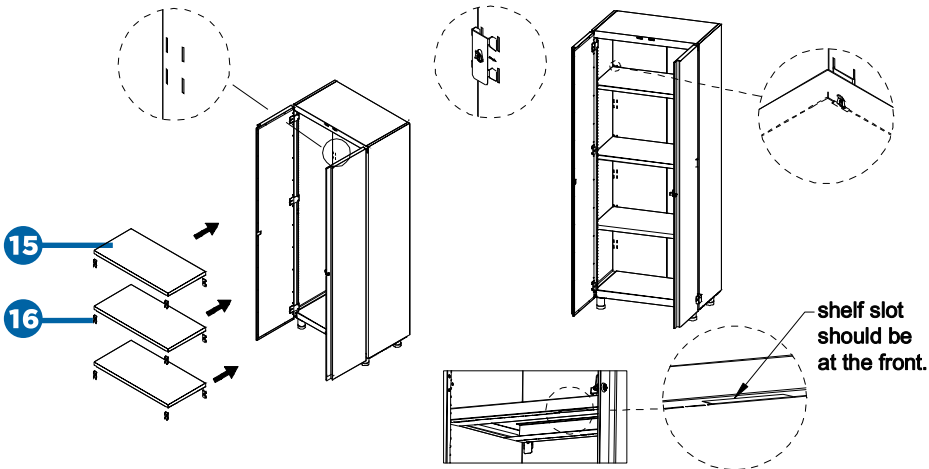

IMPORTANT NOTE:

One of the shelves should be installed in the center of the cabinet.
Make sure the slot underneath the shelf is placed towards the front of the cabinet.

STEP 10

Place the cabinet on a flat floor against a wall. Use a power drill to attach the cabinet to the wall with 2 PCS of M6 x 65 hex tapping screw (17) through the holes on the back of the top panel. Tighten securely. For safety, the screws shall be drilled into the studs of the wall. The tall cabinet is ready for use.

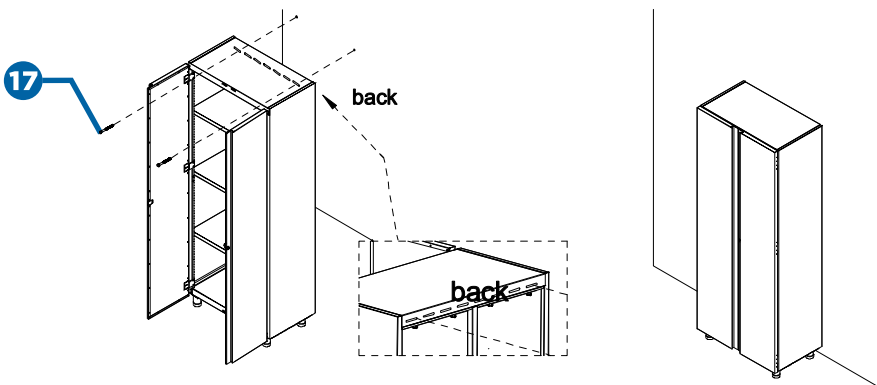

model no. 068-7098-6 | contact us: 1-888-670-6682

COORDINATING PRODUCTS

This product coordinates well with the units below to offer a best storage solution. They can be combined into various combinations to meet different storage requirements.

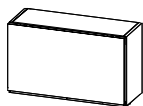
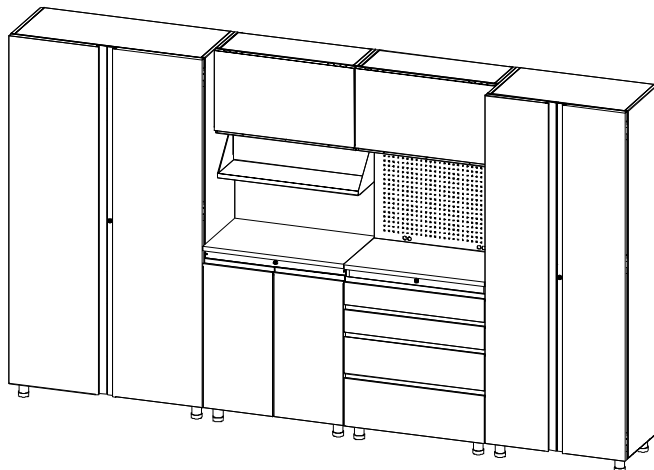

30 1/2" (77.6 cm) wall cabinet
068-7099-4



30 1/2" (77.6 cm) shelf
068-7303-8

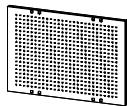

30 1/2" (77.6 cm) peg board
068-7304-6

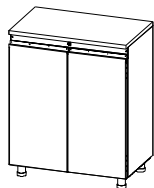

30 1/2" (77.6 cm) 2-door cabinet
068-7095-2

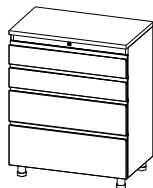

30 1/2" (77.6 cm) 4-drawer cabinet
068-7096-0

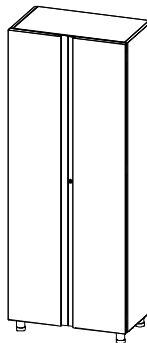

30 1/2" (77.6 cm) tall cabinet
068-7097-8

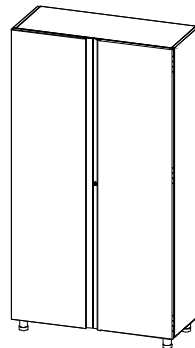

42" (106.8 cm) tall cabinet
068-7098-6

LIMITED WARRANTY

This product is guaranteed for 1 year from the date of original retail purchase against defects in materials and workmanship.

Subject to the conditions and limitations described below, this product, if returned to us with a proof of purchase within the stated warranty period and if covered under this warranty, will be repaired or replaced (with the same model, or one of equal value or specification), at our option. We will bear the cost of any repair or replacement and any costs of labor relating thereto.

This warranty is subject to the following conditions and limitations:

- a) A sales receipt that indicates the date of purchase must be provided;
- b) This warranty will not apply to any product or part thereof which is worn or broken or which has become inoperative due to abuse, misuse, accidental damage, neglect or lack of proper installation, operation or maintenance (as outlined in the applicable owner's manual or operating instructions) or which is being used for industrial, professional, commercial or rental purposes;
- c) This warranty will not apply to normal wear and tear or to expendable parts or accessories that may be supplied with the product that are expected to become inoperative or unusable after a reasonable period of use;
- d) This warranty will not apply to routine maintenance and consumable items such as, but not limited to, fuel, lubricants, vacuum bags, blades, belts, sandpaper, bits, fluids, tune-ups or adjustments;
- e) This warranty will not apply if damage is caused by repairs made or attempted by others (i.e. persons not authorized by the manufacturer);
- f) This warranty will not apply to any product that was sold as a reconditioned or refurbished product (unless otherwise specified in writing);
- g) This warranty will not apply to any product or part thereof if any part from another manufacturer is installed therein or any repairs or alterations have been made or attempted by unauthorized persons;
- h) This warranty will not apply to normal deterioration of the exterior finish, such as, but not limited to, scratches, dents, paint chips, or to any corrosion or discoloring by heat, abrasive and chemical cleaners;
- i) This warranty will not apply to component parts sold by and identified as the product of another company, which shall be covered under the product manufacturer's warranty, if any.

Additional Limitations

This warranty applies only to the original purchaser and may not be transferred. Neither the retailer nor the manufacturer shall be liable for any other expense, loss or damage, including, without limitation, any indirect, incidental, consequential or exemplary damages arising in connection with the sale, use or inability to use this product.

Notice to Consumer

This warranty gives you specific legal rights, and you may have other rights, which may vary from province to province. The provisions contained in this warranty are not intended to limit, modify, take away from, disclaim or exclude any statutory warranties set forth in any applicable provincial or federal legislation.