

CANVAS^{TM/MC}

HANS ELECTRIC FIREPLACE/MEDIA CONSOLE

MODEL NO. 064-3179-6

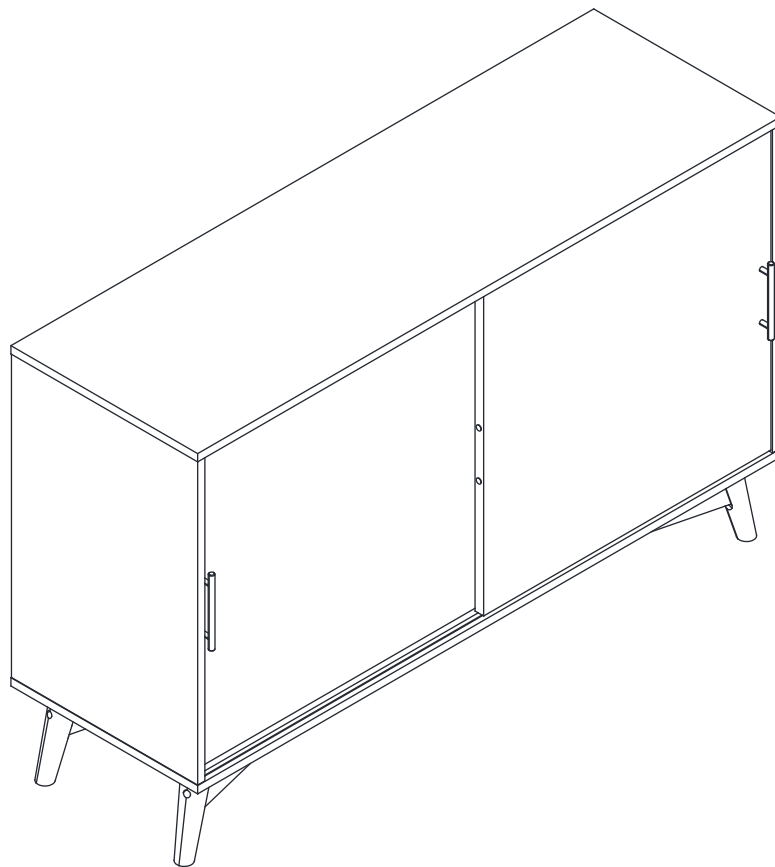

HOMEOWNER'S MANUAL

 1-888-670-6684

IMPORTANT: If you have any problems or questions, email or call customer service before you return this product to the store where it was purchased.

Important Safety Information	3
Parts List	6
Assembly	8
Operating Instructions	20
Care and Maintenance	22
Troubleshooting Guide	24
Replacement Parts List and Exploded View	25
Warranty	26



Warning! To reduce the risk of serious injury, read the following safety instructions before assembling and operating this fireplace.

When using electrical appliances, basic precautions should always be followed to reduce the risk of fire, electric shock and injury to persons, including the following:

Read all instructions before installing or using the fireplace.



DANGER: If the information in this manual is not followed exactly, an electric shock or fire may result causing property damage, personal injury or loss of life.



WARNING: This appliance is hot when in use. To avoid burns, DO NOT let bare skin touch hot surfaces. Keep combustible material, such as furniture, pillows, bedding, papers, clothes and curtains, at least 3' (0.9 m) from the front of the heater and keep them away from the sides and rear.



WARNING: Extreme caution is necessary when any heater is used by or near children or individuals with disabilities and whenever the fireplace is left operating and unattended.



WARNING: DO NOT run cord under carpeting. DO NOT cover cord with throw rugs, runners, or similar covering. Arrange cord away from traffic areas and where it will not be tripped over.



WARNING: Do NOT insert or allow foreign objects to enter any ventilation or exhaust opening as this may cause an electric shock or fire, or damage the appliance.



WARNING: This appliance has hot and arcing or sparking parts inside. DO NOT use it in areas where gasoline, paint or flammable vapours or liquids are used or stored. This fireplace should not be used as a drying rack for clothing. Christmas stockings or decorations should not be hung on it or near it.

IMPORTANT: Retain for future reference, and read carefully.

4 MODEL NO. 064-3179-6

Use this appliance only as described in the manual. Any other use is NOT recommended by the manufacturer and may cause fire, electric shock or injury to persons.

CAUTION!

- If possible, ALWAYS unplug this appliance when not in use.
- DO NOT operate any heater with a damaged cord or plug or after the heater malfunctions.
- DO NOT operate any heater if it has been dropped or damaged in any manner. Disconnect power at service panel and have heater inspected by a reputable electrician before reusing.
- Any repairs to this fireplace should be carried out by a qualified service person.
- Under no circumstances should this fireplace be modified. Parts having to be removed for servicing must be replaced prior to operating this fireplace again.
- DO NOT use outdoors.
- This fireplace may be installed on the floor only in your home. This fireplace is an insert fireplace and can't be used as a movable fireplace.
- This heater is not intended for use in bathrooms, laundry areas and similar indoor locations. NEVER place heater where it may fall into a bathtub or other water container.
- To disconnect this appliance, turn controls to the off position, then remove plug from outlet.
- ONLY connect to properly-grounded outlets.
- This appliance, when installed, must be electrically grounded in accordance with local codes, with the current CSA C22.1 Canadian Electrical Code or follow the National Electrical Code, ANSI/NFPA N0.70.
- To prevent a possible fire, DO NOT block air intakes or exhaust in any manner. DO NOT use on soft surfaces, where opening may become blocked.
- The heaters MUST NOT be located immediately below a socket-outlet.
- ALWAYS plug heaters directly into a wall outlet/receptacle. NEVER use with an extension cord or relocatable power tap (outlet/power strip).
- The heater has a safety device that makes it stop working once the inner temperature reaches 85°C (± 2°C). To reset the appliance, turn heater off and disconnect power, let it cool off for 10 minutes and plug back in.
- DO NOT slide insert on top of wood to avoid scratching wood surface.
- DO NOT place any objects on top of insert and top air intake vents as this will cause unit to overheat and can cause a fire.
- This Class B digital apparatus complies with Canadian ICES-003.

Electrical Specifications

Voltage	120 V AC, 60 Hz
Amps	12.5 A
Watts	1,500 W

Electric Connection

- A 15 A, 120 V, 60 Hz circuit with a properly-grounded outlet is required. Preferably, the fireplace will be on a dedicated circuit as other appliances on the same circuit may cause the circuit breaker to trip or the fuse to blow when the heater is in operation. The unit comes standard with 6' (1.8 m) three prong cord, exiting from the rear of the fireplace. Plan the installation to avoid the use of an extension cord. ALWAYS plug heaters directly into a wall outlet/receptacle. NEVER use with an extension cord or relocatable power tap (outlet/power strip).
- This heater is for use on 120 V. The cord has a plug as shown below.

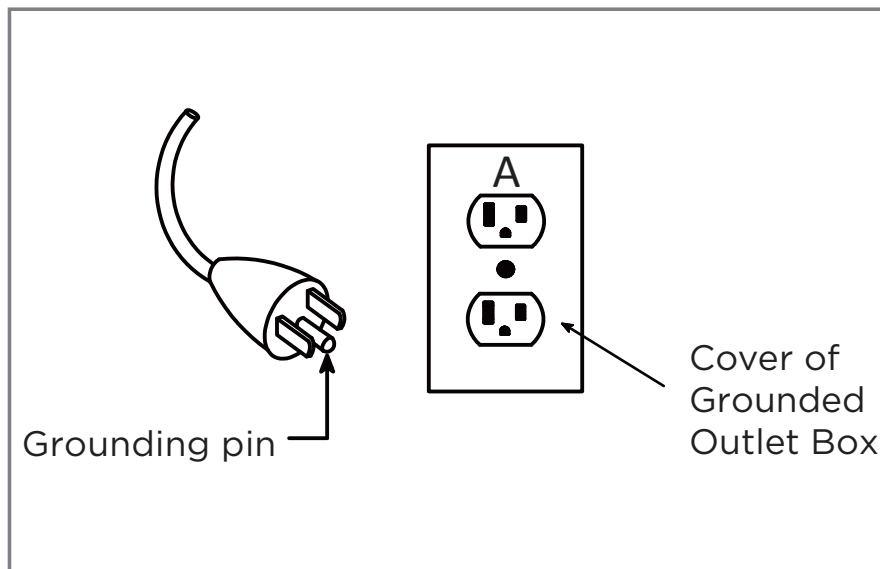

6 MODEL NO. 064-3179-6

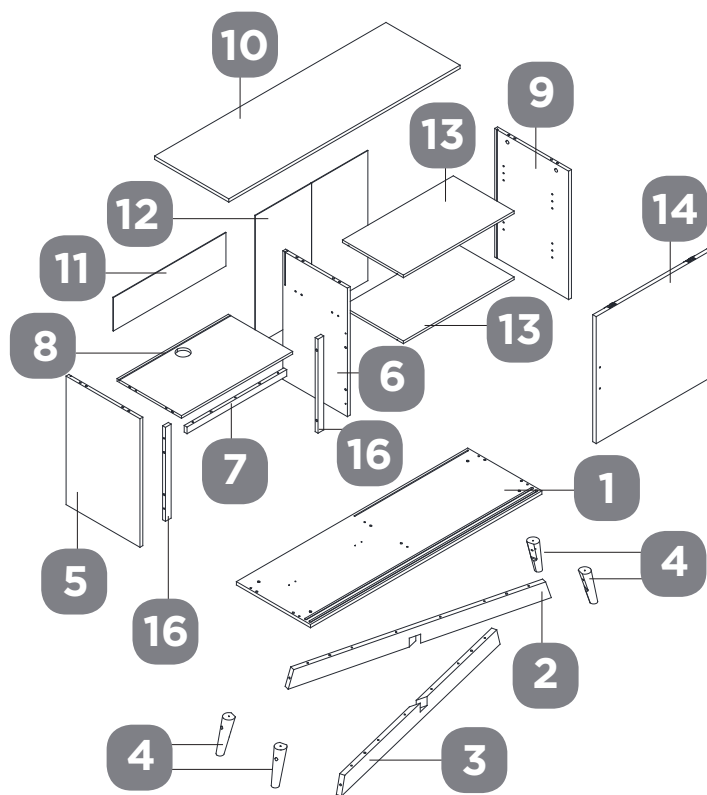

1

Bottom - 1

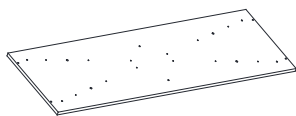

2

Bottom trim 1 - 1



3

Bottom trim 2 - 1



4

Support feet - 4



5

Left side panel - 1

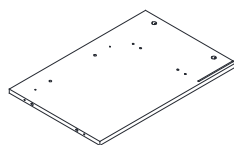

6

Divider - 1

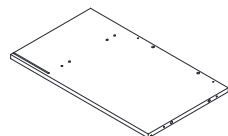

15

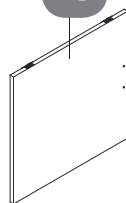

7

Upper Decorative Panel - 1

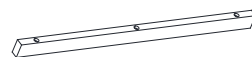

8

Fixed shelf - 1

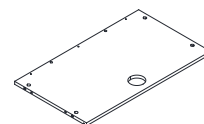

9

Right side panel - 1

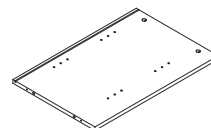

10

Top - 1

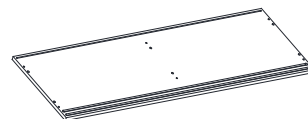

11

Left back panel - 1



12

Right back panel - 1

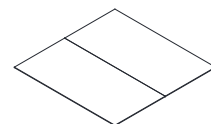

13

Adjustable shelf - 2

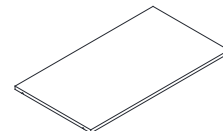

14

Left door - 1

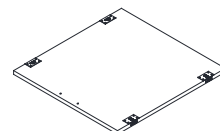

15

Right door - 1

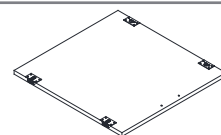

16

Left and right decorative panel - 2

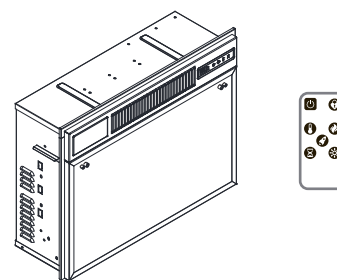

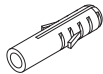
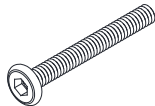
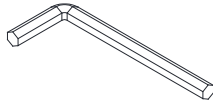
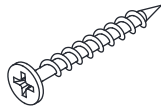
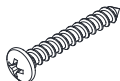
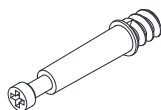
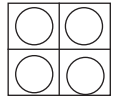
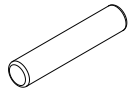
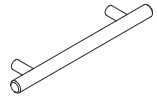
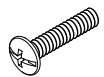
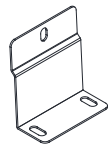
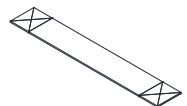
AWood dowels 7.8 x 30 mm - **26****B**Wall anchor - **2****C**Screw 4 x 50 mm - **12****D**Bolt M6 x 60 mm - **4****E**Crosshead nut - **4****F**Hex wrench - **1****G**Screw 4 x 40 mm - **10****H**Screw 4 x 35 mm - **9****I**Metal washer - **4****J**Screw 4 x 14 mm - **2****K**Cam bolt (large) - **10****L**Cam (large) - **10****M**Sticker - **18****N**Support - **8****O**Handle - **2****P**Bolt M4 x 24mm - **4****Q**Cushioning cushion - **2****R**Connector - **12****S**Screw 3 x 16 mm - **12****T**Firebox L-bracket - **2****U**Screw 4 x 10 mm - **6****V**Fabric strip - **2**

8 MODEL NO. 064-3179-6

- Read each section carefully before starting. It is very important that each step is performed in the correct order. If these steps are not followed in sequence, assembly difficulties will occur.
- Make sure all parts are included. Most board parts are labelled or stamped on the raw edge.
- Work in a spacious area, preferably on a carpet, near the place the unit will be located.
- Do not use power tools to assemble your furniture. Power tools may strip or damage the parts.

HELPFUL HINTS

- Identify, sort and count the parts before beginning assembly.
- Compression dowels should be tapped in with a rubber mallet.
- Back panels provide stability and support. Unit may collapse without the back panel installed.
- Clean the product with your choice of furniture polish and a soft cloth. **DO NOT USE** harsh chemicals or abrasive cleaners.
- Move your new furniture carefully. Two people are needed to lift and carry the unit to its new location.
- Never push or drag your furniture (especially on a carpet).

These illustrations show how the cam fastening system works.

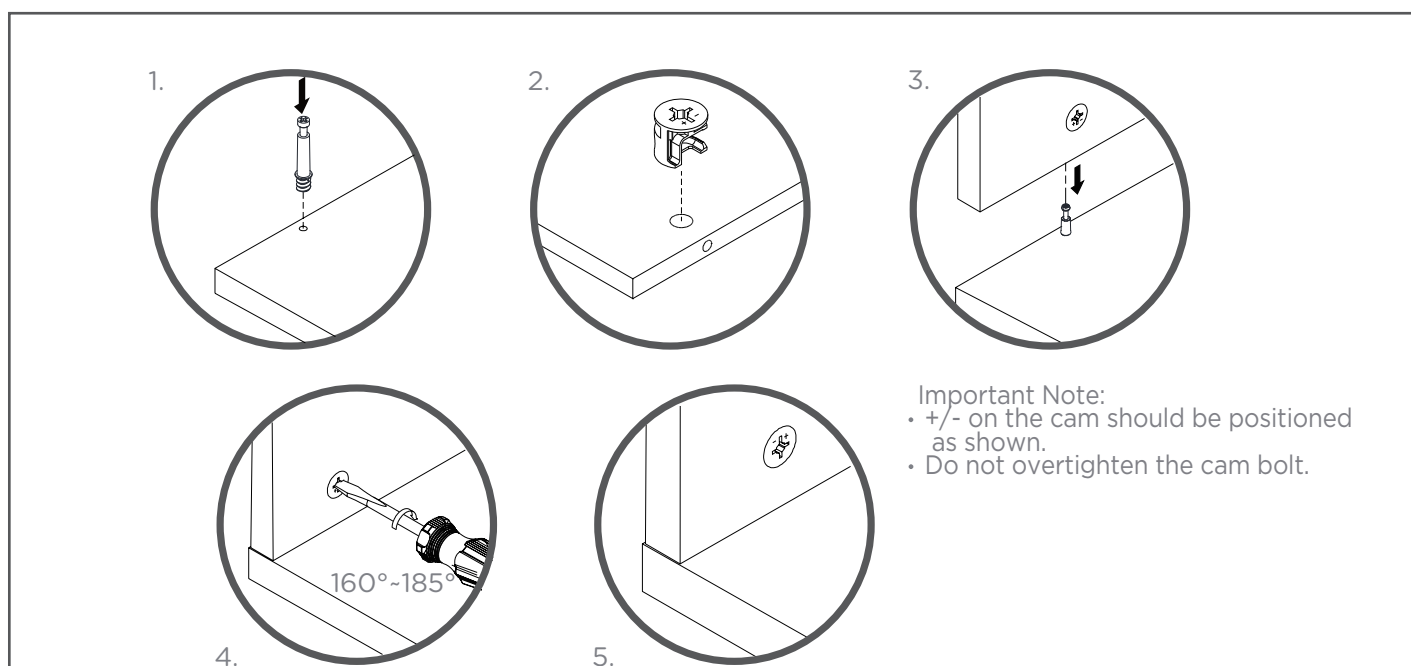

Needed for assembly:



Maillet en caoutchouc



Flat-head screwdriver



Star-head screwdriver

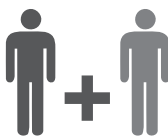

2 people

Glue not enclosed. (We recommend to apply some glue into holes before inserting wood dowels.)

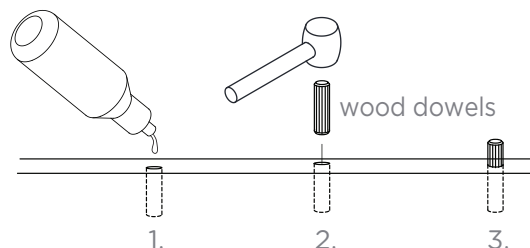

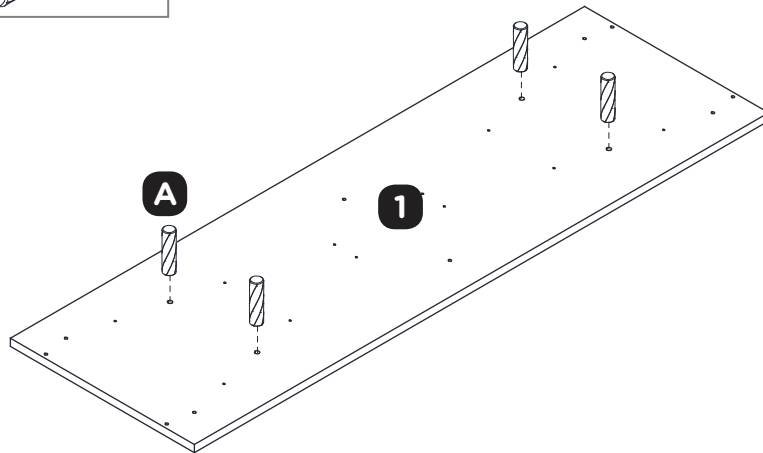
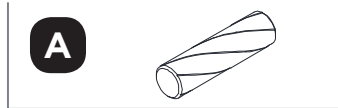
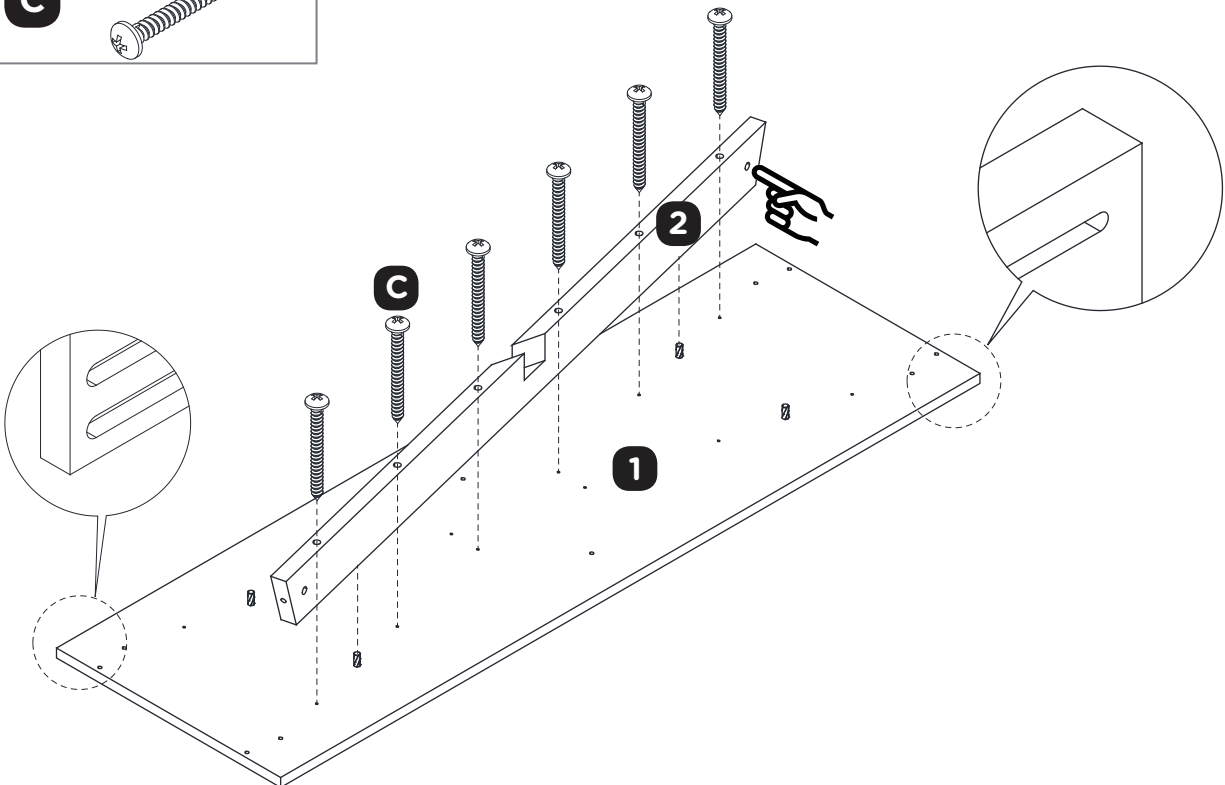
Step 1Requires **1, A****Step 2**Requires **1, 2, C**

10 MODEL NO. 064-3179-6

Step 3

Requires 1, 3, C

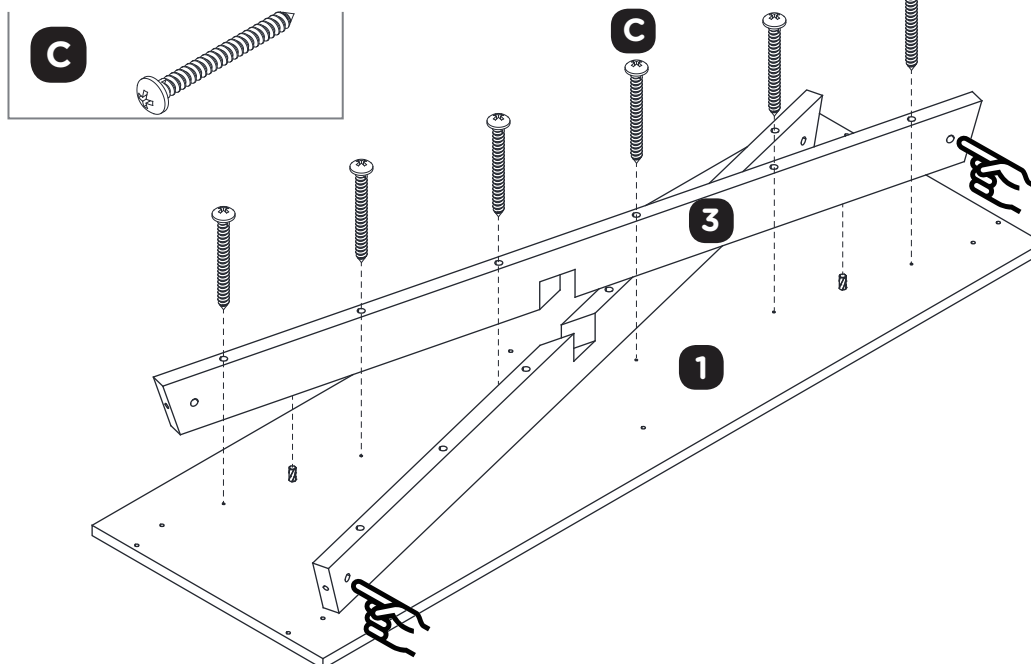

Step 4

Requires 1, 4, D, E, F



Warning: Before completely fastening the parts in Step 4, make sure the parts in Step 5 are fastened in position.

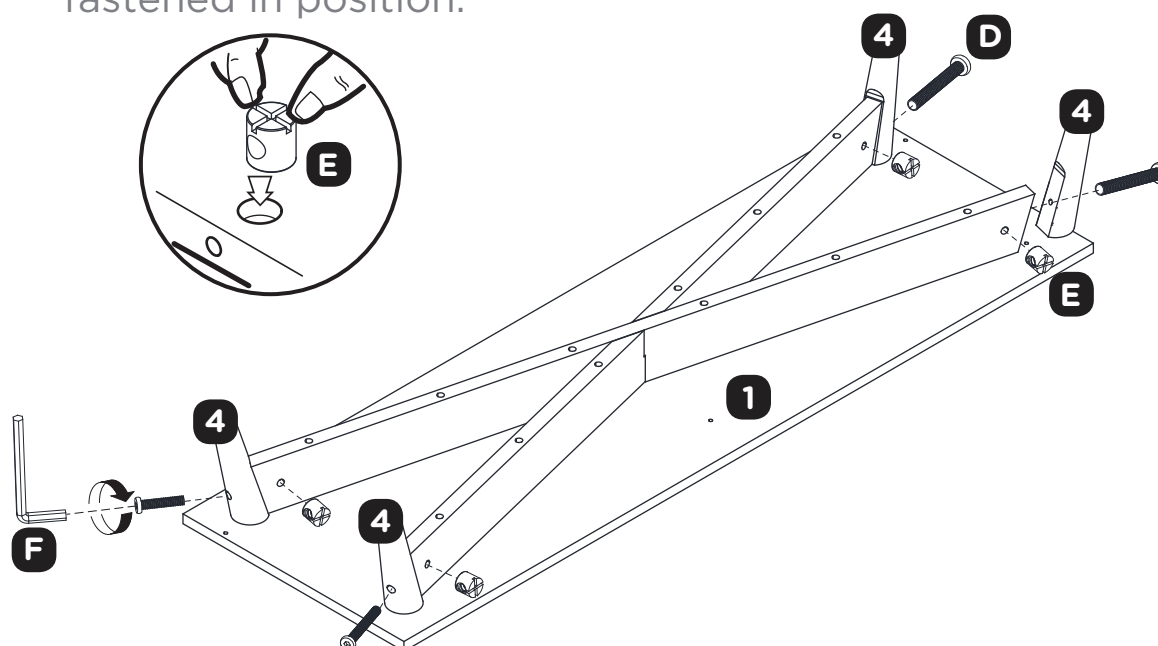

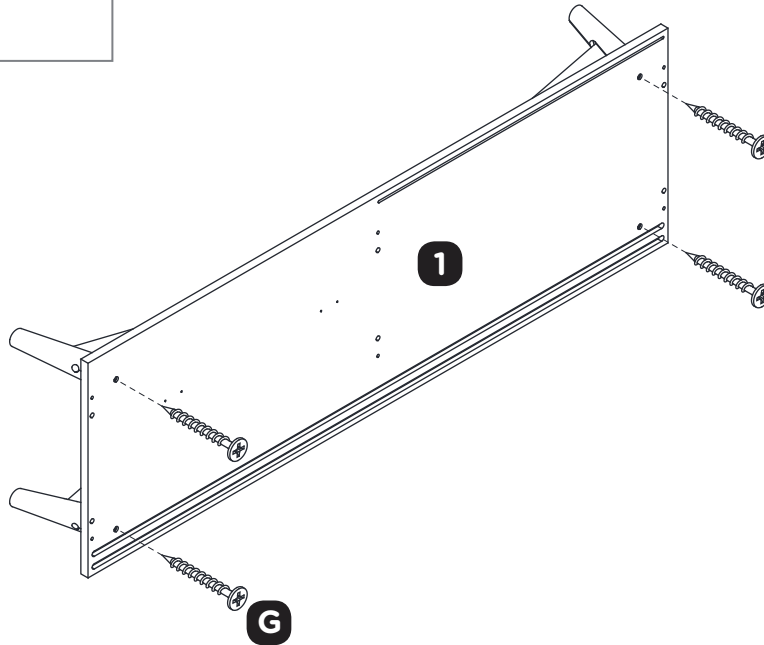
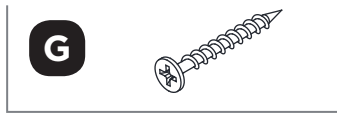
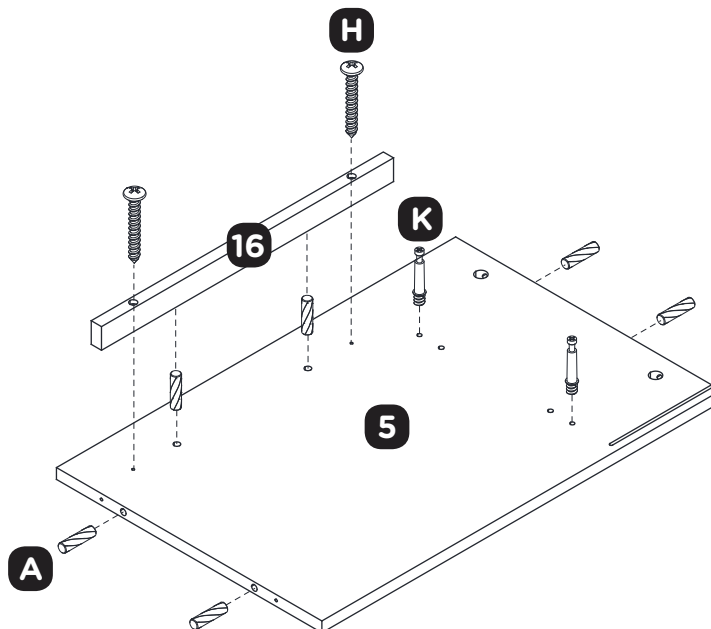
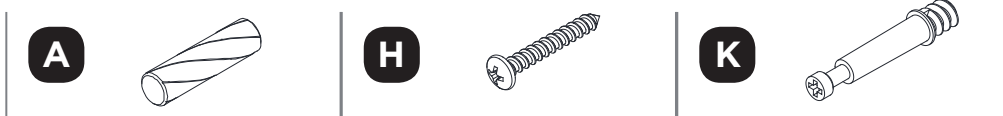
Step 5Requires **1, G****Step 6**Requires **5, 16, A, H, K**

12 MODEL NO. 064-3179-6

Step 7

Requires **6, 16, A, H, K**

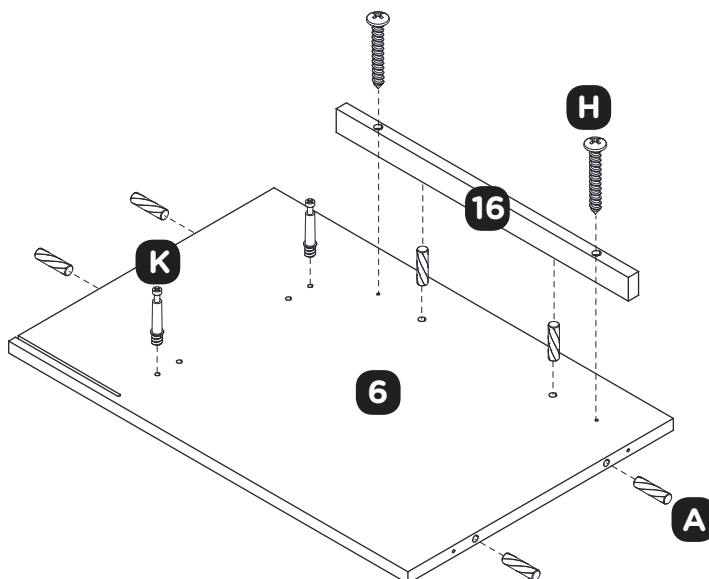
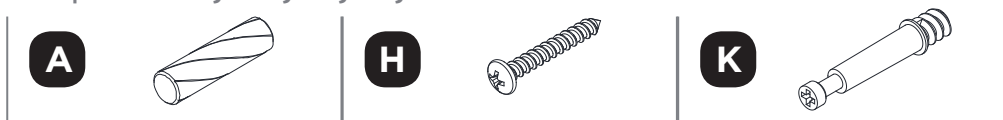

Step 8

Requires **7, 8, A, H**

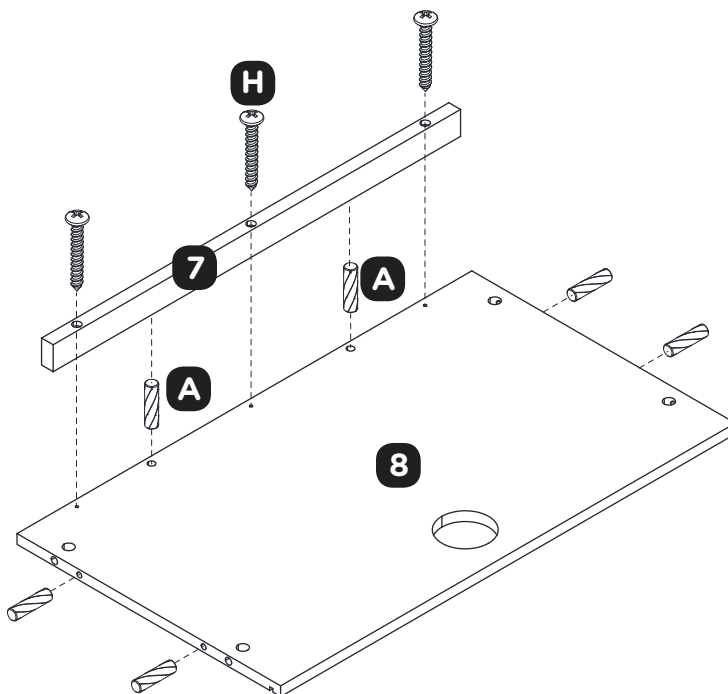

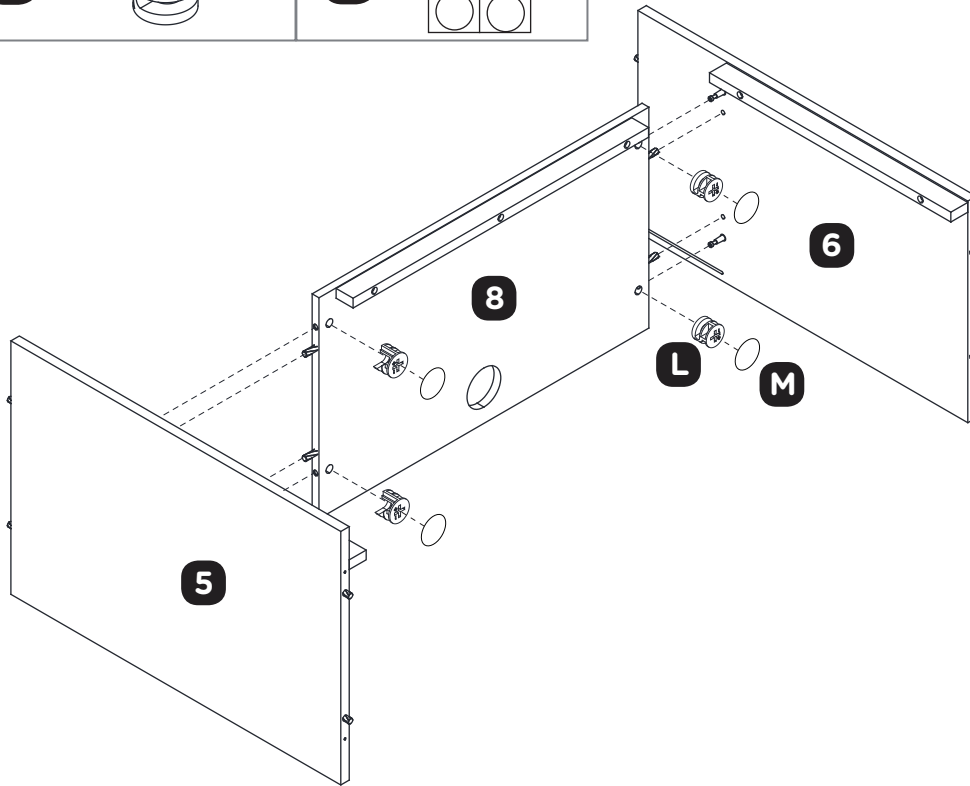
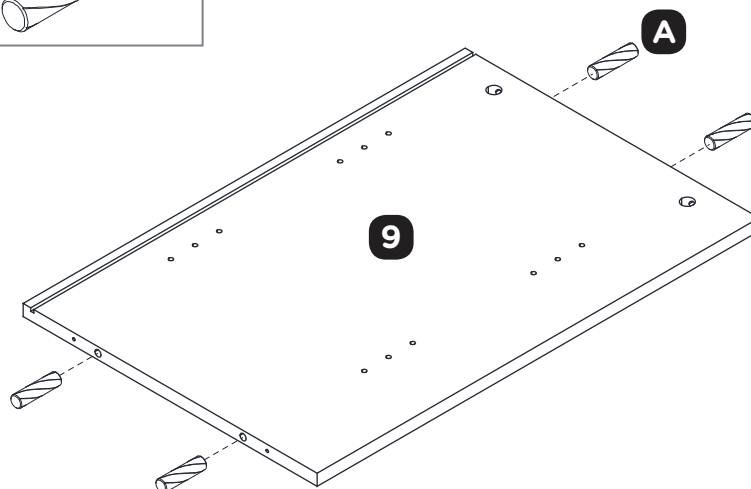
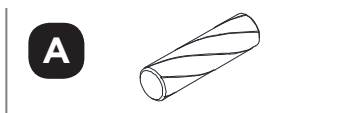
Step 9Requires **5, 6, 8, L, M****Step 10**Requires **9, A**

14 MODEL NO. 064-3179-6

Step 11

Requires **1, 5, 6, 9, G, M**

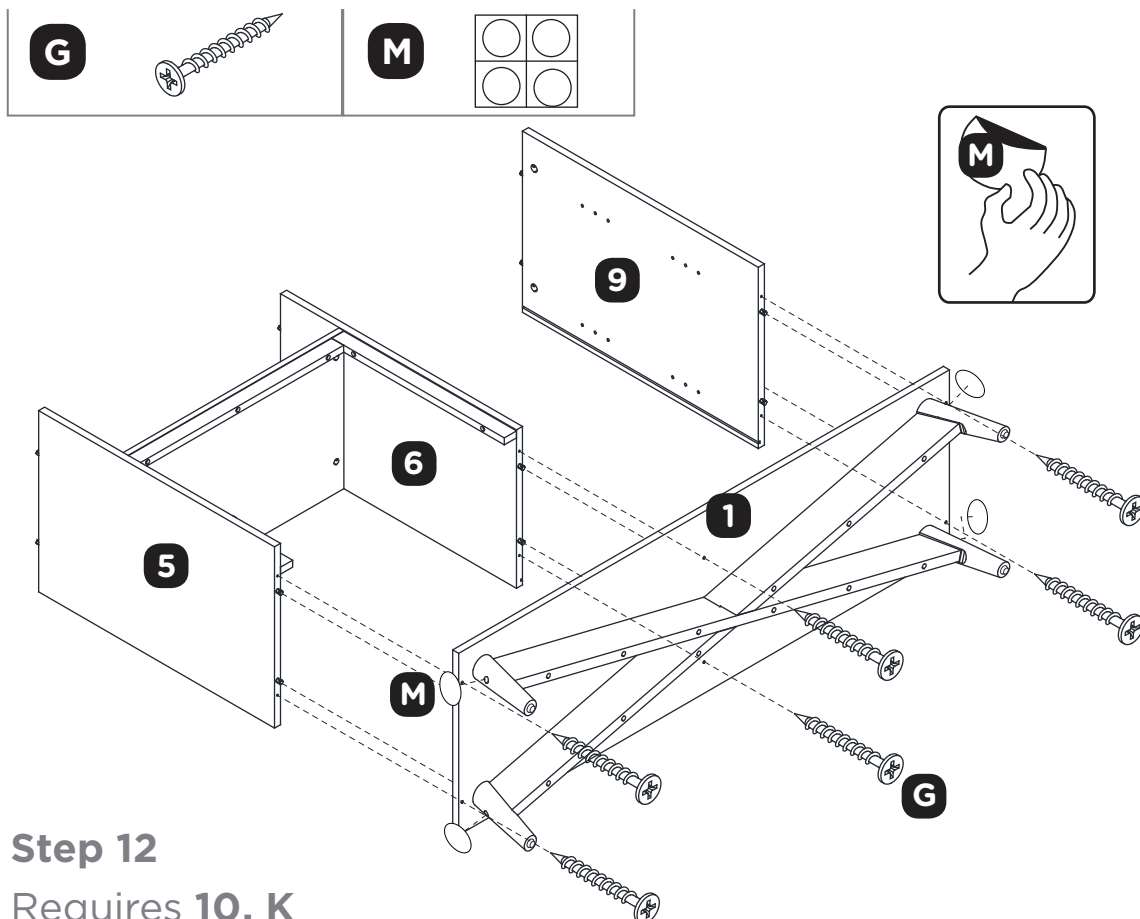

Step 12

Requires **10, K**

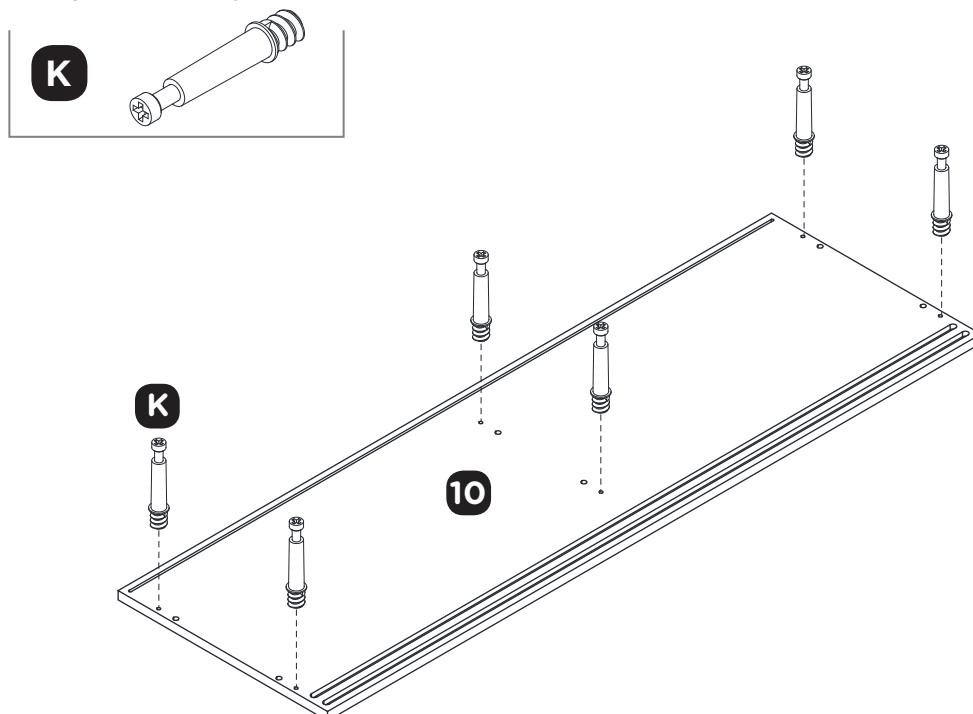

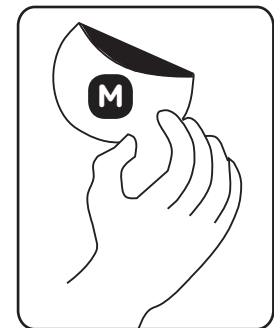
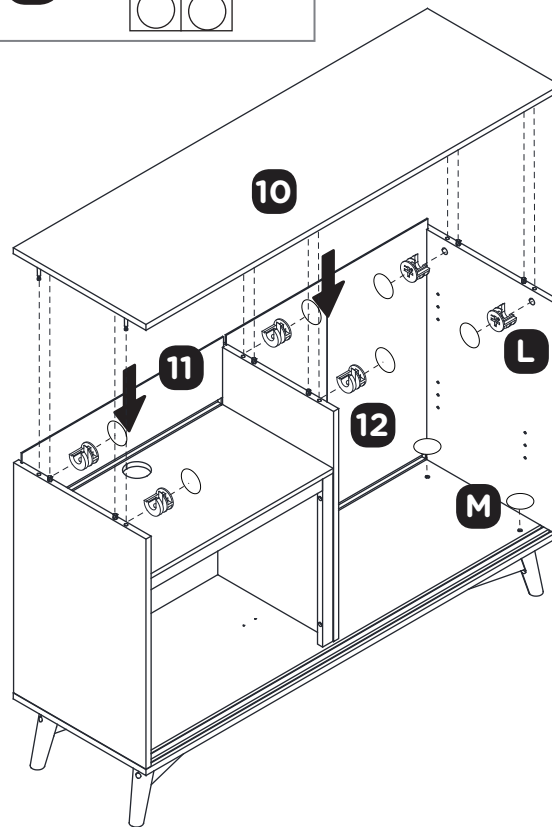
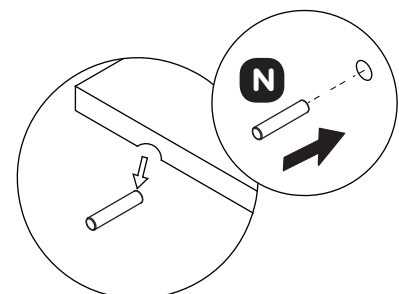
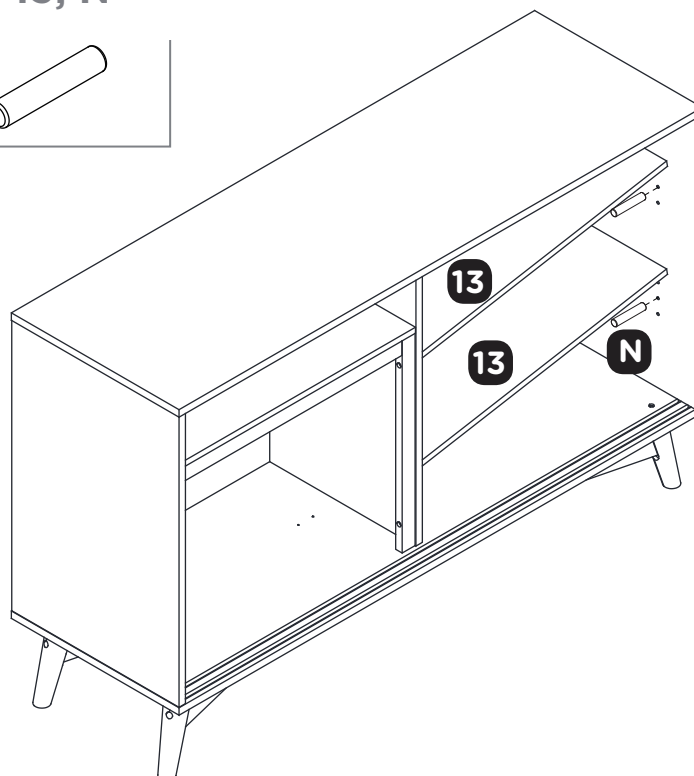
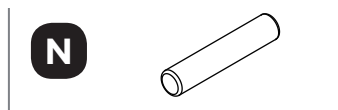
Step 13Requires **10, 11, 12, L, M****Step 14**Requires **13, N**

16 MODEL NO. 064-3179-6

Step 15

Require 14

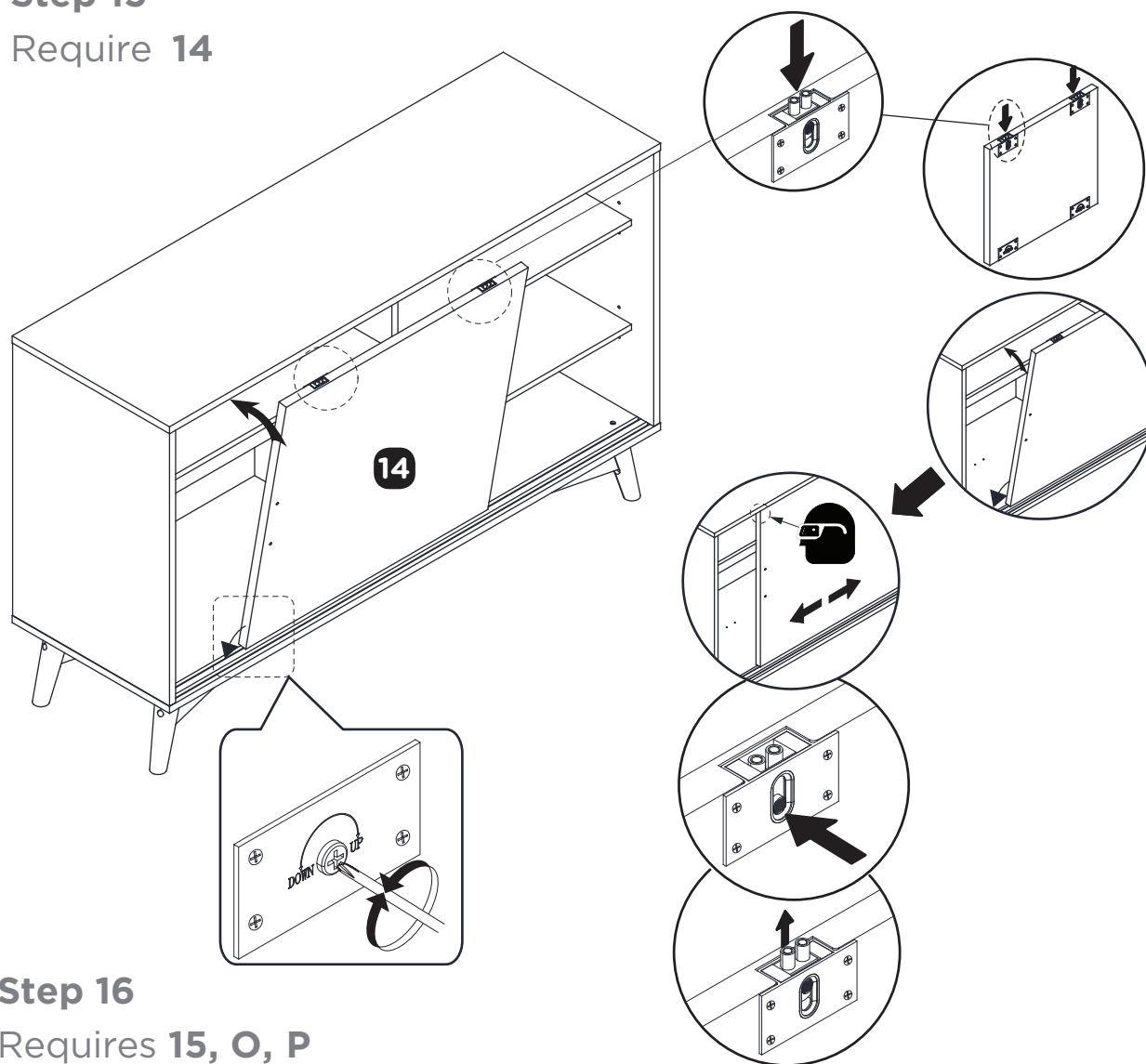

Step 16

Requires 15, O, P

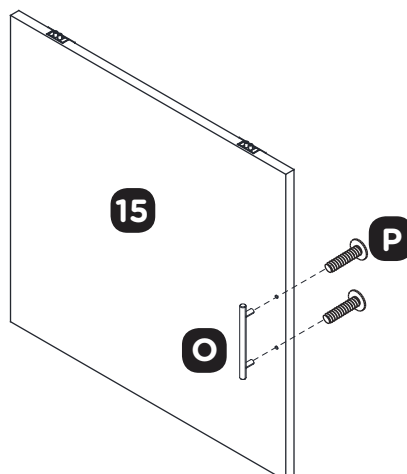

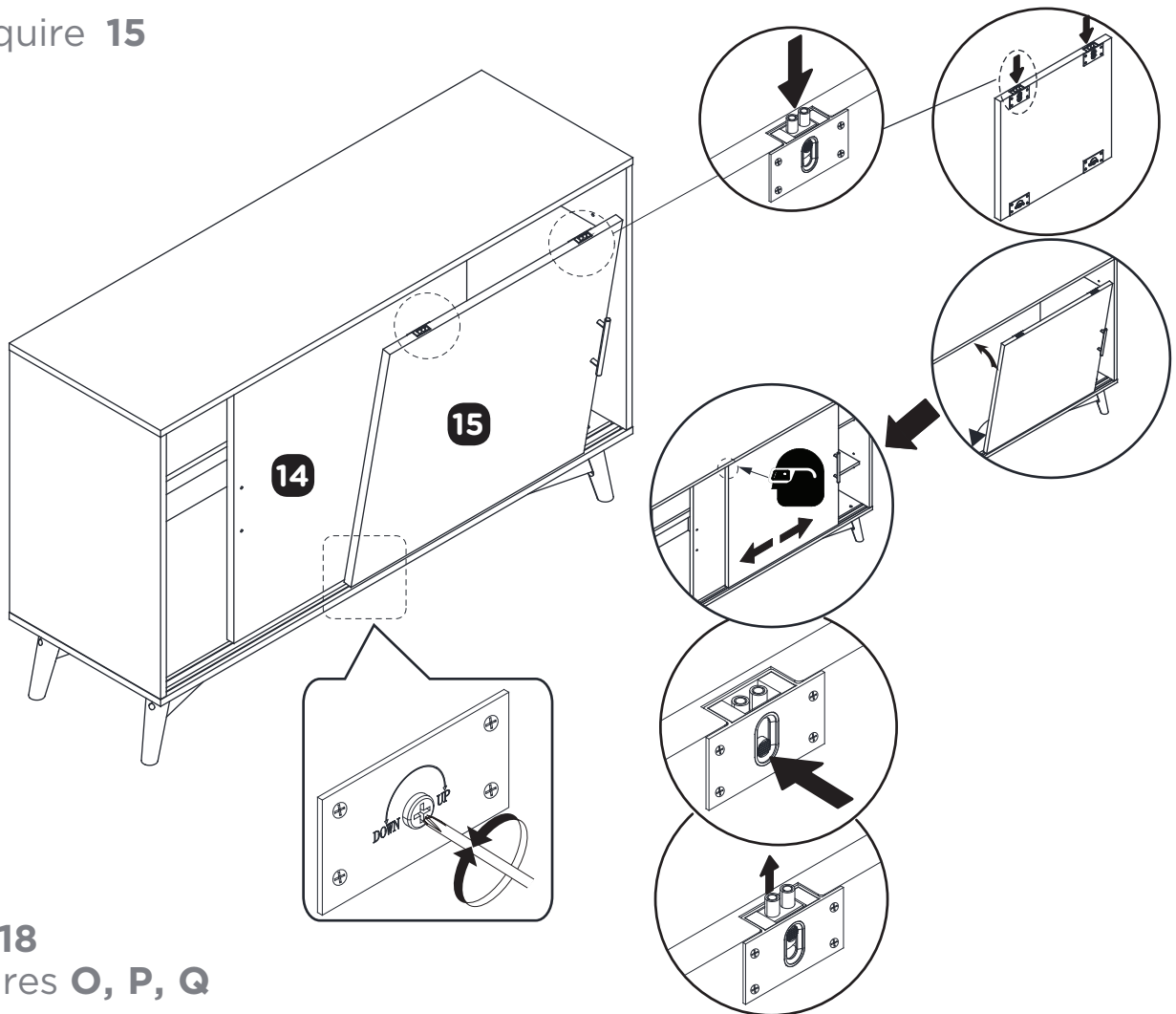
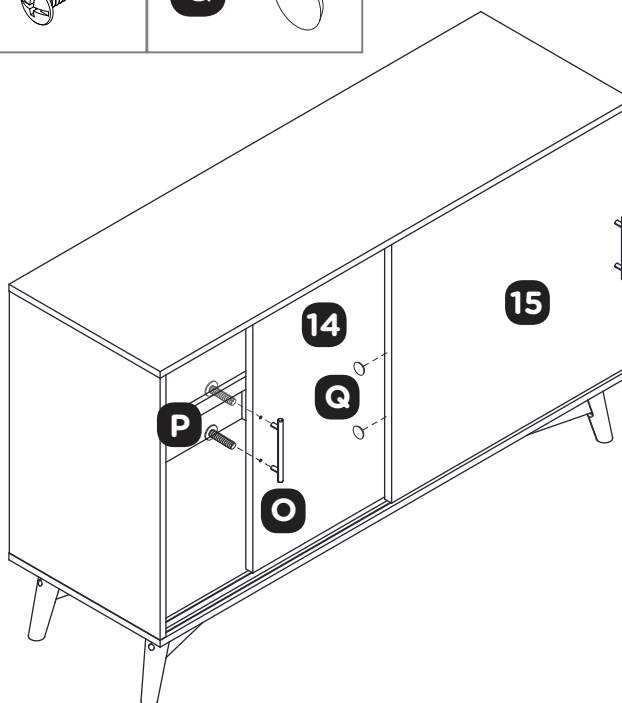
Step 17Require **15****Step 18**Requires **O, P, Q**

Step 19

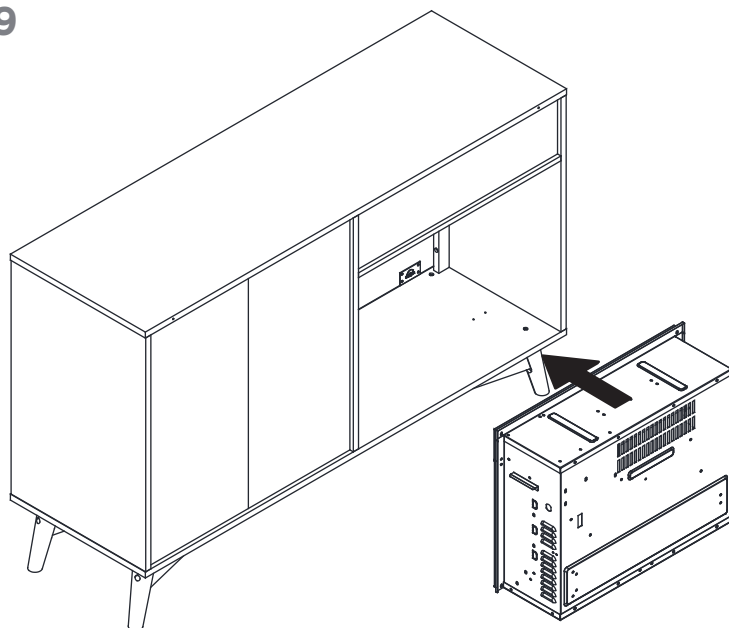

Step 20

Requires **I, J, R, S, T, U, V**

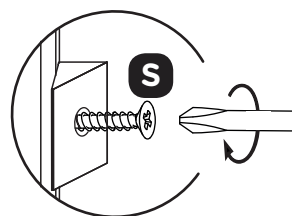
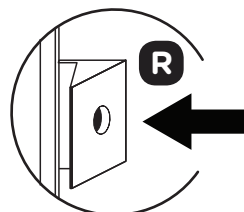
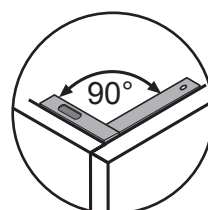
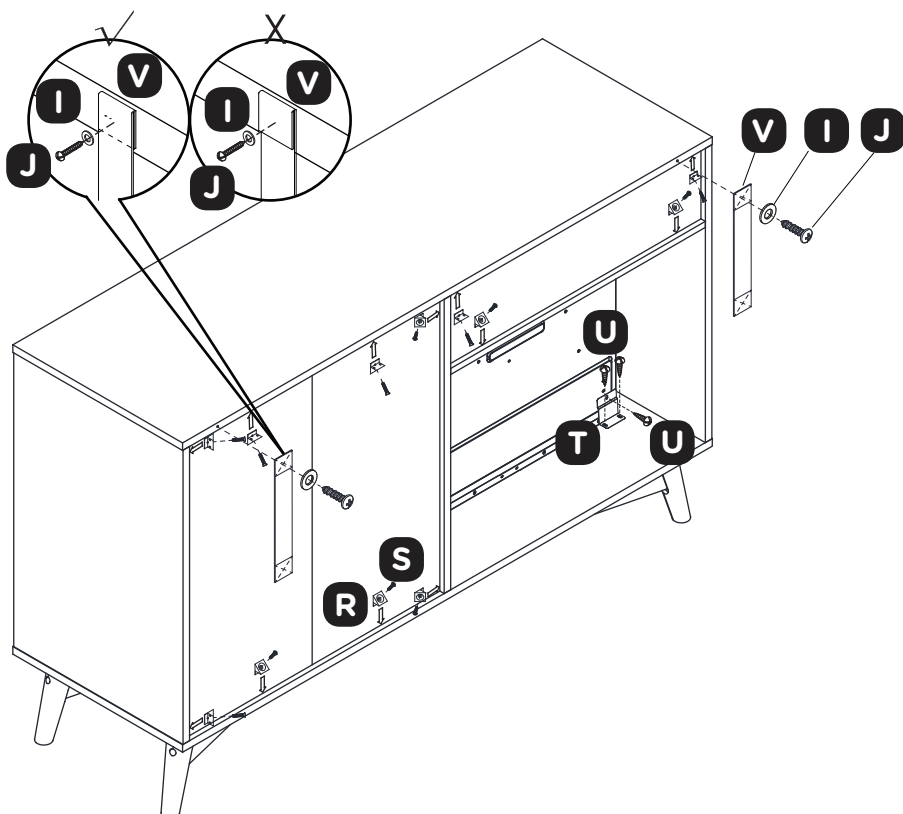
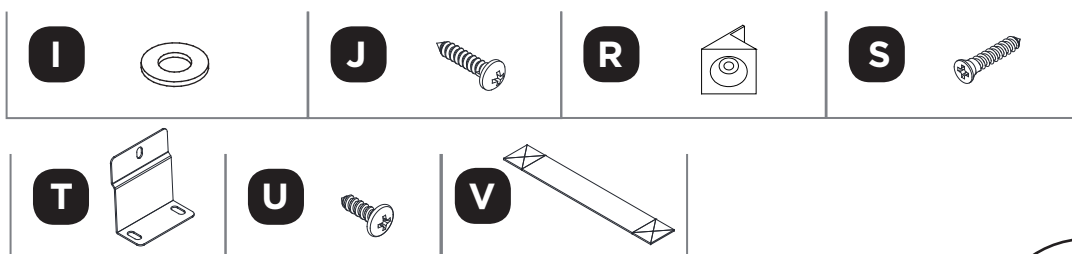

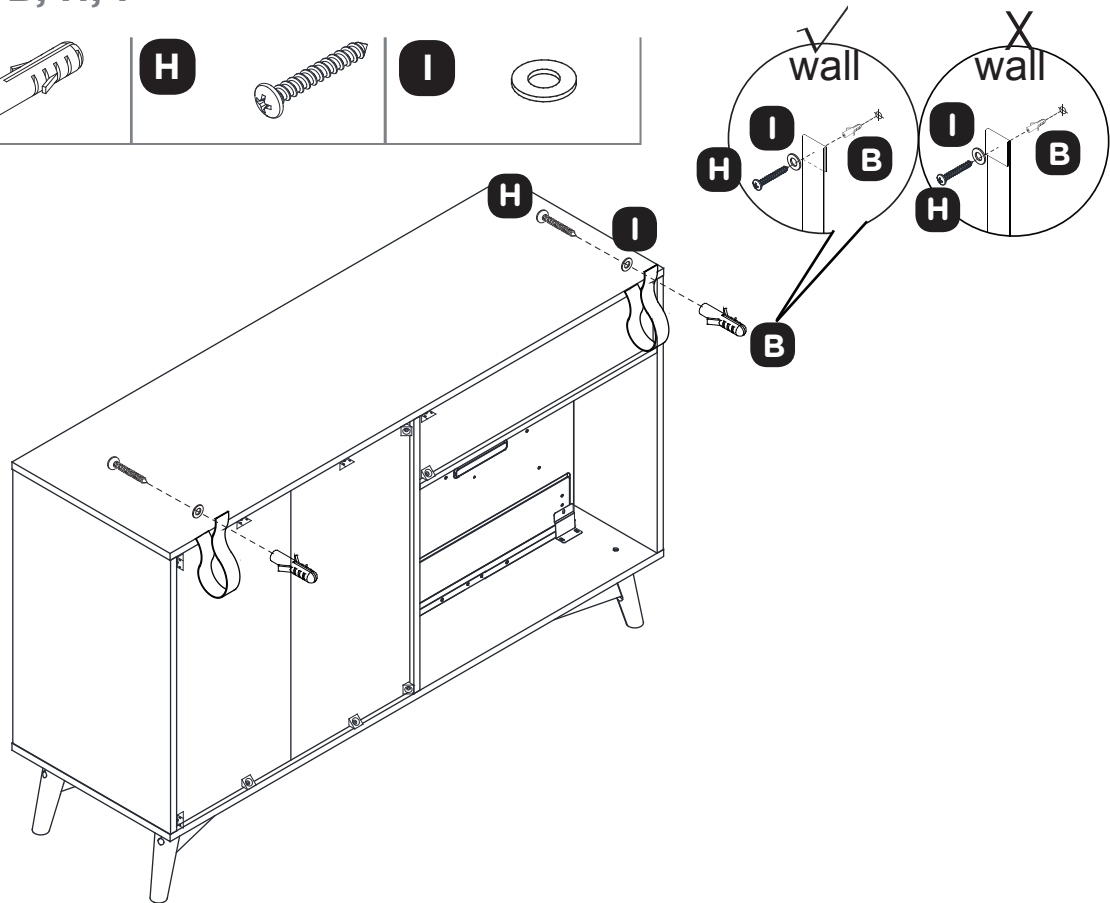
Step 21Requires **B**, **H**, **I****WARNING**

Young children may be injured by tipping furniture. The use of a tipping restraint is highly recommended. This hardware, when properly installed, could provide protection against the unexpected tipping of furniture due to improper use.

Step 22 Enjoy your furniture**WARNING**

For use with most LCD/Plasma televisions up to 52" (132 cm) weighing 101 lb 7 oz (46 kg) or less. Use with televisions or loads heavier than the maximum weights specified may result in instability causing tip-over resulting in death or serious injury. To avoid instability, place flat panel TV in centre or towards back of the unit. **DO NOT** place TV near front edge.

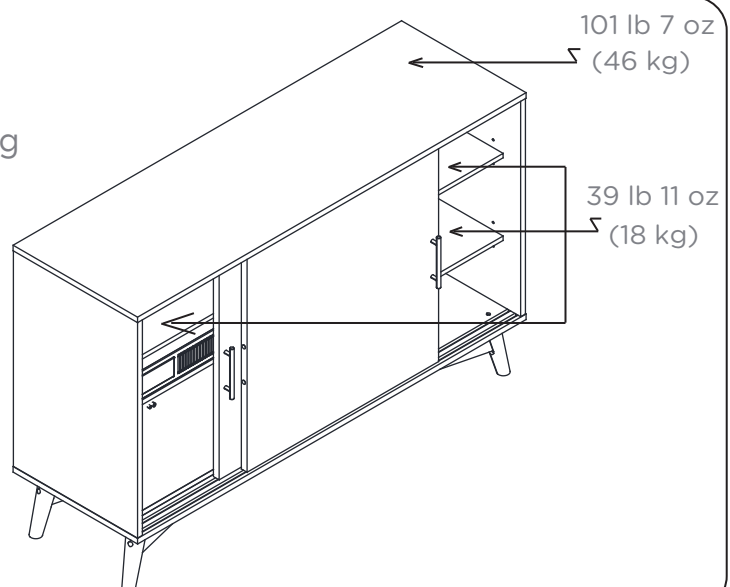

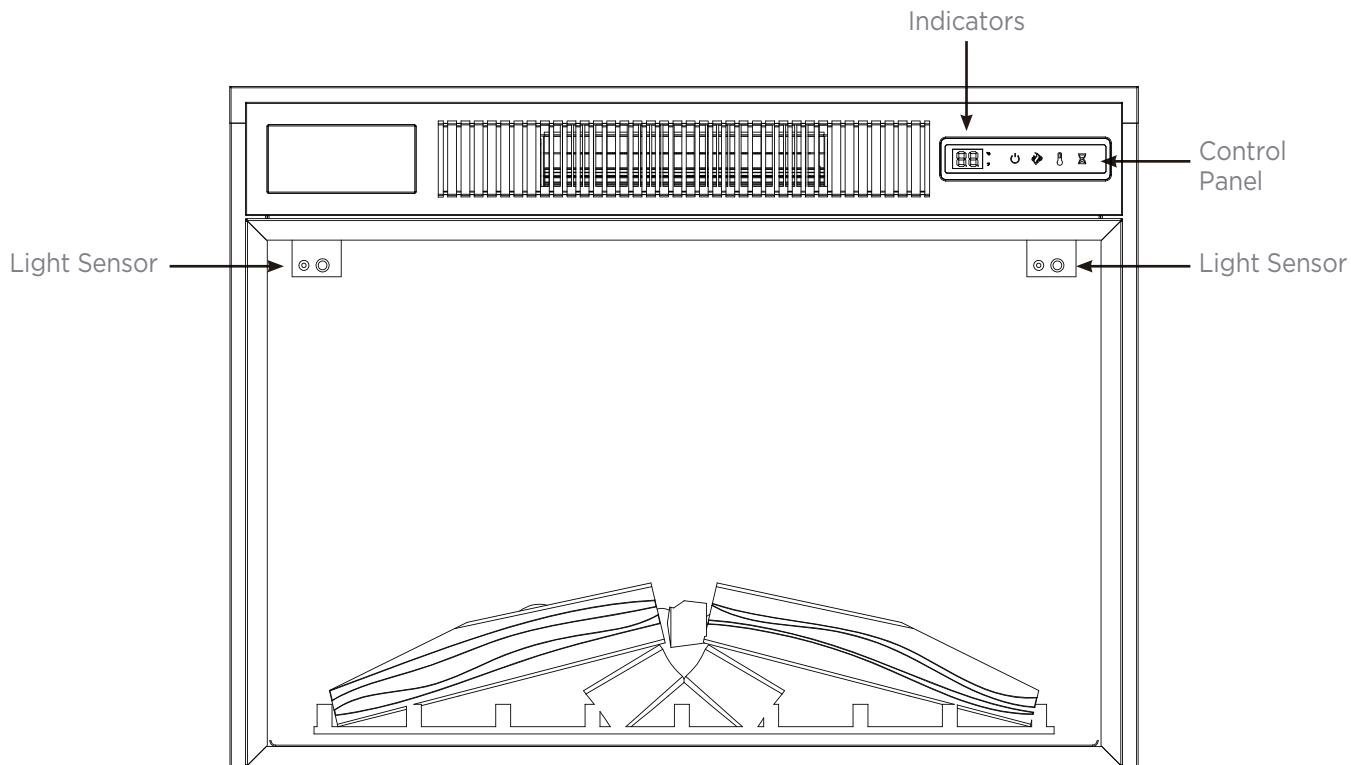







When a function is changed from the control panel or remote there will be a corresponding indicator displayed. The indicator shows the level selected of each function.

When the mantel sliding doors cover the insert, the insert will turn off automatically after 10 seconds and display shows "EO". To restart the insert, slide the door away from the insert. Make sure the power is turned off when not in use.



FUNCTION	ICON	DESCRIPTION
POWER		<p>Press the power button to turn the fireplace insert on and off. Press the power button once to turn the unit on. Press again to turn the unit off.</p> <p>NOTE: When the unit is ON, hold the POWER button for 3 seconds will restore the factory setting.</p>
FLAME MODE		<p>5 different flame effects are available:</p> <ol style="list-style-type: none"> 1. Snow White 2. Rubine 3. Ocean 4. Provence 5. Party <p>Party: In this mode, the unit will cycle automatically between all flame effects periodically.</p>
HEATER		<p>The fireplace contains a fan forced heater.</p> <p>The default setting temperature is 72°F (22°C). The thermostat setting range is 50°-86°F or 10°-30°C. The thermostat is adjustable by 2°F or 1°C increments.</p> <p>To change between °F and °C press and hold the HEATER button for 5 seconds.</p>
TIMER		<p>Pressing the timer button repeatedly will cycle through the following timer settings 30 minutes, 1, 2, 3, 4, 5, 6, 7, 8 hours and off.</p> <p>The fireplace will automatically turn off when the timer reaches zero minutes.</p>
CHILD SAFETY LOCK		<p>The child safety lock is adjustable from remote control only.</p> <p>When the unit is ON, hold the child safety lock button for 3 seconds to activate the child lock function. "CL" will be displayed indicating that the child lock is activated. All function keys are locked. When any button is pressed, "CL" will show on the display indicating that the child safety lock function is activated.</p> <p>To deactivate the child lock function, hold the child safety lock for 3 seconds.</p>
BOOST		<p>The BOOST is adjustable from remote control only.</p> <p>To quickly heat up a cold room/space, press the BOOST button to run the heater at the full rated wattage.</p> <p>Pressing the BOOST button repeatedly will cycle through the following boost settings: 5, 10, 15, 20, 25, 30 minutes and off</p>
FLAME BRIGHTNESS		<p>The flame brightness is adjustable from remote control only.</p> <p>This button controls the brightness of the flame effect. Flame brightness range: setting 1 the darkest to setting 5 the brightest.</p>

Care and Maintenance

- Make sure the unit is turned OFF, unplugged and the heating elements of heater are cool whenever you are cleaning the heater.
- Clean the metal trim using a water-dampened soft, clean cloth. DO NOT use brass polish or household cleaners as these products will damage the metal trim.
- The motors used on the fan and the flame generator assembly are pre-lubricated for extended bearing life and require no further lubrication. However, periodic cleaning/vacuuming of the fan/heater and air intake/output vents is recommended.
- Check your heater cord and plug connections. A loose fitting outlet can cause the plug to overheat and / or cause a fire. Ensure plug fits tightly in the outlet. Check frequently during use to make sure plug and outlet are not hot. If so, discontinue using heater and have outlet replaced by a qualified electrician.

Note: Heaters draw more current than small appliances, overheating of the outlet may occur even if it has not occurred with the other appliances.

- Any other servicing should be performed by an authorized service representative.



WARNING: Make sure the power is turned off before proceeding. Any electrical repairs or rewiring of this unit should be carried out by a licensed electrician in accordance with national and local codes.

If repairing or replacing any electrical component or wiring, the original wire routing, colour coding and securing locations must be followed.



WARNING: Electrical outlet wiring must comply with local building codes and other applicable regulations to reduce the risk of fire, electric shock and injury to persons.



WARNING: Do not use this fireplace if any part of it has been under water. Immediately call a qualified service technician to inspect the fireplace and replace any part of the electrical system.



WARNING: Disconnect power before attempting any maintenance or cleaning to reduce the risk of fire, electric shock or personal injury.

WARNING: During any service of this appliance, the power to the unit must be turned off. First turn the main power switch to the "OFF" position. Then remove the electrical plug from the wall outlet.

Replacing the Remote Control Battery

When the remote control stops operating or its range seems reduced, it is time to replace the battery with new ones.

3 volt lithium coin cell type 2025 battery.

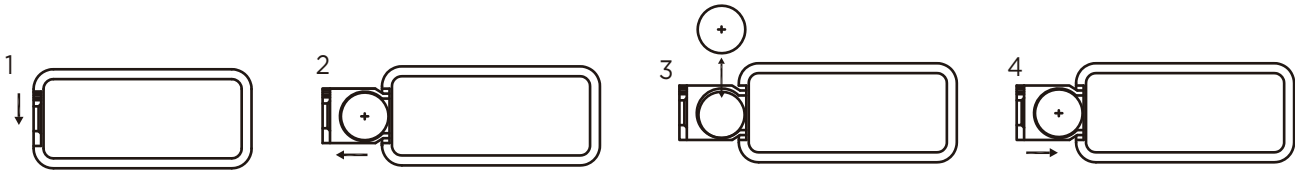

NOTE: Caution for Ingestion.

Do not mix alkaline, standard (carbon-zinc), or rechargeable (ni-cad, ni-mh, etc) batteries. Battery should be removed if the product is to be left unused for a long time.

Please operate the remote control at a slow measured pace. Press the remote control buttons with an even motion and gentle pressure. Repeatedly pressing buttons in rapid succession may cause the transmitter to malfunction.

Disposal of Used Battery

The batteries may contain hazardous substances that could endanger the environment and human health.

Used batteries must not be processed with municipal waste. Instead they should be brought to the appropriate collection point for recycling.

By correctly disposing of used batteries, you prevent potential negative consequences for the environment and human health. Recycling used materials also preserves our natural resources.

For more information about collecting and recycling used batteries, please contact your local municipality, your waste disposal service or the store where you purchased this product.

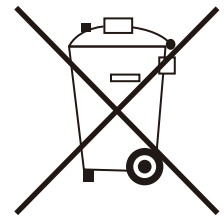

PROBLEM	POSSIBLE CAUSE	CORRECTIVE ACTION
Display shows "E2".	The thermostat sensor is broken or disconnected.	Contact Customer Service for a replacement thermostat sensor.
There is no power.	There is no power to the unit.	Check that unit is plugged into a standard 120V outlet. Press the power button several times and make sure the power is set to the "ON" position.
The heater does not blow warm air.	Thermostat setting is preventing heater from turning on.	Adjust the temperature settings to ensure that the thermostat is set higher than the current room temperature.
Power cord gets warm.	Normal operation.	Check your heater cord and plug connections. Faulty wall outlet connections or loose plugs can cause the outlet or plug to overheat. Ensure plug fits tightly in the outlet. Heaters draw more current than small appliances, overheating of the outlet may occur even if it has not occurred with the use of other appliances. During use check frequently to determine if your plug outlet or faceplate is HOT! If so, discontinue use of the heater and have a qualified electrician check and/or replace the faulty outlet(s).
The remote control is not working.	There is no battery or the signal is poor.	Insert or change the remote battery. Operate remote control at a slow measured pace. Press the remote control buttons with an even motion and gentle pressure. Repeatedly pressing buttons in rapid succession may cause the transmitter to malfunction.
The noise when the heater is on is louder than normal.	a. The air intakes are dirty or obstructed.	a. Check the air intakes for obstructions or high dust build up.
	b. The blower/heater assembly is defective.	b. Contact Customer Service for a new heater/blower assembly.
Abnormal noise when the heater is not on and the flame effect is on.	The spinner motor is defective.	Contact Customer Service for a new spinner motor.

For replacement parts, please call 1-888-670-6684, 7:00 am -5:00 pm CST, Monday - Friday.

Part	Part Name	Part	Part Name
1	Flame Generator Drive Motor	7	Light sensor
2	Heater / Blower Assembly	8	Ember bed with Log
3	Main Circuit Board	9	Ember bed Circuit Board
4	Thermostat Sensor	10	Flame Effect Circuit Board
5	Control Panel Circuit Board	11	Flame Generator / Spinner
6	Control Panel Buttons	12	Remote Control

Some parts and specifications may change without notice.

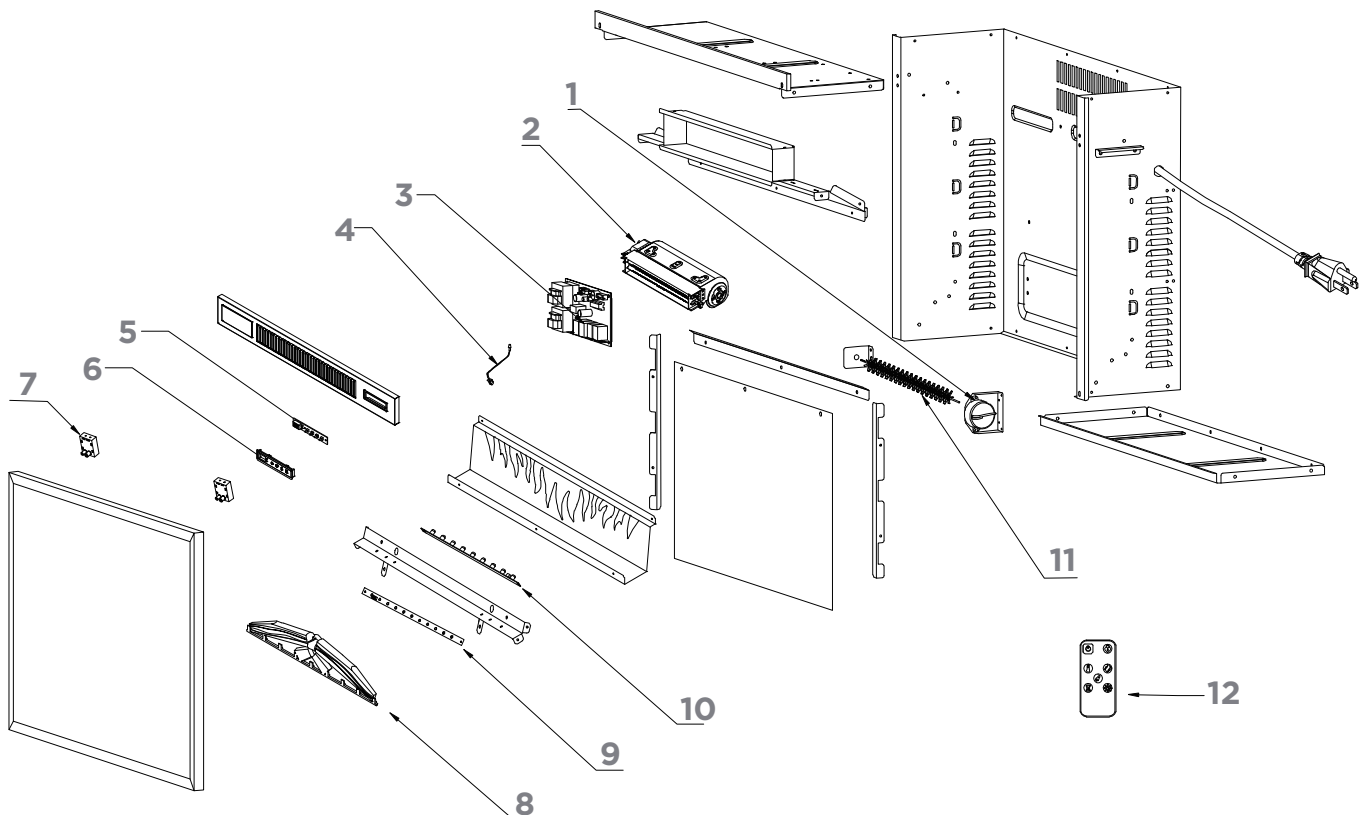

This CANVAS product carries a one (1) year warranty against defects in workmanship and materials. Trileaf Distribution agrees to replace the defective product free of charge within the stated warranty period, when returned by the original purchaser with proof of purchase. This product is not guaranteed against wear or breakage due to misuse and/or abuse.