

# **CERTIFIED**

TM/MC

model number 060-3938-8

## **SNOWBLOWER CABIN**

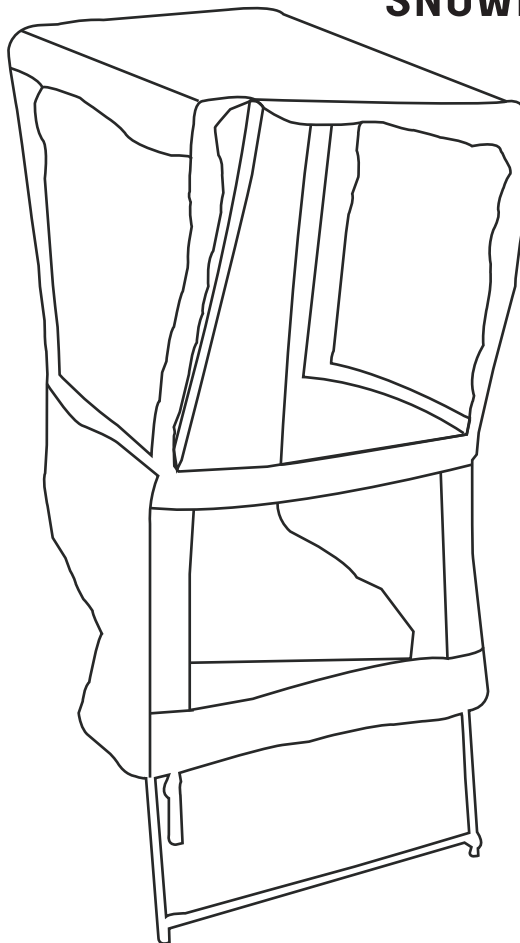

### **IMPORTANT:**

Please read and understand all instructions before use. Retain this manual for future reference.

**INSTRUCTION  
MANUAL**

model number 060-3938-8 | contact us 1-855-867-5633

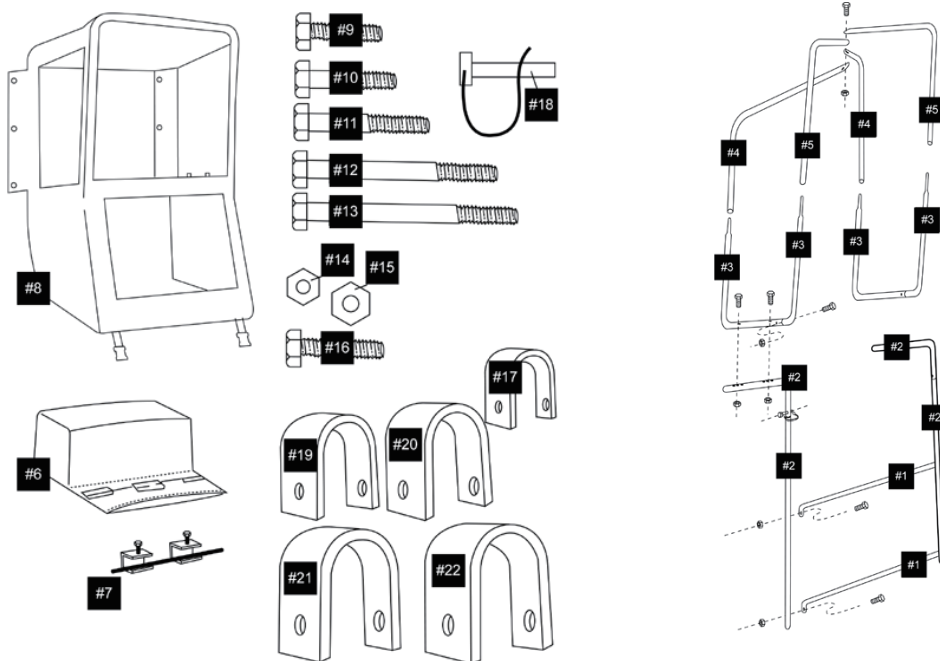

**PARTS BREAKDOWN**

## PARTS LIST

#	DESCRIPTION	QTY.
1	Horizontal mounting bar	2
2	Frame support with end cap	2
3	Lower rib (marked as LF in front, LB at the back)	2
4	Upper back rib (marked as UB)	2
5	Upper front rib (marked as UF)	2
6	Counterweight sandbag	1
7	Sandbag bracket	1
8	Cabin cover	1
9	Hex cap screw, 1/4-20 x 1"	2
10	Hex bolt, 1/4-20 x 1/4"	5
11	Bolt, 1/4-20 x 1-3/4"	4
12	Bolt, 5/16 x 2 -3/4"	4
13	Bolt, 5/16 x 3-1/4"	4
14	Locknut, 1/4-20"	11
15	Locknut, 5/16-18"	4
16	Hex cap screw, 5/16 x 1-1/4"	2
17	U-clamp, 3/4"	4
18	Frame pin, 1-1/4 x 1/4" diameter	2
19	U-clamp, 1-1/16"	4
20	U-clamp, 1-1/18"	4
21	U-clamp, 1-1/4"	4
22	U-clamp, 1-5/16"	4

**PARTS LIST**



model number 060-3938-8 | contact us 1-855-867-5633

## INTRODUCTION

Provides protection from blowing snow. Features an easy, no-drill installation. Includes a counterweight sandbag.

## SPECIFICATIONS

Colour	Black
Weight	21 lb (9.52 kg)
Dimensions	28 x 30 x 50" (71.1 x 76.2 x 127 cm)
Size	Fits all two-stage snow blowers
Material	100% polyester cover with freeze-resistant, super-clear vinyl windows and water-repellant fabric
	3/4" powder-coated steel tube frame with quick-detach design

## WORK AREA

1. Operate in a safe work environment. Keep your work area clean, well-lit and free of distractions.
2. Keep anyone not wearing the appropriate safety equipment away from the work area.
3. Store unused tools properly in a safe and dry location to prevent rust or damage. Lock tools away and keep out of the reach of children.



### WARNING!

Wear personal protective equipment approved by the Canadian Standards Association (CSA) or American National Standards Institute (ANSI).

## PERSONAL PROTECTIVE EQUIPMENT

1. Always wear impact safety goggles that provide front and side protection for the eyes. Eye protection equipment should comply with CSA Z94.3-07 or ANSI Z87.1 standards based on the type of work performed.
2. Wear gloves that provide protection based on the work materials or to reduce the effects of tool vibration.
3. Wear protective clothing designed for the work environment and tool.
4. Non-skid footwear is recommended to maintain footing and balance in the work environment.

## PERSONAL PRECAUTIONS

Control the tool, personal movement and the work environment to avoid personal injury or damage to tool.

1. Do not operate any tool when tired or under the influence of drugs, alcohol or medications.

2. Avoid wearing clothes or jewellery that can become entangled with the moving parts of a tool. Keep long hair covered or bound.
3. Do not overreach when operating a tool. Proper footing and balance enables better control in unexpected situations.

### SPECIFIC SAFETY PRECAUTIONS

1. Use the correct tool for the job. This tool was designed for a specific function. Do not modify or alter this tool or use it for an unintended purpose.
2. The cabin does not provide protection from noise, exhaust gas, corrosive chemicals and collisions.
3. Do not operate the snowblower with the cabin in areas without adequate ventilation.
4. Check surrounding areas thoroughly. Operating the snowblower with the cabin restricts your field of vision.
5. Watch for tree branches and other overhangs that might snag the cabin during operation.
6. Install the counterweight to prevent the snowblower from tipping.



#### WARNING!

DO NOT let comfort or familiarity with product (gained from repeated use) replace strict adherence to the tool safety rules. If you use this tool unsafely or incorrectly, you can suffer serious personal injury.

### UNPACKING

Remove the parts and accessories from the packaging and inspect for damage. Make sure that all items in the parts list are included.



#### WARNING!

Do not operate the tool if any part is missing. Replace the missing part before operating. Failure to do so could result in a malfunction and personal injury.

model number 060-3938-8 | contact us 1-855-867-5633

### Tools required for assembly:

- Tape Measure
- 10" Adjustable Wrench
- 7/16 or 1/2" Wrench or Socket
- 13 to 15 lb (6 to 7 kg) of Dry Sand or Non-clumping Cat Litter

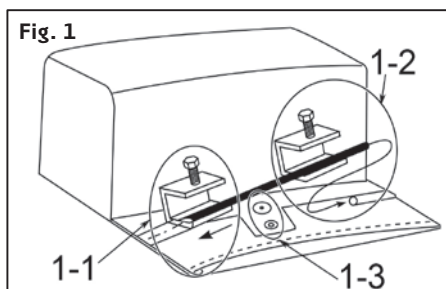

### 1. Assemble the counterweight sandbag (#6).

- Place the empty sandbag on a flat surface.
- Insert one end of the sandbag bracket (#7) into one of the small pockets (Fig. 1-1).
- Stretch the opposite end of the bag until you can slip the other end of the bracket into the pocket (Fig. 1-2).
- Fasten the snap tab (Fig. 1-3) around the bracket.
- Fill the sandbag with a minimum 13 lb (6 kg) of dry sand or non-clumping cat litter.

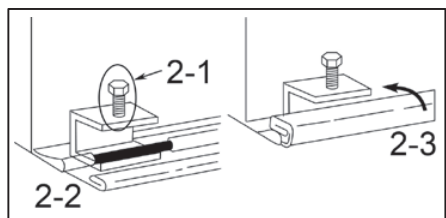

Fig. 2

### 2. Install the sandbag.

- Insert the 1 1/4" hex cap screws (#16) into the bracket (Fig. 2-1). Do not fully tighten.
- Close the sandbag by folding the edge of the flap (Fig. 2-2) inwards and placing the fold (Fig. 2-3) in between the mounting brackets.
- Place the bag on top of the auger housing. Do not cover any warning labels. Position the bag so that the front edge of the auger housing meets the inside edge of the mounting bracket. Tighten the cap screws to secure.

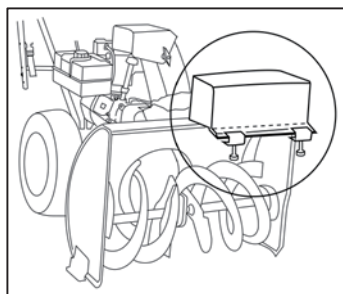
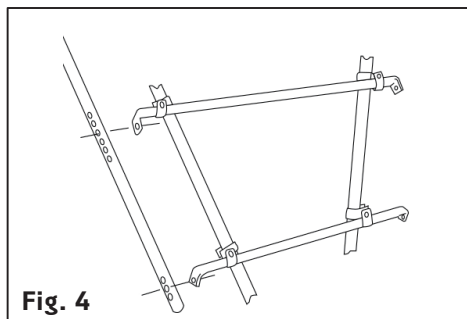
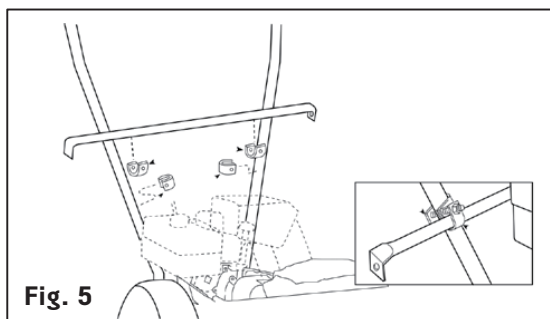

Fig. 3



### WARNING!

Ensure that the snowblower is cool and turned off before installing the cabin to prevent equipment damage and/or personal injury. Numbered references in parenthesis (#1) refer to the included Parts List. Dashed numbers in parenthesis (Fig. 1-1) refer to a specific point in an illustration or image.

**Fig. 4**

**Fig. 5**

### 3. Install the lower horizontal mounting bar.

The horizontal mounting bars (#1) attach to the handlebars of the snowblower using a U-clamp system that is designed to fit different machines. Position the bars properly so they do not obstruct the snowblower's controls, lights or moving parts. Refer to Fig. 4 for the recommended setup.

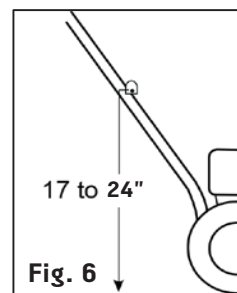
- Install a 3/4" U-clamp (#17) on each end of the horizontal mounting bars.
- Install the appropriate U-clamps (#19, #20, #21 or #22) on the handle bars.
- Position the lower bar 17 to 24" above the ground to allow at least 6 1/2" of headroom inside the cabin.
- Use 2 3/4" (#12) or 3 1/4" (#13) bolts and 1/4" locknuts (#14) to attach the bar to the handlebars.

**Fig. 6**

#### **IMPORTANT!**

The locknuts have vibration resistant linings and may be difficult to thread.

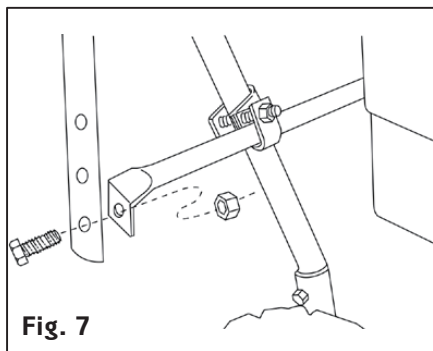
**Fig. 7**

### 4. Install the frame supports (#2).

- Attach the longer legs of the frame support to the lower mounting bar. The holes to use on the support depends on the bar's height. If the bar is:
  - 17 to 19" from the ground, use the bottom holes.
  - 19 to 21" from the ground, use the middle holes.
  - 21 to 24" from the ground, use the top holes.
- Secure using 1 1/4" hex bolts (#10) and 1/4" locknuts (#14).

**5. Assemble the legs of the frame supports together. Align the holes and slide the frame pin (#18) through. Fasten to lock in place.**

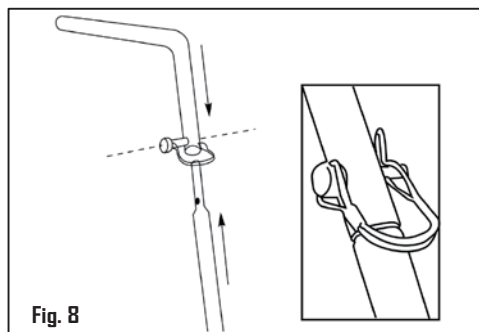

Fig. 8

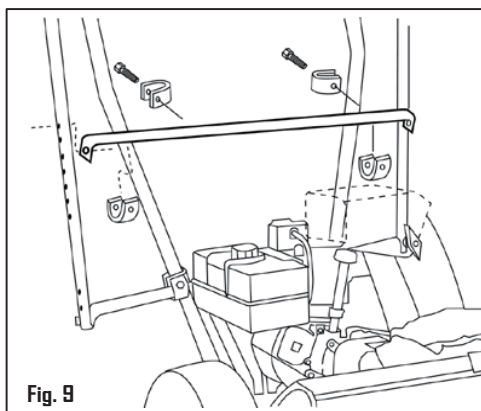

Fig. 9

**6. Install the upper horizontal mounting bar.**

- Swivel the shorter legs of the frame support upwards until they are parallel to the ground.
- Position the upper horizontal mounting bar as far as possible from the lower bar. Align the holes of the bar with any of the holes in the frame support.
- Use 2 3/4" (#12) or 3 1/4" (#13) bolts and 1/4" locknuts (#14) to attach the bar to the handlebars.

**7. Attach the frame supports to the upper horizontal mounting bar using hex bolts (#10) and 1/4" lock nuts (#14)**

**8. Check and adjust the frame supports. The shorter legs (Fig.10-1) of the frame supports should be parallel to the ground and spaced 28 1/2" apart.**

**If they are not parallel:**

- Put an adjustable wrench on the partially flattened end of the lower bar.
- Use the wrench as a level to rotate the bar.
- Adjust until the legs are parallel.

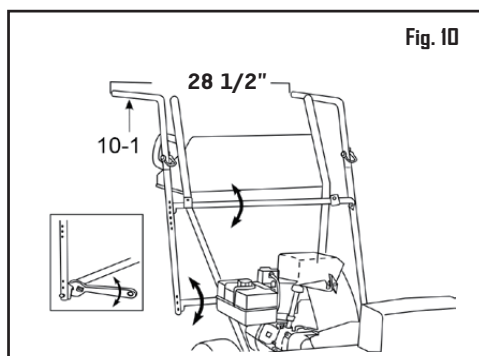

Fig. 10



**IMPORTANT!**

The upper bar may have to be rotated with the lower bar in certain setups.

**9. Tighten all mounting bolts securely.**

**10. Install the lower ribs (#3)**

- Assemble the lower ribs together. Secure using a 1" hex cap screw (#9) and a 1/4" locknut (#14).
- Attach the lower ribs assembly to the frame supports using 1 3/4" bolts (#11) and 1/4" locknuts (#14). Use any of the holes in the frame support. Ensure that the sides of the lower ribs that are marked LF are facing towards the snowblower.

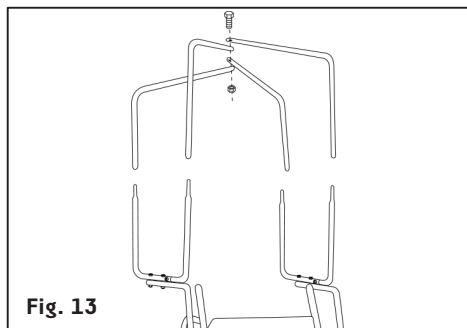
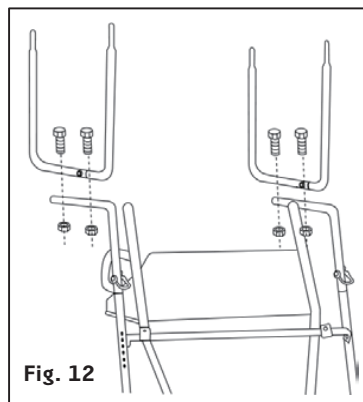
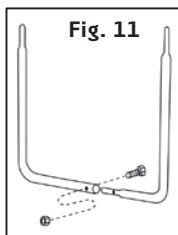

**11. Install the upper ribs.**

- Insert the upper back ribs (#4) into the lower ribs marked LB.
- Insert the upper front ribs (#5) into the lower ribs marked LF.
- Align the flattened ends of the upper ribs. Secure using a 1 1/4" hex bolt (#10) and a 1/4" locknut (#14).
- Adjust the upper front ribs until they are 28 1/2" apart.

**12. Install the cabin cover (#8).**

- Drape the cover over the handlebars.
- Gradually pull the cover up and over the frame from the inside.
- Locate the 2 long flaps at the back of the cabin. Fold the flaps over the upper back ribs. Connect the hook and loop straps and the snaps over the frame (Fig. 14).
- Locate the hook and loop straps on the front corners of the cabin and wrap them around the frame poles (Fig. 15). Clip the buckle straps inside the cabin over the side frame (Fig. 16).
- Locate the buckle straps on the bottom front corners of the cabin. Loop each strap under and over the lower mounting bar and clip them together in front of the cover.
- Adjust the length of the straps as necessary.

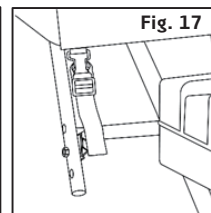
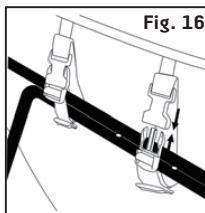
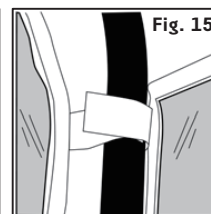
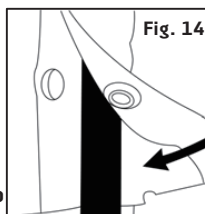

**IMPORTANT! Be careful not to scratch the plastic windows.**

model number 060-3938-8 | contact us 1-855-867-5633

## REMOVING THE CABIN

1. Unclip the buckle straps from the lower mounting bar.
2. Remove the frame pins from the frame supports (Fig. 19).
3. Gently lift the cabin away from the lower frame supports (Fig. 20).

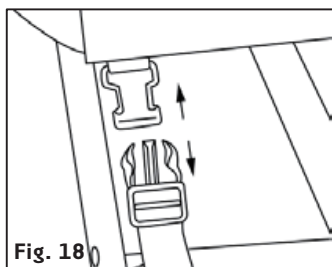

Fig. 18

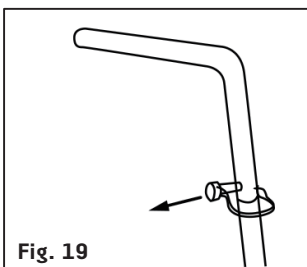

Fig. 19

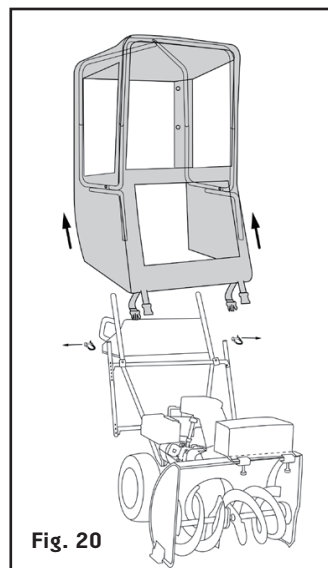

Fig. 20

## CARE AND MAINTENANCE

1. Maintain the tool with care. A tool in good condition is efficient, easier to control and will have fewer problems.
2. Inspect the tool components periodically. Repair or replace damaged or worn components. Only use identical replacement parts when servicing.



### WARNING!

Only qualified service personnel should repair the tool. An improperly repaired tool may present a hazard to the user and/or others.

## CLEANING

- Wipe the windows with a clean, soft cloth. Liquid soap and automotive windshield cleaners may be used.
- Wipe the fabric areas with a clean, moist cloth. Do not use solvents.



### NOTICE!

Do not clean the plastic windows while dry to prevent scratching the surface.

## STORAGE

Store in a clean, dry location. Do not store while wet or damp to avoid mildew growth. Avoid folding the windows when storing for long periods. When not in use for an extended period, tighten the connections before using the tool again.

## DISPOSAL

Recycle a tool damaged beyond repair at the appropriate facility.

model number 060-3938-8 | contact us 1-855-867-5633

## 2 YEAR LIMITED WARRANTY

This CERTIFIED product is guaranteed for a period of two (2) years from the date of original retail purchase against defects in workmanship and materials.

Subject to the conditions and limitations described below, this product, if returned to us with proof of purchase within the stated warranty period and if covered under this warranty, will be repaired or replaced (with the same model, or one of equal value or specification), at our option. We will bear the cost of any repair or replacement and any costs of labour relating thereto.

These warranties are subject to the following conditions and limitations:

- a) a bill of sale verifying the purchase and purchase date must be provided;
- b) this warranty will not apply to any product or part thereof which is worn or broken or which has become inoperative due to abuse, misuse, accidental damage, neglect or lack of proper installation, operation or maintenance (as outlined in the applicable owner's manual or operating instructions) or which is being used for industrial, professional, commercial or rental purposes;
- c) this warranty will not apply to normal wear and tear or to expendable parts or accessories that may be supplied with the product that are expected to become inoperative or unusable after a reasonable period of use;
- d) this warranty will not apply to routine maintenance and consumable items such as, but not limited to, fuel, lubricants, vacuum bags, blades, belts, sandpaper, bits, fluids, tune-ups or adjustments;
- e) this warranty will not apply where damage is caused by repairs made or attempted by others (i.e. persons not authorized by the manufacturer);
- f) this warranty will not apply to any product that was sold to the original purchaser as a reconditioned or refurbished product (unless otherwise specified in writing);
- g) this warranty will not apply to any product or part thereof if any part from another manufacturer is installed therein or any repairs or alterations have been made or attempted by unauthorized persons;
- h) this warranty will not apply to normal deterioration of the exterior finish, such as, but not limited to, scratches, dents, paint chips, or to any corrosion or discolouring by heat, abrasive and chemical cleaners; and
- i) this warranty will not apply to component parts sold by and identified as the product of another company, which shall be covered under the product manufacturer's warranty, if any.

## Additional Limitations

This warranty applies only to the original purchaser and may not be transferred. Neither the retailer nor the manufacturer shall be liable for any other expense, loss or damage, including, without limitation, any indirect, incidental, consequential or exemplary damages arising in connection with the sale, use or inability to use this product.

## Notice to Consumer

This warranty gives you specific legal rights, and you may have other rights, which may vary from province to province. The provisions contained in this warranty are not intended to limit, modify, take away from, disclaim or exclude any statutory warranties set forth in any applicable provincial or federal legislation.

Made in China

Imported by  
Trileaf Distribution Trifeuil Toronto,  
Canada M4S 2B8