

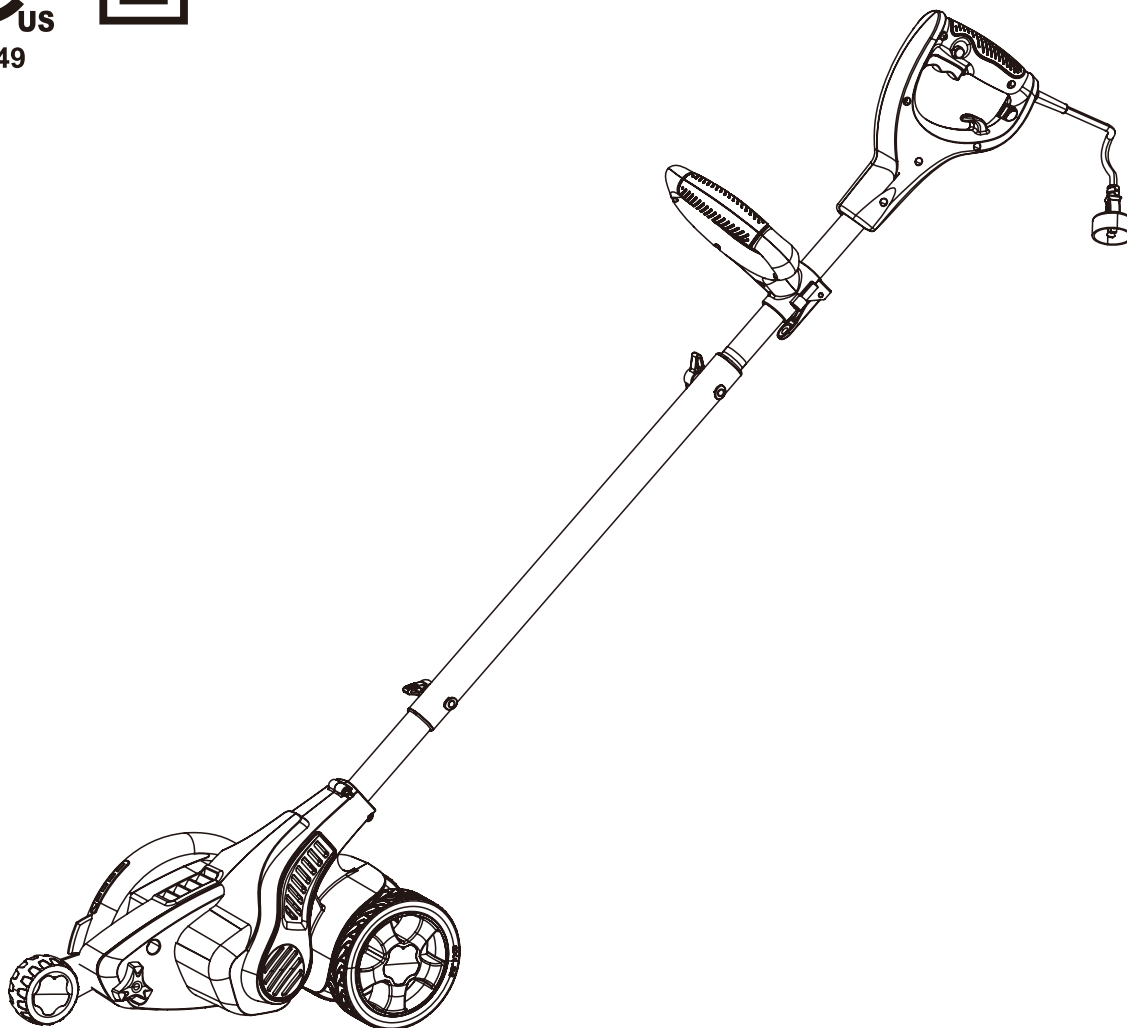

YARDWORKS^{TM/MC}

Electric Lawn Edger

model number 060-3808-8 | contact us: 1-866-523-5218



IMPORTANT:

Read and follow all safety rules and operating instructions before using this product.

**Operator's
Manual**



YARDWORKS^{TM/MC}



For problems or questions,
**DO NOT RETURN TO
STORE.** Please contact one
of our Customer Service
Agents who would be happy
to assist you.

En cas de problèmes ou si vous avez des questions,
NE RETOURNEZ PAS L'ARTICLE AU MAGASIN.
Contactez plutôt un de nos agents du service à la
clientèle, qui se fera un plaisir de vous aider.

For Customer Assistance Please Call:

Pour le service à la clientèle, veuillez composer :



CANADA: 1-866-523-5218

model no. 060-3808-8 | contact us: 1-866-523-5218

Table of Contents

SPECIFICATIONS	2
KNOW YOUR EDGER	3
SYMBOLS	4
SAFETY INFORMATION	5
ELECTRICAL INFORMATION	9
EXPLODED VIEW	11
PARTS LIST	12
ASSEMBLY	13
OPERATION	15
MAINTENANCE	20
TROUBLESHOOTING	23
WARRANTY	24

Specifications

Input:	120 V, 60 Hz, 12 A
Blade length:	7 1/2 in (19 cm)
Weight:	13.9 lb (6.3 kg)

model no. 060-3808-8 | contact us: 1-866-523-5218

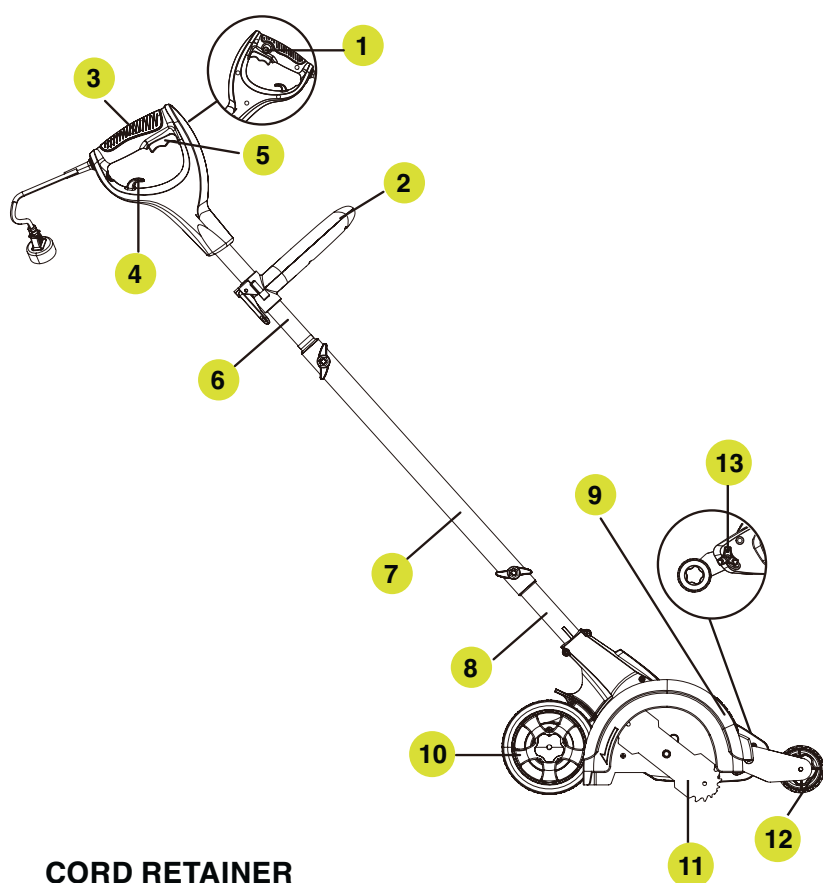

1. Lock-off button
2. Adjustable auxiliary handle
3. Rear handle
4. Cord retainer
5. Trigger switch
6. Upper tube
7. Middle tube
8. Lower tube
9. Blade guard
10. Wheel
11. Blade
12. Spring assist front wheel
13. Height adjusting knob

Know your edger

CORD RETAINER

A convenient cord retainer helps keep the extension cord connection secure during tool operation.

FRONT HANDLE

For ease of operation, the edger is equipped with an adjustable front handle.

LAWN EDGING AND TRENCHING

The edger blade can be adjusted to depths that allow for either lawn edging or for trenching.

LOCK-OFF BUTTON

The lock-off button reduces the possibility of accidental starting.

SPRING ASSIST FRONT WHEEL

The spring assist front wheel allows the user to determine the depth of the edger blade.

WHEELS

The front wheel and rear wheels are designed to fit snugly on top of curbs for improved edging.













KNOW YOUR EDGER

The safe use of this product requires an understanding of the information on the tool and in this Operator's Manual as well as a knowledge of the project you are attempting. Before using this product, familiarize yourself with all operating features and safety rules.

model no. 060-3808-8 | contact us: 1-866-523-5218

Symbols

Some of the following symbols may be used on this product. Please study them and learn their meaning. Proper interpretation of these symbols will allow you to operate the product better and safer.

Symbol	Name	Designation/Explanation
V	Volts	Voltage
A	Amperes	Current
Hz	Hertz	Frequency (cycles per second)
W	Watts	Power
min	Minutes	Time
	Alternating Current	Type of current
	Direct Current	Type of current
	Class II Construction	Double-insulated construction
	Wet Conditions Alert	Do not expose to rain or use in damp locations.
	Read the Operator's Manual	To reduce the risk of injury, users must read and understand the Operator's Manual before using this product.
	Safety Alert	Precautions to ensure your safety.
	Keep Bystanders Away	Keep all bystanders at least 50' (15m) away.
	Eye and Ear Protection	Always wear safety goggles or safety glasses with side shields and, if necessary, a full face shield when operating this product.
	Long Hair	Failure to keep long hair away could result in personal injury.
	Loose Clothing	Failure to keep away loose clothing or jewelry could result in personal injury.
	Ricochet	Thrown objects can ricochet and result in personal injury or property damage.
	Sharp Blade	Keep feet and hands away from rotating blade.
	Hand Danger	Failure to keep your hands away from the blade will result in serious personal injury.



model no. 060-3808-8 | contact us: 1-866-523-5218

READ ALL INSTRUCTIONS

- Read the Operator's Manual carefully. Be thoroughly familiar with the controls and the proper use of the equipment. Know how to stop the unit and disengage the controls quickly in case of emergency.
- Do not allow children or untrained individuals to use this unit.
- Clear the work area before each use. Remove all objects such as rocks, broken glass, nails, wire, or string which can be thrown or become entangled in the edger blade.
- Wear safety glasses or goggles that comply with ANSI Z87.1 standard when operating this product.
- Dress properly - Do not wear loose clothing or jewelry. They can be caught in moving parts. The use of sturdy gloves is recommended. The use of rubber gloves and safety footwear is recommended when working outdoors. Wear protective hair covering to contain long hair.
- Do not operate this product when barefoot or wearing open sandals. Always wear safety footwear and pants or slacks that cover your legs.
- Never operate this unit on the operator's left side.
- Keep Children Away – Keep all bystanders, children, and pets at least 50' (15 m) away. Bystanders should be encouraged to wear eye protection. If approached, stop the motor immediately.
- Stay alert, watch what you are doing, and use common sense. Do not use product while tired or under the influence of drugs, alcohol, or medication.
- Do not operate in poor lighting.
- Keep firm footing and balance. Do not overreach. Overreaching can result in loss of balance or exposure to hot or sharp surfaces. Keep cutting attachment below waist.
- Keep all parts of your body away from any moving part.
- Unplug from the power outlet before making any adjustments or repairs. Wear protective equipment and observe all safety instructions. When the unit is turned off, make sure the cutting attachment has stopped before setting the unit down.
- Inspect the unit before each use for loose fasteners. Replace any damaged parts before use.
- Do not, under any circumstance, use any attachments or accessories on this product which was not provided with the product, or identified as appropriate for use with this product in the Operator's Manual.
- Avoid dangerous environments - Do not use the product in damp or wet locations.
- Do not use in rain.
- If the product vibrates abnormally, immediately stop the motor and check for the cause. Vibration is generally a warning of trouble, an indication that maintenance and/or servicing is required.
- Before cleaning, repairing, or inspecting, shut off the motor and make certain all moving parts have stopped.
- Service on the product must be performed by qualified repair personal only. Service or maintenance performed by unqualified personal could result in injury to the damage to the product.
- Use only identical replacement parts when servicing the product. Use of unauthorized parts may damage the product or create a risk of serious injuries to the operator or bystanders.

Safety Information

- To reduce the risk of electric shock, this tool has a polarized plug (one blade is wider than the other) and will require the use of a polarized extension cord. The plug will fit into a polarized extension cord only one way. If the plug does not fit fully into the extension cord, reverse the plug. If the plug still does not fit, obtain a correct polarized extension cord. A polarized extension cord will require the use of a polarized wall outlet. This plug will fit into the polarized wall outlet only one way. If the plug does not fit fully into the wall outlet, reverse the plug. If the plug still does not fit, contact a qualified electrician to install the proper wall outlet. Do not change the equipment plug, extension cord receptacle, nor extension cord plug in any way.
- Avoid body contact with grounded surfaces such as pipes, radiators, ranges, and refrigerators.
- There is an increased risk of electric shock if your body is grounded.
- Do not expose product to rain or wet conditions. Water entering a power tool will increase the risk of electric shocks.
- Do not handle the plug or the tool with wet hands.
- When operating a power tool outside, use an outdoor extension cord marked "W-A" or "W". These cords are rated for outdoor use and reduce the risk of electric shocks.
- Store idle edger indoors. When not in use, store in dry, and high or locked up place out of reach of children.
- Turn off all controls before unplugging.
- Do not use tool if the switch does not turn it on or off. Any tool that cannot be controlled with the switch is dangerous and must be repaired.
- Do not use with a damaged plug. If tool is not working as it should or has been dropped, damaged, left outdoors, or dropped into water, return it to an authorized service center.
- Do not leave the tool plugged in. Unplug from the power outlet when not in use, before servicing, changing accessories, and before storing the tool. Such preventative safety measures reduce the risk of starting the tool accidentally.
- Do not abuse cord. Do not pull or carry the tool by its cord, use the cord as a handle, close a door on the cord, or pull the cord around sharp edges or corners. Do not run appliance over the cord. Keep the cord away from heated surfaces.
- Do not unplug by yanking on the cord to disconnect it. To unplug, grasp the plug, not the cord.
- Do not handle the plug or the appliance with wet hands.
- In a double insulated appliance, two systems of insulation are provided instead of grounding. No grounding means the appliance is equipped with double insulation and that grounding need not be added. Servicing a double insulated appliance requires extreme care and knowledge of the system and should be done only by qualified service personnel.
- Replacement parts for a double insulated appliance must be identical to the parts they replace.
- For household use only.
- Ground Fault Circuit Interrupter (GFCI) – Protection should be provided on the circuit or outlet to be used for the edger. Receptacles are available having built in GFCI protection and may be used for this safety measure.
- Avoid unintentional starting. Do not carry plugged in edger with your finger on the switch. Be sure the switch is off when plugging in the tool.
- Do not grasp the exposed cutting blades or cutting edges when picking up or holding the edger.



model no. 060-3808-8 | contact us: 1-866-523-5218

- Do not force the edger. It will do the job better and with less likelihood of a risk of injury at rate for which it was designed.
- Maintain the edger with care. Keep the sharp cutting edge clean for best performance and to reduce the risk of injury. Follow the instruction for lubricating and changing accessories. Inspect the edger cord periodically and, if damaged, have it repaired by an authorized service technician. Inspect the extension cords periodically and replace it if damaged. Keep handles dry, clean, and free from oil and grease.
- Check damaged parts. Check the alignment and the binding of moving parts, the overall condition of the tool. A defective tool or one with a guard or other part that is damaged should be properly repaired or replaced by an authorized service center.
- Use the right appliance. Do not use edger for any job except that for which it is intended.
- Use the appropriate extension cord. Make sure your extension cord is in good condition. When using an extension cord, be sure to use one heavy enough to carry the current your product will draw. A wire gauge size (A.W.G.) of at least 14 is recommended for an extension cord 50' (15 m) or less in length. If in doubt, use the next heavier gauge. The smaller the gauge number, the heavier the cord. An undersized cord will cause a drop in line voltage resulting in loss of power and overheating.

SPECIFIC SAFETY RULES

- Be sure all guards are properly and securely attached. Never use a tool without its guard.
- Replace dull or worn blade; do not attempt to sharpen. Failure to heed this warning could result in excessive vibration causing serious personal injury or property damage.
- Use this edger for edging along sidewalks, driveways, and flower beds. Do not use for any other purpose.
- Do not use the edger on or near graveled surfaces.
- If the edger strikes any type of foreign object: a) Stop the edger and disconnect from the power supply. b) Inspect for damage to the edger blade and guard. c) Correct damage before using the edger attachment. Failure to do so can cause serious injury.
- Make yourself familiar with the area you are edging. Be aware of uneven sidewalks and holes in the terrain as well as other similar hazardous conditions (example: wire or wire rope which can break off and become a dangerous projectile). Always push the edger attachment slowly over rough ground.
- Never direct discharge of material toward bystanders or allow anyone near the area of operation. Use care in directing discharge to avoid glass enclosures, automobiles, and the like.
- Always stop the motor and disconnect from power supply before attempting to remove any obstruction caught or jammed in the blade, installing attachment, or making any adjustments.
- To reduce the risk of fire, do not allow excessive grass, leaves, or grease to accumulate on the product.

model no. 060-3808-8 | contact us: 1-866-523-5218

Safety Information

- Do not attempt to remove cut material nor hold material to be cut when the motor is running or when the cutting blade is moving.
- Always keep your right hand on the rear handle and your left hand on the front handle when the blade is rotating.
- Always be aware of the power cord's location and keep clear of the area you are working in. Cords may become a trip hazard to the operator. Cords that are in the cutting path may be cut by the edger.
- Never stand or have any part of your body in line with the path of the edger blade.
- A coasting blade can cause injury while it continues to spin after the motor is stopped or throttle trigger released. Maintain proper control until the blade has completely stopped rotating.
- Do not leave the product unattended.
- If the power supply cord is damaged, it must be replaced only by the manufacturer or by an authorized service center to avoid risks of injury.
- Save these instructions. Refer to them frequently and use them to instruct others who may use this tool. If you loan someone this tool, loan them these instructions and make sure they read and understand them before they use the tool in order to prevent the misuse of the product and possible injuries.



DANGER – ROTATING BLADE:

- Keep both hands on the handles when the blade is rotating.
- Keep hands and feet away from the cutting area.
- Do not attempt to remove cut material nor hold material to be cut when the motor is running or when blade is moving.
- Make sure the unit is unplugged when clearing jammed material from blade.
- Keep guards in place.
- Keep blade clean and sharp. Replace dull blades as needed.



CAUTION: The blade continues to rotate for a few seconds after the unit is turned off.

**SAVE THESE INSTRUCTIONS FOR
FUTURE REFERENCE!**

EXTENSION CORDS

When using a power tool at a considerable distance from a power source, be sure to use an extension cord that has the capacity to handle the current the product will draw. An undersized cord will cause a drop in line voltage, resulting in overheating and loss of power. Use the chart to determine the minimum wire size required in an extension cord. Only round jacketed cords listed by Underwriter's Laboratories (UL) should be used.

When working outdoors with a product, use an extension cord that is designed for outside use. This type of cord is designated with "W-A" or "W" on the cord's jacket. Before using any extension cord, inspect it for loose or exposed wires and cut or worn insulation.

Minimum Gauge for Extension Cords (AWG) (when using 120 V only)

Ampere Rating		Total Length of Cord in Feet (meters)			
More Than	Not More Than	25' (7.6 m)	50' (15 m)	100' (30.4 m)	150' (45.7 m)
0	6	18	16	16	14
6	10	18	16	14	12
10	12	16	16	14	12
12	16	14	12	Not Recommended	

Extension Cord – Make sure your extension cord is in good condition. When using an extension cord, be sure to use one heavy enough to carry the current your product will draw. An undersized extension cord will cause a drop in line voltage resulting in loss of power and overheating. The table shows the correct size to use depending on cord length and nameplate ampere rating. If in doubt, use the next heavier gage. The smaller the gage number, the heavier the cord. To reduce the risk of disconnection of appliance cord from the extension cord during operating:

- Make a knot as shown in Figure on page 10, or
- Use one of the plug-receptacle retaining straps or connectors described in this manual.

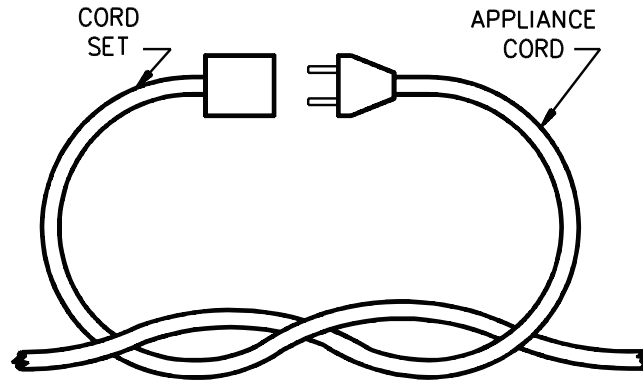
Method of securing extension cord

(A) THE CORD AS SHOWN

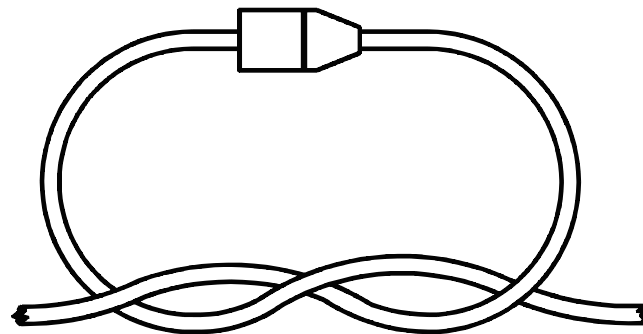

(B) CONNECT PLUG AND RECEPTACLE

! WARNING: Keep the extension cord clear of the working area. Position the cord so that it will not get caught on lumber, tools, or other obstructions while you are working with a power tool. Failure to do so can result in serious personal injury.

! WARNING: Check extension cords before each use. If damaged replace immediately. Never use the product with a damaged cord since touching the damaged area could cause electrical shock resulting in serious injury.

model no. 060-3808-8 | contact us: 1-866-523-5218

Exploded View

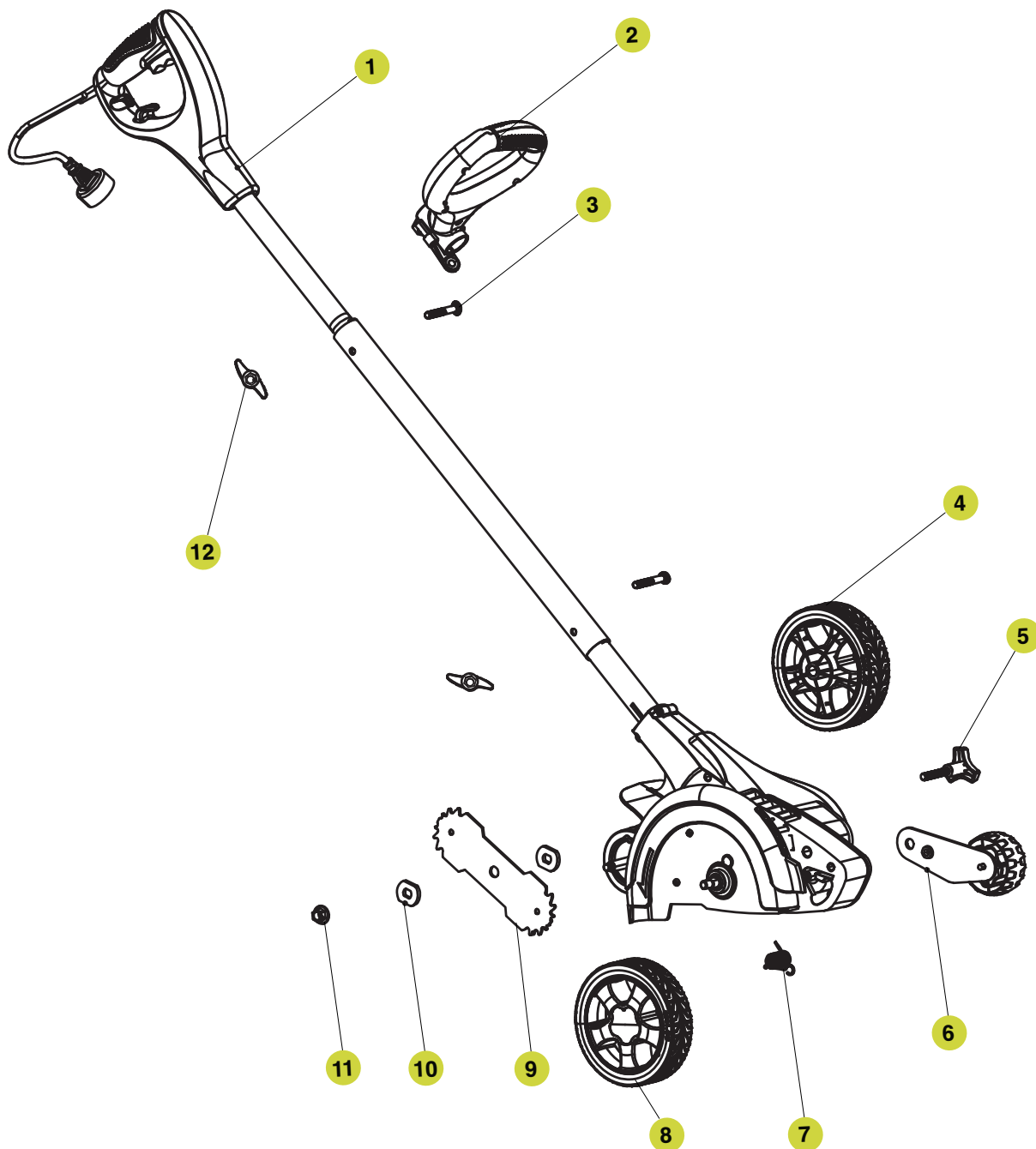

model no. 060-3808-8 | contact us: 1-866-523-5218

Parts List

Item	Description	Drawing	Qty
1	Bare tool assembly	31101270	1
2	Auxiliary handle assembly	31102270	1
3	Bolt	3220436	2
4	Left wheel assembly	31307270	1
5	Knob	34110263-2	1
6	Front wheel assembly	31103270	1
7	Spring	33401263-1	1
8	Right wheel assembly	31104270	1
9	7 1/2" Blade	33301261-1	1
10	Board	3330418A	2
11	Nut	3221037	1
12	Knob	34108283-2	2

model no. 060-3808-8 | contact us: 1-866-523-5218

CONNECTING THE POLE

Before using the edger, a one-time assembly is required. When removed from the box, the three poles are connected by an electrical cord as shown below.

1. Remove packaging material from cord and discard.
2. Slide upper handle tube down into middle handle tube so that the holes line up. There are two positions available for adjustment to your preferred height setting.
3. Ensure the power cable moves smoothly down into the middle handle tube while assembling.
4. Fasten the upper and middle handle tubes together with the knob (1, below) and curved head bolt (2). Note that when you first insert the bolt it may be necessary to wiggle it carefully to get it pass the jacketed wire inside the tube.
5. Repeat this process to attach the middle handle tube to the lower handle tube.
6. CAUTION: NEVER use a sharp object to move jacketed wires out of the way.

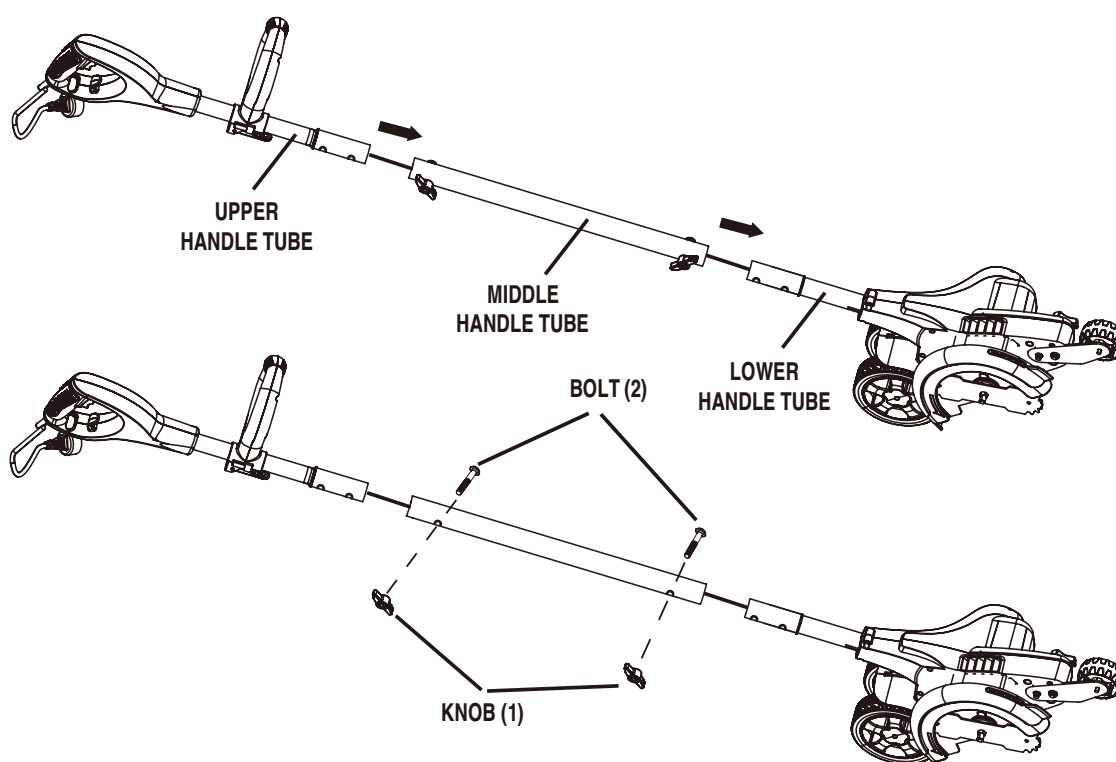

! WARNING: If any parts are damaged or missing, do not operate this product until the parts are replaced. Using a product with damaged or missing parts could result in serious personal injury

! WARNING: Failure to lock handle tubes as directed above could result in serious injury or death.

model no. 060-3808-8 | contact us: 1-866-523-5218

Assembly**ASSEMBLING THE FRONT WHEEL**

1. Screw off the adjusting knob from the hole (1).
2. Put the front wheel down.
3. Insert the adjusting knob into the hole (2) and tighten it.

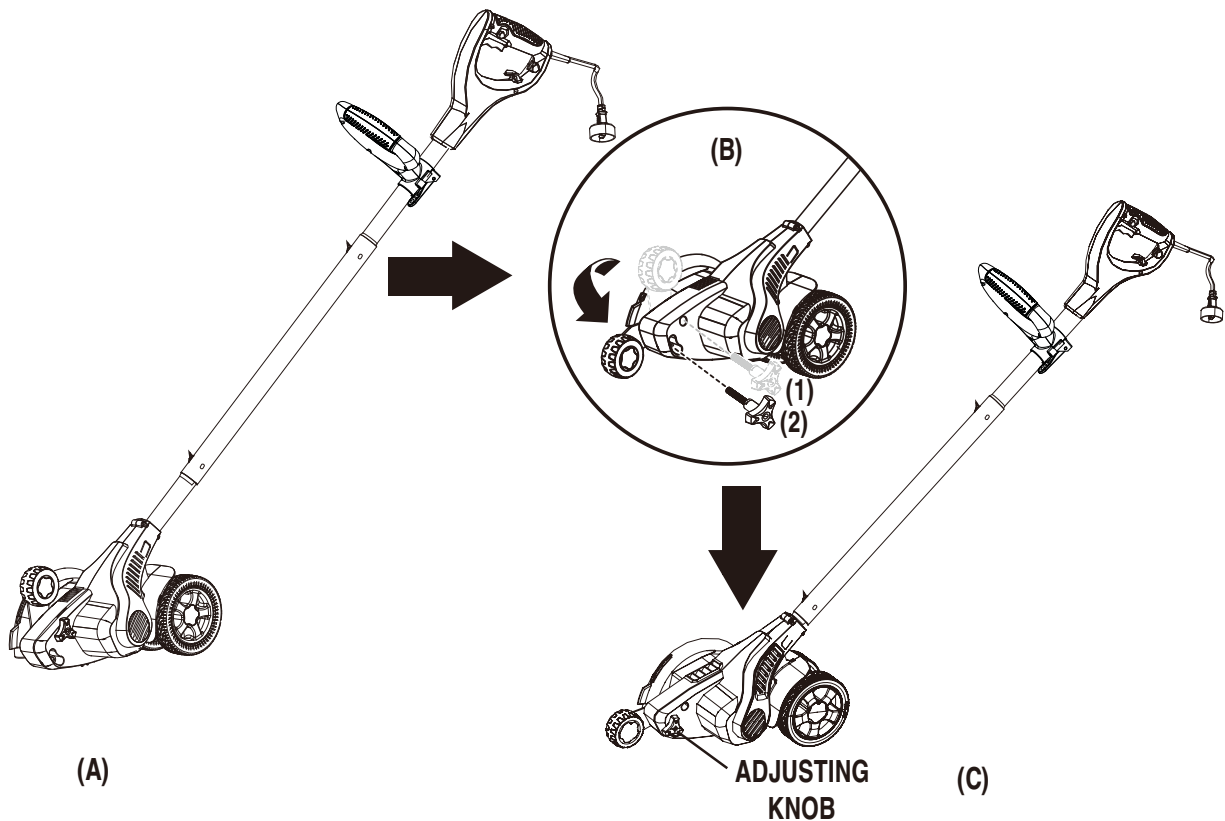

NOTE: Do not plug the extension cord into the outlet until it has been connected to the cord retainer and plugged into the mower.

model no. 060-3808-8 | contact us: 1-866-523-5218

APPLICATIONS

You may use this product for the purpose listed below:

1. Edging around walkways, driveways, curbs, and flower beds;
2. Trenching.

CONNECTING TO POWER SUPPLY

This product is designed with a cord retainer that prevents the extension cord from being pulled loose while using.

1. Form a loop with the end of the extension cord.
2. Insert loop portion of extension cord through opening in the bottom of the rear handle and place it over cord retainer
3. Slowly pull the loop against the cord retainer until the slack is removed.
4. Plug the product into an extension cord.

NOTE: Failure to remove all excess cord slack from extension cord retainer could result in the plug loosening from the receptacle.

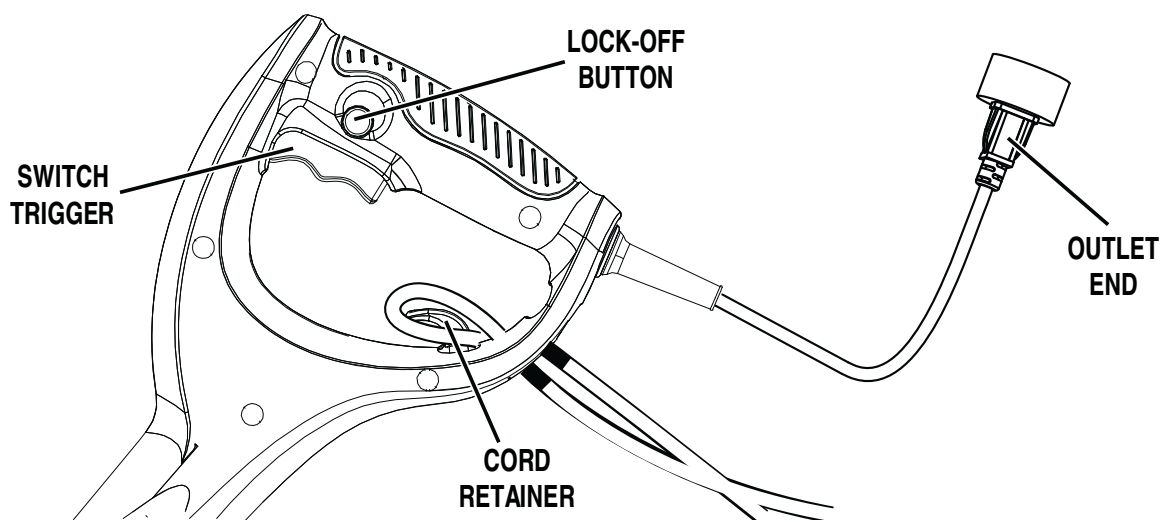

WARNING: Always wear safety goggles or safety glasses with side shields when operating power tools. Failure to do so could result in objects being thrown into your eyes, resulting in possible serious injury.



WARNING: Do not allow familiarity with this product to make you careless. Remember that a careless fraction of a second is sufficient to inflict serious injury.

model no. 060-3808-8 | contact us: 1-866-523-5218

Operation**STARTING AND STOPPING**

To start the motor:

1. Plug the edger into an AC power outlet.
2. Press and hold the lock-off button (1) and press the switch trigger (2). The motor of the edger will stay ON as long as the trigger switch (2) is held.

To stop the motor:

1. Release the switch trigger (2)
2. Allow at least 5 seconds for the blade to stop rotating.
3. The edger will be locked OFF until you press the lock-off button (1) again.

ADJUSTING THE AUXILIARY HANDLE

1. Pull the lock button (4) up to loosen.
2. Adjust the auxiliary handle (3) to the desired position.
3. Push the lock button (4) back down to secure.

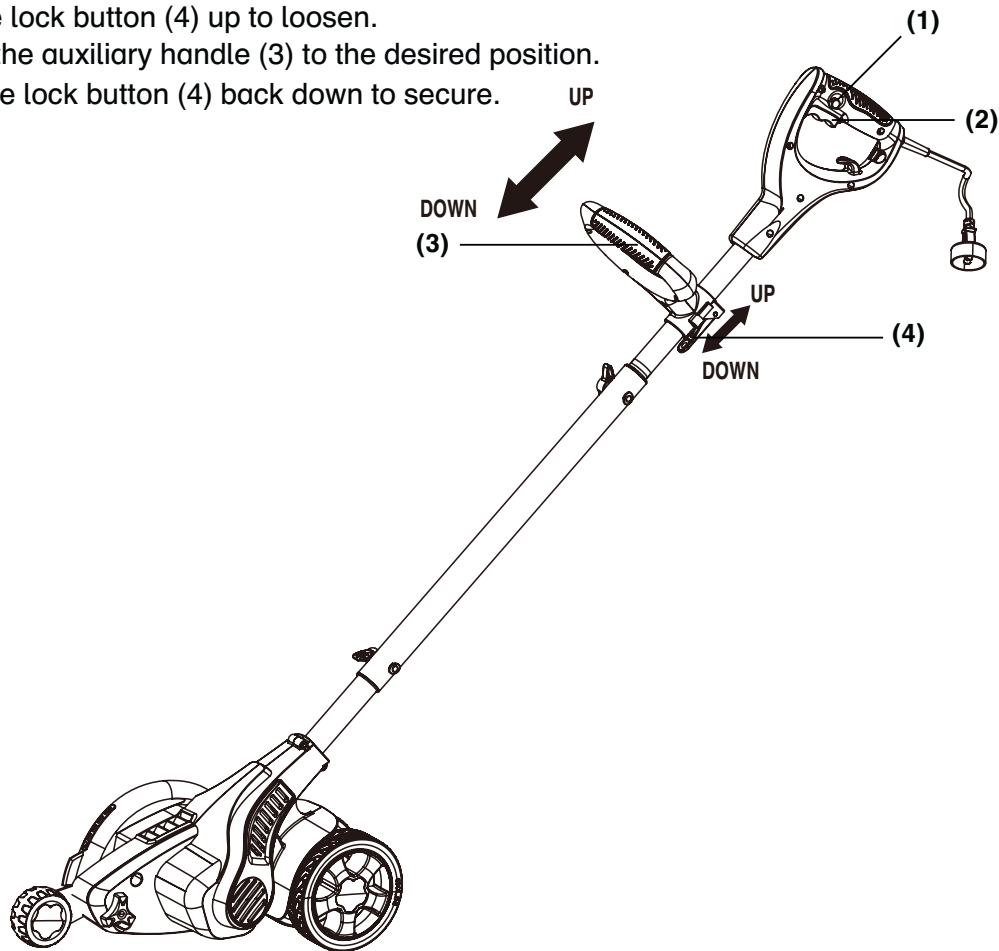

WARNING: Do not use any attachments or accessories not recommended by the manufacturer of this product. The use of attachments or accessories not recommended can result in serious personal injury.

model no. 060-3808-8 | contact us: 1-866-523-5218

ADJUSTING THE POLE HEIGHT

1. Disconnect the edger from the power supply. Allow sufficient time for the blade to stop rotating.
2. Rotate the knobs (1) counterclockwise to loosen them up. Remove the bolts (2).
3. Two positions are available on both the upper and the lower handle tubes. Adjust them to your preferred height setting.
4. Fasten the handle tubes back together with the knob and bolt to secure.

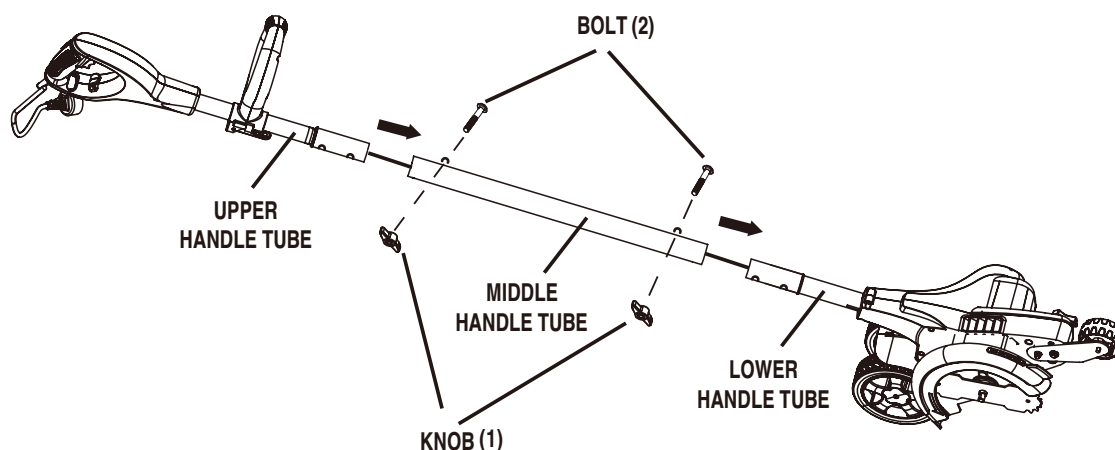

NOTE: When adjusting your hand placement on the shaft of the edger, always make sure you can keep proper balance. Do not attempt to use the edger at a length which does not allow you to maintain proper footing and balance at all times.



NOTE: Adjust the blade depth from 1/2" (1.3 cm) to 1" (2.5 cm) deep initially. Make a shallow cut to test the cutting depth. If the cutting depth needs adjusting, this should be done progressively until the desired depth is reached. To increase the blade life span, keep the initial cutting depth at a minimum and increase the depth setting only as the blade wears out.

ADJUSTING THE DEPTH OF THE CUT

The front wheel can be adjusted to allow a deeper or shallower cut, and to increase the life of the blade. Change the edging depth from the shipping position to your desired depth by:

1. Release the power switch. Wait for blade to come to a complete stop.
2. UNPLUG THE TOOL.
3. Loosen the adjusting knob and move the wheel up (to increase the depth) or down (to decrease the depth).
4. After the adjustment is complete, tighten the adjusting knob securely.

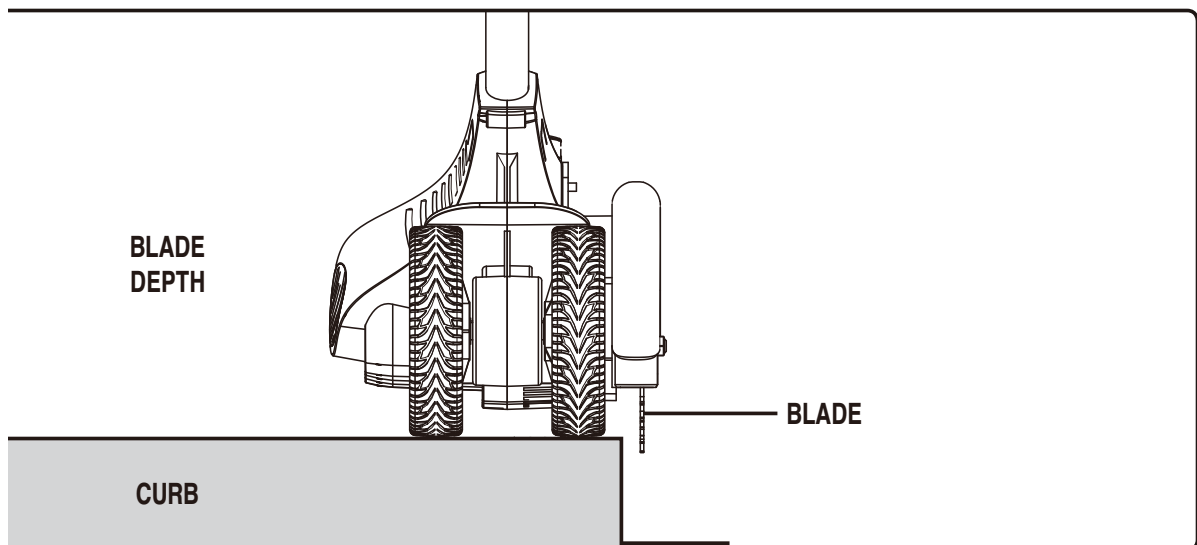
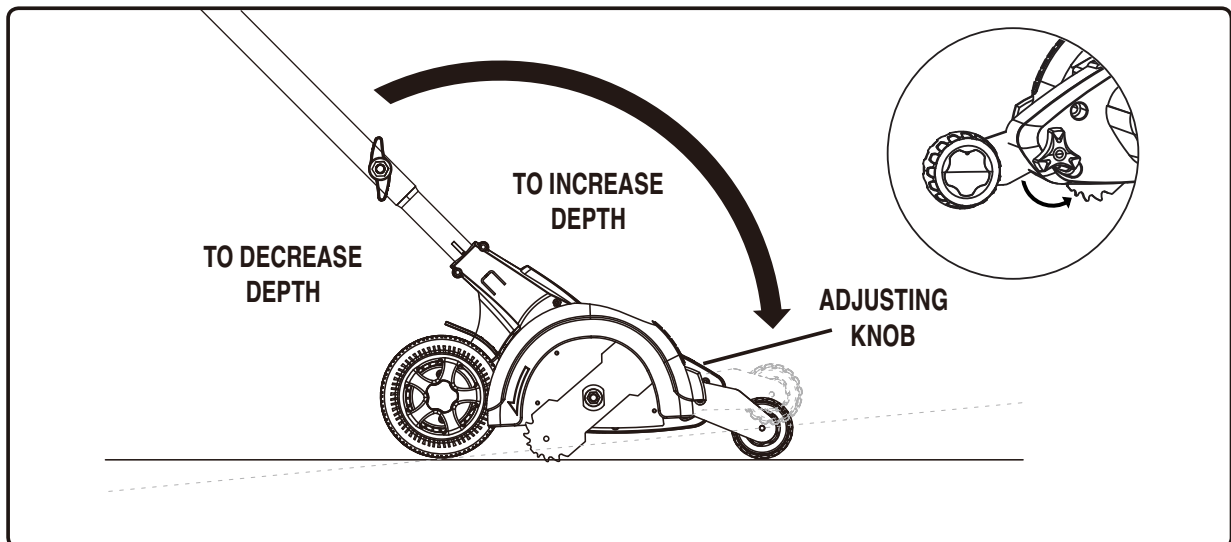

WARNING: Thick overgrowth may drag on the guard. Reduce the cut of the depth to a minimum to help reduce this effect.

OPERATING TIPS

- Set the initial cut depth at 1" (2.5 cm) .
- Before starting the edger, line up the tool so the edger guide lines up against the edge of the paved surface. Both rear wheels should be on the paved surface when edging.
- To avoid kickbacks, press the handle down so the blade is above the guard.
- Turn the switch ON and allow the blade to spin without moving the tool.
- Slowly lift the handle to lower the blade. Find the edge of the paved surface and start edging. Then, move the tool forward slowly along the edge of the paved surface, keeping the edge guide lined up against the pavement edge.

For the first edging of each season, it is best to move forward slowly because the grass is thickest. Subsequent edging will be completed more rapidly. If the tool slows down, back it up an inch or two (2.5 or 5 cm) until the blade comes up to normal speed. During edging, some sparks may be generated from hitting stones: this is normal. Do not attempt to edge when the grass or the soil is wet or moist for electrical safety and to prevent clogging of the blade chamber. If you must edge under conditions that cause the blade chamber to become clogged, release the trigger, wait for the blade to come to complete stop, UNPLUG THE TOOL, open the door and remove the clogged material with a stick. To continue to operate the tool in a clogged condition will seriously overload the motor.



WARNING: Make sure that other people and pets are at least 100' (30 m) away from the work area.



WARNING: Before landscaping or trenching, inspect and ensure there are no exposed or buried cables, pipes or other objects that may create a hazard or interfere with operating the edger. Set depth to only that required for the job. Do not overload. If the tool slows down, back up slightly and wait until the blade comes back up to its normal speed.



WARNING: Do not attempt to unclog the blade chamber by dropping or tapping the tool on the ground. This can damage the unit. Keep hands clear of the edge guide and blade when cleaning as these wear to a very sharp point during edging.



NOTE: The edger requires a lot of power and should not be operated simultaneously with other tools or utilities on the same household circuit.



NOTE: When there is Heavy overgrowth of grass over the paved surface may drag on the guard. An initial cut may be require to reduce the depth at cut.

model no. 060-3808-8 | contact us: 1-866-523-5218

Maintenance

GENERAL MAINTENANCE

Avoid using solvents when cleaning plastic parts. Most plastics are susceptible to damage from various types of commercial solvents and may be damaged by their use. Use clean cloths to remove dirt, dust, oil, grease, etc.

Stop the motor and unplug the edger whenever you are not using the tool. Unplug the edger and allow sufficient time for the blade to stop rotating before unclogging the blade guard or when making a repair, adjustment, inspection, etc.

Keep all nuts, bolts, and screws tight.

You can make the adjustments and repairs described here on a regular basis. For other repairs, have the product serviced by an authorized service dealer.



WARNING: When servicing, use only identical replacement parts. Use of any other parts may create a hazard or cause product damage.



WARNING: Always wear safety goggles or safety glasses with side shields during power tool operation or when blowing dust. If operation is dusty, also wear a dust mask.



WARNING: Before inspecting, cleaning or servicing the unit, stop the motor, wait for all moving parts to stop, and disconnect from the power supply. Failure to follow these instructions can result in serious personal injury or property damage.



WARNING: Do not, at any time, let brake fluids, gasoline, petroleum-based products, penetrating oils, etc., come in contact with plastic parts. Chemicals can damage, weaken, or destroy plastic, which may result in serious personal injury.



WARNING: Do not attempt to sharpen blade. Failure to heed this warning could result in serious personal injury or property damage.

model no. 060-3808-8 | contact us: 1-866-523-5218

REPLACING THE BLADE

Replace the blade that is damaged or worn. To increase blade life span, keep initial cutting depth at minimum and increase depth setting only as blade wears.

1. Stop the motor and allow sufficient time for the moving parts to stop and unplug the edger.
2. Using a 1" (26 mm) wrench, hold the inner flange washer.
3. Using a 1/2" (16 mm) socket wrench, turn the blade nut counterclockwise to loosen.
4. Remove the blade nut, the outer flange washer, the blade, and the inner flange washer.
5. Reinstall the inner flange washer onto the edger shaft.
6. Center the new blade on the inner flange washer, making sure the blade sits flat.
7. Install the outer flange washer onto the edger shaft.
8. Using a 1" (26 mm) wrench, hold the inner flange washer.
9. Install the blade nut onto the edger shaft.
10. Using a 1/2" 16 mm socket wrench, turn the blade nut clockwise and tighten securely. The recommended torque for the blade nut is 6.42-12.8 N*M.

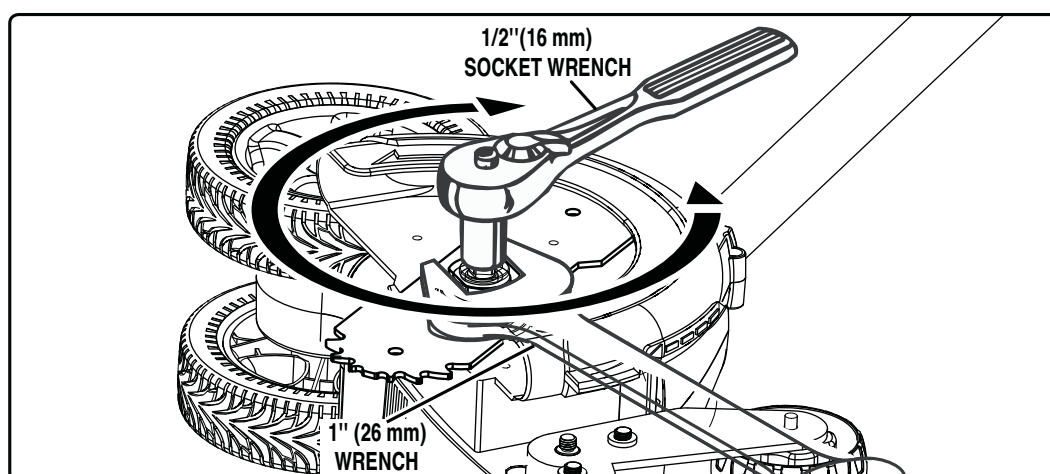
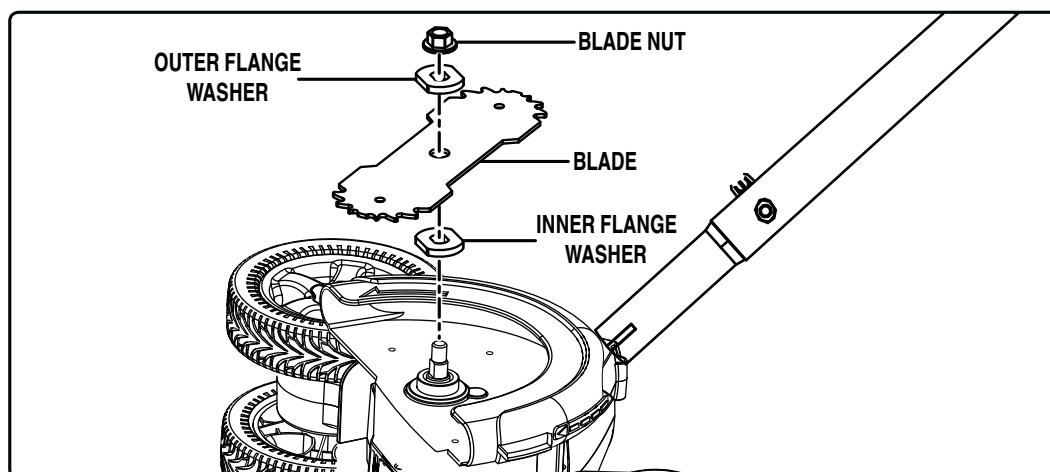

NOTE: Always make sure the blade is correctly installed and securely fastened before each use.

model no. 060-3808-8 | contact us: 1-866-523-5218

Maintenance

STORING THE EDGER

1. Be sure the tool is unplugged.
2. Remove and clean any debris from the outside of the edger and inside of the guard before storage. If necessary, the edger may be stored by hanging on a hook by the handle.
3. Clean all foreign material from the edger.
4. Store it in a place that is inaccessible to children.
5. Keep away from corrosive agents such as garden chemicals and de-icing salts.



WARNING: DO NOT HANG EDGER BY THE TRIGGER NOR THE POWER CORD.



NOTE: Do not store the tool near fertilizers or chemicals. Such storage can cause rapid corrosion.



model no. 060-3808-8 | contact us: 1-866-523-5218

PROBLEM	POSSIBLE CAUSE	SOLUTION
Motor fails to start when switch trigger is depressed.	1. Then power cord is not plugged in or the connection is loose.	1. Plug in the power cord.
	2. The household circuit breaker has tripped.	2. Check the circuit breaker.

Troubleshooting

2-YEAR LIMITED WARRANTY

For TWO YEARS from the date of purchase within Canada, Yardworks® CANADA will, at its option, repair or replace for the original purchaser, free or charge, any part or parts that are found to be defective in material or workmanship.

- 7-day over-the-counter replacement for initial defects for unused product; (RA# required for used product)
- 2-year repair warranty.

LIMITATIONS

This warranty does not cover the following:

1. Any part that has become inoperative due to misuse, commercial use, abuse, neglect, accident, improper maintenance, or alteration;
2. The unit, if it has not been operated and/or maintained in accordance with the Owner's Manual;
3. Normal wear;
4. Routine maintenance items such as lubricants, blades;
5. Normal deterioration of the exterior finish due to use or exposure.

HOW TO OBTAIN SERVICE

Warranty service is available by calling the toll -free helpline, at 1-866-523-5218. Yardworks® CANADA will not accept the return of a complete unit unless prior written permission has been extended by Yardworks® CANADA.

TRANSPORTATION CHARGES

Transportation charges for the movement of any power equipment unit or attachment are the responsibility of the purchaser. The purchaser must pay transportation charges for any part submitted for replacement under this warranty, unless such return is requested, in writing, by Yardworks® CANADA.

OTHER WARRANTIES

All other warranties, whether express or implied, including any implied warranty of merchantability, are limited in their duration to that set forth in this express limited warranty. The provisions as set forth in this warranty provide the sole and exclusive remedy of Yardworks® CANADA obligations arising from the sale of its products.

Made in China

Imported by

Yardworks Canada Toronto, Canada M4S 2B8

Yardworks CANADA will not be liable for incidental or consequential loss or damage.