



YARDWORKS^{TM/MC}

Cordless Telescopic Grass Trimmer & Edger

model number 060-2341-2 | contact us: 1.866.523.5218



Intertek

3025736

Conforms to UL STD 82

Certified to CAN/CSA STD.

C22.2 No.147-M90

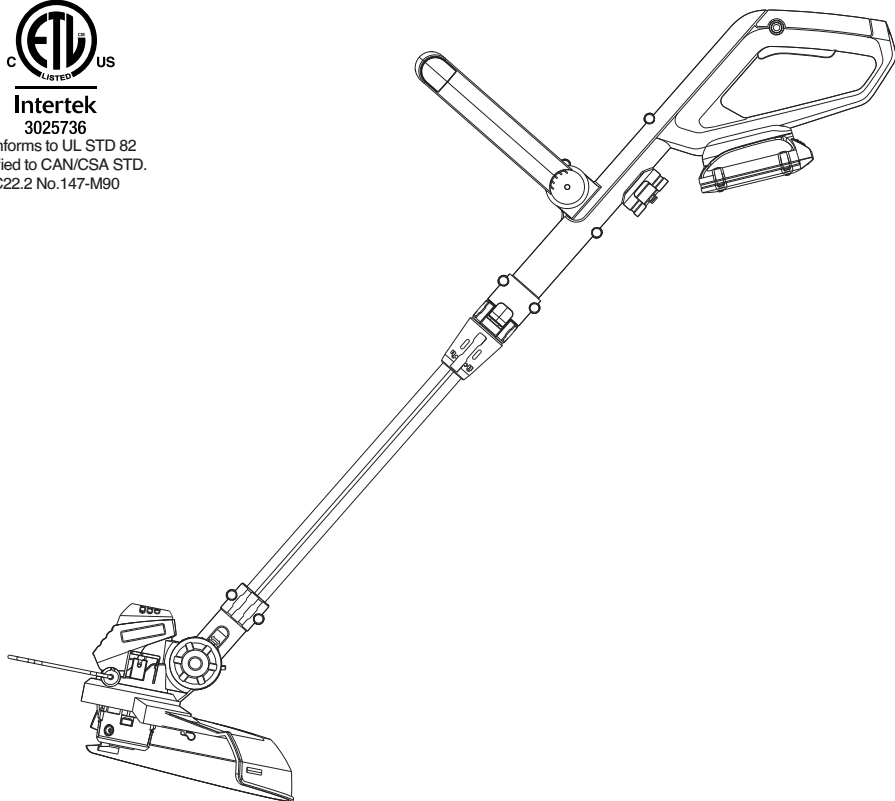

IMPORTANT:

Read and follow all safety rules and operating instructions before using this product.

**Instruction
Manual**

Technical Specifications	2
General Safety Rules	3
Know Your Grass Trimmer	6
Accessories	6
Exploded View	7
Part List	8
Assembly	9
Operation Instructions	10
Operation	14
Storing Your Grass Trimmer	17
Maintenance	19
Troubleshooting	20
Symbols	21
Warranty	22

TECHNICAL SPECIFICATIONS

Type	Cordless
Charger voltage	120 V ~ 60 Hz
Voltage	20 V max*
Battery capacity	2 Ah, lithium-ion
No load speed	8500 RPM
Cutting path	12" (30.5 cm)
Diameter of line	0.065" (1.65 mm)
Spool length	10' (3 m)
Charging time	5-7 hours
Weight	4 lb 11 oz (2.13 kg)
Charger Protection class	□/II

* Voltage measured without workload. Initial battery voltage reaches maximum of 20 V. Nominal voltage is 18 V.

FOR ALL APPLIANCES

- Avoid dangerous environments - do not use appliances in damp or wet locations.
- Don't use in rain.
- Keep children away - all people and pets should be kept at a distance from the work area.
- Dress properly - do not wear loose clothing or jewelry. They can be caught in moving parts. Wear protective clothing; use of work gloves, long pants, a long sleeved shirt and safety footwear is recommended when working outdoors. Wear protective hair covering to contain long hair.
- Use safety glasses - always use face or dust mask if the area in which you are working is dusty.
- Use right appliance - do not use appliance for any job except that for which it is intended.
- Do not force appliance - it will do the job better and with less likelihood of a risk of injury at the rate for which it was designed.
- Do not overreach - keep proper footing and balance at all times.
- Stay alert. Use common sense. Do not operate appliance when you are tired or under the influence of drugs, alcohol or medication.
- When not in use, appliances should be

stored indoors in dry places out of reach of children.

- Maintain appliance with care. Follow instructions for lubricating and changing accessories. Keep handles dry, clean, and free from oil and grease.
- Check damaged parts. Before using the appliance, make sure the safety guards are intact. Never use a tool without its safety guard. Check the alignment of the moving parts, the binding of the moving parts. Check for broken or defective parts that can affect the safe operation of your tool. A guard or other part that is damaged should be properly repaired or replaced by an authorized service centre unless indicated elsewhere in this manual.

1. FOR ALL BATTERY-OPERATED GARDENING APPLIANCES:

- Do not charge appliance in rain, or in wet locations.
- Do not use battery-operated appliances in the rain.

Always remove or disconnect battery pack before adjusting, cleaning, servicing or transporting the lawn trimmer.

2. FOR ALL BATTERY-OPERATED PRODUCTS EMPLOYING A DETACHABLE OR SEPARABLE BATTERY:

- Use only the following type and size battery: 060-2346-2



WARNING: When using cordless gardening appliances, basic safety precautions must always be followed to reduce the risk of fires, electric shocks, and personal injuries.



WARNING: Read all instructions.



WARNING: This product may contain lead, phthalates or other chemicals known to the State of California to cause cancer, birth defects and other reproductive harm. Please wash your hands after use.

- Do not dispose of the battery in a fire. The cell may explode. Check with local codes for possible special disposal instructions.
- Do not open or mutilate the battery. Released electrolyte is corrosive and may cause damage to the eyes or skin. It may be toxic if swallowed.
- Exercise care in handling the battery in order not to short it with conducting materials such as rings, bracelets, and keys. The battery or conductor may overheat and cause burns.

3. AVOID UNINTENTIONAL STARTING – DO NOT INSERT BATTERY WHILE YOUR FINGER IS ON THE SWITCH. BE SURE SWITCH IS OFF WHEN INSERTING THE BATTERY.

ADDITIONAL SAFETY RULES FOR GRASS AND EDGE TRIMMERS

- Keep guards in place and in good working order.
- Keep hands and feet away from cutting area.
- Do not use heavier lines than those recommended in this manual.
- Do not use line materials of other types – for example, metal wire, rope, and the like.

GENERAL SAFETY WARNINGS FOR THE BATTERY PACK

- **WARNING: Risk of fires and burns. Do not disassemble, heat above 100°C (212°F), nor incinerate. Do not expose cells or batteries to heat or fire. Avoid storage in direct sunlight. Do not leave in vehicles in the summer, or anywhere that can reach a temperature reaching 100°C (212°F).**
- **Dispose of used battery promptly and properly. When disposing of secondary cells or batteries, keep cells or batteries of different electrochemical systems separate from each other.**
- **Keep battery out of reach of children and in original package until ready to use.**

- **Never put batteries in one's mouth. If swallowed, contact local poison control centre immediately.**
- **CAUTION – The battery used in this device may present a risk of fire or chemical burn if mishandled. Replace battery with Yardworks brand only. Use of another battery may present a risk of fire or explosion.**
- **WARNING: Do not use a visibly damaged battery pack or appliance.**
- **WARNING: Do not modify or attempt to repair the appliance or the battery pack.**
- **BATTERIES MUST BE RECYCLED.**
- **Do not short-circuit a cell or battery. Do not store cells or batteries haphazardly in a box or drawer where they may short-circuit each other or be short-circuited by conductive materials.**
- **Do not subject cells or batteries to mechanical shocks.**
- **Keep cells and batteries clean and dry. Wipe the cell or battery terminals with a clean dry cloth if they become dirty.**
- **Do not maintain secondary cells and batteries on charge when not in use.**
- **Retain the original cell and battery literature for future reference.**
- **Do not use any charger other than that specifically provided for use with the equipment. Secondary cells and batteries need to be charged before use. Always use the correct charger and refer to the manufacturer's instructions or equipment manual for proper charging instructions.**
- **When possible, remove the battery from the equipment when not in use.**
- **Prevent unintentional starting. Ensure the switch is in the off-position before connecting to the battery pack, picking up or carrying the appliance. Carrying the appliance with your finger on the switch or energizing appliances that have the switch on invites accidents.**



WARNING: Read all safety warnings and instructions. Failure to follow the warnings and instructions may result in electric shock, fire and/or serious injury.



model no. 060-2341-2 | contact us: 1.866.523.5218

- Disconnect the battery pack from the appliance before making any adjustments, changing accessories, or storing appliance. Such preventive safety measures reduce the risk of starting the appliance accidentally.
- Under abusive conditions, liquid may be ejected from the battery; avoid contact. If contact accidentally occurs, flush with water. If liquid contacts eyes, additionally seek medical help. Liquid ejected from the battery may cause irritation or burns.
- Have servicing performed by a qualified repair person using only identical replacement parts. This will ensure that the safety of the product is maintained.

IMPORTANT SAFETY INSTRUCTIONS FOR CHARGER

WARNING: This product may contain lead, phthalate or other chemicals known to the State of California to cause cancer, birth defects and other reproductive harm. Please wash your hands after use.

INFORMATION FOR RADIATED EMISSION

This device complies with Canadian ICES-001.
Cet appareil ISM est conforme à la norme NMB-001 du Canada.

This device complies with Part 15 of the FCC Rules.

Operation is subject to the following two conditions:

- (1) this device may not cause harmful interference, and
- (2) this device must accept any interference received, including interference that may cause undesired operation.

WARNING: Changes or modifications on this unit not expressly approved by the party, responsible for compliance could void the user's authority to operate the equipment.

- NOTE: This equipment has been tested and found to comply with the limits for a Class B digital device, pursuant to Part 15 of the FCC Rules.

These limits are designed to provide reasonable protection against harmful interference in a residential installation. This equipment generates, uses and can radiate radio frequency energy. If not installed and used in accordance with the instructions, it may cause harmful interference to radio communications.

However, there is no guarantee that interference will not occur in a particular installation. If this equipment does cause harmful interference to radio or television reception, which can be determined by turning the equipment off and on, the user is encouraged to try to correct the interference by one or more of the following measures:

- Reorient or relocate the receiving antenna.
- Increase the separation between the equipment and receiver.
- Connect the equipment into an outlet on a circuit different from that to which the receiver is connected.
- Consult the dealer or an experienced radio/TV technician for help.

SAVE THESE INSTRUCTIONS!

model no. 060-2341-2 | contact us: 1.866.523.5218

1. Lock off button
2. On/off switch
3. Auxiliary handle
4. Height adjustment locking mechanism
5. Safety guard
6. Flower guard
7. Spool and line
8. Flattening head adjustment button
9. Handle rotation locking mechanism
10. Spare spool holder
11. Battery pack

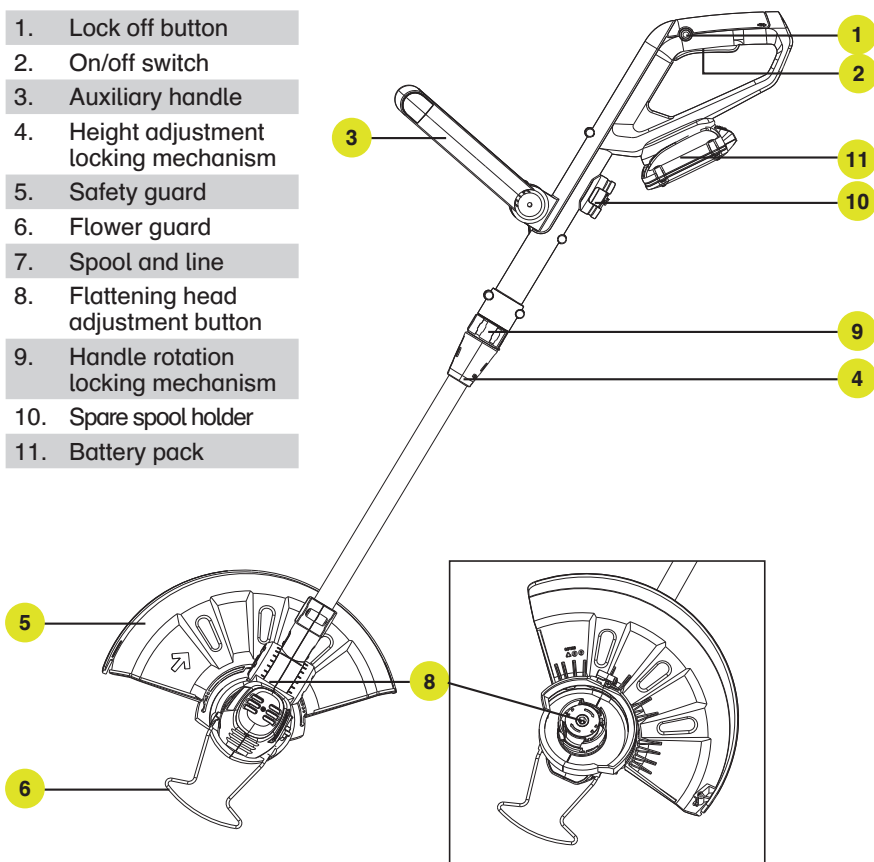

Charger	1 (ACG318GU1)
Auxiliary Handle	1
Safety Guard	1
Battery Pack	1 (060-2346-2)

We recommend that you purchase your accessories from the same store that sold you the tool. Refer to the accessory packaging for further details. Store personnel can assist you and offer advice.

model no. 060-2341-2 | contact us: 1.866.523.5218

Exploded View

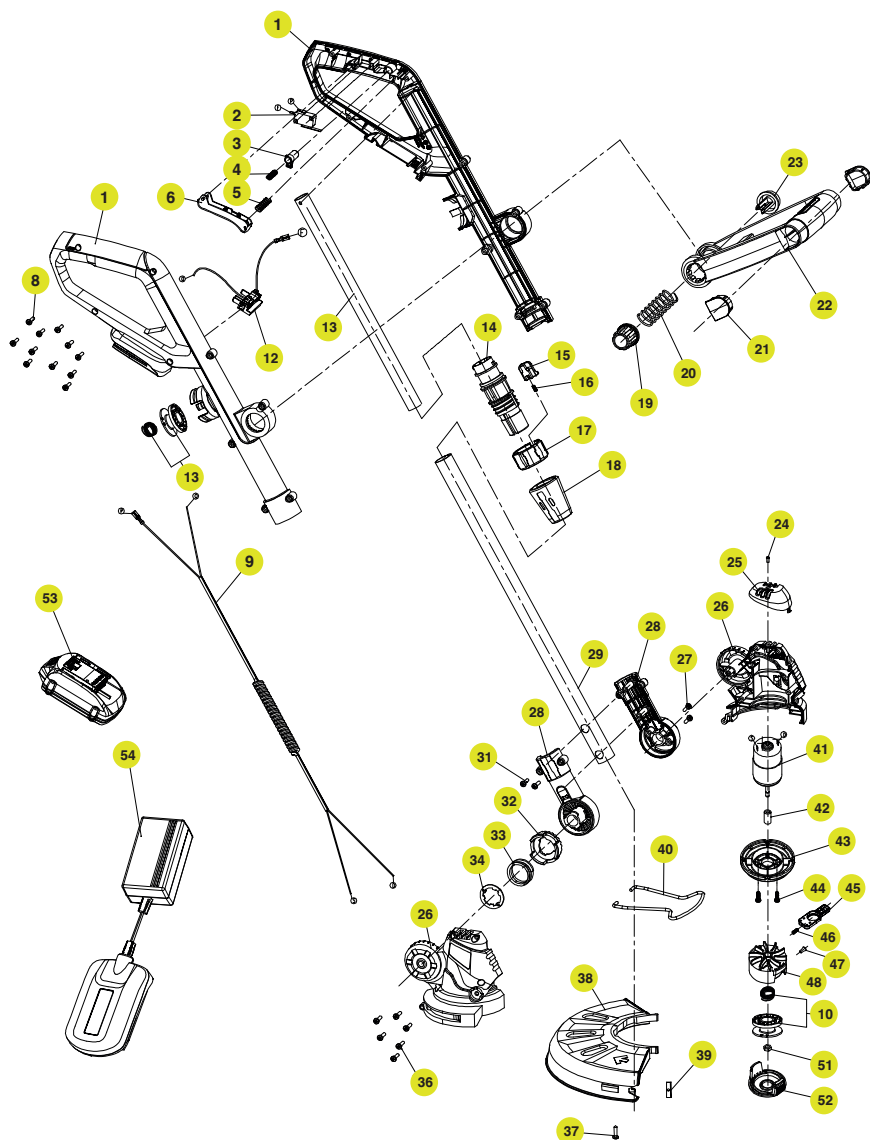

Item	Description	QTY
1	Left/Right Handle	1
2	Switch	1
3	Switch Button	1
4	Compression Spring I	1
5	Compression Spring II	1
6	Trigger	1
8	Self Tapping Screw	9
9	Coiled Cable	1
10	Spool & Line	1
12	Electrode	1
13	PVC tube	1
14	Thread Sleeve	1
15	Retract lock	1
16	Compression Spring	1
17	Rotate Collar	1
18	Retract Nut	1
19	Auxiliary Handle Button	1
20	Compression Spring	1
21	Auxiliary Handle Cover	2
22	Auxiliary Handle	1
23	Vice-Hand Fixed Rack	1
24	Self Tapping Screw	1
25	Housing Husk	1
26	Left/Right Housing	1
27	Self Tapping Screw	2

Item	Description	QTY
28	Left/Right Swivel Shell	1
29	Aluminium Tube	1
31	Self Tapping Screw	2
32	Slide Gear	1
33	Compression Spring	1
34	Cover	1
36	Self Tapping Screw	6
37	Self Tapping Screw	1
38	Guard	1
39	Cutting Blade	1
40	Flower guard wire	1
41	Motor	1
42	Adapter Sleeve	1
43	Fixing Block	1
44	Screw washer assembly	2
45	Line feeder	1
46	Compression Spring	1
47	Rivet	2
48	Cutting Head	1
51	Nut	1
52	Cutting Head Cover	1
53	Battery Pack (060-2346-2)	1
54	5-7 hour Charger (ACG318GU1)	1

1. ASSEMBLY OF THE SAFETY GUARD (SEE FIG. A1, A2, A3)

Remove the screw (a) from the guard (SEE FIG. A1). Attach the safety guard to the trimmer head. Align the guard so it slides into the slots located on the trimmer head (SEE FIG. A2). Secure the safety guard onto the trimmer head with the screw (a) (See FIG. A3).

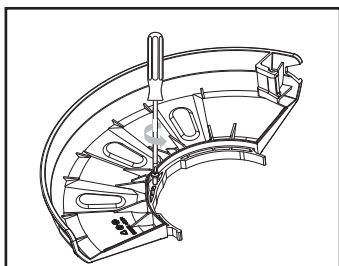

A1

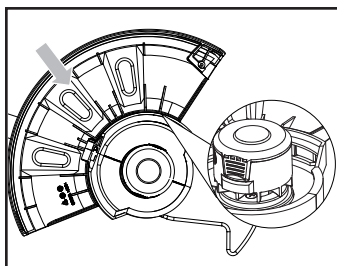

A2

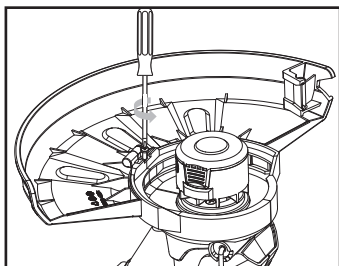

A3

1. BEFORE USING YOUR CORDLESS GRASS TRIMMER

The battery pack included is shipped UNCHARGED. You must charge before first use. The battery charger supplied was designed to only charge the Li-on battery also supplied. Do not use another battery charger.

2. CHARGING YOUR BATTERY PACK (SEE FIG. B)

The Li-on battery is protected against deep discharging. When the battery is empty, the machine will switch off by means of a protective circuit: The trimmer head will no longer rotate.

To charge your battery pack, connect the battery charger to the power supply and the light will be green. Slide the battery pack into the charger to make the connections. The light will turn red to show charging has started. A discharged battery at normal ambient temperature will take approximately 5-7 hours to reach full charge. When charging is completed the light will turn green.

In a warm environment or after heavy use, the battery pack may become too hot to permit charging. Allow time for the battery to cool down before recharging.

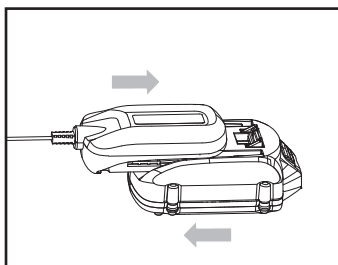

B

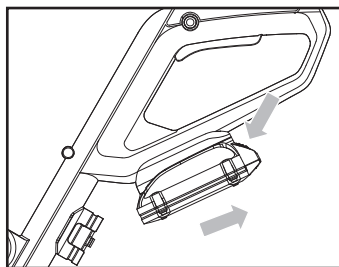

C1

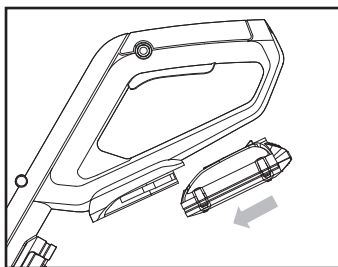

C2

3. TO REMOVE OR INSTALL BATTERY PACK (SEE FIG. C1, C2)

Depress the battery release button to release battery pack from your trimmer. After recharging, insert the battery pack into trimmer's battery port. A simple push and slight pressure will be sufficient until a click is heard.

Note: When removing the battery pack, hold it firmly to avoid potential accidents.



WARNING: The charger and battery pack are specially designed to work together so do not attempt to use any other devices. Never insert or allow metallic objects into your charger or battery pack connections because an electrical failure and hazard will occur.

4. SAFETY ON/OFF SWITCH (SEE FIG. D)

The on/off switch is locked off to prevent accidental starting. Depress the lock off button (a) then depress the on/off switch (b) and release lock off button. Your trimmer is now on. To switch off, just release the on/off switch.

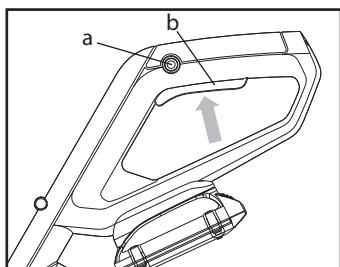

D

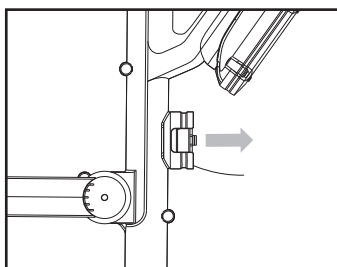

E

5. INSTALLING OR REMOVING THE SPARE SPOOL (SEE FIG. E)

To remove the Spare spool, just pull it out from the Spool holder mechanism. To install, just push it to the Spool holder mechanism with force, and a click will be heard.

6. ADJUSTING AUXILIARY HANDLE (SEE FIG. F)

Press the Auxiliary handle locking knob (a).

Rotate the auxiliary handle to the most comfortable and balanced position.

Then release the Auxiliary handle locking knob (a). Shake the Auxiliary handle to make sure it is fixed firmly.

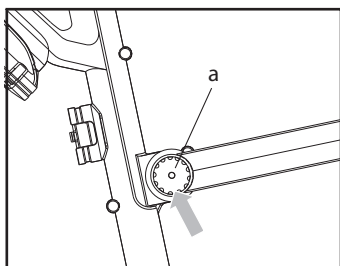

F



WARNING! The cutting head continues to rotate after the trimmer has been switched off; wait until it has completely stopped then lay down the tool.

6. ADJUSTING THE HEIGHT (SEE FIG. G)

Rotate the Height adjustment locking mechanism to loose it. Adjust the length of the Aluminum tube to be more comfortable for you, then rotate the Height adjustment locking mechanism to the opposite direction to ensure it is fixed firmly.

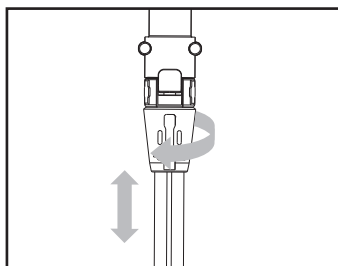

G

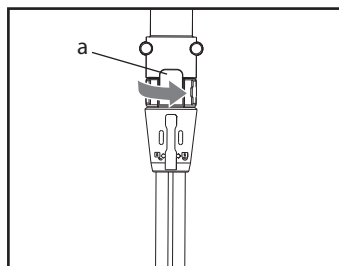

H

7. ADJUSTING THE DIRECTION OF TRIMMING & EDGING (SEE FIG. H)

Unscrew the Handle rotation locking mechanism, (a) in the direction of unlocking, and turn it in a counterclockwise direction.

Tighten the Handle rotation locking mechanism (a) in the direction of locking, and turn it in a clockwise direction.

8. ADJUSTING THE CUTTING ANGLE (SEE FIG. I1,I2)

To adjust the Main handle angle, downwards or convert the tool from trimming mode to edging mode, put one foot on the motor housing portion of the trimmer head, then grip the main handle and apply adequate force on the Main handle pushing it downwards.

Adjust the Main handle angle upwards, put one foot on the safety guard area of the trimmer head, then grip the main handle, apply adequate force to adjust.

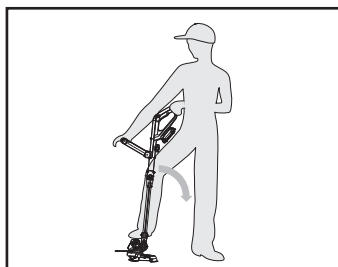

I1



I2

ADJUSTING FLOWER GUARD (SEE FIG. J)

Lift the flower guard up when edging and put it down before trimming, as shown in Figure I. Before trimming or edging make sure the flower guard is locked firmly in position.

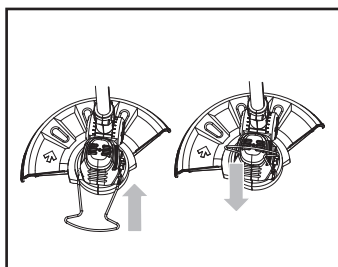

J

1. TRIMMING

- Do not cut wet grass because it tends to stick to the trimmer head and guard, prevents proper discharge of grass clippings, and could cause you to slip and fall.
- Regularly remove clippings and dirt around the trimmer head with a switched off trimmer.
- Work rhythmically, stand firmly with your feet apart. Cut from right to left so the trimmings will be thrown away from the work area.
- Do not move the trimmer too fast as this will result in ineffective cutting and possible damage.
- Cut repeatedly from up and down in layers when the grass is very high. Keep the trimmer head at an angle of about 30° to the ground when trimming. Avoid pressing it against the ground as this can ruin the lawn and damage the trimmer head.
- If you find that the nylon line is too short follow the instructions in the “Automatic line feed system” or “To manually feed the line” section.

NOTE: Let the cutting device do the work. Let it work at its own pace, never press it into the area to be cut.



WARNING: Always wear eye protection. Never lean over the trimmer head. Rocks or debris can ricochet or be thrown into your eyes and face, causing blindness or other serious injury.

Wear eye protection and heavy clothing. Hold front handle with one hand and auxiliary handle with the other hand. Keep unit below waist level. Work only from your right to left to ensure debris is thrown away from you. Without bending over, keep line near and parallel to the ground (perpendicular when edging) and not crowded into the material being cut.



WARNING: Make sure that the line is fed out before operation. Make sure the motor is up to full speed before trimming.



WARNING: Use only 0.065" (1.65 mm) diameter cutting line. Other sizes of line will not feed properly and will result in improper cutting head function or can cause serious injury. Do not use other material such as wire, string, rope, etc. Wire can break off during cutting and become a dangerous projectile that can cause serious injury.

2. EDGING(SEE FIG. K1-K3)

Change the tool from trimming to edging mode by adjusting the cutting angle to be in the lowest horizontal setting as shown in Fig K1. Then push the Handle rotation locking mechanism downward and rotate the main handle 90° clockwise (Fig K3).

The guard has two white line guides to indicate the cutting line position. Align the two white lines with the edge of your lawn.

Keep the safety guard away from the ground to protect the grass trimmer .

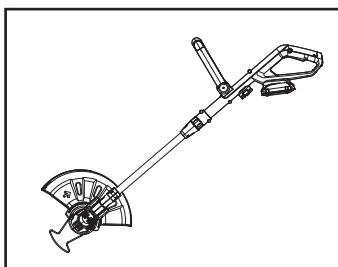

K1

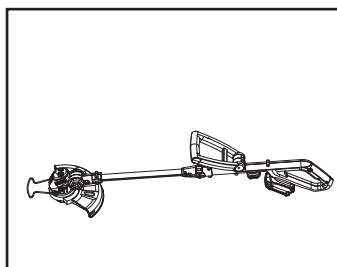

K2

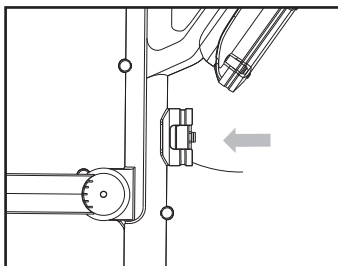

K3

3. AUTOMATIC LINE FEED SYSTEM

When initially switching on the trimmer, a small length of line is fed out. A ‘clattering’ noise will be heard when the lines hit the line cutter. **DO NOT BE ALARMED** this is quite normal. After about 5 seconds the line will be cut to the correct length and the noise will reduce as the motor receives full speed.

If the noise of the line being cut can't be heard, more line will be fed out. To feed more line, it is first necessary to allow the trimmer to stop completely, and then restart, allowing the motor to reach full speed.

Repeat above until you hear the lines hitting against the line cutter. (Do not repeat this procedure more than 6 times)

4. TO MANUALLY FEED THE LINE (SEE FIG. L)

If required, line can be fed out manually. Before manually feeding, remove the battery first. To operate, press and release manual line feed button (a), while gently pulling out the lines until the lines reach the line cutter. If the line extends past the line cutter, too much line has been fed out. If too much line is fed out, remove the spool cap and turn spool counter-clockwise until the line is at the desired length.

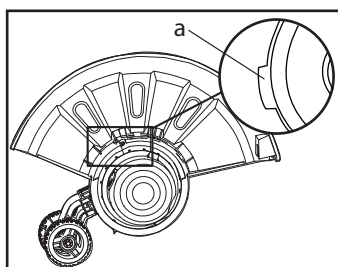

L

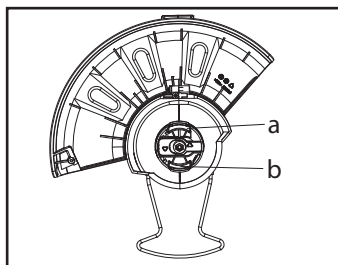

M1

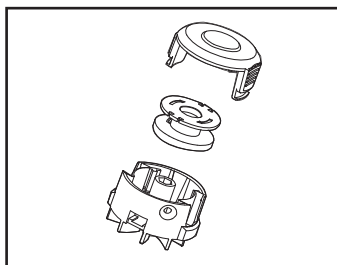

M2

5. TO REMOVE THE CAP (SEE FIG. M1,M2)

Press and hold in the two latches (a, b). (See Fig. M1) Pull cap away from the spool holder (See Fig. M2) when refitting the spool cap. Keep all areas of the cap and spool holder clean. Replace the cap, pressing firmly down towards the spool holder to ensure cap is fully located. Check that the cap is correctly fitted by trying to remove it without depressing the two latches.

6. TO REPLACE CUT LINE

For your convenience it is recommended you buy spool and line complete.

7. TO FIT SPOOL AND LINE COMPLETE (SEE FIG. N)

Remove old spool.

Place new spool into cap with cut out areas of the spool in line with eyelets.

Release line from cleat and feed line through eyelet.

Refit the cap.

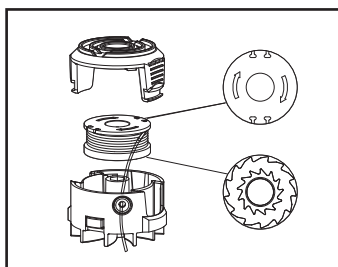

N

8. TO FIT NYLON LINE ONLY:**Wind spool with new line (SEE FIG. O1,O2, O3)**

IMPORTANT! Your trimmer is designed to use only line with a maximum diameter of 1.65 mm.

1. Remove the empty spool from the tool as described in "TO REPLACE CUTTING LINE" above.
2. Remove any remaining cutting line from the spool.
3. **IMPORTANT** - Always wind the line onto the upper section of the spool first. Take approximately 3 m of line. Insert 15 mm of line into one of the holes in the upper section of the spool and wind line in the direction of the arrows on the top of the spool.

Leave approximately 100 mm of line unwound and place into cleat. Repeat on lower section of spool. Care should be taken to ensure that the line is neatly coiled on the spool. Failure to do so will impair the efficiency of the automatic line feed. Then fit spool as described in "To fit spool and line complete"

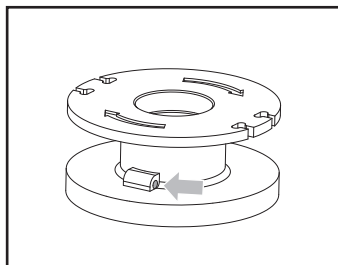

O1

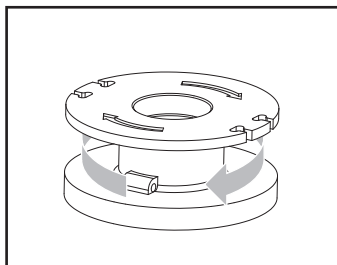

O2

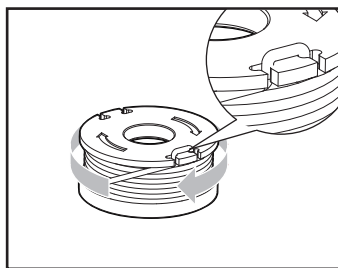

O3



WARNING: Take approximately 3 m of line, insert 1.65 mm of line into the spool holes and wind line in the direction of the arrows on the top of the spool.



IMPORTANT: Leave approximately 100 mm of line unwound and place into cleat. Care should be taken to ensure that the line is neatly coiled on the spool. Failure to do so will impair the efficiency of the automatic line feed. Then fit spool as described in "To fit spool and line complete".



model no. 060-2341-2 | contact us: 1.866.523.5218

Always remove the battery pack from your trimmer after use.

Store in a dry place where the trimmer and battery can be protected from damage.

Remove the battery before carrying out any adjustment, servicing or maintenance.

Your power tool requires no additional lubrication or maintenance. There are no user serviceable parts in your power tool. Never use water or chemical cleaners to clean your power tool. Wipe clean with a dry cloth. Always store your power tool in a dry place. Keep the motor ventilation slots clean.

Keep all working controls free of dust. Occasionally you may see sparks through the ventilation slots. This is normal and will not damage your power tool.

If the supplied charger cord is damaged, it must be replaced by the manufacturer, its service agent or similarly qualified persons in order to avoid a hazard.







The following chart lists problem symptoms, possible causes and corrective action, if your electric grass trimmer does not operate properly. If these do not identify and correct the problem, contact your helpline.

Problems	Possible Causes	Corrective Actions
Trimmer fails to operate.	Battery discharged. Battery too hot/cold. Motor is broken. Internal wiring of machine damaged.	Recharge battery; also see the content in charger manual. Allow to cool/warm. Contact Service Agent. Contact Service Agent.
Trimmer runs intermittently.	Motor is broken. Battery not fully charged. On/Off switch defective.	Contact Service Agent. Recharge battery. Contact Service Agent.
Excessive vibrations/noise.	Machine defective. Line spool is not wound well.	Contact Service Agent. Rewind the line. See "To fit spool and line assembly."
Cutting time per battery charge too low.	Battery has not been used for long period or only charged for short term. Grass too high. Battery defective.	Fully charge battery; also see the content in charger manual. Cut in stages. Replace the battery.
Machine does not cut.	Line broken. Battery not fully charged. Motor is broken (speed is too low). Grass entangled around cutting head.	Replace the line. Recharge battery; also see the content in charger manual. Contact Service Agent. Remove grass.
Continuous lighting of the battery charge indicator. No charging procedure possible.	Battery not (properly) inserted. Battery contacts contaminated. Battery defective.	Properly insert battery into battery charger. Clean the battery contacts (e.g. by inserting and removing the battery several times) or replace the battery. Replace the battery.



WARNING! Always switch the product off, disconnect it from power supply and let the product cool down before performing inspection, maintenance and cleaning!

Some of the following symbols may be used on this product. Please study them and learn their meaning. Proper interpretation of these symbols will allow you to operate the product effectively and safely.

Symbol	Name	Designation/Explanation
V	Volts	Voltage
A	Amperes	Current
Hz	Hertz	Frequency (cycles per second)
W	Watts	Power
min	Minutes	Time
	Alternating Current	Type of current
	Direct Current	Type of current
	Class II Construction	Double-insulated construction
/min	Per Minute	Revolutions, strokes, surface speed, orbits etc., per minute
	Read The Operator's Manual	To reduce the risk of injury, user must read instruction manual
	Ear Protection	Wear ear protection
	Operation condition	Do not expose to rain.
	Li-ion Battery	Lithium-ion. Separate collection: battery must be recycled

SAVE THESE INSTRUCTIONS!

TWO-YEAR LIMITED WARRANTY

For Two (2) Years from the date of purchase within Canada, YARDWORKS CANADA will, at its option, repair or replace for the original purchaser, free of charge, any part or parts found to be defective in material or workmanship.

THIS WARRANTY DOES NOT COVER

1. Any part that has become inoperative due to misuse, commercial use, abuse, neglect, accident, improper maintenance, or alteration; or
2. The unit, if it has not been operated and/or maintained in accordance with the owner's manual; or
3. Normal wear, except as noted below;
4. Routine maintenance items such as lubricants, blade sharpening;
5. Normal deterioration of the exterior finish due to use or exposure.

FULL ONE HUNDRED TWENTY (120) DAYS WARRANTY ON NORMAL WEAR PARTS

Normal wear parts are defined as blade adaptors, blades, grass bags and tires. These parts are warranted to the original purchaser to be free from defects in material and workmanship for a period of one hundred twenty (120) days from the date of retail purchase.

HOW TO OBTAIN SERVICE

Warranty service is available by calling the toll-free helpline, at 1-866-523-5218. The factory will not accept the return of a complete unit unless prior written permission has been extended by YARDWORKS CANADA.

TRANSPORTATION CHARGES

Transportation charges for the movement of any power equipment unit or attachment are the responsibility of the purchaser. The purchaser must pay transportation charges for any part submitted for replacement under this warranty unless such return is requested in writing by YARDWORKS CANADA.

OTHER WARRANTIES

All other warranties, express or implied, including any implied warranty of merchantability is limited in its duration to that set forth in this express limited warranty.

The provisions as set forth in this warranty provide the sole and exclusive remedy of YARDWORKS CANADA obligations arising from the sale of its products.



Always remove or disconnect the battery pack before adjusting, cleaning, servicing or transporting the grass trimmer.

