

## TABLE OF CONTENTS

TECHNICAL SPECIFICATIONS	4
SAFETY GUIDELINES	5
KEY PARTS DIAGRAM	10
TECHNICAL INFORMATION	11
TYPES OF NAILS	14
OPERATING INSTRUCTIONS	15
MAINTENANCE	20
TROUBLESHOOTING	21
EXPLODED VIEW	23
PARTS LIST	24
WARRANTY	25

**NOTE:** If any parts are missing or damaged, or if you have any questions, please call our toll-free helpline at 1-888-670-6682.



### SAVE THESE INSTRUCTIONS

This manual contains important safety and operating instructions. Read all instructions and follow them with use of this product.

TECHNICAL SPECIFICATIONS

MAGAZINE CAPACITY	100 nails/staples
STAPLES	18-gauge 7/32" narrow crown (5/8-1 5/8") with 0.222" widths
NAILS	18-gauge brad nails (5/8 to 2")
OPERATING PRESSURE	70-110 PSI (4.8-7.5 bar)
MAXIMUM PRESSURE	120 PSI (8.3 bar)
AVERAGE AIR CONSUMPTION	0.03 CF/cycle @ 90 PSI
AIR INLET	1/4"-18 NPT
WEIGHT	3 lb 8 oz (1.6 kg)

CF: Cubic Feet (the volumetric flow rate of air corrected to standardized conditions of temperature and pressure).  
NPT: National Pipe Thread.

SAFETY GUIDELINES

This manual contains information that relates to PROTECTING PERSONAL SAFETY and PREVENTING EQUIPMENT PROBLEMS. It is very important to read this manual carefully and understand it thoroughly before using the product. The symbols listed below are used to indicate this information.



**DANGER!**  
Potential hazard that will result in serious injury or loss of life.



**WARNING!**  
Potential hazard that could result in serious injury or loss of life.



**CAUTION!**  
Potential hazard that may result in moderate injury or damage to equipment.

PERSONAL SAFETY

These precautions are intended for the personal safety of the user and others working with the user. Please take time to read and understand them.

**NOTE:** The word "Note" is used to inform the reader of something he/she needs to know about the tool.

## SAFETY GUIDELINES



- **Do not use oxygen or any other combustible or bottled gas to power air-powered tools.** Failure to observe this warning can cause an explosion and serious personal injury or death. Use only compressed air to power air-powered tools. Use a minimum of 25' (7.6 m) of hose to connect the tool to the compressor. Failure to comply will result in serious injury or loss of life.

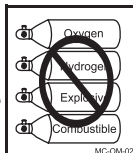

- **Risk of electric shock.** Do not expose a compressor to rain. Store it indoors. Disconnect the compressor from the power source before servicing. Compressor must be grounded. Do not use grounding adaptors.



- **Risk of personal injury.** Do not direct compressed air from the air hose toward the user or other personnel.



- **Risk for breathing.** Never directly inhale the air produced by the compressor.

**NOTE:** Carefully read and understand all the instructions in this manual before using the tool. Ensure that the operator has read and understood these instructions.

**DANGER!**

Potential hazard that will result in serious injury or loss of life.

- Keep children away from the work area. Do not allow children to handle power tools.
- Keep air hose away from heat, oil, and sharp edges. Check air hose for wear before each use and ensure that all connections are proper.
- Always ensure that the workpiece is firmly secured leaving both hands free to control the tool.
- Always ensure that the tool has stopped before putting it down after use, in the interest of safety and to prevent possible damage to the tool/user.
- Keep proper footing at all times in order to ensure correct balance.



- **Risk of bursting.** Do not adjust the pressure switch or safety valve for any reason. They have been preset at the factory for this compressor's maximum pressure. Tampering with the pressure switch or the safety valve may cause personal injury or property damage.



- **Risk of burns.** The pump and the manifold generate high temperatures. In order to avoid burns or other injuries, do not touch the pump, the manifold, or the transfer tube while the compressor is running. Allow the parts to cool down before handling or servicing. Keep children away from the compressor at all times.

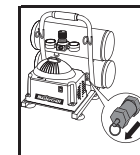

- **Risk of bursting.** Make sure the regulator is adjusted so that the compressor outlet pressure is set lower than the maximum operating pressure of the tool. Before starting the compressor, pull the ring on the safety valve to make sure the valve moves freely. Drain water from tank after each use. Do not weld or repair tank. Relieve all pressure in the hose before removing or attaching accessories.

**WARNING!**

Potential hazard that could result in serious injury or loss of life.

- Do not allow unskilled or untrained individuals to operate the Air-powered Nailer/Stapler.
- Do not use the Air-powered Nailer/Stapler for any task other than that it is designed to perform.
- Do not use the Air-powered Nailer/Stapler unless you have been instructed in its use.
- Locate the compressor in a well-ventilated area for cooling, at a minimum of 12" (31 cm) away from the nearest wall.
- Protect the air hose and the power cord from damage and puncture. Inspect them for weak or worn spots every week, and replace them if necessary.
- Always wear hearing protection when using the air compressor. Failure to do so may result in hearing loss.
- Do not carry the compressor while it is running.
- Do not operate the compressor if it is not in a stable position.
- Do not operate the compressor on a rooftop or an elevated position that could allow the unit to fall or be tipped over.
- Always replace a damaged gauge before operating the unit again.

- Always ensure that the tool has stopped before connecting it to the air supply.
- Do not wear watches, rings, bracelets, or loose clothing when using any air tool.
- Do not overload the tool. Allow the tool to operate at its optimum speed for maximum efficiency.
- Do not use a tool that is leaking air, with missing or damaged parts, or that requires repairs. Verify that all screws are securely tightened.
- For optimal safety and tool performance, inspect the tool daily in order to ensure free movement of the trigger, safety mechanisms, and springs.
- Always keep your air tool clean and lubricated. Daily lubrication is essential to avoid internal corrosion and possible failures.
- Ensure the floor is not slippery and wear non-slip shoes. Floor should be kept clean and clear.
- Always follow all workshop safety rules, regulations, and conditions when using the Air-powered Nailer/Stapler.
- Carry the tool by the handle only, keeping the finger away from the trigger. Do not carry the tool by the hose, magazine or any other parts.
- Do not use the tool near or below the freezing condition, as doing so may cause tool failure.
- Do not store the tool in a freezing environment to prevent ice formation on the operating valves of the tool, as doing so may cause tool failure.
- Handling and storage of oil: Use with adequate ventilation. Avoid contact of oil with eyes, skin, and clothing. Avoid breathing spray or mist. Store in a tightly closed container in a cool, dry, well-ventilated area free from incompatible substances.

- Disconnect the tool from the air supply and turn off the compressor before performing any maintenance, or changing accessories, when the tool is not in use, when it is being handed to another person, and when it is left unattended. Failure to comply may result in moderate injury or damage to equipment.

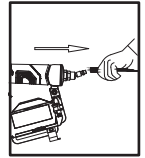

- Use safety goggles and ear protection: Wear safety glasses with side shields when operating the tool/compressor and verify that others in the work area are also wearing safety glasses. Safety glasses must provide protection from flying particles from the front and the sides.



Air-powered tools are loud and the sound can cause hearing damage. Always wear ear protection to prevent hearing damage and loss. Failure to comply may result in moderate injury.



**Note:** Recycle the unwanted materials rather than disposing of them as waste. Sort the tools, hoses, and packaging in specific categories and take to the local recycling centre or dispose of them in an environmentally safe way.

**CAUTION!**

Potential hazard that may result in moderate injury or damage to equipment.

**CAUTION!**

Potential hazard that may result in moderate injury or damage to equipment.

No.	Description	No.	Description
1	Air deflector	5	Safety stand
2	Air inlet plug	6	Release handle
3	Latch	7	Trigger
4	Magazine	8	Depth adjustment dial

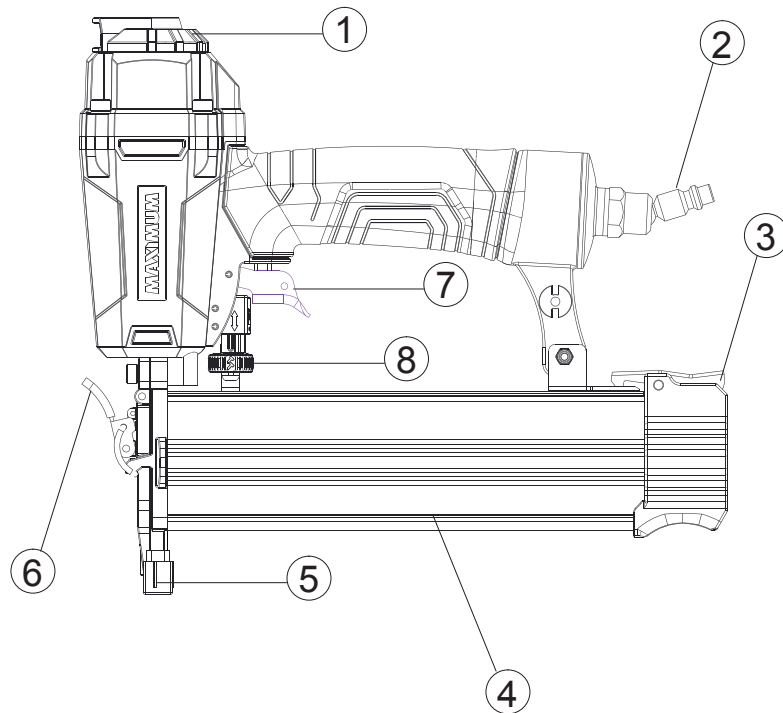

### Compatible compressors

#### GUIDELINES FOR PROPER USE AND OPERATION

Be sure to use a proper air compressor with MAXIMUM® Air-powered tools. The compressor should be able to supply a minimal air delivery of 2.65 CFM @ 90 PSI (6.3 bar) to ensure the compressor can run continuously with the MAXIMUM® Air-powered Nailer/Stapler.

Air Compressor Size and Power	1/3-11/3 HP	1 1/2-2 HP	+ HP
2-6 Gallons	Light-duty and intermittent use	Light-duty and intermittent use	Light-duty and intermittent use
8-11 Gallons	Light-duty and intermittent use	Heavy-duty and continuous use	Heavy-duty and continuous use
15+ Gallons	Medium-duty and intermittent use	Heavy-duty and continuous use	Heavy-duty and continuous use

### General use

This MAXIMUM® Air-powered Nailer/Stapler drives 18-gauge brad nails having a length of 15 to 50 mm (5/8 to 2") and 18 gauge staples having a length of 5/8 to 1 5/8". The 2-in-1 magazine accepts staples and brad nails without adjustment. The tool has a die cast aluminum body that is strong and light in weight, and a rubber-made handle sleeve for providing improved control and comfort, even during extended use. The tool has a 360° air deflector and a safety stand for improved operator safety. The tool is best suited for installing door and window trim, decorative trim, small cabinet work, and finish paneling using brad nails, while staples can be used for attaching house wrap, vapour barriers, and similar.

Wood density	Nail size	Compressor air pressure
>0.6 g/cm <sup>3</sup>	<1 1/2" (32 mm) brad nails	90 PSI (6.2 bar)
	≥1 1/2" (32 mm) brad nails	110 PSI (7.6 bar)
	<1" (25 mm) staples	90 PSI (6.2 bar)
	≥1" (25 mm) staples	110 PSI (7.6 bar)
≤0.6 g/cm <sup>3</sup>	<1 1/2" (32 mm) brad nails	70 PSI (5 bar)
	≥1 1/2" (32 mm) brad nails	90 PSI (6.2 bar)
	<1" (25 mm) staples	70 PSI (5 bar)
	≥1" (25 mm) staples	100 PSI (7 bar)

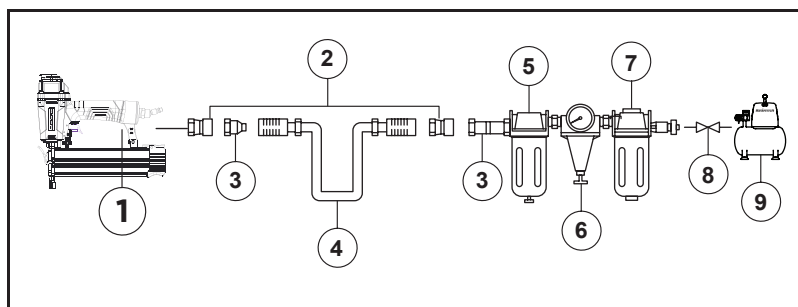

No.	Description	No.	Description
1	MAXIMUM® Air-powered Nailer/Stapler	6	Regulator: 0 to 123 PSI (0 to 8.5 bar)
2	Quick connector	7	Filter
3	Quick coupler	8	Cut-off valve
4	Air hose	9	Air compressor
5	Lubricator		

- Always use clean, dry, regulated, compressed air at 70 to 110 psi (4.8 to 7.5 bar).
- Do not exceed the maximum or minimum pressures. Operating the tool at the inappropriate pressure (too low or too high) will cause excessive noise or rapid wear.

### Read this instruction manual carefully before using the Air-powered Nailer/Stapler

- Read and follow all the safety instructions at the beginning of this manual. Inspect the Air-powered Nailer/Stapler prior to each use in order to :
  - Ensure that the proper power source is being used.
  - Verify that the tool is in proper working order.
- It is recommended that a filter-regulator-lubricator be used and be located as close to the tool as possible.
- If a filter-regulator-lubricator is not installed, place up to 6 drops of pneumatic tool oil into the air inlet plug before each use.
- If a filter-regulator-lubricator is installed, keep the air filter clean. A dirty filter will reduce the air pressure to the tool, which will cause reduction in power, efficiency, and general performance.
- For optimal performance, install a quick connector to the tool and a quick coupler on the hose, if applicable.
- Verify that all of the connections in the air supply system are sealed in order to prevent air from leaking.



### WARNING!

Potential hazard that could result in serious injury or loss of life.

- Keep hands and other parts of the body away from the tool's discharge and working areas when connecting the air supply. Failure to comply could lead to serious injury or loss of life.
- Do not use the tool if it is not in proper working order.
- Do not use oxygen or any other combustible or bottled gas to power this tool.
- Do not use this tool in the presence of any flammable liquids or gases.
- Keep hands and other parts of the body away from the firing head during use.
- Do not point the tool towards the operator or other people.
- Do not attempt to clear a jammed fastener when the air hose is connected.
- Do not drive a fastener on top of an existing fastener. Failure to comply could lead to serious injury or loss of life.

This MAXIMUM® Air-powered Nailer/Stapler drives 18-gauge brad nails having a length of 5/8 to 2" (15 to 50 mm) and 18-gauge staples having a length of 5/8 to 1 5/8" (16 to 40 mm).

### Acceptable Fasteners

Brad nails: 5/8 to 2" (16 to 50 mm).

Staples: 5/8 to 1 5/8" (16 to 40 mm).

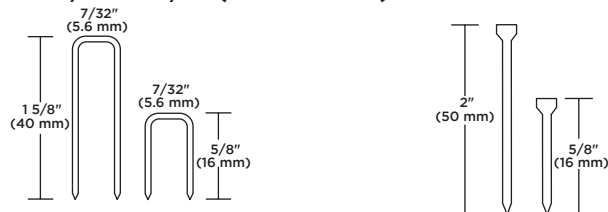

This nailer can be used with a variety of shank types (e.g. ring, smooth, spiral) and a variety of coatings or nail compositions (e.g. electro, mechanical, hot-dipped galvanized or stainless steel, etc.).

### Types of Nails

These icons are used to select the proper nails for this specific nailer.

#### COMPATIBLE NAILS/STAPLES:

#### CLOUS/AGRAFES COMPATIBLES :



NAIL SIZE:  
TAILLE :  
5/8-2"



NAIL SIZE:  
TAILLE :  
5/8-1 5/8"

**NOTE:** Icons are colour coded, please refer the actual tool for the specific colour.



### WARNING!

Potential hazard that could result in serious injury or loss of life.

- The use of any other types of nails will cause the nailer to jam and could lead to serious injury or loss of life.

### Loading Fasteners

#### Operation

1. Disconnect the tool (1) from the air supply (2) (see Fig. A).

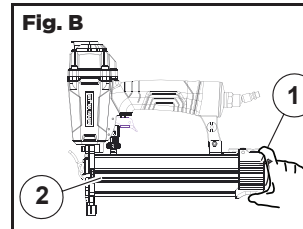
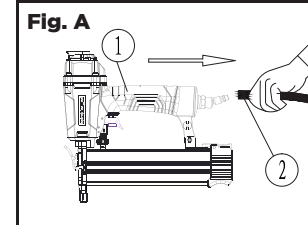

2. Hold the Air-powered Nailer/Stapler firmly with one hand, and use the other hand to press the latch (1) on the magazine (2) and slide it back (see Fig. B).

3. Insert a strip of fasteners into the magazine. Be sure that the points of the fasteners are facing down. Close the magazine (1) (see Fig. C). (Refer to the nail type icon on page 14).

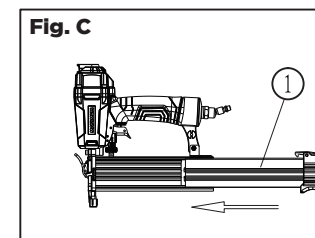

### WARNING!

Potential hazard that could result in serious injury or loss of life.

- Disconnect the tool from the compressed air source before loading fasteners.
- Do not point the tool towards the operator or other people while changing fasteners.
- Do not hold the tool with the trigger pressed while changing the fasteners.
- Failure to comply will lead to serious injury or loss of life.



4. Plug in compressor, turn it on, and set the pressure regulator to 90 PSI (6.2 bar), attach one end of the air hose to the compressor and the other end of the air hose (1) to the tool (2). Use plumber's tape to avoid air leaks (see section "Technical specifications") (see Fig. D). (Refer to the wood density chart on page 12).

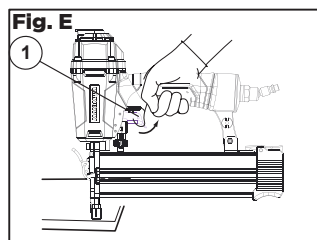
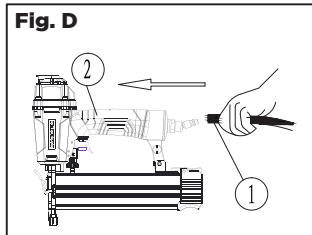

5. Test the driving depth of the fasteners on sample piece of wood by pressing the trigger (1) before working on the workpiece. If the fasteners are being driven too deep, or not deep enough, adjust the regulator in the air supply in order to provide more or less air pressure, as required (see Fig. E).

### Loading brad nails

Insert brad nails into the channel along the left side of the magazine (see Fig. F).

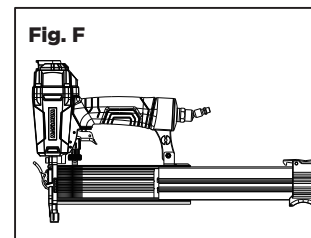

### Loading staples

Insert the staples from the top area of magazine with one 'arm' of the staple in the centre slot of the magazine and the other arm of the staple along the left side of the magazine (see Fig. G).

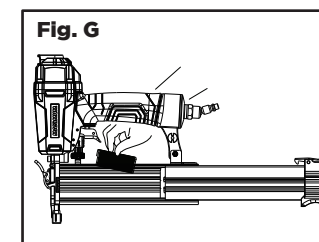

### Firing modes

The MAXIMUM® Air-powered Nailer/Stapler is equipped with a single, sequential actuation mode which follows this sequence for firing the fastener:

- Press the safety stand against the workpiece.
- Pull the trigger in order to drive the fastener.
- If safety stand remains pressed against the workpiece, successive fasteners will fire each time the trigger is pulled.

### Fasteners depth adjustment

The MAXIMUM® Air-powered Nailer/Stapler has a depth adjustment dial below the trigger to adjust the firing depth of the fasteners.

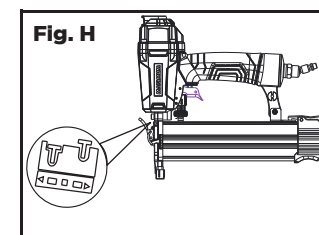

### WARNING!

Potential hazard that could result in serious injury or loss of life.

- The safety stand must be in contact with the workpiece before activating the tool.
- Do not operate the tool if the fasteners are not loaded, as doing so may damage the tool.
- Do not fire fasteners into the air, as doing so may cause injury to the operators or others, apart from damaging the tool.
- Do not load different sized fasteners into the magazine, as doing so may cause fasteners to jam. Failure to comply could lead to serious injury or loss of life.



**Note:** Refer to the graphic imprinted below the trigger and adjust the firing depth accordingly (see Fig. H).



### CAUTION!

Potential hazard that may result in moderate injury or damage to equipment.

- Operate the tool with the utmost care when it is connected to the air compressor. Failure to comply may result in moderate injury or damage to equipment.



### Cold weather operation

When operating any air-powered tool below freezing temperature:

- Verify the compressor tanks have been properly drained prior to use.
- Keep the tool as warm as possible using any safe, convenient method.
- Place up to 6 drops of pneumatic tool oil into the tool's air inlet.
- Maintain the operating level of the air pressure between 80 to 100 psi (5.5 to 7 bar).
- Load the fasteners into the magazine (if required).
- Actuate the tool 5 to 6 times into a scrap piece of wood in order to lubricate the O-rings.
- Relubricate the tool, as described in the maintenance section.
- Drain the compressor tanks at least once per day.

### Decreasing Fastener Depth

Turn the depth adjustment dial counterclockwise (with the discharge area of the tool facing away from the operator) (see Fig. I).

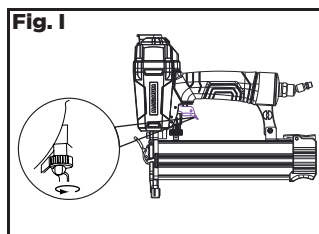

### Increasing Fastener Depth

Turn the depth adjustment dial clockwise (with the discharge area of the tool facing away from the operator) (see Fig. J).

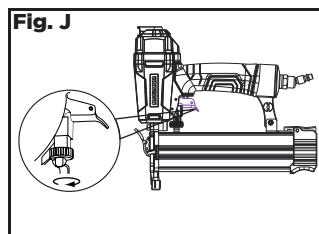

### Clearing a jammed fastener

To clear the jammed fastener:

- Disconnect the tool from the air supply line.
- Remove the fasteners that are stored in the tool's magazine.
- Operate the magazine release latch to open the movable magazine.
- Use pliers or any appropriate tool to remove the jammed fasteners.
- Reload fasteners into the tool magazine.
- Close the movable magazine and verify that the magazine release latch has moved to its original position.
- Reconnect the air supply line to the tool's air inlet.
- Test fire 3 to 5 fasteners into a piece of scrap wood in order to ensure proper operation.

**Note:** If the fasteners continue to jam, please call 1-888-670-6682.



### WARNING!

Potential hazard that could result in serious injury or loss of life.

- Disconnect the air supply from the tool before loading or changing the fasteners.
- Disconnect the magazine from the tool and remove the non-jammed fasteners from the tool before clearing the jammed fastener. Failure to comply could cause them to be fired out of the tool causing serious injury.
- Do not point the tool towards the operator or other people with the trigger pressed while loading or changing the fasteners. Serious personal injury could result if these instructions are not followed.

**Note:** If the fasteners are not going deep enough, or going too deep, adjust the pressure of the regulator.

MAINTENANCE REQUIRED	DESCRIPTION	TOOLS OR MATERIALS REQUIRED	MAXIMUM SERVICE INTERVAL		
			Each use or every 2 hrs	Monthly	As needed
General inspection—free movement	Trigger, spring, safety mechanism	None	X		
In-depth inspection	Worn or broken parts			X	X
Replace worn or broken parts					X
Lubrication	See below	Pneumatic tool oil	X		

- **Lubrication:** If the Air-powered Nailer/Stapler and the compressor are not equipped with an in-line lubrication system, place up to 6 drops of pneumatic tool oil into the air inlet before each work day, or after every 2 hours of continuous use, depending on the characteristics of the workpiece and type of nails used.
- Air-operated tools must be inspected periodically, and worn or broken parts must be replaced in order to keep tools operating safely and efficiently.
- Inspect and replace worn or damaged O-rings, seals, etc. Tighten all screws and caps frequently in order to help prevent personal injury.
- Inspect the trigger, spring, and safety mechanism for free movement on a regular basis in order to ensure that the safety system is fully functional. Verify that no parts are loose or missing and no parts are sticking or jammed.
- Keep the magazine and the firing area of the tool clean and free of any dirt or abrasive particles.

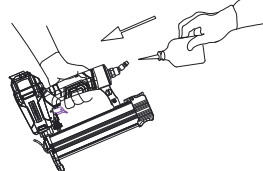
**DANGER!**

Potential hazard that will result in serious injury or loss of life.

- Disconnect the tool from the air compressor before performing maintenance/service, adjusting, clearing jams, reloading, and when it is not in use.
- Repairs must be performed by a qualified service technician only. Failure to comply will lead to serious injury or loss of life.

PROBLEM	POSSIBLE CAUSES	SOLUTIONS
No nail is fired.	Incorrect or abnormal nails (large sized head, nails that are bent or incorrectly chained) are loaded.	Remove incorrect nails and load 18-gauge, 5/8 to 2" nails.  <b>Have the tool serviced by a qualified technician.</b>
	<b>Magazine unit</b> 1. The magazine push lever/nail feed portion is damaged. 2. Nail feeder is deflected, bent or broken. 3. Feed spring is worn or broken. 4. Adhesive fragment or wood dust is sticking on the magazine or nail feeder. 5. Push lever is damaged.	1. Repair deformed parts. 2. Replace defective parts. 3. Replace defective parts. 4. Remove adhesive fragment or wood dust. 5. Check push lever movement and replace if necessary.  <b>Have the tool serviced by a qualified technician.</b>
	<b>Output unit: piston or driver</b> 1. Air pressure is too low. 2. Piston ring is worn. 3. Piston bumper is defective. 4. Bumper piece is defective, worn, or broken. 5. O-ring is disconnected, deformed or broken. 6. Driver blade is deflected, deformed, or broken. 7. Foreign material (adhesive or wood fragment) is present inside the cylinder.	<b>Have the tool serviced by a qualified technician.</b> 1. Check compressor for pressure setting. 2. Replace piston ring if tool does not drive at minimum operating pressure. 3. Replace the piston bumper. 4. Replace the piece. 5. Reassemble or replace the O-ring. 6. Replace the blade. 7. Remove the material (adhesive fragment or wood) and clean the cylinder.

PROBLEM	POSSIBLE CAUSES	SOLUTIONS
The driven nail is bent.	<ol style="list-style-type: none"> <li>1. Nails are inaccurately fed.</li> <li>2. Incorrect nails are loaded.</li> <li>3. Air pressure is too low.</li> <li>4. Driver blade is worn or broken.</li> <li>5. The wood is too hard.</li> </ol>	<ol style="list-style-type: none"> <li>1. Remove and load the nails properly.</li> <li>2. Remove incorrect nails and load the recommended nails (see section "Technical specifications.")</li> <li>3. Adjust the air pressure.</li> <li>4. Replace the driver blade if it either protrudes from the blade guide or appears to be excessively worn.</li> <li>5. Test fire to determine whether nails bend on soft wood. If it bends, a higher gauge nailer is required.</li> </ol>
Nails do not fire "flush" into the workpiece.	<ol style="list-style-type: none"> <li>1. The wood is too hard.</li> <li>2. Air pressure is too low.</li> <li>3. Drive blade is worn or broken.</li> <li>4. Incorrect driving depth adjustment.</li> </ol>	<ol style="list-style-type: none"> <li>1. Test fire to determine whether nails bend on softer wood. If it bends, a higher gauge nailer is required.</li> <li>2. Adjust the air pressure.</li> <li>3. Replace the driver blade if it either protrudes from the blade guide or appears to be excessively worn.</li> <li>4. Adjust the depth adjustment dial to the appropriate position.</li> </ol>
Nails jam.	<ol style="list-style-type: none"> <li>1. Piston ring or cylinder is worn, broken, or dirty.</li> <li>2. Nails are not feeding into the chamber properly.</li> <li>3. Incorrect nails being used.</li> <li>4. Driver blade tip is worn.</li> <li>5. Driver guide is damaged or worn.</li> <li>6. Workpiece material (or backer) is too hard.</li> </ol>	<ol style="list-style-type: none"> <li>1. Send for service.</li> <li>2. See above items.</li> <li>3. See above items.</li> <li>4. Send for service.</li> <li>5. Inspect and send tool for service.</li> <li>6. Use an alternate tool.</li> </ol>

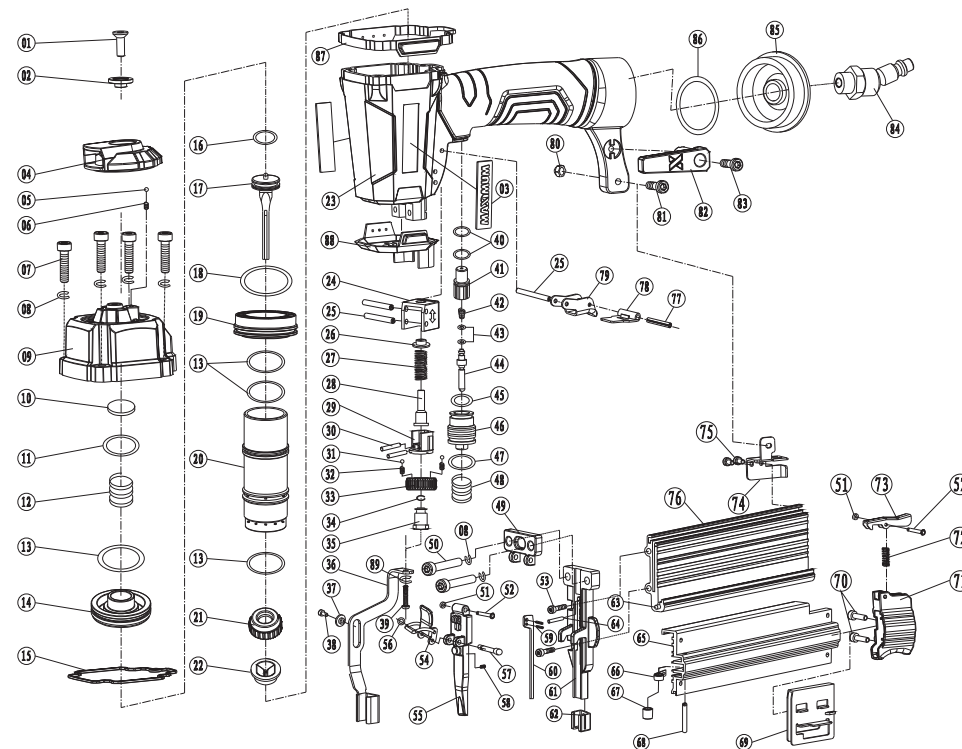

No.	Description	Qty
1	Bolt M5 x 16	1
2	Axle sleeve	1
3	Logo	2
4	Exhaust valve cap	1
5	Ball Dw=3	1
6	Spring	1
7	Bolt M5 x 20	4
8	Spring washer 5	6
9	Cylinder cover	1
10	Sealing washer	1
11	O-ring 17 x 2.65	1
12	Compressed spring	1

No.	Description	Qty
13	O-ring 33.6 x 2	4
14	Switch valve	1
15	Sealing gasket	1
16	O-ring 24.2 x 3.1	1
17	Main piston	1
18	O-ring 41.7 x 3	1
19	Collar	1
20	Cylinder	1
21	Bumper	1
22	Washer	1
23	Housing	1
24	Guide stand	1

**Note:** For further repair information, please call 1- 888-670-6682.

No.	Description	Qty
25	Pin 3 x 26	3
26	Washer II	1
27	Compressed spring	1
28	Snap retainer	1
29	Adjustable stand	1
30	Norm pin 1.5 x 8	2
31	Ball Dw=3	2
32	Compressed spring B	2
33	Adjustable nut	1
34	Retainer ring	1
35	Adjustable stem	1
36	Safety mechanism	1
37	Guide sleeve	1
38	Bolt M3 x 8	1
39	Adjustable bolt	1
40	O-ring 7 x 1.5	2
41	Trigger valve guide	1
42	Screw spring	1
43	O-ring 1.9 x 1.1	2
44	Switch lever	1
45	O-ring 11.2 x 1.6	1
46	Trigger valve seat	1
47	O-ring 11.7 x 2.4	1
48	Compressed spring	1
49	Fixed driver guide cover	1
50	Bolt M5 x 25	2
51	Pin sleeve	2
52	Pin	2
53	Bolt M4 x 16	2
54	Quick release handle	1
55	Movable driver guide cover I	1
56	O-ring 1.9 x 1.2	1
57	Pin	1
58	Compressed spring	1
59	Pin 2 x 6	2

No.	Description	Qty
60	Flexible bar	1
61	Driver guide	1
62	Safety nozzle	1
63	Inlay slice	1
64	Pin 1 x 10	2
65	Movable magazine	1
66	Spring	1
67	Roll core	1
68	Pin 3 x 20	1
69	Pusher	1
70	Bolt M4 x 16	2
71	Position seat	1
72	Compressed spring	1
73	Fixed lever	1
74	Fixed seat	1
75	Bolt M4 x 16	2
76	Fixed magazine	1
77	Pin 3 x 17.5	1
78	Safety spacer	1
79	Trigger II	1
80	Nut M4	1
81	Bolt M4 x 16	1
82	Hook	1
83	Bolt M4 x 12	1
84	Air inlet plug	1
85	End cap	1
86	O-ring 36.3 x 3.55	1
87	Front anti-collision rubber	1
88	Black anti-collision rubber	1
89	Spring washer	1

This MAXIMUM product is guaranteed for a period of 5 years from the date of original retail purchase against defects in workmanship and materials only and is subject to the following components:

a) Component A: The carrying case is guaranteed for a period of 1-year from the date of original retail purchase against defects in workmanship and materials.

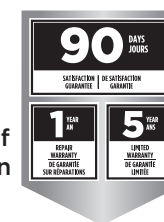

Subject to the conditions and limitations described below, this product, if returned to us with proof of purchase within the stated warranty period and if covered under this warranty, will be repaired or replaced (with the same model, or one of equal value or specification), at the sole discretion of the Maximum Canada authorised repair centre ("Service Provider"). We will bear the cost of any repair or replacement and any costs of labour relating thereto.

#### These warranties are subject to the following conditions and limitations:

- A bill of sale verifying the purchase and purchase date must be provided;
- Defects in workmanship and material to be assessed and determined by the Service Provider;
- This warranty will not apply to any product or part thereof which is worn or broken or which has become inoperative due to abuse, misuse, accidental damage, neglect or lack of proper installation, operation or maintenance (as outlined in the applicable owner's manual or operating instructions);
- This warranty does not apply to normal wear and tear or to expendable parts or accessories (including drill bits and saw blades) that may be supplied with the product that by their nature have a limited life span and are expected to become inoperative or unusable after a reasonable period of use;
- This warranty will not apply to routine maintenance and consumable items such as, but not limited to, driver blades, bumpers, pistons, piston rings, rubber o-rings, tune-ups or adjustments;
- This warranty excludes the following components that may accompany your product:
  - The carrying case, which is only for a period of 1-year from the date of original retail purchase against defects in workmanship and materials.
  - Accessories, including drill bits and saw blades, which do not carry a warranty of any kind.
- This warranty will not apply where damage is caused by repairs made or attempted by others (i.e. persons not authorized by the manufacturer), and any such unauthorized repairs or attempted repairs shall void this warranty in its entirety;

- h) This warranty will not apply to any parts other than original parts, except to the extent that the retailer or manufacturer or persons authorized by either of them have repaired or replaced them;
- i) This warranty will not apply to any product that was sold to the original purchaser as a reconditioned or refurbished product (unless otherwise specified in writing);
- j) This warranty will not apply to any product or part thereof if any part from another manufacturer is installed therein or any repairs or alterations have been made or attempted by unauthorized persons;
- k) This warranty will not apply to normal deterioration of the exterior finish, such as, but not limited to, scratches, dents, paint chips, or to any corrosion or discolouring by heat, abrasive and chemical cleaners; and
- l) This warranty will not apply to component parts sold by and identified as the product of another company, which shall be covered under that product manufacturer's warranty, if any;
- m) Any products replaced by the retailer in attempt to fulfill warranty obligations is subject to the original product warranty conditions and related time period as initiated by the original date of purchase; if product is purchased in Quebec, the warranty term will be extended for a period equal to the time during which the Quebec retailer possesses the product in attempt to fulfill warranty obligations; replaced product will not default to new product warranty conditions; and
- n) The retailer and manufacturer's sole obligation and the purchaser's sole remedy under this warranty shall be as set out herein. The warranties contained herein are not transferable and are given only to the purchaser.

FURTHER, THE WARRANTIES SET OUT HEREIN ARE IN LIEU OF ALL OTHER WARRANTIES OR CONDITIONS, WHETHER EXPRESS, IMPLIED OR STATUTORY (INCLUDING SUCH AS ARISE UNDER THE SALE OF GOODS ACT OR THE INTERNATIONAL SALE OF GOODS ACT), ARISING OUT OF A COURSE OF DEALING OR USAGE OF TRADE OR OTHERWISE, INCLUDING, SUBJECT TO APPLICABLE LAW, ANY IMPLIED WARRANTIES OR CONDITIONS OF MERCHANTABILITY, MERCHANTABLE QUALITY, FITNESS OR ADEQUACY FOR A PARTICULAR PURPOSE OR USE, AND ALL OTHER SUCH WARRANTIES ARE EXPRESSLY DISCLAIMED BY THE RETAILER AND MANUFACTURER.

### Additional Limitations

This warranty applies only to the original purchaser and may not be transferred.

This warranty applies for a period of 5 years from the date of original retail purchase, as indicated on the bill of sale.

Neither the retailer, Maximum Canada, nor the manufacturer shall be liable for any other expense, loss or damage, including, without limitation, any indirect, incidental, consequential or exemplary damages arising in connection with the sale, use or inability to use this product.

Under no circumstances shall the retailer, Maximum Canada, or manufacturer be liable to the purchaser for any claim for (a) indirect, special, punitive, incidental, exemplary, or consequential damages, (b) compensation for loss of profits, anticipated revenue, savings or goodwill, or other economic loss of the purchaser, (c) exemplary, aggravated or punitive damages howsoever incurred, (d) contribution or set-off in respect of any claims against the purchaser, (e) any damages whatsoever relating to third party products or services or the purchaser's materials, or (f) any damages whatsoever relating to interruption, delays, errors or omissions; in each case under any theory of law or equity, arising out of or in any way related to this warranty, even if advised of the possibility thereof. Notwithstanding any provision herein or entitlement of the purchaser at law, in equity or otherwise, in no event shall the liability of the retailer or manufacturer under this warranty, whether in contract, tort, product liability or otherwise, exceed, in the aggregate, the amount paid by the purchaser to the retailer for the product to which this warranty applies.

### \*Notice to Consumer

This warranty gives you specific legal rights, and you may have other rights, which may vary from province to province. The provisions contained in this warranty are not intended to limit, modify, take away from, disclaim or exclude any statutory warranties set forth in any applicable provincial or federal legislation.

In addition to the 5-Year Limited Warranty, this MAXIMUM product is covered by our:

### **1-Year Repair Warranty**

Maximum Canada will maintain this product and replace critical parts which have worn beyond reasonable use through normal use of such product, any time during the first year after purchase.

The following are excluded from this 1-Year Repair Warranty:

- a) Missing or damaged parts or components that are a result of abuse or misuse;
- b) Any wear and tear to non-critical parts or accessories that do not affect the core function of the product.

### **90-Day Satisfaction Guarantee**

If you are not completely satisfied with the performance of your MAXIMUM product for any reason, you can return it within 90 days from the date of purchase with proof of purchase for exchange or a full refund.

Made in China,

Imported by  
MAXIMUM Canada Toronto, Canada M4S 2B8