

model no. 054-8259-0

**Mastercraft™**

## ORBITAL JIGSAW

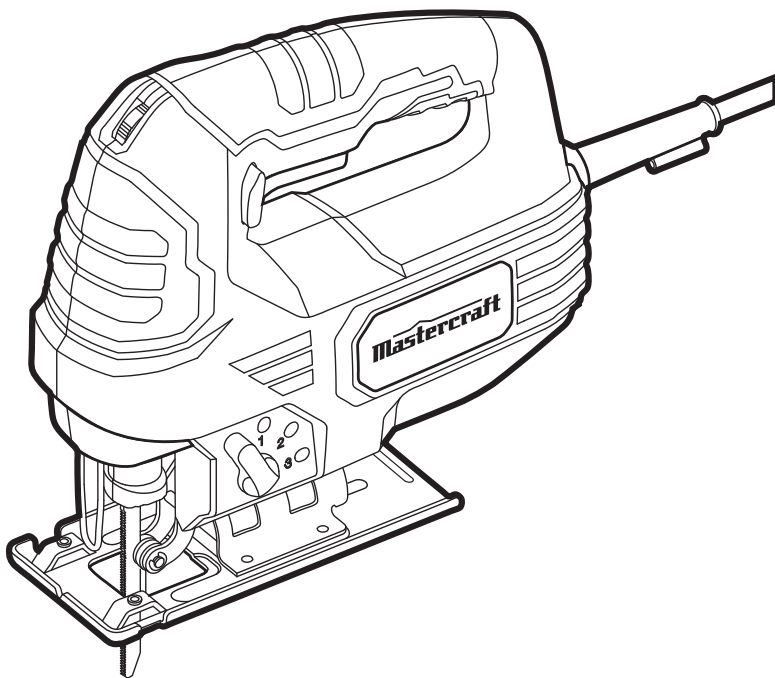

### **IMPORTANT:**

Read and understand this instruction manual thoroughly before using the product.

## **INSTRUCTION MANUAL**

**TABLE OF CONTENTS**

|                          |       |
|--------------------------|-------|
| Technical Specifications | 4     |
| Safety Guidelines        | 5–8   |
| Key Parts Diagram        | 9     |
| Important Information    | 10–12 |
| Assembly Instructions    | 13–14 |
| Operating Instructions   | 15–17 |
| Maintenance              | 18    |
| Troubleshooting          | 19    |
| Part list                | 20–21 |
| Warranty                 | 22–23 |

**NOTE:** If any parts are missing or damaged, or if you have any questions, please call our toll-free helpline at 1-800-689-9928

**SAVE THESE INSTRUCTIONS**

- This manual contains important safety and operating instructions. Read all instructions and follow them with use of this product.

**TECHNICAL SPECIFICATIONS**

|                      |                     |
|----------------------|---------------------|
| Rated power input    | 5A                  |
| Rated voltage        | 120V~, 60Hz         |
| No load speed        | 800–3000 SPM        |
| Length of stroke     | 13/16" (20 mm)      |
| Maximum capacities:  |                     |
| Wood                 | 3 11/32" (85 mm)    |
| Metal                | 1/4" (6 mm)         |
| Cutting angle range  | 0–45°               |
| Available blade type | T- and U-shank      |
| Tool weight          | 4 lb 8 oz (2.04 kg) |

**RULES FOR SAFE OPERATION****WARNING!**

Safety symbols in this Instruction Manual are used to flag possible dangers. The safety symbols and their explanations require your full understanding. The safety warnings do not, by themselves, eliminate any danger, nor are they substitutes for proper accident prevention measures.

**WARNING!**

This Safety Alert Symbol indicates caution, warning, or danger. Failure to obey a safety warning can result in serious injury to yourself or others. To reduce the risk of injury, fire, or electric shock, always follow the safety precautions.

**KNOW YOUR TOOL**

To operate this tool, carefully read this Instruction Manual and all labels affixed to the Orbital Jigsaw before using. Keep this manual available for future reference.

**IMPORTANT**

This tool should only be serviced by a qualified service technician. For more information, call the toll-free helpline at 1-800-689-9928.

**READ ALL INSTRUCTIONS THOROUGHLY****SAVE THESE INSTRUCTIONS****SAFETY GUIDELINES FOR POWER TOOLS****WARNING!**

Read all safety warnings and instructions. Failure to follow the warnings and instructions may result in electric shock, fire and/or serious injury.

**SAVE ALL WARNINGS AND INSTRUCTIONS FOR FUTURE REFERENCE.**

The term "power tool" in the warnings refers to your mains-operated (corded) power tool or battery-operated (cordless) power tool.

**WORK AREA SAFETY**

- **Keep work area clean and well lit.** Cluttered or dark areas invite accidents.
- **Do not operate power tools in explosive atmospheres, such as in the presence of flammable liquids, gases or dust.** Power tools create sparks, which may ignite the dust or fumes.
- **Keep children and bystanders away while operating a power tool.** Distractions can cause you to lose control.

## ELECTRICAL SAFETY

- **Power tool plugs must match the outlet.** Never modify the plug in any way. Do not use any adapter plugs with earthed (grounded) power tools. Unmodified plugs and matching outlets will reduce risk of electric shock.
- **Avoid body contact with earthed or grounded surfaces such as pipes, radiators, ranges and refrigerators.** There is an increased risk of electric shock if your body is earthed or grounded.
- **Do not expose power tools to rain or wet conditions.** Water entering a power tool will increase the risk of electric shock.
- **Do not abuse the cord.** Never use the cord for carrying, pulling or unplugging the power tool. Keep the cord away from heat, oil, sharp edges or moving parts. Damaged or entangled cords increase the risk of electric shock.
- **When operating a power tool outdoors, use an extension cord suitable for outdoor use.** Use of a cord suitable for outdoor use reduces the risk of electric shock.
- **If operating a power tools in a damp location is unavoidable, use a ground-fault circuit interrupter (GFCI) protected supply.** Use of a GFCI reduces the risk of electric shock.

## PERSONAL SAFETY

- **Stay alert, watch what you are doing and use common sense when operating a power tool.** Do not use a power tool while you are tired or under the influence of drugs, alcohol or medication. A moment of inattention while operating power tools may result in serious personal injury.
- **Use personal protective equipment.** Always wear eye protection. Protective equipment such as dust mask, non-skid safety shoes, hard hat, or hearing protection used for appropriate conditions will reduce personal injuries.
- **Prevent unintentional starting.** Ensure that the switch is in the off-position before connecting to power source or battery pack, picking up or carrying the tool. Carrying power tools with your finger on the switch or energising power tools that have the switch on invites accidents.
- **Remove any adjusting key or wrench before turning the power tool on.** A wrench or a key left attached to a rotating part of the power tool may result in personal injury.
- **Do not overreach. Keep proper footing and balance at all times.** This enables better control of the power tool in unexpected situations.
- **Dress properly. Do not wear loose clothing or jewellery. Keep your hair, clothing and gloves away from moving parts.** Loose clothes, jewellery or long hair can be caught in moving parts.
- **If devices are provided for the connection of dust extraction and collection facilities, ensure that these are connected and properly used.** Use of dust collection devices can reduce dust-related hazards.

## POWER TOOL USE AND CARE

- **Do not force the power tool.** Use the correct power tool for your application. The correct power tool will do the job better and more safely at the rate for which it was designed.
- **Do not use the power tool if the switch does not turn it on and off.** Any power tool that cannot be controlled with the switch is dangerous and must be repaired.

- **Disconnect the plug from the power source and/or the battery pack from the power tool before making any adjustments, changing accessories, or storing power tools.** Such preventive safety measures reduce the risk of starting the power tool accidentally.
- **Store idle power tools out of the reach of children and do not allow persons unfamiliar with the power tool or these instructions to operate the power tool.** Power tools are dangerous in the hands of untrained users.
- **Maintain power tools.** Check for misalignment or binding of moving parts, breakage of parts and any other condition that may affect the power tool's operation. If damaged, have the power tool repaired before use. Many accidents are caused by poorly maintained power tools.
- **Keep cutting tools sharp and clean.** Properly maintained cutting tools with sharp cutting edges are less likely to bind and are easier to control;
- **Use the power tool, accessories, tool bits, etc. in accordance with these instructions, taking into account the working conditions and the work to be performed.** Use of the power tool for operations different from those intended could result in a hazardous situation.

## SERVICE

- **Have your power tool serviced by a qualified repair person using only identical replacement parts.** This will ensure that the safety of the power tool is maintained.

## SAFETY GUIDELINES FOR JIGSAW

- **Hold the power tool by the insulated gripping surfaces when performing an operation where the cutting accessory may contact hidden wiring or its own cord.** If a cutting accessory contacts a “live” wire, it may make the exposed metal parts of the power tool “live” and could give the operator an electric shock.
- **Use clamps or another practical way to support the workpiece and secure it to a stable platform.** Holding the work by hand or against your body leaves it unstable and may lead to loss of control.
- **The label on your tool may include the following symbols. The symbols and their definitions are as follows:**

V ..... Volts

A ..... Amperes

Hz ..... Hertz

W ..... Watts

min ..... Minutes

~ ..... Alternating current

— — ..... Direct current

$n_0$  ..... No-load speed

 ..... Class II Construction

.../min ..... Revolutions or reciprocation per minute

 ..... Grounding terminal

BPM ..... Beats per minute

 ..... WARNING – To reduce the risk of injury, user must read instruction manual.

- **The saw blade must be locked in its holder securely.** Check that it had been securely seated before use.
- **Secure material before cutting.** Never hold it in your hand or across legs.
- **Never touch the saw blade immediately after use.** It may be hot after prolonged use.
- **Always wear safety goggles or eye protection when using this tool.** Use a dust mask or respirator or connect the tool to an external dust vacuum if the cutting generates a great amount of dust.
- **Keep hands away from cutting area. Do not reach under the material being cut.** The proximity of the blade to your hand is hidden from your sight.
- **Do not use dull or damaged saw blades and accessories.**
- **Protect your hearing.** Wear appropriate personal hearing protection during use. Under some conditions noise from this product may contribute to hearing loss.
- **Inspect the tool cords periodically and if damaged have them repaired by a qualified service technician. BE AWARE of the cord location.**

## PACKAGE CONTENTS

Orbital jigsaw, edge guide, hex key (installed on the tool), wood cutting blade and instruction manual.

## KEY PARTS DIAGRAM

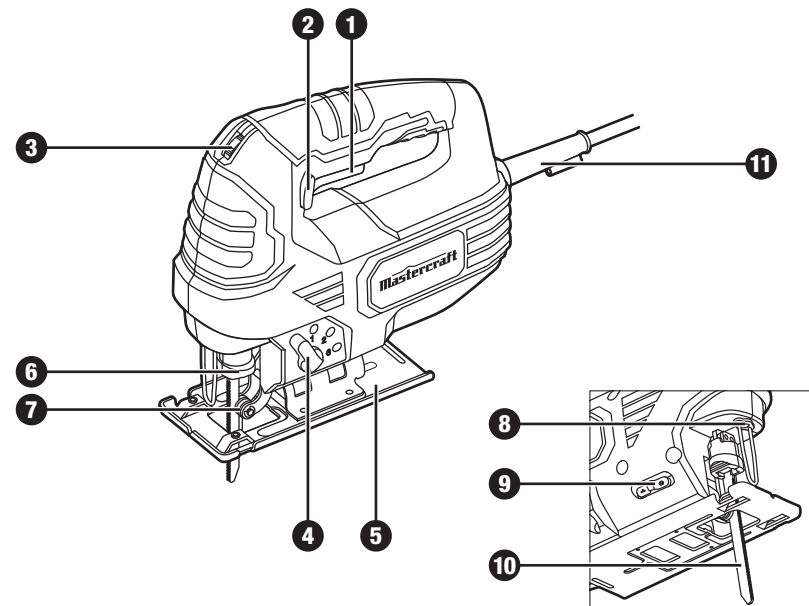

| No. | Part                  |
|-----|-----------------------|
| 1   | On/off trigger switch |
| 2   | Lock-on button        |
| 3   | Variable-speed dial   |
| 4   | Orbital control lever |
| 5   | Shoe plate            |
| 6   | Tool-less blade clamp |

| No. | Part               |
|-----|--------------------|
| 7   | Blade-guide roller |
| 8   | LED worklight      |
| 9   | Dust blower switch |
| 10  | Blade              |
| 11  | Hex key storage    |



### WARNING!

- Remove the jigsaw from the package and examine it carefully. Do not discard the carton or any packaging material until all parts have been examined.

**IMPORTANT INFORMATION**

Before attempting to use this tool, become familiar with all of its operating features and safety requirements. For optimum performance and safety, read the following operating instructions carefully before using.

**LED WORKLIGHT (fig 1)**

The LED worklight, located above the tool-less blade clamp, will illuminate when the jigsaw is turned on. This provides additional light on the surface of the workpiece for operation in lower-light conditions.

The LED worklight turns on automatically when the tool is plugged into a power source.

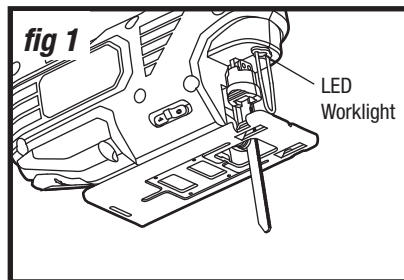
**ON-BOARD BLADE STORAGE (fig 2)**

The blade storage compartment is located on the rear of the saw.

To open: pull the blade storage cover out. To close: push the cover in with your thumb or finger.

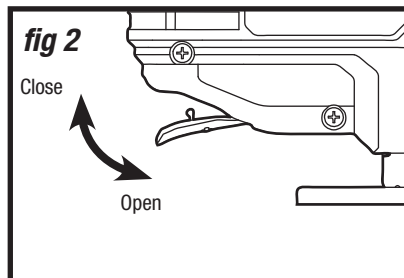
**WARNING!**

- Do not allow familiarity with the jigsaw to cause a lack of alertness. A fraction of a second of carelessness is enough to cause severe injury.
- Never connect the jigsaw to the power source when you are assembling parts, making adjustments, installing or removing cutting blade, cleaning, or when it is not in use. Disconnecting the jigsaw will prevent accidental starting, which could cause serious personal injury.

**ORBIT ADJUSTMENT (fig 3)**

The jigsaw has orbital action, whereby the blade roller guide moves back and forth to make the blade swing slightly as it cuts.

Orbital action increases the speed of cut, but may result in a rougher finish to the cut in some materials.

Set the orbit control lever to one of the four settings according to degree of orbit action required:

“0”: No orbit action

“1”: Minimal orbit action

“2”: Medium orbit action

“3”: Maximum orbit action for the most aggressive action, for quick cutting plywood or soft material.

Experiment on a piece of scrap material to determine the optimum orbit action setting.

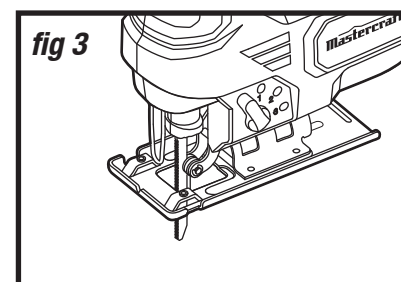
**VARIABLE-SPEED DIAL (fig 4)**

Your jigsaw is equipped with a variable-speed dial.

Rotate the speed dial to the “1” position for the lowest speed. Rotate the speed dial to the “6” position for the highest speed.

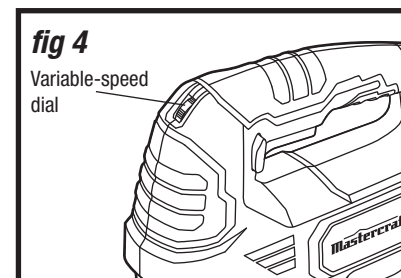
**BLADE SELECTION**

To obtain the best performance from the saw, it is important to select the correct blade for the particular application and type of material you wish to cut.

By doing this, you will get a smoother, faster cut and prolong blade life.

**NOTICE:**

- Determine the optimum speed for cutting your workpiece by making a trial cut in a scrap piece of material.
- Metal should never be cut in orbital action.

## THE FOLLOWING CHART CAN HELP YOU PICK THE PROPER SPEED, BLADE AND ORBIT ACTION

| Workpiece to be cut  | Setting on the speed dial | Teeth per inch of the blade | Orbit      |
|----------------------|---------------------------|-----------------------------|------------|
| Soft wood            | 5–6                       | 6                           | Max. orbit |
| Hard wood            | 3–4                       | 6                           | Med. orbit |
| Mild steel, aluminum | 3–6                       | 14–24                       | No orbit   |
| Stainless steel      | 3–4                       | 14–24                       | No orbit   |
| Plastic              | 1–4                       | 10–12                       | Min. orbit |

## SAWDUST REMOVAL

### Dust blower

The dust blower helps clear the cutting area of debris created from the blade.

To turn the dust blower on: slide the dust blower switch to the “” position.

To turn the dust blower off: slide the dust blower switch to the “” position.

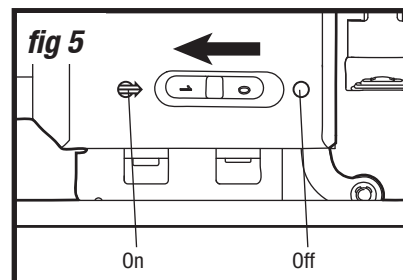

## ASSEMBLY INSTRUCTIONS

### INSTALLING THE SAW BLADE (fig 6)

1. Unplug the jigsaw from the power supply.
2. Turn the tool upside down, depress the tool-less blade clamp, and insert the blade into the slot of the clamp as far as it can go. The back of the blade must rest in the groove of the guide roller (fig 7).
3. Release the tool-less blade clamp to lock the blade. Pull on the blade to check that it is securely locked in place.

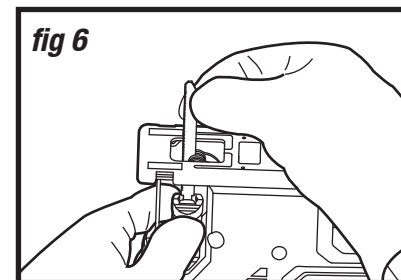

### REMOVING THE SAW BLADE

1. Unplug the jigsaw from the power supply.
2. Turn the tool upside down; depress the tool-less blade clamp to remove the blade.

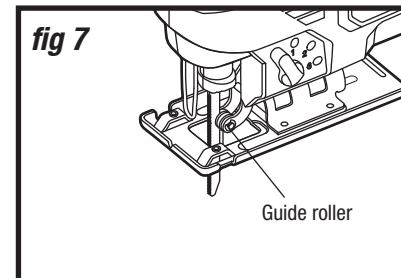

**NOTICE:** For use with both “T” and “U” shanked blades.



### CAUTION!

- For all work or when changing the blade, always wear protective gloves. The sharp edge of the blade will cause personal injury. The blade can be very hot while working.
- Allow the blade to cool after use. The blade can become dangerously hot.

### WARNING!

- Check that the blade is correctly attached. An incorrect or insecurely fastened blade can come loose during operation and cause a hazard.
- Always ensure that the tool is turned OFF and unplugged from the power supply before making any adjustments and installing any attachments.

**ATTACHING THE EDGE GUIDE (fig 8)**

1. Loosen the two edge guide locking knobs.
2. Insert the bar of the edge guide through the slots in the base of the jigsaw. The edge guide can be inserted from either side of the base, with the edge guide facing down.
3. Measure the distance from the edge of the workpiece to the line of the cut. Slide the edge guide to this desired distance and tighten the locking knobs to secure the edge guide in place.

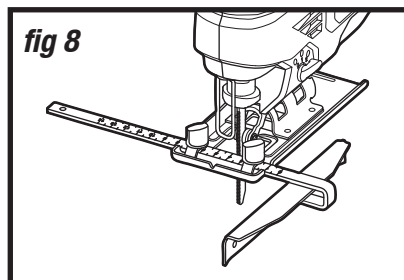
**ADJUSTING THE SHOE PLATE FOR ANGULAR CUTTING (fig 9)**

1. Use the hex key to loosen the two hex screws located on the underside of the tool.
2. Move the shoe plate slightly forward and tilt it to the desired angle between 0° and 45° left or right, using the scale marked on the base bracket. If the required angle is 0° or 45° to the left or right, push the shoe plate backwards so that the teeth on the shoe plate mesh with the retaining teeth.
3. Securely retighten the hex screws.

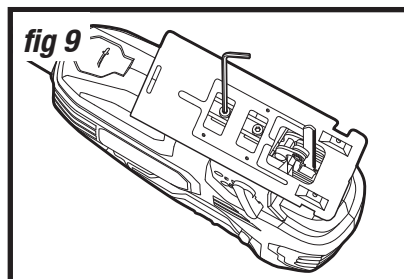

Accurate work requires a trial cut: measure the work after cutting and reset the angle setting until the correct setting is achieved.

**WARNING!**

- Always ensure that the tool is turned OFF and unplugged from the power supply before making any adjustments and installing any attachments.

**OPERATING INSTRUCTIONS****TURNING ON AND OFF (fig 10)**

1. Connect the power cord of your jigsaw to a standard household power outlet.
2. To turn the saw ON, depress the on/off trigger switch.
3. To turn the tool OFF, release the trigger switch.
4. To lock the on/off trigger switch in the "on" position, press the trigger switch and, while holding it "on", press in the lock-on button from either side. The lock-on button allows the operator to keep the jigsaw running without squeezing the trigger switch. This feature is convenient for continuous sawing applications.
5. To release the lock-on button, press and release the trigger switch.

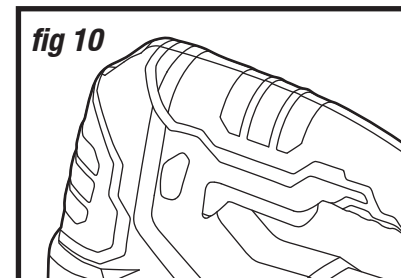
**STRAIGHT CUTTING (fig 11)**

A straight cut can be made by clamping a piece of wood or a straight edge to the workpiece and guiding the edge of the saw against it. Make the cut from one direction only. Never cut partway and then complete the cut from the opposite end.

The straight cut can be also made by using the parallel guide supplied with this tool.

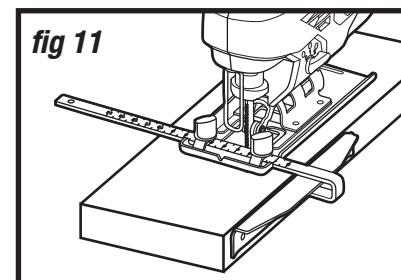
**CAUTION!**

- Allow the blade to come to a complete standstill before setting the jigsaw down.

**WARNING!**

- Always ensure that the tool is turned OFF and unplugged from the power supply before making any adjustments and installing any attachments.
- Make sure the switch is not locked in the ON position before plugging your jigsaw.



## GENERAL CUTTING

1. Make sure that the workpiece is firmly clamped to prevent the workpiece from moving while cutting.
2. Use the appropriate type and size of blade for the workpiece material and size.
3. Check for clearance behind the workpiece so that the blade will not impact another surface.
4. Clearly mark the line of cut.
5. Hold the saw firmly. Make sure to keep your hand on the insulated gripping areas only.
6. Use the variable speed dial to set the speed. Turn on the jigsaw and bring it to the maximum desired cutting speed before applying the blade to the workpiece.
7. Do not force the tool. Keep the shoe plate flat against the workpiece while cutting. Use only enough steady pressure on the blade to keep the saw cutting.
8. Reduce pressure as the blade comes to the end of the cut.
9. Allow the saw to come to a complete stop before removing the blade from the workpiece.
10. If sawing fiberglass, plaster, wallboard, or spackling compound, clean the saw motor vents frequently with a vacuum or compressed air. Always wear safety goggles when cleaning tools using compressed air. These materials are highly abrasive and may accelerate the wear on motor bearings and brushes.

## METAL CUTTING

When cutting metal, clamp the material down. Be careful to move the saw along slowly. Use lower speeds. Do not twist, bend, or force the blade. If the saw jumps or bounces, use a blade with finer teeth. If the blade seems clogged when cutting soft metal, use a blade with coarser teeth.

For easier cutting, lubricate the blade with a stick of cutting wax, if available, or cutting oil when cutting steel. Thin metal should be sandwiched between two pieces of wood or tightly clamped onto a single piece of wood (wood on top of the metal). Draw the cut lines or design on the top piece of wood.

**NOTICE:** Always apply a steady, firm, downward pressure on the front of the saw as you cut. This will keep the saw blade from jumping out of the workpiece.



### WARNING!

- Do not allow familiarity with the saw to make you careless.
- Always securely clamp and support the workpiece. Always maintain proper control of the jigsaw. Failure to clamp and support the workpiece and loss of control of the saw could result in serious injury.

## PLUNGE CUTTING (fig 12)

Plunge cutting is useful and time-saving for making rough openings in soft materials. It makes it unnecessary to drill a hole for an inside or pocket cut.

1. Draw cutting lines for the opening.
2. Hold the saw firmly and tilt it forward so the toe of the shoe plate rests on the workpiece.
3. Make sure that the blade is well clear of the workpiece.
4. With the toe of the shoe plate held firmly against the workpiece to prevent side wobble, start the saw and then gradually lower the blade into the workpiece.
5. When the blade touches the workpiece, continue pressing down on the toe of the shoe plate.
6. Slowly pivot the saw like a hinge until the blade cuts through the workpiece and the shoe plate rests flat on the workpiece.
7. Then begin sawing in the usual manner along the cut line.

fig 12

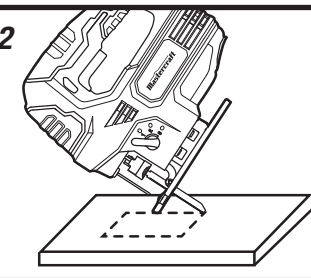

## CUTTING CURVES

Curved cuts can be made with the jigsaw by guiding the direction of the cut with pressure applied on the saw.

## CUTTING A CIRCLE (fig 13)

1. Before attaching the edge guide, draw a circle and drive a finishing nail into the workpiece at the centre of the circle.
2. Drill or plunge cut near the circle's edge.
3. Turn the saw off and disconnect the plug from the power source.
4. Attach the edge guide to the saw with the edge guide facing "up".
5. The distance from the finishing nail to the blade should be equal to the circle radius.
6. Insert the plug into the power source, hold the saw firmly, squeeze the trigger and slowly push the saw forward. To make a hole, cut from inside the circle. To make wheels or discs, cut from the outside.

fig 13

Finishing nail

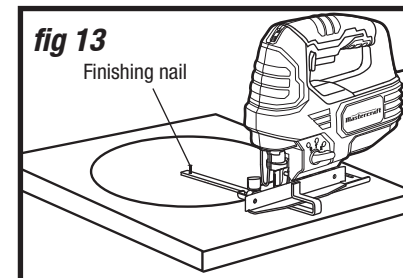

**NOTICE:** Cut slowly so the blade will stay straight in the cut. Place small wedges in the cut to keep the inner circle from spreading when near the end of the cut.



### WARNING!

- Do not try to plunge cut into hard materials, such as steel.

**MAINTENANCE****BEFORE EACH USE**

1. Inspect the jigsaw, the trigger switch, the cord and the accessories for damage.
2. Check for damaged, missing, or worn parts.
3. Check for loose screws, misalignment or binding of moving parts, or any other condition that may affect the operation.
4. If abnormal vibration or noise occurs, turn the tool off immediately and have the problem corrected before further use.
5. Unplug the tool from power source before cleaning or performing any maintenance. Using compressed air may be the most effective cleaning method. Always wear safety goggles when cleaning tools using compressed air.

**CAUTION!**

- Do not allow brake fluids, gasoline and petroleum-based products, penetrating oil, etc. come into contact with plastic parts. These substances contain chemicals that can damage, weaken, or destroy plastic.
- When servicing, use only identical replacement parts. The use of any other parts may create a hazard or cause damage to the product.
- Use only accessories that are recommended for this jigsaw by the manufacturer. Accessories that may be suitable for one tool may become hazardous when used with another tool.
- Maintain tools with care. Keep cutting tools sharp and clean. Properly maintained tools with sharp cutting edges are less likely to bind, and are easier to control.
- To ensure safety and reliability, all repairs should be performed by a qualified service technician.

**TROUBLESHOOTING**

| Problem                  | Possible Causes                             | Solution                           |
|--------------------------|---------------------------------------------|------------------------------------|
| The motor does not start | The tool is not connected to a power source | Connect the tool to a power source |
| Blade cannot be removed  | Saw dust in the slot                        | Clean the clamp slot with a brush  |
| Cutting is difficult     | Saw blade is worn                           | Replace the saw blade              |

If the problem remains unsolved after performing the checks described above, call the toll-free helpline at 1-800-689-9928.

## EXPLODED VIEW

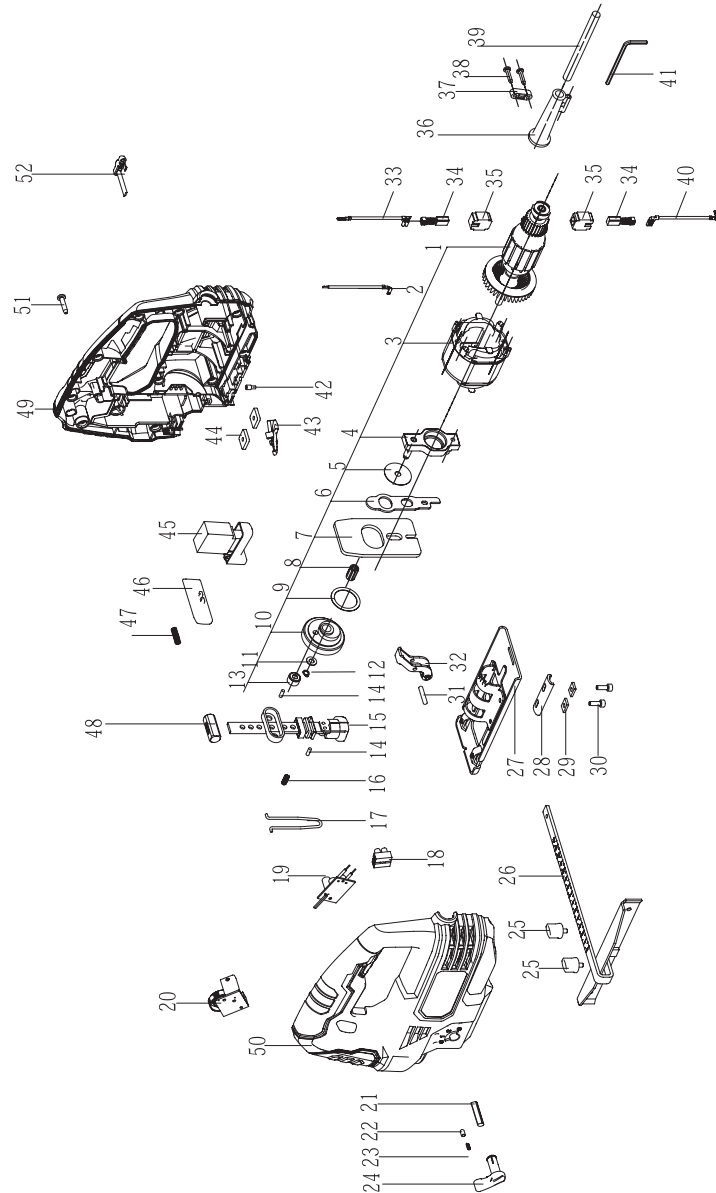

| No. | Part No.   | Description              |
|-----|------------|--------------------------|
| 1   | 2750883000 | Rotor                    |
| 2   | 2823927000 | Internal Wire Assembly   |
| 3   | 2740103000 | Stator                   |
| 4   | 2822537000 | Bearing Support Assembly |
| 5   | 3700214000 | Washer                   |
| 6   | 3704216000 | Pendulum Plate           |
| 7   | 3704217000 | Counterweight            |
| 8   | 5700184000 | Needle Bearing           |
| 9   | 3700181000 | Washer A                 |
| 10  | 2822554000 | Gear Set                 |
| 11  | 3700197000 | Washer                   |
| 12  | 5660004000 | Circlips For Shaft       |
| 13  | 3520415000 | Crank Roller             |
| 14  | 3550147000 | Needle Pin               |
| 15  | 2822536000 | Plunger Assembly         |
| 16  | 3660060000 | Spring                   |
| 17  | 3650008000 | Wire Guard               |
| 18  | 4930004000 | Connector                |
| 19  | 4890462000 | PCB Assembly             |
| 20  | 4900270000 | Speed Adjustor           |
| 21  | 3700237000 | Pendulum Lever Shaft     |
| 22  | 3700191000 | Cap                      |
| 23  | 3660050000 | Spring B                 |
| 24  | 3120507000 | Pendulum Lever           |
| 25  | 3400175000 | Knob                     |
| 26  | 3700675000 | Rip Fence                |

| No. | Part No.   | Description                |
|-----|------------|----------------------------|
| 27  | 2821924000 | Base Plate Assembly        |
| 28  | 3703598000 | Clamp                      |
| 29  | 3700149000 | Square Washer              |
| 30  | 5620011000 | Hexagon Socket Screw       |
| 31  | 3550177000 | Guiding Roller Support Pin |
| 32  | 2822532000 | Roller Support Set         |
| 33  | 2823942000 | Internal Wire Assembly     |
| 34  | 4960008000 | Carbon Brush               |
| 35  | 2800018000 | Brush Holder               |
| 36  | 3121037000 | Cord Guard                 |
| 37  | 3120234000 | Cord Anchorage             |
| 38  | 5610024000 | Tapping Screw              |
| 39  | 4810002000 | Power Cord & Plug          |
| 40  | 2823943000 | Internal Wire Assembly     |
| 41  | 5680019000 | Hexagon Wrench             |
| 42  | 3550146000 | Located Pin                |
| 43  | 3126385000 | Blade Cover                |
| 44  | 3700164000 | Square Nut                 |
| 45  | 4870475000 | Trigger Switch             |
| 46  | 3126146000 | Lock Button                |
| 47  | 3660057000 | Spring                     |
| 48  | 3520427000 | Upper Sliding Bearing      |
| 49  | 3321806000 | Right Housing              |
| 50  | 3321807000 | Left Housing               |
| 51  | 5610042000 | Tapping Screw              |
| 52  | 3126386000 | Blow Switch                |

If any parts are missing or damaged, or if you have any questions, please call the Toll-free Helpline, at 1-800-689-9928.



This Mastercraft product is guaranteed for a period of **3 years from the date of original retail purchase** against defects in workmanship and materials, except for the following components:

- a) Component A: Batteries, chargers and carrying case, which are guaranteed for a period of 2 years from the date of original retail purchase against defects in workmanship and materials;
- b) Component B: Accessories, which are guaranteed for a period of 1-year from the date of original retail purchase against defects in workmanship and materials.

Subject to the conditions and limitations described below, this product, if returned to us with proof of purchase within the stated warranty period and if covered under this warranty, will be repaired or replaced (with the same model, or one of equal value or specification), at our option. We will bear the cost of any repair or replacement and any costs of labour relating thereto.

**These warranties are subject to the following conditions and limitations:**

- a) a bill of sale verifying the purchase and purchase date must be provided;
- b) this warranty will not apply to any product or part thereof which is worn or broken or which has become inoperative due to abuse, misuse, accidental damage, neglect or lack of proper installation, operation or maintenance (as outlined in the applicable owner's manual or operating instructions) or which is being used for industrial, professional, commercial or rental purposes;
- c) this warranty will not apply to normal wear and tear or to expendable parts or accessories that may be supplied with the product that are expected to become inoperative or unusable after a seasonable period of use;
- d) this warranty will not apply to routine maintenance and consumable items such as, but not limited to, fuel, lubricants, vacuum bags, blades, belts, sandpaper, bits, fluids, tune-ups or adjustments;
- e) this warranty will not apply where damage is caused by repairs made or attempted by others (i.e. persons not authorized by the manufacturer);
- f) this warranty will not apply to any product that was sold to the original purchaser as a reconditioned or refurbished product (unless otherwise specified in writing);
- g) this warranty will not apply to any product or part thereof if any part from another manufacturer is installed therein or any repairs or alterations have been made or attempted by unauthorized persons;
- h) this warranty will not apply to normal deterioration of the exterior finish, such as, but not limited to, scratches, dents, paint chips, or to any corrosion or discolouring by heat, abrasive and chemical cleaners; and
- i) this warranty will not apply to component parts sold by and identified as the product of another company, which shall be covered under the product manufacturer's warranty, if any.

**Additional Limitations**

This warranty applies only to the original purchaser and may not be transferred. Neither the retailer nor the manufacturer shall be liable for any other expense, loss or damage, including, without limitation, any indirect, incidental, consequential or exemplary damages arising in connection with the sale, use or inability to use this product.

**Notice to Consumer**

This warranty gives you specific legal rights, and you may have other rights, which may vary from province to province. The provisions contained in this warranty are not intended to limit, modify, take away from, disclaim or exclude any statutory warranties set forth in any applicable provincial or federal legislation.

**IMPORTED BY MASTERCRAFT CANADA TORONTO, CANADA M4S 2B8**

