

model no. 054-7240-8

Mastercraft © IMD

3 X 21" BELT SANDER

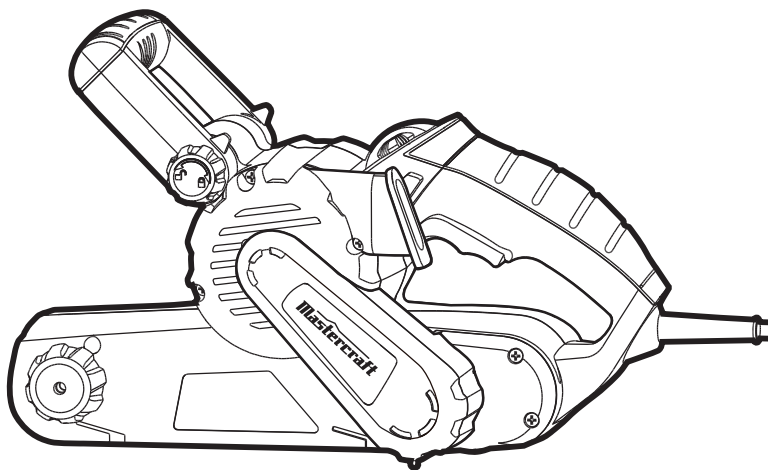

IMPORTANT:

Read and understand this instruction manual thoroughly before using the product.

INSTRUCTION MANUAL

TABLE OF CONTENTS

Technical Specifications	4
Safety Guidelines	5–8
Key Parts Diagram	9–10
Important Information	11
Assembly Instructions	12–13
Operating Instructions	14
Maintenance	15
Troubleshooting	16
Part list	17–18
Warranty	19–20

NOTE: If any parts are missing or damaged, or if you have any questions, please call our toll-free helpline at 1-800-689-9928

**SAVE THESE INSTRUCTIONS**

- This manual contains important safety and operating instructions. Read all instructions and follow them with use of this product.

TECHNICAL SPECIFICATIONS

Rated voltage	120V~, 60Hz
Rated power input	6.0 A
Belt speed	600–1100 ft/min
Belt size	3 x 21"
Net weight	7 lb 1 oz (3.2 kg)

RULES FOR SAFE OPERATION**WARNING!**

Safety symbols in this Instruction Manual are used to flag possible dangers. The safety symbols and their explanations require your full understanding. The safety warnings do not, by themselves, eliminate any danger, nor are they substitutes for proper accident prevention measures.

**WARNING!**

This Safety Alert Symbol indicates caution, warning, or danger. Failure to obey a safety warning can result in serious injury to yourself or others. To reduce the risk of injury, fire, or electric shock, always follow the safety precautions.

KNOW YOUR TOOL

To operate this tool, carefully read this Instruction Manual and all labels affixed to the Belt Sander before using. Keep this Instruction Manual available for future reference.

IMPORTANT

This tool should only be serviced by a qualified service technician. For more information, call the toll-free helpline at 1-800-689-9928.

READ ALL INSTRUCTIONS THOROUGHLY**SAVE THESE INSTRUCTIONS****SAFETY GUIDELINES FOR POWER TOOLS****WARNING!**

Read all safety warnings and instructions. Failure to follow the warnings and instructions may result in electric shock, fire and/or serious injury.

SAVE ALL WARNINGS AND INSTRUCTIONS FOR FUTURE REFERENCE.

The term “power tool” in the warnings refers to your mains-operated (corded) power tool or battery-operated (cordless) power tool.

WORK AREA SAFETY

- **Keep work area clean and well lit.** Cluttered or dark areas invite accidents.
- **Do not operate power tools in explosive atmospheres, such as in the presence of flammable liquids, gases or dust.** Power tools create sparks, which may ignite the dust or fumes.
- **Keep children and bystanders away while operating a power tool.** Distractions can cause you to lose control.

ELECTRICAL SAFETY

- **Power tool plugs must match the outlet.** Never modify the plug in any way. Do not use any adapter plugs with earthed (grounded) power tools. Unmodified plugs and matching outlets will reduce risk of electric shock.
- **Avoid body contact with earthed or grounded surfaces such as pipes, radiators, ranges and refrigerators.** There is an increased risk of electric shock if your body is earthed or grounded.
- **Do not expose power tools to rain or wet conditions.** Water entering a power tool will increase the risk of electric shock.
- **Do not abuse the cord.** Never use the cord for carrying, pulling or unplugging the power tool. Keep the cord away from heat, oil, sharp edges or moving parts. Damaged or entangled cords increase the risk of electric shock.
- **When operating a power tool outdoors, use an extension cord suitable for outdoor use.** Use of a cord suitable for outdoor use reduces the risk of electric shock.
- **If operating a power tools in a damp location is unavoidable, use a ground-fault circuit interrupter (GFCI) protected supply.** Use of a GFCI reduces the risk of electric shock.

PERSONAL SAFETY

- **Stay alert, watch what you are doing and use common sense when operating a power tool.** Do not use a power tool while you are tired or under the influence of drugs, alcohol or medication. A moment of inattention while operating power tools may result in serious personal injury.
- **Use personal protective equipment.** Always wear eye protection. Protective equipment such as dust mask, non-skid safety shoes, hard hat, or hearing protection used for appropriate conditions will reduce personal injuries.
- **Prevent unintentional starting.** Ensure that the switch is in the off-position before connecting to power source or battery pack, picking up or carrying the tool. Carrying power tools with your finger on the switch or energising power tools that have the switch on invites accidents.
- **Remove any adjusting key or wrench before turning the power tool on.** A wrench or a key left attached to a rotating part of the power tool may result in personal injury.
- **Do not overreach. Keep proper footing and balance at all times.** This enables better control of the power tool in unexpected situations.
- **Dress properly. Do not wear loose clothing or jewellery. Keep your hair, clothing and gloves away from moving parts.** Loose clothes, jewellery or long hair can be caught in moving parts.
- **If devices are provided for the connection of dust extraction and collection facilities, ensure that these are connected and properly used.** Use of dust collection devices can reduce dust-related hazards.

POWER TOOL USE AND CARE

- **Do not force the power tool.** Use the correct power tool for your application. The correct power tool will do the job better and more safely at the rate for which it was designed.
- **Do not use the power tool if the switch does not turn it on and off.** Any power tool that cannot be controlled with the switch is dangerous and must be repaired.

- **Disconnect the plug from the power source and/or the battery pack from the power tool before making any adjustments, changing accessories, or storing power tools.** Such preventive safety measures reduce the risk of starting the power tool accidentally.
- **Store idle power tools out of the reach of children and do not allow persons unfamiliar with the power tool or these instructions to operate the power tool.** Power tools are dangerous in the hands of untrained users.
- **Maintain power tools.** Check for misalignment or binding of moving parts, breakage of parts and any other condition that may affect the power tool's operation. If damaged, have the power tool repaired before use. Many accidents are caused by poorly maintained power tools.
- **Keep cutting tools sharp and clean.** Properly maintained cutting tools with sharp cutting edges are less likely to bind and are easier to control;
- **Use the power tool, accessories, tool bits, etc. in accordance with these instructions, taking into account the working conditions and the work to be performed.** Use of the power tool for operations different from those intended could result in a hazardous situation.

SERVICE

- **Have your power tool serviced by a qualified repair person using only identical replacement parts.** This will ensure that the safety of the power tool is maintained.

SPECIFIC SAFETY RULES FOR BELT SANDER

- **Hold the power tool by insulated gripping surfaces when performing an operation where the cutting accessory may contact hidden wiring or its own cord.** If a cutting accessory contacts a "live" wire, it may cause the exposed metal parts of the power tool to become "live" and shock the operator.
- **The label on your tool may include the following symbols. The symbols and their definitions are as follows:**

V Volts

A Amperes

Hz Hertz

W Watts

min Minutes

~ Alternating current

— — — Direct current

n_0 No-load speed

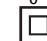
 Class II Construction

.../min Revolutions or reciprocation per minute

 Grounding terminal

BPM Beats per minute

 WARNING – To reduce the risk of injury, user must read instruction manual.

- **A suitable breathing respirator must be worn while sanding lead paint, some woods and metal to avoid breathing the harmful/toxic dust or air.**
- **Always wear safety goggles and a dust mask when sanding, especially sanding over-head.**
- **The machine is not suitable for wet sanding.**
- **Do not use sanding paper larger than needed.** Extra paper extending beyond the sanding pad can also cause serious lacerations.
- **Secure the workpiece.** A workpiece clamped with clamping devices or in a vice is held more securely than by hand.
- **Wear protective gloves when changing cutting tools.** Cutting tools become hot after prolonged usage.

PACKAGE CONTENTS

Belt sander, dust bag, fine belt, coarse belt and instruction manual

KEY PARTS DIAGRAM

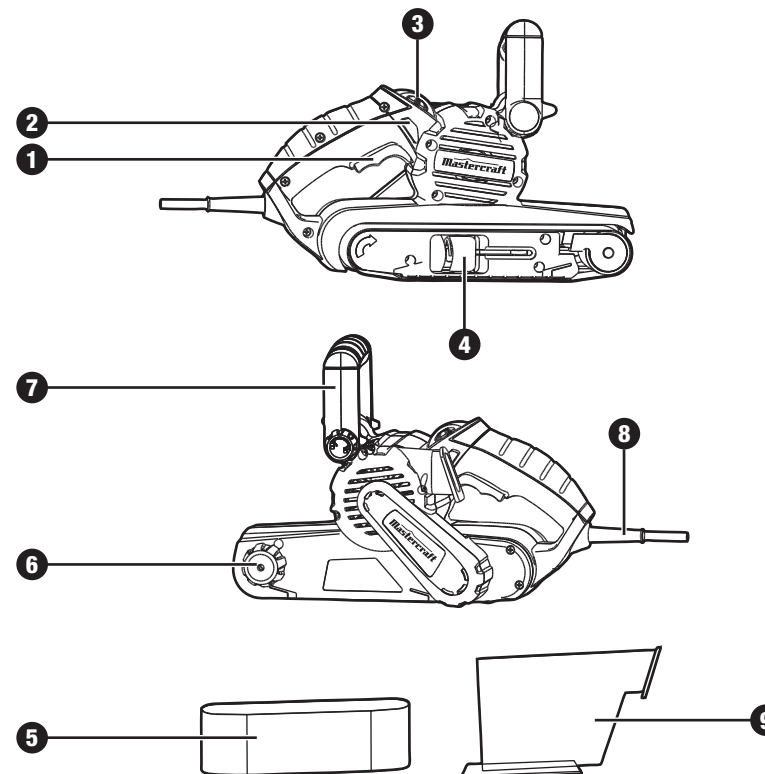

WARNING!

- Remove the sander from the package and examine it carefully. Do not discard the carton or any packaging material until all parts have been examined.

No.	Part
1	ON/OFF 2-finger trigger switch
2	"Lock-ON" button
3	Adjustable belt speed knob
4	Quick release tension lever
5	Sander belt

No.	Part
6	Belt adjustment knob
7	3-position adjustable handle
8	Cord guard
9	Dust collection bag

IMPORTANT INFORMATION

Before attempting to use this sander, familiarize yourself with all its operating features and safety requirements.

This sander is designed to sand wood surfaces, remove lacquer, varnish and other types of coating.

ADJUSTABLE BELT SPEED KNOB

Rotate the adjustable belt speed knob to select the desired speed necessary for the at-hand application.

QUICK RELEASE TENSION LEVER

Lift lever for fast and easy belt adjustments.

DUST COLLECTION BAG

When sanding, attach the dust bag to the sander.

ASSEMBLY INSTRUCTIONS

SANDER BELT (fig 1)

To install belt:

1. Place sander on its side and pull the quick release tension lever out, as shown in fig 1.
2. Insert the new belt around both rollers. Ensure the arrow on the inside of belt is pointing in the direction of rotation as indicated on housing.
3. Once the belt is centred over the rollers and bottom plate, place quick release tension lever back in its original position to restore belt tension.

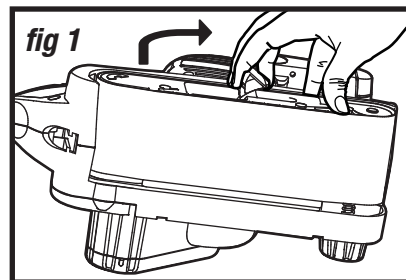

To remove belt:

1. Place the sander on its side and rotate the quick-release lever away from the sander, as shown in fig.1.
2. With the sander on its side and the open side facing you, you can easily remove the belt.

BELT ADJUSTMENT KNOB (fig 2)

Your sander features an automatic belt-control system that helps to keep the belt running in the centre of the rollers. The system has been preset at the factory, but may require adjustment to avoid frayed belt edges and wear on the sander frame when a belt is changed or an older belt stretches.

To adjust the belt (if necessary)

1. Plug in the cord with the tool OFF.
2. Hold handle of the sander with one hand and tilt the sander so that the belt is facing the operator.
3. Squeeze trigger switch to begin rotation of the belt.
4. Turn the belt adjustment knob counterclockwise to move the belt away from the sander motor. Turn the belt adjustment knob clockwise to move it towards the sander motor.
5. Release the trigger switch and make sure that the belt has come to a complete stop before setting the tool down.

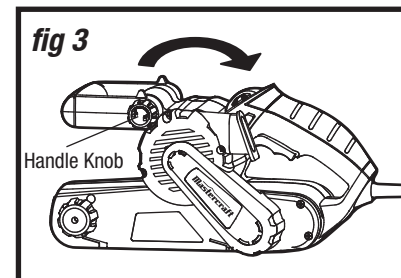
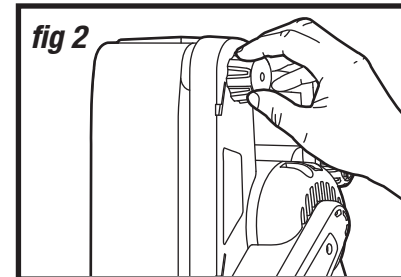

3-position adjustable handle

Rotate the handle knob and position handle to one of the three positions. Tighten the knob to secure handle in place (see fig 3).

INSTALLING AND REMOVING THE DUST COLLECTION BAG

To install: Align the edge of dust port with the slot of dust bag outlet. Insert into tool until firmly seated (see fig 4).

To remove: Lift dust bag outlet up, and gently pull on dust bag.

To clean the dust bag: Empty the dust bag by unzipping the lever lock (see B in fig 5) located on bottom of the bag, gently tap to remove dust.

Occasionally, slip the bag off of the frame and turn bag inside out. Brush dust off of the lining using a soft brush.

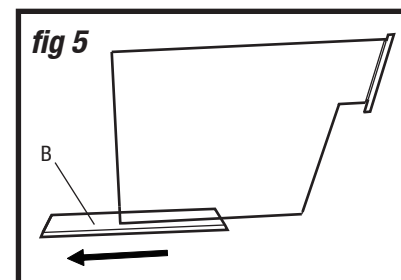
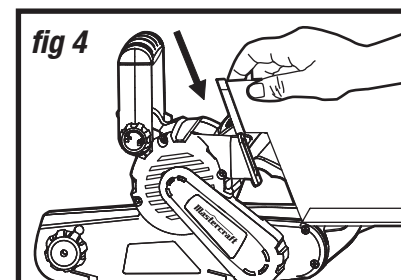

WARNING!

- Always disconnect the sander from its power supply before attaching or removing sandpaper.

OPERATING INSTRUCTIONS

TURNING THE SANDER ON AND OFF

The tool can be turned “ON” or “OFF” by squeezing or releasing the trigger.

“LOCK-ON” BUTTON

1. The tool is also equipped with a “Lock-ON” button that allows continuous operation without continually holding the trigger.
2. To lock switch “ON”: Squeeze trigger, depress the “Lock-ON” button, and release trigger.
3. To unlock switch: Squeeze trigger, then release trigger without depressing the “Lock-ON” button.

GENERAL SANDING

1. Be sure the cord is clear of the belt. Grasp the handles firmly.
2. Start the sander off of the work surface to avoid gouging the belt. NEVER start or stop the sander with the belt in contact with the work surface.
3. Place the heel of the sander on the work surface first. Then, with a forward motion, begin the sanding stroke as the tool is lowered onto the work surface.
4. Use short, overlapping strokes, moving the sander slowly back and forth across the work surface.
5. Avoid tilting or rocking the sander or sanding in one spot for too long. This causes gashes and hollows in the surface. Do not apply pressure to the sander. The sander is the weighted for the pressure needed. Too much pressure will overload the motor and reduce the belt speed.
6. Begin sanding with a coarser grit sandpaper and gradually use finer grits, until the desired finish is achieved. Do not switch from a coarse grit to a very fine grit in one step.
7. To stop, lift the sander from the work surface, then turn the sander OFF. Disengage the Lock-ON button. Allow the sander to come to a complete stop before setting it down. A moving belt will cause the sander to “run away” even if the motor is off.



WARNING!

- Before sanding small workpieces, ensure workpiece is securely held in a vise or clamp.
- Sanding can produce clouds of fine dust particles that can ignite in the presence of sparks or an open flame. To avoid injury, always use your sander in a well-ventilated area.
- For your safety and to avoid damage, turn the sander ON and OFF only when the sander is not in contact with a surface.



WARNING!

- Do not let brake fluids, gasoline, petroleum-based products, penetrating oil, etc., come in contact with plastic parts. They contain chemicals that can damage, weaken or destroy plastic.
- To ensure safety and reliability, all repairs should be performed by a qualified service technician.
- If the power cord is damaged, it must be replaced with an identical replacement part and be installed by an authorized service technician.

No.	Part No.	Description
1	2740085000	Stator
2	2750093000	Rotor
3	2800026000	Brush Holder
4	2820230000	Bracket Assembly
5	2820334000	Internal Wire Assembly 1
6	3120234000	Cord Anchorage
7	3120398000	Front Pulley
8	3120516000	Lock Button
9	3121011000	Cord Guard
10	3121026000	Bearing Holder
11	3121034000	Timing Belt
12	3128299000	Rubber Bushing
13	3121102000	Left Housing
14	3121103000	Belt Cover
15	3121106000	Fan Baffle
16	3121107000	Mounting Cover
17	3121113000	Lever
18	3121115000	Front Handle Cover
19	3320165000	Right Housing
20	3320166000	Middle Housing
21	3320182000	Front Handle
22	3400036000	Lock Knob
23	3400037000	Adjusting Knob
24	3420101000	Big Belt Pulley
25	3420102000	Small Belt Pulley
26	3420308000	Mounting
27	3420309000	Rear Pulley
28	3520032000	Gear
29	3550143000	Front Pulley Shaft
30	3550145000	Gear Shaft
31	3550331000	Rear Pulley Shaft
32	3660129000	Spring
33	3660130000	Spring

No.	Part No.	Description
34	3660131000	Spring
35	3660242000	Spring
36	3700145000	Washer A
37	3700183000	Washer C
38	3700487000	Epoxy Board
39	3700564000	Belt Control Plate
40	3700566000	Mounting Plate
41	3700629000	Front Pulley Bracket
42	4810002000	Power Cord & Plug
43	4870305000	Switch
44	4900036000	Speed Adjustor
45	4960010000	Carbon Brush
46	4970057000	Inductor Assembly
47	4970273000	Capacitor
48	5610006000	Tapping Screw
49	5610024000	Tapping Screw
50	5610034000	Tapping Screw
51	5610049000	Tapping Screw
52	5610093000	Tapping Screw
53	5610106000	Tapping Screw
54	5630011000	Hexagon Nut
55	5650017000	Plain Washer
56	5650038000	Plain Washer
57	5650048000	Wave Washer
58	5650049000	Plain Washer
59	5650050000	Plain Washer
60	5660029000	E Ring
61	5680017000	Rivet
62	5700004000	Ball Bearing
63	5700005000	Ball Bearing
64	5700006000	Ball Bearing
65	5700031000	Needle Bearing



This Mastercraft product is guaranteed for a period of **3 years from the date of original retail purchase** against defects in workmanship and materials, except for the following components:

- a) Component A: Batteries, chargers and carrying case, which are guaranteed for a period of 2 years from the date of original retail purchase against defects in workmanship and materials;
- b) Component B: Accessories, which are guaranteed for a period of 1-year from the date of original retail purchase against defects in workmanship and materials.

Subject to the conditions and limitations described below, this product, if returned to us with proof of purchase within the stated warranty period and if covered under this warranty, will be repaired or replaced (with the same model, or one of equal value or specification), at our option. We will bear the cost of any repair or replacement and any costs of labour relating thereto.

These warranties are subject to the following conditions and limitations:

- a) a bill of sale verifying the purchase and purchase date must be provided;
- b) this warranty will not apply to any product or part thereof which is worn or broken or which has become inoperative due to abuse, misuse, accidental damage, neglect or lack of proper installation, operation or maintenance (as outlined in the applicable owner's manual or operating instructions) or which is being used for industrial, professional, commercial or rental purposes;
- c) this warranty will not apply to normal wear and tear or to expendable parts or accessories that may be supplied with the product that are expected to become inoperative or unusable after a seasonable period of use;
- d) this warranty will not apply to routine maintenance and consumable items such as, but not limited to, fuel, lubricants, vacuum bags, blades, belts, sandpaper, bits, fluids, tune-ups or adjustments;
- e) this warranty will not apply where damage is caused by repairs made or attempted by others (i.e. persons not authorized by the manufacturer);
- f) this warranty will not apply to any product that was sold to the original purchaser as a reconditioned or refurbished product (unless otherwise specified in writing);
- g) this warranty will not apply to any product or part thereof if any part from another manufacturer is installed therein or any repairs or alterations have been made or attempted by unauthorized persons;
- h) this warranty will not apply to normal deterioration of the exterior finish, such as, but not limited to, scratches, dents, paint chips, or to any corrosion or discolouring by heat, abrasive and chemical cleaners; and
- i) this warranty will not apply to component parts sold by and identified as the product of another company, which shall be covered under the product manufacturer's warranty, if any.

If any parts are missing or damaged, or if you have any questions, please call the Toll-free Helpline, at 1-800-689-9928.

Additional Limitations

This warranty applies only to the original purchaser and may not be transferred. Neither the retailer nor the manufacturer shall be liable for any other expense, loss or damage, including, without limitation, any indirect, incidental, consequential or exemplary damages arising in connection with the sale, use or inability to use this product.

Notice to Consumer

This warranty gives you specific legal rights, and you may have other rights, which may vary from province to province. The provisions contained in this warranty are not intended to limit, modify, take away from, disclaim or exclude any statutory warranties set forth in any applicable provincial or federal legislation.

IMPORTED BY MASTERCRAFT CANADA TORONTO, CANADA M4S 2B8