

# MAXIMUM™

**5" (125 mm)**

**Heavy-duty Angle Grinder**



**Model No. 054-4297-2**

**IMPORTANT:**

Please read this manual carefully before using this product, and save it for reference.

**INSTRUCTION  
MANUAL**



### TABLE OF CONTENTS

Technical Specifications	4
Safety Guidelines	5
Key Parts Diagram	11
Important Information	12
Assembly Instructions	13
Operating Instructions	16
Maintenance	18
Troubleshooting	20
Parts List	21
Warranty	23

**NOTE:** If any parts are missing or damaged, or if you have any questions, please call our toll-free helpline at 1-888-670-6682.



### SAVE THESE INSTRUCTIONS

- This manual contains important safety and operating instructions. Read all instructions and follow them with use of this product.

**TECHNICAL SPECIFICATIONS**

Rated Voltage	120V~, 60 Hz
Rated Power Input	13A
Rated Speed	10,500 RPM*
Compatible wheel sizes	5" (125 mm) & 4 1/2" (115 mm)
Wheel guard sizes	5" (125 mm) & 4 1/2" (115 mm)
Arbour Size	5/8" (16 mm)
Weight	6 lb 5 oz (2.87 kg)
Supply cord	10' (3 m) SJOW

\*Tool's rated speed is 10,500 RPM; using constant speed control (CSC) the optimized speed is 9000 RPMs.

## **RULES FOR SAFE OPERATION**

### **KNOW YOUR TOOL**

To operate this angle grinder, carefully read this instruction manual and all labels affixed to the tool. Keep this manual available for future reference.

### **IMPORTANT**

This angle grinder should only be serviced by a qualified service technician. For more information, call the toll free helpline at 1-888-670-6682.

### **READ ALL INSTRUCTIONS CAREFULLY**

### **SAVE THESE INSTRUCTIONS**

### **GENERAL POWER TOOL SAFETY WARNINGS**



#### **WARNING!**

Read all safety warnings and instructions. Failure to follow the warnings and instructions may result in electric shock, fire and/or serious injury.

### **SAVE ALL WARNINGS AND INSTRUCTIONS FOR FUTURE REFERENCE.**

The term “power tool” in the warnings refers to your mains-operated (corded) power tool or battery-operated (cordless) power tool.

### **WORK AREA SAFETY**

- **Keep work area clean and well lit.** Cluttered or dark areas invite accidents.
- **Do not operate power tools in explosive atmospheres, such as in the presence of flammable liquids, gases or dust.** Power tools create sparks which may ignite the dust or fumes.
- **Keep children and bystanders away while operating a power tool.** Distractions can cause you to lose control.

### **ELECTRICAL SAFETY**

- **Power tool plugs must match the outlet. Never modify the plug in any way. Do not use any adapter plugs with earthed (grounded) power tools.** Unmodified plugs and matching outlets will reduce risk of electric shock.
- **Avoid body contact with earthed or grounded surfaces, such as pipes, radiators, ranges and refrigerators.** There is an increased risk of electric shock if your body is earthed or grounded.
- **Do not expose power tools to rain or wet conditions.** Water entering a power tool will increase the risk of electric shock.
- **Do not abuse the cord. Never use the cord for carrying, pulling or unplugging the power tool. Keep cord away from heat, oil, sharp edges or moving parts.**

Damaged or entangled cords increase the risk of electric shock.

- **When operating a power tool outdoors, use an extension cord suitable for outdoor use.** Use of a cord suitable for outdoor use reduces the risk of electric shock.
- **If operating a power tool in a damp location is unavoidable, use a ground-fault circuit interrupter (GFCI) protected supply.** Use of a GFCI reduces the risk of electric shock.

## PERSONAL SAFETY

- **Stay alert, watch what you are doing and use common sense when operating a power tool. Do not use a power tool while you are tired or under the influence of drugs, alcohol or medication.** A moment of inattention while operating power tools may result in serious personal injury.
- **Use personal protective equipment. Always wear eye protection.** Protective equipment such as dust mask, non-skid safety shoes, hard hat, or hearing protection used for appropriate conditions will reduce personal injuries.
- **Prevent unintentional starting. Ensure the switch is in the off-position before connecting to power source and/or battery pack, picking up or carrying the tool.** Carrying power tools with your finger on the switch or energising power tools that have the switch on invites accidents.
- **Remove any adjusting key or wrench before turning the power tool on.** A wrench or a key left attached to a rotating part of the power tool may result in personal injury.
- **Do not overreach. Keep proper footing and balance at all times.** This enables better control of the power tool in unexpected situations.
- **Dress properly. Do not wear loose clothing or jewellery. Keep your hair, clothing and gloves away from moving parts.** Loose clothes, jewellery or long hair can be caught in moving parts.
- **If devices are provided for the connection of dust extraction and collection facilities, ensure that these are connected and properly used.** Use of these devices can reduce dust-related hazards.

## POWER TOOL USE AND CARE

- **Do not force the power tool. Use the correct power tool for your application.** The correct power tool will do the job better and more safely at the rate for which it was designed.
- **Do not use the power tool if the switch does not turn it on and off.** Any power tool that cannot be controlled with the switch is dangerous and must be repaired.
- **Disconnect the plug from the power source and/or the battery pack from the power tool before making any adjustments, changing accessories, or storing power tools.** Such preventive safety measures reduce the risk of starting the power tool accidentally.

- **Store idle power tools out of the reach of children and do not allow persons unfamiliar with the power tool or these instructions to operate the power tool.** Power tools are dangerous in the hands of untrained users.
- **Maintain power tools.** Check for misalignment or binding of moving parts, breakage of parts and any other condition that may affect the power tool's operation. If damaged, have the power tool repaired before use. Many accidents are caused by poorly maintained power tools.
- **Keep cutting tools sharp and clean.** Properly maintained cutting tools with sharp cutting edges are less likely to bind and are easier to control.
- **Use the power tool, accessories, tool bits, etc. in accordance with these instructions, taking into account the working conditions and the work to be performed.** Use of the power tool for operations different from those intended could result in a hazardous situation.

### SERVICE

- **Have your power tool serviced by a qualified repair person using only identical replacement parts.** This will ensure that the safety of the power tool is maintained.

### SAFETY GUIDELINES FOR ANGLE GRINDER

- **This power tool is intended to function as a grinder.** Read all safety warnings, instructions, illustrations and specifications provided with this power tool. Failure to follow all instructions listed below may result in electric shock, fire and/or serious injury.
- **Operations such as sanding, wire brushing, polishing or cutting-off are not recommended to be performed with this power tool.** Operations for which the power tool was not designed may create a hazard and cause personal injury.
- **Do not use accessories that are not specifically designed and recommended by the tool manufacturer.** Just because the accessory can be attached to your power tool, it does not assure safe operation.
- **The rated speed of the accessory must be at least equal to the maximum speed marked on the power tool.** Accessories running faster than their rated speed can break and fly apart.
- **The outside diameter and the thickness of your accessory must be within the capacity rating of your power tool.** Incorrectly sized accessories cannot be adequately guarded or controlled.
- **Threaded mounting of accessories must match the grinder spindle thread.** For accessories mounted by flanges, the arbour hole of the accessory must fit the locating diameter of the flange. Accessories that do not match the mounting hardware of the power tool will run out of balance, vibrate excessively and may cause loss of control.

- **Do not use a damaged accessory.** Before each use, inspect the accessory, such as abrasive wheels, for chips and cracks. If the power tool or accessory is dropped, inspect it for damage or install an undamaged accessory. After inspecting and installing an accessory, position yourself and bystanders away from the plane of the rotating accessory and run the power tool at maximum no-load speed for one minute. Damaged accessories will normally break apart during this test time.
- **Wear personal protective equipment.** Depending on the application, use a face shield, safety goggles or safety glasses. As appropriate, wear a dust mask, hearing protectors, gloves and a workshop apron capable of stopping small abrasive or workpiece fragments. The eye protection must be capable of stopping flying debris generated by various operations. The dust mask or respirator must be capable of filtering particles generated by your operation. Prolonged exposure to high intensity noise may cause hearing loss.
- **Keep bystanders a safe distance away from the work area.** Anyone entering the work area must wear personal protective equipment. Fragments of a workpiece or of a broken accessory may fly away and cause injury beyond the immediate area of operation.
- **Hold the power tool by insulated gripping surfaces only, when performing an operation where the cutting accessory may contact hidden wiring or its own cord.** Cutting accessory contacting a "live" wire may make exposed metal parts of the power tool "live" and could give the operator an electric shock.
- **Position the cord clear of the spinning accessory.** If you lose control, the cord may be cut or snagged and your hand or arm may be pulled into the spinning accessory.
- **Never lay the power tool down until the accessory has come to a complete stop.** The spinning accessory may grab the surface and pull the power tool out of your control.
- **Do not run the power tool while carrying it at your side.** Accidental contact with the spinning accessory could snag your clothing, pulling the accessory into your body.
- **Regularly clean the power tool's air vents.** The motor's fan will draw dust inside the housing and excessive accumulation of powdered metal may cause electrical hazards.
- **Do not operate the power tool near flammable materials.** Sparks could ignite these materials.
- **Do not use accessories that require liquid coolants.** Using water or other liquid coolants may result in electrocution or shock.
- **Use the right size of wheel guard when grinding with different size wheel.** Misuse of wheel guard will possibly cause personal injury.



- The label on your tool may include the following symbols. The symbols and their definitions are as follows:

V ..... Volts

A ..... Amperes

Hz ..... Hertz

W ..... Watts

min ..... Minutes

~ ..... Alternating current

— — — ..... Direct current

n ..... Rated speed

n<sub>0</sub> ..... No-load speed

 ..... Class II Construction

.../min ..... Revolutions or reciprocations per minute

 ..... Grounding terminal

BPM ..... Beats per minute

RPM ..... Revolutions per minute

 ..... WARNING – To reduce the risk of injury, user must read instruction manual.

 ..... WARNING – To reduce the risk of injury always wear eye protection.

 ..... WARNING – To reduce the risk of injury always wear ear protection.

## ADDITIONAL SAFETY INSTRUCTIONS FOR GRINDING OPERATIONS

- Use only wheel types that are recommended for your power tool and use only the specific guard designed for the selected wheel. Wheels for which the power tool was not designed cannot be adequately guarded and are unsafe.
- The grinding surface of centre-depressed wheels must be mounted below the plane of the guard lip. An improperly mounted wheel that projects through the plane of the guard lip cannot be adequately protected.
- The guard must be securely attached to the power tool and positioned for maximum safety, so the least amount of wheel is exposed towards the operator. The guard helps to protect the operator from broken wheel fragments, accidental contact with wheel and sparks that could ignite clothing.
- Wheels must be used only for recommended applications. For example: do not grind with the side of a cut-off wheel. Abrasive cut-off wheels are intended for peripheral grinding; side forces applied to these wheels may cause them to shatter.

- **Always use undamaged wheel flanges that are of correct size and shape for your selected wheel.** Proper wheel flanges support the wheel, thus reducing the possibility of wheel breakage. Flanges for cut-off wheels may be different from grinding wheel flanges.
- **Do not use worn down wheels from larger power tools.** Wheels intended for larger power tools are not suitable for the higher speed of a smaller tool and may burst.

### **KICKBACK AND RELATED WARNINGS**

Kickback is the result of power tool misuse and/or incorrect operating procedures or conditions and can be avoided by taking proper precautions, as given below.

- **Maintain a firm grip on the power tool and position your body and arms to allow you to resist kickback forces.** Always use the auxiliary handle, if provided, for maximum control over kickback or torque reaction during start-up. The operator can control torque reactions or kickback forces if proper precautions are taken.
- **Never place your hand near the rotating accessory.** The accessory may kickback over your hand.
- **Do not position your body in the area where the power tool will move if kickback occurs.** Kickback will propel the tool in the direction opposite to the wheel's movement at the point of snagging.
- **Use special care when working corners, sharp edges, etc.** Avoid bouncing and snagging the accessory. Corners, sharp edges or bouncing have a tendency to snag the rotating accessory and cause loss of control or kickback.
- **Do not attach a saw chain, wood carving blade or toothed saw blade.** Such blades create frequent kickback and loss of control.

## PACKAGE CONTENTS

High-performance angle grinder, 5" (125 mm) grinding wheel, 5" (125 mm) & 4 1/2" (115 mm) wheel guards, anti-vibration auxiliary handle, wrench, 2 extra carbon brushes, tote, and instruction manual.

## KEY PARTS DIAGRAM

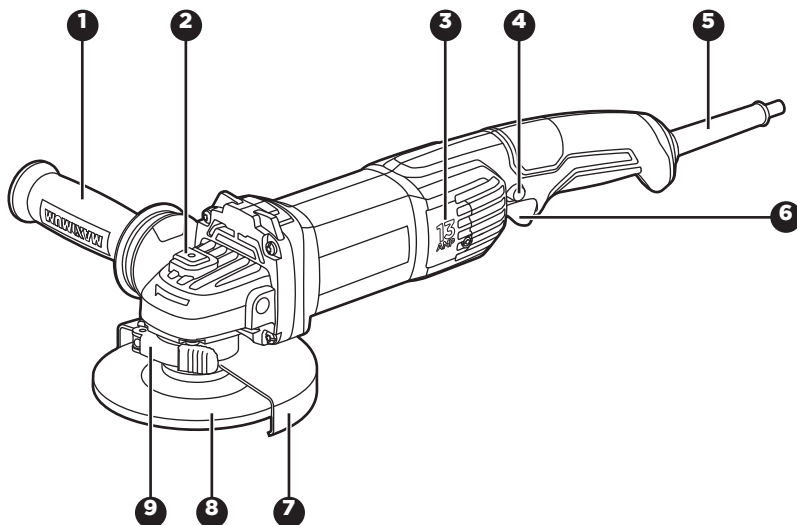

KEY PARTS DIAGRAM

NO.	PART
1	Side handle
2	Spindle-lock button
3	Carbon brush cover
4	Lock-on button
5	Cord guard

NO.	PART
6	Trigger switch
7	Wheel guard
8	Grinding wheel
9	Guard latch



### WARNING!

- Remove the grinder from the carton and examine it carefully. Do not discard the carton or any packaging material until all parts are examined.

**IMPORTANT INFORMATION**

Before attempting to use this tool, become familiar with all of its operating features and safety requirements. For optimum performance and safety, read the following operating instructions carefully before using.

**WARNING!**

- Do not allow familiarity with the angle grinder to make you careless. A fraction of a second of carelessness is enough to cause severe injury.
- To avoid injury, always turn the tool off and disconnect the angle grinder from the power outlet before installing or changing the grinding wheel.

### ASSEMBLY INSTRUCTIONS

#### REPLACING THE WHEEL GUARD [4 1/2" (115 MM) AND 5" (125 MM)]

This grinder is supplied with 5" (125 mm) and 4 1/2" (115 mm) TYPE27 grinding wheel guards. The size has been stamped on each guard (fig 1). Always make sure that a wheel guard of the proper size is used when grinding with different wheels.

fig 1

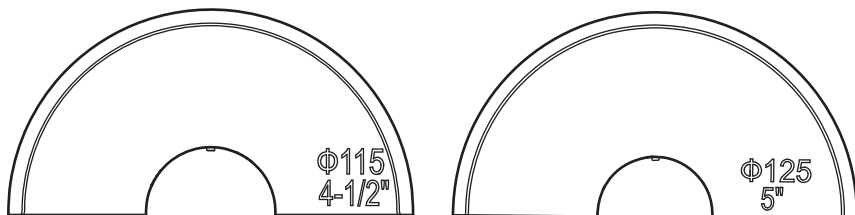

#### TO REMOVE THE WHEEL GUARD (fig 2a and 2b)

1. Disconnect the plug from electrical outlet.
2. Remove wheel and flanges from the tool; refer to the section "**INSTALLING AND REMOVING THE GRINDING WHEEL**".
3. Open the guard latch; refer to fig 2a.
4. Rotate wheel guard clockwise until the lugs on the guard match the notches on the gear box cover; refer to fig 2b.
5. Lift wheel guard off the tool.

fig 2a

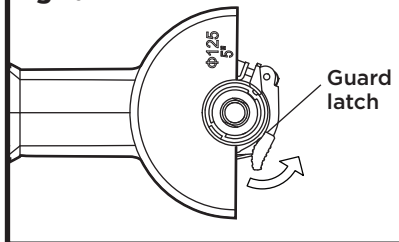
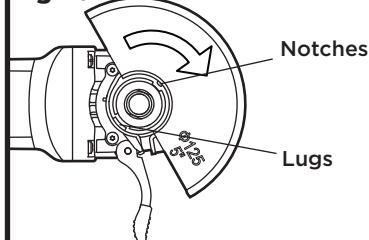

fig 2b



**TO INSTALL THE WHEEL GUARD**

1. Open the guard latch.
2. Align the lugs on the guard with the notches on the gear box cover.
3. Rotate wheel guard into desired working position.
4. Close the guard latch to secure the guard.

**INSTALLING AND REMOVING THE GRINDING WHEEL****TO INSTALL A WHEEL (fig 3 and 4)**

1. Disconnect the plug from the electrical outlet. Make sure the proper guard is securely in place.
2. While pressing the spindle-lock button, loosen the lock nut by turning it counter-clockwise with the wrench supplied.
3. Check to ensure that the backing flange is properly seated on the spindle. It will click into place on the spindle and will cause the spindle to rotate when the backing flange is rotated.
4. Place the wheel on the spindle. Check the rated speed on the grinding wheel.  
Do not use a wheel with a rated speed lower than the speed shown on the grinder's nameplate.

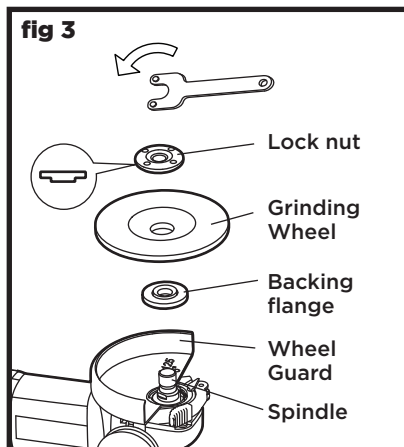
**WARNING!**

- A wheel guard must be attached when using a grinding wheel. Always keep the wheel guard between you and your work while grinding.
- You should not be able to rotate the wheel guard by hand when the guard latch is closed. Do not operate the grinder with a loose guard or the guard latch in the open position.
- Use only Type 27 wheels with the thickness of 1/4" (6 mm), such as the one provided with this product. Never attach a Type 1 straight or cut-off wheel to this angle grinder. This product is only designed for grinding. Use for any other purpose is not recommended and creates a hazard, which will result in serious injury.

5. Thread the lock nut on the spindle with the flat side of the flange facing up, making sure the opening in the wheel is positioned around the raised portion of the lock nut (fig 4).
6. Press the spindle-lock button to keep the spindle from moving.
7. While pressing the spindle-lock button, tighten the lock nut by turning it clockwise with the wrench supplied.

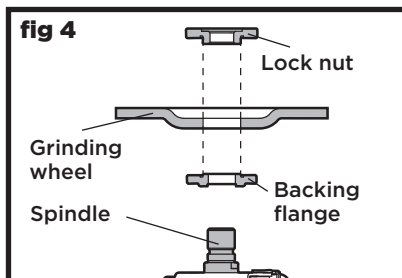

### TO REMOVE A WHEEL

1. Disconnect the plug from the electrical outlet.
2. While pressing the spindle-lock button, loosen the lock nut by turning it counter-clockwise with the wrench supplied.
3. Remove the wheel from the spindle.

### INSTALLING THE SIDE HANDLE (fig 5)

1. Disconnect the plug from the electrical outlet.
2. The side handle may be installed on the right side or the left side of the tool. Thread the side handle into the desired operating position.
3. Securely tighten the side handle by turning it clockwise.

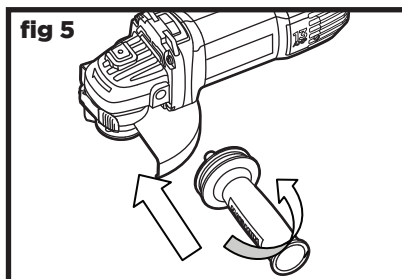

### WARNING!

- When you are trying to remove a wheel, the tool must be completely stopped. Do not depress the spindle-lock button until the spindle has completely stopped moving.
- The side handle should always be used during operation.

**OPERATING INSTRUCTIONS****TRIGGER SWITCH (fig 6)**

1. To turn the angle grinder on, depress the trigger switch.
2. To turn it off, release the trigger switch.

**LOCK-ON BUTTON**

The angle grinder is equipped with a lock-on feature, which is convenient for continuous grinding for extended period of time.

1. Depress the trigger switch.
2. Push in and hold the lock-on button, located on the side of the handle.
3. Release the trigger switch.
4. Release the lock-on button and the angle grinder will continue running.
5. To release the lock, depress and release the trigger switch.

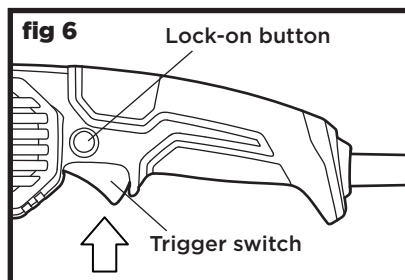

**NOTICE:** If the lock-on feature is engaged during use and the angle grinder becomes disconnected from the power supply, disengage the lock-on feature immediately.

**WARNING!**

- Hold the tool with both hands while starting the tool; the torque from the motor can cause the tool to twist. Start the tool before applying to work and let the tool come to full speed before contacting the workpiece. Lift the tool from the work before releasing the switch.
- Do not turn the angle grinder "ON" or "OFF" while the grinder is in contact with the workpiece. It will decrease the life of the paddle switch and could cause damage to the workpiece.



### GENERAL OPERATION

1. For best control, hold the angle grinder firmly with one hand gripping the side handle and the other gripping the body of the angle grinder.
2. Always position the guard so that the exposed grinding wheel is pointing away from the operator.
3. After starting the tool, apply the grinding wheel to the workpiece.
4. Tilt the angle grinder at a 10 to 15° angle for easy handling and smooth grinding (fig 7). This will make it easier to remove the wheel from the workpiece and will prevent overloading.
5. When using a new grinding wheel, do not move the wheel in a forward direction (A) on the workpiece. Doing so will cause the edge of the wheel to cut into the surface of the workpiece. While grinding, the direction of movement should be backward, toward the operator (B in fig 7).

fig 7

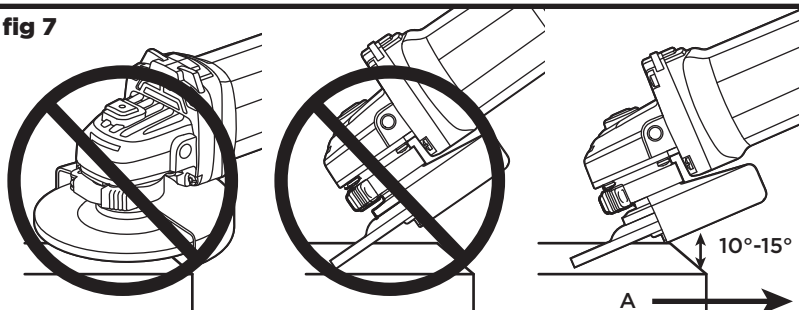

### WARNING!

- Do not apply unnecessary pressure. The weight of the tool applies adequate pressure. Excessive or sudden pressure will overload the motor, cause a drop in the speed and put dangerous stress on the grinding wheel, possibly causing breakage and injury.

## MAINTENANCE

Before cleaning or performing any maintenance, the tool should be unplugged from the power supply. Using compressed air may be the most effective cleaning method. Always wear safety goggles when cleaning tools with compressed air.

Do not let brake fluid, gasoline, petroleum-based products, penetrating oil, etc., come into contact with plastic parts. These substances contain chemicals that can damage, weaken or destroy plastic.

### REPLACING THE CARBON BRUSHES (fig 8a and 8b)

1. Disconnect the plug from the electrical outlet.
2. Loosen and remove the screw on the brush cover with a screwdriver (not included), and then lift the brush cover.
3. Push the terminal out with a straight screwdriver; pry the spiral spring out with a straight screwdriver.
4. Remove the older brushes and insert the new brushes into the brush holders; both carbon brushes should be replaced at the same time. Keep the carbon brush clean and free to slip in the holder.
5. Place the terminal inside; pry the spiral spring back to the carbon brush.
6. Tighten the brush cover with a screwdriver.

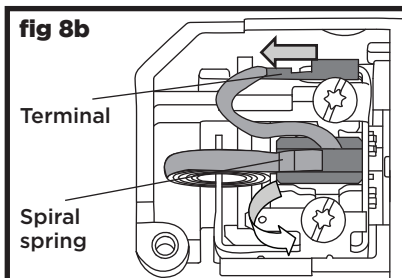
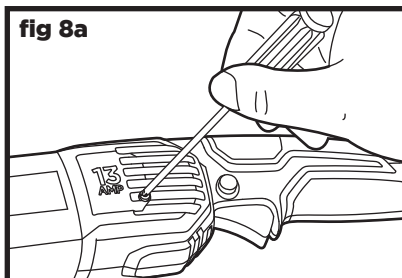

### NOTICE:

- If the tool stops working after long term use, the brushes might have become worn. Replace them with identical carbon brushes. If you need new brushes, please call our toll-free helpline at 1-888-670-6682.
- Make sure that the carbon brush is assembled in the right direction: the terminal is on the top of the spiral spring.

### TIGHTENING THE WHEEL GUARD (fig 9)

1. Disconnect the plug from the electrical outlet.
2. Remove the flanges and the wheel; refer to the section “**INSTALLING AND REMOVING THE GRINDING WHEEL**”.
3. Open the guard latch and rotate the guard to a proper position.
4. Close the guard latch and tighten the screw on the guard with a screw driver (not supplied).

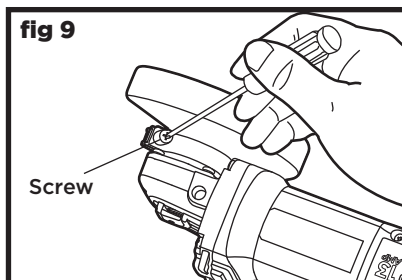

**NOTICE:** After the wheel guard tightened, the guard should be fixed firmly when the latch is closed and rotated normally when the latch is opened.



### WARNING!

- You should not be able to rotate the wheel guard by hand when the guard latch is closed. Do not operate the grinder with a loose guard or the guard latch in the open position.
- When servicing, use only identical replacement parts. The use of any other parts may create a hazard or cause damage to the product. For more information, call the toll-free helpline, at 1-888-670-6682.
- Use only accessories that are recommended by the manufacturer for your model. Accessories that may be suitable for one tool may become hazardous when used with another tool.
- Maintain tools with care. Keep cutting tools sharp and clean. Properly maintained tools, with sharp cutting edges, are less likely to bind and are easier to control.
- If the supply cord is damaged, it must be replaced by a specially prepared cord available through the service organization.

**TROUBLESHOOTING**

PROBLEM	CAUSE OF THE PROBLEM	SUGGESTED CORRECTIVE ACTION
Motor does not start.	Tool was not plugged in.	Check to see that the supply cord is properly connected to an electrical supply.
	Tool is still locked on when the plug was pulled out.	Depress and release the trigger switch.
Tool stops working.	Tool is over heated.	Cool the tool.
	Tool is forced.	Do not force the tool.
	Carbon brushes have worn out.	Replace carbon brushes.
Tool vibrates or shakes.	Damaged wheel.	Replace the wheel.
	Loose wheel.	Tighten the lock nut.
Spindle lock button cannot be used.	Spindle lock button is blocked by debris.	Clean the debris from inside the spindle lock button.

If the problem remains unsolved after performing the checks described above, call the toll-free helpline at 1-888-670-6682.

## EXPLODED VIEW

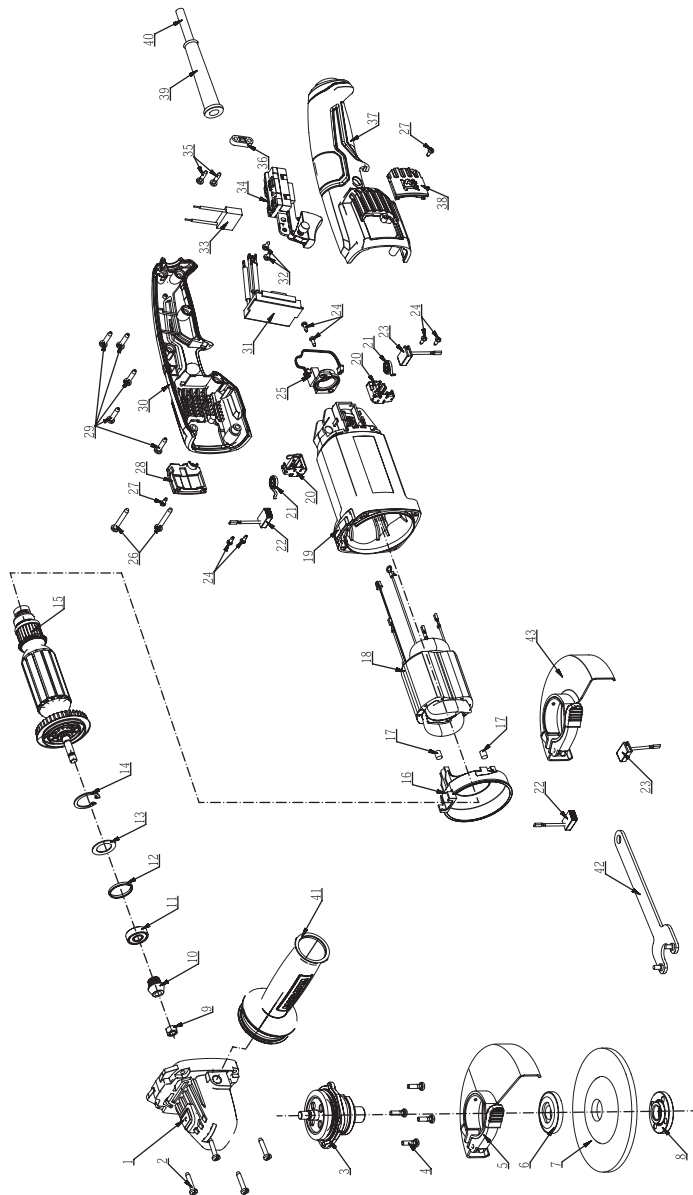

## PARTS LIST

No.	Part No.	Description	No.	Part No.	Description
1	2823582000	Gear Case Assembly	23	4960330000	Carbon Brush
2	5610284000	Tapping Screw	24	5610010000	Tapping Screw
3	2824769000	Spindle Assembly	25	2830159000	Electric Assembly
4	5620360000	Hexagon Lobuar Screw	26	5620169000	Tapping Screw
5	2824705000	Guard Assembly	27	5610283000	Tapping Screw
6	2820067000	Inner Flange	28	3128536000	Right Brush Cover
7	3810003000	Grinding Wheel Slice	29	5620157000	Hexagon Socket Screw
8	3550130000	Outer Flange	30	3322114000	Right Handle
9	5630224000	Nut	31	2830161000	Electric Assembly
10	3551562000	Pinion	32	3700137000	Flange Screw
11	5700008000	Ball Bearing	33	4970040000	Capacitor
12	3121029000	Rubber Ring	34	4870592000	Switch
13	5650368000	Adjusting Washer	35	5610264000	Hexagon Lobular Screw
14	5660174000	Circlips For Hole	36	3120234000	Cord Anchorage
15	2824768000	Rotor Set	37	3322113000	Left Handle
16	3128494000	Fan Baffle	38	3128538000	Left Brush Cover
17	3121006000	Rubber Insert	39	3121050000	Cord Guard
18	2740409000	Stator	40	4810002000	Power Cord and Plug
19	3128495000	Motor Housing	41	3322123000	Side Handle
20	2800259000	Brush Support Assembly	42	3704780000	Wrench
21	3660268000	Spiral Spring	43	2824704000	Guard Assembly
22	4960331000	Carbon Brush			

If any parts are missing or damaged, or if you have any questions, please call the toll-free helpline at 1-888-670-6682.

## 5-YEAR LIMITED WARRANTY

This MAXIMUM product is guaranteed for a period of 5 years from the date of original retail purchase against defects in workmanship and materials only and is subject to the following components:

- a) Component A: The carrying case is guaranteed for a period of 1-year from the date of original retail purchase against defects in workmanship and materials.
- b) Component B: Accessories, including drill bits and saw blades, do not carry a warranty.

Subject to the conditions and limitations described below, this product, if returned to us with proof of purchase within the stated warranty period and if covered under this warranty, will be repaired or replaced (with the same model, or one of equal value or specification), at the sole discretion of the Maximum Canada authorised repair centre ("Service Provider"). We will bear the cost of any repair or replacement and any costs of labour relating thereto.

### These warranties are subject to the following conditions and limitations:\*

- a) a bill of sale verifying the purchase and purchase date must be provided;
- b) defects in workmanship and material to be assessed and determined by the Service Provider;
- c) this warranty will not apply to any product or part thereof which is worn or broken or which has become inoperative due to abuse, misuse, accidental damage, neglect or lack of proper installation, operation or maintenance (as outlined in the applicable owner's manual or operating instructions);
- d) this warranty does not apply to normal wear and tear or to expendable parts or accessories (including drill bits and saw blades) that may be supplied with the product that by their nature have a limited life span and are expected to become inoperative or unusable after a reasonable period of use;
- e) this warranty will not apply to routine maintenance and consumable items such as, but not limited to, fuel, lubricants, vacuum bags, blades, belts, sandpaper, bits, fluids, rubber o-rings, tune-ups or adjustments;
- f) this warranty excludes the following components that may accompany your product:
  - (1) the carrying case, which is only for a period of 1-year from the date of original retail purchase against defects in workmanship and materials.
  - (2) accessories, including drill bits and saw blades, which do not carry a warranty of any kind.
- g) this warranty will not apply where damage is caused by repairs made or attempted by others (i.e. persons not authorized by the manufacturer), and any such unauthorized repairs or attempted repairs shall void this warranty in its entirety;

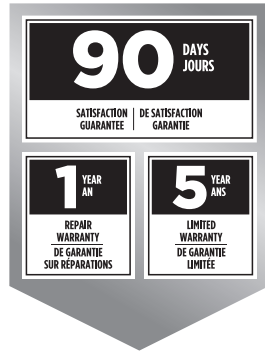

- h) this warranty will not apply to any parts other than original parts, except to the extent that the retailer or manufacturer or persons authorized by either of them have repaired or replaced them;
- i) this warranty will not apply to any product that was sold to the original purchaser as a reconditioned or refurbished product (unless otherwise specified in writing);
- j) this warranty will not apply to any product or part thereof if any part from another manufacturer is installed therein or any repairs or alterations have been made or attempted by unauthorized persons;
- k) this warranty will not apply to normal deterioration of the exterior finish, such as, but not limited to, scratches, dents, paint chips, or to any corrosion or discolouring by heat, abrasive and chemical cleaners;
- l) this warranty will not apply to component parts sold by and identified as the product of another company, which shall be covered under that product manufacturer's warranty, if any;
- m) any products replaced by the retailer in attempt to fulfill warranty obligations is subject to the original product warranty conditions and related time period as initiated by the original date of purchase; if product is purchased in Quebec, the warranty term will be extended for a period equal to the time during which the Quebec retailer possesses the product in attempt to fulfill warranty obligations; replaced product will not default to new product warranty conditions; and
- n) the retailer and manufacturer's sole obligation and the purchaser's sole remedy under this warranty shall be as set out herein. The warranties contained herein are not transferable and are given only to the purchaser. FURTHER, THE WARRANTIES SET OUT HEREIN ARE IN LIEU OF ALL OTHER WARRANTIES OR CONDITIONS, WHETHER EXPRESS, IMPLIED OR STATUTORY (INCLUDING SUCH AS ARISE UNDER THE SALE OF GOODS ACT OR THE INTERNATIONAL SALE OF GOODS ACT), ARISING OUT OF A COURSE OF DEALING OR USAGE OF TRADE OR OTHERWISE, INCLUDING, SUBJECT TO APPLICABLE LAW, ANY IMPLIED WARRANTIES OR CONDITIONS OF MERCHANTABILITY, MERCHANTABLE QUALITY, FITNESS OR ADEQUACY FOR A PARTICULAR PURPOSE OR USE, AND ALL OTHER SUCH WARRANTIES ARE EXPRESSLY DISCLAIMED BY THE RETAILER AND MANUFACTURER.

### **Additional Limitations**

This warranty applies only to the original purchaser and may not be transferred.

This warranty applies for a period of 5 years from the date of original retail purchase, as indicated on the bill of sale.

Neither the retailer, Maximum Canada, nor the manufacturer shall be liable for any other expense, loss or damage, including, without limitation, any indirect, incidental, consequential or exemplary damages arising in connection with the sale, use or inability to use this product.



Under no circumstances shall the retailer, Maximum Canada, or manufacturer be liable to the purchaser for any claim for (a) indirect, special, punitive, incidental, exemplary, or consequential damages, (b) compensation for loss of profits, anticipated revenue, savings or goodwill, or other economic loss of the purchaser, (c) exemplary, aggravated or punitive damages howsoever incurred, (d) contribution or set-off in respect of any claims against the purchaser, (e) any damages whatsoever relating to third party products or services or the purchaser's materials, or (f) any damages whatsoever relating to interruption, delays, errors or omissions; in each case under any theory of law or equity, arising out of or in any way related to this warranty, even if advised of the possibility thereof. Notwithstanding any provision herein or entitlement of the purchaser at law, in equity or otherwise, in no event shall the liability of the retailer or manufacturer under this warranty, whether in contract, tort, product liability or otherwise, exceed, in the aggregate, the amount paid by the purchaser to the retailer for the product to which this warranty applies.

**\*Notice to Consumer**

This warranty gives you specific legal rights, and you may have other rights, which may vary from province to province. The provisions contained in this warranty are not intended to limit, modify, take away from, disclaim or exclude any statutory warranties set forth in any applicable provincial or federal legislation.

In addition to the 5-Year Limited Warranty, this MAXIMUM product is covered by our:

**1-Year Repair Warranty**

Maximum Canada will maintain this product and replace critical parts which have worn beyond reasonable use through normal use of such product, any time during the first year after purchase.

The following are excluded from this 1-Year Repair Warranty:

- a) missing or damaged parts or components that are a result of abuse or misuse;
- b) any wear and tear to non-critical parts or accessories that do not affect the core function of the product.

**90-Day Satisfaction Guarantee**

If you are not completely satisfied with the performance of your MAXIMUM product for any reason, you can return it within 90 days from the date of purchase with proof of purchase for exchange or a full refund.

Made in China

Imported by

MAXIMUM Canada Toronto, Canada M4S 2B8

