

# MAXIMUM<sup>®</sup>

## Multi-voltage Battery Charger



**Model no. 054-3204-0**

**IMPORTANT:**

Please read this manual carefully before using this product, and save it for reference.

**INSTRUCTION  
MANUAL**

# TABLE OF CONTENTS

TECHNICAL SPECIFICATIONS	4
SAFETY INSTRUCTIONS	5
KEY PARTS DIAGRAM	9
OPERATING INSTRUCTIONS	10
MAINTENANCE	12
WARRANTY	13



## WARNING!

For use with the compatible Maximum® batteries only.



## SAVE THESE INSTRUCTIONS

This manual contains important safety and operating instructions. Read all instructions and follow them with use of this product

model no. 054-3204-0 | contact us 1-888-670-6682

MAXIMUM®

**TECHNICAL SPECIFICATIONS**

CHARGER INPUT	120 V AC, 60 Hz, 110W
OUTPUT	12-20V DC, 4 A
CHARGING TIMES	12V max* (1.5Ah) Li-ion: 30 minutes 20V max* (2.0Ah) Li-ion (054-3203-2): 35 minutes 20V max* (4.0Ah) Li-ion (054-3206-6): 65 minutes
COMPATIBLE MAXIMUM® BATTERIES	12V max*(1.5Ah) LITHIUM-ION 054-3203-2, 20V max*(2.0Ah) LITHIUM-ION 054-3206-6, 20V max*(4.0Ah) LITHIUM-ION
OPTIMUM CHARGING TEMPERATURE	40 to 104°F (4 to 40°C)
WEIGHT	1 lb 8 oz (0.66 kg)

\*Maximum battery voltage (12V max\* and 20V max\*) without workload; with workload nominal voltage is 10.8V and 18V.

The term “power tool” in the warnings refers to your mains operated (corded) power tool or battery operated (cordless) power tool.

**WORK AREA**

- **Keep the work area clean and well lit.** Cluttered and dark areas invite accidents.
- **Do not operate power tools in explosive atmospheres, such as in the presence of flammable liquids, gases or dust.** Power tools create sparks, which may ignite the dust or fumes.
- **Keep children and bystanders away while operating a power tool.** Distractions can cause you to lose control.

**ELECTRICAL SAFETY**

- **Power tool plugs must match the outlet. Never modify the plug in any way. Do not use any adaptor plugs with earthed (grounded) power tools.** Unmodified plugs and matching outlets will reduce the risk of electric shock.
- **Avoid body contact with earthed or grounded surfaces such as pipes, radiators, ranges and refrigerators.** There is an increased risk of electric shock if your body is earthed or grounded.
- **Do not expose power tools to rain or wet conditions.** Water entering a power tool will increase the risk of electric shock.
- **Do not abuse the cord. Never use the cord for carrying, pulling or unplugging the power tool. Keep the cord away from heat, oil, sharp edges or moving parts.** Damaged or entangled cords increase the risk of electric shock.
- **When operating a power tool outdoors, use an extension cord suitable for outdoor use.** Use of a cord suitable for outdoor use reduces the risk of electric shock.
- **If operating a power tool in a damp location is unavoidable, use a ground-fault circuit interrupter (GFCI) protected supply.** Use of a GFCI reduces the risk of electric shock.

**PERSONAL SAFETY**

- **Stay alert, watch what you are doing and use common sense when operating a power tool. Do not use a power tool while you are tired or under the influence of drugs, alcohol or medication.** A moment of inattention while operating power tools may result in serious personal injury.
- **Use personal protective equipment. Always wear eye protection.** Protective equipment such as a dust mask, nonskid safety shoes, hard hat, or hearing protection, used for appropriate conditions, will reduce personal injuries.

**WARNING!**

Read all safety warnings and instructions.

- **Prevent unintentional starting.** Ensure that the switch is in the off- position before connecting to a power source and/or battery pack, picking up or carrying the tool. Carrying power tools with your finger on the switch or energizing power tools that have the switch on invites accidents.
- **Remove any adjusting key or wrench before turning the power tool on.** A wrench or a key left attached to a rotating part of the power tool may result in personal injury.
- **Do not overreach.** Keep proper footing and balance at all times. This enables better control of the power tool in unexpected situations.
- **Dress properly.** Do not wear loose clothing or jewelry. Keep your hair, clothing and gloves away from moving parts. Loose clothing, jewelry or long hair can be caught in moving parts.
- **If devices are provided for the connection of dust-extraction and collection facilities, ensure that these are connected and properly used.** Use of these devices can reduce dust-related hazards.

#### POWER TOOL USE AND CARE

- **Do not force the power tool.** Use the correct power tool for your application. The correct power tool will do the job better and more safely at the rate for which it was designed.
- **Do not use the power tool if the switch does not turn it on and off.** Any power tool that cannot be controlled with the switch is dangerous and must be repaired.
- **Disconnect the plug from the power source and/or the battery pack from the power tool before making any adjustments, changing accessories, or storing power tools.** Such preventive safety measures reduce the risk of starting the power tool accidentally.
- **Store idle power tools out of the reach of children and do not allow persons unfamiliar with the power tool or these instructions to operate the power tool.** Power tools are dangerous in the hands of untrained users.
- **Maintain power tools.** Check for misalignment or binding of moving parts, breakage of parts and any other condition that may affect the power tool's operation. If damaged, have the power tool repaired before use. Many accidents are caused by poorly maintained power tools.
- **Keep cutting tools sharp and clean.** Properly maintained cutting tools with sharp cutting edges are less likely to bind and are easier to control.
- **Use the power tool, accessories, tool bits, etc. in accordance with these instructions, taking into account the working conditions and the work to be performed.** Use of the power tool for operations different from those intended could result in a hazardous situation.

#### BATTERY TOOL USE AND CARE

- **Recharge only with the charger specified by the manufacturer.** A charger that is suitable for one type of battery pack may create a risk of fire when used with

another battery pack.

- **Use power tools only with specifically designated battery packs.** Use of any other battery packs may create a risk of injury and fire.
- **When a battery pack is not in use, keep it away from other metal objects, such as paper clips, coins, keys, nails, screws or other small metal objects that can make a connection from one terminal to another.** Shorting the battery terminals together may cause burns or a fire.
- **Under abusive conditions, liquid may be ejected from the battery; avoid contact. If contact accidentally occurs, flush with water. If liquid contacts eyes, additionally seek medical help.** Liquid ejected from the battery may cause irritation or burns.

#### SERVICE

- **Have your power tool serviced by a qualified repair person using only identical replacement parts.** This will ensure that the safety of the power tool is maintained.

#### SPECIFIC SAFETY RULES FOR LITHIUM-ION CHARGER

- Before using the battery charger, read all instructions and cautionary markings in this manual and on the battery charger. Also read all the instructions in the manuals for and the cautionary markings on the battery and the product using the battery to prevent misuse of the products and possible injury or damage.
- Do not use the charger outdoors or expose it to wet or damp conditions. Water entering the charger will increase the risk of electric shock.
- Use of an attachment not recommended or sold by the battery- charger manufacturer may result in a risk of fire, electric shock or injury to persons.
- Do not abuse the cord or charger. Never use the cord to carry the charger. Do not pull the charger cord to disconnect the plug from a receptacle. Damage to the cord or charger could occur and create an electric shock hazard. Replace damaged cords immediately.



#### CAUTION!

To reduce the risk of electric shock or damage to the charger and battery, charge only those rechargeable batteries specifically designated on your charger's label. Other types of batteries may burst, causing personal injury or damage.



#### WARNING!

Read and understand all instructions. Failure to follow all instructions listed below may result in electric shock, fire, and/or serious personal injury.

- Make sure that the cord is located so that it will not be stepped on, tripped over, come in contact with sharp edges or moving parts, or otherwise subjected to damage or stress. This will reduce the risk of accidental falls, which could cause injury and damage to the cord, which could then result in electric shock.
- Keep the cord and charger away from heat to prevent damage to the housing or internal parts.
- Do not allow gasoline, oils, petroleum-based products, etc. to come in contact with plastic parts. These materials contain chemicals that can damage, weaken, or destroy plastic.
- An extension cord should not be used unless absolutely necessary. Use of an improper extension cord could result in a risk of fire and electric shock. If an extension cord must be used, make sure that:
- The pins on the plug of extension cord are the same number, size and shape as those of the plug on charger.
- The cord is properly wired and in good electrical condition.

The size is large enough for AC ampere rating of charger as specified below:

CORD LENGTH	25' (7.6 m)	50' (15 m)	100' (30 m)
CORD SIZE (AWG)	16	16	16

#### AWG = American Wire Gauge

- Do not operate the charger with a damaged cord or plug, which could cause shorting and electric shock. If damaged, have the charger repaired or replaced by an authorized service technician.
- Do not operate the charger if it has received a sharp blow, been dropped, or has otherwise been damaged in any way. Take it to an authorized service technician for an electrical check to determine if the charger is in good working order.
- Do not disassemble the charger. Take it to an authorized service technician when service or repair is required. Incorrect reassembly may result in a risk of electric shock or fire.
- Unplug the charger from the electrical outlet before attempting any maintenance or cleaning to reduce the risk of electric shock.
- Disconnect charger from the power supply when not in use. This will reduce the risk of electric shock or damage to the charger if metal items should fall into the opening. It will also help prevent damage to the charger during a power surge.
- Risk of electric shock. Do not touch the uninsulated portion of output connector or uninsulated battery terminal.
- Save these instructions. Refer to them frequently and use them to instruct others who may use this tool. If you loan this tool to someone else, ensure they read these instructions to prevent misuse of the product and possible injury.

NO.	DESCRIPTION
1	CHARGING INDICATORS
2	AIR VENTS
3	ELECTRIC CONTACTS
4	DETACHABLE CABLE & PLUG

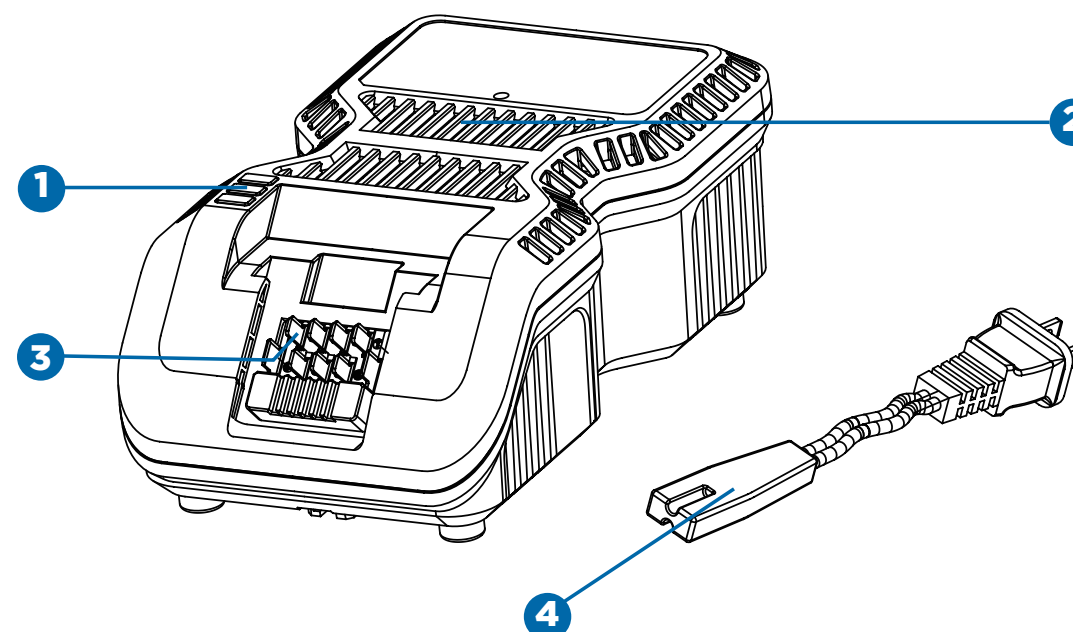

#### WARNING!

Remove the product and any accessories from the package. Inspect the tool carefully to make sure no breakage or damage occurred during shipping.

Do not discard the carton or any packaging material until all parts have been examined.

Before attempting to use the charger, familiarize yourself with all of its operating features and safety requirements.

### BATTERY CHARGING

- Before attempting to charge the battery, check the charger and the battery to ensure the charging equipment matches the battery supplied. The components are all labelled with component numbers.
- The rechargeable battery is not fully charged on leaving the factory. Charge the rechargeable battery before first use.
- Recharge discharged batteries as soon as possible after use or battery life may be greatly diminished. For longest battery life, do not discharge batteries fully.
- A fully discharged battery pack will charge about 30–65 minutes, depending on the type. Charging times maybe longer depending on the surrounding temperature and battery conditions.
- The working temperature of the charger is 40–104°F (4–40°C).

### CHARGING PROCEDURE

- Connect the plug cable to the charger, and then plug into an appropriate outlet before inserting battery pack. All three charging lights will be on for two seconds and then off. (Fig. 1)
- Insert the battery pack into the charger, making sure the pack is fully seated in the charger. (Fig. 2) During the charging process, the charging lights will indicate the charging status as follows:
  - Less than 30% charged: all three charging lights will blink in sequence.
  - Less than 60% charged: one light will stay on, while the other two lights will blink in sequence.
  - Over 60% charged: two lights will stay on, while the remaining light will blink continuously.
  - Fully charged: all three lights will remain on continuously.

(Fig. 1)

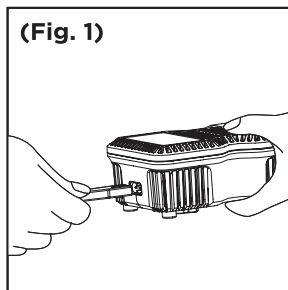

(Fig. 2)

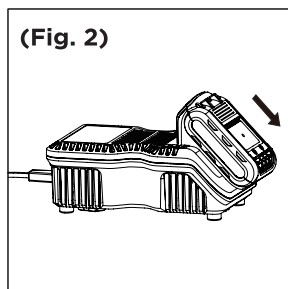

### WARNING!

Do not allow familiarity with the charger to cause carelessness. Remember that one careless moment is enough to cause severe injury. Before attempting to use any tool, be sure to become familiar with all of the operating features and safety instructions.

### CHARGER DIAGNOSTICS

The charger is designed to detect certain problems that can arise with battery packs.

- When the charger detects a battery pack that is overheated, all three charging lights will blink at the same time. Please remove the battery and allow it to cool down for 15–30 minutes and re-insert.
- When the charger detects a malfunction in the battery, two charging lights will blink at the same time. Please remove the battery and allow it to cool down for 15–30 minutes. Then re-insert the battery pack into the charger. If two charging lights still flash, the battery may require service.
- When the charger detects a malfunction of the charger itself, three charging lights will blink at the same time. Please remove the battery pack and unplug the charger for at least 2 minutes. After 2 minutes, plug charger back in and re-insert the pack into the charger. If all three charging lights still blink at the same time, the charger may require service.



**GENERAL MAINTENANCE**

Avoid using solvents when cleaning plastic parts. Most plastics are susceptible to damage from various types of commercial solvents and may be damaged by their use. Use clean cloths to remove dirt, dust, oil, grease, etc.

**MAINTENANCE AND STORAGE**

Store your charger in a cool, dry place. As a general practice, it is best to unplug battery chargers and remove battery packs when not in use.

**CLEANING**

Before cleaning or performing any maintenance, remove the battery pack from the tool. For safe and proper operation, always keep the tool and its ventilation slots clean. Always use only a soft, dry cloth to clean your charger; never use any detergent or alcohol.

**WARNING!**

To reduce the risk of injury, always unplug the charger and remove the battery pack from the charger before performing any maintenance. Never disassemble the battery charger.

To reduce the risk of injury and damage, never immerse your battery charger in liquid or allow a liquid to flow inside it.

**3-YEAR BATTERY/CHARGER REPAIR WARRANTY**

Maximum Canada will repair or replace the batteries/chargers which have worn beyond reasonable use due to normal use of such items, for a period of three (3) years from the date of original purchase.

Any defects with such battery and/or charger will be subject to repair or replacement as determined by the Service Provider. For proper servicing, both the battery and charger will require diagnosis to evaluate warranty requirements and therefore must both be provided to the Service Provider at the time of service request.



The following is excluded from this 3-Year Battery/Charger Repair Warranty:

- a) Damages that are a result of abuse or misuse
- b) Any wear and tear that does not affect the core function of the product.

Made in China

Imported by MAXIMUM Canada Toronto, Canada M4S 2B8