

MastercraftTM

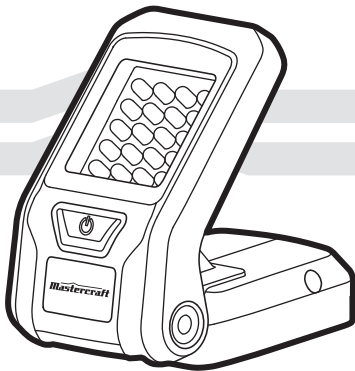

INSTRUCTION MANUAL

20V max* LITHIUM-ION CORDLESS LED WORK LIGHT

054-3187-0

If any parts are missing or damaged, or if you have any questions, please call our toll-free helpline at 1-800-689-9928.



Read and understand this instruction manual thoroughly before using the product. It contains important information for your safety as well as operating and maintenance advice.

Keep this instruction manual for future use. Should this product be passed on to a third party, then this instruction manual must be included.

TECHNICAL SPECIFICATIONS	3
SAFETY GUIDELINES	4–10
DESCRIPTION	11
OPERATING INSTRUCTIONS	12–13
MAINTENANCE	14
TROUBLESHOOTING	15
PARTS LIST	16
WARRANTY	17–19

HEAD PIVOT	0-115°
NUMBERS OF LED	20 pcs
ILLUMINATION AT 1m	300 lux
RUN TIME	9 hours
TOOL WEIGHT (WITHOUT BATTERY)	6 oz (0.17 kg)
BATTERY TYPE	Lithium-ion
BATTERY VOLTAGE	20V max* DC
CHARGER INPUT	120V, 60 Hz AC only
OPTIMUM CHARGING TEMPERATURE	0-40°C (32-104°F)

*Maximum battery voltage without workload; with workload nominal voltage is 18V.



WARNING!

Safety symbols in this Instruction Manual are used to flag possible dangers. The safety symbols and their explanations require your full understanding. The safety warnings do not, by themselves, eliminate any danger, nor are they substitutes for proper accident prevention measures.



WARNING!

This Safety Alert Symbol indicates caution, warning, or danger. Failure to obey a safety warning can result in serious injury to yourself or others. To reduce the risk of injury, fire, or electric shock, always follow the safety precautions.

Know your tool

To operate this tool, carefully read this Instruction Manual and all labels affixed to the Cordless LED Work Light before using. Keep this manual available for future reference.

Important

This tool should only be serviced by a qualified service technician. For more information, call the toll-free helpline at 1-800-689-9928.

Read all instructions thoroughly

Save these instructions

General power tool safety warnings



WARNING!

Read all safety warnings and instructions. Failure to follow the warnings and instructions may result in electric shock, fire and/or serious injury.

Save all warnings and instructions for future reference.

The term "power tool" in the warnings refers to your mains-operated (corded) power tool or battery-operated (cordless) power tool.

Work area safety

- **Keep the work area clean and well lit.** Cluttered or dark areas invite accidents.
- **Do not operate power tools in explosive atmospheres, such as in the presence of flammable liquids, gases or dust.** Power tools create sparks, which may ignite the dust or fumes.
- **Keep children and bystanders away while operating a power tool.** Distractions can cause you to lose control.

Electrical safety

- **Power tool plugs must match the outlet. Never modify the plug in any way. Do not use any adapter plugs with earthed (grounded) power tools.** Unmodified plugs and matching outlets will reduce the risk of electric shock.
- **Avoid body contact with earthed or grounded surfaces such as pipes, radiators, ranges and refrigerators.** There is an increased risk of electric shock if your body is earthed or grounded.
- **Do not expose power tools to rain or wet conditions.** Water entering a power tool will increase the risk of electric shock.
- **Do not abuse the cord. Never use the cord for carrying, pulling or unplugging the power tool. Keep the cord away from heat, oil, sharp edges or moving parts.** Damaged or entangled cords increase the risk of electric shock.

- **When operating a power tool outdoors, use an extension cord suitable for outdoor use.** Use of a cord suitable for outdoor use reduces the risk of electric shock.
- **If operating a power tool in a damp location is unavoidable, use a ground-fault circuit interrupter (GFCI) protected supply.** Use of a GFCI reduces the risk of electric shock.

Personal safety

- **Stay alert, watch what you are doing and use common sense when operating a power tool. Do not use the tool while tired or under the influence of drugs, alcohol, or medication.** A moment of inattention while operating power tools may result in serious personal injury.
- **Use personal protective equipment. Always wear eye protection.** Protective equipment such as dust mask, non-skid safety shoes, hard hat, or hearing protection, used for appropriate conditions, will reduce personal injuries.
- **Prevent unintentional starting. Ensure the switch is in the off-position before connecting to power source and/or battery pack, picking up or carrying the tool.** Carrying power tools with your finger on the switch or energising power tools that have the switch on invites accidents.
- **Remove any adjusting key or wrench before turning the power tool on.** A wrench or a key left attached to a rotating part of the power tool may result in personal injury.
- **Do not overreach. Keep proper footing and balance at all times.** This enables better control of the power tool in unexpected situations.
- **Dress properly. Do not wear loose clothing or jewellery. Keep your hair, clothing and gloves away from moving parts.** Loose clothes, jewellery or long hair can be caught in moving parts.

- If devices are provided for the connection of dust extraction and collection facilities, ensure that these are connected and properly used. Use of these devices can reduce dust-related hazards.

Power tool use and care

- **Do not force the power tool. Use the correct power tool for your application.** The correct power tool will do the job better and more safely at the rate for which it was designed.
- **Do not use the power tool if the switch does not turn it on and off.** Any power tool that cannot be controlled with the switch is dangerous and must be repaired.
- **Disconnect the plug from the power source and/or the battery pack from the power tool before making any adjustments, changing accessories, or storing power tools.** Such preventive safety measures reduce the risk of starting the power tool accidentally.
- **Store idle power tools out of the reach of children and do not allow persons unfamiliar with the power tool or these instructions to operate the power tool.** Power tools are dangerous in the hands of untrained users.
- **Maintain power tools. Check for misalignment or binding of moving parts, breakage of parts and any other condition that may affect the power tool's operation. If damaged, have the power tool repaired before use.** Many accidents are caused by poorly maintained power tools.
- **Keep cutting tools sharp and clean.** Properly maintained cutting tools with sharp cutting edges are less likely to bind and are easier to control.
- **Use the power tool, accessories, tool bits, etc. in accordance with these instructions, taking into account the working conditions and the work to be performed.** Use of the power tool for operations different from those intended could result in a hazardous situation.

Battery tool use and care

- **Recharge only with the charger specified by the manufacturer.** A charger that is suitable for one type of battery pack may create a risk of fire when used with another battery pack.
- **Use power tools only with specifically designated battery packs.** Use of any other battery packs may create a risk of injury and fire.
- **When battery pack is not in use, keep it away from other metal objects like paper clips, coins, keys, nails, screws or other small metal objects that can make a connection from one terminal to another.** Shorting the battery terminals together may cause burns or a fire.
- **Under abusive conditions, liquid may be ejected from the battery; avoid contact. If contact accidentally occurs, flush with water. If liquid contacts eyes, also seek medical help.** Liquid ejected from the battery may cause irritation or burns.

Service

- **Have your power tool serviced by a qualified repair person using only identical replacement parts.** This will ensure that the safety of the power tool is maintained.

Safety guidelines for cordless LED work light



WARNING!

When using electric appliances, basic precautions should always be followed, including the following:

- **Read all the instructions before using the appliance.**
- **To reduce the risk of injury, close supervision is necessary when an appliance is used near children.**
- **Do not contact moving parts.**

- **Only use attachments recommended or sold by the manufacturer.**
- **Do not use outdoors.**
- **To reduce the risk of electrical shock, do not put work light and battery pack in water or other liquid.** Do not place or store appliance where it can fall or be pulled into a tub or sink.

- **Use only the recommended battery packs and charger listed below.** Any attempt to use another battery pack will cause damage to the work light; it could possibly explode or cause a fire or personal injury.



Battery pack	Charger
--------------	---------

054-3124-0

054-3125-8

054-3126-6

- **The label on your tool may include the following symbols. The symbols and their definitions are as follows:**

V	Volts
A	Amperes
Hz	Hertz
W	Watts
min	Minutes
~	Alternating current
≡	Direct current
n ₀	No-load speed
	Class II Construction
.../min	Revolutions per minute
	Grounding terminal

BPM



Beats per minute

WARNING – To reduce the risk of injury, user must read instruction manual.

Contents:

Cordless LED Light and instruction manual.

**WARNING!**

Remove the Cordless LED Work Light from the package and examine it carefully. Do not discard the carton or any packaging material until all parts have been examined.

**WARNING!**

If any part of the work light is missing or damaged, do not attach the battery pack to the tool or use the tool until the part has been repaired or replaced. Failure to heed this warning could result in serious injury.

Know your tool

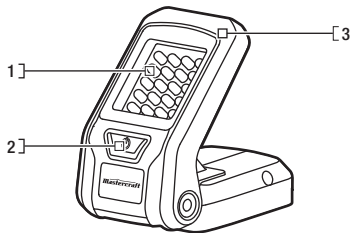

No.	Description	No.	Description
1	LEDs	3	Work light Head
2	On/Off Button		

Before attempting to use this tool, become familiar with all of its operating features and safety requirements. For optimum performance and safety, read the following operating instructions carefully before using.

**WARNING!**

Do not allow familiarity with the Cordless LED Work Light to cause a lack of alertness. A fraction of a second of carelessness is enough to cause severe injury.

To attach the battery pack (fig 1)

1. Align the raised platform on the battery pack with the grooves on the bottom of the work light, and then attach battery pack to the work light as shown in fig 1.

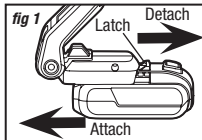

2. Make sure that the latch on the battery pack snaps into place and the battery pack is secured to the work light before beginning operation.

NOTICE: When inserting the battery pack into the tool, make sure that the raised platform on the pack aligns with the grooves on the bottom of the tool and that the latches snap properly into place. Improper assembly of the battery pack can cause damage to internal components.

To detach the battery pack (fig 1)

1. Depress the battery-release buttons located on the front of the battery pack to release the battery pack.
2. Pull the battery pack out and remove it from the tool.

Turn on/off the work light (fig 2)

Depress the on/off button to turn on the work light; depress the switch button again to turn off the work light.

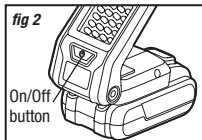

To adjust the work light head (fig 3)

The work light head independently pivots 115° for maximum flexibility. Move the head by manually adjusting it to any position within the 115° pivot range. Do not force the head beyond the 115° range.

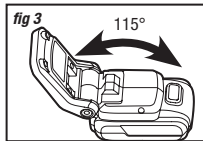

General maintenance

Avoid using solvents when cleaning plastic parts. Most plastics are susceptible to damage from various types of commercial solvents and may be damaged by their use. Use clean cloths to remove dirt, dust, oil, grease, etc.



WARNING!

When servicing, use only identical replacement parts. Use of any other parts may create a hazard or cause product damage. To ensure safety and reliability, all repairs should be performed by a qualified service technician.



WARNING!

Do not at any time let brake fluids, gasoline, petroleum-based products, penetrating oils, etc. to come in contact with plastic parts. Chemicals can damage, weaken or destroy plastic.

PROBLEM	POSSIBLE CAUSES	SOLUTIONS
The work light does not light	The battery is depleted	Charge the battery

If the problem remains unsolved after performing the checks described above, call the toll-free helpline at 1-800-689-9928.

Exploded view

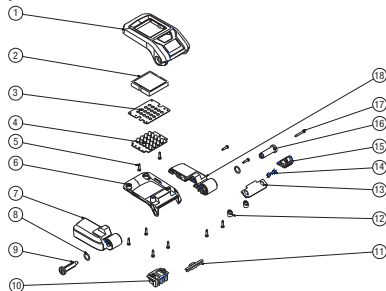

No.	Part No.	Description	No.	Part No.	Description
1	3126251000	Upper Housing	10	3402385000	Contact Receptacle Assembly
2	3126250000	Transparent Guard	11	3126261000	Rubber Gasket
3	3705114000	Reflector	12	3126258000	Plate
4	4890822000	PCB Assembly	13	4890821000	PCB Assembly
5	5610012000	Tapping Screw	14	3660318000	Spring
6	3126252000	Lower Housing	15	3126253000	Switch Cover
7	3127173000	Right Base	16	3126260000	Pin
8	5690004000	O Ring	17	5610015000	Tapping Screw
9	3126259000	Pin	18	3127172000	Left Base

If any parts are missing or damaged, or if you have any questions, please call the Toll-free Helpline, at 1-800-689-9928.



This Mastercraft product is guaranteed **three (3) years from the date of original retail purchase** against defects in materials and workmanship, except for the following components:

- a) Component A: Batteries, chargers and carrying case, which are guaranteed for a period of 2 years from the date of original retail purchase against defects in workmanship and materials;
- b) Component B: Accessories, which are guaranteed for a period of 1-year from the date of original retail purchase against defects in workmanship and materials.

Subject to the conditions and limitations described below, this product, if returned to us with proof of purchase within the stated warranty period and if covered under this warranty, will be repaired or replaced (with the same model, or one of equal value or specification), at our option. We will bear the cost of any repair or replacement and any costs of labour relating thereto.

These warranties are subject to the following conditions and limitations:

- a) a bill of sale verifying the purchase and purchase date must be provided;

- b) this warranty will not apply to any product or part thereof which is worn or broken or which has become inoperative due to abuse, misuse, accidental damage, neglect or lack of proper installation, operation or maintenance (as outlined in the applicable owner's manual or operating instructions) or which is being used for industrial, professional, commercial or rental purposes;
- c) this warranty will not apply to normal wear and tear or to expendable parts or accessories that may be supplied with the product which are expected to become inoperative or unusable after a reasonable period of use;
- d) this warranty will not apply to routine maintenance and consumable items such as, but not limited to, fuel, lubricants, vacuum bags, blades, belts, sandpaper, bits, fluids, tune-ups or adjustments;
- e) this warranty will not apply where damage is caused by repairs made or attempted by others (i.e. persons not authorized by the manufacturer);
- f) this warranty will not apply to any product that was sold to the original purchaser as a reconditioned or refurbished product (unless otherwise specified in writing);
- g) this warranty will not apply to any product or part thereof if any part from another manufacturer is installed therein or any repairs or alterations have been made or attempted by unauthorized persons;
- h) this warranty will not apply to normal deterioration of the exterior finish, such as, but not limited to, scratches, dents, paint chips, or to any corrosion or discolouring by heat, abrasive and chemical cleaners; and

- i) this warranty will not apply to component parts sold by and identified as the product of another company, which shall be covered under the product manufacturer's warranty, if any.

Additional limitations

This warranty applies only to the original purchaser and may not be transferred. Neither the retailer nor the manufacturer shall be liable for any other expense, loss or damage, including, without limitation, any indirect, incidental, consequential or exemplary damages arising in connection with the sale, use or inability to use this product.

Notice to consumer

This warranty gives you specific legal rights, and you may have other rights, which may vary from province to province. The provisions contained in this warranty are not intended to limit, modify, take away from, disclaim or exclude any statutory warranties set forth in any applicable provincial or federal legislation.

**IMPORTED BY MASTERCRAFT CANADA TORONTO, CANADA
M4S 2B8**