

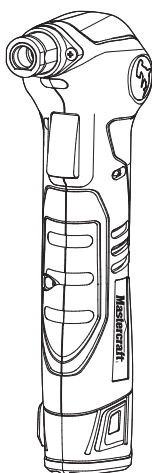

## OWNER'S MANUAL

# 12 V LITHIUM-ION AUTO HAMMER

054-1257-6



Parts missing or damaged? Questions? Toll-free Helpline – 1-800-689-9928

### IMPORTANT :

 Read this Owner's Manual carefully before using this tool. Pay close attention to all **Safety Instructions, Warnings, and Caution sections**. Use this tool properly, and only for its intended use

 Safety symbols in this manual are used to indicate possible danger. The safety symbols and their explanations require your full understanding. The safety warnings do not eliminate any danger by themselves, and they are not substitutes for proper accident prevention measures.

 This Safety Alert Symbol indicates caution, warning, or danger. Failure to obey a safety warning can result in serious injury to yourself or others. To reduce the risk of injury, fire, or electric shock, always follow the safety precautions.

# TABLE OF CONTENTS

Specifications..... Page 2

Rules for Safe Operation..... Page 3

Operation.....Page 11

Troubleshooting.....Page 16

Maintenance.....Page 17

Exploded View & Parts List..... Page 18

Warranty.....Page 19

# SPECIFICATIONS

Mitre Saw Specifications :	
Motor:	12 V DC
Hammer Weight (without battery).	1 lb 5 oz (0.65kg)
Battery Type	Lithium-Ion
Battery Voltage	12 V DC
Charger Input	120 V 60 Hz AC only
Optimum Charging Temperature	32° F (0° C) -104° F (40° C)

# RULES FOR SAFE OPERATION

## KNOW YOUR TOOL

Read this Owner's Manual and all labels affixed to the hammer carefully before using. Keep this manual available for future reference.

## IMPORTANT

This tool should only be serviced by a qualified service technician. For more information, call the Toll-free Helpline, at 1-800-689-9928.

## READ ALL INSTRUCTIONS CAREFULLY

## SAVE THESE INSTRUCTIONS

## GENERAL SAFETY RULES

**⚠CAUTION:** Do not attempt to operate this tool until you have thoroughly read all instructions, safety rules, and warnings. Failure to comply can result in fire, electric shock, or serious personal injury. Save this manual, and review it frequently for reference.

**⚠WARNING:** Basic safety precautions should always be followed when using power tools in order to reduce the risk of fire, electric shock, and personal injury.

## WORK AREA SAFETY

- **Keep your work area clean and well-lit.** Cluttered benches and dark areas invite accidents.
- **Do not operate power tools in an explosive environment, such as in the presence of flammable liquids, gases, or dust.** Power tools create sparks that may ignite the dust or fumes.
- **Keep bystanders, children, and visitors away while operating a power tool.** Distractions can cause you to lose control.

## ELECTRICAL SAFETY

**⚠WARNING!** To reduce the risk of electrocution, keep all connections dry and off the ground. Do not touch a plug with wet hands.

- **The plug on the power cord must match the outlet.**
- **Do not alter the plug in any way. Do not use an adaptor plug with a grounded power tool.** Using unaltered plugs and proper outlets reduces the risk of electric shock.
- **Avoid bodily contact with grounded surfaces, such as pipes, radiators, ranges, and refrigerators.** There is an increased risk of electric shock if

**the operator's body is grounded.**

- **Do not expose power tools to rain or wet conditions. Water entering a power tool will increase the risk of electric shock.**
- **Do not abuse the power cord. Never use the cord to carry the tool or to pull the plug out of an outlet. Keep the cord away from heat, oil, sharp edges, and moving parts. Damaged or entangled cords increase the risk of electric shock.**
- **When operating a power tool outdoors, use an outdoor extension cord that is suitable for outdoor use. Using the proper extension cord reduces the risk of electric shock.**

## **PERSONAL SAFETY**

- **Stay alert and aware, and use common sense when operating a power tool.**
- **Do not use a power tool when tired or under the influence of drugs, alcohol, or medication. A moment of inattention while operating a power tool could result in serious personal injury.**
- **Use safety equipment. Always wear eye protection. Safety equipment such as a dust mask, non-skid safety shoes, a hardhat, and/or hearing protection should be used under appropriate conditions in order to reduce the risk of personal injury.**
- **Avoid accidental start-ups. Verify that the switch is in the “off” position before attaching the tool to a power source. Do not carry a power tool with a finger on the switch, and do not plug in a power tool if the switch is in the “on” position. Doing so invites accidents.**
- **Remove all adjusting keys or wrenches before turning the power tool “on”. A wrench or key that is left attached to a rotating part of the power tool may result in personal injury.**
- **Do not overreach. Maintain proper footing and balance at all times. This allows for better control of the power tool in unexpected situations.**
- **Dress properly. Do not wear loose clothing or jewellery. Keep hair, clothing, and gloves away from moving parts. Loose clothes, jewellery, or long hair can get caught in moving parts or be drawn into air vents.**
- **If the tool is equipped for the connection of dust extraction and collection devices, verify that these devices are properly connected and used. The use of these devices can reduce dust-related hazards.**
- **Do not use on a ladder or unstable support. Stable footing on a solid surface allows for better control of the power tool in unexpected situations.**

 **WARNING** : The operation of any tool can result in foreign objects being propelled into the eyes, resulting in severe eye damage. When operating a power tool, always wear safety goggles or safety glasses with side shields and a full face shield when needed.

 **WARNING** : Remove adjusting keys or switches before turning the tool on. A wrench or a key that is left attached to a rotating part of the tool may result in personal injury.

 **WARNING** : If any parts are missing, do not operate the tool until the missing parts have been replaced. Failure to replace parts could result in serious personal injury.

## USE AND CARE OF BATTERY-OPERATED TOOLS

- **Ensure that the switch is in the off position before inserting the battery pack.** Inserting the battery pack into a power tool that has the switch on invites accidents.
- **Recharge only using the charger specified by the manufacturer.** A charger that is suitable for one type of battery pack may create a risk of fire when used with another battery pack.
- **Only use power tools with specifically designated battery packs.** The use of any other battery packs may create a risk of injury and fire.
- **When a battery pack is not in use, keep it away from other metal objects like paper clips, coins, keys, nails, screws, or other small metal objects that can make a connection from one terminal to another.** Shorting the battery terminals together may cause burns or a fire.
- **Under abusive conditions, liquid may be ejected from the battery, avoid contact. If contact accidentally occurs, flush with water. If liquid contacts eyes, seek additional medical help.** Liquid ejected from the battery may cause irritation or burns.
- **Battery-operated tools do not have to be plugged into an electrical outlet. Therefore, they are always in operating condition. Be aware of possible hazards when not using your battery-operated tool or when changing accessories.** Following this rule will reduce the risk of electric shock, fire or serious personal injury.
- **Do not place battery-operated tools or their batteries near fire or heat.** This will reduce the risk of explosion and possibly injury.
- **Do not crush, drop or damage the battery pack. Do not use a battery pack or charger that has been dropped or that has received a sharp blow. A damaged battery is subject to explosion.** Properly dispose of a dropped or damaged battery immediately.

- **Batteries vent hydrogen gas, and can explode in the presence of a source of ignition such as a pilot light.** To reduce the risk of serious personal injury, never use any cordless product in the presence of an open flame. An exploded battery can propel debris and chemicals. If exposed, flush with water immediately.
- **Do not charge a battery-operated tool in a damp or wet location.** Following this rule will reduce the risk of electric shock.
- **Under extreme usage or temperature conditions, battery leakage may occur. If liquid comes into contact with your skin, wash immediately with soap and water, then neutralize using lemon juice or vinegar.** If liquid gets in your eyes, flush them with clean water for at least 10 minutes, and then seek immediate medical attention. Following this rule will reduce the risk of serious personal injury.

## **SAFETY INSTRUCTIONS FOR THE AUTO HAMMER**

- **Hold power tools by insulated gripping surfaces when performing any operation where the cutting tool may contact hidden wiring or its own cord.** Contact with a “live” wire will also make exposed metal parts of the tool “live” and shock the operator.
- **Do not insert or try to insert your finger into the hammer clamp at any time.** Doing so could result in serious personal injury.
- **Do not stare directly into the LED worklight.** Never project the worklight to someone else’s eyes.
- **Do not leave your hand on the nail while hammering.** Use your hand only to root the nail on the workpiece at the beginning of hammering.
- **This hammer is recommended** for use for nails with a diameter of less than 7/16” (11 mm) and a length of less than 3 ½” (8.9cm).
- **Use clamps or another practical way to secure and support the workpiece to a stable platform.** Holding the work by hand or against your body leaves it unstable, and may lead to loss of control.
- **Know your power tool. Read the Owner’s Manual carefully. Learn its applications and limitations, as well as the specific potential hazards related to this tool.** Following this rule will reduce the risk of electric shock, fire or serious injury.
- **Always wear safety glasses with side shields. Everyday glasses only have impact-resistant lenses. They are NOT safety glasses.** Following this rule will reduce the risk of eye injury.
- **Protect your lungs. Wear a face or dust mask if the operation is dusty.** Following this rule will reduce the risk of serious personal injury.

- **Protect your hearing. Wear hearing protection during extended periods of operation.** Following this rule will reduce the risk of serious person injury.
- **Battery-operated tools do not have to be plugged into an electrical outlet. Therefore, they are always in operating condition. Be aware of possible hazards when not using your battery-operated tool or when changing accessories.** Following this rule will reduce the risk of electric shock, fire or serious personal injury.
- **Do not place battery-operated tools or their batteries near fire or heat.** This will reduce the risk of explosion and possibly injury.
- **Do not crush, drop or damage the battery pack. Do not use a battery pack or charger that has been dropped or that has received a sharp blow.** A damaged battery is subject to explosion. Properly dispose of a dropped or damaged battery immediately.
- **Batteries vent hydrogen gas, and can explode in the presence of a source of ignition such as a pilot light.** To reduce the risk of serious personal injury, never use any cordless product in the presence of an open flame. An exploded battery can propel debris and chemicals. If exposed, flush with water immediately.
- **Do not charge battery-operated tool in a damp or wet location.** Following this rule will reduce the risk of electric shock.
- **For best results, your battery-operated tool should be charged in a location where the temperature is higher than 32° F (0° C) but lower than 104° F (40° C). Do not store outside or in a vehicle.**
- **Under extreme usage or temperature conditions, battery leakage may occur. If liquid comes into contact with your skin, wash immediately with soap and water, then neutralize using lemon juice or vinegar. If liquid gets in your eyes, flush them with clean water for at least 10 minutes, then seek immediate medical attention.** Following this rule will reduce the risk of serious personal injury.
- **Save these instructions.** Refer to them frequently and use them to instruct others who may use this tool. If you loan someone this tool, loan them these instructions also.
- **If the power supply cord is damaged,** it must be replaced by the manufacturer or by an authorized service centre in order to avoid risk.

**⚠ WARNING :** To reduce the risk of injury, the user must read the Owner's Manual.

## SAFETY INSTRUCTIONS FOR THE CHARGER

**⚠ WARNING :** READ AND UNDERSTAND ALL INSTRUCTIONS. Failure to follow all instructions listed below may result in electric shock, fire and/or serious personal injury.

- **Before using the battery charger**, read all instructions and cautionary markings in this manual, on the battery charger, the battery and the products using the battery in order to prevent misuse of the products and possible injury or damage.

**⚠ CAUTION:** To reduce the risk of electric shock or damage to the charger and the battery, charge only lithium-ion rechargeable batteries as specifically designated on your charger. Other types of batteries may burst, causing personal injury or damage.

- **Do not use the charger outdoors or expose it to wet or damp conditions.** Water entering the charger will increase the risk of electric shock.
- **The use of an attachment that is not recommended or sold by the battery charger manufacturer may result in a risk of fire, electric shock or injury to persons.** Following this rule will reduce the risk of electric shock, fire or serious personal injury.
- **Do not abuse the cord or the charger.** Never use the cord to carry the charger. Do not pull the charger cord rather than the plug when disconnecting from the receptacle. Damage to the cord or charger could occur and create an electric shock hazard. Replace damaged cords immediately.
- **Make sure cord is located so that it will not be stepped on, tripped over, come into contact with sharp edges or moving parts or otherwise subjected to damage or stress.** This will reduce the risk of accidental falls, which could cause injury and damage to the cord, which could result in electric shock.
- **Keep the cord and the charger away from heat in order to prevent damage to the housing or internal parts.**
- **Do not let gasoline, oils, petroleum-based products, etc. come into contact with plastic parts.** They contain chemicals that can damage, weaken or destroy plastic.
- **An extension cord should not be used unless absolutely necessary. The use of an improper extension cord could result in a risk of fire and electric shock. If an extension cord must be used, make sure:**
  1. The pins on the plug of the extension cord are the same number, size and shape as those on the plug on the charger.



2. The extension cord is properly wired and in good electrical condition; and
3. The wire size is large enough for the AC amperage rating of the charger, as specified below:

Cord Length (Feet)	25'(7.6m)	50'(15.2m)	100'(30.5m)
Cord Size (AWG)	16	16	16

**NOTE:** AWG = American Wire Gauge

- **Do not operate the charger with a damaged cord or plug.** Doing so could cause shorting and electric shock. If damaged, have the charger repaired or replaced by an authorized service technician.
- **Do not operate the charger if it has received a sharp blow, or if it has been dropped or otherwise damaged in any way.** Take it to an authorized service technician for an electrical check to determine whether the charger is in good working order.
- **Do not disassemble the charger.** Take it to an authorized service technician at a Service Centre when service or repair is required. Incorrect reassembly may result in a risk of electric shock or fire.
- **Unplug the charger from the outlet before attempting any maintenance or cleaning in order to reduce the risk of electric shock.**
- **Disconnect the charger from the power supply when not in use.** This will reduce the risk of electric shock or damage to the charger if metal items should fall into the opening. It will also help prevent damage to the charger during a power surge.
- **Risk of electric shock.** Do not touch the uninsulated portion of the output connector or the uninsulated battery terminal.
- **Save these instructions.** Refer to them frequently and use them to instruct others who may use this tool. If you loan someone this tool, loan them these instructions also in order to prevent misuse of the product and possible injury.

## SERVICE

- Have your power tool serviced by a qualified repairperson.
- When servicing a power tool, use only identical replacement parts. This will ensure that the safety of the power tool is maintained.
- Follow instructions in the Maintenance section of this manual

## CONTENTS:

Cordless auto hammer, 1 pc battery pack, 1 pc 30-minute li-ion Charger, soft

**⚠ WARNING :** Remove the auto hammer from the package and examine it carefully. Do not discard the carton or any packaging material until all parts have been examined.

**⚠ WARNING :** If any part of the hammer is missing or damaged, do not attach the battery pack to the tool or use the tool until the part has been repaired or replaced. Failure to heed this warning could result in serious injury.

## KNOW YOUR HAMMER (Fig. 1)

Before attempting to use this tool, become familiar with all of its operating features and safety requirements. For optimum performance and safety, read the following operating instructions carefully before using.

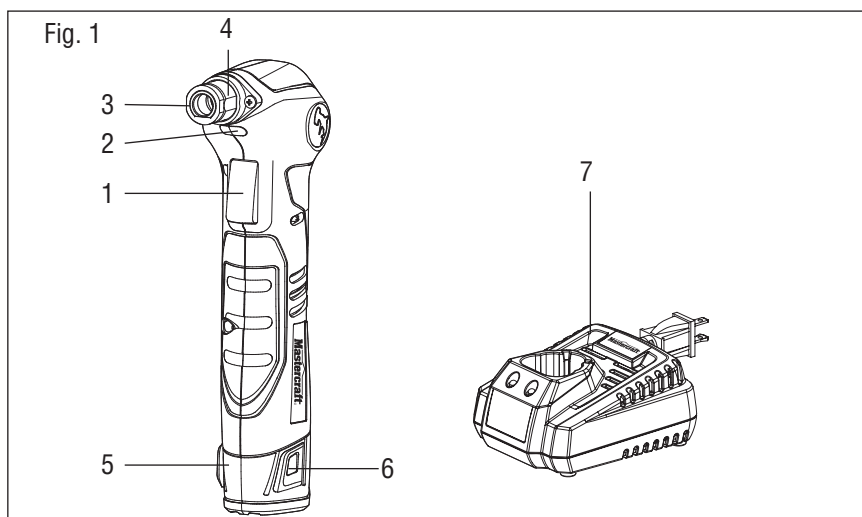

1. Trigger switch
2. LED worklight
3. Hammer head
4. Magnetic sleeve
5. Battery pack
6. Battery pack release button
7. Charger

**⚠ WARNING :** Do not allow familiarity with the cordless hammer to cause a lack of alertness. A fraction of a second of carelessness is enough to cause severe injury.

## **REMOVING THE BATTERY PACK AND PREPARATION FOR RECYCLING**

To preserve natural resources, please recycle or dispose of batteries properly. This product contains Lithium-Ion batteries. Provincial or municipal laws may prohibit the disposal of Lithium-Ion batteries in ordinary trash. Consult the local waste management authority for information concerning available recycling and/or disposal options.

## **OPERATION**

### **LOW BATTERY CAPACITY INDICATOR**

- If the LED begins to flash rapidly when the trigger switch is depressed, this indicates that the power in the battery pack has run out, and that the battery pack should be recharged.
- Unlike other types of battery packs, Lithium-Ion battery packs deliver fade-free power for the entire run time. The tool will not experience a slow, gradual loss of power as you work. To signal that the battery pack is at the end of its run time and needs to be charged, power to the tool will drop quickly. NOTE: The LED may also flash due to an overload or high temperature situation (see BATTERY PROTECTION).

**NOTE:** A significantly reduced run time after fully charging the battery pack indicates that the batteries are near the end of their usable life and must be replaced.

### **BATTERY PROTECTION**

The circuitry protects the battery pack from extreme temperature, over-discharge, and over-charging. In order to protect the battery from damage and prolong its life, the battery pack circuitry will turn off the battery pack if it becomes overloaded or if the temperature becomes too high during use. This may happen in extremely high torque, binding, and stalling situations. This intelligent system will shut down your battery pack if its operating temperature exceeds 176° F (80° C) and will begin normal operation when it returns to 32° F (0° C) - 122° F (50° C).

- The LED light will begin to flash slowly if the battery circuitry detects a momentary overload.

**NOTE:** The battery can automatically reset. If the LED continues to flash, it indicates that the capacity is too low. Place the battery on the charger for charging.

**NOTE:** A significantly reduced run time after fully charging the battery pack indicates that the battery is near the end of its usable life and must be replaced.

## WHEN TO CHARGE THE BATTERY PACK

The Lithium-Ion battery can be charged at any time and will not develop a “memory” when charged after only a partial discharge. It is not necessary to run down the battery pack charge down before recharging. Remove the battery pack from the tool when convenient for you and your job.

- You can “top-off” your battery pack’s charge before starting a big job or a long period of use.
- Due to Lithium-Ion’s fade-free properties, the only time it is necessary to charge the Lithium-Ion battery pack is when the pack has reached the end of its charge. To signal the end of charge, power to the tool will drop quickly. Charge the battery pack as needed.

## HOW TO CHARGE THE BATTERY PACK

**NOTE:** This Lithium-Ion battery pack is shipped partially charged. Fully charge the battery pack before using it for the first time.

A fully discharged battery pack will charge in about 30 minutes at a temperature between 32° F (0° C) and 104° F (40° C).



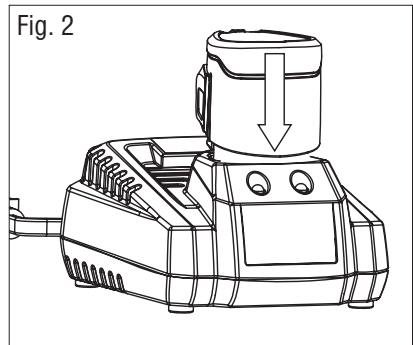





- Connect the charger to a power supply.
- Attach the battery pack to the charger by aligning the raised ribs of the battery pack with the slot in the charger. Insert the battery pack into the charger (Fig. 2)
- The charger will communicate with the battery pack to evaluate the condition of the battery pack.
- The green lights will flash while the battery pack is charging. After charging is complete, the green LED on the charger will be on. The flickering red light indicates defective battery or bad connection between the battery and the charger.
- If left on the charger, the battery pack will fully charge, but will not overcharge.



**NOTE:** For your convenience, the charger can operate with most generators and inverters rated at 300 W or higher.

## LED FUNCTIONS OF THE CHARGER (Fig. 3)

Fig. 3

LED INDICATOR	BATTERY PACK	RED LED	GREEN LED	ACTION
 HI/LO TEMP. (SEE MANUAL) 	Hot/Cold battery	On	Off	Charging will begin when battery returns to 32°F(0°C)-104°F(40°C)
 DEFECTIVE BATTERY 	Defective	Flashing	Off	Battery pack or Charger/Adapter is defective
 BATTERY CHARGING 	Charging	Off	Flashing	Charging
 BATTERY FULL 	Fully charged	Off	On	Charging is complete Maintenance charging

### CHARGING A HOT BATTERY PACK

If the battery pack is above normal temperature range, the red LED will be lit and the green LED will be off. When the battery pack cools down to approximately 104° F (40° C), the charger will begin charging automatically.

### CHARGING A COLD BATTERY PACK

If the battery pack is below the normal temperature range, the red LED will be lit and the green LED will be off. When the battery warms to a temperature of more than 32° F (0° C), the charger will begin charging automatically.

### DEFECTIVE BATTERY

If the charger detects a problem, the red LED will begin flashing and the green LED will be off.

- If defective, remove and reinsert the battery pack in the charger. If the LED status reads “defective” a second time, try charging a different battery pack.
- If a different battery pack charges normally, dispose of the defective battery pack (see Maintenance section).
- If a different battery pack also indicates “defective,” the charger may be defective.

### BATTERY CHARGING

If the temperature of the battery pack is within the normal temperature range, the green LED will begin flashing and the red LED will be off. The battery pack will reach a full charge in 30 minutes.

### BATTERY FULL

If the battery pack is within the normal temperature range, the green LED will be lit and the red LED will be off. The battery pack is fully charged and ready to use. If left on the charger, the battery pack will fully charge, but will not overcharge.

**NOTE:** The charger may become warm with several continuous charge cycles. This is part of the normal operation of the charger. Charge in a well-ventilated area.

### TO ATTACHING THE BATTERY PACK (Fig. 4)

**⚠CAUTION:** To avoid the possibility of accidental starting, always take care not to activate the trigger switch when you are attaching the battery pack or performing others to the tool.

- Align the raised portion on the battery pack with the grooves on the bottom of the hammer, and then attach the battery pack to the hammer as shown.
- Make sure the latch on the battery pack snap into place and the battery pack is secured to the tool before beginning the operation.

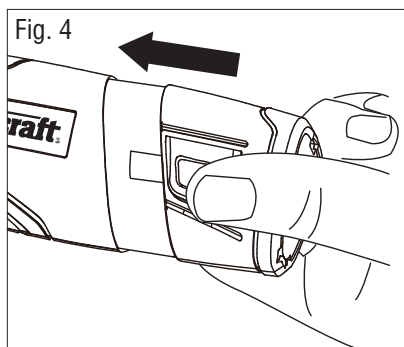

### TO DETACHING THE BATTERY PACK (Fig. 4)

**⚠CAUTION:** To avoid the possibility of accidental starting, always take care not to activate the trigger switch when you are detaching the battery pack or performing others to the tool.

- Depress the battery release buttons that are located on the both sides of the battery pack in order to release the battery pack.
- Pull the battery pack out and remove it from the tool.

**⚠CAUTION:** When placing the battery pack in the tool, be sure the raised rib on the battery pack aligns with the groove inside the hammer, and that the latches snap into place properly. Improper assembly of the battery pack can cause damage to internal components.

### TRIGGER SWITCH (Fig. 5)

1. To start the tool, press the trigger switch and keep it pressed.
2. To switch the unit off, release the trigger switch

**⚠CAUTION:** Do not let familiarity with your hammer make you careless. Remember that a fraction of a second of carelessness is sufficient to cause severe injury.

The LED worklight located on the base of the hammer comes on when the trigger switch is depressed. The LED worklight turns off when the trigger switch is released. This provides additional lighting on the surface of the workpiece for operation in lower-light areas.

Fig. 5

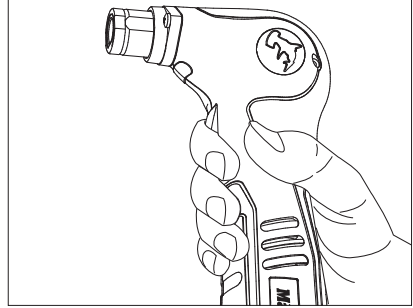

## HAMMER HEAD

The hammer head impacts the nails automatically when the tool is turned on.

## MAGNETIC SLEEVE

The Magnetic sleeve helps to hold the nails for hammering.

## HAMMERING (Fig. 6)

1. Attach the battery pack to the auto hammer.
2. Secure the material to be nailed with clamps in order to keep it from turning when hammering.
3. Holding the auto hammer firmly, place the hammer head against the nail. The magnetic sleeve will help to hold the nail in place.
4. Holding the shaft of the nail steady with your hand, press the trigger switch to drive the nail far enough into the workpiece so that it stands on its own. Remove your hand from the nail.
5. After the nail is secured in the workpiece, remove your hand from the nail.

Fig. 6

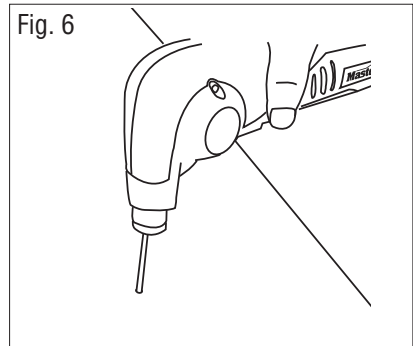

**⚠WARNING :** Failure to remove the hand from the nail could result in personal injury.

6. Place the magnetic sleeve over the nail. Depress the trigger switch in order to continue hammering until the nail is fully hammered into the workpiece.

**⚠ WARNING :** Do not force the hammer or apply sideways pressure. Hold the tool firmly. The tool will hammer the nail automatically.

### Recommended Nailing Materials for the Auto Hammer

The Auto Hammer can be used for driving nails into all types of woods, wood-like materials, and plaster board.

**Note:** This tool is not suitable for driving nails into hard metal or concrete.

### Recommended Nails to Use

The Auto Hammer is versatile for use with a variety of nails. Nails with a diameter of less than 7/16" (11 mm) and a length equal to or less than 3 1/2" (8.9 cm) are recommended for use with this Auto Hammer.

Refer to the table below for recommended nails to use:

No	Nail Type	Size	Shank Diameter	Head Diamete	Length
1	Bright Common	4d	0.1"	1/4"	1 1/2-in
2	Bright Finish	6d	0.091"	9/64"	2-in
3	Bright Finish	4d	0.072"	7/64"	1 1/2-in
4	Coated Sinker	4d	0.08"	13/64"	1 3/8-in
5	Electro Galvanized Roofing	4d	0.12"	1/4"	1 1/2-in
6	Framing nails	10d	0.115"	3/8"	3-in
7	Tempered Hard Trim	6d	0.07"	9/64"	2-in
8	Framing nails	16d	0.1495"	5/16"	3 1/2- in

### TROUBLESHOOTING

PROBLEM	CAUSE	SOLUTION
The auto hammer does not work	Battery is depleted	Charge the battery
	The machine is too hot after continuous use	Cool down the machine
	Battery is too hot after continuous use	Allow the battery to cool or replace it with a cool battery



**⚠️WARNING :** Turn the trigger switch to the “OFF” position and remove the battery from the power tool before performing troubleshooting procedures.

**Contact the Canadian Tire Service Centre at 1-800-689-9928 (toll free) if the problem remains unsolved after the above checks.**

## **MAINTENANCE**

Before each use:

- Inspect the auto hammer, the trigger switch, and the cord for damage.
- Check for damaged, missing, or worn parts.
- Check for loose screws, misalignment or binding of moving parts, or any other condition that may affect the operation.
- If abnormal vibration or noise occurs, turn the hammer off immediately and have the problem corrected before further use. Remove the battery from the tool before cleaning or performing any maintenance. Using compressed air may be the most effective cleaning method. Always wear safety goggles when cleaning tools using compressed air.

**⚠️WARNING :** Do not let brake fluids, gasoline, petroleum-based products, penetrating oil, etc. come into contact with plastic parts. These substances contain chemicals that can damage, weaken, or destroy plastic.

**⚠️WARNING :** When servicing, use only identical replacement parts. The use of any other parts may create a hazard or cause damage to the product.

**⚠️WARNING :** Use only accessories that are recommended for this hammer by the manufacturer. Accessories that may be suitable for one tool may become hazardous when used with another tool.

**⚠️WARNING :** Maintain tools with care. Keep cutting tools sharp and clean. Properly maintained tools with sharp cutting edges are less likely to bind, and are easier to control.

**⚠️WARNING :** To ensure safety and reliability, all repairs should be performed by a qualified service technician.

EXPLODED VIEW

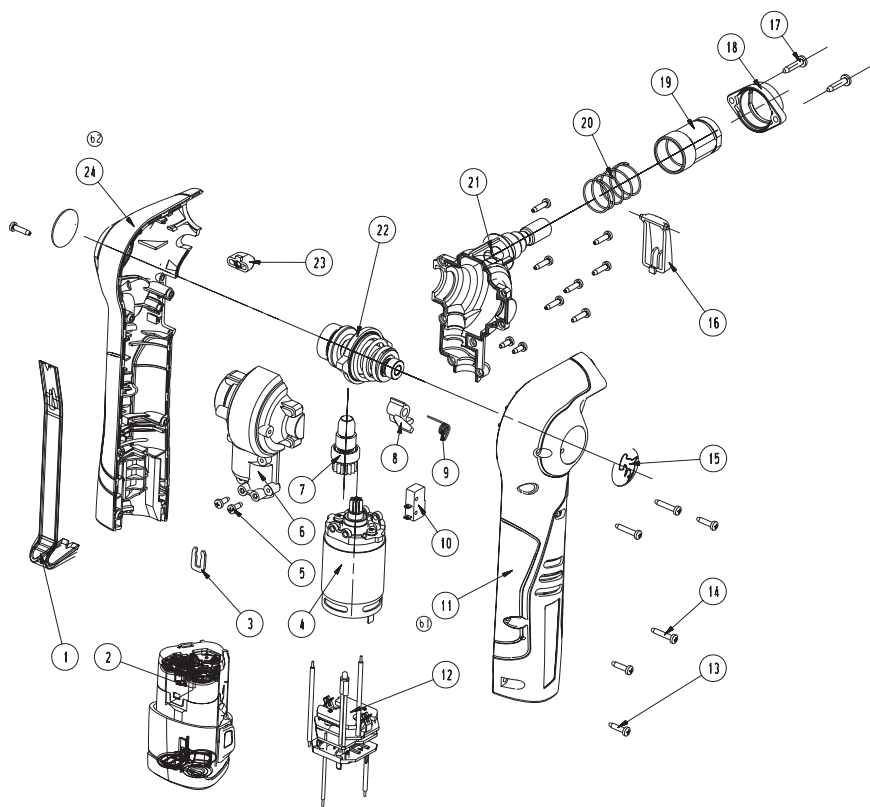

## PARTS LIST

No	Part No	Part Name	Qty
1	3704397000	Nail Remover	1
2	2770153000	5120 Power Pack	1
3	3704254000	Handle Hoop	1
4	2822577000	Motor&Gear ASSY	1
5	5610010000	Tapping Screw	4
6	3124289000	Right Gear Case	1
7	2822572000	Gear Set	1
8	3124418000	Push Button	1
9	3660374000	Torsion Spring	1
10	4870397000	Micro Switch	1
11	3320859000	Right Housing ASSY	1
12	4890504000	PCB Assembly	1
13	5610012000	Tapping Screw	11
14	5610013000	Tapping Screw	3
15	3124514000	Logo Label	2
16	3124287000	Switch Trigger	1
17	5610024000	Tapping Screw	2
18	3124504000	Support	1
19	2822569000	Top Cover ASSY	1
20	3660376000	Spring	1
21	2822614000	Gear Case Cover ASSY	1
22	2822762000	Impact Block ASSY	1
23	3124148000	LED Cover	1
24	3320858000	Left Housing ASSY	1

## MASTERCRAFT LIMITED WARRANTY

This **Mastercraft®** product is guaranteed for **three (3) years from the date of original retail purchase** against defects in materials and workmanship, except for the following components:

- a) Component A: Batteries, chargers and carrying case, which are guaranteed for a period of **2 years** from the date of original retail purchase against defects in workmanship and materials;
- b) Component B: Accessories, which are guaranteed for a period of **1-year** from the date of original retail purchase against defects in workmanship and materials.

Subject to the conditions and limitations described below, this product, if returned to us with proof of purchase within the stated warranty period, and if covered under this warranty, will be repaired or replaced (with the same model, or one of equal value or specification) at our option. We will bear the cost of any repair or replacement and any costs of labour relating thereto.

**These warranties are subject to the following conditions and limitations:**

- a) a bill of sale verifying the purchase and the purchase date must be provided;
- b) this warranty will not apply to any product or part thereof that is worn or broken or that has become inoperative due to abuse, misuse, accidental damage, neglect or lack of proper installation, operation or maintenance (as outlined in the applicable owner's manual or operating instructions), or that is being used for industrial, professional, commercial or rental purposes;
- c) this warranty will not apply to normal wear and tear or to expendable parts or accessories that may be supplied with the product and that are expected to become inoperative or unusable after a reasonable period of use;
- d) this warranty will not apply to routine maintenance and consumable items, including but not limited to fuel, lubricants, vacuum bags, blades, belts, sandpaper, bits, fluids, tune-ups or adjustments;
- e) this warranty will not apply where damage is caused by repairs made or attempted by others (i.e. persons not authorized by the manufacturer);
- f) this warranty will not apply to any product that was sold to the original purchaser as a reconditioned or refurbished product (unless otherwise specified in writing);
- g) this warranty will not apply to any product or part thereof if any part from another manufacturer is installed therein or any repairs or alterations have been made or attempted by unauthorized persons;
- h) this warranty will not apply to normal deterioration of the exterior finish, including but not limited to scratches, dents, paint chips, or to any corrosion or discolouring caused by heat, abrasive and chemical cleaners; and
- i) this warranty will not apply to component parts sold by and identified as the product of another company, which shall be covered under the product manufacturer's warranty, if any.

**Additional Limitations**

This warranty applies only to the original purchaser and cannot be transferred. Neither the retailer nor the manufacturer shall be liable for any other expense, loss or damage, including but not limited to any indirect, incidental, consequential or exemplary damages arising in connection with the sale, use or inability to use this product.

**Notice to the Consumer**

This warranty gives you specific legal rights, and you may have other rights, which may vary from province to province. The provisions contained in this warranty are not intended to limit, modify, take away from, disclaim or exclude any statutory warranties set forth in any applicable provincial or federal legislation.





