

model no. 054-0237-0

Mastervac ®/MD

WET/DRY VACUUM

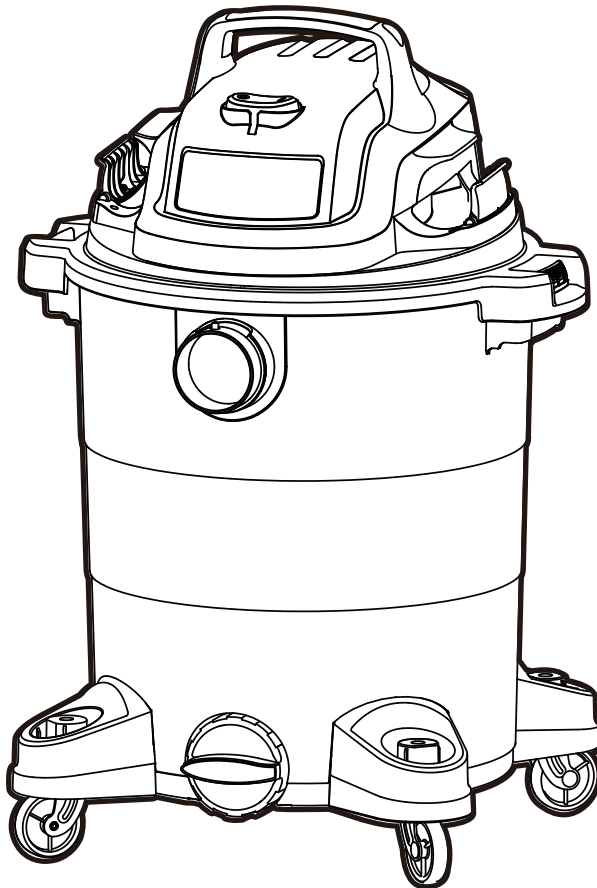

IMPORTANT:

Read and understand this instruction manual thoroughly before using the product.

**INSTRUCTION
MANUAL**

TABLE OF CONTENTS

SPECIFICATIONS	4
EXTENSION CORDS	4
SAFETY WARNINGS	5
LOCATION OF PARTS	8
GENERALASSEMBLY INSTRUCTIONS	9
DRY VACUUM OPERATION	12
WET VACUUM OPERATION	14
BLOWER OPERATION	16
MAINTENANCE	17
CARTRIDGE FILTER	19
TROUBLESHOOTING	21
ACCESSORIES	22
EXPLODED VIEW	23
PARTS LIST	24
WARRANTY	25

If any parts are missing or damaged, or if you have any questions, please call our toll-free helpline at 1-800-689-9928.



Read and understand this instruction manual thoroughly before using the product. It contains important information for your safety as well as operating and maintenance advice.
Keep this instruction manual for future use. Should this product be passed on to a third party, then this instruction manual must be included.

Tank size:	30 L (8 U.S. gallons / 6 5/8 imperial gallons)
Peak horsepower:	4
Power:	120 V, 60 Hz, 9 A
Tank:	Polypropylene
Power cord:	6' (1.8 m)
Hose:	1 1/4" x 7' (3.2 cm x 2.1 m)
Water lift:	58" (147.3 cm) at end of hose
Air flow:	67.8 CFM at end of hose
Noise:	80 dBA
Filters:	Cloth filter, foam filter
Weight:	14 lb 2 oz (6.4 kg)

When using an extension cord with your Wet/Dry Vac refer to the following table to determine the required AWG wire size. Before using the cleaner make sure the power cord and extension cord are in good working conditions. Make repairs or replacements before using the vacuum cleaner. Only use extension cords that are rated for outdoor use.

Length of Extension Cord				
110V-120V	25'(7.5 m)	50' (15.25 m)	100' (30.5 m)	150' (45.7 m)
Amps	AWG Wire Size			
0-6	18	16	16	14
7-10	18	16	14	12
11-12	16	16	14	12
13-16	14	12	Not recommended	

IMPORTANT SAFETY INSTRUCTIONS

Household Type

SAVE THIS MANUAL FOR FUTURE REFERENCE.

- Read all instructions before using this appliance
- Read and understand this instruction manual and all labels on the Wet/Dry Vacuum before using.
- Safety is a combination of common sense, staying alert and knowing how this Wet/Dry Vacuum works. Use this Wet/Dry Vacuum only as described in this manual. To reduce the risk of personal injury or damage to the Wet/Dry Vacuum, use only recommended accessories.

Understanding Safety Terminology

When using this Wet/Dry Vacuum follow basic safety precautions including the following:

To reduce the risk of fire, electric shock or injury:

- Do not run the Wet/Dry Vacuum unattended.
- Do not vacuum, or use this Wet/Dry Vacuum near liquids, gases, or explosive vapours like gasoline or similar fuels, lighter fluid, cleaners, oil based paints, natural gas or hydrogen. Do not vacuum or use this Wet/Dry Vacuum near explosive dusts like coal dust, magnesium dust, grain dust, or gunpowder as sparks inside the motor can ignite flammable vapours or dust.
- Do not vacuum burning or smoking items such as cigarettes, matches, or hot ashes.
- Keep the cord away from heated surfaces.
- Do not expose to rain. Store indoors.
- Do not unplug by pulling on cord. To unplug, grasp the plug, not the cord.
- Do not use if the cord, plug or other parts are damaged.
- If the Wet/Dry Vacuum is not working correctly or has missing parts, has been dropped or damaged, left outdoors or dropped in water, return it to an independent service centre.
- Do not pull or carry by the cord. Do not use the cord as a handle, close a door on the cord, or pull the cord around sharp edges or corners.
- Do not run the Wet/Dry Vacuum over the cord.
- Do not handle the plug or the Wet/Dry Vacuum with wet hands.



DANGER!

If safety information is not followed, someone will be seriously injured or killed.

WARNING!

If safety information is not followed, someone could be seriously injured or killed.

CAUTION!

If safety information is not followed, someone may be injured.

- To reduce the risk of health hazards from vapours or dusts, do not vacuum toxic materials.
- Do not use or store near hazardous materials.
- Do not use this Wet/Dry Vacuum with a torn filter or without installing the filter except when vacuuming liquids as described in the operation section of this manual.
- Do not use the Wet/Dry Vacuum as a toy. Pay particularly close attention when it is being used by or near children.
- To reduce the risk of injury from the Wet/Dry Vacuum accidentally starting, unplug the power cord before changing or cleaning the filter.
- Do not leave the Wet/Dry Vacuum unattended when it is plugged in. Unplug it from the power outlet when not in use and before servicing. Turn off the Wet/Dry Vacuum before unplugging.
- Do not put any objects into the ventilation openings. Do not vacuum with any ventilation openings blocked.
- Keep free of dust, lint, hair or any other items that may reduce the air flow.
- Keep hair, loose clothing, fingers, and all body parts away from openings and moving parts.
- To reduce the risk of falling, use extra care when cleaning on stairs.

When using as blower:

- Direct air discharge only at work area.
- Do not use Wet/Dry Vac as a sprayer.
- Do not direct air at bystanders.
- Keep children away when blowing.
- Wear safety goggles.

This Wet/Dry Vacuum is double-insulated, eliminating the need for a separate grounding system. Use only identical replacements parts. Read the servicing instructions before servicing the Wet/Dry Vacuum.

Use this Wet/Dry Vacuum only as described in this manual.

Observe the following warnings that appear on the motor housing of this Wet/Dry Vacuum.



DOUBLE INSULATED GROUNDING NOT REQUIRED. WHEN SERVICING USE ONLY IDENTICAL REPLACEMENT PARTS.



WARNING!

For your own safety, read and understand this instruction manual. Do not operate unattended. Do not use this Wet/Dry Vacuum to pick up hot ashes, coals, toxic, flammable or other hazardous materials. Do not use near explosive liquids or vapours.

WARNING!

To reduce the risk of electric shock, do not expose to rain. Store indoors.



CAUTION!

Do not vacuum drywall dust or cold fireplace soot or ash with a standard wet/dry filter. This dust is very fine and hence will not be captured by the filter and may cause damage. Refer to the operation section for proper filter selection.

WARNING!

SERVICING OF DOUBLE-INSULATED WET/DRY VACUUM.

CAUTION!

To reduce the risk of injury from moving parts, unplug before servicing.

In a double-insulated Wet/Dry Vacuum, two systems of insulation are provided instead of grounding. No method of grounding is provided on a double-insulated appliance, nor should one be added. Servicing a double-insulated Wet/Dry Vacuum requires extreme care and knowledge of the system, and should be done only by qualified service personnel. Replacement parts for a double-insulated Wet/Dry Vacuum

must be identical to the parts that are being replaced. This Wet/Dry Vacuum is marked with the words 'DOUBLE INSULATED' and the symbol  may also be marked on the appliance.

- For household use only.
- To reduce the risk of electric shock, unplug before cleaning or servicing.
- DO NOT use without filters in place.
- To reduce the risk of electric shock, use indoors only.

POLARIZATION

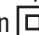
To reduce the risk of electric shock, this appliance has a polarized plug (one blade is wider than the other). This plug will fit in a polarized outlet only one way. If the plug does not fit fully in the outlet, reverse the plug. If it still does not fit, contact a qualified electrician to install the proper outlet. Do not change the plug in any way. Double insulation  eliminates the need for the three-wire, grounded power cord and grounded power supply system.

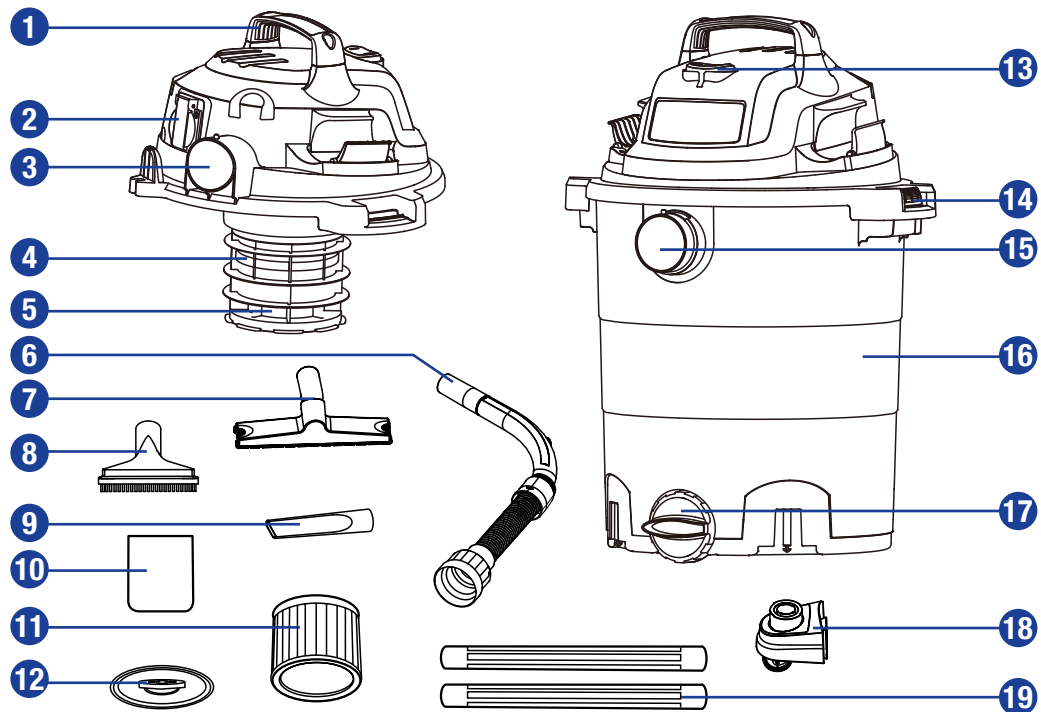

No.	Description	No.	Description
1	Handle	11	Regular Cartridge Filter
2	Top section	12	Filter retainer
3	Blower connection	13	Switch
4	Filter basket	14	Clasp (x 2)
5	Safety float valve	15	Vacuum hose connector
6	1 1/4" (3.17 cm) hose	16	Tank
7	10" (25.4 cm) floor brush	17	Drain outlet
8	Utility nozzle	18	Casters (x 4)
9	Crevice tool	19	Extension wand (x 2)
10	Foam Sleeve / Wet Filter		

- 1 Ensure that the power cord is disconnected from the power outlet.

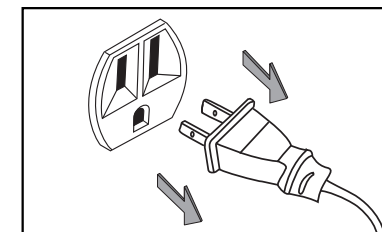

- 2 Undo the clasps.

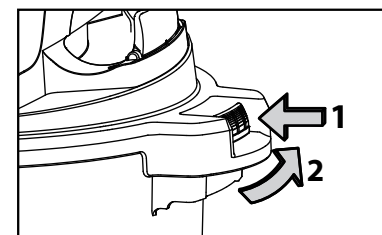

- 3 Lift the top section off the tank.

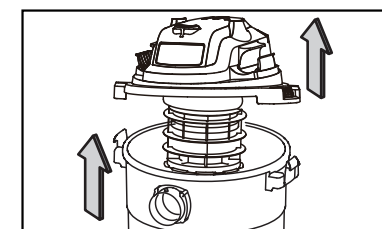

- 4 Remove the contents from inside the tank.

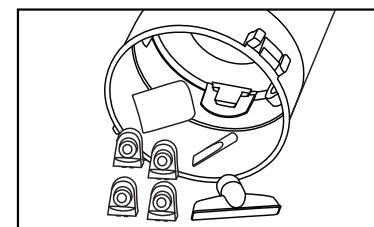

WARNING!

Do not plug in power cord to power outlet. make sure plug is disconnected before assembling the wet/dry vac.

- 5** Turn the tank upside down, and insert the casters on to the four feet of the tank. Ensure that they are mounted correctly. Do not over tighten.

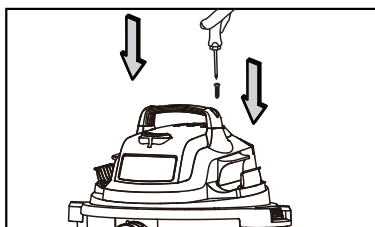
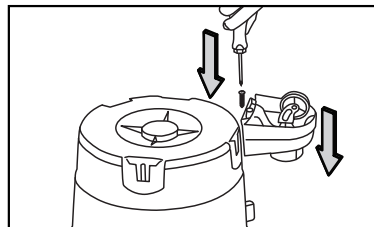

- 6** Remove the contents from inside the tank.

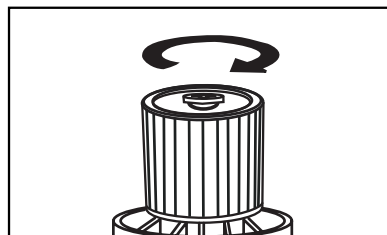

- 7** For dry vacuum cleaning, install the supplied cartridge filter.

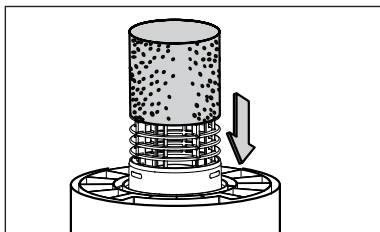

- 8** For wet vacuum cleaning, install the supplied foam filter.

- 9** Replace the top section on the tank. Align the top section with the clasps and snap into place by applying pressure until clasps click.

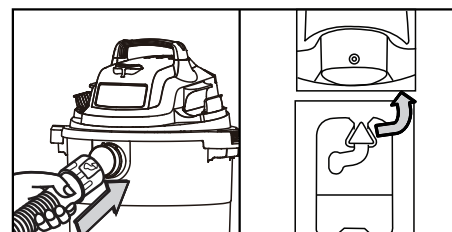
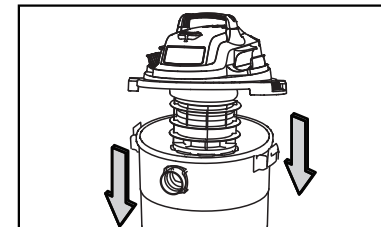

- 10** Insert the large end of the hose into the front inlet of the tank and turn to lock.

- 11** Fit the required accessory on to the suction tube.

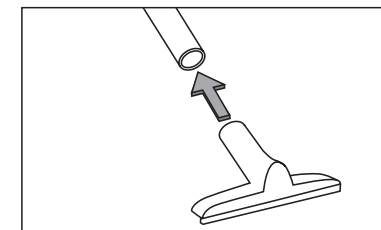

OPERATING INSTRUCTIONS – DRY VACUUMING

- 1** Ensure that the power cord is disconnected from the outlet.

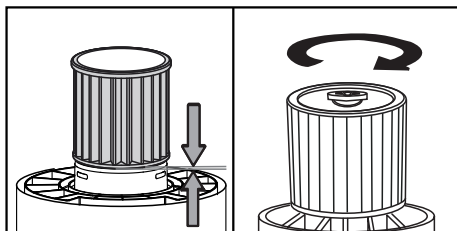
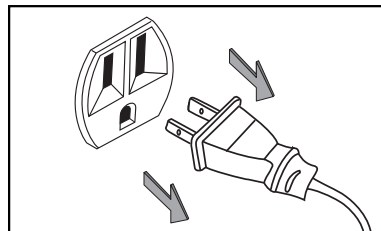

- 2** Ensure that the cartridge filter is completely mounted. Ensure that the filter is inserted all the way.

- 3** Replace the top section on the tank, and secure it in place using the clasps.

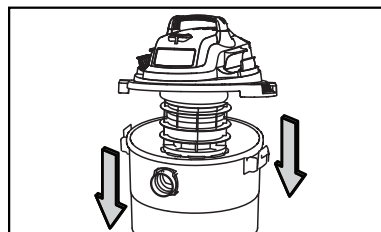

- 4** Insert the larger end of the hose into the front inlet on the tank and lock it in place. Push the required attachment on to the free end of the hose or extension.

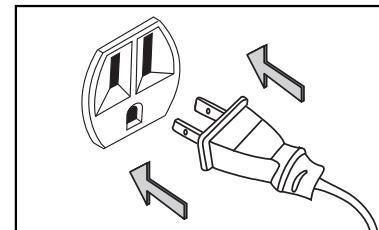
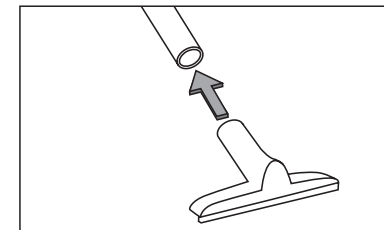

- 5** Plug the power cord in to the power outlet.

- 6** Turn the motor on by flipping the switch to the 'I' position.

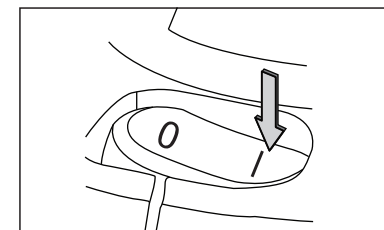

- 7** Once you have finished vacuuming, flip the switch to the 'O' position and unplug the power cord from the power outlet.

DO NOT USE THE CARTRIDGE FILTER FOR LIQUID VACUUMING.

O = OFF I = ON

**WARNING!**

Before starting please read, understand, and apply the safety instructions in Section 1.
Reminder: DO NOT vacuum hazardous substances.

Vacuuming Liquids

- 1 Ensure that the power cord is disconnected from the power outlet.
Ensure that the tank is clean and free of dust and dirt.

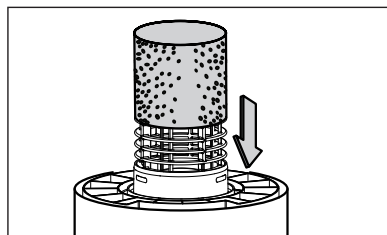
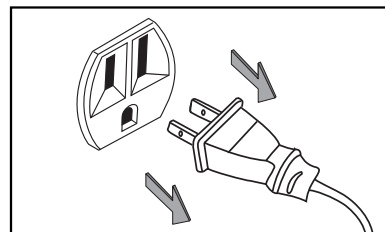

- 2 Remove the cartridge filter and install a foam filter over the filter basket and place the top section back on the tank.
DO NOT use the cartridge filter for wet or sharp materials.

- 3 Fit the desired nozzle to the vacuum hose.

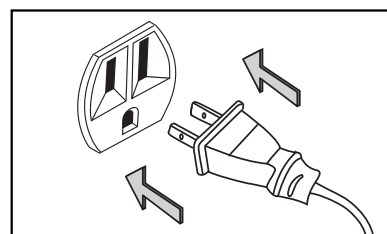
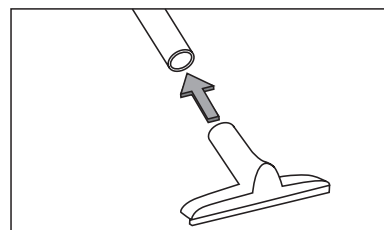

- 4 Ensure that the switch is in the '0' position before plugging the power cord into the power outlet.

- 5 Turn the motor on by flipping the switch to the "I" position.

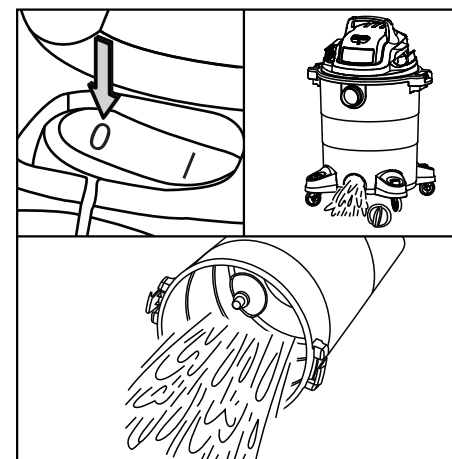
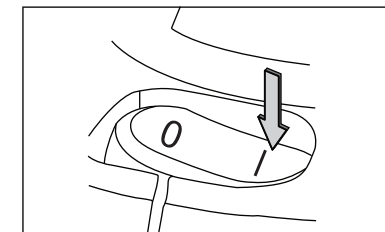

- 6 After use, flip the switch to the "0" position and unplug the power cord, then empty and dry the tank.

**WARNING!**

Before starting ensure to read, understand, and apply the safety instructions in section 1.
Reminder: DO NOT vacuum hazardous substances.

**REMEMBER!**

The foam filter must be removed after wet vacuuming, and a cartridge filter must be installed before dry vacuuming again.

IMPORTANT!

When vacuuming large quantities of liquids, do not immerse the nozzle completely in the liquid; leave a gap at the tip of the nozzle opening to allow air inflow. The machine is fitted with a float valve that stops the suction action when the container reaches its maximum capacity. You will notice an increase in motor speed. When this happens, turn off the machine, disconnect from power supply, and drain the liquid into a suitable receptacle or drain. To continue vacuuming, refit the container with the draincap. After wet vacuuming, turn the machine off and remove plug from power supply. Empty the container, clean and dry the inside and outside before storage.

This Wet/Dry Vac has blowing capabilities.
To use the blower feature follow the instructions listed.

- 1** Insert the large end of the hose into the blower connection in the top of the motor housing.

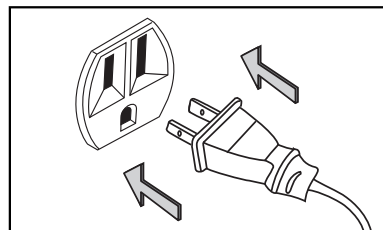
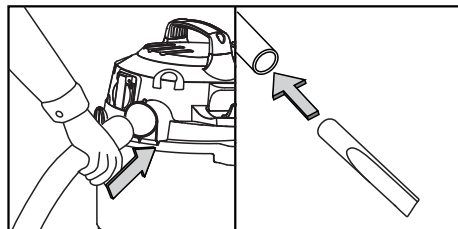

- 2** Ensure the power switch is turned off and plug in the power supply.

- 3** Turn the motor on by flipping the switch to the "I" position.

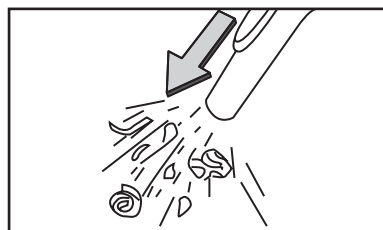
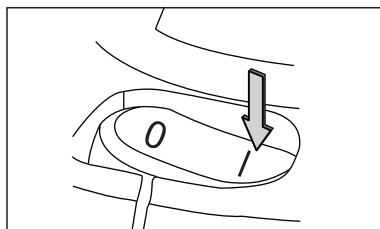

- 4** The unit will now blow through the vacuum hose and can be used to clear obstructions within the hose.

- 1** Ensure that the power cord is disconnected from the outlet.

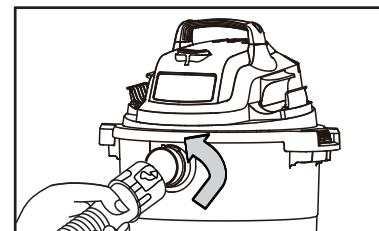
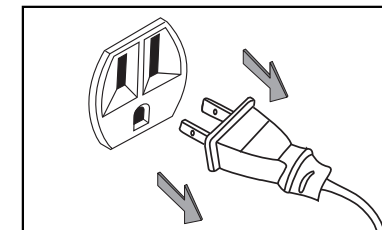

- 2** Disconnect the hose from the tank.

- 3** Undo the clasps and remove the top section from the tank.

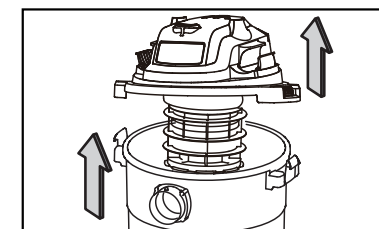

- 4** Clear all dirt or debris from the tank and hose.



WARNING!

ALWAYS WEAR SAFETY GOGGLES COMPLYING WITH ANSI Z87.1 (OR IN CANADA, CSA Z94.3) BEFORE USING BLOWER.

KEEP BYSTANDERS CLEAR FROM BLOWING DEBRIS.

WEAR A DUST MASK IF BLOWING CREATES DUST THAT MIGHT BE INHALED.

WARNING!

If after a few seconds the hose continues to be blocked, turn off the unit and clear the hose manually.

- 5 Clean the foam filter by washing it with a mild soapy solution.

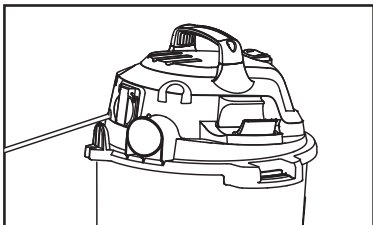
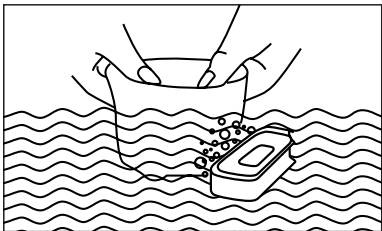

- 6 Check the hose, attachments and the power cord to ensure that they have not been damaged.

REPLACEMENT FILTERS

Replace filters regularly.

Foam Sleeve / Wet Filter (054-0035)
 Dry Reusable filter (054-0148)
 Household Collector Bag (054-0150)
 Fine Dust High Eff. Collector Bag (054-0212)
 Fine Dust High Efficiency Collector Bag (054-0262)
 Regular Cartridge Filter (054-0008)
 Fine Cartridge Filter (054-0255)
 HEPA Cartridge Filter (054-0159)



IMPORTANT!

CLEAN THE CARTRIDGE FILTER REGULARLY. IF THE MACHINE IS USED WITHOUT THE CARTRIDGE FILTER, THE MOTOR WILL BURN OUT AND THE WARRANTY WILL BE VOIDED. ALWAYS ENSURE TO KEEP SPARE FILTERS HANDY.

Installation and cleaning

- 1 Slide cartridge filter down over filter cage

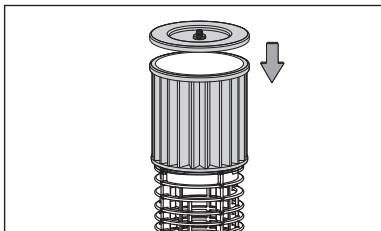
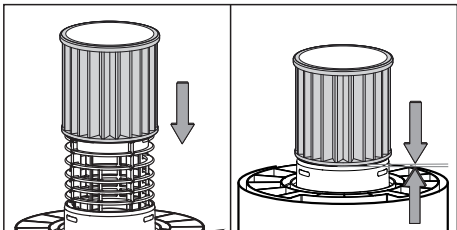

- 2 Place retainer on top of cartridge filter against hole of basket.

- 3 To secure filter; put on retainer nut and turn clockwise to tighten until snug. Do not over tighten.

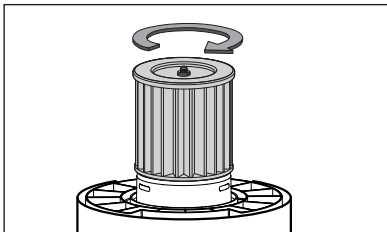

NOTICE!

The filter included is made of high quality material designed to stop small dust particles. The filter should be used for dry pick-up only. A dry filter is necessary to pick up dust. If the dust filter is wet, it will clog quickly and be very difficult to clean. Handle the filter carefully when removing it for cleaning and replacing it. Check the filters for tears or small holes; a small hole can let dust pass through and out of the cleaner. Do not use a filter with holes or tears; replace it immediately.



WARNING!

Always disconnect the plug from the power outlet before removing the power head from the collection tank.

- 4 To remove filter for cleaning again, hold lid assembly with one hand and turn retainer counter-clockwise.

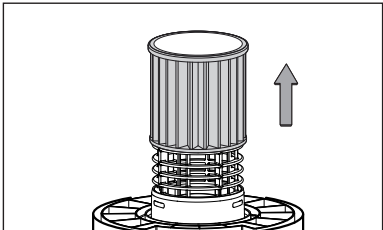
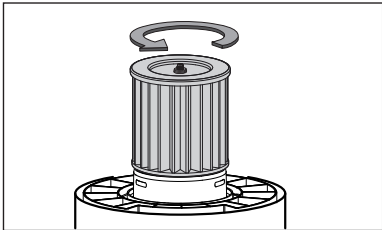

- 5 Slide cartridge filter off filter cage.

- 6 Clean filter by tapping it on inside of trash can. Clean filter by rinsing from the inside.

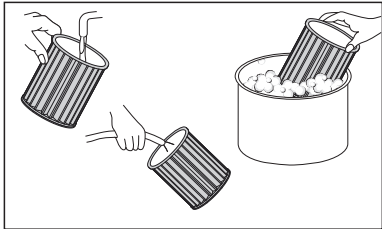

- 7 When wet (to prevent mould and/or mildew build-up), the cartridge filter should be moved and allowed to air dry for a 24-hour period before being re-installed back onto the filter cage.

Problem	Possible Causes	Corrective Action
Wet/Dry Vacuum will not operate.	No power supply.	Check power supply: cord, breakers, fuses.
	Faulty power cord.	Check the power cord and repair or replace as necessary.
	Tank is full of liquid.	Empty tank.
Motor cover emits dust.	The cartridge filter is missing or damaged.	Attach or replace the cartridge filter.
Reduced efficiency and motor/speed vibration.	Blockage in the nozzle, hose or the tank inlet.	Check the nozzle, the hose and the tank or filter inlet for blockage.
	Filter may be blocked by fine dust.	Remove the filter, wash and clean it. Do not reuse until it is completely dry. Use a new filter if necessary.

Additional accessories for your Mastervac® Wet/Dry Vacuum are available.

Consumables	
054-0035	Foam Sleeve / Wet Filter
054-0148	Dry Reusable Filter
054-0150	Household Collector Bag
054-0212	Fine Dust High Efficiency Collector Bag
054-0262	Tear-Resistant Wet/Dry Collector Bag
054-0008	Regular Cartridge Filter
054-0255	Fine Cartridge Filter
054-0159	Heap Cartridge Filter

1 1/4" accessories	
054-0047	Hose
054-0120	Multi-surface nozzle
054-0009	Micro kit
054-0084	Round brush
054-0085	Crevice tool
054-0086	Utility nozzle
054-0087	Floor nozzle
054-0128	Extension wand
054-0079	Claw utility nozzle
054-0080	1 1/4" to 2 1/2" adapter
054-0227	Crevice Tool and So
054-0226	Drain Hero

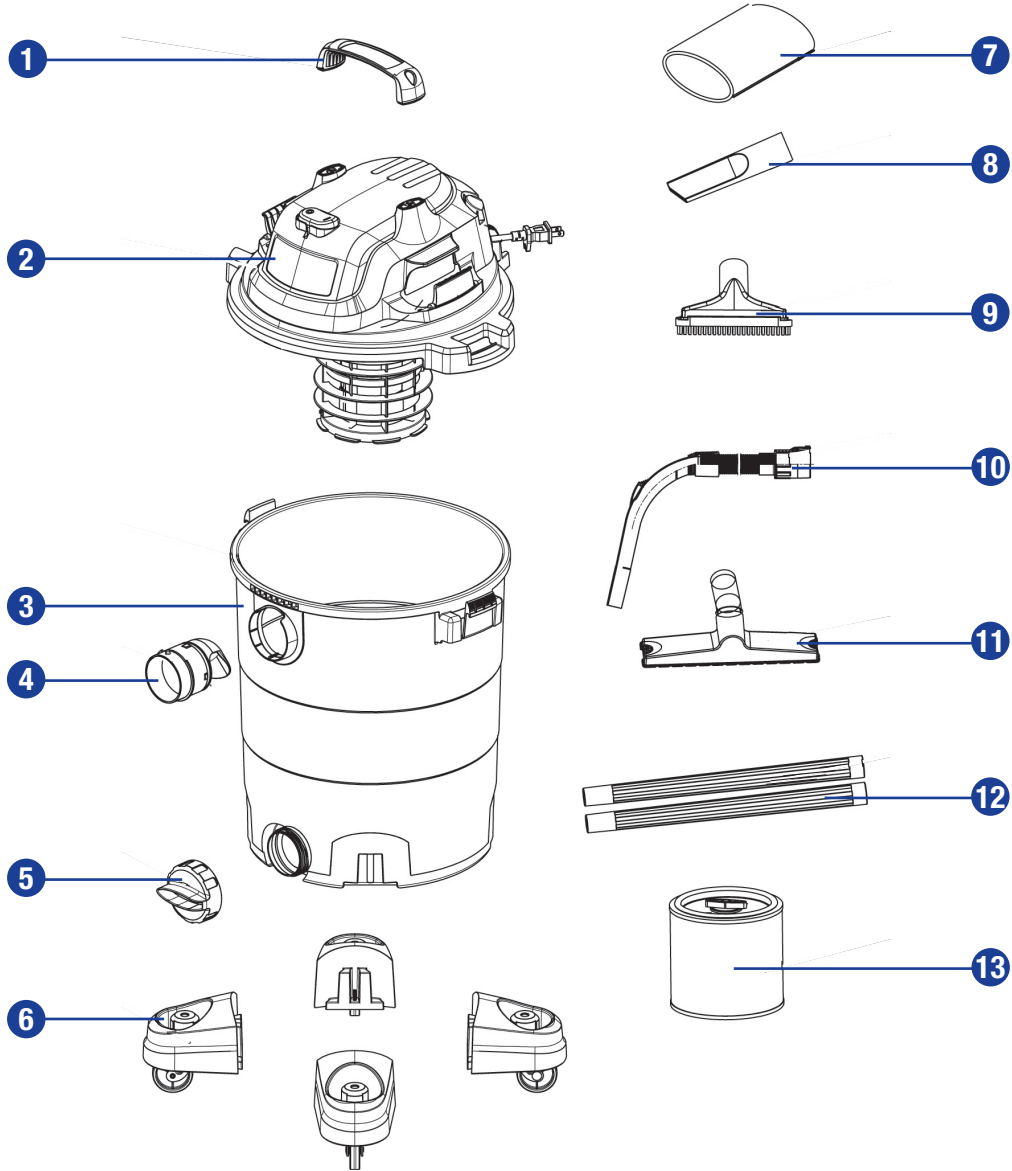

No.	Description
1	Handle
2	Head assembly
3	30 L (8 U.S. gallon / 6 5/8 Imperial gallon) tank
4	Hose inlet assembly
5	Drain outlet
6	Casters (×4)
7	Foam Sleeve / Wet Filter
8	Crevice tool
9	Utility nozzle
10	Hose
11	Floor brush
12	Extension wand (×2)
13	Cartridge Filter

If any parts are missing or damaged, or if you have any questions, please call the Toll-free Helpline, at 1-800-689-9928.

MASTERVAC LIMITED WARRANTY

This Mastervac product is guaranteed for a period of three (3) years from the date of original retail purchase against defects in materials and workmanship. Subject to the conditions and limitations described below, this product, if returned to us with proof of purchase within the stated warranty period and if covered under this warranty, we berepaired or replaced(with the same model, or one of equal value or specification),at our option. We will bear the cost of any repair or replacement and any costs of labour relating thereto.

This warranty is subject to the following conditions and limitations:

- a) a bill of sale verifying the purchase and purchase date must be provided;
- b) this warranty will not apply to any product or part thereof which is worn or broken or which has become inoperative due to abuse, misuse, accidental damage, neglect or lack of proper installation, operation or maintenance (as outlined in the applicable owner's manual or operating instructions) or which is being used for industrial, professional, commercial or rental purposes;
- c) this warranty will not apply to normal wear and tear or to expendable parts or accessories that may be supplied with the product which are expected to become inoperative or unusable after a reasonable period of use;
- d) this warranty will not apply to routine maintenance and consumable items such as, but not limited to, fuel, lubricants, vacuum bags, blades, belts, sandapaper, bits, fluids, tune-ups or adjustments;
- e) this warranty will not apply where damage is caused by repairs made or attempted by others (i.e. persons not authorized by the manufacturer);
- f) this warranty will not apply to any product that was sold to the original purchaser as a reconditioned or refurbished product (unless otherwise specified in writing);
- g) this warranty will not apply to any product or part thereof if any part from another manufacturer is installed therein or any repairs or alterations have been made or attempted by unauthorized persons;
- h) this warranty will not apply to normal deterioration of the exterior finish, such as, but not limited to, scratches, dents, paint chips, or to any corrosion or discolouring by heat, abrasive and chemical cleaners;
- i) this warranty will not apply to component parts sold by and identified as the product of another company, which shall be covered under the product manufacturer's warranty, if any.

Additional Limitations

This warranty applies only to the original purchaser and may not be transferred. Neither the retailer nor the manufacturer shall be liable for any other expense, loss or damage, including, without limitation, any indirect, incidental, consequential or exemplary damages arising in connection with the sale, use or inability to use this product.

Notice to Consumer

This warranty gives you specific legal rights, and you may have other rights, which may vary from province to province. The provisions contained in this warranty are not intended to limit, modify, take away from, disclaim or exclude any statutory warranties set forth in any applicable provincial or federal legislation.

Made in China

Imported by
Trifleaf Distribution Trifeuil Toronto, Canada
M4S 2B8