

CANVAS^{TM/MC}

ATLAS 1-LIGHT PENDANT

MODEL NO. 052-8360-0



ASSEMBLY INSTRUCTIONS

IMPORTANT: Please read this manual carefully before attempting to assemble, operate or install the product, and save it for reference.

Package and Hardware Contents	2
Important Safety Instructions	3
Assembly Preparation	3
Assembly Instructions	4
Care and Maintenance/Troubleshooting	7
Warranty	7

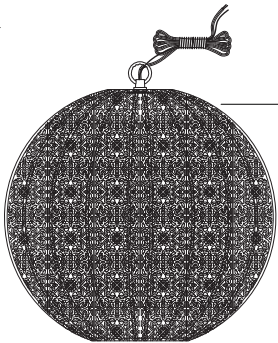

A

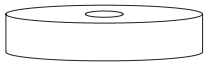

Canopy
Qty. 1

AA

BB



Chain
Qty. 1

CC



Chain link
Qty. 2

DD



Bracket
Qty. 1

EE



Nipple
Qty. 1

FF



Hex nut
Qty. 2

GG



Collar
loop
Qty. 1

HH



Collar
loop ring
Qty. 1

II



Outlet
box screw
Qty. 2

JJ



Wire
connector
Qty. 3

▲ CAUTION

The following rules must be adhered to when assembling the product. If you have any doubts about how to install the product or if it fails to work properly, contact a local, licensed electrician. Failure to comply with these requirements could lead to an electric shock or fire, which could cause serious injury or fatality.

Ensure:

Power at the main fuse box is disconnected before installing the fixture.

The fixture ground wire (bare or green insulated wire) is NOT connected to current-carrying wires.

No bare wires are exposed outside the wire connectors when joining current-carrying wires.

The insulation on wires has not been damaged during installation.

No rough or sharp edges are in contact with any of the wires.

Fixture wires are connected to the proper house supply wires. If you have any doubts about which house supply wire is white and which is black, contact a licensed electrician.

Light bulbs with wattage no greater than those specified for the fixture are used.

Power is off when installing light bulb into the fixture.

Before beginning assembly of this product, make sure all parts are present. Compare parts with package contents list and hardware contents list. If any part is missing or damaged, do not attempt to assemble, install or operate the product.

Place all parts from the box in a cleared area and position them on the floor in front of you. Remove all packing materials and place them back into the box. Do not dispose of the packing materials until assembly is complete. Read each step carefully before beginning any assembly and make sure you understand each step.

Tools required for assembly (not included):

Flat-head screwdriver, cross-head screwdriver, electrical tape, safety glasses, ladder, wire strippers, pliers.



4 MODEL NO. 052- 8360-0

1. Secure the bracket (DD) onto the outlet box (not included) with outlet box screws (II) and tighten until snug. Thread one hex nut (FF) onto top end of the mounting nipple (EE), then thread the mounting nipple (FF) into the centre lock hole of the bracket (DD). Using pliers (not included) secure hex nut (FF) against the crossbar (DD). Thread another hex nut (FF) onto the bottom end of the mounting nipple (EE).

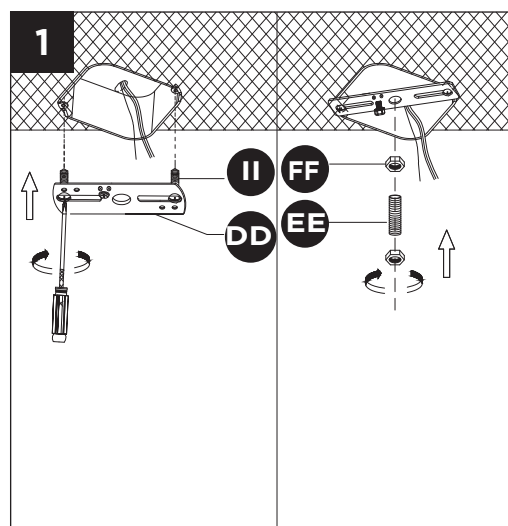

2. Remove collar loop ring (HH) from collar loop (GG). Pull the canopy (AA) through the collar loop (GG), chain (BB), and then attach the chain link (CC) to collar loop (GG) and chain (BB).

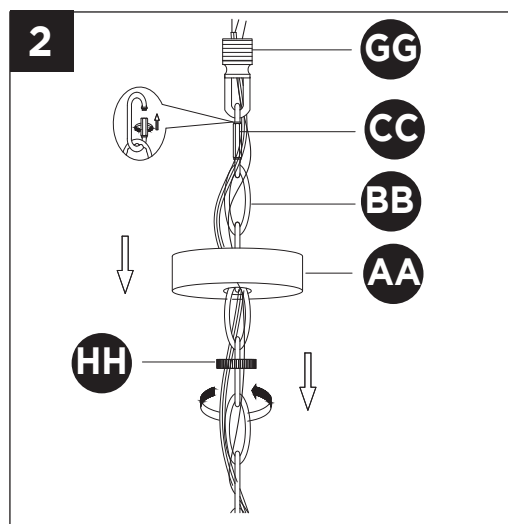

3. Turn collar loop (GG) onto mounting nipple (EE) and adjust the hex nut (FF) so it attaches to the collar loop (GG). Pull the supply wires through the chain (BB), alternating links, then pull the wires through the collar loop ring (HH), canopy (AA), collar loop (GG) and then mounting nipple (EE).

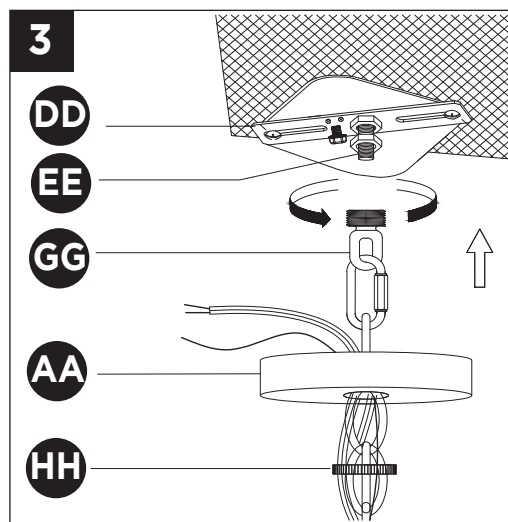

4. Attach chain (BB) to fixture loop on fixture body (A) with chain link (CC).

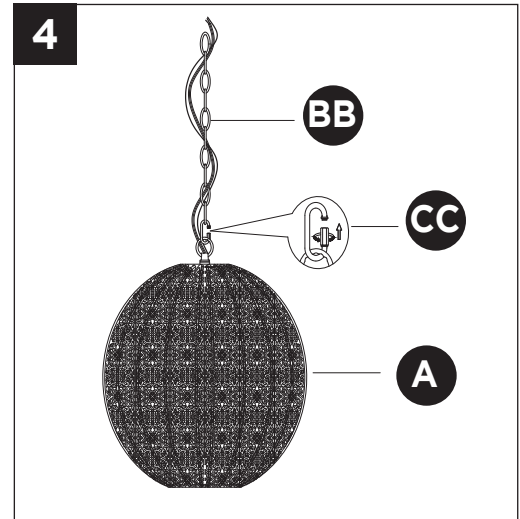

5. Strip 3/4" (19 mm) of insulation from fixture wire ends. Twist stripped ends together with pliers (not included). Connect the smooth, or un-tinned wire with writing from the fixture ("N") with the white wire from the outlet box. Connect the ribbed or tinned wire without writing from the fixture ("L") to the black wire from the outlet box in same manner. Snip ends. Wrap the ground wire from the outlet box around the green screw preassembled on the bracket (DD), and then connect the ground wire from the outlet box to the ground wire from the fixture. Attach wire connectors (JJ) to ends. Tape wire connectors (JJ) and wires together with electrical tape (not included).

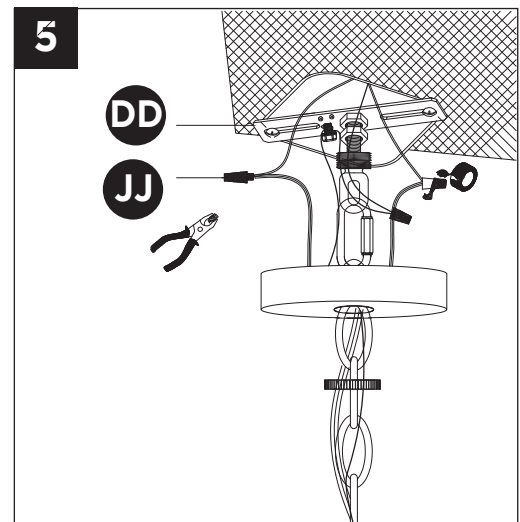

6. Push canopy (AA) upward to the outlet box. Thread the collar loop ring (HH) onto the collar loop (GG) and tighten until snug to secure canopy (AA).

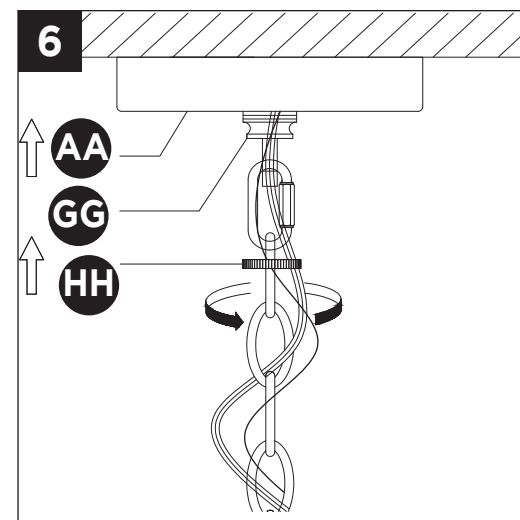

- 7.** Install the bulb. Use one 60 W (max.) type A lamp (not included).

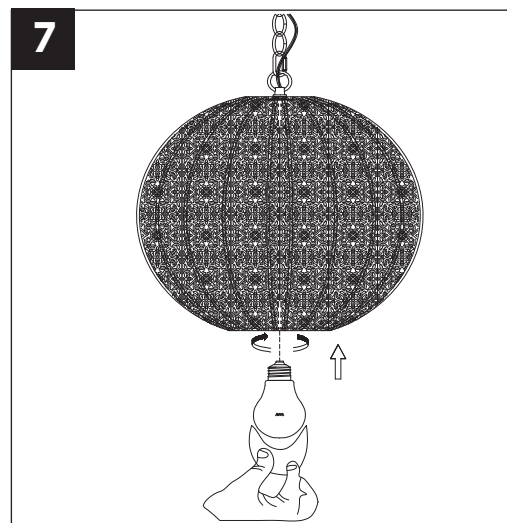

CARE AND MAINTENANCE

- Shut off main power before cleaning light with damp cloth or window cleaner. Do not use abrasive cleansers.
- Bulb replacement: Use one 60 W (max.) type A lamp or equivalent CFL.

TROUBLESHOOTING

PROBLEM	POSSIBLE CAUSE	CORRECTIVE ACTION
Bulb won't light.	1. Bulb is burned out. 2. Power is off. 3. Faulty wire connection. 4. Faulty switch.	1. Replace the bulb. 2. Check if power supply is on. 3. Check wiring. 4. Test or replace the switch.
Fuse blows out or circuit breaker trips when light is turned on.	1. Crossed wires or power wire is grounding out.	1a. Check the wiring connection. 1b. Consult a qualified electrician.

This CANVAS product carries a one (1) year warranty against defects in workmanship and materials.

Trileaf Distribution agrees to replace a defective product free of charge within the stated warranty period, when returned by the original purchaser with proof of purchase. This product is not guaranteed against wear or breakage due to misuse and /or abuse.

Made in China
Imported by
Trileaf Distribution Trifeuil Toronto, Canada M4S 2B8