

CANVAS^{TM/MC}

FLOOR LAMP

MODEL NO. 052-7827-8

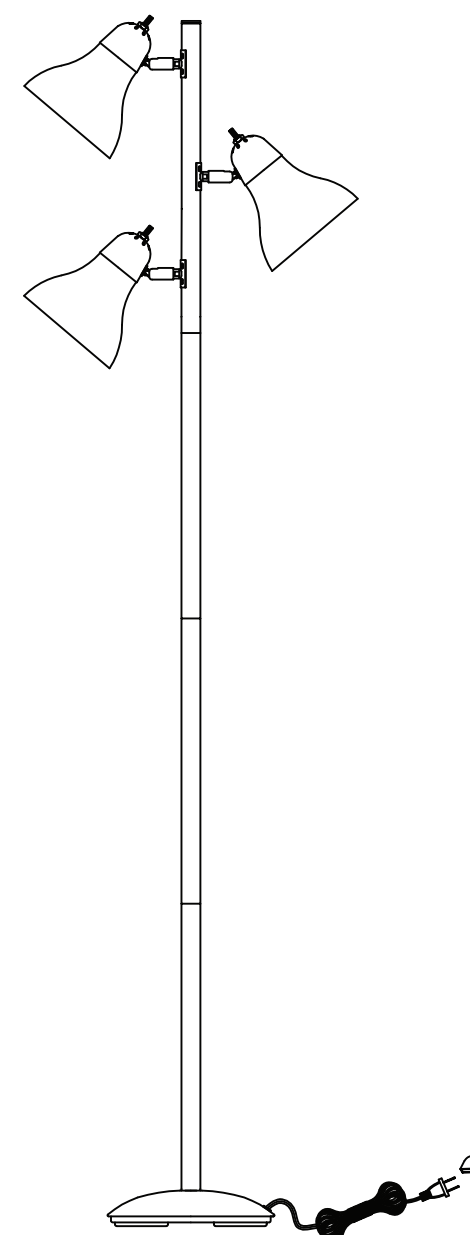

ASSEMBLY INSTRUCTIONS

IMPORTANT: Please read this manual carefully before attempting to assemble, operate or install the product, and save it for reference.

Package Contents	2
Important Safety Instructions	3
Assembly Preparation	3
Assembly Instructions	4
Care and Maintenance/Troubleshooting	6
Warranty	6

Package Contents

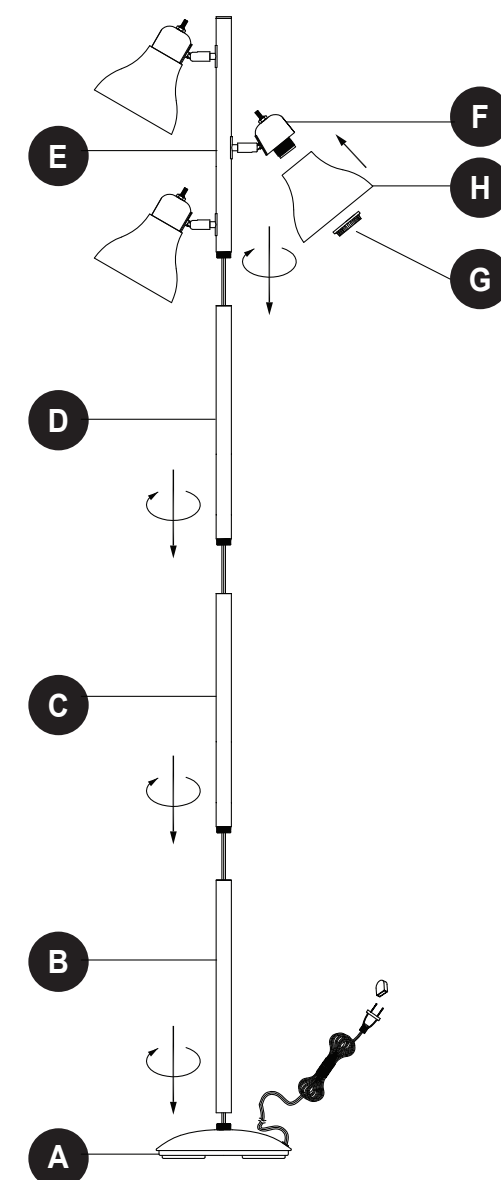

PART	DESCRIPTION	QUANTITY
A	Lamp Base	1
B	Bottom Stem	1
C	Middle Stem 1	1
D	Middle Stem 2	1
E	Fixture	1
F	Socket	1
G	Socket Ring	1
H	Plastic Shade	3

2

Table of Contents

CANVAS^{TM/MC}

3

Important Safety Instructions

CAUTION

The following rules must be adhered to when assembling the product. If you have any doubts about how to install the product or if it fails to work properly, contact a local, licensed electrician. Failure to comply with these requirements could lead to an electric shock or fire, which could cause serious injury or fatality.

- Some metal parts in the fixture may have sharp edges. To prevent cuts and scrapes, wear gloves when handling the parts.
- Account for small parts and destroy packing material after assembly is complete, as these may be hazardous to children.
- Use a flashlight or alternate light source to light work area during installation.
- Assistance may be required to support fixture during installation.
- Ensure that the insulation on any of the wires has not been damaged during installation.
- Ensure that no rough or sharp edges are in contact with any of the wires.
- Only use light bulbs with wattage no greater than those specified for the fixture are used.

Assembly Preparation

Before beginning assembly of this product, make sure all parts are present. Compare parts with package contents list and hardware contents list. If any part is missing or damaged, do not attempt to assemble, install or operate the product.

Place all parts from the box in a cleared area and position them on the floor in front of you. Remove all packing materials and place them back into the box. Do not dispose of the packing materials until assembly is complete. Read each step carefully before beginning any assembly and make sure you understand each step.

Tools required for assembly (not included):

Pliers, gloves.



4 MODEL NO. 052-7827-8

Assembly Instructions

1. Place lamp base (A) upright on floor. Attach bottom stem (B) to the lamp base (A). Turn clockwise to tighten.

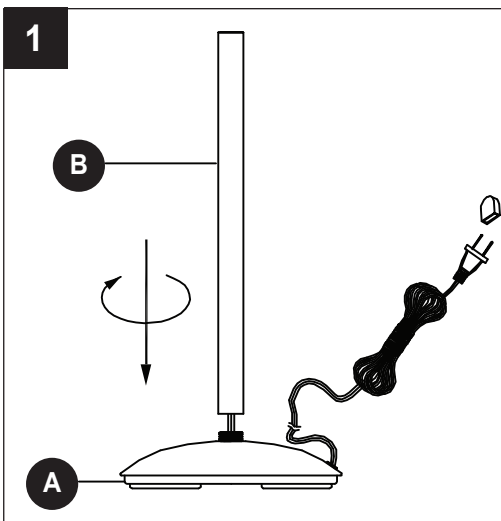

2. Attach middle stem 1 (C) to bottom stem (B); then attach middle stem 2 (D) to middle stem 1 (C). Turn clockwise to tighten.

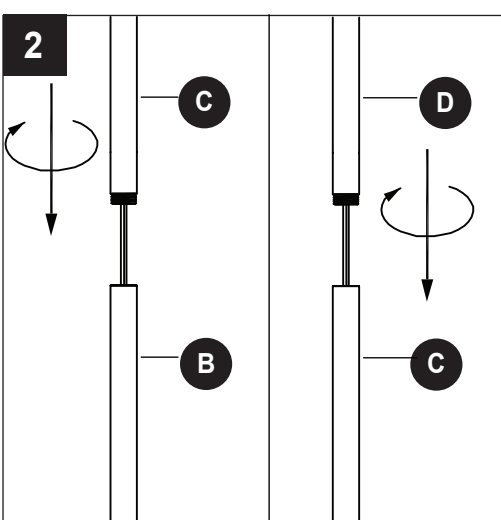

3. Attach fixture (E) to the middle stem 2 (D). Turn clockwise to tighten.

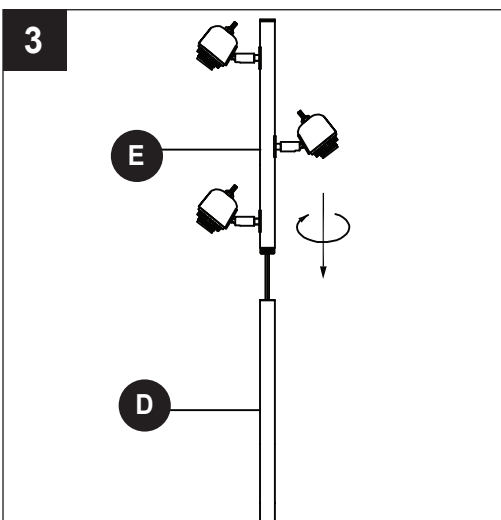

CANVAS^{TM/MC}

5

Assembly Instructions

4. Unscrew socket rings (G) from sockets (F).

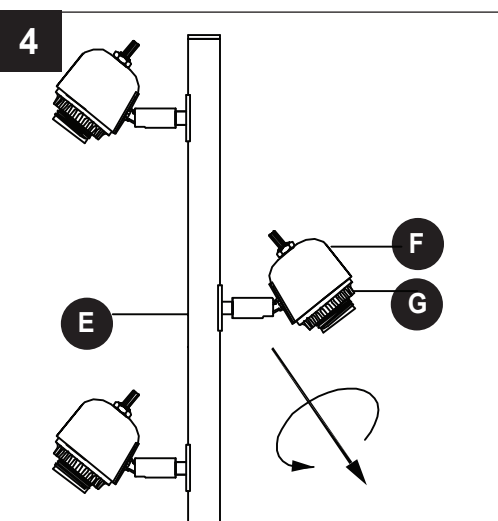

5. Attach plastic shades (H) to sockets (F). Secure with socket rings (G).

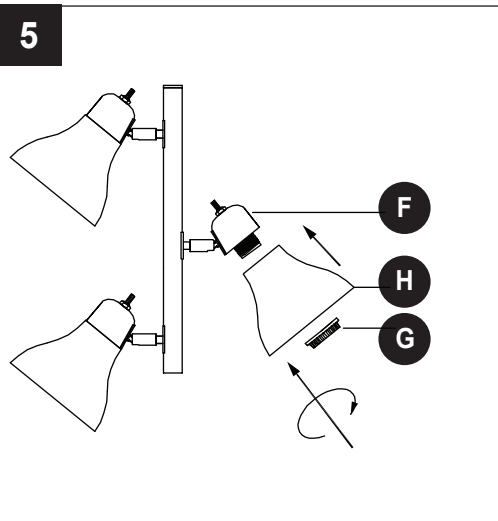

6. Install the bulbs. Please use three 40 W (max.) medium-base incandescent bulbs (not included).

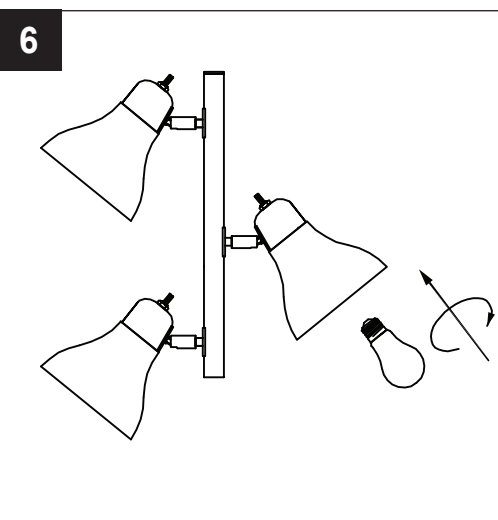

6 MODEL NO. 052-7827-8

Care and Maintenance/Troubleshooting

CARE AND MAINTENANCE

To clean, unplug the lamp and wipe it with a damp, non-abrasive cloth.

TROUBLESHOOTING

PROBLEM	POSSIBLE CAUSE	CORRECTIVE ACTION
Bulbs won't light.	1. Bulbs are burned out. 2. Power is off. 3. Faulty wire connection. 4. Faulty switch.	1. Replace the bulb. 2. Check if power supply is on. 3. Check wiring. 4. Test or replace the switch.
Fuse blows out or circuit breaker trips when light is turned on.	1. Crossed wires or power wire is grounding out.	1a. Check the wiring connection. 1b. Consult a qualified electrician.

This CANVASTM product carries a one (1) year warranty against defects in workmanship and materials.

Trileaf Distribution agrees to replace the defective product free of charge within the stated warranty period, when returned by the original purchaser with proof of purchase. This product is not guaranteed against wear or breakage due to misuse and/or abuse.

Made in China

Imported by
Trileaf Distribution Trifeuil Toronto, Canada M4S 2B8

Warranty