

NOMA[®] MD

RUSTON CEILING FAN

model no. 052-6940-2

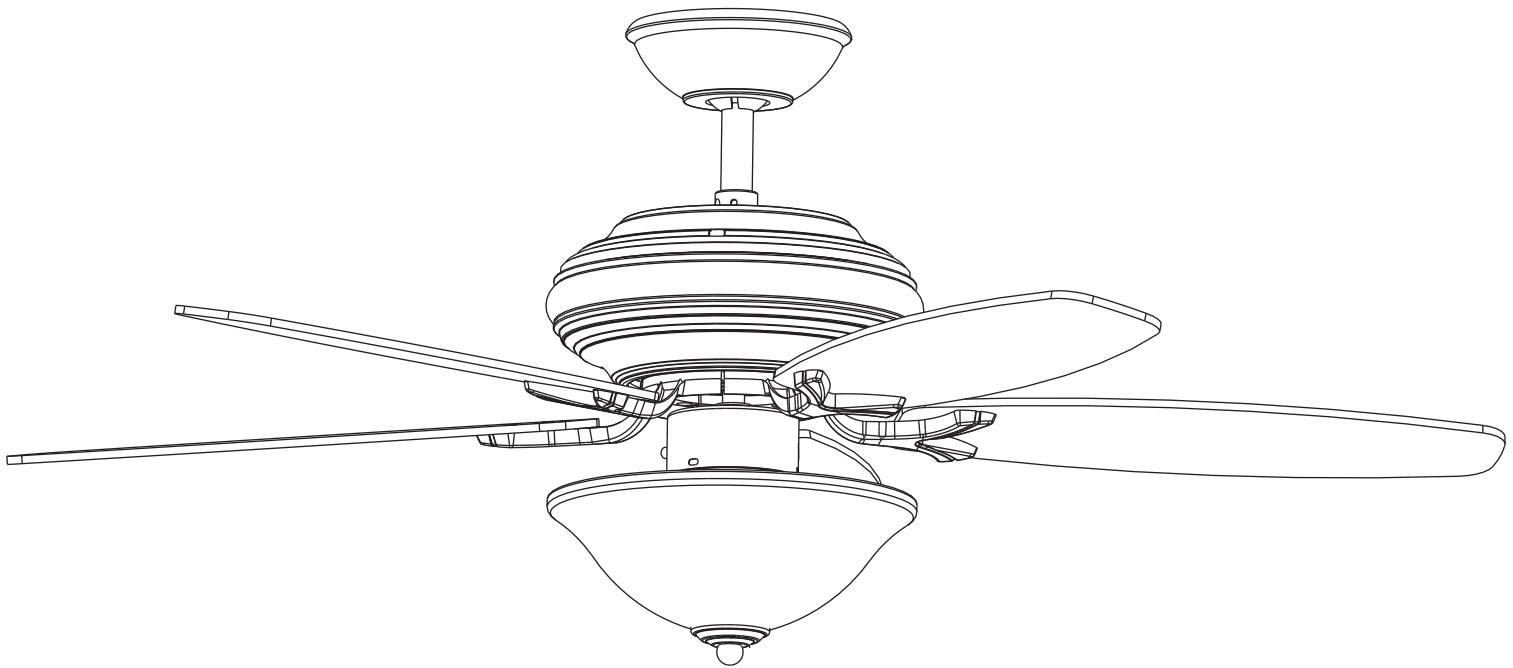

Instruction Manual

Toll Free: 1-866-827-4985

IMPORTANT: Please read and understand this manual before any assembly. Before beginning assembly of product, make sure all parts are present. Compare parts with exploded view. If any part is missing, or if you have any questions, contact customer service at 1-866-827-4985 (toll-free).

| | |
|-------------------------------------|----|
| Exploded view | 1 |
| Important safety instructions | 2 |
| Rules for safe installation | 2 |
| Tools required for assembly | 3 |
| Assembly | 3 |
| Operation | 7 |
| Maintenance | 8 |
| Care and cleaning | 8 |
| Troubleshooting | 8 |
| Environmental protection | 9 |
| Warranty | 10 |

EXPLODED VIEW

| No. | Description | Qty. | No. | Description | Qty. |
|-----|---------------|------|-----|------------------|------|
| A | Downrod | 1 | G | Light kit | 1 |
| B | Canopy | 1 | H | Remote control | 1 |
| C | Motor | 1 | I | Receiver | 1 |
| D | Glass shade | 1 | J | Mounting bracket | 1 |
| E | Blades | 5 | K | Parts pack | 1 |
| F | Blade bracket | 5 | L | Balance pack | 1 |

A

B

C

D

E

F

G

H

I

J

K

L

IMPORTANT SAFETY INSTRUCTIONS

Please retain this manual for future reference.



Note: Always turn the power off before servicing the ceiling fan.

- A dry dust cloth is suitable for most cleanings.
- Should the ceiling fan become wet, have a qualified electrician inspect it before next use.
- In order to comply with safety regulations and to avoid safety hazards, ceiling fan repairs must be carried out by qualified personnel.
- Pay attention to the ceiling fan blades when cleaning, painting or working nearby.
- Children do not recognize the dangers that may occur when operating ceiling fan. Keep children away from ceiling fans.

- DO NOT:**
- Expose the ceiling fan to water or immerse it in water.
 - Operate the ceiling fan if it shows any signs of damage or if it has been dropped.
 - Attempt to remove any parts of the housing or insert any object while the ceiling fan is operating.
 - Position the ceiling fan on or near hot surfaces such as stove tops, or near open flames.
 - Expose the ceiling fan to rain or moisture.
 - Operate the ceiling fan outdoors or with wet hands.
 - Use the reverse switch while the fan blades are in motion. This could result in damage to the ceiling fan.

RULES FOR SAFE INSTALLATION

This ceiling fan is designed for household use only and not for commercial applications. No responsibility is accepted for damage resulting from improper use or noncompliance with the instructions.



CAUTION!

- To avoid possible electric shock, be sure electricity at the fuse box or the circuit breaker is turned off before wiring.
- All wiring must be done in accordance with national and local wiring codes. Consult a qualified electrician to ensure correct branch circuit conductor.
- Follow the recommended instructions for the proper method of wiring for the new ceiling fan. The ceiling fan must be grounded as a precaution against possible electric shock.
- If you do not have sufficient electrical wiring knowledge, have the fan installed by a licensed electrician.
- The outlet box and joist must be securely mounted and capable of reliably supporting at least 35 lb (15.9 kg).
- Mount the lowest moving parts at least 6' 11" (2.1 m) above floor or ground level.
- Make sure all electrical connections are sealed with proper connectors and electrical tape inside the outlet box.
- Make sure the ceiling fan is securely fastened to the ceiling.
- All set screws must be checked and re-tightened where necessary before fan operation.









WARNING!

- Mount only to an outlet box marked acceptable for fan support.
- To prevent injury, make sure the fan blades are not bent and that there are no objects within the rotation area.
- The important precautions, safeguards and instructions appearing in this manual are not meant to cover all possible situations. It must be understood that common sense and caution are factors which cannot be built into the product.
- Not suitable for use with solid-state speed controls.







TOOLS REQUIRED FOR ASSEMBLY

This manual is designed to make it as easy as possible for you to assemble, install, operate and maintain the ceiling fan. The following tools listed are required for assembly and installation:

| | | | |
|---|---------------------------|--|--------------------------|
|  | 1 x star-head screwdriver |  | 1 x stepladder |
|  | 1 x flat screwdriver |  | 1 x wire stripper/pliers |
|  | 1 x wrench |  | 1 x electrical tape |

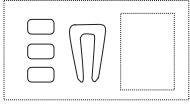
After opening the package you should find all the necessary parts for installing this ceiling fan. The box should also contain:

Parts Pack Containing:

- | | | | |
|------------------------------------|--|--|---|
| 2 wood screws with flat washers |  | 1 extra blade bracket screw with spring washer |  |
| 2 mouting screws with lock washers |  | 3 balance pieces |  |
| 16 blade screws with washers |  | 1 balance clip | |
| 1 "J" hook |  | 1 instruction sheet | |
| 1 zip tie |  | | |

ASSEMBLY

Preparing for installation

Getting ready

- Unpack and inspect carefully to make sure all parts are included and not damaged (see Fig. 1). Lay all pieces out on a working space.
- Turn off power at fuse box or circuit breaker to avoid possible electric shock (see Fig. 2).

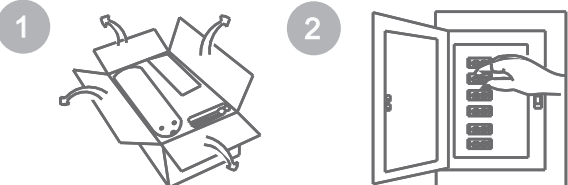

Choosing a location for the ceiling fan

- For effective air circulation, fans should be located in the centre of the room, or a minimum of 32" (81.3 cm) from adjacent walls or obstructions.
- Choose a location where there is a high enough ceiling clearance (at least 6' 11" (2.1 m) from the floor to the ceiling fan's lowest moving part).
- Ensure that the outlet box in the room's ceiling can support the weight of the fan. Typically, if the outlet box is marked "acceptable for fan support", it can hold the fan securely.

Mounting options

Drop-mount (for normal ceilings)

- This method is preferred if the ceiling is sloped or vaulted, or if the ceiling is extra high, requiring the need of a downrod (see Fig. 3).

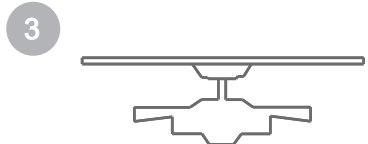

Installation

1. Installing Mounting Bracket

- Remove the mounting bracket from the canopy by loosening the two slotted canopy-mounting screws on the bottom of the canopy one half turn from the screw head (see Fig. 4a).

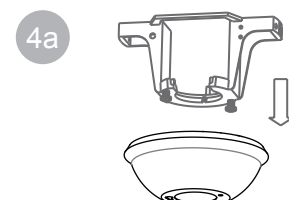

ASSEMBLY

- Remove the four sets of side screws from mounting bracket and save for future use.

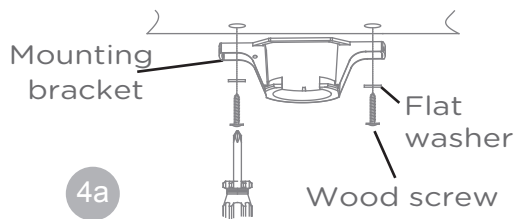

Wooden ceiling

- Drill two mounting holes in the ceiling joist. Securely attach the mounting bracket to the ceiling or wooden ceiling as indicated below (Fig. 4a).

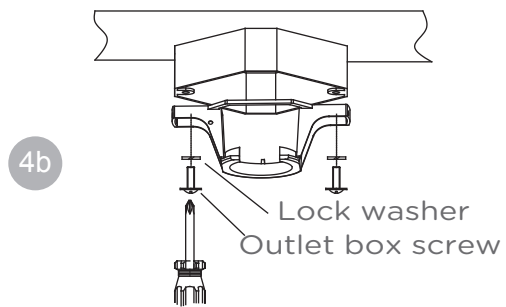

Normal masonry ceiling

- Securely attach the mounting bracket to an outlet box marked "**Acceptable for Fan Support**", using the supplied outlet box screws with lock washers (Fig. 4b).

2. Drop-Mount Installation

2.1 Installing Down Rod Assembly

- Remove the clip and connection pin from the down rod (see Fig. 5a).
- Insert the down rod through the canopy, while feeding the power wires from the fan motor assembly through the down rod (see Fig. 5b).
- Carefully thread the safety cable and all the wires through the down rod assembly (see Fig. 5b).

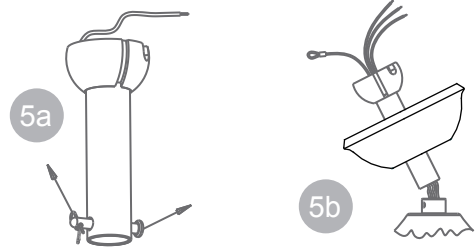

2.2 Securing Down Rod Assembly

- Raise the canopy.
- Loosen the two down rod set screws on the coupling (see Fig. 5c).
- Insert the down rod into the coupling. Make sure to align the holes of these two parts.
- Install the connection pin through the aligned holes and secure it with the clip.
- Tighten the two down rod set screws on the coupling (see Fig. 5c).

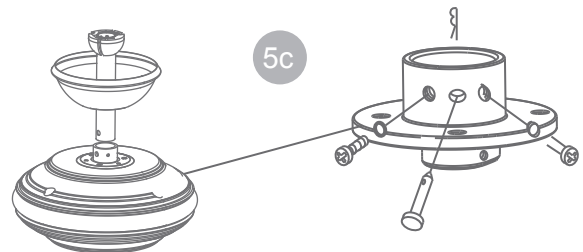

2.3 Hanging Fan Assembly to Mounting Bracket

- Carefully lift the fan motor assembly up to the mounting bracket and seat the hanger ball in the mounting bracket socket. Make sure the tab on the mounting bracket socket is properly seated in the groove in the hanger ball. This will help to balance the ceiling fan (see Fig. 5d).

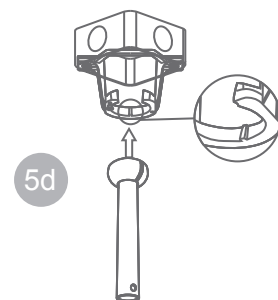

NOTE: For added security, attach safety cable from fan unit to "J" hook in outlet box. Secure by looping zip tie through safety cable and "J" hook. Tighten zip tie securely (see Fig. 6).

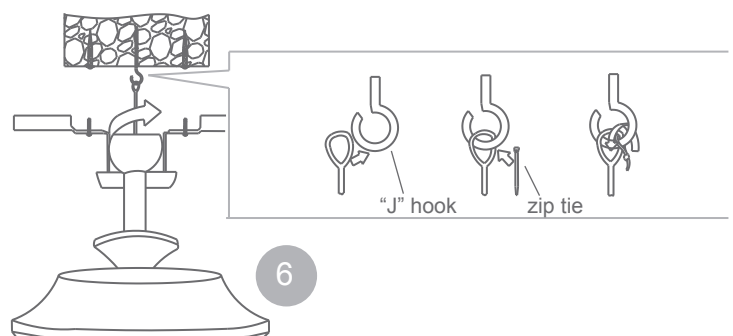

ASSEMBLY

3. Wiring Instructions

⚠ IMPORTANT: If you are not sure if the electrical outlet box and fan are grounded, contact a licensed electrician for advice. They must be grounded for safe operation.

⚠ WARNING: To avoid possible electric shock, be sure electricity is turned off at the main fuse box before wiring.

3.1 Remote and Receiver Pairing (see Fig. 7a).

Codes are set by pushing the location of the dip switches located on the transmitter and receiver up or down. It is important that the code used for both the remote and receiver are identical for the two devices to be able to communicate; otherwise the remote will not be able to control the fan.

⚠ If you plan to install more than one fan then each fan will require the remote and receiver to use a unique code, or else one remote will be able to control more than one fan.

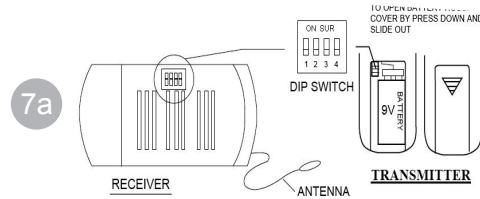

3.2 Installing Receiver Assembly (see Fig. 7b).

Once the connection has been made, the receiver inserts into the drop rod hanging bracket. The canopy comes up to cover the receiver and bracket.

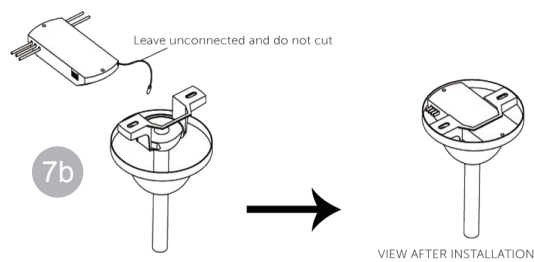

3.3 Making Connections

Between fan and receiver:

- Connect the black wire marked "L" from the fan to the black wire marked "TO MOTOR L" from the receiver.
- Connect the blue wire marked "FOR LIGHT" from the fan to the blue wire marked "FOR LIGHT" from the receiver.
- Connect the white wire marked "N" from the fan to the WHITE wire marked "TO MOTOR N" from the receiver.

Between receiver and mains:

- Connect the black live wire marked "AC IN L" from the receiver to the live wire (typically black) from the outlet box.
- Connect the white neutral wire marked "AC IN N" from the receiver to the neutral wire (typically white) from the outlet box.
- Connect the green ground wires from the mounting bracket and hanger ball to the ground wire (bare or green) from the outlet box.

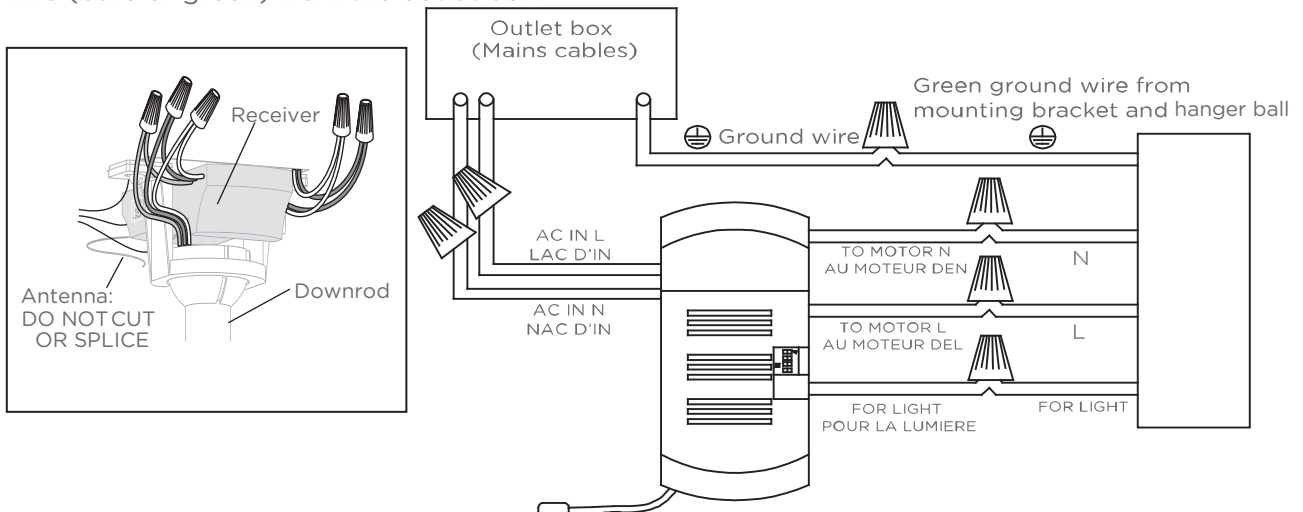

- When wires are matched up, connect them by twisting frayed ends together (see Fig. 7c).
- Screw wire connectors (3 are provided) onto the tops of the twisted wires (see Fig. 7d).
- Fasten them with electrical tape (see Fig. 7e).

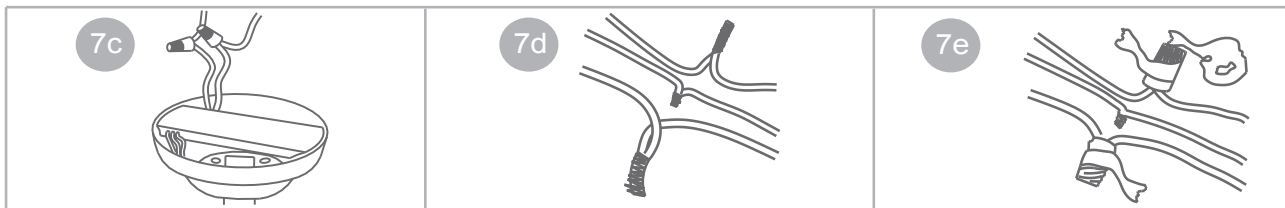

⚠ WARNING: Be sure no bare wire or wire strands are visible after making connections. Place green and white connections on opposite side of box from the black and blue (if applicable) connections.

ASSEMBLY

4. Fan Assembly to Mounting Bracket

- Unhook the assembly from the mounting bracket.
- Hold the assembly by the canopy and raise up to align the two holes in the canopy with the holes in the mounting bracket.
- Tighten the loosened screws. Now re-secure the screws and washers which were removed (see Fig. 8).

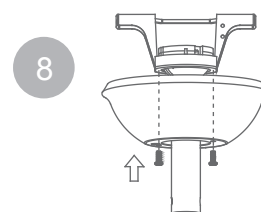

5. Blade Assembly to Motor

- Using the fan blade screws, attach the fan blades between the fan blade brackets with the desired finished side faced down on the fan blade brackets (see Fig. 9a).
- If there are plastic tabs shaped like bottle caps, remove and discard them. These are stabilizers that protect the motor during shipping.
- Remove blade bracket screws on the bottom of the motor and use them to attach the blade assembly to the motor. Ensure the screws are tightened (see Fig. 9b).

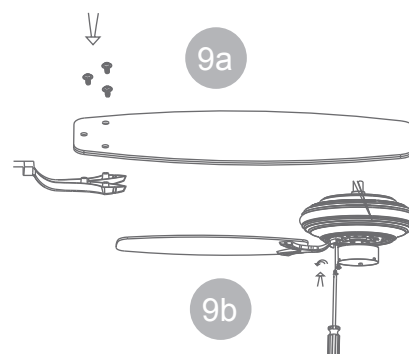

6. Installing the Light Fixture

Installing the Light Kit

- Remove the light kit screws from the light kit. Connect the blue wire from the switch housing to the blue wire from the light kit, and the white wire from the switch housing to the white wire from the light kit simply by joining the connector plugs together. Be sure the push in type terminals snap into place (see Fig. 10a).
- Carefully put the wires into the switch housing.
- Attach the light kit by connecting the switch housing cap to the fan switch housing, then tightly secure light kit screws that were previously removed from the light kit (see Fig. 10a).

Installing Bulb

- Install two 60 W (max.) candelabra bulbs or equivalent CFLs (not included) into the sockets on the light kit (see Fig. 10b).

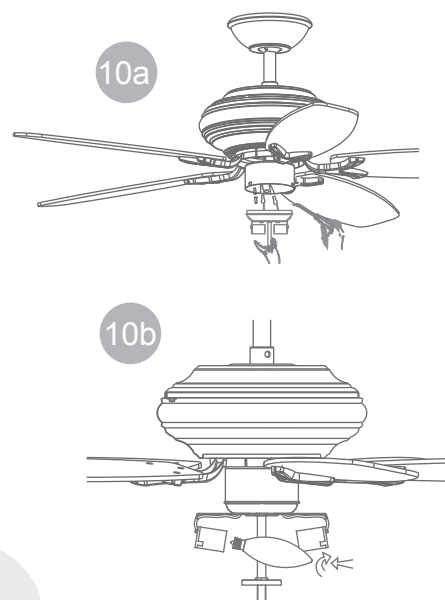

Note: The dimmer function does not work if CFL bulb is used. There is only ON/OFF function.



Note: The fan has an energy-saving wattage limiter. If you replace the bulbs with over 190 W, the light will automatically turn off. Ensure total bulb wattage is always below 190 W.

Attaching Glass Shade

- Remove the finial, cap, hexagon nut, flat washer and fibre washer from the light kit (see Fig. 10c).
- Bring the glass shade through the threaded rod up to the light kit (see Fig. 10c).
- Reattach the fibre washer, flat washer, hexagon nut, cap and finial to the threaded rod. Ensure the hexagon nut is securely tightened to hold the glass shade in place.

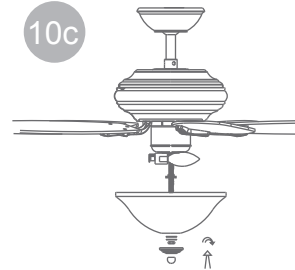

OPERATION

Install the 9 V battery (not included). To prevent damage to transmitter remove the battery if not used for long periods.

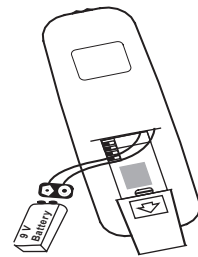

Turn fan on/off and select fan speed

- Restore power to ceiling fan and test for proper operation.
- The fan remote control controls the fan settings:

OFF: Turn off the ceiling fan.

HI: Turn on the fan at high speed.

MED: Turn on the fan at medium speed.

LOW: Turn on the fan at low speed.

LIGHT: ON/OFF: Press and release immediately to turn on or off the light.

DIMMER: Press and hold on to dim or brighten lights to the desired level and release (Only for the tungsten bulb).

Forward and reverse direction function.

This ceiling fan is equipped with a reverse switch for downward or upward air-flow.

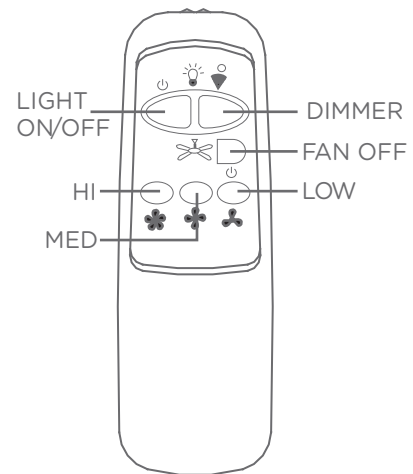

Note: Do not use the reverse switch when the fan blades are in motion.

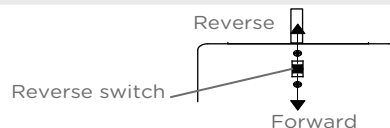
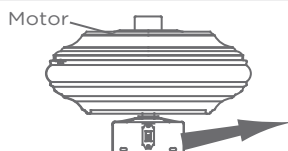

Forward function

- On this setting, the fan will turn counter-clockwise to create a cooling effect. Use this function during warmer weather to circulate hot air away from your living space (see Fig. 11).

11

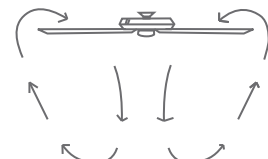

Reverse function

- On this setting, the fan will turn clockwise. Use this function during cooler weather to re-circulate warm air (see Fig. 12).

12



MAINTENANCE

- Because of the fan's natural movement, some connections may become loose. Check the support connections, brackets and blade attachments twice a year. Make sure they are secure.
- There is no need to oil your fan. The motor has permanently-lubricated bearings.

CARE AND CLEANING

- Dust your fan periodically with a soft, dry cloth. Do not use harsh cleaners or materials as they may damage the unit.
- To prevent bending the blades during cleaning, support the blades so that no pressure is applied to them.



Caution!

Do not allow water to come in contact with fan blades or the ceiling fan. Doing so will create fire and /or shock hazards, damaging property.

TROUBLESHOOTING

If problems persist, seek help from a certified electrician.

| Problem | Possible reason | Solution |
|-------------------------------|---|---|
| Fan is noisy during operation | <ul style="list-style-type: none"> · Blade screws are loose. · The mounting bracket or canopy is loose. · Screws securing decorative housing to hanger are loose. · Lamp shades or bulbs are loose. · Screws securing downrod to hanger are loose. · Wire connectors are vibrating against the inside of canopy. · Light kit or light bulb is not firmly attached. · Canopy is rattling against ceiling. · Motor housing screws have come loose. | <ul style="list-style-type: none"> · Tighten screws on blades with a screwdriver. · Check and tighten the screws. · Check and tighten the screws. · Tighten by hand, as necessary. · Check and tighten screws. · Disconnect power at fuse box, loosen canopy and re-position connectors. · Remove and re-attach. · Be sure canopy is not touching ceiling. · Check and tighten the screws. |
| Fan does not start | <ul style="list-style-type: none"> · Fuse is blown, or circuit breaker has tripped. · Loose or incorrect power line connections to the fan or switch wires. | <ul style="list-style-type: none"> · Check main fuse and branch circuit fuses or circuit breaker. Repair as necessary. · Check all the wire connections to fan and housing wiring. Repair as necessary. <div>  Caution! Make sure the main power is turned off. </div> |

TROUBLESHOOTING

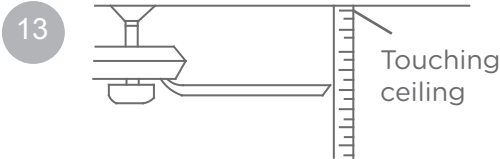
| Problem | Possible reason | Solution |
|------------------------------------|--|---|
| Light does not work | <ul style="list-style-type: none"> Wires are not properly connected. Light bulbs are faulty. This fan is equipped with a 190 W LIMITER that will automatically turn the light off total wattage exceeds the maximum wattage level. | <ul style="list-style-type: none"> Ensure wire connector in switch housing is connected. Unscrew light bulbs and discard properly. Turn the power OFF and replace the bulbs with lower wattage bulbs so that the total wattage is below 190 W. |
| Fan does not seem to move much air | <ul style="list-style-type: none"> Fan is in reverse (blades are moving in clockwise direction). Fan is not properly located. | <ul style="list-style-type: none"> Counter-clockwise (forward) is recommended in warm weather. Turn off fan and power and wait for rotation to stop. Use the eraser end of a pencil to change the forward/reverse slide switch. Place fan in the centre of the room so there is at least 12" (30 cm) between the end of the blades and walls or other obstructions. |
| Fan wobbles or shakes excessively | <ul style="list-style-type: none"> Screws securing fan blade clips to motor are loose. Fan blade and its blade clip are not fastened securely. Canopy and mounting bracket are not tightened securely. Blades are unbalanced. <div>  </div> | <ul style="list-style-type: none"> Make sure that screws which attach fan blade clips to motor are fastened and tightened. Tighten screws of fan blade to blade clip securely. Ensure that canopy and mounting bracket are tightened securely to ceiling joist. Check by selecting a point on the ceiling above the tip of one of the blades. Measure this distance and ensure all blades are even (see Fig. 13). If all blade levels are not equal, adjust accordingly (see Balancing Kit Manual). |

ENVIRONMENTAL PROTECTION



Discarded electrical appliances are recyclable and should not be discarded in your regular domestic waste! Please actively support us in conserving resources and protecting the environment by returning this appliance to a collection centre (if available).

Battery reclamation (please keep to comply with the local law).

WARRANTY

This Noma product carries a limited ten (10) year warranty against defects in the motor, and a one (1) year warranty against defects in workmanship and materials. Noma Canada agrees to replace the defective product free of charge within the stated warranty period, when returned by the original purchaser with proof of purchase. This product is not guaranteed against wear or breakage due to misuse and/or abuse.

Subject to the conditions and limitations described below, this product, if returned to us with proof of purchase within the stated warranty period and if covered under this warranty, will be repaired or replaced (with the same model, or one of equal value or specification), at our option. We will bear the cost of any repair or replacement and any costs of labor relating thereto.

These warranties are subject to the following conditions and limitations:

- a) A bill of sale verifying the purchase and purchase date must be provided;
- b) This warranty will not apply to any product or part thereof which is worn or broken or which has become inoperative due to abuse, misuse, accidental damage, neglect or lack of proper installation, operation or maintenance (as outlined in the applicable owner's manual or operating instructions) or which is being used for industrial, professional, commercial or rental purposes;
- c) This warranty will not apply to normal wear and tear or to expendable parts or accessories that may be supplied with the product that are expected to become inoperative or unusable after a reasonable period of use;
- d) This warranty will not apply to routine maintenance and consumable items such as, but not limited to, fuel, lubricants, vacuum bags, blades, belts, sandpaper, bits, fluids, tune-ups or adjustments;
- e) This warranty will not apply where damage is caused by repairs made or attempted by others (i.e. persons not authorized by the manufacturer);
- f) This warranty will not apply to any product that was sold to the original purchaser as a reconditioned or refurbished product (unless otherwise specified in writing);
- g) This warranty will not apply to any product or part thereof if any part from another manufacturer is installed therein or any repairs or alterations have been made or attempted by unauthorized persons;
- h) This warranty will not apply to normal deterioration of the exterior finish, such as, but not limited to, scratches, dents, paint chips, or to any corrosion or discoloring by heat, abrasive and chemical cleaners;
- i) This warranty will not apply to component parts sold by and identified as the product of another company, which shall be covered under the product manufacturer's warranty, if any.

Additional Limitations

This warranty applies only to the original purchaser and may not be transferred. Neither the retailer nor the manufacturer shall be liable for any other expense, loss or damage, including, without limitation, any indirect, incidental, consequential or exemplary damages arising in connection with the sale, use or inability to use this product.

Notice to Consumer

This warranty gives you specific legal rights, and you may have other rights, which may vary from province to province. The provisions contained in this warranty are not intended to limit, modify, take away from, disclaim or exclude any statutory warranties set forth in any applicable provincial or federal legislation

Made in China

Imported by
Noma Canada, Toronto, Canada M4S 2B8