

SS-100
User's Manual

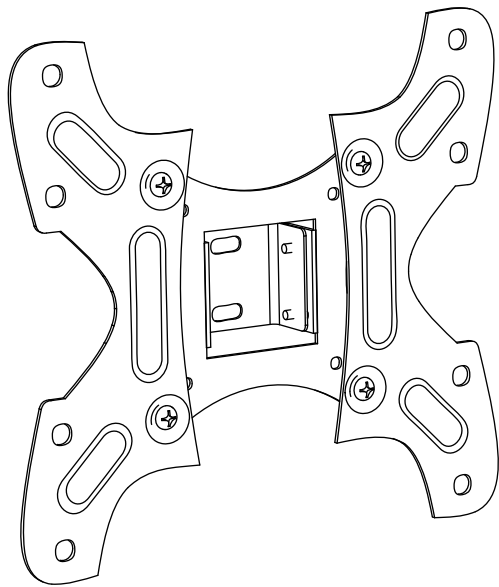

- TV size range: 9” to 32”
- Max weight load 39.6 lbs / 18 kg
- Universal VESA 100x100 and 200x200

Disclaimer

Sky Wire intends to make this manual accurate and complete, however, Sky Wire makes no claim that the information contained herein covers all details, conditions or variations, nor does it provide for every possible contingency in connection with the installation or use of this product. The information contained in this document is subject to change without notice or obligation of any kind. Sky Wire makes no representation of warranty, expressed or implied, regarding the information contained herein. Sky Wire assumes no responsibility for accuracy, completeness or sufficiency of the information contained in this document.

Warnings & Cautions

IT IS HIGHLY RECOMMENDED THAT THIS PRODUCT BE INSTALLED BY A PROFESSIONAL.

PLEASE REVIEW THIS INSTRUCTION MANUAL COMPLETELY BEFORE STARTING THE INSTALLATION PROCESS.

WARNING: A WARNING alerts you to the possibility of serious injury or death if you do not follow the instructions.

CAUTION: A CAUTION alerts you to the possibility of damage or destruction of equipment if you do not follow the corresponding instruction.

WARNING: Improper installation can result in serious personal injury! Make sure that the structural members can support a weight factor five times the total weight of the equipment. If not, reinforce the structure before starting the installation.

WARNING: Be aware also of the potential for personal injury or damage to the unit if it is not adequately mounted.

WARNING: The installer is responsible for verifying that the wall or ceiling to which the mount is anchored will safely support the combined load of all attached components or other equipment.

WARNING: The weight of the display placed on the mount must not exceed the maximum load capacity of the mounts.

WARNING: Watch for pinch points. Do not put your fingers between movable parts.

WARNING: Make sure the mount and brackets are correctly oriented.

CAUTION: Check the unit for shipping damage before you begin the installation.

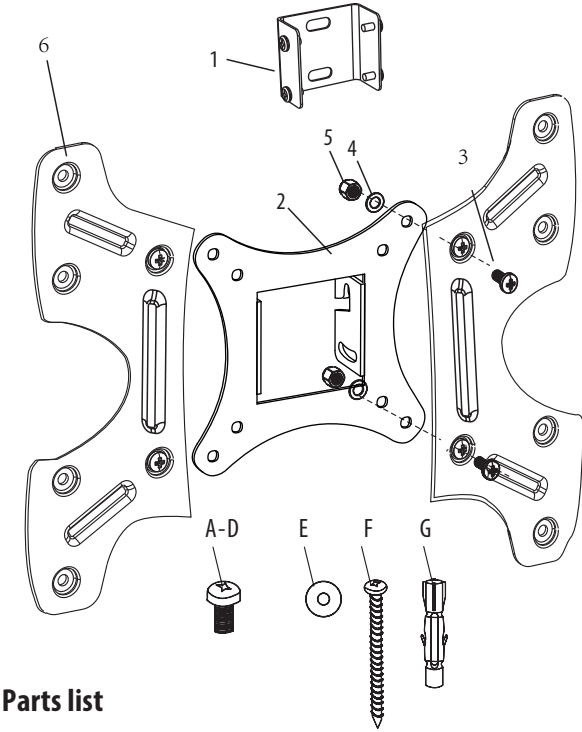

Parts list

1. Wall plate	(x1)	A M4 x 8 bolt	(x4)
2. Adapter bracket	(x1)	B M4 x 12 bolt	(x4)
3. Bolt	(x4)	C M5 x 8 bolt	(x4)
4. Washer	(x4)	D M5 x 12 bolt	(x4)
5. Nut	(x4)	E M5 washer	(x6)
6. Extension plate	(x2)	F Lag Bolt	(x2)
		G Concrete anchor	(x2)

1a. Drywall installation

Find studs in wall. Using wall plate (1) as a template, making sure it's leveled, mark the two mounting holes on the center of the wood stud. Drill two holes of 1/8" (3 mm) diameter and 2" (50 mm) deep. Level wall plate and bolt to wall with 2 lag bolts (F) and 2 washers (E). Tighten bolts firmly, but do not overtighten.

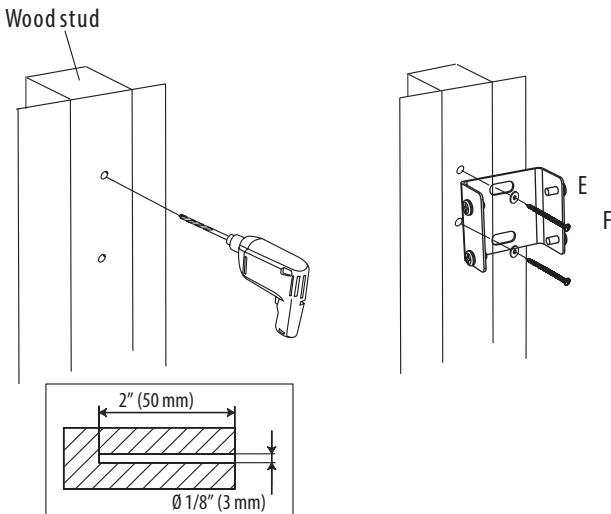

1b. Concrete Installation

Using wall plate (1) as a template, making sure it's leveled, mark the two mounting holes on the wall. Drill two holes of 7/16" (10.5 mm) diameter and 2" (50 mm) deep. Insert a concrete anchor (D) into each hole and push until it's flush to the wall. Level wall plate and bolt to wall with 2 lag bolts (F) and 2 washers (E). Tighten bolts firmly, but do not overtighten.

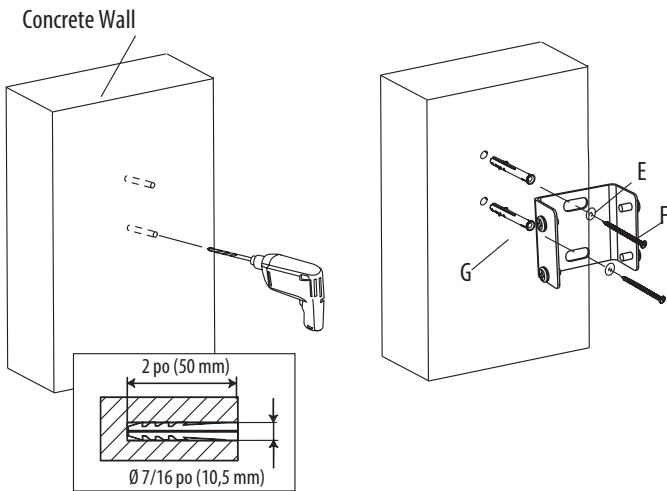

2. Bolt TV plate to TV *

Center TV plate on the back of your TV and align the four mounting holes. Select the proper size bolts (A, B, C or D) to affix it to the TV using 4 washers (E). Tighten bolts firmly, but do not overtighten.

*If your TV has a 200 x 200 hole pattern, skip this step.

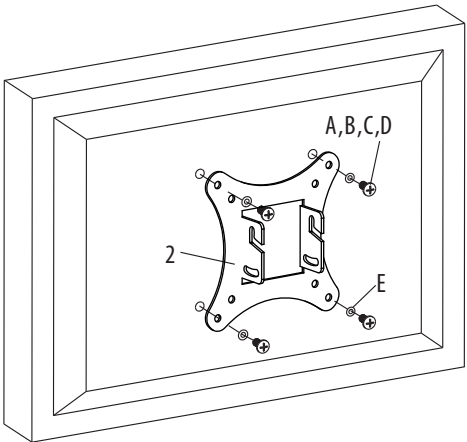

3. Install Extensions

If your TV has a 200 x 200 hole pattern, install the extensions. Start by aligning the outer holes of the TV plate with the inner holes of the extensions as described in the dawning. Bolt the extensions with 4 bolts (4), 4 washers (5) and 4 nuts (6). Tighten bolts firmly, but do not overtighten.

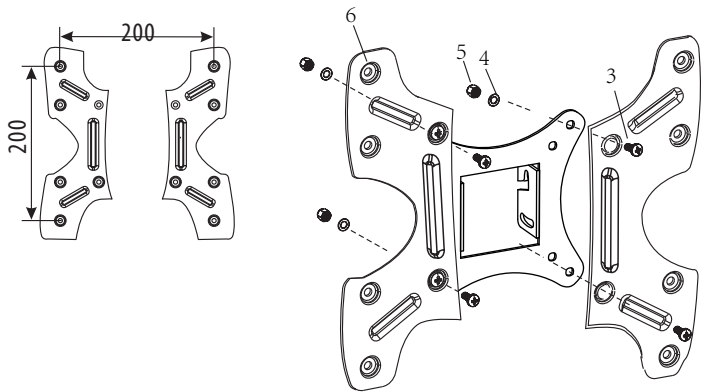

3. Slide in TV Plate on Wall Plate

Align the TV and the mounted wall plate horizontally. Slide TV from top to bottom until it stops where the plates have engaged. Install safety bolt from top. Tighten bolt firmly, but do not overtighten.

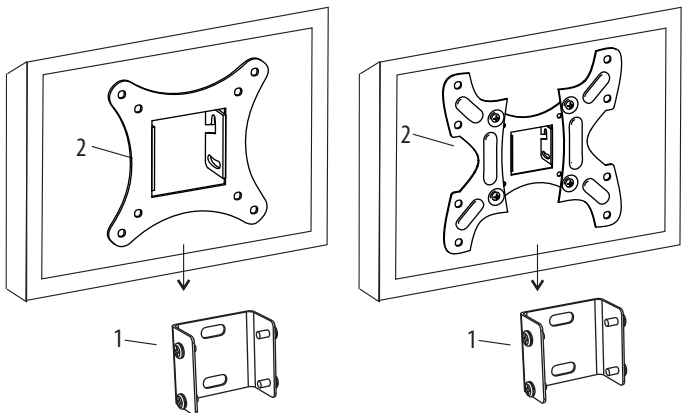

For more information, visit: www.cambreproducts.com

Sky Wire™ name, logo and model numbers are property of Cambre.