

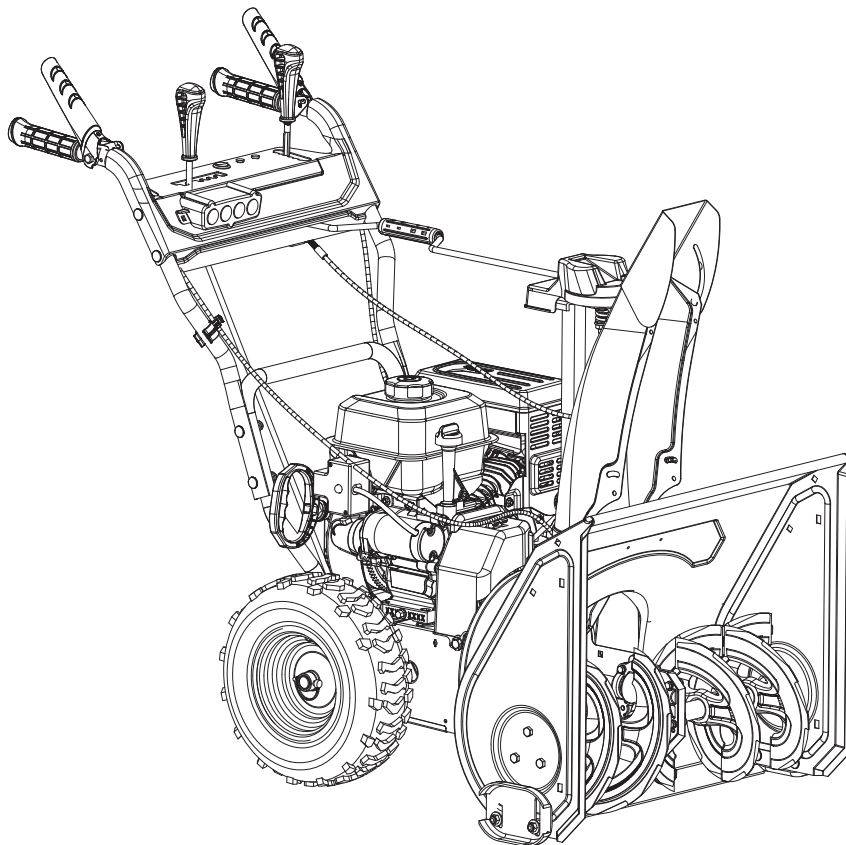

499-0908-6
YFM24D

SNOW BLOWER OWNER'S MANUAL



Our Customer Service staff is ready to provide assistance.

In the case of a damaged or missing part, most replacement parts ship directly from Merotec USA in Atlanta or from one of our service partners in the US.

For immediate help with assembly, or for additional product information, email support@MerotecUSA.com. Or for the USA call 866-902-9690 M-F 8:30am – 5:00pm ET, for Canada call 1-833-818-4111 M-F 9:00am – 5:00pm ET. More information can be found on www.YardForceUSA.com, or YardForceCA.com.



SAVE THIS MANUAL FOR REFERENCE

You will need this manual for safety instructions, operating procedures, and Warranty. The original sales receipt is required for warranty service.

TABLE OF CONTENTS

Safety Instructions.....3

Description of Symbols.....8

Package Contents.....10

Assembly.....13

Operation.....16

Maintenance and Storage.....24

Troubleshooting.....32

Transportation, storage and disposal.....35

Warranty.....36

SAFETY INSTRUCTIONS

GENERAL SAFETY INSTRUCTIONS

1. Use the product correctly. Injury or death is a possible result of incorrect use. Only use the product for the tasks found in this manual. Do not use the product for other tasks.
2. Obey the instructions in this manual. Obey the safety symbols and the safety instructions. If the operator does not obey the instructions and the symbols, injury, damage or death is possible result.
3. Do not discard this manual. Use the instructions to assemble, to operate and to keep your product in good condition. Use the instructions for correct installation of attachments and accessories. Only use approved attachments and accessories.
4. Do not use a damaged product. Obey the maintenance schedule. Only do the maintenance work that you find an instruction about in this manual.
An approved service center must do all other maintenance work.
5. This manual cannot include all situations that can occur when you use the product. Be careful and use your common sense. Do not operate the product or do maintenance to the product if you are not sure about of the situation. Speak to a product expert, your dealer, service agent or approved service center for information.
6. Disconnect the spark plug cable before you assemble the product, put the product into storage or do maintenance.
7. Do not use the product if it is charged from its initial specification. Do not change a part of the product without approval from the manufacturer. Only use parts that are approved by the manufacturer. Injury or death is a possible result of incorrect maintenance.
8. Do not breathe in the fumes from the engine. Long term inhalation of the engine's exhaust fumes is a health risk.
9. Do not start the product indoors or near flammable material. The exhaust fumes are hot and can contain a spark which can start a fire. Not sufficient airflow can cause injury or death because of asphyxiation or carbon monoxide.
10. When you use this product the engine makes an electromagnetic field.
The electromagnetic field can cause damage to medical implants. Speak to your physician and medical implant manufacturer before you operate the product.
11. Do not let a child operate the product. Do not let a person, without knowledge of the instructions operate the product.
12. Make sure that you always monitor a person, with decreased physical capacity or mental capacity, that uses the product. A responsible adult must be there at all times.
13. Lock the product in an area that children and unapproved persons cannot access.
14. The product can eject objects and cause injuries. Obey the safety instructions to decrease the risk of injury or death.
15. Do not go away from the product when the engine is on.
16. The operator of the product is responsible if an accident occurs.
17. Before and while you walk rearward, look behind and down for small children, animals or other risks that can cause you to fall.
18. Make sure that parts are not damaged before you use the product.
19. Make sure that you are at a minimum 15 m (50 ft) away from other persons or animals before you use the product. Make sure that a person in adjacent area knows that you will use the product.
20. Refer to national or local laws. They can prevent or decrease the operation of the product in some conditions.

SAFETY INSTRUCTIONS

TRAINING

1. Read understand and follow all instructions on the machine and in the manual(s) before operating this unit. Be thoroughly familiar with the controls and the proper use of the equipment. Know how to stop the unit and disengage the controls quickly.
2. Never allow children to operate the equipment.
3. Never allow adults to operate the equipment without proper instruction.
4. Keep the area of operation clear of all persons particularly small children.
5. Exercise caution to avoid slipping or falling, especially when operating the snow thrower in reverse.

SAFETY INSTRUCTIONS FOR OPERATION

1. Do not put hands or feet near or under rotating parts. Keep clear of the discharge opening at all times.
2. Exercise extreme caution when operating on or crossing gravel drives, walks, or roads. Stay alert for hidden hazards traffic.
3. After striking a foreign object, stop the engine(motor), remove the wire from the spark plug, disconnect the cord on electric motors, thoroughly inspect the product for any damage and repair the damage before restarting and operating the product.
4. If the product starts to vibrate abnormally, stop the engine (motor) and check immediately for the cause. Vibration is generally a warning of trouble.
5. Stop the engine(motor) whenever you leave the operating position, before unclogging the auger housing or chute deflector, and when making any repairs, adjustments and inspections.
6. When cleaning, repairing or inspecting the product, stop the engine and make certain the augers and all moving parts have stopped. Disconnect the spark plug wire and keep the wire away from the plug to prevent accidental starting.
7. Do not run the engine indoors, except when starting the engine and for transporting the product in or out of the building. Open the outside doors as exhaust fumes are dangerous.
8. Exercise extreme caution when operating on slopes.
9. Never operate the product without proper guards, and other safety protective devices in place and working.
10. Never direct the chute deflector toward people or areas where property damage can occur. Keep children and others away.
11. Do not overload the product capacity by attempting to clear snow at too fast a rate.
12. Never operate the product at high transport speeds on slippery surfaces. Look behind and use care when operating in reverse.
13. Disengage power to the augers when the product is transported or not in use.
14. Use only attachments and accessories approved by the manufacturer of the product (such as wheel weights, counterweights, or cabs).
15. Never operate the product without good visibility or light. Always be sure of your footing, and keep a firm hold on the handles. Walk, never run.
16. Never touch a hot engine or muffler.

WORK AREA SAFETY

1. Thoroughly inspect the area where the equipment is to be used and remove all doormats, sleds, boards, wires and other foreign objects.

SAFETY INSTRUCTIONS

2. Disengage all clutches and shift into neutral before starting the engine (motor).
3. Do not operate the product without wearing adequate winter garments.
Avoid loose fitting clothing that can get caught in moving parts. Wear footwear that will improve footing on slippery surfaces.
4. Handle fuel with care; it is highly flammable.
 - a. Use an approved fuel container.
 - b. Never add fuel to a running engine or hot engine.
 - c. Fill fuel tank outdoors with extreme care. Never fill fuel tank indoors.
 - d. Never fill containers inside a vehicle or on a truck or trailer bed with a plastic liner. Always place containers on the ground, away from your vehicle, before filling.
 - e. When practical, remove gas-powered equipment from the truck or trailer and refuel it on the ground. If this is not possible, then refuel such equipment on a trailer with a portable container, rather than from a gasoline dispenser nozzle.
 - f. Keep the nozzle in contact with the rim of the fuel tank or container opening at all time, until refueling is complete. Do not use a nozzle lock-open device.
 - g. Replace gasoline cap securely and wipe up spilled fuel.
 - h. If fuel is spilled on clothing, change clothing immediately.
5. Use extension cords and receptacles as specified by the manufacturer for all units with electric drive motors or electric starting motors.
6. Adjust the auger housing height to clear gravel or crushed rock surface.
7. Never attempt to make any adjustments while the engine (motor) is running (except when specifically recommended by the manufacturer).
8. Always wear safety glasses or eye shields during operation or while performing an adjustment or repair to protect from foreign objects that may be thrown from the machine.

PERSONAL PROTECTIVE EQUIPMENT

Always use the correct personal protective equipment when you operate the product. This includes, at minimum, sturdy footwear, eye protection and hearing protection. Personal protective equipment does not erase the risk of injury but may decrease the grade of injury if an accident occurs.

1. Always wear safety glasses or eye protection while you operate the product or do maintenance or repairs.
2. Always wear appropriate winter garments when you operate the product.
3. Always use heavy-duty slip-resistant boots with good ankle support while you operate the product.
4. Do not wear loose fitting clothing that can get caught in moving parts.
5. Use approved protective gloves, if necessary. For example, when attaching, examining or cleaning the blade.
6. Always use approved ear protection while you operate the product.
Noise for a long period can cause noise-induced hearing loss.

SAFETY DEVICES ON THE PRODUCT

1. Make sure that you regularly do the maintenance to the product.
 - a. The life of the product increases.
 - b. The risk of accidents decreases.

SAFETY INSTRUCTIONS

Let an approved dealer or an approved service center regularly examine the product to do adjustments or repairs.

2. Do not use a product with damaged protective equipment. If the product is damaged, speak to an approved service center.

MUFFLER SAFETY

The muffler keeps the noise levels to a minimum and sends the exhaust fumes away from the operator. Do not use the product if the muffler is missing or defective. A defective muffler increases the noise level and the risk of fire. Examine the muffler regularly to make sure that it is attached correctly and not damaged.



ATTENTION:

The muffler becomes very hot during and after use and when the engine operates at idle speed. Be careful near flammable materials to prevent fire.

FUEL SAFETY



WARNING

Read the warning instructions that follow before you use the product.

1. Do not start the product if there is fuel or engine oil on the product.
Remove the unwanted fuel and let the product dry.
2. If you spill fuel on your clothing, change clothing immediately.
3. Do not get fuel on your body, it can cause injury. If you get fuel on your body, use soap and water to remove the fuel.
4. Do not start the product if the engine has a leak. Examine the engine for leaks regularly.
5. Be careful with fuel. Fuel is flammable and the fumes are explosive and can cause injuries or death.
6. Do not breathe in the fuel fumes, it can cause injury. Make sure that there is a sufficient airflow.
7. Do not smoke near the fuel or the engine.
8. Do not put warm objects near the fuel or the engine.
9. Do not add the fuel when the engine is on.
10. Make sure that the engine is cool before you refuel.
11. Before you refuel, open the fuel tank cap slowly and release the pressure carefully.
12. Do not add fuel to the engine in an indoor area. Not sufficient airflow can cause injury or death because of asphyxiation or carbon monoxide.
13. Tighten the fuel tank cap fully. If the fuel tank cap is not tightened, there is a risk of fire.
14. Move the product a minimum of 3m (10 ft) from the position where you filled the tank before a start.
15. Do not put too much fuel in the fuel tank.

SAFETY INSTRUCTIONS FOR MAINTENANCE



WARNING

Read the warning instructions that follow before you use the product.

SAFETY INSTRUCTIONS

1. The exhaust fumes from the engine contain carbon monoxide, an odorless, poisonous and very dangerous gas. Do not start the engine indoors or inclosed spaces.
2. Before you do the maintenance on the product, stop the engine and remove the ignition cable from the spark plug.
3. Use protective gloves when you do maintenance on the blades. The blades are very sharp and cuts can easily occur.
4. Accessories and changes to the product that are not approved by the manufacturer, can cause serious injury or death. Do not change the product.
Always use accessories that are approved by the manufacturer.
5. If the maintenance is not done correctly and regularly, the risk of injury and damage to the product increases.
6. Only do the maintenance as given in this operator's manual. All other servicing must be done by an approved service agent.
7. Let an approved service agent do servicing on the product regularly.
Replace damaged, worn or broken parts.



WARNING!

Some dust created by power sanding, sawing, grinding, drilling and other construction activities contains chemicals known to the state of California to cause cancer, birth defects or other reproductive harm. Some examples of these chemicals are:

- Lead from lead - based paints
- Crystalline silica from bricks and cement and other masonry products, and
- Arsenic and chromium from chemically -treated lumber.

Your risk from these exposures varies, depending on how often you do this type of work.

To reduce your exposure to these chemical: work in a well ventilated area, and work with approved safety equipment, such as those dust masks that are specially designed to filter out microscopic particles.

For more information go to www.P65warnings.ca.gov.

SAVE THESE INSTRUCTIONS

DESCRIPTION OF SYMBOLS

The following symbols may be used on this product. Please study them and learn their meaning. Proper description of these symbols will allow you to operate the product safely.



Precautions that involve your safety.



To reduce the risk of injury, user must read and understand the instruction manual before operating this product.



Wear eye protection. Always wear safety goggles or safety glasses with side shields.
Wear ear protection. Always wear full ear protection when operating this product.
Wear breathing protection.



Electric shock. Failure to use the starter in dry conditions and to observe safe practices can result in electric shock.



Risk of fire. Fuel and its vapors are extremely flammable and explosive. Fire can cause severe burns or death. Do not add fuel while the product is operating or still hot.



Toxic Fumes. The engine exhaust from this product contains chemicals known to cause cancer, birth defects and other reproductive harm.



Risk of asphyxiation. This engine emits carbon monoxide, a colorless, odorless poison gas. Breathing carbon monoxide can cause nausea, fainting or death. Use only in a well-ventilated area.



Thrown Objects. This machine may pick up and throw objects which can cause serious personal injury.



Always use chute tool. Never use your hands to clear a clogged chute assembly. Shut off engine and remain behind handles until all moving parts have stopped before unclogging.



Hot surface. do not touch. Exhaust gases, muffler and engine components are extremely HOT and cause burns.



Check oil level. Recommended oil is 5W-30. The engine can be seriously damaged without oil. Always check the oil level before use. The machine must be resting firmly on level ground when checking.



Safe Distance, By stander to keep a safe distance



Rotating Auger. Danger: Avoid injury from rotating auger. Keep feet away.



Wear protective gloves when using the machine and handling debris.

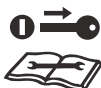

WARNING! Turn the machine OFF and disconnect it from the power supply before inspecting, cleaning, changing accessories, or conducting any other maintenance task.

DESCRIPTION OF SYMBOLS



Rotating Parts. Never put hand in the chute. Contact with rotating parts can hands.



Rotating Impeller. Never use your hands to clear a clogged chute assembly. Shut OFF engine and remain behind handles until all moving parts have stopped before unclogging.



Danger: Keep hands and feet away.



Fuel Shut off. Remove the engine key and fuel shut off.



Shut off engine and remove key before performing maintenance or repair work.



Use Clean, fresh, regular unleaded gasoline with a minimum octane rating of 87 and an ethanol content of less than 10% by volume.



Insert Ignition key.



Remove Ignition key.



Cold starting, Prime 3 times.



Warm starting, no need to Prime.



Move the fuel valve lever to the "ON" position.



Move the fuel valve lever to the "OFF" position.



Move the throttle lever to full speed.



Lower the speed of the engine.



Choke opened, when the engine starts, move the choke to the choke to "RUN" position.



Choke closed, to start a cold engine, move the choke lever to the "CHOKE" position.

PACKAGE CONTENTS

Remove the contents from the package (See Fig. 1)

1. Main body	1 pc	7. Shift rod	1 pc
2. Tires	2 pcs	8. Accessories kit	
3. Lower handle	1 pc	a) Handle fixing hardware	4 sets
4. Upper handle	1 pc	b) Socket wrench	1 pc
5. Chute control rod	1 pc	c) Control handle grip	2 pcs
6. Chute assembly	1 pc	d) Cable clip	2 pcs
		e) Safety shear pin	2 pcs

Fig. 1

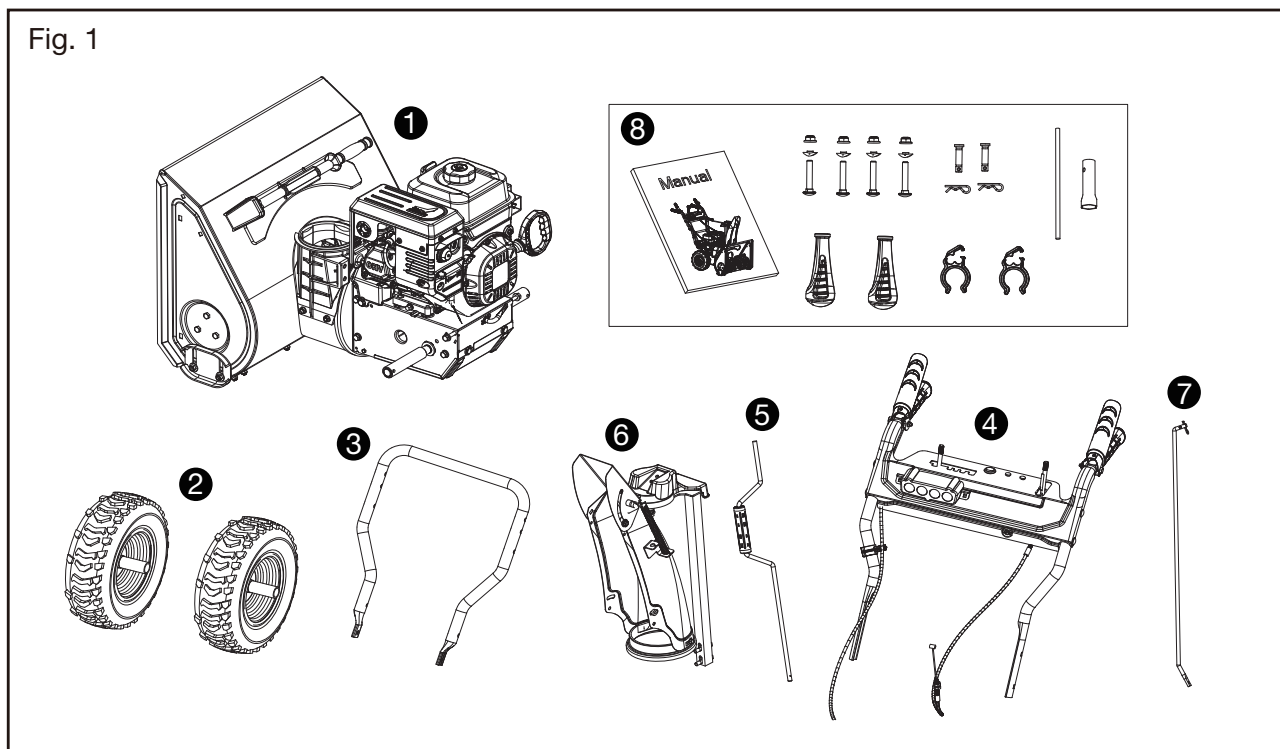

PARTS LIST

KNOW YOUR SNOW BLOWER (See Fig.1)

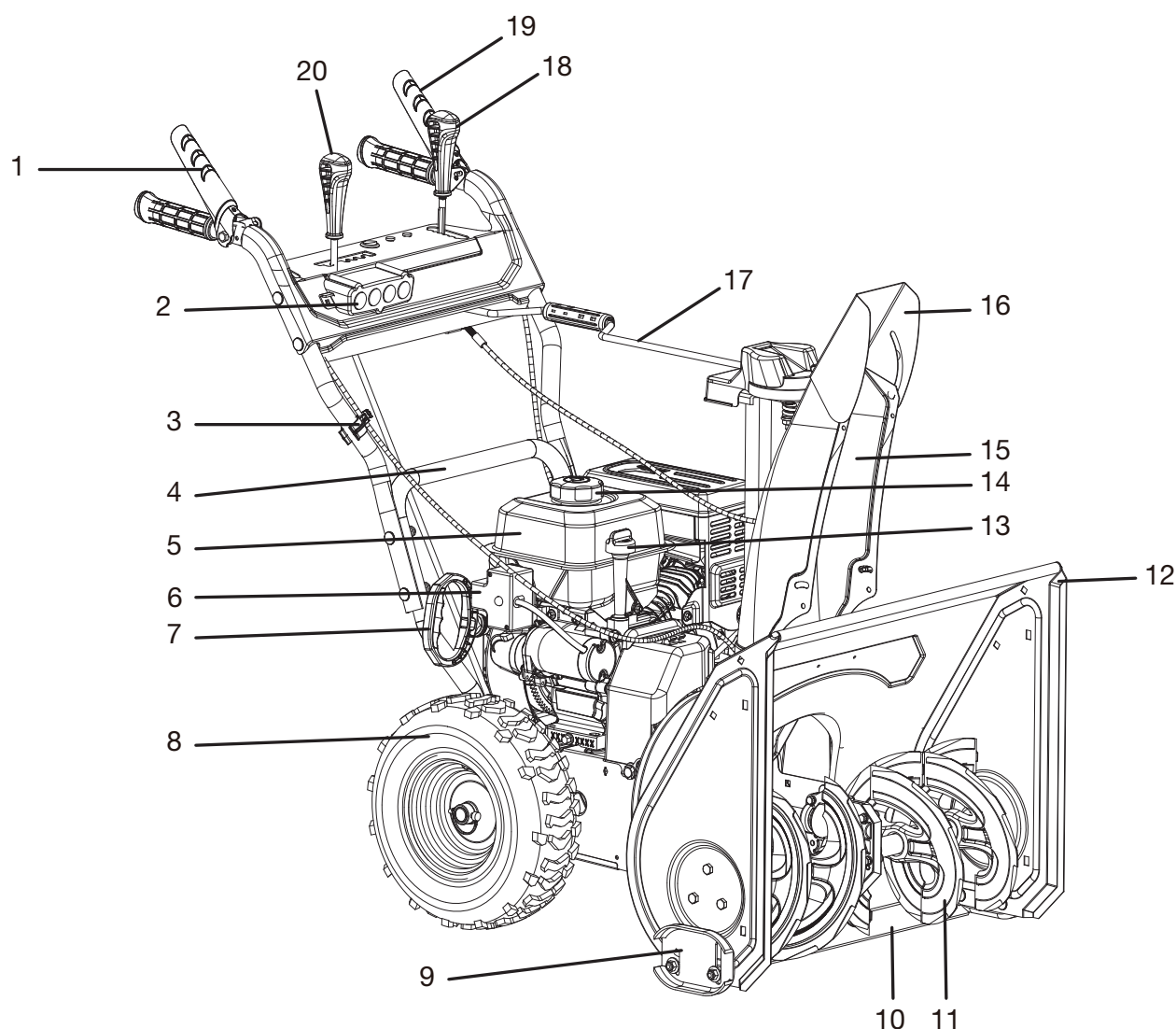

1. Auger Control Trigger
2. LED Headlight
3. Cable Clip
4. Lower Handle Assembly
5. Engine
6. Electric starter
7. Recoil Starter
8. Tire
9. Skid shoe
10. Scraper Bar

11. Auger
12. Auger Housing
13. Oil Fill
14. Fuel Tank Cap
15. Snow Discharge Chute
16. Chute Deflector
17. Chute Rotation Bar
18. Chute Deflector Handle
19. Drive Control Trigger
20. Speed Shift Handle

Snow blowers allow you to clear snow quickly and efficiently. Refer to the following diagrams to become familiarized with all the parts and controls of your snow blower. The components will be referred to later in the manual for assembly and operation instructions.

PRODUCT SPECIFICATIONS

Some parameters may be changed due to improvement, only for reference, not for acceptance.

Engine Displacement	212 cc
Gasoline capacity and type	2.5 L (0.66 U.S.Gal) Unleaded regular (maximum 10% ethanol)
Oil type (API SJ-SN)	SAE 5W-30 (below 0°C (32°F))
Oil capacity	0.6 L (20 oz)
Spark plug	F7RTC or equivalent spark plug
Spark plug electrode gap	0.7-0.8 mm
Tire pressure	138 kPa (20 psi)
Clearing Width	24 in
Intake Height	21 in
Throwing Distance	Up to 40 ft.
Wheel Size	13 in
Operating Temperature	-4°F-50°F (-20°C-10°C)
Storage Temperature	-4°F-158°F (-20°C-70°C)
Snow Blower Weight	137.8 lbs (62.5 kg)

ASSEMBLY



WARNING: If any parts are damaged or missing, do not operate this product until the parts are replaced. Use of this product with damaged or missing parts could result in serious personal injury.



WARNING: Do not attempt to modify this tool or create accessories not recommended for use with this product. Any such alteration or modification is misuse and could result in a hazardous condition leading to serious injury.

- Inspect the product carefully to make sure that no breakage or damage occurred during shipping.
- Do not discard the packing material until you have carefully inspected and satisfactorily operated the tool.
- If any parts are damaged or missing, please contact our customer service department for help.

INSTALL THE LOWER HANDLE AND TIRES (See Fig. 2 & 3)

1. Install the lower handle on transmission box with carriage bolt, tighten them by open-end spanner.

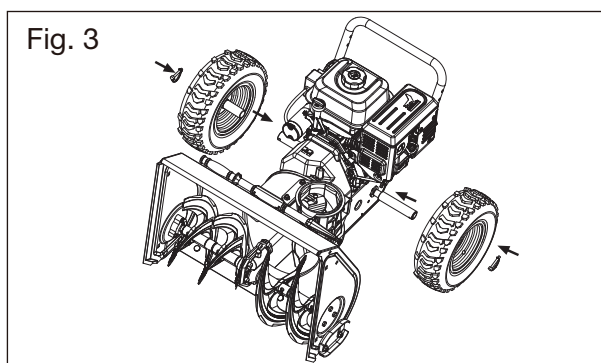
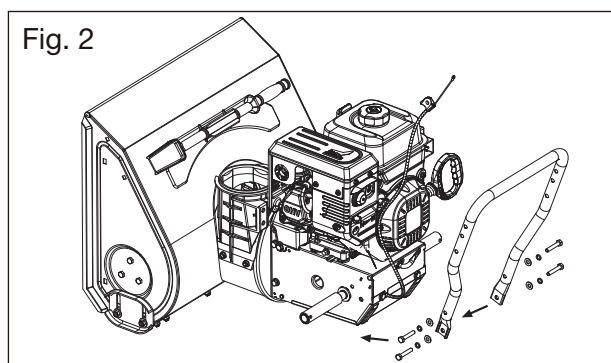

2. Install the tires to the output shaft, and fix them by bolts.

INSTALL THE PANEL & HANDLES

The panel is installed with handles already. All you need to you is to fix the cables to the panel.

1. Connect the drive cable to drive clutch lever, and auger cable to auger clutch lever (Fig. 4).

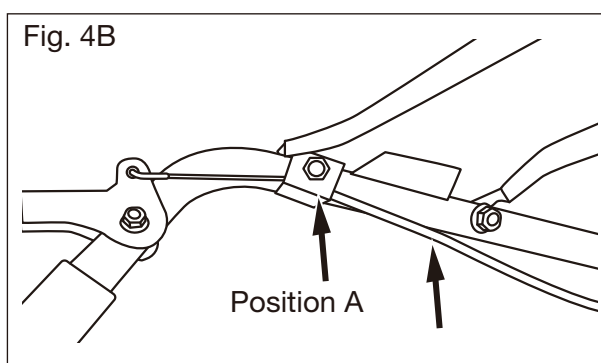
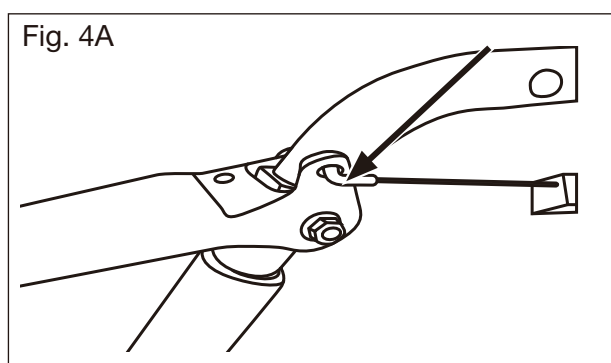

2. Attach handle to the control panel, and fix it with bolts together with the cable holder (position A).
3. Take up the panel & handles, and slot them into the lower handle and secure it with the bolts, nuts & washers (Fig. 5).
4. Attach the auger drive control cable to the cable clamp located on the belt cover (Fig. 6).

ASSEMBLY

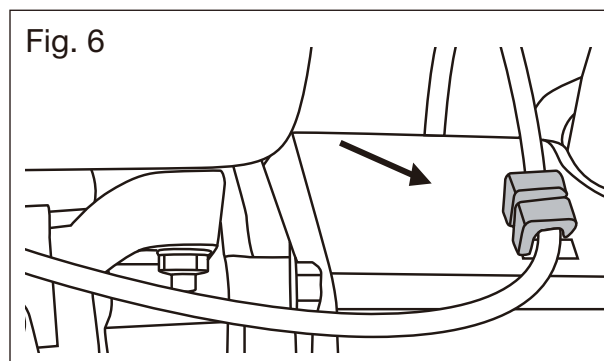
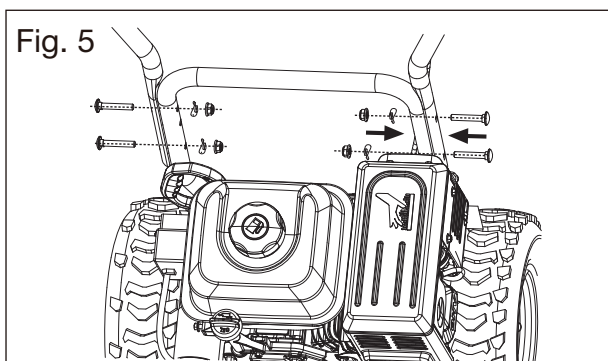

TO ASSEMBLE THE SPEED SHIFT ROD (See Fig. 7 & 8)

1. Remove the cotter pin from the bottom plate of the speed shift handle. (Fig. 7)
2. Attach the upper end of shift rod to the pin on the bottom plate of the speed shift handle and secure it in place with the cotter pin.
3. Remove the cotter pin from the other end of shift rod and insert the angled end into the hole on the shift lever, and secure it in place with the cotter pin. (Fig. 8)

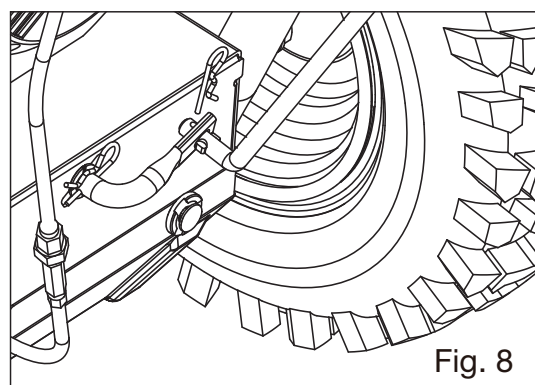
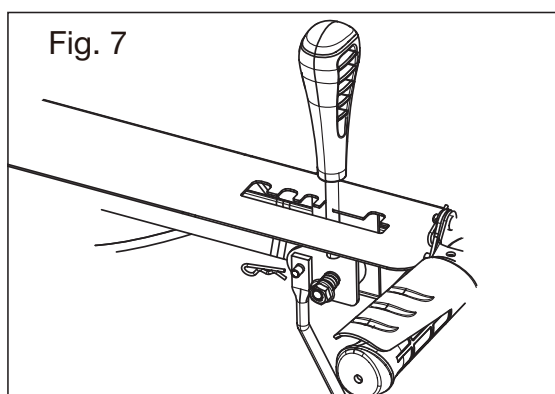

TO ASSEMBLE THE CONTROL HANDLE GRIP (See Fig. 9)

Rotate the control handle grips to the handle ends on the dash panel. Tighten each by hand.

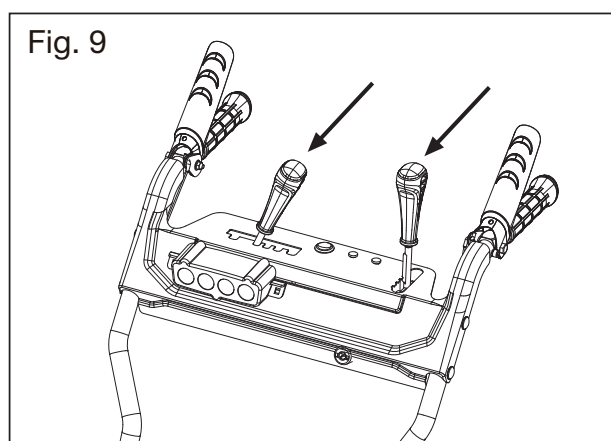

ASSEMBLY

TO INSTALL THE SNOW DISCHARGE CHUTE ASSEMBLY



WARNING: Never operate the snow blower without the complete discharge chute in place.



WARNING: Use the chute rotation handle to make sure that the chute rotates properly and that the discharge opening never crosses the operator controls.

1. Remove two bolts and metal plate from the end of chute support bar (Fig. 10B).
2. Place the chute on the machine, seat chute end (Fig. 10C) on the chute seat (Fig. 11A). The end of the chute support bar (Fig. 10B) must be aligned with the seat bracket (Fig. 11B).
3. Fix the chute support bar end (Fig. 10B) to the seat bracket (Fig. 11B) with the two bolts and metal plate.
4. Insert the chute rotation bar's end (Fig. 12A) to the hole in the control panel. Remove the cotter pin from the hole on chute assembly and insert the other end (Fig. 12B) hole on chute assembly as shown (Fig. 13A). Once inserted, secure with the cotter pin.
5. Remove the cotter pin from the bracket (Fig. 14B) of chute deflector handle and connect chute deflector control cable end (Fig. 15B) to the bracket (Fig. 14B), and secure with cotter bin.
6. Place cable with nuts (Fig. 15A) onto bracket (Fig. 14A) so nuts are on each side of bracket. Check the deflector handle function and tighten nuts to secure the cable.

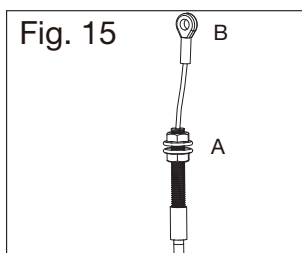
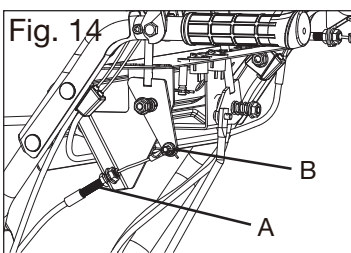
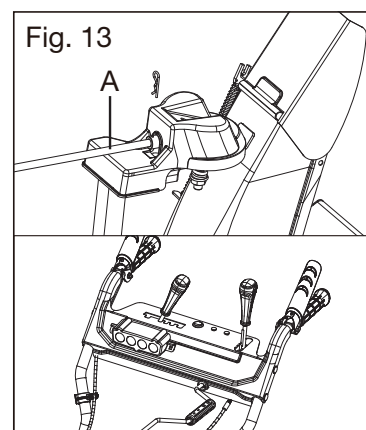
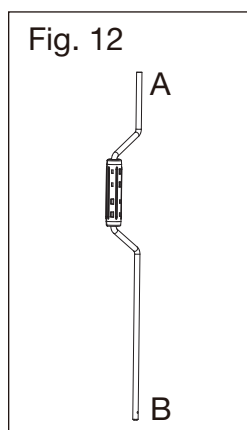
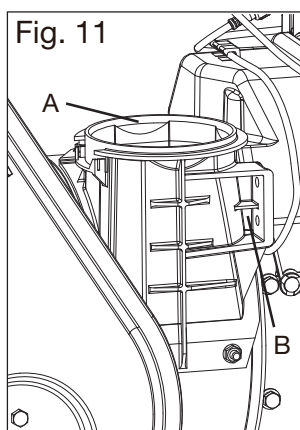
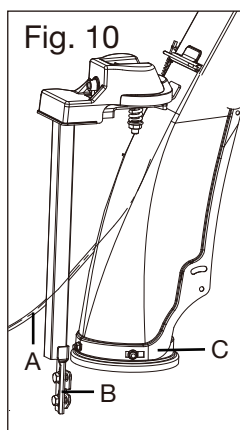

WARNING: Do not allow familiarity with this product to make you careless. Remember that a careless fraction of a second is sufficient to inflict serious injury.



WARNING: Always wear eye protection with side shields marked to comply with ANSI Z87.1. Failure to do so could result in objects being thrown into your eyes and other possible serious injuries.



WARNING: Do not use any attachments or accessories not recommended by the manufacturer of this product. The use of attachments or accessories not recommended can result in serious personal injury.

OPERATING CONTROLS



WARNING

Read, understand, and follow all instructions and warnings on the machine and in this manual before operating.

Shift Lever



Fig.16

The shift lever is located on panel. Place the shift lever into any position to control speed. See Figure 16.

Forward

There are four forward (F) speeds. Position one (1) is the slowest and position four (4) is the fastest.

Reverse

There is one reverse (R) speed.

Primer

Depressing the primer forces fuel directly into the engine's carburetor to aid in cold-weather starting.

Choke Control

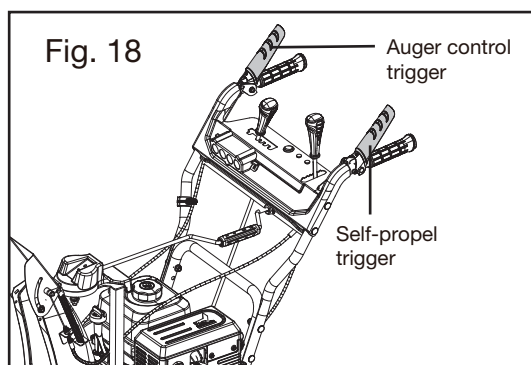

Fig.17

The choke control is found on the rear of the engine and is activated by rotating the knob clockwise. Activating the choke control closes the choke plate on the carburetor and aids in starting the engine. See Figure 17.

OPERATING YOUR SNOW BLOWER

AUGER CONTROL TRIGGER AND DRIVE CONTROL TRIGGER (Fig. 18)



1. The auger control is located on the right handle. Squeeze the control trigger against the grip to engage the augers and start snow blowing action. Release to stop. See Figure 18.
2. The drive control is located on the left handle. Squeeze the control trigger against the grip to engage the wheel drive. Release to stop. See Figure 18.

Adjust The Direction of Snow-Discharge Chute

The chute can be adjusted to change both the direction and the distance of the discharged snow to assist you in moving snow away from one area and placing it in another.

The direction of snow discharge can be adjusted 180° left to right. To adjust the direction (Fig. 19A):

1. Rotate the chute rotation bar to the left to rotate the chute to the left.
2. Rotate the chute rotation bar to the right to rotate the chute to the right.

Adjust The Chute Deflector

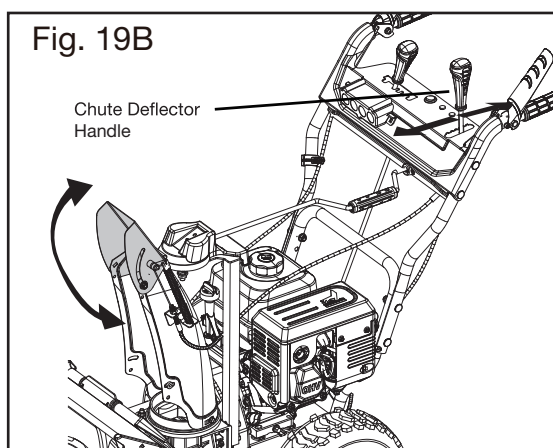
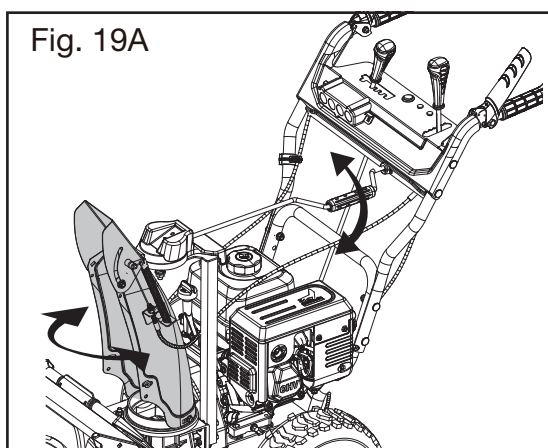

The throwing distance of the snow blower is adjusted by moving the chute deflector up or down. To increase or decrease the distance that the snow is thrown, pull the chute deflector handle backward or forward to raise or lower the chute deflector (Fig. 19B). Once arriving at the desired chute deflector position, engage the chute deflector handle back into the locking slot.

OPERATING YOUR SNOW BLOWER

LED HEADLIGHT OPERATION (Fig.20)

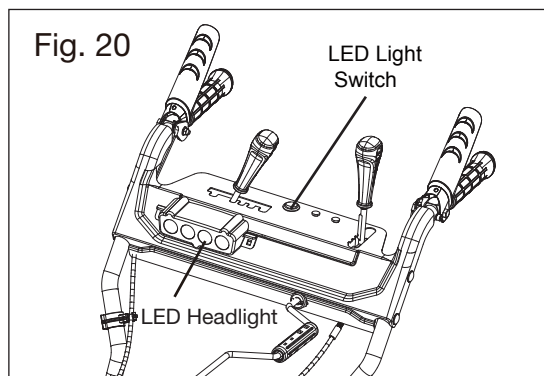

To operate the LED Headlight:

1. Set the LED light switch into the "on" position to turn on the headlight.
2. To turn off the LED headlight, set the LED light switch to the "off" position.

Skid Shoe Adjustment

The space between shave plate and the ground can be adjusted. See Figure 21.

- For close snow removal on a smooth surface, set the skid shoes higher on the auger housing to decrease shave plate height.
- Set the skid shoes in the middle or lower on the auger housing to increase shave plate height when the area being cleared is uneven, such as a gravel driveway.

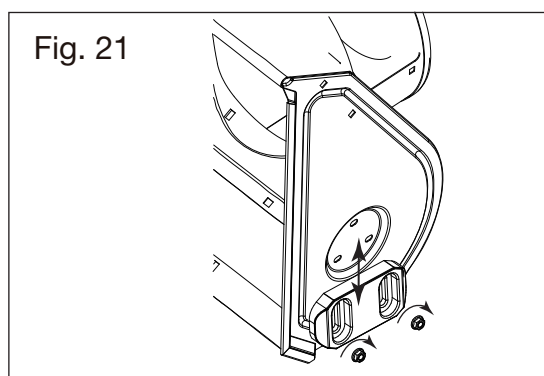

To adjust the skid shoes:

1. Loosen the four hex nuts (Two on each side) and carriage bolts. Move skid shoes to desired position.
2. Make certain the entire bottom surface of skid shoe is against the ground to avoid uneven wear on the skid shoes.
3. Retighten nuts and bolts securely.

OPERATING YOUR SNOW BLOWER

CLEARING A CLOGGED CHUTE



WARNING: Hands coming in contact with the rotating auger inside the chute is the most common cause of injury associated with snow blowers. Never use your hand to clean out the chute.

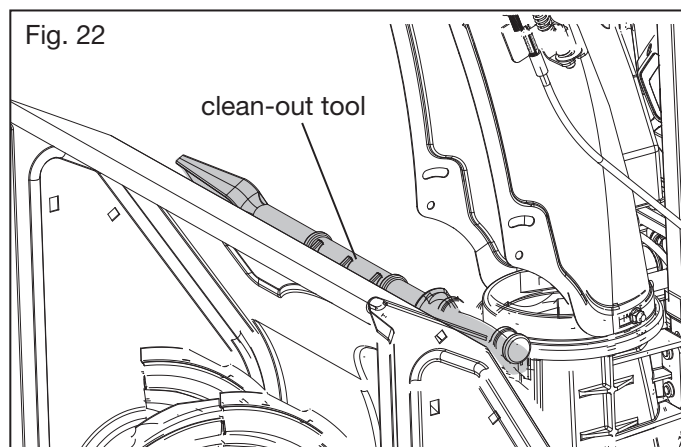

Fig. 22

clean-out tool

To Clear the Chute:

1. Turn off the unit.
2. Wait 10 seconds to be sure the auger has stopped rotating.
3. Always use the chute clean-out tool which is attached to the machine as an accessory. **DO NOT USE YOUR HAND** (Fig.22).

Recoil Starter Handle

This handle is used to manually start the engine.

Electric Starter Outlet

Requires the use of a two-prong outdoor extension cord and a 120V power source.

NOTE: This machine is not equipped with an extension cord.

Augers

When engaged, the augers rotate and draw snow into the auger housing.

Chute Assembly

Snow drawn into the auger housing is discharged out the chute assembly.

Gas Cap

Unthread the gas cap to add gasoline to the fuel tank.

Oil Fill

Engine oil level can be checked and oil added through the oil fill!

Before Starting Engine

Do not start the engine until filled with oil. The engine can be seriously damaged without oil .

1. Place the machine on a level floor.
2. Loose and remove the dipstick from oil filler, then clean the oil on the dipstick if have.

OPERATION YOUR SNOW BLOWER

3. Insert the dipstick but not screw into the oil filler, then pull out to check the oil level shown on the dipstick.
4. The oil level shall be between the marks "HIGH" and "LOW". If not, add or drain some oil to make it.
5. Use good quality oil marked A.P.I. service SF, SG or SH. Use SAE 5W-30 oil. Use SAE 0W-30 oil for temperatures under -18°C. Do not use SAE 10W-40.

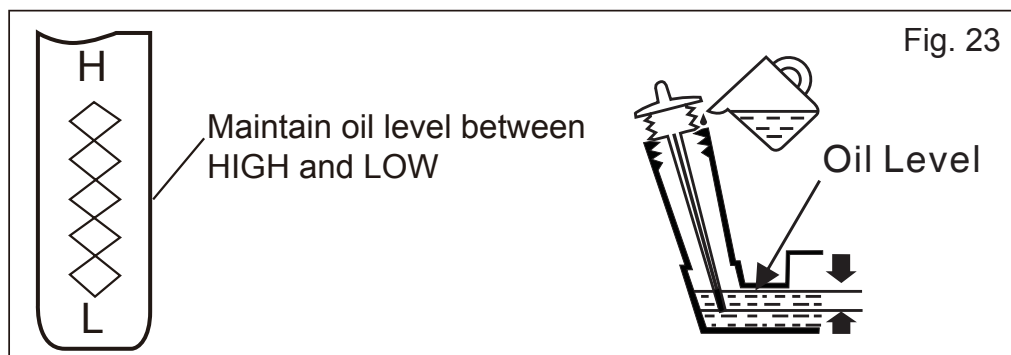

Gasoline



WARNING

Use extreme care when handling gasoline is extremely flammable and the vapors are explosive. Never fuel the machine indoors or while the engine is hot or running. Extinguish cigarettes, cigars, pipes and other sources of ignition.

- Store gasoline in a clean, approved container and keep the cap in place on the container.
- Make sure that the container from which you pour the gasoline is clean and free from rust or other foreign particles.

NOTE: A plastic dust cap may be found inside the fuel fill opening.

Remove and discard, if present.

- Always fill the fuel tank outdoors and use a funnel or spout to prevent spilling.
- Fill fuel tank with clean, fresh, unleaded gasoline.
- Never fill the fuel tank completely. Fill the tank to within 1/2" from the top to provide space for expansion of fuel.
- Make sure to wipe off any spilled fuel before starting the engine.

STARTING THE ENGINE

1. Attach spark plug wire to spark plug. Make certain the metal loop on the end of the spark plug wire (inside the rubber boot) is fastened securely over the metal tip on the spark plug.
2. Make certain both the auger control and drive control are in the disengaged (released) position.
3. Move throttle control up to FAST position. Insert ignition key into slot. Make sure it snaps into place. Do not attempt to turn the key.

NOTE: The engine cannot start without the key is fully inserted into the ignition switch.

Electric Starter

Determine that your home's wiring is a two-wire grounded system. Ask a licensed electrician if you are not certain.

OPERATING YOUR SNOW BLOWER



WARNING

The optional electric starter is equipped with a grounded two-wire power plug, and is designed to operate on 120V household current. It must be used with a properly grounded two-prong receptacle at all times to avoid the possibility of electric shock.

If your home's wiring system is not a grounded system, do not use this electric starter under any conditions.

If your home electrical system is grounded, but a two-hole extension cord is not available, do not use your snow blower's electric starter.

Follow all instructions carefully prior to operating the electric starter.

If you have all of the above, proceed as follows:

1. Plug the extension cord into the outlet located on the engine's surface. Plug the other end of extension cord into a 120-volt, grounded, AC outlet in a well-ventilated area.
2. Rotate choke control to FULL choke position (for a cold engine start).

NOTE: If the engine is already warm, place choke control in the OFF position instead of FULL.

3. Push the primer to restart a warm engine start, making sure to cover vent hole in the center of the primer when pushing.

NOTE: DO NOT use primer to restart a warm engine after a short shutdown.

4. Push start button to start engine.
5. Once the engine starts, release starter button.
6. AS the engine warms, slowly rotate the choke control to the OFF position. If the engine falters, quickly rotate the choke control back to FULL and then slowly into the OFF position again.
7. When disconnecting the extension cord, always unplug the end at the wall outlet unplugging the opposite end from the snow blower.

Recoil Starter

1. Rotate choke control to FULL choke position (cold engine start).

NOTE: If the engine is already warm, place choke control in the OFF position instead of FULL.

2. Push the primer two or three times for cold engine start, making sure to cover vent hole in the center of the primer when pushing.

NOTE: DO NOT use primer to restart a warm engine after a short shutdown.

NOTE: Additional priming maybe necessary if the temperature is below -10° Centigrade.

3. Grasp the recoil starter handle and slowly pull the rope out. At the point where it becomes slightly harder to pull the rope, slowly allow the rope to recoil.
4. Pull the starter handle with a firm, rapid stroke. Do not release the handle and allow it to snap back. Keep a firm hold on the starter handle and allow it to slowly recoil.
5. As the engine warms, slowly rotate the choke control to the OFF position. If the engine falters, quickly rotate the choke control back to the FULL position and then slowly into the OFF position again.

NOTE: Allow the engine to warm up for a few minutes after starting. The engine will not develop full power until reaching operating temperatures.

STOPPING THE ENGINE

Run engine for a few minutes before stopping to help dry off any moisture on the engine.

To help prevent possible starter freeze-up, proceed as follows:

OPERATING YOUR SNOW BLOWER

Electric Starter

1. Connect extension cord to the electric starter outlet on the engine, then to 120V outlet.
2. With the engine running, push the starter button and allow the starter for spin for several seconds. The noise made in the starter is normal. The engine's starter is not being harmed.
3. When disconnecting the extension cord, always unplug the end at the wall outlet before unplugging the opposite end from the snow blower.
4. Move throttle control to OFF position.
5. Remove the ignition key and store in a safe place.
6. Wipe all snow and moisture from the area around the engine as well as the area in and around the drive control and auger control. Also, engage and release both controls several times.

Recoil Starter

1. With engine running, pull the starter rope with a rapid, continuous full arm stroke three or four times. Pulling the starter rope will produce a loud clattering sound, which is not harmful to engine.
2. Move the throttle control to OFF position.
3. Remove the ignition key and store in a safe place.
4. Wipe all snow and moisture form the area around the engine as well as the area in and around the drive control several times

Chute Clean-Out Tool

The chute clean-out tool is conveniently fastened to the rear of the auger housing with a mounting clip. Should snow and ice become clogged in the chute assembly during operation, proceed as follows to safely clean the chute assembly and chute opening.

1. Release both the Auger Control and the Drive Control.
2. Stop the engine by removing the ignition key.
3. Remove the clean-out tool from the clip which auger housing.



WARNING

The muffler, engine and surrounding areas become hot and can cause a burn. DO not touch.

4. Use the shovel-shaped end of the clean-out tool to dislodge and scoop any snow and ice which has formed in and near the chute assembly.
5. Refasten the clean-out tool to the mounting clip on the rear of the auger housing, reinsert the ignition key and start the snow blower's engine.
6. While standing in the operator's position (behind the snow blower), engage the auger control for a few seconds to clear any remaining snow and ice from the chute assembly.

To Engage Drive

1. With the throttle control in the Fast (rabbit) position, move shift lever into one of the four forward(F) positions or the reverse (R) position. Select a speed appropriate for the snow conditions and a pace you're comfortable with.

NOTE: When selecting a Drive Speed, use the slower speeds until you are comfortable and familiar with the operation of the snow blower.

2. Squeeze the auger control against the handle and the auger will turn. Release it and the augers will stop.
3. Squeeze the drive control against the handle and snow blower will move. Release it and drive motion will stop.

OPERATING YOUR SNOW BLOWER

IMPORTANT: NEVER reposition the shift lever (change speeds or direction of travel) without first releasing the drive control and bringing the snow blower to a complete stop. Doing so will result in premature wear to the snow blower's drive system.

MAINTENANCE

Lubrication



WARNING

Before lubricating, repairing, or inspecting, disengage all controls and stop engine. Wait until all moving parts have come to a complete stop.

Gear Shaft

The gear (hex) shaft should be lubricated at least once a season or after every 25 hours of operation.

1. Remove the lower frame cover by removing the two screws which secure it.
2. Apply a light coating of an all-weather multi-purpose grease to the hex shaft. See Figure 24.

IMPORTANT: Avoid oil spillage on rubber friction wheel and aluminum drive plate.

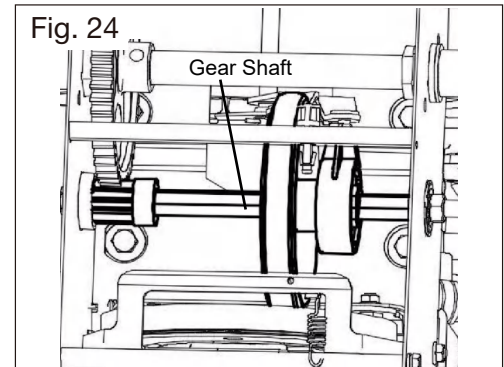

Wheels

At least once a season, remove both wheels. Clean and coat the axles with a multipurpose automotive grease before reinstalling wheels.

Chute Directional Control

Once a season, the joystick should be lubricated with petroleum jelly, Linseed oil, mineral oil, paraffin wax or 3-in1 oil.

Auger Shaft

At least once a season, remove the shear pins on auger shaft. Spray lubricant inside shaft, around the spacers. Also lubricate the flange bearings found at either end of the shaft. See Figure 25.

Gear Case

The auger gear case has been filled with grease. If disassembled from any reason, lubricate with three ounces of new grease.

NOTE: Do not over fill the gear case. Damage to the seals could result. Be sure the vent plug is free of grease in order to relieve pressure.

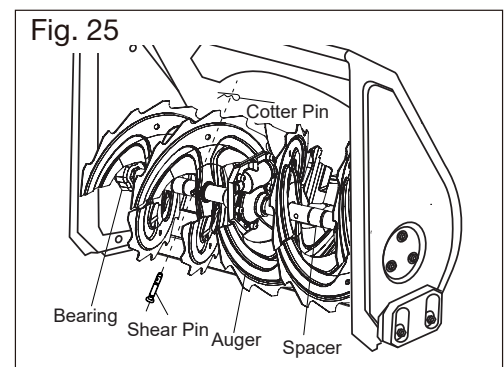

Shave Plate and Skid Shoes

The shave plate and skid shoes on the bottom of the snow blower are subject to wear. They should be checked periodically and replaced when necessary.

To remove skid shoes:

1. Remove the four carriage bolts and hex flange nuts which secure them to the snow blower.
2. Reassemble new skid shoes with the four carriage bolts (two on each side) and hex flange nuts. See Figure 26.

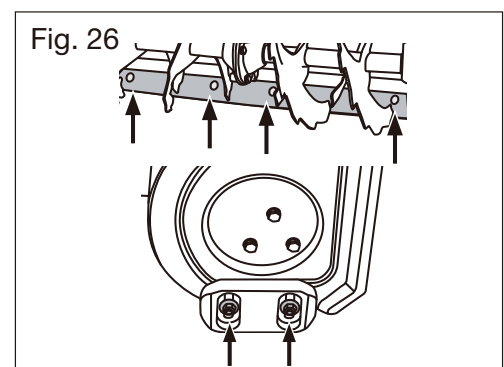

MAINTENANCE

To remove shave plate:

1. Remove the carriage bolts and hex nuts which attach it to the snow blower housing.
2. Reassemble new shave plate, making sure heads of carriage bolts are to the inside of housing. Tighten securely. See Figure 26.

Auger Belt Replacement

To remove and replace your snow blower's auger belt, proceed as follows:

1. Remove the belt cover on the front of the engine by removing the two self-tapping screws.
- NOTE:** Drain the gasoline from the snow blower, or place of plastic under the gas cap. See Figure 27.
2. Carefully pivot the snow blower up and forward so that it rests on the auger housing. Remove the frame cover from the underside of the snow blower by removing four self-tapping screws which secure it. See Figure 28.
3. Roll the auger belt off the engine pulley. See Figure 29.
4. a. Loosen and remove the shoulder screw which acts as a belt keeper.
b. Unhook the support bracket spring from the frame. See Figure 30.
5. Remove the belt from around the auger pulley, and slip the belt between the support bracket and the auger pulley. Reassemble auger belt by following instructions in reverse order. See Figure 31.

NOTE: Do NOT forget to reinstall the shoulder screw and reconnect the spring to the frame after installing a replacement auger belt.

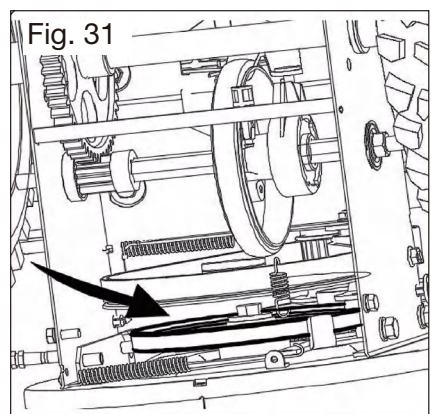
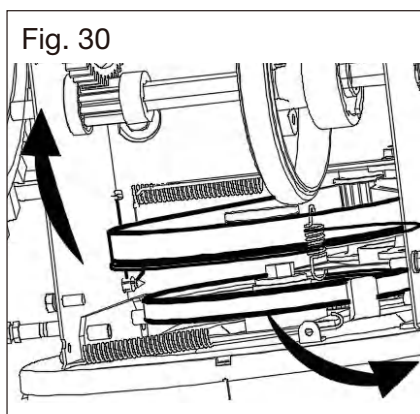
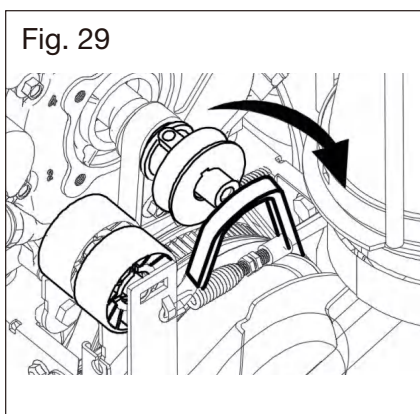
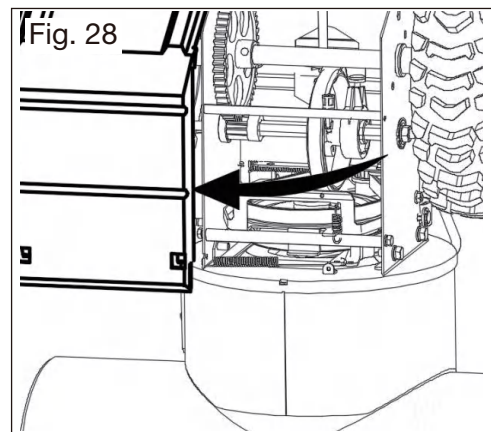
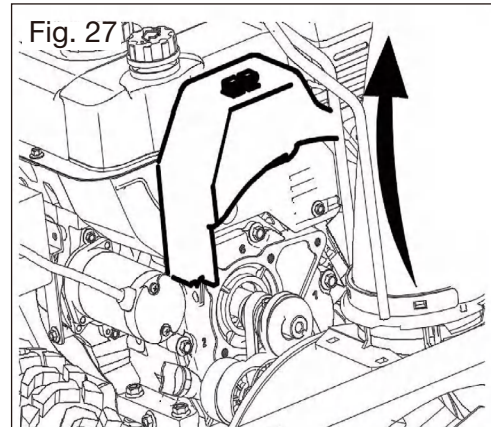

MAINTENANCE

Augers

- The auger is secured to the spiral shaft with two shear pins and cotter pins. If the auger should strike a foreign object or ice jam, the snow blower is designed so that the pins may shear. See Figure 32.
- If the augers will not turn, check to see if the pins have sheared. One set of replacement shear pins has been provided with the snow blower. When replacing pins, spray an oil lubricant into shaft before inserting new pins.

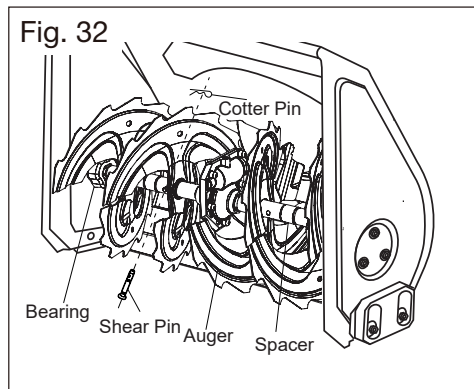

Drive Belt Replacement

To remove and replace your snow blower's auger belt, proceed as follows:

1. Remove the belt cover in the front of the engine by removing the two self-tapping screws. See Figure 33.

NOTE: Drain the gasoline from the snow blower or place a piece of plastic under the gas cap.

2. Carefully pivot the snow blower up and forward so that it rests on the auger housing. Remove the frame cover from the underside of the snow blower by removing four self-tapping screws which secure it. See Figure 34.
3. a. Grasp the idler pulley and pivot it toward the right.
b. Roll the auger belt off the engine pulley.
c. Lift the drive belt off engine pulley. See Figure 35.
4. Slip the drive belt off the pulley and between friction wheel and friction wheel disc. See Figure 36.
5. Replace belt in the reverse order.

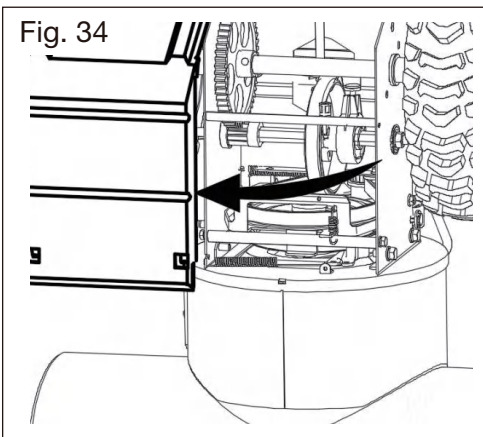
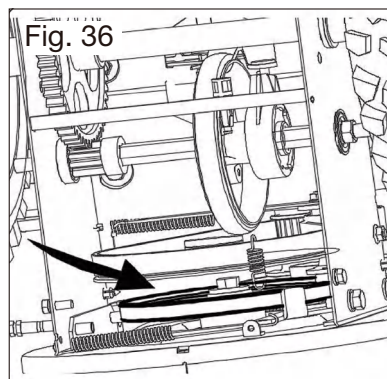
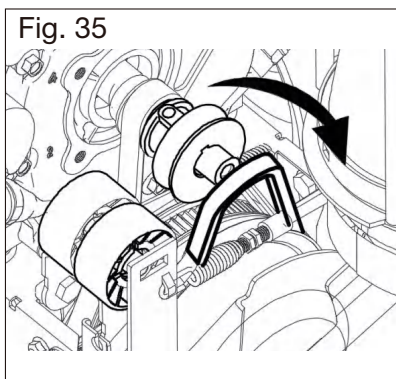
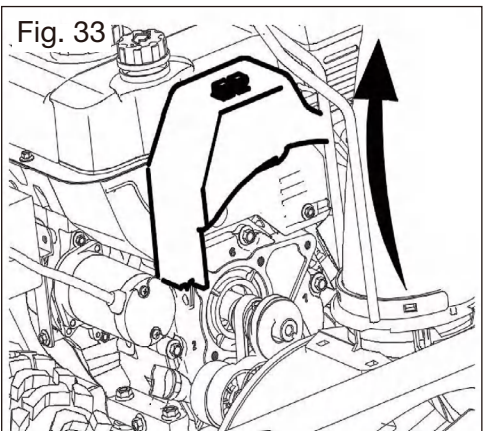

Friction Wheel Removal

If the snow blower fails to drive with the drive control engaged, and performing the drive control cable adjustment fails to correct the problem, the friction wheel may need to be replaced. Follow the instructions below.

1. Examine the friction wheel for signs of wear or cracking and replace if necessary.
 - Place the shift lever in third Forward (F3) position.
 - Drain the gasoline from the snow blower, or place a piece of plastic under the gas cap.
 - Carefully pivot the snow blower up and forward so that it rests on the auger housing.

MAINTENANCE

2. a. Remove the frame cover from the underside of the snow blower by removing four self-tapping screws which secure it.
b. Remove the right-hand wheel by removing the screw and bell washer which secure it to the axle. See Figure 37.
3. Carefully remove the hex nut and washer which secures. See Figure 38. The hex shaft to the snow blower frame and lightly tap the shaft's end to dislodge the ball bearing from the right side of the frame.
4. Carefully position the hex shaft downward and to the left before carefully sliding the friction wheel assembly off the shaft.

NOTE: If you're replacing the friction wheel assembly as a whole, discard the worn part and slide the new part onto the hex shaft. Follow the steps above the friction wheel and replacing only the rubber ring, proceed as follows. See Figure 39.

5. Slide the friction wheel assembly back onto the hex shaft and follow the steps above in reverse order to reassemble components.

Checking Engine Oil

1. Be sure engine is upright and level.
2. Unscrew oil fill cap from oil filler tube and wipe dipstick clean. See Figure 40.
3. Screw oil cap back into oil filler tube. Tighten securely.
4. Unscrew and remove oil fill cap from oil filler tube. Note oil level. If oil reading on dipstick is below "LOW" mark, slowly add oil to reach "HIGH" level. See Figure 41.
5. Screw oil fill cap back into oil filler tube. Tighten securely.
6. Wipe away any spilled oil.

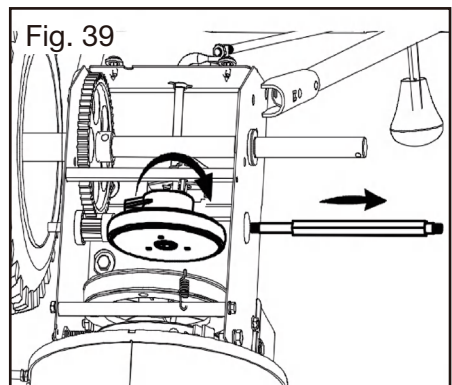
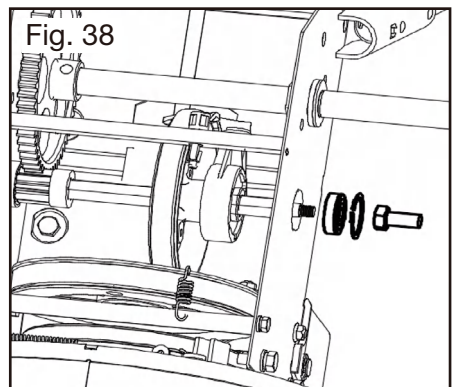
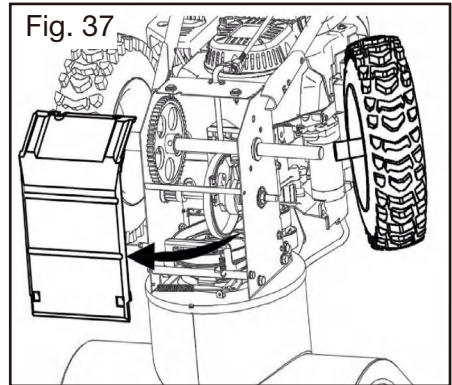

Fig. 40

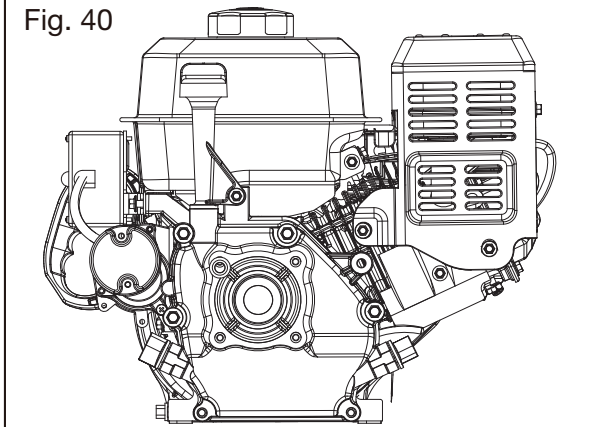
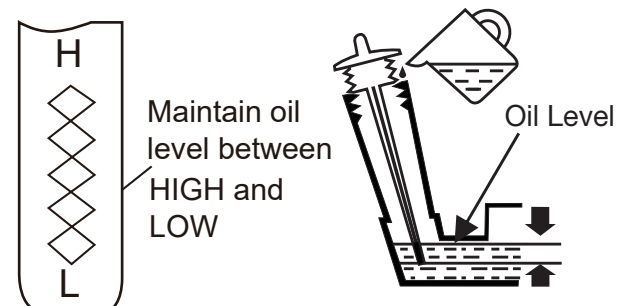

Fig. 41



MAINTENANCE

Changing Engine Oil

To avoid engine damage, it is important to:

- Check oil level before each use and every five operating hours.
- Change oil after first two operating hours and every 25 operating hours thereafter.
- Engine should still be warm but not hot from recent use.

1. Locate the oil drain plug, See figure 42.
2. Be sure the gas cap is on and is tighten securely.
3. Clean area around oil drain plug, see figure 42.
4. Place approved recyclable oil container under oil drain plug.
5. Remove oil drain plug and drain oil.

Note: Used oil must be disposed of at a proper collection center.

6. Install oil drain plug and tighten securely.
7. Refill the engine with recommended oil, see Recommended Oil Usage chart.
8. Wipe away any spilled oil.

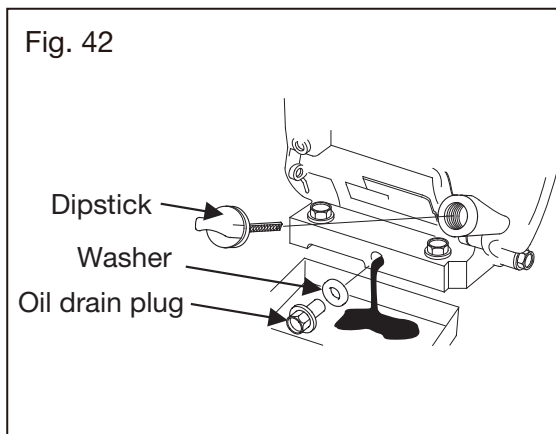

Checking Spark Plug

Check spark plug yearly or every 100 operating hours.

1. Clean area around spark plug.
2. Remove and inspect spark plug.
3. Replace spark plug if porcelain is cracked or if electrodes are pitted, burned or fouled with deposits.
4. Check electrode gap with a feeler gauge and set gap to 0.030" (0.76 mm) if necessary. See Figure 43.
5. Reinstall spark plug and tighten securely.

NOTE: A resistor spark plug must be used for replacement. Contact the distributor or local agent for a replacement spark plug.

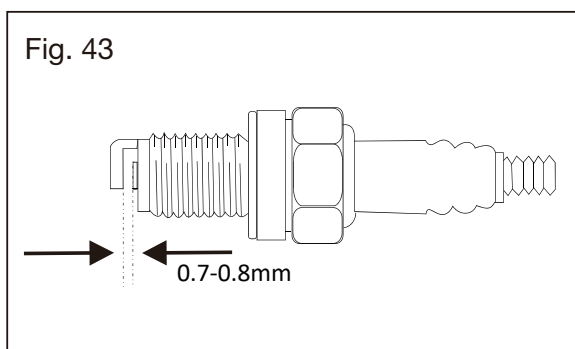

MAINTENANCE

Carburetor

If you suspect your carburetor needs adjusted, contact the distributor or local agent, engine performance should not be affected at altitudes up to 7000 feet (2134 meters). For operation at higher elevations, contact the distributor or local agent.

Engine Speed



WARNING

Avoid serious injury or death. DO NOT modify engine in any way. Tampering with the governor setting can cause the engine and equipment to operate at unsafe speeds. NEVER tamper with factory setting of engine governor. Running the engine faster than the speed set at the factory is dangerous.

SERVICE AND ADJUSTMENT

Control Wire Adjustment

After long time using, or when the belts are adjusted or replaced, the control wires must also be adjusted as well. See Figure 44.

1. Lift the snow blower forward and rest in on the auger housing.
2. Push the wire through the spring so that the threaded part is exposed.
3. Hold the threaded part and adjust the nut or until the correct setting is obtained.
4. Pull the wire through the spring again, Hook the wire into the upper part of the clutch lever same adjustment for both sides.

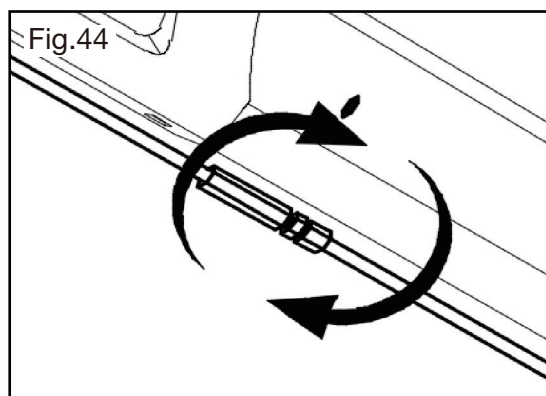

Skid Shoe Adjustment

The space between skid shoes and the ground can be adjusted. See Figure 45.

- For close snow removal on a smooth surface, raise skid shoes higher on the auger housing.
- Use a middle or lower position when the area to be cleared is uneven, such as a gravel driveway.

To adjust the skid shoes:

1. Loosen the four hex nuts (Two on each side) and carriage bolts. Move skid shoes to desired position.
2. Make certain the entire bottom surface of skid shoe is against the ground to avoid uneven wear on the skid shoes.
3. Retighten nuts and bolts securely.

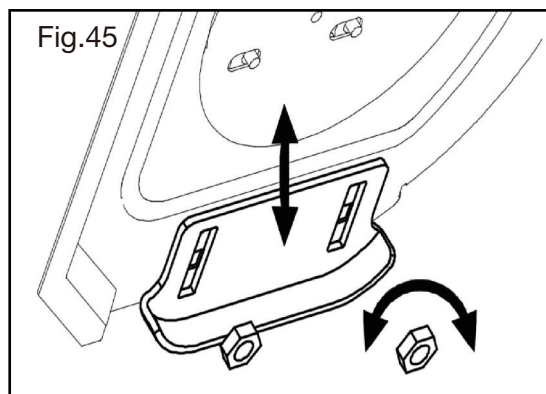

Tire Pressure

Before operating, Check the pressure and reduce pressure to between 15 psi and 20 psi (you can also refer to the specifications printed on the tire). If the tire pressure is not equal in both tires, the unit may pull to one side or the other.

OFF-SEASON STORAGE

Preparing Engine



WARNING

Never store snow blower with fuel in tank indoors or in poorly ventilated areas, where fuel fumes may reach an open flame, spark or pilot light as on a furnace, water heater, clothes dryer or gas appliance.

NOTE: It is important to prevent gum deposits from forming in essential fuel system parts of the engine such as the carburetor, fuel filter, fuel hose or tank during storage.

CAUTION: Alcohol blended fuels (called gasohol or using ethanol or methanol) can attract moisture which leads to separation and formation acids during storage. Acidic gas can damage the fuel system of an engine while in storage.

To avoid engine problems, the fuel system should be emptied before storage for 30 days or longer, follow these instructions to prepare your snow blower for storage:



WARNING

Drain fuel into an approved container outdoors, away from any open flame. Be certain engine is cool. Do not smoke. Fuel left in engine during warm weather deteriorates and will cause serious starting problems.

1. Remove ALL gasoline from the carburetor and the fuel tank to prevent gum deposits from forming on these parts and harming the engine.
2. Run the engine until the fuel tank is empty and it stops due to lack of fuel.
3. Drain carburetor by pressing upward on bowl drain, located below the carburetor cover.



WARNING

Do not drain carburetor if using fuel stabilizer. Never use engine or carburetor cleaning products in the fuel tank or permanent damage may occur.

NOTE: Fuel stabilizer (such as STA-BIL) is an acceptable alternative in minimizing the formation of fuel gum deposits during storage. Add stabilizer to gasoline in fuel tank or storage container, always follow mix ratio found on stabilizer container. Run engine at least 10 minutes after adding stabilizer to allow it to reach the carburetor. Do not drain carburetor if using fuel stabilizer.

4. Remove the spark plug and pour one ounce of engine oil through the spark hole into the cylinder. Cover spark plug hole with a rag and crank the engine several times to distribute the oil. Replace spark plug.

Preparing Snow Blower

1. When storing the snow blower in an unventilated or metal storage shed, care should be taken to rustproof the equipment, using a light oil or silicone, coat the equipment, especially any chains, springs, bearings and cables.
2. Remove all dirt from exterior of engine and equipment.
3. Follow lubrication recommendations in the Maintenance section of this manual.
4. Store equipment in a clean dry area.

TROUBLESHOOTING

IF THESE SOLUTIONS DO NOT SOLVE THE PROBLEM, CONTACT CUSTOMER SERVICE.

PROBLEM	POSSIBLE CAUSE	SOLUTION
The product does not start	The safety ignition key is not inserted.	Insert the safety ignition key.
	The product is out of fuel.	Fill the fuel tank with fresh, clean gasoline.
	The choke is in OFF (CLOSE) position.	Move the choke to ON (FULL, OPEN) position.
	The primer is not depressed.	Press the primer.
	The engine is flooded.	Wait a few minutes before restarting, DO NOT prime.
		Restart the engine while full throttle and the choke in OFF (CLOSE) position.
	The spark plug wire is not connected.	Connect the wire to the spark plug.
	The spark plug is bad.	Replace the spark plug.
	There is water in the fuel or the fuel is too old.	Empty the fuel tank and carburetor. Fill the fuel tank with fresh, clean gasoline.
	There is vapor locked in the fuel line.	Make sure that all the fuel line is below the outlet of the fuel tank. The fuel line should run continuously down from fuel tank to carburetor.
	Other causes.	Inspect the starting procedures carefully in this manual.
Decreased power	The fuel switch (if so equipped) is in CLOSE (OFF) position.	Turn the fuel switch to OPEN(ON) position.
	The spark plug wire is not connected.	Connect the wire to the spark plug.
	The product throws too much snow.	Decrease the speed and the width of the swath.
	The fuel tank cap is covered with ice or snow.	Remove the ice and the snow on and around the fuel tank cap.
	The muffler is dirty or clogged.	Clean or replace the muffler.
	Improper cable length.	Adjust the cable.
	The muffler is blocked.	Make sure that the engine is cool. Clear the blockage.
	The air intake of the carburetor is blocked.	Make sure that the engine is cool. Clear the blockage.

TROUBLESHOOTING

The engine idles or runs roughly	The choke is in ON (FULL, OPEN) position.	Move the choke to OFF (CLOSE) position.
	The fuel line is blocked.	Clean the fuel line.
	There is water in the fuel or the fuel is too old.	Empty the fuel tank and carburetor.
		Fill the fuel tank with fresh, clean gasoline.
	The carburetor needs to be replaced.	Contact an authorized service center.
Excessive vibration / Handle movement	The belt is stretched.	Replace the auger v-belt.
	Some parts are loose. The augers are damaged.	Tighten all fasteners. Replace the damaged parts. If vibration remains, contact an authorized service center.
	The handles are not positioned correctly.	Make sure that the handles are locked into position.
The recoil start handle is hard to pull	The adjustment lever nuts are loose.	Tighten the nuts until the handle feels safe.
	The recoil start handle is frozen.	Slowly pull out as much rope out of the starter as possible and release the recoil start handle. If the engine does not start, repeat the procedure or use the electrical starter.
Loss of traction drive/ slowing of drive speed Loss of snow discharge or slowing of snow discharge	The rope is interfering with components.	The recoil rope should not touch any wires or hoses.
	The belt slips.	Adjust the cable. Adjust the belt.
	The belt is worn.	Check / replace the belt.
	The belt is off the pulley.	Check / reinstall the belt.
	The chute deflector is clogged.	Clean the chute deflector.
	Foreign objects clog the augers.	Remove the debris or the foreign object from the augers.
	The shear pin is broken.	Replace the broken shear pin.
	Excessive snow and ice build up in between track components track components.	Remove snow and ice build up from in between track components.
Failure of auger rotation after the grip is released	The friction drive wheel is worn.	Contact an authorized service center.
	The drive belt is not aligned.	Adjust the drive belt.
The lights are not on (if so equipped)	The discharge deflector is not aligned.	Adjust the discharge deflector.
	The engine is not running.	Start the engine.
	The wire connection is loose.	The wire connection is loose.
	The LED is burnt out.	Replace the LED light module. Individual LEDs can not be replaced.

TROUBLESHOOTING

The chute rotator is difficult to move	There is debris in the chute rotator mechanism.	Clean the internal parts of the chute rotator mechanism.
	The cables are kinked or damaged.	Make sure that the cables are not kinked. Replace the cables that are damaged.
The product turns to one side	The tire pressure is not equal.	Adjust the tire pressure and fill the tire.
	The product drives with only one wheel.	Inspect the tire lock pin.
	Uneven sled adjustment.	Adjust the skid plates and the sledge.
	Uneven skid plates adjustment.	Adjust the skid plates and the sledge.

TRANSPORTATION, STORAGE AND DISPOSAL

Transportation and storage

1. For storage and transportation of the product and fuel, make sure that there are no leaks or fumes. Sparks or open flames, for example from electrical devices or boilers, can start a fire.
2. Always use approved containers for storage and transportation of fuel.
3. Empty the fuel tank before you put the product in storage for a long period of time. Discard the fuel at an applicable disposal location.
4. Safely attach the product during transportation to prevent damage and accidents.
5. Keep the product in a locked area to prevent access for children or persons that are not approved.
6. Keep the product in a dry and frost free area.

Disposal

1. Obey the local recycling requirements and applicable regulations.
2. Discard all chemicals, such as engine oil or fuel, at a service center or at an applicable disposal location.
3. When the product is no longer in use, discard it at a recycling location.

WARRANTY

USA WARRANTY

Product Warranty

Please keep your original purchase receipt in a safe place as proof of purchase. Warranty coverage for this product must be verified by the original purchase receipt. The warranty period begins on the day the product was purchased from an authorized retailer of Yard Force products. Warranty coverage only applies to the original purchaser and is not transferable.

Warranty coverage is only provided on products purchased from authorized Yard Force retailers.

Warranty only applies to products purchased and OPERATED in the USA. Any product purchased or operated outside of the USA is not covered by any warranty.

(2) Two-Year Limited Warranty

The snow blower has a 2-Year Limited Warranty from the date of purchase against manufacturer defects for residential use only. Commercial use voids the warranty. This warranty does not cover accidental damage, unreasonable use, normal wear and tear, neglect or non-compliance with the Operating, Safety and Maintenance Instructions. All service, outside of normal maintenance as described in this manual, must be done by an authorized service technician. Any unauthorized service or changes to the original configuration of this product will void the warranty. All parts and accessories used on and with this product must be manufactured and or authorized by Merotec Inc.

(90) Ninety-Day Warranty – Components

The accessories included with the snow blower including the auger, belt and other similar parts are warranted against manufacturer defects for residential use only for a period of 90 days from date of purchase.

Warranty does not cover loss of use or other consequential damages arising from any of the above, nor does it cover repairs made or attempted by unauthorized persons.

This warranty is void if the product is used for commercial, rental or industrial purposes.

Certain parts, attachments and accessories are subject to normal wear and tear and are excluded from the warranty.

Service and Warranty Claims Process

Contact the Yard Force Support Center toll-free at **(866) 902-9690 Monday-Friday between 8:30 AM and 5:00 PM Eastern Time** for service and warranty support.

Yard Force Service Support agents can help you troubleshoot problems over the phone to get you back up and running as quickly as possible. In the situation where service or warranty inspection is needed, please follow these steps:

1. Call Yard Force at **(866) 902-9690 Monday-Friday between 8:30 AM and 5:00 PM Eastern Time**.
2. Send in proof-of-purchase and serial number (if applicable) to confirm warranty Coverage as directed by Yard Force.
3. If service or a warranty evaluation is requested, Yard Force will provide an RGA number that should be used in all communications with Yard Force and is required to be indicated on the product itself and on the outside of the box.
4. All shipments to Yard Force must have an RGA number. Any shipment received that does not have an RGA number clearly marked on the outside of the box will be refused.
5. All shipments must be sent pre-paid, Yard Force does not pay for any shipping costs for service or warranty evaluation. Yard Force is not responsible for any packages that are lost by carrier. We recommend that shipments are made by a carrier that provides tracking and delcert confirmation

For more information or to ask questions, please call toll-free **(866) 902-9690 Monday-Friday between 8:30 AM and 5:00 PM Eastern Time**.

SAVE THESE INSTRUCTIONS

WARRANTY

CANADA WARRANTY

Product Warranty

Please keep your original purchase receipt in a safe place as proof of purchase. Warranty coverage for this product must be verified by the original purchase receipt. The warranty period begins on the day the product was purchased from an authorized retailer of Yard Force products. Warranty coverage only applies to the original purchaser and is not transferable.

Warranty coverage is only provided on products purchased from authorized Yard Force retailers.

Warranty only applies to products purchased and OPERATED in the Canada. Any product purchased or operated outside of the Canada is not covered by any warranty.

(2) Two-Year Limited Warranty

The snow blower has a 2-Year Limited Warranty from the date of purchase against manufacturer defects for residential use only. Commercial use voids the warranty. This warranty does not cover accidental damage, unreasonable use, normal wear and tear, neglect or non-compliance with the Operating, Safety and Maintenance Instructions. All service, outside of normal maintenance as described in this manual, must be done by an authorized service technician. Any unauthorized service or changes to the original configuration of this product will void the warranty. All parts and accessories used on and with this product must be manufactured and or authorized by Merotec Inc.

(90) Ninety-Day Warranty – Components

The accessories included with the snow blower including the auger, belt and other similar parts are warranted against manufacturer defects for residential use only for a period of 90 days from date of purchase.

Warranty does not cover loss of use or other consequential damages arising from any of the above, nor does it cover repairs made or attempted by unauthorized persons.

This warranty is void if the product is used for commercial, rental or industrial purposes.

Certain parts, attachments and accessories are subject to normal wear and tear and are excluded from the warranty.

Service and Warranty Claims Process

Contact the Yard Force Support Center toll-free at **1-833-818-4111 Monday-Friday between 9:00 AM and 5:00 PM Eastern Time** for service and warranty support.

Yard Force Service Support agents can help you troubleshoot problems over the phone to get you back up and running as quickly as possible. In the situation where service or warranty inspection is needed, please follow these steps:

1. Call Yard Force at **1-833-818-4111 Monday-Friday between 9:00 AM and 5:00 PM Eastern Time**.
2. Send in proof-of-purchase and serial number (if applicable) to confirm warranty Coverage as directed by Yard Force.
3. If service or a warranty evaluation is requested, Yard Force will provide an RGA number that should be used in all communications with Yard Force and is required to be indicated on the product itself and on the outside of the box.
4. All shipments to Yard Force must have an RGA number. Any shipment received that does not have an RGA number clearly marked on the outside of the box will be refused.
5. All shipments must be sent pre-paid, Yard Force does not pay for any shipping costs for service or warranty evaluation. Yard Force is not responsible for any packages that are lost by carrier. We recommend that shipments are made by a carrier that provides tracking and delcert confirmation.

For more information or to ask questions, please call toll-free **1-833-818-4111 Monday-Friday between 9:00 AM and 5:00 PM Eastern Time**.

SAVE THESE INSTRUCTIONS



Need Help?

Please do not return the product to your place of purchase yet. We're here to help and take care of all your needs.

Contact our customer service department for help with:

- Product assembly or use
- Missing or damaged parts
- Troubleshooting
- Replacement parts and accessories

You can submit a support request by scanning the QR code on this page, or by visiting:
www.YardForceUSA.com/contact-support

Scan Code to connect with Yard Force Support



1-866-902-9690 (US)
1-833-818-4111 (CA)



www.YardForceUSA.com
YardForceCA.com

Register your product today to maintain warranty coverage and stay up to date with information on the use, care, maintenance and service of your product.

Register online today at:

www.yardforceusa.com/product-registration

Yard Force Power Equipment Inc.
3655 Kennesaw North Industrial Parkway,
Kennesaw, GA 30144

© 2025 Yard Force Power Equipment