

CERTIFIED®

model number 399-8640-0

2X20 V CORDLESS LAWN MOWER

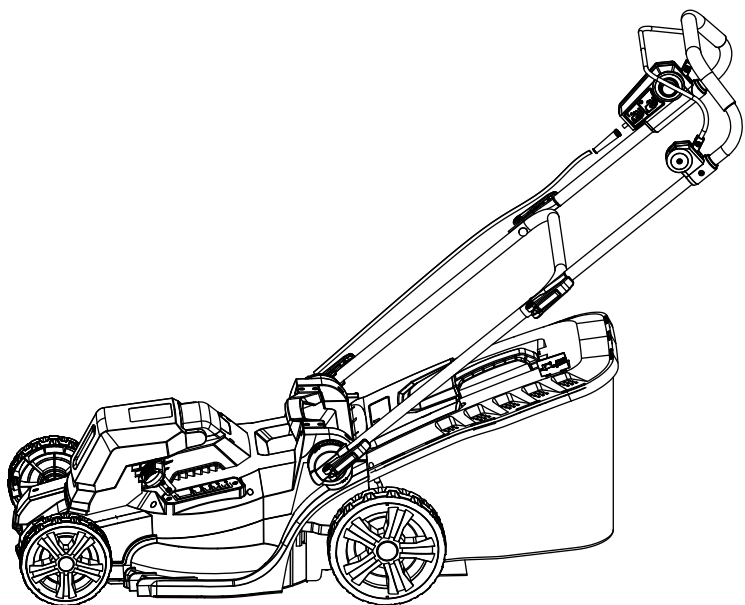

IMPORTANT:

Please read this manual carefully before running this product and save it for reference.

SAFETY AND OPERATING MANUAL

model number 399-8640-0



For problems or questions, **DO**
NOT RETURN TO STORE. Please
contact one of our Customer
Service Agents who would be
happy to assist you.

For customer assistance please call:



CANADA: 1-844-428-7277



Read and understand this instruction manual thoroughly before using the product. It contains important information for your safety as well as operating and maintenance advice.

Keep this instruction manual for future use. Should this product be passed on to a third party, this instruction manual must be included.



model number 399-8640-0

TABLE OF CONTENTS

PRODUCT SAFETY	5
For all lawn mowers	5
For all battery-operated gardening appliances	5
Safety warnings for battery pack	6
Safety instructions for walk-behind mowers	7
Safe operation practices for walk-behind mowers	9
Information for radiated emission	10
SYMBOLS	12
COMPONENT LIST	13
TECHNICAL DATA	14
ACCESSORIES	15
ASSEMBLY	16
Handle assembly	16
Grass catcher assembly	18
Charging the battery pack	18
Checking the battery charge condition	18
Attaching the battery packs	19
Releasing the battery packs	19
OPERATION	20
Handle height adjustment	20
Cutting height adjustment	20
Grass catcher indicator	21
Empty the grass catcher	21
Starting/stopping	22
General operation	22
Mowing tips	23
MAINTENANCE	24
Troubleshooting	27
EXPLODED VIEW	28
PARTS LIST	29
WARRANTY	33

SAVE THESE INSTRUCTIONS

This manual contains important safety and operating instructions. Read all instructions and follow them with use of this product.

FOR ALL LAWN MOWERS

1. Avoid dangerous environments — Don't use lawn mowers in damp or wet locations.
2. Don't use in rain.
3. Keep children away — All visitors should be kept a safe distance from work area.
4. Dress properly — Do not wear loose clothing or jewellery. They can be caught in moving parts. Use of rubber gloves and footwear is recommended when working outdoors.
5. Use safety glasses — Additionally, always use face or dust mask if operation is dusty.
6. Use right appliance — Do not use lawn mower for any job except that for which it is intended.
7. Don't force the lawn mower — It will do the job better and safer at the rate for which it was designed.
8. Don't overreach — Keep proper footing and balance at all times.
9. Stay alert — Watch what you are doing. Use common sense. Do not operate lawn mower when you are tired.
10. Store idle lawn mower indoors — When not in use, lawn mower should be stored in an indoor, dry and locked-up place — out of reach of children.

11. Maintain lawn mower with care — Keep cutting edges sharp and clean for best and safest performance. Follow instructions for lubricating and changing accessories. Keep handles dry, clean, and free from oil and grease.
12. Keep guards in place and in working order.
13. Keep blades sharp.
14. Keep hands and feet away from cutting area.
15. Objects struck by the lawn mower blade can cause severe injuries to persons. The lawn should always be carefully examined and cleared of all objects prior to each mowing.
16. If lawn mower strikes a foreign object, follow these steps:
 - i) Stop lawn mower. Release the switch.
 - ii) Remove battery pack.
 - iii) Inspect for damage.
 - iv) Repair any damage before restarting and operating the lawn mower.
17. Use identical replacement blades only.

FOR ALL BATTERY-OPERATED GARDENING APPLIANCES

1. Prevent unintentional starting. Ensure the switch is in the

READ ALL INSTRUCTIONS

WARNING! When using lawn mowers, basic safety precautions should always be followed to reduce the risk of fire, electric shock, and personal injury, including the following:

WARNING: Risk of injury could occur if the lawn mower is operated without the catcher assembly attached.

WARNING: The use of any other accessory or attachment might increase the risk of injury.

CAUTION: For battery-operated lawn mowers, use only identical replacement batteries and specific battery types recommended by the manufacturer.



- off-position before connecting to battery pack, picking up or carrying the appliance. Carrying the appliance with your finger on the switch or energizing an appliance that has the switch on invites accidents.
2. Disconnect the battery pack from the appliance before making any adjustments, changing accessories, or storing appliance. Such preventive safety measures reduce the risk of starting the appliance accidentally.
 3. Recharge only with the charger specified by the manufacturer. A charger that is suitable for one type of battery pack may create a risk of fire when used with another battery pack.
 4. Use appliances only with specifically designated battery packs. Use of any other battery packs may create a risk of injury and fire.
 5. When battery pack is not in use, keep it away from other metal objects, like paper clips, coins, keys, nails, screws or other small metal objects, that can make a connection from one terminal to another. Shorting the battery terminals together may cause burns or a fire.
 6. Under abusive conditions, liquid may be ejected from the battery; avoid contact. If contact accidentally occurs, flush with water. If liquid contacts eyes, additionally seek medical help. Liquid ejected from the battery may cause irritation or burns.
 7. Do not use a battery pack or appliance that is damaged or modified. Damaged or modified batteries may exhibit unpredictable behavior resulting in fire, explosion or risk of injury.
 8. Do not expose a battery pack or appliance to fire or excessive temperature. Exposure to fire or temperature above 266°F (130°C) may cause explosion.
 9. Follow all charging instructions and do not charge the battery pack or appliance outside of the temperature range specified in the instructions. Charging improperly or at temperatures outside of the specified range may damage the battery and increase the risk of fire.
 10. Have servicing performed by a qualified repair person using only identical replacement parts. This will ensure that the safety of the product is maintained.
 11. Do not modify or attempt to repair the appliance or the battery pack (as applicable) except as indicated in the instructions for use and care.

SAFETY WARNINGS FOR BATTERY PACK

1. Do not dismantle, open or shred battery pack.
2. Do not expose battery pack to heat or fire. Avoid storage in direct sunlight.
3. Do not short-circuit a battery pack. Do not store battery packs haphazardly in a box or drawer where they may short-circuit each

other or be short-circuited by other metal objects. When battery pack is not in use, keep it away from other metal objects, like paper clips, coins, keys, nails, screws or other small metal objects, that can make a connection from one terminal to another. Shorting the battery terminals together may cause burns or fire.

4. Do not subject battery pack to mechanical shock.
5. In the event of battery leaking, do not allow the liquid to come in contact with the skin or eyes. If contact has been made, wash the affected area with copious amounts of water and seek medical advice.
6. Do not use any battery pack which is not designed for use with the equipment.
7. Keep battery pack out of the reach of children.
8. Always purchase the battery pack recommended by the device manufacturer for the equipment.
9. Keep battery pack clean and dry.
10. Wipe the battery pack terminals with a clean, dry cloth if they become dirty.
11. Battery pack needs to be charged before use. Always use the correct charger and refer to the manufacturer's instructions or equipment manual for proper charging instructions.
12. Do not leave battery pack on prolonged charge when not in use.
13. After extended periods of storage, it may be necessary to charge and discharge the battery pack several times to obtain maximum performance.
14. Recharge only with the charger specified by manufacturer. Do not

use any charger other than that specifically provided for use with the equipment.

15. Retain the original product literature for future reference.
16. Use only the battery pack in the application for which it was intended.
17. Remove the battery pack from the equipment when not in use.
18. Dispose of properly.
19. Do not mix cells of different manufacture, capacity, size or type within a device.
20. Keep the battery away from microwaves and high pressure.

SAFETY INSTRUCTIONS FOR WALK-BEHIND MOWERS IMPORTANT

I. GENERAL OPERATION

1. Read, understand, and follow all instructions on the machine and in the manual(s) before starting.
2. Do not put hands or feet near or under the machine. Keep clear of the discharge opening at all times.
3. Only allow responsible adults, who are familiar with the instructions, to operate this machine.
4. Clear the area of objects such as rocks, wire, toys, etc., which could be thrown by the blade. Stay behind the handle when the motor is running.
5. Be sure the area is clear of bystanders before operating. Stop machine if anyone enters the area.
6. Do not operate machine barefooted or while wearing sandals. Always

model number 399-8640-0

PRODUCT SAFETY

wear substantial footwear.

7. Do not pull machine backward unless absolutely necessary. Always look down and behind before and while moving backward.
8. Never direct discharged material toward anyone. Avoid discharging material against a wall or obstruction. Material may ricochet back toward the operator. Stop the blade when crossing gravel surfaces.
9. Do not operate machine without the entire grass catcher, discharge guard, rear guard, or other safety protective devices in place and working.
10. Never leave a running machine unattended.
11. Stop the motor and wait until the blade comes to a complete stop before cleaning the machine, removing grass catcher, or unclogging the discharge guard.
12. Operate machine only in daylight or good artificial light.
13. Do not operate machine while under the influence of alcohol or drugs.
14. Never operate mower in wet grass. Always be sure of your footing; walk, never run.
15. Disengage the drive system, if so equipped, before starting the motor.
16. If the machine should start to vibrate abnormally, stop the motor and check for the cause immediately. Vibration is generally a warning of trouble.
17. Always wear eye protection when operating machine.

18. See manufacturer's instructions for proper operation and installation of accessories. Only use accessories approved by the manufacturer.

II. SLOPE OPERATION

Slopes are a major factor related to slip and fall accidents, which can result in severe injury. Operation on all slopes requires extra caution. If you feel uneasy on a slope, do not mow it.

1. Mow across the face of slopes; never up and down. Exercise extreme caution when changing direction on slopes.
2. Watch for holes, ruts, bumps, rocks, or other hidden objects. Uneven terrain could cause a slip and fall accident. Tall grass can hide obstacles.
3. Do not mow on wet grass or excessively steep slopes. Poor footing could cause a slip and fall accident.
4. Do not mow near drop-offs, ditches, or embankments. You could lose your footing or balance.

III. CHILDREN

Tragic accidents can occur if the operator is not alert to the presence of children. Children are often attracted to the machine and the mowing activity. Never assume that children will remain where you last saw them.

1. Keep children out of the mowing area and under the watchful care of a responsible adult other than the operator.

2. Be alert and turn mower off if a child enters the area.
3. Never allow children to operate the machine.
4. Use extra care when approaching blind corners, shrubs, trees, or other objects that may block your view of a child.

IV. SERVICE

1. Keep all nuts and bolts tight to be sure the equipment is in safe working condition.
2. Never tamper with safety devices. Check their proper operation regularly.
3. Keep machine free of grass, leaves, or other debris build-up.
4. If you strike a foreign object, stop and inspect the machine. Repair, if necessary, before starting.
5. Never make any adjustments or repairs with the motor running.
6. Always unplug electric mowers before adjusting, cleaning, or repairing.
7. Check grass catcher components and the discharge guard frequently and replace with manufacturer's recommended parts when necessary.
8. Mower blades are sharp. Wrap the blade or wear gloves, and use extra caution when servicing them.
9. Maintain or replace safety and instruction labels, as necessary.

SAFE OPERATION PRACTICES FOR WALK-BEHIND MOWERS

I. TRAINING

1. Read the operating and service instruction manual carefully. Be thoroughly familiar with the controls and the proper use of the equipment.
2. Never allow children to operate a power mower.
3. Keep the area of operation clear of all persons, particularly small children, and pets.
4. Do not use a mower for any job except that for which it is intended.

II. PREPARATION

1. Thoroughly inspect the area where the equipment is to be used and remove all stones, sticks, wires, bones, and other foreign objects.
2. Do not operate the equipment when barefoot or wearing sandals. Always wear substantial footwear.
3. Disengage the self-propelled mechanism or drive clutch on units so equipped before starting the motor.
4. Never attempt to make a wheel height adjustment while the motor is running.
5. Mow only in daylight or in good artificial light.
6. Never operate the equipment on wet grass. Always be sure of your footing. Keep a firm hold on the handle, and walk, never run.

III. OPERATION

1. Do not put hands or feet near or under rotating parts. Keep clear of the discharge opening at all times.
2. Stop the blade(s) when crossing gravel drives, walks, or roads.
3. After striking a foreign object, stop the motor, unplug, thoroughly inspect the mower for any damage, and repair the damage before restarting and operating the mower.
4. If the equipment should start to vibrate abnormally, stop the motor and check immediately for the cause. Vibration is generally a warning of trouble.
5. Stop the motor and unplug whenever you leave the equipment, before cleaning the mower housing, and before making any repairs or inspections.
6. Shut the motor off and wait until the blade comes to a complete stop before removing the grass catcher or before unclogging the chute.
7. Mow across the face of slopes, never up and down. Exercise extreme caution when changing direction on slopes. Do not mow excessively steep slopes.
8. Never operate the mower without proper guards, plates, or other safety protective devices in place.
9. Do not wash with a hose; avoid getting water in motor and electrical connections.
2. Keep all nuts, bolts, and screws tight to be sure the equipment is in safe working condition.
3. Check bag frequently for deterioration and wear, and replace worn bags. Check that replacement bags comply with the original manufacturer's recommendations or specifications.
4. Replace the blade if it is bent or cracked. An unbalanced blade causes vibration that could damage the motor drive unit or cause personal injury.
5. Sharpen a dull blade equally at each end to maintain the balance.
6. Clean the blade thoroughly and check its balance by supporting it horizontally on a thin nail through its centre hole. The nail should also be in a horizontal position. If either end of the blade rotates downward, remove some metal from the heavy or lower end until the blade is balanced. It is balanced when neither end drops.

INFORMATION FOR RADIATED EMISSION

This device complies with Canadian ICES-001.

This device complies with Part 15 of the FCC Rules.

Operation is subject to the following two conditions:

- (1) This device may not cause harmful interference; and
- (2) This device must accept any interference received, including interference that may cause

IV. MAINTENANCE

1. Check the blade and the motor mounting bolts at frequent intervals for proper tightness.

undesired operation.

! **WARNING:** Changes or modifications to this unit not expressly approved by the party responsible for compliance could void the user's authority to operate the equipment.

NOTE: This equipment has been tested and found to comply with the limits for a Class B digital device, pursuant to Part 15 of the FCC Rules.

These limits are designed to provide reasonable protection against harmful interference in a residential installation. This equipment generates, uses and can radiate radio frequency energy and, if not installed and used in accordance with the instructions, may cause harmful interference to radio communications.

However, there is no guarantee that interference will not occur in a particular installation. If this equipment does cause harmful interference to radio or television reception, which can be determined by turning the equipment off and on, the user is encouraged to try to correct the interference by one or more of the following measures:

- Reorient or relocate the receiving antenna.
- Increase the separation between the equipment and receiver.
- Connect the equipment into an outlet on a circuit different from that to which the receiver is connected.
- Consult the dealer or an experienced radio/TV technician for help.

FCC Part 15

Supplier's Declaration of Conformity

Product Description: Charger

Model Number: ACG1820W2U

Trade Name: CERTIFIED®

This device complies with part 15 of the FCC Rules.

Operation is subject to the following two conditions:

- This device may not cause harmful interference; and
- This device must accept any interference received, including interference that may cause undesired operation.

Responsible Party:

Positec USA, Inc.

929 Jay St. Suite 200, Charlotte, NC 28208

Tel.: (704) 599-3711

Fax: (704) 599-6390

SAVE THESE INSTRUCTIONS

model number 399-8640-0

SYMBOLS



Warning



To reduce the risk of injury, user must read instruction manual



CPSC Danger label



Severing of toes or fingers—rotary mower blade



Thrown objects from mower deck



Keep bystanders/children away



Slip on slope



Read the operator's manual



Look behind while backing



Li-ion

Lithium-ion battery; battery must be recycled



Do not burn



Batteries may enter water cycle if disposed improperly, which can be hazardous for ecosystem. Do not dispose of waste batteries as unsorted municipal waste.

**call2recycle**

Certified[®] Inc. has established a partnership with the RBRC Corporation to recycle any Certified[®] batteries with the RBRC-call2recycle seal. For environmental protection, please do not discard batteries in the trash. After the batteries' life cycle has ended, please call 1-800-822-8837 for a free service that will properly dispose of the battery.

1. Grip handle
2. Start lever
3. Safety switch button
4. Upper handle bar
5. Clamp lever (x4)
6. Lower handle bar
7. Grass catcher
- 7a. Grass catcher carry handle
- 7b. Grass catcher hatch
8. Deflector guard
9. Rear wheel
10. Transport handle
11. Lever for cutting height adjustment
12. Cutting blade compartment
13. Front wheel
14. Battery cover
15. Safety key
16. Inter-connection cord
17. Charger
18. Battery pack release button
19. Battery pack
20. Mulch insert

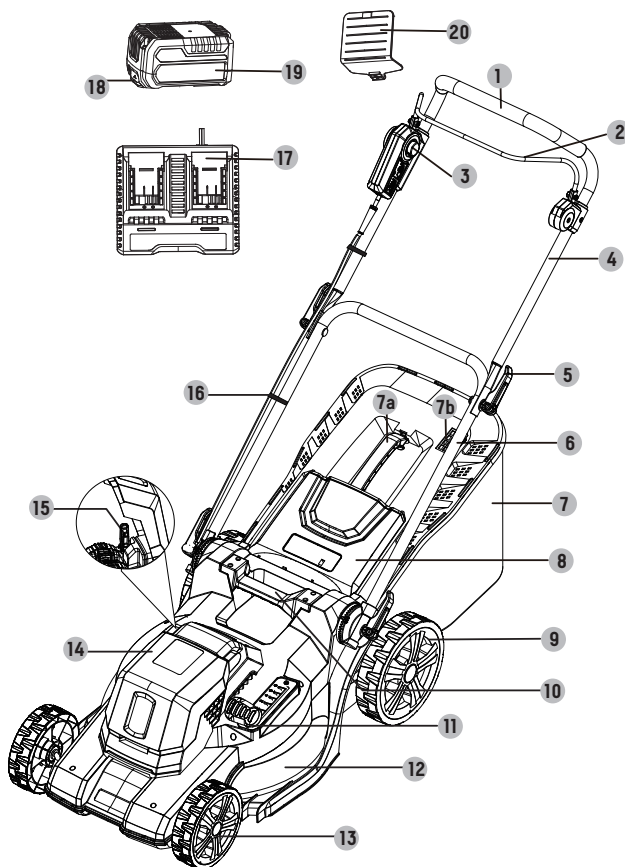

model number 399-8640-0

Rated voltage	2*20 V \equiv Max.*
No load speed	2900 /min
Deck size	18" (45.5 cm)
Cutting width	17" (43 cm)
Cutting height range	25 – 70 mm
Collection capacity	45 L
Cutting height positions	6 levels
Front wheel diameter	7" (17.5 cm)
Rear wheel diameter	9" (23 cm)
Battery capacity (ABP1840HWU)	4.0 Ah
Charger input (ACG1820W2U)	120V~, 60 Hz
Charger output (ACG1820W2U)	20V \equiv , 2.0A
Charging time	2 hr (4.0 Ah x 1) 4 hr (4.0 Ah x 2)
Protection class	 /II
Machine weight	31 lb (14.15 kg)

*Voltage measured without workload. Initial battery voltage reaches maximum of 2*20 volts. Nominal voltage is 2*18 volts.

Charger	1
Battery pack	2
Grass collection bag	1
Mulch insert	1

We recommend that you purchase your accessories from the same store that sold you this product. Refer to the accessory packaging for further details. Store personnel can assist you and offer advice.

model number 399-8640-0

OPERATION INSTRUCTION



NOTE: Before using this product, read the instruction book carefully.

INTENDED USE

This product is intended for domestic lawn mowing.

ASSEMBLY

1. HANDLE ASSEMBLY

The lower handle bars are pre-installed on the transport handle.

- 1) Unfold and loosen the clamp levers counter-clockwise on the lower handle bars, but do not remove them (Fig. A1, step 1).
- 2) Grasp the lower handle bars and unfold them from storage position to work position (Fig. A1, step 2).
- 3) Secure the lower handle bars by folding up the clamp levers towards the lower handle bars. If the clamp lever cannot be folded, loosen it and fold again. If it is too loose, tighten it by turning the clamp lever clockwise (Fig. A2).

NOTE: For first assembly, secure the lower handle bars with the clamp levers in the middle position of the tilt adjustment mechanism by aligning the indication line (a) with the indicator (b) of the transport handle. Ensure the lower handle bars are assembled on the same height level on both side.

- 4) Hold the upper handle bar with the start lever facing upwards. Align the mounting holes of the upper handle bar and the lower handle bars (Fig. A3, step 1).
- 5) Pass the mounting bolt through the mounting holes to the end (Fig. A3, step 2).
- 6) Attach the washer and screw in the clamp lever clockwise through the thread of the mounting bolt, lock it by folding up the clamp lever towards the handle. If clamp lever cannot be folded, loosen it and fold again. If it is too loose, tighten it by swinging the clamp lever (Fig. A3, step 3).
- 7) Repeat these instructions for the other side. Make sure that the inter-connection cord runs on the upper side of the handle bars.
- 8) Secure the inter-connection cord with two wire clips (Fig. A4). Pull the inter-connection cord to avoid contact with the rear wheel if necessary.



WARNING: The mower must be fully assembled before operation! Do not use a product that is only partly assembled or assembled with damaged parts!

WARNING: Do not connect the product to battery packs before it is completely assembled!



WARNING: Make sure the clamp levers are properly tightened before using the mower.

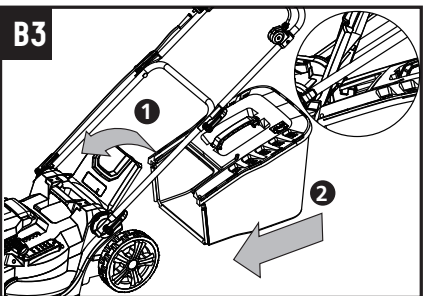
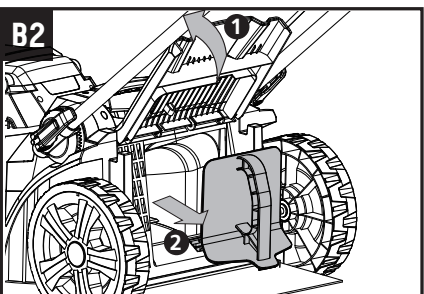
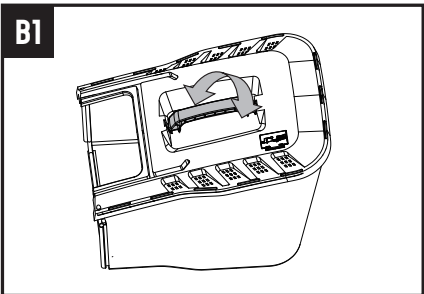
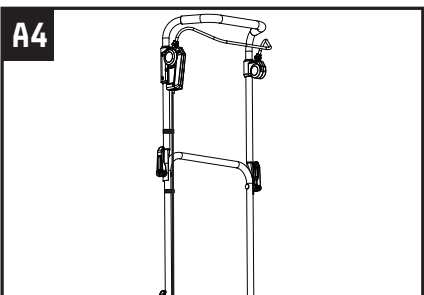
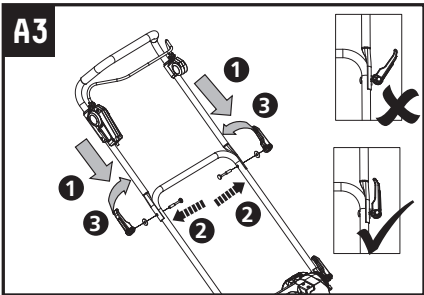
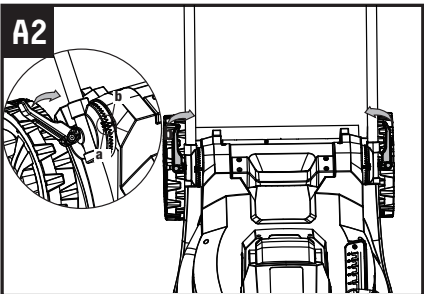
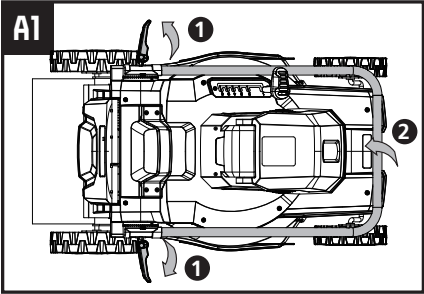

2. GRASS CATCHER ASSEMBLY

- 1) The carry handle is already preassembled on the top cover and its position is rotatable to fit the intended use (Fig. B1).
- 2) Raise the deflector guard and hold it up; remove the mulch insert if it is in the rear chute (Fig. B2).
- 3) Carry the grass catcher by its carry handle.
- 4) Align the support with the hooks and hang the grass catcher onto it (Fig. B3).
- 5) Carefully release the deflector guard afterwards.



3. CHARGING THE BATTERY PACK

- 1) Do not use any charger other than that specifically provided for use with the equipment.
- 2) If the battery pack is very hot you must remove your battery pack from the charger and allow time for the battery to cool down before recharging.
- 3) The battery in your new tool is not charged when it leaves the plant; therefore, it must be full charged before using the first time.
- 4) Please charge the battery to reach full or no less than half charge before storage. If the tool will not be used for long periods of time, charge the battery every 3-6 months.

CHARGING PROCEDURE (SEE FIG. C1)

- 1) Plug the charger into an appropriate outlet. The light (c) will be green.
- 2) Slide the battery pack into the charger; the light will turn red to indicate the charging process has started.
- 3) When charging is completed, the light will turn green. The pack is now fully charged; unplug the charger and remove the battery pack.

CHARGING INDICATOR

Light	Status
Red on ● 	Charging
Green on ● 	Fully Charged

4. CHECKING THE BATTERY CHARGE CONDITION (SEE FIG. C2)

The battery level can be determined from the battery indicator light by pressing the button beside the lights.

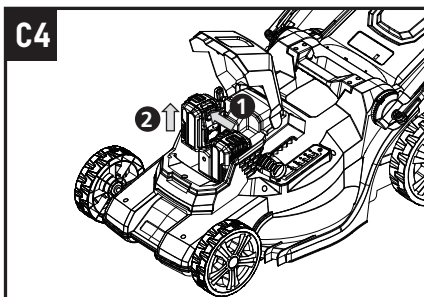
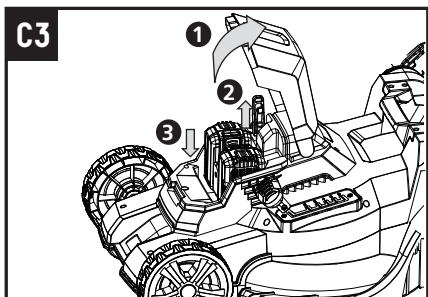
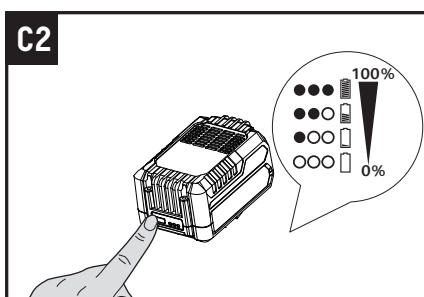
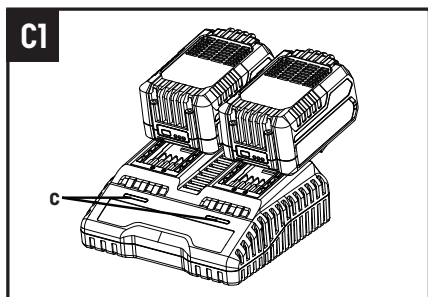

5. ATTACHING THE BATTERY PACKS (SEE FIG. C3)

- 1) Hold the groove and open the battery cover (Fig. C3, step 1).
- 2) Remove the safety key and keep it avoid loss (Fig. C3, step 2).
- 3) Slide the battery packs into the slot until it snaps in place with a click (Fig. C3, step 3).
- 4) The battery packs can only be installed in one direction.
- 5) Reinstall safety key to its slot.
- 6) Close the battery cover.

6. RELEASING THE BATTERY PACKS (SEE FIG. C4)

The battery packs can't be charged whilst in the mower. Remove the battery packs from its battery compartment for charging.

- 1) Hold the groove and open the battery cover.
- 2) Press down the release button to unlock the latch of battery pack (Fig. C4, step 1).
- 3) Slide out the battery packs from the battery compartment (Fig. C4, step 2).
- 4) Close the battery cover.

1. HANDLE HEIGHT ADJUSTMENT (SEE FIG. D1, D2)

Adjust the lower handle bars to a suitable height according to your needs. There are three handle heights to choose.

- 1) Unfold and loosen the clamp levers counter-clockwise on both sides of the lower handle bars, but do not remove them (Fig. D1, step 1).
- 2) Hold and swing the handle assembly gently to the desired position by aligning the indication line with the indicator of transport handle. Ensure the handle assembly is assembled on the same height level on both side (Fig. D2, step 2).
- 3) Secure the handle assembly by folding up the clamp lever towards the transport handle. If clamp lever cannot be folded, loosen it and fold again. If it is too loose, tighten it by turning the clamp lever clockwise (Fig. D2, step 3).

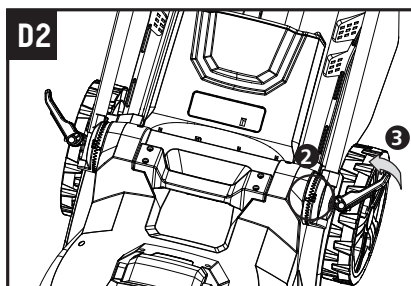
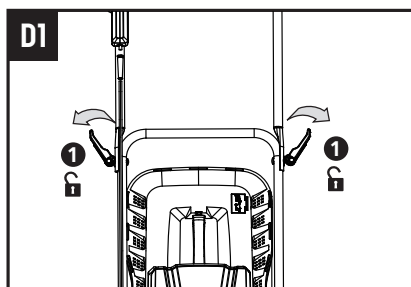
**2. CUTTING HEIGHT ADJUSTMENT (SEE FIG. E)**

Adjust the cutting height according to the needs of your lawn. The cutting height depends on the kind of lawn and its actual height. When mowing high grass, start with the maximum cutting height and make a second cut with a lower cutting height.

- 1) Pull the lever outward to release the lever (Fig. E, step 1).
- 2) Move forward or backward to adjust the cutting height (Fig. E, step 2).
- 3) Release the lever and ensure it engages in the slot properly (Fig. E, step 3).



WARNING! Switch the mower off and wait until the cutting blade has come to a complete stop before adjusting the handle height!
Remove the safety key before adjusting the handle height!
To ensure safe operation, the height adjustment of the handle bar is limited to the indicated positions! Do not attempt to adjust any other height!



WARNING! Ensure that the lever engages in the slot after each adjustment.

3. GRASS CATCHER INDICATOR (SEE FIG. F)

Attach the grass catcher. Always carry the grass catcher by its carry handle. The grass catcher is equipped with a hatch that indicates the amount of clippings during operation.

- 1) When the hatch is opened the grass catcher has sufficient volume left to collect grass.
- 2) When the hatch is closed, the grass catcher is full and must be emptied.

4. EMPTY THE GRASS CATCHER

Empty the grass catcher frequently during use. Do not wait until it is completely full. We recommend emptying it when it is half full.

- 1) Switch the mower off and make sure that the motor has stopped and the blade has stopped rotating.
- 2) Lift the deflector guard and lift the grass catcher off the hooks.
- 3) Remove the grass clippings from the rear discharge chute into the grass catcher. Use a proper tool such as a brush.
- 4) Remove the grass catcher by its carry handle.
- 5) Empty the grass clippings onto a compost heap.
- 6) Re-fit the grass catcher to the mower.

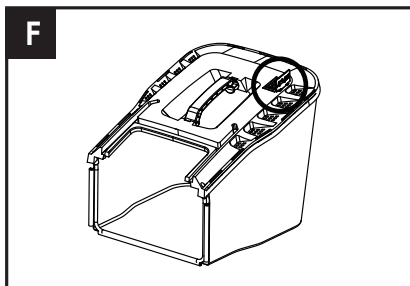
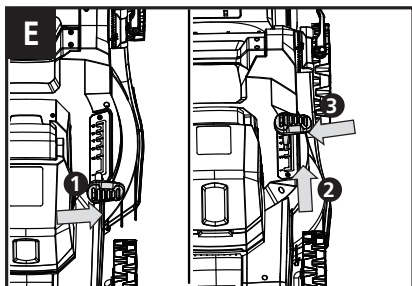

WARNING! Never use your hands or feet to remove grass clippings from the rear discharge chute!

5. STARTING/STOPPING (SEE FIG. G1, G2)

NOTE: The mower can only be started by pressing the safety switch button followed by squeezing the start lever. Reverse operation cannot start the mower.

- 1) Install the battery packs into the battery compartment (Fig. G1, step 1).
- 2) Insert the safety key into the slot fully (Fig. G1, step 2).
- 3) Stand behind the grip handle.
- 4) While holding the safety switch button pressed (Fig. G2, step 1), pull the start lever towards the grip handle (Fig. G2, step 2).
- 5) After the mower starts, release the safety switch button.
- 6) The product begins mowing.
- 7) Release the start lever to stop the mower.

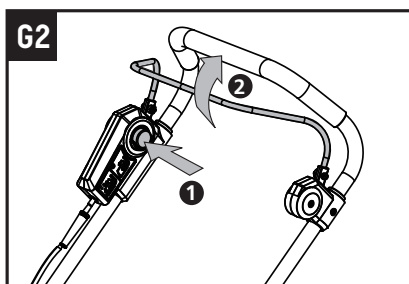
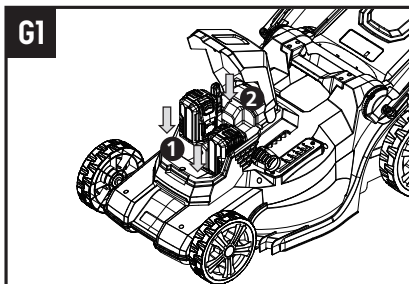
**6. GENERAL OPERATION**

- 1) Check the mower, its battery pack and charger as well as accessories for damage before each use. Do not use the mower if it is damaged or shows wear. Take care of any problem you find or have the product checked by qualified specialist.
- 2) Double check that accessories or attachments are properly fixed.
- 3) Always push the mower using the grip handle. Keep the handles dry to ensure safe operation.
- 4) Ensure that the air vents are always unobstructed and clear. Clean them if necessary with a soft brush. Blocked air vents may lead to overheating and damage the product.
- 5) Switch the mower off immediately if you are disturbed while working by other people entering the working area. Always let the mower come to complete stop before putting it down.
- 6) Do not overwork yourself. Take regular breaks to ensure you can concentrate on the work and have full control over the mower.



WARNING! Before starting, put the mower on a flat surface free of high grass! Clean the underside of the deck!
Start the motor carefully according to instructions. Keep your feet well away from the cutting blade!
Do not tilt the mower when starting the motor.

7. MOWING TIPS (Grass Catcher Mowing and Mulch Insert Mowing)

NOTE: Always inspect area where mower is to be used and remove all stones, sticks, wire, metal and other debris which might be thrown by the rotating blade.

- 1) It is recommended to mow your lawn more frequently, walk at normal pace, and not to start/stop the mower too often during operation.
- 2) For best performance, please use fully charged battery packs.
- 3) Walk slowly when cutting long grass so as to have more effective cutting and to properly discharge the clippings.
- 4) Avoid cutting wet grass; otherwise, it will stick to the underside of the deck and the clippings cannot be collected or discharged properly.
- 5) Use a higher cutting height for new or thick grass to extend battery life.
- 6) Mow across the face of slopes, never up-and-down. Exercise extreme caution when changing direction on slopes. Do not mow excessively steep slopes. Always maintain good footing.
- 7) Release start bar to turn mower OFF when crossing any gravelled area (stones can be thrown by the blade).
- 8) Set mower at highest cutting height when mowing in rough ground or in tall weeds. Removing too much grass at one time can cause circuit breaker to trip, which stops mower.
- 9) If mower should start to vibrate abnormally, release start bar to turn mower OFF. Check immediately for cause. Vibration is a warning of trouble. Do not operate mower until a service check has been made.
- 10) Mow in slight overlapping rows. The most effective pattern for mowing lawns is straight lines along one of the sides. This will keep the rows even and ensures that all the lawn is cut without missing any spots (Fig. H).
- 11) **ALWAYS RELEASE START BAR TO TURN MOWER OFF WHEN LEAVING IT UNATTENDED EVEN FOR A SHORT PERIOD OF TIME.**

Mowing with grass catcher attached (See Fig. B3)

If a grass bag is used during the fast growing season, the grass may tend to clog up at the discharge opening. Release start bar to turn mower off. Remove the grass bag and shake the grass down to the back end of the bag. Also clean out any grass or debris which may be packed around the discharge opening. Replace the grass collection bag.

NOTE: Do not attach the mulch insert when mowing with grass catcher.

Mowing with mulch insert attached (See Fig. I)

Use the mower with mulching insert instead of grass catcher attached. The lawn mower will mulch as it cuts and the fine grass clippings are distributed back onto the grass surface without leaving piles of grass clippings.



WARNING! If the mower strikes a foreign object, stop immediately! Let the mower cool down and thoroughly inspect the mower for damage! Have any damage repaired before restarting!

Extensive vibration of the mower during operation is an indication of damage! The mower should be promptly inspected and repaired!

model number 399-8640-0

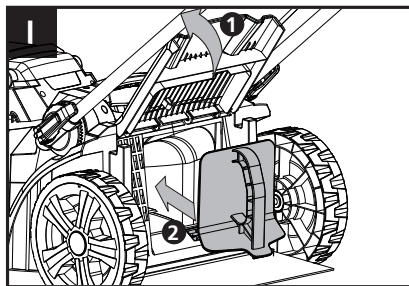
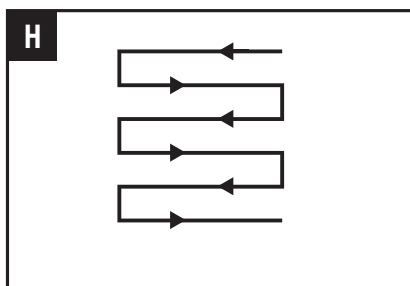

1. AFTER USE

- 1) Switch the mower off, disconnect the safety key, remove the battery pack and let it cool down.
- 2) Check, clean and store the product as described below.

2. THE GOLDEN RULES FOR CARE

- 1) Keep the mower clean. Remove debris from it after each use and before storage.
- 2) Regular and proper cleaning will help ensure safe use and prolong the life of the product.
- 3) Inspect the mower before each use for worn and damaged parts. Do not operate it if you find broken and worn parts.

3. GENERAL CLEANING

- 1) Clean the mower with a dry cloth. Use a brush for areas that are hard to reach.
- 2) Remove stubborn dust with high pressure air (max. 3 bar).

NOTE: Do not use chemical, alkaline, abrasive or other aggressive detergents or disinfectants to clean this product as they might be harmful to its surfaces.

- 3) Check for any damage and wear. Repair damages in accordance with this instruction manual or take it to an authorised service centre before using the product again.



WARNING! Always switch the mower off, remove the battery pack and safety key. Let the product cool down before performing inspection, maintenance and cleaning work!



WARNING! Only perform repairs and maintenance work according to these instructions! All further works must be performed by a qualified specialist!

4. UNDERBODY AND CUTTING BLADE

- 1) Keep the underbody and cutting blade clean and free of debris. Remove clippings from the rear discharge chute.
- 2) Check all fasteners, such as nuts and bolts, periodically for tightness before operation. After prolonged use, especially in sandy soil conditions, the cutting blade will become worn and lose some of the original shape. The cutting efficiency will be reduced and the cutting blade should be replaced.
- 3) Keep the cutting blade sharp to ensure a good cutting performance. Replace a worn or damaged cutting blade with a new one of the same type or have it sharpened by a qualified specialist.
- 4) Loosen the hex nut counter-clockwise using a suitable wrench (size 13 mm) and remove it together with the cutting blade (Fig. J1).
- 5) Replace the cutting blade with a new one of the same type. First check the status of the flange and the bushing on the spindle, then attach the cutting blade, washers and hex nut properly. Tighten the hex nut clockwise with a torque wrench to between 20 – 25 Nm to ensure safe operation of your product (Fig. J2).
- 6) Replace this cutting blade after 50 hours mowing or 2 years whichever is sooner regardless of condition. If the cutting blade is cracked or damaged, you must immediately replace it with a new one.
- 7) Lubricate the cutting blade after each use to prolong the life span of cutting blade and product. Apply light machine oil along the edge of the cutting blade.

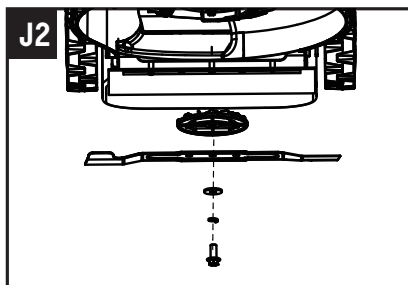
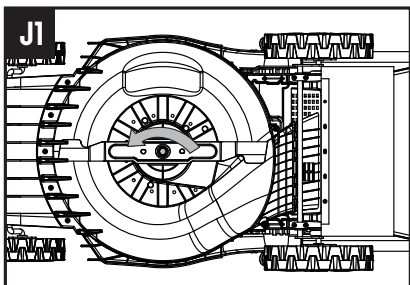

WARNING! Wear safety gloves when working on the blade or close to it! Use proper tools to remove debris, i.e., a wooden stick! Never use your bare hands!

Always use original spare parts for replacement. The cutting blade must be replaced by model no. GT2257. Do not attach any other type of cutting blade!

The replacement of the cutting blade should be done by a qualified specialist! Reworking or sharpening blades is not recommended unless it is done by a repair service or a similarly qualified specialist!

model number 399-8640-0

5. GRASS CATCHER

- 1) Inspect the grass catcher before each use. Do not use it if you find any damage.
- 2) Clean the grass catcher after operation using water and mild soap.
- 3) Let the grass catcher dry thoroughly before storing to avoid mildew.

6. INTER-CONNECTION CORD

Check the inter-connection cord before each use.

7. STORAGE

- 1) Switch the mower off, disconnect the safety key and remove the battery pack before storage.
- 2) Clean the product as described above.
- 3) Fold the handle assembly to the storage position.
- 4) Store the mower and its accessories in a dark, dry, frost-free, well-ventilated place.
- 5) Always store the product in a place that is inaccessible to children. The ideal storage temperature is between 50 and 86°F (10 and 30°C).
- 6) We recommend using the original package for storage or covering the product with a suitable cloth or enclosure to protect it against dust.

7. TRANSPORTATION

- 1) Switch the product off, disconnect the safety key and remove the battery pack before transporting it anywhere.
- 2) Attach transportation guards, if applicable.
- 3) Always transport the product by its transport handle.
- 4) Protect the product from any heavy impact or strong vibrations which may occur during transportation in vehicles.
- 5) Secure the product to prevent it from slipping or falling over which may result in damage and injury.

MAINTENANCE

Your power tool requires no additional lubrication or maintenance.

There are no user serviceable parts in your power tool. Never use water or chemical cleaners to clean your power tool. Wipe clean with a dry cloth.

Always store your power tool in a dry place. Keep the motor ventilation slots clean. Keep all working controls free of dust. Occasionally you may see sparks through the ventilation slots. This is normal and will not damage your power tool.

FOR BATTERY TOOLS

The ambient temperature range for the use and storage of tool and battery is 32 – 113°F (0 – 45°C).

The recommended ambient temperature range for the charging system during charging is 32 – 104°F (0 – 40°C).

TROUBLESHOOTING

Use this section to help you to try and solve any problems you may have.

Problem	Possible Cause	Corrective Action
1. Mower does not start	1.1 Battery packs are not properly attached 1.2 Battery packs are discharged 1.3 Battery packs are damaged 1.4 Other electrical defect to the product 1.5 Safety key not properly inserted	1.1 Attach properly 1.2 Remove and charge battery packs 1.3 Have checked by a specialist electrician 1.4 Have checked by a specialist electrician 1.5 Insert properly
2. Mower does not reach full power	2.1 Battery packs capacity too low 2.2 Air vents are blocked	2.1 Charge battery packs 2.2 Clean the air vents
3. Cutting result is unsatisfactory	3.1 Cutting blade is dull/damaged 3.2 Cutting material exceeds capacity 3.3 Cutting height is incorrect	3.1 Replace with a new one 3.2 Only cut materials according to the product capacity 3.3 Adjust the cutting height
4. Mower suddenly stops	4.1 Battery pack is discharged 4.2 Battery pack is too hot 4.3 Cutting device is blocked	4.1 Remove and charge battery pack 4.2 Remove battery pack and let it cool down 4.3 Remove blockage
5. Excessive vibration or noise	5.1 Cutting blade is dull/damaged 5.2 Cutting material exceeds capacity 5.3 Cutting height is incorrect 5.4 Bolts/nuts are loosen	5.1 Replace with a new one 5.2 Only cut materials according to the product capacity 5.3 Adjust the cutting height 5.4 Tighten bolts/nuts

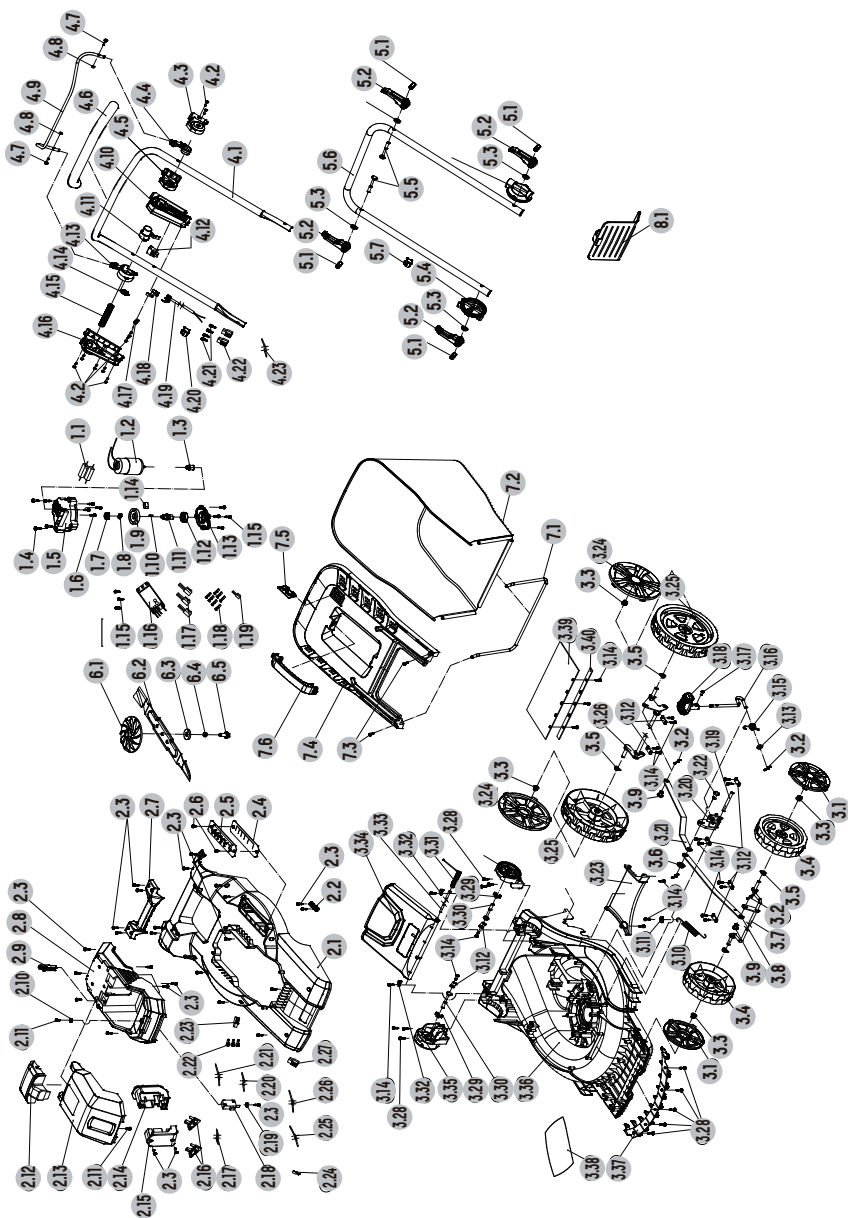

Item	Description	QTY.
1.1	Cement resistor	2
1.2	997 motor	1
1.3	Small gear	1
1.4	Cross recessed self-tapping screw	4
1.5	Reducer box - DC	1
1.6	Hexagon socket head bolt with partial threads	4
1.7	Bearing	1
1.8	Snap ring (outer)	1
1.9	Large gear	1
1.10	Flat key	1
1.11	Output shaft	1
1.12	Bearing	1
1.13	Reducer box cover	1
1.14	Wool felt	1
1.15	Cross recessed self-tapping screw	7
1.16	Controller	1
1.17	Double hole male terminal sleeve	3
1.18	Female terminal	7
1.19	Single hole male terminal sleeve	1
2.1	Upper housing	1
2.2	Cable pressing plate	1
2.3	Cross recessed self-tapping screw	28
2.4	Scale panel gasket	1
2.5	Scale panel	1
2.6	Countersunk head screw	2
2.7	Housing handle	1
2.8	Upper cover - DC	1
2.9	Security key	1
2.10	Magnet	1
2.11	Flat head screw	2
2.12	Pressing plate - DC	1
2.13	Transparent cover - DC	1
2.14	Battery pack upper bracket	1
2.15	Battery pack lower bracket	1
2.16	Blade seat	2
2.17	Internal wiring 1	1
2.18	Micro switch	1
2.19	Gasket	1
2.20	Internal wiring 3	1
2.21	Internal wiring 5	1

model number 399-8640-0

PARTS LIST

Item	Description	QTY.
2.22	Male terminal	3
2.23	Single hole female terminal sleeve	1
2.24	6.3 Direct-insert terminal	1
2.25	Internal wiring 4	1
2.26	Carbon brush wiring 1	1
2.27	Double hole female terminal sleeve	1
3.1	7" (17.8 cm) wheel cover - deepen	2
3.2	Cotter pin	4
3.3	Lock nut on the flange face	4
3.4	7" (17.8 cm) wheel - through hole	2
3.5	Wave washer	4
3.6	Gasket	1
3.7	Front wheel shaft	1
3.8	Front connecting rod	1
3.9	Connecting rod buckle - 2	2
3.10	Height adjustment tension spring	1
3.11	Gasket	1
3.12	Wheel axle pressing plate	8
3.13	Gasket	1
3.14	Cross recessed self-tapping screw	21
3.15	Adjustment rod torsion spring	1
3.16	Adjustment rod	1
3.17	Large flat head screw	1
3.18	Height adjustment handle	1
3.19	Adjustment rod rotation shaft	1
3.20	Adjustment rod base	1
3.21	Rear connecting rod	1
3.22	Connecting rod buckle - 1	1
3.23	Bottom plate	1
3.24	9" (22.9 cm) wheel cover - deepen	2
3.25	9" (22.9 cm) wheel - through hole	2
3.26	Rear wheel shaft	1
3.27	Left holder	1
3.28	Cross recessed self-tapping screw	11
3.29	Handrail fixing plate	2
3.30	Square head bolt	2
3.31	Rear cover torsion spring	1
3.32	L type pressing plate	2
3.33	Rear cover shaft	1

Item	Description	QTY.
3.34	Rear cover	1
3.35	Right holder	1
3.36	Chassis	1
3.37	Straw raker	1
3.38	Counterweight block	1
3.39	Fender apron	1
3.40	Fender apron trim strip	1
4.1	Upper push rod	1
4.2	Cross recessed self-tapping screw	9
4.3	Left auxiliary switch box	1
4.4	Auxiliary trigger	1
4.5	Right auxiliary switch box	1
4.6	Sponge sleeve	1
4.7	Cross recessed pan head screw (three-in-one combination)	2
4.8	Hexagon nut	2
4.9	Switch lever	1
4.10	Left main switch box	1
4.11	Switch unlock button	1
4.12	Double micro switch	1
4.13	Main trigger	1
4.14	Main trigger tension spring	1
4.15	Unlock button spring	1
4.16	Right main switch box	1
4.17	Cable pressing plate	1
4.18	6.3 Direct-insert terminal	3
4.19	Cable	1
4.20	Cable clip	1
4.21	Male terminal	4
4.22	Double hole female terminal sleeve	2
4.23	Internal wiring	1
5.1	Screw rod pin	4
5.2	Quick-release wrench	4
5.3	Gasket	4
5.4	Adjustment block - outer	2
5.5	Square head bolt	2
5.6	Lower push rod	1
5.7	Cable clip	1

model number 399-8640-0

PARTS LIST

Item	Description	QTY.
6.1	Blade holder	1
6.2	Blade	1
6.3	Flat gasket	1
6.4	Spring gasket	1
6.5	Outer hexagon flanged anti-skid bolt	1
7.1	Straw basket frame	1
7.2	Straw collecting bag	1
7.3	Three-in-one screw	2
7.4	Straw collecting cover	1
7.5	Sunroof cover	1
7.6	Straw basket handle	1
8.1	Plug	1

1-YEAR LIMITED WARRANTY

This CERTIFIED® product is guaranteed for a period of one (1) year from the date of original retail purchase against defects in workmanship and materials.

Subject to the conditions and limitations described below, this product, if returned to us with proof of purchase within the stated warranty period and if covered under this warranty, will be repaired or replaced (with the same model, or one of equal value or specification), at our option. We will bear the cost of any repair or replacement and any costs of labour relating thereto.

This warranty is subject to the following conditions and limitations:

- a) a bill of sale verifying the purchase and purchase date must be provided;
- b) this warranty will not apply to any product or part thereof which is worn or broken or which has become inoperative due to abuse, misuse, accidental damage, neglect or lack of proper installation, operation or maintenance (as outlined in the applicable owner's manual or operating instructions) or which is being used for industrial, professional, commercial or rental purposes;
- c) this warranty will not apply to normal wear and tear or to expendable parts or accessories that may be supplied with the product that are expected to become inoperative or unusable after a reasonable period of use;
- d) this warranty will not apply to routine maintenance and consumable items such as, but not limited to, lubricants, blades, fluids, tune-ups or adjustments;
- e) this warranty will not apply where damage is caused by repairs made or attempted by others (i.e., persons not authorized by the manufacturer);
- f) this warranty will not apply to any product that was sold to the original purchaser as a reconditioned or refurbished product (unless otherwise specified in writing);
- g) this warranty will not apply to any product or part thereof if any part from another manufacturer is installed therein or any repairs or alterations have been made or attempted by unauthorized persons;
- h) this warranty will not apply to normal deterioration of the exterior finish, such as, but not limited to, scratches, dents, paint chips, or to any corrosion or discolouring by heat, abrasive and chemical cleaners; and
- i) this warranty will not apply to component parts sold by and identified as the product of another company, which shall be covered under the product manufacturer's warranty, if any.

Additional Limitations

This warranty applies only to the original purchaser and may not be transferred. Neither the retailer nor the manufacturer shall be liable for any other expense, loss or damage, including, without limitation, any indirect, incidental, consequential or exemplary damages arising in connection with the sale, use or inability to use this product.

Notice to Consumer

This warranty gives you specific legal rights, and you may have other rights, which may vary from province to province. The provisions contained in this warranty are not intended to limit, modify, take away from, disclaim or exclude any statutory warranties set forth in any applicable provincial or federal legislation.

Made in China

Imported by Trileaf Distribution Trifeuil Toronto, Canada M4S 2B8

CERTIFIED®

model number 399-8640-0

20 V CORDLESS SWEEPER

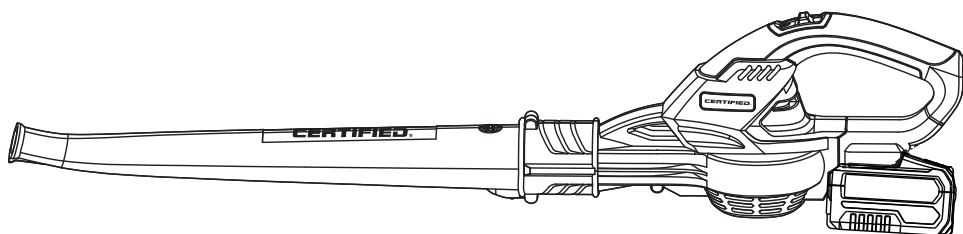

IMPORTANT:

Please read this manual carefully before running this product and save it for reference.

SAFETY AND OPERATING MANUAL

model number 399-8640-0



For problems or questions, **DO**
NOT RETURN TO STORE. Please
contact one of our Customer
Service Agents who would be
happy to assist you.

For customer assistance please call:



CANADA: 1-844-428-7277



Read and understand this instruction manual thoroughly before using the product. It contains important information for your safety as well as operating and maintenance advice.

Keep this instruction manual for future use. Should this product be passed on to a third party, this instruction manual must be included.



Intertek
3026035

model number 399-8640-0

TABLE OF CONTENTS

PRODUCT SAFETY	5
Important safety instructions for all appliances	5
For all battery-operated gardening appliances	5
Additional safety warnings for power tool	6
Safety warnings for battery pack	7
Information for radiated emission	8
SYMBOLS	9
COMPONENT LIST	10
TECHNICAL DATA	11
ACCESSORIES	12
ASSEMBLY	13
Charging the battery pack	13
Checking the battery charge condition	14
Installing or removing battery pack	15
Assembling the blower tube	15
OPERATION	17
Starting and stopping	17
Using the blower	17
MAINTENANCE	18
TROUBLESHOOTING	18
EXPLODED VIEW	19
PARTS LIST	20
WARRANTY	21

SAVE THESE INSTRUCTIONS

This manual contains important safety and operating instructions. Read all instructions and follow them with use of this product.

IMPORTANT SAFETY INSTRUCTIONS FOR ALL APPLIANCES:

- 1) **Avoid Dangerous Environments**—Don't use appliances in damp or wet locations.
- 2) **Don't Use In Rain.**
- 3) **Keep Children Away**—All visitors should be kept at a distance from work area.
- 4) **Dress Properly**—Do not wear loose clothing or jewellery. They can be caught in moving parts. Use of rubber gloves and substantial footwear is recommended when working outdoors. Wear protective hair covering to contain long hair.
- 5) **Use Safety Glasses**—Always use face or dust mask if operation is dusty.
- 6) **Use Right Appliance**—Do not use appliance for any job except that for which it is intended.
- 7) **Don't Force Appliance**—It will do the job better and with less likelihood of a risk of injury at the rate for which it was designed.
- 8) **Don't Overreach**—Keep proper footing and balance at all times.
- 9) **Stay Alert**—Watch what you are doing. Use common sense. Do not operate appliance when you are tired.
- 10) **Store Idle Appliances Indoors**—When not in use, appliances should be stored indoors in dry, and high or locked-up place—out of reach of children.

- 11) **Maintain Appliance With Care**—Keep cutting edge sharp and clean for best performance and to reduce the risk of injury. Follow instructions for lubricating and changing accessories. Keep handles dry, clean, and free from oil and grease.
- 12) **Check Damaged Parts**—Before further use of the appliance, a guard or other part that is damaged should be carefully checked to determine that it will operate properly and perform its intended function. Check for alignment of moving parts, binding of moving parts, breakage of parts, mounting, and any other condition that may affect its operation. A guard or other part that is damaged should be properly repaired or replaced by an authorized service centre unless indicated elsewhere in this manual.

FOR ALL BATTERY-OPERATED GARDENING APPLIANCES:

- 1) **Prevent unintentional starting.** Ensure the switch is in the off-position before connecting to battery pack, picking up or carrying the appliance. Carrying the appliance with your finger on the switch or energizing appliance that have the switch on invites accidents.
- 2) **Disconnect the battery pack** from the appliance before making any adjustments, changing accessories,



READ ALL INSTRUCTIONS

WARNING! Read all safety warnings and instructions. Failure to follow the warnings and instructions may result in electric shock, fire and/or serious injury.

WARNING: The use of any other accessory or attachment might increase the risk of injury.

model number 399-8640-0

or storing appliance. Such preventive safety measures reduce the risk of starting the appliance accidentally.

- 3) Recharge only with the charger specified by the manufacturer. A charger that is suitable for one type of battery pack may create a risk of fire when used with another battery pack.
- 4) Use appliances only with specifically designated battery packs. Use of any other battery packs may create a risk of injury and fire.
- 5) When battery pack is not in use, keep it away from other metal objects, like paper clips, coins, keys, nails, screws or other small metal objects, that can make a connection from one terminal to another. Shorting the battery terminals together may cause burns or a fire.
- 6) Under abusive conditions, liquid may be ejected from the battery; avoid contact. If contact accidentally occurs, flush with water. If liquid contacts eyes, additionally seek medical help. Liquid ejected from the battery may cause irritation or burns.
- 7) Do not use a battery pack or appliance that is damaged or modified. Damaged or modified batteries may exhibit unpredictable behavior resulting in fire, explosion or risk of injury.
- 8) Do not expose a battery pack or appliance to fire or excessive temperature. Exposure to fire or temperature above 130°C (265°F) may cause explosion.
- 9) Follow all charging instructions and do not charge the battery pack or appliance outside of the

temperature range specified in the instructions. Charging improperly or at temperatures outside of the specified range may damage the battery and increase the risk of fire.

- 10) Have servicing performed by a qualified repair person using only identical replacement parts. This will ensure that the safety of the product is maintained.
- 11) Do not modify or attempt to repair the appliance or the battery pack (as applicable) except as indicated in the instructions for use and care.

ADDITIONAL SAFETY WARNINGS FOR POWER TOOL

IMPORTANT SAFETY INSTRUCTIONS.

When using an electrical appliance, basic precautions should always be followed, including the following:

READ ALL INSTRUCTIONS BEFORE USING THIS APPLIANCE

- 1) To reduce the risk of electric shock —Do not use on wet surfaces. Do not expose to rain. Store indoors.
- 2) Do not allow to be used as a toy. Close attention is necessary when used by or near children.
- 3) Use only as described in this manual. Use only manufacturer's recommended attachments.
- 4) If appliance is not working as it should, has been dropped, damaged, left outdoors, or dropped into water, return it to a service centre.
- 5) Keep hair, loose clothing, fingers, and all parts of body away from openings and moving parts.
- 6) Do not charge the unit outdoors.

- 7) Use only the charger supplied by the manufacturer to recharge.
- 8) Do not incinerate the appliance even if it is severely damaged. The batteries can explode in a fire.
- 9) Do not put any object into openings. Do not use with any opening blocked; keep free of dust, lint, hair, and anything that may reduce airflow.
- 10) Do not handle plug or appliance with wet hands.
- 11) Do not leave appliance when plugged in. Unplug from outlet when not in use and before servicing.
- 12) Turn off all controls before unplugging.
- 13) Use extra care when cleaning on stairs.

SAFETY WARNINGS FOR BATTERY PACK

- 1) Do not dismantle, open or shred battery pack.
- 2) Do not expose battery pack to heat or fire. Avoid storage in direct sunlight.
- 3) Do not short-circuit a battery pack. Do not store battery packs haphazardly in a box or drawer where they may short-circuit each other or be short-circuited by other metal objects. When battery pack is not in use, keep it away from other metal objects, like paper clips, coins, keys, nails, screws or other small metal objects, that can make a connection from one terminal to another. Shorting the battery terminals together may cause burns or fire.
- 4) Do not subject battery pack to mechanical shock.
- 5) In the event of battery leaking, do not allow the liquid to come in

- contact with the skin or eyes. If contact has been made, wash the affected area with copious amounts of water and seek medical advice.
- 6) Do not use any battery pack which is not designed for use with the equipment.
- 7) Keep battery pack out of the reach of children.
- 8) Always purchase the battery pack recommended by the device manufacturer for the equipment.
- 9) Keep battery pack clean and dry.
- 10) Wipe the battery pack terminals with a clean, dry cloth if they become dirty.
- 11) Battery pack needs to be charged before use. Always use the correct charger and refer to the manufacturer's instructions or equipment manual for proper charging instructions.
- 12) Do not leave battery pack on prolonged charge when not in use.
- 13) After extended periods of storage, it may be necessary to charge and discharge the battery pack several times to obtain maximum performance.
- 14) Recharge only with the charger specified by manufacturer. Do not use any charger other than that specifically provided for use with the equipment.
- 15) Retain the original product literature for future reference.
- 16) Use only the battery pack in the application for which it was intended.
- 17) Remove the battery pack from the equipment when not in use.
- 18) Dispose of properly.
- 19) Do not mix cells of different manufacture, capacity, size or type

model number 399-8640-0

within a device.

- 20) Keep the battery away from microwaves and high pressure.

INFORMATION FOR RADIATED EMISSION

This device complies with Canadian ICES-001.

This device complies with Part 15 of the FCC Rules.

Operation is subject to the following two conditions:

- (1) This device may not cause harmful interference; and
- (2) This device must accept any interference received, including interference that may cause undesired operation.

 **WARNING:** Changes or modifications to this unit not expressly approved by the party responsible for compliance could void the user's authority to operate the equipment.

NOTE: This equipment has been tested and found to comply with the limits for a Class B digital device, pursuant to Part 15 of the FCC Rules.

These limits are designed to provide reasonable protection against harmful interference in a residential installation. This equipment generates, uses and can radiate radio frequency energy and, if not installed and used in accordance with the instructions, may cause harmful interference to radio communications.

However, there is no guarantee that interference will not occur in a particular installation. If this equipment does cause harmful interference to radio or television reception, which can be determined by turning the equipment off and on, the user is encouraged to try

to correct the interference by one or more of the following measures:

- Reorient or relocate the receiving antenna.
- Increase the separation between the equipment and receiver.
- Connect the equipment into an outlet on a circuit different from that to which the receiver is connected.
- Consult the dealer or an experienced radio/TV technician for help.

SAVE THESE INSTRUCTIONS

FCC Part 15

Supplier's Declaration of Conformity

Product Description: Charger

Model Number: ACG1820W2U

Trade Name: CERTIFIED®

This device complies with part 15 of the FCC Rules.

Operation is subject to the following two conditions:

- This device may not cause harmful interference; and
- This device must accept any interference received, including interference that may cause undesired operation.

Responsible Party:

Positec USA, Inc.

929 Jay St. Suite 200, Charlotte, NC 28208

Tel.: (704) 599-3711

Fax: (704) 599-6390

SYMBOLS



Warning



To reduce the risk of injury, user must read instruction manual



Wear ear protection



Li-ion

Lithium-ion battery; battery must be recycled



Do not burn



Batteries may enter water cycle if disposed improperly, which can be hazardous for ecosystem. Do not dispose of waste batteries as unsorted municipal waste.







call2recycle®

CERTIFIED® Inc. has established a partnership with the RBRC Corporation to recycle any CERTIFIED® batteries with the RBRC-call2recycle seal. For environmental protection, please do not discard batteries in the trash. After the battery's life cycle has ended, please call 1-800-822-8837 for a free service that will properly dispose of the battery.

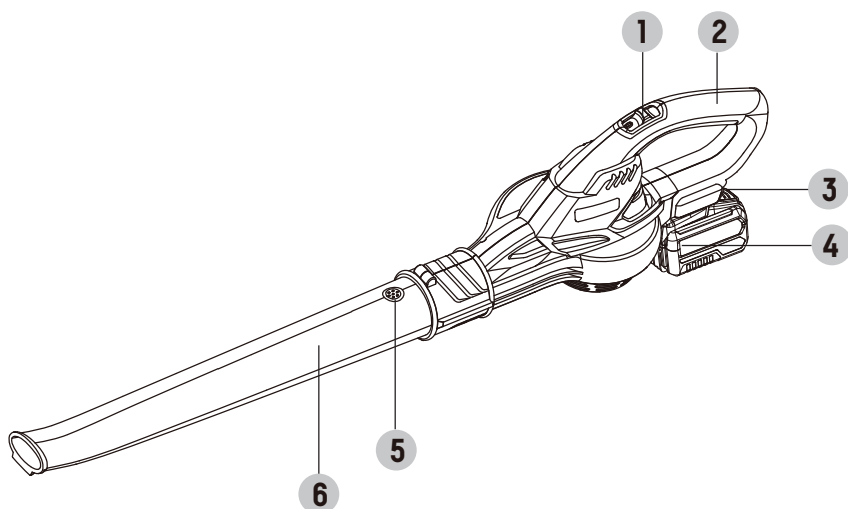
model number 399-8640-0

1. On/off switch
2. Handle
3. Battery pack release button
4. Battery pack
5. Tube release button
6. Blower tube



Rated voltage	20 V  , Max*
Air speed	120 MPH (193.1 km/h)
Air volume	80 CFM (2.3 m ³ /min)
Battery capacity (ABP1840HWU)	4.0 Ah
Charger input (ACG1820W2U)	120V~, 60 Hz
Charger output (ACG1820W2U)	20 V  , 2.0 A
Charging time	2 hr (4.0 Ah x 1) 4 hr (4.0 Ah x 2)
Protection class	 /II
Machine weight	3 lb 9 oz (1.61 kg)

*Voltage measured without workload. Initial battery voltage reaches maximum of 20 volts. Nominal voltage is 18 volts.

model number 399-8640-0

Charger	1
Battery pack	1

We recommend that you purchase your accessories from the same store that sold you this product. Refer to the accessory packaging for further details. Store personnel can assist you and offer advice.

OPERATION INSTRUCTION

NOTE: Before using this product, read the instruction book carefully.

INTENDED USE

The blower is intended for residential use only. Use the blower outdoors to move yard debris as needed.

1. CHARGING THE BATTERY PACK

- a) Do not use any charger other than that specifically provided for use with the equipment.
- b) If the battery pack is very hot, remove your battery pack from the charger and allow time for the battery to cool down before recharging.
- c) The battery in your new tool is not charged when it leaves the plant. Therefore it must be full charged before using the first time.
- d) Please charge the battery to reach full or no less than half charge before storage. If the tool will not be used for long periods of time, charge the battery every 3-6 months.

CHARGING PROCEDURE (SEE FIG. A1)

- 1) Plug the charger into an appropriate outlet. The light will be green.
- 2) Slide the battery pack into the charger; the light (c) will turn red to indicate the charging process has started.
- 3) When charging is completed, the light will turn green. The pack is now fully charged; unplug the charger and remove the battery pack.

NOTE: Charge the two battery packs at the same time or charge them one by one.



WARNING: The charger and battery pack are specially designed to work together so do not attempt to use any other devices. Never insert or allow metallic objects into your charger or battery pack connections because an electrical failure and hazard will occur.

WARNING: When battery charge runs out after continuous use or exposure to direct sunlight or heat, allow time for the tool to cool down before re-charging to achieve the full charge.

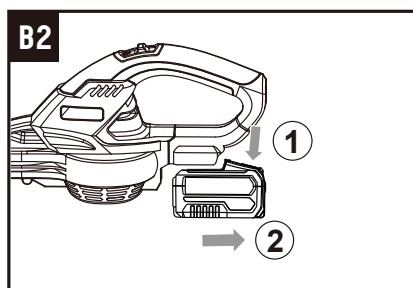
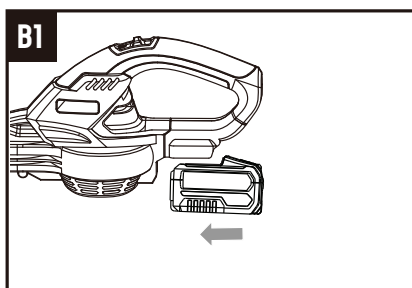
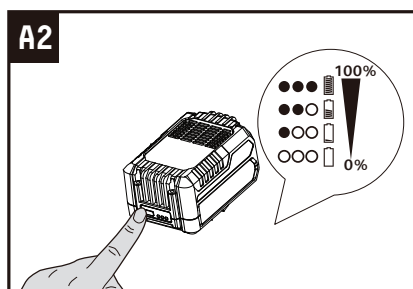
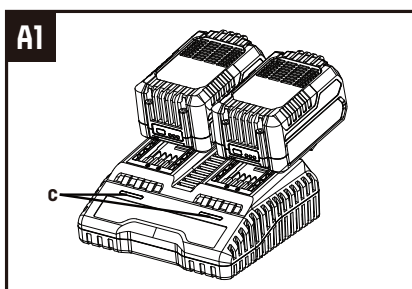

CHARGING INDICATOR

Light	Status
Red on ●	Charging
Green on ●	Fully Charged

2. CHECKING THE BATTERY CHARGE CONDITION (SEE FIG. A2)

The battery level can be determined from the battery indicator light by pressing the button beside the lights.

3. INSTALLING OR REMOVING BATTERY PACK (SEE FIG. B1, B2)

Depress the battery release button to release battery pack from your blower. After recharging, insert the battery pack into blower's battery port. A simple push and slight pressure will be sufficient. The battery pack is seated when a click is heard.

Note: When removing the battery pack, hold it firmly to avoid dropping and potential injury or accident.

4. ASSEMBLING THE BLOWER TUBE (SEE FIG. C1-C4)

Before assembling the blower tube, be sure the on/off switch is in "0" (off) position. Fit the blower tube to the motor housing as shown in Fig. C1. Check the blower tube is firmly secured. Fix the blower tube to the blower port with the screw provided.

(See Fig. C3)

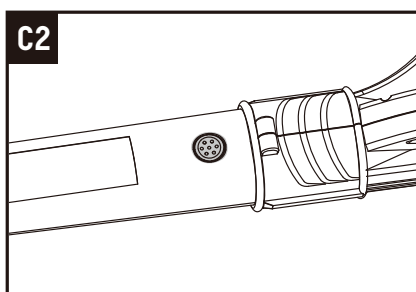
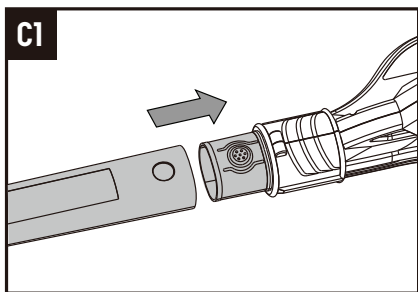

NOTE:

Before disassembling the blower tube, be sure the on/off switch is in "0" (off) position. First loosen the screw, as shown in Fig. C3. Press the tube release button so that you can separate the tubes (See Fig. C4). Do not try to separate the tubes by force or by using tools.

model number 399-8640-0

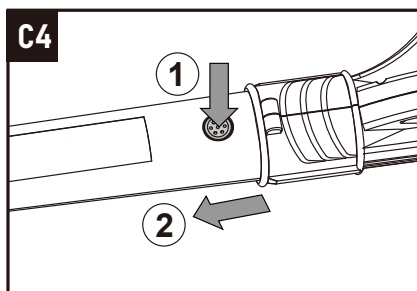
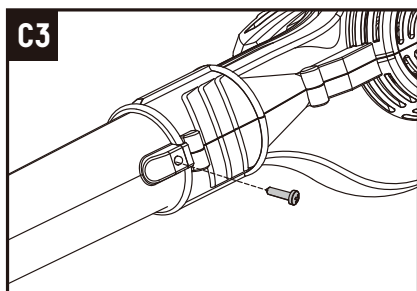

1. STARTING AND STOPPING (SEE FIG. D)

Starting:

Move the on/off switch to the "I" (on) position.

Stopping:

Move the on/off switch to the "O" (off) position.

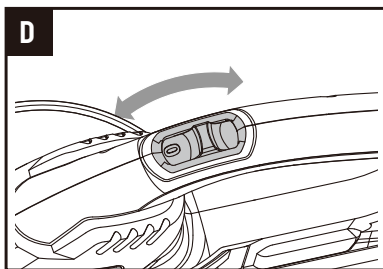

2. USING THE BLOWER (SEE FIG. E)

The blower is intended for residential use only. Use the blower outdoors to move debris from hard surfaces. This blower is not designed to clear leaves from large grassy areas, or move wet, heavy debris.

USER TIPS

- Hold the blow tube approx 7" (18 cm) above the ground when operating the tool.
 - Use a sweeping motion from side to side.
- Advance slowly keeping the accumulated debris/leaves in front of you.
- After blowing the debris/leaves into a pile, it is easy to dispose of the pile.

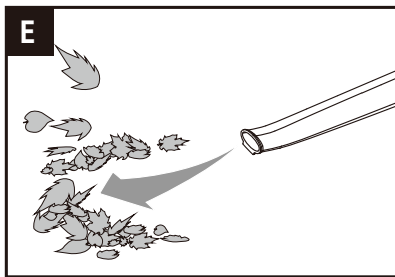

WARNING:

- Do not blow hard objects such as nails, bolts, or rocks.
- Do not operate the blower near bystanders or pets.
- Use extra care when cleaning debris from stairs or other tight areas.
- Wear safety goggles or other suitable eye protection, long pants, and shoes.

MAINTENANCE

1. Remove the battery pack before any work on the device.
2. Store the tool, instruction manual and accessories in a secure, dry place. In this way you will always have the information ready.
3. Keep the tool's air vents unclogged and clean at all times.
4. Remove dust and dirt regularly. Cleaning is best done with a rag or brush.
5. Never use caustic agents to clean plastic parts.

For Battery Tools:

The ambient temperature range for the use and storage of tool and battery is 32 – 113°F (0 – 45°C).

The recommended ambient temperature range for the charging system during charging is 32 – 104°F (0 – 40°C).

TROUBLESHOOTING

Problem	Possible cause	Fault correction
The tool does not work	Low battery capacity	Charge the battery
	The battery pack is not fully inserted	Insert the battery pack completely
The battery pack cannot be removed	The battery pack release button is not pressed	Press the battery pack release button



WARNING: Do not use cleaning agents to clean the plastic parts of the tool. A mild detergent on a damp cloth is recommended. Water must never come into contact with the tool.

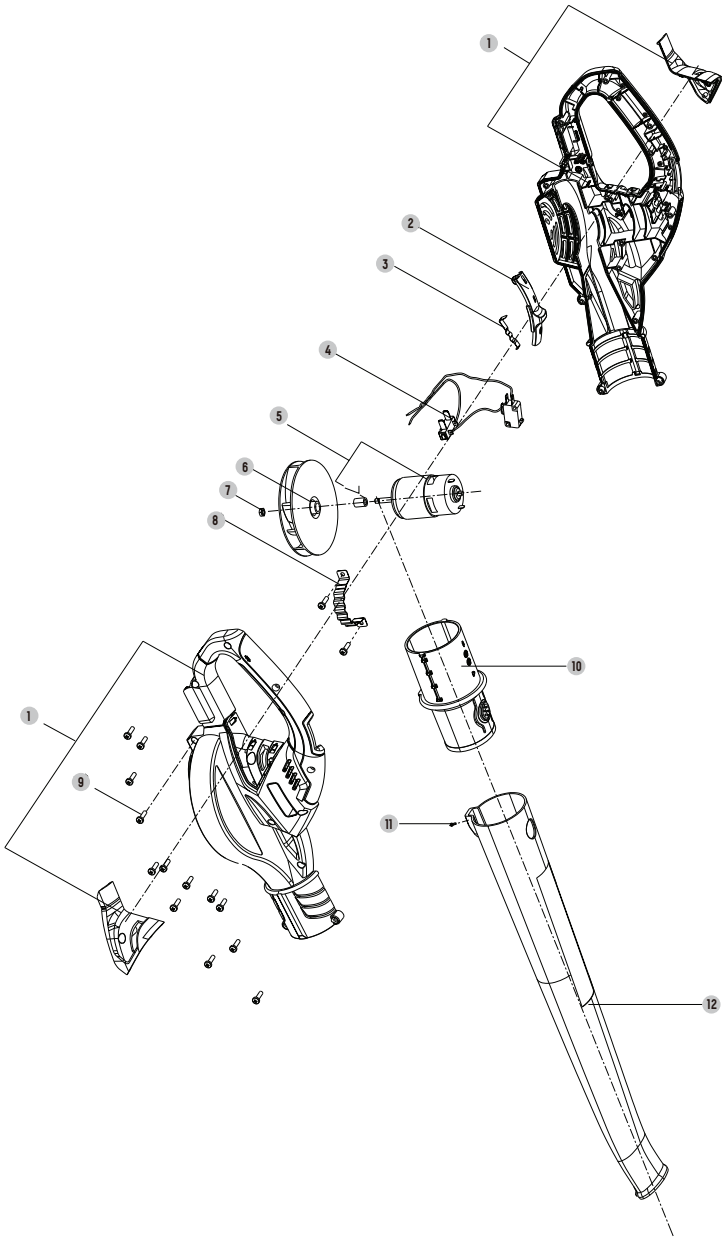

EXPLODED VIEW

model number 399-8640-0

Item	Description	QTY.
1	Left/Right Housing	1
2	Button	1
3	Spring Plate	1
4	Switch Assembly	1
5	DC Motor	1
6	Fan	1
7	Nut M5 LH	1
8	Clamp	1
9	Self-tapping Screw ST3.9X16	15
10	Blower Tube	1
11	Screw ST2.9x10	1
12	Blower Tube II	1

1-YEAR LIMITED WARRANTY

This CERTIFIED® product is guaranteed for a period of one (1) year from the date of original retail purchase against defects in workmanship and materials.

Subject to the conditions and limitations described below, this product, if returned to us with proof of purchase within the stated warranty period and if covered under this warranty, will be repaired or replaced (with the same model, or one of equal value or specification), at our option. We will bear the cost of any repair or replacement and any costs of labour relating thereto.

This warranty is subject to the following conditions and limitations:

- a) a bill of sale verifying the purchase and purchase date must be provided;
- b) this warranty will not apply to any product or part thereof which is worn or broken or which has become inoperative due to abuse, misuse, accidental damage, neglect or lack of proper installation, operation or maintenance (as outlined in the applicable owner's manual or operating instructions) or which is being used for industrial, professional, commercial or rental purposes;
- c) this warranty will not apply to normal wear and tear or to expendable parts or accessories that may be supplied with the product that are expected to become inoperative or unusable after a reasonable period of use;
- d) this warranty will not apply to routine maintenance and consumable items such as, but not limited to, lubricants, blades, fluids, tune-ups or adjustments;
- e) this warranty will not apply where damage is caused by repairs made or attempted by others (i.e., persons not authorized by the manufacturer);
- f) this warranty will not apply to any product that was sold to the original purchaser as a reconditioned or refurbished product (unless otherwise specified in writing);
- g) this warranty will not apply to any product or part thereof if any part from another manufacturer is installed therein or any repairs or alterations have been made or attempted by unauthorized persons;
- h) this warranty will not apply to normal deterioration of the exterior finish, such as, but not limited to, scratches, dents, paint chips, or to any corrosion or discolouring by heat, abrasive and chemical cleaners; and
- i) this warranty will not apply to component parts sold by and identified as the product of another company, which shall be covered under the product manufacturer's warranty, if any.

Additional Limitations

This warranty applies only to the original purchaser and may not be transferred. Neither the retailer nor the manufacturer shall be liable for any other expense, loss or damage, including, without limitation, any indirect, incidental, consequential or exemplary damages arising in connection with the sale, use or inability to use this product.

Notice to Consumer

This warranty gives you specific legal rights, and you may have other rights, which may vary from province to province. The provisions contained in this warranty are not intended to limit, modify, take away from, disclaim or exclude any statutory warranties set forth in any applicable provincial or federal legislation.

Made in China

Imported by Trileaf Distribution Trifeuil Toronto, Canada M4S 2B8

CERTIFIED®

model number 399-8640-0

20 V CORDLESS GRASS TRIMMER

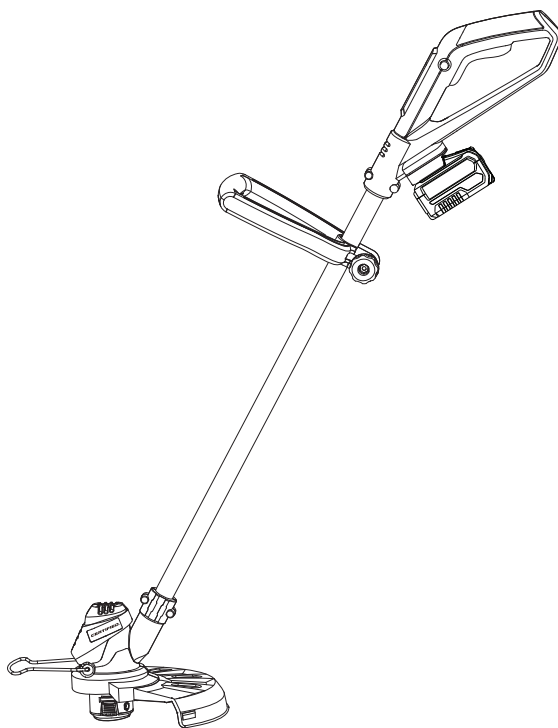

IMPORTANT:

Please read this manual carefully before running this grass trimmer and save it for reference.

**SAFETY AND
OPERATING
MANUAL**

model number 399-8640-0



For problems or questions, **DO**
NOT RETURN TO STORE. Please
contact one of our Customer
Service Agents who would be
happy to assist you.

For customer assistance please call:



CANADA: 1-844-428-7277



Read and understand this instruction manual thoroughly before using the product. It contains important information for your safety as well as operating and maintenance advice.

Keep this instruction manual for future use. Should this product be passed on to a third party, this instruction manual must be included.



Intertek
3026035

TABLE OF CONTENTS

PRODUCT SAFETY	5
Important safety instructions for all appliances	5
For all battery-operated gardening appliances	5
Additional safety rules for lawn trimmer and edge trimmer	6
Safety warnings for battery pack	6
Information for radiated emission	7
SYMBOLS	9
COMPONENT LIST	10
TECHNICAL DATA	11
ACCESSORIES	12
ASSEMBLY	13
Charging the battery pack	13
Checking the battery charge condition	14
Installing or removing battery pack	15
Assembly of auxiliary handle	15
Assembly of the safety guard	15
Removing the blade protect label	15
OPERATION	16
Safety on/off switch	16
Flower guard	17
Trimming	18
Automatic line feed system	18
Manually feeding the line	18
Removing the cap	19
Changing the spool	19
Manually winding line	20
MAINTENANCE	21
TROUBLESHOOTING	21
EXPLODED VIEW	22
PARTS LIST	23
WARRANTY	24

SAVE THESE INSTRUCTIONS

This manual contains important safety and operating instructions. Read all instructions and follow them with use of this product.

IMPORTANT SAFETY INSTRUCTIONS FOR ALL APPLIANCES:

- 1) **Avoid Dangerous Environments**—Don't use appliances in damp or wet locations.
- 2) **Don't Use In Rain.**
- 3) **Keep Children Away**—All visitors should be kept at a distance from work area.
- 4) **Dress Properly**—Do not wear loose clothing or jewellery. They can be caught in moving parts. Use of rubber gloves and substantial footwear is recommended when working outdoors. Wear protective hair covering to contain long hair.
- 5) **Use Safety Glasses**—Always use face or dust mask if operation is dusty.
- 6) **Use Right Appliance**—Do not use appliance for any job except that for which it is intended.
- 7) **Don't Force Appliance**—It will do the job better and with less likelihood of a risk of injury at the rate for which it was designed.
- 8) **Don't Overreach**—Keep proper footing and balance at all times.
- 9) **Stay Alert**—Watch what you are doing. Use common sense. Do not operate appliance when you are tired.
- 10) **Store Idle Appliances Indoors**—When not in use, appliances should be stored indoors in dry, and high or locked-up place—out of reach of children.

- 11) **Maintain Appliance With Care**—Keep cutting edge sharp and clean for best performance and to reduce the risk of injury. Follow instructions for lubricating and changing accessories. Keep handles dry, clean, and free from oil and grease.
- 12) **Check Damaged Parts**—Before further use of the appliance, a guard or other part that is damaged should be carefully checked to determine that it will operate properly and perform its intended function. Check for alignment of moving parts, binding of moving parts, breakage of parts, mounting, and any other condition that may affect its operation. A guard or other part that is damaged should be properly repaired or replaced by an authorized service centre unless indicated elsewhere in this manual.

FOR ALL BATTERY-OPERATED GARDENING APPLIANCES:

- 1) **Prevent unintentional starting.** Ensure the switch is in the off-position before connecting to battery pack, picking up or carrying the appliance. Carrying the appliance with your finger on the switch or energizing appliance that have the switch on invites accidents.
- 2) **Disconnect the battery pack** from the appliance before making any



READ ALL INSTRUCTIONS

WARNING! Read all safety warnings and instructions. Failure to follow the warnings and instructions may result in electric shock, fire and/or serious injury.

WARNING: The use of any other accessory or attachment might increase the risk of injury.

model number 399-8640-0

PRODUCT SAFETY

adjustments, changing accessories, or storing appliance. Such preventive safety measures reduce the risk of starting the appliance accidentally.

- 3) Recharge only with the charger specified by the manufacturer. A charger that is suitable for one type of battery pack may create a risk of fire when used with another battery pack.
- 4) Use appliances only with specifically designated battery packs. Use of any other battery packs may create a risk of injury and fire.
- 5) When battery pack is not in use, keep it away from other metal objects, like paper clips, coins, keys, nails, screws or other small metal objects, that can make a connection from one terminal to another. Shorting the battery terminals together may cause burns or a fire.
- 6) Under abusive conditions, liquid may be ejected from the battery; avoid contact. If contact accidentally occurs, flush with water. If liquid contacts eyes, additionally seek medical help. Liquid ejected from the battery may cause irritation or burns.
- 7) Do not use a battery pack or appliance that is damaged or modified. Damaged or modified batteries may exhibit unpredictable behavior resulting in fire, explosion or risk of injury.
- 8) Do not expose a battery pack or appliance to fire or excessive temperature. Exposure to fire or temperature above 265°F (130°C) may cause explosion.
- 9) Follow all charging instructions and do not charge the battery

pack or appliance outside of the temperature range specified in the instructions. Charging improperly or at temperatures outside of the specified range may damage the battery and increase the risk of fire.

- 10) Have servicing performed by a qualified repair person using only identical replacement parts. This will ensure that the safety of the product is maintained.
- 11) Do not modify or attempt to repair the appliance or the battery pack (as applicable) except as indicated in the instructions for use and care.

ADDITIONAL SAFETY RULES FOR LAWN TRIMMER AND EDGE TRIMMER

- 1) Keep guards in place and in good working order.
- 2) Keep hands and feet away from cutting area.
- 3) Do not use heavier lines than recommended in this manual.
- 4) Do not use line materials of other types – for example, metal wire, rope, and the like.

SAFETY WARNINGS FOR BATTERY PACK

- 1) Do not dismantle, open or shred battery pack.
- 2) Do not expose battery pack to heat or fire. Avoid storage in direct sunlight.
- 3) Do not short-circuit a battery pack. Do not store battery packs haphazardly in a box or drawer where they may short-circuit each other or be short-circuited by

other metal objects. When battery pack is not in use, keep it away from other metal objects, like paper clips, coins, keys, nails, screws or other small metal objects, that can make a connection from one terminal to another. Shorting the battery terminals together may cause burns or fire.

- 4) Do not subject battery pack to mechanical shock.
- 5) In the event of battery leaking, do not allow the liquid to come in contact with the skin or eyes. If contact has been made, wash the affected area with copious amounts of water and seek medical advice.
- 6) Do not use any battery pack which is not designed for use with the equipment.
- 7) Keep battery pack out of the reach of children.
- 8) Always purchase the battery pack recommended by the device manufacturer for the equipment.
- 9) Keep battery pack clean and dry.
- 10) Wipe the battery pack terminals with a clean, dry cloth if they become dirty.
- 11) Battery pack needs to be charged before use. Always use the correct charger and refer to the manufacturer's instructions or equipment manual for proper charging instructions.
- 12) Do not leave battery pack on prolonged charge when not in use.
- 13) After extended periods of storage, it may be necessary to charge and discharge the battery pack several times to obtain maximum performance.
- 14) Recharge only with the charger specified by manufacturer. Do not use any charger other than that

specifically provided for use with the equipment.

- 15) Retain the original product literature for future reference.
- 16) Use only the battery pack in the application for which it was intended.
- 17) Remove the battery pack from the equipment when not in use.
- 18) Dispose of properly.
- 19) Do not mix cells of different manufacture, capacity, size or type within a device.
- 20) Keep the battery away from microwaves and high pressure.

INFORMATION FOR RADIATED EMISSION

This device complies with Canadian ICES-001.

This device complies with Part 15 of the FCC Rules.

Operation is subject to the following two conditions:

- (1) This device may not cause harmful interference; and
- (2) This device must accept any interference received, including interference that may cause undesired operation

 **WARNING:** Changes or modifications to this unit not expressly approved by the party responsible for compliance could void the user's authority to operate the equipment.

NOTE: This equipment has been tested and found to comply with the limits for a Class B digital device, pursuant to Part 15 of the FCC Rules.

These limits are designed to provide reasonable protection against harmful interference in a residential installation.

model number 399-8640-0

This equipment generates, uses and can radiate radio frequency energy and, if not installed and used in accordance with the instructions, may cause harmful interference to radio communications.

However, there is no guarantee that interference will not occur in a particular installation. If this equipment does cause harmful interference to radio or television reception, which can be determined by turning the equipment off and on, the user is encouraged to try to correct the interference by one or more of the following measures:

- Reorient or relocate the receiving antenna.
- Increase the separation between the equipment and receiver.
- Connect the equipment into an outlet on a circuit different from that to which the receiver is connected.
- Consult the dealer or an experienced radio/TV technician for help.

FCC Part 15

Supplier's Declaration of Conformity

Product Description: Charger

Model Number: ACG1820W2U

Trade Name: CERTIFIED®

This device complies with part 15 of the FCC Rules.

Operation is subject to the following two conditions:

- This device may not cause harmful interference, and
- This device must accept any interference received, including interference that may cause undesired operation.

Responsible Party:

Positec USA, Inc.

929 Jay St. Suite 200, Charlotte, NC
28208

Tel.: (704) 599-3711

Fax: (704) 599-6390

SAVE THESE INSTRUCTIONS

SYMBOLS



Warning



To reduce the risk of injury, user must read instruction manual



Wear ear protection



Li-ion

Lithium-ion battery; battery must be recycled



Do not burn



Batteries may enter water cycle if disposed improperly, which can be hazardous for ecosystem. Do not dispose of waste batteries as unsorted municipal waste.



call2recycle®

CERTIFIED® Inc. has established a partnership with the RBRC Corporation to recycle any CERTIFIED® batteries with the RBRC-call2recycle seal. For environmental protection, please do not discard batteries in the trash. After the battery's life cycle has ended, please call 1-800-822-8837 for a free service that will properly dispose of the battery.

model number 399-8640-0

1. Auxiliary Handle

2. Lock Off Button

3. On/Off Switch

4. Battery Pack

5. Safety Guard

6. Flower Guard

7. Line Cutter

8. Spool Cover

9. Cap Release Latch

10. Spool

11. Trimmer Head

12. Eyelet

13. Main Handle

14. Line Feed Button (See Fig. I)

15. Battery Pack Release Button

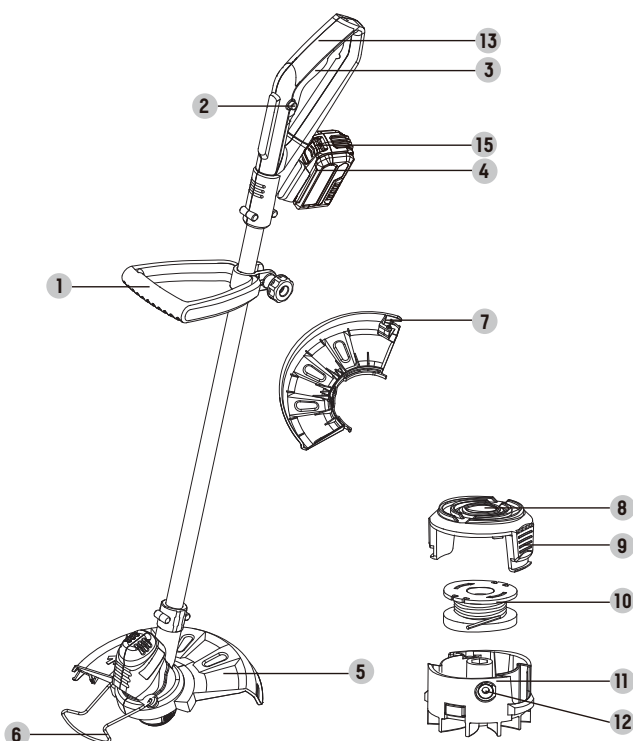

Rated voltage	20 V $\overline{=}$, Max*
No load speed	9500 RPM
Max. cutting diameter	10" (25.4 cm)
Diameter of line	0.065" (1.65 mm)
Line length	10' (3 m)
Battery capacity (ABP1840HWU)	4.0 Ah
Charger input (ACG1820W2U)	120 V~, 60 Hz
Charger output (ACG1820W2U)	20 V $\overline{=}$, 2.0 A
Charging time	2 hr (4.0 Ah x 1) 4 hr (4.0 Ah x 2)
Protection class	\square / II
Machine weight	4 lb 3 oz (1.91 kg)

*Voltage measured without workload. Initial battery voltage reaches maximum of 20 volts. Nominal voltage is 18 volts.

model number 399-8640-0

Charger	1
Battery pack	1
Safety guard	1
Auxiliary handle	1
Spacer guard	1

We recommend that you purchase your accessories from the same store that sold you this product. Refer to the accessory packaging for further details. Store personnel can assist you and offer advice.

OPERATION INSTRUCTION

NOTE: Before using this product, read the instruction book carefully.

INTENDED USE

The machine is intended for the cutting of grass and weeds under bushes as well as on slopes and edges that can not be reached with the lawn mower.

1. CHARGING THE BATTERY PACK

- a) Do not use any charger other than that specifically provided for use with the equipment.
- b) If the battery pack is very hot, remove your battery pack from the charger and allow time for the battery to cool down before recharging.
- c) The battery in your new tool is not charged when it leaves the plant. Therefore it must be full charged before using the first time.
- d) Please charge the battery to reach full or no less than half charge before storage. If the tool will not be used for long periods of time, charge the battery every 3-6 months.

CHARGING PROCEDURE (SEE FIG. A1)

- 1) Plug the charger into an appropriate outlet. The light will be green.
- 2) Slide the battery pack into the charger; the light (c) will turn red to indicate the charging process has started.
- 3) When charging is completed, the light will turn green. The pack is now fully charged; unplug the charger and remove the battery pack.

NOTE: Charge the two battery packs at the same time or charge them one by one.



WARNING: The charger and battery pack are specially designed to work together so do not attempt to use any other devices. Never insert or allow metallic objects into your charger or battery pack connections because an electrical failure and hazard will occur.

WARNING: When battery charge runs out after continuous use or exposure to direct sunlight or heat, allow time for the tool to cool down before re-charging to achieve the full charge.

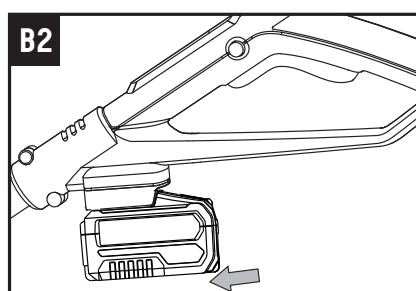
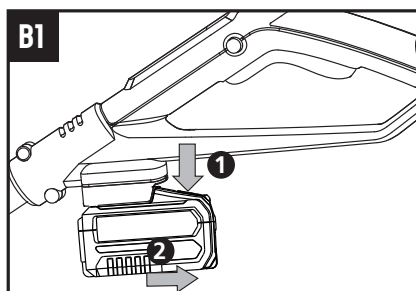
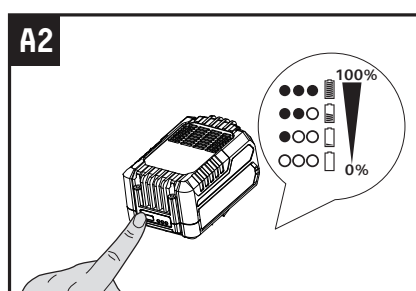
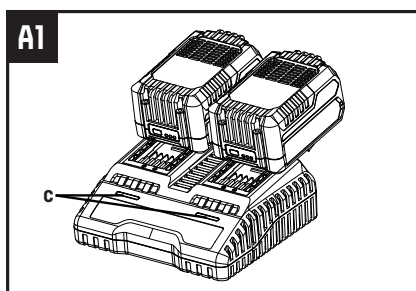

CHARGING INDICATOR

Light	Status
Red on ●	Charging
Green on ●	Fully Charged

2. CHECKING THE BATTERY CHARGE CONDITION (SEE FIG. A2)

The battery level can be determined from the battery indicator light by pressing the button beside the lights.

3. INSTALLING OR REMOVING BATTERY PACK (SEE FIG. B1, B2)

Depress the battery release button to release battery pack from your trimmer. After recharging, insert the battery pack into trimmer's battery port. A simple push and slight pressure will be sufficient. The battery pack is seated when a click is heard.

Note: When removing the battery pack, hold it firmly to avoid dropping and potential injury or accident.

4. ASSEMBLY OF AUXILIARY HANDLE (SEE FIG. C1, C2)

Insert the shaft onto the upper housing. Hand grabbing area should face down. Attach the screw to the housing unit, and then to the knob. Finally, rotate the knob until it is hand tight.

Note: Make sure that the handle is firmly locked in place.

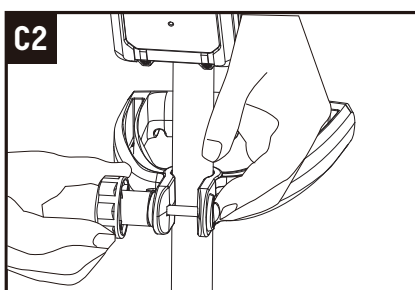
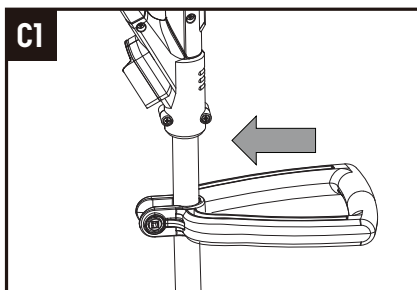

5. ASSEMBLY OF THE SAFETY GUARD (SEE FIG. D1-D3)

Remove the screw from the guard. Attach the safety guard to the trimmer head. Align the guard so it slides into the slots located on the trimmer head. Secure the safety guard onto the trimmer head with the screw.

6. REMOVING THE BLADE PROTECT LABEL (SEE FIG. E)

The blade is covered with a protective label. Please remove it before operation.

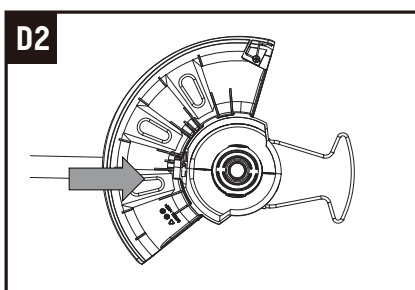
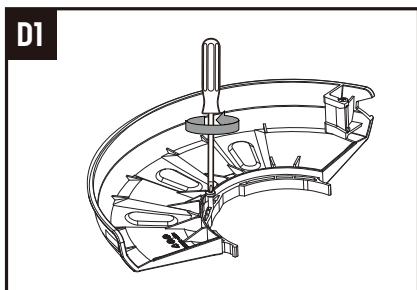

model number 399-8640-0

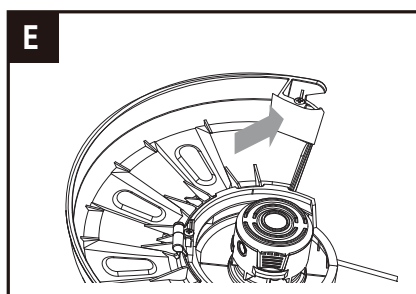
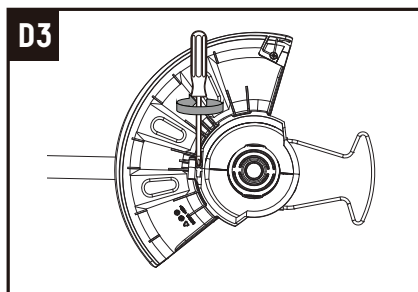

1. SAFETY ON/OFF SWITCH (SEE FIG. F)

The safety switch is locked off to prevent accidental starting. Depress the lock-off button then depress the on/off switch and release lock-off button. Your trimmer is now on. To switch off, just release the on/off switch.

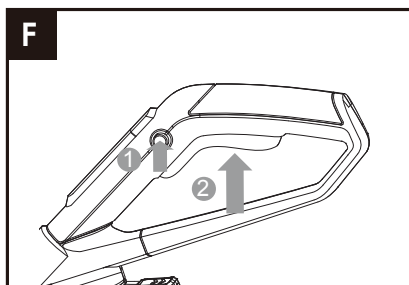

WARNING: The cutting head continues to rotate after the trimmer has been switched off; wait until it has completely stopped, then lay down the tool.

2. Flower Guard (See Fig. G1, G2)

Push the flower guard out before trimming, as shown in Fig. G1, G2.

G1

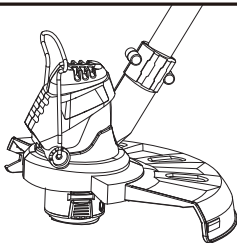

G2

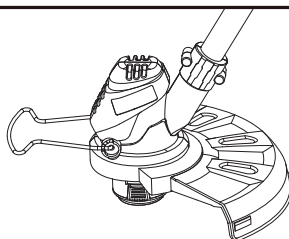

OPERATION



WARNING: Always wear eye protection. Never lean over the trimmer head. Rocks or debris can ricochet or be thrown into eyes and face and cause blindness or other serious injury. When operating unit:

Wear eye protection and heavy clothing. Hold front handle with one hand and auxiliary handle with the other hand. Keep unit below waist level. Work only from your right to your left to ensure debris is thrown away from you. Without bending over, keep line near and parallel to the ground (perpendicular when edging) and not crowded into material being cut.



WARNING: Make sure that line is fed out before operation. Make sure motor is up to full speed before trimming.



WARNING: Use only 0.065" (1.65 mm) diameter cutting line. Other sizes of line will not feed properly and will result in improper cutting head function or can cause serious injury. Do not use other material such as wire, string, rope, etc. Wire can break off during cutting and become a dangerous projectile that can cause serious injury.

3. Trimming (See Fig. H)

Position the trimmer head as shown in Fig. H for trimming.

Keep the bottom of the trimmer head just above the ground and at an angle.

Allow only the tip of line to make contact. Do not force trimmer line into work area.

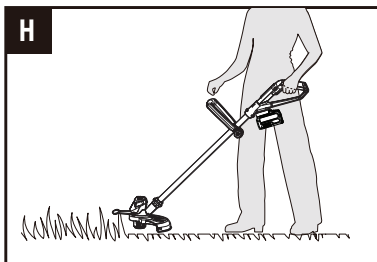

4. Automatic Line Feed System

When initially switching on the trimmer, a small length of line is fed out. A 'clattering' noise will be heard when the lines hit the line cutter. **DO NOT BE ALARMED**, this is quite normal. After about 5 seconds the line will be cut to the correct length and the noise will reduce as the motor receives full speed.

If the noise of the line being cut can't be heard, more line will be fed out. To feed more line, it is first necessary to allow the trimmer to stop completely, and then restart, allowing the motor to reach full speed.

Repeat above until you hear the lines hitting against the line cutter. (Do not repeat this procedure more than 6 times.)

5. Manually Feeding the Line (See Fig. I)

If required, line can be fed out manually. Before manual feed, remove the battery first. To operate, press and release manual line feed button, while gently pulling out the lines until the lines reach the line cutter. If the line extends past the line cutter, too much line has been fed out. If too much line is fed out, remove the spool cap and turn spool counter-clockwise until the line is at the desired length.

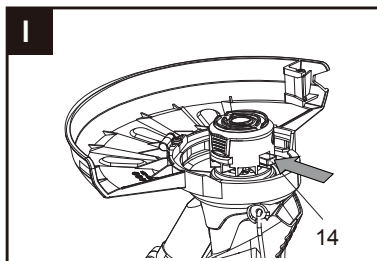

6. Removing the Cap (See Fig. J)

Press and hold in the two latches. Pull cap away from the spool holder. When refitting the spool cap, keep all areas of the cap and spool holder clean. Replace the cap, pressing firmly down towards the spool holder to ensure cap is fully located. Check that the cap is correctly fitted by trying to remove it without depressing the two latches.

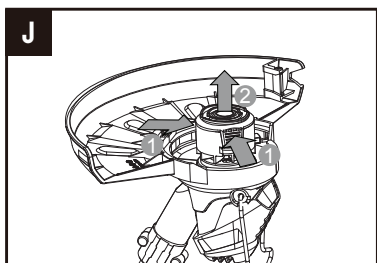

7. Changing the Spool (See Fig. K)

Note: For your convenience it is recommended you buy replacement spools with the trimmer line preinstalled.

Remove spool cap cover. Remove the old spool from spool holder. Clear any broken line or cutting debris from the spool area. Pull the line from the new replacement spool through the eyelet of the spool holder. Place new spool into the holder with the cut out areas of the spool facing inward or down. When installed into the spool holder, the smooth side of the spool should be visible. Release line from cleat on the spool. Refit the spool cap cover.

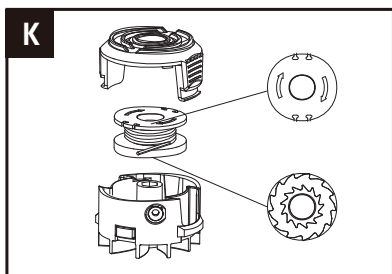

8. Manually Winding the Line (See Fig. L1-L3)

Important! Your trimmer is designed to use only line with a maximum diameter of 0.065" (1.65 mm).

Take approximately 10' (3 m) of line. Insert 1/2" (15 mm) of line into the spool holes and wind line in the direction of the arrows on the top of the spool (see Fig. L1, L2). Leave approximately 4" (10 cm) of line unwound and place it into the cleat. Care should be taken to ensure that the line is neatly coiled on the spool (see Fig. L3). Failure to do so will impair the efficiency of the automatic line feed. Then fit the spool as described above in "Changing the Spool".

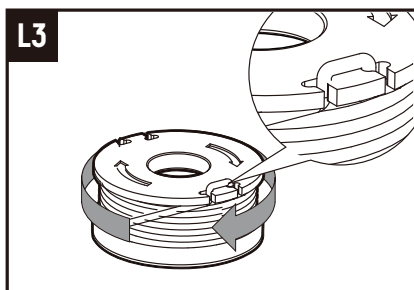
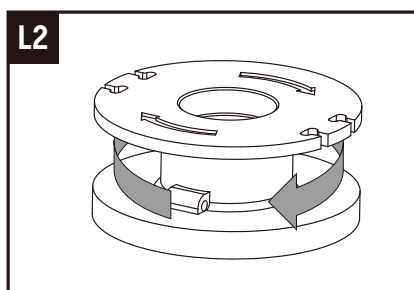
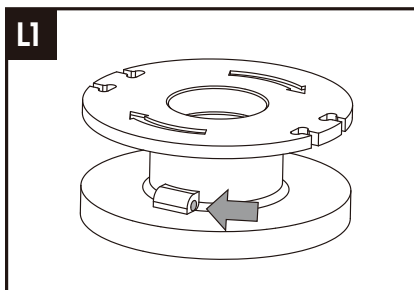

MAINTENANCE

Remove the battery pack from the tool before carrying out any adjustment, servicing or maintenance.

Your tool requires no additional lubrication or maintenance. There are no user serviceable parts in your power tool. Never use water or chemical cleaners to clean your power tool. Wipe clean with a dry cloth. Always store your power tool in a dry place. Keep the motor ventilation slots clean. Keep all working controls free of dust. Occasionally you may see sparks through the ventilation slots. This is normal and will not damage your power tool.

For Battery Tools

The ambient temperature range for the use and storage of tool and battery is 32 – 113°F (0 – 45°C).

The recommended ambient temperature range for the charging system during charging is 32 – 104°F (0 – 40°C).

STORAGE

1. Use only the manufacturer's recommended replacement parts and accessories.
2. Inspect and maintain the machine regularly. Have the machine repaired only by an authorized repairer.
3. When not in use, store the machine out of the reach of children.

TROUBLESHOOTING

Although your new grass trimmer is really easy to operate, if you do experience problems, check the following:

1. If grass trimmer will not operate
 - Check the battery pack assembly.
 - Charge the battery: running of the grass trimmer is dependent upon sufficient charge in the battery pack.

2. If the battery will not charge
 - Check to see if the battery is properly inserted the charger base, and make sure the indicator light is on; if not, check the plug and fuse connected with supply.

3. If the trimmer is not cutting properly
 - Check the condition of the cutting head, if the cutting line is too short, or if the cutting head is damaged.

Note:

Do not use damaged cutting head.

4. If a fault is suspected, return the trimmer to an authorized dealer for repair.

Note:

There are no user serviceable parts in the trimmer.

model number 399-8640-0

EXPLODED VIEW

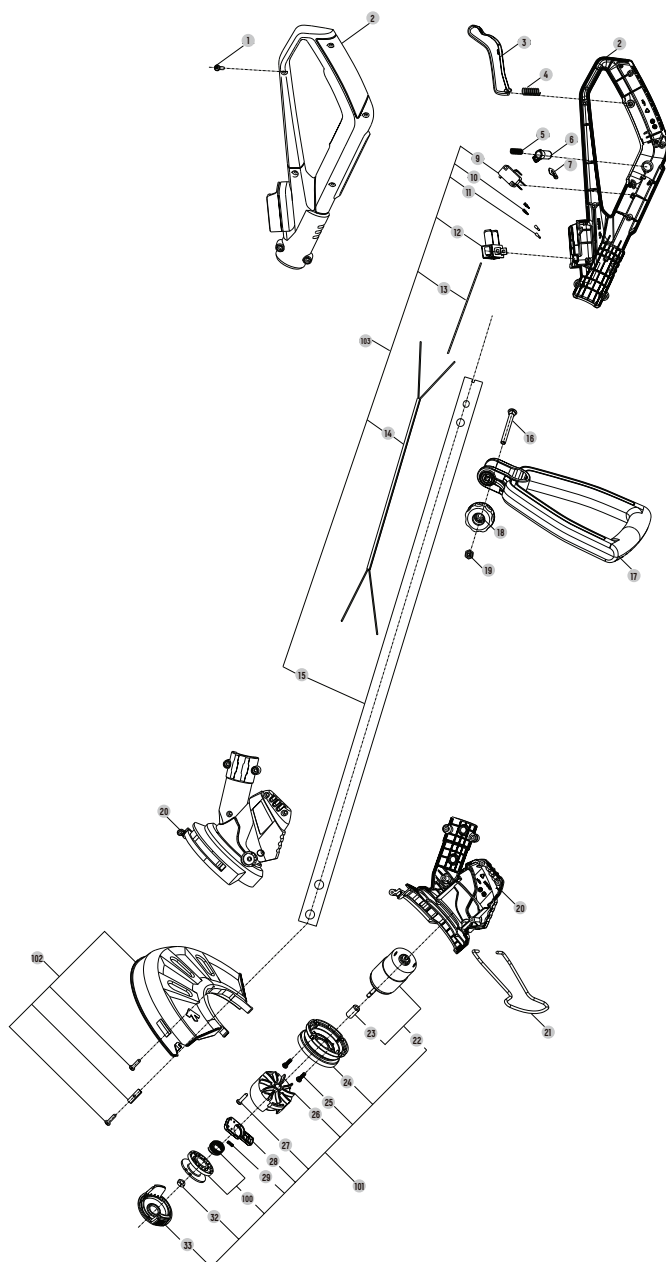

Item	Description	QTY.
1	Self-tapping Screw ST3.9X16	15
2	Left/Right Handle	1
3	Switch Button	1
4	Compression Spring	1
5	Compression Spring	1
6	Button	1
7	Linkage	1
9	Switch	1
10	Plug Bush	2
11	Connector Sheath	2
12	Terminal	1
13	Inner Wire	1
14	Coiled Cable	1
15	Heatgun Can	1
16	Bolt M6	1
17	Handle	1
18	Knob II	1
19	Nut M6	1
20	Left/Right Housing	1
21	Flower Guard Wire	1
22	DC motor	1
23	Adaptor Sleeve	1
24	Fixing Block	1
25	Screw Washer Assembly M4*12	2
26	Cutting Head	1
27	Self-tapping Screw ST3.2X16	1
28	Line Feeder	1
29	Compression Spring	1
32	Nut	1
33	Cutting Head Cover	1
100	Spool Clamp; Line	1
101	Motor Reel Assembly	1
102	Guard Assembly	1
103	Switch Unit	1

model number 399-8640-0

1-YEAR LIMITED WARRANTY

This CERTIFIED® product is guaranteed for a period of one (1) year from the date of original retail purchase against defects in workmanship and materials.

Subject to the conditions and limitations described below, this product, if returned to us with proof of purchase within the stated warranty period and if covered under this warranty, will be repaired or replaced (with the same model, or one of equal value or specification), at our option. We will bear the cost of any repair or replacement and any costs of labour relating thereto.

This warranty is subject to the following conditions and limitations:

- a) a bill of sale verifying the purchase and purchase date must be provided;
- b) this warranty will not apply to any product or part thereof which is worn or broken or which has become inoperative due to abuse, misuse, accidental damage, neglect or lack of proper installation, operation or maintenance (as outlined in the applicable owner's manual or operating instructions) or which is being used for industrial, professional, commercial or rental purposes;
- c) this warranty will not apply to normal wear and tear or to expendable parts or accessories that may be supplied with the product that are expected to become inoperative or unusable after a reasonable period of use;
- d) this warranty will not apply to routine maintenance and consumable items such as, but not limited to, lubricants, blades, fluids, tune-ups or adjustments;
- e) this warranty will not apply where damage is caused by repairs made or attempted by others (i.e., persons not authorized by the manufacturer);
- f) this warranty will not apply to any product that was sold to the original purchaser as a reconditioned or refurbished product (unless otherwise specified in writing);
- g) this warranty will not apply to any product or part thereof if any part from another manufacturer is installed therein or any repairs or alterations have been made or attempted by unauthorized persons;
- h) this warranty will not apply to normal deterioration of the exterior finish, such as, but not limited to, scratches, dents, paint chips, or to any corrosion or discolouring by heat, abrasive and chemical cleaners; and
- i) this warranty will not apply to component parts sold by and identified as the product of another company, which shall be covered under the product manufacturer's warranty, if any.

Additional Limitations

This warranty applies only to the original purchaser and may not be transferred. Neither the retailer nor the manufacturer shall be liable for any other expense, loss or damage, including, without limitation, any indirect, incidental, consequential or exemplary damages arising in connection with the sale, use or inability to use this product.

Notice to Consumer

This warranty gives you specific legal rights, and you may have other rights, which may vary from province to province. The provisions contained in this warranty are not intended to limit, modify, take away from, disclaim or exclude any statutory warranties set forth in any applicable provincial or federal legislation.

Made in China

Imported by Trileaf Distribution Trifeuil Toronto, Canada M4S 2B8