



**REDLINE**™/MC

## **REDLINE® STRYKER STUNT SCOOTER**

**This manual contains important safety, performance and maintenance information.**

**Read the manual before taking your first ride on your new scooter, and keep the manual handy for future reference.**



## TABLE OF CONTENTS

---

WARNING .....	4
RIDING INSTRUCTIONS .....	4
OPERATING INSTRUCTIONS .....	5
KNOW YOUR SCOOTER.....	5
ASSEMBLY INSTRUCTIONS .....	6
HOW TO USE .....	7
CARE INSTRUCTIONS .....	8
CLEANING YOUR SCOOTER .....	8

## **WARNING**

### **! AN IMPORTANT MESSAGE TO PARENTS:**

This manual contains important information. For your child's safety, it is your responsibility to review this information with your child and make sure that your child understands all warnings, cautions, instructions and safety topics. We recommend that you periodically review and reinforce the information in this manual with younger riders, and understand you are required to inspect and maintain your child's scooter to ensure their safety.

### **! GENERAL WARNING:**

Scooter riding can be a hazardous activity. Scooters are intended to move, and it is therefore possible to get into dangerous situations and/or lose control and/or fall. If such things occur, the user or third parties can be seriously injured or die. Like any other moving product, using a scooter can be a dangerous activity and may result in injury or death even when used with proper safety precautions. Use at your own risk and use common sense.

- Always wear safety equipment such as helmet, knee pads and elbow pads.
- Always wear closed shoes when riding your scooter.
- Obey all local traffic and scooter laws and regulations.
- Rider weight does not necessarily mean a child's size is appropriate to fit or maintain control of the scooter.
- A parent's decision to allow his or her child to ride this product should be based on the child's maturity, skill and ability.

## **RIDING INSTRUCTIONS**

- Scooters are meant to be used only in controlled environments free of potential traffic hazards and not on public streets. Do not allow your child to ride the scooter in any areas where vehicle traffic is present. Watch out for pedestrians.
- Do not use on wet, unpaved or uneven roads or other surfaces.
- Do not ride the scooter in wet weather. It will impair traction, braking, and visibility.
- Avoid sharp bumps, drainage grates, and sudden surface changes. The scooter may suddenly stop.
- Avoid excessive speeds that are associated with downhill rides.
- The brake will get hot from continuous use. Do not touch after braking.
- The child must maintain a hold on the handlebars at all times. Never allow more than one child at a time to ride a scooter.
- The scooter does not include any headlights or lights. It is therefore not suited for use at night or during periods when visibility is limited.
- Always inspect your scooter before riding and regularly maintain it.
- Do not exceed 176 lb (80 kg) total weight on the scooter.
- Do not allow children under age eight (8) to use the scooter. All children and pre-teens should ride with adult supervision at all times. Adult assembly required.

## OPERATING INSTRUCTIONS

### KNOW YOUR SCOOTER

**TO BEGIN**, remove contents from box. Inspect the contents of the box for scratches in the paint and/or dents that may have occurred during shipping.

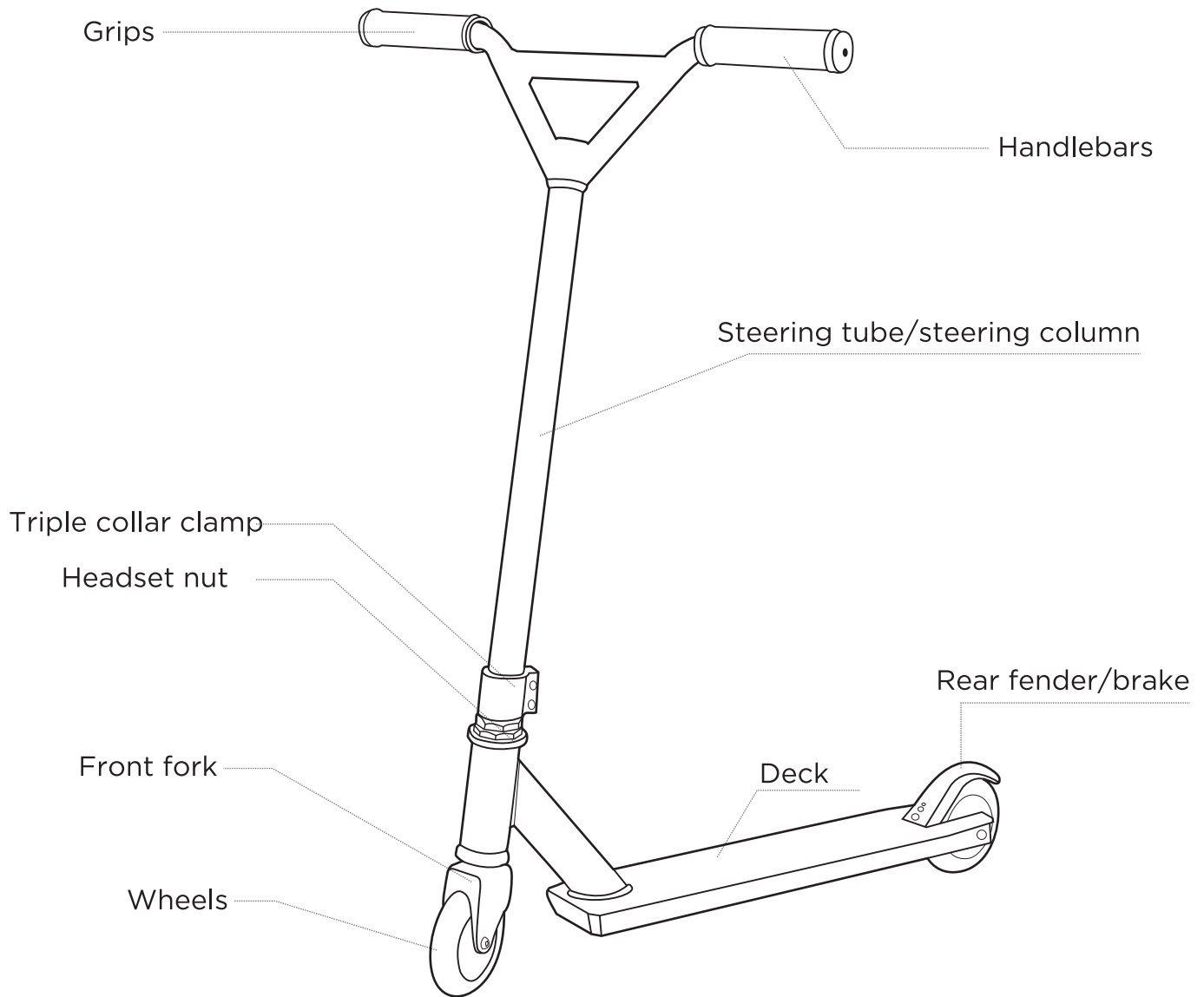

### ACCESSORIES INCLUDED:

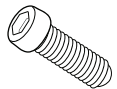

2 × M6 × 22 mm hex key bolts

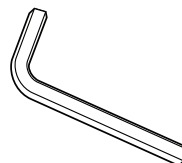

5 mm hex key

## ASSEMBLY INSTRUCTIONS

- Adults must assist children in the assembly and adjustment procedures.
- During these operations, be careful not to pinch your fingers in the hinge and locking system.

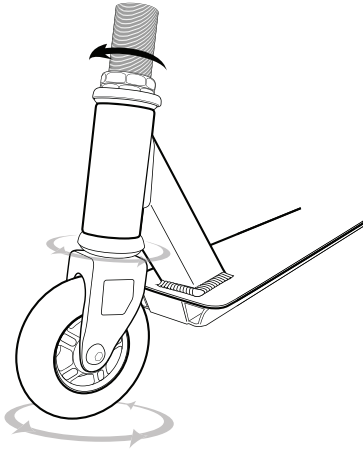

1. Tighten the headset lock nut to the point where the wheel spins freely but is firmly tightened to the headset. Ensure front wheel spins freely while head set nut is tightened.

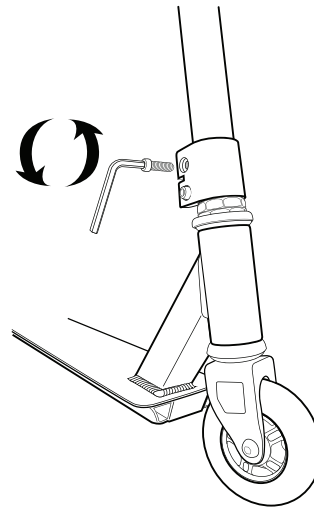

2. Remove the collar clamp bolts with the 5 mm hex key provided.

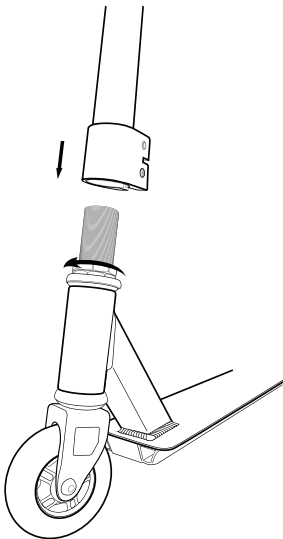

3. Push and thread the stem onto the body until it's up against the headset lock nut.

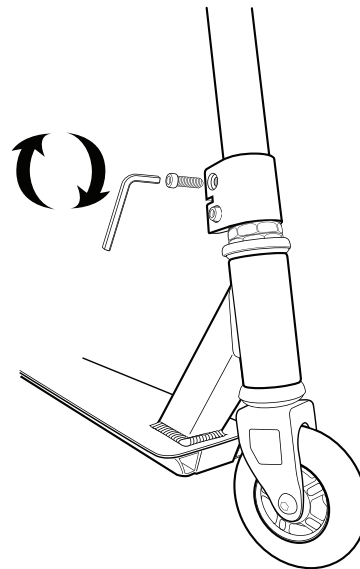

4. Re-insert collar clamp bolts. Ensure handlebars and front wheel are in line with each other, then tighten collar clamp bolts one by one from bottom to top, until all screws are securely tightened.

## HOW TO USE

- Grip the handlebars with your hands, place one foot on the deck and the other foot on the ground.
- Pay attention to your surroundings and make sure that your riding area is clear.
- Kick backwards with your foot beside the scooter to give you motion.
- Repeat this kicking action in order to stay in motion.
- To stop or slow down, place your kicking foot on the brake pedal above the rear wheel or put your kicking foot on the ground.
- Do not over-steer as this could cause you to fall off the scooter.

## REFLECTIVE STICKERS—IMPROVE YOUR SAFETY IN THE DARKNESS

For increased safety, reflective stickers have been included in the box. These high-visibility stickers will reflect light and provide better visibility of riders. See below for recommended placement.

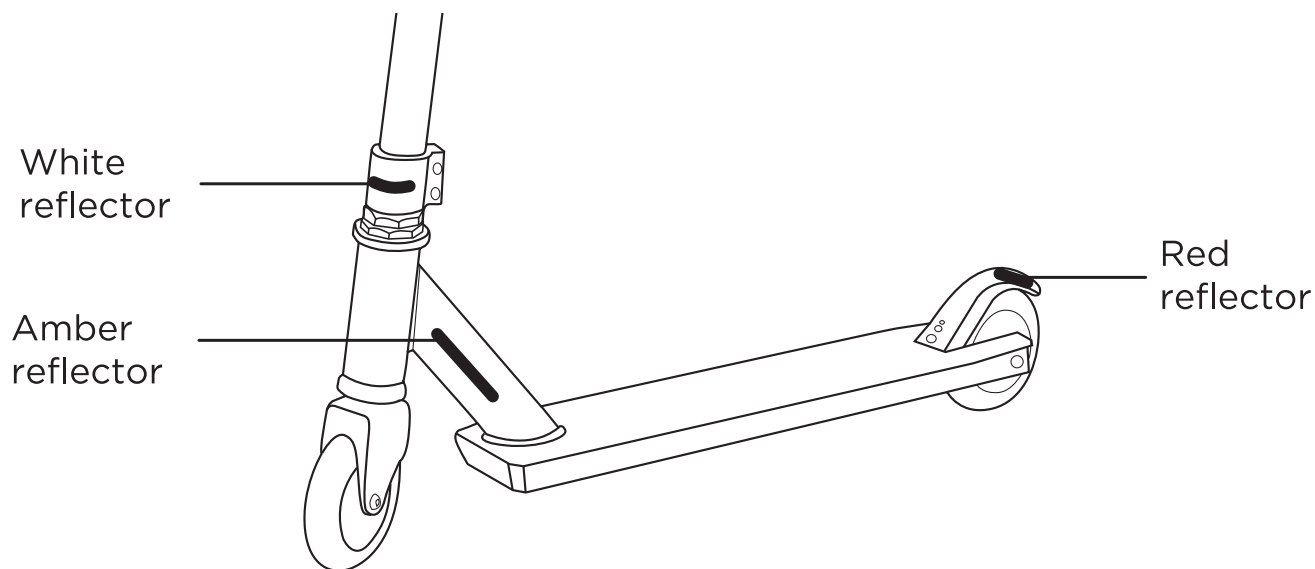

**NOTE: Always check all nuts, bolts, and screws to make sure they are secure for safe riding.**



## **CARE INSTRUCTIONS**

---

1. Please rotate the bearings and wheels to check if they are rolling smoothly.
2. It is suggested to disassemble, clean, and add lubricant every 6 months paying extra attention to the moving parts, clearing them of grit and dirt so they move freely. Please make sure the parts specifications are correct with the dealers if some parts need to be replaced.
3. Make sure the front fork and wheels are fixed tightly; you can use a wrench to tighten the locking nut properly. Use firm pressure but don't over-tighten.
4. The PU wheels may be worn out after some time of use, please replace with new PU wheels for a safe ride.
5. The wheels and wheel bearings can become worn after regular use and can be replaced easily. Remove the axle bolts with three hex keys and slide the wheel off its fork. Replace with the new item, screw in the bolt through the aligned fork and wheel then tighten securely with a hex key on either side.
6. Make sure all components are assembled and secured sturdily before each use.
7. Self-locking nuts and other self-locking pieces may lose their effectiveness over time. If any of these components are no longer functioning properly, it is strongly recommended that you discontinue use of the product and seek approved replacement parts.

### **BE CAREFUL**

You will see people on TV and maybe even people you know playing tricks and stunts. These are people who have been practicing on scooters for a very long time. Don't try something until you are ready. Avoid steep inclines and don't ride too fast—you can lose control and fall. Skateboard parks are not designed for scooters. Never ride in traffic or on the street, and watch your surroundings for pedestrians, bikers, boarders and skaters. Maintain a hold on the handlebars at all times.

## **CLEANING YOUR SCOOTER**

---

HAND WASH WITH COLD WATER AND A NEUTRAL SOAP. AIR DRY.

Wipe with a damp cloth to remove dirt and dust. Do not use industrial cleaners or solvents as they may damage the surfaces. Do not use alcohol, alcohol-based or ammonia-based cleaners as they may damage or dissolve the plastic components and soften the decals or decal adhesive.





**REDLINE**<sup>TM/MC</sup>

# **Built for Expression**

This product carries a one (1) year warranty against defects in workmanship and materials. REDLINE CANADA agrees to replace the defective product free of charge within the stated warranty period, when returned by the original purchaser with proof of purchase. This product is not guaranteed against wear or breakage due to misuse and/or abuse.

**Made in China / Fabriqué en Chine**  
**IMPORTED BY**  
**REDLINE CANADA TORONTO, CANADA M4S 2B8**