

CANVAS^{TM/MC}

RENFREW CONVERSATION SECTIONAL SET

PRODUCT NO. 088-2040-4

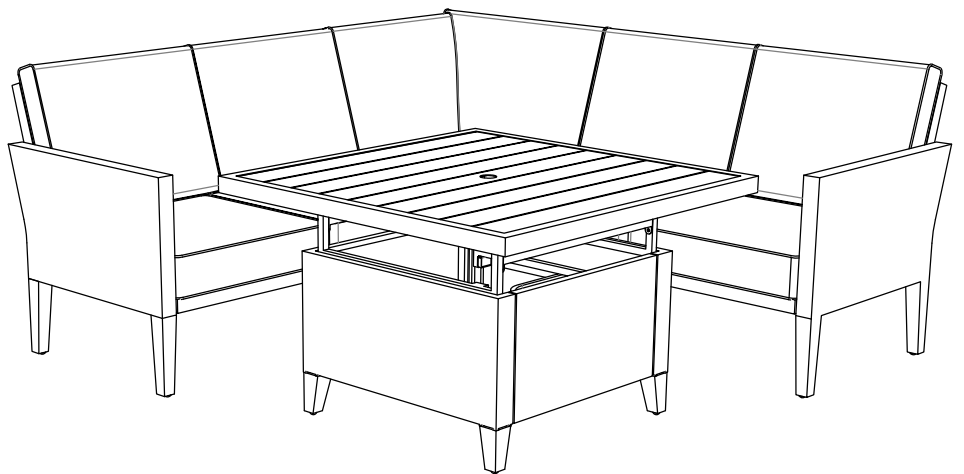

ASSEMBLY INSTRUCTIONS

Toll free: 1-888-670-6684

IMPORTANT: Please read and understand this manual before any assembly. Before beginning assembly of product, make sure all parts are present. Compare parts with packaging contents list. If any part is missing, or if you have any questions, contact the customer service department at 1-888-670-6684.

Made in China

IMPORTED BY TRILEAF DISTRIBUTION TRIFEUIL TORONTO, CANADA M4S 2B8

Table of Contents	3
Important Safety Instructions	3
Parts list - loveseat	5
Assembly - loveseat	6-7
Parts list-sofa	8
Assembly - sofa	9-10
Parts list-table	11
Assembly - table	12-14
Cleaning and Maintenance	16
Technical Data	16
Warranty	17



Warning! To reduce the risk of serious injury, read the following safety instructions before assembling and using these products.

Caution! Always keep children under close supervision while they are using or around these products.

Never leave children unattended.

- These products are intended for domestic outdoor use only.
- These products should be placed on flat, horizontal ground.
- Any assembly or maintenance of these products must be carried out by adults only.
- Arrange necessary manpower when assembling or moving these products.
- Some parts may contain sharp edges. Wear protective gloves if necessary.
- Keep children and pets away while setting up the table
- Check all nuts and bolts periodically for tightness. When required, tighten them again.
- Repairing and replacing parts should be done by a qualified technician.
- If these products will not be used for a long period (e.g. winter time), they should be stored in a clean, dry environment.
- Do not light any fires below or near these products!
- Retain the original packaging to store these products.

IMPORTANT: Retain for future reference, and read carefully.



CAUTION!

- The maximum weight capacity for the loveseat & sofa is 250 lb (113.39 kg) per seat. The maximum load for table is 44 lb (20 kg).
Do not stand on loveseat or sofa; do not sit or stand on table.
- Keep children away during assembly.
This product contains small parts which can be swallowed by children.
- Keep fingers away from the places where they can be pinched or trapped.
- Do not attempt to assemble the table if any parts are missing.



Let us help you!

DO NOT RETURN YOUR PRODUCT TO THE STORE. CALL US FIRST!

1-888-670-6684

If you have questions regarding your product, require warranty assistance, or have damaged or missing parts, please call our customer service toll-free helpline. Contact us for assistance; we're here to help.

Place all parts from the box in a cleared area and position them on the floor in front of you. Remove all packing materials and place them back into the box. Do not dispose of the packing materials until assembly is complete. Read each step carefully before beginning any assembly and make sure you understand each step. If you are missing a part, please call our toll-free number for assistance 1-888-670-6684.

Needed for assembly:



Hex key



Two people

1

Right arm panel-1

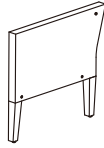

A

Screw with washer M6X20 - 1



2

Back panel-1

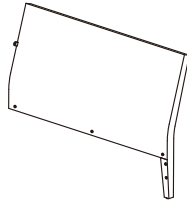

B

Screw with washer M6X40 - 7

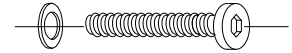

3

Seat panel -1

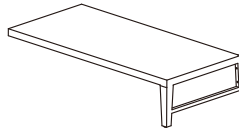

C

Hex key - 1



4

Back cushion -2

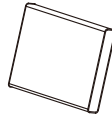

5

Seat cushion -2



6 PRODUCT NO. 088-2040-4

Note: Do not tighten screws all the way until you have assembled the loveseat.
Once assembly is complete, tighten each screw.

Step 1

Requires part 1, 3, B, C

Attach right arm (1) to the seat panel (3) by using M6X40 screw (B) with washers, aligning the holes. When assembled, tighten the screws with Hex Key (C).

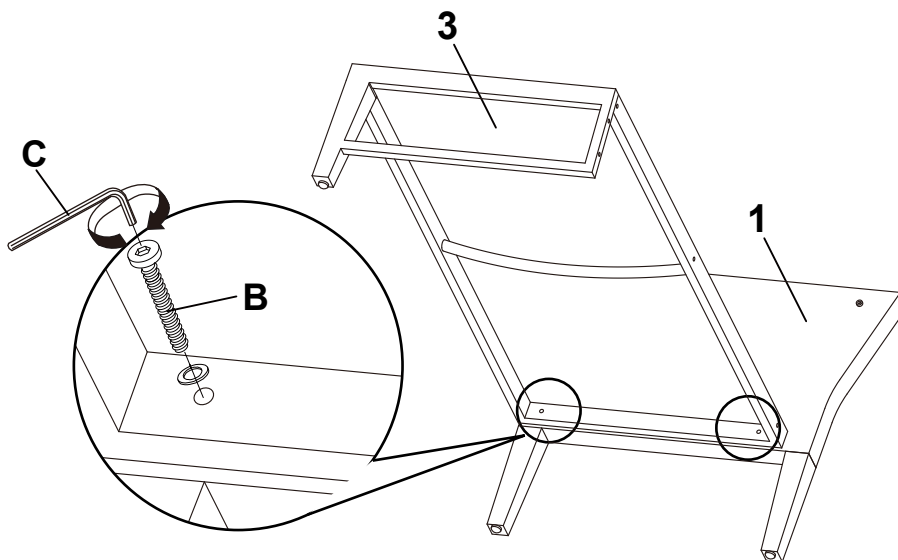

Step 2

Requires parts 2, 3, B,

Connect the back panel (2) to the seat panel (3), using the M6X40 screw (B) with washers, then tighten the screws with Hex Key (C).

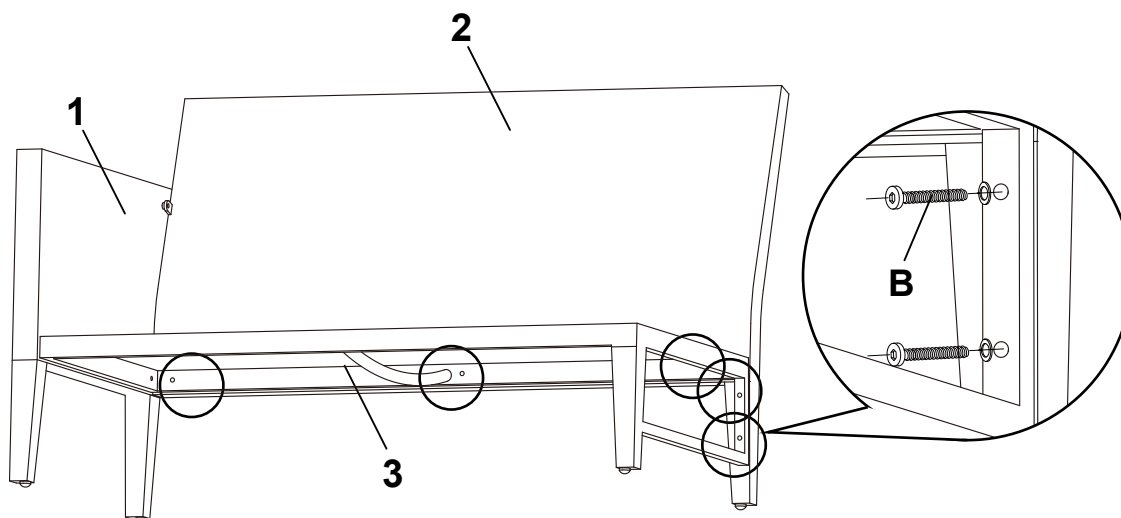

Step 3

Requires parts 1,2, A

Connect right arm (1) with back panel (2) by using M6X20 screw (A), then tighten the screws with Hex Key (C).

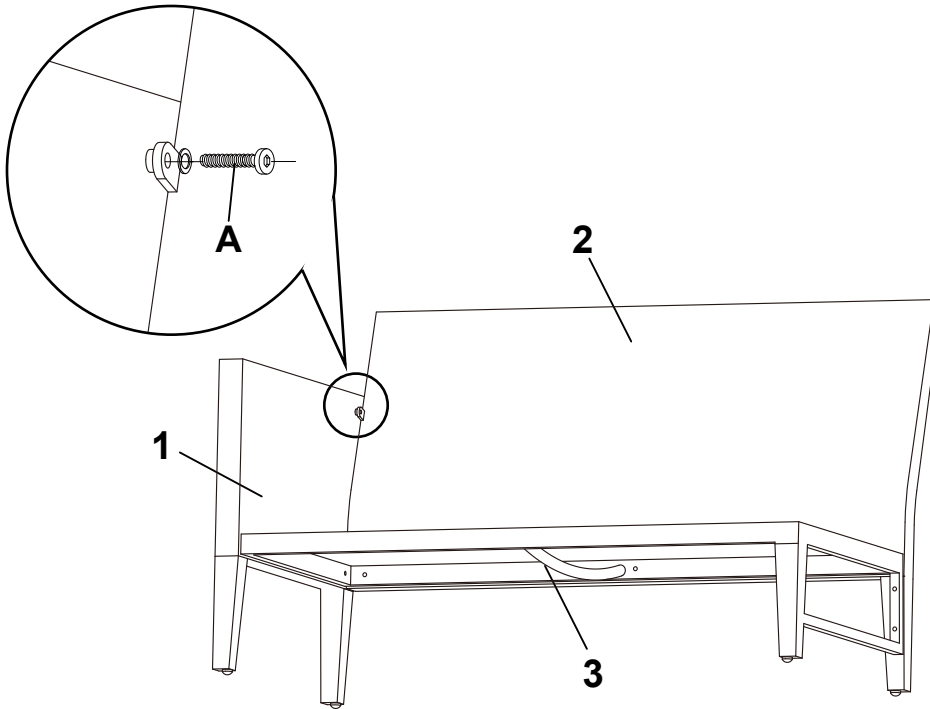
**Step 4**

Requires parts 4,5

Put the seat cushions (5) and back cushions (4) on the seat.

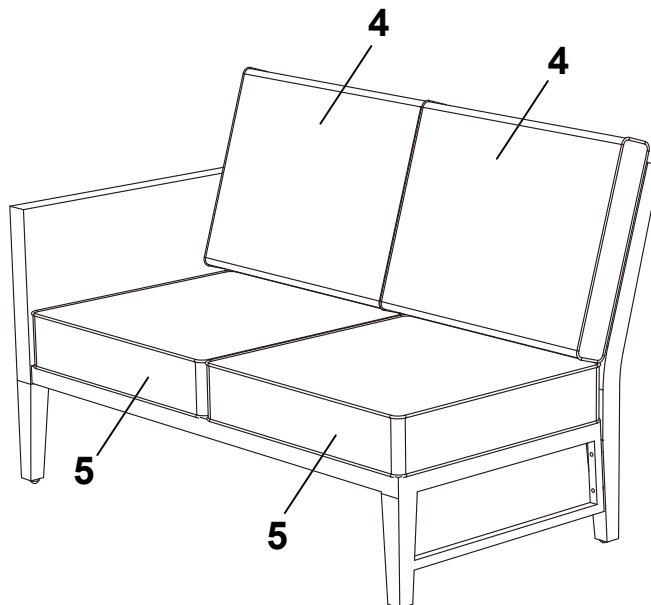

1

Right arm panel-1

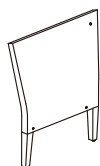

A

Screw with washer M6X20 - 6



2

Left arm panel-1

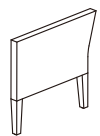

B

Screw with washer M6X40 - 8



3

Back panel-1

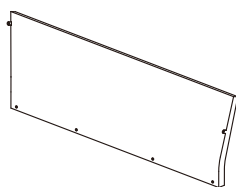

C

Hex key - 1



4

Seat panel-2

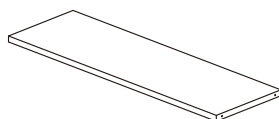

5

Middle leg-1



6

Longer Sectional back cushion -1

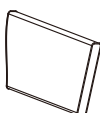

7

Shorter Sectional back cushion -1



8

Back cushion-2

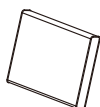

9

Seat cushion-3

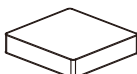

Note: Do not tighten screws all the way until you have assembled the sofa.
Once assembly is complete, tighten each screw.

Step 1

Requires part 2, 4, B, C

Attach left arm panel (2) to the seat panel (4), using the screws (B) with washers, aligning the holes. When assembled, tighten the screws with Hex Key (C).

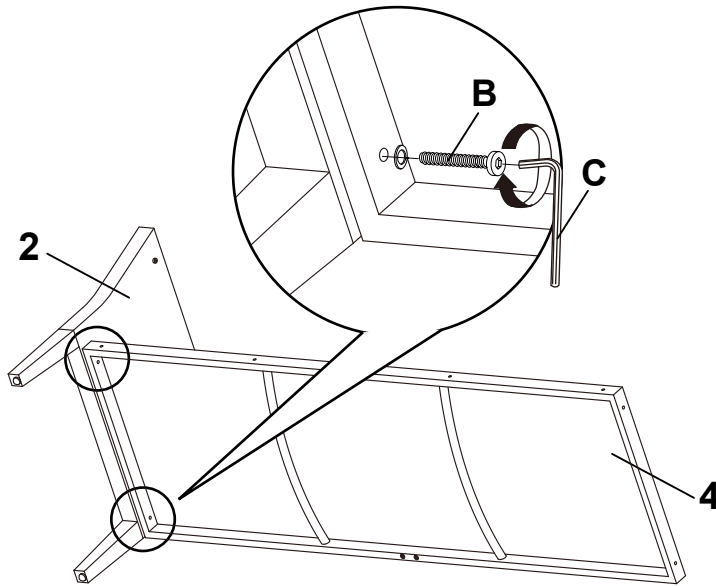

Step 2

Requires parts 2, 3, 4, A, B

Connect the back panel (3) to the seat panel (4), using the screw (B) with washers, then connect back panel (3) with left arm (2) by using screw (A) with washer, then tighten the screws with Hex Key (C)

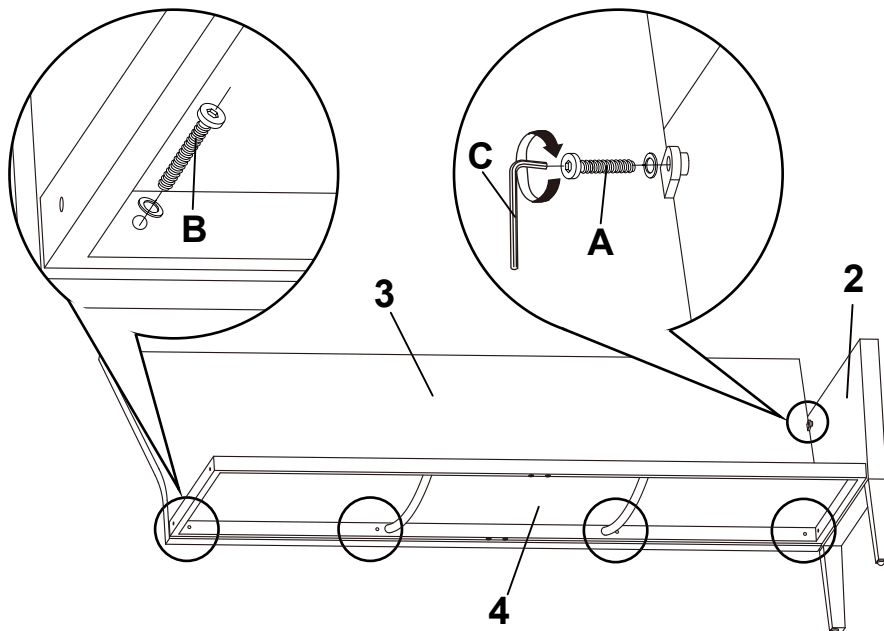

10 PRODUCT NO. 088-2040-4

Step 3

Requires parts 1,3,4,A,B

Connect right arm panel (1) to the seat panel (4) by using the screw (B), then connect back panel (3) to the right (1) by using screw (A). Then tighten the screws with Hex Key (C).

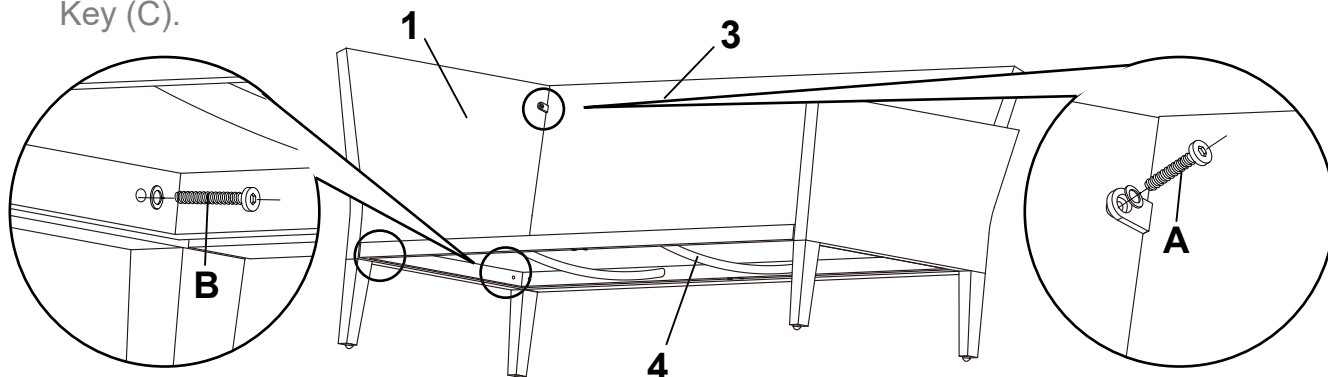

Step 4

Requires parts 4,5,A

Turn the sofa upside-down, then connect the middle leg (5) to the seat panel (4) by using M6X20 screws (A) with washers, then tighten the screws with Hex Key (C).

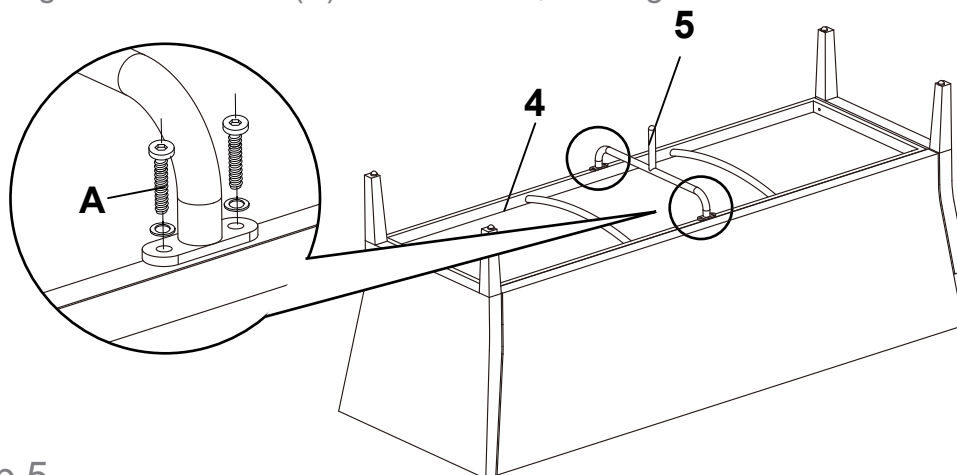

Step 5

Requires parts 6,7,8,9

Turn the sofa to upright position and put on seat cushions (9) and back cushions (6),(7),(8).

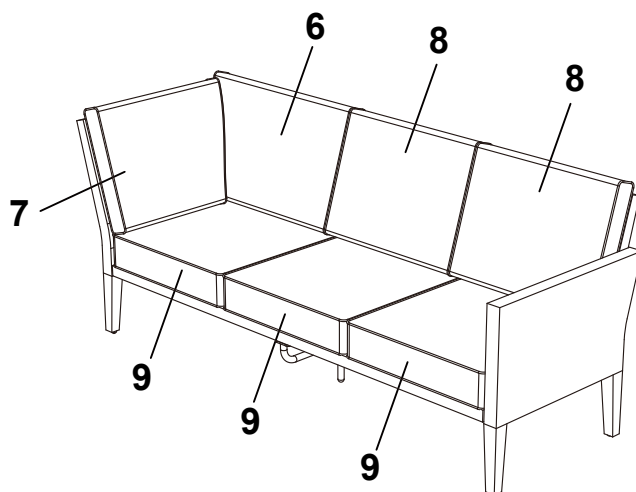

1

Table top-1

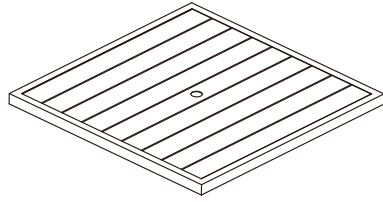

A

Screw with washer M6X20 - 16

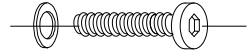

2

Inner support leg-2

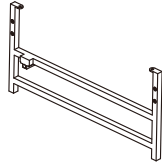

B

Screw with washer M6X40 - 8

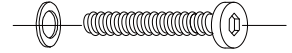

3

Connecting bar-2



C

Nut M8-4

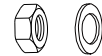

4

Base connecting bar-1

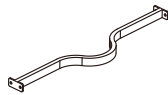

D

Hex key - 1



5

Longer side panel-2

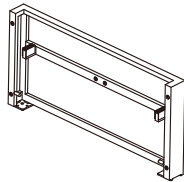

E

Wrench-1



6

shorter side panel-2

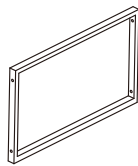

7

Table foot-4



12 PRODUCT NO. 088-2040-4

Note: Do not tighten screws all the way until you have assembled the table.
Once assembly is complete, tighten each screw.

Step 1

Requires part 2, 3, A, D

Connect two support legs (2) by two connecting bar (3), using M6X20 screw (A), aligning the holes. When assembled, tighten the screws with Hex Key (D).

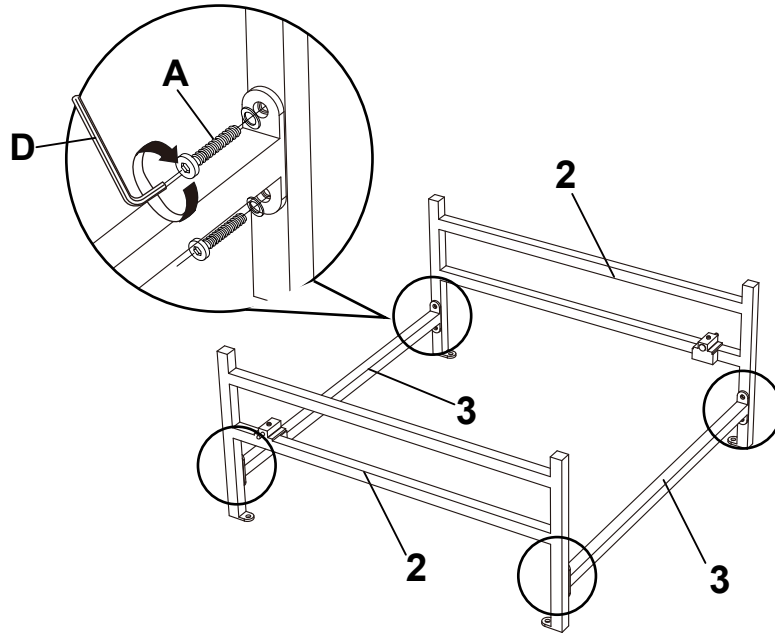

Step 2

Requires parts 1, 2, A, D

Connect the support leg (2) to the table top (1) by using the M6X20 screw (A) with washers, then tighten the screws with Hex Key (D).

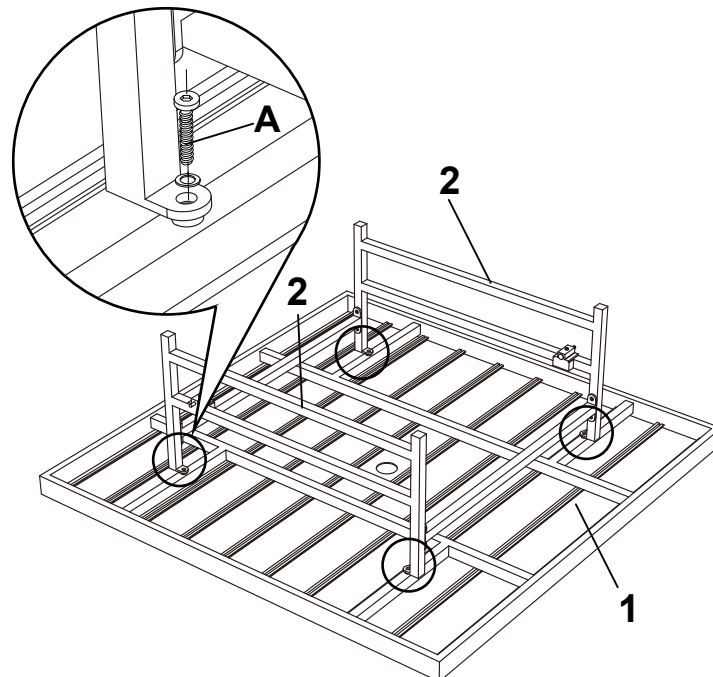

Step 3

Requires parts 4,5,6,A,B,

Connect the longer side panel (5) to two pieces of shorter side panel (6) by using M6X40 screw (B), then attach the base connecting bar (4) to the panel (5) by using M6X20 screw (A), then tighten the screws with Hex Key (D).

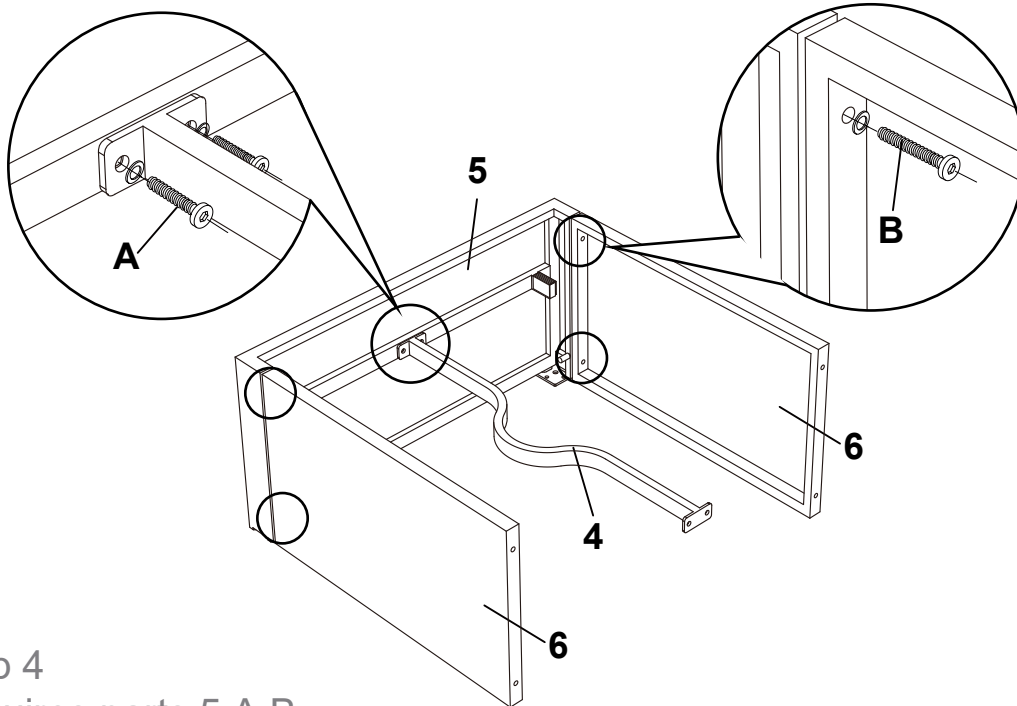
**Step 4**

Requires parts 5,A,B,

Connect the another longer side panel (5) to two pieces of shorter side panel (6) by using M6X40 screw (B), then attach the base connecting bar (4) to the panel (5) by using M6X20 screw (A), then tighten the screws with Hex Key (D).

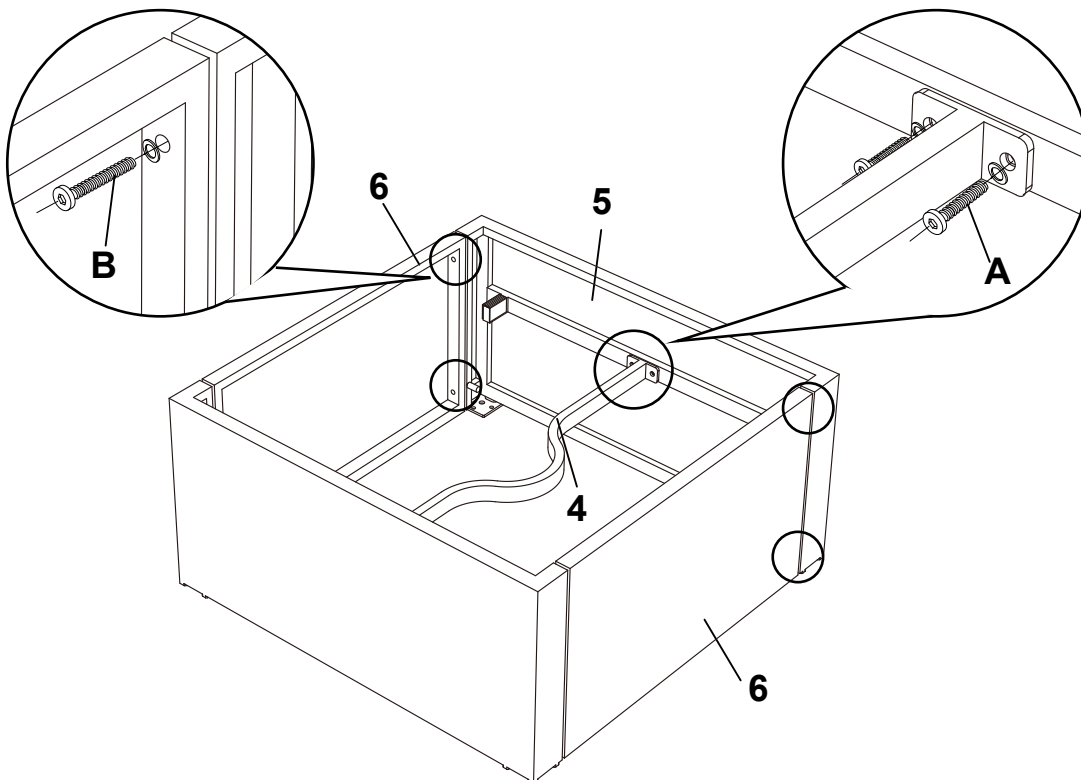

Step 5**Requires part 7, C, E**

Attach the table feet (7) to the table side panel, using the M8 nuts (C) with the help of wrench (E).

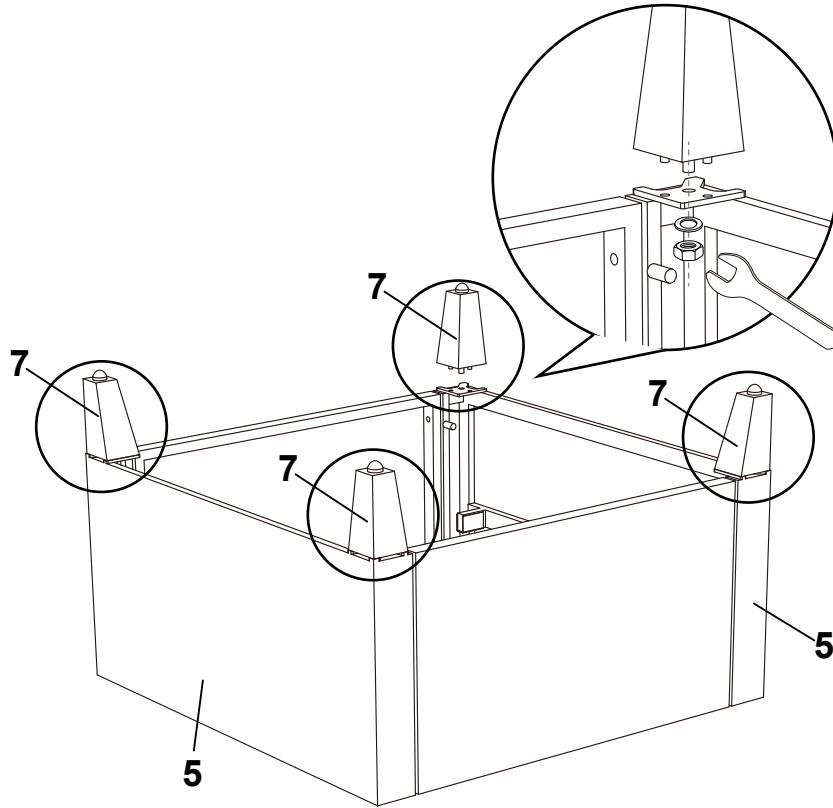
**Step 6**

Turn the table to the upright position, then insert the table top into the base panel, when the table is at the dining height, press two buttons (black) underneath to lock the support leg to keep it stable.

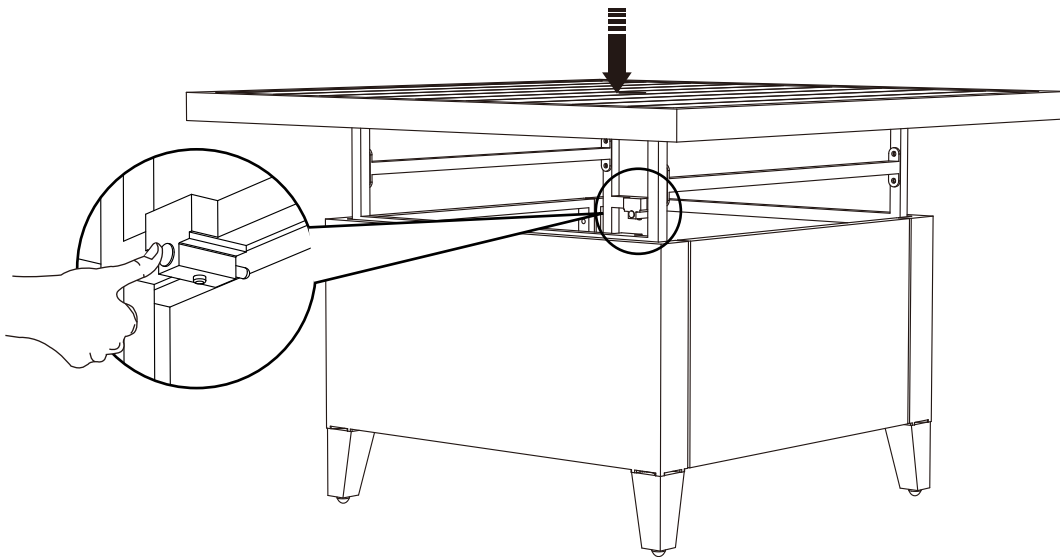

Step 7

To lower table, release the lock by pressing 2 red buttons underneath; have 2 people lift table top, rotate 90° and push down towards base.

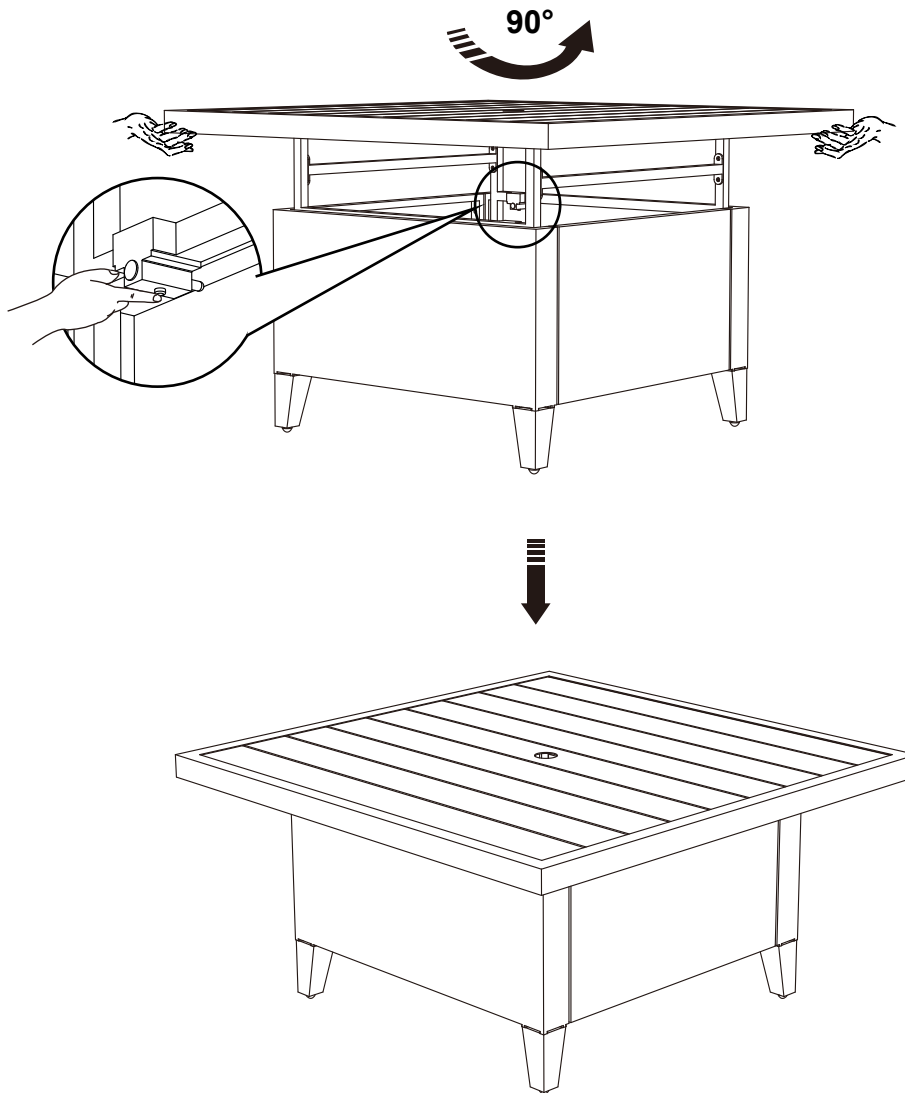



CAUTION!

- Check all screws and nuts periodically for tightness, tightening them again as required.
- Disassemble the table in the reverse order of the assembly steps. Always disassemble the table completely.

- Clean the product with a slightly damp cloth and a little detergent. Let it dry thoroughly.
- Do not use bleach, acid, or other abrasive cleaners on the cushions or frame parts.

Dimensions (L x W x H)

Loveseat: 50 x 29 15/16 x 31 7/8"

(127 x 76 x 81 cm)

Sofa: 79 1/2 x 29 15/16 x 31 7/8"

(202 x 76 x 81 cm)

Table: 39 15/16 x 39 15/16 x 19 11/16"

(101.4 x 101.4 x 50 cm)

Product weight

Loveseat: 45 lb 14 oz (20.8 kg)

Sofa: 69 lb 7 oz (31.5 kg)

Table: 63 lb 4 oz (28.7 kg)

This CANVAS product carries a one (1) year warranty against defects in workmanship and materials.

Trileaf Distribution agrees to replace the defective product free of charge within the stated warranty period, when returned by the original purchaser with proof of purchase. This product is not guaranteed against wear or breakage due to misuse and/or abuse.