

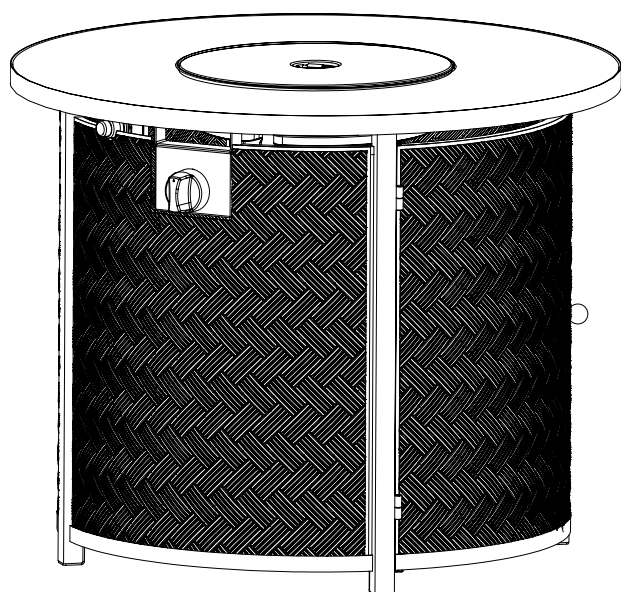

Tuscan Gas Fire Table

Model No. 085-1571-2



Design certified under ANSI
Z21.97 - CSA 2.41-(2014)
Requirements for Outdoor Gas
Fireplaces



DANGER

If you smell gas:

1. Shut off gas to the appliance.
2. Extinguish any open flame.
3. If odour continues, keep away from the appliance and immediately call your gas supplier or fire department.



WARNING

Do not store or use gasoline or other flammable vapours and liquids in the vicinity of this or any other appliance. An LP-cylinder not connected for use shall not be stored in the vicinity of this or any other appliance. If you are assembling this unit for someone else, give this manual to him or her to read and save for the future.



WARNING

For outdoor use only.



DANGER



CARBON MONOXIDE HAZARD

This appliance can produce carbon monoxide which has no odour.

Using it in an enclosed space can kill you.

Never use this appliance in an enclosed space such as a camper, tent, car or home.

Assembly Instructions

Toll-free: 1-877-483-6759

IMPORTANT: Please read this manual carefully before beginning assembly of this product.
Keep this manual for future reference.

Important Safety Instructions	3
Parts List	6
Assembly	7
Operation	13
Cleaning and Maintenance	14
Technical Specifications	14
Warranty	14



Warning! Please read and understand this entire manual before attempting to assemble, operate or install the product. Failure to follow the dangers, warnings and cautions contained in this instruction manual may result in a fire or explosion causing damage to property, serious bodily injury or death.

- The installation of this product must conform with local codes, or in the absence of local codes, with either the National Fuel Gas Code, ANSI Z223.1/NFPA 54, or CAN/CGA-B149.1, National Gas and Propane Installation Code.
- **FOR OUTDOOR USE ONLY!** This appliance shall be used only outdoors in a well-ventilated space and shall not be used in a building, garage, or any other enclosed area.
- **USE PROPANE GAS ONLY!**
- Use only with a propane gas tank (sold separately). Do not attach to a remote gas supply.
- Propane gas is not natural gas. Only use propane gas for this fireplace.
- The conversion or attempted use of natural gas in a propane unit or propane gas in a natural gas unit is dangerous and not recommended. Doing so may void your warranty.
- Never use charcoal or any other solid fuel in the fireplace.
- During ignition procedure, you should never get your face close to the burner as an unnoticed flame may light up and cause injury.
- **LP GAS WARNING:** Do not exceed 1/4" (6 mm) depth of pumice stones directly above burner holes. Applying too much media may result in unburned gas pooling in fireplace. Ventilation is required to allow fresh air into enclosure and for any residual gas to escape.
- If you see, smell or hear the hiss of escaping gas from the propane gas tank: 1. Disconnect propane gas tank. 2. Do not attempt to correct the problem yourself. 3. Contact your gas supplier and/or the fire department for help.
- Do not operate the fireplace if there is a gas leak present.
- Never use a flame to check for gas leaks.
- The maximum inlet supply pressure is 11" w.c. (2.74 kPa).
- The gas pressure regulator provided with the fireplace must be used.
- Use LP propane gas tanks only with these required measurements: 12" (30.5 cm) (diameter) x 18" (45.7 cm) (tall) with 20 lb (9 kg) capacity maximum.
- Propane tank used must include a collar to protect the propane gas tank valve.
- Never fill the propane gas tank beyond 80% full.
- Propane gas tank supply system must be arranged for vapour withdrawal.
- Do not use a propane gas tank with a damaged valve and any other worn out parts. A dented or rusty propane

IMPORTANT: RETAIN FOR FUTURE REFERENCE, AND READ CAREFULLY.

gas tank may be hazardous and should be checked by your gas supplier prior to use.

- Do not burn any other materials than are supplied with and intended for use in this fireplace.
- Pumice stones could hit somebody's face or eyes during initial start of this unit, so please keep away from the fireplace for the first 20 minutes after it has been ignited.
- Do not operate fireplace unless it is completely assembled and all parts are in place.
- Pay attention when operating the fireplace. It is hot when in use and should never be left unattended. Do not move it while in operation.
- Do not use this fireplace for cooking.
- Do not put any other fireplace cover or anything flammable on, beneath or around the fireplace.
- Users should be alerted to the hazards of high surface temperatures and keep a safe distance to avoid burning or clothing ignition.
- Do not sit on the fireplace. Do not rest feet or hands on the fireplace.
- Never lean over the open fireplace or place hands or fingers on the upper portion of an operational unit.
- Keep any electrical supply cords and the fuel supply hose away from any heated surfaces.
- Combustible materials should never be within 6' (1.8 m) of the top, or within 4' (1.2 m) of the back or sides of the fireplace.
- This fireplace must be attended at all times!
- Should the fire go out while burning, turn the gas valve off. Follow the instructions, and wait five minutes before attempting to relight.
- Do not use this fireplace if any part has been under water.
- Do not pour water into fireplace.
- Immediately call a qualified service technician to inspect the appliance and to replace any part of the control system and any gas control which has been under water.
- Do not light or use gas unit if pumice stones are wet. Ensure pumice stones are completely dry before igniting as intense heat could cause the stones to crack or pop.
- Do not attempt to disconnect the gas regulator or any gas fittings while your fireplace is in operation.
- Do not handle fireplace until it is shut off and completely cooled.
- The propane gas tank must be disconnected when fireplace is not in use.
- Do not store a spare or disconnected propane gas tank under or near this fireplace, or in the vicinity of any other appliance.
- If the fireplace is stored indoors, detach and leave propane gas tank outdoors.
- Do not enlarge valve orifices or burner ports when cleaning the valve or burner.
- Do not use this fireplace on vehicles or boats. Always operate the appliance on flat ground outdoors.
- After a period of storage and/or non-use, the propane fireplace should be checked for gas leaks and burner obstructions before use.
- The propane fireplace should never be used by children. Children must be supervised when they are anywhere near the appliance.
- Please keep gas tank a minimum of 5' (1.5 m) away from fireplace when lit.
- The maximum gas supply pressure is 250 PSI.
- Clothing or other flammable materials should not be hung from the appliance, or placed on or near the appliance.
- **Any guard or other protective device removed for servicing the appliance must be replaced prior to operating the appliance.**
- **All installation and repair should be done by a qualified service person. This appliance should be inspected annually. More frequent cleaning may be required as necessary. It is imperative that the control compartment, burners and circulating air passageways of the appliance be kept clean.**
- Inspect the burner before each use of this fireplace. If there is evidence of damage, the burner must be replaced prior to use of this fireplace.

- Inspect the hose before each use of this fireplace. If the hose shows signs of cracks, abrasion, cuts or damage, do not use this fireplace. Fix the hose as required before using appliance.
- Remove the hose out of pathways where it may be tripped over or subject to accidental damage.
- **Children and adults should be alerted to the hazards of high surface temperatures and should stay away to avoid burns or clothing ignition.**
- **Young children should be carefully supervised when they are in the area of this appliance.**
- The LP gas supply tank must be constructed and marked in accordance with the specifications for LP gas tanks of the U.S. Department of Transportation (DOT) or the National Standard of Canada CAN/CSA-B339, LP gas tanks, spheres and tubes for the Transportation of Dangerous Goods; and Commission.
- The LP gas tank must have a listed overfill prevention device (OPD) and a QCCI or Type I, (CGA810) LP gas tank connection.
- Allow fireplace to cool completely before placing on lid.
- **DO NOT** use fireplace while lid is installed. Always remove the lid while fireplace is in use.

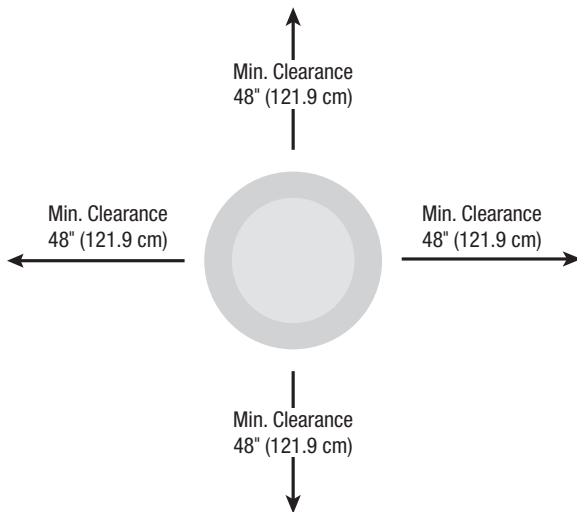

Combustible materials should not be within 72" (183 cm) of the top of the unit, or within 48" (122 cm) around the entire unit.
KEEP 72" (183 cm) AWAY FROM ALL BUILDINGS WHEN IN USE.

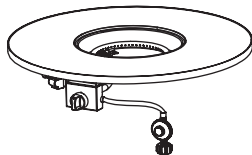
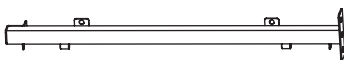
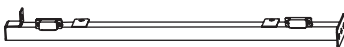
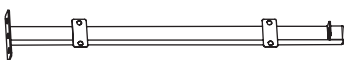
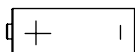
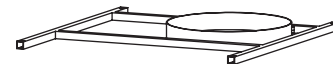
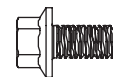
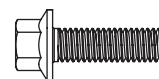
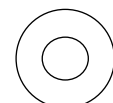
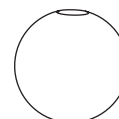
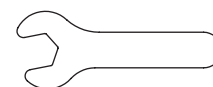
1Lid - **1****2**Tabletop - **1****3**Side Panel - **2****4**Door - **1****5**Front Panel - **1****6**Right Front Leg - **1****7**Right Back Leg - **1****8**Left Leg - **2****9**AAA Battery - **1****10**Lava Rocks - **1 box****11**Metal Stand - **1****A**M6 x 10 Screw - **20****B**M6 x 20 Screw - **4****C**M6 x 10 Screw - **1****D**M6 Washer - **1****E**Door Knob - **1****F**Nut - **4****G**Wrench - **1**



Let us help you!

DO NOT RETURN YOUR PRODUCT TO THE STORE. CALL US FIRST!

1-877-483-6759

If you have questions regarding your product, require warranty assistance, or have damaged or missing parts, please call our customer service toll-free helpline. Contact us for assistance; we're here to help.

IMPORTANT: Please read and understand this manual before any assembly. Before beginning assembly of product, make sure all parts are present. Compare parts with packaging contents list. If any part is missing, or if you have any questions, contact the service centre at 1-877-483-6759.

Place all parts from the box in a cleared area and position them on the floor in front of you. Remove all packing materials and place them back into the box. Do not dispose of the packing materials until assembly is complete. Read each step carefully before beginning any assembly, and make sure you understand each step. If you are missing a part, please call our toll-free number for assistance: 1-877-483-6759.

Step 1

Requires 2

Unpack and identify all parts using the parts list provided. Check each part before using the product. Make sure the gas supply system is turned "OFF" before assembling.

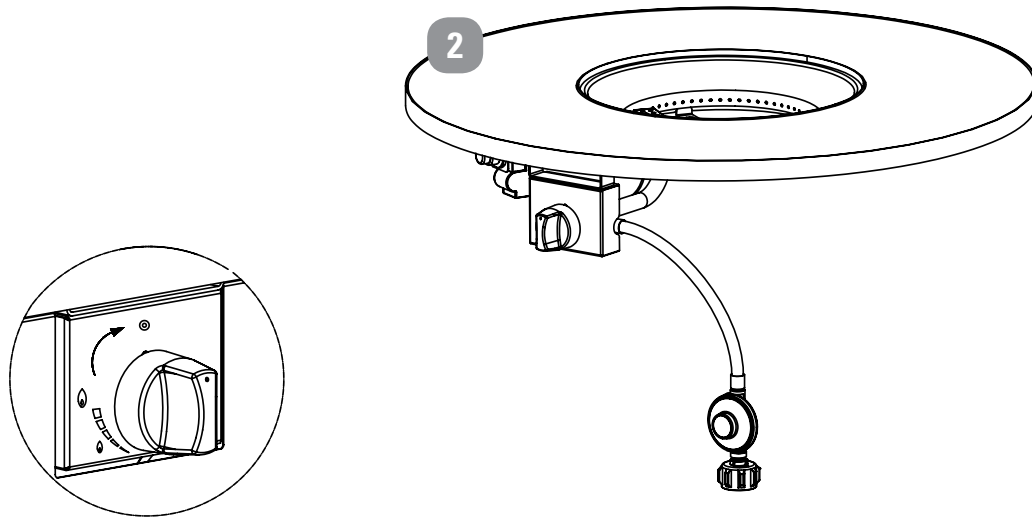

Step 2

Requires 6, 7, 8, 11, B

Attach right front leg **6**, right back leg **7** and both left legs **8** to the metal stand **11** using four M6 x 20 screws **B** and four nuts **F**.

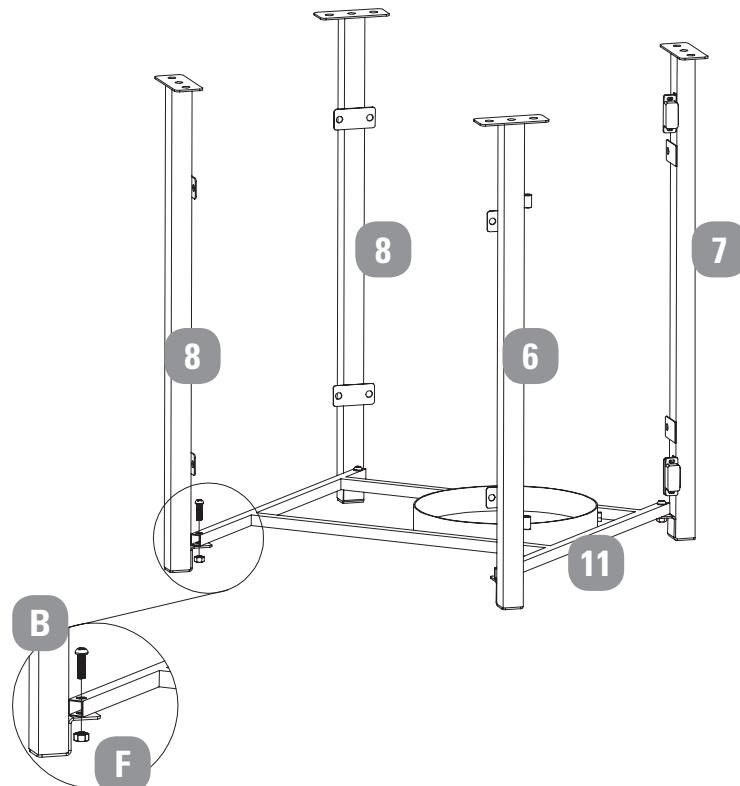

Step 3

Requires **3, 5, A**

Attach the two side panels **3** and front panel **5** to the legs using twelve M6 x 10 screws **A**.

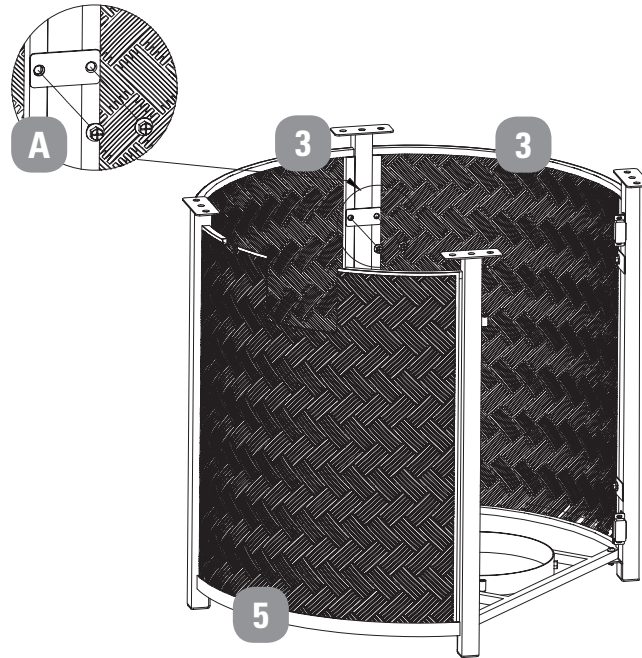

Step 4

Requires **2, A**

Attach steel base to the bottom part of the tabletop **2** using eight M6 x 10 screws **A**.

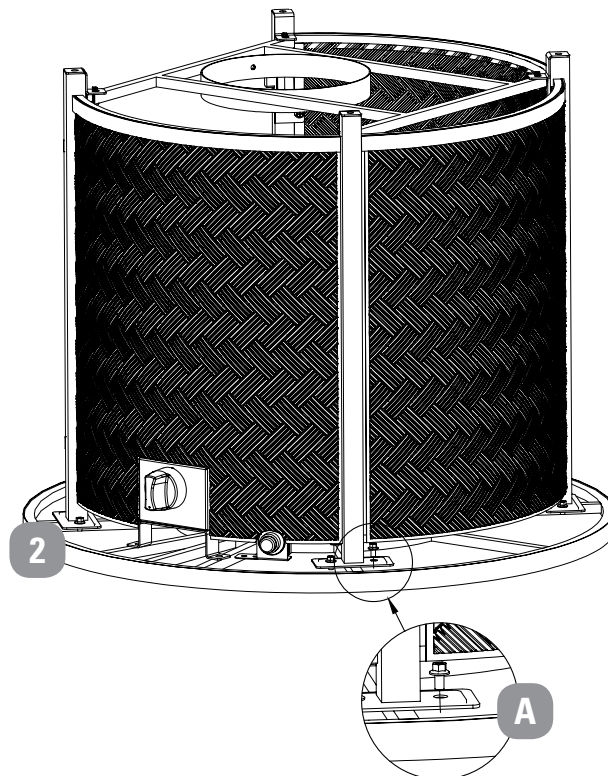

Step 5**Requires 4, 6, C, D, E**

Insert the door **4** to the right front leg **6** and attach door knob **E** to the door using one M6 x 10 screw **C** and washer **D**.

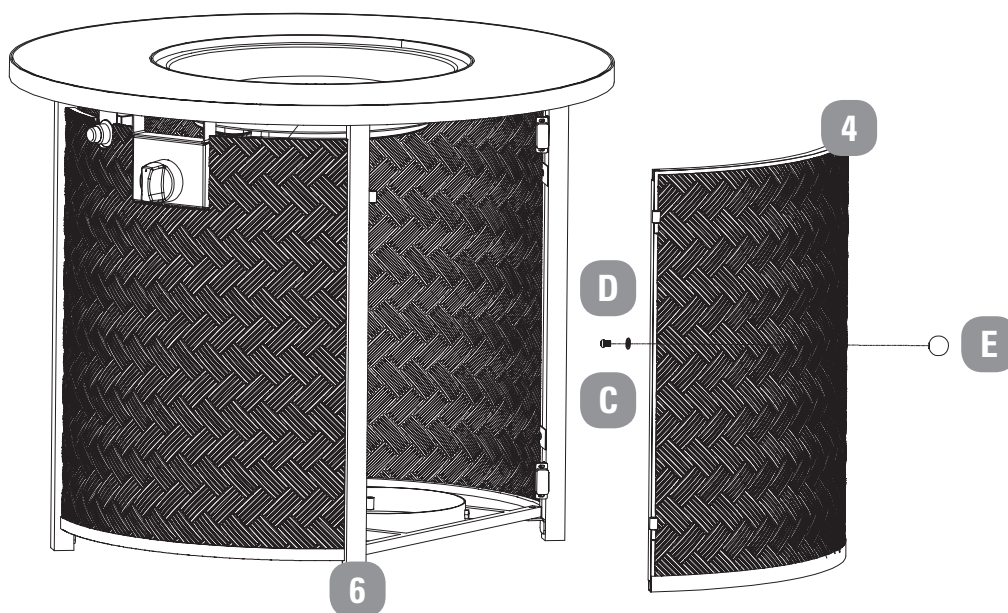
**Step 6**

Attach hose regulator tightly to the bracket on the inside of the table body.

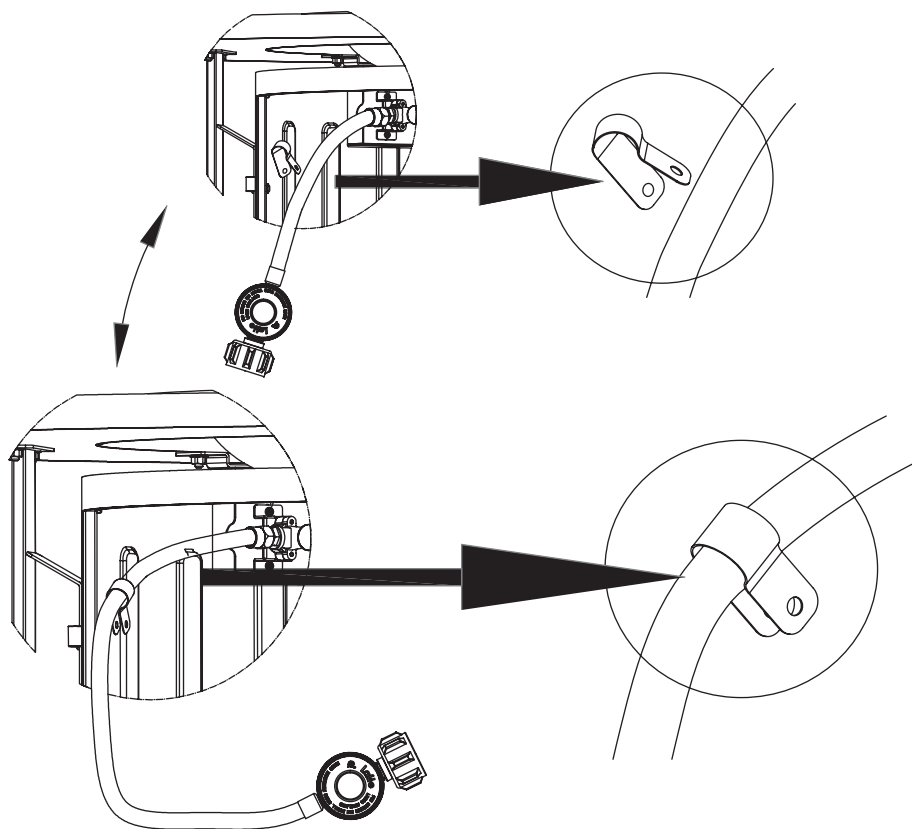

Step 7

Requires 11

Place propane gas tank (not included) into the metal stand **11**. Make sure the gas tank sits on the metal stand **11** completely. Turn the preassembled wing screw on the outer part of metal stand **11** clockwise to secure the propane gas tank tightly.

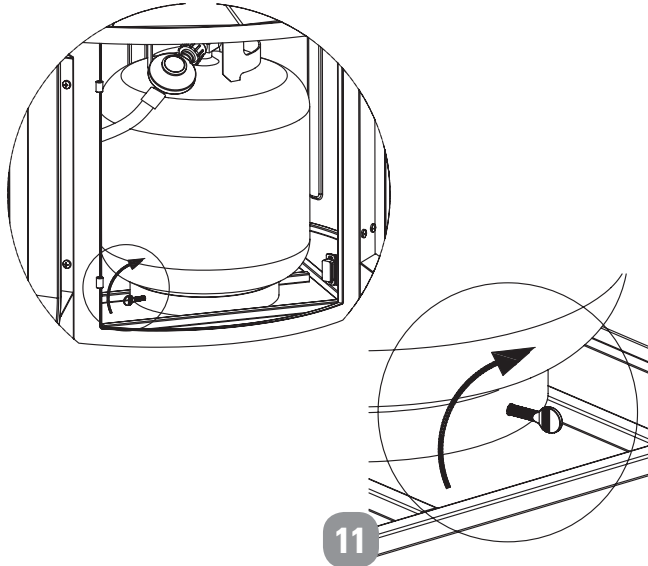

Step 8

Turn the cylinder valve on the tank clockwise to connections by hand only. Attach the preassembled regulator from the tabletop to the cylinder valve by turning the regulator coupling nut clockwise. Make sure it is fastened securely and tighten connections by hand only.

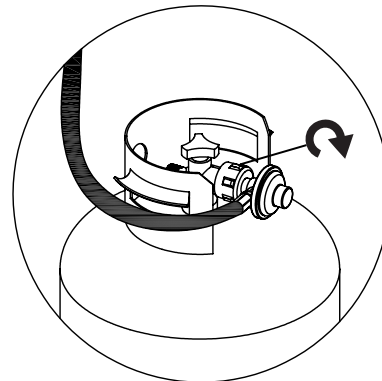
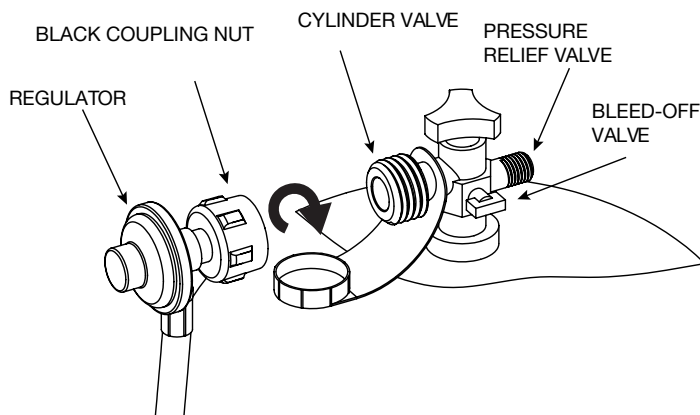

Step 9

Requires 9

Remove the rubber cap on the electronic igniter by unscrewing and slide battery **9** into the battery slot. Make sure the positive side of the battery faces outwards. Screw the electronic igniter cap over the battery tightly.

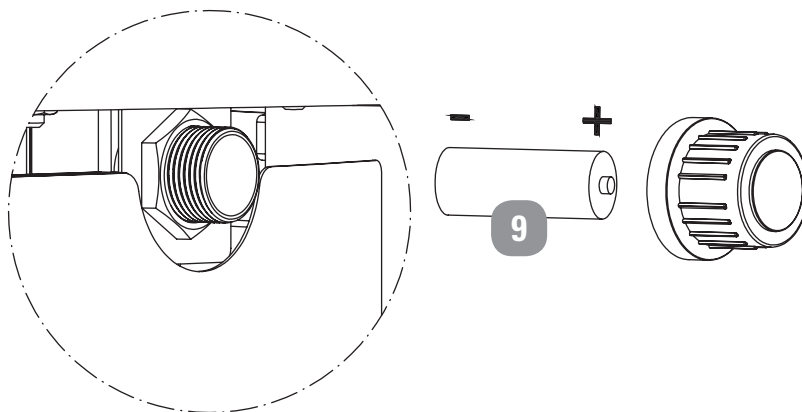

Step 10

Requires 2, 10

Place the lava rocks **10** evenly in the burner area **2** on the top of the fire table.

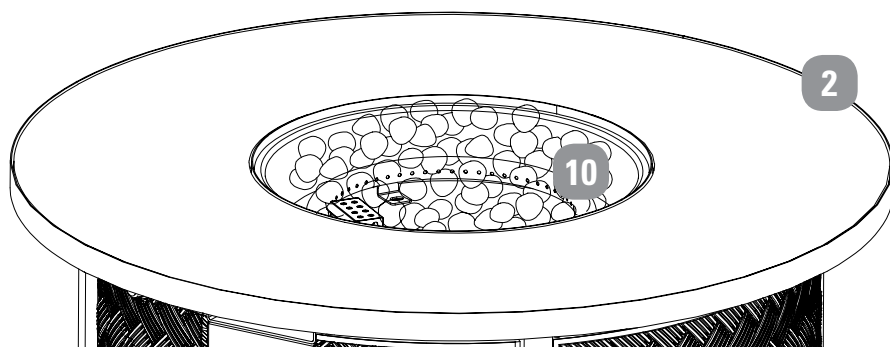

Warning! The screen in this heating unit **MUST** be clear and free of obstructions at all times to ensure proper operation. Make sure the burner area is completely covered with lava rocks or the flame may extinguish occasionally.

CORRECT

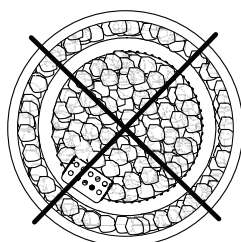
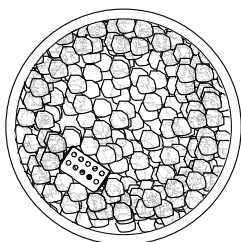

INCORRECT

Before performing a leak test, be sure that no sparks can occur and you are in a spacious outdoor area. Connect the propane gas tank to the regulator and turn the valve on the unit to the “OFF” position. Brush a soap and water mixture on all connections. Turn the gas supply on; if bubbles occur on any connection there may be a leak. If you smell gas or a leak is discovered turn the gas valve off, disconnect propane gas tank and do not use the appliance until the leak is repaired.

Do not use the heating unit without inspecting the gas hose. If there are signs of wear or abrasion you must replace the hose (if applicable). Pumice stones/lava rocks/LavaGlass® could pop up and strike somebody’s face during the process of lighting this unit; stand away from the unit for the first 20 minutes after igniting. Flame height should be a yellow/blue colour between 2 to 10” (5 to 25 cm) in height. Wait 5 minutes after extinguishing flame prior to placing a lid (if applicable) or protective cover on heating item.

To Light

1. Make sure the ignition control knob is in the “OFF” position.
2. Open the door **4** and slowly open the valve on the propane gas tank by turning the knob counter-clockwise.
3. Close the door **4** on the body.
4. Push the ignition control knob in and turn counter-clockwise to the “HIGH” position. This will ignite the fuel.
5. If ignition doesn’t occur within a few seconds, release the ignition control knob and rotate to the “OFF” position. Wait for 5 minutes for gas to clear and then repeat the above lighting instructions.
6. Once the fire product is lit, the fame intensity may be controlled by turning the ignition control knob between the “LOW” and “HIGH” positions.

To Extinguish

1. Turn ignition control knob clockwise to the “HIGH” position; let the knob pop up and continue turning the ignition control knob to the “OFF” position.
2. Close the cylinder valve on the propane gas tank if you don’t intend to use it for a long time.

- Disconnect propane gas tank from appliance before performing any maintenance.
- Store the fire table in a cool, dry place away from direct sunlight.
- The propane cylinder must be disconnected and removed from the heating unit before the appliance can be stored indoors.
- Make sure both the gas and the heating unit are turned off before changing battery. Please refer to the process of installing the battery.
- Use manufacturer-approved or supplied replacement parts and accessories only. Otherwise, you may void the warranty of this product and result in a hazardous condition.
- Keep the fire table free and clear from combustible materials.
- Visually inspect burner for obstructions. Keep fire table free and clear from debris.
- After the burner and lava rocks are completely cooled down, use a soft cloth to get rid of mild stains, loose dirt and soil.
- Battery replacement: use AAA alkaline batteries.
- Installation; Check the product prior to placing the cover on to ensure that there are no sharp objects or corners that could stress or damage the protective cover.

Dimension	30 x 30 x 24 1/4"
	76.2 x 76.2 x 61.5 cm
Product weight	58 lb 13 oz
	26.8 kg

This For Living product carries a one (1) year warranty against defects in workmanship and materials. Trileaf Distribution agrees to replace the defective product free of charge within the stated warranty period, when returned by the original purchaser with proof of purchase. This product is not guaranteed against wear or breakage due to misuse and/or abuse.

