

11 x 11'

OneTouchTM Screen House

Product No. 076-6534-2
Model No. CTCXP1111SL-2

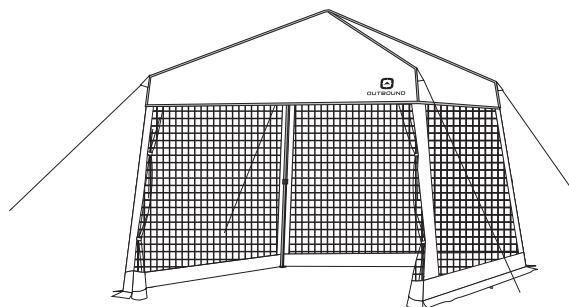

SPECIFICATIONS



| | |
|---------------|-------------------------|
| Floor size | 3.4 x 3.4 m (11' x 11') |
| Centre height | 2.8 m (110") |
| Weight | 20.3 kg (44 lb 11 oz) |

SAFETY



DANGER!

- Stoves, lanterns, candles, grills, heaters and other fuel-burning devices produce carbon monoxide and will consume the available oxygen in a tent. Use of such devices in a tent may cause asphyxiation, carbon monoxide poisoning, and death or serious and permanent injuries. For this reason:
 - DO NOT use fuel-burning devices inside or near this product.
 - Your failure to follow this warning may cause death or serious and permanent injury to you or others.

WARNING!

- **KEEP ALL FLAME AND HEAT SOURCES AWAY FROM THIS SHELTER.** This shelter is not fireproof. The fabric will burn if left in continuous contact with a flame source. The application of any foreign substance to the fabric may render the flame-resistant properties ineffective.
- Do NOT use candles, matches or other open flames in or near a shelter. Exercise extreme caution: keep appliances away from the shelter fabric. Do NOT leave them unattended. Turn them off before going to sleep. Make sure the shelter is well ventilated at all times to avoid suffocation. Build campfires downwind and several metres away from a shelter. Extinguish campfires before leaving a campsite or going to sleep. Do NOT fuel lamps, heaters or stoves in a shelter. Do NOT smoke in a shelter. Do NOT store flammable liquids in a shelter. Keep exits clear. Do NOT apply any foreign substance to a shelter. It may diminish the flame resistant properties of shelter material(s). Follow manufacturer's instructions for safe appliance use.
- Anchor properly at all times and carefully consider campsite choice. Be aware of possible falling rocks or tree limbs, lightning strikes, flash floods, strong winds and other hazards which may cause harm to this product or its occupants.
- Have a minimum of two adults for assembly. During assembly, poles are under tension. If not held firmly in place during assembly, poles could break or flip up, possibly causing serious injury.
- Exercise care when using electric devices in and near tents.
- This product is intended for temporary day use and activities including camping, picnicking, and day tripping. This product is not intended as a semi-permanent shelter.

INSTRUCTION MANUAL



HAVING TROUBLE?
CALL US: 1-888-280-7876
hkdglobal.net/contact-us

IMPORTANT: Please read this manual carefully before assembly of this product. Keep for future reference.

BEFORE YOU GO...



TIPS:

- Research the area where you intend to camp. Prepare for any possible weather condition. Be aware of hazards and emergency protocol. Know the rules and regulations.
- Check out your equipment before your trip. Be sure your cook stove, lanterns, flash lights, air mattress, etc., are in good working order. Erect your tent to become familiar with setup. Once you've assembled your tent in a dry, well-ventilated area, apply seam sealing compound to the stitching of the inside seams following manufacturer's directions. Allow to dry thoroughly before storage. Reapply annually.

ASSEMBLY INSTRUCTIONS



IMPORTANT NOTE BEFORE ASSEMBLY:

- Assemble your screen house before camping to become familiar with the assembly.
- Two people are recommended for setup.
- Select a clean, level area for your campsite, free of debris and sharp objects, and away from any natural water source.
- To prevent damage to the zippers, unzip the doors and windows of the screen house prior to disassembly.

1 VERIFY PACKAGE CONTENTS

- Canopy: 1 each

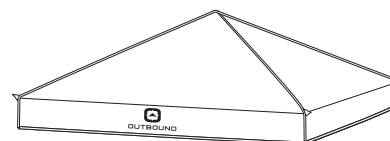

- OneTouchTM Frame: 1 each



- Screen Wall: 1 each

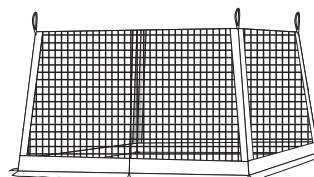

- Tent Stakes: 16 each





2 OPEN THE FRAME

1. Lift and expand the frame.

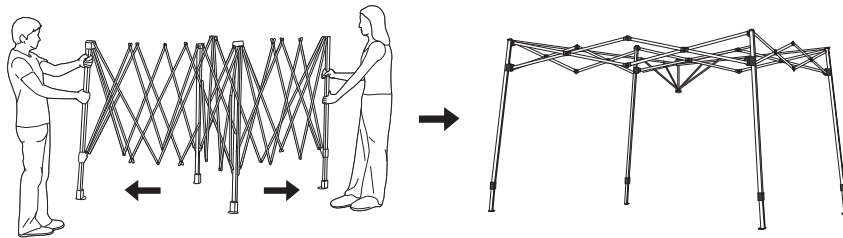

3 LOCK THE ROOF

1. Lift the frame and position yourself underneath.
2. Expand the frame by pushing the OneTouch™ hub straight up until it clicks and locks in place.

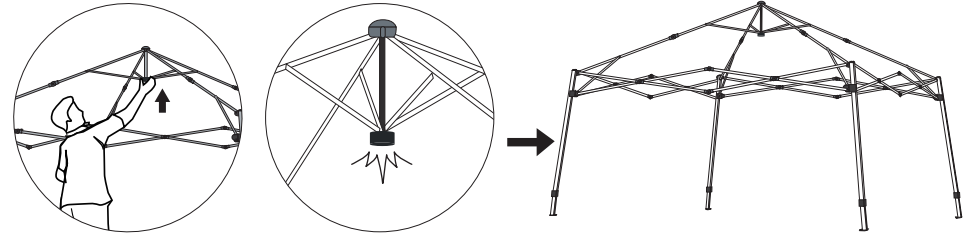

4 ATTACH THE CANOPY

1. Unfold and place over the roof frame.
2. Attach hook and loop tabs at the four corners to the frame.
3. Under the canopy attach the hook and loop tabs along the roof and eaves of the frame.

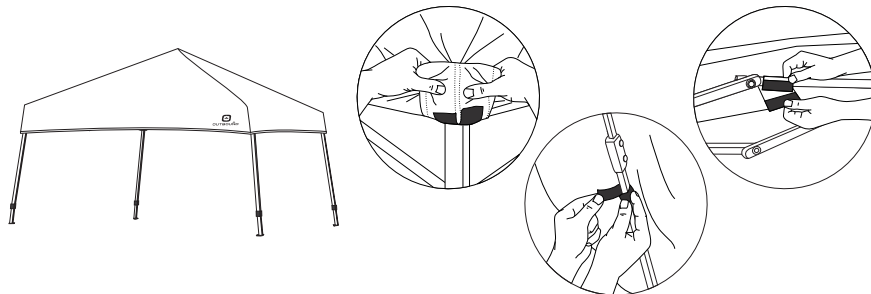

5 EXTEND THE LEGS

1. Lift the upper leg section and extend the lower sections until they are locked securely in place.

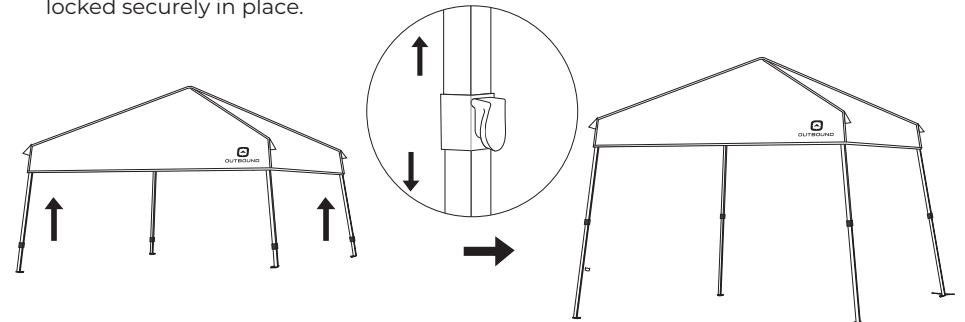

6 STAKE SHELTER

1. Secure shelter by driving stakes through the holes in the base of each frame post.

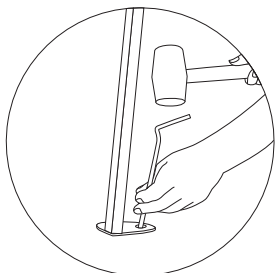

7 SECURE GUY LINES

1. Secure shelter using all guy lines and stakes.
Shelter must be secured for proper function.
2. Hammer stakes into ground at a 45° angle using a hammer or mallet.



8 ATTACH SCREEN WALL

1. Attach the screen wall by wrapping hook and loop tabs around eaves of the frame
2. Attach the hooks on the screen wall to the rings on the frame, at the legs.
3. Use brass eyelets to stake perimeter.

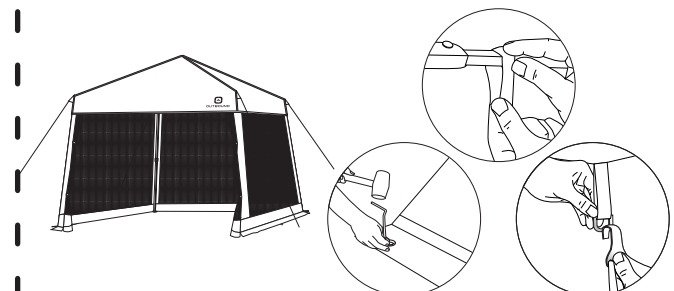

ASSEMBLY INSTRUCTIONS



Product No. 076-6534-2
Model No. CTCXP1111SL-2

9 SPECIALTY

1. Magnetic Door zipper.
2. Wheelchair user can able to open and close the door.

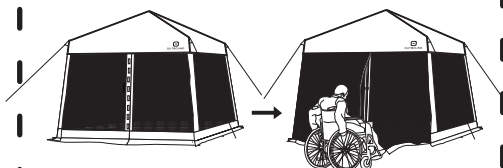

10 DISASSEMBLY

1. To disassemble, work in reverse order. **Be cautious of pinch points.**
2. Detach hook and loop fasteners and remove screen wall. Fold for storage.
3. Remove stakes with hammer or stake puller. DO NOT pull on tent.
4. To lower the shelter, press the push buttons along each leg and slide the legs downward.

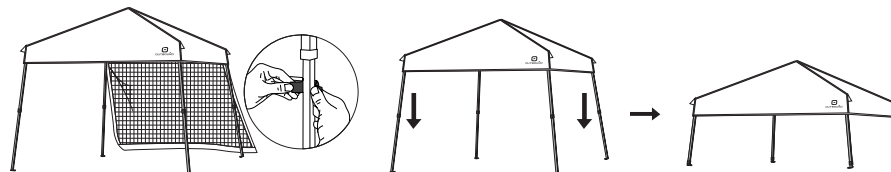

11 REMOVE THE CANOPY

1. Detach all hook and loop fasteners and remove canopy. Fold for storage.

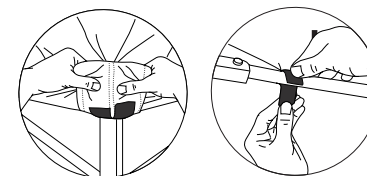

12 RELEASE THE ROOF HUB

1. Position yourself under the frame.
2. Press the button on the centre hub to lower the roof frame.

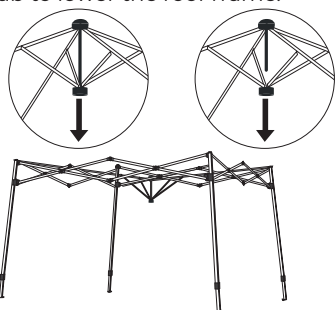

13 FOLD THE FRAME

1. Lift opposite corners and push inward, collapsing the frame.

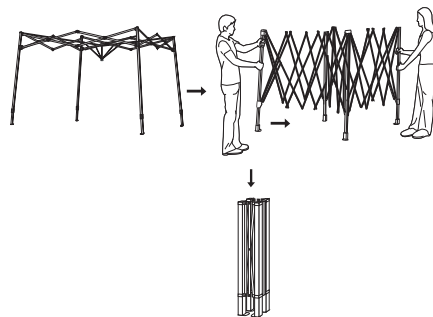

14 STORE YOUR SHELTER

1. To prolong the life of your shelter, make sure all components are clean and dry before placing in the carry bag.
2. Place folded frame "feet first" into the carry bag.
3. Place stakes in the stake bag to prevent damage to the canopy.
4. Place folded canopy along the side of the frame and carefully zip the bag closed.
5. Store in a clean, dry area.



**NEVER STORE CANOPY WHILE ATTACHED TO FRAME.
YOU MAY DAMAGE CANOPY FABRIC, FRAME, OR BOTH.**

REPLACEMENT PARTS



| MODEL NO. CTCXP1111SL (076-076-6534-2) | | QTY. REQ. |
|--|--------------------|--------------|
| DESCRIPTION | PART NO. | |
| Call customer service for steel frame replacement parts. | | |
| Canopy | HTF CTC-XP1111SL | 1 |
| Screen Wall | HTF CTC-XP1111SL-2 | 1 |
| Stakes | HMS4-7 | 16 |





| PROBLEM | SOLUTION |
|--------------------|---|
| CONDENSATION | Condensation occurs when warm, moist air inside tent comes in contact with cooler outside air. Avoid touching walls to reduce contact leakage. Venting doors and windows will reduce condensation. Store wet clothing outside of tent. A battery-powered fan may be helpful. Not applicable to screen houses. |
| SEAM LEAKAGE | Apply a generous amount of seam-sealer on inside seams. Seam-sealer may be purchased at any local sporting goods store. |
| MILDEW | To avoid mildew, store tent/screen house ONLY when thoroughly dry. However, if mildew occurs, use a soft-bristle brush or sponge with mild dishwashing soap or laundry soap to clean. Let dry thoroughly and a tent-approved water-repellent compound may be applied. |
| REPAIRING A TEAR | For small tears use a self-adhesive patch kit. We recommend a canvas or awning repair shop for larger tears. |
| FAULTY ZIPPER | Zippers are self-repairing. If the zipper separates, you can move the slider to the beginning of the zipper tape and rework the zipper. |
| FADING FABRIC | Do not leave up in direct sunlight longer than necessary. If left in sunlight for prolonged periods of time, fabric will fade and weaken. |
| FLOOR CONDENSATION | A ground cloth under the floor helps prolong its life, provides additional insulation and moisture protection. The cloth should be smaller than the floor to prevent rain from running under the tent. Not applicable to screen houses. |
| USE OF STAKES | Stakes should be installed at a 45° angle using a hammer or mallet. Stake loops should be kept taut without over-stretching fabric or webbing. This could cause tears or leakage. To remove safely, use a hammer or stake puller. Do not remove by pulling on the fabric. |

CARE AND MAINTENANCE



- Allow dirt to dry on the fabric after a rainfall before lightly sweeping it off with a brush. For tougher stains, spray the area with water and lightly wipe it off with a few strokes. Do not use washer or dryer. DO NOT SCRUB THE FABRIC. ALWAYS MAKE SURE IT IS COMPLETELY DRY BEFORE REPACKING.

WARRANTY



- CTC 7-DAY REPLACEMENT WARRANTY: Unpack and inspect all contents for defects in workmanship and materials within 7 days of purchase. If any defects are found, return the product to the place of purchase, along with the proof of purchase, and it will be replaced free of charge.
- 1-YEAR REPLACEMENT PARTS LIMITED WARRANTY: This product carries a replacement parts warranty against defects in materials and workmanship for a period of 12 months from date of purchase. At its discretion, the manufacturer may provide replacement parts. The original purchaser will be required to provide proof of purchase. The consumer will be responsible for shipping costs incurred outside of the U.S. or Canada.
- Warranties DO NOT cover normal wear and tear, misuse, abuse, inclement weather conditions (i.e., wind, rain, hail, lightning, tornadoes or hurricanes) or other acts of God, mildew and rotting, damage or fading caused by prolonged exposure to UV rays. This warranty gives you specific legal rights. You may also have other rights which vary depending on locale. Under no circumstances shall the manufacturer be liable for any incidental or consequential damages.
- The tent is water-repellent. It is not waterproof. During heavy or continuous rain, some leakage may occur. Avoid contact between objects and the inside of the tent, as this may result in leakage at points of contact. In the event of seam leakage, apply a seam-sealer compound.
- Although our products are manufactured according to rigorous specifications, periods of wind or rain may loosen the stakes and cause the frame to sink into the ground. This will weaken the structure's overall rigidity. Puddles may also form on the roof if the unit has not been assembled tightly. If pooling should occur, it is advisable to drain the fly to avoid possible damage to frame and fabric. Adjustment of guy lines may be necessary. In case of inclement weather, remove valuables and seek appropriate shelter. Intended for recreational use only.