

10-PERSON DOME TENT WITH SCREEN ROOM

Product No. 076-6437-6

Model No. CTC241415



SPECIFICATIONS



Floor size	14' x 10' (4.3 m x 3 m)
Centre height	6' 8" (2 m)
Weight	13.2 kg (29 lb 2 oz)

SAFETY



DANGER!

- Stoves, lanterns, candles, grills, heaters and other fuel-burning devices produce carbon monoxide and will consume the available oxygen in a tent. Use of such devices in a tent may cause asphyxiation, carbon monoxide poisoning, and death or serious and permanent injuries. For this reason:

- DO NOT use fuel-burning devices inside or near this product.
- Your failure to follow this warning may cause death or serious and permanent injury to you or others.

WARNING!

- **KEEP ALL FLAME AND HEAT SOURCES AWAY FROM THIS SHELTER.** This shelter is not fireproof. The fabric will burn if left in continuous contact with a flame source. The application of any foreign substance to the fabric may render the flame-resistant properties ineffective.
- Do NOT use candles, matches or other open flames in or near a shelter. Exercise extreme caution: keep appliances away from the shelter fabric. Do NOT leave them unattended. Turn them off before going to sleep. Make sure the shelter is well ventilated at all times to avoid suffocation. Build campfires downwind and several metres away from a shelter. Extinguish campfires before leaving a campsite or going to sleep. Do NOT fuel lamps, heaters or stoves in a shelter. Do NOT smoke in a shelter. Do NOT store flammable liquids in a shelter. Keep exits clear. Do NOT apply any foreign substance to a shelter. It may diminish the flame resistant properties of shelter material(s). Follow manufacturer's instructions for safe appliance use.
- Anchor properly at all times and carefully consider campsite choice. Be aware of possible falling rocks or tree limbs, lightning strikes, flash floods, strong winds and other hazards which may cause harm to this product or its occupants.
- Have a minimum of two adults for assembly. During assembly poles are under tension. If not held firmly in place during assembly, poles could break or flip up, possibly causing serious injury.
- Exercise care when using electric devices in and near tents.
- This product is intended for temporary day use and activities including camping, picnicking, and day tripping. This product is not intended as a semi-permanent shelter.

INSTRUCTION MANUAL



HAVING TROUBLE?
CALL US: 1-888-280-7876
hkdglobal.net/contact-us

IMPORTANT: Please read this manual carefully before assembly of this product. Keep for future reference.

BEFORE YOU GO...



TIPS :

- Research the area where you intend to camp. Prepare for any possible weather condition. Be aware of hazards and emergency protocol. Know the rules and regulations.
- Check out your equipment before your trip. Be sure your cook stove, lanterns, flashlights, air mattress, etc., are in good working order. Erect your tent to become familiar with setup. Once you've assembled your tent in a dry, well-ventilated area, apply seam sealing compound to the stitching of the inside seams following manufacturer's directions. Allow to dry thoroughly before storage. Reapply annually.

ASSEMBLY INSTRUCTIONS



IMPORTANT NOTE BEFORE ASSEMBLY:

- Assemble your screen house before camping to become familiar with the assembly.
- Two people are recommended for setup.
- Select a clean, level area for your campsite, free of debris and sharp objects, and away from any natural water source.
- To prevent damage to the zippers, unzip the doors and windows of the screen house prior to disassembly.

1 VERIFY PACKAGE CONTENTS

- Tent: 1 each

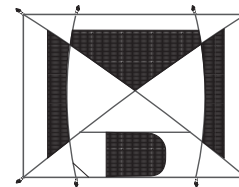

- Rainfly: 1 each

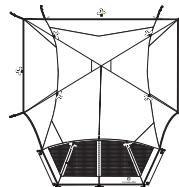

- Fiberglass Poles: 2 each (total)



(A) Side: 2 each



(B) Fly: 1 each



(C) Main (Red): 4 each (D) Porch roof: 1 each



- Tent Stakes: 20 each

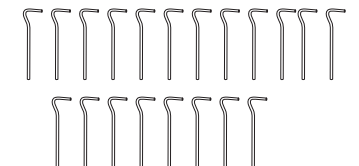



2 ASSEMBLE POLES

1. Assemble the tent poles by placing fibreglass sections into the metal ferrules. Four poles are provided:

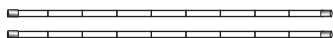

2 each (A) Side poles



1 each (B) Fly pole



4 each (C) Main pole (Red)



1 each (D) Porch Roof Pole

3 SPREAD TENT AND INSERT POLES

1. Spread out the tent flat, floor side down.
2. Find attached tent's hub located at centre of the tent roof. Using the illustration below as a guide. Insert 4 main poles (C, Red) into the hub's corner hole (red tape).
3. Place each end of the main poles (C) onto the pin located at tent corners.
4. Clip the plastic hooks on the tent to the frame.

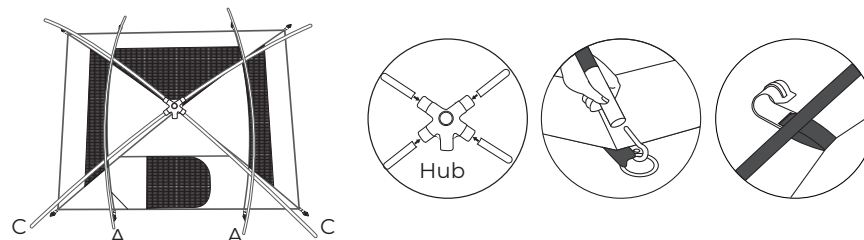

4 RAISE THE TENT

1. Slide each side pole (A) through the side pole sleeves.
2. Place the side pole (B) onto the pin located near the centre of the tent.
3. Clip the plastic hooks along the side poles to the frame.



5 STAKE THE TENT

1. Stake down the tent by inserting a stake through the stake loops, located along the perimeter of the tent.
2. Make certain the tent floor is pulled out evenly and tightly.
3. Hammer the stakes into the ground at a 45° angle using a hammer or mallet.

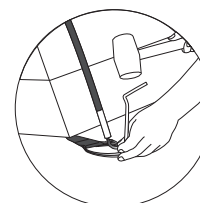

6 ATTACH FLY

1. Unfold the fly and stretch out all corners.
2. Place the fly over the tent, making certain the fly awning is over the front door.
3. At the four corners of the tent attach the plastic S-hooks on the fly to metal rings at the stake loops.



7 ATTACH FLY POLE

1. Insert the fly pole (B) through the sleeve and loop found at the edge of the fly awning, over the front door.
2. Flex the pole and insert each end into the pin located on either side of the door at side pole.
3. Wrap the hook and loop fasteners, sewn on the underside of the fly, around the fibreglass poles.

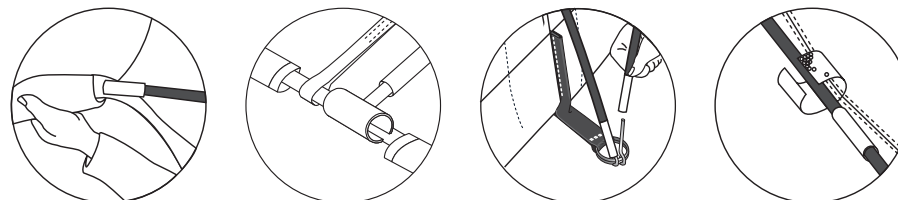



8 SECURE PORCH ROOF POLE AND GUY LINES.

1. Insert the porch roof pole (D, Blue) through the sleeve found at the front of the fly above the door. Insert the pole end into the front port of the hub at centre of the roof.
2. Clip the hook end of pole (D) to pole (B) at the screen room door.
3. Secure fly with S-hooks at each side of the door. With door closed. Stake screen room corners.
4. Secure tent using all guy lines and stakes. Tent must be secured for proper function.

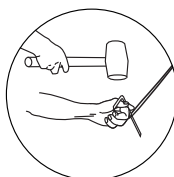
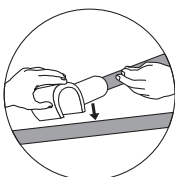
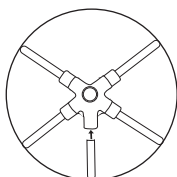

9 DISASSEMBLY

1. To take down the tent, disassemble in reverse order.
2. Be sure to leave doors and windows unzipped to avoid zipper damage.
3. Remove stakes with hammers or stake puller. **DO NOT** pull on screen house.
4. Carefully disengage poles from pins or pockets. Push poles away from you through the sleeves to minimize risk of damage to screen house or poles.
5. Keep poles and stakes together in bags provided.

10 PACKING THE TENT

1. Spread screen house flat, distribute evenly.
2. Fold into quarters not to exceed the length of pole bag.

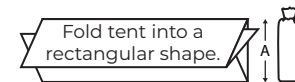

Dimension A should be close to but not exceeding the length of the pole bag.

3. Lay pole bag at opposite end from door. Tightly roll bag and screen house, forcing any air out of the unzipped side.



4. Secure with ties and place in carry bag with stakes and accessories.
5. Tent must be clean and dry before storage. Store off concrete floor.

**Be certain campfires are extinguished.
Dispose of trash appropriately.**

REPLACEMENT PARTS



KEY NO.	MODEL NO. CTC241415 (076-6437-6)		QTY. REQ.
	DESCRIPTION	PART NO.	
A	Fibreglass Pole - Side	HFP11-515f	1
B	Fibreglass Pole - Fly	HFP11-586f	2
C	Fibreglass Pole - Main	HFP11-356f	4
D	Fibreglass Pole - Porch Roof	HFP11-276f,h	1
	Replacement Fly	HTFCTC241415	1
	Tent Stake-Metal	HMS4-7	20

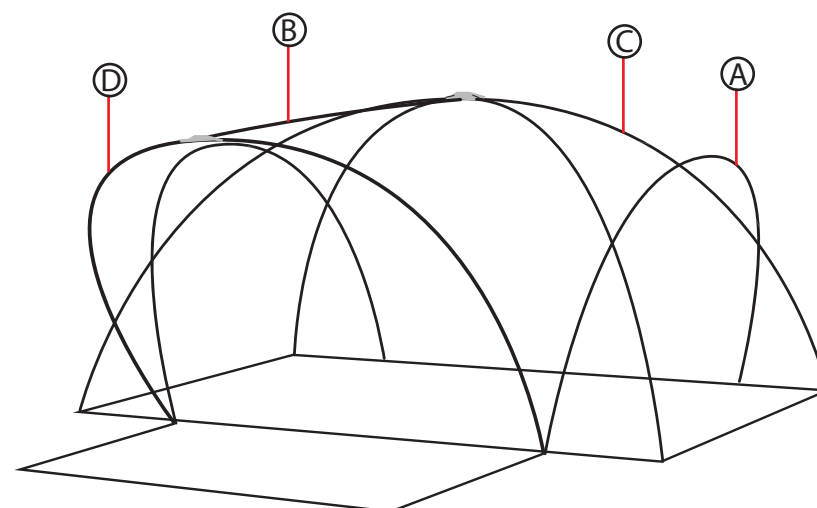



PROBLEM	SOLUTION
CONDENSATION	Condensation occurs when warm, moist air inside tent comes in contact with cooler outside air. Avoid touching walls to reduce contact leakage. Venting doors and windows will reduce condensation. Store wet clothing outside of tent. A battery-powered fan may be helpful. Not applicable to screen houses.
SEAM LEAKAGE	Apply a generous amount of seam-sealer on inside seams. Seam-sealer may be purchased at any local sporting goods store.
MILDEW	To avoid mildew, store tent/screen house ONLY when thoroughly dry. However, if mildew occurs use a soft-bristle brush or sponge with mild dishwashing soap or laundry soap to clean. Let dry thoroughly and a tent-approved water-repellent compound may be applied.
REPAIRING A TEAR	For small tears use a self-adhesive patch kit. We recommend a canvas or awning repair shop for larger tears.
FAULTY ZIPPER	Zippers are self-repairing. If the zipper separates, you can move the slider to the beginning of the zipper tape and rework the zipper.
FADING FABRIC	Do not leave up in direct sunlight longer than necessary. If left in sunlight for prolonged periods of time, fabric will fade and weaken.
FLOOR CONDENSATION	A ground cloth under the floor helps prolong its life, provides additional insulation and moisture protection. The cloth should be smaller than the floor to prevent rain from running under the tent. Not applicable to screen houses.
USE OF STAKES	Stakes should be installed at a 45° angle using a hammer or mallet. Stake loops should be kept taut without over-stretching fabric or webbing. This could cause tears or leakage. To remove safely, use a hammer or stake puller. Do not remove by pulling on the fabric.

CARE & MAINTENANCE



- Allow dirt to dry on the fabric after a rainfall before lightly sweeping it off with a brush. For tougher stains, spray the area with water and lightly wipe it off with a few strokes. Do not use washer or dryer. DO NOT SCRUB THE FABRIC. ALWAYS MAKE SURE IT IS COMPLETELY DRY BEFORE REPACKING.

WARRANTY



- CTC 7-DAY REPLACEMENT WARRANTY: Unpack and inspect all contents for defects in workmanship and materials within 7 days of purchase. If any defects are found, return the product to the place of purchase, along with the proof of purchase, and it will be replaced free of charge.
- 1-YEAR REPLACEMENT PARTS LIMITED WARRANTY: This product carries a replacement parts warranty against defects in materials and workmanship for a period of 12 months from date of purchase. At its discretion, the manufacturer may provide replacement parts. The original purchaser will be required to provide proof of purchase. The consumer will be responsible for shipping costs incurred outside of the U.S. or Canada.
- Warranties DO NOT cover normal wear and tear, misuse, abuse, inclement weather conditions (i.e., wind, rain, hail, lightning, tornadoes or hurricanes) or other acts of God, mildew and rotting, damage or fading caused by prolonged exposure to UV rays. This warranty gives you specific legal rights. You may also have other rights which vary depending on locale. Under no circumstances shall the manufacturer be liable for any incidental or consequential damages.
- The tent is water-repellent. It is not waterproof. During heavy or continuous rain, some leakage may occur. Avoid contact between objects and the inside of the tent, as this may result in leakage at points of contact. In the event of seam leakage, apply a seam-sealer compound.
- Although our products are manufactured according to rigorous specifications, periods of wind or rain may loosen the stakes and cause the frame to sink into the ground. This will weaken the structure's overall rigidity. Puddles may also form on the roof if the unit has not been assembled tightly. If pooling should occur, it is advisable to drain the fly to avoid possible damage to frame and fabric. Adjustment of guy lines may be necessary. In case of inclement weather, remove valuables and seek appropriate shelter. Intended for recreational use only.