

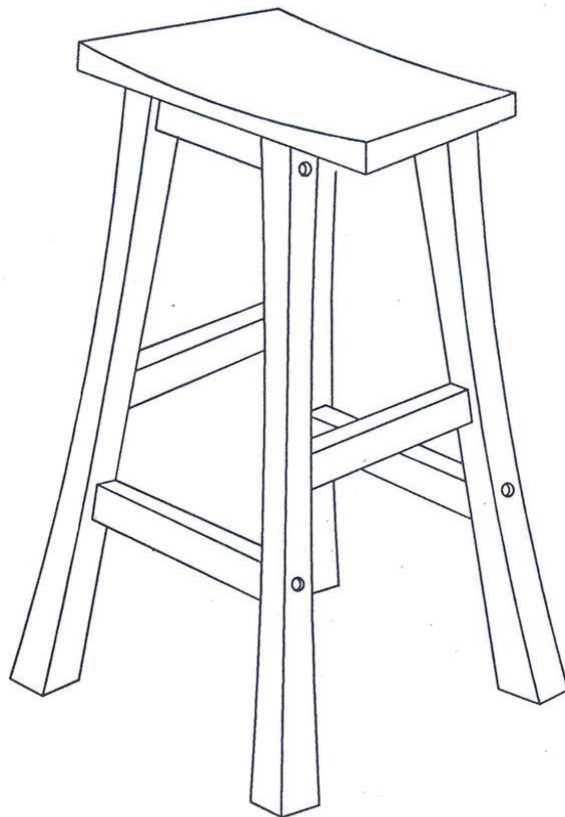

# Shinto Stool

Product No. 068-7499-2

Model No. BN-2812B



## Assembly Instructions

Toll-free: 1-877-483-6759

**IMPORTANT:** Please read this manual carefully before beginning assembly of this product.  
Keep this manual for future reference.

When it comes to products for your home, it's essential they stand up to the realities of everyday family life. Designed with your family in mind, For Living™ products combine timeless style and family-friendly features. Now you can focus on what's important—creating lasting memories with your family.

Table of Contents	<b>3</b>
Important Safety Instructions	<b>3</b>
Parts	<b>4</b>
Assembly	<b>5-7</b>
Cleaning and Maintenance	<b>8</b>
Technical Data	<b>8</b>
Warranty	<b>9</b>



**Warning!** To reduce the risk of serious injury, read the following safety instructions before assembling and using the Shinto Stool.

### **Caution!**

- Keep children away during assembly.
- This product contains small parts which can be swallowed by children.
- Keep fingers away from the places where they can be pinched or trapped.
- Do not attempt to assembly the stool if any parts are missing.
- This product is intended for domestic indoor use only.
- To avoid damage, assemble the product on a non-abrasive surface.
- Do not use power tools to assemble the Shinto Stool. Power tools may strip or damage the parts.
- Make sure that all screws are tightly fastened before the product is used.
- CAUTION: Do not exceed maximum weight capacity of 350 lb (159 kg).
- This stool is intended for use by one person at a time.
- Do not stand on stool or use as a stepladder.
- All legs must be on ground.
- Possibility of serious injury if the stool is used improperly. Failure to follow warnings could result in serious injury.

**IMPORTANT: RETAIN FOR FUTURE REFERENCE, AND READ CAREFULLY**

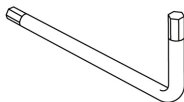
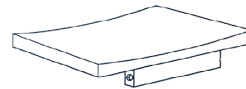
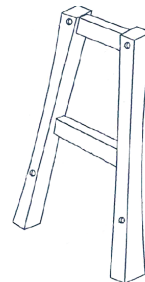
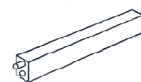
**A**Hex Screw - **8****B**Silicone Plug - **8****C**Dowel - **4****D**Hex Wrench - **1****E**Felt Pad - **4****1**Seat - **1****2**Pre-Assembled Leg Frame - **2****3**Leg Support Crossbar - **2**

Optional: Use wood glue to strengthen bond. \* Glue not included.



**Let us help you!**

**DO NOT RETURN YOUR PRODUCT TO THE STORE. CALL US FIRST!**

**1-877-483-6759**

If you have questions regarding your product, require warranty assistance, or have damaged or missing parts, please call our customer service toll-free helpline.

Contact us for assistance, we're here to help.

**IMPORTANT:** Please read and understand this manual before any assembly. Before beginning assembly of product, make sure all parts are present. Compare parts with packaging contents list. If any part is missing, or if you have any questions, contact customer service at 1-877-483-6759 (toll free).

Place all parts from the box in a cleared area and position them on the floor in front of you. Remove all packing materials and place them back into the box. Do not dispose of the packing materials until assembly is complete.

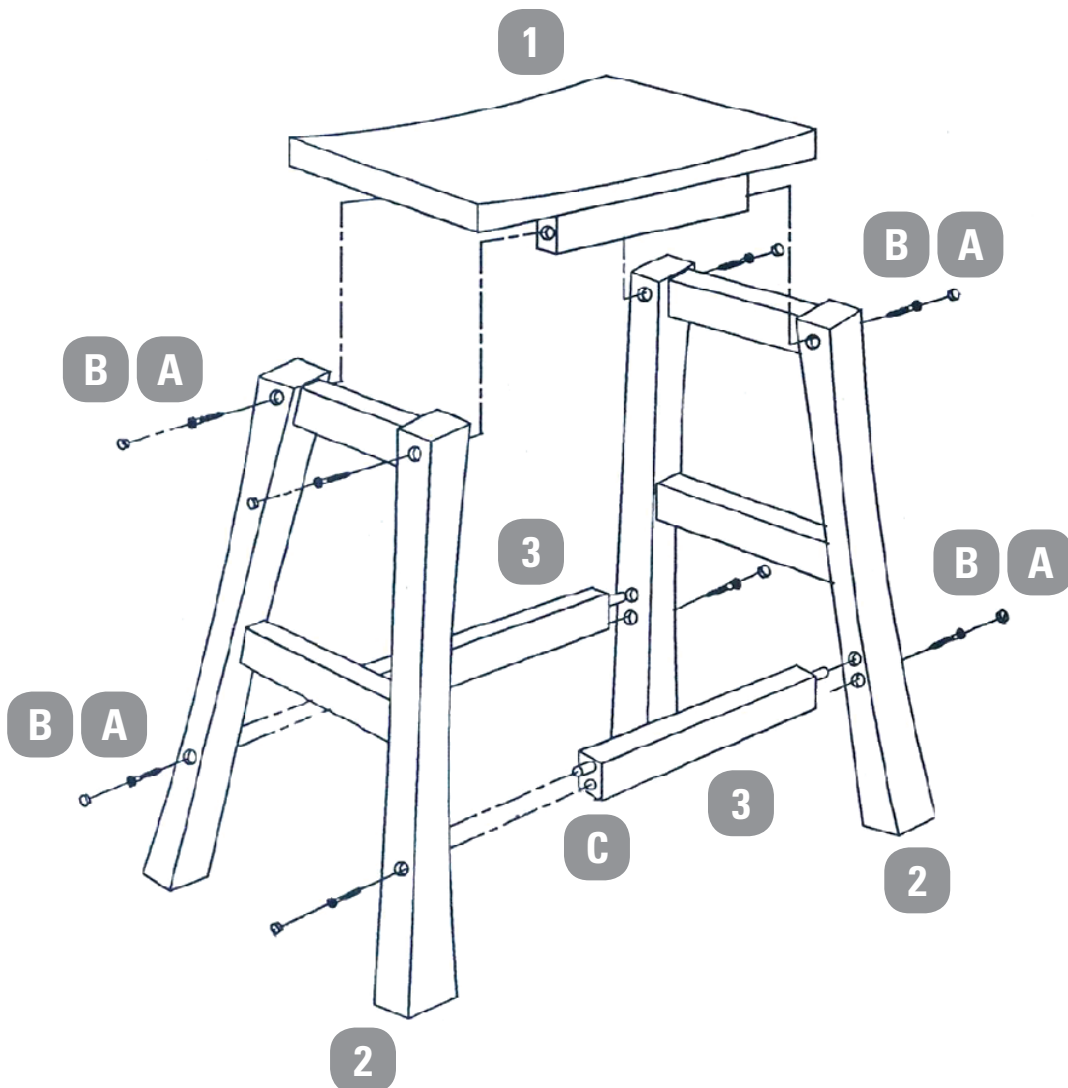

**Step 1****Requires 1, 2, A, D**

Take the seat (1) and set it upside down on a clean, smooth surface that will not scratch it during assembly. Place one pre-assembled leg frame (2) onto the seat bottom (1) and align the screw holes. Fasten the leg frame to the seat bottom by tightening the screws (A).

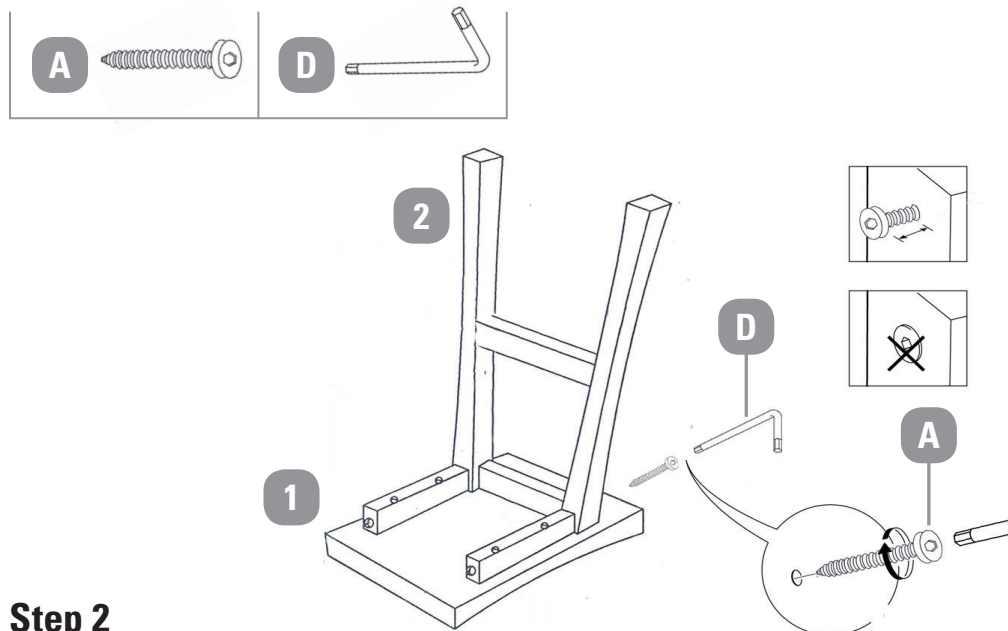
**Step 2****Requires 1, 2, 3, A, C, D**

Insert the compression dowels into the pre-drilled holes on the side of the leg support crossbars (3), one on each side. Place leg support crossbars (3) onto the side of the leg frame (2) and align the screw holes. Fasten the leg support crossbars to the side leg frame by tightening the screws (A).

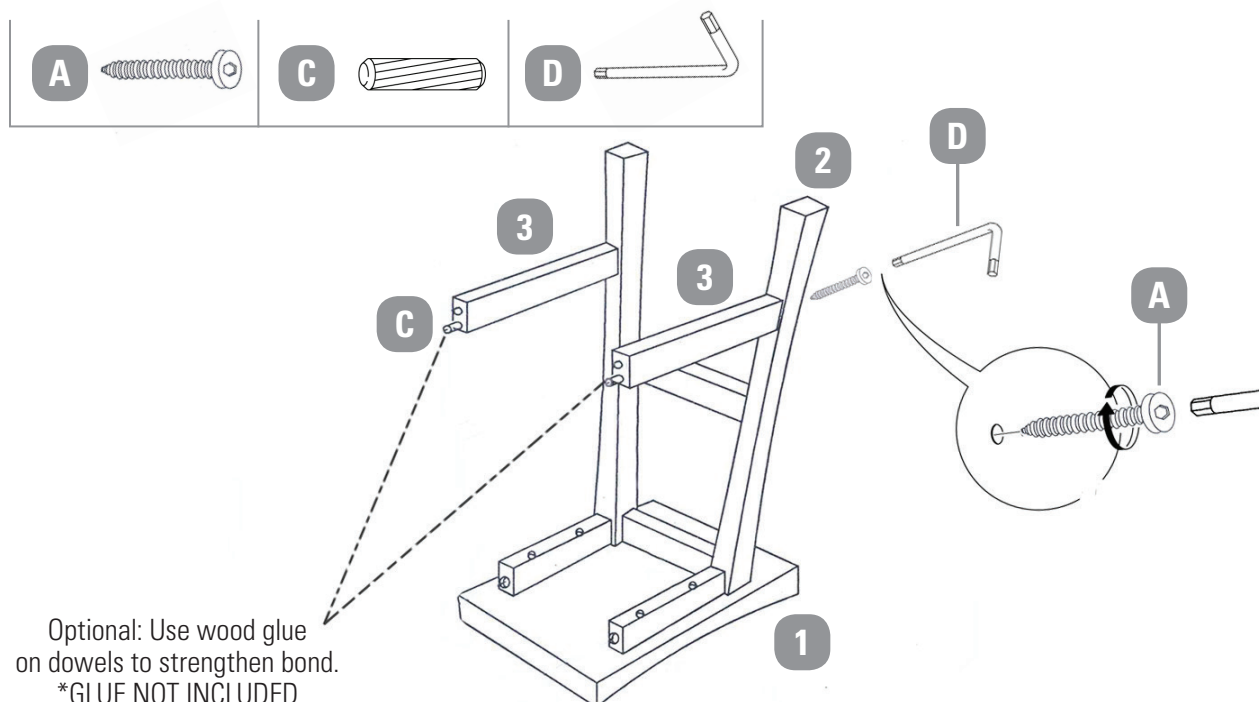

**Note:** Do not fully tighten screws (A) when fastening the side of the legs to the seat bottom and to the leg support bars.

### Step 3

#### Requires 1, 2, 3, A, D

Place the second pre-assembled leg frame (2) onto the seat bottom (1) and align the screw holes. Insert the dowels of the leg support crossbars (3) into the corresponding holes on the side legs.

Fasten the leg frames to the seat (1) bottom and to the leg support crossbars (3) by tightening the screws (A).

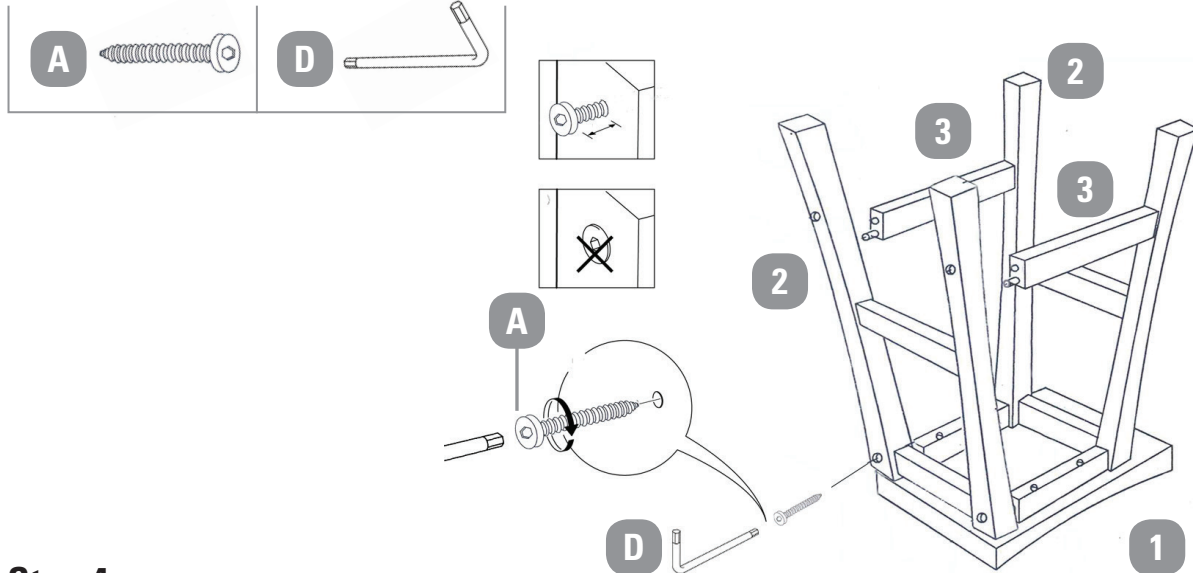

### Step 4

Place stool upright on a level surface.

Do not sit on the stool.

Apply weight on the seat of the stool, using your hands, to level out.

### Step 5

#### Requires B

Tighten all screws fully. Do not over-tighten. Insert the silicone plugs (B).



### Step 6

If necessary, extra felt pads (E) are included that can be applied to the bottom of the legs to prevent the stool from wobbling on uneven surfaces.

**Now your stool is ready for use. Enjoy!**



**Caution!**

- Check all screws periodically for tightness, fastening them again as required.
- Clean the stool with a damp cloth. Use furniture polish on the wood as needed. Avoid prolonged exposure to moisture.

Dimensions (L x W x H)

38 x 28 x 66 cm

15 x 11 x 26"

Weight Capacity

159 kg

350 lb

This For Living™ product carries a one (1) year warranty against defects in workmanship and materials. Trileaf Distribution agrees to replace the defective product free of charge within the stated warranty period, when returned by the original purchaser with proof of purchase. This product is not guaranteed against wear or breakage due to misuse and/or abuse.

