

MAXIMUM® / MD

## Industrial Storage Rack

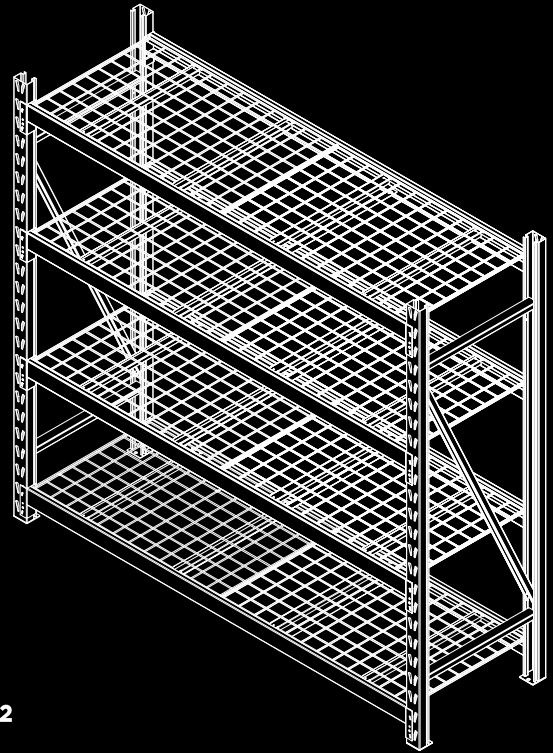

Model No. 068-7066-2

**IMPORTANT:**  
Please read this manual carefully before using this product, and save it for reference.

INSTRUCTION  
MANUAL

SAFETY

Model No. 068 - 7066 - 2

MAXIMUM® / MD

- To reduce the risk of serious injury read the following safety instructions before assembling and using the product.
- This product is intended for domestic, indoor use only.
- Assemble the unit on a hard and level surface. Never assemble on a carpet.
- Arrange for necessary manpower when assembling and moving the product.
- When using a mallet, use a cloth or wood block to protect the surface finish of the product. The mallet is NOT included in the package.
- Place small, stable items on the top shelves. Heavier and bulkier items should be stored on the lower shelves. Never allow children to climb or hang on shelves.
- It is recommended that wall anchors should be used to secure the shelving unit. The anchors are included in the package.
- Serious or fatal crashing injuries can occur from furniture tipping over. To prevent this, the rack must be secured to a wall especially in earthquake-prone environments, where surfaces are uneven, and where children and/or pets are present.
- Different wall materials require different types of fasteners. Use fasteners suitable for your specific type of wall. If you are uncertain about what type of fasteners to use, please contact your local hardware store.
- Do not exceed the following weight limits for this product.
  - Maximum load: 8,000 lb (3,628 kg).
  - Maximum load for each shelf: 2,000 lb (907.2 kg).
- Tools Required for Rack Assembly:  
Rubber mallet, power drill, masonry drill bit.



### SAVE THESE INSTRUCTIONS

This manual contains important safety and operating instructions. Read all instructions and follow them when using this product.

KNOW YOUR RACK

Model No. 068 - 7066 - 2

MAXIMUM® / MD

### CONTENTS:

No.	Description	Qty.
1	Upright Columns	4
2	Upright-Horizontal Struts	4
3	Upright-Diagonal Struts	2
4	Beams	8
5	Wire Deck	8
6	Beam Braces	8
7	Button Head Hex Bolt	13
8	Hex Nut	13
9	Hex Bolt	17
10	Hex Nut	17
11	Hex Key	1
12	Wall Mount Bracket Assembly	1

The hardware bag includes 1 extra piece for each Bolt and Nut.

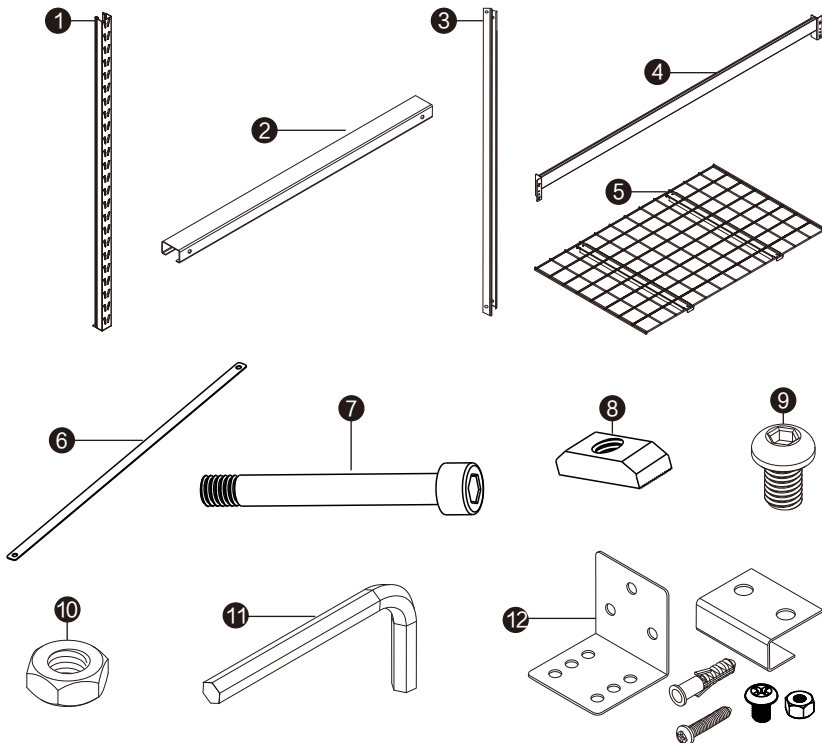

ASSEMBLY INSTRUCTIONS

Model No. 068 - 7066 - 2

MAXIMUM® / MD

### Step 1:

Place two Upright Columns (1) parallel on the floor. The widest part of the "butterfly" hole pattern on each Upright Column should be facing away from you. The elliptical hole on the side should face you (Fig. 1).

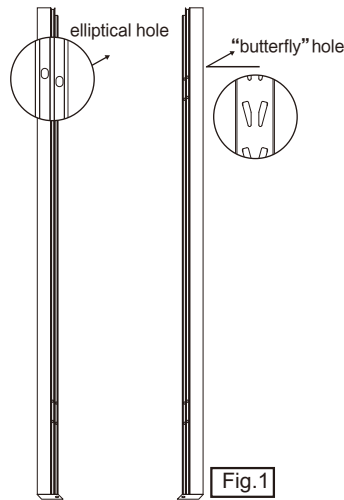

### Step 2:

Take one Upright-Horizontal Strut (2) and insert it into the channel of Upright Column (1) on one side. Using the Button Head Hex Bolt (7) and Hex Nut (8) to connect the Upright Column (1) and Horizontal Strut (2), thread a Button Head Hex Bolt (7) through the top hole (next to the assembled Horizontal Strut (2)) from one side to the other side. Use Hex Nut (8) and Hex Key (11) to tighten (do not fully tighten the bolt). Please note that the channel of Horizontal Strut (2) should be downward (Fig. 2-Fig. 7).

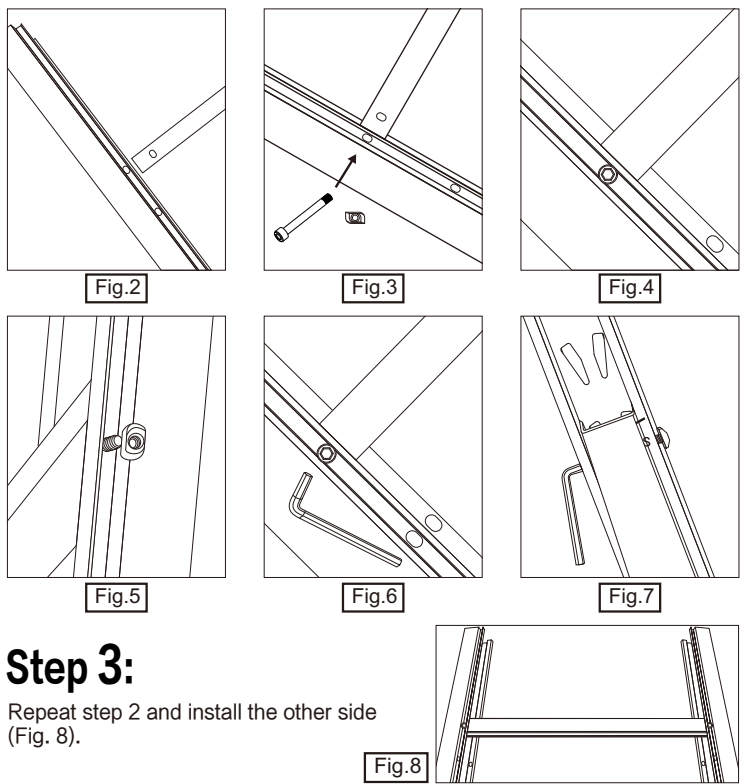

### Step 3:

Repeat step 2 and install the other side (Fig. 8).

ASSEMBLY INSTRUCTIONS

Model No. 068 - 7066 - 2

MAXIMUM® / MD

### Step 4:

Take one Upright-Diagonal Strut (3) and insert it into the channel of Upright Column (1) on one side. Using the Button Head Hex Bolt (7) and Hex Nut (8) to connect the Upright Column (1) and Diagonal Strut (3), thread a Button Head Hex Bolt (7) through the second hole (next to the assembled Horizontal Strut (2)) from one side to the other side. Use Hex Nut (8) and Hex Key (11) to tighten (do not fully tighten the bolt). Please note that the channel of Horizontal Strut (2) should be downward (Fig. 9-Fig. 13).

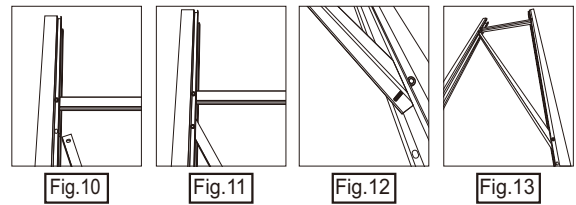

### Step 5:

Repeat step 2 and install the second Upright-Horizontal Strut (2) on the bottom of upright frame (Fig. 14-Fig. 15).

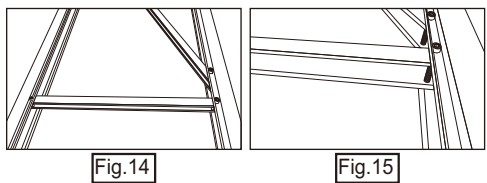

### Step 6:

Repeat step 1 to step 5 to assemble the second upright frame.

Once all above installation steps are completed, fully tighten the screws on all corners with the included Hex Key (11) (Fig. 16).

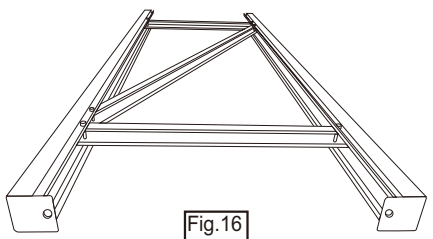

5

Model No. 068 - 7066 - 2

MAXIMUM® / MD

ASSEMBLY INSTRUCTIONS

### Step 7: BOTTOM ASSEMBLY — BACK LOWER LOAD BEAM

After grouping parts for assembly, verify that all contents have been included. Have one person hold the upright in standing position while the second person inserts a load beam in the lower part of the upright. Begin with lower back load beam. Insert the beam clips into the upright slots at the bottom [uprights have 3" (7.6 cm) increments]. Hit the load beam near the joint with a rubber mallet to drive the beam clips to the bottom of the slot (Fig. 17).

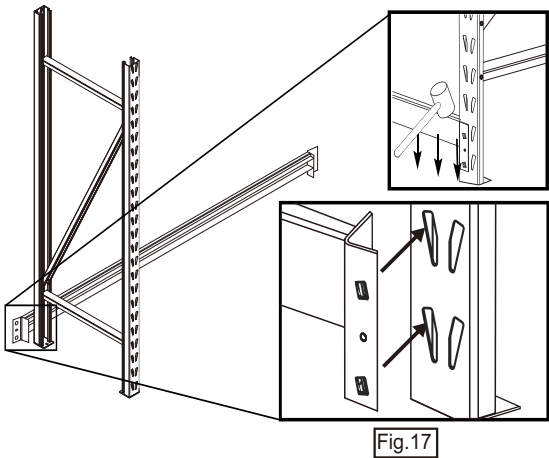

### Step 8:

#### BOTTOM ASSEMBLY (CONTINUED)

Join the load beam to the other upright at the same slot level. Count slots to help you align the load beams' heights. Insert the load beam clips into the upright slots. Hit the beam near the joint with a rubber mallet to drive the beam clips to the bottom of the slot (Fig. 18).

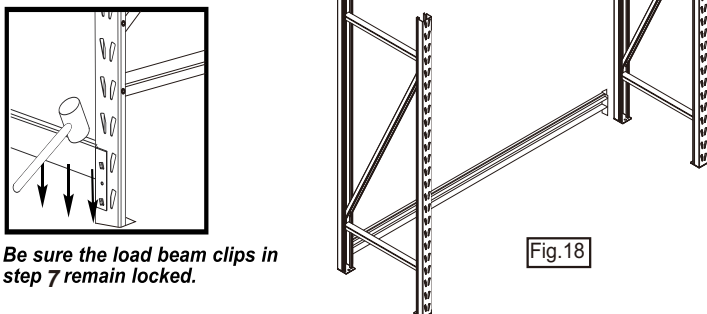

6

Model No. 068 - 7066 - 2

MAXIMUM® / MD

ASSEMBLY INSTRUCTIONS

### Step 9: FRONT LOWER BEAM

Repeat steps 1 and 2 to install front lower load beam—be it is at the same level as the back load beam (Fig. 19). Count slots to help you align the load beams' heights.

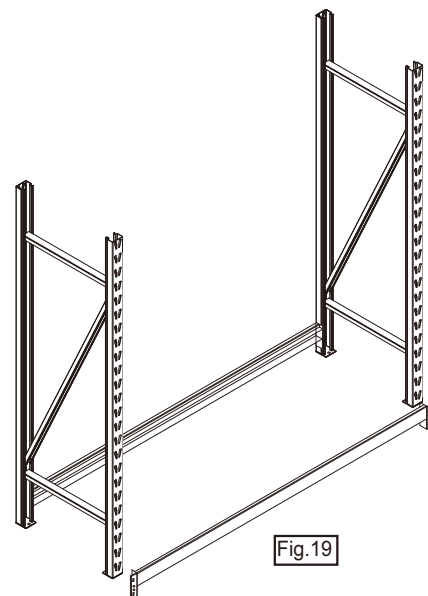

### Step 10:

#### TOP AND MIDSECTION LOAD BEAMS

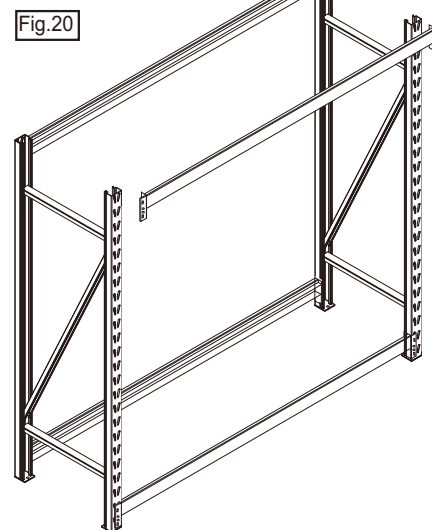

First install the back top load beam. Insert the load beam clips into the two top slots of each upright. Hit the beam near the joint with a rubber mallet to drive the beam clips to the bottom of the slot (Fig. 20). Repeat step for front top load beam.

7

Model No. 068 - 7066 - 2

MAXIMUM® / MD

ASSEMBLY INSTRUCTIONS

Fig.21

Install a 5th and 6th load beam at desired location. Be sure the front load beam is at the same level as the back load beam. Count slots to help you align the load beams' heights. Repeat for a 7th and 8th load beam (Fig. 21).

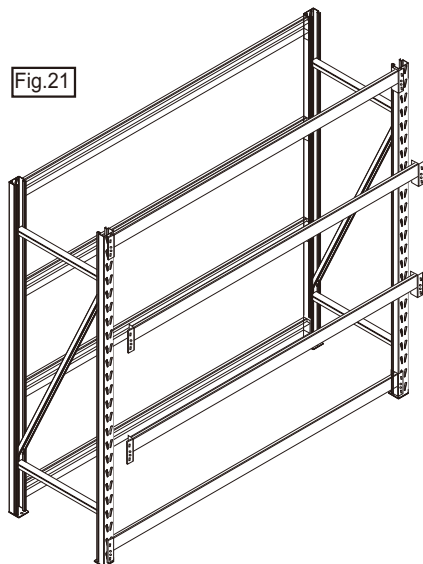

### Step 11:

Fit the beam braces at the load beams' desired locations. Starting at the bottom of the rack, place the Beam Braces (6) between the Beam (4) where the two sets of pre-drilled holes are. Use a Hex Bolt (9) and Hex Nut (10) screw to fasten the Beam Brace (6) to the Beam (4), and use the Hex Key (11) to tighten completely. Please note that the screw head should be down (Fig. 22-Fig. 23). Fit the beam braces at the load beams' desired locations (Fig. 24).

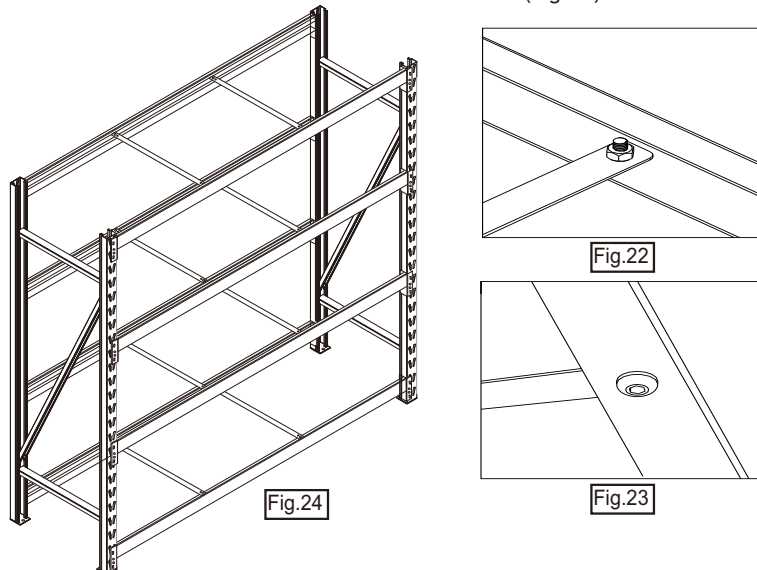

8

Model No. 068 - 7066 - 2

MAXIMUM® / MD

ASSEMBLY INSTRUCTIONS

### Step 12:

Once all load beams are installed, place two wire decks on top inside lip of beams. Repeat for each wire deck (Fig. 25).

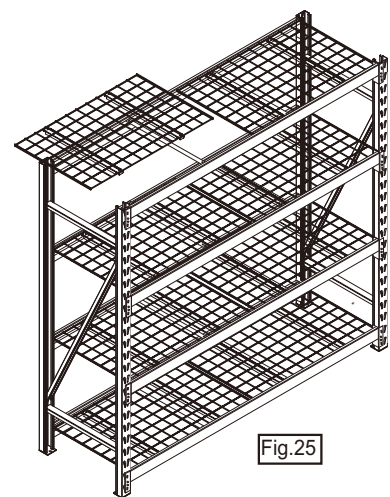

### Step 13:

#### WALL MOUNTING INSTRUCTIONS

Note: Drywall anchors and anchor screws are included with this rack; however, different wall materials require different types of fasteners. Use fasteners suitable for your specific type of wall. If you are uncertain about what type of fasteners to use, please contact your local hardware store.

#### Step 13-1:

Take the U-shaped bracket and rock it up at an angle to attach it to the bottom inner channel of the Beam (4). Once attached, the back portion will sit flush against the inside of the Beam (4) (Fig. 26).

#### Step 13-2:

The L-shaped bracket has three square holes that allow you to adjust the distance of the rack to the wall. Use two Button Head Hex Bolts and two nuts to attach the L-shaped bracket to the bottom of the U-shaped bracket (Fig. 27).

#### Step 13-3:

Position the rack so the flat end of the L-shaped bracket is touching the wall. Use a pencil to mark the location of the three holes on the wall. Use the included drywall anchors, anchor screws, and recommended tools (Fig. 28).

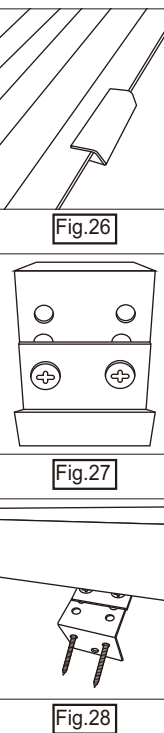

ASSEMBLY INSTRUCTIONS

Model No. 068 - 7066 - 2

MAXIMUM® / MD

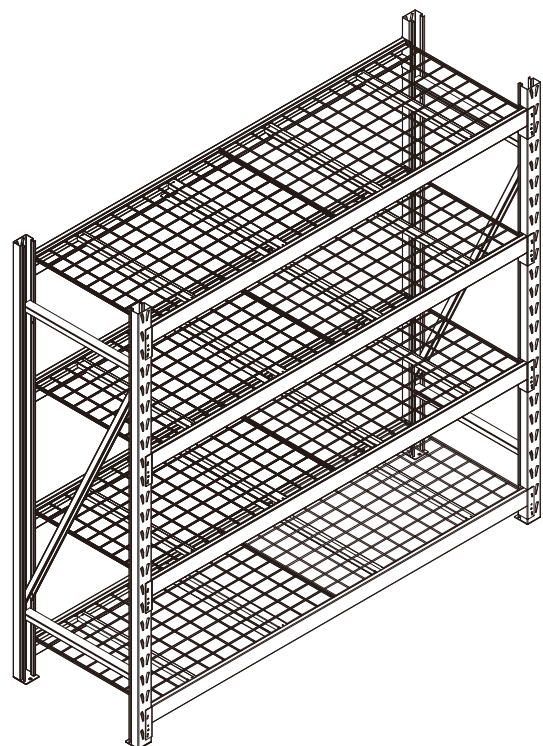

1. Serious or fatal crashing injuries can occur from furniture tipping over. To prevent this, the rack must be secured to a wall, especially in earthquake-prone environments, where surfaces are uneven, and where children and/or pets are present.
2. This MAXIMUM product carries a one (1) year warranty against defects in workmanship and materials. If found defective, this product will be replaced free of charge. This product is not guaranteed against wear or breakage due to misuse and/or abuse.

Made in China  
Imported by  
MAXIMUM Canada Toronto, Canada M4S 2B8

WARRANTY