

MAXIMUM[®] MD

PROFESSIONAL GRADE

**36" (93 cm) Wide Tall Cabinet
with Stainless Steel Doors**



Model no. 068-1810-6

IMPORTANT

Please read this manual carefully before assembling and using this product, and save it for reference.

INSTRUCTION MANUAL

Due to continuing improvements, the actual product may differ slightly from the product described herein.

TABLE OF CONTENTS

SAFETY	3
EXPLODED VIEW / PARTS LIST	4
ASSEMBLY INSTRUCTIONS	5
COORDINATING PRODUCTS	12
MAINTENANCE	12
WARRANTY	13

NOTE

If any parts are missing or damaged, or if you have any questions, please call our toll-free helpline at: 1-888-670-6682. Have the product number, cash register receipt and the date of purchase available when you call. **DO NOT SHIP YOUR PRODUCT BACK TO THE STORE UNLESS WE SEND YOU WRITTEN INSTRUCTIONS FOR RETURN.**





SAVE THESE INSTRUCTIONS

This manual contains important safety and operating instructions. Read all instructions and follow them carefully with use of this product.

SAFETY

To reduce the risk of serious injury, read and follow the safety instructions below before assembling and using this product.

- This product is intended for indoor use only.
- This product is not designed for commercial nor industrial usage.
- Keep the product on level surfaces. The product could become unstable and it may tip over if stored or moved on an uneven surface, which may cause personal injury, death or product damage.
- Any assembly or maintenance of the cabinet must be carried out by adults only.
- Use at least two people to move, assemble or install this cabinet. Failure to do so can result in personal injury or product damage.
- Check all nuts and bolts periodically for tightness. When required, tighten them.
- Close and lock the doors before moving this cabinet.
- DO NOT alter this product in any manner. For example, do not weld external bar locks or attach electrical equipment. This may cause product damage or personal injury.
- DO NOT exceed the following weight limits for this product.
 - Maximum load: 672 lb (305 kg)
 - Maximum load for each shelf: 150 lb (68 kg)
 - Maximum load for bottom panel: 200 lb (91 kg)
 - Maximum load for each door: 11 lb (5 kg)

⚠ WARNING	
	<p>Children have died from furniture tipover. To reduce the risk of furniture tipover:</p> <ul style="list-style-type: none"> -ALWAYS install anti-tip device provided. -NEVER put a TV on this product. -NEVER allow children to stand, climb or hang on drawers, doors, or shelves.
	<ul style="list-style-type: none"> -NEVER open more than one drawer at a time. -Place heaviest items in the lowest drawers. <p><i>This is a permanent label. Do not remove!</i></p>



- Before assembling and using this product, carefully read this instruction manual and all of the labels affixed to the product. Failure to follow all warnings and instructions may result in product damage or personal injury.
- Save all warnings and instructions for future reference.

EXPLODED VIEW / PARTS LIST

No.	Description	Part No.	Qty.	No.	Description	Part No.	Qty.
1	Safety strap	314230	1	11	Bottom panel	124218	1
2	Safety bracket	212591	1	12	M4 x 16 cross-head pan head screw	320362	8
3	M6 x 40 hex tapping bolt	320328	2	13	Shelf	245770	3
4	Combination of right side and back panels	124548	1	14	Shelf bracket	243311	12
5	Grommet	314295	1	15	Left door	124205	1
6	Lock (001-010)	304075	1	16	Magnet	312033	2
7	Right door	124222	1	17	Door stopper	124219	1
8	Adjustable foot	313066	4	18	Combination of left side and back panels	124547	1
9	M6 x 16 hex socket head screw *	320327	49	19	Top panel	124217	1
10	Key (001-010)	304196	2	20	Hex wrench	317035	1

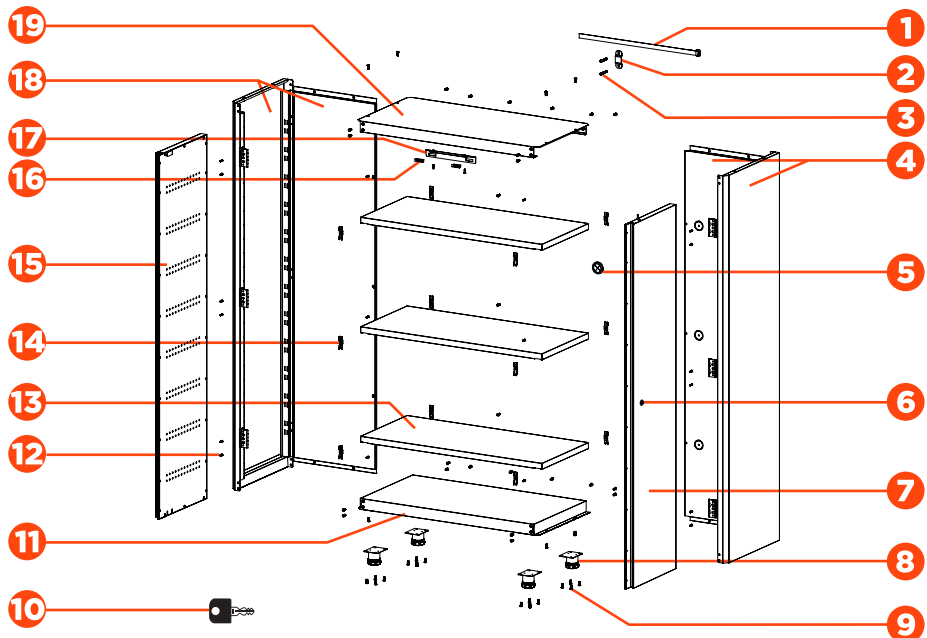

* NOTE: Extra M6 x 16 hex socket head screw(s) is (are) provided.

**NOTE**

- Replacement keys may be ordered. Call our toll-free number. The code which appears on the lock will be required.
- Give information for spare parts: part number and quantity required.

ASSEMBLY INSTRUCTIONS

TOOLS REQUIRED FOR ASSEMBLY

- Hex wrench (20)
- Power drill (not included)
- Measuring tape (not included)

NOTE: Assemble on a flat surface. A piece of cardboard is recommended to keep the product from being scratched during assembly.



WARNING: Please wear gloves during the whole assembly process.

STEP 1 INSTALL THE ADJUSTABLE FEET

Install the adjustable feet (8) to the bottom panel (11). Make sure side A of the adjustable feet are facing outside of the cabinet. Tighten securely with sixteen M6 x 16 hex socket head screws (9).

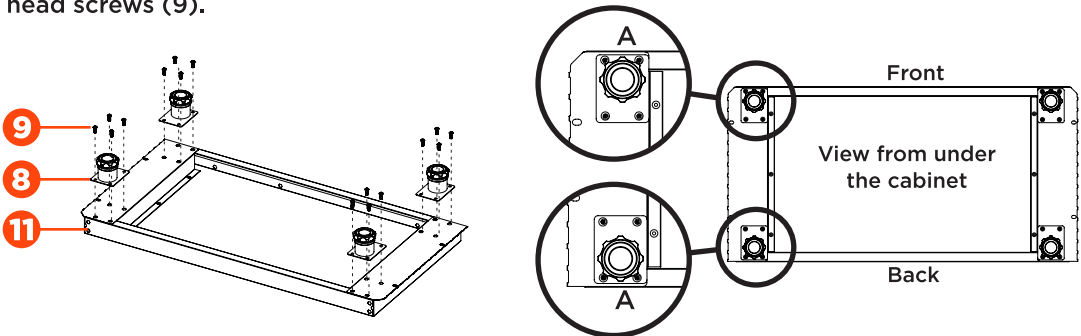

STEP 2 TURN THE LEFT BACK PANEL OUT

- Take out the left door set (15 and 18) with MAXIMUM® logo as shown in illustration 1.
- Open the left door (15) and turn the left back panel (18) out as shown in illustrations 2 and 3.
- Close the left door (15) back as shown in illustration 4.

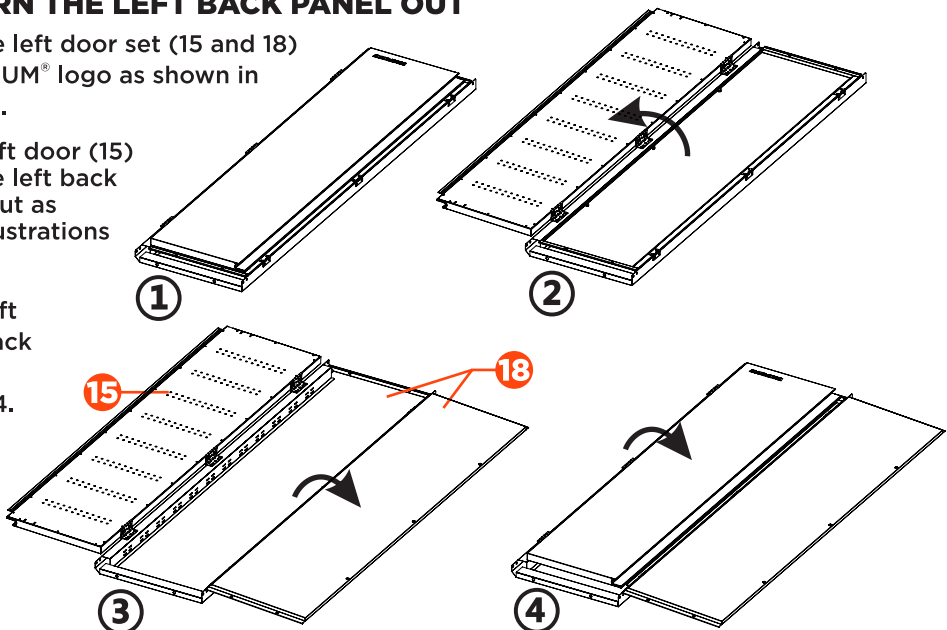

STEP 3 TURN THE RIGHT BACK PANEL OUT

- Take out the right door set (4 and 7) with the lock as shown in illustration 1.
- Open the right door (7) and turn the right back panel (4) out as shown in illustrations 2 and 3.
- Close the right door (7) back as shown in illustration 4.

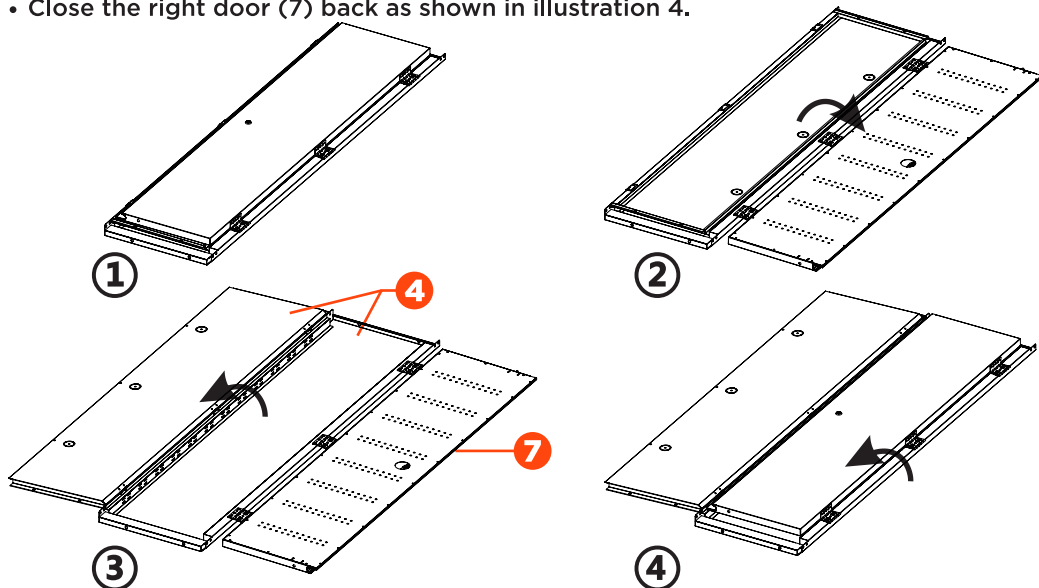
**STEP 4 CONNECT THE BACK PANELS**

With holding up both back panels (4 and 18) and make them horizontal. Attach them with two M6 x 16 hex socket head screws (9) at top and bottom. Tighten screws only by hand.

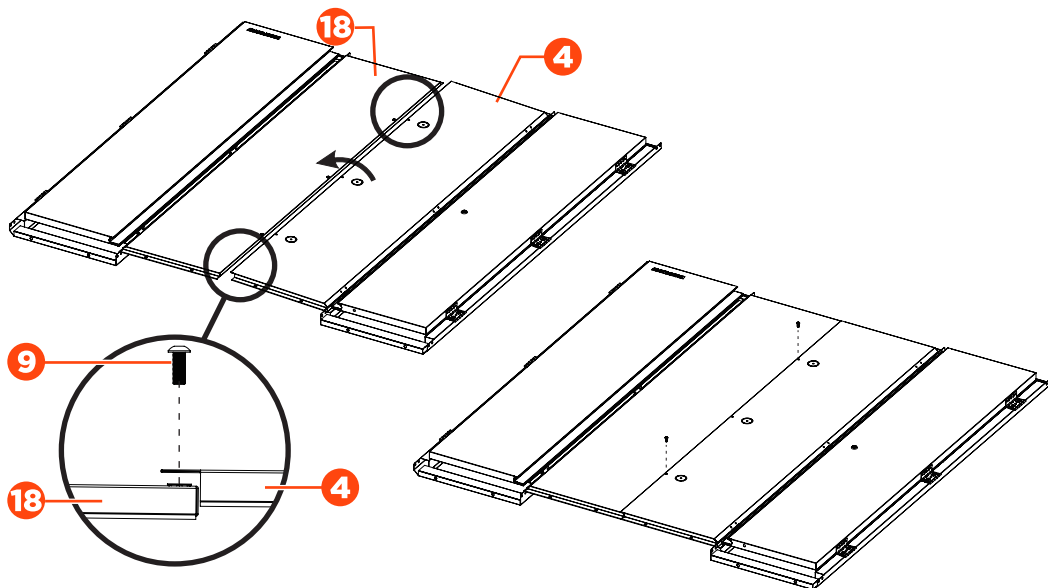

STEP 5 CONNECT THE BOTTOM PANEL AND SIDE PANELS

- Attach the bottom panel (11) to the left side panel (18) with four M6 x 16 hex socket head screws (9) as shown in illustration 1. Tighten screws only by hand.
- Flip the bottom panel (11) and left side panel (18) by 90° as shown in illustration 2.
- Flip up the right door set (4 and 7). Connect the right side panel (4) and bottom panel (11) with four M6 x 16 hex socket head screws (9) as shown in illustration 3. Tighten screws only by hand.

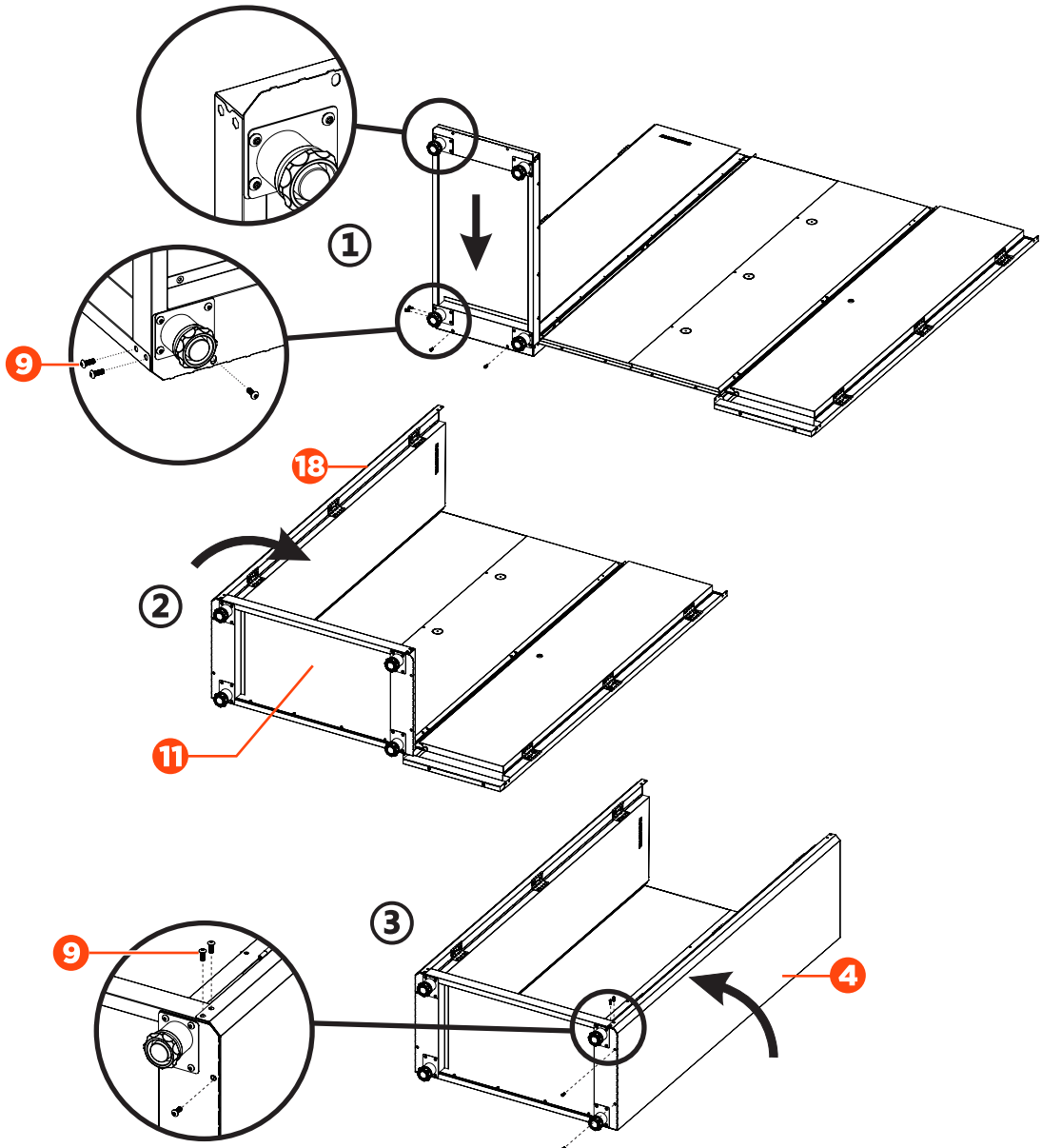

STEP 6 ATTACH THE TOP PANEL

- Attach the top panel (19) to the side panels (4 and 18) with eight M6 x 16 hex socket head screws (9). Tighten screws only by hand.

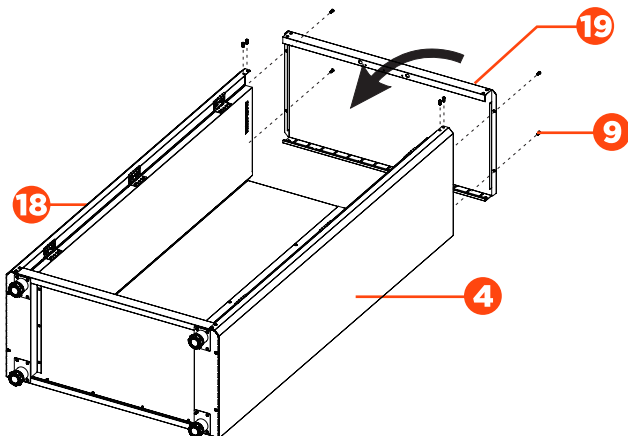

STEP 7 FIX THE BACK PANELS

- Stand up the cabinet.
- At the cabinet back, fix the back panels (4 and 18) with fourteen M6 x 16 hex socket head screws (9). Tighten screws only by hand.

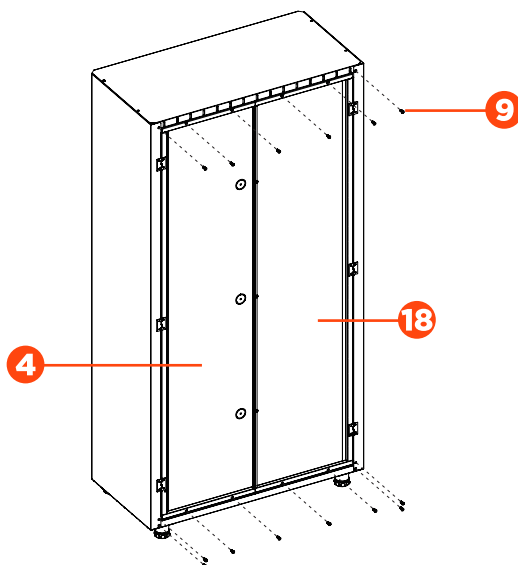

STEP 8 FIX THE HINGES

- Fully open the left door (15) 180° and make sure all hinges are fully extended.
- Push the door inward horizontally to make sure two flaps of each hinge are overlapped. Secure them with three M4 x 16 cross-head pan head screws (12), one for each hinge.
- Repeat the same procedure to fix the hinges on the right door (7).
- Fix the back panels with one M6 x 16 hex socket head screws (9) at the middle.
- Release the rubber bumpers from the bottom of the doors.

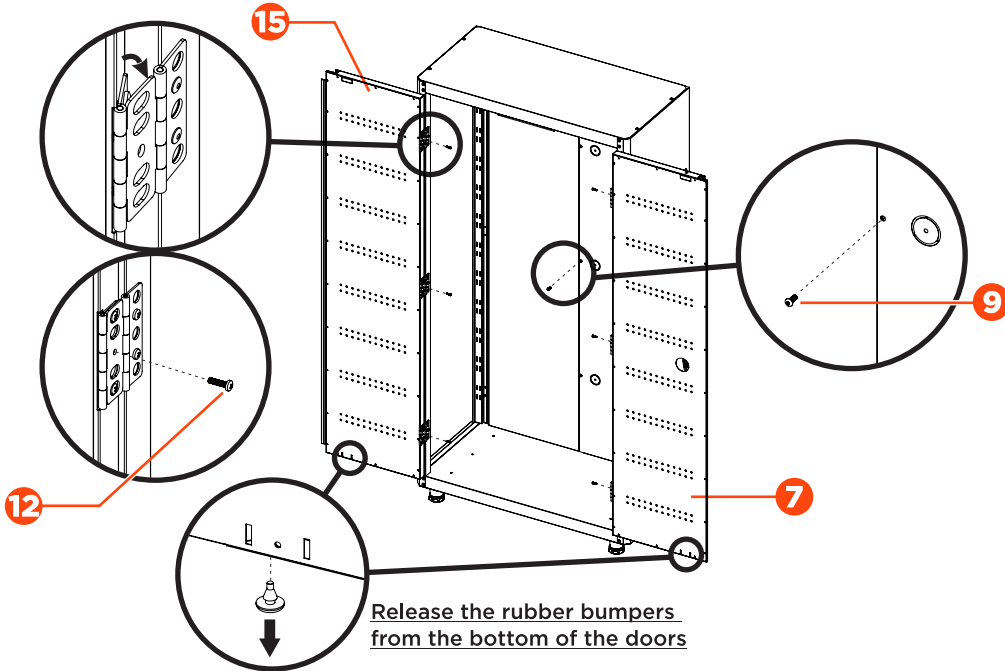

STEP 9 INSTALL THE DOOR STOPPER

- Insert the short side of the door stopper (17) onto the bottom edge of the front top beam. Tighten securely with two M4 x 16 cross-head pan head screws (12).

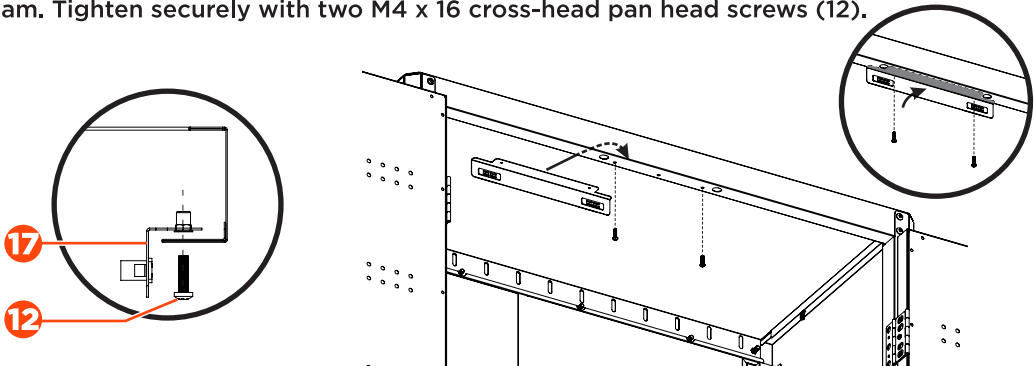

STEP 10 ADJUSTING THE CABINET AND TIGHTENING THE SCREWS

- Close the doors to see if they can touch the magnets completely and are flush with each other. If not, adjust the cabinet's top and side panels to make sure the shape of the cabinet is square and flush (diagonal line aa=bb).
- When the doors catch the magnets completely and are flush, tighten all the screws you previously tightened by hand.

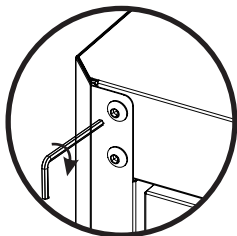

Tighten all screws you previously tightened by hand

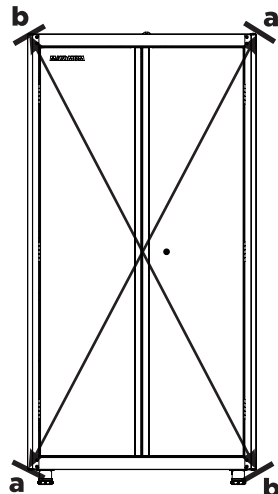

STEP 11 CONNECT THE CABINET TO THE WALL



WARNING: The M6 x 40 hex tapping bolts (3) should be drilled into the wall studs.



WARNING: The safety bracket's bottom M6 x 40 hex tapping bolt (3) should be 70 3/8" (179 cm) from the floor.

- Find a flat floor where the cabinet will be placed. Install the safety bracket (2) to the wall with two M6 x 40 hex tapping bolts (3).
- Move the cabinet against the wall. Adjust the feet (8) so that the tall cabinet will be level.
- Fasten the tall cabinet by using the safety strap (1) to tie the tall cabinet and safety bracket (2) together. Tighten securely.

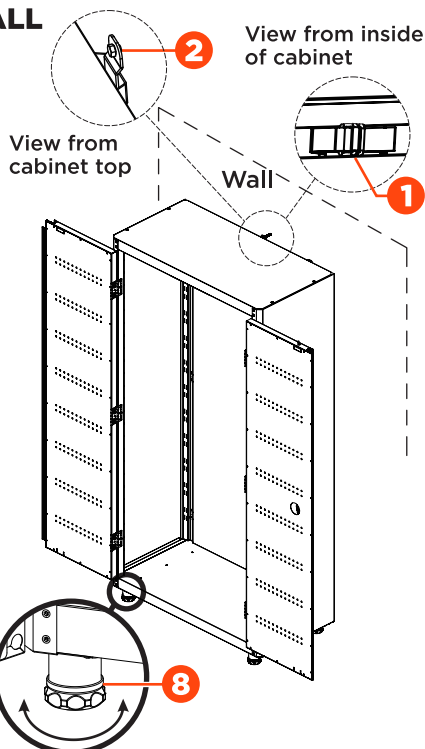
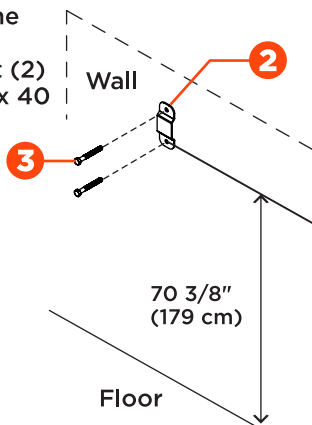

STEP 12 INSTALL THE SHELVES

- Insert twelve shelf brackets (14) into the slots on the side panels at the desired height. Make sure the four brackets (14) for each shelf (13) are at the same height.
- Place the shelves (13) over the shelf brackets (14), and push them down onto the shelf brackets (14).
- Make sure the shelves (13) are properly and safely locked by the upright hooks of the shelf brackets (14).

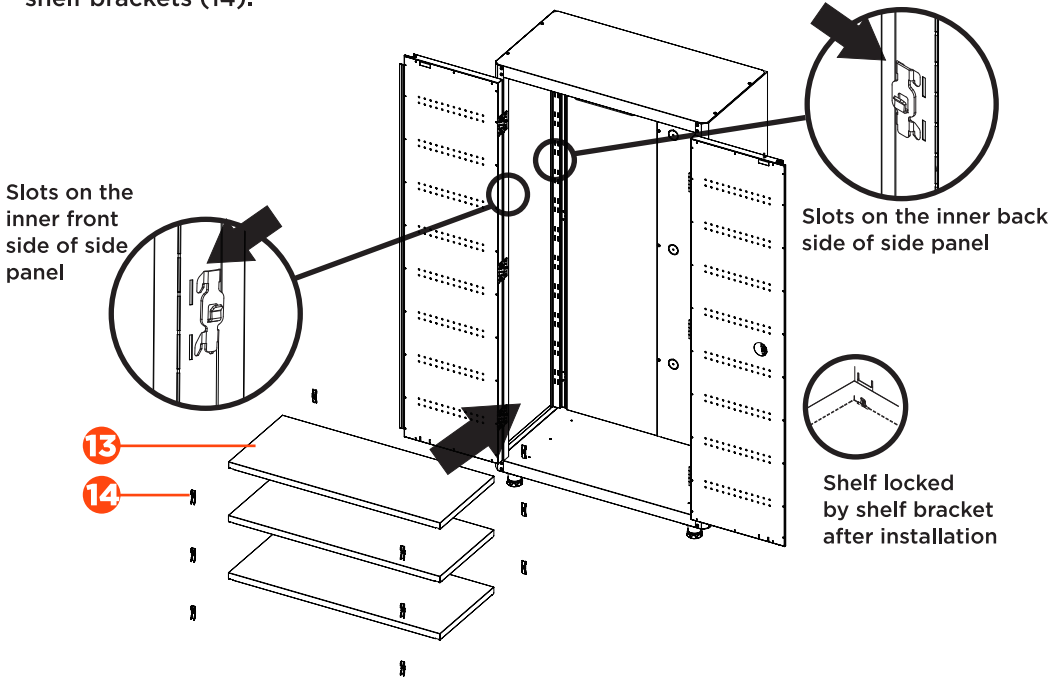

STEP 13 INSTALL THE GROMMET

- Insert the short side of the hex wrench (20) by half into your desired cord access holes, and pry the knock-out towards your side.
- Take away the knock-out carefully and install the grommet (5).

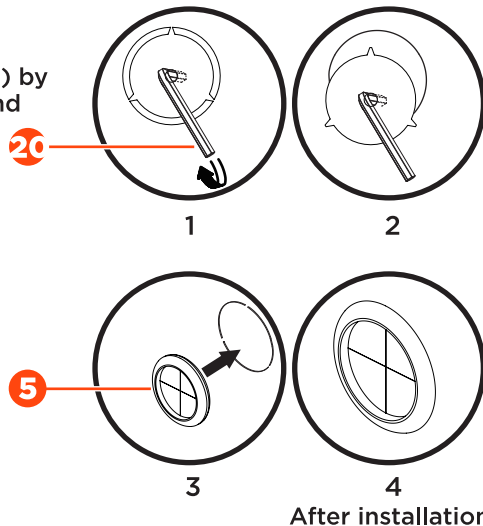

model no. 068-1810-6 | contact us 1-888-670-6682

COORDINATING PRODUCTS

This product coordinates well with the units below to offer our best storage solutions. They can be combined into various combinations to meet different storage requirements.

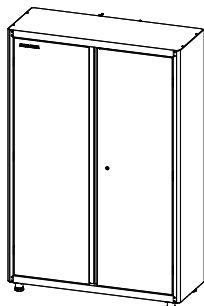
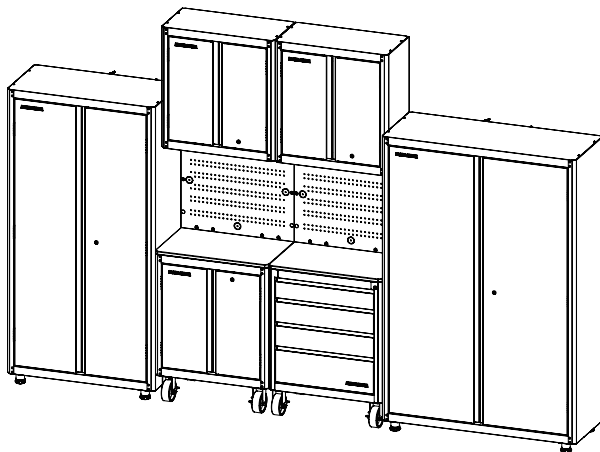

48" (122 cm)
Wide Tall Cabinet
with Stainless Steel Doors
068-1811-4

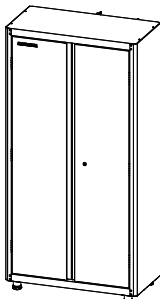

36" (93 cm)
Wide Tall Cabinet
with Stainless Steel Doors
068-1810-6

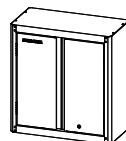

28" (71.3 cm) Wall Cabinet
with Stainless Steel Doors
068-1807-6

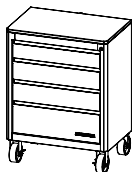

28" (71.3 cm)
4-Drawer Pre-Assembled
Base Cabinet with Castors
and Stainless Steel Fronts
068-1809-2

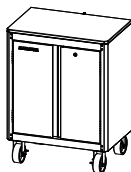

28" (71.3 cm)
2-Door Base Cabinet
with Castors and
Stainless Steel Doors
068-1808-4

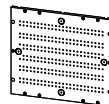

28 x 24" (71.3 x 60.8 cm)
Pegboard
068-1827-8

MAINTENANCE

- Periodically clean the surfaces with a soft cloth and water.
- Grease and oil can be removed with most standard cleaning fluids. For safety, use a nonflammable cleaning fluid.

LIMITED WARRANTY

This product is guaranteed for five (5) years from the date of original retail purchase against defects in materials and workmanship.

Subject to the conditions and limitations described below, this product, if returned to us with a proof of purchase within the stated warranty period and if covered under this warranty, will be repaired or replaced (with the same model, or one of equal value or specification), at our option. We will bear the cost of any repair or replacement and any costs of labour relating thereto.

This warranty is subject to the following conditions and limitations:

- a) A sales receipt that indicates the date of purchase must be provided;
- b) This warranty will not apply to any product or part thereof which is worn or broken or which has become inoperative due to abuse, misuse, accidental damage, neglect or lack of proper installation, operation or maintenance (as outlined in the applicable owner's manual or operating instructions) or which is being used for industrial, professional, commercial or rental purposes;
- c) This warranty will not apply to normal wear and tear or to expendable parts or accessories that may be supplied with the product which are expected to become inoperative or unusable after a reasonable period of use;
- d) This warranty will not apply to routine maintenance and consumable items such as, but not limited to, fuel, lubricants, vacuum bags, blades, belts, sandpaper, bits, fluids, tune-ups or adjustments;
- e) This warranty will not apply if damage is caused by repairs made or attempted by others (i.e., persons not authorized by the manufacturer);
- f) This warranty will not apply to any product that was sold as a reconditioned or refurbished product (unless otherwise specified in writing);
- g) This warranty will not apply to any product or part thereof if any part from another manufacturer is installed therein or any repairs or alterations have been made or attempted by unauthorized persons;
- h) This warranty will not apply to normal deterioration of the exterior finish, such as, but not limited to, scratches, dents, paint chips, or to any corrosion or discolouring by heat, abrasive and chemical cleaners; and
- i) This warranty will not apply to component parts sold by and identified as the product of another company, which shall be covered under the product manufacturer's warranty, if any.

Additional Limitations

This warranty applies only to the original purchaser and may not be transferred. Neither the retailer nor the manufacturer shall be liable for any other expense, loss or damage, including, without limitation, any indirect, incidental, consequential or exemplary damages arising in connection with the sale, use or inability to use this product.

Notice to Consumer

This warranty gives you specific legal rights, and you may have other rights, which may vary from province to province. The provisions contained in this warranty are not intended to limit, modify, take away from, disclaim or exclude any statutory warranties set forth in any applicable provincial or federal legislation.