

MAXIMUM[®] MD

PROFESSIONAL GRADE

28" (71.3 cm) 4-Drawer Pre-Assembled Base Cabinet with Castors and Stainless Steel Fronts



Model no. 068-1809-2

IMPORTANT

Please read this manual carefully before assembling and using this product, and save it for reference.

INSTRUCTION MANUAL

Due to continuing improvements, the actual product may differ slightly from the product described herein.

TABLE OF CONTENTS

SAFETY	3
EXPLODED VIEW / PARTS LIST	4
ASSEMBLY INSTRUCTIONS	5
COORDINATING PRODUCTS	7
MAINTENANCE	7
WARRANTY	8

NOTE

If any parts are missing or damaged, or if you have any questions, please call our toll-free helpline at: 1-888-670-6682. Have the product number, cash register receipt and the date of purchase available when you call. **DO NOT SHIP YOUR PRODUCT BACK TO THE STORE UNLESS WE SEND YOU WRITTEN INSTRUCTIONS FOR RETURN.**





SAVE THESE INSTRUCTIONS

This manual contains important safety and operating instructions. Read all instructions and follow them carefully with use of this product.

SAFETY

To reduce the risk of serious injury, read and follow the safety instructions below before assembling and using this product.

- This product is intended for indoor use only.
- This product is not designed for commercial nor industrial usage.
- Keep the product on level surfaces. The product could become unstable and it may tip over if stored or moved on an uneven surface, which may cause personal injury, death or product damage.
- Any assembly or maintenance of the cabinet must be carried out by adults only.
- Use at least two people to move, assemble or install this cabinet. Failure to do so can result in personal injury or product damage.
- Check all nuts and bolts periodically for tightness. When required, tighten them.
- Close and lock the doors before moving this cabinet.
- Fill from the bottom drawer up. If the cabinet is filled from the top drawer down, it will be top-heavy and may tip over.
- DO NOT alter this product in any manner. For example, do not weld external bar locks or attach electrical equipment. This may cause product damage or personal injury.
- DO NOT exceed the following weight limits for this product.
 - Maximum load: 550 lb (249 kg)
 - Maximum load for each drawer: 100 lb (45 kg)
 - Maximum load for rubber wood top: 150 lb (68 kg)

 WARNING	
	<p>Children have died from furniture tipover. To reduce the risk of furniture tipover:</p> <ul style="list-style-type: none"> -ALWAYS install anti-tip device provided. -NEVER put a TV on this product. -NEVER allow children to stand, climb or hang on drawers, doors, or shelves.
	<ul style="list-style-type: none"> -NEVER open more than one drawer at a time. -Place heaviest items in the lowest drawers. <p><i>This is a permanent label. Do not remove!</i></p>



- Before assembling and using this product, carefully read this instruction manual and all of the labels affixed to the product. Failure to follow all warnings and instructions may result in product damage or personal injury.
- Save all warnings and instructions for future reference.

No.	Description	Part No.	Qty	No.	Description	Part No.	Qty
1	Safety strap	314230	1	8	Rigid castor (R)	302280	1
2	Safety bracket	212591	1	9	Drawer liner	550239	4
3	M6 x 40 hex tapping bolt	320328	2	10	Rigid castor (L)	302281	1
4	Lock (001-010)	304075	1	11	Slide (Left)	300000	4
5	Slide (Right)	300001	4	12	Key (001-010)	304196	2
6	Swivel castor	302201	2	13	Rubberwood top	307082	1
7	M6 x 16 hex flange bolt *	321006	16				

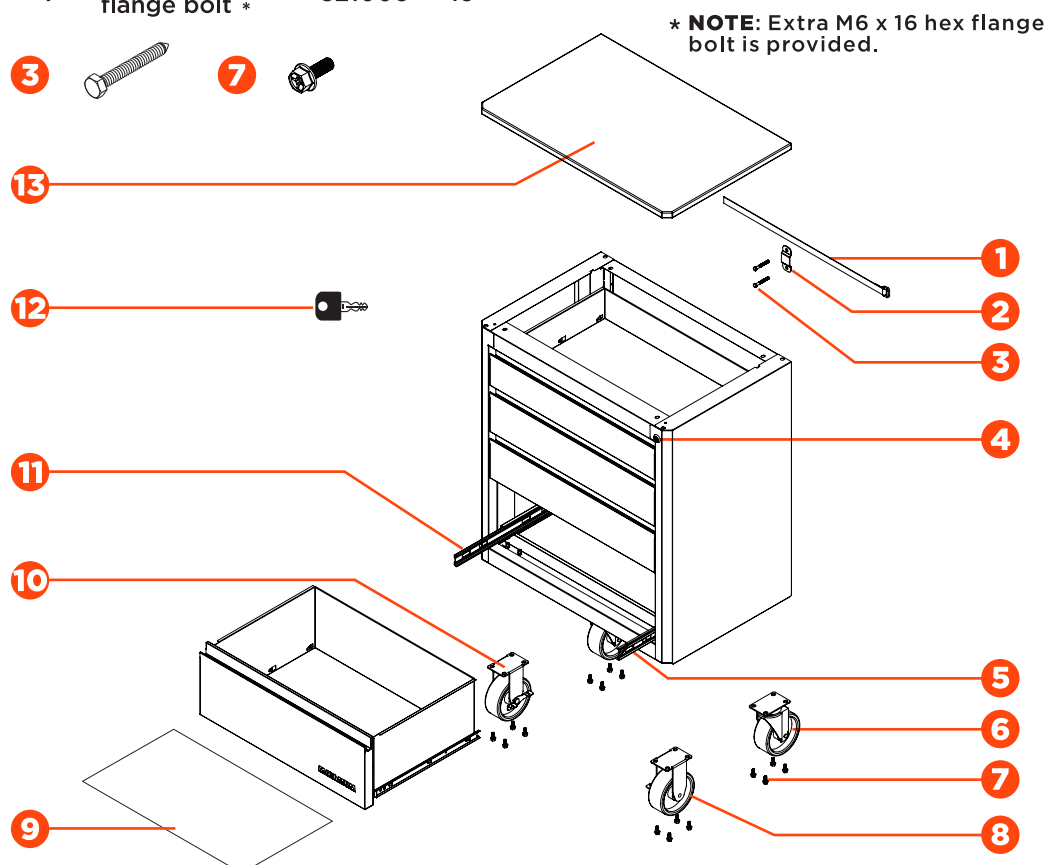
**NOTE**

- The keys are taped to the top of the castor carton, which is placed in the third drawer of the cabinet.
- Replacement keys may be ordered. Call our toll-free number. The code which appears on the lock will be required.
- Give information for spare parts: part number and quantity required.

ASSEMBLY INSTRUCTIONS

- Remove all items from the box and ensure that all parts listed on the parts list are present.
- Inspect the product carefully to make sure no breakage or damage occurred during shipping.
- Do not discard the carton or any packaging material until all parts have been examined.

TOOLS REQUIRED FOR ASSEMBLY

- Power drill (not included)
- Measuring tape (not included)

CASTOR INSTALLATION

NOTE: Make sure the brakes of the rigid castors (8 and 10) face towards the inside of the base cabinet.

NOTE: For easy manoeuvrability, make sure the lettering "ON" on the brakes is facing towards the front of the cabinet.

- Carefully lay the base cabinet on its back, with a soft mat underneath for protection.
- Position the two swivel castors (6) on the back side of the base cabinet. Insert eight M6 x 16 hex flange bolts (7) through the castors and into the bottom of the base cabinet. Tighten securely.
- Repeat the same procedure to install the two rigid castors (8 and 10) on the front side of the base cabinet. The brakes of the rigid castors (8 and 10) should face towards the inside of the base cabinet.

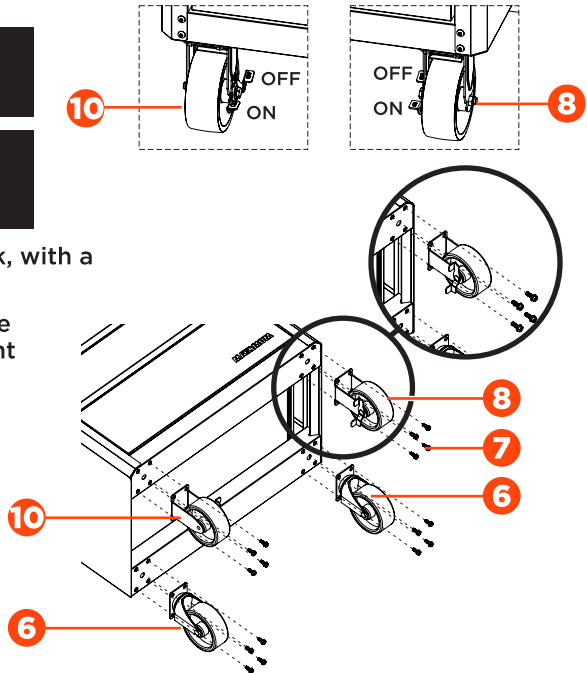

DRAWER REMOVAL

Empty the drawer. Pull the drawer out until almost fully extended. There are two black release levers, one on each side of the drawer. Pull up the black release lever on one side, while pushing down the black release lever on the other side. While holding the levers in the positions as instructed above, pull the drawer outward until it is released from the drawer slides.

Pull up – one side

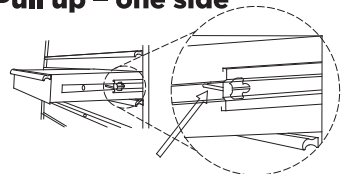

Push down – other side

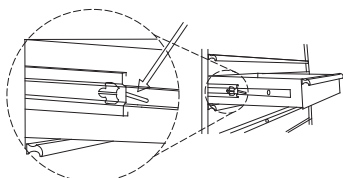

DRAWER REPLACEMENT

Extend the drawer slides from the tool chest or cabinet. Insert the brackets on each side of the drawer into the slots in the slides, being careful that they are properly positioned. Once properly inserted, completely close the drawer to set the slides in their proper positions.

CONNECTING THE CABINET TO THE WALL

NOTE: The M6 x 40 hex tapping bolts (3) should be drilled into the wall studs.

NOTE: The safety bracket's bottom M6 x 40 hex tapping bolt (3) should be 34 1/2" (87.7 cm) from the floor.

- Remove the top drawer (as instructed on page 5) from the cabinet.
- Bolt the safety bracket (2) with two M6 x 40 hex tapping bolts (3) to the stud in the wall and fasten the base cabinet by using the safety strap (1) to tie the base cabinet and safety bracket (2) together.

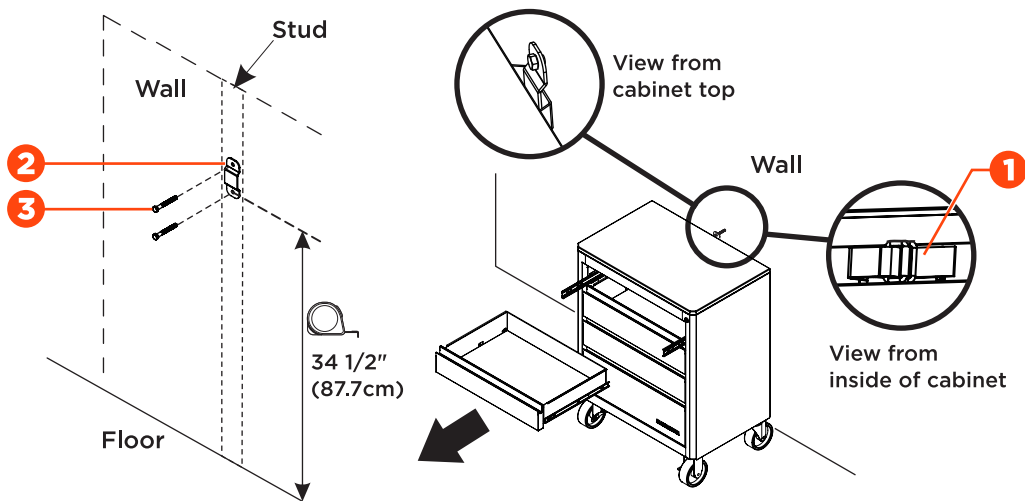

- Install the top drawer back (as instructed on page 5) into the cabinet. The cabinet is ready for use.

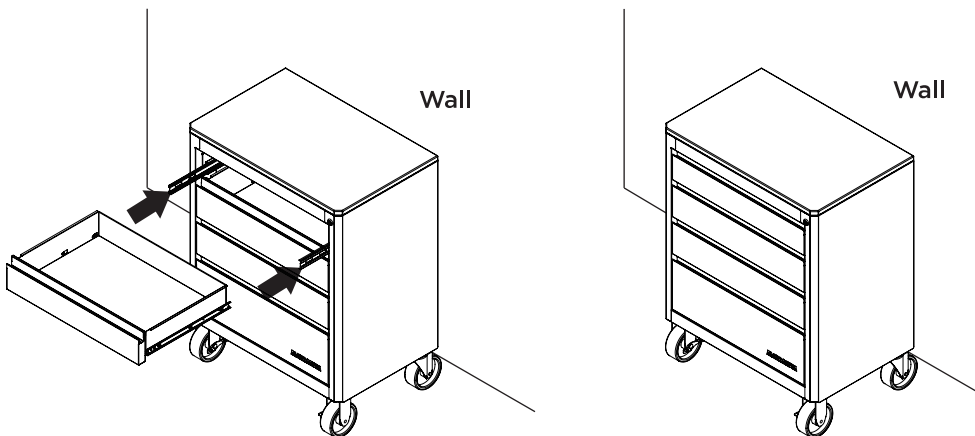

COORDINATING PRODUCTS

This product coordinates well with the units below to offer our best storage solutions. They can be combined into various combinations to meet different storage requirements.

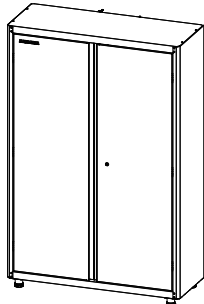
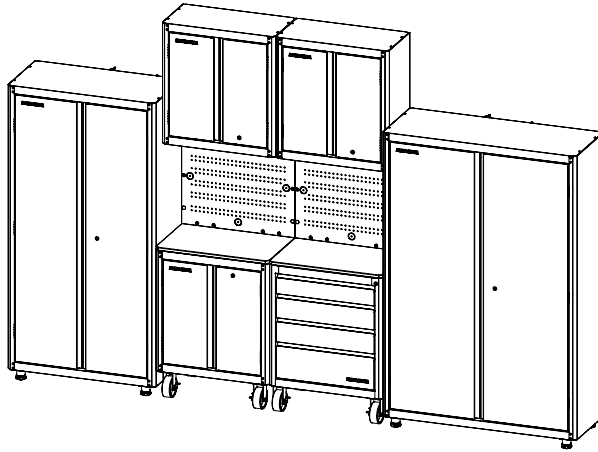

48" (122 cm)
Wide Tall Cabinet
with Stainless Steel Doors
068-1811-4

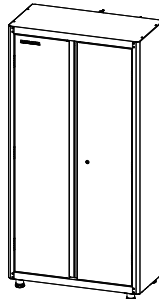

36" (93 cm)
Wide Tall Cabinet
with Stainless Steel Doors
068-1810-6

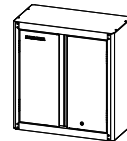

28" (71.3 cm) Wall Cabinet
with Stainless Steel Doors
068-1807-6



28" (71.3 cm)
4-Drawer Pre-Assembled
Base Cabinet with Castors
and Stainless Steel Fronts
068-1809-2

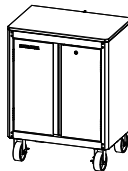

28" (71.3 cm)
2-Door Base Cabinet
with Castors and
Stainless Steel Doors
068-1808-4

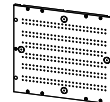

28 x 24" (71.3 x 60.8 cm)
Pegboard
068-1827-8

MAINTENANCE

- Lubricate the slides (twice a year) with a spray lubricant or light duty oil.
- Periodically clean the surfaces with a soft cloth and water.
- Grease and oil can be removed with most standard cleaning fluids. For safety, use a nonflammable cleaning fluid.

LIMITED WARRANTY

This product is guaranteed for five (5) years from the date of original retail purchase against defects in materials and workmanship.

Subject to the conditions and limitations described below, this product, if returned to us with a proof of purchase within the stated warranty period and if covered under this warranty, will be repaired or replaced (with the same model, or one of equal value or specification), at our option. We will bear the cost of any repair or replacement and any costs of labour relating thereto.

This warranty is subject to the following conditions and limitations:

- a) A sales receipt that indicates the date of purchase must be provided;
- b) This warranty will not apply to any product or part thereof which is worn or broken or which has become inoperative due to abuse, misuse, accidental damage, neglect or lack of proper installation, operation or maintenance (as outlined in the applicable owner's manual or operating instructions) or which is being used for industrial, professional, commercial or rental purposes;
- c) This warranty will not apply to normal wear and tear or to expendable parts or accessories that may be supplied with the product which are expected to become inoperative or unusable after a reasonable period of use;
- d) This warranty will not apply to routine maintenance and consumable items such as, but not limited to, fuel, lubricants, vacuum bags, blades, belts, sandpaper, bits, fluids, tune-ups or adjustments;
- e) This warranty will not apply if damage is caused by repairs made or attempted by others (i.e., persons not authorized by the manufacturer);
- f) This warranty will not apply to any product that was sold as a reconditioned or refurbished product (unless otherwise specified in writing);
- g) This warranty will not apply to any product or part thereof if any part from another manufacturer is installed therein or any repairs or alterations have been made or attempted by unauthorized persons;
- h) This warranty will not apply to normal deterioration of the exterior finish, such as, but not limited to, scratches, dents, paint chips, or to any corrosion or discolouring by heat, abrasive and chemical cleaners; and
- i) This warranty will not apply to component parts sold by and identified as the product of another company, which shall be covered under the product manufacturer's warranty, if any.

Additional Limitations

This warranty applies only to the original purchaser and may not be transferred. Neither the retailer nor the manufacturer shall be liable for any other expense, loss or damage, including, without limitation, any indirect, incidental, consequential or exemplary damages arising in connection with the sale, use or inability to use this product.

Notice to Consumer

This warranty gives you specific legal rights, and you may have other rights, which may vary from province to province. The provisions contained in this warranty are not intended to limit, modify, take away from, disclaim or exclude any statutory warranties set forth in any applicable provincial or federal legislation.