

model no. 068-1577-2

**Mastercraft**®/MD

## 54" (137 cm) Workstation

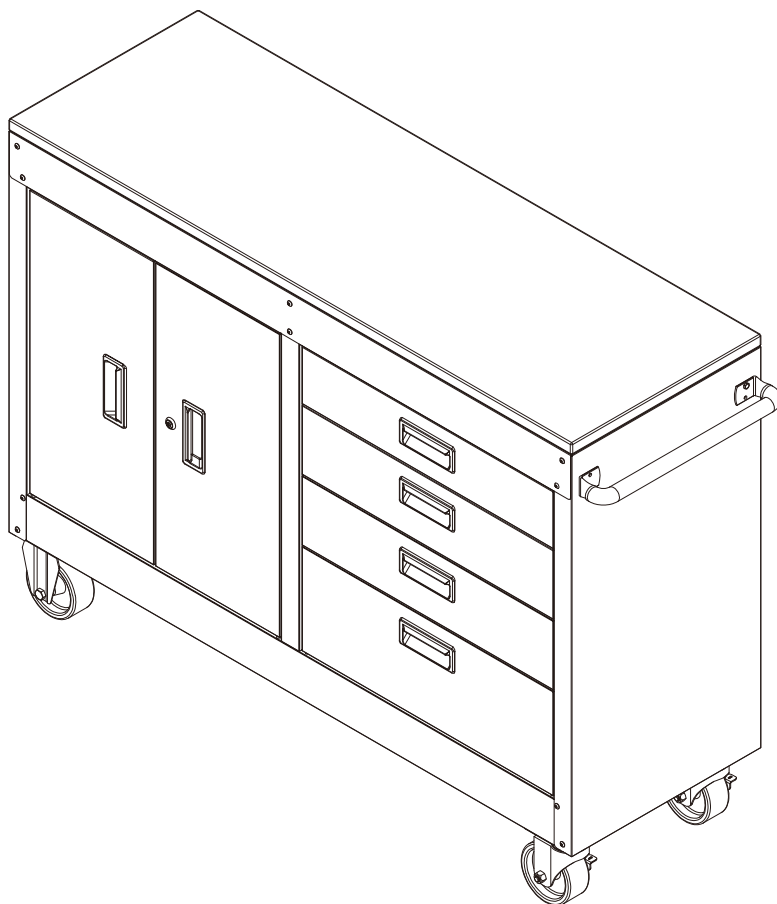

### **IMPORTANT**

Please read this manual carefully before assembling and using this product, and save it for reference.

### **INSTRUCTION MANUAL**

Due to continuing improvements, the actual product may differ slightly from the product described herein.

## TABLE OF CONTENTS

|                       |    |
|-----------------------|----|
| SAFETY                | 3  |
| MAINTENANCE           | 3  |
| EXPLODED VIEW         | 4  |
| PARTS LIST            | 5  |
| ASSEMBLY INSTRUCTIONS | 6  |
| COORDINATING PRODUCTS | 18 |
| WARRANTY              | 19 |

**NOTE:**

If any parts are missing or damaged, or if you have any questions, please call our toll-free helpline at: 1-800-689-9928. Have the product number, cash register receipt and the date of purchase available when you call. DO NOT SHIP YOUR PRODUCT BACK TO THE STORE UNLESS WE SEND YOU WRITTEN INSTRUCTIONS FOR RETURN.

**SAVE THESE INSTRUCTIONS**

This manual contains important safety and operating instructions. Read all instructions and follow them carefully with use of this product.

## SAFETY

To reduce the risk of serious injury, read and follow the safety instructions below before assembling and using this product.

- This product is intended for indoor use only.
- This product is not designed for commercial nor industrial usage.
- Keep the product on level surfaces. The product could become unstable and it may tip over if stored or moved on an uneven surface, which may cause personal injury, death or product damage.
- Use at least two people to move, assemble or install this cabinet. Failure to do so can result in personal injury or product damage.
- DO NOT open more than one drawer at a time.
- Fill from the bottom drawer up. If the cabinet is filled from the top drawer down, it will be top-heavy and may tip over.
- Use the brakes when not moving this product. This will prevent the product from rolling, which may cause personal injury or product damage.
- Close and lock the doors before moving this cabinet.
- It is always recommended to secure this product to the wall with the anti-tip hardware provided.
- DO NOT alter this product in any manner. For example, do not weld external bar locks or attach electrical equipment. This may cause product damage or personal injury.
- DO NOT leave children unattended near this product. Cabinets may tip over if improperly opened.
- DO NOT step or climb on this product or on the drawers.
- DO NOT exceed the following weight limits for this product.
  - Maximum load: 830 lb (376 kg)
  - Maximum load for shelf: 100 lb (45 kg)
  - Maximum load for bottom panel: 150 lb (68 kg)
  - Maximum load for each drawer: 70 lb (32 kg)
  - Maximum load for rubberwood top: 300 lb (136 kg)

## MAINTENANCE

- For castors, use high quality bearing grease once a year.
- Lubricate the slides (twice a year) with a spray lubricant or light duty oil.
- Periodically clean the surfaces with a soft rag and water.
- Grease and oil can be removed with most standard cleaning fluids. For safety, use a nonflammable cleaning fluid.



- Before assembling and using this product, carefully read this instruction manual and all of the labels affixed to the product. Failure to follow all warnings and instructions may result in product damage or personal injury.
- Save all warnings and instructions for future reference.

## EXPLODED VIEW

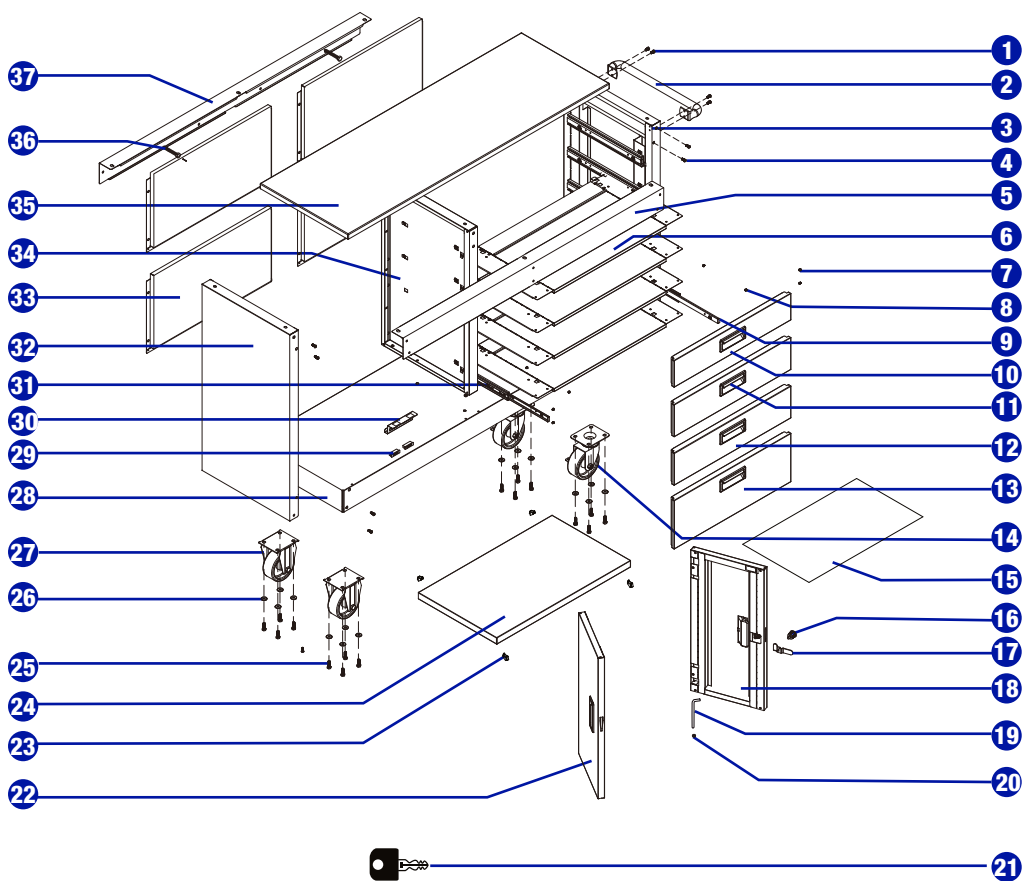
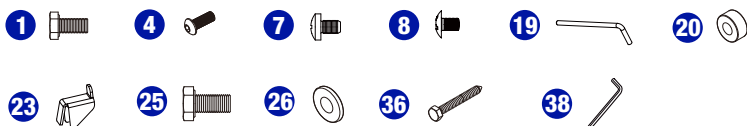



## PARTS LIST

| No. | Description                               | Part No. | Qty. |
|-----|---|----------|------|
| 1   | M6 x 12 hex bolt                          | 321051   | 4    |
| 2   | Side handle                               | 306046   | 1    |
| 3   | Right side panel                          | 121645   | 1    |
| 4   | M6 x 16 hex socket head screw *           | 320327   | 52   |
| 5   | Front top beam                            | 242933   | 1    |
| 6   | Drawer panel                              | 242781   | 4    |
| 7   | M4 x 6 cross-head pan head tapping bolt * | 320335   | 16   |
| 8   | M4 x 5 cross-head bolt *                  | 320336   | 16   |
| 9   | Right slide                               | 300399   | 4    |
| 10  | Top drawer front panel                    | 121548   | 1    |
| 11  | Handle                                    | 306018   | 6    |
| 12  | Middle drawer front panel                 | 121549   | 2    |
| 13  | Bottom drawer front panel                 | 121550   | 1    |
| 14  | Swivel castor                             | 302065   | 2    |
| 15  | Drawer liner                              | 552183   | 4    |
| 16  | Lock (001-010)                            | 304236   | 1    |
| 17  | Locking hook                              | 236397   | 1    |
| 18  | Right door                                | 118124   | 1    |

| No. | Description              | Part No. | Qty. |
|-----|--------------------------|----------|------|
| 19  | Pin                      | 237444   | 4    |
| 20  | Rubber ring *            | 314219   | 2    |
| 21  | Key (001-010)            | 304196   | 2    |
| 22  | Left door                | 118123   | 1    |
| 23  | Shelf bracket            | 203902   | 4    |
| 24  | Shelf                    | 121659   | 1    |
| 25  | M8 x 25 hex bolt         | 321047   | 16   |
| 26  | Washer                   | 324002   | 16   |
| 27  | Rigid castor             | 302066   | 2    |
| 28  | Bottom panel             | 121644   | 1    |
| 29  | Magnet                   | 312033   | 2    |
| 30  | Door stopper             | 236270   | 1    |
| 31  | Left slide               | 300398   | 4    |
| 32  | Left side panel          | 121608   | 1    |
| 33  | Back panel               | 113539   | 4    |
| 34  | Centre panel             | 121646   | 1    |
| 35  | Rubberwood top           | 572164   | 1    |
| 36  | M6 x 40 hex tapping bolt | 320328   | 2    |
| 37  | Back top beam            | 242934   | 1    |
| 38  | Hex wrench               | 317023   | 1    |

\* NOTE: Extra pcs are provided.

**NOTE:**

- Replacement keys may be ordered. Call our toll-free number. The code which appears on the lock will be required.
- Give information for spare parts: part number and quantity required.

## ASSEMBLY INSTRUCTIONS

### TOOLS REQUIRED FOR ASSEMBLY

- Hex wrench (38)
- Power Drill (not included)
- Cross-head Screwdriver (not included; magnetic is preferable)
- Measuring Tape (not included)

**NOTE:** Assemble on a flat surface. A piece of cardboard is recommended to keep the product from being scratched during assembly.



Please wear gloves during the whole assembly process.

### STEP 1 ATTACH THE SIDE AND BOTTOM PANELS

- Lay the bottom panel (28) on its front and attach the side panels (3 & 32) to the bottom panel (28) with two M6 x 16 hex socket head screws (4) through the holes on bottom left and right corners. **DO NOT** tighten.
- Screw two M6 x 16 hex socket head screws (4) at the middle of bottom. Tighten securely.

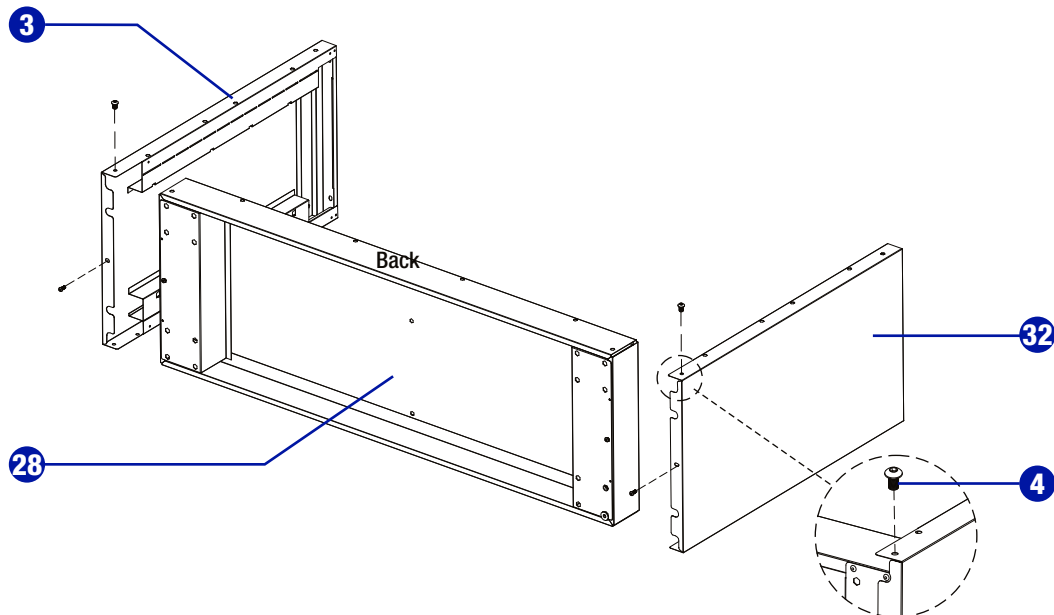

## STEP 2 INSTALL THE CASTORS

**NOTE:** For easy movement, the swivel casters are suggested to be installed on the same side as the side handle.

- Position the two rigid castors (27) on one side of the bottom of the cabinet. Insert the M8 x 25 hex bolts (25) through washers (26), then through the castors and into the bottom of the cabinet. Tighten securely.
- Repeat for the two swivel castors (14) on the other side of the cabinet.

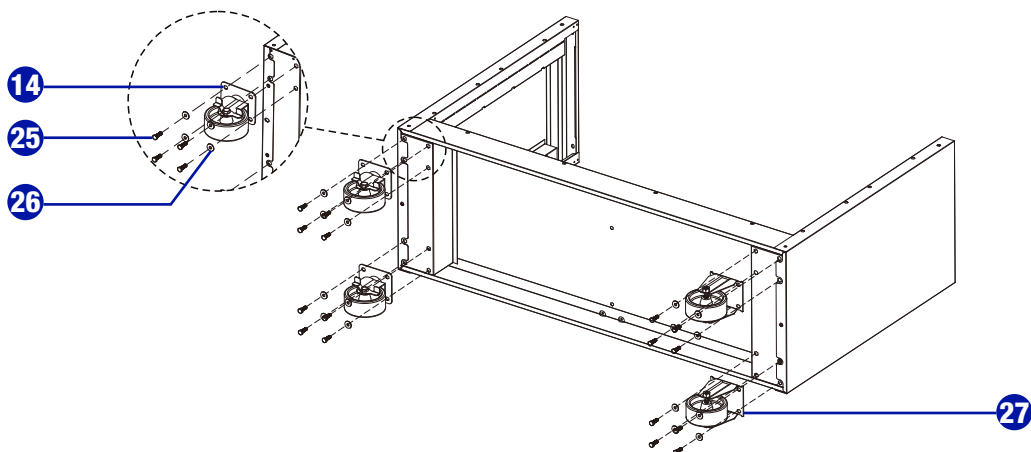

## STEP 3 ATTACH THE CENTRE PANEL

Attach the centre panel (34) to the bottom panel (28) with two M6 x 16 hex socket head screws (4). Tighten securely.

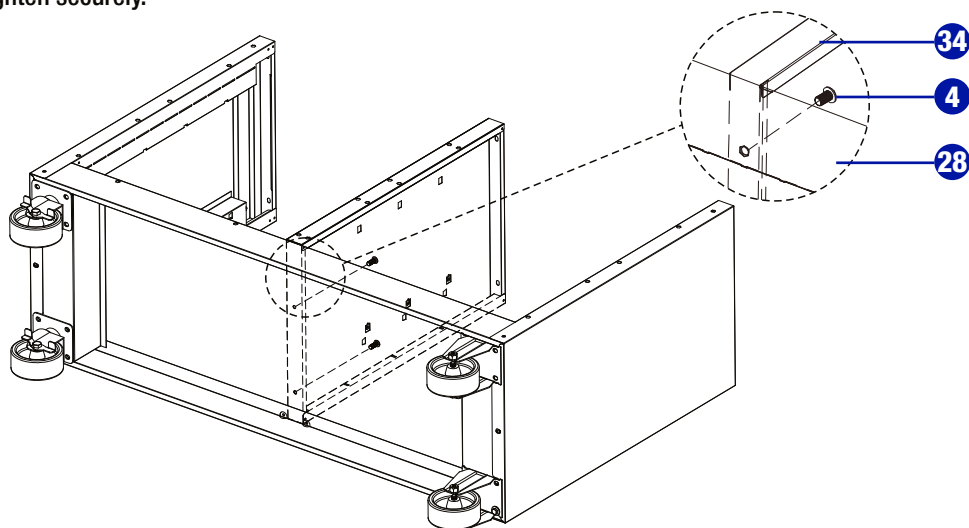

## STEP 4 ATTACH THE BACK TOP BEAM

Attach the back top beam (37) to the side panels (3 & 32) with two M6 x 16 hex socket head screws (4). Insert the screws by hand. DO NOT tighten.

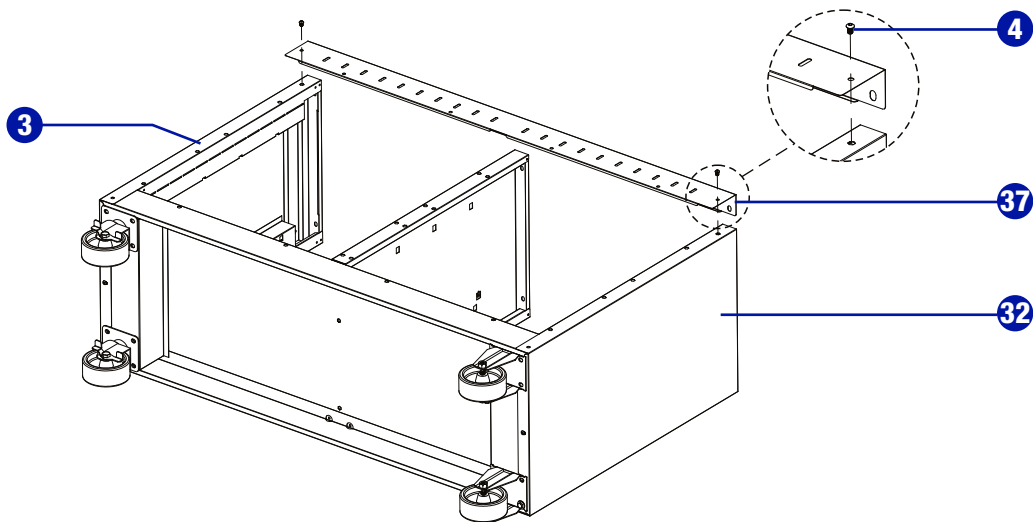

## STEP 5 ATTACH THE BACK PANELS



The top edge of the top back panel should be inserted under the back top beam.

- Attach the back panels (33) to the back of the cabinet with twenty-eight M6 x 16 hex socket head screws (4). Insert the screws by hand. DO NOT tighten.

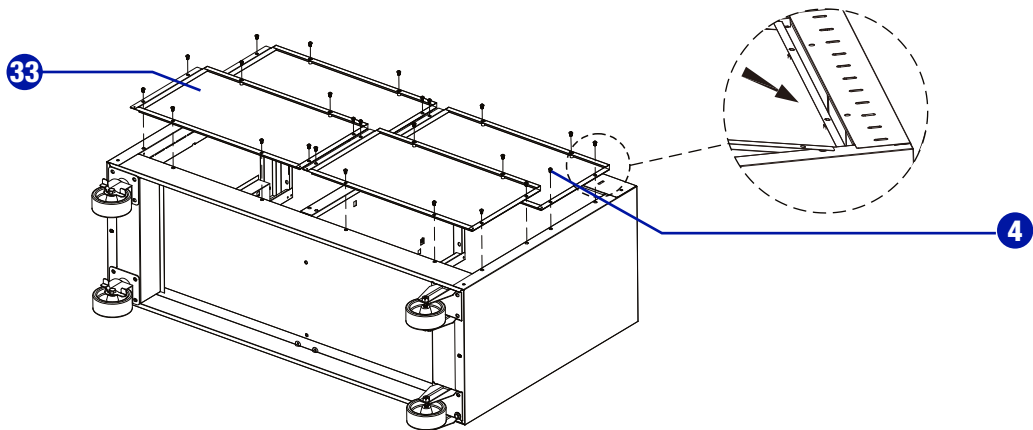

## STEP 6 ATTACH THE DOOR STOPPER

- First press the two trapezoidal tabs at the right side of the front top beam (5) inwards by 90 degrees.
- Insert the door stopper (30) onto the two tabs. Make sure the magnets (29) are outside of the front top beam and face toward the front of the cabinet.
- Finally, bend the two trapezoidal tabs of the front top beam (5) outwards until they are against the door stopper (30).

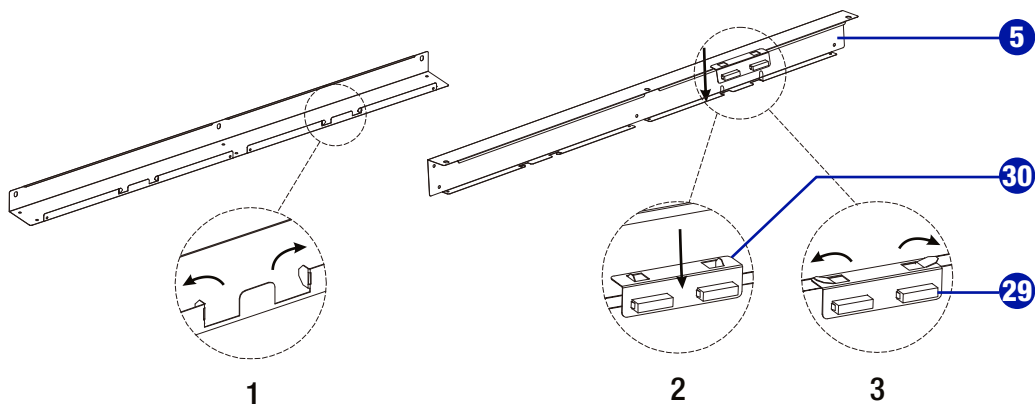

## STEP 7 ATTACH THE FRONT TOP BEAM

- Attach the front top beam (5) to the side panels (3 & 32) with six M6 x 16 hex socket head screws (4). Insert the screws by hand. DO NOT tighten.
- At the same time, screw four M6 x 16 hex socket head screws (4) through the side panels (3 & 32) to the bottom panel (28). DO NOT tighten.

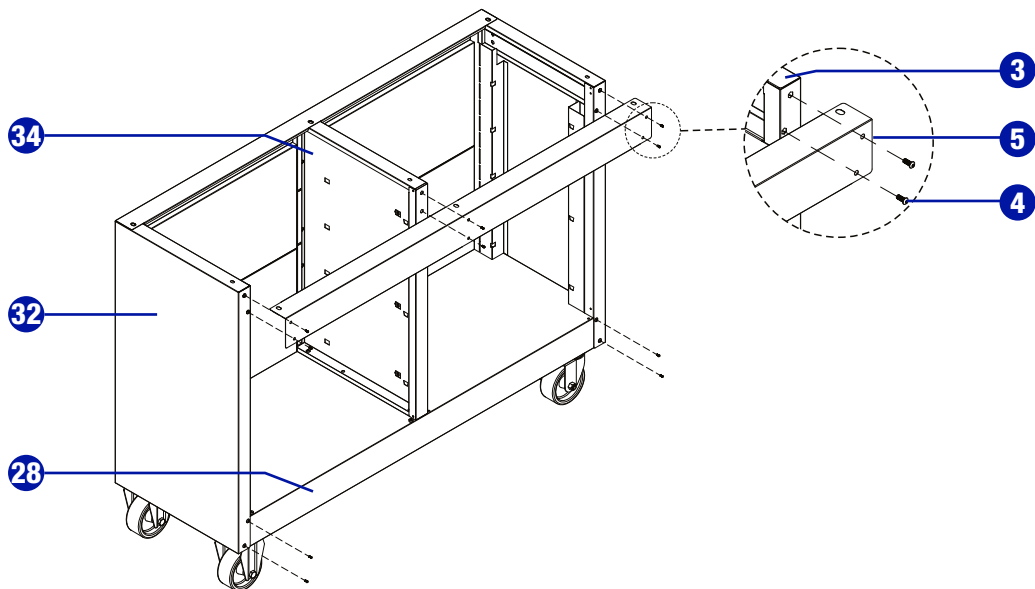

## STEP 8 INSTALL THE SLIDES

- Slide the back clip of the outer rail of a right slide (9) into the back slot at the right side panel (3) and slide the front clip of the outer rail into the slot at the front of the right side panel (3).
- Repeat the same procedure to install the other right slides (9) to the right side panel (3).
- Repeat the same procedure to install four left slides (31) to the centre panel (34).
- Bend the eight clips above the left and right slides outwards with the help of a straight screwdriver so as to secure the slides.

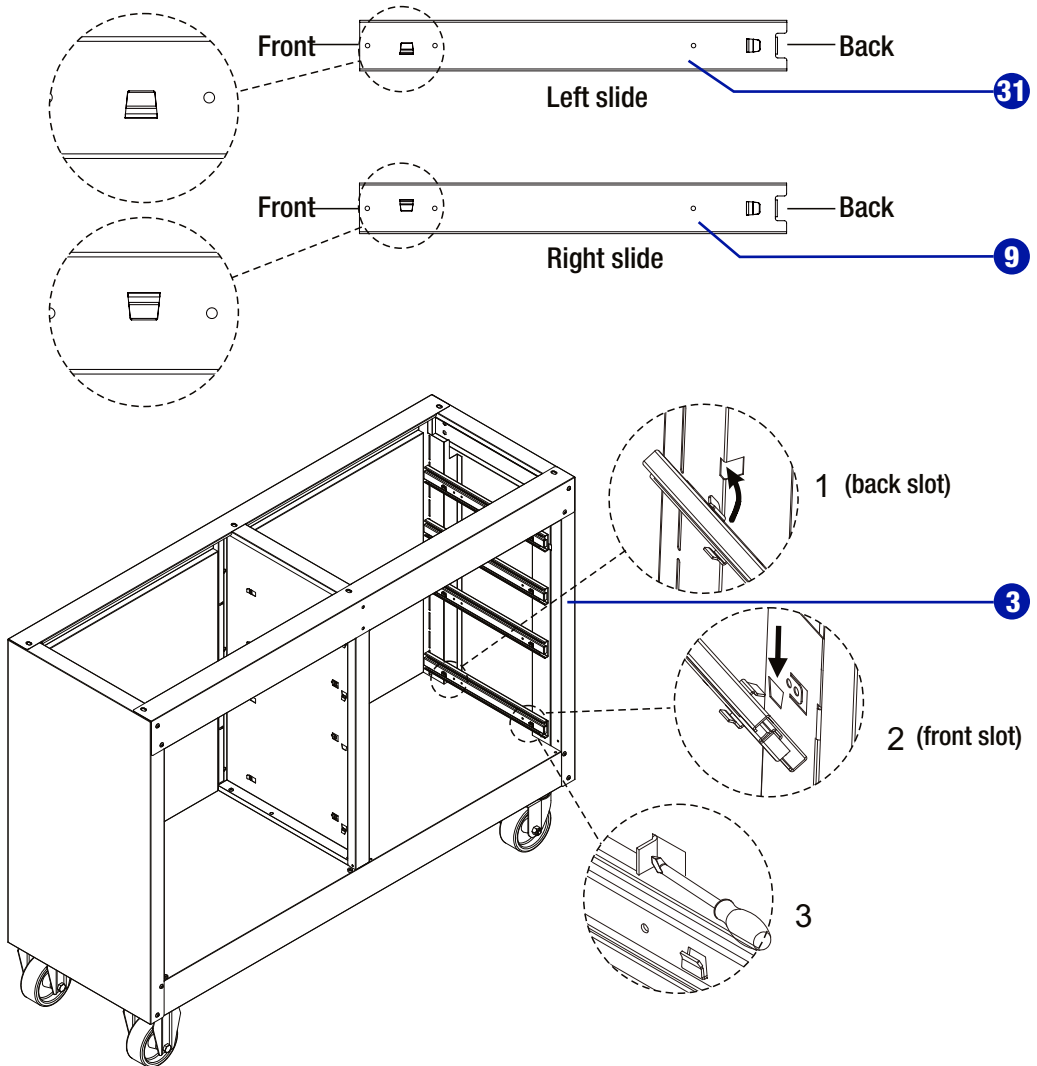

## STEP 9 ATTACH THE SOLID WOOD TOP AND SECURE TO WALL

- Attach the rubberwood top (35) to the cabinet top by inserting six M6 x 16 hex socket head screws (4) through the pre-drilled holes underneath. Tighten securely.
- At the same time, square up the cabinet and make sure the inner diagonal lines are equal with the help of a measuring tape. Tighten all screws on front and back.
- Move the cabinet on a flat floor against a wall. Use a power drill to attach the cabinet to the wall with two M6 x 40 hex tapping bolts (36) through the holes at the back top beam (37). Tighten securely. For safety, the bolts shall be drilled into the studs of the wall.

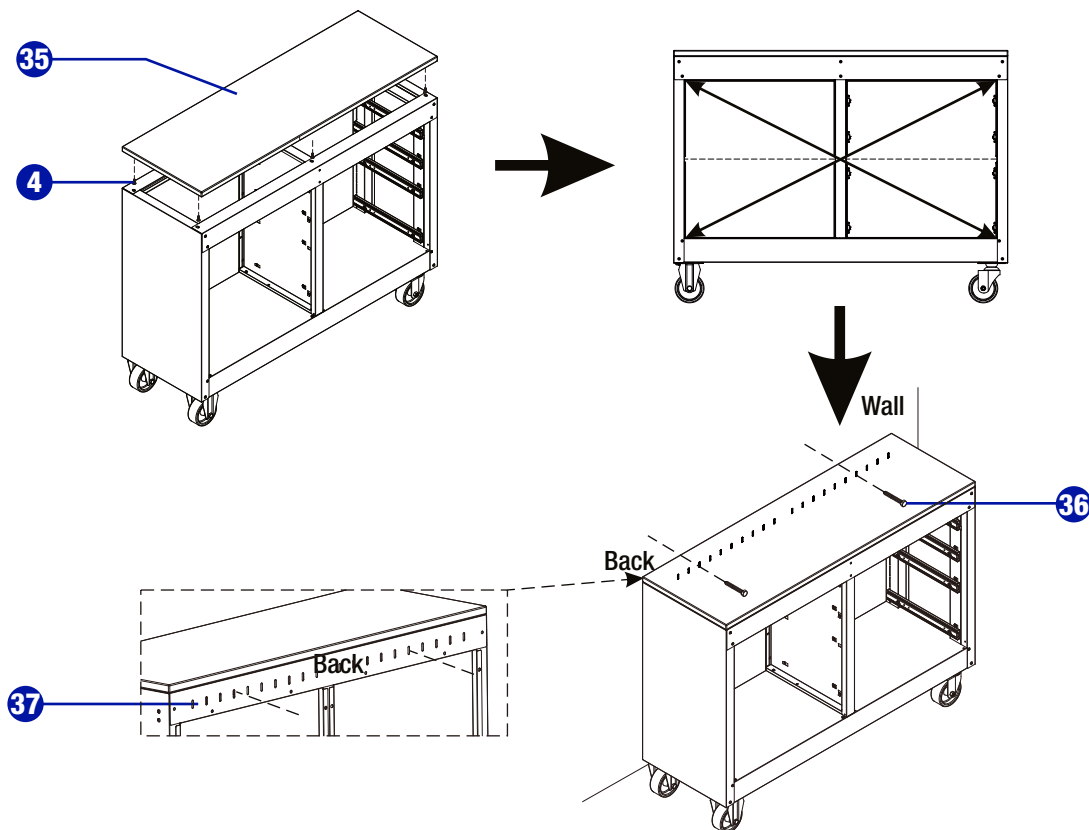

## STEP 10 ASSEMBLE THE DRAWERS

**NOTE:** Make sure your platform is free of debris or the drawer bottom is protected before laying the drawer on its bottom.

- Lay the drawer panel (6) on its bottom.
- Bend up the side panels upright to 90°. During this process, insert the clips at the two ends of the back panel into the slots of the side panels.
- Bend all the clips towards the back panel until they lean against the back panel.

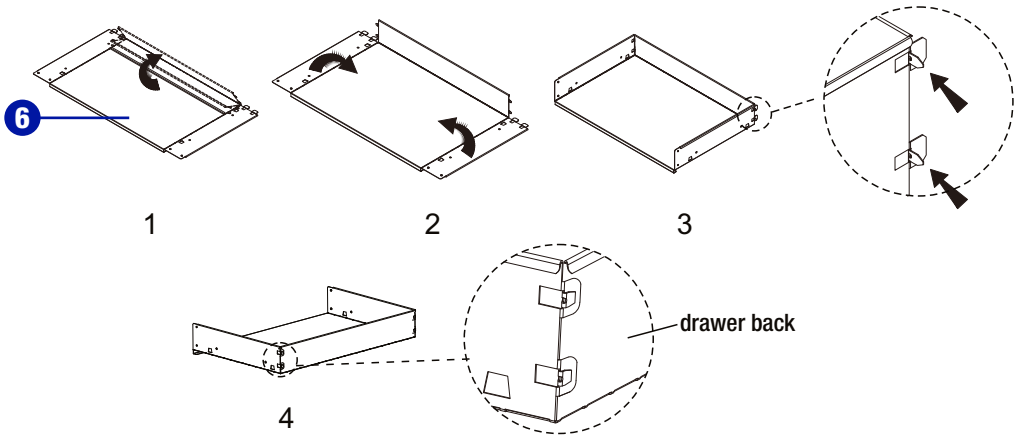

### STEP 11 ASSEMBLE THE DRAWERS (continued)

- Lay down the drawer front panel (10 & 12 & 13) on its face with a soft mat underneath for protection.
- Put the drawer body's front onto the drawer front panel.
- Slide the drawer body's front bottom bended edge into the bottom groove of the drawer front panel.
- Turn up the drawer front panel upright to 90°
- Fasten the drawer front panel and side panels together by screwing four M4 x 6 cross-head pan head tapping bolts (7).
- Repeat the same procedure to assemble all drawers.

**NOTE:** At this step, DO NOT use power tool. Otherwise, product damage may be caused. A magnetic cross-head screwdriver is preferred.

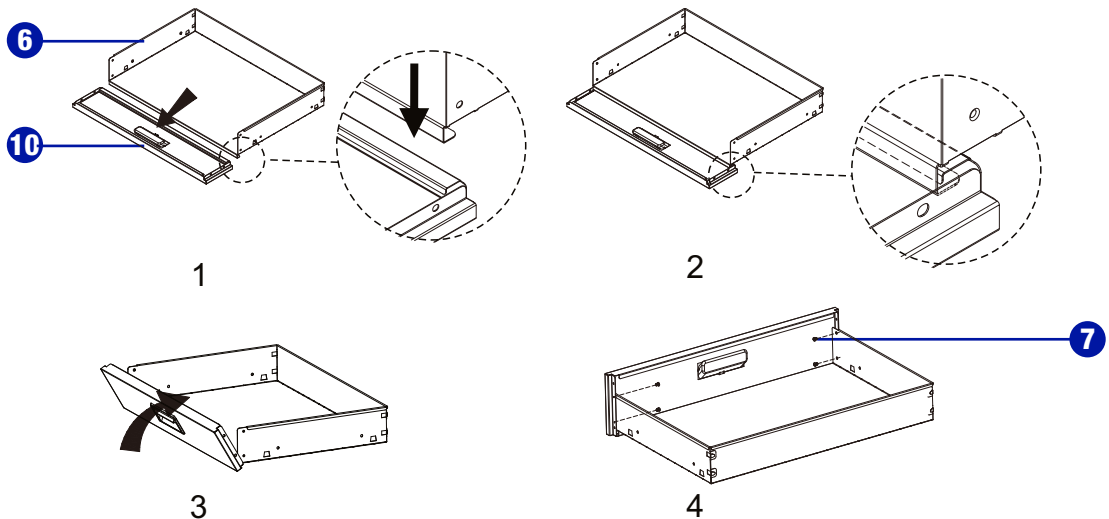



## STEP 12 ATTACH THE DRAWERS BOTTOM-UP

**NOTE:** Read the procedure to attach the top drawer (refer to page 14) carefully. Otherwise, product scratch may be caused.

- Extend the bottom slides and attach the bottom drawer to the slides by sliding the slots at the drawer's side panels onto the upright clips of the slides.
- Secure the drawer to the slides by screwing four M4 x 5 cross-head bolts (8) through the drawer to the slides.
- Repeat the same procedure to attach the other two middle drawers to the slides, attaching the lower one first.

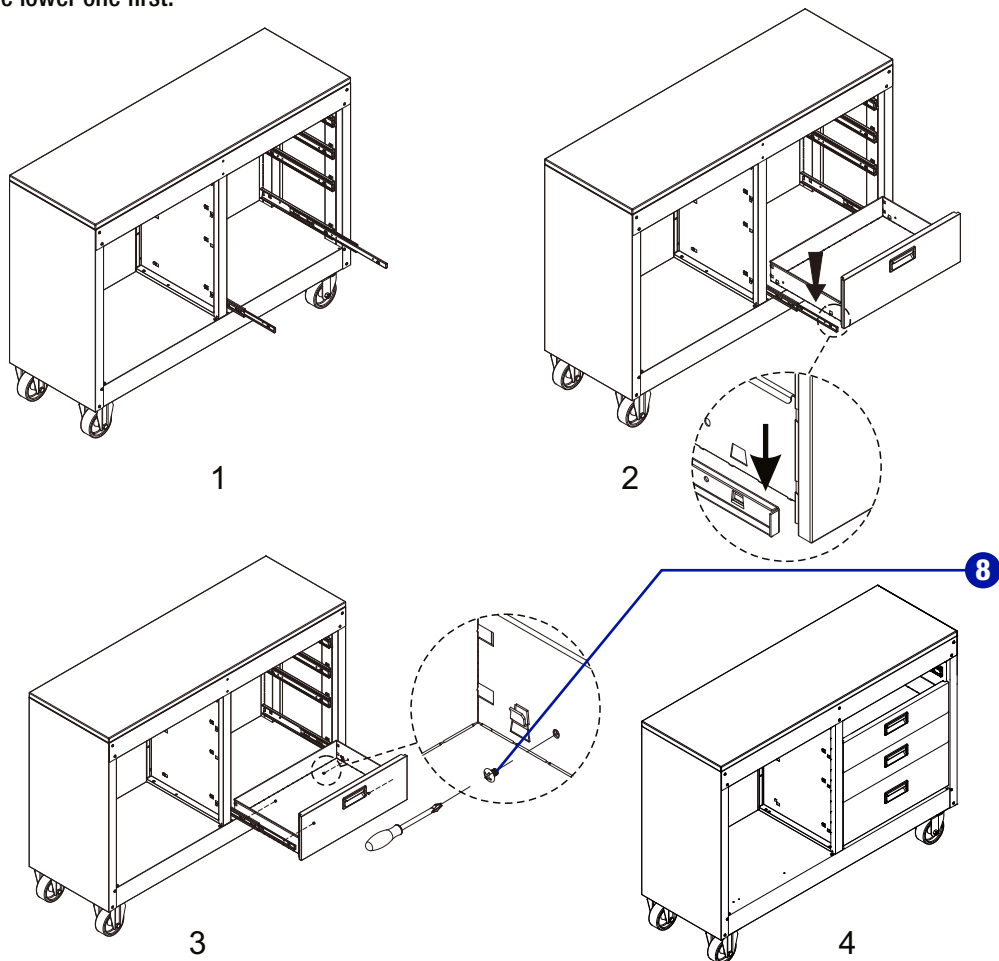

**NOTE:** At this step, DO NOT use power tool. A magnetic cross-head screwdriver is preferred. Otherwise, product damage may be caused.

- Before attaching the top drawer, extend the slides first. There are two black release levers on each side of inner rails. Pull one up and push the other one down until you see a silver dot.
- Repeat the same procedure as the other drawers to attach the top drawer to the slides.

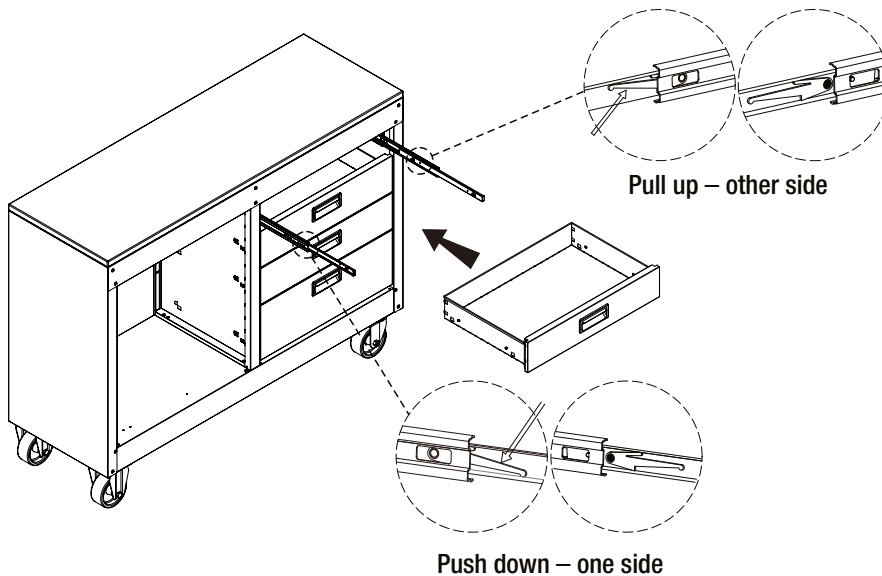

- Place the drawer liners (15) into each drawer of the cabinet.

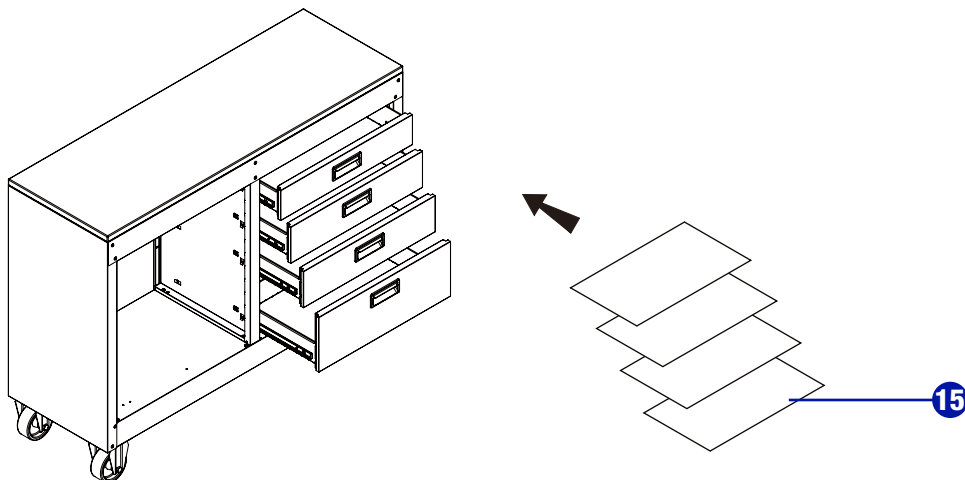

## STEP 13 ATTACH THE DOORS

- Lay down the left door (22) on its face with a soft mat underneath. Pull the bottom locking tab at the right bottom corner of the door outwards. Insert a pin (19) through the hole at the door's bottom corner and put a rubber ring (20) onto the pin's vertical end.
- Push back the bottom locking tab to its place. Insert the horizontal end of the pin (19) into the hole at the locking tab at the same time.
- Take up the left door (22) and insert the pin (19) into the hole at the left bottom corner of the bottom panel (28).
- Pull the upper locking tab at the right top corner of the door outwards. Insert a pin (19) through the hole at door's right top corner into the hole at the left top corner of the cabinet.
- Push back the upper locking tab to its place. Insert the horizontal end of the pin (19) into the hole at the locking tab at the same time.
- Repeat the same procedure to install the right door (18).



When pushing the locking tab back to its place, make sure the end of the pin's horizontal part is inserted into the hole of the locking tab to ensure the pin is well secured.

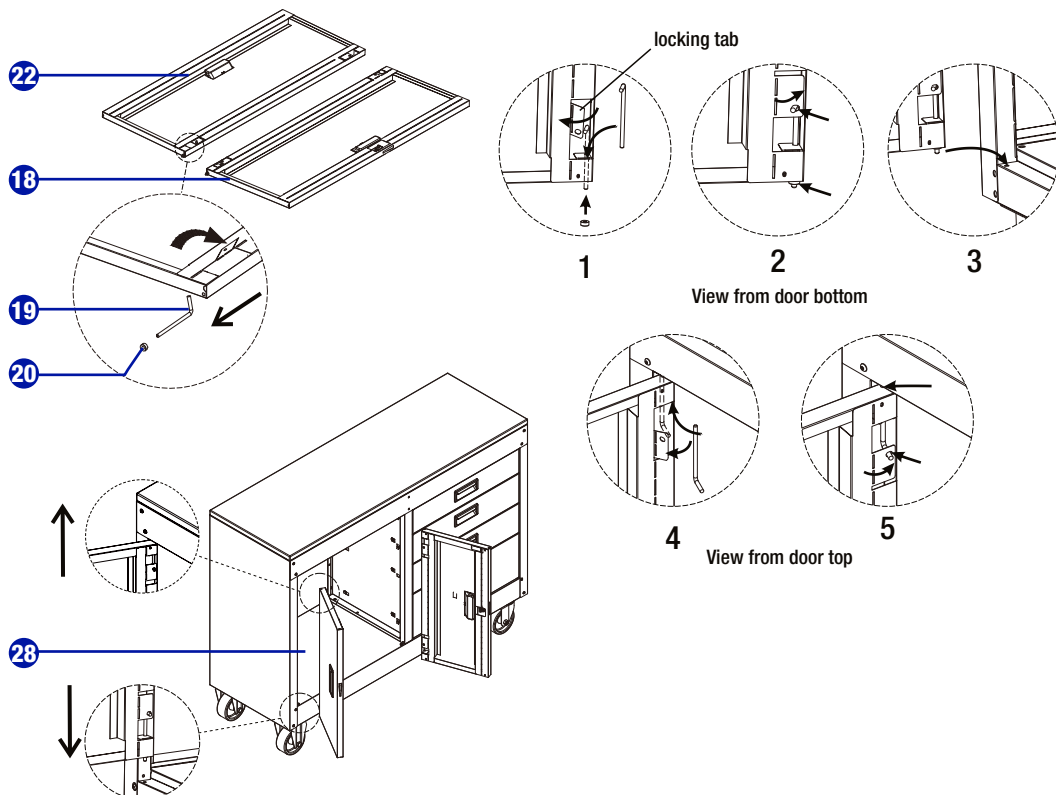

## STEP 14 INSTALL THE LOCKING HOOK

Install the lock (16) as shown below, ensuring the lock code stays on top of the lock face. Release the nut from the lock (16) back and attach the locking hook (17) as shown in illustration 3 below. Tighten the hook (17) securely with the nut previously removed from the lock (16) back as shown in illustration 4.

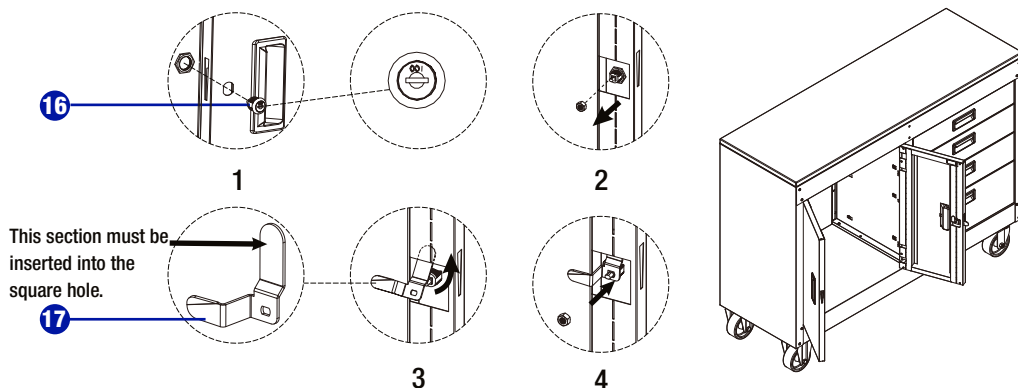

## STEP 15 INSTALL THE SHELF

Insert shelf brackets (23) into the slots and place the shelf (24) over the shelf brackets (23).

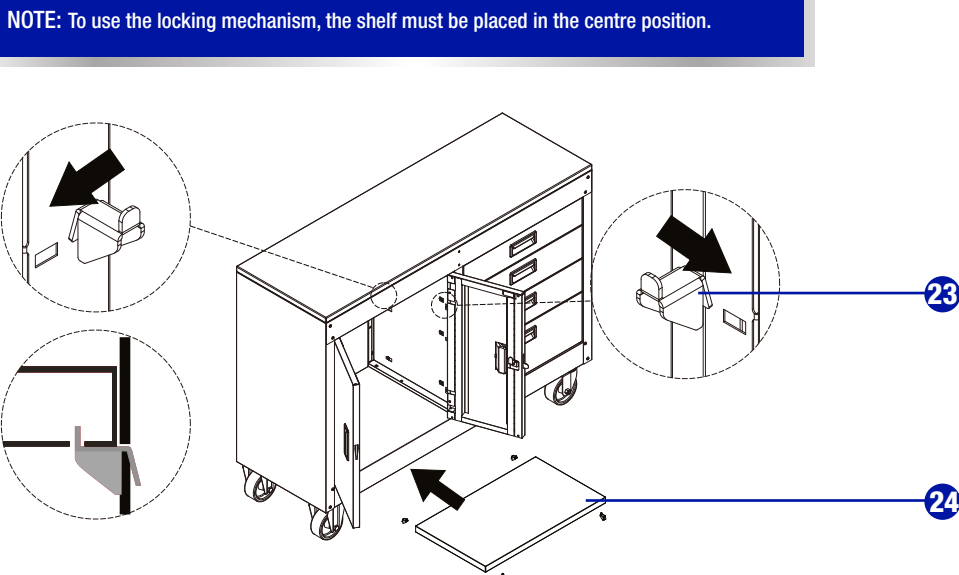

## STEP 16 INSTALL THE SIDE HANDLE

Simply position the side handle (2) over the holes and attach with four M6 x 12 hex bolts (1). Tighten securely. The cabinet is ready for use.

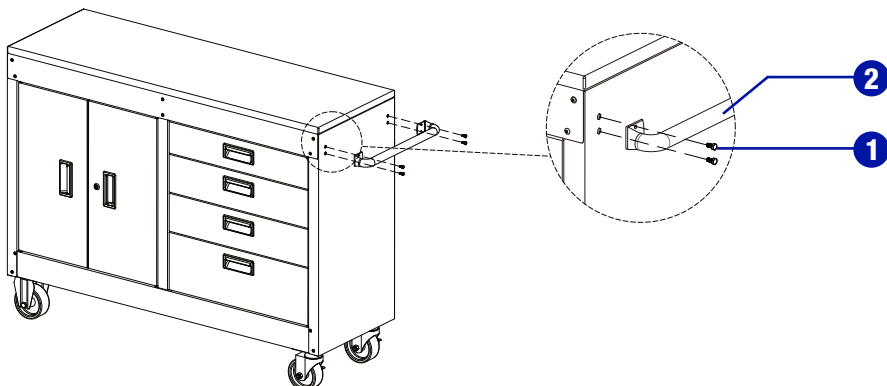

## DRAWER REMOVAL

Pull the drawer out until it is extended to the maximum. There are two black release levers: one on each side of the drawer. Pull one up while you push the other one down simultaneously. At the same time, pull the drawer out of the drawer slides.

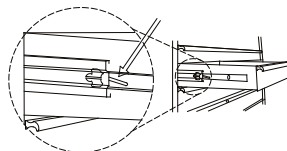

Push down - one side

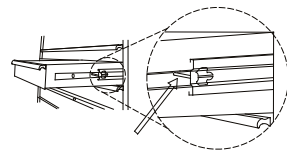

Pull up - other side

## DRAWER REPLACEMENT

Extend the drawer slides from the tool chest or cabinet. Insert the brackets on each side of the drawer into the slots in the slides, being careful that they are properly positioned. Once properly inserted, completely close the drawer to set the slides in their proper positions.

## COORDINATING PRODUCTS

This product coordinates well with the units below to offer our best storage solutions. They can be combined into various combinations to meet different storage requirements.

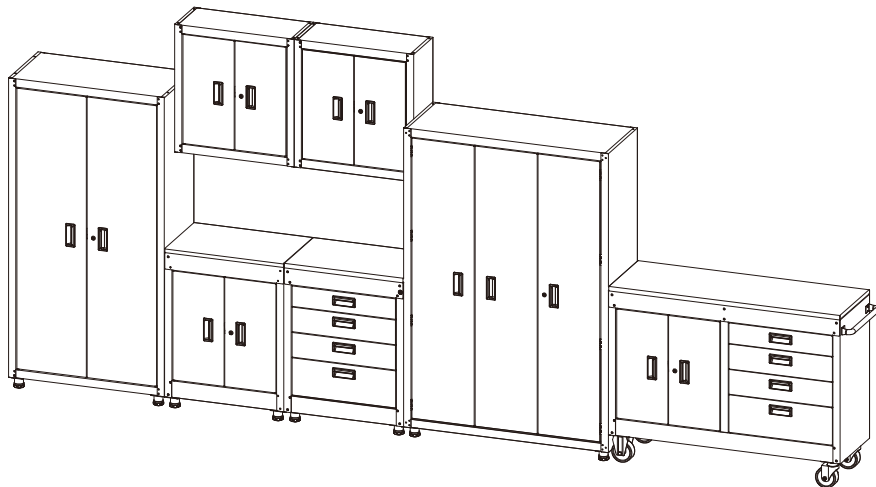

Wall Cabinet  
068-0005-0



28" (71 cm) Base Cabinet  
068-1554-6



28" (71 cm) Base Cabinet  
with Drawers  
068-1575-6



54" (137 cm) Workstation  
068-1577-2



2-Door Tall Cabinet  
068-0006-8

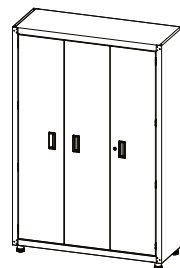

48 x 72" (122 x 183 cm)  
Tall Cabinet  
068-1576-4

## LIMITED WARRANTY

This product is guaranteed for 1 year from the date of original retail purchase against defects in materials and workmanship.

Subject to the conditions and limitations described below, this product, if returned to us with a proof of purchase within the stated warranty period and if covered under this warranty, will be repaired or replaced (with the same model, or one of equal value or specification), at our option. We will bear the cost of any repair or replacement and any costs of labour relating thereto.

### **This warranty is subject to the following conditions and limitations:**

- a) A sales receipt that indicates the date of purchase must be provided;
- b) This warranty will not apply to any product or part thereof which is worn or broken or which has become inoperative due to abuse, misuse, accidental damage, neglect or lack of proper installation, operation or maintenance (as outlined in the applicable owner's manual or operating instructions) or which is being used for industrial, professional, commercial or rental purposes;
- c) This warranty will not apply to normal wear and tear or to expendable parts or accessories that may be supplied with the product that are expected to become inoperative or unusable after a reasonable period of use;
- d) This warranty will not apply to routine maintenance and consumable items such as, but not limited to, fuel, lubricants, vacuum bags, blades, belts, sandpaper, bits, fluids, tune-ups or adjustments;
- e) This warranty will not apply if damage is caused by repairs made or attempted by others (i.e., persons not authorized by the manufacturer);
- f) This warranty will not apply to any product that was sold as a reconditioned or refurbished product (unless otherwise specified in writing);
- g) This warranty will not apply to any product or part thereof if any part from another manufacturer is installed therein or any repairs or alterations have been made or attempted by unauthorized persons;
- h) This warranty will not apply to normal deterioration of the exterior finish, such as, but not limited to, scratches, dents, paint chips, or to any corrosion or discolouring by heat, abrasive and chemical cleaners; and
- i) This warranty will not apply to component parts sold by and identified as the product of another company, which shall be covered under the product manufacturer's warranty, if any.

### **Additional Limitations**

This warranty applies only to the original purchaser and may not be transferred. Neither the retailer nor the manufacturer shall be liable for any other expense, loss or damage, including, without limitation, any indirect, incidental, consequential or exemplary damages arising in connection with the sale, use or inability to use this product.

### **Notice to Consumer**

This warranty gives you specific legal rights, and you may have other rights, which may vary from province to province. The provisions contained in this warranty are not intended to limit, modify, take away from, disclaim or exclude any statutory warranties set forth in any applicable provincial or federal legislation.

### **This product is not guaranteed if used for industrial or commercial purposes.**

Made in China.

Imported by Mastercraft Canada Toronto, Canada M4S 2B8