

model no. 068-1554-6

**Mastercraft**®/MD

## 28" (71 cm) Base Cabinet

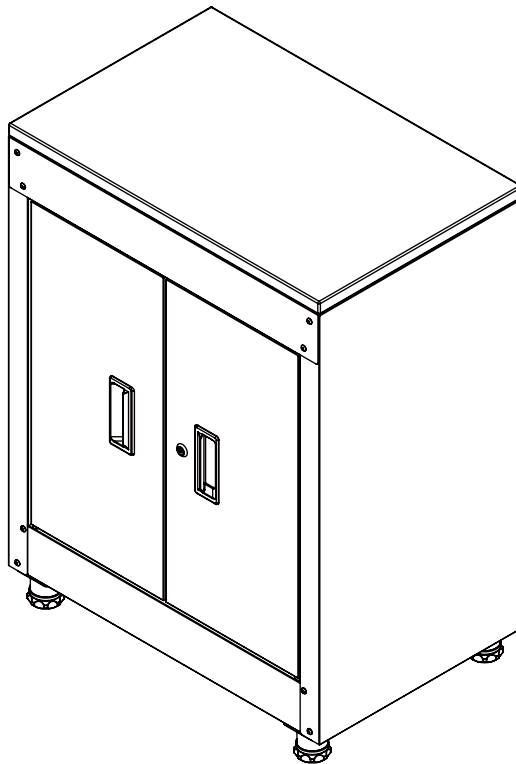

### IMPORTANT

Please read this manual carefully before assembling and using this product, and save it for reference.

### INSTRUCTION MANUAL

Due to continuing improvements, the actual product may differ slightly from the product described herein.

## TABLE OF CONTENTS

SAFETY	3
MAINTENANCE	3
EXPLODED VIEW / PARTS LIST	4
ASSEMBLY INSTRUCTIONS	5
COORDINATING PRODUCTS	10
WARRANTY	11

**NOTE:**

If any parts are missing or damaged, or if you have any questions, please call our toll-free helpline at: 1-800-689-9928. Have the product number, cash register receipt and the date of purchase available when you call. DO NOT SHIP YOUR PRODUCT BACK TO THE STORE UNLESS WE SEND YOU WRITTEN INSTRUCTIONS FOR RETURN.

**SAVE THESE INSTRUCTIONS**

This manual contains important safety and operating instructions. Read all instructions and follow them carefully with use of this product.



## SAFETY

To reduce the risk of serious injury, read and follow the safety instructions below before assembling and using this product.

- This product is intended for indoor use only.
- This product is not designed for commercial nor industrial usage.
- Keep the product on level surfaces. The product could become unstable and it may tip over if stored or moved on an uneven surface, which may cause personal injury, death or product damage.
- Any assembly or maintenance of the product must be carried out by adults only.
- Use at least two people to move, assemble or install this cabinet. Failure to do so can result in personal injury or product damage.
- Check all nuts and bolts periodically for tightness. When required, tighten them.
- Close and lock the doors before moving this cabinet.
- It is always recommended to secure this product to the wall with the anti-tip hardware provided.
- DO NOT alter this product in any manner. For example, do not weld external bar locks or attach electrical equipment. This may cause product damage or personal injury.
- DO NOT leave children unattended near this product. Cabinets may tip over if improperly opened.
- DO NOT stand or lean on the product.
- DO NOT exceed the following weight limits for this product.
  - Maximum load: 400 lb (181 kg)
  - Maximum load for shelf: 100 lb (45 kg)
  - Maximum load for bottom panel: 150 lb (68 kg)
  - Maximum load for rubber wood top: 150 lb (68 kg)

## MAINTENANCE

- Periodically clean the surfaces with a soft rag and water.
- Grease and oil can be removed with most standard cleaning fluids. For safety, use a nonflammable cleaning fluid.



- Before assembling and using this product, carefully read this instruction manual and all of the labels affixed to the product. Failure to follow all warnings and instructions may result in product damage or personal injury.
- Save all warnings and instructions for future reference.

**EXPLODED VIEW / PARTS LIST**

No.	Description	Part No.	Qty.	No.	Description	Part No.	Qty.
1	Right side panel	121609	1	13	Left door	118123	1
2	Shelf bracket	203902	4	14	Key (001-010)	304196	2
3	Shelf	121659	1	15	Door handle	306018	2
4	Bottom panel	121607	1	16	Adjustable foot	313066	4
5	Front top beam	242910	1	17	M6 x 16 hex socket head screw *	320327	48
6	Door stopper	236270	1	18	Left side panel	121608	1
7	Magnet	312033	2	19	Back panel	113539	2
8	Right door	118124	1	20	M6 x 40 hex tapping bolt	320328	2
9	Lock (001-010)	304236	1	21	Back top beam	242909	1
10	Locking hook	236397	1	22	Rubberwood top	572161	1
11	Pin	237444	4	23	Hex wrench	317023	1
12	Rubber ring *	314219	2				

\* NOTE: Extra pcs are provided.

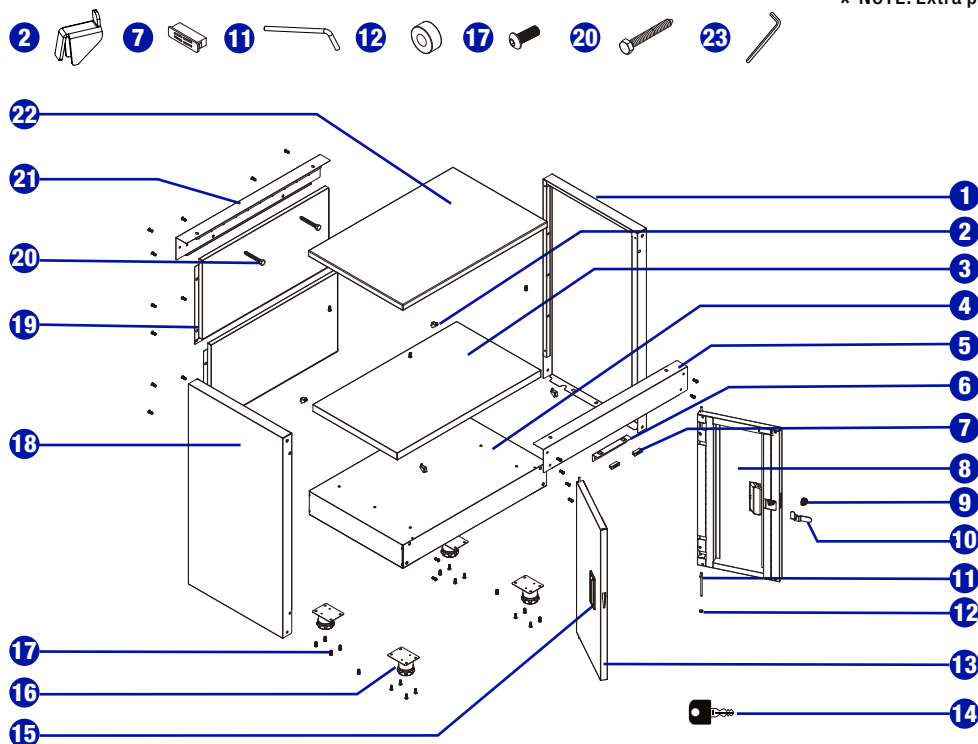
**NOTE:**

- Replacement keys may be ordered. Call our toll-free number. The code which appears on the lock will be required.
- Give information for spare parts: part number and quantity required.

## ASSEMBLY INSTRUCTIONS

### TOOLS REQUIRED FOR ASSEMBLY

- Hex Wrench (23)
- Power Drill (not included)
- Measuring Tape (not included)

**NOTE:** Assemble on a flat surface. A piece of cardboard is recommended to keep the product from being scratched during assembly.



Please wear gloves during the whole assembly process.

### STEP 1 ATTACH THE SIDE AND BOTTOM PANELS

- Lay the bottom panel (4) on its front and attach the side panels (1 & 18) to the bottom panel (4) with two M6 x 16 hex socket head screws (17) through the holes on bottom left and right corners. **DO NOT** tighten.
- Screw two M6 x 16 hex socket head screws (17) in the middle of the bottom. Tighten securely.

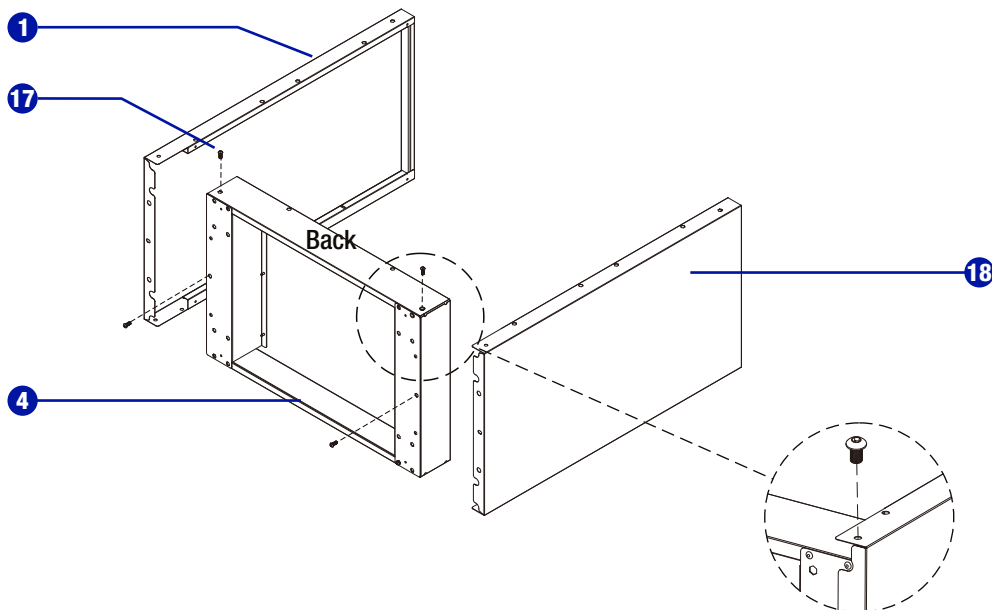

## STEP 2 ATTACH THE BACK TOP BEAM AND BACK PANELS



The top edge of the top back panel (19) should be inserted under the back top beam (21).

Attach the back top beam (21) and back panels (19) to the back. Insert sixteen M6 x 16 hex socket head screws (17) by hand. DO NOT tighten.

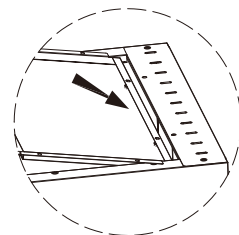
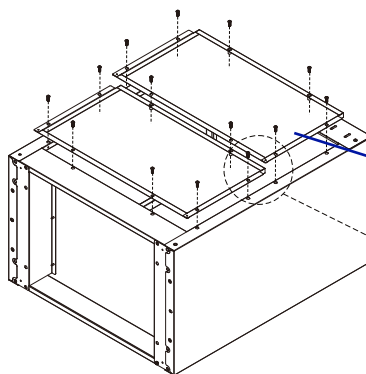
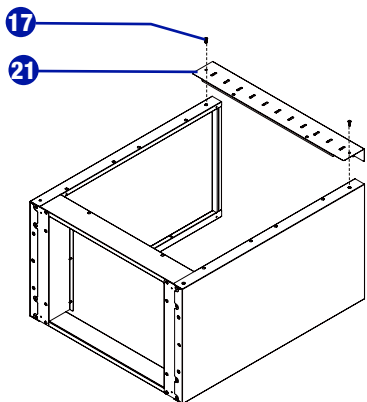

Insert the top edge of top back panel under the back top beam.

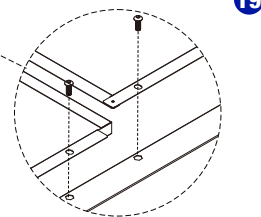

## STEP 3 INSTALL THE ADJUSTABLE FEET

Install the adjustable feet (16) to the bottom panel (4). Tighten securely with sixteen M6 x 16 hex socket head screws (17).

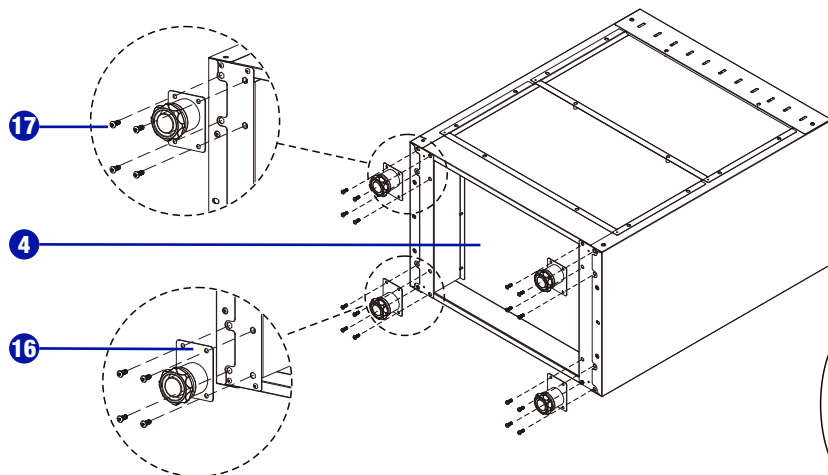

## STEP 4 ATTACH THE DOOR STOPPER AND FRONT TOP BEAM

- First press the two trapezoidal tabs at the centre of the front top beam (5) inwards by 90 degrees.
- Insert the door stopper (6) onto the two tabs. Make sure the magnets are outside of the front top beam (5) and face toward the front of the cabinet.
- Finally, bend the two trapezoidal tabs of the front top beam outwards until they are against the door stopper.
- Stand up the cabinet.
- Attach the front top beam (5) to the side panels (1 & 18) with four M6 x 16 hex socket head screws (17). DO NOT tighten.
- Screw four M6 x 16 hex socket head screws (17) through the side panels (1 & 18) into the bottom panel (4). DO NOT tighten.

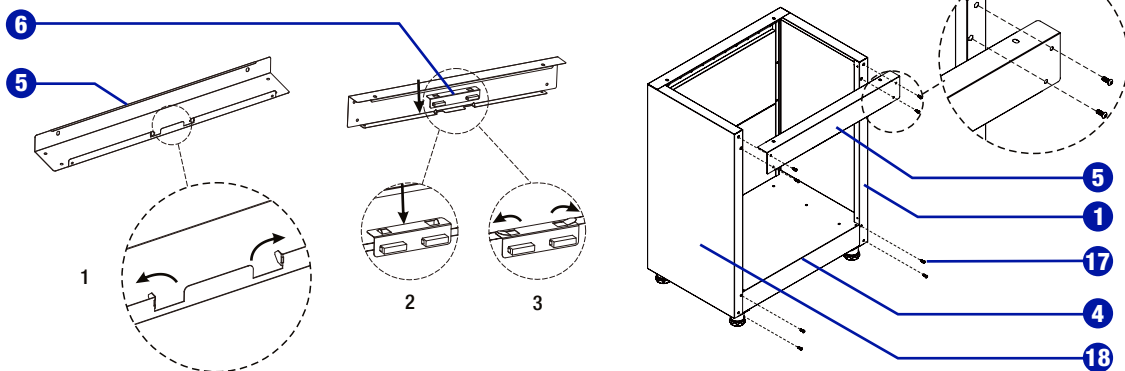

## STEP 5 ATTACH THE RUBBERWOOD TOP

- Attach the rubberwood top (22) to the cabinet top by inserting four M6 x 16 hex socket head screws (17) through the pre-drilled holes underneath. Tighten securely.
- At the same time, square up the cabinet and make sure the inner diagonal lines are equal with the help of a measuring tape. Tighten all screws on front and back.

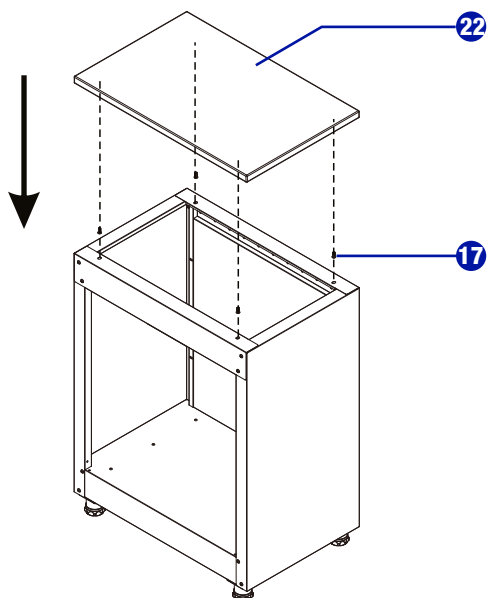
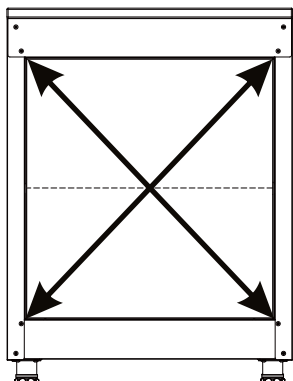

## STEP 6 ATTACH THE DOORS

- Lay down the left door (13) on its face with a soft mat underneath. Pull the bottom locking tab at the right bottom corner of the door outwards. Insert a pin (11) through the hole at the door's bottom corner and put a rubber ring (12) onto the pin's vertical end.
- Push back the bottom locking tab to its place. Insert the horizontal end of the pin (11) into the hole at the locking tab at the same time.
- Take up the left door (13) and insert the pin (11) into the hole at the left bottom corner of the bottom panel (4).
- Pull the upper locking tab at the right top corner of the door outwards. Insert a pin (11) through the hole at door's right top corner into the hole at the left top corner of the cabinet.
- Push back the upper locking tab to its place. Insert the horizontal end of the pin (11) into the hole at the locking tab at the same time.
- Repeat the same procedure to install the right door (8).



When push the locking tab back to its place, make sure the end of the pin's horizontal part is inserted into the hole of the locking tab to ensure the pin is well secured.

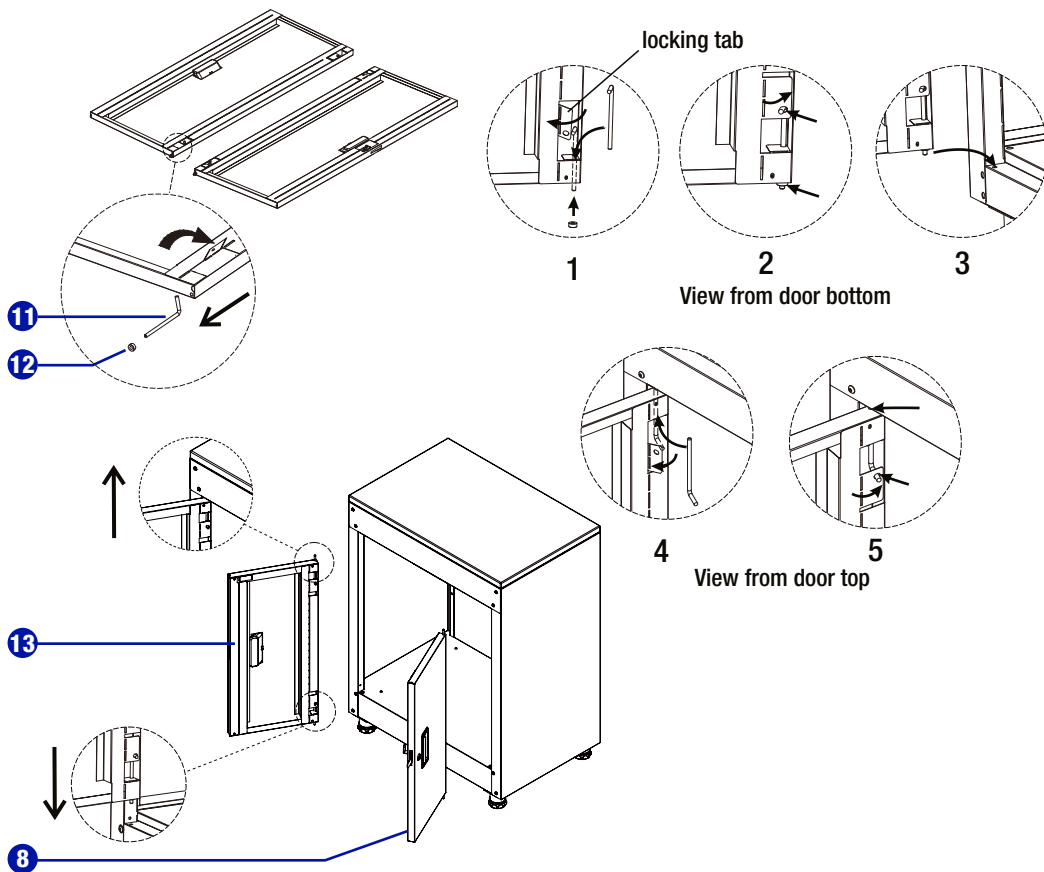

## STEP 7 INSTALL THE LOCKING HOOK

Install the lock (9) as shown below, ensuring the lock code stays on top of the lock face. Release the nut from the lock (9) back and attach the locking hook (10) as shown in illustration 3 below. Tighten the hook (10) securely with the nut previously removed from the lock (9) back as shown in illustration 4.

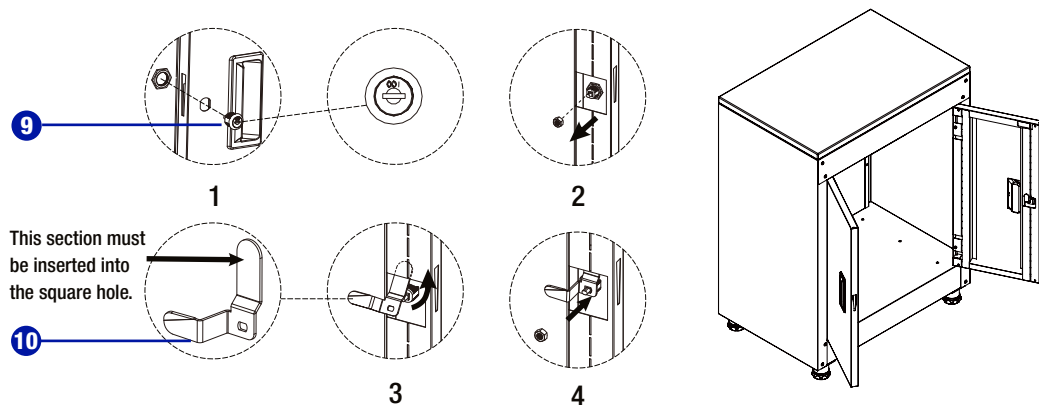

## STEP 8 INSTALL THE SHELF

Insert four shelf brackets (2) into the slots on the side panels (1 & 18) at the desired height. Make sure the four brackets (2) are at the same height. Place the shelf (3) over the shelf brackets (2).

**NOTE:** To use the locking mechanism, the shelf must be placed in the centre position.

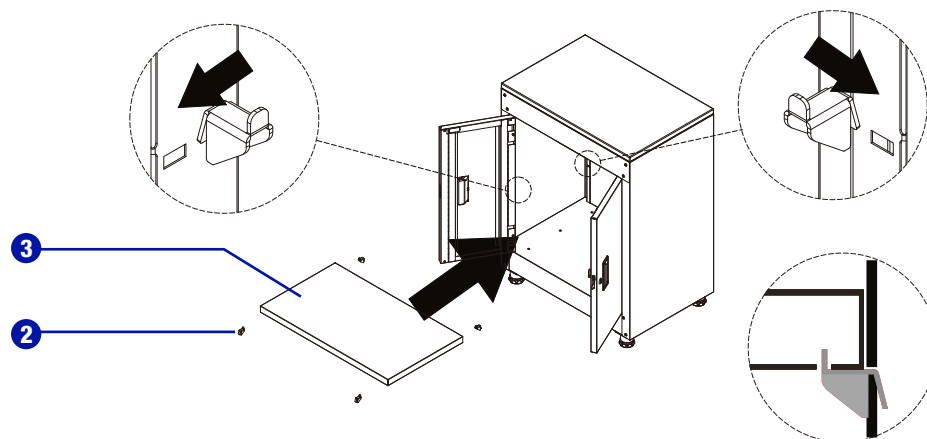

## STEP 9 SECURE THE CABINET TO WALL

Place the cabinet on a flat floor against a wall. Use a power drill to attach the cabinet to the wall with two M6 x 40 hex tapping bolts (20) through the holes at the back top beam (21). Tighten securely. For safety, the bolts should be drilled into the studs of the wall. The cabinet is ready for use.

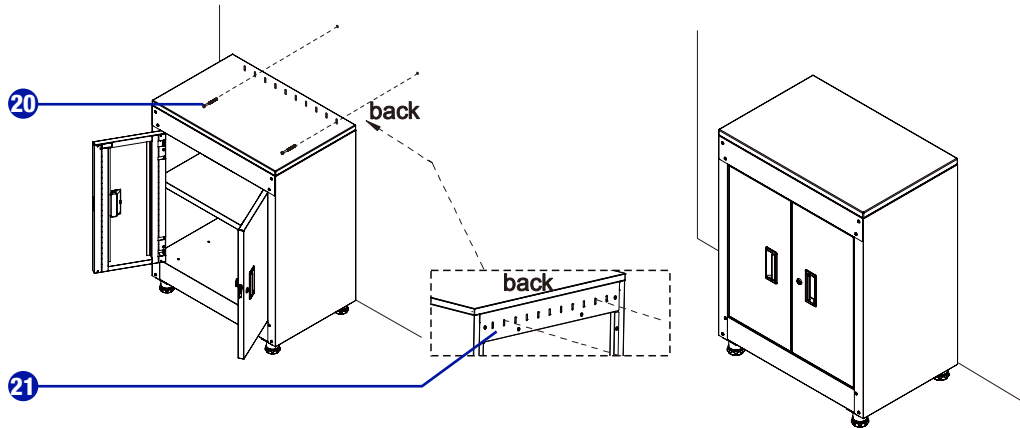

## COORDINATING PRODUCTS

This product coordinates well with the units below to offer our best storage solutions. They can be combined into various combinations to meet different storage requirements.

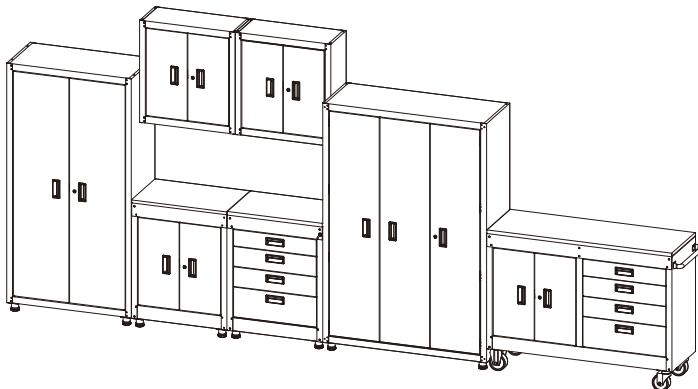

2-Door Tall Cabinet  
068-0006-8



Wall Cabinet  
068-0005-0



28" (71 cm)  
Base Cabinet  
068-1554-6



28" (71 cm) Base  
Cabinet with Drawers  
068-1575-6



54" (137 cm)  
Workstation  
068-1577-2



48 x 72" (122 x 183 cm)  
Tall Cabinet  
068-1576-4



## LIMITED WARRANTY

This product is guaranteed for 1 year from the date of original retail purchase against defects in materials and workmanship.

Subject to the conditions and limitations described below, this product, if returned to us with a proof of purchase within the stated warranty period and if covered under this warranty, will be repaired or replaced (with the same model, or one of equal value or specification), at our option. We will bear the cost of any repair or replacement and any costs of labour relating thereto.

### **This warranty is subject to the following conditions and limitations:**

- a) A sales receipt that indicates the date of purchase must be provided;
- b) This warranty will not apply to any product or part thereof which is worn or broken or which has become inoperative due to abuse, misuse, accidental damage, neglect or lack of proper installation, operation or maintenance (as outlined in the applicable owner's manual or operating instructions) or which is being used for industrial, professional, commercial or rental purposes;
- c) This warranty will not apply to normal wear and tear or to expendable parts or accessories that may be supplied with the product that are expected to become inoperative or unusable after a reasonable period of use;
- d) This warranty will not apply to routine maintenance and consumable items such as, but not limited to, fuel, lubricants, vacuum bags, blades, belts, sandpaper, bits, fluids, tune-ups or adjustments;
- e) This warranty will not apply if damage is caused by repairs made or attempted by others (i.e., persons not authorized by the manufacturer);
- f) This warranty will not apply to any product that was sold as a reconditioned or refurbished product (unless otherwise specified in writing);
- g) This warranty will not apply to any product or part thereof if any part from another manufacturer is installed therein or any repairs or alterations have been made or attempted by unauthorized persons;
- h) This warranty will not apply to normal deterioration of the exterior finish, such as, but not limited to, scratches, dents, paint chips, or to any corrosion or discolouring by heat, abrasive and chemical cleaners; and
- i) This warranty will not apply to component parts sold by and identified as the product of another company, which shall be covered under the product manufacturer's warranty, if any.

### **Additional Limitations**

This warranty applies only to the original purchaser and may not be transferred. Neither the retailer nor the manufacturer shall be liable for any other expense, loss or damage, including, without limitation, any indirect, incidental, consequential or exemplary damages arising in connection with the sale, use or inability to use this product.

### **Notice to Consumer**

This warranty gives you specific legal rights, and you may have other rights, which may vary from province to province. The provisions contained in this warranty are not intended to limit, modify, take away from, disclaim or exclude any statutory warranties set forth in any applicable provincial or federal legislation.

### **This product is not guaranteed if used for industrial or commercial purposes.**

Made in China.

Imported by Mastercraft Canada Toronto, Canada M4S 2B8