

model no. 068-0007-6

**Mastercraft** ® / MD

## 3-Tier Locker

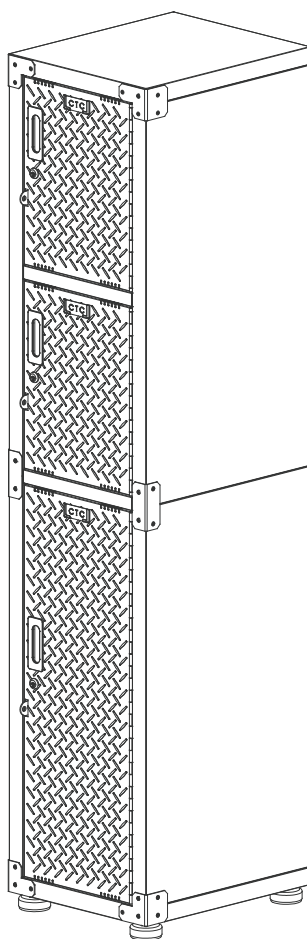

### IMPORTANT:

Please read this manual carefully before installing this locker and save it for reference.

**INSTRUCTION  
MANUAL**

## 2

model no. 068-0007-6 | contact us 1-800-689-9928

## TABLE OF CONTENTS

Safety Guidelines	3
Parts List	4
Assembly Instructions	6
Warranty	13

**NOTE:**

If any parts are missing or damaged, or if you have any questions, please call our toll-free helpline at 1-800-689-9928.

**SAVE THESE INSTRUCTIONS**

This manual contains important safety and operating instructions. Read all instructions and follow them with use of this product.

## SAFETY GUIDELINES

This manual contains information that relates to PROTECTING PERSONAL SAFETY and PREVENTING EQUIPMENT PROBLEMS. It is very important to read this manual carefully and understand it thoroughly before using the product. The symbols listed below are used to indicate this information.



### CAUTION!

Potential hazard that may result in moderate injury or damage to equipment.

- The locker should be positioned on a level surface.
- This locker is intended for indoor use only.
- Check all nuts and bolts periodically and tighten them, if required.
- Use a slightly damp, soft cloth to clean the locker.
- Do not stand on locker and do not use it as a scaffold.
- Do not exceed the maximum load of 300 lb (136 kg).
- Any assembly or maintenance of the locker must be carried out by adults only.
- Do not assemble or move the locker without necessary manpower.
- Do not exceed the following weight limits for this product.

Maximum each shelf load: 100 lb (45 kg)

Maximum cabinet load: 300 lb (136 kg)

## 4

model no. 068-0007-6 | contact us 1-800-689-9928

## PARTS LIST

## PARTS LIST

No.	Description	Qty.	No.	Description	Qty.
#1-A	Left Panel	1	#25	Wrench	1
#2-A	Right Panel	1	#21	Screwdriver	1
#3	Top Panel	1	#22	Key	6
#4	Bottom Panel	1	#23	Magnet	6
#1-A1	Left Side - Upper Panel	1	#41	Screw F (M4 x 8L)	78
#2-A1	Right Side - Upper Panel	1	#54	Screw N (M4 x 10L)	28
#1-A2	Left Side - Bottom Panel	1	#42	Screw G (M4 x 30L)	12
#2-A2	Right Side - Bottom Panel	1	#61	Screw O (M4 x 12L)	2
#5	Middle Shelf	1	#27-B	Washer (M8)	2
#7	Middle Layer Panel	1	#27	Washer (M4)	2
#8	Upper Back Panel	1	#55	Screw M (M6 x 50L)	2
#10	Bottom Back Panel	1	#55-A	Wall Anchor	2
#14-A	Small Door	2	#60	Mounting Strap	2
#14-B	Large Door	1	#62	Door Slot Label	3
#13	Middle Shelf Bracket	2	#6	Levelling Feet	4
#11	Lock Plate	3			
#12	Middle Panel Bracket	2			
#17	Middle Corner Protection	2			
#15	Corner Protection - A	2			
#16	Corner Protection - B	2			

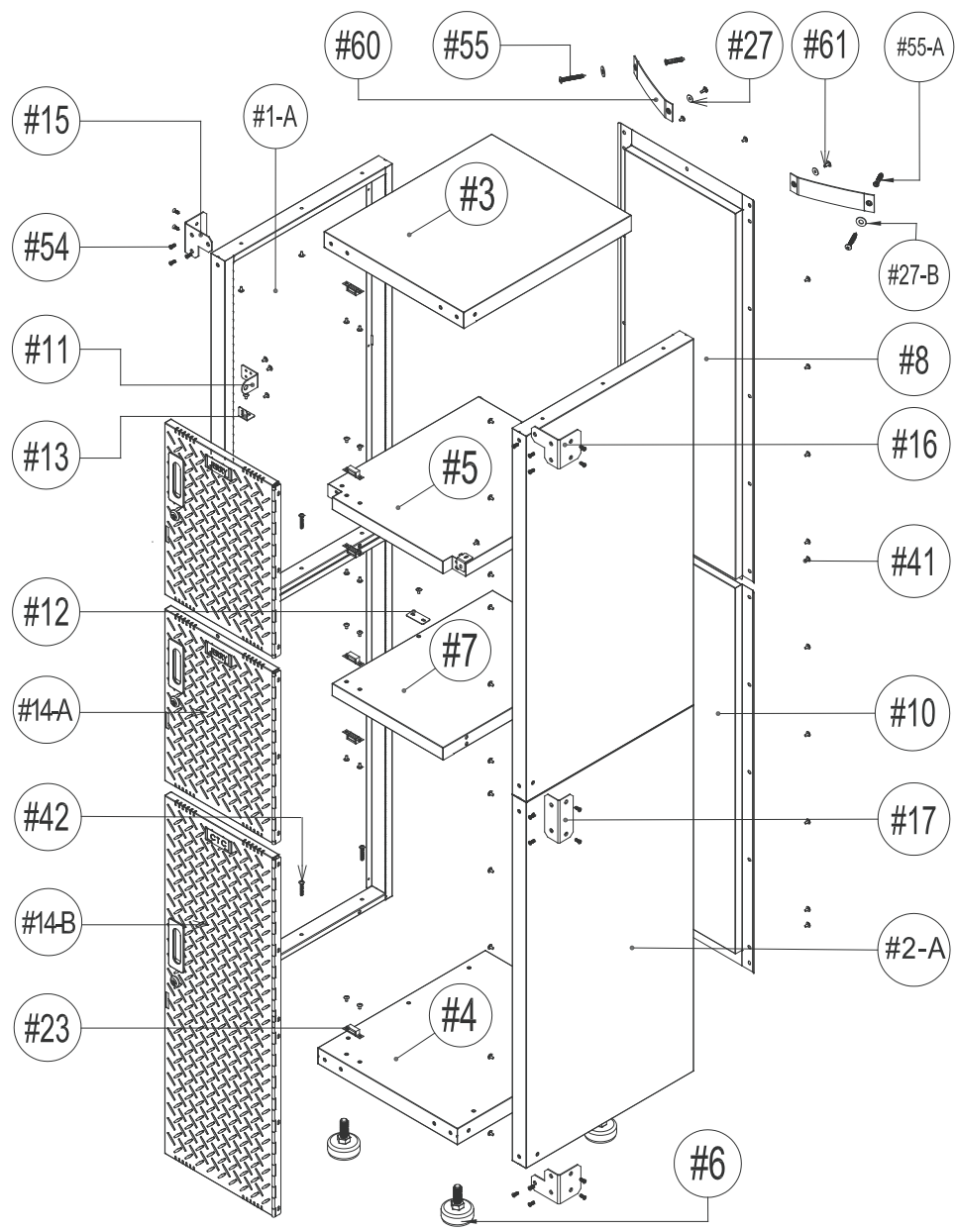

PARTS LIST

## 6

model no. 068-0007-6 | contact us 1-800-689-9928

## ASSEMBLY INSTRUCTIONS

**Assembly Preparation**

- Assemble the storage cabinet on a clean, level surface.
- Remove all items from the packaging box and ensure that all parts listed on pages 4 and 5 are included.
- When installing parts that have more than one screw, tighten all screws by hand before tightening them with the screwdriver.

**TIP**

A magnetic screwdriver is included for your convenience. If a power screwdriver is used, keep on a low torque setting.

**WARNING**

Some parts may have sharp edges. To avoid injury, wearing gloves is recommended during assembly.

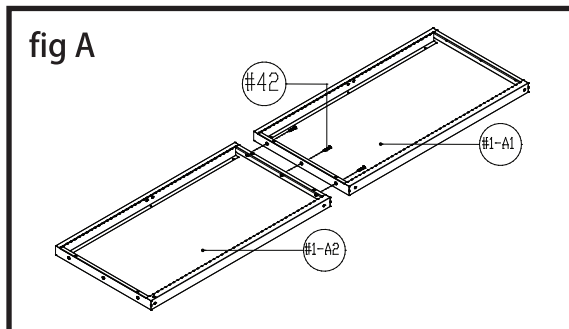
**Assembly Instructions****1. Install Left Side Panel (Part 1-A)**

Place the Left Side - Upper Panel (Part 1-A1) and Left Side - Bottom Panel (Part 1-A2) together, line up screw holes, and use 3 pcs of Screw G (Part 42) to tighten from the side (*fig A*).

Note: Before tightening screws, make sure the corners and the face of the Left Side Panel (Part 1-A) are completely flush.

fig B

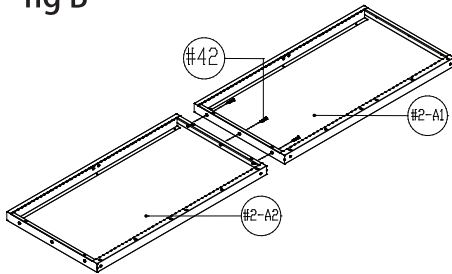

## 2. Install Right Side Panel (Part 2-A)

Repeat Step 1. Place Right Side Upper Panel (Part 2-A1), Right Side Bottom Panel (Part 2-A2) together, line up screw holes, and use 3 pcs of Screw G (Part 42) to tighten from the side (*fig B*).

Note: Before tightening screws, make sure the corners and the face of the Right Side Panel (Part 2-A) are completely flush.

fig C

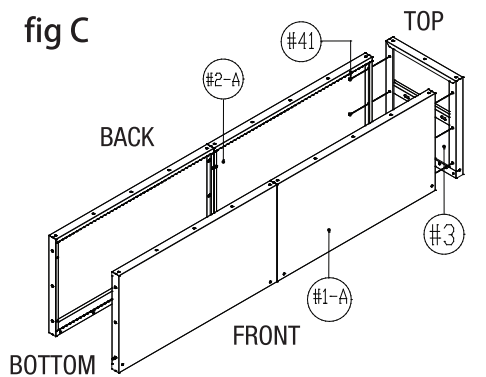

## 3. Install Top Panel (Part 3) to Left Side Panel (Part 1-A) and Right Side Panel (Part 2-A)

Attach Top Panel (Part 3) to Left Side Panel (Part 1-A) and Right Side Panel (Part 2-A). Make sure the front of the unit faces downward. Line up screw holes, and use 6 pcs Screw F (Part 41) to tighten (*fig C*).

Note: Before tightening screws, make sure the corners of the Top Panel (Part 3) are completely flush.

fig D

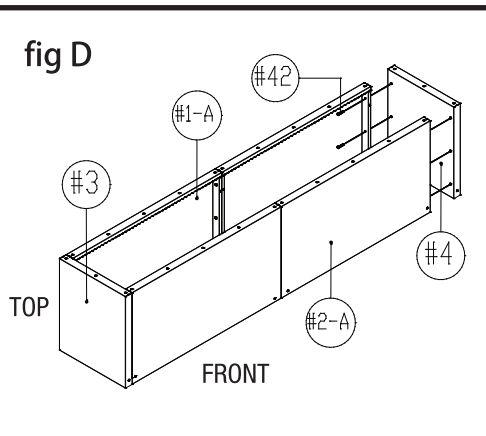

## 4. Install Bottom Panel (Part 4) to Left Side Panel (Part 1-A) and Right Side Panel (Part 2-A)

Attach Bottom Panel (Part 4) to Left Side Panel (Part 1-A) and Right Side Panel (Part 2-A). Make sure the front of the unit faces downward. Line up screw holes, and use 6 pcs Screw G (Part 42) to tighten (*fig D*).

Note: Before tightening screws, make sure the corners of the Bottom Panel (Part 4) are completely flush.

## 8

model no. 068-0007-6 | contact us 1-800-689-9928

## ASSEMBLY INSTRUCTIONS

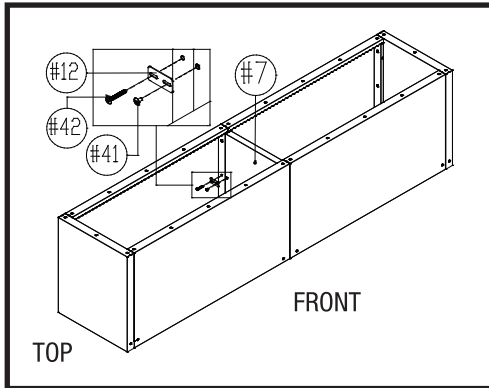
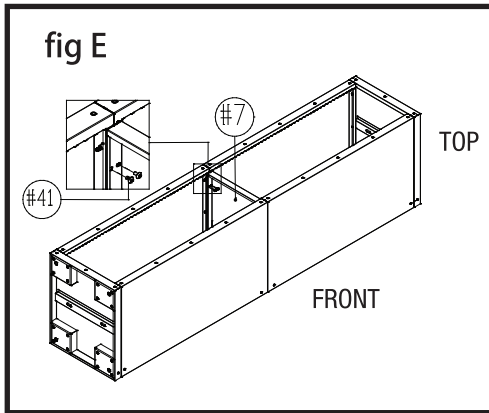

## 5. Install Middle Layer Panel (Part 7)

1) Attach the Middle Layer Panel (Part 7) as the left picture shows. Use 8 pcs of Screw F (Part 41) to fasten the Middle Layer Panel to the Left and Right Panels (Part 1-A and Part 2-A).

NOTE: Make sure that the middle layer panel brackets is level when securing in place.

2) Remove the middle Screw G (Part 42) which attaches the upper and bottom side panels in Steps 1 and 2. Attach the Middle Layer Panel Bracket (Part 12) to the centre of the Middle

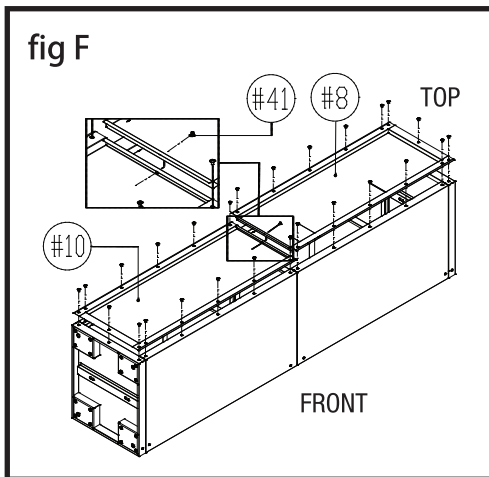

## 6. Install Upper and Bottom Back Panels (Part 8 and Part 10)

1) Attach Bottom Back Panel (Part 10) onto both Bottom of Left and Right Side Panels (Part 1-A2 and Part 2-A2) and Bottom Panel (Part 4).

2) Attach the Upper Back Panel (Part 8) above the Bottom Back Panel (Part 10) the same way. Place the groove of the Upper Back Panel (Part 8) onto the top edge of the Bottom Back Panel (Part 10).

3) Line up all the screw holes, and use 27 pcs Screw F (Part 41) to tighten the Back Panels (*fig F*).

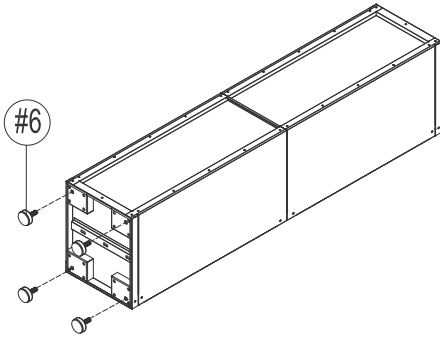
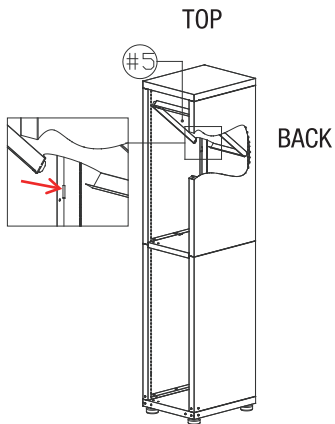

fig G

**7. Install Levelling Feet (Part 6).**

Install Levelling Feet (Part 6) into the largest corner holes of the Bottom Panel (Part 4), and use Wrench (Part 25) to tighten (*fig G*).

fig H

**8. Install Middle Shelf (Part 5)**

Insert a Middle Shelf (Part 5) into the slots on the Side Panels. Use 6 pcs Screw F (Part 41) to fasten the Middle Shelf Bracket (Part 13) to the front of the side panels (*fig H*).

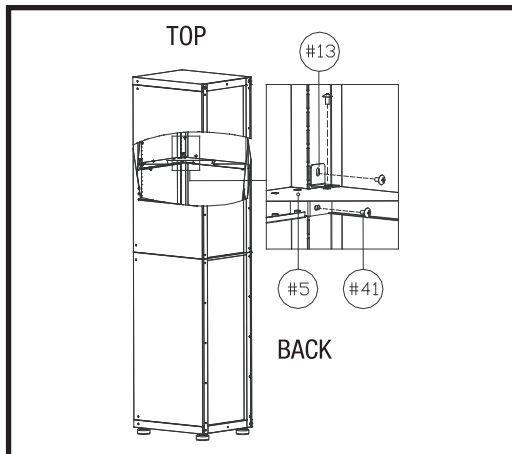

## 10

model no. 068-0007-6 | contact us 1-800-689-9928

## ASSEMBLY INSTRUCTIONS

fig I

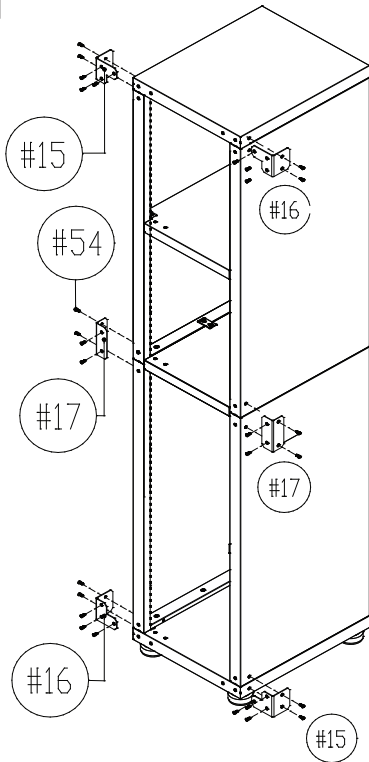
**9. Install Corner Protections (Part 15, Part 16 and Part 17)**

1). Attach Corner Protection A, B (Part 15, Part 16) onto top and bottom of the cabinet, and use 20 pcs Screw N (Part 54) to tighten.

2). Attach (Part 17) Middle Corner Protection to the middle of (Part 1-A) Left Side Panel and (Part 2-A) Right Side Panel, and use 8 pcs Screw N (Part 54) to tighten (*fig I*).

fig J

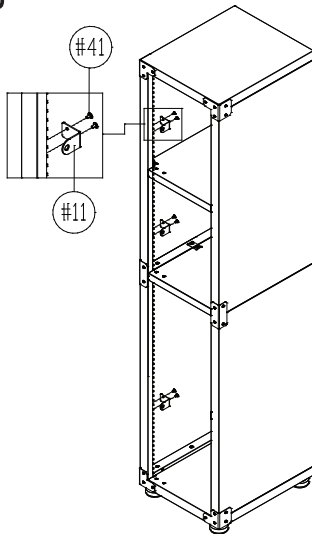
**10. Install Lock Plate (Part 11)**

Attach the Lock Plate (Part 11) on the Left Panel (1-A), and use 6 pcs Screw F (Part 41) to tighten (*fig J*).

fig K

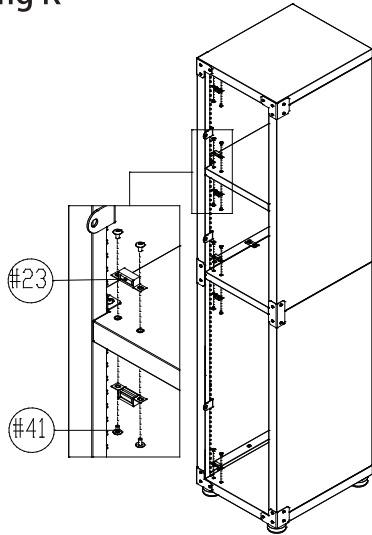
**11. Install Magnet (Part 23)**

Place Magnet (Part 23) onto the top and bottom of each panel (the black plate should be facing the front), and use total 12 pcs Screw F (Part 41) to tighten the magnets (*fig K*).

fig L

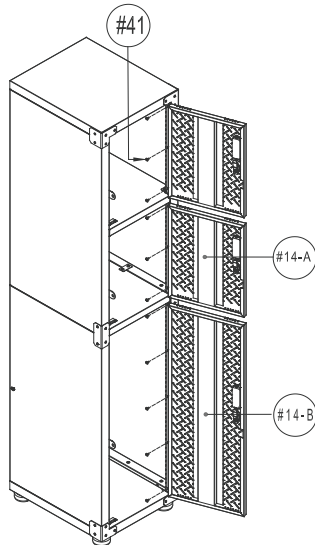
**12. Install Door (Part 14-A) (Part 14-B)**

1) Attach the Small Door (Part 14-A) to the Right Side Panel, and use 3 pcs Screw F (Part 41) to tighten.

2) Attach the Large Door (Part 14-B) to the Right Side Panel, and use 5 pcs Screw F (Part 41) to tighten (*fig L*).

Note: The screw holes on the door hinge have tolerance, enabling the door to be adjusted and centred in the door frame. Place top, middle and bottom screws first. Don't tighten screws completely - this may save time by avoiding having to make slight adjustments for levelling door panels later.

## 12

model no. 068-0007-6 | contact us 1-800-689-9928

## ASSEMBLY INSTRUCTIONS

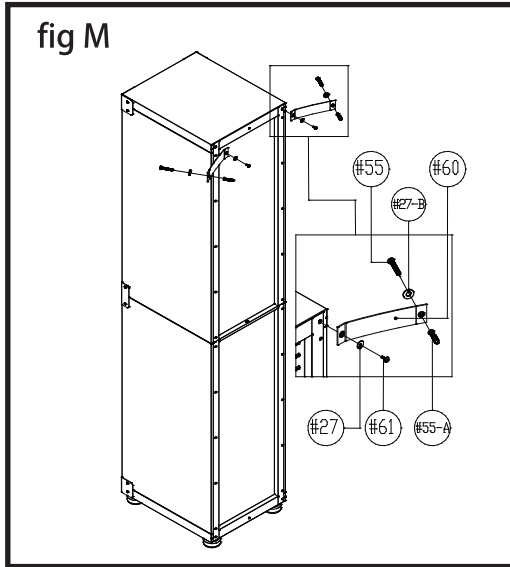
**13. Install Mounting Strap (Part 60)**

- A. Remove 1 pc Screw F (Part 41) from the back corner protection.
- B. Attach the Mounting Strap (Part 60) to the back Corner Protection brackets as the left photo shows using Screw O (Part 61) and Washer (Part 27).
- C. Drill a hole in the wall with a 5/16" drill bit, and insert the Wall Anchor (Part 55-A) into the hole.
- D. Attach the other end of the Mounting Strap (Part 60) to the wall using Screw M (Part 55) and Washer (Part 27-B) (*fig M*).

**Repeat steps A through D to install the other mounting strap.**

**Warning: To prevent possible tipping, it is suggested that the Mounting Straps be installed. For safety, secure the mounting straps to wood studs whenever possible.**

**Stainless Steel Maintenance:**

These parts have an fingerprint-resistant finish. Do not use traditional stainless steel cleaners on this unit. Lightly wipe off once a month with clean warm water and a soft cloth (preferably a microfibre cloth). This is the safest formula to prevent new stains from appearing over time and manage unwanted fingerprints or grease marks. Remember to always wipe in the direction of the surface grain (NEVER ACROSS) and always use a lint-free cloth. Once the surface is clean, thoroughly wipe dry with a soft, absorbent cloth.

This Mastercraft product is guaranteed for a period of **one (1) year** from the date of original retail purchase, against defects in materials and workmanship.

Subject to the conditions and limitations described below, this product, if returned to us with proof of purchase within the stated warranty period and if covered under this warranty, will be repaired or replaced (with the same model, or one of equal value or specification), at our option. We will bear the cost of any repair or replacement and any costs of labour relating thereto.

### These warranties are subject to the following conditions and limitations

- a. a bill of sale verifying the purchase and purchase date must be provided;
- b. this warranty will not apply to any product or part thereof which is worn or broken or which has become inoperative due to abuse, misuse, accidental damage, neglect or lack of proper installation, operation or maintenance (as outlined in the applicable owner's manual or operating instructions) or which is being used for industrial, professional, commercial or rental purposes;
- c. this warranty will not apply to normal wear and tear or to expendable parts or accessories that may be supplied with the product which are expected to become inoperative or unusable after a reasonable period of use;
- d. this warranty will not apply to routine maintenance and consumable items such as, but not limited to, fuel, lubricants, vacuum bags, blades, belts, sandpaper, bits, fluids, tune-ups or adjustments;
- e. this warranty will not apply where damage is caused by repairs made or attempted by others (i.e. persons not authorized by the manufacturer);
- f. this warranty will not apply to any product that was sold to the original purchaser as a reconditioned or refurbished product (unless otherwise specified in writing);
- g. this warranty will not apply to any product or part thereof if any part from another manufacturer is installed therein or any repairs or alterations have been made or attempted by unauthorized persons;
- h. this warranty will not apply to normal deterioration of the exterior finish, such as, but not limited to, scratches, dents, paint chips, or to any corrosion or discolouring by heat, abrasive and chemical cleaners; and
- i. this warranty will not apply to component parts sold by and identified as the product of another company, which shall be covered under the product manufacturer's warranty, if any.

### Additional Limitations

This warranty applies only to the original purchaser and may not be transferred. Neither the retailer nor the manufacturer shall be liable for any other expense, loss or damage, including, without limitation, any indirect, incidental, consequential or exemplary damages arising in connection with the sale, use or inability to use this product.

### Notice to Consumer

This warranty gives you specific legal rights, and you may have other rights, which may vary from province to province. The provisions contained in this warranty are not intended to limit, modify, take away from, disclaim or exclude any statutory warranties set forth in any applicable provincial or federal legislation.

Imported by Mastercraft Canada Toronto, Canada M4S 2B8