

model no. 068-0006-8

Mastercraft®/MD

Tall Cabinet

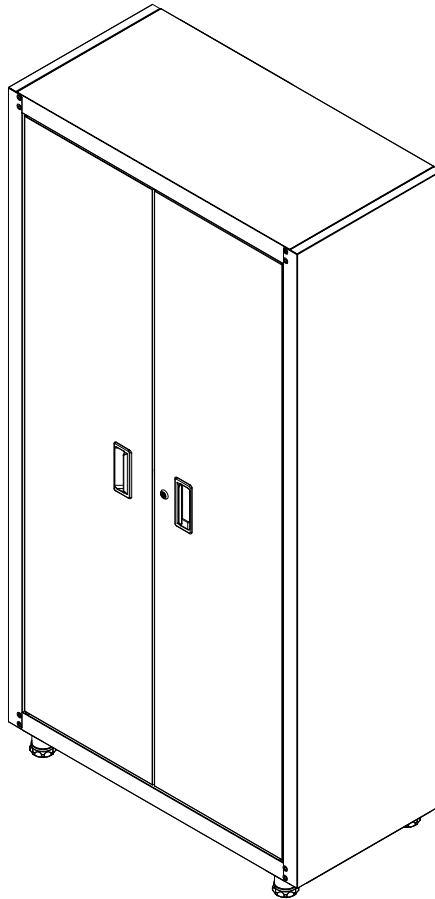

IMPORTANT

Please read this manual carefully before assembling and using this product, and save it for reference.

INSTRUCTION MANUAL

Due to continuing improvements, the actual product may differ slightly from the product described herein.

TABLE OF CONTENTS

SAFETY	3
MAINTENANCE	3
EXPLODED VIEW / PARTS LIST	4
ASSEMBLY INSTRUCTIONS	5
COORDINATING PRODUCTS	10
WARRANTY	11

NOTE:

If any parts are missing or damaged, or if you have any questions, please call our toll-free helpline at: 1-800-689-9928. Have the product number, cash register receipt and the date of purchase available when you call. DO NOT SHIP YOUR PRODUCT BACK TO THE STORE, UNLESS WE SEND YOU WRITTEN INSTRUCTIONS FOR RETURN.

**SAVE THESE INSTRUCTIONS**

This manual contains important safety and operating instructions. Read all instructions and follow them carefully with use of this product.

SAFETY

To reduce the risk of serious injury, read and follow the safety instructions below before assembling and using this product.

- This product is intended for indoor use only.
- This product is not designed for commercial nor industrial usage.
- Keep the product on level surfaces. The product could become unstable and it may tip over if stored or moved on an uneven surface, which may cause personal injury, death or product damage.
- Any assembly or maintenance of the cabinet must be carried out by adults only.
- Use at least two people to move, assemble or install this cabinet. Failure to do so can result in personal injury or product damage.
- Check all nuts and bolts periodically for tightness. When required, tighten them.
- Close and lock the doors before moving this cabinet.
- DO NOT alter this product in any manner. For example, do not weld external bar locks or attach electrical equipment. This may cause product damage or personal injury.
- DO NOT stand on the cabinet and do not use it as scaffold.
- DO NOT leave children unattended near this product. Cabinets may tip over if improperly opened.
- It is always recommended to secure this product to the wall with the anti-tip hardware provided.
- DO NOT put anything on the top panel of this product.
- DO NOT exceed the following weight limits for this product.
 - Maximum load: 450 lb (203 kg)
 - Maximum load for shelf: 100 lb (45 kg)
 - Maximum load for bottom panel: 150 lb (68 kg)

MAINTENANCE

- Periodically clean the surfaces with a soft rag and water.
- Grease and oil can be removed with most standard cleaning fluids. For safety, use a nonflammable cleaning fluid.



- Before assembling and using this product, carefully read this instruction manual and all of the labels affixed to the product. Failure to follow all warnings and instructions may result in product damage or personal injury.
- Save all warnings and instructions for future reference.

EXPLODED VIEW / PARTS LIST

No.	Description	Part No.	Qty.	No.	Description	Part No.	Qty.
1	Safety strap	314230	1	13	Key (001-010)	304196	2
2	Safety bracket	212591	1	14	Rubber ring	314219	2
3	M6 x 40 hex tapping bolt	320328	2	15	Pin	237444	4
4	Back panel	113177	5	16	Lock (001-010)	304236	1
5	Grommet	314027	5	17	Locking hook	236397	1
6	M6 x 16 hex socket head screw *	320327	64	18	Door handle	306018	2
7	Right side panel	117598	1	19	Left door	118093	1
8	Shelf	118443	3	20	Magnet	312033	2
9	Shelf bracket	226078	12	21	Door stopper	117680	1
10	Bottom panel	118591	1	22	Left side panel	117597	1
11	Adjustable foot	313066	4	23	Top panel	117599	1
12	Right door	118094	1	24	Hex wrench	317023	1

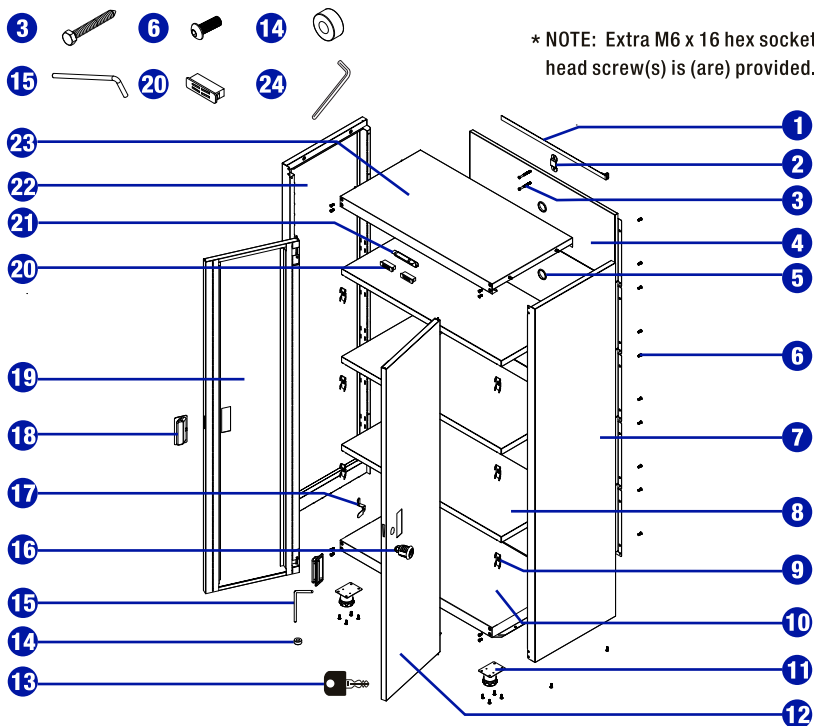
**NOTE:**

- Replacement keys may be ordered. Call our toll-free number. The code which appears on the lock will be required.
- Give information for spare parts: part number and quantity required.

ASSEMBLY INSTRUCTIONS

TOOLS REQUIRED FOR ASSEMBLY

- Hex wrench (24)
- Power drill (not included)

NOTE: Assemble on a flat surface. A piece of cardboard is recommended to keep the product from being scratched during assembly.

STEP 1 INSTALL THE ADJUSTABLE FEET

Install the adjustable feet (11) to the bottom panel (10). Make sure side A of the adjustable feet (11) are facing either towards the back or the front of the cabinet. Tighten securely with sixteen M6 x 16 hex socket head screws (6).

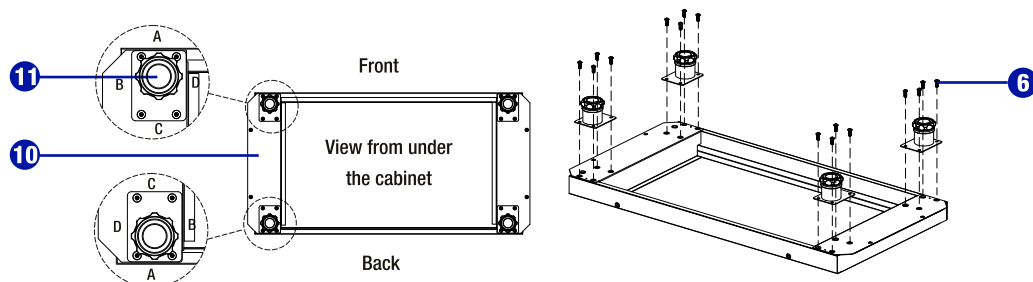

STEP 2 ATTACH THE SIDE AND BOTTOM PANELS

Attach the side panels (7 and 22) to the bottom panel (10) with eight M6 x 16 hex socket head screws (6).

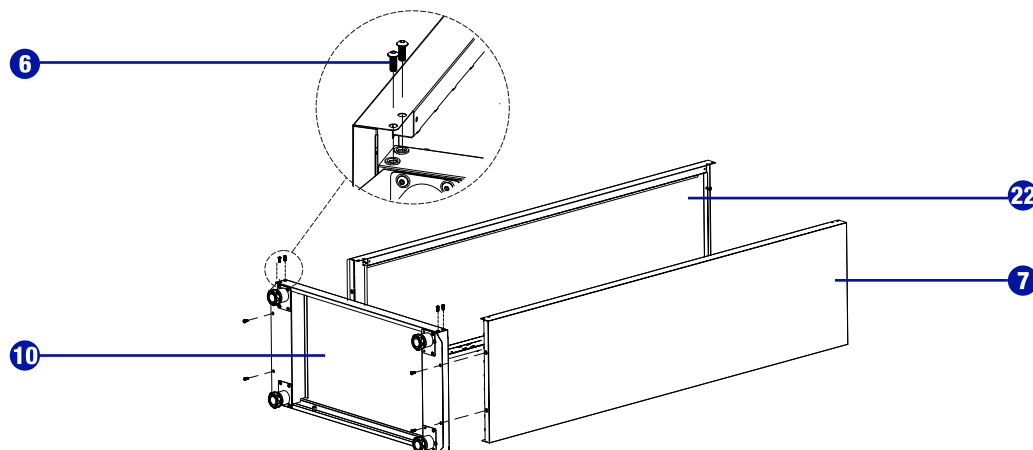

STEP 3 ATTACH THE DOOR STOPPER AND THE TOP PANEL

- First press the two trapezoidal taps at the front centre of the top panel (23) inwards by 90 degrees.
- Insert the door stopper (21) onto the two taps. Make sure the magnets (20) are outside of the top panel (23) and face toward the front of the cabinet.
- Finally, bend the two trapezoidal taps of the top panel (23) outwards until they are against the door stopper (21).

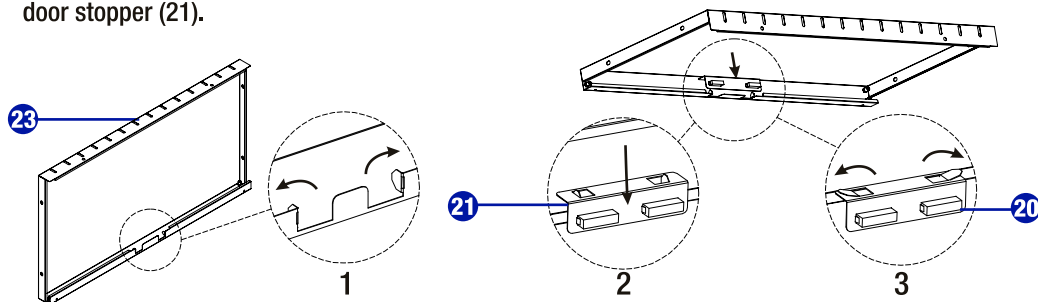

- Attach the top panel (23) to the side panels (7 and 22) with eight M6 x 16 hex socket head screws (6). Insert the screws by hand. DO NOT tighten.

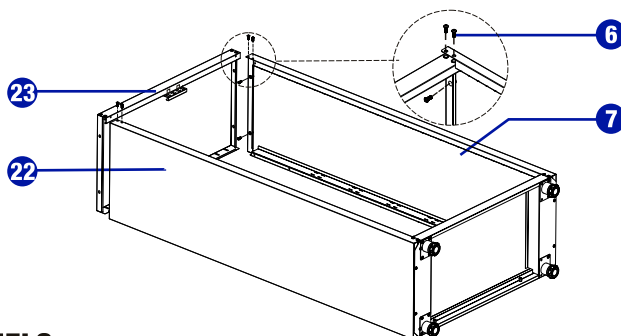

STEP 4 ATTACH THE BACK PANELS



Make sure your floor is free of debris or the cabinet face is protected before laying the cabinet on its face.



The top edge of the top back panel should be inserted under the back of the top panel.

- Lay the cabinet on its face.
- Insert rubber grommets (5) into cut-out holes at the centre of the back panels (4).
- Attach the back panels (4) to the back of the cabinet with thirty-two M6 x 16 hex socket head screws (6). Insert the screws by hand. DO NOT tighten.

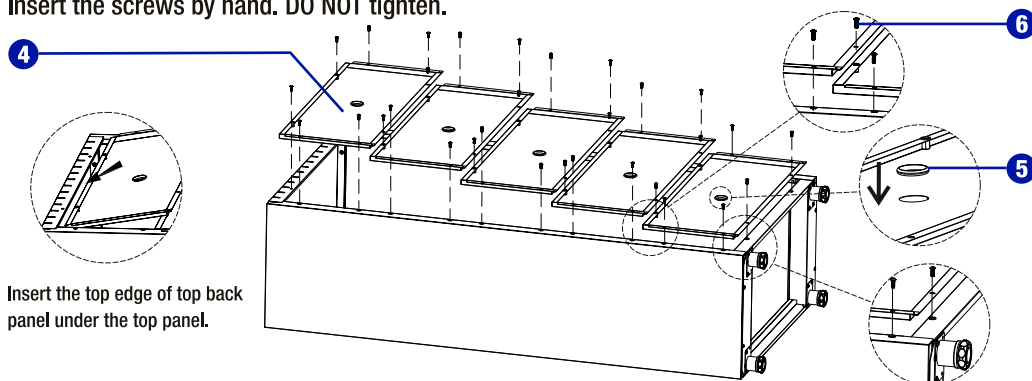

Insert the top edge of top back panel under the top panel.

STEP 5 ATTACH THE DOORS

- Lay down the left door (19) on its face with a soft mat underneath. Pull the bottom locking tab at the right bottom corner of the door outwards. Insert a pin (15) through the hole at the door's bottom corner and put a rubber ring (14) into the pin's vertical end.
- Push back the bottom locking tab to its place. Insert the horizontal end of the pin (15) into the hole at the locking tab at the same time.
- Take up the left door (19) and insert the pin (15) into the hole at the left bottom corner of the bottom panel (10).
- Pull the upper locking tab at the right top corner of the door outwards. Insert a pin (15) through the hole at door's right top corner into the hole at the left top corner of the cabinet.
- Push back the upper locking tab to its place. Insert the horizontal end of the pin (15) into the hole at the locking tab at the same time.
- Repeat the same procedure to install the right door (12).
- Close the doors to see if the doors can touch the magnets (20) completely. If not, adjust the cabinet's top and side panels to make sure the shape of the cabinet is square and flush. Until the doors can catch the magnets (20) completely, tighten the top and back panels' screws.



When push the locking tab back to its place, make sure the end of the pin's horizontal part inserted into the hole of the locking tab to make the pin well locked.

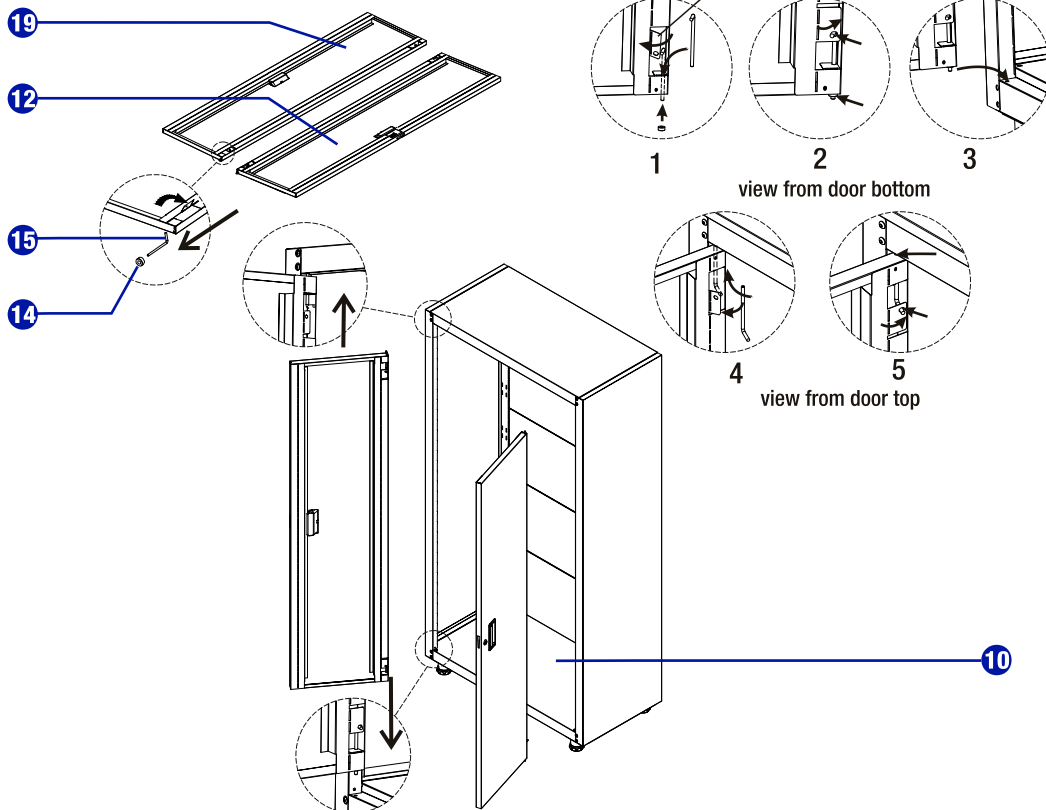

STEP 6 INSTALL THE LOCKING HOOK

Install the lock (16) per Step 1, ensuring the lock code stays on top of the lock face. Release the nut from the lock (16) back and attach the locking hook (17) per Step 3. Tighten the hook (17) securely with the nut previously removed from the lock (16) back as shown in Step 4.

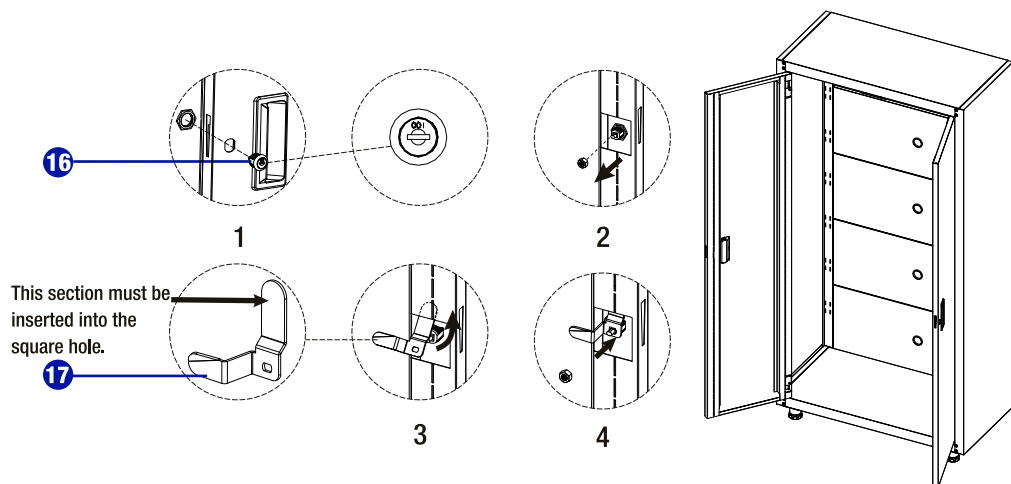

STEP 7 INSTALL THE SHELVES

- Insert twelve shelf brackets (9) into the slots on the side panels (7 and 22) at the desired heights. Make sure the four brackets (9) for each shelf (8) are at the same height.
- Place the shelves (8) over the shelf brackets (9), and push them down onto the shelf brackets (9). Make sure the shelves (8) are properly and safely locked by the upright hooks of the shelf brackets (9).

NOTE: To use the locking mechanism, one of the shelves must be placed in the center position.

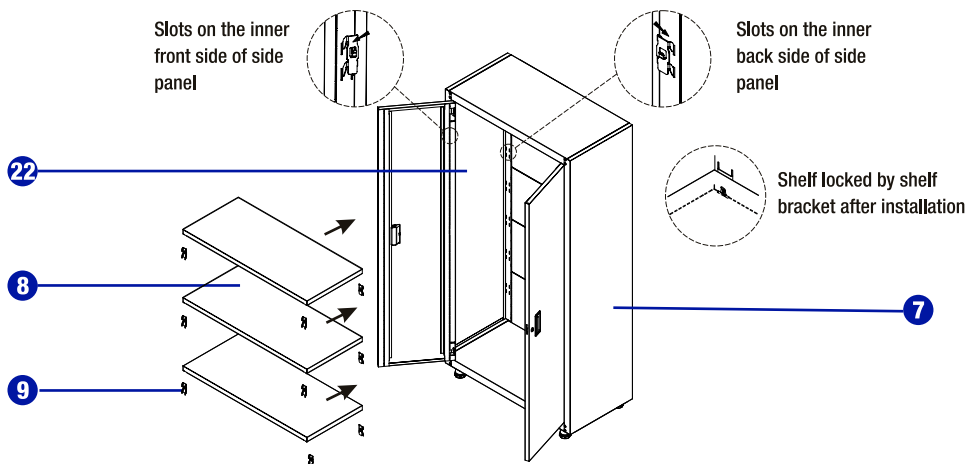

STEP 8 CONNECT THE CABINET TO THE WALL

The M6 x 40 hex tapping bolts (3) should be drilled into the stud of the wall.



The safety bracket's bottom M6 x 40 hex tapping bolt (3) should be 70 3/8" (179 cm) from the floor.

Install the safety bracket (2) to the wall with two M6 x 40 hex tapping bolts (3).

Fasten the tall cabinet by using the safety strap (1) to tie the tall cabinet and safety bracket (2) together. Tighten securely.

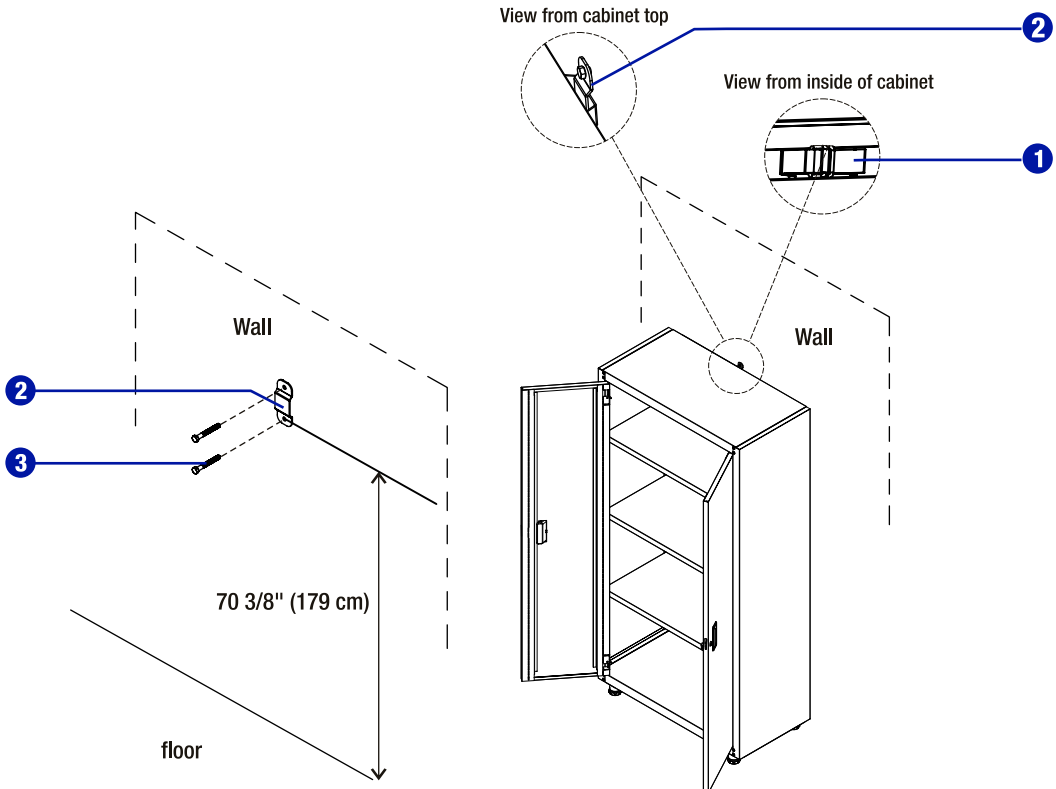

COORDINATING PRODUCTS

This product coordinates well with the units below to offer a best storage solution. They can be combined into various combinations to meet different storage requirements.

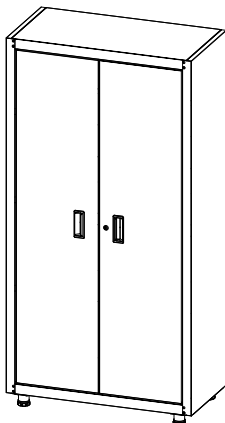
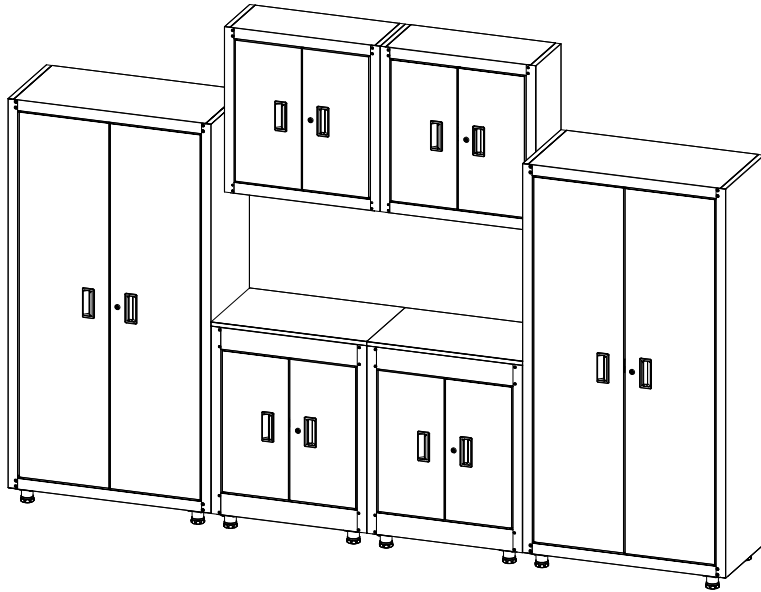

Tall Cabinet
068-0006-8

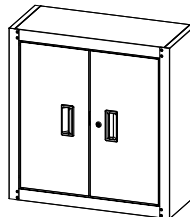

Wall Cabinet
068-0005-0

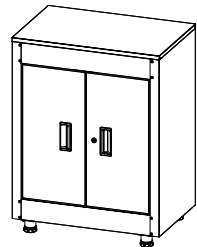

Stainless Steel Top
Base Cabinet
068-0004-2

LIMITED WARRANTY

This product is guaranteed for 1 year from the date of original retail purchase against defects in materials and workmanship.

Subject to the conditions and limitations described below, this product, if returned to us with a proof of purchase within the stated warranty period and if covered under this warranty, will be repaired or replaced (with the same model, or one of equal value or specification), at our option. We will bear the cost of any repair or replacement and any costs of labour relating thereto.

This warranty is subject to the following conditions and limitations:

- a) A sales receipt that indicates the date of purchase must be provided;
- b) This warranty will not apply to any product or part thereof which is worn or broken or which has become inoperative due to abuse, misuse, accidental damage, neglect or lack of proper installation, operation or maintenance (as outlined in the applicable owner's manual or operating instructions) or which is being used for industrial, professional, commercial or rental purposes;
- c) This warranty will not apply to normal wear and tear or to expendable parts or accessories that may be supplied with the product that are expected to become inoperative or unusable after a reasonable period of use;
- d) This warranty will not apply to routine maintenance and consumable items such as, but not limited to, fuel, lubricants, vacuum bags, blades, belts, sandpaper, bits, fluids, tune-ups or adjustments;
- e) This warranty will not apply if damage is caused by repairs made or attempted by others (i.e. persons not authorized by the manufacturer);
- f) This warranty will not apply to any product that was sold as a reconditioned or refurbished product (unless otherwise specified in writing);
- g) This warranty will not apply to any product or part thereof if any part from another manufacturer is installed therein or any repairs or alterations have been made or attempted by unauthorized persons;
- h) This warranty will not apply to normal deterioration of the exterior finish, such as, but not limited to, scratches, dents, paint chips, or to any corrosion or discolouring by heat, abrasive and chemical cleaners;
- i) This warranty will not apply to component parts sold by and identified as the product of another company, which shall be covered under the product manufacturer's warranty, if any.

Additional Limitations

This warranty applies only to the original purchaser and may not be transferred. Neither the retailer nor the manufacturer shall be liable for any other expense, loss or damage, including, without limitation, any indirect, incidental, consequential or exemplary damages arising in connection with the sale, use or inability to use this product.

Notice to Consumer

This warranty gives you specific legal rights, and you may have other rights, which may vary from province to province. The provisions contained in this warranty are not intended to limit, modify, take away from, disclaim or exclude any statutory warranties set forth in any applicable provincial or federal legislation.

This product is not guaranteed if used for industrial or commercial purposes.

Made in China.

Imported by Mastercraft Canada Toronto, Canada M4S 2B8