

# **CERTIFIED**®

model number 060-6106-0

## **20 V TELESCOPIC GRASS TRIMMER & EDGER**

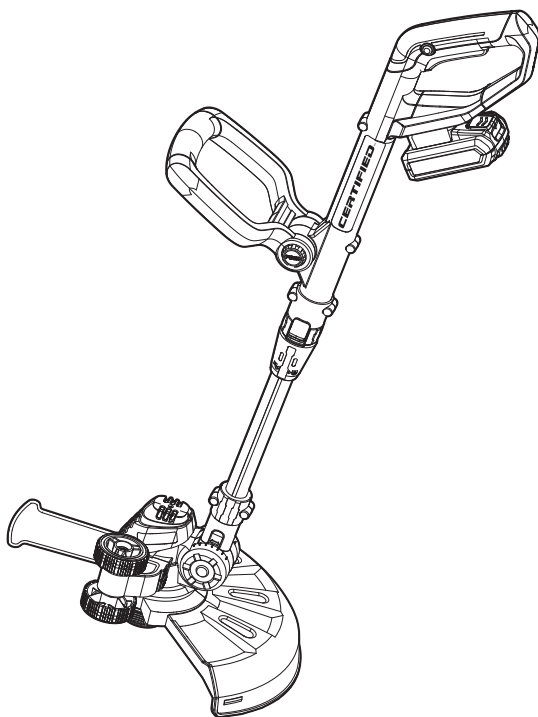

### **IMPORTANT:**

Please read this manual carefully before running this grass trimmer and save it for reference.

## **SAFETY AND OPERATING MANUAL**



For problems or questions, **DO NOT RETURN TO STORE.** Please contact one of our Customer Service Agents who would be happy to assist you.

For customer assistance please call:



**CANADA: 1-844-428-7277**



**Read and understand this instruction manual thoroughly before using the product. It contains important information for your safety as well as operating and maintenance advice.**

**Keep this instruction manual for future use. Should this product be passed on to a third party, this instruction manual must be included.**



**Intertek  
3026035**

model number 060-6106-0

## TABLE OF CONTENTS

<b>PRODUCT SAFETY</b>	<b>5</b>
Important safety instructions for all appliances	5
For all battery-operated gardening appliances	5
Additional safety rules for lawn trimmer and edge trimmer	6
Safety warnings for battery pack	6
Information for radiated emission	7
<b>SYMBOLS</b>	<b>9</b>
<b>COMPONENT LIST</b>	<b>10</b>
<b>TECHNICAL DATA</b>	<b>11</b>
<b>ACCESSORIES</b>	<b>12</b>
<b>ASSEMBLY</b>	<b>13</b>
Charging the battery pack	13
Checking the battery charge condition	14
Installing or removing battery pack	14
Fitting the safety guard	15
Removing the blade protection label	15
Fitting/removing the edger wheel	16
Adjusting the auxiliary handle	16
Adjusting the height	16
Adjusting the cutting angle	17
Adjusting spacer guard	17
<b>OPERATION</b>	<b>18</b>
Safety on/off switch	18
Trimming	18
Edging	19
Automatic line feed system	20
To manually feed the line	20
<b>MAINTENANCE</b>	<b>21</b>
<b>EXPLODED VIEW</b>	<b>24</b>
<b>PARTS LIST</b>	<b>25</b>
<b>WARRANTY</b>	<b>27</b>

### SAVE THESE INSTRUCTIONS

This manual contains important safety and operating instructions. Read all instructions and follow them with use of this product.

**IMPORTANT SAFETY INSTRUCTIONS  
FOR ALL APPLIANCES:**

- 1) **Avoid Dangerous Environments** — Don't use appliances in damp or wet locations.
- 2) **Don't Use In Rain.**
- 3) **Keep Children Away** — All visitors should be kept at a distance from work area.
- 4) **Dress Properly** — Do not wear loose clothing or jewellery. They can be caught in moving parts. Use of rubber gloves and substantial footwear is recommended when working outdoors. Wear protective hair covering to contain long hair.
- 5) **Use Safety Glasses** — Always use face or dust mask if operation is dusty.
- 6) **Use Right Appliance** — Do not use appliance for any job except that for which it is intended.
- 7) **Don't Force Appliance** — It will do the job better and with less likelihood of a risk of injury at the rate for which it was designed.
- 8) **Don't Overreach** — Keep proper footing and balance at all times.
- 9) **Stay Alert** — Watch what you are doing. Use common sense. Do not operate appliance when you are tired.
- 10) **Store Idle Appliances Indoors** — When not in use, appliances should be stored indoors in dry, and high or locked-up place — out of reach of children.

- 11) **Maintain Appliance With Care** — Keep cutting edge sharp and clean for best performance and to reduce the risk of injury. Follow instructions for lubricating and changing accessories. Keep handles dry, clean, and free from oil and grease.
- 12) **Check Damaged Parts** — Before further use of the appliance, a guard or other part that is damaged should be carefully checked to determine that it will operate properly and perform its intended function. Check for alignment of moving parts, binding of moving parts, breakage of parts, mounting, and any other condition that may affect its operation. A guard or other part that is damaged should be properly repaired or replaced by an authorized service centre unless indicated elsewhere in this manual.

**FOR ALL BATTERY-OPERATED  
GARDENING APPLIANCES:**

- 1) **Prevent unintentional starting.** Ensure the switch is in the off-position before connecting to battery pack, picking up or carrying the appliance. Carrying the appliance with your finger on the switch or energizing appliance that have the switch on invites accidents.
- 2) **Disconnect the battery pack from the appliance before making any adjustments, changing accessories, or storing appliance.** Such

**READ ALL INSTRUCTIONS**

**WARNING!** Read all safety warnings and instructions. Failure to follow the warnings and instructions may result in electric shock, fire and/or serious injury.

**WARNING:** The use of any other accessory or attachment might increase the risk of injury.



preventive safety measures reduce the risk of starting the appliance accidentally.

- 3) Recharge only with the charger specified by the manufacturer. A charger that is suitable for one type of battery pack may create a risk of fire when used with another battery pack.
- 4) Use appliances only with specifically designated battery packs. Use of any other battery packs may create a risk of injury and fire.
- 5) When battery pack is not in use, keep it away from other metal objects, like paper clips, coins, keys, nails, screws or other small metal objects, that can make a connection from one terminal to another. Shorting the battery terminals together may cause burns or a fire.
- 6) Under abusive conditions, liquid may be ejected from the battery; avoid contact. If contact accidentally occurs, flush with water. If liquid contacts eyes, additionally seek medical help. Liquid ejected from the battery may cause irritation or burns.
- 7) Do not use a battery pack or appliance that is damaged or modified. Damaged or modified batteries may exhibit unpredictable behavior resulting in fire, explosion or risk of injury.
- 8) Do not expose a battery pack or appliance to fire or excessive temperature. Exposure to fire or temperature above 130°C ( 265°F) may cause explosion.
- 9) Follow all charging instructions and do not charge the battery pack or appliance outside of the temperature range specified in the

instructions. Charging improperly or at temperatures outside of the specified range may damage the battery and increase the risk of fire.

- 10) Have servicing performed by a qualified repair person using only identical replacement parts. This will ensure that the safety of the product is maintained.
- 11) Do not modify or attempt to repair the appliance or the battery pack (as applicable) except as indicated in the instructions for use and care.

### ADDITIONAL SAFETY RULES FOR LAWN TRIMMER AND EDGE TRIMMER

1. Keep guards in place and in good working order.
2. Keep hands and feet away from cutting area.
3. Do not use heavier lines than recommended in this manual.
4. Do not use line materials of other types – for example, metal wire, rope, and the like.

### SAFETY WARNINGS FOR BATTERY PACK

- a) Do not dismantle, open or shred battery pack.
- b) Do not expose battery pack to heat or fire. Avoid storage in direct sunlight.
- c) Do not short-circuit a battery pack. Do not store battery packs haphazardly in a box or drawer where they may short-circuit each other or be short-circuited by other metal objects. When battery pack is not in use, keep it away

from other metal objects, like paper clips, coins, keys, nails, screws or other small metal objects, that can make a connection from one terminal to another. Shorting the battery terminals together may cause burns or fire.

- d) Do not subject battery pack to mechanical shock.
- e) In the event of battery leaking, do not allow the liquid to come in contact with the skin or eyes. If contact has been made, wash the affected area with copious amounts of water and seek medical advice.
- f) Do not use any battery pack which is not designed for use with the equipment.
- g) Keep battery pack out of the reach of children.
- h) Always purchase the battery pack recommended by the device manufacturer for the equipment.
- i) Keep battery pack clean and dry.
- j) Wipe the battery pack terminals with a clean, dry cloth if they become dirty.
- k) Battery pack needs to be charged before use. Always use the correct charger and refer to the manufacturer's instructions or equipment manual for proper charging instructions.
- l) Do not leave battery pack on prolonged charge when not in use.
- m) After extended periods of storage, it may be necessary to charge and discharge the battery pack several times to obtain maximum performance.
- n) Recharge only with the charger specified by manufacturer. Do not use any charger other than that specifically provided for use with the equipment.

- o) Retain the original product literature for future reference.
- p) Use only the battery pack in the application for which it was intended.
- q) Remove the battery pack from the equipment when not in use.
- r) Dispose of properly.
- s) Do not mix cells of different manufacture, capacity, size or type within a device.
- t) Keep the battery away from microwaves and high pressure.

## INFORMATION FOR RADIATED EMISSION

This device complies with Canadian ICES-001.

This device complies with Part 15 of the FCC Rules.

Operation is subject to the following two conditions:

- (1) This device may not cause harmful interference; and
- (2) This device must accept any interference received, including interference that may cause undesired operation



**WARNING:** Changes or modifications to this unit not expressly approved by the party responsible for compliance could void the user's authority to operate the equipment.

**NOTE:** This equipment has been tested and found to comply with the limits for a Class B digital device, pursuant to Part 15 of the FCC Rules.

These limits are designed to provide reasonable protection against harmful interference in a residential installation. This equipment generates, uses and can radiate radio frequency energy and, if not installed and used in

## model number 060-6106-0

accordance with the instructions, may cause harmful interference to radio communications.

However, there is no guarantee that interference will not occur in a particular installation. If this equipment does cause harmful interference to radio or television reception, which can be determined by turning the equipment off and on, the user is encouraged to try to correct the interference by one or more of the following measures:

- Reorient or relocate the receiving antenna.
- Increase the separation between the equipment and receiver.
- Connect the equipment into an outlet on a circuit different from that to which the receiver is connected.
- Consult the dealer or an experienced radio/TV technician for help.

**SAVE THESE INSTRUCTIONS**

### FCC Part 15

Supplier's Declaration of Conformity

Product Description: Charger

Model Number: ACG318WU1

Trade Name: CERTIFIED®

This device complies with part 15 of the FCC Rules.

Operation is subject to the following two conditions:

- This device may not cause harmful interference; and
- This device must accept any interference received, including interference that may cause undesired operation.

Responsible Party:

Positec USA, Inc.

10130 Perimeter Parkway, Charlotte, NC  
28216 USA

Tel.: (704) 599-3711

Fax: (704) 599-6390



## SYMBOLS



Warning



To reduce the risk of injury, user must read instruction manual



Wear ear protection



Li-ion

Lithium-ion battery; battery must be recycled



Do not burn



Batteries may enter water cycle if disposed improperly, which can be hazardous for ecosystem. Do not dispose of waste batteries as unsorted municipal waste.



### call2recycle®

Certified® Inc. has established a partnership with the RBRC Corporation to recycle any Certified® batteries with the RBRC-call2recycle seal. For environmental protection, please do not discard batteries in the trash. After the batteries' life cycle has ended, please call 1-800-822-8837 for a free service that will properly dispose of the battery.

## model number 060-6106-0

- |                                     |                                     |
|-------------------------------------|-------------------------------------|
| 1. Lock-off button                  | 9. Edger wheel                      |
| 2. On/Off switch                    | 10. Spacer guard                    |
| 3. Battery pack release button      | 11. Cutting head assembly           |
| 4. Battery pack                     | 12. Auxiliary handle locking knob   |
| 5. Handle rotation locking button   | 13. Auxiliary handle                |
| 6. Height adjustment locking collar | 14. Line cutter (See Fig. D)        |
| 7. Telescope tube                   | 15. Line feed button (See Fig. M)   |
| 8. Safety guard                     | 16. Cap release latch (See Fig. N1) |

\* Not all the accessories illustrated or described are included in standard delivery.

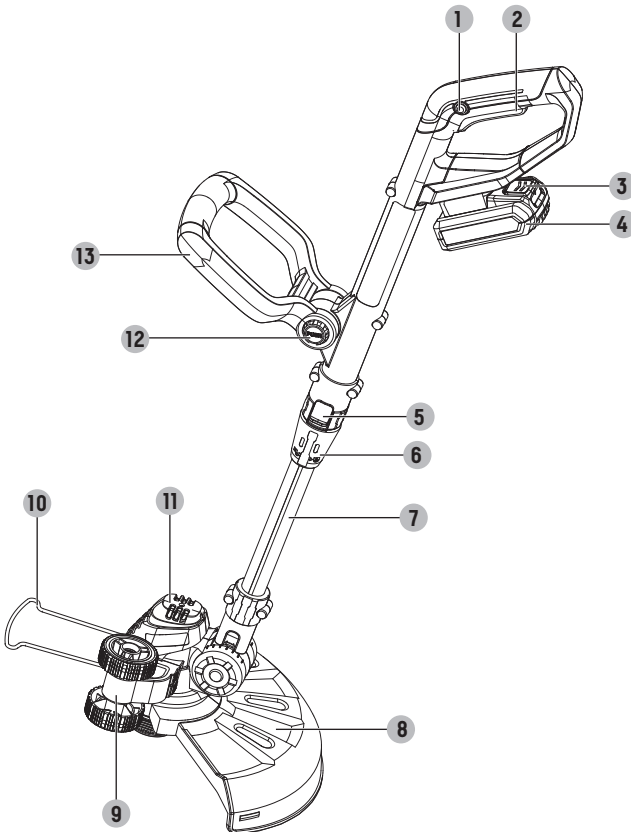

Rated voltage	20 V $\equiv$ Max.*
No load speed	8500 /min
Max. cutting diameter	12" (30.5 cm)
Diameter of line	0.065" (1.65 mm)
Line Length	10' (3 m)
Battery capacity (ABP1820HWU)	2.0 Ah
Charger input (ACG318WU1)	120 V~60 Hz, 10 W
Charger output (ACG318WU1)	18 V $\equiv$ , 0.4 A
Charging time	5 – 7 hours
Protection class	$\square$ /II
Machine weight	4 lb 15 oz (2.24kg)

\*Voltage measured without workload. Initial battery voltage reaches maximum of 20 volts. Nominal voltage is 18 volts.

## model number 060-6106-0

Charger	1
Battery pack	1
Safety guard	1
Auxiliary handle	1
Spacer guard	1
Edger wheel	1

We recommend that you purchase your accessories from the same store that sold you this product. Refer to the accessory packaging for further details. Store personnel can assist you and offer advice.

**OPERATION INSTRUCTION**

**NOTE:** Before using this product, read the instruction book carefully.

**INTENDED USE**

The machine is intended for the cutting of grass and weeds under bushes, as well as on slopes and edges that can not be reached with the lawn mower.

**1. CHARGING THE BATTERY PACK**

- a) Do not use any charger other than that specifically provided for use with the equipment.
- b) If the battery pack is very hot you must remove your battery pack from the charger and allow time for the battery to cool down before recharging.
- c) The battery in your new tool is not charged when it leaves the plant. Therefore it must be full charged before using the first time.
- d) Please charge the battery to reach full or no less than half charge before storage. If the tool will not be used for long periods of time, charge the battery every 3-6 months.

**CHARGING PROCEDURE (SEE FIG. A1)**

- 1) Plug the charger into an appropriate outlet. The light will be green.
- 2) Slide the battery pack into the charger; the light will turn red to indicate the charging process has started.
- 3) When charging is completed, the light will turn green. The pack is now fully charged; unplug the charger and remove the battery pack.



**WARNING:** The charger and battery pack are specially designed to work together so do not attempt to use any other devices. Never insert or allow metallic objects into your charger or battery pack connections because an electrical failure and hazard will occur.

**WARNING:** When battery charge runs out after continuous use or exposure to direct sunlight or heat, allow time for the tool to cool down before re-charging to achieve the full charge.

model number 060-6106-0

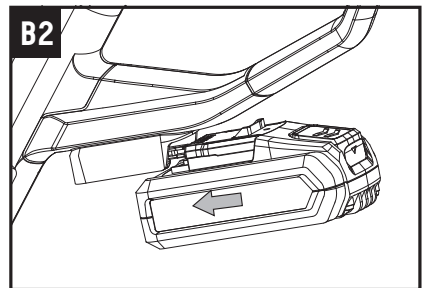
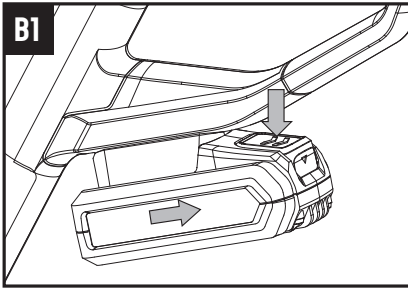
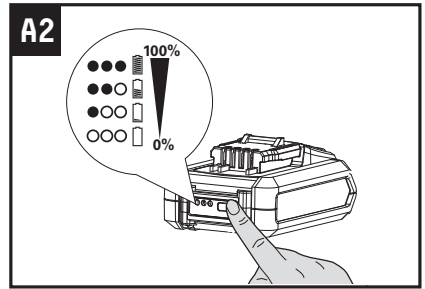
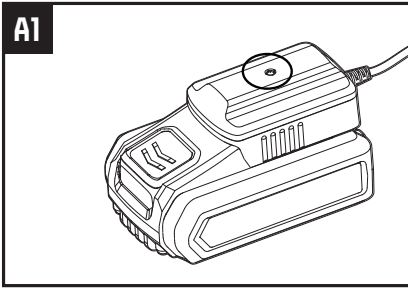

### CHARGING INDICATOR

Light	Status
Red on ●	Charging
Green on ●	Fully Charged

### 2. CHECKING THE BATTERY CHARGE CONDITION (SEE FIG. A2)

The battery level can be determined from the battery indicator light by pressing the button beside the lights.

### 3. INSTALLING OR REMOVING BATTERY PACK (SEE FIG. B1, B2)

Depress the battery pack release button to release battery pack from your grass trimmer. After recharging, insert the battery pack into grass trimmer's battery port. A simple push and slight pressure will be sufficient.

**4. FITTING THE SAFETY GUARD (SEE FIG. C1-C3)**

- 1) Remove the pre-assembled mounting screw (a) from safety guard, see Fig. C1.
- 2) Attach the safety guard to the trimmer head, align the guard so it slides into the slots located on the trimmer head, see Fig. C2.
- 3) Secure the safety guard onto the trimmer head with the screw provided, see C3.

**5. REMOVING THE BLADE PROTECTION LABEL (SEE FIG.D)**

The blade is covered with a protect label. Please remove it before operation.

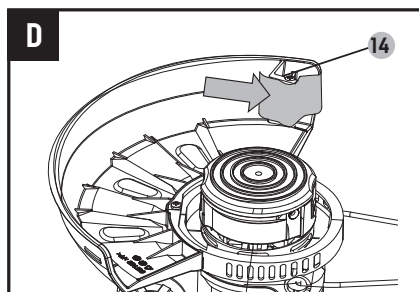
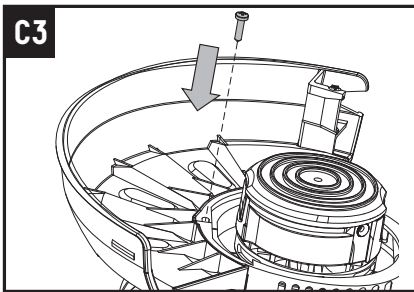
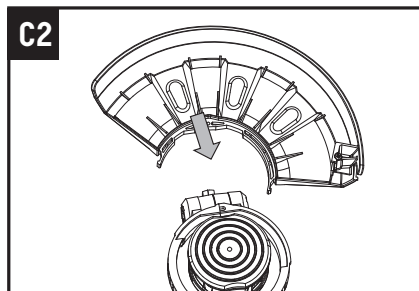
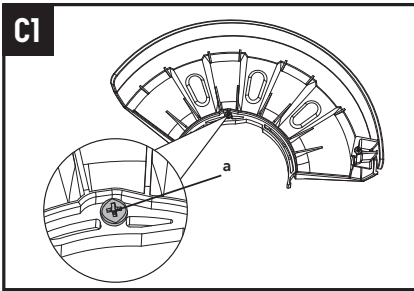

**WARNING:** The guard must always be on the tool to protect the user.  
**WARNING:** Never operate the tool without the guard properly in place. Use of the unit without having installed the guard will cause the motor to overheat, and void the warranty.



**WARNING:** Be careful when doing this as the guard has a very sharp line cutter. (See Fig. D)

model number 060-6106-0

### 6. FITTING/REMOVING THE EDGER WHEEL (SEE FIG. E1, E2)

With the tool upside-down, slide the edger wheel onto the metal plate located on the side of the trimmer head. Make sure the grooves of the edger wheel locks onto the metal plate; you will hear it click into place. To remove the wheel, press the release button (b) on the wheel and pull the wheel out from the trimmer head.

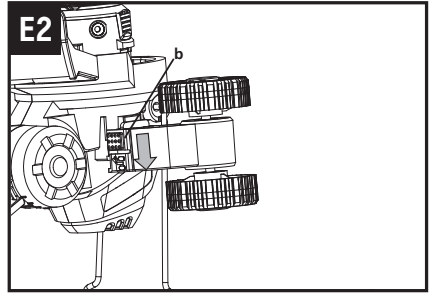
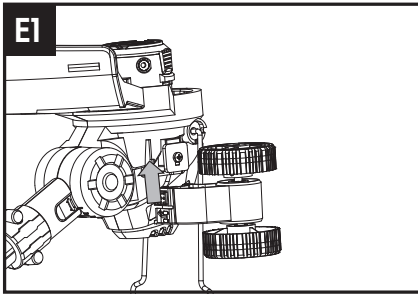

### 7. ADJUSTING THE AUXILIARY HANDLE (SEE FIG. F)

Press the auxiliary handle locking knob. Rotate the auxiliary handle to the most comfortable and balanced position. Then, release the auxiliary handle locking knob.

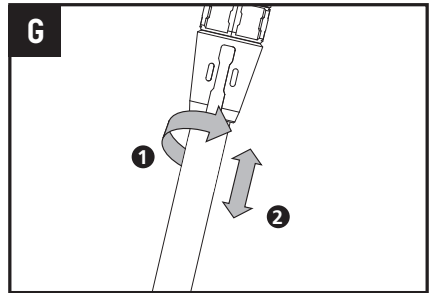
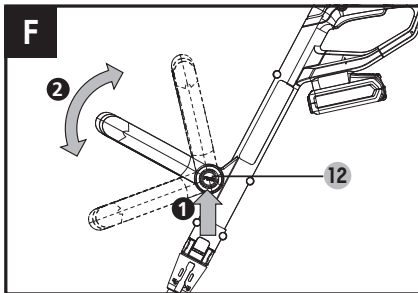

### 8. ADJUSTING THE HEIGHT (SEE FIG. G)

Unscrew the height adjustment locking collar in the direction indicated. To unlock, turn it clockwise.

Adjust the length of the aluminum tube to the most comfortable length. Tighten the locking collar in the direction indicated. To lock, turn it counter-clockwise.



**9. ADJUSTING THE CUTTING ANGLE (SEE FIG. H1, H2)**

To adjust the main handle angle downwards, or convert the tool from trimming mode to edging mode, put one foot on the motor housing portion of the trimmer head, then grip the main handle and apply adequate force on the main handle pushing it downwards, as shown in Fig. H1.

To adjust the main handle angle upwards, put one foot on the safety guard area of the trimmer head, then grip the main handle, and apply adequate force to adjust, as shown in Fig. H2.

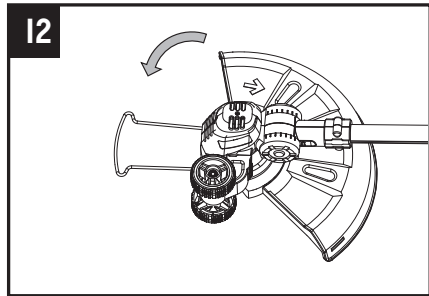
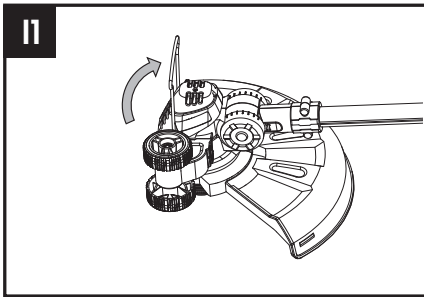
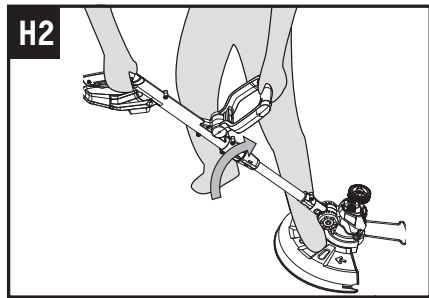
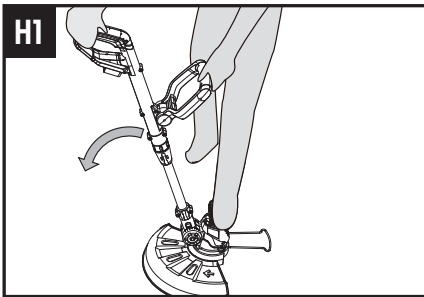
**10. ADJUSTING SPACER GUARD (SEE FIG. I1, I2)**

Lift the spacer guard up when edging and put it down before trimming. Before trimming or edging make sure the spacer guard is locked firmly in position.

model number 060-6106-0

### 1. SAFETY ON/OFF SWITCH (SEE FIG. J)

The safety switch is locked off to prevent accidental starting. Depress the lock off button first then depress the on/off switch, after that you can release the lock off button. Your trimmer is now on.

To switch off, just release the on/off switch.

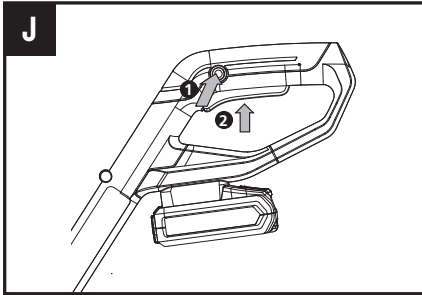

### 2. TRIMMING

- 1) Keep the trimmer head at an angle of about 30° to the ground when trimming (see Fig. K1).
- 2) Do not cut wet grass because it tends to stick to the trimmer head and guard, prevents proper discharge of grass clippings, and could cause you to slip and fall.
- 3) Regularly remove clippings and dirt around the trimmer head when trimmer



**WARNING!** The cutting head continues to rotate after the trimmer has been switched off; wait until it has completely stopped then lay down the tool.



**WARNING!** Always wear the eye protection. Never lean over the trimmer head. Rocks or debris can ricochet or be thrown into eyes and face and cause blindness or other serious injury. When operating unit, check for the following:

Wear eye protection and heavy clothing. Hold front handle with one hand and auxiliary handle with the other hand. Keep unit below waist level. Work only from your right to your left to ensure debris is thrown away from you. Without bending over, keep line near and parallel to the ground (perpendicular when edging) and not crowded into material being cut.



**WARNING!** Make sure that line is fed out before operation. Make sure motor is up to full speed before trimming.

is switched off and battery is removed.

- 4) Work rhythmically, stand firmly with your feet apart. Cut from right to left so the trimmings will be thrown away from the work area (see Fig. K2).
- 5) When cutting longer /high grass, please make sure that you cut this down in 2 to 3 stages (see Fig.K3, K4).
- 6) Do not move the trimmer too fast as this will result in ineffective cutting and possible damage.

If you find that the nylon line is too short follow the instructions in "AUTOMATIC LINE FEED SYSTEM" or "TO MANUALLY FEED THE LINE".

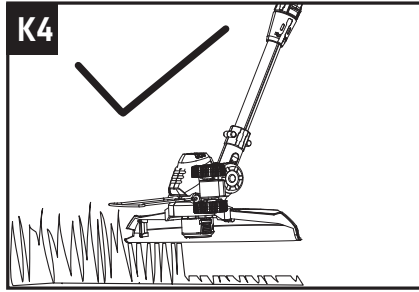
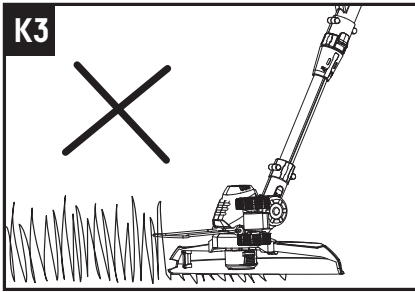
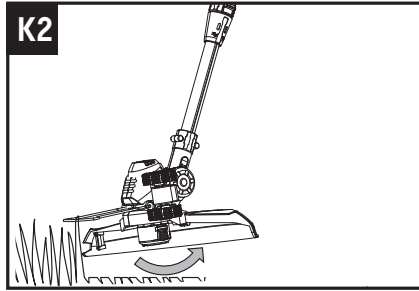
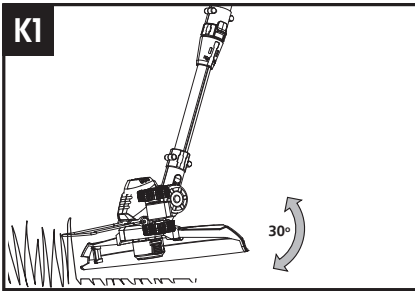

### 3. EDGING (SEE FIG. L1, L2)

Change the tool from trimming to edging mode by adjusting the cutting angle to be in the lowest horizontal setting. Then push the handle rotation locking button downward and rotate the main handle 90 degrees clockwise.

While edging, only allow the tip of the line to make contact with the area being worked. Do not force the line. The edging wheel help protect the unit and keep the unit from contacting the ground. Take extra caution while edging as objects can be thrown from the trimmer line.

model number 060-6106-0

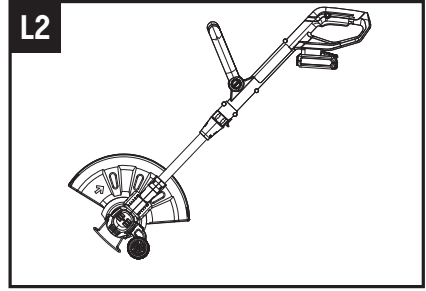
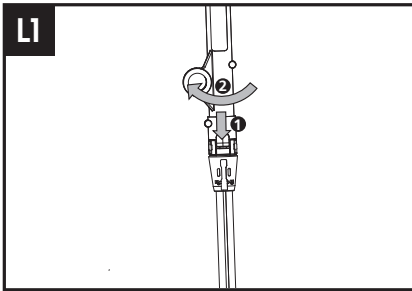

#### 4. AUTOMATIC LINE FEED SYSTEM

When initially switching on the trimmer, a small length of line is fed out. A 'clattering' noise will be heard when the lines hit the line cutter. **DO NOT BE ALARMED.** This is quite normal. After about 5 seconds, the line will be cut to the correct length and the noise will reduce as the motor reaches full speed. If the noise of the line being cut can't be heard, more line will be fed out. To feed more line, it is first necessary to allow the trimmer to stop completely, then restart, allowing the motor to reach full speed. Repeat above until you hear the lines hitting against the line cutter. (Do not repeat this procedure more than 6 times.)

#### 5. TO MANUALLY FEED THE LINE (SEE FIG. M)

The required line can be fed out manually. Before manually feeding, remove the battery first.

To operate, press and release manual line feed button, while gently pulling out the lines until the lines reach the line cutter.

If the line extends past the line cutter, too much line has been fed out.

If too much line is fed out, remove the spool cap and turn spool counter-clockwise until the line is at the desired length.

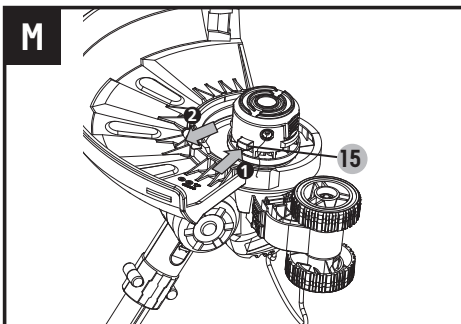

**1. TO REMOVE THE CAP**

Press and hold in the two latches (see Fig. N1).

Pull cap away from the spool holder (see Fig. N2).

When refitting the spool cap, keep all areas of the cap and spool holder clean.

Replace the cap, pressing firmly down towards the spool holder to ensure cap is fully secure.

Check that the cap is correctly fitted by trying to remove it without depressing the two latches.

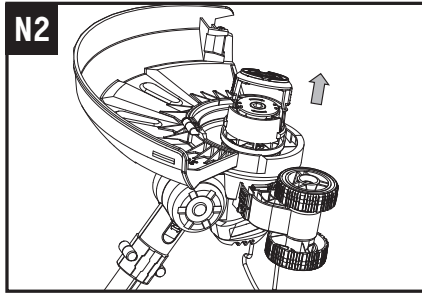
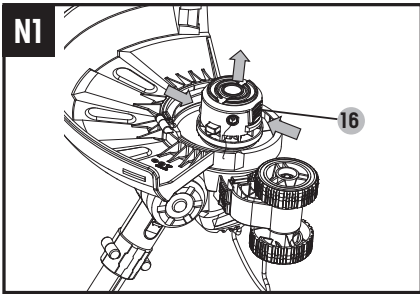
**2. REPLACING TRIMMER LINE (SEE FIG. 01-03)**

To reload nylon string trimmer line, use either 0.065" (1.65 mm) diameter bulk trimmer line or purchase pre-wound replacement spools. These can be purchased through most lawn and garden retailers.

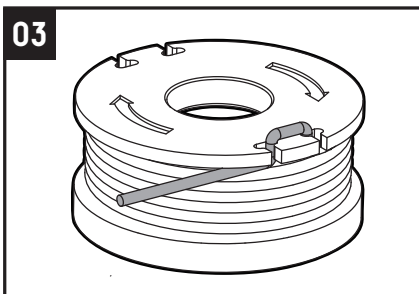
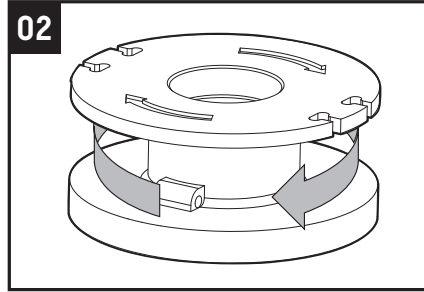
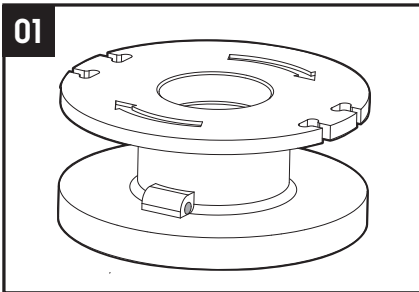

## model number 060-6106-0

**3. TO FIT SPOOL AND LINE COMPLETE**

Remove old spool.

Place new spool into cap with cut out areas of the spool in line with eyelets.

Release line from cleat and feed line through eyelet.

Refit the cap.

**4. TO FIT NYLON LINE ONLY**

Take approximately 10' (3 m) of line. Insert 0.59" (15 mm) of line into one of the holes in the upper section of the spool and wind line in the direction of the arrows on the top of the spool.

Leave approximately 4" (10 cm) of line unwound and place into cleat.

Care should be taken to ensure that the line is neatly coiled on the spool.

Failure to do so will impair the efficiency of the automatic line feed.

Then fit spool as described in "TO FIT SPOOL AND LINE COMPLETE".

**5. TROUBLESHOOTING**

Problems	Possible Causes	Corrective Action
Trimmer fails to operate.	Battery discharged.  Battery too hot/cold.  Motor is broken. Internal wiring of machine damaged.	Recharge battery; also see "CHARGING PROCEDURE" Allow to cool/warm.  Contact Service Agent. Contact Service Agent.
Trimmer runs intermittently.	Battery not fully charged. Motor is broken. On/Off switch defective.	Recharge battery. Contact Service Agent.  Contact Service Agent.
Excessive vibrations/noise.	Machine defective. Line spool is not wound well.	Contact Service Agent. Rewind the line.



**WARNING!** For manually re-loading spool with bulk trimmer line, **ONLY USE 0.065" (1.65 mm) DIAMETER NYLON MONOFILAMENT STRING TRIMMER LINE.** Do not use heavier gauge line, as it can overload the motor and cause overheating or other potential damage to the unit.

<p>Cutting time per battery charge too short.</p>	<p>Battery has not been used for long period or only charged for short term. Grass too high. Battery defective.</p>	<p>Fully charge battery; also see "CHARGE THE BATTERY PACK". Cut in stages. Replace the battery.</p>
<p>Machine does not cut.</p>	<p>Line broken. Battery not fully charged. Motor is broken (speed is too low). Grass entangled around cutting head.</p>	<p>Replace the line. Recharge battery; also see "CHARGING PROCEDURE". Contact Service Agent. Remove grass.</p>
<p>Auto feed does not work.</p>	<p>Cutting line is not wound well. The line is tangled.  Line is used up.</p>	<p>Manually feed the line. If still does not feed out, remove the spool and rewind the line. Replace with a new spool of line.</p>

**6. GENERAL MAINTENANCE**

After use, remove the battery from the tool and check for damage. Your tool requires no additional lubrication or maintenance. There are no user serviceable parts in your tool. Never use water or chemical cleaners to clean your power tool. Wipe clean with a dry cloth. Always check the cutting head and guard before each use. Always store your power tool in a dry place. Keep the motor ventilation slots clean. Keep all working controls free of dust.

**7. FOR BATTERY TOOLS**

The ambient temperature range for the use and storage of tool and battery is 32°F - 113°F (0°C - 45°C).

The recommended ambient temperature range for the charging system during charging is 32°F - 104°F (0°C - 40°C).

EXPLODED VIEW

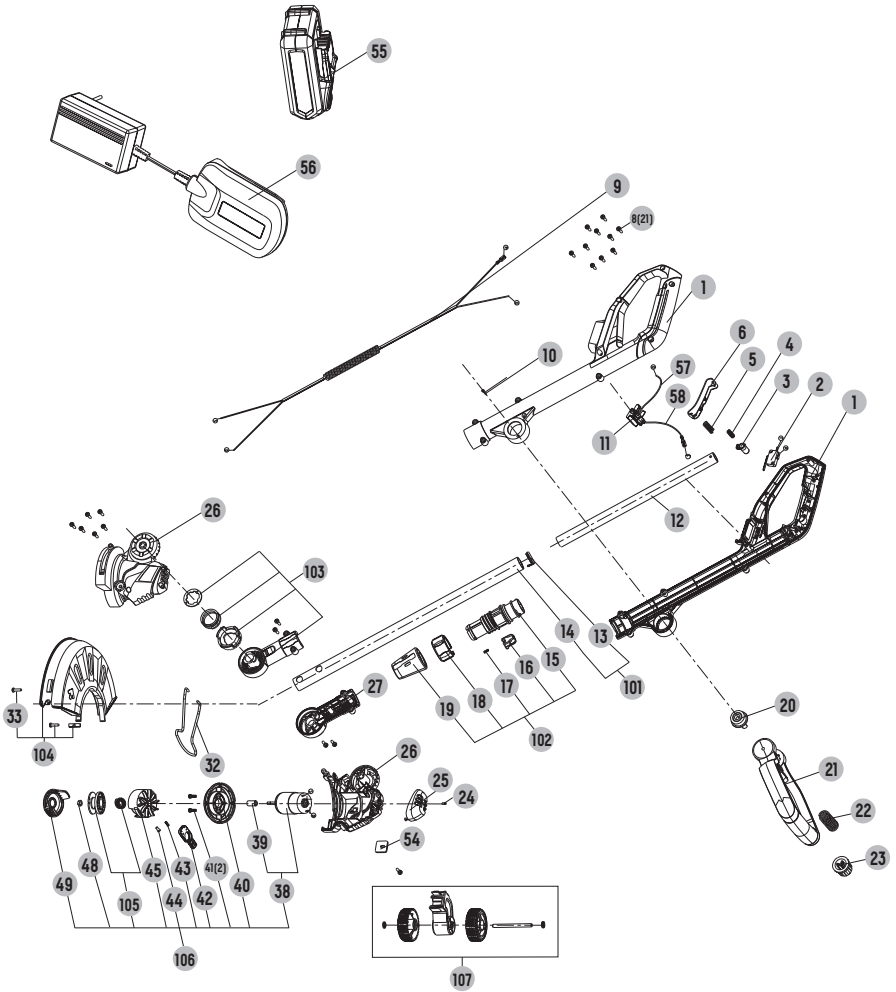



<b>Item</b>	<b>Description</b>	<b>QTY.</b>
1	Left Handle	1
2	Switch	1
3	Lock Button	1
4	Compression Spring I	1
5	Compression Spring	1
6	Switch Button	1
8	Self Tapping Screw	21
9	Coiled Cable	1
10	Self Tapping Screw	1
11	Terminal	1
12	Pvc Tube	1
13	Cover	1
14	Aluminium Tube	1
15	Thread Sleeve	1
16	Retract Lock	1
17	Compression Spring	1
18	Rotating Bush	1
19	Retract Nut	1
20	Vice-Hand Fixed Rack	1
21	Auxiliary Handle	1
22	Compression Spring	1
23	Auxiliary Handle	1
24	Self Tapping Screw	1
25	Ornament Cover	1
26	Left/Right Housing	1
27	Turn Head Lift	1
33	Screw	1
37	Flower Guard Wire	1
38	DC Motor	1
39	Adapter Sleeve	1
40	Fixing Block	1
41	Screw Washer Assembly M4*12	2
42	Line Feeder	1
43	Compression Spring	1
44	Rivet	1
45	Cutting Head	1
48	Nut	1
49	Cutting Head Cover	1
54	Clamping Plate	1
55	Battery Pack	1

## model number 060-6106-0

## PARTS LIST

56	Charger	1
57	Inner Wire	1
58	Inner Wire	1
101	Aluminium Tube	1
102	Connecting Tube	1
103	Right turn Head Assembly	1
104	Guard Set	1
105	Spool & Line	1
106	Spool & Line	1
107	Rollor Set	1

### 1-YEAR LIMITED WARRANTY

This CERTIFIED® product is guaranteed for a period of one (1) year from the date of original retail purchase against defects in workmanship and materials.

Subject to the conditions and limitations described below, this product, if returned to us with proof of purchase within the stated warranty period and if covered under this warranty, will be repaired or replaced (with the same model, or one of equal value or specification), at our option. We will bear the cost of any repair or replacement and any costs of labour relating thereto.

These warranties are subject to the following conditions and limitations:

- a) a bill of sale verifying the purchase and purchase date must be provided;
- b) this warranty will not apply to any product or part thereof which is worn or broken or which has become inoperative due to abuse, misuse, accidental damage, neglect or lack of proper installation, operation or maintenance (as outlined in the applicable owner's manual or operating instructions) or which is being used for industrial, professional, commercial or rental purposes;
- c) this warranty will not apply to normal wear and tear or to expendable parts or accessories that may be supplied with the product that are expected to become inoperative or unusable after a reasonable period of use;
- d) this warranty will not apply to routine maintenance and consumable items such as, but not limited to, lubricants, blades, fluids, tune-ups or adjustments;
- e) this warranty will not apply where damage is caused by repairs made or attempted by others (i.e., persons not authorized by the manufacturer);
- f) this warranty will not apply to any product that was sold to the original purchaser as a reconditioned or refurbished product (unless otherwise specified in writing);
- g) this warranty will not apply to any product or part thereof if any part from another manufacturer is installed therein or any repairs or alterations have been made or attempted by unauthorized persons;
- h) this warranty will not apply to normal deterioration of the exterior finish, such as, but not limited to, scratches, dents, paint chips, or to any corrosion or discolouring by heat, abrasive and chemical cleaners; and
- i) this warranty will not apply to component parts sold by and identified as the product of another company, which shall be covered under the product manufacturer's warranty, if any.

#### Additional Limitations

This warranty applies only to the original purchaser and may not be transferred. Neither the retailer nor the manufacturer shall be liable for any other expense, loss or damage, including, without limitation, any indirect, incidental, consequential or exemplary damages arising in connection with the sale, use or inability to use this product.

#### Notice to Consumer

This warranty gives you specific legal rights, and you may have other rights, which may vary from province to province. The provisions contained in this warranty are not intended to limit, modify, take away from, disclaim or exclude any statutory warranties set forth in any applicable provincial or federal legislation.

Made in China

Imported by Trileaf Distribution Trifeuil Toronto, Canada M4S 2B8

