



# YARDWORKS<sup>®/MD</sup>

## BRUSHLESS BLOWER WITH AERO FORCE TECHNOLOGY<sup>®</sup>

model no. 060-3095-2 | contact us: 1.866.523.5218



Intertek  
3026035

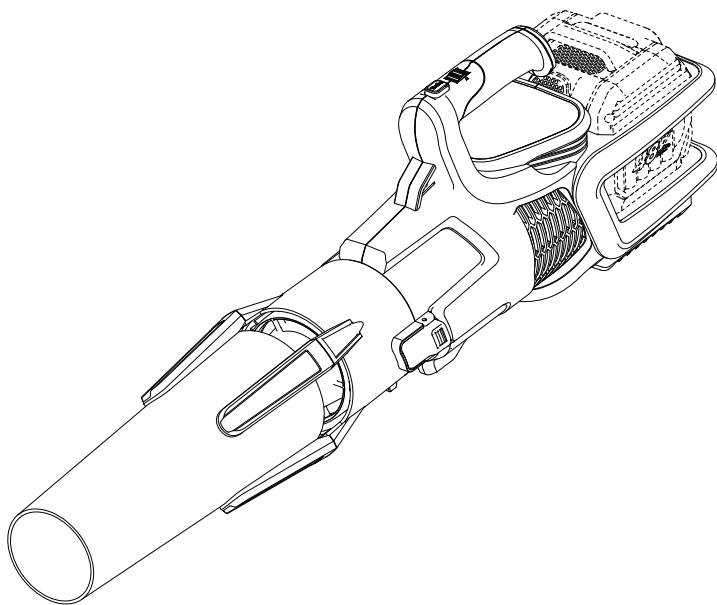

### **IMPORTANT:**

Read and follow all safety rules and operating instructions before using this product.

**Instruction  
Manual**



For problems or questions, **DO NOT RETURN TO STORE.** Please contact one of our Customer Service Agents who would be happy to assist you.

For Customer Assistance Please Call:



**CANADA: 1.866.523.5218**

Introduction	4
Safety Instructions and Symbols	5
Product Specifications	10
Product Diagram	11
Assembly	12
Operation	13
Maintenance	18
Storage	18
Troubleshooting	19
Exploded View	20
Parts List	21
Warranty	22



**Please do not operate garden equipment near children. This could lead to severe injury or death.**

**INTRODUCTION**

Congratulations on your purchase of your new Yardworks<sup>®</sup> tool. It has been designed, engineered and manufactured to give you the best possible dependability and performance.

Should you experience any problem you cannot easily remedy, please contact our Yardworks<sup>®</sup> customer service line at 1.866.523.5218.

PLEASE READ AND RETAIN THIS INSTRUCTION MANUAL. These instructions will enable you to assemble and maintain your appliance properly. ALWAYS observe the "SAFETY RULES".

The instruction manual was designed to conveniently help you get your purchase ready to use so there's less risk of damaging it and to provide you with enough information for you to get familiar with your product's controls and features and to operate it safely.

**SAFETY FIRST**



**CAUTION: The operation of lawn equipment can result in foreign objects thrown into the eyes, which can result in SEVERE EYE INJURY. ALWAYS wear safety glasses or eye shields while operating your lawn equipment or performing any adjustments or repairs. We recommend standard safety glasses or a wide vision safety mask worn over spectacles.**



Please read this manual carefully and make sure you understand the instructions before using the machine.

Model number: \_\_\_\_\_

Serial number: \_\_\_\_\_

Date of purchase (MM/DD/YYYY): \_\_\_\_\_

Notes: \_\_\_\_\_

\_\_\_\_\_  
\_\_\_\_\_  
\_\_\_\_\_  
\_\_\_\_\_  
\_\_\_\_\_

## FOR ALL APPLIANCES

- Avoid dangerous environments — do not use appliances in damp or wet locations.
- Don't use in rain.
- Keep children away — all people and pets should be kept at a distance from the work area.
- Dress properly — do not wear loose clothing or jewellery. They can be caught in moving parts. Wear protective clothing; use of work gloves, long pants, a long-sleeved shirt and safety footwear is recommended when working outdoors. Wear protective hair covering to contain long hair.
- Use safety glasses — always use face or dust mask if the area in which you are working is dusty.
- Use the right appliance — do not use appliance for any job except that for which it is intended.
- Do not force appliance — it will do the job better and with less likelihood of a risk of injury at the rate for which it was designed.
- Do not overreach — keep proper footing and balance at all times.
- Stay alert. Use common sense. Do not operate appliance when you are tired or under the influence of drugs, alcohol or medication.
- When not in use, appliances should be stored indoors in dry places out of reach of children.
- Maintain appliance with care. Follow instructions for lubricating and changing accessories. Keep handles dry, clean, and free from oil and grease.
- Check damaged parts. Before using the appliance, make sure the safety guards are intact. Never use a tool without its

safety guard. Check the alignment of the moving parts, the binding of the moving parts. Check for broken or defective parts that can affect the safe operation of your tool. A guard or other part that is damaged should be properly repaired or replaced by an authorized service centre unless indicated elsewhere in this manual.

## 1. FOR ALL BATTERY-OPERATED GARDENING APPLIANCES:

1. Prevent unintentional starting. Ensure the switch is in the off position before connecting to battery pack, picking up or carrying the appliance. Carrying the appliance with your finger on the switch or energizing appliance that has the switch on invites accidents.
2. Disconnect the battery pack from the appliance before making any adjustments, changing accessories, or storing appliance. Such preventive safety measures reduce the risk of starting the appliance accidentally.
3. Recharge only with the charger specified by the manufacturer. A charger that is suitable for one type of battery pack may create a risk of fire when used with another battery pack.
4. Use appliances only with specifically designated battery packs. Use of any other battery packs may create a risk of injury and fire.
5. When battery pack is not in use, keep it away from other metal objects, like paper clips, coins, keys, nails, screws or other small metal objects, that can make a connection from one terminal to another. Shorting the battery terminals together may cause burns or a fire.
6. Under abusive conditions, liquid may be



**WARNING:** Read all safety warnings and all instructions. *Failure to follow the warnings and instructions may result in electric shock, fire and/or serious injury.*

ejected from the battery; avoid contact. If contact accidentally occurs, flush with water. If liquid contacts eyes, seek additional medical help. Liquid ejected from the battery may cause irritation or burns.

7. Do not use a battery pack or appliance that is damaged or modified. Damaged or modified batteries may exhibit unpredictable behaviour resulting in fire, explosion or risk of injury.
8. Do not expose a battery pack or appliance to fire or excessive temperature. Exposure to fire or temperature above 130°C ( 265°F) may cause an explosion.
9. Follow all charging instructions and do not charge the battery pack or appliance outside of the temperature range specified in the instructions. Charging improperly or at temperatures outside of the specified range may damage the battery and increase the risk of fire.
10. Have servicing performed by a qualified repair person using only identical replacement parts. This will ensure that the safety of the product is maintained.
11. Do not modify or attempt to repair the appliance or the battery pack (as applicable) except as indicated in the instructions for use and care.

### ADDITIONAL SAFETY WARNINGS IMPORTANT SAFETY INSTRUCTIONS

When using an electrical appliance, basic precautions should always be followed, including the following:

#### READ ALL INSTRUCTIONS BEFORE USING THIS APPLIANCE

**WARNING** – To reduce the risk of fire, electric shock, or injury:

1. To reduce the risk of electric shock – Do not use on wet surfaces. Do not expose to rain. Store indoors.
2. Do not allow to be used as a toy. Close attention is necessary when used by or near children.
3. Use only as described in this manual. Use only manufacturer's recommended attachments.
4. If appliance is not working as it should, has been dropped, damaged, left outdoors, or dropped into water, return it to a service centre.
5. Keep hair, loose clothing, fingers, and all parts of body away from openings and moving parts.
6. Do not charge the unit outdoors.
7. Use only the charger supplied by the manufacturer to recharge.
8. Do not incinerate the appliance even if it is severely damaged. The batteries can explode in a fire.
9. Do not put any object into openings. Do not use with any opening blocked; keep free of dust, lint, hair, and anything that may reduce airflow.
10. Do not handle plug or appliance with wet hands.
11. Do not leave appliance when plugged in. Unplug from outlet when not in use and before servicing.
12. Turn off all controls before unplugging.
13. Use extra care when cleaning on stairs.



**WARNING: Read all safety warnings and instructions. Failure to follow the warnings and instructions may result in electric shock, fire and/or serious injury.**

**SAFETY WARNINGS FOR BATTERY PACK**

- a) Do not dismantle, open or shred cells or battery pack.
- b) Do not expose battery pack to heat or fire. Avoid storage in direct sunlight.
- c) Do not short-circuit a battery pack. Do not store battery packs haphazardly in a box or drawer where they may short-circuit each other or be short-circuited by conductive materials. When battery pack is not in use, keep it away from other metal objects, like paper clips, coins, keys, nails, screws or other small metal objects, that can make a connection from one terminal to another. Shorting the battery terminals together may cause burns or a fire.
- d) Do not remove battery pack from its original packaging until required for use.
- e) Do not subject battery pack to mechanical shock.
- f) In the event of battery leaking, do not allow the liquid to come into contact with the skin or eyes. If contact has been made, wash the affected area with copious amounts of water and seek medical advice.
- g) Observe the plus (+) and minus (-) marks on the battery back and equipment and ensure correct use.
- h) Do not use any battery pack which is not designed for use with the equipment.
- i) Keep battery pack out of the reach of children.
- j) Seek medical advice immediately if a cell or battery pack has been swallowed.
- k) Always purchase the battery pack recommended by the device manufacturer for the equipment.
- l) Keep battery pack clean and dry.
- m) Wipe the battery pack terminals with a clean, dry cloth if they become dirty.
- n) Battery pack needs to be charged before use. Always use the correct charger and refer to the manufacturer's instructions or equipment manual for proper charging instructions.
- o) Do not leave battery pack on prolonged charge when not in use.
- p) After extended periods of storage, it may be necessary to charge and discharge the battery pack several times to obtain maximum performance.
- q) Battery pack gives its best performance when it is operated at normal room temperature (20°C ± 5°C/68°F ± 9°F).
- r) When disposing of battery packs, keep battery packs of different electrochemical systems separate from each other.
- s) Recharge only with the charger specified by Yardworks<sup>®</sup>. Do not use any charger other than that specifically provided for use with the equipment. A charger that is suitable for one type of battery pack may create a risk of fire when used with another battery pack.
- t) Retain the original product literature for future reference.
- u) Use only the battery pack in the application for which it was intended.
- v) Remove the battery from the equipment when not in use.
- w) Dispose of properly.

**SAVE THESE INSTRUCTIONS!**

**Information for radiated emission**

This device complies with Canadian ICES-001.

This device complies with Part 15 of the FCC Rules.

Operation is subject to the following two conditions:

- (1) This device may not cause harmful interference, and
- (2) This device must accept any interference received, including interference that may cause undesired operation.

**NOTE:** This equipment has been tested and found to comply with the limits for a Class B digital device, pursuant to Part 15 of the FCC Rules.

These limits are designed to provide reasonable protection against harmful interference in a residential installation. This equipment generates, uses and can radiate radio frequency energy and, if not installed and used in accordance with the instructions, may cause harmful interference to radio communications.

However, there is no guarantee that interference will not occur in a particular installation. If this equipment does cause harmful interference to radio or television reception, which can be determined by turning the equipment off and on, the user is encouraged to try to correct the interference by one or more of the following measures:

- Reorient or relocate the receiving antenna.
- Increase the separation between the equipment and receiver.
- Connect the equipment into an outlet on a circuit different from that to which the receiver is connected.







**WARNING:** Changes or modifications to this unit not expressly approved by the party responsible for compliance could void the user's authority to operate the equipment.



model no. 060-3095-2 | contact us: 1.866.523.5218

Some of the following symbols may be used on this product. Please study them and learn their meaning. Proper interpretation of these symbols will allow you to operate the product effectively and safely.

Symbol	Designation/Explanation
	To reduce the risk of injury, user must read instruction manual.
	Wear ear protection.
	Do not burn.
 <b>call2recycle</b>	Yardworks <sup>®</sup> CANADA has established a partnership with the RBRC Corporation to recycle any Yardworks <sup>®</sup> batteries with the RBRC-call2recycle seal. For environmental protection, please do not discard batteries in the trash. After the battery's life cycle is ended, please call 1-800-822-8837 for a free service that will properly dispose of the battery.

**SAVE THESE INSTRUCTIONS!**





**PRODUCT SPECIFICATIONS**

Rated voltage	48 V 
Air speed	Turbo: 110 MPH (177 km/h)
Air volume	Turbo: 700 CFM (19.8 m <sup>3</sup> /min)
Machine weight	7 lb 3 oz (3.3 Kg)

**SUITABLE BATTERY PACKS**

Item number	060-1987-2	ABP4830SH	060-1988-0	ABP4850SH	060-1989-8
Battery capacity	2.0 Ah	3.0 Ah	4.0 Ah	5.0 Ah	6.0 Ah
	Not included	Not included	Not included	Not included	Not included

**SUITABLE CHARGERS**

Item number	060-1990-2	060-1992-8
Charger input	120 V~, 60 Hz, 110 W	120 V~, 60 Hz, 320 W
Charger output	48 V  , 2 A	48 V  , 6 A
Charger protection class	 /II	 /II
	Not included	Not included

model no. 060-3095-2 | contact us: 1.866.523.5218

1. Turbo button
2. On/off switch with variable speed control
3. Handle
4. Battery pack (not included)
5. Motor housing
6. Tube release button
7. Aeroforce tube
8. Battery pack release button (not included)

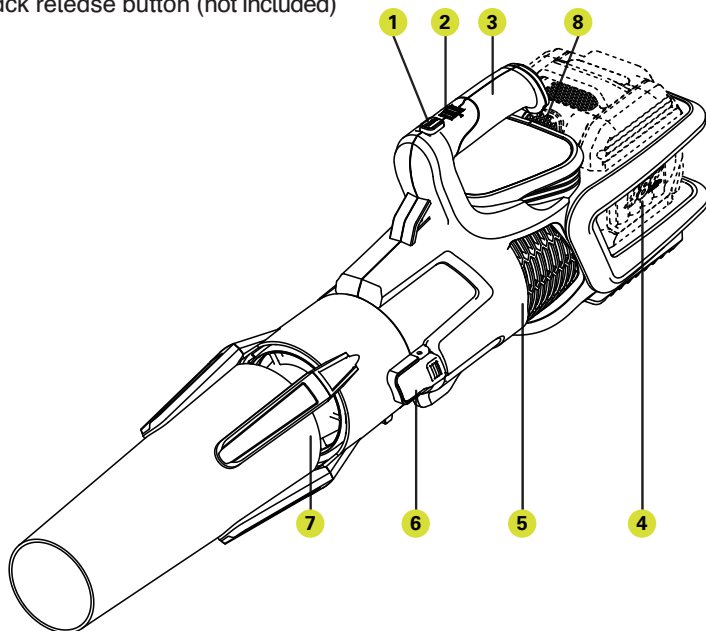

We recommend that you purchase your accessories from the same store that sold you the tool. Refer to the accessory packaging for further details. Store personnel can assist you and offer advice.



**NOTE:** Before using the tool, read the instruction book carefully.

## ASSEMBLY

### 1. ASSEMBLING AND REMOVING THE BLOWER TUBE (SEE FIG. A1)

#### - ASSEMBLING

Before assembling the blower tube, be sure the on/off switch is in "O" Off position. Insert the blower tube directly to the motor housing as shown in Fig. A1. Be sure to align the tube release button with the buckle on the motor housing. Check to see if the blower tube is firmly secured.

#### - REMOVING (SEE FIG. A2)

Before disassembling the blower tube, be sure the on/off switch is in "O" Off position. Press the tube release button, so that you can separate the tube. Pull the blower tube out from the motor housing. Do not try to separate the tubes by force or by using tools.

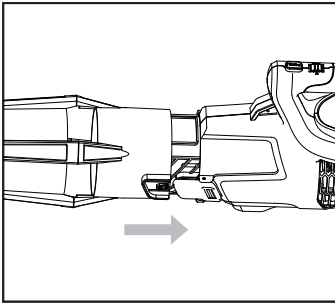

A1

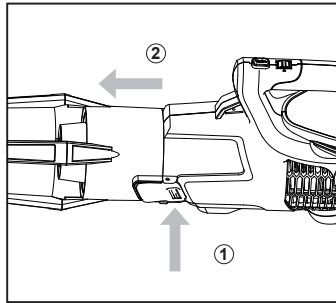

A2



**WARNING:** Remove the battery pack before any work on the tool.



**WARNING!** Do not attempt to assemble or remove the tube by any means other than the normal.

**OPERATION****BEFORE PUTTING INTO OPERATION****1. CHARGING THE BATTERY (SEE FIG. B)**

- The battery pack (not included) must be fully charged before first use.
- If the battery pack is very hot you must remove your battery pack from the charger and allow your battery pack to cool first to ambient temperature and then recharging can be started.
- To prevent damage to the battery pack, when charge runs out, please charge the battery to reach full or no less than half charge before storage.
- If the tool will not be used for long periods of time, charge the battery pack every 3-6 months.

**CHARGING PROCEDURE**

- Plug the charger (not included) into an appropriate outlet.
- Slide the battery pack into the charger, and make sure the battery is in the correct charge position firmly. The light will begin flashing green to indicate the charging process has started.
- When charging is completed, the light will turn solid green.
- After the battery is fully charged, unplug the charger and remove the battery pack.

**NOTE:** If the battery pack is locked in the charger, press the battery pack release button and remove it.

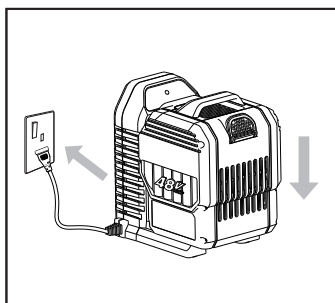
**B**







**WARNING!** The charger and battery pack are specially designed to work together so do not attempt to use any other devices. Never insert or allow metallic objects into your charger or battery pack connections because an electrical failure and hazard will occur.



**WARNING:** When battery charge runs out after continuous use or exposure to direct sunlight or heat, allow time for the tool to cool down before re-charging to achieve the full charge.

### CHARGING INDICATOR

This charger is designed to detect some problems that can arise with battery packs. Indicator lights indicate problems (see table below).

Light	ON/ Flash	Status
Red on ● 	————	Defective Battery
Red flash  	.....	Battery Temperature Protection. The temperature of battery pack is less than 0°C (32°F) or more than 40°C (104°F).
Green on ●  	————	Fully Charged
Green flash  	.....	Charging

## 2. REMOVING AND INSTALLING THE BATTERY PACK (SEE FIG. C1, C2)

### 1) REMOVING

Depress the battery pack release button firmly first and then lift the battery pack up to remove from your tool.

### 2) INSTALLING

Place the fully charged battery pack into the tool until it clicks into position.

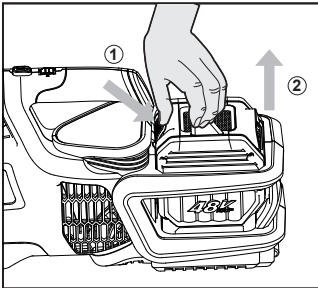

C1

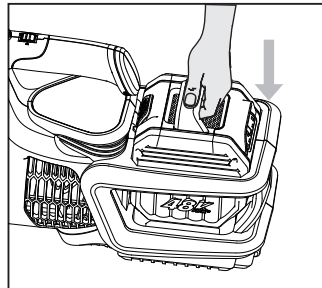

C2

### 3. STARTING AND STOPPING (SEE FIG. D)

#### - STARTING

Move the on/off switch forward to the “I” position.

#### - STOPPING

Move the on/off switch backward to the “O” position.

#### - VARIABLE SPEED CONTROL

The on/off switch with variable speed (2) controls the airflow. The airflow can be adjusted from the minimum to maximum by pushing the on/off switch forward. The airflow increases when the on/off switch is pushed forward gradually.

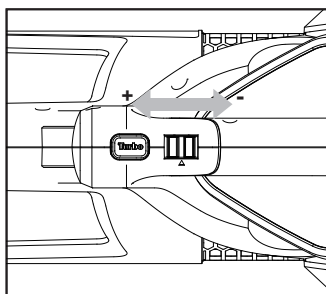

D



**WARNING!** The tool runs for a few seconds after it has been switched off. Let the motor come to a complete standstill before setting the tool down.

#### 4. USING THE BLOWER (SEE FIG. E1, E2)

The blower is intended for residential use only. Use the blower outdoors to move debris from hard surfaces.

Adjust the airflow by adjusting the on/off switch to use in different working conditions.

#### USER TIPS

- Hold the blower tube approximately 8" (20 cm) above the ground when operating the tool.
- Use a sweeping motion from side to side. Advance slowly keeping the accumulated debris/leaves in front of you.

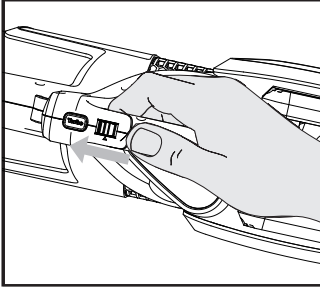

E1

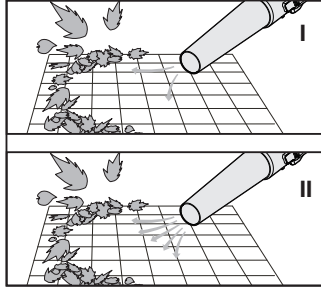

E2



#### CAUTION!

- Do not blow hard objects such as nails, bolts, or rocks.
- Do not operate the blower near bystanders or pets.
- Use extra care when cleaning debris from stairs or other tight areas.
- Wear safety goggles or other suitable eye protection, long pants, and close-toed shoes.



### 5. TURBO BUTTON FOR POWER BOOSTING (SEE FIG. F)

Turbo button can increase airflow significantly, and it can be used for clearing heavy or wet debris.

To use the turbo button, first switch on the blower, push the on/off switch forward to select any speed control, then depress the turbo button and hold it.

Release the turbo button and the blower will return to the previously selected speed.

**NOTE:** It is recommended to use ordinary blowing speed to blow debris/leaves on hard surfaces, while using turbo button to blow debris/leaves within the lawn.

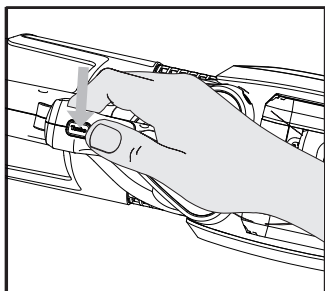

F

Remove the battery pack before carrying out any adjustment, servicing or maintenance. There are no user-serviceable parts in your blower. Keep the motor ventilation slots clean. Keep all working controls free of dust.

#### **CLEANING THE TOOL**

Clean the tool regularly.

#### **FOR BATTERY TOOLS**

The ambient temperature range for the use and storage of tool and battery is 0 — 45°C (32 — 113°F).

The recommended ambient temperature range for the charging system during charging is 0 — 40°C (32 — 104°F).

It is recommended that the battery be stored indoors for the winter months.

Remove the battery pack and disassemble the blower by removing the blower tube. Store the blower and the battery pack indoors, in a cool, dry, clean place which is protected from the effects of weather and temperature and is out of the reach of children and animals.



**WARNING! Keep your product dry. Under no circumstances spray with water**

- To clean the tool, use only mild soap and a damp cloth.
- Do not use any type of detergent, cleaner or solvent which may contain chemicals that could seriously damage the plastic.
- Self lubricating bearings are used in your product, therefore lubrication is not required.



model no. 060-3095-2 | contact us: 1.866.523.5218

The following table gives checks and actions that you can perform if your machine does not operate correctly. If these do not identify/remedy the problem, contact Yardworks® at 1.866.523.5218.

Symptom	Possible Causes	Solution
The blower does not start	Defective motor or on/off switch	Contact Yardworks® at 1.866.523.5218.
The blower suddenly stops during operation	Overload and battery temperature too high	Relieve the load on the machine immediately and allow cooling for approx. 30 seconds by running the machine on no-load
	Low battery capacity	Charge the battery pack

Exploded View

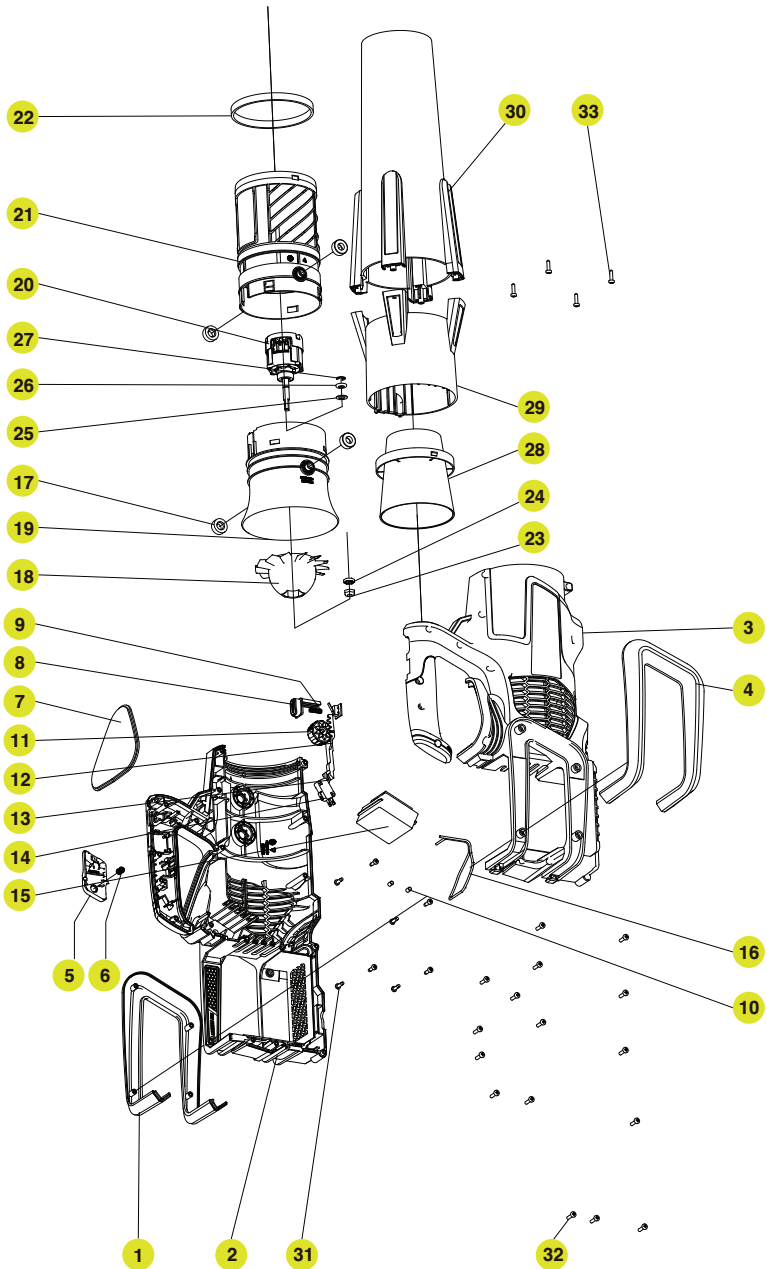

model no. 060-3095-2 | contact us: 1.866.523.5218

Item	Description	QTY.
1	Left Decorative Cover	1
2	Left Housing	1
3	Right Housing	1
4	Right Decorative Cover	1
5	Button Set	1
6	Compression Spring	1
7	Cover	1
8	Button Set	1
9	Spring	1
10	Rubber	2
11	Trigger	1
12	Slide Gear	1
13	Linkage	1
14	Switch Assembly	1
15	Control Board	1
16	Torsional Spring	1
17	Rubber Ring	4
18	Fan	1
19	Bracket	1
20	Motor	1
21	Baffle	1
22	Rubber Sheath	1
23	Nut M8	1
24	Roller Plate	1
25	Washer	1
26	Washer	1
27	Ringent Washer	1
28	Cover	1
29	Tube	1
30	Tube I	1
31	Self-tapping Screw	8
32	Screws	16
33	Self-tapping Screw	4

### FIVE-YEAR LIMITED WARRANTY

For FIVE (5) years from the date of purchase within Canada, YARDWORKS CANADA will, at its option, repair or replace for the original purchaser, free of charge, any part or parts found to be defective in material or workmanship (excludes battery).

For THREE (3) years from the date of purchase within Canada, YARDWORKS CANADA will, at its option, repair or replace for the original purchaser, free of charge, any battery found to be defective in material or workmanship.

### THIS WARRANTY DOES NOT COVER

1. Any part that has become inoperative due to misuse, commercial use, abuse, neglect, accident, improper maintenance, or alteration;
2. The unit, if it has not been operated and/or maintained in accordance with the owner's manual;
3. Normal wear, except as noted below;
4. Routine maintenance items such as lubricants, blade sharpening; or
5. Normal deterioration of the exterior finish due to use or exposure.

### FULL ONE YEAR (365) DAYS WARRANTY ON NORMAL WEAR PARTS

Normal wear parts are defined as blade adaptors, blades, grass bags and tires. These parts are warranted to the original purchaser to be free from defects in material and workmanship for a period of three hundred sixty-five (365) days from the date of retail purchase.

Made in China. Imported by Yardworks Canada  
Toronto, Canada M4S 2B8

### HOW TO OBTAIN SERVICE

Warranty service is available by calling the toll-free helpline at 1.866.523.5218. The factory will not accept the return of a complete unit unless prior written permission has been extended by YARDWORKS CANADA.

### TRANSPORTATION CHARGES

Transportation charges for the movement of any power equipment unit or attachment are the responsibility of the purchaser. The purchaser must pay transportation charges for any part submitted for replacement under this warranty unless such return is requested in writing by YARDWORKS CANADA.

### OTHER WARRANTIES

All other warranties, express or implied, including any implied warranty of merchantability is limited in its duration to that set forth in this express limited warranty. The provisions as set forth in this warranty provide the sole and exclusive remedy of YARDWORKS CANADA obligations arising from the sale of its products.



**Always remove or disconnect the battery pack before adjusting, cleaning, servicing or transporting your appliance.**







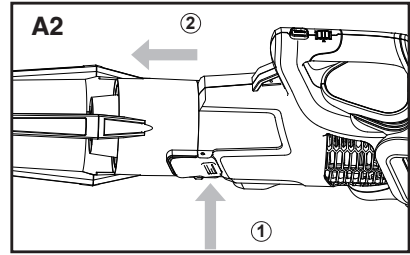
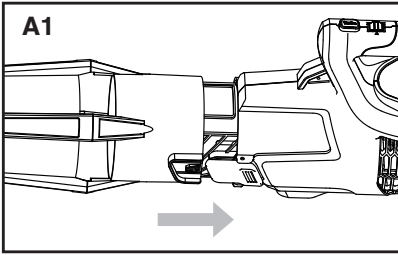
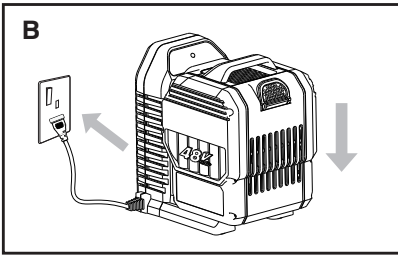
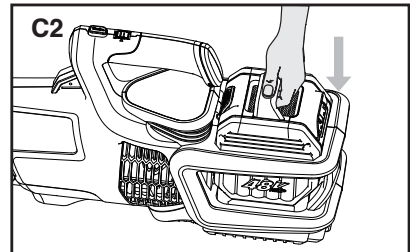
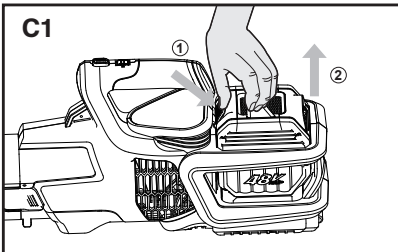

**ASSEMBLY**
**ASSEMBLING AND REMOVING THE BLOWER TUBE**

**OPERATION**
**1. CHARGING THE BATTERY (not included) (SEE FIG. B)**

**2. REMOVING AND INSTALLING THE BATTERY PACK(not included) (SEE FIG. C1, C2)**

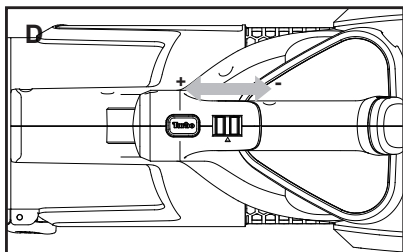
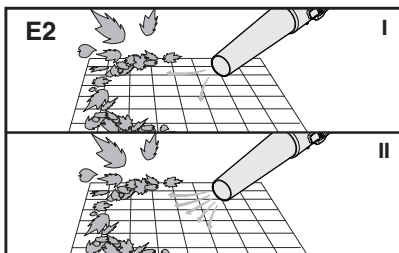
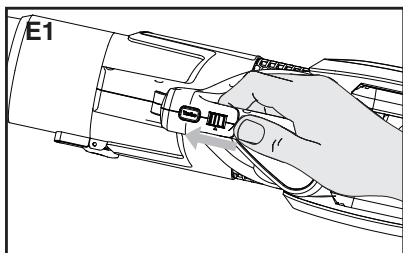
\* This information is provided for your convenience. It does not replace the instruction manual and safety instructions. The manual and safety instructions need to be read and understood in their entirety.

**BRUSHLESS BLOWER WITH AERO FORCE TECHNOLOGY®**

Item # 060-3095-2 | contact us: 1.866.523.5218

**3. STARTING AND STOPPING (SEE FIG. D)**

**4. USING THE BLOWER (SEE FIG. E1, E2)**

**5. TURBO BUTTON (SEE FIG. F)**

To use turbo button, first switch on the blower and select a speed, then depress the turbo button and hold it.

Release the turbo button and the blower will return to the previously selected speed.

