



# YARDWORKS<sup>®/MD</sup>

## Grass Trimmer

model number 060-2365-6 | contact us: 1.866.523.5218



**Intertek**  
**3025736**

Certified to CSA Std. C22.2

No. 147

Conforms to UL Std. 82

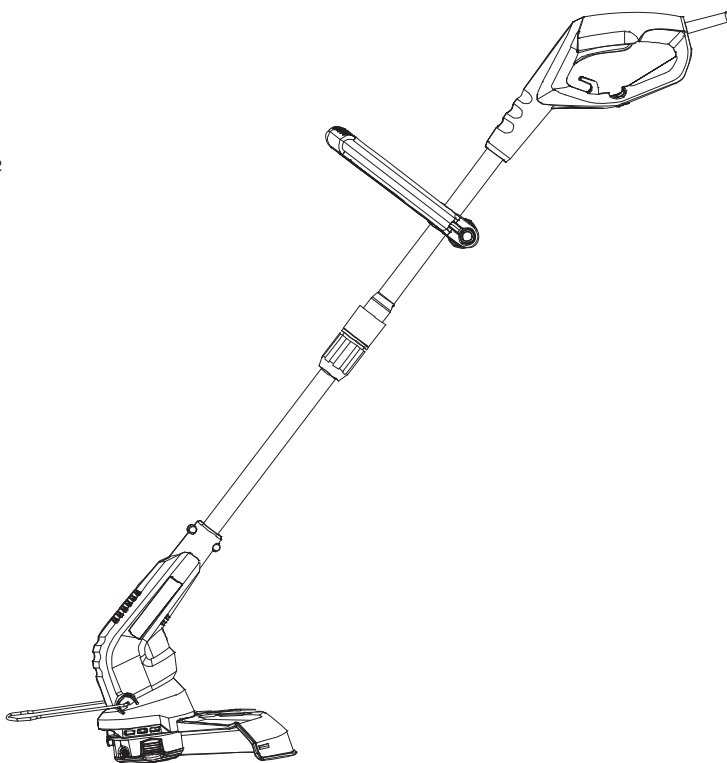

### **IMPORTANT:**

Read and follow all safety rules and operating instructions before using this product.

**Instruction  
Manual**



For problems or questions, **DO**  
**NOT RETURN TO STORE.** Please  
contact one of our Customer  
Service Agents who would be  
happy to assist you.

For Customer Assistance Please Call:



**CANADA: 1-866-523-5218**

model number 060-2365-6 | contact us: 1.866.523.5218

Technical Specifications	3
General Safety Rules	4
Know Your Grass Trimmer	7
Accessories	7
Exploded View	8
Parts List	9
Assembly & Operation	10
Maintenance	15
Symbols	16
Warranty	17

## TECHNICAL SPECIFICATIONS

Voltage	120 V~ 60 Hz
Rated Current	5 A
No Load Speed	8000/min
Cutting Diameter	14" (35.56 cm)
Line Diameter	0.065" (1.65 mm)
Line Length	2x16' (2x4.9 m)
Machine Weight	5 lb (2.3 kg)
Protection class	 /II

**FOR ALL APPLIANCES**

- Avoid Dangerous Environment - Don't use appliances in damp or wet locations.
  - Don't Use In Rain.
  - Keep Children Away - All visitors should be kept at a distance from work area.
  - Dress Properly - Do not wear loose clothing or jewellery. They can be caught in moving parts. Use of rubber gloves and substantial footwear is recommended when working outdoors. Wear protective hair covering to contain long hair.
  - Use Safety Glasses - Always use face or dust mask if operation is dusty.
  - Use Right Appliance - Do not use appliance for any job except that for which it is intended.
  - Ground Fault Circuit Interrupter (GFCI) protection should be provided on the circuit(s) or outlet(s) to be used for the gardening appliance. Receptacles are available having built-in GFCI protection and may be used for this measure of safety.
  - Warning -To reduce the risk of electric shock, use only with an extension cord intended for outdoor use, such as an extension cord of cord type SW-A, SOW-A, STW-A, STOW-A, SJW-A, SJOW-A, SJTW-A. or SJTOW-A.
  - Extension Cord - Make sure your extension cord is in good condition.
- When using an extension cord, be sure to use one heavy enough to carry the current your product will draw. An undersized extension cord will cause a drop in line voltage resulting in loss of power and overheating. Table 1 shows the correct size to use depending on cord length and nameplate ampere rating. If in doubt, use the next heavier gauge. The smaller the gauge number, the heavier the cord. To reduce the risk of disconnection of appliance cord from the extension cord during operating:
- Make a knot as shown in Figure 1 ; or
  - ii) Use one of the plug-receptacle retaining straps or connectors described in this manual.
  - Avoid Unintentional Starting - Don't carry plugged-in appliance with finger on switch. Be sure switch is off when plugging in.
  - Don't Abuse Cord - Never carry appliance by cord or yank it to disconnect from receptacle. Keep cord from heat, oil, and sharp edges.
  - Don't Force Appliance - It will do the job better and with less likelihood of a risk of injury at the rate for which it was designed.
  - Don't Overreach - Keep proper footing and balance at all times.
  - Stay Alert - Watch what you are doing. Use common sense. Do not operate appliance when you are tired.



**WARNING:** When using electric gardening appliances, basic safety precautions should always be followed to reduce the risk of fire, electric shock, and personal injury.



**WARNING:** Read all instructions.

- **Disconnect Appliance** - Disconnect the appliance from the power supply when not in use, before servicing, when changing accessories such as blades, and the like.
- **Store Idle Appliances Indoors** - When not in use, appliances should be stored indoors in dry and high or locked-up place - out of reach of children.
- **Maintain Appliance With Care** - Keep cutting edge sharp and clean for best performance and to reduce the risk of injury. Follow instructions for lubricating and changing accessories. Inspect appliance cord periodically, and if damaged, have it repaired by an authorized service facility. Inspect extension cords periodically and replace if damaged. Keep handles dry, clean, and free from oil and grease.
- **Check Damaged Parts** - Before further use of the appliance, a guard or other part that is damaged should be carefully checked to determine that it will operate properly and perform its intended function. Check for alignment of moving parts, binding of moving parts, breakage of parts, mounting, and any other condition that may affect its operation. A guard or other part that is damaged should be properly repaired or replaced by an authorized service centre unless indicated elsewhere in this manual.

Volts	Total length of cord			
	25' (7.6 m)	50' (15.2 m)	100' (30.5 m)	150' (45.7 m)
Ampere rating more than not more than	AWG			
0-6	18	16	16	14
6-10	18	16	14	12
10-12	16	16	14	12
12-16	14	12	Not recommended	

**Figure 1**  
**Method of securing extension cord**

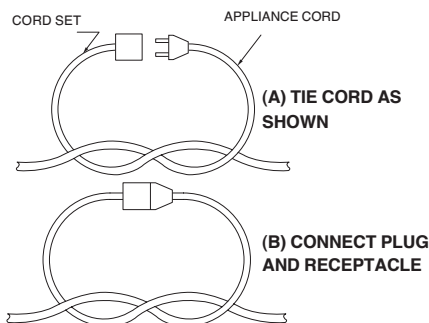

**FOR ALL DOUBLE-INSULATED APPLIANCES**



**WARNING:** Read all safety warnings and instructions. Failure to follow the warnings and instructions may result in electric shock, fire and/or serious injury.

- **Replacement Parts**  
When servicing use only identical replacement parts.
- **Polarized Appliance Connections**  
To reduce the risk of electric shock, this appliance has a polarized plug (one blade is wider than the other) and will require the use of a polarized extension cord. The appliance plug will fit into a polarized extension cord only one way. If the plug does not fit fully into the extension cord, reverse the plug. If the plug still does not fit, obtain a correct polarized extension cord. A polarized extension cord will require the use of a polarized wall outlet. This plug will fit into the polarized wall outlet only one way. If the plug does not fit fully into the wall outlet, reverse the plug. If the plug still does not fit, contact a qualified electrician to install the proper wall outlet. Do not change the equipment plug, extension cord receptacle, or extension cord plug in any way.

**SAVE THESE INSTRUCTIONS****ADDITIONAL SAFETY RULES FOR LAWN TRIMMER AND EDGE TRIMMER**

1. Keep guards in place and in working order.
2. Do not use this product without the guard being fitted.
3. Keep hands and feet away from cutting area.
4. Do not use heavier lines than recommended in this manual.
5. Do not use line materials of other types – for example, metal wire, rope, and the like.

**SAVE THESE INSTRUCTIONS!**

model number 060-2365-6 | contact us: 1.866.523.5218

- |                            |                          |
|----------------------------|--------------------------|
| 1. Auxiliary Handle        | 5. Cutting Head Assembly |
| 2. On/Off Switch           | 6. Flower Guard          |
| 3. Extension Cord Retainer | 7. Line Cutter           |
| 4. Safety Guard            |                          |

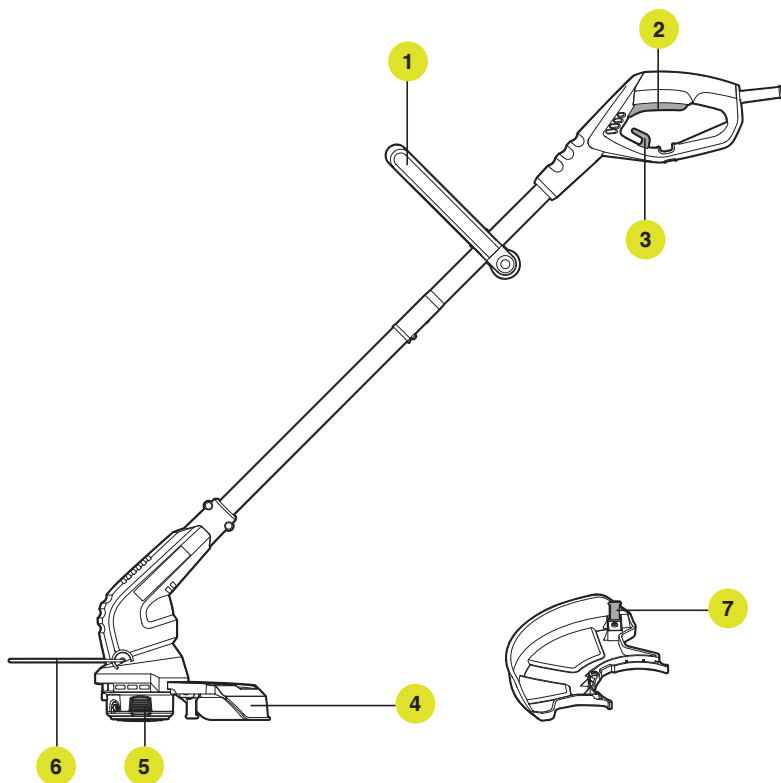

Safety guard	1
Flower guard	1
Auxiliary handle	1

model number 060-2365-6 | contact us: 1.866.523.5218

Exploded View

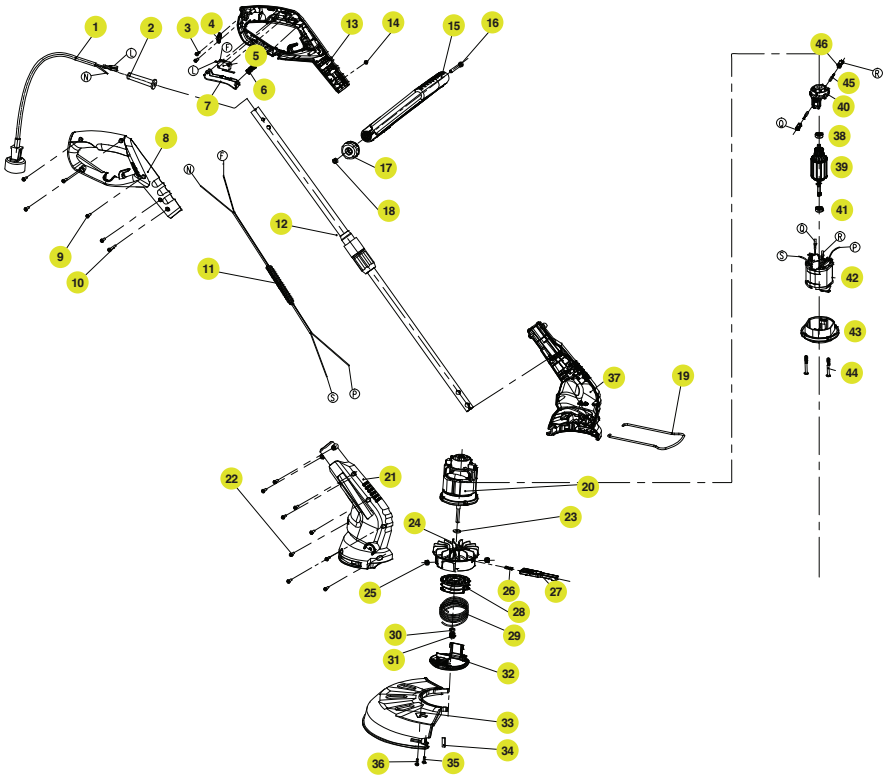



model number 060-2365-6 | contact us: 1.866.523.5218

Item	Description	QTY.
1	Power Cord	1
2	Cable Protector	1
3	Self Tapping Screw	2
4	Cord Clamp	1
5	Switch	1
6	Compression Spring	1
7	Trigger	1
8	Right Handle	1
9	B-Self Tapping Screw	5
10	Self Tapping Screw	1
11	Coiled Cable	1
12	Tube	1
13	Left Handle	1
14	Nut	1
15	Self Tapping Screw	1
16	Handle	1
17	Knob	1
18	Nut	1
19	Flower guard wire	1
20	Motor	1
21	Right Housing	1
22	B-Self Tapping Screw	9
23	Washer	1
24	Blower	1
25	Rivet	2
26	Compression Spring	1
27	Line Feeder	1
28	Winding Spool	1
29	Cutting Line	1
30	Nut	1
31	Insulation Cap	1
32	Cutting Head Cover	1
33	Guard	1
34	Cutting Blade	1

35	B-Self Tapping Screw	1
36	B-Self Tapping Screw	1
37	Left Housing	1
38	Ball Bearing 607	1
39	Rotor	1
40	Brush Holder	1
41	Ball Bearing 608	1
42	Stator	1
43	Front Bracket	1
44	Screw	2
45	Carbon Brush Assembly	2
46	Brush Holder Bush	2

## ASSEMBLY AND OPERATION

### 1. FITTING THE GUARD (See Fig. A)

Attach the safety guard to the trimmer head. Align the guard so it slides into the slots located on the trimmer head. Turn the tool over and secure the safety guard onto the trimmer head with the screw (a) provided.

### 2. FITTING THE FLOWER GUARD (See Fig. B)

Attach the flower guard to the trimmer head. Align the guard so it slides into the holes located on the trimmer head.

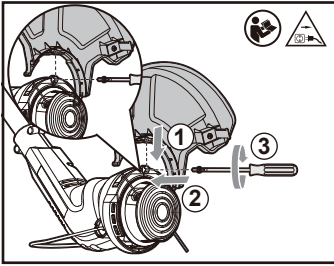

A

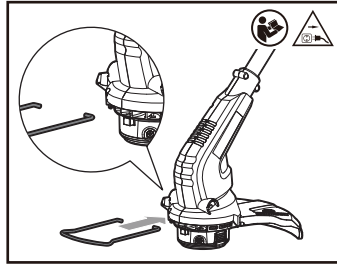

B

### 3. ATTACHING THE HANDLE (Fig. C)

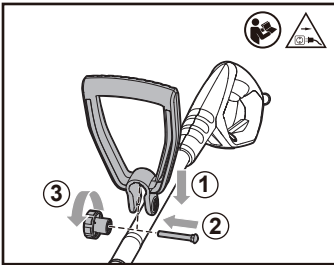

C

### 4. ADJUSTING THE HEIGHT (Fig. D)

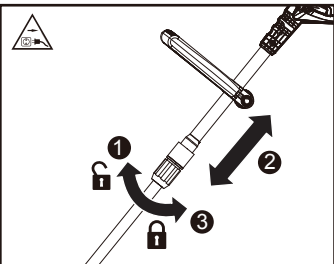

D

model number 060-2365-6 | contact us: 1.866.523.5218

#### ADJUSTING THE ANGLE (Fig. F)

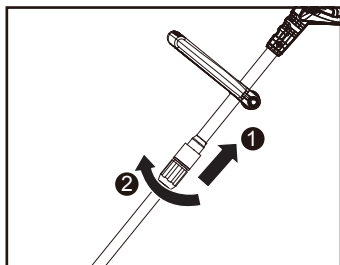

F

#### 5. MAINS SUPPLY CABLE STRAIN RELIEF (SEE FIG. D1 D2)

In order to reduce strain on the cable inlet, form a loop and locate the cable around the strain relief arm.

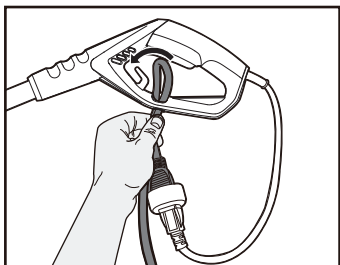

D1

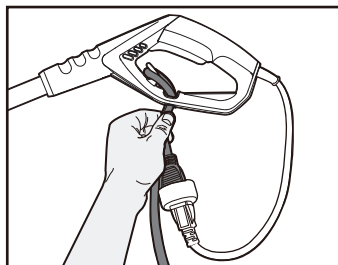

D2

6. Take great care when doing this as the guard has a very sharp cutting edge.  
(See Fig. E)

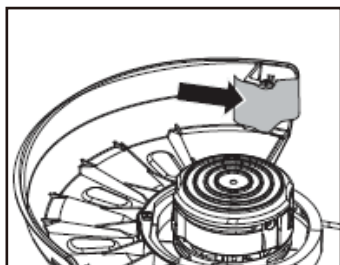

E

model number 060-2365-6 | contact us: 1.866.523.5218

## 7. MANUALLY FEEDING THE LINE (Fig. F)

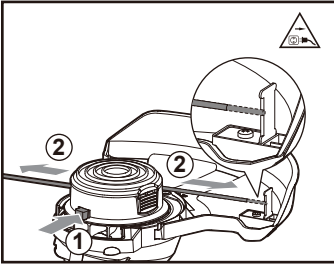

F

### Replacing spool & replacing line

#### To remove the cap

Press and hold in the two latches. (See Fig. H1-H3)

Pull cap away from the spool holder. When refitting the spool cap keep all areas of the cap and spool holder clean.

Replace the cap, pressing firmly down towards the spool holder to ensure cap is fully located.

Check that the cap is correctly fitted by trying to remove it without depressing the two latches.

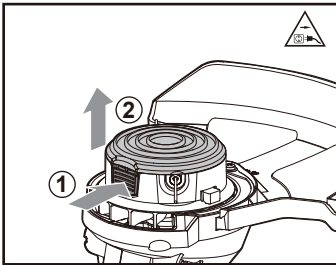

H1

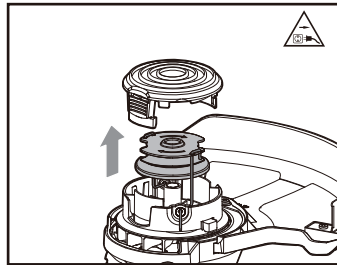

H2

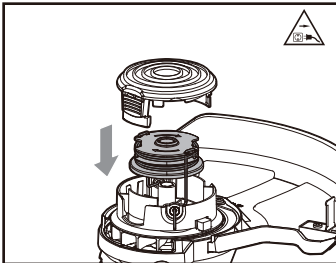

H3

model number 060-2365-6 | contact us: 1.866.523.5218

### 8. TRIMMING (Fig. I)

To switch on the trimmer, If you find that the nylon line is too short follow the instruction as in 'Automatic line feed system' or "To manually feed the line". Hold the bottom of the trimmer head about just above the ground and at a slight angle. Allow only the tip of line to make contact with the grass. Let the trimmer line work at its own pace. Do not force trimmer line into work area.



I

### Edging (Fig. J)

Change the tool from trimming to edging mode push the handle rotation locking button downward and rotate the main handle 90°. While edging, only allow the tip of the line to make contact with area being worked. Do not force the line. The edging wheels help protect the unit and keep the unit from contacting the ground. Take extra caution while edging as objects can be thrown from the trimmer line.



J

### 9. AUTOMATIC LINE FEED SYSTEM

When initially switching on the trimmer, a small length of line is fed out.

A clattering noise will be heard when the lines hit the line cutter. **DO NOT BE ALARMED**, this is normal. After about 5 seconds the line will be cut to the correct length and the noise will reduce as the motor receives full speed.

If the noise of the line being cut can't be heard, more line will be fed out.

To feed more line, it is first necessary to allow the trimmer to stop completely, then restart, allowing the motor to reach full speed.

Repeat above until you hear the lines hitting against the line cutter. (Do not repeat this procedure more than 6 times)

model number 060-2365-6 | contact us: 1.866.523.5218

### 10. MANUALLY WINDING THE LINE (SEE FIG. K, L, M, N)

Take approximately 16' (5 m) line and insert 5/8" (15 mm) of line into one of the holes in the upper section of the spool (Fig. M). Wind the line in the direction of the arrows on the top of the spool (Fig. N).

Leave approximately 4" (100 mm) of line unwound and place it into the cleat. Repeat on the lower section of spool.

Care should be taken to ensure that the line is neatly coiled on the spool (Fig. O). Failure to do so will impair the efficiency of the automatic line feed.

Then fit the spool as described above in "Replacing the Trimmer Line and Spool".

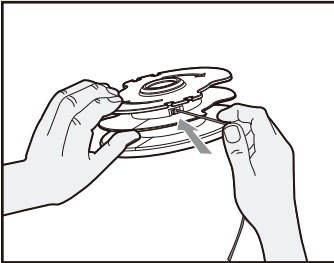

K

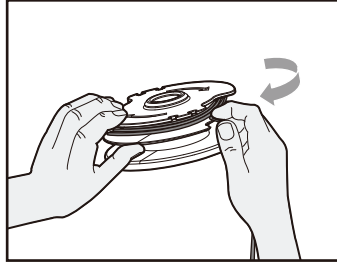

L

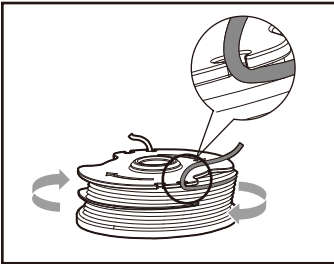

M

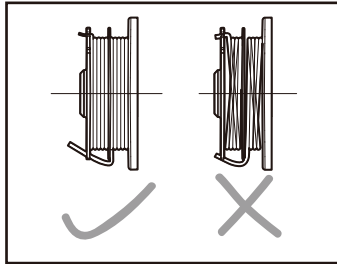













N



model number 060-2365-6 | contact us: 1.866.523.5218

After use, disconnect the machine from the mains and check for damage. Your power tool requires no additional lubrication or maintenance. There are no user serviceable parts in your power tool. Mains powered trimmers should only be repaired by an authorized repairer use only manufacturers recommended replacement parts and accessories. Never use water or chemical cleaners to clean your power tool. Wipe clean with a dry cloth. Always store your power tool in a dry place out of the reach of children. Keep the motor ventilation slots clean. Keep all working controls free of dust. If you see some sparks flashing in the ventilation slots, this is normal and will not damage your power tool.

model number 060-2365-6 | contact us: 1.866.523.5218

Symbol	Name	Designation/Explanation
V	Volts	Voltage
A	Amperes	Current
Hz	Hertz	Frequency (cycles per second)
W	Watts	Power
min	Minutes	Time
	Alternating Current	Type of current
	Direct Current	Type of current
	Class II Construction	Double-insulated construction
/min	Per Minute	Revolutions, strokes, surface speed, orbits etc., per minute
	Read the Operator's Manual	To reduce the risk of injury, user must read instruction manual.
	Ear Protection	Wear ear protection.
	Operation Condition	Do not expose to rain.
		Keep all other people, including children, pets and bystanders outside the 15 metres hazard zone; stop the trimmer immediately if you are approached.
		Before any work on the machine itself, pull the power plug from the outlet.
		Trimming
		Edging
		Lock
		Unlock
		Wear protective gloves.

**SAVE THESE INSTRUCTIONS!**





model number 060-2365-6 | contact us: 1.866.523.5218

## TWO-YEAR LIMITED WARRANTY

For Two (2) Years from the date of purchase within Canada, YARDWORKS CANADA will, at its option, repair or replace for the original purchaser, free of charge, any part or parts found to be defective in material or workmanship.

### THIS WARRANTY DOES NOT COVER

1. Any part that has become inoperative due to misuse, commercial use, abuse, neglect, accident, improper maintenance, or alteration;
2. The unit, if it has not been operated and/or maintained in accordance with the owner's manual;
3. Normal wear, except as noted below;
4. Routine maintenance items such as lubricants, blade sharpening; or
5. Normal deterioration of the exterior finish due to use or exposure.

### FULL ONE HUNDRED TWENTY (120) DAYS WARRANTY ON NORMAL WEAR PARTS

Normal wear parts are defined as blade adaptors, blades, grass bags and tires. These parts are warranted to the original purchaser to be free from defects in material and workmanship for a period of one hundred twenty (120) days from the date of retail purchase.

## HOW TO OBTAIN SERVICE

Warranty service is available by calling the toll-free helpline, at 1.866.523.5218. The factory will not accept the return of a complete unit unless prior written permission has been extended by YARDWORKS CANADA.

## TRANSPORTATION CHARGES

Transportation charges for the movement of any power equipment unit or attachment are the responsibility of the purchaser. The purchaser must pay transportation charges for any part submitted for replacement under this warranty unless such return is requested in writing by YARDWORKS CANADA.

## OTHER WARRANTIES

All other warranties, express or implied, including any implied warranty of merchantability is limited in its duration to that set forth in this express limited warranty. The provisions as set forth in this warranty provide the sole and exclusive remedy of YARDWORKS CANADA obligations arising from the sale of its products.





