

MASTERCRAFT™/MC

CORDLESS BRUSHLESS GRASS TRIMMER

060-1970-0

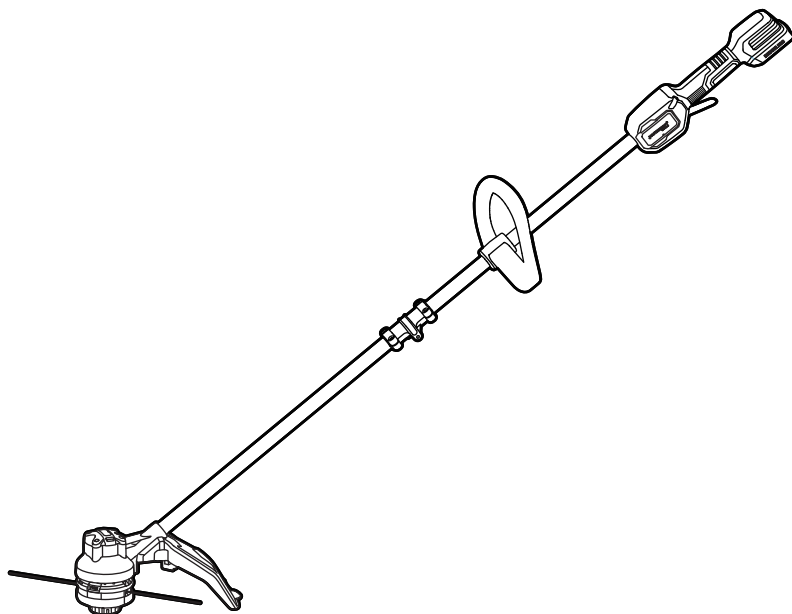

IMPORTANT:

Read and understand this instruction manual thoroughly before using the product.

INSTRUCTION MANUAL

TABLE OF CONTENTS

Technical Specifications	4
Safety Guidelines	5
Key Parts Diagram	11
Operating Instructions	12
Maintenance	20
Troubleshooting	21
Parts List	22
Warranty	24

NOTE:

If any parts are missing or damaged, or if you have any questions, please call our toll-free helpline at 1-800-689-9928.



SAVE THESE INSTRUCTIONS

- This manual contains important safety and operating instructions. Read all instructions and follow them when using this product.

TECHNICAL SPECIFICATIONS

Rated Voltage	20 V d.c.
Maximum Speed	6 500/min (at no load)
Cutting-line Type	0.08" (2 mm) twisted nylon line
Cutting Width	12" (30.5 cm) / 14" (35.6 cm)
Weight	2.8 kg (6 lb 3 oz)

Recommend using tool with Mastercraft® and PWR POD™ 20V max* Lithium-ion 4.0 Ah battery (054-7557-6 and 054-7564-8; sold separately) for optimal performance.

COMPATIBLE BATTERIES AND CHARGERS

Brand	Battery Pack	Charger
PWR POD™	2.0 Ah: 054-7563-0	45 W Charger: 054-3126-6
	4.0 Ah: 054-7564-8	90 W Fast Charger: 054-7565-6
	5.0 Ah: 054-7558-4	Dual-Port Charger: 054-7567-2
	8.0 Ah: 054-7569-8	4 Port Fast Charger: 054-7571-0 150 W Fast Charger: 054-7570-2
Mastercraft®	2.0 Ah: 054-7553-4	90W Fast Charger: 054-7559-2
	4.0 Ah: 054-7557-6	60W X 2 Dual-Port Charger: 054-8299-4
	5.0 Ah: 054-2434-8	

SAFETY GUIDELINES:



WARNING!

Safety symbols in this Instruction Manual are used to flag possible dangers. The safety symbols and their explanations require your full understanding. The safety warnings do not, by themselves, eliminate any danger, nor are they substitutes for proper accident prevention measures.



WARNING!

This Safety Alert Symbol indicates caution, warning, or danger. Failure to obey a safety warning can result in serious injury to yourself or others. To reduce the risk of injury, fire, or electric shock, always follow the safety precautions.

KNOW YOUR TOOL

To operate this tool, carefully read this Instruction Manual and all labels affixed to the cordless string trimmer before using. Keep this instruction manual available for future reference.

IMPORTANT

This tool should only be serviced by a qualified service technician. For more information, call the toll-free helpline at 1-800-689-9928.

READ ALL INSTRUCTIONS THOROUGHLY.

SAVE THESE INSTRUCTIONS.

GENERAL MACHINE SAFETY WARNINGS



WARNING!

Read all safety warnings, instructions, illustrations and specifications provided with this machine. Failure to follow all instructions listed below may result in electric shock, fire and/or serious injury.

SAVE ALL WARNINGS AND INSTRUCTIONS FOR FUTURE REFERENCE.

The term “machine” in the warnings refers to your mains-operated (corded) machine or battery-operated (cordless) machine.

WORK AREA SAFETY

- **Keep work area clean and well lit.** Cluttered or dark areas invite accidents.
- **Do not operate machines in explosive atmospheres, such as in the presence of flammable liquids, gases or dust.** Machines create sparks which may ignite the dust or fumes.
- **Keep children and bystanders away while operating a machine.** Distractions can cause you to lose control.
- **Avoid dangerous environments.** Don't use appliances in damp or wet locations.

ELECTRICAL SAFETY

- **Machine plugs must match the outlet. Never modify the plug in any way. Do not use any adaptor plugs with earthed (grounded) machines.** Unmodified plugs and matching outlets will reduce risk of electric shock.
- **Avoid body contact with earthed or grounded surfaces, such as pipes, radiators, ranges and refrigerators.** There is an increased risk of electric shock if your body is earthed or grounded.
- **Do not expose machines to rain or wet conditions.** Water entering a machine will increase the risk of electric shock.
- **Do not abuse the cord. Never use the cord for carrying, pulling or unplugging the machine. Keep cord away from heat, oil, sharp edges or moving parts.** Damaged or entangled cords increase the risk of electric shock.
- **When operating a machine outdoors, use an extension cord suitable for outdoor use.** Use of a cord suitable for outdoor use reduces the risk of electric shock.
- **If operating a machine in a damp location is unavoidable, use a ground-fault circuit interrupter (GFCI) protected supply.** Use of a GFCI reduces the risk of electric shock.

PERSONAL SAFETY

- **Stay alert, watch what you are doing and use common sense when operating a machine. Do not use a machine while you are tired or under the influence of drugs, alcohol or medication.** A moment of inattention while operating machines may result in serious personal injury.
- **Use personal protective equipment.** Always wear eye protection. Protective equipment such as a dust mask, non-skid safety shoes, hard hat or hearing protection used for appropriate conditions will reduce personal injuries.
- **Prevent unintentional starting. Ensure the switch is in the off-position before connecting to power source and/or battery pack, picking up or carrying the tool.** Carrying machines with your finger on the switch or energising machines that have the switch on invites accidents.
- **Remove any adjusting key or wrench before turning the machine on.** A wrench or a key left attached to a rotating part of the machine may result in personal injury.
- **Do not overreach. Keep proper footing and balance at all times.** This enables better control of the machine in unexpected situations.
- **Dress properly. Do not wear loose clothing or jewellery. Keep your hair and clothing away from moving parts.** Loose clothes, jewellery or long hair can be caught in moving parts.
- **If devices are provided for the connection of dust extraction and collection facilities, ensure these are connected and properly used.** Use of dust collection can reduce dust-related hazards.
- **Do not let familiarity gained from frequent use of tools allow you to become complacent and ignore tool safety principles.** A careless action can cause severe injury within a fraction of a second.

MACHINE USE AND CARE

- **Do not force the machine. Use the correct machine for your application.** The correct machine will do the job better and safer at the rate for which it was designed.
- **Do not use the machine if the switch does not turn it on and off.** Any machine that cannot be controlled with the switch is dangerous and must be repaired.
- **Disconnect the plug from the power source and/or remove the battery pack, if detachable, from the machine before making any adjustments, changing accessories, or storing machines.** Such preventive safety measures reduce the risk of starting the machine accidentally.
- **Store idle machines out of the reach of children and do not allow persons unfamiliar with the machine or these instructions to operate the machine.** Machines are dangerous in the hands of untrained users.
- **Maintain machines and accessories. Check for misalignment or binding of moving parts, breakage of parts and any other condition that may affect the machine's operation. If damaged, have the machine repaired before use.** Many accidents are caused by poorly maintained machines.
- **Keep cutting tools sharp and clean.** Properly maintained cutting tools with sharp cutting edges are less likely to bind and are easier to control.
- **Use the machine, accessories, tool bits, etc., in accordance with these instructions, taking into account the working conditions and the work to be performed.** Use of the machine for operations different from those intended could result in a hazardous situation.
- **Keep handles and grasping surfaces dry, clean and free from oil and grease.** Slippery handles and grasping surfaces do not allow for safe handling and control of the tool in unexpected situations.
- **Keep cables away from the working area of the tool.** During operation cables may be hidden from view and can be accidentally damaged by the tool.

BATTERY TOOL USE AND CARE

- **Recharge only with the charger specified by the manufacturer.** A charger that is suitable for one type of battery pack may create a risk of fire when used with another battery pack.
- **Use machines only with specifically designated battery packs.** Use of any other battery packs may create a risk of injury and fire.
- **When battery pack is not in use, keep it away from other metal objects, like paper clips, coins, keys, nails, screws or other small metal objects, that can make a connection from one terminal to another.** Shorting the battery terminals together may cause burns or a fire.
- **Under abusive conditions, liquid may be ejected from the battery; avoid contact. If contact accidentally occurs, flush with water. If liquid contacts eyes, seek additional medical help.** Liquid ejected from the battery may cause irritation or burns.
- **Do not use a battery pack or tool that is damaged or modified.** Damaged or modified batteries may exhibit unpredictable behaviour resulting in fire, explosion or risk of injury.

- **Do not expose a battery pack or tool to fire or excessive temperature.** Exposure to fire or temperature above 130°C (265°F) may cause an explosion.
- **Follow all charging instructions and do not charge the battery pack or tool outside the temperature range specified in the instructions.** Charging improperly or at temperatures outside the specified range may damage the battery and increase the risk of fire.

SERVICE

- **Have your machine serviced by a qualified repair person using only identical replacement parts.** This will ensure that the safety of the machine is maintained.
- **Never service damaged battery packs.** Service of battery packs should only be performed by the manufacturer or authorized service providers.

GRASS TRIMMER SAFETY WARNINGS

- **Do not use the machine in bad weather conditions, especially when there is a risk of lightning.** This decreases the risk of being struck by lightning.
- **Thoroughly inspect the area for wildlife where the machine is to be used.** Wildlife may be injured by the machine during operation.
- **Thoroughly inspect the area where the machine is to be used and remove all stones, sticks, wires, bones, and other foreign objects.** Thrown objects can cause personal injury.
- **Before using the machine, always visually inspect to see that the cutter and the cutter assembly are not damaged.** Damaged parts increase the risk of injury.
- **Follow instructions for changing accessories.** Improperly tightened blade-securing nuts or bolts may either damage the blade or result in it becoming detached.
- **Wear eye, ear, head and hand protection.** Adequate protective equipment will reduce personal injury by flying debris or accidental contact with the cutting line or blade.
- **While operating the machine, always wear non-slip and protective footwear. Do not operate the machine when barefoot or wearing open sandals.** This reduces the chance of injury to the feet from contact with the moving lines.
- **While operating the machine, always wear safety footwear. Do not operate the machine when barefoot or wearing open sandals.** This reduces the chance of injury to the feet from contact with a line.
- **While operating the machine, always wear long trousers.** Exposed skin increases the likelihood of injury from thrown objects.
- **Keep bystanders away while operating the machine.** Thrown debris can result in serious personal injury.
- **Always use two hands when operating the machine.** Holding the machine with both hands will avoid loss of control.
- **Hold the machine by the insulated gripping surfaces only—the cutting line or blade may contact hidden wiring.** Cutting line or blades contacting a “live” wire may make exposed metal parts of the machine “live” and could give the operator an electric shock.

- **Always keep proper footing and operate the machine only when standing on the ground.** Slippery or unstable surfaces may cause a loss of balance or control of the machine.
- **Do not operate the machine on excessively steep slopes.** This reduces the risk of loss of control, slipping and falling which may result in personal injury.
- **When working on slopes, always be sure of your footing; always work across the face of slopes, never up or down, and exercise extreme caution when changing direction.** This reduces the risk of loss of control, slipping and falling which may result in personal injury.
- **Keep all parts of the body away from the line when the machine is operating. Before you start the machine, make sure line is not contacting anything.** A moment of inattention while operating the machine may result in injury to yourself or others.
- **Do not operate the machine above waist height.** This helps prevent unintended line contact and enables better control of the machine in unexpected situations.
- **When cutting brush or saplings that are under tension, be alert for spring back.** When the tension in the wood fibres is released, the brush or sapling may strike the operator and/or throw the machine out of control.
- **Use extreme caution when cutting brush and saplings.** The slender material may catch the line and be whipped toward you or pull you off balance.
- **Maintain control of the machine and do not touch lines and other hazardous moving parts while they are still in motion.** This reduces the risk of injury from moving parts.
- **When clearing jammed material or servicing the machine, make sure all power switches are off and the battery is disconnected.** Unexpected starting of the machine while clearing jammed material or servicing may result in serious personal injury.
- **Carry the machine with the machine switched off and away from your body.** Proper handling of the machine will reduce the likelihood of accidental contact with a moving line.
- **Only use replacement lines and cutting heads specified by the manufacturer.** Incorrect replacement parts may increase the risk of breakage and injury.
- **If you strike a foreign object with the trimmer or it becomes entangled, stop the tool immediately, check for damage and have any damage repaired before further operation is attempted.** Do not operate with a broken guard or spool.
- **If machine starts to vibrate abnormally, stop the motor and check immediately for the cause.** Vibration is generally a warning of trouble. A loose head may vibrate, crack, break or come off the trimmer, which may result in serious or fatal injury. Make sure that the cutting attachment is properly fixed in position. If the head loosens after fixing it in position, replace it immediately. Never use a trimmer with a loose cutting attachment.

ADDITIONAL SAFETY GUIDELINES

- **The label on your tool may include the following symbols. The symbols and their definitions are as follows:**
 - V Volts
 - A Amperes

Hz Hertz

W Watts

min Minutes

— or d.c..... Direct current

n₀ No-load speed

/min Revolutions per minute



..... WARNING – To reduce the risk of injury, user must read instruction manual.



..... WARNING – To reduce the risk of injury, always wear eye protection.



..... WARNING – To reduce the risk of injury, always wear ear protection.



..... The logo of UL certification

LISTED
GARDENING APPLIANCE
E490727

..... WARNING – Beware of thrown objects



..... WARNING – The distance between the machine and bystanders shall be at least 15 m (50')



..... WARNING – Disconnect battery before maintenance

**WARNING!**

To reduce the risk of electric shock or damage to the charger and battery, use only the Mastercraft® and PWR POD™ batteries and chargers listed.

Brand	Battery Pack	Charger
PWR POD™	2.0 Ah: 054-7563-0	45 W Charger: 054-3126-6
	4.0 Ah: 054-7564-8	90 W Fast Charger: 054-7565-6
	5.0 Ah: 054-7558-4	Dual-Port Charger: 054-7567-2
	8.0 Ah: 054-7569-8	4 Port Fast Charger: 054-7571-0
Mastercraft®		150 W Fast Charger: 054-7570-2
	2.0 Ah: 054-7553-4	90W Fast Charger: 054-7559-2
	4.0 Ah: 054-7557-6	60W X 2 Dual-Port Charger: 054-8299-4
	5.0 Ah: 054-2434-8	

- **For best results, your battery and tool should be stored, charged, and used in a location where the temperature is more than 5°C (41°F) but less than 40°C (104°F).** Do not store outside or in vehicles.
- **Please refer to the battery pack and charger manuals for detailed operating information.**

SAVE THESE INSTRUCTIONS!

PACKAGE CONTENTS:

Cordless grass trimmer, front-assist handle, guard, screw knob, bolt, hexagon screws (2), screws with washer (2) for the guard, wrench.

KEY PARTS DIAGRAM

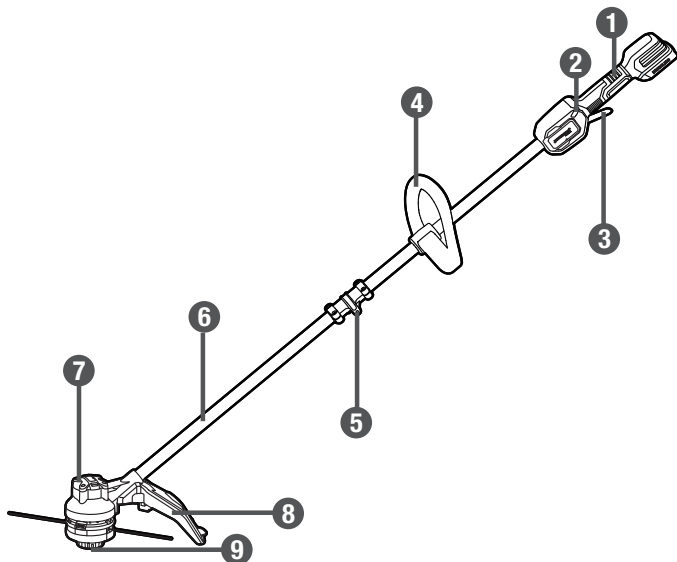

No.	Description
1	Rear handle
2	Lock-off button
3	Variable-speed trigger switch
4	Front-assist handle
5	Hinge

No.	Description
6	Trimmer shaft
7	Trimmer head
8	Guard
9	Bump knob

Before attempting to use this tool, become familiar with all of its operating features and safety requirements. For optimum performance and safety, read the following operating instructions carefully before using.



WARNING!

- Remove the grass trimmer from the package and examine it carefully. Do not discard the carton or any packaging material until all parts have been examined.
- If any part of the grass trimmer is missing or damaged, do not attach the battery pack to the tool or use the tool until the part has been repaired or replaced. Failure to heed this warning could result in serious injury.
- Do not allow familiarity with the grass trimmer to cause a lack of alertness. A fraction of a second of carelessness is enough to cause severe injury.

OPERATING INSTRUCTIONS**UNFOLD THE SHAFT (fig. 1-fig. 2)**

1. Remove the battery pack from the trimmer.
2. Put the trimmer on the ground and carefully unfold the shaft. Make sure that the cable is inside the shaft so that it will not be pinched when closing the joints.
3. Use the wrench (included) to lock the shaft with the hexagon screws supplied.

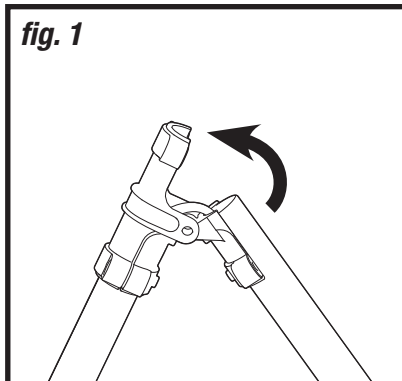
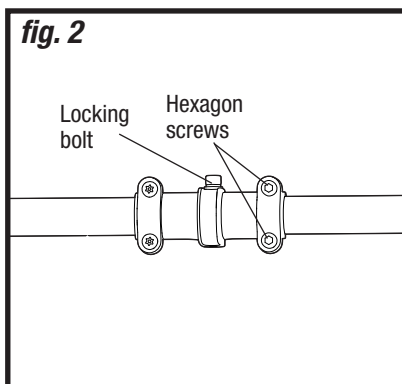
fig. 1**fig. 2****NOTICE:**

- To fold the shaft again, remove two hexagon screws near the rear handle side.
- Slightly loosen the locking bolt if the hexagon screws are misaligned. Then retighten after hexagon screws are secured.

**WARNING!**

- Always take care to not allow the shaft to pinch the cable when you are unfolding or folding the string trimmer. Do not attempt to start the trimmer until the shaft has been locked.

MOUNTING THE GUARD (fig. 3-fig. 4)

1. Remove the battery pack from the trimmer.
2. Lift the trimmer head and face it upward; align the groove on the bottom of the guard with the raised portion on the base of the trimmer head, and then slide the guard onto the base (fig. 3).
3. Make sure that the two mounting holes in the guard are aligned with the two assembly holes in the base of the shaft. Insert a screw into each washer, and then lock the guard in place by tightening the two screws with the included wrench (fig. 4).

fig. 3

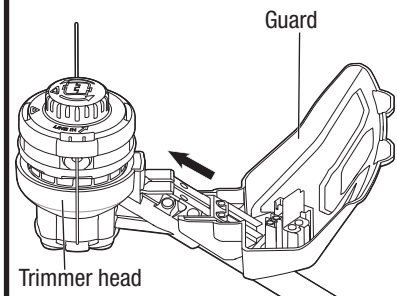
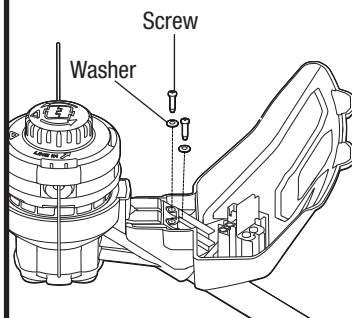

fig. 4



WARNING!

- Always wear gloves when mounting or replacing the guard. Be careful of the blade on the guard and protect your hands from being injured by the blade.

MOUNTING THE FRONT-ASSIST HANDLE (fig. 5a)

1. Remove the battery pack from the trimmer.
2. Remove the screw knob and the bolt from the front-assist handle.
3. Press the front-assist handle onto the shaft of the grass trimmer. Make sure that the front-assist handle faces upward so that it points toward the top of the handle.
4. To attach the front-assist handle on the shaft, insert the bolt into the hole on the front-assist handle, and then use the screw knob to tighten the bolt.

fig. 5a

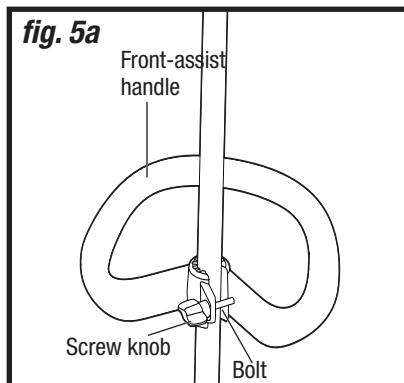

TO ADJUST THE FRONT-ASSIST HANDLE (fig. 5b)

Remove the battery before adjusting the handle. The handle should be placed at least 25 cm (10") away (after the arrow label) from the rear handle to make sure that your front arm will be straight when using the trimmer (fig. 5b). To adjust the front-assist handle position, loosen the screw knob so that the front-assist handle can be moved to the desired position of the shaft. Tighten the screw knob so that the handle cannot move on the shaft during operation.

fig. 5b

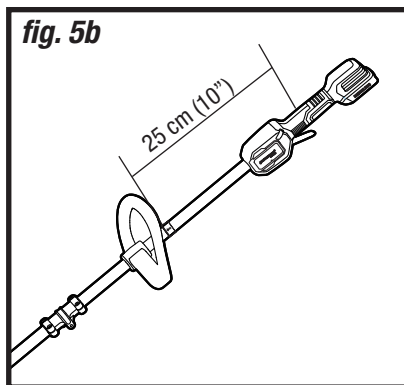

TO ATTACH BATTERY PACK (fig. 6)

1. Make sure that the switch is in the OFF position.
2. Align the raised portion on the battery pack with the grooves on the bottom of the tool, and then slide the battery pack onto the tool as shown.
3. Ensure that the battery-release button on the battery pack snaps into place and the battery pack is secured to the tool before beginning operation.

NOTICE: When placing a battery pack on the tool, be sure that the raised rib on the battery pack aligns with the groove on the string trimmer and the latches snap into place properly. Improper assembly of the battery pack can cause damage to internal components.



WARNING!

- To avoid the possibility of accidental starting, always take care not to activate the variable-speed trigger switch when you are attaching the battery pack or performing other adjustments to the tool.

TO DETACH THE BATTERY PACK (fig. 6)

1. Ensure that the switch is in the OFF position.
2. Depress the battery-release button located on the front of the battery pack to release the battery pack.
3. Pull rearward on the battery pack to remove it from the tool.

HOLDING THE GRASS TRIMMER (fig. 7)

Before operating the unit, stand in the operating position and check that:

- The operator is wearing eye protection and proper clothing.
- One arm is slightly bent, and the hand on that arm is holding the rear handle.
- The other arm is straight, with that hand holding the front-assist handle.
- The trimmer head is parallel to the ground and easily contacts the material to be cut without the operator having to bend over.

TO START/STOP THE GRASS TRIMMER (fig. 8)

Before starting the grass trimmer:

- Make sure that you have a secure and balanced footing.
 - Stand upright and hold the grass trimmer in a relaxed position.
 - Make sure that the cutting line is not touching the ground or any other objects.
 - Hold the grass trimmer with both hands: one hand on the rear handle and the other hand on the front-assist handle.
1. To turn the grass trimmer on, press the lock-off button and then depress the variable-speed trigger switch.
 2. The variable-speed trigger switch delivers higher speed with increased trigger pressure and lower speed with decreased trigger pressure.

fig. 6

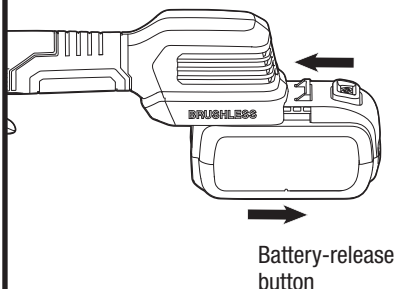
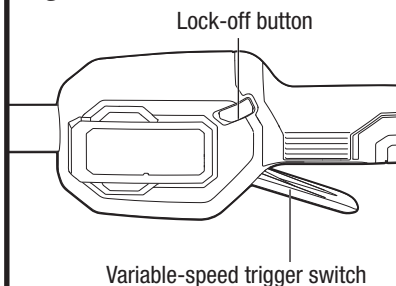

fig. 7



fig. 8



WARNING!

- Dress properly to reduce the risk of injury when operating this tool. Do not wear loose clothing or jewellery. Wear eye and ear/hearing protection. Wear heavy, long pants, boots, and gloves. Do not wear short pants or sandals or go barefoot.

3. To turn the grass trimmer off, release the variable-speed trigger switch and allow the trimmer to come to a complete stop.

TIPS FOR USING THE GRASS TRIMMER

(fig. 9)

- To avoid serious personal injury, wear safety glasses, face mask, proper clothing and footwear at all times when operating this unit.
- Clear the area to be cut before each use. Remove all objects, such as rocks, broken glass, nails, wire, or string, that can be thrown or become entangled in the cutting attachment.
- The correct angle for the cutting attachment is parallel to the ground.
- Do not force the trimmer. Allow the very tip of the line to do the cutting (especially along walls). Cutting with more than the tip of the line will reduce cutting efficiency and may overload the motor.
- Grass over 8" (20 cm) should be cut by working from top to the bottom in small increments to avoid premature line wear or motor drag.
- Slowly move the trimmer into and out of the area being cut while maintaining the cutting head position at the desired cutting height. Cutting shorter lengths produces best results.
- Trim only when grass and weeds are dry.
- Avoid trees and shrubs. Tree bark, wood mouldings, siding, and fence posts can easily be damaged by the strings.

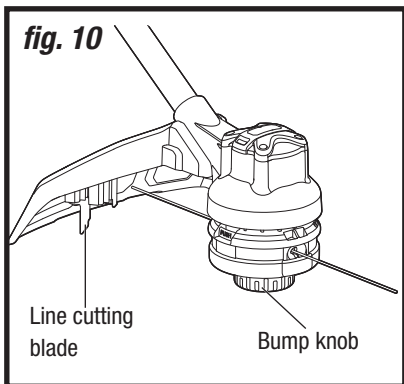
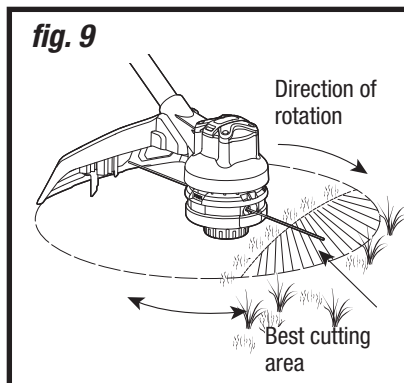

ADJUSTING THE CUTTING LINE LENGTH (fig. 10)

The trimmer head allows the operator to release more cutting line without stopping the motor. As line becomes frayed or worn, additional line can be released by lightly tapping the bump knob on the ground while operating the trimmer.

For best results, tap the bump knob on bare ground or hard soil. If line release is attempted in tall grass, the motor may overheat.

Always keep the trimming line fully extended. Line release becomes more difficult as the cutting line becomes shorter.

ADJUSTING THE CUTTING SWATH (fig. 11 – fig. 12)

The string trimmer is factory set at 12" (30.5 cm) cutting swath. To increase the cutting swath from 12 to 14" (30.5 to 35.6 cm):

1. Remove the battery pack from the tool.
2. Use a cross-head head screwdriver (not included) to loosen and remove the two screws that secure the line-cutting blade to the guard (fig. 11).
3. Move the blade and align the two holes in the blade with the other two holes in the guard. Insert two screws and tighten them securely (fig. 12).

fig. 11

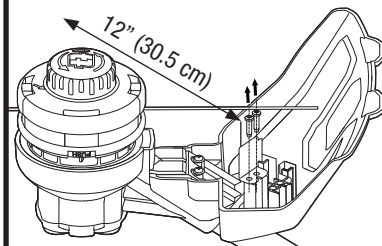
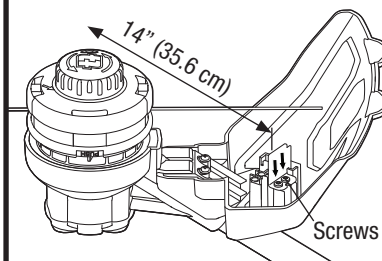

fig. 12



NOTICE:

- Cutting at 14" (35.6 cm) provides a higher efficiency; however, it will increase the load and decrease the runtime. Choose a suitable cutting swath depending on your operating situation.



WARNING!

- Do not remove or alter the line cutting blade assembly. Excessive line length will cause the motor to overheat and may result in serious personal injury.

LOAD THE SPOOL WITH NEW LINE (fig. 13 – fig. 17)

1. Remove the remaining lines first, if not, go directly to step 4.
2. Press the two release tabs on the spool cap and remove the spool retainer. Remove the line (fig. 13).
3. Reinstall the spool retainer in such a way that the threading hole on the spool retainer is aligned with one of the eyelets (fig. 13).
4. Rotate the bump head to make sure that the arrow on the spool cap is aligned with the arrow on the bump head (fig. 14).
5. Insert the new line into the eyelet marked LINE IN.
Feed the line until the end of the line comes out of the other side eyelet of the spool base (fig. 15).
6. Insert till the line from the other side equals amounts of line appear on both sides (fig. 16).
7. Hold the spool base and rotate the bump head in the direction indicated by the arrow to wind the cutting line.

fig. 13

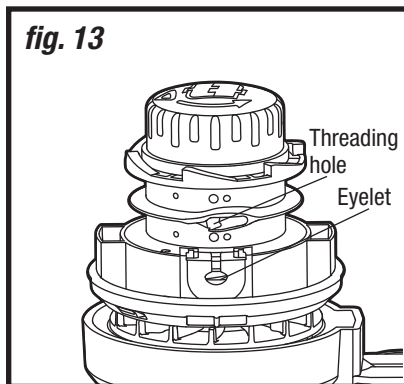

fig. 14

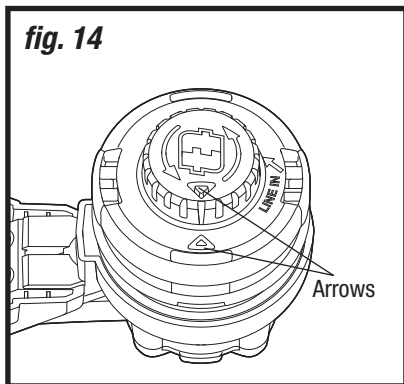

fig. 15

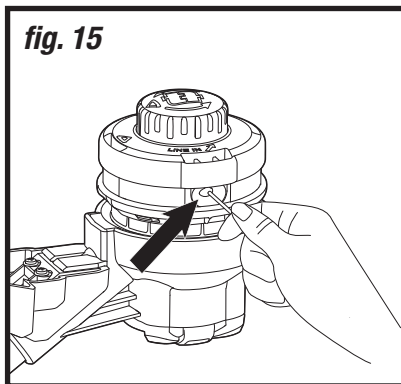

fig. 16

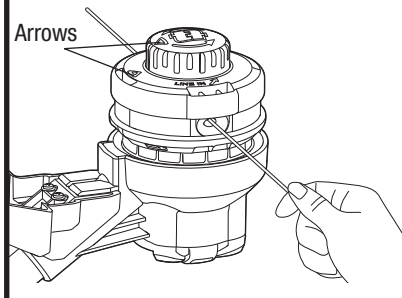
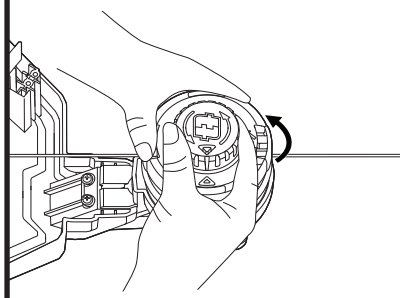

fig. 17



NOTICE:

- Always use triangle-shaped twisted nylon cutting line with a size that does not exceed 0.08" (2.0 mm). Using line other than that specified may cause the string trimmer to overheat or become damaged.
- Make sure that the spool base is installed correctly; otherwise, new line can't be wound properly.
- After each line replacement, tap the bump knob on the ground several times to check whether the cutting line can be released normally before trimming grass.
- If spool container is not installed correctly, line can't be wound properly. Reinstall spool container with threading hole aligned with eyelets.



WARNING!

- Never use metal-reinforced line, wire, rope, etc. These can break off and become dangerous projectiles.

MAINTENANCE

CHECK FOR DAMAGED/WORN PARTS BEFORE EACH USE

Check the bump head, guard, and front-assist handle, and replace any parts that are cracked, warped, bent, or damaged in any way. The line-cutting blade on the edge of the guard can dull over time. It is recommended that you periodically sharpen it with a file or replace it with a new blade.

CLEAN THE TRIMMER AFTER EACH USE

1. Clear any grass that may have wrapped itself around the motor shaft or trimmer head.
2. Use only a clean, dry and soft cloth to clean the tool. Never let any liquid get inside the tool; never immerse any part of the tool into a liquid.
3. Always keep the air vents in the rear housing free from debris.

STORAGE

Clean the tool thoroughly before storing it. Store the unit in a dry, well-ventilated area, locked-up or up high, and out of the reach of children. Keep away from corrosive agents, such as garden chemicals and de-icing salts.



WARNING!

- Do not let brake fluids, gasoline, petroleum-based products, penetrating oil, etc., come into contact with plastic parts. These substances contain chemicals that can damage, weaken, or destroy plastic.
- When servicing, use only identical replacement parts. The use of any other parts may create a hazard or cause damage to the product.
- Use only accessories that are recommended for this string trimmer by the manufacturer. Accessories that may be suitable for one tool may become hazardous when used with another tool.
- To ensure safety and reliability, all repairs should be performed by a qualified service technician.

TROUBLESHOOTING

Problem	Possible causes	Solutions
The trimmer does not work.	The battery pack is depleted.	Charge the battery pack.
	The motor shaft or trimmer head is bound with grass.	Stop the trimmer, remove the battery, and remove the grass from the motor shaft and trimmer head.
	The motor is overloaded.	Remove the trimmer head from the grass and restart the tool. Move the trimmer head to cut the grass no more than 8" (20 cm) of length in a single cut.
	The battery pack or string trimmer is too hot.	Release the trigger switch, wait for the tool to cool down, and then start the tool again.
Trimmer head will not advance line.	The trimmer head is bound with grass.	Stop the trimmer, remove the battery, and clean the trimmer head.
	There is not enough line on the spool.	Remove the battery and replace the cutting line; follow the section "LOAD THE SPOOL WITH NEW LINE" in this manual.
	Line can't come out from the other side.	Insert by following "LINE IN" direction.
Line can't be installed.		Improper installation of spool container, check the section "LOAD THE SPOOL WITH NEW LINE" to reinstall spool container.
	Line can't be wound properly.	

If the problem remains unsolved after performing the checks described above, call the toll-free helpline at 1-800-689-9928.

EXPLODED VIEW

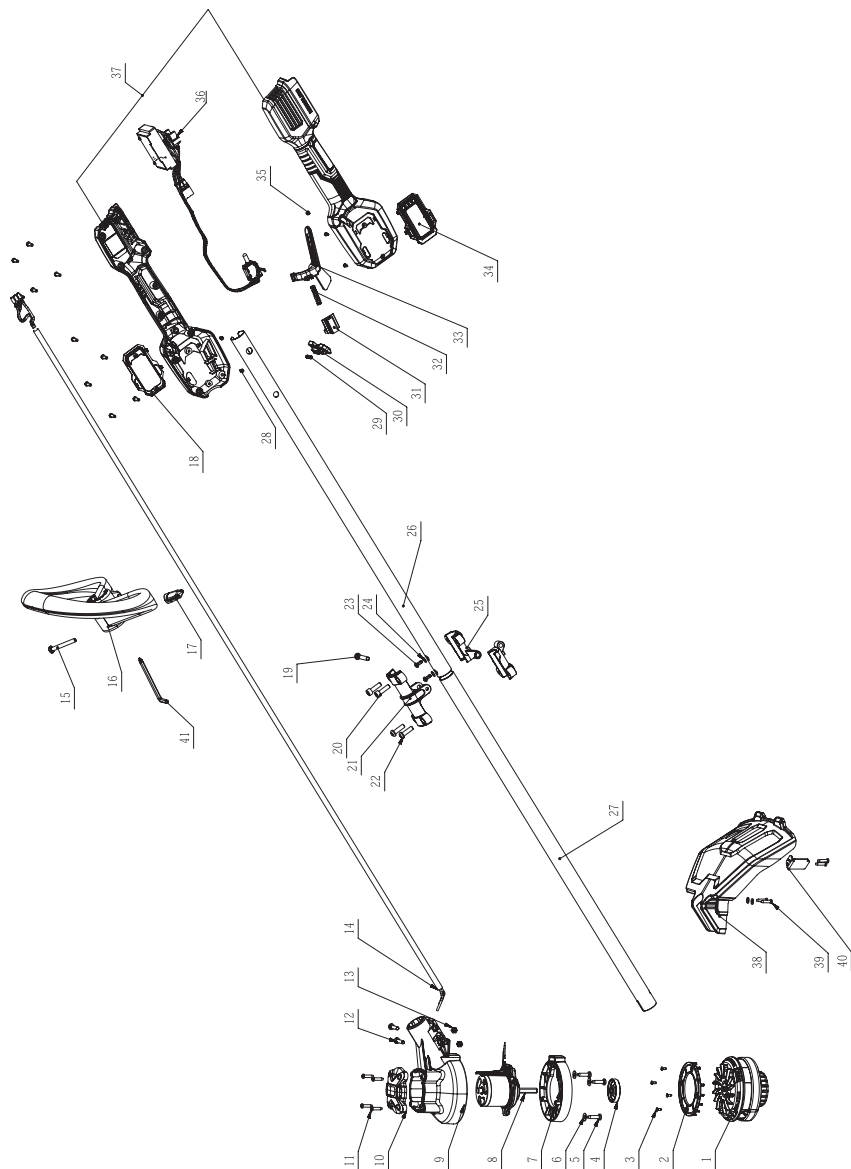

No.	Part No.	Description
1	2828435001	Cutting Head Set
2	3132697001	Fan Baffle
3	5610076004	Tapping Screw
4	3520800001	Outer Flange
5	5610055004	Tapping Screw
6	5650396003	Washer
7	3128752001	Shield
8	2730277001	DC Motor
9	3129576002	Motor Housing
10	3129575002	Rear Cover
11	5610294001	Tapping Screw
12	5620052001	Screw
13	5630007001	Prevailing Torque Hexagon Nut
14	4860300006	Internal Wire Assembly
15	5640243001	Hexagon Head Bolt
16	3129573001	Front Handle
17	3402297002	Wing Nut
18	3135826001	Right Cover
19	5620512004	Hexagon Socket Screw
20	5620334004	Hexagon Socket Screw
21	3422219003	Connecting Tube

No.	Part No.	Description
22	5620675001	Hexalobular Socket Screw
23	5610097002	Thread Forming Screw
24	5650005002	Plain Washer
25	3422218003	Connecting Tube
26	3706621001	Connecting Tube
27	3706622001	Connecting Tube
28	5610010007	Tapping Screw
29	3660124001	Spring
30	3129615001	Lock Button
31	3128797001	Sliding Block
32	3660348001	Spring
33	3129614001	Switch Trigger
34	3135825001	Left Cover
35	5620176002	Screw with Washer
36	2830604002	Electric Assembly
37	3900226001	L/R Housing Set
38	3135191001	Guard
39	5610032004	Tapping Screw
40	3704344002	Blade
41	5680186001	Inner Hexagon Wrench

If any parts are missing or damaged, or if you have any questions, please call the toll-free helpline at 1-800-689-9928.

This Mastercraft® product is guaranteed for a period of **three (3) years from the date of original retail purchase** against defects in workmanship and materials, except for the following components:

- a) Component A: Batteries, chargers and carrying case, which are guaranteed for a period of two (2) years from the date of original retail purchase against defects in workmanship and materials;
- b) Component B: Accessories, which are guaranteed for a period of one (1) year from the date of original retail purchase against defects in workmanship and materials.

Subject to the conditions and limitations described below, this product, if returned to us with proof of purchase within the stated warranty period and if covered under this warranty, will be repaired or replaced (with the same model, or one of equal value or specification), at our option. We will bear the cost of any repair or replacement and any costs of labour relating thereto.

These warranties are subject to the following conditions and limitations:

- a) a bill of sale verifying the purchase and purchase date must be provided;
- b) this warranty will not apply to any product or part thereof which is worn or broken or which has become inoperative due to abuse, misuse, accidental damage, neglect or lack of proper installation, operation or maintenance (as outlined in the applicable owner's manual or operating instructions) or which is being used for industrial, professional, commercial or rental purposes;
- c) this warranty will not apply to normal wear and tear or to expendable parts or accessories that may be supplied with the product that are expected to become inoperative or unusable after a reasonable period of use;
- d) this warranty will not apply to routine maintenance and consumable items such as, but not limited to, fuel, lubricants, vacuum bags, blades, belts, sandpaper, bits, fluids, tune-ups or adjustments;
- e) this warranty will not apply where damage is caused by repairs made or attempted by others (i.e., persons not authorized by the manufacturer);
- f) this warranty will not apply to any product that was sold to the original purchaser as a reconditioned or refurbished product (unless otherwise specified in writing);
- g) this warranty will not apply to any product or part thereof if any part from another manufacturer is installed therein or any repairs or alterations have been made or attempted by unauthorized persons;
- h) this warranty will not apply to normal deterioration of the exterior finish, such as, but not limited to, scratches, dents, paint chips, or to any corrosion or discolouring by heat, abrasive and chemical cleaners; and
- i) this warranty will not apply to component parts sold by and identified as the product of another company, which shall be covered under the product manufacturer's warranty, if any.

Additional Limitations

This warranty applies only to the original purchaser and may not be transferred. Neither the retailer nor the manufacturer shall be liable for any other expense, loss or damage, including, without limitation, any indirect, incidental, consequential or exemplary damages arising in connection with the sale, use or inability to use this product.

Notice to Consumer

This warranty gives you specific legal rights, and you may have other rights, which may vary from province to province. The provisions contained in this warranty are not intended to limit, modify, take away from, disclaim or exclude any statutory warranties set forth in any applicable provincial or federal legislation.

Made in China

Imported by

Mastercraft Canada Toronto, Canada M4S 2B8

