

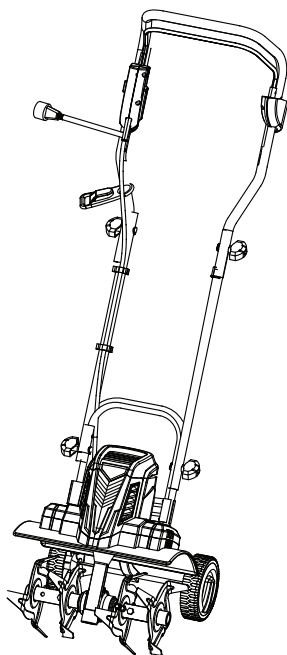

# YARDWORKS<sup>®/MD</sup>

## 10 A Electric Tiller

model number 060-1809-8 | contact us: 1.866.523.5218



### IMPORTANT:

Read and follow all safety rules and operating instructions before using this product.

**Instruction  
Manual**



For problems or questions, **DO**  
**NOT RETURN TO STORE.** Please  
contact one of our Customer  
Service Agents who would be  
happy to assist you.

For Customer Assistance Please Call:



**CANADA: 1-866-523-5218**

model number 060-1809-8 | contact us: 1.866.523.5218

Technical Data	3
Product Safety	4
Know Your Tiller	7
Component List	8
Exploded View	9
Parts List	10
Assembly & Operation	11
Maintenance And Storage	16
Troubleshooting	16
Symbols	17
Warranty	18

## TECHNICAL DATA

Rated Voltage:	120 V~60 Hz
Rated Power :	10 A
No load speed:	390 RPM
Working width:	14' (35.56 cm)
Working depth	7' (17.78 cm)
Protection Class:	□/II
Machine Weight:	20 lb 3 oz (9.15 kg)

### Important Safety Instructions

 **WARNING:** When using electric tillers, basic safety precautions should always be followed to reduce the risk of fire, electric shock, and personal injury, including the following:

**WARNING: Read all instructions**

#### FOR ALL TILLERS

- 1) Avoid Dangerous Environments - Don't use tillers in damp or wet locations.
- 2) Don't Use In Rain.
- 3) Keep Children Away - All visitors should be kept at a distance from work area.
- 4) Dress Properly - Do not wear loose clothing or jewellery. They can be caught in moving parts. Use of rubber gloves and proper footwear is recommended when working outdoors. Wear protective hair covering to contain long hair.
- 5) Use Safety Glasses - Always use face or dust mask if operation is dusty.
- 6) Use the Right Tiller - Do not use tiller for any job except that for which it is intended.
- 7) Ground Fault Circuit Interrupter (GFCI) protection should be provided on the circuit(s) or outlet(s) to be used for the gardening tiller. Receptacles are available having built-in GFCI protection and may be used for this measure of safety.
- 8) Warning -To reduce the risk of electric shock, use only with an extension cord intended for outdoor use, such as an extension cord of cord type SW-A, SOW-A, STW-A, STOW-A, SJW-A, SJOW-A, SJTW-A. or SJTOW-A.
- 9) Extension Cord - Make sure your extension cord is in good condition. When using an extension cord, be sure to use one heavy enough to carry the current your product will draw. An undersized extension cord will cause a drop in line voltage resulting in loss of power and overheating. Table 1 shows the correct size to use depending on cord length and nameplate ampere rating. If in doubt, use the next heavier gauge. The smaller the gauge number, the heavier the cord. To reduce the risk of disconnection of tiller cord from the extension cord during operating:
  - i) Make a knot as shown in Figure 1; or
  - ii) Use one of the plug-receptacle retaining straps or connectors described in this manual.
- 10) Avoid Unintentional Starting - Don't carry plugged-in tiller with finger on switch. Be sure switch is off when plugging in.
- 11) Don't Abuse Cord - Never carry tiller by cord or yank it to disconnect from receptacle. Keep cord from heat, oil, and sharp edges.
- 12) Don't grasp the exposed cutting blades or cutting edges when picking up or holding the tiller.



**WARNING:** When using electric garden products, basic safety precautions should always be followed to reduce the risk of fire, electric shock, and personal injury, including the following:



**WARNING:** Read all instructions.

- 13) Don't Force Tiller - It will do the job properly and safer at the rate for which it was designed.
- 14) Don't Overreach - Keep proper footing and balance at all times.
- 15) Stay Alert - Watch what you are doing. Use common sense. Do not operate tiller when you are tired.
- 16) Disconnect Tiller - Disconnect tiller from the power supply when not in use, before servicing, when changing accessories such as blades, and the like.
- 17) Store Idle Tillers Indoors - When not in use, tillers should be stored indoors in dry, and high or locked-up place - out of reach of children.
- 18) Maintain Tiller With Care - Keep cutting edge sharp and clean for best performance and to reduce the risk of injury. Follow instructions for lubricating and changing accessories. Inspect cord periodically, and if damaged, have it repaired by an authorized service facility. Inspect extension cords periodically and replace if damaged. Keep handles dry, clean, and free from oil and grease.
- 19) Check Damaged Parts - Before further use of the tiller, a guard or other part that is damaged should be carefully checked to determine that it will operate properly and perform its intended function. Check for alignment of moving parts, binding of moving parts, breakage of parts, mounting, and any other condition that may affect its operation. A guard or other part that is damaged should be properly repaired or replaced by an authorized

service center unless indicated elsewhere in this manual.

- 20) Keep hands away from blades.

### SAVE THESE INSTRUCTIONS

Table 1 Minimum gauge for extension cords				
Volts	Total length of cord			
120 V	25' 7.2 m	50' 15.2 m	100' 30.4 m	150' 45.7 m
Ampere rating more than not more than	AWG			
0-6	18	16	16	14
6-10	18	16	14	12
10-12	16	16	14	12
12-16	14	12	Not recommended	

### Method of securing extension cord

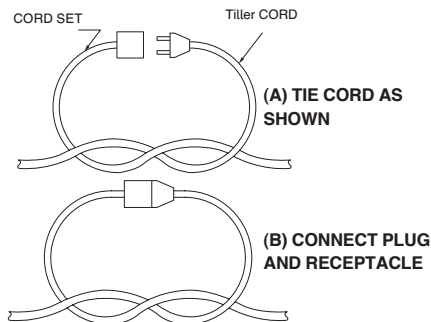

Figure 1



**WARNING:** Read all safety warnings and instructions. Failure to follow the warnings and instructions may result in electric shock, fire and/or serious injury.

**FOR ALL DOUBLE-INSULATED TILLERS****1) Replacement Parts**

When servicing use only identical replacement parts.

**2) Polarized Connections**

To reduce the risk of electric shock, this tiller has a polarized plug (one Prong is wider than the other) and will require the use of a polarized extension cord. The tiller plug will fit into a polarized extension cord only one way. If the plug does not fit fully into the extension cord, reverse the plug. If the plug still does not fit, obtain a correct polarized extension cord. A polarized extension cord will require the use of a polarized wall outlet. This plug will fit into the polarized wall outlet only one way. If the plug does not fit fully into the wall outlet, reverse the plug. If the plug still does not fit, contact a qualified electrician to install the proper wall outlet. Do not change the equipment plug, extension cord receptacle, or extension cord plug in any way.

**SAVE THESE INSTRUCTIONS**



model number 060-1809-8 | contact us: 1.866.523.5218

- |                                       |  |
|---------------------------------------|--|
| 1. Handle bar                         | 12. Motor housing                      |
| 2. Switch Lever                       | 13. Locking knob for middle handle x 2 |
| 3. Upper handle                       | 14. Plug connector                     |
| 4. Locking bolt for upper handle x 2  | 15. Locking knob for upper handle x 2  |
| 5. Middle handle                      | 16. Cord retainer                      |
| 6. Locking bolt for middle handle x 2 | 17. Lock-out Button                    |
| 7. Lower handle                       | 18. Hitch pin                          |
| 8. Wheel x 2                          | 19. Wheel assembly                     |
| 9. Tine shield                        | 20. Connector for wheels               |
| 10. Outer tine x 2                    | 21. Clamping bolt                      |
| 11. Inner tine x 2                    |  |

model number 060-1809-8 | contact us: 1.866.523.5218

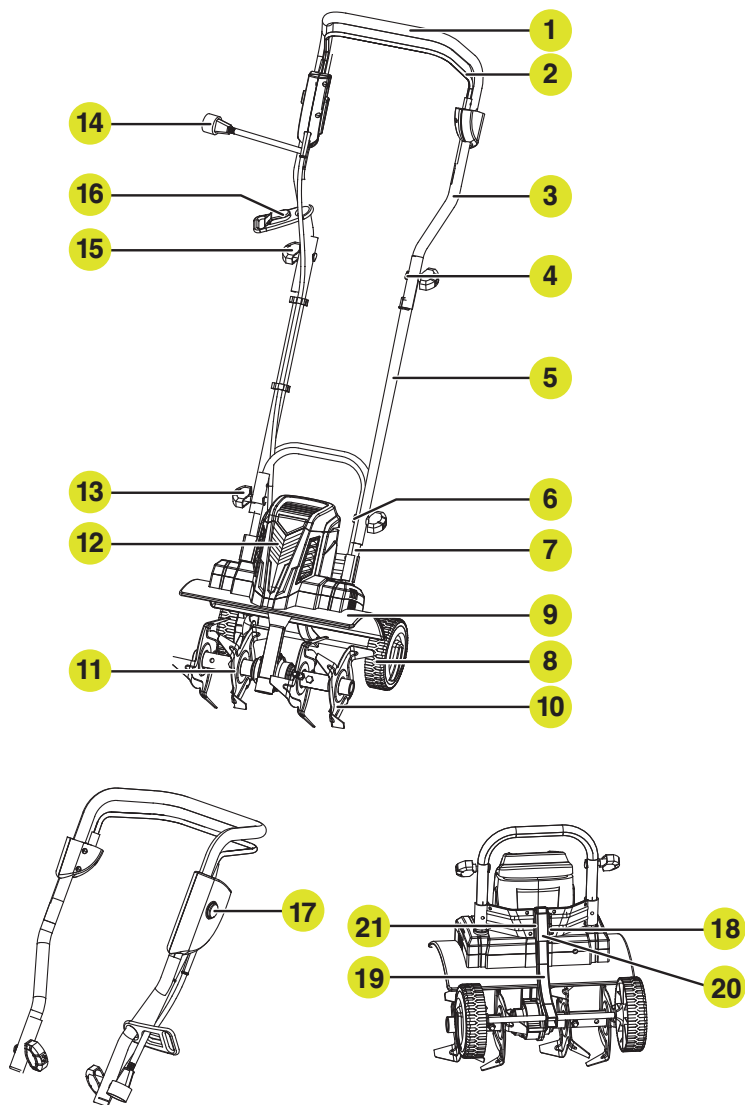

We recommend that you purchase your accessories from the same store that sold you this product. Refer to the accessory packaging for further details. Store personnel can assist you and offer advice.



model number 060-1809-8 | contact us: 1.866.523.5218

Exploded View

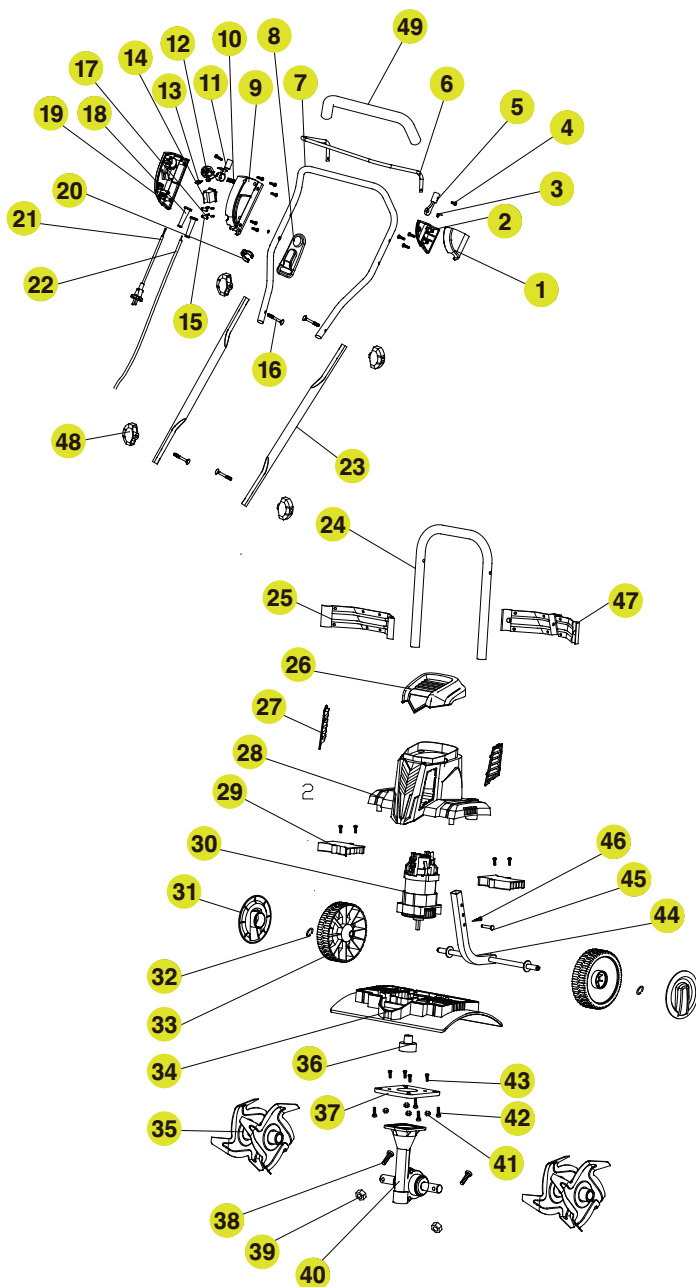

Item	Description	QTY.
1	switchgear cabinet 4	1
2	switchgear cabinet 3	1
3	torsional spring	1
4	screw-M4X10	1
5	trigger bar	1
6	Bale lever	1
7	Upper handle assembly	1
8	Cord retainer	1
9	switchgear cabinet 2	1
10	spring	1
11	trigger bar	1
12	power door unlock	1
13	tension spring	1
14	switch	1
15	pressing plate	3
16	Bolt	4
17	screw-ST4X16	14
18	protecting bush	2
19	switchgear cabinet 1	1
20	Hang for power cord	2
21	attaching plug	1
22	power line	1
23	intermedium tube	2
24	Lower handle	1
25	upper revit board	1
26	loam cake	1
27	decorative sheet	2
28	fuselage cover	1
29	wind board	2
30	Motor assembly	1

Item	Description	QTY.
31	cover board	2
32	jump ring	2
33	wheel	2
34	baseplate	1
35	tine	2
36	coupler	1
37	junction plate	1
38	screw-M8X40	2
39	nut-M8	2
40	gear box assembly	1
41	nut-M6	4
42	screw-ST6X25	8
43	screw-M6X20	4
44	wheel shelf assembly	1
45	alignment pin	1
46	plug pin	1
47	lower revit board	1
48	knob	4
49	Sponge sheath	1

**MOUNTING****Proper use**

This tiller is only intended for scarifying/aerating (loosening and aerating of the lawn). It is only suitable for domestic use in home and hobby gardens.

**Improper use**

The tiller must not be used in permanent operation and not in industrial environments.

**ASSEMBLY**

This product must be assembled correctly before use.



**WARNING!** Do not connect to power supply until assembly is complete. Failure to comply could result in accidental starting and possible serious personal injury.

**1. FITTING THE CORD RETAINER (See Fig. A)**

Simply attach the cord retainer (16) by inserting it through the upper handle (4).

**2. FITTING THE HANDLE****Assembling the middle handle with lower handle (SEE FIG. B1)**

- 1) Attach the middle handle to the lower handle, align the hole on the middle handle with the hole on lower handle.
- 2) Insert the locking bolt (6) for middle handle through the aligned holes on middle and lower handles.
- 3) Insert the locking knob (13) for middle handle through the bolt and turn it clockwise to tighten.
- 4) Repeat the above steps to assemble the other side of the middle handle.

**Assembling the middle handle with upper handle (SEE FIG. B2)**

- 5) Attach the upper handle to the middle handle, align the hole on the middle handle with the hole on upper handle.
- 6) Insert the locking bolt (4) for upper handle through the aligned holes on middle and upper handles.
- 7) Insert the locking knob (15) for middle handle through the bolt and turn it clockwise to tighten.
- 8) Repeat the above steps to assemble the other side of the upper handle.

**3. FITTING AND ADJUSTING THE WHEELS**

The wheels are used to control the depth of operation and for transport.

**Assembling the wheels (SEE FIG. C1, C2):**

- 1) Insert the wheel assembly (19) into the connector for wheels (20) on the machine. (See Fig. C1)
- 2) Choose a desired hole on the wheel assembly (a) according to the required height. Align the hole with the hole (b) on the connector for wheels.
- 3) Slide the clamping bolt (21) provided through the aligned holes. (See Fig. C2)
- 4) Insert the hitch pin (18) through the hole on the bolt lock the wheel assembly. (See Fig. C3)

**Adjusting the wheels (SEE FIG. C4):**

Remove the hitch pin and the clamping bolt, move the wheel assembly upwards or downwards to a desired position. Re-tighten the hitch pin to the bolt to lock the wheels.

**NOTE:** The wheels can be removed (i.e. tilling without the wheels) for the greatest tilling depth.

**OPERATION**

 **WARNING:** Never operate the tiller without the proper safety devices in place and working. Never operate the tiller with damaged safety devices. Operation of this product with damaged or missing parts could result in serious personal injury.

 **WARNING:**

- Do not allow hands, feet, or any other part of the body or clothing near the rotating tines or any other moving part.
- The tines continue to rotate until the switch trigger is released. Failure to avoid contact could cause serious personal injury.

**1.STARTING AND STOPPING****To start (See Fig. D):**

- 1) Plug the tiller into an approved outdoor extension cord.
- 2) Press the lock-out button and press the switch lever against the handle bar to start the tiller. Release the lock-out button while continuing to hold upward on switch lever to continue use.

**To stop:**

Release the switch lever to stop the tiller. Allow sufficient time for the rotating parts to come to a complete stop.

 **WARNING:**

- If any parts are damaged or missing do not operate this product until the parts are replaced.
- Failure to heed this warning could result in serious personal injury. Call our customer service help line.
- Do not attempt to modify this product or create accessories not recommended for use with this product. Any such alteration or modification is misuse and could result in a hazardous condition leading to possible serious personal injury.

**2.USING THE CORD RETAINER**

This tiller is equipped with a cord retainer in order to prevent the extension cord from disconnecting from the power cord while the tiller is in use.

To use the cord retainer:

- 1) Fold the extension cord in order to form a tight loop. Push the loop through the rectangular hole in the retainer. (See Fig. E1)
- 2) Slide the loop over the retaining clip, and pull down until the cord is secured. (See Fig. E2)

### 3. PREPARING THE SEED BED

The tiller can be used to break up the garden soil and prepare a seed bed for planting. Plan ahead to leave enough room between the seed rows to allow for machine cultivating after the plants have grown.

#### TILLING SOD

Tilling sod into the soil is not recommended. If sod must be removed to perform application, then it is suggested to do as follows:

- 1) Map out the area of sod required to be removed.
- 2) Cut into 16" x 36" (40 x 81 cm) sections using a spade shovel or edger at a depth of 3" (7.7 cm).
- 3) Lift the sod from the edges using a shovel, sliding below at the roots.
- 4) Remove the sod. Carry sod to compost pile or ground that requires fill. Turn the sod upside down to allow grass to decompose.
- 5) Once sod layer is removed, begin to till the soil to desired depth.

#### ATTENTION:

- Move the tiller to the work area prior to starting the motor.
- Hold the tiller firmly while starting. The tines will pull the tiller forward during operation. Lower the tines slowly with the guide bar.
- By pulling the tiller back towards yourself, the tines will dig deeper and more aggressively.
- To keep tripping, take extra precautions when moving backwards and when pulling the tiller back toward yourself.
- If the tiller digs deep enough to stay in one spot, gently rock it side to side until it starts moving forward again.
- Never pass the tiller over the extension cord. Make sure the cord is always in a safe position behind you.
- When working on inclines always stand diagonally to the incline to retain a firm, safe footing. Do not work on steep slopes.

#### WORKING HINTS FOR TILLING:

1. With the wheel assembly installed to the desired depth position, roll the tiller to the work area.
2. Plug the tiller into an approved extension cord.
3. Stand behind the tiller, with tines on ground and the work area clean and free of obstructions.
4. Start the tiller to work.

**! IMPORTANT:** If weeds, roots, vines or other growth gets collected around the bottom of the tiller it is important to stop tiller. Disconnect from power source and clean tines using a screwdriver or other object which can help remove debris. If necessary, removes tines to untangle debris from shaft and tines.

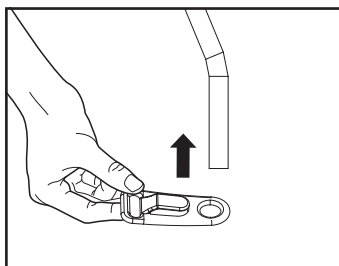

A

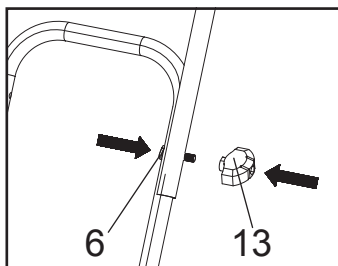

B1

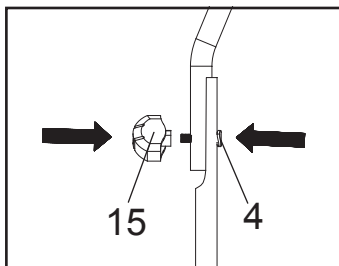

B2

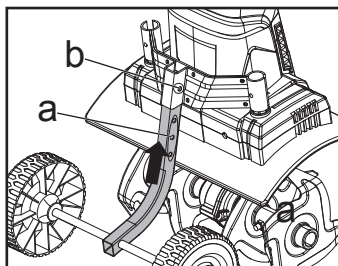

C1

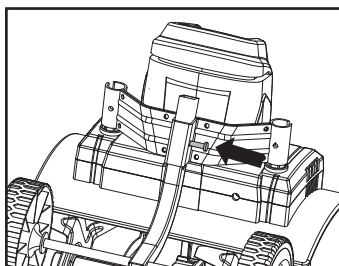

C2

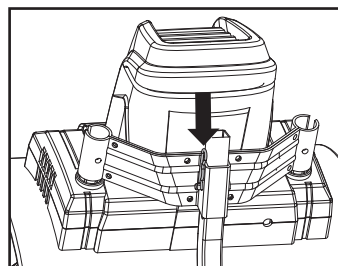

C3

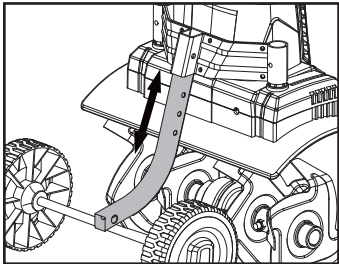

C4

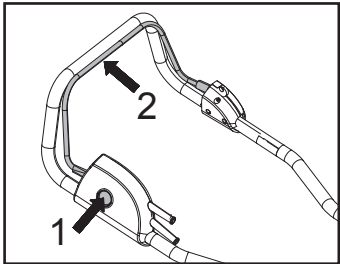

D

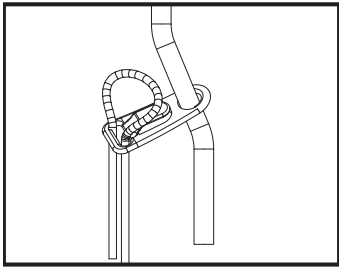

E1

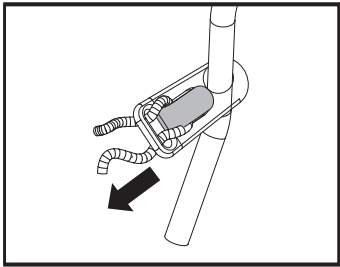

E2

**MAINTENANCE AND STORAGE**

**Attention: Before carrying out maintenance operations, disconnect power supply.**













- Clean dirt, grass, and other materials from the entire unit.
- Wipe the tines with oil or spray them with a silicone lubricant to prevent rusting.
- Oil the switch trigger cable and all visible moving parts.
- Order new parts to replace any that are badly worn or broken.
- Store in an upright position in a clean, dry place out of reach of children. Store with the handles in the extended position, or loosen handle knobs and fold the handles down. Do not allow fingers nor the switch trigger cable to become pinched when lowering the handlebar.
- During extended periods of storage, ensure that the tiller is protected against corrosion and frost.



model number 060-1809-8 | contact us: 1.866.523.5218

## TROUBLE SHOOTING

Problem	Possible causes	Remedy
Motor does not start	1. Unit not plugged.... 2. No Electricity 3. Defective Table... 4. Defective Safety Switch plug 5. Overheat Protection activated	Plug in the unit Check power supply Check cable. Repair or replace if required Arrange for repair 1. Working depth too large, set to a shorter depth. 2. Blades blocked, remove the blockage. 3. Soil too hard, select correct work depth and move forward and backward several times while slowing down the operation speed. Wait until the motor cools down for about 15 minutes before further use.
Abnormal noises	1. Blade is jammed 2. Lubrication running out 3. Bolts, nuts or other components are loose.	Switch off. Wait till tines comes to a complete stop. Remove jammed objects. Tiller must be repaired. Call our customer service help line. Tighten all components. Arrange for repair if noises continue.
Abnormal vibrations	1. Blades damaged or worn 2. Working depth too large	Replace damaged or worn blades. Set to correct working depth.
Poor results	1. Working depth too small	Set to correct working depth.

Symbol	Name	Designation/Explanation
V	Volts	Voltage
A	Amperes	Current
Hz	Hertz	Frequency (cycles per second)
W	Watts	Power
min	Minutes	Time
	Alternating Current	Type of current
	Direct Current	Type of current
	Class II Construction	Double-insulated construction
/min	Per Minute	Revolutions, strokes, surface speed, orbits etc., per minute.
	Read The Operator's Manual	To reduce the risk of injury, user must read instruction manual.
	Ear Protection	Wear ear protection.
		Wear eye protection.
	Operation condition	Do not expose to rain.
	Rotating tines	Danger – Keep hands and feet away from rotating tines. Rotating tines can cause severe injury.
		Read operator's manual
		Warning
		WARNING – Beware of sharp tines, keep fingers and toes away. Remove plug from mains before maintenance, adjusting, cleaning or if the cord is entangled or damaged. Tines continue to rotate after the motor is switched off
		Keep bystanders away



model number 060-1809-8 | contact us: 1.866.523.5218

## TWO-YEAR LIMITED WARRANTY

For Two(2) Years from the date of purchase within Canada, YARDWORKS CANADA will, at its option, repair or replace for the original purchaser, free of charge, any part or parts found to be defective in material or workmanship.

### THIS WARRANTY DOES NOT COVER

1. Any part that has become inoperative due to misuse, commercial use, abuse, neglect, accident, improper maintenance, or alteration;
2. The unit, if it has not been operated and/or maintained in accordance with the owner's manual;
3. Normal wear, Including but not limited to: Routine maintenance items such as lubricants, blade sharpening; or Normal deterioration of the exterior finish due to use or exposure.

### FULL ONE HUNDRED TWENTY (120) DAYS WARRANTY ON NORMAL WEAR PARTS

Normal wear parts are defined as blade adaptors, blades, grass bags and tires. These parts are warranted to the original purchaser to be free from defects in material and workmanship for a period of one hundred twenty (120) days from the date of retail purchase.

## HOW TO OBTAIN SERVICE

Warranty service is available by calling the toll-free helpline, at 1.866.523.5218. The factory will not accept the return of a complete unit unless prior written permission has been extended by YARDWORKS CANADA.

## TRANSPORTATION CHARGES

Transportation charges for the movement of any power equipment unit or attachment are the responsibility of the purchaser. The purchaser must pay transportation charges for any part submitted for replacement under this warranty unless such return is requested in writing by YARDWORKS CANADA.

## OTHER WARRANTIES

All other warranties, express or implied, including any implied warranty of merchantability is limited in its duration to that set forth in this express limited warranty. The provisions as set forth in this warranty provide the sole and exclusive remedy of YARDWORKS CANADA obligations arising from the sale of its products.

Made in China  
Imported by Yardworks Canada,  
Toronto Canada M4S 2B8

