

model no. 060-1551-8

MASTERCRAFTTM

BRUSHLESS GRASS TRIMMER

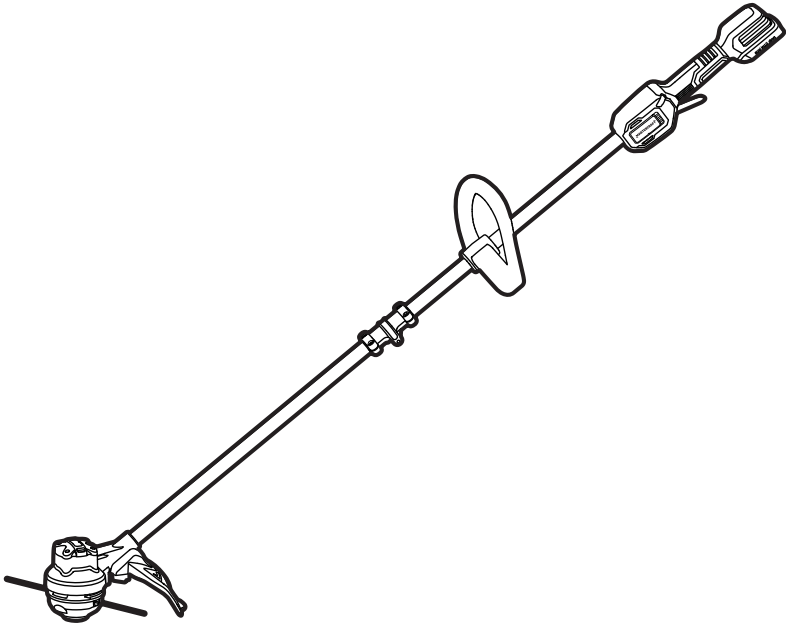

IMPORTANT:

Read and understand this instruction manual thoroughly before using the product.

**INSTRUCTION
MANUAL**

TABLE OF CONTENTS

Technical Specifications	4
Safety Guidelines	5
Key Parts Diagram	10
Operating Instructions	11
Maintenance	19
Troubleshooting	20
Parts List	21
Warranty	23

NOTE:

If any parts are missing or damaged, or if you have any questions, please call our toll-free helpline at 1-800-689-9928.



SAVE THESE INSTRUCTIONS

- This manual contains important safety and operating instructions. Read all instructions and follow them when using this product.

TECHNICAL SPECIFICATIONS

Rated Voltage	20 V d.c.
Maximum Speed	7,100 RPM
Cutting-line Type	0.08" (2 mm) twisted nylon line
Cutting Width	12" (30.5 cm)

*Maximum battery voltage without workload; with workload nominal voltage is 18 V.

SAFETY GUIDELINES:



WARNING!

Safety symbols in this Instruction Manual are used to flag possible dangers. The safety symbols and their explanations require your full understanding. The safety warnings do not, by themselves, eliminate any danger, nor are they substitutes for proper accident prevention measures.



WARNING!

This Safety Alert Symbol indicates caution, warning, or danger. Failure to obey a safety warning can result in serious injury to yourself or others. To reduce the risk of injury, fire, or electric shock, always follow the safety precautions.

KNOW YOUR TOOL

To operate this tool, carefully read this Instruction Manual and all labels affixed to the cordless string trimmer before using. Keep this instruction manual available for future reference.

IMPORTANT

This tool should only be serviced by a qualified service technician. For more information, call the toll-free helpline at 1-800-689-9928.

READ ALL INSTRUCTIONS THOROUGHLY.

SAVE THESE INSTRUCTIONS.

GENERAL POWER TOOL SAFETY WARNINGS



WARNING!

Read all safety warnings, instructions, illustrations and specifications provided with this power tool. Failure to follow all instructions listed below may result in electric shock, fire and/or serious injury.

SAVE ALL WARNINGS AND INSTRUCTIONS FOR FUTURE REFERENCE.

The term “power tool” in the warnings refers to your mains-operated (corded) power tool or battery-operated (cordless) power tool.

WORK AREA SAFETY

- **Keep work area clean and well lit.** Cluttered or dark areas invite accidents.
- **Do not operate power tools in explosive atmospheres, such as in the presence of flammable liquids, gases or dust.** Power tools create sparks which may ignite the dust or fumes.
- **Keep children and bystanders away while operating a power tool.** Distractions can cause you to lose control.
- **Avoid dangerous environments.** Don't use appliances in damp or wet locations.

PERSONAL SAFETY

- **Stay alert, watch what you are doing and use common sense when operating a power tool. Do not use a power tool while you are tired or under the influence of drugs, alcohol or medication.** A moment of inattention while operating power tools may result in serious personal injury.
- **Always use personal protective equipment.** Personal protective equipment such as eye protection, dust mask, non-skid safety shoes, hard hat and/or hearing protection used for appropriate conditions will reduce personal injuries.
- **Prevent unintentional starting. Ensure the switch is in the off-position before connecting to power source and/or battery pack, picking up or carrying the tool.** Carrying power tools with your finger on the switch or energising power tools that have the switch on invites accidents.
- **Remove any adjusting key or wrench before turning the power tool on.** A wrench or a key left attached to a rotating part of the power tool may result in personal injury.
- **Do not overreach. Keep proper footing and balance at all times.** This enables better control of the power tool in unexpected situations.
- **Dress properly. Do not wear loose clothing or jewellery. Keep your hair and clothing away from moving parts.** Loose clothes, jewellery or long hair can be caught in moving parts.
- **If devices are provided for the connection of dust extraction and collection facilities, ensure these are connected and properly used.** Use of dust collection can reduce dust-related hazards.
- **Do not let familiarity gained from frequent use of tools allow you to become complacent and ignore tool safety principles.** A careless action can cause severe injury within a fraction of a second.

POWER TOOL USE AND CARE

- **Do not force the power tool. Use the correct power tool for your application.** The correct power tool will do the job better and safer at the rate for which it was designed.
- **Do not use the power tool if the switch does not turn it on and off.** Any power tool that cannot be controlled with the switch is dangerous and must be repaired.
- **Disconnect the plug from the power source and/or remove the battery pack, if detachable, from the power tool before making any adjustments, changing accessories, or storing power tools.** Such preventive safety measures reduce the risk of starting the power tool accidentally.
- **Store idle power tools out of the reach of children and do not allow persons unfamiliar with the power tool or these instructions to operate the power tool.** Power tools are dangerous in the hands of untrained users.
- **Maintain power tools and accessories. Check for misalignment or binding of moving parts, breakage of parts and any other condition that may affect the power tool's operation. If damaged, have the power tool repaired before use.** Many accidents are caused by poorly maintained power tools.

- **Keep cutting tools sharp and clean.** Properly maintained cutting tools with sharp cutting edges are less likely to bind and are easier to control.
- **Use the power tool, accessories and tool bits, etc. in accordance with these instructions, taking into account the working conditions and the work to be performed.** Use of the power tool for operations different from those intended could result in a hazardous situation.
- **Keep handles and grasping surfaces dry, clean and free from oil and grease.** Slippery handles and grasping surfaces do not allow for safe handling and control of the tool in unexpected situations.
- **Keep cables away from the working area of the tool.** During operation cables may be hidden from view and can be accidentally damaged by the tool.

BATTERY TOOL USE AND CARE

- **Recharge only with the charger specified by the manufacturer.** A charger that is suitable for one type of battery pack may create a risk of fire when used with another battery pack.
- **Use power tools only with specifically designated battery packs.** Use of any other battery packs may create a risk of injury and fire.
- **When battery pack is not in use, keep it away from other metal objects, like paper clips, coins, keys, nails, screws or other small metal objects, that can make a connection from one terminal to another.** Shorting the battery terminals together may cause burns or a fire.
- **Under abusive conditions, liquid may be ejected from the battery; avoid contact. If contact accidentally occurs, flush with water. If liquid contacts eyes, seek additional medical help.** Liquid ejected from the battery may cause irritation or burns.
- **Do not use a battery pack or tool that is damaged or modified.** Damaged or modified batteries may exhibit unpredictable behaviour resulting in fire, explosion or risk of injury.
- **Do not expose a battery pack or tool to fire or excessive temperature.** Exposure to fire or temperature above 130°C (265°F) may cause an explosion.
- **Follow all charging instructions and do not charge the battery pack or tool outside the temperature range specified in the instructions.** Charging improperly or at temperatures outside the specified range may damage the battery and increase the risk of fire.

SERVICE

- **Have your power tool serviced by a qualified repair person using only identical replacement parts.** This will ensure that the safety of the power tool is maintained.
- **Never service damaged battery packs.** Service of battery packs should only be performed by the manufacturer or authorized service providers.

ADDITIONAL SAFETY GUIDELINES

- **The label on your tool may include the following symbols. The symbols and their definitions are as follows:**

V Volts

A Amperes

Hz Hertz

W Watts

min Minutes

~ Alternating current

— or d.c..... Direct current

 n_0 No-load speed

..... Class II Construction

RPM Revolutions per minute



..... WARNING – To reduce the risk of injury, user must read instruction manual.



..... WARNING – To reduce the risk of injury, always wear eye protection.



..... WARNING – To reduce the risk of injury, always wear ear protection.



..... The logo of UL certification

LISTED
GARDENING APPLIANCE
E490727**WARNING!**

To reduce the risk of electric shock or damage to the charger and battery, use only the Mastercraft® batteries and chargers listed.

BATTERY PACKS

054-3124-0, 054-7553-4, 054-7557-6

CHARGERS

054-3126-6, 054-7559-2

- **When replacing the cutting line, use no more than 0.08" (2.0 mm) nylon line;** using heavier lines than recommended by the manufacturer increases the load on the motor and reduces its operating speed. This results in overheating and damage to the trimmer.
- **To reduce the risk of serious injury, never use wire or metal-reinforced line or other material in place of the nylon cutting lines.** Pieces of wire could break off and be thrown at high speed toward the operator or bystanders.
- **Replace a cracked, damaged or worn-out cutting head immediately, even if damage is limited to superficial cracks.** Such attachments may shatter at high speed and cause serious or fatal injury.
- **For best results, your battery and tool should be stored, charged and used in a location where the temperature is more than 5°C (41°F) but less than 40°C (104°F).** Do not store outside or in vehicles.

- **If the power tool should start to vibrate abnormally or become noisy, stop the motor and check immediately for the cause.** Abnormal noise is generally a warning of trouble.
- **Make sure all proper guards and other safety devices are properly and securely attached before using this product. Do not operate without guards in place.**
- **Do not charge the battery pack in rain, or in wet locations.**
- **Do not open or mutilate the battery.** Released electrolyte is corrosive and may cause damage to the eyes or skin. It may be toxic if swallowed.
- **Battery tools do not have to be plugged into an electrical outlet; therefore, they are always in operating condition.** Be aware of possible hazards even when the tool is not operating. Take care when performing maintenance or service.
- **Do not wash with a hose; avoid getting water in motor and electrical connections.**
- **SAVE THESE INSTRUCTIONS.** Refer to them frequently and use them to instruct others who may use this tool. If you lend this tool to someone else, also lend these instructions to them to prevent misuse of the product and possible injury.

SAVE THESE INSTRUCTIONS!

PACKAGE CONTENTS:

Cordless grass trimmer, front-assist handle, guard, screw knob, bolt, hexagon screws (2), screw with washer (2) for the guard, wrench.

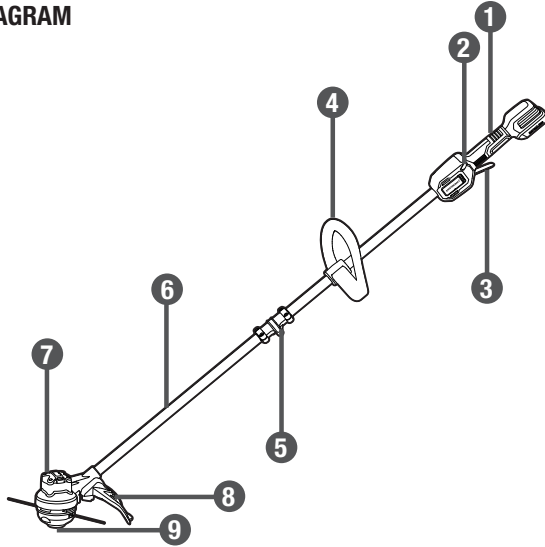
KEY PARTS DIAGRAM

No.	Description
1	Rear handle
2	Lock-off button
3	Variable-speed trigger switch
4	Front-assist handle
5	Hinge

No.	Description
6	Trimmer shaft
7	Trimmer head
8	Guard
9	Bump knob

Before attempting to use this tool, become familiar with all of its operating features and safety requirements. For optimum performance and safety, read the following operating instructions carefully before using.

**WARNING!**

- Remove the grass trimmer from the package and examine it carefully. Do not discard the carton or any packaging material until all parts have been examined.
- If any part of the grass trimmer is missing or damaged, do not attach the battery pack to the tool or use the tool until the part has been repaired or replaced. Failure to heed this warning could result in serious injury.
- Do not allow familiarity with the grass trimmer to cause a lack of alertness. A fraction of a second of carelessness is enough to cause severe injury.

OPERATING INSTRUCTIONS

UNFOLD THE SHAFT (fig 1-fig 2)

1. Remove the battery pack from the trimmer.
2. Put the trimmer on the ground and carefully unfold the shaft. Make sure that the cable is inside the shaft so that it will not be pinched when closing the joints.
3. Use the wrench (included) to lock the shaft with the hexagon screws supplied.

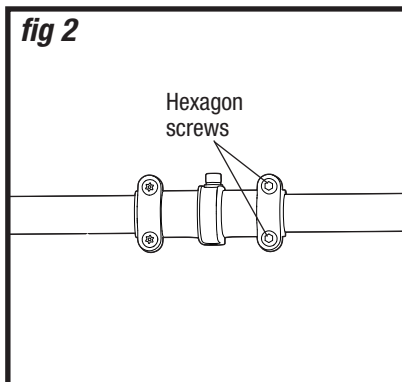
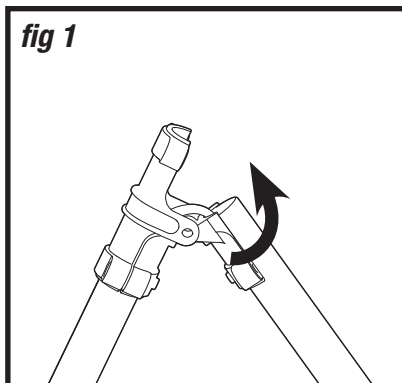

WARNING!

- Always take care to not allow the shaft to pinch the cable when you are unfolding or folding the string trimmer. Do not attempt to start the trimmer until the shaft has been locked.

NOTICE: To fold the shaft again, remove two hexagon screws near the rear handle side.

MOUNTING THE GUARD (fig 3-fig 4)

1. Remove the battery pack from the trimmer.
2. Lift the trimmer head and face it upward; align the groove on the bottom of the guard with the raised portion on the base of the trimmer head, and then slide the guard onto the base (fig 3).
3. Make sure that the two mounting holes in the guard are aligned with the two assembly holes in the base of the shaft. Insert a screw into each washer, and then lock the guard in place by tightening the two screws with the included wrench (fig 4).

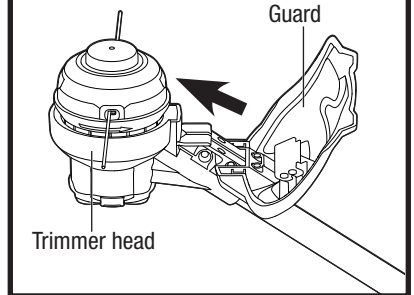
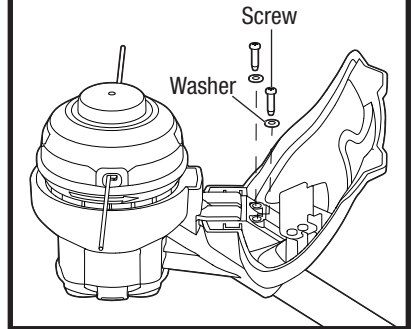
fig 3**fig 4****WARNING!**

- Always wear gloves when mounting or replacing the guard. Be careful of the blade on the guard and protect your hands from being injured by the blade.

MOUNTING THE FRONT-ASSIST HANDLE (fig 5)

1. Remove the battery pack from the trimmer.
2. Remove the screw knob and the bolt from the front-assist handle.
3. Press the front-assist handle onto the shaft of the grass trimmer. Make sure that the front-assist handle faces upward so that it points toward the top of the handle.
4. To attach the front-assist handle on the shaft, insert the bolt into the hole on the front-assist handle, and then use the screw knob to tighten the bolt.

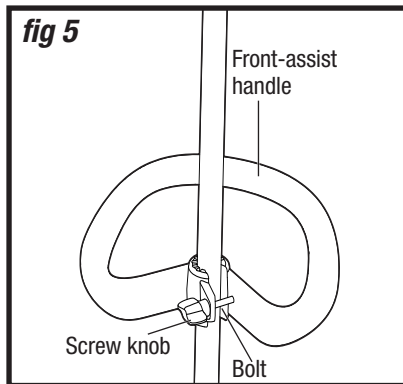

TO ADJUST THE FRONT-ASSIST HANDLE (fig 5)

The handle should be adjusted so that your front arm will be straight when using the trimmer. To adjust the front-assist handle position, loosen the screw knob so that the front-assist handle can be moved to the desired position of the shaft. Tighten the screw knob so that the handle cannot move on the shaft during operation.

TO ATTACH BATTERY PACK (fig 6)

1. Make sure that the switch is in the OFF position.
2. Align the raised portion on the battery pack with the grooves on the bottom of the tool, and then slide the battery pack onto the tool as shown.
3. Ensure that the battery-release button on the battery pack snaps into place and the battery pack is secured to the tool before beginning operation.

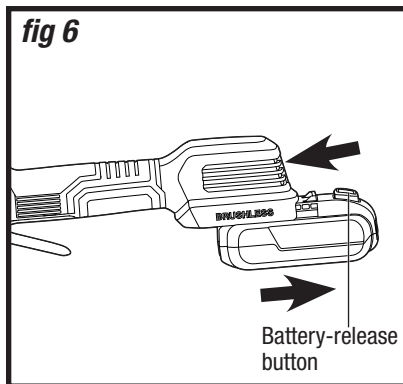

TO DETACH THE BATTERY PACK (fig 6)

1. Ensure that the switch is in the OFF position.
2. Depress the battery-release button located on the front of the battery pack to release the battery pack.
3. Pull rearward on the battery pack to remove it from the tool.

NOTICE: When placing a battery pack on the tool, be sure that the raised rib on the battery pack aligns with the groove on the string trimmer and the latches snap into place properly. Improper assembly of the battery pack can cause damage to internal components.



WARNING!

- To avoid the possibility of accidental starting, always take care not to activate the variable-speed trigger switch when you are attaching the battery pack or performing other adjustments to the tool.

HOLDING THE GRASS TRIMMER (fig 7)

Before operating the unit, stand in the operating position and check that:

- The operator is wearing eye protection and proper clothing.
- One arm is slightly bent, and the hand on that arm is holding the rear handle.
- The other arm is straight, with that hand holding the front-assist handle.
- The trimmer head is parallel to the ground and easily contacts the material to be cut without the operator having to bend over.

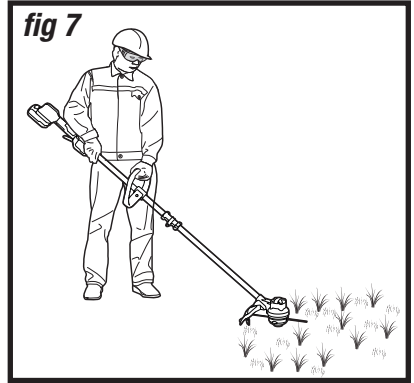
**WARNING!**

- Dress properly to reduce the risk of injury when operating this tool. Do not wear loose clothing or jewellery. Wear eye and ear/hearing protection. Wear heavy, long pants, boots, and gloves. Do not wear short pants or sandals or go barefoot.

TO START/STOP THE GRASS TRIMMER (fig 8)

Before starting the grass trimmer:

- Make sure that you have a secure and balanced footing.
- Stand upright and hold the grass trimmer in a relaxed position.
- Make sure that the cutting line is not touching the ground or any other objects.
- Hold the grass trimmer with both hands: one hand on the rear handle and the other hand on the front-assist handle.

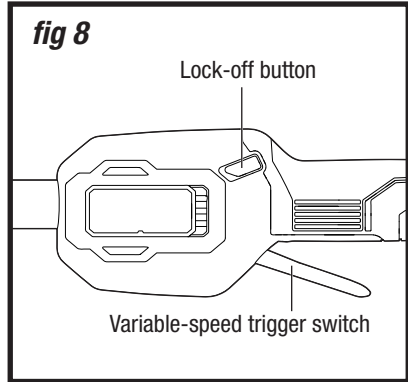

1. To turn the grass trimmer on, press the lock-off button and then depress the variable-speed trigger switch.
2. The variable-speed trigger switch delivers higher speed with increased trigger pressure and lower speed with decreased trigger pressure.
3. To turn the grass trimmer off, release the variable-speed trigger switch and allow the trimmer to come to a complete stop.

TIPS FOR USING THE GRASS TRIMMER (fig 9)

- To avoid serious personal injury, wear safety glasses, face mask, proper clothing and footwear at all times when operating this unit.
- Clear the area to be cut before each use. Remove all objects, such as rocks, broken glass, nails, wire, or string, that can be thrown or become entangled in the cutting attachment.
- The correct angle for the cutting attachment is parallel to the ground.
- Do not force the trimmer. Allow the very tip of the line to do the cutting (especially along walls). Cutting with more than the tip of the line will reduce cutting efficiency and may overload the motor.
- Grass over 8" (20 cm) should be cut by working from top to the bottom in small increments to avoid premature line wear or motor drag.
- Slowly move the trimmer into and out of the area being cut while maintaining the cutting head position at the desired cutting height. Cutting shorter lengths produces best results.
- Trim only when grass and weeds are dry.
- Avoid trees and shrubs. Tree bark, wood moldings, siding, and fence posts can easily be damaged by the strings.

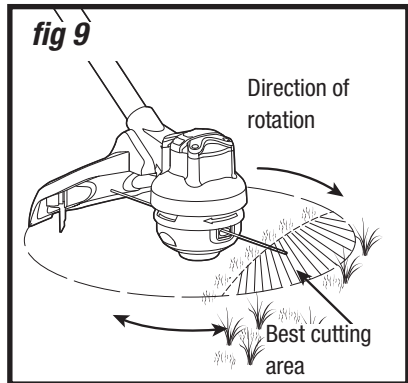

ADJUSTING THE CUTTING LINE LENGTH
(fig 10)

The trimmer head allows the operator to release more cutting line without stopping the motor. As line becomes frayed or worn, additional line can be released by lightly tapping the bump knob on the ground while operating the trimmer.

For best results, tap the bump knob on bare ground or hard soil. If line release is attempted in tall grass, the motor may overheat.

Always keep the trimming line fully extended. Line release becomes more difficult as the cutting line becomes shorter.

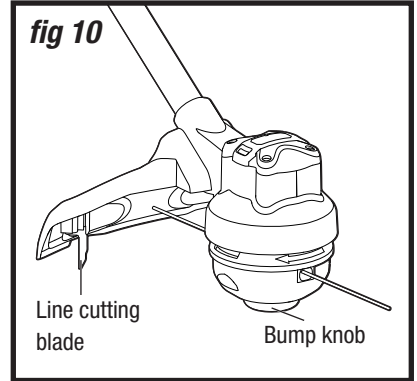
**WARNING!**

- Do not remove or alter the line cutting blade assembly. Excessive line length will cause the motor to overheat and may result in serious personal injury.

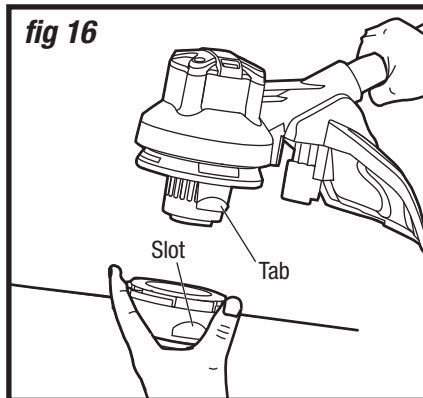
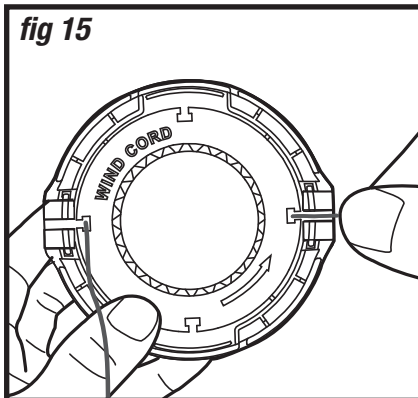
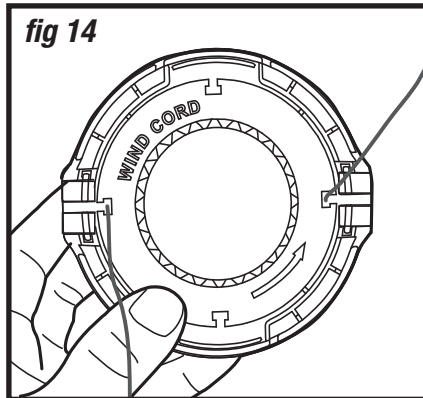
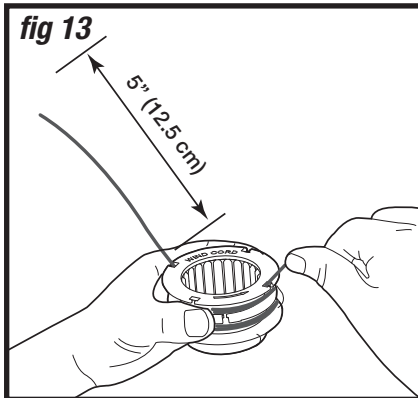
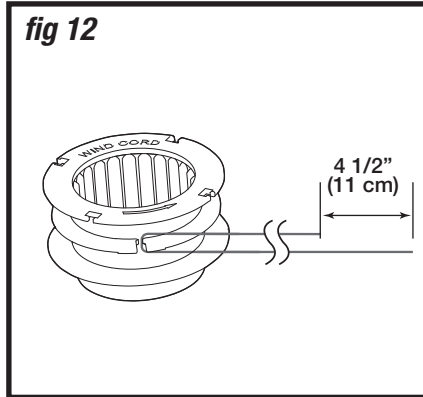
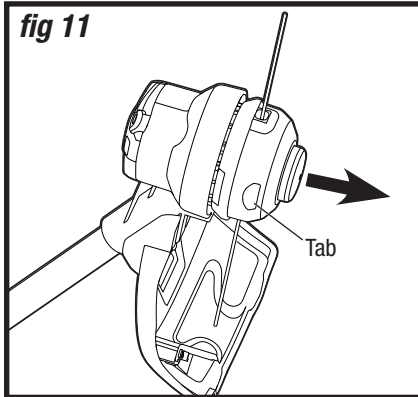
WIND THE SPOOL WITH NEW LINE (fig 11-fig 16)

1. Press the two release tabs on the spool base and remove the spool retainer by pulling it straight out (*fig 11*).
2. Remove the spool. Use a clean cloth to clean the inner surfaces of the spool retainer and spool base.
3. Check the spool retainer, spool, and spool base for worn parts.
4. Take approximately 15' (4.5 m) of 0.08" (2.0 mm) diameter cutting line. Fold the line in half and then adjust it so that one end is 4 1/2" (11 cm) longer than the other (*fig 12*).
5. Hook the folded end of the cutting line onto either of the slots in the spool.
6. Wind the line, in two even and tight layers, onto the spool. Wind the line in the direction indicated on the spool.
7. Place the ends of the line in the two opposite notches in the spool, with approximately 5" (12.5 cm) protruding from each side (*fig 13*).
8. Align the notches of the spool from which the lines protrude with the eyelets in the spool retainer and position the spool in the retainer (*fig 14*).
9. Holding the spool and spool retainer, grasp one end of the line and pull it to release the line from the notch in the eyelet (*fig 15*). Repeat with the other end.
10. With the spool base facing downward, align the slots in the spool retainer with the tabs on the spool base and press the retainer evenly down until it snaps into place (*fig 16*).

NOTICE:

- Always clean the spool retainer and spool base before reassembling the trimmer head.
- Failure to wind the line in the direction indicated will cause the trimmer head to operate incorrectly.
- Make sure that the tabs on the spool base snap into place or the spool will come out during operation.
- After each line replacement, tap the bump knob on the ground several times to check whether the cutting line can be released normally before trimming grass.

MAINTENANCE

CHECK FOR DAMAGED/WORN PARTS BEFORE EACH USE

Check the bump head, guard, and front-assist handle, and replace any parts that are cracked, warped, bent, or damaged in any way. The line-cutting blade on the edge of the guard can dull over time. It is recommended that you periodically sharpen it with a file or replace it with a new blade.

CLEAN THE TRIMMER AFTER EACH USE

1. Clear any grass that may have wrapped itself around the motor shaft or trimmer head.
2. Use only a clean, dry and soft cloth to clean the tool. Never let any liquid get inside the tool; never immerse any part of the tool into a liquid.
3. Always keep the air vents in the rear housing free from debris.

STORAGE

Clean the tool thoroughly before storing it. Store the unit in a dry, well-ventilated area, locked-up or up high, and out of the reach of children. Keep away from corrosive agents, such as garden chemicals and de-icing salts.



WARNING!

- Do not let brake fluids, gasoline, petroleum-based products, penetrating oil, etc., come into contact with plastic parts. These substances contain chemicals that can damage, weaken, or destroy plastic.
- When servicing, use only identical replacement parts. The use of any other parts may create a hazard or cause damage to the product.
- Use only accessories that are recommended for this string trimmer by the manufacturer. Accessories that may be suitable for one tool may become hazardous when used with another tool.
- To ensure safety and reliability, all repairs should be performed by a qualified service technician.

TROUBLESHOOTING

Problem	Possible causes	Solutions
The trimmer does not work.	The battery pack is depleted.	Charge the battery pack.
	The motor shaft or trimmer head is bound with grass.	Stop the trimmer, remove the battery, and remove the grass from the motor shaft and trimmer head.
	The motor is overloaded.	Remove the trimmer head from the grass and restart the tool. Move the trimmer head to cut the grass no more than 8" (20 cm) of length in a single cut.
Trimmer head will not advance line.	The battery pack or string trimmer is too hot.	Release the trigger switch, wait for the tool to cool down, and then start the tool again.
	The motor shaft or trimmer head is bound with grass.	Stop the trimmer, remove the battery, and clean the motor shaft and trimmer head.
	There is not enough line on the spool.	Remove the battery and replace the cutting line; follow the section "WIND THE SPOOL WITH NEW LINE" in this manual.

If the problem remains unsolved after performing the checks described above, call the toll-free helpline at 1-800-689-9928.

EXPLODED VIEW

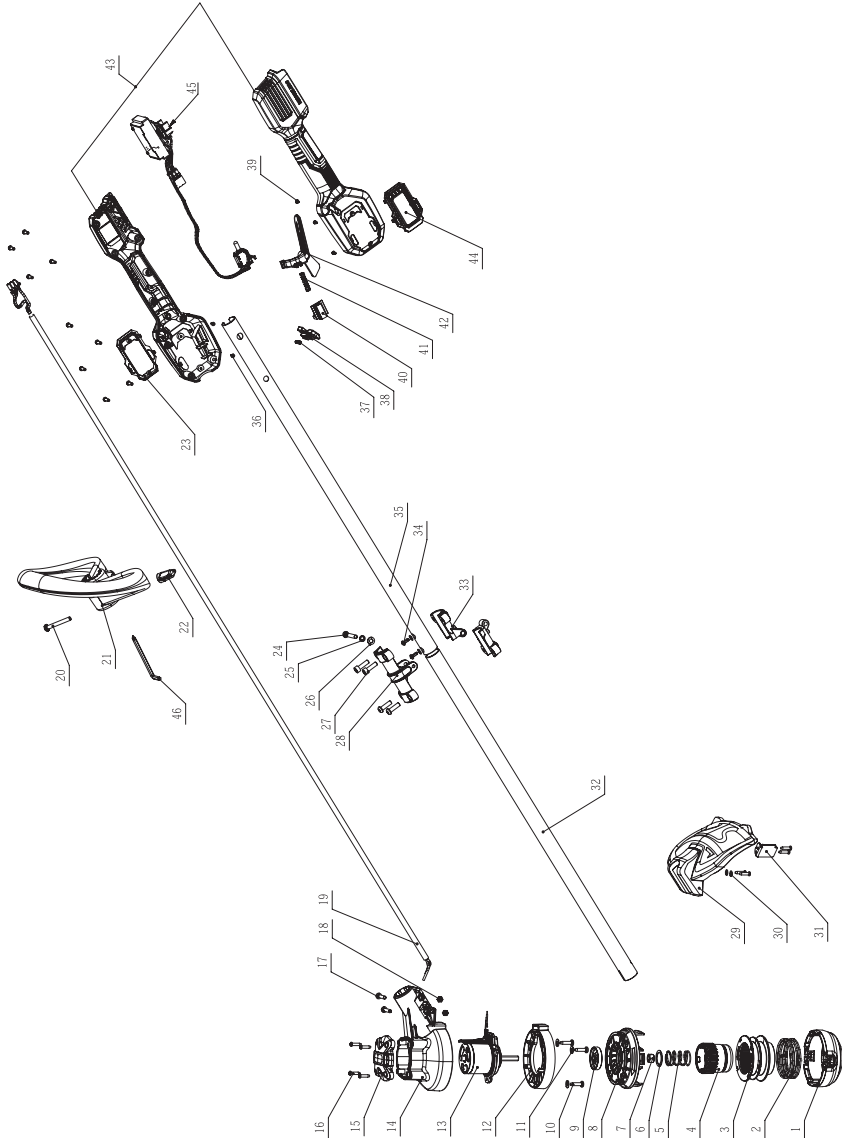

No.	Part No.	Description	No.	Part No.	Description
1	2824019000	Lower Housing Assembly	24	5620512000	Hexagon Socket Screw
2	3800123000	Trimmer Line	25	5650020000	Spring Washer
3	3127635000	Mounting Wire Holder	26	5650016000	Plain Washer
4	2824022000	Support Head Assembly	27	5620334000	Hexagon Socket Screw
5	3660582000	Compression Spring	28	3422219000	Connecting Tube
6	5650349000	Washer	29	3129574000	Guard
7	5630271000	Nut	30	5650005000	Plain Washer
8	2824497000	Upper Housing Assembly	31	3704344000	Blade
9	3520800000	Outer Flange	32	3706622000	Connecting Tube
10	5610055000	Tapping Screw	33	3422218000	Connecting Tube
11	5650396000	Washer	34	5610097000	Thread Forming Screw
12	3128752000	Shield	35	3706621000	Connecting Tube
13	2730277000	DC Motor	36	5610010000	Tapping Screw
14	3129576000	Motor Housing	37	3660124000	Spring
15	3129575000	Rear Cover	38	3129615000	Lock Button
16	5610294000	Tapping Screw	39	5620176000	Screw with Washer
17	5620052000	Screw	40	3128797000	Sliding Block
18	5630007000	Prevailing Torque Hexagon Nut	41	3660348000	Spring
19	4860300000	Internal Wire Assembly	42	3129614000	Switch Trigger
20	5640243000	Hexagon Head Bolt	43	3900226000	L R Housing Set
21	3129573000	Front Handle	44	3130557000	Left Cover
22	3402297000	Wing Nut	45	2830604000	Electric Assembly
23	3127462000	Right Cover	46	5680186000	Inner Hexagon Spanner

If any parts are missing or damaged, or if you have any questions, please call the toll-free helpline at 1-800-689-9928.



This product is guaranteed for a period of **3 years from the date of original retail purchase** against defects in workmanship and materials, except for the following components:

- a) Component A: Batteries, chargers and carrying case, which are guaranteed for a period of 2 years from the date of original retail purchase against defects in workmanship and materials;
- b) Component B: Accessories, which are guaranteed for a period of 1 year from the date of original retail purchase against defects in workmanship and materials.

Subject to the conditions and limitations described below, this product, if returned to us with proof of purchase within the stated warranty period and if covered under this warranty, will be repaired or replaced (with the same model, or one of equal value or specification), at our option. We will bear the cost of any repair or replacement and any costs of labour relating thereto.

These warranties are subject to the following conditions and limitations:

- a) a bill of sale verifying the purchase and purchase date must be provided;
- b) this warranty will not apply to any product or part thereof which is worn or broken or which has become inoperative due to abuse, misuse, accidental damage, neglect or lack of proper installation, operation or maintenance (as outlined in the applicable owner's manual or operating instructions) or which is being used for industrial, professional, commercial or rental purposes;
- c) this warranty will not apply to normal wear and tear or to expendable parts or accessories that may be supplied with the product that are expected to become inoperative or unusable after a reasonable period of use;
- d) this warranty will not apply to routine maintenance and consumable items such as, but not limited to, fuel, lubricants, vacuum bags, blades, belts, sandpaper, bits, fluids, tune-ups or adjustments;
- e) this warranty will not apply where damage is caused by repairs made or attempted by others (i.e., persons not authorized by the manufacturer);
- f) this warranty will not apply to any product that was sold to the original purchaser as a reconditioned or refurbished product (unless otherwise specified in writing);
- g) this warranty will not apply to any product or part thereof if any part from another manufacturer is installed therein or any repairs or alterations have been made or attempted by unauthorized persons;

- h) this warranty will not apply to normal deterioration of the exterior finish, such as, but not limited to, scratches, dents, paint chips, or to any corrosion or discolouring by heat, abrasive and chemical cleaners; and
- i) this warranty will not apply to component parts sold by and identified as the product of another company, which shall be covered under the product manufacturer's warranty, if any.

Additional Limitations

This warranty applies only to the original purchaser and may not be transferred. Neither the retailer nor the manufacturer shall be liable for any other expense, loss or damage, including, without limitation, any indirect, incidental, consequential or exemplary damages arising in connection with the sale, use or inability to use this product.

Notice to Consumer

This warranty gives you specific legal rights, and you may have other rights, which may vary from province to province. The provisions contained in this warranty are not intended to limit, modify, take away from, disclaim or exclude any statutory warranties set forth in any applicable provincial or federal legislation.

Made in China

Imported by

Mastercraft Canada Toronto, Canada M4S 2B8