

# MASTERCRAFT™/MC

## CORDLESS BRUSHLESS LAWN MOWER 060-1337-0

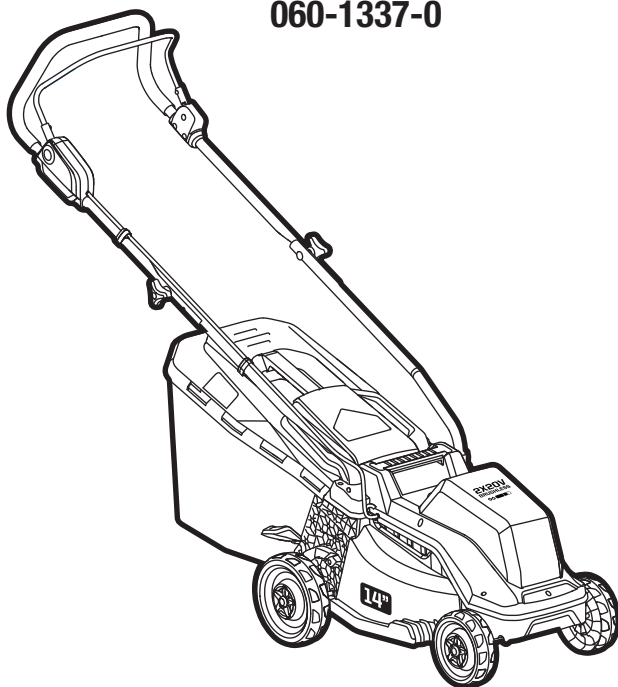

### **IMPORTANT:**

Read and understand this instruction manual thoroughly before using the product.

## **INSTRUCTION MANUAL**



## TABLE OF CONTENTS

Technical Specifications	4
Safety Guidelines	5
Key Parts Diagram	13
Operating Instructions	14
Maintenance	18
Troubleshooting	20
Parts List	22
Warranty	24

### NOTE:

If any parts are missing or damaged, or if you have any questions, please call our toll-free helpline at 1-800-689-9928.



### SAVE THESE INSTRUCTIONS

- This manual contains important safety and operating instructions. Read all instructions and follow them with use of this product.

**TECHNICAL SPECIFICATIONS**

Rated Voltage	40 V d.c.
Deck Size	14" (35.6 cm)
No-load Speed	3300 /min at low speed 3800 /min at high speed
Cutting height	1 to 3" (2.5 to 7.6 cm)

Recommend using tool with Mastercraft® and PWR POD™ 20 V Lithium-ion 4.0 Ah battery (054-7557-6 and 054-7564-8; sold separately) for optimal performance.

**COMPATIBLE BATTERIES AND CHARGERS**

Brand	Battery Pack	Charger
PWR POD™	2.0 Ah: 054-7563-0 4.0 Ah: 054-7564-8 5.0 Ah: 054-7558-4 8.0 Ah: 054-7569-8	45 W Charger: 054-3126-6 90 W Fast Charger: 054-7565-6 Dual-Port Charger: 054-7567-2 4 Port Fast Charger: 054-7571-0 150 W Fast Charger: 054-7570-2
Mastercraft®	2.0 Ah: 054-7553-4 4.0 Ah: 054-7557-6 5.0 Ah: 054-2434-8	90 W Fast Charger: 054-7559-2 60 W x2 Dual-Port Charger: 054-8299-4

Batteries with an Ah of 4.0 or higher are recommended for optimal runtime and performance.

**NOTICE:** The mower needs two 20 V max\* batteries to work.

### SAFETY GUIDELINES:



#### WARNING!

Safety symbols in this Instruction Manual are used to flag possible dangers. The safety symbols and their explanations require your full understanding. The safety warnings do not, by themselves, eliminate any danger, nor are they substitutes for proper accident prevention measures.



#### WARNING!

When using electric lawn mowers, basic safety precautions should always be followed to reduce the risk of fire, electric shock, and personal injury.

### KNOW YOUR TOOL

To operate this tool, carefully read this Instruction Manual and all labels affixed to the lawn mower before using. Keep this instruction manual available for future reference.

### IMPORTANT

This tool should only be serviced by a qualified service technician. For more information, call the toll-free helpline at 1-800-689-9928. This machine is capable of amputating hands and feet and throwing objects. Failure to observe the following safety instructions could result in serious injury or death.

### READ ALL INSTRUCTIONS THOROUGHLY.

### SAVE THESE INSTRUCTIONS.

### LAWNMOWER SAFETY WARNINGS



#### WARNING!

**Read all safety warnings, instructions, illustrations and specifications provided with this power tool.** Failure to follow all instructions listed below may result in electric shock, fire and/or serious injury.

### SAVE ALL WARNINGS AND INSTRUCTIONS FOR FUTURE REFERENCE.

### WORK AREA SAFETY

- **To avoid bystander contact with the moving blade or a thrown object injury, keep the area of operation clear of all bystanders, particularly small children. Stop the lawnmower and any attachment(s) if anyone enters the area.** Contact with the moving blade or thrown objects may result in serious personal injury or death.
- **Only operate the lawnmower in daylight or good artificial light.** Dark areas invite accidents.
- **Do not operate lawnmowers in explosive atmospheres, such as in the presence of flammable liquids, gases or dust.** Lawnmowers create sparks which may ignite the dust or fumes.

- **Do not use the lawnmower in bad weather conditions, especially when there is a risk of lightning.** This decreases the risk of being struck by lightning.
- **Thoroughly inspect the area where the lawnmower is to be used, and remove all stones, sticks, wires, bones, and other foreign objects.** Thrown objects can cause personal injury.

## ELECTRICAL SAFETY

- **Do not expose the lawnmower to rain or wet conditions.** Water entering a lawnmower may increase the risk of electric shock.

## PERSONAL SAFETY

- **Use personal protective equipment. Always wear eye protection.** Protective equipment will reduce personal injuries.
- **Dress properly. Do not wear loose clothing or jewellery. Keep your hair and clothing away from moving parts.** Loose clothes, jewellery or long hair can be caught in moving parts.
- **While operating the lawnmower, always wear long trousers.** Exposed skin increases the likelihood of injury from thrown objects.
- **While operating the lawnmower, always wear non-slip and protective footwear. Do not operate the lawnmower when barefoot or wearing open sandals.** This reduces the chance of injury to the feet from contact with the moving blade.
- **Prevent unintentional starting. Ensure the switch is in the off-position before connecting to power source and/or batteries, picking up or carrying the lawnmower.** Carrying a lawnmower with your finger on the switch or energising a lawnmower that has the switch on invites accidents.
- **Remove any adjusting key or wrench before turning the lawnmower on.** A wrench or a key left attached to a rotating part of the lawnmower may result in personal injury.
- **Keep proper footing and balance at all times.** This enables better control of the lawnmower in unexpected situations.
- **Stay alert, watch what you are doing and use common sense when operating a lawnmower. Do not use a lawnmower while you are tired or under the influence of drugs, alcohol or medication.** A moment of inattention while operating a lawnmower may result in serious personal injury.
- **Do not let familiarity gained from frequent use of lawnmower allow you to become complacent and ignore lawnmower safety principles.** A careless action can cause severe injury within a fraction of a second.
- **To avoid operator blade contact or a thrown object injury, stay in the operator zone behind the lawnmower handles.** Blade contact or thrown objects may result in serious personal injury.
- **Do not touch blades and other hazardous moving parts while they are still in motion.** This reduces the risk of injury from moving parts.

### LAWNMOWER USE AND CARE

- **Use the lawnmower and accessories in accordance with these instructions, taking into account the working conditions and the work to be performed.** Use of the lawnmower for operations different from those intended may result in a hazardous situation.
- **Before using the lawnmower, always visually inspect to see that the blade(s) and the blade(s) assembly are properly secured and not worn or damaged.** Loose, worn, or damaged parts may increase the risk of injury.
- **Keep guards and other safety devices in place, properly mounted, and in working order.** A guard or other safety device that is loose, damaged, or is not functioning correctly may result in personal injury.
- **Keep all cooling air inlets clear of debris.** Blocked air inlets and debris may result in overheating or risk of fire.
- **Do not use the lawnmower if the switch does not turn it on and off.** Any lawnmower that cannot be controlled with the switch is dangerous and must be repaired.
- **Do not operate the lawnmower in wet grass. Walk, never run.** This reduces the risk of slipping and falling which may result in personal injury.
- **Do not operate the lawnmower on excessively steep slopes.** This reduces the risk of loss of control, slipping and falling which may result in personal injury.
- **Do not force the lawnmower. Use the correct lawnmower for your application.** The correct lawnmower will do the job better and safer at the rate for which it was designed.
- **Be aware of the mower and attachment discharge direction and do not point the mower discharge at anyone.** Thrown objects can cause personal injury.
- **Use extreme caution when reversing or pulling the lawnmower towards you. Always be aware of your surroundings.** This reduces the risk of tripping during operation.
- **When working on slopes, always be sure of your footing; always work across the face of slopes, never up or down, and exercise extreme caution when changing direction.** This reduces the risk of loss of control, slipping or falling which may result in personal injury.
- **Operate the disabling device and/or remove all battery packs, if removable, from the lawnmower before making any adjustments, changing accessories, or storing the lawnmower.** Such preventive safety measures reduce the risk of starting the lawnmower accidentally.
- **Keep handles and grasping surfaces dry, clean and free from oil and grease.** Slippery handles and grasping surfaces do not allow for safe handling and control of the lawnmower in unexpected situations.
- **Check the grass catcher frequently for wear or deterioration.** A worn or damaged grass catcher may increase the risk of personal injury.

- **Before removing the grass collection bag, turn off the motor and wait until the blade comes to a complete stop. The cutting blade continues to rotate after the blade control is released. Never place any part of the body in the blade area until you are certain the motor is off and the blade has stopped rotating.** Contact with the moving cutting blade may result in serious personal injury.
- **Before unclogging the chute, turn off the motor, wait until the blade comes to a complete stop, and operate the disabling device and/or remove all batteries, if removable. The cutting blade continues to rotate after the blade control is released. Never place any part of the body in the blade area until you are certain the motor is off and the blade has stopped rotating.** Contact with the moving cutting blade may result in serious personal injury.
- **Before cleaning or inspecting the lawnmower, turn off the motor, wait until the blade comes to a complete stop, and operate the disabling device and/or remove all batteries, if removable.** Accidental contact with the moving blade and moving parts may result in personal injury.
- **Maintain the lawnmower and accessories. Check for misalignment or binding of moving parts, breakage of parts and any other condition that may affect the lawnmower's operation. If damaged, have the lawnmower repaired before use.** Many accidents are caused by poorly maintained lawnmowers.
- **Store idle lawnmowers out of the reach of children and do not allow persons unfamiliar with the lawnmower or these instructions to operate the lawnmower.** Lawnmowers are dangerous in the hands of untrained users.

## BATTERY LAWNMOWER USE AND CARE

- **Use lawnmowers only with specifically designated battery packs.** Use of any other battery packs may create a risk of injury and fire.
- **Recharge only with the charger specified by the manufacturer.** A charger that is suitable for one type of battery pack(s) may create a risk of fire when used with another battery pack(s).
- **Follow all charging instructions and do not charge the battery pack(s) outside the temperature range specified in the instructions.** Charging improperly or at temperatures outside the specified range may damage the battery and increase the risk of fire.
- **Do not use a battery pack or lawnmower that is damaged or modified.** Damaged or modified batteries may exhibit unpredictable behaviour resulting in fire, explosion or risk of injury.
- **Do not expose a battery pack(s) or lawnmower to fire or excessive temperature.** Exposure to fire or temperature above 265°F(130°C) may cause explosion.
- **Under abusive conditions, liquid may be ejected from the battery(ies); avoid contact. If contact accidentally occurs, flush with water. If liquid contacts eyes, additionally seek medical help.** Liquid ejected from the battery(ies) may cause irritation or burns.
- **When battery packs are not in use, keep them away from other metal objects, like paper clips, coins, keys, nails, screws or other small metal objects, that can make a connection from one terminal to another.** Shorting the battery terminals together may cause burns or a fire.



### SERVICE

- **Have your lawnmower serviced by a qualified repair person using only identical replacement parts. This will ensure that the safety of the lawnmower is maintained.** Use of parts which do not meet the original equipment specifications may lead to improper performance and compromise safety.
- **Never service damaged battery packs.** Service of battery packs should only be performed by the manufacturer or authorized service providers.

### ADDITIONAL RULES FOR LAWNMOWER

- The user is responsible for accidents or hazards occurring to other people or their property. Be familiar with the controls and the proper use of the machine.
- Before using, always visually inspect to see that the blade and blade bolt are not worn or damaged. Replace worn or damaged blade and bolt in sets to preserve balance. Keep all nuts, bolts and screws tight to be sure the product is in safe working condition.
- Check the functioning of the machine before each use and, in case of a defect, have it repaired immediately by a qualified person; never open the machine yourself.
- Never operate the machine with a defective rear guard or defective grass catcher. When operating the machine without grass catcher, ensure that the rear guard is in closed position (risk of injury caused by rotating cutting blade).
- Always switch off the machine, remove battery pack(s), and ensure that all moving parts have come to a complete standstill:
  - whenever leaving the machine unattended;
  - before clearing jammed material;
  - before checking, cleaning or working on the machine;
  - after striking a foreign which then requires inspecting the machine for damage and making repairs before restarting and operating the machine; or
  - if the machine starts to vibrate abnormally. Immediately inspect for damage, replace or repair any damaged parts and to check for and tighten any loose parts.
- Always keep hands and feet away from rotating parts.
- Keep away from the discharge opening at all times.
- Switch on the motor according to instructions and with feet well away from the cutting blade.
- Never mow in the direct vicinity of persons (especially children) and animals.
- Stop the cutting blade if the product has to be tilted for transportation when crossing surfaces other than grass, and when transporting the product to and from the area to be used.
- Do not tilt the product when switching on the motor, except if the product has to be tilted for starting. In this case, do not tilt it more than absolutely necessary, and lift only the part which is away from the operator.

- Be careful during adjustment of the product to prevent entrapment of the fingers between moving blade and fixed parts of the product.
- Always allow the machine to cool down before storing.
- When servicing the blade be aware that, even though the power source is switched off, the blade can still move.
- Check for accumulation near the cutting blade to prevent blockage; keep the cutting blade and mower deck clean. Remove grass clippings, leaves, dirt and any other accumulated debris before and after each use.
- When blockage happens, stop the mower and remove the battery pack(s), then remove any buildup of grass and leaves on or around the drive shaft and motor fan (do not use water). Wipe the mower clean with a damp cloth.
- Empty the grass bag before storage.
- Never use the machine when handle cord is damaged; have it replaced by a qualified person.
- Follow all cleaning and maintenance instructions before storing.

The label on your tool may include the following symbols. The symbols and their definitions are as follows:

V ..... Volts

A ..... Amperes

Hz ..... Hertz

W ..... Watts

min ..... Minutes

— or d.c. .... Direct current

$n_0$  ..... No-load speed

RPM ..... Revolutions per minute



..... WARNING – To reduce the risk of injury, user must read instruction manual.



..... WARNING – To reduce the risk of injury, always wear eye protection.



..... WARNING – To reduce the risk of injury, always wear ear protection.



..... Keep hands away.



..... Beware of thrown objects. Keep bystanders away.



..... Switch off and remove detachable battery pack (or disabling device) before adjusting or cleaning.



..... Keep hands and feet away from the blades.



..... Do not mow slopes greater than 15 degrees.



**WARNING!**

To reduce the risk of electric shock or damage to the charger and battery, use only the Mastercraft® and PWR POD™ batteries and chargers listed.

Brand	Battery Pack	Charger
PWR POD™	2.0 Ah: 054-7563-0 4.0 Ah: 054-7564-8 5.0 Ah: 054-7558-4 8.0 Ah: 054-7569-8	45 W Charger: 054-3126-6 90 W Fast Charger: 054-7565-6 Dual-Port Charger: 054-7567-2 4 Port Fast Charger: 054-7571-0 150 W Fast Charger: 054-7570-2
Mastercraft®	2.0 Ah: 054-7553-4 4.0 Ah: 054-7557-6 5.0 Ah: 054-2434-8	90 W Fast Charger: 054-7559-2 60 W x2 Dual-Port Charger: 054-8299-4

Batteries with an Ah of 4.0 or higher are recommended for optimal runtime and performance.

- **For best results, your battery and tool should be stored and used in a location where the temperature is more than 5°C (41°F) but less than 40°C (104°F).** Do not store outside or in vehicles.
- **Do not wash the mower with a hose. Avoid getting water in the motor and electrical connections.**
- **To reduce a fire hazard, keep the motor cover free of grass, leaves and debris build-up.**
- **Please refer to the battery pack and charger manuals for detailed operating information.**

**SAVE THESE INSTRUCTIONS!**

## PACKAGE CONTENTS:

Lawn mower, cable clamps (X2), grass collection bag, bolts (X2), knobs (X2), washers (X2), upper handle bar, mulching insert (installed on the mower)

## KEY PARTS DIAGRAM

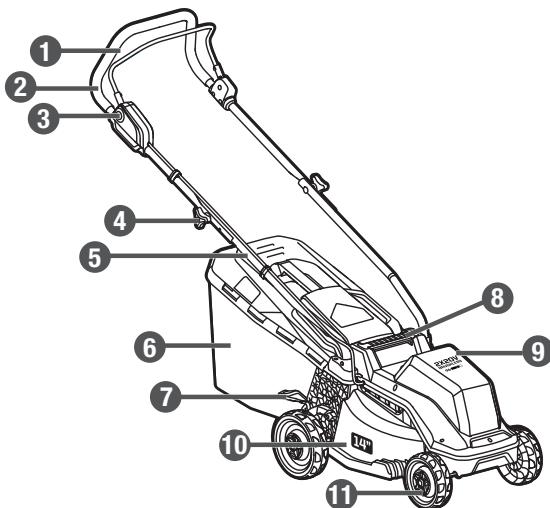

## KEY PARTS DIAGRAM

No.	Description
1	Start Lever
2	Upper Handle Bar
3	Lock-off Switch
4	Locking Knob
5	Lower Handle Bar
6	Grass Collection Bag

No.	Description
7	Cutting-height Adjustment Lever
8	Lift Handle
9	Battery Compartment
10	Deck
11	Wheel

Before attempting to use this tool, become familiar with all of its operating features and safety requirements. For optimum performance and safety, read the following operating instructions carefully before using.



### WARNING!

- Remove the lawn mower from the package and examine it carefully. Do not discard the carton or any packaging material until all parts have been examined.
- If any part of the lawn mower is missing or damaged, do not attach the battery pack to the tool or use the tool until the part has been repaired or replaced. Failure to heed this warning could result in serious injury.

## OPERATING INSTRUCTIONS

### ASSEMBLE THE LOWER HANDLE BAR (fig. 1)

1. Insert the lower handle bar into the upper housing.
2. Rotate till the hole on the lower handle bar is aligned with hole on the upper housing.
3. Use a cross-head screwdriver to fix a screw into the lower handle bar and the upper housing.
4. Repeat and install the other handle bar.

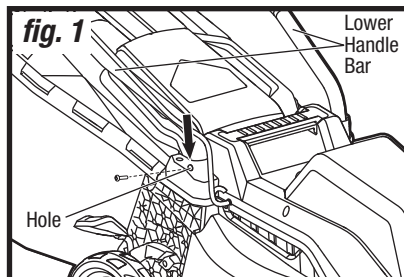

### INSTALL THE UPPER HANDLE BAR (fig. 2)

1. Align the holes on the upper handle bar with the holes on the lower handle bar.
2. Insert the locking knob with washers into the holes and nuts and then turn the locking knob clockwise to lock the upper handle bar onto the lower handle bar.

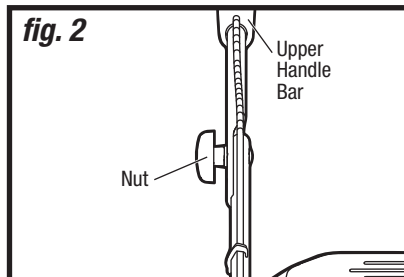

### CABLE CLAMP (fig. 3)

This mower is equipped with cable clamps. Simply press the cable clamps onto the bar, and then the cable can be fixed onto the upper handle bar.

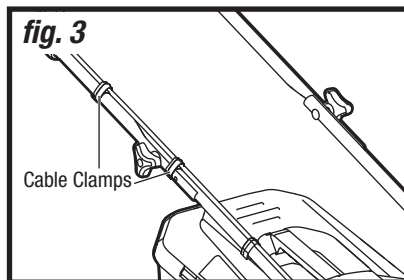

## ATTACH/REMOVE THE MULCHING INSERT (fig. 4)

1. Lift the rear-discharge door and insert the mulching insert into the grass outlet of the mower. Then release the rear-discharge door.
2. To remove, lift the rear-discharge door and just pull the mulching insert out directly. Then release the rear-discharge door.

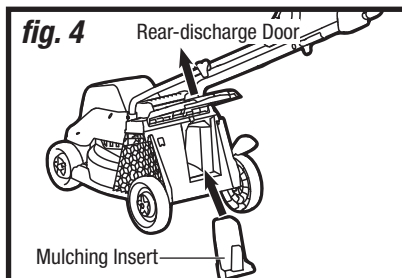

## ATTACH/REMOVE THE GRASS COLLECTION BAG (fig. 5)

1. Remove the pre-installed mulching insert before attaching the grass collection bag to the mower.
2. Use one hand to lift the rear-discharge door; use your other hand to hold the handle bar of the grass collection bag and align the rods on the grass collection bag with the slots on the mower to assemble it.
3. To remove the grass collection bag, just lift the rear-discharge door and remove the rods of grass collection bag.

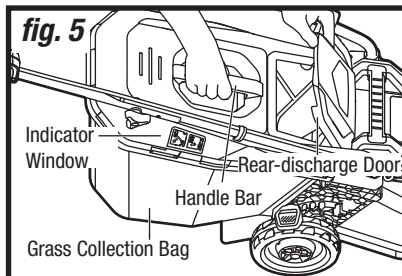

If the grass collection bag is not full, airflow created by the rotating blade will blow and open the indicator window.

If the grass collection is full, the indicator window will be closed as airflow is isolated by grass. Empty the grass collection bag at this time or cutting performance will be affected.

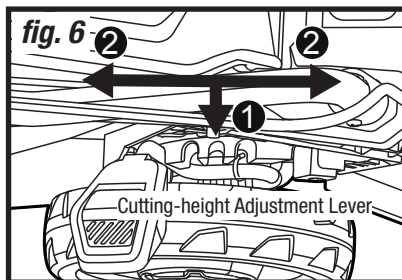

## ADJUST THE CUTTING HEIGHT (fig. 6)

Pull out the cutting-height adjustment lever from the slot, then move it forward or backward to adjust the cutting height (fig. 6). The mower has five slots which can adjust the cutting height from about 1 to 3" (2.5 to 7.6 cm).

### NOTICE:

- The mulching insert must be removed in order to install and use the grass collection bag.
- Use the mulching insert without the grass collection bag to get more finely cut grass clippings on your lawn.
- Empty the grass collection bag frequently during use. Do not wait until it is completely full. We recommend emptying it when it is half full.



### WARNING!

- Do not place the lever out of the five slots.

**ATTACH THE BATTERY PACK (fig. 7)**

1. Release the start lever.
2. Open the protective cap of the battery compartment.
3. Align the raised rib on the battery packs with the grooves in the tool, and then slide the battery packs onto the tool.
4. Make sure that the latches on the battery packs snap into place and that the battery packs are attached securely to the tool before beginning operation.

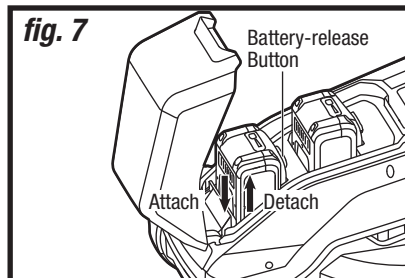
**DETACH THE BATTERY PACK (fig. 7)**

1. Release the start lever.
2. Open the protective cap of the battery compartment.
3. Depress the battery-release button, located on the front of the battery packs, to release the battery packs.
4. Pull the battery packs out and remove them from the tool.

**WARNING!**

- Avoid the possibility of accidental starting. Always take care not to activate the on/off switch when you are attaching the battery pack or performing other adjustments to the tool.



### START/STOP THE MOWER (fig. 8)

1. Install the battery packs into the mower, and then close the battery compartment.
2. Depress the safety lock-off switch first, pull back the start lever to meet the handle and then release the safety lock-off switch to start the machine.
3. To stop, fully release the start lever. The electric brake will stop the blade rotation within several seconds after releasing the start lever.

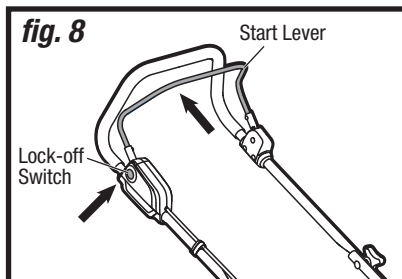

### NOTICE:

- Mower will start with low speed for firm control and changes to high speed automatically when load goes up to have a higher cutting efficiency. It will return to low speed when load is removed.
- This mower has an efficient collecting rate; the grass bag will be filled up in a short time. Empty the grass bag frequently or it will affect mowing performance.



### WARNING!

- Rotating blades can cause serious injury. To prevent serious injury, remove the battery packs when the mower is unattended, or when adjusting, cleaning, servicing, transporting, lifting, or storing the mower.
- The operation of any lawn mower can result in foreign objects being thrown into your or others' eyes, which can damage eyes severely. Always wear safety glasses while operating the mower or while performing any adjustments or repairs on the mower.
- Ensure that other people and pets remain at least 100' (30 m) away from the mower when it is in use.
- The blade will continue to rotate for a few seconds after the mower is turned off. Allow the motor/blade to stop rotating before starting it again. Do not rapidly turn the mower off and on.

**MAINTENANCE****BEFORE EACH USE**

1. Inspect the mower, the start lever and the battery packs for damage.
2. Check for damaged, missing, or worn parts.
3. Check for loose screws, misalignment or binding of moving parts, or any other condition that may affect the operation.
4. If abnormal vibration or noise occurs, turn the tool off immediately and have the problem corrected before further use. Remove the battery from the power tool before cleaning or performing any maintenance.

**REMOVE/INSTALL THE BLADE****(fig. 9)**

After prolonged use, especially in sandy soil conditions, the blade will become worn and lose some of the original shape, which will reduce the cutting efficiency. Therefore, the blade should be replaced to ensure a good cutting performance.

1. Remove battery packs from the mower.
2. Turn the mower upside down. Keep the underbody and blade clean and free of debris.
3. Using a piece of wood to keep the blade from turning, loosen the hex bolt counter-clockwise using a suitable wrench and remove it together with the blade.
4. Attach a new blade of the same type onto the spindle while maintaining the correct alignment. Insert the hex bolt on the spindle. Use a piece of wood to keep the blade from turning, and then tighten the hex bolt clockwise to ensure safe operation of your product.

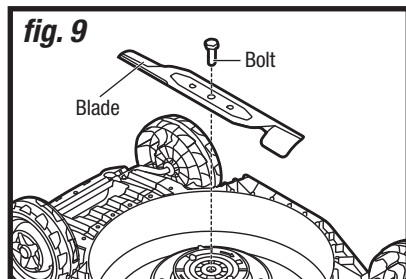
**WARNING!**

- Wear gloves when removing/installing the blade to avoid accidental personal injury.

### CLEANING

Using compressed air may be the most effective cleaning method. Always wear safety goggles when cleaning tools using compressed air. The underside of mower deck should be cleaned after each use as grass clippings, leaves, dirt and other debris will accumulate. This accumulation is undesirable, and it will promote rust and corrosion on metal parts and reduce the cutting efficiency of the mower. Wipe the mower clean with a damp cloth.

### STORAGE (fig. 10)

The mower can be stored in a compact way.

1. Remove battery packs from the mower.
2. Loosen the locking knob and fold the upper handle bar into the storage position.
3. To use the mower, unfold the upper handle bar and tighten the locking knob.

Store the product and its accessories in a dark, dry, frost-free, and well-ventilated place. Store the tool indoors in a place that is inaccessible to children. Keep away from corrosive agents.

### CARRY THE MOWER (fig. 10)

After folding the mower, it can be carried by using the lift handle on the upper housing (fig. 10).

DO NOT attempt to lift the mower by grasping the upper handle bar.

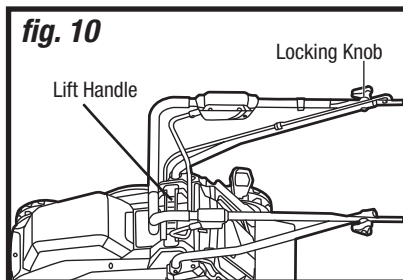

### WARNING!

- To avoid personal injury, always remove the battery pack from the tool when cleaning or performing any maintenance.
- Do not let brake fluids, gasoline, petroleum-based products, penetrating oil, etc., come into contact with plastic parts. These substances contain chemicals that can damage, weaken, or destroy plastic.
- When servicing, use only identical replacement parts. The use of any other parts may create a hazard or cause damage to the product.
- Use only accessories that are recommended for this lawn mower by the manufacturer. Accessories that may be suitable for one tool may become hazardous when used with another tool.
- To ensure safety and reliability, all repairs should be performed by a qualified service technician.

**TROUBLESHOOTING**

Problem	Possible Causes	Solution
The mower doesn't work.	Battery pack is depleted.	Charge the battery.
	The battery is over-temperature.	Cool the battery pack under airflow.
	The tool is overheated.	Allow the tool to cool down.
Cutting performance is unsatisfactory.	Blade is dull.	Keep the blade sharp.
	Blade is damaged.	Please find the replacement blade 060-6116-4 from CTC.
	Deck or discharge chute is clogging.	Clean the deck or discharge chute.
Mower is abnormally noisy and vibrates.	The blade is bent or damaged.	Replace with a new blade. Please refer to "BLADE CHANGE" section
Grass collection bag doesn't pick up grass clippings.	Discharge chute is clogged.	Clear the grass clippings in the discharge chute.
	Bag is full.	Empty the bag.

If the problem remains unsolved after performing the checks described above, call the toll-free helpline at 1-800-689-9928.

## EXPLODED VIEW

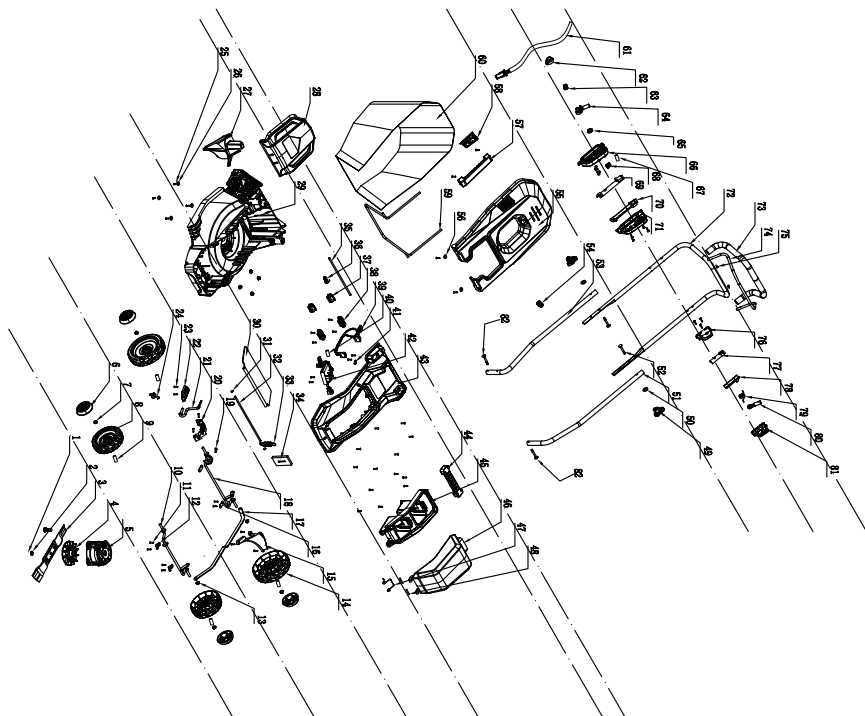

## PARTS LIST

No.	Part No.	Description
1	0601337001	Screw
2	0601337002	Spring Washer
3	0601337003	Blade
4	0601337004	Fan
5	0601337005	Brushless Motor
6	0601337006	Wheel Cover
7	0601337007	Nut
8	0601337008	Wheel
9	0601337009	Sleeve
10	0601337010	Front Axle
11	0601337011	Screw
12	0601337012	Press Plate
13	0601337013	Nut
14	0601337014	Wheel
15	0601337015	Base Plate
16	0601337016	Press Plate
17	0601337017	Connect Bar
18	0601337018	Rear Axle
19	0601337019	Height Adjustment R Pin
20	0601337020	Height Adjustment Plate
21	0601337021	Height Adjustment Assembly
22	0601337022	Height Adjustment Knob
23	0601337023	Screw
24	0601337024	Height Adjustment Spring
25	0601337025	Screw
26	0601337026	Flat Mat
27	0601337027	Deck Insert
28	0601337028	Rear Guard
57	0601337057	Grass Bag Handle

No.	Part No.	Description
29	0601337029	Deck
30	0601337030	Rubber
31	0601337031	Opening Ring
32	0601337032	Rubber Shaft
33	0601337033	Height Adjustment Spring
34	0601337034	Sponge
35	0601337035	Rear Cover Shaft
36	0601337036	Torsion Spring
37	0601337037	Terminal
38	0601337038	Terminal Press Plate
39	0601337039	Cable Assembly
40	0601337040	Heat Shrink Tubing
41	0601337041	Cable Press Plate
42	0601337042	Controller
43	0601337043	Motor Cover
44	0601337044	Handle
45	0601337045	Battery Seat
46	0601337046	Battery Cover
47	0601337047	Battery Cover Torsion Spring
48	0601337048	Battery Cover Shaft
49	0601337049	Knob
50	0601337050	Flat Mat
51	0601337051	Right Lower Handle Bar
52	0601337052	Bolt
53	0601337053	Left Lower Handle Bar
54	0601337054	Cable Click
55	0601337055	Grass Bag Upper Cover
56	0601337056	Flat Mat
70	0601337070	Right Switch Box Cover

58	0601337058	Indicator	71	0601337071	Right Handle Bar Cover
59	0601337059	Grass Bag Frame	72	0601337072	Upper Handle Bar
60	0601337060	Grass Bag	73	0601337073	Sponge
61	0601337061	Power Cable	74	0601337074	Wire Trigger
62	0601337062	Switch Button	75	0601337075	Screw
63	0601337063	Spring of Adjust Knob	76	0601337076	Wire Trigger Support Box (Right)
64	0601337064	Wire Trigger Holder(Right)	77	0601337077	Wire Trigger Lower Sleeve
65	0601337065	Spring of Switch Box	78	0601337078	Wire Trigger Upper Sleeve
66	0601337066	Support of switch box	79	0601337079	Wire Trigger Holder Torsion Springs
67	0601337067	Heat Shrink Tubing	80	0601337080	Wire Trigger Holder (Left)
68	0601337068	Switch	81	0601337081	Wire Trigger Support Box (Left)
69	0601337069	Lower Cover of Switch Box	82	0601337082	Tapping Screw

If any parts are missing or damaged, or if you have any questions, please call the toll-free helpline at 1-800-689-9928.

This Mastercraft® product is guaranteed for a period of **three (3) years from the date of original retail purchase** against defects in workmanship and materials, except for the following components:

- a) Component A: Batteries, chargers and carrying case, which are guaranteed for a period of two (2) years from the date of original retail purchase against defects in workmanship and materials; and
- b) Component B: Accessories, which are guaranteed for a period of one (1) year from the date of original retail purchase against defects in workmanship and materials.

Subject to the conditions and limitations described below, this product, if returned to us with proof of purchase within the stated warranty period and if covered under this warranty, will be repaired or replaced (with the same model, or one of equal value or specification), at our option. We will bear the cost of any repair or replacement and any costs of labour relating thereto.

**These warranties are subject to the following conditions and limitations:**

- a) a bill of sale verifying the purchase and purchase date must be provided;
- b) this warranty will not apply to any product or part thereof which is worn or broken or which has become inoperative due to abuse, misuse, accidental damage, neglect or lack of proper installation, operation or maintenance (as outlined in the applicable owner's manual or operating instructions) or which is being used for industrial, professional, commercial or rental purposes;
- c) this warranty will not apply to normal wear and tear or to expendable parts or accessories that may be supplied with the product that are expected to become inoperative or unusable after a reasonable period of use;
- d) this warranty will not apply to routine maintenance and consumable items such as, but not limited to, fuel, lubricants, vacuum bags, blades, belts, sandpaper, bits, fluids, tune-ups or adjustments;
- e) this warranty will not apply where damage is caused by repairs made or attempted by others (i.e., persons not authorized by the manufacturer);
- f) this warranty will not apply to any product that was sold to the original purchaser as a reconditioned or refurbished product (unless otherwise specified in writing);
- g) this warranty will not apply to any product or part thereof if any part from another manufacturer is installed therein or any repairs or alterations have been made or attempted by unauthorized persons;
- h) this warranty will not apply to normal deterioration of the exterior finish, such as, but not limited to, scratches, dents, paint chips, or to any corrosion or discolouring by heat, abrasive and chemical cleaners; and
- i) this warranty will not apply to component parts sold by and identified as the product of another company, which shall be covered under the product manufacturer's warranty, if any.



## Additional Limitations

This warranty applies only to the original purchaser and may not be transferred. Neither the retailer nor the manufacturer shall be liable for any other expense, loss or damage, including, without limitation, any indirect, incidental, consequential or exemplary damages arising in connection with the sale, use or inability to use this product.

## Notice to Consumer

This warranty gives you specific legal rights, and you may have other rights, which may vary from province to province. The provisions contained in this warranty are not intended to limit, modify, take away from, disclaim or exclude any statutory warranties set forth in any applicable provincial or federal legislation.

Made in China

Imported by

Mastercraft Canada Toronto, Canada M4S 2B8





