

MASTERCRAFT™/MC

**CORDLESS
2-IN-1
SELF-PROPELLED
BRUSHLESS LAWN MOWER**
060-0590-0

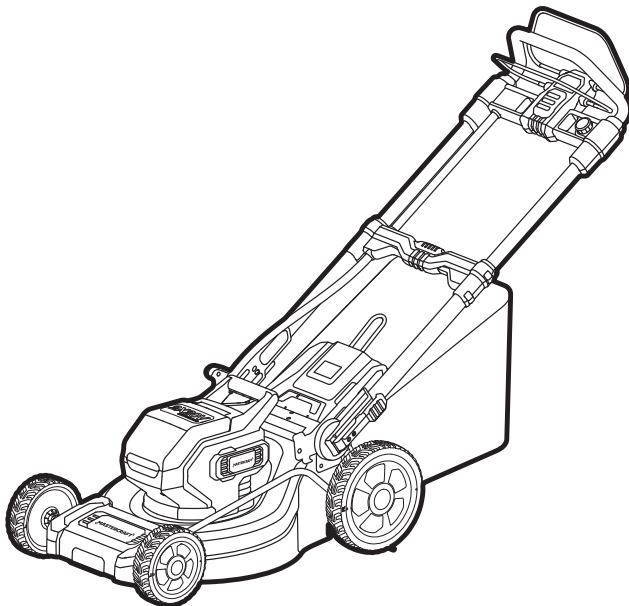

IMPORTANT:

Read and understand this instruction manual thoroughly before using the product.

**INSTRUCTION
MANUAL**

TABLE OF CONTENTS

Technical Specifications	4
Safety Guidelines	5
Key Parts Diagram	10
Operating Instructions	11
Maintenance	15
Troubleshooting	17
Parts List	18
Warranty	22

NOTE:

If any parts are missing or damaged, or if you have any questions, please call our toll-free helpline at 1-800-689-9928.



SAVE THESE INSTRUCTIONS

- This manual contains important safety and operating instructions. Read all instructions and follow them with use of this product.

TECHNICAL SPECIFICATIONS

Rated Voltage	40 V d.c. max.*
Deck Size	19" (48 cm)
Cutting Height	1 1/2 to 3" (3.8 to 7.6 cm)

*Maximum battery voltage without workload; with workload nominal voltage is 18 V.

NOTICE: The mower needs two 20 V max* batteries to work.

SAFETY GUIDELINES:



WARNING!

Safety symbols in this Instruction Manual are used to flag possible dangers. The safety symbols and their explanations require your full understanding. The safety warnings do not, by themselves, eliminate any danger, nor are they substitutes for proper accident prevention measures.

IMPORTANT

This tool should only be serviced by a qualified service technician. For more information, call the toll-free helpline at 1-800-689-9928. This machine is capable of amputating hands and feet and throwing objects. Failure to observe the following safety instructions could result in serious injury or death.



WARNING!

When using electric lawn mowers, basic safety precautions should always be followed to reduce the risk of fire, electric shock, and personal injury.



WARNING!

Read all safety warnings and instructions. Failure to follow the warnings and instructions may result in electric shock, fire and/or serious injury.

READ ALL INSTRUCTIONS

GENERAL INFORMATION

- Read, understand, and follow instructions and warnings in this manual and on the machine and attachments.
- Only allow operators who are responsible, trained, familiar with the instructions, and physically capable to operate the machine.
- Do not operate the machine while under the influence of alcohol or drugs.

PREPARATION BEFORE OPERATING

- Clear the operation area of any objects which could be thrown by or interfere with operation of the machine.
- Keep the area of operation clear of all bystanders, particularly small children. Stop the machine and attachment(s) if anyone enters the area.
- Do not operate the machine without the entire grass catcher, discharge chute, or other safety devices in place and functioning properly. Check frequently for signs of wear or deterioration and replace as needed.
- Wear appropriate personal protective equipment such as safety glasses, hearing protection, and footwear.

CHILDREN SPECIFIC

- Tragic accidents can occur if the operator is not alert to the presence of children. Children are often attracted to the machine and mowing activity. Never assume that children will remain where you last saw them.
- Keep children out of the operating area and under the watchful care of a responsible adult other than the operator.

OPERATING

- **Only operate the machine in daylight or good artificial light.**
- **Avoid holes, nuts, bumps, rocks, or other hidden hazards.** Uneven terrain could overturn the machine, or cause operator to lose the balance or footing.
- **Do not put hands or feet near rotating parts of under the machine.** Keep clear of the discharge opening at all times.
- **Do not direct discharge material toward anyone.** Avoid discharging material against a wall or obstruction. Material may ricochet back toward the operator. Stop the blade(s) when crossing gravel surface.
- **Do not mow in reverse unless absolutely necessary.** Always look down and behind before and when backing up.
- **Avoid dangerous environments.** Don't use lawn mowers in damp or wet locations.
- **Keep children away.** All visitors should be kept a safe distance from work area.
- **Dress properly.** Do not wear loose clothing or jewellery. They can be caught in moving parts. Use of rubber gloves and footwear is recommended when working outdoors.
- **Use safety glasses.** Always use face or dust mask if operation is dusty.
- **Use right appliance.** Do not use lawn mower for any job except that for which it is intended.
- **Don't force lawn mower.** It will do the job better and safer at the rate for which it was designed.
- **Don't overreach.** Keep proper footing and balance at all times.
- **Stay alert.** Watch what you are doing. Use common sense. Do not operate lawn mower when you are tired.
- **Store idle lawn mower indoors.** When not in use, lawn mower should be stored in an indoor, dry and locked-up place out of reach of children.
- **Maintain lawn mower with care.** Keep cutting edges sharp and clean for best and safest performance. Follow instructions for lubricating and changing accessories. Inspect lawn mower cord periodically and if damaged, have it repaired by an authorized service facility. Keep handles dry, clean, and free from oil and grease.
- **Keep guards in place and in working order.**
- **Keep blades sharp.**
- **Keep hands and feet away from cutting area.**

- **Objects struck by the lawn mower blade can cause severe injuries to persons.** The lawn should always be carefully examined and cleared of all objects prior to each mowing.
- If lawn mower strikes a foreign object, follow these steps: 1) Stop lawn mower; release the switch. 2) Detach the battery pack. 3) Inspect for damage. 4) Repair any damage before restarting and operating the lawn mower.
- **Use identical replacement blades only.**
- **Use extra care while operating machine with grass catcher or other attachment(s).** They can affect the stability of the machine.

SAFETY GUIDELINES FOR BATTERY-OPERATED TOOLS

- **Prevent unintentional starting.** Ensure the switch is in the off-position before connecting to battery pack, picking up or carrying the appliance. Carrying the appliance with your finger on the switch or energizing an appliance that has the switch on invites accidents.
- **Disconnect the battery pack from the appliance before making any adjustments, changing accessories, or storing appliance.** Such preventive safety measures reduce the risk of starting the appliance accidentally.
- **Recharge only with the charger specified by the manufacturer.** A charger that is suitable for one type of battery pack may create a risk of fire when used with another battery pack.
- **Use appliances only with specifically designated battery packs.** Use of any other battery packs may create a risk of injury and fire.
- **When battery pack is not in use, keep it away from other metal objects, like paper clips, coins, keys, nails, screws or other small metal objects, that can make a connection from one terminal to another.** Shorting the battery terminals together may cause burns or a fire.
- **Under abusive conditions, liquid may be ejected from the battery; avoid contact. If contact accidentally occurs, flush with water.** If liquid contacts eyes, seek additional medical help. Liquid ejected from the battery may cause irritation or burns.
- **Do not use a battery pack or appliance that is damaged or modified.** Damaged or modified batteries may exhibit unpredictable behavior resulting in fire, explosion or risk of injury.
- **Do not expose a battery pack or appliance to fire or excessive temperature.** Exposure to fire or temperature above 130°C (265°F) may cause an explosion.
- **Follow all charging instructions and do not charge the battery pack or appliance outside of the temperature range specified in the instructions.** Charging improperly or at temperatures outside of the specified range may damage the battery and increase the risk of fire.
- **Have servicing performed by a qualified repair person using only identical replacement parts.** This will ensure that the safety of the product is maintained.
- **Do not modify or attempt to repair the appliance or the battery pack (as applicable) except as indicated in the instructions for use and care.**

OPERATION ON A SLOPE

Slopes are a major factor related to slip-and-fall accidents, which can result in severe injury. Operation on slopes requires extra caution. If you feel uneasy on a slope, do not mow it.

Mow across the face of slopes; never mow up and down. Exercise extreme caution when changing direction on slopes.

- Watch for holes, ruts, rocks, hidden objects, or bumps which can cause you to slip or trip. Tall grass can hide obstacles.
- Do not mow near drop-offs, ditches or embankments; you could lose your footing or balance.
- Do not mow slopes greater than 15 degrees. Do not mow on wet grass. Unstable footing could cause slipping.
- Do not operate machine under any condition where traction, steering, or stability is in question. Tires could slide even if the wheels are stopped.
- Always keep the machine in gear when going down slopes. Do not coast downhill.
- Avoid starting and stopping on slopes. Avoid making sudden changes in speed or direction. Make turns slowly and gradually.

ADDITIONAL SAFETY GUIDELINES FOR LAWN MOWER

- **The label on your tool may include the following symbols. The symbols and their definitions are as follows:**

V Volts

A Amperes

W Watts

min Minutes

 or d.c. Direct current

n_0 No-load speed



..... Class II construction

RPM Revolutions per minute



..... WARNING—To reduce the risk of injury, user must read instruction manual.



..... WARNING—To reduce the risk of injury, always wear eye protection.



..... WARNING—To reduce the risk of injury, always wear ear protection.



..... Maintain safety devices: Do not open or remove safety shields while the tool is running.



..... Look behind when backing up. Look down and behind first to avoid tripping when pulling back.



DANGER—Keep hands and feet away. To reduce the risk of injury, keep hands and feet away from rotating parts. Do not operate unless discharge cover or grass bag is in its proper place. If damaged, replace immediately.



DANGER—Keep bystanders away. Do not mow when children or others are around.



DANGER—Thrown debris. Remove objects that can be thrown by the blade in any direction. Wear safety glasses.



DANGER—Steep slope hazard. Use extra caution on slopes. Do not mow slopes greater than 15 degrees.



WARNING!

To reduce the risk of electric shock or damage to the charger and battery, use only the Mastercraft® and PWR POD™ batteries and chargers listed.

BATTERY PACK

Mastercraft®: 054-3124-0, 054-7553-4,
054-7557-6, 054-2434-8
PWR POD™: 054-7563-0, 054-7564-8,
054-7558-4

CHARGERS

Mastercraft®: 054-3126-6, 054-7559-2,
054-8299-4
PWR POD™: 054-3126-6, 054-7565-6,
054-7567-2

- **Use only those accessories and attachments (blade, grass collection bag, etc.) that have been found to be acceptable for the lawn mower.** Use of any other accessory or attachment might increase the risk of injury.
- **For best results, your battery and tool should be stored, charged and used in a location where the temperature is more than 5°C (41°F) but less than 40°C (104°F).** Do not store outside or in vehicles.
- **Do not wash the mower with a hose.** Avoid getting water in the motor and electrical connections.
- **To reduce a fire hazard, keep the motor cover free of grass, leaves and debris build-up.**

SAVE THESE INSTRUCTIONS!

PACKAGE CONTENTS:

Cordless lawn mower, grass collection bag, mulching insert (inside of the mower).

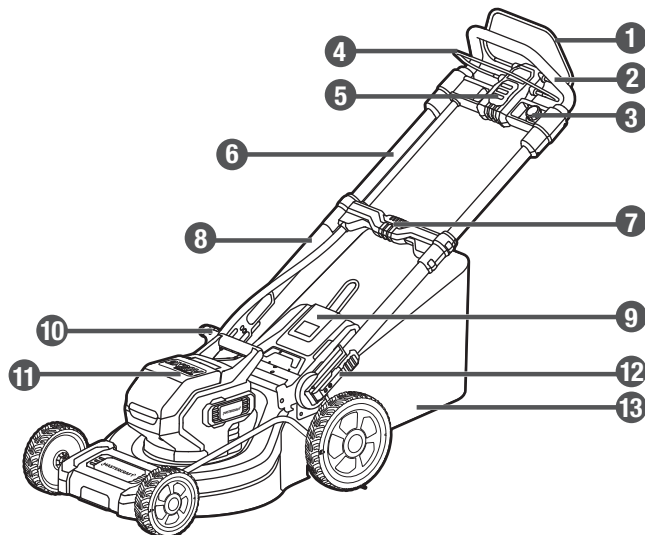
KEY PARTS DIAGRAM

No.	Description
1	Self-propelling lever
2	Grip handle
3	Speed dial
4	Start lever
5	Safety lock-off switch
6	Upper handle bar
7	Unlock button

No.	Description
8	Lower handle bar
9	Rear-discharge door
10	Cutting-height-adjustment lever
11	Battery compartment
12	Clamp lever
13	Grass collection bag

Before attempting to use this tool, become familiar with all of its operating features and safety requirements. For optimum performance and safety, read the following operating instructions carefully before using.

**WARNING!**

- Remove the lawn mower from the package and examine it carefully. Do not discard the carton or any packaging material until all parts have been examined.
- If any part of the lawn mower is missing or damaged, do not attach the battery pack to the tool or use the tool until the part has been repaired or replaced. Failure to heed this warning could result in serious injury.
- Do not allow familiarity with the lawn mower to cause a lack of alertness. A fraction of a second of carelessness is enough to cause severe injury.

OPERATING INSTRUCTIONS

UNFOLD THE HANDLE BAR (fig. 1)

1. Put the product on the ground. Note that it is delivered with the handle bar in its storage position.
2. Pull the clamp lever outwards, hold it in position, and then rotate the lower handle bar clockwise to put the product from storage to working position.
3. Release the clamp lever and keep rotating the handle bar until the lock pin of clamping lever engaged in the upper hole or lower hole on the supporting plate, depending on the required handle height.
4. Press the unlock button, hold it in position, and then gradually pull out upper handle bar until the bar reaches STOP position.
5. Release the unlock button and ensure the upper handle bar is secured.

fig. 1a

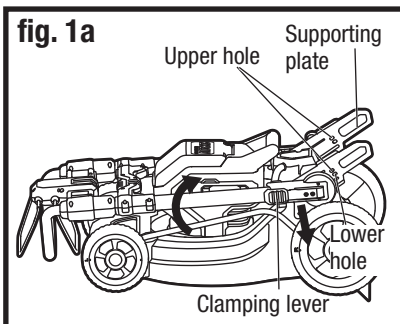

fig. 1b

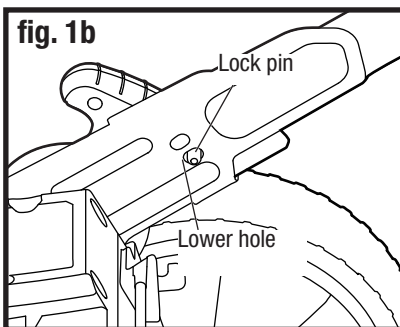
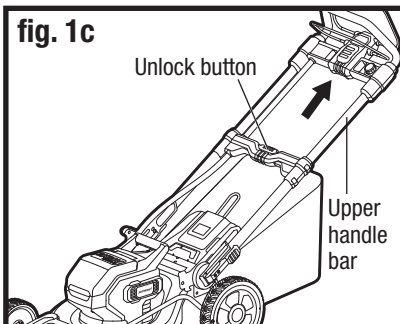

fig. 1c



NOTICE:

- Pull or push the upper handle bar gently. Do not use sudden force.
- The upper handle bar can only be secured in its lower or upper position.
- The power can only be activated once the upper handle bar is secured at the STOP position.



WARNING!

- In order to avoid pinching your hands or fingers, do not hold the handle bar at the joints.

ATTACH/REMOVE THE MULCHING INSERT (fig. 2)

1. Lift the rear-discharge door and insert the mulching insert into the grass outlet of the mower, then release the rear-discharge door.
2. To remove, lift the rear-discharge door and just pull the mulching insert out, then release the rear-discharge door.

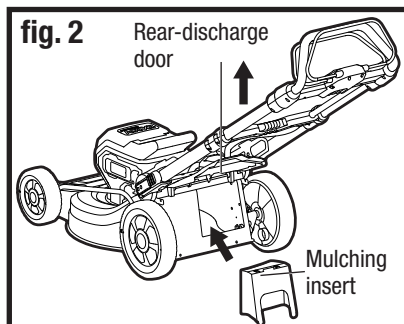

ATTACH/REMOVE THE GRASS COLLECTION BAG (fig. 3)

1. Remove the pre-installed mulching insert before attaching the grass collection bag to the mower.
2. Use one hand to lift the rear-discharge door; use your other hand to hold the handle bar of the grass collection bag. To assemble, align the rods on the grass collection bag with the slots on the mower.
3. To remove the grass collection bag, just lift the rear-discharge door and remove the grass collection bag rods from the mower.

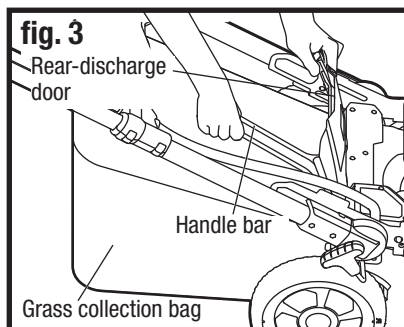

ADJUST THE CUTTING HEIGHT (fig. 4)

Pull out the cutting-height-adjustment lever from the slot and move forward or backward to adjust the cutting height. The mower has five slots which can adjust the cutting height from about 1 1/2 to 3" (3.8 to 7.6 cm). Do not place the lever out of the five slots.

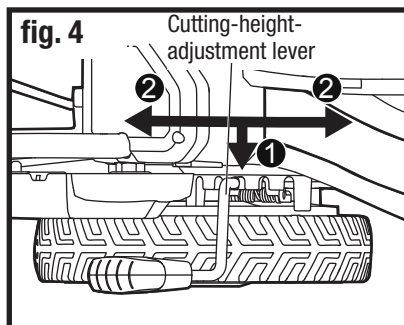

NOTICE:

- The mulching insert must be removed in order to install and use the grass collection bag.
- Use the mulching insert without the grass collection bag to get more finely cut grass clippings on your lawn.
- Empty the grass collection bag frequently during use. Do not wait until it is completely full. We recommend emptying it when it is half full.

TO ATTACH THE BATTERY (fig. 5)

1. Open the protective cap of the battery compartment.
2. Align the raised portion on the battery pack with the grooves inside of the battery compartment, and then slide the battery pack onto the mower.
3. Ensure that the battery-release button on the battery pack snaps into place and the battery pack is secured to the tool before beginning operation.

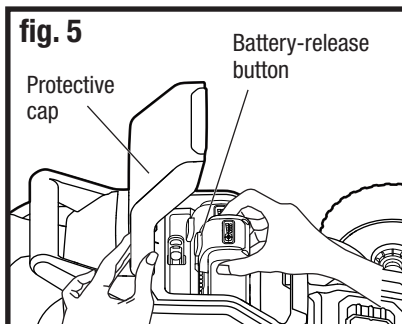

TO DETACH THE BATTERY (fig. 5)

1. Open the protective cap of the battery compartment.
2. Depress the battery-release button located on the front of the battery pack to release the battery.
3. Pull rearward on the battery pack to remove it from the tool.

SAFETY KEY (fig. 6)

In order to prevent accidental start-up or unauthorized use of your cordless mower, a removable safety key has been incorporated into the design of your mower.

The mower will be completely disabled when the safety key has been removed from the mower. Press the lever, insert the safety key into the assembly slot, and then the mower may be operated.

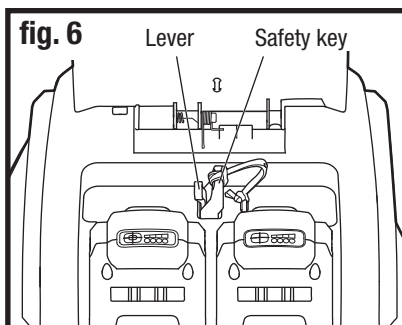

NOTICE: Two batteries should be used together to start the mower. The mower cannot be used with only one battery.



WARNING!

- Keep your feet away from the deck when adjusting its height.
- To avoid the possibility of accidental starting, always take care not to activate the start lever when you are attaching the battery pack or performing other adjustments to the tool.

START/STOP THE MOWER (fig. 7)

1. Install the battery packs into the mower, insert the safety key into the key slot and then close the battery compartment.
2. Depress the safety lock-off switch first, pull back the start lever to meet the handle and then release the safety lock-off switch to start the machine.
3. To stop, fully release the start lever. The electric brake will stop the blade rotation within several seconds after releasing the start lever.

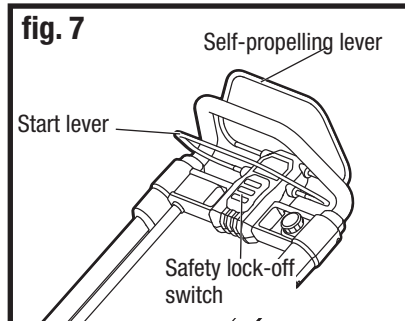
**START/STOP THE WHEEL DRIVING (fig. 7)**

1. Push the self-propelling lever forward and hold it against the grip handle to start the wheel driving.
2. Release the self-propelling lever to stop the mower's forward motion.

SPEED DIAL FOR THE WHEEL DRIVING (fig. 8)

The wheel driving speed can be adjusted by turning the speed dial.

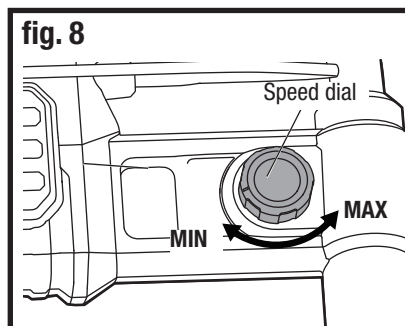
**WARNING!**

- The operation of any lawn mower can result in foreign objects being thrown into your or others' eyes, which can damage eyes severely. Always wear safety glasses while operating the mower or while performing any adjustments or repairs on the mower.
- Ensure that other people and pets remain at least 100' (30 m) away from the mower when it is in use.
- The blade will continue to rotate for a few seconds after the mower is turned off. Allow the motor/blade to stop rotating before starting it again. Do not rapidly turn the mower off and on.
- Operate the self-propelling lever with a quick and complete motion, so the clutch is either fully engaged or fully released.
- Never set the speed of wheel driving beyond your control.

MAINTENANCE

REMOVE/INSTALL THE BLADE (fig. 9)

After prolonged use, especially in sandy soil conditions, the blade will become worn and lose some of the original shape, which will reduce the cutting efficiency. Therefore, the blade should be replaced to ensure a good cutting performance.

1. Remove the safety key and battery pack.
2. Turn the mower upside down. Keep the underbody and blade clean and free of debris.
3. Using a piece of wood to keep the blade from turning, loosen the hex bolt counter-clockwise using a suitable wrench and remove it together with the blade.
4. Attach a new blade of the same type (MASTERCRAFT® 060-1542-0 replacement mower blade) onto the spindle while maintaining the correct alignment. Insert the hex bolt on the spindle. Use a piece of wood to keep the blade from turning, and then tighten the hex bolt clockwise to ensure safe operation of your product.

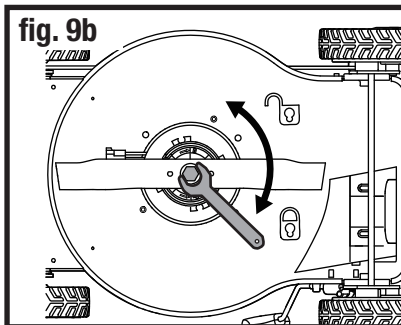
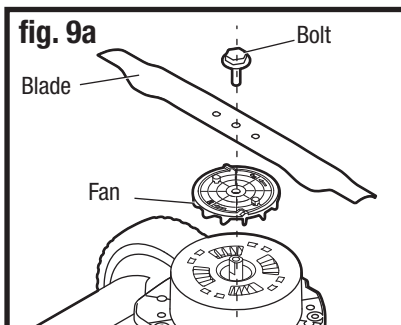

CLEAN THE MOWER

The underside of mower deck should be cleaned after each use as grass clippings, leaves, dirt and other debris will accumulate. This accumulation is undesirable, and it will promote rust and corrosion on metal parts and reduce the cutting efficiency of the mower. Wipe the mower clean with a damp cloth.

STORAGE

1. Switch the product off, disconnect the safety key and remove the battery packs.
2. Clean the product as described above.
3. Follow the reverse order of "UNFOLD THE HANDLE BAR" to fold the lawn mower for storage.
4. Store the product and its accessories in a dark, dry, frost-free, well-ventilated place.
5. Always store the product in a place that is inaccessible to children. The ideal storage temperature is between 10 and 30°C (50 to 86°F).
6. We recommend using the original package for storage or covering the product with a suitable cloth or enclosure to protect it against dust.

TRANSPORTATION

1. Switch the product off, disconnect the safety key and remove the battery packs.
2. Fold the lawn mower handle if necessary. Always transport the product by its handle.
3. Protect the product from any heavy impact or strong vibrations which may occur during transportation in vehicles.
4. Secure the product to prevent it from slipping or falling over, which may cause damage and injury.

**WARNING!**

- Wear safety gloves when working on the blade and close to it. Use proper tools to remove debris, i.e., a wooden stick. Never use your bare hands.
- Do not let brake fluids, gasoline, petroleum-based products, penetrating oil, etc., come into contact with plastic parts. These substances contain chemicals that can damage, weaken, or destroy plastic.
- When servicing, use only identical replacement parts. The use of any other parts may create a hazard or cause damage to the product.
- Always remove the safety key and battery pack when servicing or transporting the mower.
- To ensure safety and reliability, all repairs should be performed by a qualified service technician.

TROUBLESHOOTING

Problem	Possible causes	Solutions
The mower doesn't work.	The battery is depleted.	Charge the battery pack.
	The motor or the battery is overloaded.	Raise the cutting height, and restart the tool again.
	The battery or the tool is too hot.	Wait for the battery or tool to cool down, and then start the tool again.
	The safety key is not inserted into the slot of the battery compartment.	Insert the safety key into the slot.
	Upper handle bar is not correctly assembled.	Pull upper handle bar to the STOP position.
Mower runs but cutting performance is unsatisfactory.	Blade is dull.	Keep the blade sharp.
	Deck or discharge chute is clogging.	Clean the deck or discharge chute.
Mower is abnormally noisy and vibrates.	The blade is bent or damaged.	Replace with a new blade.
Grass collection bag doesn't pick up grass clippings.	Discharge chute is clogged.	Clear the grass clippings in the discharge chute.
	Bag is full.	Empty the bag more often.

If the problem remains unsolved after performing the checks described above, call the toll-free helpline at 1-800-689-9928.

EXPLODED VIEW

PARTS LIST

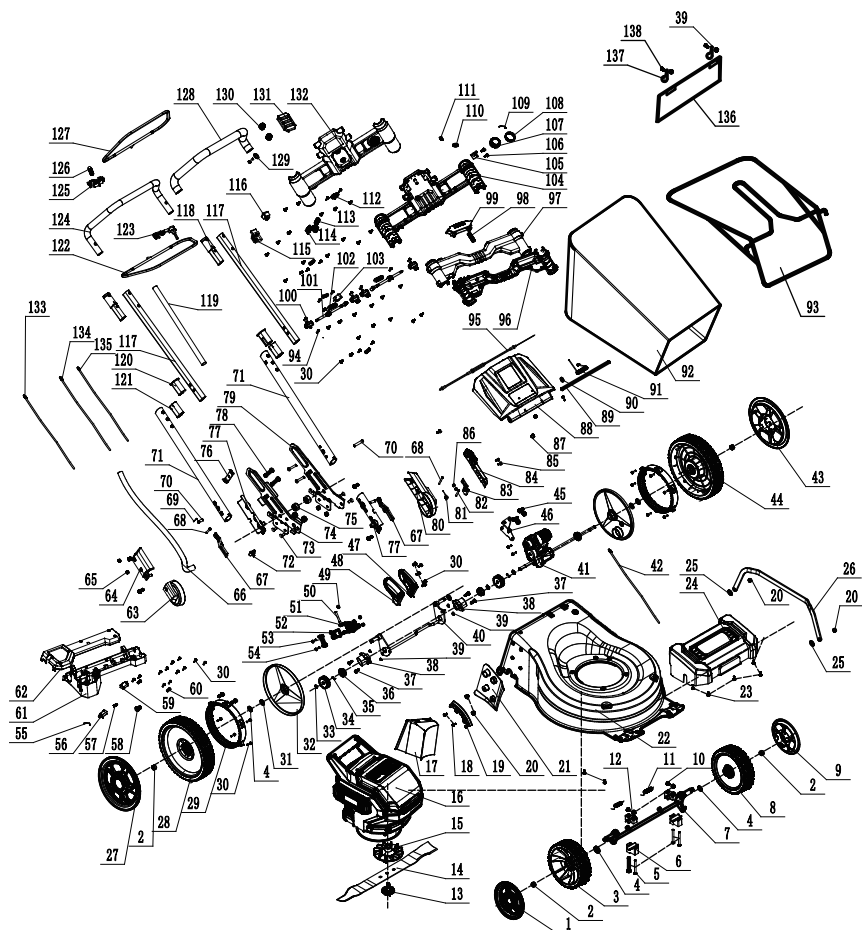

No.	Part no.	Description
1	0600590001	Right Front Wheel Cover
2	0600590002	Hexagonal Nut
3	0600590003	Right Front Wheel
4	0600590004	Wave Washer
5	0600590005	Square Head Bolt
6	0600590006	Front Wheel Bracket
7	0600590007	Front Wheel Axle
8	0600590008	Left Front Wheel
9	0600590009	Left Front Wheel Cover
10	0600590010	Nut
11	0600590011	Tension Spring
12	0600590012	Front Wheel Bracket
13	0600590013	Blade Bolt
14	0600590014	Blade
15	0600590015	Fan
16	0600590016	Power Head
17	0600590017	Mulching Insert
18	0600590018	Screw
19	0600590019	Plate
20	0600590020	Hexagonal Nut
21	0600590021	Grass Guide Plate
22	0600590022	Base
23	0600590023	Screw
24	0600590024	Front Face
25	0600590025	Flat Washer
26	0600590026	Connecting Rod
27	0600590027	Right Rear Wheel Cover
28	0600590028	Right Wheel
29	0600590029	Self-propelled Rack
30	0600590030	Screw
31	0600590031	Flat Washer
32	0600590032	Rear Wheel Cover

No.	Part no.	Description
33	0600590033	External Circlips
34	0600590034	R Gear
35	0600590035	Pin
36	0600590036	Ball Bearing
37	0600590037	Screw
38	0600590038	Bearing Housing
39	0600590039	Nut
40	0600590040	Rear Axle
41	0600590041	Self-propelled Assembly
42	0600590042	Power Cord
43	0600590043	Rear Left Wheel Cover
44	0600590044	Rear Left Wheel
45	0600590045	Screw
46	0600590046	Press Plate
47	0600590047	Left Height Handle
48	0600590048	Right Height Handle
49	0600590049	E-Ring Circlip
50	0600590050	Shaft
51	0600590051	Assembly
52	0600590052	Torsion Spring
53	0600590053	Torsion Spring Seat
54	0600590054	Screw
55	0600590055	Switch Box Shrapnel
56	0600590056	Telescopic Spring Button
57	0600590057	Spring
58	0600590058	Screw
59	0600590059	Micro Switch
60	0600590060	Cable Press Plate
61	0600590061	Lower Cover
62	0600590062	Upper Cover
63	0600590063	Right Lower Cover
64	0600590064	Right Upper Cover

65	0600590065	Cap Nut	98	0600590098	Return Spring
66	0600590066	Corrugated Pipe	99	0600590099	Push Button
67	0600590067	Folding Plate	100	0600590100	Sliding Sleeve
68	0600590068	Rotating Shaft	101	0600590101	Limit lock Shaft
69	0600590069	Elastic Pin	102	0600590102	Trigger Slider
70	0600590070	Right Pop-up Pin	103	0600590103	Micro Switch
71	0600590071	Pushing Down Tube	104	0600590104	Lower Operation Panel
72	0600590072	Bushing	105	0600590105	Speed Control Board
73	0600590073	Bolt	106	0600590106	Screw
74	0600590074	Bracket	107	0600590107	Soft Skin
75	0600590075	Hexagonal Nut	108	0600590108	Speed Control Knob
76	0600590076	Trigger Washer	109	0600590109	Knob Shrapnel
77	0600590077	Connecting Plate	110	0600590110	Flat Washer
78	0600590078	Screw	111	0600590111	Thin Hexagon Nut
79	0600590079	Bracket	112	0600590112	Spring Pressure Plate
80	0600590080	Left Cover	113	0600590113	Spring Pressing Plate
81	0600590081	Torsion Spring	114	0600590114	Trigger Block
82	0600590082	Elastic Pin	115	0600590115	Trigger Switch
83	0600590083	Pressing Plate	116	0600590116	Rocker Switch
84	0600590084	Handrail Rod	117	0600590117	Upper Pushing Tube
85	0600590085	Screw	118	0600590118	Connecting Sleeve
86	0600590086	Hexagonal Nut	119	0600590119	Corrugated Pipe
87	0600590087	Bolt	120	0600590120	Limiting Sleeve
88	0600590088	Back Cover	121	0600590121	Bushing
89	0600590089	Pin	122	0600590122	Wire Trigger
90	0600590090	E-Ring Circlip	123	0600590123	Switch Trigger Bracket
91	0600590091	Torsion Spring	124	0600590124	Upper Rail
92	0600590092	Grass Bag	125	0600590125	Trigger Bracket
93	0600590093	Grass Bag Bracket	126	0600590126	Spring
94	0600590094	Screw	127	0600590127	Steel Wire Trigger
95	0600590095	Folding Latch	128	0600590128	Rubber Hose
96	0600590096	Lower Bracket	129	0600590129	Flat Washer
97	0600590097	Upper Bracket	130	0600590130	Spring

131	0600590131	Self Locking Button	135	0600590135	Power Cord
132	0600590132	Upper Operation Panel	136	0600590136	Protective Cover
133	0600590133	Power Cord	137	0600590137	Pressing Plate
134	0600590134	Power Cord	138	0600590138	Screw

If any parts are missing or damaged, or if you have any questions, please call the toll-free helpline at 1-800-689-9928.

This Mastercraft® product is guaranteed for a period of **3 years from the date of original retail purchase** against defects in workmanship and materials, except for the following components:

- a) Component A: Batteries, chargers and carrying case, which are guaranteed for a period of 2 years from the date of original retail purchase against defects in workmanship and materials;
- b) Component B: Accessories, which are guaranteed for a period of 1 year from the date of original retail purchase against defects in workmanship and materials.

Subject to the conditions and limitations described below, this product, if returned to us with proof of purchase within the stated warranty period and if covered under this warranty, will be repaired or replaced (with the same model, or one of equal value or specification), at our option. We will bear the cost of any repair or replacement and any costs of labour relating thereto.

These warranties are subject to the following conditions and limitations:

- a) a bill of sale verifying the purchase and purchase date must be provided;
- b) this warranty will not apply to any product or part thereof which is worn or broken or which has become inoperative due to abuse, misuse, accidental damage, neglect or lack of proper installation, operation or maintenance (as outlined in the applicable owner's manual or operating instructions) or which is being used for industrial, professional, commercial or rental purposes;
- c) this warranty will not apply to normal wear and tear or to expendable parts or accessories that may be supplied with the product that are expected to become inoperative or unusable after a reasonable period of use;
- d) this warranty will not apply to routine maintenance and consumable items such as, but not limited to, fuel, lubricants, vacuum bags, blades, belts, sandpaper, bits, fluids, tune-ups or adjustments;
- e) this warranty will not apply where damage is caused by repairs made or attempted by others (i.e., persons not authorized by the manufacturer);
- f) this warranty will not apply to any product that was sold to the original purchaser as a reconditioned or refurbished product (unless otherwise specified in writing);
- g) this warranty will not apply to any product or part thereof if any part from another manufacturer is installed therein or any repairs or alterations have been made or attempted by unauthorized persons;
- h) this warranty will not apply to normal deterioration of the exterior finish, such as, but not limited to, scratches, dents, paint chips, or to any corrosion or discolouring by heat, abrasive and chemical cleaners; and
- i) this warranty will not apply to component parts sold by and identified as the product of another company, which shall be covered under the product manufacturer's warranty, if any.

Additional Limitations

This warranty applies only to the original purchaser and may not be transferred. Neither the retailer nor the manufacturer shall be liable for any other expense, loss or damage, including, without limitation, any indirect, incidental, consequential or exemplary damages arising in connection with the sale, use or inability to use this product.

Notice to Consumer

This warranty gives you specific legal rights, and you may have other rights, which may vary from province to province. The provisions contained in this warranty are not intended to limit, modify, take away from, disclaim or exclude any statutory warranties set forth in any applicable provincial or federal legislation.

Made in China

Imported by

Mastercraft Canada Toronto, Canada M4S 2B8

