

MAXIMUM[®]

Air-powered Finishing Nailer

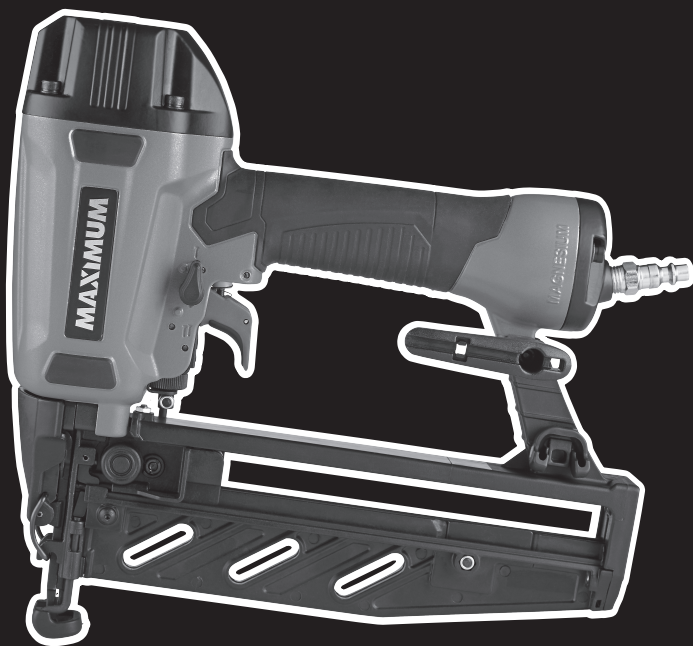

Model No. 058-9842-6

IMPORTANT:

Please read this manual carefully before using this product, and save it for reference.

**INSTRUCTION
MANUAL**

TABLE OF CONTENTS

TECHNICAL SPECIFICATIONS	4
SAFETY GUIDELINES	5
KEY PARTS DIAGRAM	10
TECHNICAL INFORMATION	11
TYPES OF NAILS	14
OPERATING INSTRUCTIONS	15
MAINTENANCE	19
TROUBLESHOOTING	20
EXPLODED VIEW	22
PARTS LIST	23
WARRANTY	24

NOTE: If any parts are missing or damaged, or if you have any questions, please call our toll-free helpline at 1-888-670-6682.



SAVE THESE INSTRUCTIONS

This manual contains important safety and operating instructions. Read all instructions and follow them with use of this product.

TECHNICAL SPECIFICATIONS

MAGAZINE CAPACITY	100 nails
NAILS	16-gauge finishing nails (1 - 2 1/2")
OPERATING PRESSURE	70-120 PSI (4.8-8.3 bar)
AIR CONSUMPTION	0.05 CF/cycle @ 90 PSI
AIR INLET	1/4" - 18 NPT
WEIGHT	3 lb 13 oz (1.74 kg)

CF: Cubic Feet (the volumetric flow rate of air corrected to standardized conditions of temperature and pressure).
NPT: National Pipe Thread.

SAFETY GUIDELINES

This manual contains information that relates to PROTECTING PERSONAL SAFETY and PREVENTING EQUIPMENT PROBLEMS. It is very important to read this manual carefully and understand it thoroughly before using the product. The symbols listed below are used to indicate this information.

**DANGER!**

Potential hazard that will result in serious injury or loss of life.

**WARNING!**

Potential hazard that could result in serious injury or loss of life.

**CAUTION!**

Potential hazard that may result in injury or damage to equipment.

PERSONAL SAFETY

These precautions are intended for the personal safety of the user and others working with the user. Please take time to read and understand them. Make sure you read and understand this manual before using this tool. Make sure other users read and understand this manual before they use the tool.

NOTE: The word "Note" is used to inform readers of something they need to know about the tool.

SAFETY GUIDELINES



- **Do not use oxygen or any other combustible or bottled gas to power air-powered tools.** Failure to observe this warning can cause explosion and serious personal injury or death. Use only compressed air to power air-powered tools. Use a minimum of 25' (7.6 m) of hose to connect the tool to the compressor. Failure to comply will result in serious injury or loss of life.

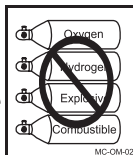

- **Risk of electric shock.** Do not expose a compressor to rain. Store it indoors. Disconnect the compressor from the power source before servicing. The compressor must be grounded. Do not use grounding adaptors.



- **Risk of personal injury.** Do not direct compressed air from the air hose toward the user or other people or animals.



- **Risk of inhalation.** Never directly inhale the air produced by the compressor.



- **Risk of bursting.** Do not adjust the pressure switch or safety valve for any reason. They have been preset at the factory for the compressor's maximum pressure. Tampering with the pressure switch or the safety valve may cause personal injury or property damage.

**DANGER!**

Potential hazard that will result in serious injury or loss of life.

- Keep children away from the work area. Do not allow children to handle power tools.
- Do not use this tool in the presence of flammable liquids or gases. Sparks that are created during use may ignite gases.
- Do not point the tool toward yourself or other people. Keep hands, feet and all other parts of the body clear from work area.
- Always ensure that the workpiece is firmly secured, leaving both hands free to control the tool.
- Always ensure that the tool has stopped after use, for safety purposes and to prevent possible damage to the tool or personal injury or death.



- **Risk of burns.** The pump and the manifold generate high temperatures. In order to avoid burns or other injuries, do not touch the pump, the manifold or the transfer tube while the compressor is running. Allow the parts to cool down before handling or servicing. Keep children and pets away from the compressor at all times.

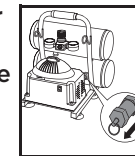

- **Risk of bursting.** Make sure the regulator is adjusted so that the compressor outlet pressure is set lower than the maximum operating pressure of the tool. Before starting the compressor, pull the ring on the safety valve to make sure the valve moves freely. Drain water from tank after each use. Do not weld or repair the tank. Relieve all pressure in the hose before removing or attaching accessories.

**WARNING!**

Potential hazard that could result in serious injury or loss of life.

- Do not allow unskilled or untrained individuals to operate the air-powered finishing nailer.
- Do not use the air-powered finishing nailer for any task other than that it is designed to perform.
- Keep hands and other parts of the body away from the firing head during use. Keep hands, feet, and all other parts of the body at least 8" (20 cm) away from the firing head. Nails can cause serious injury if they are deflected by the workpiece or by objects in the workpiece or if they are driven away from the point of entry.
- Do not drive a nail on top of existing nails. The nail may ricochet, causing serious personal injury.
- Use only nails of the proper size and gauge, as specified in this manual (see section "Technical Specifications"). Failure to comply could result in serious injury or loss of life.
- Protect the air hose and the power cord from damage and puncture. Inspect them for weak or worn spots before every use, and replace them if necessary.
- Always wear hearing protection when using the air compressor. Failure to do so may result in hearing loss.
- Do not carry the compressor while it is running.
- Do not operate the compressor if it is not in a stable position.
- Do not operate the compressor on a rooftop or in an elevated position that could allow the unit to fall or be tipped over.
- Always replace a damaged gauge before operating the unit.

- **Carry the tool by the handle only.** Do not carry the tool with a finger on the trigger. Do not carry the tool by the hose, the magazine nor any other part.
- **Keep proper footing at all times in order to ensure correct balance.**
- Do not use a tool that is leaking air, with missing or damaged parts, or that requires repairs. **Verify that all screws are securely tightened.**
- For optimal safety and tool performance, inspect the tool before every use in order to ensure free movement of the trigger, safety mechanisms, and spring.
- **Keep the work area clean.** A cluttered or dirty workbench or floor is more prone to accidents. They should be kept clear and clean.
- **This tool is not a toy. Use it with caution.**
- **Tripping hazard:** The air hose may become a tripping hazard when it is placed in the work area.
- **Do not store the tool in a freezing environment** to prevent ice formation on the operating valves of the tool, as doing so may cause tool failure.

- **Disconnect the tool from the air supply and turn off the compressor** before performing any maintenance, loading or changing nails, when the tool is not in use, when it is being handed to another person, and when it is left unattended. Failure to comply may result in injury or damage to equipment.

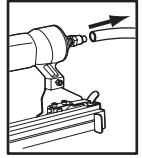

- **Use safety goggles and ear protection:**
Wear safety glasses with side shields when operating the tool and verify that others in the work area are also wearing safety glasses. Safety glasses must provide protection from flying particles from the front and the sides.



Air-powered tools are loud and the sound can cause hearing damage. Always wear ear protection to prevent hearing damage and loss. Failure to comply may result in injury.
Do not use while under the influence of alcohol, drugs or medication.



NOTE: Recycle unwanted materials rather than disposing of them as waste. Sort the tools, hoses, and packaging in specific categories and take them to the local recycling centre or dispose of them in an environmentally safe way.

**CAUTION!**

Potential hazard that may result in injury or damage to equipment.

**CAUTION!**

Potential hazard that may result in injury or damage to equipment.

No.	Description	No.	Description
1	Air inlet plug	5	Quick release handle
2	Pusher	6	Depth adjustment dial
3	Magazine	7	Trigger
4	Safety tip	8	Rear exhaust

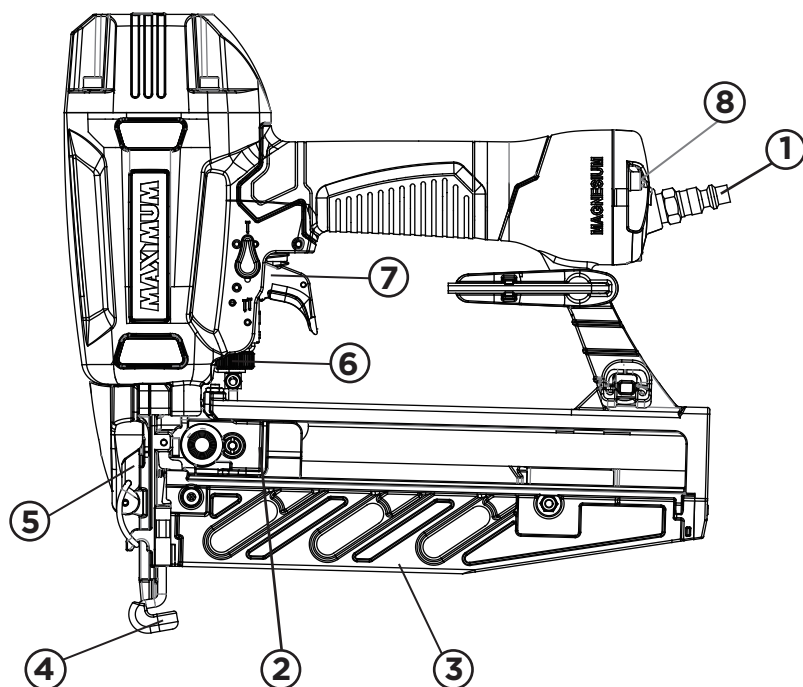

Compatible compressors

GUIDELINES FOR PROPER USE AND OPERATION

Be sure to use a proper air compressor with MAXIMUM® air-powered tools. The compressor that is being used must be able to supply appropriate amount of pressure (PSI) to the tool.

General use

This MAXIMUM® Air-powered Finishing Nailer is designed to drive 16GA finish nails from 1 - 2 1/2" in length. It includes a die cast magnesium body that delivers a strong and lightweight design, and an overmolded hand grip for improved control and comfort, even during extended use. The oil free design eliminates the need to add oil to the nailer and removes the risk of oil stains. The toggle switch allows for either sequential or contact fire mode with the simple flip of the switch. Other features include a tool-free jam release mechanism, tool-free depth adjustment, rear air exhaust, reversible belt hook, low nail indicator, dry-fire lock-out and no mar tip. The air-powered finishing nailer is best suited for interior and exterior finish and trim, furniture, cabinet work, base boards, shoe and crown molding, window casing, chair rail molding, etc.

Air Compressor Size and Power	1 1/2-2 HP	2 1/2 HP	3+ HP
4-5 Gallons	Light-duty and intermittent use	Light-duty and intermittent use	Light-duty and intermittent use
6-11 Gallons	Light-duty and intermittent use	Medium-duty and intermittent use	Medium-duty and intermittent use
15+ Gallons	Medium-duty and intermittent use	Heavy-duty and continuous use	Heavy-duty and continuous use

Wood Density	Nail Size	Compressor Air Pressure
>0.6 g/cm ³	<1 1/2" (38 mm) finish nails	90 PSI (6.2 bar)
	≥1 1/2" (38 mm) finish nails	120 PSI (8.3 bar)
≤0.6 g/cm ³	<1 1/2" (38 mm) finish nails	70 PSI (4.8 bar)
	≥1 1/2" (38 mm) finish nails	100 PSI (7 bar)

Air system

- Always use clean, dry, regulated, compressed air at 4.8 to 8.3 bar (70 to 120 PSI).
- Do not exceed the maximum or minimum pressures. Operating the tool at inappropriate pressure (too low or too high) will cause excessive noise or rapid wear.

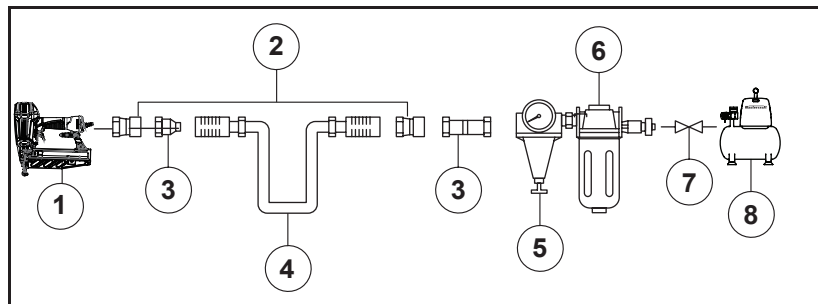

No.	Description	No.	Description
1	MAXIMUM® Air-powered Finishing Nailer	5	Regulator 0-123 PSI (0-8.5 bar)
2	Quick connector	6	Filter
3	Quick coupler	7	Cut-off valve
4	Air hose	8	Air compressor

Read this Instruction Manual carefully before using the tool.

- Read and follow all the safety instructions at the beginning of this manual. Inspect the air-powered finishing nailer prior to each use in order to:
 - Ensure that the proper power source is being used.
 - Verify that the tool is in proper working order.
 - Verify that the air pressure level(s) are properly set on the air compressor.
- It is recommended that a filter-regulator be used and be located as close to the tool as possible.
- If a filter-regulator is installed, keep the air filter clean. A dirty filter will reduce the air pressure to the tool, which will cause a reduction in power, efficiency, and general performance.
- For optimal performance, install a quick connector to the tool and a quick coupler on the hose, if applicable.
- Verify that all connections in the air supply system are sealed in order to prevent air leakage.

**WARNING!**

Potential hazard that could result in serious injury or loss of life.

- Keep hands and other parts of the body away from the tool's discharge and working areas when connecting the tool to the air supply. Failure to comply could lead to serious injury or loss of life.

**WARNING!**

Potential hazard that could result in serious injury or loss of life.

- Do not use the tool if it is not in proper working order.
- Do not use oxygen or any other combustible or bottled gas to power this tool.
- Do not use this tool in the presence of any flammable liquids or gases.
- Keep hands and other parts of the body away from the firing head during use.
- Do not point the tool towards the operator or other people.
- Do not attempt to clear a jammed nail when the air hose is connected.
- Do not drive a nail on top of an existing nail. Failure to comply could lead to serious injury or loss of life.

This MAXIMUM® Air-powered Finishing Nailer drives 16-gauge
1 - 2 1/2" (25-64 mm) long finish nails.

ACCEPTABLE NAILS

Length: 1 - 2 1/2" (25 to 64 mm)

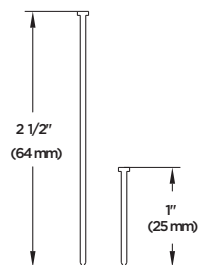

NAIL TYPE ICONS

These icons are used to select the proper nails for this specific nailer.

COMPATIBLE NAILS: CLOUS COMPATIBLES :



NAIL SIZE:
TAILLE :
1 - 2 1/2"

NOTE: Icons are colour coded. Please refer to the actual tool for the specific colour.



WARNING!

Potential hazard that could result in serious injury or loss of life.

- The use of any other types of nails will cause the nailer to jam and could lead to serious injury or loss of life.

Loading Nails

1. Disconnect the tool (1) from the air supply (2) (Fig. A).

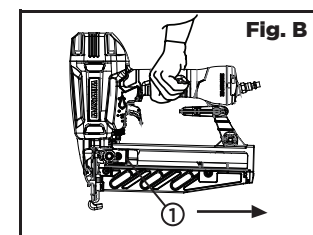
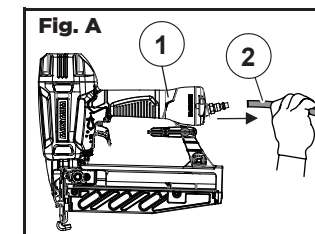

2. Hold the air-powered finishing nailer firmly with one hand. Use the other hand to slide the pusher (1) back until locked (Fig. B).

3. Make sure you have the right nails for your tool (page 14). Insert a strip of nails (1) through the slot in the rear of magazine. Ensure the points of the nails are facing down. Press the button to release the pusher. The pusher will stop when it rests against the last nail in the strip (Fig. C).

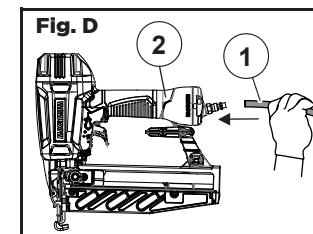
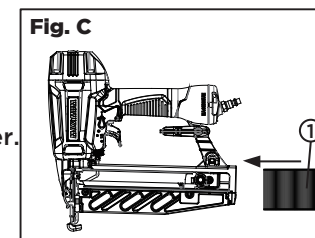

4. Plug in compressor, turn it on, set the pressure regulator to 90 PSI, and attach one end of the air hose to the compressor and the other end of the air hose (1) to the tool (2). Use plumber's tape to prevent air leaks (Fig. D).



DANGER!

Potential hazard that could result in serious injury or loss of life.

- Disconnect the tool from the compressed air source before loading nails.
- Do not point the tool towards the operator or other people while changing nails.
- Do not hold the tool with the trigger pressed while changing the nails. Failure to comply will result in serious injury or loss of life.

Fig. E

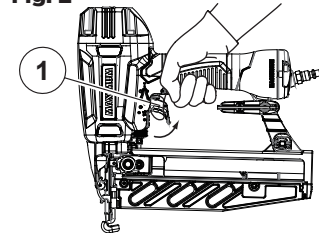

5. Test the driving depth of the tool against a scrap piece of wood by pressing the trigger (1) before working on the workpiece. If the nails are being driven too deep or not deep enough, adjust the depth adjustment dial to achieve desired penetration (Fig. E).

6. This tool is featured with anti-dry fire function. When only few nails are remained in magazine, tool will be locked until reloading more nails. When this happens, repeat above 1 to 3 steps.

Firing modes

The MAXIMUM® Air-powered Finishing Nailer offers two types of actuation modes.

Sequential actuation mode

1. Press the safety tip firmly against the workpiece.
2. Pull the trigger.
3. If the safety tip remains pressed, successive nails will fire each time the trigger is pulled.

Contact fire (bump fire) actuation mode

Using this mode, two methods are available: single fastener placement and rapid fastener operation.



CAUTION!

Potential hazard that may result in injury or damage to equipment.

- Operate the tool with the utmost care when it is connected to the air compressor. Failure to comply may result in injury or damage to equipment.



WARNING!

Potential hazard that could result in serious injury or loss of life.

- The safety stand must be in contact with the workpiece before activating the tool.
- Do not operate the tool if the nails are not loaded as doing so may damage the tool.
- Do not fire nails into the air as doing so may cause injury to the operators or others, apart from damaging the tool.
- Do not load different sized nails into the magazine as doing so may cause nails to jam. Failure to comply could lead to serious injury or loss of life.

SINGLE FASTENER PLACEMENT:

1. Press the safety tip firmly against the workpiece.
2. Pull the trigger.

RAPID FASTENER OPERATION:

1. Pull the trigger.
2. Press the safety tip against the workpiece. As long as the trigger is pulled, the tool will drive a nail every time the contact tip is depressed.

Fasteners depth adjustment

The MAXIMUM® Air-powered Finishing Nailer has a depth adjustment dial below the trigger to adjust the firing depth of the fasteners.

Note: Refer to the graphic imprinted below the trigger and adjust the firing depth accordingly (Fig. F).

Fig. F

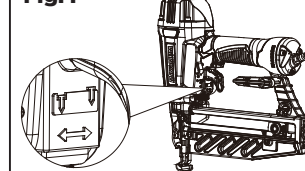

DECREASING FASTENER DEPTH

Turn the depth adjustment dial counter-clockwise (with the discharge area of the tool facing away from the operator and other people) (Fig. G).

Fig. G

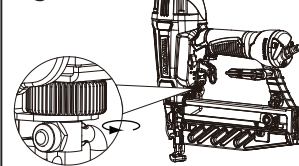

INCREASING FASTENER DEPTH

Turn the depth adjustment dial clockwise (with the discharge area of the tool facing away from the operator and other people) (Fig. H).

Fig. H

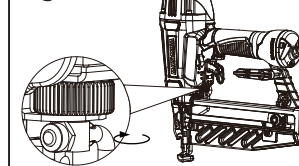

CAUTION!

Potential hazard that may result in injury or damage to equipment.

- If the trigger is pressed a second time, the recoil of the nailer may lift the safety stand enough to allow a second nail to be fired, even if the operator has not lifted the tip off the safety stand.
- Operate the tool with the utmost care when it is connected with the air compressor. Failure to comply may result in injury or damage to equipment.

Cold weather operation

When operating any air-powered tool below freezing temperature:

- Verify that the compressor tanks have been properly drained prior to use.
- Keep the tool as warm as possible using any safe, convenient method.
- Maintain the operating level of the air pressure as recommended (see section “Technical Specifications”).
- Load the nails into the magazine (if required).
- Actuate the tool 5 to 6 times into a scrap wooden piece in order to warm up parts.
- Adjust the pressure up to the operating level (do not exceed 120 PSI) and use the tool normally.
- Drain the compressor tanks at least once per day.

Clearing a jammed nail

To clear a jammed nail:

- Disconnect the tool from the air supply line.
- Remove the nails that are stored in the tool's magazine.
- Push down the release latch and open the door for viewing the jammed nails.
- Use pliers or any appropriate tool to remove the jammed nails.
- Close door and latch.
- Reload the nails into the tool magazine.
- Reconnect the air line to the tool's air inlet.
- Test fire 3 to 5 nails into a piece of scrap wood in order to ensure proper operation.

Note: For further repair information, please call 1-888-670-6682.



WARNING!

Potential hazard that could result in serious injury or loss of life.

- Disconnect the air supply from the tool before loading or changing the nails.
- Disconnect the magazine from the tool and remove the non-jammed nails from the tool before clearing the jammed nails. Failure to comply will cause them to be fired out of the tool, causing serious injury.
- Do not point the tool towards the operator or other people with the trigger pressed while loading or changing the fasteners. Serious personal injury may occur.

Maintenance

MAINTENANCE REQUIRED	DESCRIPTION	TOOLS OR MATERIALS REQUIRED	MAXIMUM SERVICE INTERVAL		
			Each use or every 2 hrs	Monthly	As needed
General inspection — free movement	Trigger, spring, safety mechanism	No	X		
In-depth inspection	Worn or broken parts	Yes		X	X
Replace worn or broken parts		Yes			X

- Air-operated tools must be inspected periodically and worn or broken parts must be replaced in order to keep tools operating safely and efficiently.
- Inspect and replace worn or damaged O-rings, seals, etc. Tighten all screws and caps frequently in order to help prevent personal injury.
- Inspect the trigger, spring, and safety mechanism for free movement on a regular basis in order to ensure that the safety system is fully functional. Verify that no parts are loose or missing and no parts are sticking or jammed.
- Keep the magazine and the safety stand of the tool clean and free of any dirt or abrasive particles.

Note: When temperatures are below freezing, keep the tools warm using any safe, convenient method.



DANGER!

Potential hazard that will result in serious injury or loss of life.

- Disconnect the tool from the air compressor before performing maintenance service, adjusting, clearing jams, reloading, and when it is not in use.
- Repairs must be performed by a qualified service technician only. Failure to comply will lead to serious injury or loss of life.

Troubleshooting

The following chart lists common issues and solutions. Please read it carefully and follow all instructions carefully.

- Disconnect the tool from the air supply before making any adjustments.
- Repairs and replacement must be performed only by a qualified service technician or in an authorized service centre.

PROBLEM	POSSIBLE CAUSES	SOLUTIONS
Air leakage in the trigger area.	<ol style="list-style-type: none"> 1. O-rings in the trigger valve are damaged. 2. The trigger valve heads are damaged. 3. Trigger valve stem, seal, or O-rings are damaged. 	<ol style="list-style-type: none"> 1. Inspect and replace the O-rings. 2. Inspect and replace trigger valve heads. 3. Inspect and replace the trigger valve stem, seal, or O-rings.
Air leakage at the bottom of the tool.	<ol style="list-style-type: none"> 1. The screws are loosened. 2. The O-rings or the bumper are worn or damaged. 	<ol style="list-style-type: none"> 1. Tighten the screws. 2. Inspect and replace the O-rings or the bumper.
Air leakage between the body and the cylinder cap.	<ol style="list-style-type: none"> 1. The screws are loosened. 2. The O-rings or the seals are worn or damaged. 	<ol style="list-style-type: none"> 1. Tighten the screws. 2. Inspect and replace the O-rings or the seals.
The nails are being driven too deep.	<ol style="list-style-type: none"> 1. The bumper is worn. 2. The air pressure is too high. 	<ol style="list-style-type: none"> 1. Replace the bumper. 2. Adjust the air pressure.



DANGER!

Potential hazard that will result in serious injury or loss of life.

- If any of the following symptoms appear while the tool is in use, turn it off and disconnect it from the air supply immediately. Failure to comply will lead to serious injury or loss of life.

PROBLEM	POSSIBLE CAUSES	SOLUTIONS
The tool does not operate properly - it does not drive the nails or operates sluggishly.	<ol style="list-style-type: none"> 1. The air supply is inadequate. 2. The O-rings or seals are worn or damaged. 3. The air deflector in the cylinder head is blocked. 	<ol style="list-style-type: none"> 1. Verify that the air supply is adequate. 2. Inspect and replace O-rings or seals. 3. Replace the damaged internal parts.
The tool skips nails.	<ol style="list-style-type: none"> 1. The bumper is worn or the spring is damaged. 2. There is dirt in the front plate. 3. Nails cannot move freely in the magazine because of dirt or damage. 4. The O-ring on the piston is worn. 5. The cylinder cover seal is leaking. 	<ol style="list-style-type: none"> 1. Replace the bumper or pusher spring. 2. Clean the drive channel on the front plate. 3. Clean the magazine. 4. Replace the O-ring. 5. Replace the sealing washer.
The tool jams.	<ol style="list-style-type: none"> 1. Improper nails are used, or nails are damaged. 2. The driver guide is damaged or worn. 3. The screw of the magazine is loosened. 4. There is dirt in the magazine. 	<ol style="list-style-type: none"> 1. Change and use appropriate nails. See section "Clearing a jammed nail" for instructions. 2. Inspect and replace the driver. 3. Tighten the screw. 4. Clean the magazine.

Note: For further repair information, please call 1-888-670-6682.

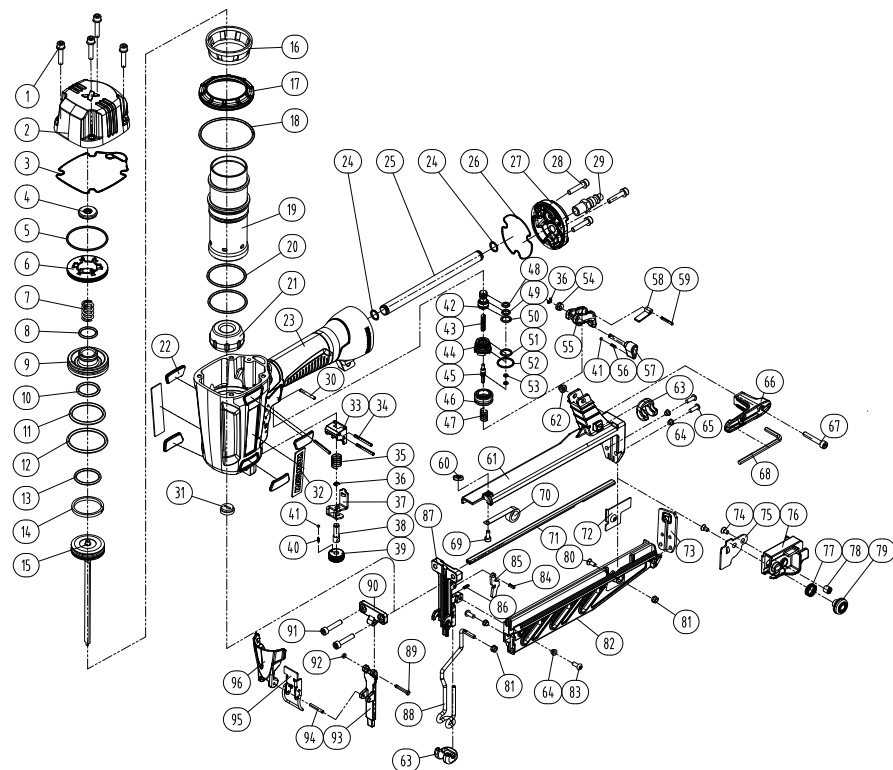

No.	Description
1	Screw
2	Cylinder Cap
3	Seal
4	Gasket
5	O-ring
6	Head Valve Guide
7	Spring
8	O-ring
9	Valve
10	O-ring
11	O-ring
12	O-ring
13	O-ring
14	Piston Ring

No.	Description
15	Piston Unit
16	Collar
17	Spacing
18	O-ring
19	Cylinder
20	O-ring
21	Bumper
22	Matress
23	Body Assembly
24	O-ring
25	Airway Tube
26	Gasket
27	End Cap
28	Screw

No.	Description
29	Air Plug
30	Pin
31	Rubber Mat
32	Name Plate
33	Guide Piece
34	Pin
35	Spring
36	Stopped Ring
37	Upper Bracket
38	Connecting Set
39	Nut
40	Spring
41	Steel Ball
42	Trigger Valve Head
43	Spring
44	Trigger Valve Bush
45	Trigger Valve Stem
46	Trigger Valve Guide
47	Spring
48	O-ring
49	O-ring
50	O-ring
51	O-ring
52	O-ring
53	O-ring
54	Shaft Sleeve
55	Trigger
56	Spring
57	Switch Grip Assembly
58	Spring
59	Pin
60	Nut
61	Upper Magazine
62	Nut

No.	Description
63	Safety Cover
64	Bushing
65	Screw
66	Belt Hook
67	Screw
68	Wrench
69	Screw
70	Spring
71	Rail
72	Guide Plate
73	Movable Magazine Cap
74	Screw
75	Pusher
76	Pusher Guide
77	Spring
78	Barrel
79	Button
80	Screw
81	Locknut
82	Lower Magazine
83	Screw
84	Pin
85	Top Plate
86	Lever Spring
87	Driver Guide
88	Safety Bracket
89	Pin
90	Plate
91	Screw
92	Washer
93	Cover Plate
94	Spring Pin
95	Pressing Plate
96	Plate Cover

If any parts are missing or damaged, or if you have any questions, please call 1-888-670-6682.

This MAXIMUM product is guaranteed for a period of 5 years from the date of original retail purchase against defects in workmanship and materials only and is subject to the following components:

Component A: The carrying case is guaranteed for a period of 1-year from the date of original retail purchase against defects in workmanship and materials.

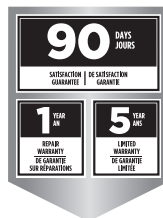

Subject to the conditions and limitations described below, this product, if returned to us with proof of purchase within the stated warranty period and if covered under this warranty, will be repaired or replaced (with the same model, or one of equal value or specification), at the sole discretion of the Maximum Canada authorised repair centre ("Service Provider"). We will bear the cost of any repair or replacement and any costs of labour relating thereto.

These warranties are subject to the following conditions and limitations:

- a) A bill of sale verifying the purchase and purchase date must be provided;
- b) Defects in workmanship and material to be assessed and determined by the Service Provider;
- c) This warranty will not apply to any product or part thereof which is worn or broken or which has become inoperative due to abuse, misuse, accidental damage, neglect or lack of proper installation, operation or maintenance (as outlined in the applicable owner's manual or operating instructions);
- d) This warranty does not apply to normal wear and tear or to expendable parts or accessories (including drill bits and saw blades) that may be supplied with the product that by their nature have a limited life span and are expected to become inoperative or unusable after a reasonable period of use;
- e) This warranty will not apply to routine maintenance and consumable items such as, but not limited to, driver blades, bumpers, pistons, piston rings, rubber o-rings, tune-ups or adjustments;
- f) This warranty excludes the following components that may accompany your product:
 - (1) The carrying case, which is only for a period of 1-year from the date of original retail purchase against defects in workmanship and materials.
 - (2) Accessories, including drill bits and saw blades, which do not carry a warranty of any kind.
- g) This warranty will not apply where damage is caused by repairs made or attempted by others (i.e., persons not authorized by the manufacturer), and any such unauthorized repairs or attempted repairs shall void this warranty in its entirety;

- h) This warranty will not apply to any parts other than original parts, except to the extent that the retailer or manufacturer or persons authorized by either of them have repaired or replaced them;
- i) This warranty will not apply to any product that was sold to the original purchaser as a reconditioned or refurbished product (unless otherwise specified in writing);
- j) This warranty will not apply to any product or part thereof if any part from another manufacturer is installed therein or any repairs or alterations have been made or attempted by unauthorized persons;
- k) This warranty will not apply to normal deterioration of the exterior finish, such as, but not limited to, scratches, dents, paint chips, or to any corrosion or discolouring by heat, abrasive and chemical cleaners; and
- l) This warranty will not apply to component parts sold by and identified as the product of another company, which shall be covered under that product manufacturer's warranty, if any;
- m) Any products replaced by the retailer in attempt to fulfill warranty obligations is subject to the original product warranty conditions and related time period as initiated by the original date of purchase; if product is purchased in Quebec, the warranty term will be extended for a period equal to the time during which the Quebec retailer possesses the product in attempt to fulfill warranty obligations; replaced product will not default to new product warranty conditions; and
- n) The retailer and manufacturer's sole obligation and the purchaser's sole remedy under this warranty shall be as set out herein. The warranties contained herein are not transferable and are given only to the purchaser.

FURTHER, THE WARRANTIES SET OUT HEREIN ARE IN LIEU OF ALL OTHER WARRANTIES OR CONDITIONS, WHETHER EXPRESS, IMPLIED OR STATUTORY (INCLUDING SUCH AS ARISE UNDER THE SALE OF GOODS ACT OR THE INTERNATIONAL SALE OF GOODS ACT), ARISING OUT OF A COURSE OF DEALING OR USAGE OF TRADE OR OTHERWISE, INCLUDING, SUBJECT TO APPLICABLE LAW, ANY IMPLIED WARRANTIES OR CONDITIONS OF MERCHANTABILITY, MERCHANTABLE QUALITY, FITNESS OR ADEQUACY FOR A PARTICULAR PURPOSE OR USE, AND ALL OTHER SUCH WARRANTIES ARE EXPRESSLY DISCLAIMED BY THE RETAILER AND MANUFACTURER.

Additional Limitations

This warranty applies only to the original purchaser and may not be transferred.

This warranty applies for a period of 5 years from the date of original retail purchase, as indicated on the bill of sale.

Neither the retailer, Maximum Canada, nor the manufacturer shall be liable for any other expense, loss or damage, including, without limitation, any indirect, incidental, consequential or exemplary damages arising in connection with the sale, use or inability to use this product.

Under no circumstances shall the retailer, Maximum Canada, or manufacturer be liable to the purchaser for any claim for (a) indirect, special, punitive, incidental, exemplary, or consequential damages, (b) compensation for loss of profits, anticipated revenue, savings or goodwill, or other economic loss of the purchaser, (c) exemplary, aggravated or punitive damages howsoever incurred, (d) contribution or set-off in respect of any claims against the purchaser, (e) any damages whatsoever relating to third party products or services or the purchaser's materials, or (f) any damages whatsoever relating to interruption, delays, errors or omissions; in each case under any theory of law or equity, arising out of or in any way related to this warranty, even if advised of the possibility thereof. Notwithstanding any provision herein or entitlement of the purchaser at law, in equity or otherwise, in no event shall the liability of the retailer or manufacturer under this warranty, whether in contract, tort, product liability or otherwise, exceed, in the aggregate, the amount paid by the purchaser to the retailer for the product to which this warranty applies.

*Notice to Consumer

This warranty gives you specific legal rights, and you may have other rights, which may vary from province to province. The provisions contained in this warranty are not intended to limit, modify, take away from, disclaim or exclude any statutory warranties set forth in any applicable provincial or federal legislation.

In addition to the 5-Year Limited Warranty, this MAXIMUM product is covered by our:

1-Year Repair Warranty

Maximum Canada will maintain this product and replace critical parts which have worn beyond reasonable use through normal use of such product, any time during the first year after purchase.

The following are excluded from this 1-Year Repair Warranty:

- a) Missing or damaged parts or components that are a result of abuse or misuse;
- b) Any wear and tear to non-critical parts or accessories that do not affect the core function of the product.

90-Day Satisfaction Guarantee

If you are not completely satisfied with the performance of your MAXIMUM product for any reason, you can return it within 90 days from the date of purchase with proof of purchase for exchange or a full refund.

Made in China,

Imported by
MAXIMUM Canada Toronto, Canada M4S 2B8