

model no. 058-9325-8 | contact us 1-800-689-9928

- g) This warranty will not apply to any product or part thereof if any part from another manufacturer is installed therein or any repairs or alterations have been made or attempted by unauthorized persons.
- h) This warranty will not apply to normal deterioration of the exterior finish, such as, but not limited to, scratches, dents, paint chips, or to any corrosion or discolouring by heat, or abrasives and chemical cleaners.
- i) This warranty will not apply to component parts sold by and identified as the product of another company, which shall be covered under the product manufacturer's warranty, if any.

Additional limitations

This warranty applies only to the original purchaser and may not be transferred. Neither the retailer nor the manufacturer shall be liable for any other expense, loss or damage, including, without limitation, any indirect, incidental, consequential, or exemplary damages arising in connection with the sale, use, or inability to use this product.

Notice to consumer

This warranty gives you specific legal rights, and you may have other rights, which may vary from province to province. The provisions contained in this warranty are not intended to limit, modify, take away from, disclaim, or exclude any statutory warranties set forth in any applicable provincial or federal legislation.

Made in China

Imported by Mastercraft Canada Toronto, Canada M4S 2B8



model no. 058-9325-8

5" AIR-POWERED DUAL-ACTION SANDER

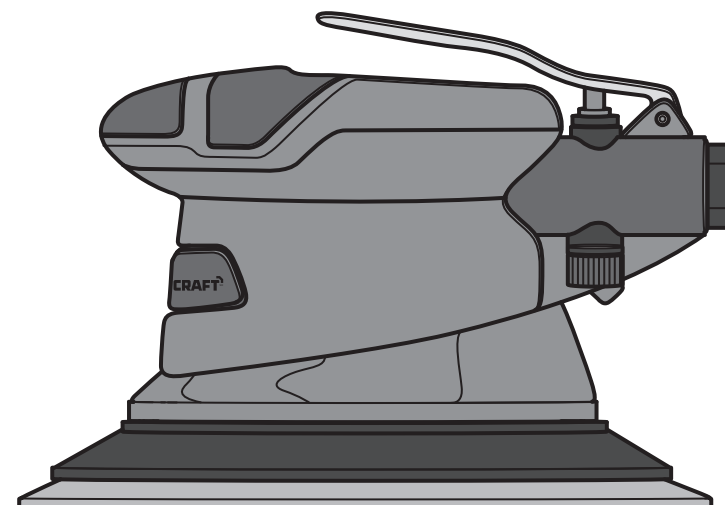

IMPORTANT:

For your own safety, read and follow all of the Safety Guidelines and Operating Instructions before operating this sander. Keep this manual for future reference.

INSTRUCTION MANUAL

TABLE OF CONTENTS

TECHNICAL SPECIFICATIONS	3
SAFETY GUIDELINES	4
KEY PARTS DIAGRAM	10
IMPORTANT INFORMATION	11
OPERATING INSTRUCTIONS	14
MAINTENANCE	16
TROUBLESHOOTING	18
EXPLODED VIEW	20
PARTS LIST	21
WARRANTY	22

NOTE: If any parts are missing or damaged, or if you have any questions, please call our toll-free helpline at 1-800-689-9928.



SAVE THESE INSTRUCTIONS

This manual contains important safety and operating instructions. Read all instructions and follow them with use of this product.

TECHNICAL SPECIFICATIONS

SANDING PAD	5" (125 mm)
SPEED (NO LOAD)	10,000 RPM
CFM REQUIREMENT	2.2 CFM @ 90 PSI (6.2 bar)
WORKING PRESSURE	90 PSI (6.2 bar)
AIR INLET SIZE	1/4"-18 NPT
AIR HOSE	3/8" (9.5 mm) ID
WEIGHT	2 lb 3 oz (1.00 kg)

CFM: Cubic Feet per Minute (the volumetric flow rate of air corrected to standardized conditions of temperature and pressure).

NPT: National Pipe Thread.

SAFETY GUIDELINES

This manual contains information that relates to PROTECTING PERSONAL SAFETY and PREVENTING EQUIPMENT PROBLEMS. It is very important to read this manual carefully and understand it thoroughly before using the product. The symbols listed below are used to indicate this information.

**DANGER!**

Potential hazard that will result in serious injury or loss of life.

**WARNING!**

Potential hazard that could result in serious injury or loss of life.

**CAUTION!**

Potential hazard that may result in moderate injury or damage to equipment.

Note: The word "Note" is used to inform the reader of something he/she needs to know about the tool.

PERSONAL SAFETY

These precautions are intended for the personal safety of the user and others working with the user. Please take time to read and understand them.

SAFETY GUIDELINES

**DANGER!**

Potential hazard that will result in serious injury or loss of life.

- **Keep children away** from the work area. Do not allow children to handle power tools.
- **Do not use this tool in the presence of flammable liquids or gases.** Sparks that are created during use may ignite gases.
- **Do not point the tool towards yourself or other people, even if the tool has stopped.** Keep hands, feet, and all other parts of the body away from work area.
- **Always ensure that the tool has stopped before putting it down after use,** for safety and to prevent possible damage to the tool/user.



- **Risk of electric shock:** Do not expose the compressor to rain. Store it indoors. Disconnect the compressor from the power source before servicing. The compressor must be grounded. Do not use grounding adaptors.



- **Risk of personal injury:** Do not direct compressed air from the air hose towards the user or other people.



- **Risk for breathing:** Never directly inhale the air produced by a compressor.



- **Risk of bursting:** Do not adjust the pressure switch or safety valve for any reason. They have been preset at the factory for this compressor's maximum pressure. Tampering with the pressure switch or the safety valve may cause personal injury or property damage.



- **Risk of burns:** The pump and the manifold generate high temperatures. In order to avoid burns or other injuries, do not touch the pump, the manifold, or the transfer tube while the compressor is running. Allow the parts to cool down before handling or servicing. Keep children away from the compressor at all times.

- **Do not use oxygen or any other combustible or bottled gas** to power air-powered tools. Failure to observe this warning can cause explosion and serious personal injury or death. Use only compressed air to power the air-powered tools. Use a minimum of 25' (7.6 m) of hose to connect the tool to the compressor. Failure to comply will result in serious injury or loss of life.

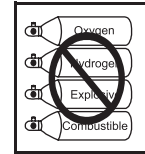

- **Risk of bursting:** Make sure the regulator is adjusted so that the compressor outlet pressure is set lower than the maximum operating pressure of the tool. Before starting the compressor, pull the ring on the safety valve to make sure the valve moves freely. Drain water from tank after each use. Do not weld or repair tank. Relieve all pressure in the hose before removing or attaching accessories.

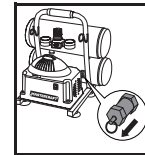

**WARNING!**

Potential hazard that could result in serious injury or loss of life.

- Do not allow unskilled or untrained individuals to operate this tool.
- Always ensure that the accessories are specially designed for use with the tool. Also ensure they are secured and correctly fastened before connecting the tool to air supply.
- **Switch and controls:** Ensure that the air flow adjuster is closed when placing the air sander in upside-down position, in order to avoid any personal injury.
- Do not carry the tool by the air supply hose.
- Pull the pressure safety valve ring every day in order to ensure that the valve is functioning properly.
- Locate the compressor in a well-ventilated area for cooling, and a minimum of 12" (31 cm) away from the nearest wall.
- Protect the air hose and the power cord from damage and puncture. Inspect them for weak or worn spots every week, and replace them if necessary.
- Always wear hearing protection when using an air compressor. Failure to do so may result in hearing loss.
- Do not carry the compressor while it is running.
- Do not operate the compressor if it is not in a stable position.
- Do not operate the compressor on a rooftop or in an elevated position that could allow the unit to fall or be tipped over.

**CAUTION!**

Potential hazard that may result in moderate injury or damage to equipment.

- Always ensure that the tool has stopped before connecting to air supply.
- Do not wear watches, rings, bracelets, or loose clothing when using any air tool.
- Keep proper footing at all times in order to ensure correct balance. Verify that the floor is not slippery, and wear non-slip shoes.
- Do not overload the tool. Allow the tool to operate at its optimum speed for maximum efficiency.
- Do not use a tool that is leaking air, with missing or damaged parts, or that requires repairs. Verify that all screws are securely tightened.
- For optimal safety and tool performance, inspect the tool daily in order to ensure free movement of the trigger, safety mechanisms, and spring.
- Always keep your air-powered tool clean and lubricated. Daily lubrication is essential to avoid internal corrosion and possible failures.
- Keep the work area clean. A cluttered or dirty workbench may lead to an accident. Floors should be kept clear.
- Use the tool only in a well-ventilated area.
- Handling and storage of oil: Use with adequate ventilation. Avoid contact of oil with eyes, skin, and clothing. Avoid breathing spray or mist. Store in a tightly closed container in a cool, dry, well-ventilated area free from incompatible substances.
- Do not use the tool near or below the freezing condition, because the moisture in the air line may freeze and cause tool failure.
- Do not store the tool in a freezing environment to prevent frost or ice formation on the operating valves and mechanisms of the tool which may cause tool failure.
- Do not use the tool for a task that it is not designed to perform.

**CAUTION!**

Potential hazard that may result in moderate injury or damage to equipment.

- Disconnect tool from the air supply and turn off the compressor before performing any maintenance, changing accessories, when the tool is not in use, when it is handed to another person, and when it is left unattended. Failure to comply may result in moderate injury or damage to equipment.

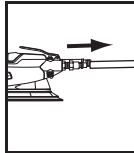

- Use safety goggles and ear protection: Wear safety glasses with side shields when operating the tool/compressor and verify that others in the work area are also wearing safety glasses. Safety glasses must conform to American National Standards Institute ANSI Z87.1 (or in Canada, CSA Z94.3) requirements and must provide protection from flying particles from the front and the sides.



Air-powered tools are loud and the sound can cause hearing damage. Always wear ear protection to prevent hearing damage and loss. Failure to comply may result in moderate injury.

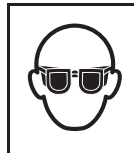

Note: Recycle unwanted materials rather than disposing of them as waste. Sort the tools, hoses, and packaging in specific categories and take to the local recycling centre or dispose of them in an environmentally safe way.

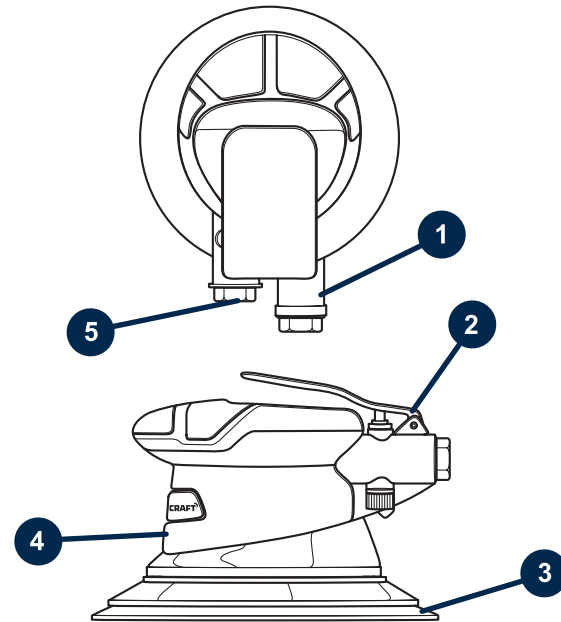

No.	Description	No.	Description
1	Air outlet plug	4	Main housing
2	Trigger	5	1/4" (6.4 mm) NPT air inlet plug
3	Sanding pad		

General usage description

The Mastercraft® 5" Air-powered Dual-action Sander features a housing made of durable, lightweight aluminum. The tool is designed with comfortable and ergonomic grips. An air regulator is attached for speed control, and a dust-proof mat is attached for filtering the debris away from the tool. The tool is useful for sanding wood, metal, fiberglass, and auto body filler. This sander provides a quiet sanding action for a smooth pattern-free finish.

Compatible compressors

GUIDELINES FOR PROPER USAGE AND OPERATION

Always ensure the use of appropriately matched air tools and compressors. The compressor should be able to supply a minimal air delivery of 2.8 CFM @ 90 PSI to ensure the compressor can run continuously with the Mastercraft® 5" Air-powered Dual-action Sander. Using tools or a combination of tools that together or separately require more than the air compressor can deliver will reduce performance and could void the compressor or tool guarantee/warranty.

Air Compressor Size and Power	2 HP	2 1/2 HP	3+ HP
5–6 Gallons	Light duty and intermittent use	Light duty and intermittent use	Medium duty and intermittent use
8–11 Gallons	Light duty and intermittent use	Medium duty and intermittent use	Heavy duty and continuous use
15+ Gallons	Medium duty and intermittent use	Heavy duty and continuous use	Heavy duty and continuous use

Air system

- Always use clean, dry, regulated, compressed air at 60 to 100 PSI (4.1 to 6.9 bar).
- Do not exceed the maximum and minimum pressures. Operating the tool at the wrong pressure (too low or too high) will cause excessive noise or rapid wear.



CAUTION!

Potential hazard that may result in moderate injury or damage to equipment.

- Verify that all connections in the air supply system are sealed in order to prevent air from leaking. Failure to comply may result in moderate injury or damage to equipment.

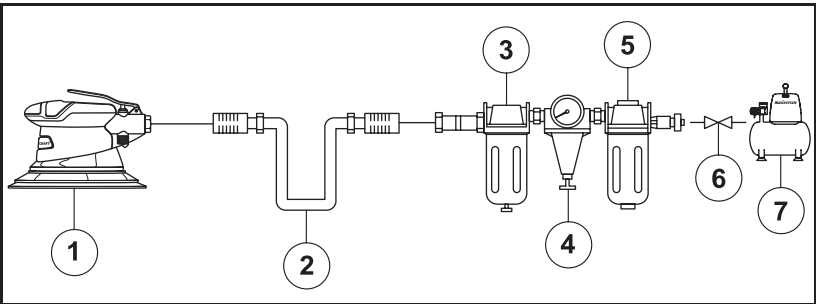

No.	Description	No.	Description
1	Mastercraft® 5" Air-powered Dual-action Sander	5	Filter
2	Air hose	6	Cut-off valve
3	Lubricator	7	Air compressor
4	Regulator (0 to 8.5 bar)		



WARNING!

Potential hazard that could result in serious injury or loss of life.

- Keep hands and other parts of the body away from the work areas when connecting the air supply. Failure to comply could lead to serious injury or loss of life.
- It is recommended that a filter-regulator-lubricator be used and be located as close to the tool as possible.
- If a filter-regulator-lubricator is not installed, place up to 6 drops of lubricating oil into the air inlet before each use.
- If a filter-regulator-lubricator is installed, keep the air filter clean. A dirty filter will reduce the air pressure to the tool, which will cause a reduction in power, efficiency, and general performance.

Read this instruction manual thoroughly or have tool operators read thoroughly before using the tool.

- Read all safety guidelines (see section "Safety Guidelines") at the beginning of this manual.
- Always inspect the air tool prior to each use to:
 - Ensure proper use of power source.
 - Determine whether the tool is in proper working order.
- Use sanding pads which are specifically designed for this tool (see section "Technical specifications").
- Drain the compressor tank daily. Water in the air line will damage the tool.
- Clean the air inlet and the filter weekly.
- Line pressure should be increased to compensate for unusually long air hoses (over 26' / 8 m). The hose diameter should be 3/8" (9.5 mm) I.D.

Operation

1. Set the operating pressure in the compressor to 90 PSI (6.3 bar), and attach one end of the air hose to the compressor and the other end of the air hose (1) to the tool (2). Use plumber's tape to prevent air leaks (Fig. A).

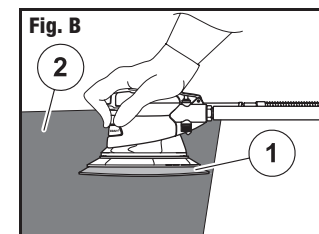
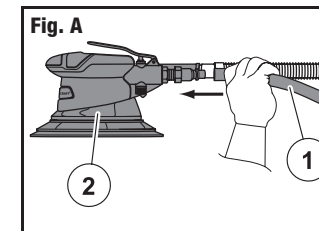

2. Place the sanding pad (1) of the sander (2) over the workpiece (2) to be sanded (Fig. B).

3. Press the trigger (1) and move the sander (2) in an oscillating motion to produce a smoother finish on the workpiece (Fig. C).

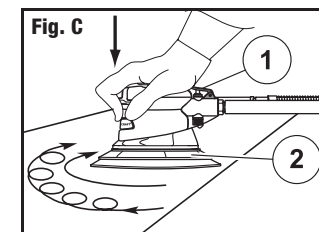

WARNING!

Potential hazard that could result in serious injury or loss of life.

- Do not use the tool if it is not in proper working order.
- Do not use oxygen or any other combustible or bottled gas to power this tool.
- Do not use this tool in the presence of any flammable liquids or gases.
- Keep hose away from heat, oil, and sharp edges. Check hose for wear and tear, and ensure that all connections are secure. Failure to comply could lead to serious injury or loss of life.



WARNING!

Potential hazard that could result in serious injury or loss of life.

- Read all instructions in this manual carefully and understand them thoroughly before using the Mastercraft® 5" Air-powered Dual-action Sander. Failure to comply could lead to serious injury or loss of life.

Changing the sanding pad

1. Disconnect the air hose (1) from the tool (2) (Fig. D).

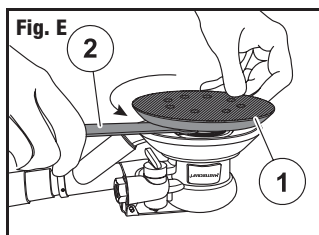
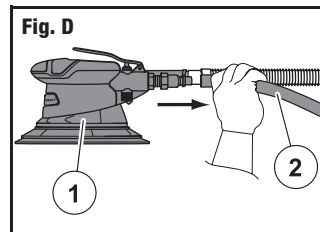

3. Place the new sanding pad (1) over the nut (2) (Fig. F).

2. Firmly hold the nut securing the sanding pad (1) with the wrench (2) provided and unscrew the pad manually to remove it (Fig. E).

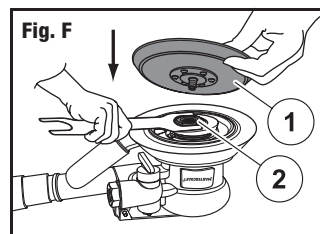

4. Secure the new sanding pad (1) manually by tightening the nut with the wrench (Fig. G).

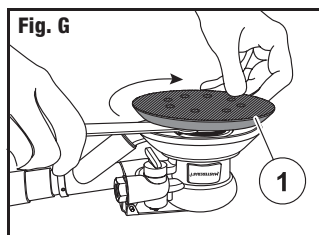

WARNING!

Potential hazard that could result in serious injury or loss of life.

- After changing the sanding pad, ensure that the sanding pad is tightened properly before operating the tool. Failure to comply could lead to serious injury or loss of life.

MAINTENANCE REQUIRED	DESCRIPTION	TOOLS OR MATERIALS REQUIRED	MAXIMUM SERVICE INTERVAL		
			Each Use or Every 2 Hrs	Monthly	As Needed
General inspection—free movement	Trigger, spring, safety mechanism	None	X		
In-depth inspection	Worn or broken parts			X	X
Replace worn or broken parts					X
Lubrication	See below	Lubricating oil	X		

- Lubrication: If the air-powered sander and the compressor are not equipped with an in-line lubrication system, place up to 6 drops of pneumatic tool oil into the air inlet before each work day or after every 2 hours of continuous use, depending on the characteristics of the workpiece and type of fasteners used.

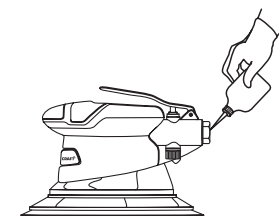

WARNING!

Potential hazard that could result in serious injury or loss of life.

- Disconnect the tool from the air supply before changing accessories, servicing, or performing maintenance.
- Use the tool only after replacing or repairing any damaged parts or accessories.
- Use only recommended and properly rated replacement parts and sanding pads. Failure to comply could lead to serious injury or loss of life.
- Repairs must be performed by a qualified service technician.

- Air operated tools must be inspected periodically, and worn or broken parts must be replaced in order to keep tools operating safely, and efficiently.
- Inspect and replace worn or damaged O-rings, seals, etc. Tighten all screws and caps frequently in order to help prevent personal injury.

Storage

If it is necessary to store the tool for an extended period of time, apply a generous amount of lubricating oil before storing. The tool should be allowed to run for approximately 30 seconds after lubricating, in order to ensure that the lubrication is uniformly distributed throughout the tool.

- When the tool is not in use, disconnect it from the air supply, clean, and store it in a safe, dry, and childproof location.
- When temperatures are below freezing, keep tools as warm as possible using any safe, convenient method.



WARNING!

Potential hazard that could result in serious injury or loss of life.

- Never use damaged/worn sanding pads. Failure to comply could lead to serious injury or loss of life.
- Inspect the trigger, the spring and the safety mechanism for free movement on a regular basis in order to ensure that the safety system is fully functional.
- Verify that no part is loose or missing and that no part is stuck or jammed.
- Check the air supply for correct size and type of hose connectors. To avoid loss of power or erratic action, ensure that there is no additional drain on the air line and no moisture or restriction in the air pipe.
- Clean the air strainer (if provided in your model) in the air inlet region of the tool and remove grit or gum deposits which may lead to loss of power or erratic action and may also reduce the performance of the tool.



CAUTION!

Potential hazard that may result in moderate injury or damage to equipment.

- The tool should be stored in a clean and dry environment. Failure to comply may result in moderate injury or damage to equipment.

Troubleshooting

The following chart lists common issues and solutions. Please read it carefully and follow all instructions closely.

PROBLEM	POSSIBLE CAUSES	SOLUTIONS
Tool runs at normal speed but loses power under load.	<ol style="list-style-type: none"> 1. Motor parts are worn or damaged. 2. Cam clutch is worn or stuck due to lack of lubricant. 	<ol style="list-style-type: none"> 1. Lubricate the clutch housing. 2. Check for excess clutch oil. Clutch cases should only be half filled, as overfilling can cause drag on high speed clutch parts. A typical oiled/lubricated wrench requires ½ oz (15 mL) of oil. <p>Grease lubrication: Heat is generated due to insufficient grease in the cylinder. Severe operating conditions may require frequent lubrication.</p> <p>If the problem persists, call 1-800-689-9928.</p>
Tool runs at low speed. Air flows slightly from exhaust.	<ol style="list-style-type: none"> 1. Motor parts are jammed with dirt. 2. Power regulator is in closed position. 3. Airflow is blocked by dirt. 	<ol style="list-style-type: none"> 1. Check whether there is blockage in the air inlet and the filter. 2. Pour lubricating oil into air inlet as per instructions. 3. Operate the tool by reversing rotation of the tool back and forth in short duration. Repeat the above steps as needed.



WARNING!

Potential hazard that could result in serious injury or loss of life.

- If any of these symptoms appears while the tool is in use, turn it off and disconnect it from the air supply immediately. Failure to heed this warning will result in serious personal injury.
- Disconnect the tool from the air supply before making any adjustments.
- Repairs must be performed by a qualified service technician only.

PROBLEM	POSSIBLE CAUSES	SOLUTIONS
Tool stops working. Air flows freely from exhaust.	One or more motor blades got stuck due to material build up.	<ol style="list-style-type: none"> 1. Pour lubricating oil into the air inlet. 2. Tap motor housing gently with plastic mallet. 3. Operate the tool by reversing rotation of the tool back and forth in short duration. Repeat the above steps as needed. 4. Disconnect the air supply. Operate the motor by manually rotating the drive shank (wherever applicable). <p>If the problem persists, call 1-800-689-9928.</p>
Tool does not shut off.	Throttle valve O-rings are dislodged from seat inlet valve.	<p>Replace O-rings.</p> <p>If the problem persists, call 1-800-689-9928.</p>

Note: For further repair information, please call 1-800-689-9928.

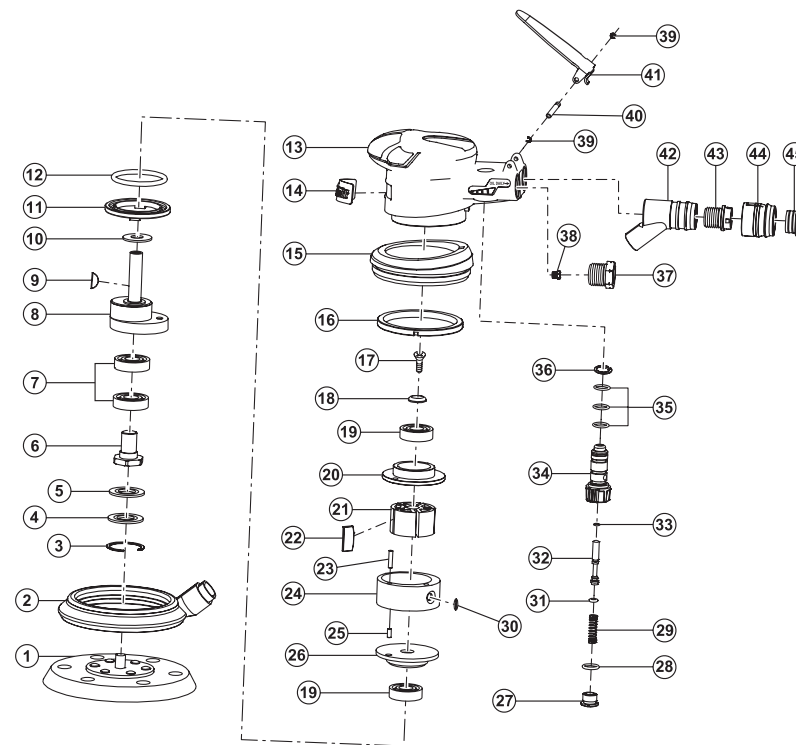

No.	Description	Qty.	No.	Description	Qty.
1	Sanding pad	1	24	Cylinder	1
2	Handle grip	1	25	Pin 3 x 7	1
3	Snap ring	1	26	Front cylinder cover	1
4	Bearing washer	1	27	Nut	1
5	Dust-proof mat	1	28	O-ring 9 x 2	1
6	Main shaft	1	29	Spring	1
7	Bearing 6001zz	2	30	O-ring 6.7 x 1.8	1
8	Drive shaft	1	31	O-ring 2.5 x 1.5	1
9	Woodruff key	1	32	Valve pin	1
10	Front cover washer	1	33	O-ring 3 x 1	1
11	Collar	1	34	Regulator	1
12	O-ring 37.5 x 3.55	1	35	O-ring 10 x 1.5	3
13	Main housing	1	36	Snap ring	1
14	Label	1	37	Air inlet	1
15	Housing edge	1	38	Bolt	1
16	Collar	1	39	Split washer	2
17	Bolt	1	40	Trigger pin	1
18	Gasket	1	41	Trigger	1
19	Bearing 6000Z	2	42	Tee coupling	1
20	Back cylinder cover	1	43	Air outlet plug	1
21	Rotor	1	44	End cap	1
22	Rotor blade	5	45	Dust cover	1
23	Pin 3 x 14	1			

If any parts are missing or damaged, or if you have any questions, please call 1-800-689-9928.

3-Year Limited Warranty

This product is guaranteed for a period of three (3) years from the date of original retail purchase against defects in workmanship and materials, except for the following component:

Component A: Accessories, which are guaranteed for a period of one (1) year from the date of original retail purchase against defects in workmanship and materials.

Subject to the conditions and limitations described below, this product, if returned to us with proof of purchase within the stated warranty period and if covered under this warranty, will be repaired or replaced (with the same model, or one of equal value or specification), at our option. We will bear the cost of any repair or replacement and any costs of labour relating thereto.

These warranties are subject to the following conditions and limitations:

- A bill of sale verifying the purchase and purchase date must be provided.
- This warranty will not apply to any product or part thereof which is worn or broken or which has become inoperative due to abuse, misuse, accidental damage, neglect, or lack of proper installation, operation, or maintenance (as outlined in the applicable instruction manual or operating instructions), or which is being used for industrial, professional, commercial, or rental purposes.
- This warranty will not apply to normal wear and tear or to expendable parts or accessories that may be supplied with the product which are expected to become inoperative or unusable after a reasonable period of use.
- This warranty will not apply to routine maintenance and consumable items such as, but not limited to, fuel, lubricants, vacuum bags, blades, belts, sandpaper, bits, fluids, tune-ups, or adjustments.
- This warranty will not apply where damage is caused by repairs made or attempted by others (i.e., persons not authorized by the manufacturer).
- This warranty will not apply to any product that was sold to the original purchaser as a reconditioned or refurbished product (unless otherwise specified in writing).