

MAXIMUM[®]

Tool Storage Combo

**56" (142.2 cm) 6-drawer Chest
and 56" (142.2 cm) 10-drawer Cabinet**



Model no. 058-6556-6 / 058-1366-8

Products sold separately.

Instructions included for both.

IMPORTANT

Please read this manual carefully before assembling and using this product, and save it for reference.

INSTRUCTION MANUAL

Due to continuing improvements, the actual product may differ slightly from the product described herein.

TABLE OF CONTENTS

SAFETY	3
EXPLODED VIEW / PARTS LIST	4
ASSEMBLY INSTRUCTIONS	6
POWER STRIP SPECIFICATIONS	8
OPERATION	8
MAINTENANCE	8
WARRANTY	9

NOTE

If any parts are missing or damaged, or if you have any questions, please call our toll-free helpline at: 1-888-670-6682. Have the product number, cash register receipt and the date of purchase available when you call. **DO NOT SHIP YOUR PRODUCT BACK TO THE STORE UNLESS WE SEND YOU WRITTEN INSTRUCTIONS FOR RETURN.**



SAVE THESE INSTRUCTIONS

This manual contains important safety and operating instructions. Read all instructions and follow them carefully with use of this product.

SAFETY

- The maximum weight for each drawer should be no more than 100 lb (45.4 kg). **DO NOT OVERLOAD DRAWERS.**
- The maximum product weight, including contents, should be no more than 1,700 lb (770 kg).
- **CLOSE AND LOCK DRAWERS BEFORE MOVING THIS PRODUCT.** They could come open and make the product unstable, which may cause personal injury or product damage.
- **DO NOT** let children near the tool chest combo.
- **DO NOT** open more than one drawer at a time.
- Fill from the bottom drawer up. If the tool chest combo is filled from the top drawer down, it will be top-heavy and may fall over.
- **DO NOT** attempt to lift the unit by the side handle using chains, ropes or other lifting devices. The side handle could fail, which may cause personal injury or damage to the product.
- **DO NOT** step or climb on this product or on the drawers.
- **DO NOT** alter this product in any manner. For example, do not weld external lockbars or attach electrical equipment. This may cause product damage or personal injury.
- Keep the product on level surfaces. The product could become unstable and tip if on an uneven surface, which may cause personal injury or product damage.
- When moving this product, do not pull it. Push the product to prevent personal injury.
- **DO NOT** tow with power equipment. The product could tip, which may cause personal injury or product damage.
- Use the brakes when not moving this product. This will prevent the product from rolling, which may cause personal injury or product damage.
- **DO NOT** mount this product on a truck bed or on any other moving object. This may cause personal injury or product damage.
- Be careful with sharp edges. Wear protective gloves.
- Always wear approved safety goggles when working with tools and equipment.



- Before assembling and using this product, carefully read this instruction manual and all of the labels affixed to the product. Failure to follow all warnings and instructions may result in product damage or personal injury.
- Save all warnings and instructions for future reference.

Common part numbers apply to both chest & cabinet.

No.	Description	Part No.	Qty.
7	Slide (Left)	300022	6
8	Drawer Liner	551774	6
9	Slide (Right)	300023	6
10	Power Strip	333065	1
11	Till Liner	552265	1
12	Cord Access Grommet	314027	1

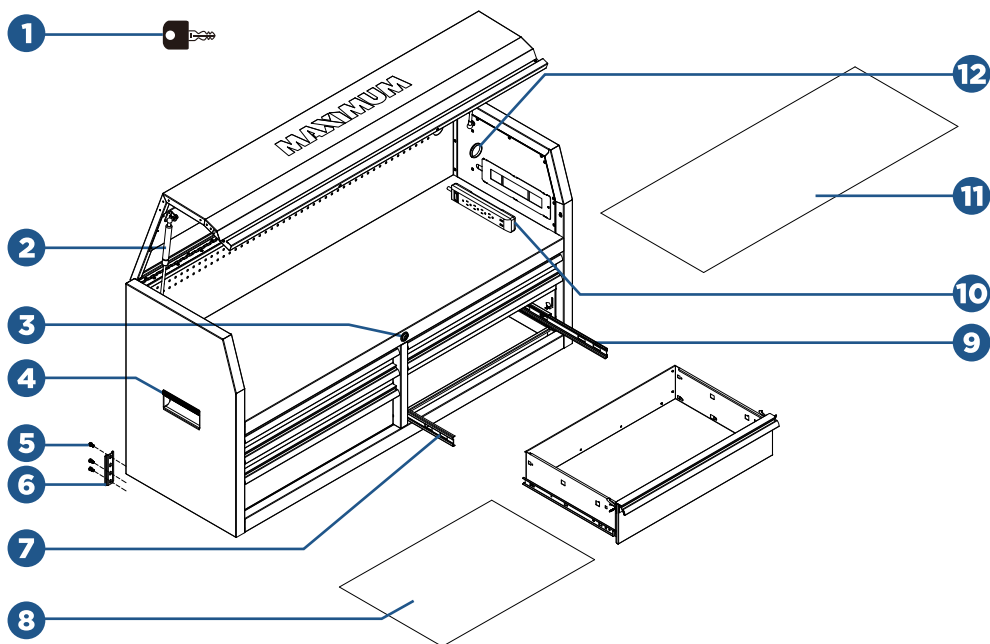

- The keys are taped to the top storage area of the chest.
- Replacement keys may be ordered. Call our toll-free number. The code which appears on the lock will be required.
- Give information for spare parts: part number and quantity required.

CABINET 058-1366-8

Common part numbers apply to both chest & cabinet.

No.	Description	Part No.	Qty	No.	Description	Part No.	Qty
1	Key (1201-1204)	304085	2	16	M8 x 20 Hex Bolt	321024	16
13	Wood Top	571409	1	17	Washer	324002	16
3	Lock (1201-1204)	304007	1	18	Swivel Castor	302208	2
7	Slide (Left)	300022	12	9	Slide (Right)	300023	12
14	Rigid Castor	302209	2	5	M6 x 12 Hex Bolt	321051	4
15	Drawer Liner	551775	1	19	Side Handle	306046	1
8	Drawer Liner	551774	9				

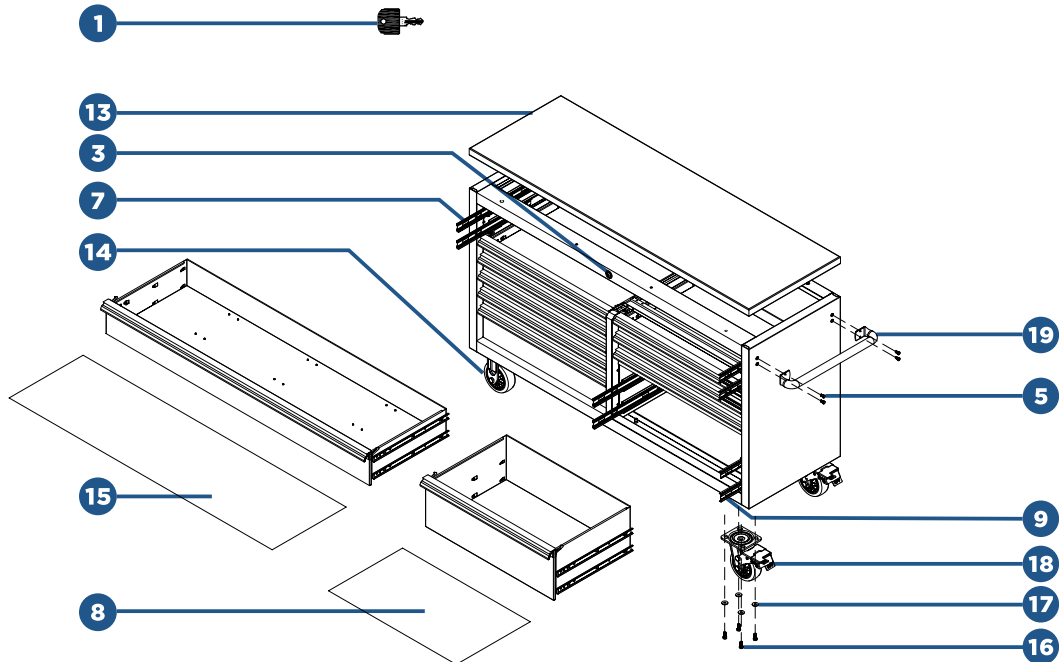

NOTE

- The keys are taped to the top of the castor carton, which is placed in the bottom drawer of the cabinet.
- Replacement keys may be ordered. Call our toll-free number. The code which appears on the lock will be required.
- Give information for spare parts: part number and quantity required.

ASSEMBLY INSTRUCTIONS

- Remove all items from the box and ensure that all parts listed on the parts list are present.
- Inspect the product carefully to make sure no breakage or damage occurred during shipping.
- Do not discard the carton or any packaging material until all parts have been examined.

TOOLS REQUIRED FOR ASSEMBLY

- 10 mm wrench for M6 hex bolts

HANDLE INSTALLATION

NOTE:

Holes in the cabinet are tapped requiring no nuts for installation. Side handle should be mounted on the same side of the cabinet as the swivel castors.

Position the side handle (19) over the holes and attach with four M6x12 hex bolts (5) provided. Tighten securely.

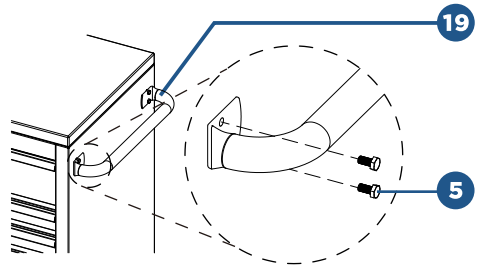

CASTOR INSTALLATION

NOTE:

You may require the assistance of another person to complete this step.

NOTE:

For easy movement, the swivel castors are suggested to be installed on the side of the side handle.

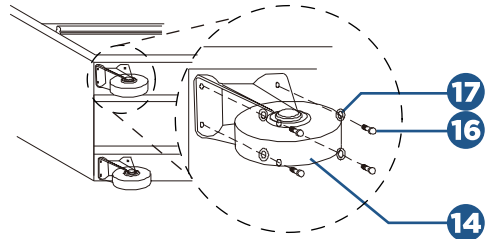

Carefully lay the cabinet on its back with a soft mat underneath for protection. Position the two rigid castors (14) on one side of the bottom of the cabinet. Insert the M8 x 20 hex bolts (16) through washers (17), then through the castors and into the bottom of the cabinet. Tighten securely.

Repeat for the two swivel castors (18) on the other side of the cabinet. Return the cabinet to the upright position.

DRAWER REMOVAL

Empty the drawer. Pull the drawer out until almost fully extended. There are two black release levers, one on each side of the drawer. Pull up the black release lever on one side, while pushing down the black release lever on the other side. While holding the levers in the positions as instructed above, pull the drawer outward until it is released from the drawer slide.

Pull up – one side

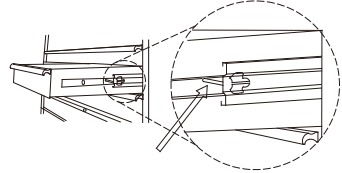

Push down – other side

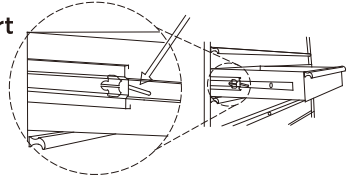

DRAWER REPLACEMENT

Extend the drawer slides from the tool chest or cabinet. Insert the brackets on each side of the drawer into the slots in the slides, being careful that they are properly positioned. Once properly inserted, completely close the drawer to set the slides in their proper positions.

CHESTS AND CABINET CONNECTION



WARNING: Two adults at least are required to complete this step.

The connector works well for both of the cabinets with or without wood top.

To work with the wood top:

- Just simply place the chest on top. Attach the two connectors (6) to the combo and fasten each with three M6 x 12 hex bolts (5).

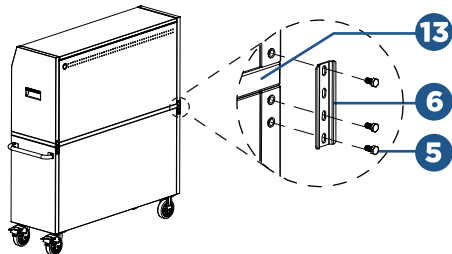

To work without the wood top:

- Follow the instructions above to remove at least five drawers until you can loosen the eight screws from the wood top.
- Remove the eight screws first and remove the wood top.
- Install the drawers back. At this time, you can place the chest on the cabinet.
- Attach the two connectors (6) to the combo and fasten each with three M6 x 12 hex bolts (5).

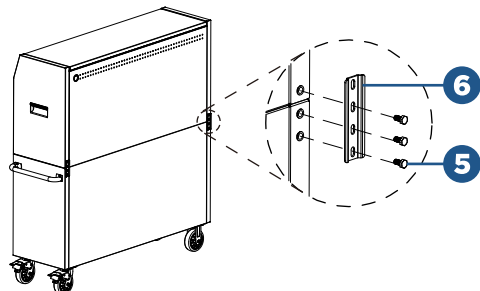
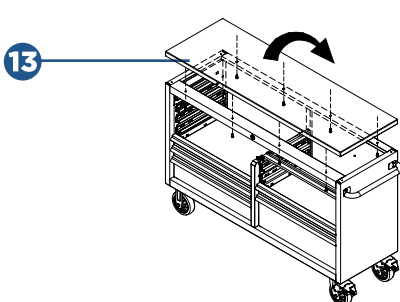

model no. 058-6556-6 / 058-1366-8 | contact us: 1-888-670-6682

POWER STRIP SPECIFICATIONS

MODEL: 10404

SURGE PROTECTIVE DEVICES

RATING: 15 A, 125 V AC, 1875 W, 60 Hz

USB: 5 V DC 2.1 A TOTAL

USB O/P: IT EQUIPMENT ONLY

VPR: 500V (L-N, L-G, N-G) TYPE 3 SPD

CONFORMS TO UL STD. 1363, 1449

CERTIFIED TO CSA STD. C22.2 NO. 308 & 269.3



WARNING: RISK OF ELECTRIC SHOCK.

To avoid serious injury from electric shock:

- Only use the power strip of this product indoors.
- Only use the power strip of this product in a dry location.
- Do not plug another power strip into one of the power strips of this product.



WARNING: Changes or modifications to this unit not expressly approved by the party responsible for compliance could void the user's authority to operate the equipment.

RAISE-AND-RELEASE DRAWER FRONTS

These units are equipped with raise-and-release drawer fronts. To open, lift up on the drawer front while pulling towards you. To close, shut the drawer firmly until the latch engages.

If the drawer does not stay closed, the hook may be bent, or it may be rubbing against the drawer slides. To fix this problem, lightly bend the hook until the drawer will engage in the slide.

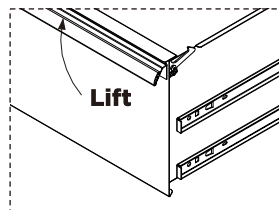

GENERAL MAINTENANCE

- For castors, use high-quality bearing grease once a year.
- Lubricate the slides twice a year with a spray lubricant or light-duty oil.
- Periodically clean the drawer fronts, drawer trim and other surfaces with mild detergent and water.
- Grease and oil can be removed with most standard cleaning fluids.

LIMITED WARRANTY

This product is guaranteed for 5 years from the date of original retail purchase against defects in materials and workmanship.

Subject to the conditions and limitations described below, this product, if returned to us with a proof of purchase within the stated warranty period and if covered under this warranty, will be repaired or replaced (with the same model, or one of equal value or specification), at our option. We will bear the cost of any repair or replacement and any costs of labour relating thereto.

This warranty is subject to the following conditions and limitations:

- a) A sales receipt that indicates the date of purchase must be provided;
- b) This warranty will not apply to any product or part thereof which is worn or broken or which has become inoperative due to abuse, misuse, accidental damage, neglect or lack of proper installation, operation or maintenance (as outlined in the applicable owner's manual or operating instructions) or which is being used for industrial, professional, commercial or rental purposes;
- c) This warranty will not apply to normal wear and tear or to expendable parts or accessories that may be supplied with the product which are expected to become inoperative or unusable after a reasonable period of use;
- d) This warranty will not apply to routine maintenance and consumable items such as, but not limited to, fuel, lubricants, vacuum bags, blades, belts, sandpaper, bits, fluids, tune-ups or adjustments;
- e) This warranty will not apply if damage is caused by repairs made or attempted by others (i.e. persons not authorized by the manufacturer);
- f) This warranty will not apply to any product that was sold as a reconditioned or refurbished product (unless otherwise specified in writing);
- g) This warranty will not apply to any product or part thereof if any part from another manufacturer is installed therein or any repairs or alterations have been made or attempted by unauthorized persons;
- h) This warranty will not apply to normal deterioration of the exterior finish, such as, but not limited to, scratches, dents, paint chips, or to any corrosion or discolouring by heat, abrasive and chemical cleaners;
- i) This warranty will not apply to component parts sold by and identified as the product of another company, which shall be covered under the product manufacturer's warranty, if any.

Additional Limitations

This warranty applies only to the original purchaser and may not be transferred. Neither the retailer nor the manufacturer shall be liable for any other expense, loss or damage, including, without limitation, any indirect, incidental, consequential or exemplary damages arising in connection with the sale, use or inability to use this product.

Notice to Consumer

This warranty gives you specific legal rights, and you may have other rights, which may vary from province to province. The provisions contained in this warranty are not intended to limit, modify, take away from, disclaim or exclude any statutory warranties set forth in any applicable provincial or federal legislation.