

MAXIMUM[®]

20V^{MAX}

Brushless Belt Sander



Model No. 054-7981-4

IMPORTANT:

Please read this manual carefully before using this product, and save it for reference.

**INSTRUCTION
MANUAL**



TABLE OF CONTENTS

| | |
|--------------------------|----|
| TECHNICAL SPECIFICATIONS | 4 |
| SAFETY INSTRUCTIONS | 5 |
| SYMBOLS | 11 |
| PARTS LIST | 12 |
| KNOW YOUR TOOL | 13 |
| ASSEMBLY INSTRUCTIONS | 15 |
| OPERATING INSTRUCTIONS | 17 |
| MAINTENANCE | 21 |
| WARRANTY | 22 |

NOTE: If any parts are missing or damaged, or if you have any questions, please call our toll-free helpline at 1-888-670-6682.



SAVE THESE INSTRUCTIONS

This manual contains important safety and operating instructions. Read all instructions and follow them with use of this product.

model no. 054-7981-4 | contact us 1-888-670-6682

MAXIMUM®

SPECIFICATIONS

| | |
|-----------------------------|--|
| MOTOR | 18V DC brushless |
| BELT SIZE | 3 x 21" (7.6 x 53.3 cm) |
| VARIABLE SPEED | 450-935 ft/min |
| COMPATIBLE MAXIMUM® BATTERY | 054-6702-6 (2.0 Ah); 054-7983-0 (X-volt) 054-3203-2 (2.0 Ah); 054-3206-6 (4.0 Ah) |
| COMPATIBLE MAXIMUM® CHARGER | 054-7985-6; 054-3204-0; 7109-B-2 |
| DIMENSIONS | 11 x 5 1/2 x 6 1/8" (279 x 139 x 156 mm) |
| WEIGHT | 5 lb 1 oz (2.3 kg) without battery |

GENERAL POWER TOOL SAFETY WARNINGS

Save all warnings and instructions for future reference.

The term "power tool" in the warnings refers to your mains-operated (corded) power tool or battery-operated (cordless) power tool.

WORK AREA SAFETY

- **Keep work area clean and well lit.** Cluttered or dark areas invite accidents.
- **Do not operate power tools in explosive atmosphere, such as in the presence of flammable liquids, gases or dust.** Power tools create sparks which may ignite the dust or fumes.
- **Keep children and bystanders away while operating a power tool.** Distractions can cause you to lose control.

ELECTRICAL SAFETY

- **Power tool plugs must match the outlet. Never modify the plug in any way. Do not use any adaptor plugs with earthed (grounded) power tools.** Unmodified plugs and matching outlets will reduce risk of electric shock.
- **Avoid body contact with earthed or grounded surfaces, such as pipes, radiators, ranges and refrigerators.** There is an increased risk of electric shock if your body is earthed or grounded.
- **Do not expose power tools to rain or wet conditions.** Water entering a power tool will increase the risk of electric shock.
- **Do not abuse the cord. Never use the cord for carrying, pulling or unplugging the power tool. Keep cord away from heat, oil, sharp edges or moving parts.** Damaged or entangled cords increase the risk of electric shock.
- **When operating a power tool outdoors, use an extension cord suitable for outdoor use.** Use of a cord suitable for outdoor use reduces the risk of electric shock.
- **If operating a power tool in a damp location is unavoidable, use a RESIDUAL CURRENT DEVICE (RCD) protected supply.** Use of an RCD reduces the risk of electric shock.

PERSONAL SAFETY

- **Stay alert, watch what you are doing and use common sense when operating a power tool. Do not use a power tool while you are tired or under the influence of drugs, alcohol or medication.** A moment of inattention while operating power tools may result in serious personal injury.



WARNING!

Read all safety warnings, instructions, illustrations and specifications provided with this power tool. Failure to follow all instructions listed may result in electric shock, fire and/or serious injury.

- **Use personal protective equipment. Always wear eye protection.** Protective equipment such as dust mask, non-skid safety shoes, hard hat, or hearing protection used for appropriate conditions will reduce personal injuries.
- **Prevent unintentional starting. Ensure the switch is in the off-position before connecting to power source and/or battery pack, picking up or carrying the tool.** Carrying power tools with your finger on the switch or energising power tools that have the switch on invites accidents.
- **Remove any adjusting key or wrench before turning the power tool on.** A wrench or a key left attached to a rotating part of the power tool may result in personal injury.
- **Do not overreach. Keep proper footing and balance at all times.** This enables better control of the power tool in unexpected situations.
- **Dress properly. Do not wear loose clothing or jewellery. Keep your hair, clothing and gloves away from moving parts.** Loose clothes, jewellery or long hair can be caught in moving parts.
- **If devices are provided for the connection of dust extraction and collection facilities, ensure these are connected and properly used.** Use of dust collection can reduce dust-related hazards.
- **Do not let familiarity gained from frequent use of tools allow you to become complacent and ignore tool safety principles.** A careless action can cause severe injury within a fraction of a second.

POWER TOOL USE AND CARE

- **Do not force the power tool. Use the correct power tool for your application.** The correct power tool will do the job better and safer at the rate for which it was designed.
- **Do not use power tool if the switch does not turn it on and off.** Any power tool that cannot be controlled with the switch is dangerous and must be repaired.
- **Disconnect the plug from the power source and/or remove the battery pack, if detachable, from the power tool before making any adjustments, changing accessories, or storing power tools.** Such preventive safety measures reduce the risk of starting the power tool accidentally.
- **Store idle power tools out of the reach of children and do not allow persons unfamiliar with the power tool or these instructions to operate the power tool.** Power tools are dangerous in the hands of untrained users.
- **Maintain power tools and accessories. Check for misalignment or binding of moving parts, breakage of parts and any other condition that may affect the power tool's operation. If damaged, have the power tool repaired before use.** Many accidents are caused by poorly maintained power tools.
- **Keep cutting tools sharp and clean.** Properly maintained cutting tools with sharp cutting edges are less likely to bind and are easier to control.
- **Use the power tool, accessories, tool bits, etc., in accordance with these instructions, taking into account the working conditions and the work to be performed.** Use of the power tool for operations different from those intended could result in a hazardous situation.

- **Keep handles and grasping surfaces dry, clean and free from oil and grease.** Slippery handles and grasping surfaces do not allow for safe handling and control of the tool in unexpected situations.

BATTERY TOOL USE AND CARE

- **Recharge only with the charger specified by the manufacturer.** A charger that is suitable for one type of battery pack may create a risk of fire when used with another battery pack.
- **Use power tools only with specifically designated battery packs.** Use of any other battery packs may create a risk of injury and fire.
- **When battery pack is not in use, keep it away from other metal objects, like paper clips, coins, keys, nails, screws or other small metal objects, that can make a connection from one terminal to another.** Shorting the battery terminals together may cause burns or a fire.
- **Under abusive conditions, liquid may be ejected from the battery; avoid contact. If contact accidentally occurs, flush with water. If liquid contacts eyes, additionally seek medical help.** Liquid ejected from the battery may cause irritation or burns.
- **Do not use a battery pack or tool that is damaged or modified.** Damaged or modified batteries may exhibit unpredictable behaviour resulting in fire, explosion or risk of injury.
- **Do not expose a battery pack or tool to fire or excessive temperature.** Exposure to fire or temperature above 265°F (130°C) may cause an explosion.
- **Follow all charging instructions and do not charge the battery pack or tool outside the temperature range specified in the instructions.** Charging improperly or at temperatures outside the specified range may damage the battery and increase the risk of fire.

SERVICE

- **Have your power tool serviced by a qualified repair person using only identical replacement parts.** This will ensure that the safety of the power tool is maintained.
- **Never service damaged battery packs.** Service of battery packs should only be performed by the manufacturer or authorized service providers.

SPECIFIC SAFETY RULES FOR BELT SANDER

- **Never leave the trigger locked “ON”.** Before inserting the battery pack into the tool, check that the trigger lock is “OFF”. Accidental start-ups could cause injury.
- **Disconnect the battery pack before changing accessories or servicing.** Accidental start-ups may occur.
- **Keep your fingers and clothing away from the belt.** They could get cut or wedged between the pulley, belt and motor housing.
- **Clamp or secure workpiece when sanding.** Clamping the workpiece prevents it from being ejected from under the sander and leaves both hands to control the tool.
- **Do not wet sand with this sander.** Liquids entering the motor housing is an electric shock hazard.
- **Always wear safety glasses. Everyday eyeglasses are NOT safety glasses.** Following this rule will reduce the risk of serious personal injury.
- **Protect your lungs. Wear a face or dust mask if the operation is dusty.** Following this rule will reduce the risk of serious personal injury.
- **Protect your hearing. Wear hearing protection during extended periods of operation.** Following this rule will reduce the risk of serious personal injury.
- **SAVE THESE INSTRUCTIONS.** Refer to them frequently and use them to instruct others who may use this tool. If someone borrows this tool, make sure he or she has these instructions also.

**WARNING!**

Always wear proper personal hearing protection that conforms to ANSI S12.6 (S3.19) during use. Under some conditions and duration of use, noise from this product may contribute to hearing loss.

**WARNING!**

ALWAYS use safety glasses. Everyday eyeglasses are NOT safety glasses. Also use face or dust mask if the operation is dusty. ALWAYS WEAR CERTIFIED SAFETY EQUIPMENT:

ANSI Z87.1 eye protection (CAN/CSA Z94.3)

ANSI S12.6 (S3.19) hearing protection

NIOSH/OSHA/MSHA respiratory protection.

**WARNING!**

Use of this tool can generate and/or disperse dust, which may cause serious and permanent respiratory or other injury. Always use NIOSH/OSHA approved respiratory protection appropriate for the dust exposure. Direct particles away from face and body.

SAFETY RULES FOR BATTERY PACK AND CHARGER







- If the battery pack casing is cracked or damaged, do not insert into charger. There is a danger of electric shock or electrocution.
- Don't allow any liquid to get inside charger. Electric shock may result. To facilitate cooling of the battery pack after use, avoid placing the charger or battery pack in a warm environment such as in a metal shed, or a trailer that is not insulated.
- This charger is not intended for any uses other than charging rechargeable batteries. Any other use may result in risk of fire, electric shock or electrocution.
- Do not place any object on top of the charger or place the charger on a soft surface that may result in excessive internal heat. Do not place the charger near any heat source.
- To reduce the potential risk of damage to the electric plug and cord, pull by the plug rather than the cord when disconnecting the charger from the power supply.
- Make sure the cord is located so it will not be stepped on, tripped over, or otherwise subjected to damage or stress.
- An extension cord should not be used unless absolutely necessary. Use of an improper extension cord could result in a risk of fire, electric shock or electrocution.
- Do not operate the charger if it has received a sharp blow, been dropped or otherwise damaged in any way.
- Do not disassemble charger. Take it to a Service Agent when service or repair is required. Incorrect reassembly may result in a risk of electric shock, electrocution or fire.
- To prevent the risk of electric shock, unplug the charger from the outlet before attempting to clean it. Only removing the battery pack from the charger will not reduce this risk.
- DO NOT store or use the tool and battery pack in locations where the temperature may reach or exceed 122°F (50°C), which can lead to deterioration of the storage battery.
- The charger is designed to operate on standard household electrical power (120 V~). Do not attempt to use it on any other voltage.

ADDITIONAL INFORMATION ON BATTERY AND CHARGER

- The battery pack is not fully charged out of the carton. First, read the safety instructions and then follow the charging notes and procedures.
- The longest life and best performance can be obtained if the battery pack is charged when the air temperature is 59–77°F (15–25°C). Do not charge the battery pack where the air temperature is below 32°F (0°C) or above 113°F (45°C). This is important and will prevent damage to the battery pack.
- Do not incinerate the battery pack even if it is seriously damaged or is completely worn out. The battery can explode in a fire.
- Never attempt to open the battery pack for any reason. If the plastic housing of the battery pack breaks or cracks, immediately discontinue use and do not recharge.
- The length of service from your battery will depend on the type of work you are doing. The battery has been designed to provide maximum trouble-free life; however, like all batteries, it will eventually wear out.
- To obtain the longest possible battery life, we suggest the following:
 - Store and charge your battery in a cool area. Temperatures above or below normal room temperature will shorten battery life.
 - Never store the battery in a discharged condition. Recharge it immediately after it has been discharged.
- All batteries gradually lose their charge. The higher the temperature, the quicker they lose their charge. If you store your tool for long periods of time without use, recharge the battery every month or two. This practice will prolong battery life.

SYMBOLS

Some of the following symbols may be used on this product. Please study them and learn their meaning. Proper interpretation of these symbols will allow you to operate the product better and safer.

| No. | Description |
|---|--|
| V | volts |
| A | amperes |
| Hz | hertz |
| W | watts |
| n ₀ | no-load speed |
| FT/MIN | feet per minute |
| ~ | alternating current |
| — | direct current |
| Ah | ampere-hours |
| Li-ion | lithium-ion battery |
| BFP | backfeed protection |
|  | safety alert symbol |
|  | To reduce the risk of injury, user must read operator's manual. |
|  | Always wear eye protection when operating this product. |
|  | Always wear breathing protection when operating this product. |
|  | Contains lithium-ion battery. Battery must be recycled or disposed of properly. |
|  | This symbol designates that this tool is listed by the Intertek Testing Services, to United States and Canadian standards. |

| No. | Description | No. | Description |
|-----|----------------------|-----|-----------------------------|
| 1 | ON/OFF trigger | 5 | Sanding belt |
| 2 | "Lock-on" button | 6 | Belt tension release lever |
| 3 | Front handle | 7 | Variable speed control dial |
| 4 | Belt adjustment knob | 8 | Dust collection bag |

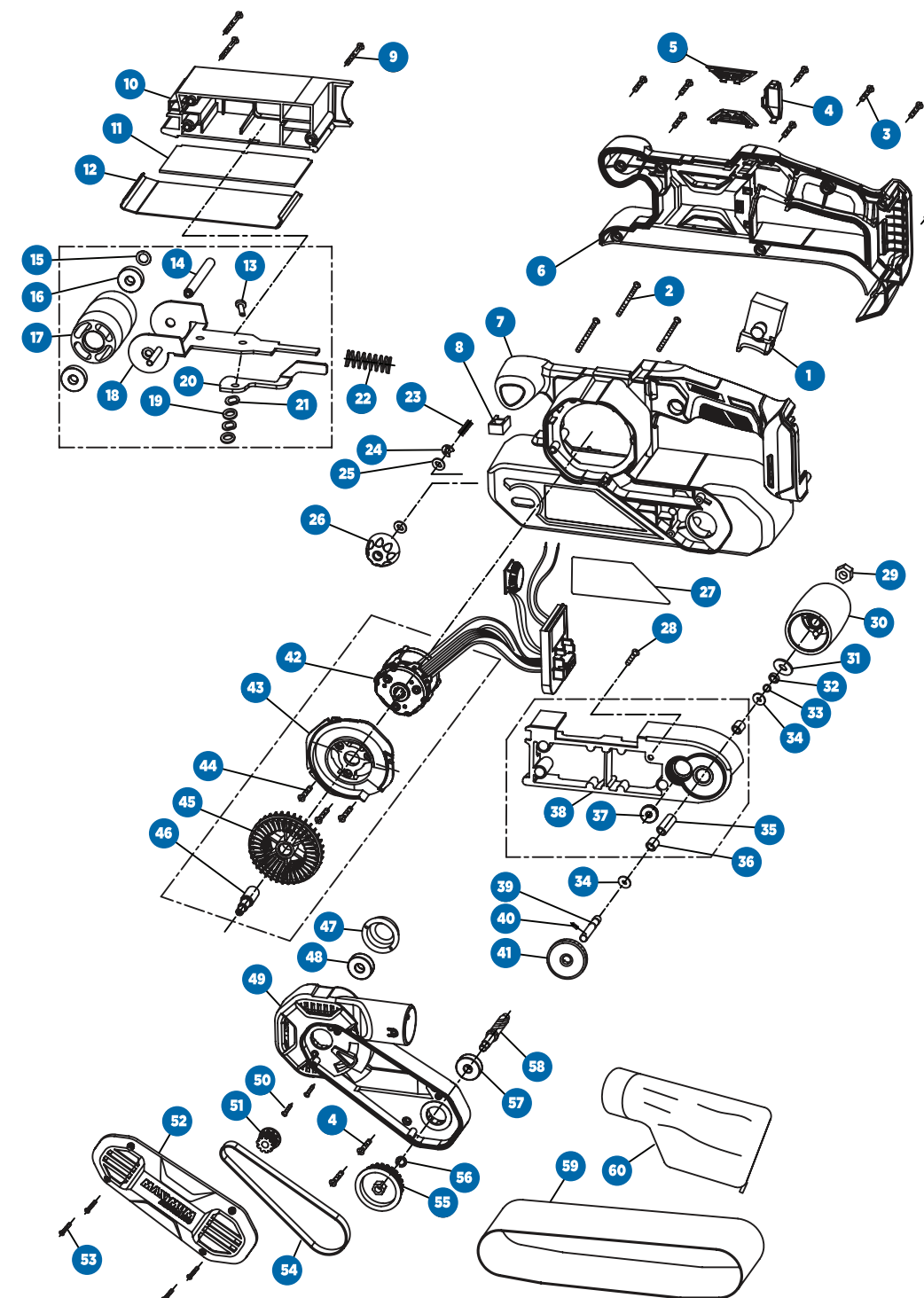
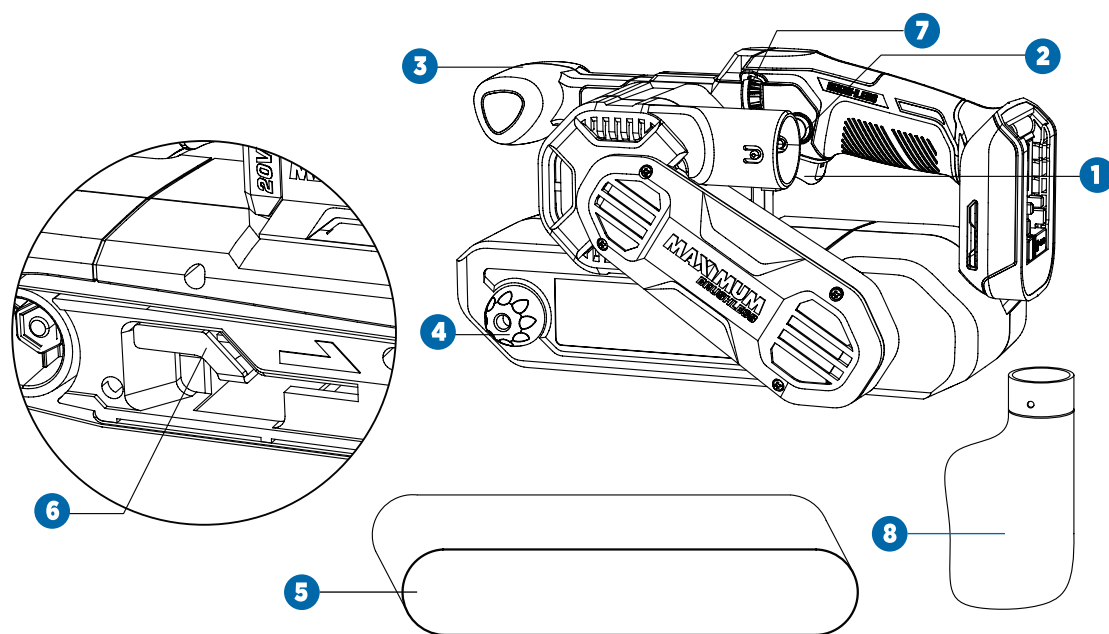
**WARNING!**

- Remove the product and any accessories from the package. Inspect the tool carefully to make sure no breakage or damage occurred during shipping.
- Do not discard the carton or any packaging material until all parts have been examined.

| NO. | DESCRIPTION |
|-----|--------------------|
| 1 | Switch |
| 2 | Screw |
| 3 | Screw |
| 4 | Cosmetic cover |
| 5 | Air vent cover |
| 6 | Right housing |
| 7 | Middle housing |
| 8 | Ceramic |
| 9 | Screw |
| 10 | Clamp device |
| 11 | Soft wood plate |
| 12 | Base plate |
| 13 | Rivet |
| 14 | Roller shaft |
| 15 | Washer |
| 16 | Ball bearing |
| 17 | Roller |
| 18 | Fork |
| 19 | Washer |
| 20 | Lever |
| 21 | Washer |
| 22 | Spring |
| 23 | Spring |
| 24 | Split washer |
| 25 | Washer |
| 26 | Knob |
| 27 | Label |
| 28 | Screw |
| 29 | Nut |
| 30 | Driven wheel |
| 31 | Washer |
| 32 | Washer |
| 33 | Ring |
| 34 | Washer |
| 35 | Sleeve |
| 36 | Needle bearing |
| 37 | Ball bearing |
| 38 | Aluminum base |
| 39 | Axes |
| 40 | Pin |
| 41 | Gear |
| 42 | Motor sub assembly |
| 43 | Baffle plate |
| 44 | Screw |

| NO. | DESCRIPTION |
|-----|--------------------|
| 45 | Fan |
| 46 | Connection shaft |
| 47 | Bearing cover |
| 48 | Ball bearing |
| 49 | Left housing |
| 50 | Screw |
| 51 | Small pulley |
| 52 | Belt cover |
| 53 | Screw |
| 54 | Drive belt |
| 55 | Big pulley |
| 56 | Washer |
| 57 | Ball bearing |
| 58 | Intermediate shaft |
| 59 | Sanding belt |
| 60 | Dust bag assembly |

INSTALLING AND REMOVING SANDING BELTS (FIG. A)**TO INSTALL BELT:**

- Remove the battery pack.
- Place sander on its side and pull the belt tension release lever out.
- Insert the new belt around both rollers, and make sure the arrow on the inside of belt corresponds to the direction of rotation as indicated on housing.
- Once the belt is centred over the rollers and bottom plate, push lever back to its original position to return tension to the belt.

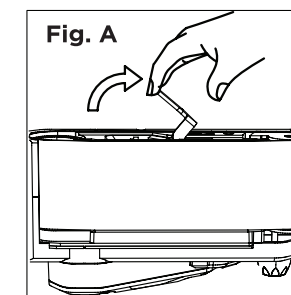
**TO REMOVE BELT:**

- Remove the battery pack.
- Place sander on its side and pull the belt tension release lever out.
- With the sander on its side and the open side facing you, you can easily remove the belt.

ADJUSTING BELT TRACKING (FIG. B)

This sander features an automatic tracking system designed to keep the sanding belt centred. The system has been preset at the factory but may require adjustment when belts are changed or an older belt stretches. For best performance the belt should be in line with the outer edge of the rear pulley. If the belt deviates more than 1/8" (3.2 mm) from the outside of the sander, adjust the belt position.

**WARNING!**

To prevent personal injury, remove the battery pack before making adjustments or assembling accessories.

**WARNING!**

- Keep hands and fingers away from moving sanding belt. Any body part coming in contact with moving sanding belt could result in serious injury. Do not wear loose clothing or jewellery when operating sander. They could get caught in moving parts and foreign objects could get thrown from sander causing injury.
- Do not allow familiarity with products to make you careless. Remember that a careless fraction of a second is sufficient to inflict serious injury.

To adjust the belt: (if necessary)

- Make sure the switch is not in the lock-on position.
- Install the battery pack.
- Set the variable speed control dial to the lowest setting.
- Hold handle of sander with one hand and tilt the sander so that the belt is facing the operator.
- Turn tool ON by pressing the trigger.
- Slowly turn the belt adjustment knob until the belt returns to the proper position.
- Release the trigger and make sure that the belt has come to a complete stop before setting the tool down.

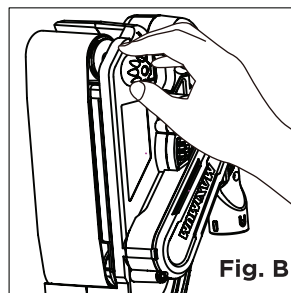

Fig. B

INSTALLING THE DUST COLLECTION BAG (FIG. C)

The dust bag provides a dust collection system for the sander. It should be installed over the exhaust hole located on the side of the sander. For more efficient operation, empty dust bag when half full.

Do not install battery pack before installing dust bag.

To install dust bag:

- Remove the battery pack.
- Place the opening of dust bag over dust exhaust of the sander.

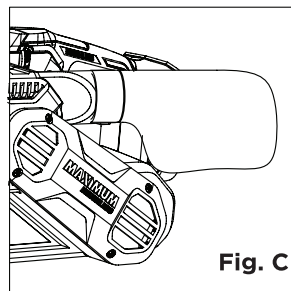

Fig. C

ATTACHING THE BELT SANDER TO A VACUUM (FIG. D)

The sander has a built-in dust extraction part, which allows a shop vacuum to be connected. A 1 1/4" (3.2 cm) vacuum hose can be connected directly to the tool.

- Remove the battery pack.
- Attach a vacuum hose to the dust port.
- Connect the vacuum to a power supply.
- Turn vacuum on before starting sanding.

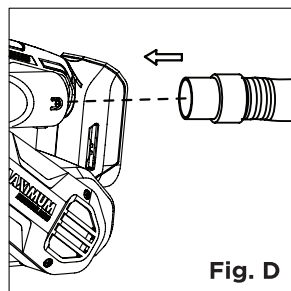

Fig. D

**WARNING!**

Do not use the dust collection bag when sanding metal. Using the dust collection bag when sanding metal creates a fire hazard, which could damage the tool and lead to serious personal injury.

FITTING AND REMOVING THE BATTERY PACK TO THE SANDER

- To install the battery pack to the tool, align the raised portion of the battery pack with the grooves on the handle of the tool, and slide it firmly into the handle until you hear the lock snap into place (Fig. E).
- To remove the battery pack from the tool, press the battery pack release button and slide the battery pack completely out of tool handle.

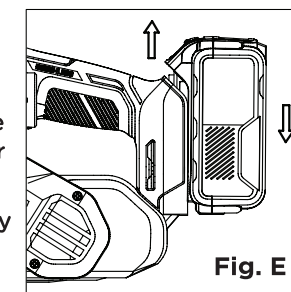

Fig. E

CHARGING PROCEDURE

- Connect the plug cable to the charger, and then plug into an appropriate outlet before inserting battery pack (Fig. F). The green light will be on for two seconds and then off.
- Insert the battery pack into the charger, making sure the pack is fully seated in the charger (Fig. G). The green (charging) light will blink continuously, indicating that the charging process has started.
- The completion of charge will be indicated by the green light remaining on continuously. The battery pack is fully charged and may be used at this time. To remove the battery pack from the charger, slide the battery pack out of the seat.

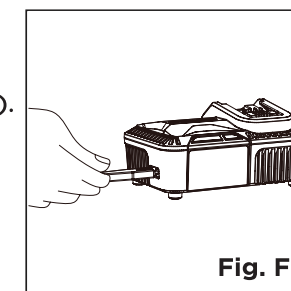

Fig. F

**WARNING!**

- Before attempting to use this cordless tool, become familiar with all of its operating features and safety requirements.
- To reduce the risk of serious personal injury, turn tool off and disconnect battery pack before making any adjustments or removing/installing attachments or accessories.

**CAUTION!**

- Before attempting to charge the battery, check the charger and the battery to ensure the charging equipment matches the battery supplied. The components are all labelled with component numbers.
- The rechargeable battery is not fully charged on leaving the factory. Charge the rechargeable battery before first use.
- Recharge discharged batteries as soon as possible after use or battery life may be greatly diminished. For longest battery life, do not discharge batteries fully.

CHARGER INDICATORS AND DIAGNOSTICS (FIG. H)

The charger is designed to detect certain problems that can arise with battery packs.

- When the charger detects the battery pack is too hot or too cold, the red light will light up and stay on, suspending charging. If the battery pack is overheated, please remove the battery pack from the charger and allow it to cool down for 15-30 minutes and re-insert. If the battery pack is too cold, please remove the battery pack from the charger and allow the battery pack to reach an optimum temperature before re-insert the battery pack. This feature ensures maximum battery life.
- When the charger detects a malfunction in the battery pack or a malfunction of the charger itself, the red light will light up and continue to blink. If this occurs, please remove the battery pack and allow it to cool down for 15-30 minutes. Then re-insert the battery pack into the charger. If the red light still flashes, try a different battery pack to determine if the charger is working properly. If the new pack charges correctly, then the original pack is defective and may require service. If the new battery pack shows the same trouble indication as the original pack, the could mean a problem with the charger.

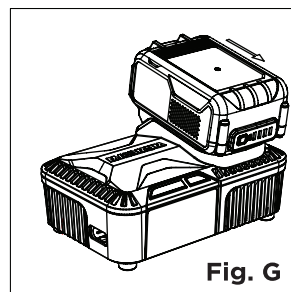

Fig. G

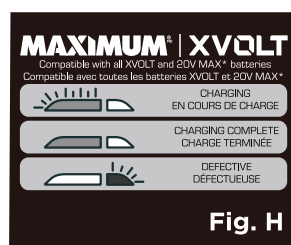

Fig. H

FUEL GAUGE

The lithium-ion battery pack is equipped with a fuel gauge which consists of four green

| LED INDICATOR | | REMAINING POWER STATUS |
|---------------|--|------------------------|
| 1 | | 0-20 % |
| 2 | | 20-40 % |
| 3 | | 40-75 % |
| 4 | | 75-100 % |

**CAUTION!**

The working temperature of the charger is 40 to 104°F (4 to 40°C).

NOTE: For maximum performance and life of lithium-ion battery packs, charge the battery pack fully before first use.

NOTE: Charging times may be longer depending on the surrounding temperature and battery condition.

LED lights that indicate the level of charge remaining in the battery pack. Press the fuel gauge button to display the LED lights, showing the approximate level of charge.

TURNING THE SANDER ON AND OFF (FIG. I)

- To turn on the sander: Depress the switch trigger.
- To turn off the sander: Release the switch trigger.

LOCK-ON BUTTON (FIG. I)

The sander is equipped with a “lock-on” button that allows continuous operation.

- To lock switch ON: Depress the switch trigger, push in the lock-on button, and release the switch trigger.
- To unlock switch: Depress and release the switch trigger.

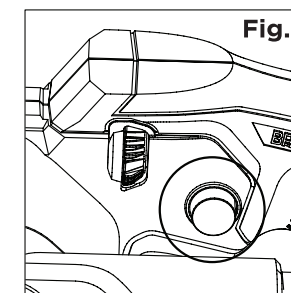
**VARIABLE SPEED CONTROL DIAL (FIG. J)**

The sander has a variable speed control dial, 1 (slowest) to 6 (fastest), designed to allow operator control of belt speed. To increase belt speed, turn the variable speed control dial to a higher setting. Turn to a lower setting to decrease belt speed.

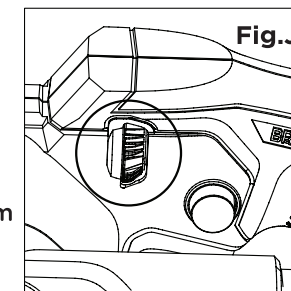
**SANDING OPERATION**

- Clamp or otherwise secure the workpiece to prevent it from moving under the sander.
- Before placing sander on work surface, squeeze the switch trigger and let the motor reach its maximum speed, then lower the sander to the work surface with a slight forward motion.

**WARNING!**

Before installing the battery pack, make sure the switch is not in the lock-on position. Failure to do so could result in accidental starting of the tool resulting in serious injury.

**WARNING!**

- An unsecured workpiece could be thrown back toward operator causing injury.
- The tool should not be in contact with the workpiece surface when you turn the tool on or off. Otherwise a poor sanding finish or damage of the belt may result.
- Keep a firm grip on sander with both hands at all times. Failure to do so could result in loss of control leading to possible serious injury.

- Hold the tool firmly with both hands. Using the rear handle to control the sander and the front handle only to guide it, move it slowly over the workpiece. Allowing the sander to remain in one place will result in an uneven surface.
- Apply proper pressure on the sander. Excessive pressure may cause stalling, overheating of the motor, burning of the workpiece and possible kickback.
- Use a coarser sanding belt for heavy sanding, not heavy pressure. The weight of the tool is sufficient to provide adequate pressure at the correct location.
- The front roller of the sander is not designed for contour sanding. Sanding on the front roller could cause irregularity in the sanding belt tracking.

GENERAL MAINTENANCE

Avoid using solvents when cleaning plastic parts. Most plastics are susceptible to damage from various types of commercial solvents and may be damaged by their use. Use clean cloths to remove dirt, dust, oil, grease, etc.

LUBRICATION

All of the bearings in this tool are lubricated with a sufficient amount of high grade lubricant for the life of the unit under normal operating conditions; therefore, no further lubrication is required.

NOTE: It is suggested to have the carbon brushes replaced by an authorized service centre.

**WARNING!**

- Make sure that the surface is safe and does not wobble.
- In stationary operation, always work with the greatest of attention. There is a risk of injury to hands and fingers by slipping on the workpiece.
- To prevent personal injury, hold workpiece with both hands in stationary operation.

**WARNING!**

- When servicing, use only identical replacement parts. Use of any other parts may create a hazard or cause product damage.
- Always wear safety goggles or safety glasses with side shields during power tool operation or when blowing dust. If operation is dusty, also wear a dust mask.
- Do not at any time let brake fluids, gasoline, petroleum-based products, penetrating oils, etc., come in contact with plastic parts. Chemicals can damage, weaken or destroy plastic which may result in serious personal injury.

5-YEAR LIMITED WARRANTY

This MAXIMUM product is guaranteed for a period of 5 years from the date of original retail purchase against defects in workmanship and materials only and is subject to the following components:

- a) Component A: The carrying case is guaranteed for a period of 1 year from the date of original retail purchase against defects in workmanship and materials.
- b) Component B: Accessories, including drill bits and saw blades, do not carry a warranty.



Subject to the conditions and limitations described below, this product, if returned to us with proof of purchase within the stated warranty period and if covered under this warranty, will be repaired or replaced (with the same model, or one of equal value or specification), at the sole discretion of the MAXIMUM Canada authorized repair centre ("Service Provider"). We will bear the cost of any repair or replacement and any costs of labour relating thereto.

These warranties are subject to the following conditions and limitations:

- a) a bill of sale verifying the purchase and purchase date must be provided;
- b) defects in workmanship and material to be assessed and determined by the Service Provider;
- c) this warranty will not apply to any product or part thereof which is worn or broken or which has become inoperative due to abuse, misuse, accidental damage, neglect or lack of proper installation, operation or maintenance (as outlined in the applicable owner's manual or operating instructions);
- d) this warranty does not apply to normal wear and tear or to expendable parts or accessories (including drill bits and saw blades) that may be supplied with the product that by their nature have a limited life span and are expected to become inoperative or unusable after a reasonable period of use;
- e) this warranty will not apply to routine maintenance and consumable items such as, but not limited to, fuel, lubricants, vacuum bags, blades, belts, sandpaper, bits, fluids, rubber o-rings, tune-ups or adjustments;
- f) this warranty excludes the following components that may accompany your product:
 - (1) The carrying case, which is only for a period of 1 year from the date of original retail purchase against defects in workmanship and materials.
 - (2) Accessories, including drill bits and saw blades, which do not carry a warranty of any kind.
- g) this warranty will not apply where damage is caused by repairs made or attempted by anyone other than the Service Provider (i.e., persons not authorized by the manufacturer), and any such unauthorized repairs or attempted repairs shall void this warranty in its entirety;
- h) this warranty will not apply to any parts other than original parts, except to the extent that the retailer or manufacturer or persons authorized by either of them

have repaired or replaced them;

- i) this warranty will not apply to any product that was sold to the original purchaser as a reconditioned or refurbished product (unless otherwise specified in writing);
- j) this warranty will not apply to any product or part thereof if any part from another manufacturer is installed therein or any repairs or alterations have been made or attempted by unauthorized persons;
- k) this warranty will not apply to normal deterioration of the exterior finish, such as, but not limited to, scratches, dents, paint chips, or to any corrosion or discolouring by heat, abrasive and chemical cleaners;
- l) this warranty will not apply to component parts sold by and identified as the product of another company, which shall be covered under that product manufacturer's warranty, if any;
- m) any products replaced by the retailer in attempt to fulfill warranty obligations is subject to the original product warranty conditions and related time period as initiated by the original date of purchase; if product is purchased in Quebec, the warranty term will be extended for a period equal to the time during which the Quebec retailer possesses the product in attempt to fulfill warranty obligations; replaced product will not default to new product warranty conditions; and
- n) The retailer and manufacturer's sole obligation and the purchaser's sole remedy under this warranty shall be as set out herein. The warranties contained herein are not transferable and are given only to the purchaser. FURTHER, THE WARRANTIES SET OUT HEREIN ARE IN LIEU OF ALL OTHER WARRANTIES OR CONDITIONS, WHETHER EXPRESS, IMPLIED OR STATUTORY (INCLUDING SUCH AS ARISE UNDER THE SALE OF GOODS ACT OR THE INTERNATIONAL SALE OF GOODS ACT), ARISING OUT OF A COURSE OF DEALING OR USAGE OF TRADE OR OTHERWISE, INCLUDING, SUBJECT TO APPLICABLE LAW, ANY IMPLIED WARRANTIES OR CONDITIONS OF MERCHANTABILITY, MERCHANTABLE QUALITY, FITNESS OR ADEQUACY FOR A PARTICULAR PURPOSE OR USE, AND ALL OTHER SUCH WARRANTIES ARE EXPRESSLY DISCLAIMED BY THE RETAILER AND MANUFACTURER.

ADDITIONAL LIMITATIONS

This warranty applies only to the original purchaser and may not be transferred.

This warranty applies for a period of 5 years from the date of original retail purchase, as indicated on the bill of sale.

Neither the retailer, MAXIMUM Canada, nor the manufacturer shall be liable for any other expense, loss or damage, including, without limitation, any indirect, incidental, consequential or exemplary damages arising in connection with the sale, use or inability to use this product.

Under no circumstances shall the retailer, MAXIMUM Canada, or manufacturer be liable to the purchaser for any claim for (a) indirect, special, punitive, incidental, exemplary, or consequential damages; (b) compensation for loss of profits, anticipated revenue, savings or goodwill, or other economic loss of the purchaser; (c) exemplary, aggravated or punitive damages howsoever incurred; (d) contribution or set-off in respect of



24

model no. 054-7981-4 | contact us 1-888-670-6682

WARRANTY

any claims against the purchaser; (e) any damages whatsoever relating to third party products or services or the purchaser's materials, or (f) any damages whatsoever relating to interruption, delays, errors or omissions; in each case under any theory of law or equity, arising out of or in any way related to this warranty, even if advised of the possibility thereof. Notwithstanding any provision herein or entitlement of the purchaser at law, in equity or otherwise, in no event shall the liability of the retailer or manufacturer under this warranty, whether in contract, tort, product liability or otherwise, exceed, in the aggregate, the amount paid by the purchaser to the retailer for the product to which this warranty applies.

NOTICE TO CONSUMER

This warranty gives you specific legal rights, and you may have other rights, which may vary from province to province. The provisions contained in this warranty are not intended to limit, modify, take away from, disclaim or exclude any statutory warranties set forth in any applicable provincial or federal legislation.

In addition to the 5-Year Limited Warranty, this MAXIMUM product is covered by our:

1-YEAR REPAIR WARRANTY

MAXIMUM Canada will maintain this product and replace critical parts which have worn beyond reasonable use through normal use of such product, any time during the first year after purchase.

The following are excluded from this 1-Year Repair Warranty:

- a) Missing or damaged parts or components that are a result of abuse or misuse; and
- b) Any wear and tear to non-critical parts or accessories that do not affect the core function of the product.

90-DAY SATISFACTION GUARANTEE

If you are not completely satisfied with the performance of your MAXIMUM product for any reason, you can return it within 90 days from the date of purchase with proof of purchase for exchange or a full refund.

Made in China

Imported by MAXIMUM Canada Toronto, Canada M4S 2B8