

# MAXIMUM<sup>®</sup>

## Orbital Jigsaw

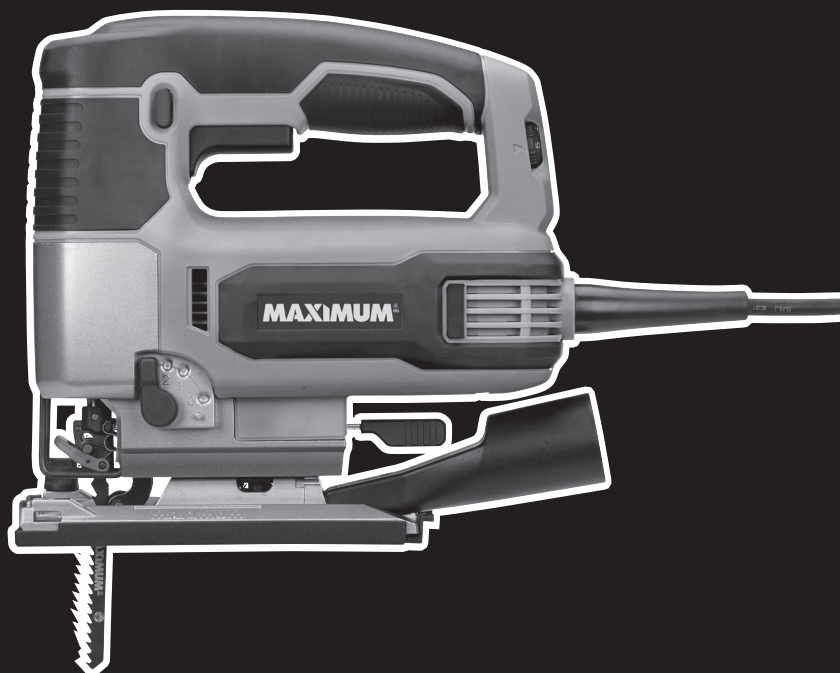

**Model No. 054-7287-8**

**IMPORTANT:**

Please read this manual carefully before using this product, and save it for reference.

**INSTRUCTION  
MANUAL**



### TABLE OF CONTENTS

Technical Specifications	4
Safety Guidelines	5
Key Parts Diagram	9
Important Information	10
Assembly Instructions	11
Operating Instructions	13
Maintenance	17
Troubleshooting	18
Parts List	19
Warranty	22

**NOTE:** If any parts are missing or damaged, or if you have any questions, please call our toll-free helpline at 1-888-670-6682.



### SAVE THESE INSTRUCTIONS

- This manual contains important safety and operating instructions. Read all instructions and follow them when using this product.

**TECHNICAL SPECIFICATIONS**

Rated Input	120V, 60 Hz, 7A
Variable Speed	0-3000 SPM (no load)
Bevel-Angle Range	0°, 15°, 30°, 45° left and right
Cutting Capacity: Softwood	3 15/16" (100 mm)
Cutting Capacity: Aluminum	19/32" (15 mm)
Cutting Capacity: Mild Steel	5/16" (8 mm)
Stroke Length	1" (25.4 mm)
Blade type	T- and U-shank
Weight	5 lb 14 oz (2.66 kg)

## **SAFETY GUIDELINES**



### **WARNING!**

Safety symbols in this Instruction Manual are used to flag possible dangers. The safety symbols and their explanations require your full understanding. The safety warnings do not, by themselves, eliminate any danger, nor are they substitutes for proper accident prevention measures.



### **WARNING!**

This Safety Alert Symbol indicates caution, warning, or danger. Failure to obey a safety warning can result in serious injury to yourself or others. To reduce the risk of injury, fire, or electric shock, always follow the safety precautions.

## **KNOW YOUR TOOL**

To operate this tool, carefully read this Instruction Manual and all labels affixed to the orbital jigsaw before using. Keep this manual available for future reference.

## **IMPORTANT**

This tool should only be serviced by a qualified service technician. For more information, call the toll-free helpline at 1-888-670-6682.

## **READ ALL INSTRUCTIONS THOROUGHLY**

## **SAVE THESE INSTRUCTIONS**

## **GENERAL POWER TOOL SAFETY WARNINGS**



### **WARNING!**

Read all safety warnings, instructions and specifications provided with this power tool. Failure to follow all instructions listed below may result in electric shock, fire and/or serious injury

## **SAVE ALL WARNINGS AND INSTRUCTIONS FOR FUTURE REFERENCE.**

The term “power tool” in the warnings refers to your mains-operated (corded) power tool or battery-operated (cordless) power tool.

## **WORK AREA SAFETY**

- **Keep work area clean and well lit.** Cluttered or dark areas invite accidents.
- **Do not operate power tools in explosive atmospheres, such as in the presence of flammable liquids, gases or dust.** Power tools create sparks which may ignite the dust or fumes.
- **Keep children and bystanders away while operating a power tool.** Distractions can cause you to lose control.

## ELECTRICAL SAFETY

- **Power tool plugs must match the outlet. Never modify the plug in any way. Do not use any adaptor plugs with earthed (grounded) power tools.** Unmodified plugs and matching outlets will reduce risk of electric shock.
- **Avoid body contact with earthed or grounded surfaces, such as pipes, radiators, ranges and refrigerators.** There is an increased risk of electric shock if your body is earthed or grounded.
- **Do not expose power tools to rain or wet conditions.** Water entering a power tool will increase the risk of electric shock.
- **Do not abuse the cord. Never use the cord for carrying, pulling or unplugging the power tool. Keep cord away from heat, oil, sharp edges or moving parts.** Damaged or entangled cords increase the risk of electric shock.
- **When operating a power tool outdoors, use an extension cord suitable for outdoor use.** Use of a cord suitable for outdoor use reduces the risk of electric shock.
- **If operating a power tool in a damp location is unavoidable, use a ground fault circuit interrupter (GFCI) protected supply.** Use of a GFCI reduces the risk of electric shock.

## PERSONAL SAFETY

- **Stay alert, watch what you are doing and use common sense when operating a power tool. Do not use a power tool while you are tired or under the influence of drugs, alcohol or medication.** A moment of inattention while operating power tools may result in serious personal injury.
- **Use personal protective equipment. Always wear eye protection.** Protective equipment such as a dust mask, non-skid safety shoes, hard hat or hearing protection used for appropriate conditions will reduce personal injuries.
- **Prevent unintentional starting. Ensure the switch is in the off-position before connecting to power source and/or battery pack, picking up or carrying the tool.** Carrying power tools with your finger on the switch or energising power tools that have the switch on invites accidents.
- **Remove any adjusting key or wrench before turning the power tool on.** A wrench or a key left attached to a rotating part of the power tool may result in personal injury.
- **Do not overreach. Keep proper footing and balance at all times.** This enables better control of the power tool in unexpected situations.
- **Dress properly. Do not wear loose clothing or jewellery. Keep your hair and clothing away from moving parts.** Loose clothes, jewellery or long hair can be caught in moving parts.
- **If devices are provided for the connection of dust extraction and collection facilities, ensure these are connected and properly used.** Use of dust collection can reduce dust-related hazards.
- **Do not let familiarity gained from frequent use of tools allow you to become complacent and ignore tool safety principles.** A careless action can cause severe injury within a fraction of a second.

## POWER TOOL USE AND CARE

- **Do not force the power tool.** Use the correct power tool for your application. The correct power tool will do the job better and safer at the rate for which it was designed.
- **Do not use the power tool if the switch does not turn it on and off.** Any power tool that cannot be controlled with the switch is dangerous and must be repaired.
- **Disconnect the plug from the power source and/or remove the battery pack, if detachable, from the power tool before making any adjustments, changing accessories, or storing power tools.** Such preventive safety measures reduce the risk of starting the power tool accidentally.
- **Store idle power tools out of the reach of children and do not allow persons unfamiliar with the power tool or these instructions to operate the power tool.** Power tools are dangerous in the hands of untrained users.
- **Maintain power tools and accessories.** Check for misalignment or binding of moving parts, breakage of parts and any other condition that may affect the power tool's operation. If damaged, have the power tool repaired before use. Many accidents are caused by poorly maintained power tools.
- **Keep cutting tools sharp and clean.** Properly maintained cutting tools with sharp cutting edges are less likely to bind and are easier to control.
- **Use the power tool, accessories and tool bits etc., in accordance with these instructions, taking into account the working conditions and the work to be performed.** Use of the power tool for operations different from those intended could result in a hazardous situation.
- **Keep handles and grasping surfaces dry, clean and free from oil and grease.** Slippery handles and grasping surfaces do not allow for safe handling and control of the tool in unexpected situations.

## SERVICE

- **Have your power tool serviced by a qualified repair person using only identical replacement parts.** This will ensure that the safety of the power tool is maintained

## SAFETY GUIDELINES FOR CORDED JIGSAW

- **Hold the power tools by insulated gripping surfaces, when performing an operation where the cutting accessory may contact hidden wiring or its own cord.** Cutting accessory contacting a "live" wire may make exposed metal parts of the power tool "live" and could give the operator an electric shock.
- **Use clamps or another practical way to secure and support the workpiece to a stable platform.** Holding the workpiece by hand or against your body leaves it unstable and may lead to loss of control.
- **Secure material before cutting.** Never hold it in your hand or across legs. Small or thin material may flex or vibrate with the blade, causing loss of control.

- Always wear eye protection and a dust mask for dusty applications and when absorbed by your eyes and inhaled easily and may cause health complications. Protect your hearing while using this tool.
- Never leave the trigger locked "ON". Before plugging the tool in, check that the trigger lock is "OFF". Accidental start-ups could cause injury.
- Keep hands away from cutting area. Do not reach under the material being cut. The proximity of the blade to your hand is hidden from your sight.
- Do not use dull or damaged blades. Bent blade can break easily or cause kickback.
- Before starting to cut, turn tool "ON" and allow the blade to come to full speed. Tool can chatter or vibrate if blade speed is too slow at beginning of cut and possibly kickback.
- When removing the blade from the tool avoid contact with skin and use proper protective gloves when grasping the blade or accessory. Accessories may be hot after prolonged use.
- The label on your tool may include the following symbols. The symbols and their definitions are as follows:

V ..... Volts

A ..... Amperes

Hz ..... Hertz

W ..... Watts

min ..... Minutes

~ ..... Alternating current

— — — ..... Direct current

n ..... Rated speed

$n_0$  ..... No-load speed

 ..... Class II Construction

.../min ..... Revolutions or reciprocations per minute

 ..... Grounding terminal

BPM ..... Beats per minute

RPM ..... Revolutions per minute

OPM ..... Orbits per minute

SPM ..... Strokes per minute

 ..... WARNING - To reduce the risk of injury, the user must read the instruction manual.

 ..... WARNING - To reduce the risk of injury, always wear eye protection.

 ..... WARNING - To reduce the risk of injury, always wear ear protection.



## PACKAGE CONTENTS

Jigsaw, 1 1/4" (31.75 mm) vacuum adaptor, anti-splinter insert, plastic overshoe, edge guide, wood-cutting blade, nylon tote, and instruction manual.

## KEY PARTS DIAGRAM

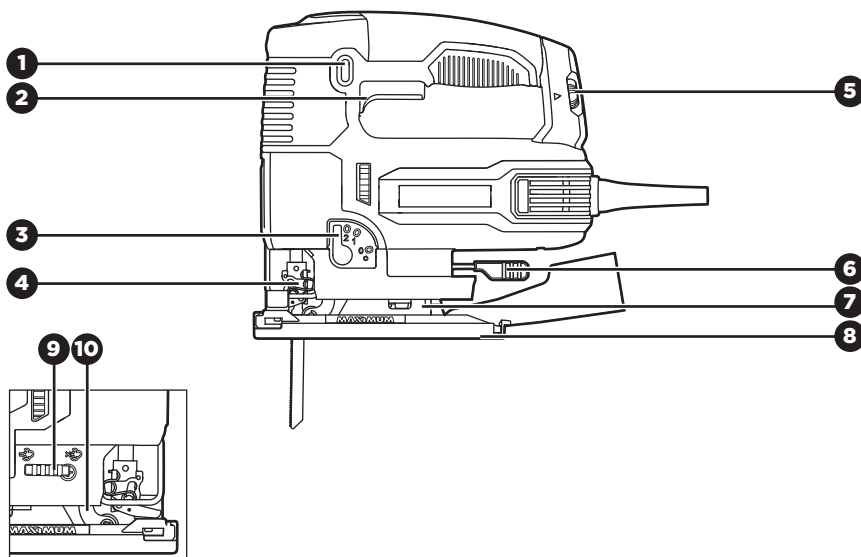

## KEY PARTS DIAGRAM

NO.	PART
1	Lock-on button
2	Trigger switch
3	Orbit-selection lever
4	One-touch blade-change lever
5	Variable-speed dial

NO.	PART
6	Tool-less bevel lever
7	Base plate
8	Plastic overshoe
9	Blower switch
10	Blade guide



## WARNING!

- Remove the jigsaw from the package and examine it carefully. Do not discard the carton or any packaging material until all parts have been examined.
- If any part of the jigsaw is missing or damaged, do not use or plug in the tool until the part has been repaired or replaced. Failure to heed this warning could result in serious injury.

**IMPORTANT INFORMATION**

Before attempting to use this tool, become familiar with all of its operating features and safety requirements. For optimum performance and safety, read the following operating instructions carefully before using.

### ASSEMBLY INSTRUCTIONS

#### INSTALLING AND REMOVING THE SAW BLADE (fig 1 and fig 2)

1. Unplug the tool and turn the tool upside down.
2. Depress the one-touch blade-change lever; it will lock in the open position (fig 1).
3. Insert the blade (teeth in cutting direction) into the clamp. If the blade can't be inserted easily, you can push the blade shank forward while inserting the blade. After inserting the blade in position, the one-touch blade-change lever will return automatically to its original position (fig 2).
4. Verify that the blade has been secured in place firmly by pulling on the blade.
5. To remove a previously-used blade, depress and hold the one-touch blade-change lever and simply pull away the blade.

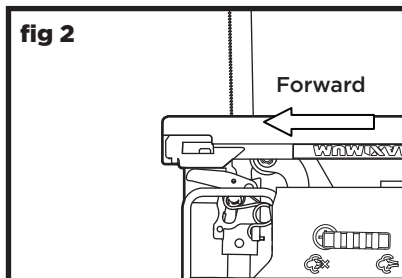
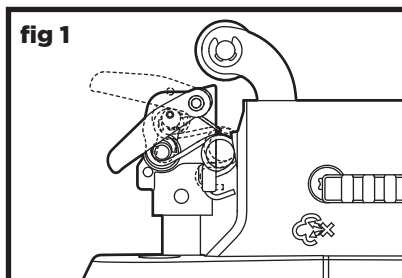

**NOTICE:** When inserting the saw blade, the back of the blade must rest in the groove of the guide roller.

### INSTALLING PLASTIC OVERSHOE (fig 3)

1. Unplug the tool.
2. Place the overshoe over the front of metal footplate and snap it into place at the rear of footplate.

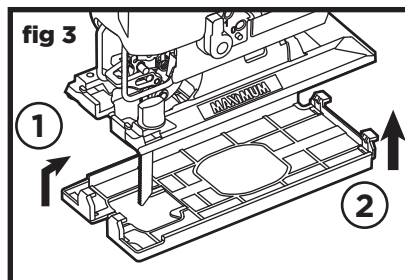

### INSTALLING ANTI-SPLINTER INSERT (fig 4)

1. Unplug the tool and turn the saw upside down.
2. Align the grooves on the insert with the ribs on the jigsaw or on the plastic overshoe, and then insert the front of the insert.
3. Squeeze the rear tabs of the anti-splinter insert and press the insert into the saw or the plastic overshoe.

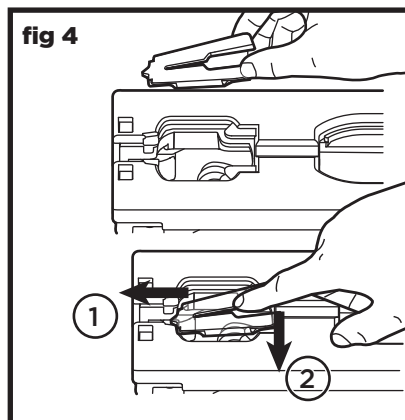

### INSTALLING THE EDGE GUIDE (fig 5)

The edge guide is used for straight cutting:

1. Insert the bar of the edge guide through the slots in the base of the saw with the edge guide facing down. It can be inserted from either side of the base.
2. Screw the edge-guide locking knob into the threaded hole in the base to tighten the edge guide bar in place.
3. Measure the distance from the edge of the workpiece to the cutting line. Slide the edge guide to this desired distance and tighten the locking knob to secure the edge guide in place.

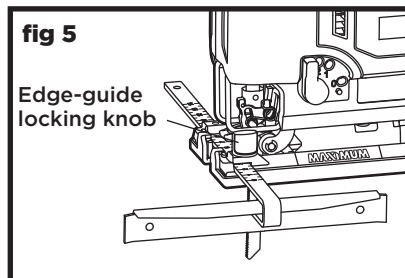

### OPERATING INSTRUCTIONS

#### VARIABLE-SPEED DIAL (fig 6)

Your jigsaw is equipped with a variable-speed dial. The optimal jigsaw cutting speed or stroke rate depends on the material being cut, the type of blade being used, and the feed rate preferred by the operator. At the “0” position, there is no blade action. The “5” position results in the highest speed. Select the speed that is appropriate for the material and the project at hand.

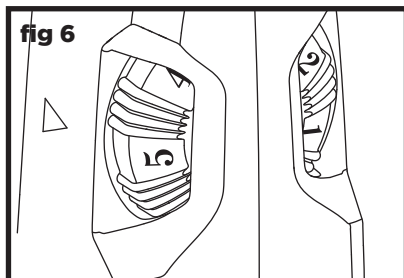

The best speed for a particular application is largely determined by experience, though, as a general rule, slower speeds are for denser materials and faster speeds for softer materials.

#### TRIGGER SWITCH AND LOCK-ON BUTTON (fig 7)

1. Connect the power cord of your jigsaw to a standard household power outlet.
2. To turn the saw ON, depress the on/off trigger switch.
3. To turn the tool OFF, release the trigger switch.
4. To lock the on/off trigger switch in the “on” position, press the trigger switch and hold it on, then press in the lock-on button. Release the trigger switch and then release the lock-on button. The lock-on button allows the operator to keep the jigsaw running without squeezing the trigger switch. This feature is convenient for continuous sawing applications.
5. To release the lock-on button, press and release the trigger switch.
6. The speed can be adjusted from the minimum to maximum SPM as set on the variable speed dial and the pressure you apply to the trigger. Apply more pressure to increase the speed and release pressure to decrease speed. Regardless of the pressure applied on the trigger, the tool speed will not exceed the maximum speed setting selected on the variable-speed dial.

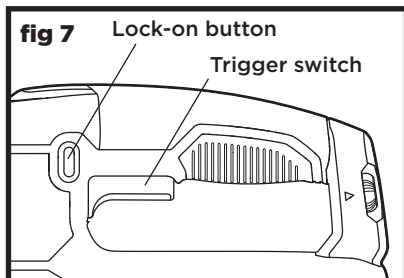

**NOTICE:** When the jigsaw is used at low speed settings for an extended length of time, the motor temperature will rise due to slower speeds of the internal cooling fan. In such cases, it is necessary to occasionally run the tool at full speed for a few minutes to keep the motor running at high efficiency.

**CHIP BLOWER (fig 8)**

Your jigsaw is equipped with a chip blower to help keep the cutting line clear of chips. Push the chip blower button forward to close the blower; push it backward to open the blower.

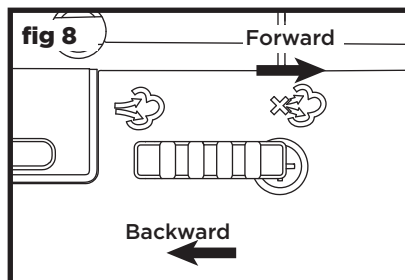
**ORBIT-SELECTOR LEVER (fig 9)**

Maximum cutting efficiency can be obtained by adjusting the orbit-selector lever to suit the material being cut. The following chart will help you determine which setting to use for your application. This chart is intended as a guideline only, and test cuts in scrap material should be performed first to determine the best setting for your project.

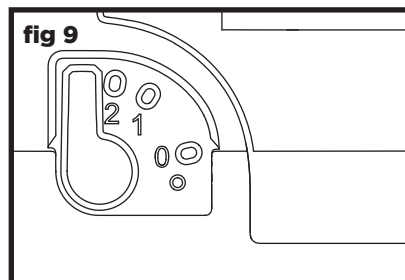

Orbit Setting	Orbit Action	Material Type	Suggested Blade Type	Suggested TPI (Teeth per inch)
Setting "0"	No orbit	Counter top, laminate board	Wood-cutting Blade	10-12 (Down stroke blade)
	No orbit	Thin sheet metal	Metal-cutting Blade	14-24
Setting "1"	Minimal orbit	Plastic and PVC	Wood-cutting Blade	10-12
Setting "2"	Medium orbit	Plywood, decking and hard wood	Wood-cutting Blade	6-12
Setting "3"	Maximum orbit	General lumber and soft wood	Wood-cutting Blade	6-10

### ADJUSTING THE BASE PLATE FOR BEVEL CUTTING (fig 10a, 10b, 10c, 10d and 10e)

1. Rotate the tool-less bevel lever to unlock the base plate; refer to fig 10a.
2. Move the base plate backward so that the base plate can be beveled; refer to fig 10b.
3. The base plate can be beveled to the left or to the right and has detents at 0, 15, 30 and 45°. Align the middle rib with the mark on the base plate; refer to fig 10c.
4. When the desired bevel angle is achieved, move the base plate forward; rotate the keyless bevel lever back to lock the base plate.
5. Accurate work requires a trial cut. Measure the work after cutting and reset the angle as necessary. Repeat the setting until the correct bevel is achieved.
6. If the base plate will not tighten as expected, you can adjust the locking screw with a hex wrench (not included). Loosen the tightening screw with a screwdriver (not included), and then tighten or loosen the locking screw. Verify that the base plate can move smoothly and will lock as expecting after adjusting. After adjusting, tighten the tightening screw again. Refer to fig 10d.

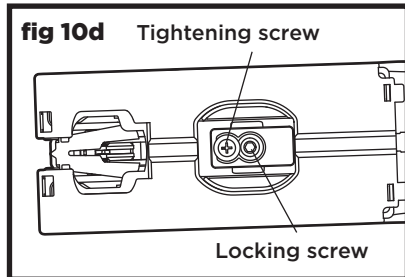
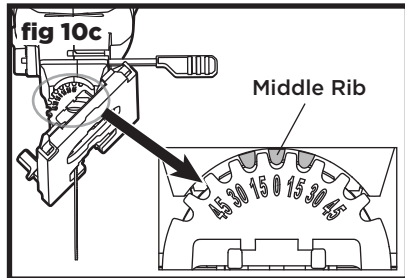
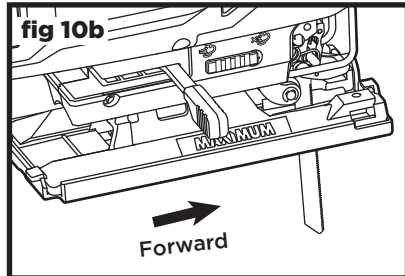
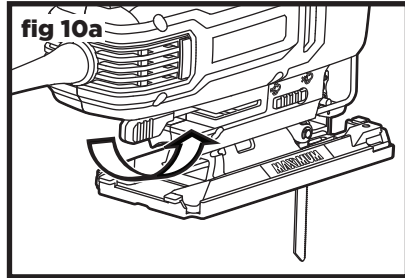

**NOTICE:** Remove the edge-guide locking knob before setting the 45° bevel angle if necessary.

7. In order to pull out the vacuum adapter, lift the vacuum adapter upward and then pull it out before adjusting the tightening and locking screws, as shown in fig 10e.

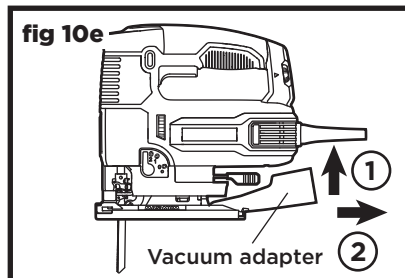

### LED WORKLIGHT (fig 11)

The LED worklight will illuminate when the trigger switch is pressed. This provides additional light on the surface of the workpiece for operation in lower light situations.

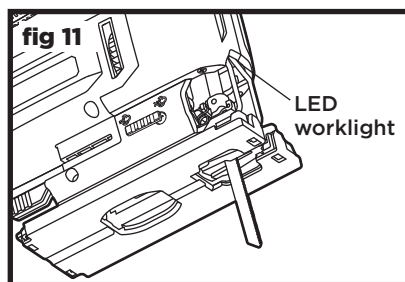

### GENERAL CUTTING

1. Firmly clamp the workpiece in place.
2. Use the appropriate type and size of blade for the workpiece.
3. Check the clearance behind the workpiece and make sure that the blade will not impact another surface.
4. Clearly mark the line of the cut.
5. Hold the saw firmly. Make sure that your hand is on the insulated gripping areas only.
6. Rest the base plate on the workpiece so that the blade is not in contact with the workpiece.
7. Turn on the jigsaw and bring it to the maximum desired cutting speed before applying the blade to the workpiece.
8. Slowly move the jigsaw into the workpiece.
9. Do not force the tool. Keep the base plate flat against the workpiece while cutting. Use only enough steady pressure on the blade to keep the saw cutting.
10. Reduce pressure as the blade comes to the end of the cut.
11. Allow the saw to come to a complete stop before removing the blade from the workpiece.
12. If sawing fiberglass, plaster, wallboard, or spackling compound, clean the saw motor vents frequently with a vacuum or compressed air. Always wear safety goggles when cleaning tools using compressed air. These materials are highly abrasive and may accelerate the wear on motor bearings and brushes.



## METAL CUTTING

When cutting metal, always clamp the material in place. Be careful to move the saw along slowly. Use lower speeds. Do not twist, bend, or force the blade. If the saw jumps or bounces, use a blade with finer teeth. If the blade is clogged when cutting soft metal, use a blade with coarser teeth.

For easier cutting, lubricate the blade with a stick of cutting wax, if available, or use cutting oil when cutting steel. **Never use gasoline!** Thin metal should be sandwiched between two pieces of wood or tightly clamped onto a single piece of wood (wood on top of the metal). Draw the cut lines or design on the top piece of wood.

## MAINTENANCE

The tool may be cleaned most effectively with compressed dry air. Always wear safety goggles when cleaning tools with compressed air. Before each use:

- Inspect the jigsaw, switch, chuck and baseplate.
- Check for damaged, missing, or worn parts.
- Check for loose screws, misalignment or binding of moving parts, or any other condition that may affect operation.
- If abnormal vibration or noise occurs, turn the tool off immediately, and have the problem corrected before further use.



### WARNING!

- To avoid accidents always disconnect the tool from the power supply before cleaning or performing any maintenance. The tool may be cleaned most effectively with compressed dry air. Always wear safety goggles when cleaning tools with compressed air.
- Do not let brake fluids, gasoline, petroleum-based products, penetrating oil, add comma etc., come into contact with plastic parts. These substances contain chemicals that can damage, weaken, or destroy plastic.
- When servicing, use only identical replacement parts. The use of any other parts may create a hazard or cause damage to the product.
- Use only accessories that are recommended for this tool. Accessories that may be suitable for one tool may become hazardous when used with another tool.
- To ensure safety and reliability, all repairs should be performed by a qualified service technician.
- Maintain tools with care. Keep cutting tools sharp and clean. Properly maintained tools with sharp cutting edges are less likely to bind and are easier to control.

**TROUBLESHOOTING**

PROBLEM	POSSIBLE CAUSES	SOLUTIONS
Blade cannot be removed.	Saw dust in the blade clamp.	Clean the clamp slot with a brush.
The blade dropped from the chuck.	The clamp didn't hold the blade tightly.	Re-attach the blade and check whether it is tightly held before cutting.
Cutting is difficult.	Saw blade is worn.	Replace the saw blade.

If the problem remains unsolved after performing the checks described above, call the toll-free helpline at 1-888-670-6682.

## EXPLODED VIEW

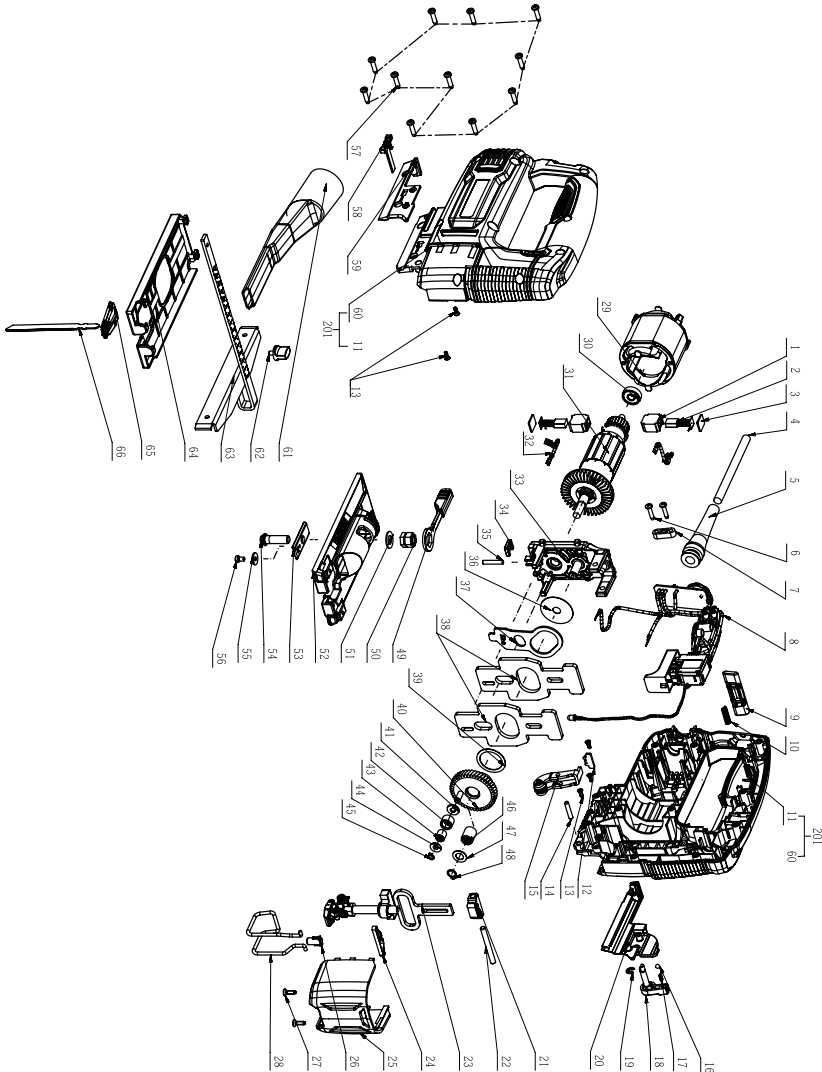

## PARTS LIST

No.	Part No.	Description	No.	Part No.	Description
1	2800015000	Brush Holder	35	3551469000	Pendulum Pin
2	4960015000	Carbon Brush	36	3700184000	Washer D
3	3700491000	Flash Board	37	3700240000	Pendulum Plate
4	4810003000	Power Cord and Plug	38	3706319000	Counterweight
5	3121124000	Cord Guard	39	3700181000	Washer A
6	5610024000	Tapping Screw	40	2825669000	Gear set
7	3120234000	Cord Anchorage	41	5650166000	Washer
8	2830320000	Electric Assembly	42	3550214000	Crank Roller
9	3128968000	Switch Button	43	5700022000	Needle Bearing
10	3660075000	Spring	44	3700159000	Gasket
11	3322214000	Left Housing	45	5660004000	Circlips For Shaft
12	3700211000	Located Block	46	5700029000	Needle Bearing
13	5610079000	Thread Forming Screw	47	3700183000	Washer C
14	3550177000	Guiding Roller Support Pin	48	5660007000	Circlips For Shaft
15	2825282000	Roller Support Set	49	3402888000	Wrench
16	5700045000	Steel Ball	50	5630046000	Nut
17	3660050000	Spring B	51	5650199000	Plain Washer
18	3402899000	Pendulum Lever	52	2825293000	Base Plate Assembly
19	5660003000	E Ring	53	3706600000	Clamp Washer
20	3422022000	Left AI Cover	54	5640213000	Flange Bolt
21	5700354000	Upper Sliding Bearing	55	5650602000	Plain Washer
22	5670348000	Located Pin	56	5620183000	Screw
23	2825278000	Quick Clamp Assembly	57	5610290000	Tapping Screw
24	3705624000	Spring Piece	58	3128963000	Blow Switch
25	3422009000	AI Cover	59	3422021000	Right AI Cover
26	3123507000	Transparent Cap	60	3322213000	Right Housing
27	5610082000	Tapping Screw	61	3129033000	Vacuum Adaptor

No.	Part No.	Description	No.	Part No.	Description
28	3650197000	Wire Guard	62	3400175000	Knob
29	2740103000	Stator	63	3700675000	Rip Fence
30	5700004000	Ball Bearing	64	3128916000	Protecting Cover
31	2750835000	Rotor	65	3126718000	Anti-splinter Insert
32	4860513000	Internal Wire Assembly	66	3810006000	Jigsaw Blade
33	2825279000	Bearing Support Assembly	201	3900026000	L R Housing Set
34	3520062000	Limiting Piece			

If any parts are missing or damaged, or if you have any questions, please call the toll-free helpline at 1-888-670-6682.

**5-YEAR LIMITED WARRANTY**

This MAXIMUM product is guaranteed for a period of 5 years from the date of original retail purchase against defects in workmanship and materials only and is subject to the following components:

- a) Component A: The carrying case is guaranteed for a period of 1-year from the date of original retail purchase against defects in workmanship and materials.
- b) Component B: Accessories, including drill bits and saw blades, do not carry a warranty.

Subject to the conditions and limitations described below, this product, if returned to us with proof of purchase within the stated warranty period and if covered under this warranty, will be repaired or replaced (with the same model, or one of equal value or specification), at the sole discretion of the Maximum Canada authorised repair centre ("Service Provider"). We will bear the cost of any repair or replacement and any costs of labour relating thereto.

**These warranties are subject to the following conditions and limitations:\***

- a) a bill of sale verifying the purchase and purchase date must be provided;
- b) defects in workmanship and material to be assessed and determined by the Service Provider;
- c) this warranty will not apply to any product or part thereof which is worn or broken or which has become inoperative due to abuse, misuse, accidental damage, neglect or lack of proper installation, operation or maintenance (as outlined in the applicable owner's manual or operating instructions);
- d) this warranty does not apply to normal wear and tear or to expendable parts or accessories (including drill bits and saw blades) that may be supplied with the product that by their nature have a limited life span and are expected to become inoperative or unusable after a reasonable period of use;
- e) this warranty will not apply to routine maintenance and consumable items such as, but not limited to, fuel, lubricants, vacuum bags, blades, belts, sandpaper, bits, fluids, rubber o-rings, tune-ups or adjustments;
- f) this warranty excludes the following components that may accompany your product:
  - (1) the carrying case, which is only for a period of 1-year from the date of original retail purchase against defects in workmanship and materials.
  - (2) accessories, including drill bits and saw blades, which do not carry a warranty of any kind.
- g) this warranty will not apply where damage is caused by repairs made or attempted by others (i.e. persons not authorised by the manufacturer), and any such unauthorised repairs or attempted repairs shall void this warranty in its entirety;

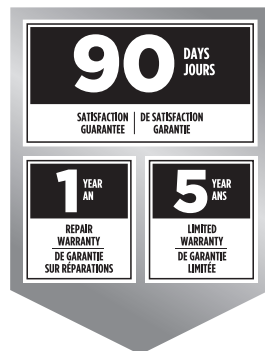

- h) this warranty will not apply to any parts other than original parts, except to the extent that the retailer or manufacturer or persons authorised by either of them have repaired or replaced them;
- i) this warranty will not apply to any product that was sold to the original purchaser as a reconditioned or refurbished product (unless otherwise specified in writing);
- j) this warranty will not apply to any product or part thereof if any part from another manufacturer is installed therein or any repairs or alterations have been made or attempted by unauthorised persons;
- k) this warranty will not apply to normal deterioration of the exterior finish, such as, but not limited to, scratches, dents, paint chips, or to any corrosion or discolouring by heat, abrasive and chemical cleaners;
- l) this warranty will not apply to component parts sold by and identified as the product of another company, which shall be covered under that product manufacturer's warranty, if any;
- m) any products replaced by the retailer in attempt to fulfill warranty obligations is subject to the original product warranty conditions and related time period as initiated by the original date of purchase; if product is purchased in Quebec, the warranty term will be extended for a period equal to the time during which the Quebec retailer possesses the product in attempt to fulfill warranty obligations; replaced product will not default to new product warranty conditions; and
- n) the retailer and manufacturer's sole obligation and the purchaser's sole remedy under this warranty shall be as set out herein. The warranties contained herein are not transferable and are given only to the purchaser. FURTHER, THE WARRANTIES SET OUT HEREIN ARE IN LIEU OF ALL OTHER WARRANTIES OR CONDITIONS, WHETHER EXPRESS, IMPLIED OR STATUTORY (INCLUDING SUCH AS ARISE UNDER THE SALE OF GOODS ACT OR THE INTERNATIONAL SALE OF GOODS ACT), ARISING OUT OF A COURSE OF DEALING OR USAGE OF TRADE OR OTHERWISE, INCLUDING, SUBJECT TO APPLICABLE LAW, ANY IMPLIED WARRANTIES OR CONDITIONS OF MERCHANTABILITY, MERCHANTABILITY QUALITY, FITNESS OR ADEQUACY FOR A PARTICULAR PURPOSE OR USE, AND ALL OTHER SUCH WARRANTIES ARE EXPRESSLY DISCLAIMED BY THE RETAILER AND MANUFACTURER.

### Additional Limitations

This warranty applies only to the original purchaser and may not be transferred.

This warranty applies for a period of 5 years from the date of original retail purchase, as indicated on the bill of sale.

Neither the retailer, Maximum Canada, nor the manufacturer shall be liable for any other expense, loss or damage, including, without limitation, any indirect, incidental, consequential or exemplary damages arising in connection with the sale, use or inability to use this product.

Under no circumstances shall the retailer, Maximum Canada, or manufacturer be liable to the purchaser for any claim for (a) indirect, special, punitive, incidental, exemplary, or consequential damages, (b) compensation for loss of profits, anticipated revenue, savings or goodwill, or other economic loss of the purchaser, (c) exemplary, aggravated or punitive damages howsoever incurred, (d) contribution or set-off in respect of any claims against the purchaser, (e) any damages whatsoever relating to third party products or services or the purchaser's materials, or (f) any damages whatsoever relating to interruption, delays, errors or omissions; in each case under any theory of law or equity, arising out of or in any way related to this warranty, even if advised of the possibility thereof. Notwithstanding any provision herein or entitlement of the purchaser at law, in equity or otherwise, in no event shall the liability of the retailer or manufacturer under this warranty, whether in contract, tort, product liability or otherwise, exceed, in the aggregate, the amount paid by the purchaser to the retailer for the product to which this warranty applies.

#### **\*Notice to Consumer**

This warranty gives you specific legal rights, and you may have other rights, which may vary from province to province. The provisions contained in this warranty are not intended to limit, modify, take away from, disclaim or exclude any statutory warranties set forth in any applicable provincial or federal legislation.

In addition to the 5-Year Limited Warranty, this MAXIMUM product is covered by our:

#### **1-Year Repair Warranty**

Maximum Canada will maintain this product and replace critical parts which have worn beyond reasonable use through normal use of such product, any time during the first year after purchase.

The following are excluded from this 1-Year Repair Warranty:

- a) missing or damaged parts or components that are a result of abuse or misuse; and
- b) any wear and tear to non-critical parts or accessories that do not affect the core function of the product.

#### **90-Day Satisfaction Guarantee**

If you are not completely satisfied with the performance of your MAXIMUM product for any reason, you can return it within 90 days from the date of purchase with proof of purchase for exchange or a full refund.

Made in China

Imported by

Maximum Canada Toronto, Canada M4S 2B8