

# MAXIMUM<sup>®</sup>

## 22 L (6 U.S. Gallons)

### Wet/Dry Vacuum



**Model no. 054-0378-4**  
Rev.01

#### **IMPORTANT:**

Please read this manual carefully before using this product, and save it for reference.

## **INSTRUCTION MANUAL**



<b>TABLE OF CONTENTS</b>	<b>PAGE</b>
TECHNICAL SPECIFICATIONS	4
SAFETY GUIDELINES	5
SYMBOLS	8
KEY PARTS DIAGRAM	9
GENERAL ASSEMBLY INSTRUCTIONS	10
DRY VACUUM OPERATION	13
WET VACUUM OPERATION	16
BLOWER OPERATION	18
MAINTENANCE	20
CARTRIDGE FILTER	22
FOAM WET FILTER	24
TROUBLESHOOTING	25
ACCESSORIES	26
EXPLODED VIEW	27
PARTS LIST	28
WARRANTY	29

**NOTE:** If any parts are missing or damaged, or if you have any questions, please call our toll-free helpline at 1-888-670-6682.



### **SAVE THESE INSTRUCTIONS**

This manual contains important safety and operating instructions. Read all instructions and follow them when using the product.

**SPECIFICATIONS**

Tank size*	22 L (6 U.S. gallons / 5 Imperial gallons)
Peak horsepower†	4
Power	120 V, 60 Hz, 8 A
Tank	Polypropylene
Hose	4.8 cm (1 7/8") diameter x 2.1 m (7') length
Water lift ‡	167.6 cm (66") at end of hose
Airflow ‡	85 CFM at end of hose
Noise	78 dBA
Filters	Standard Cartridge Filter, Foam Sleeve / Wet Filter
Weight	6.45 kg (14 lb 4 oz)

\* Tank Size refers to the actual tank volume, and does not reflect capacity available during operation.

† Peak Horsepower is a term used in the wet/dry vac industry for consumer comparison purposes. It does not denote the operational horsepower output of a wet/dry vac, but rather the horsepower output of a motor, including the motor's inertial contribution, achieved in laboratory testing. In actual use, motors do not operate at the peak horsepower shown.

‡ Water Lift and Airflow tested to ASTM standard at the end of included hose.



## IMPORTANT SAFETY INSTRUCTIONS

### READ AND UNDERSTAND ALL INSTRUCTIONS BEFORE USING THIS VACUUM.

Read and understand this operator's manual and all labels on the vacuum cleaner before operating. Safety is a combination of common sense, staying alert and knowing how your vacuum works. Use this vacuum only as described in this manual. To reduce the risk of personal injury or damage to your vacuum, use only manufacturer recommended accessories.

### SAVE THIS MANUAL FOR FUTURE REFERENCE.

When using a vacuum, basic precautions should always be followed including the following. Failure to follow the warnings and instructions may result in explosion, fire, and/or serious injury.

#### **WARNING!** To reduce the risk of fire, electric shock or injury:

- Do not run the vacuum unattended.
- Do not use to pick up flammable or combustible liquids, such as gasoline, or use in areas where they may be present.
- Do not vacuum or use this vacuum near flammable liquids, gases, or explosive vapours like gasoline or other fuels, lighter fluids, cleaners, oil-based paints, natural gas, hydrogen, or explosive dust like coal dust, magnesium dust, grain dust, or gun powder. Sparks inside the motor can ignite flammable vapours or dust.
- To reduce the risk of health hazards from vapours or dusts, do not vacuum toxic materials.
- Do not store near hazardous materials.
- Do not pick up anything that is burning or smoking, such as cigarettes, matches, or hot ashes.
- Do not expose to rain. Store indoors.
- If vacuum is not working as it should, has been dropped, damaged, left outdoors, or dropped into water, return it to a service centre.
- Do not unplug by pulling on cord. To unplug, grasp the plug, not the cord.
- Do not use the vacuum with damaged cord or plug.

#### **CAUTION!**

To reduce the risk of injury from moving parts, unplug before servicing.

#### **WARNING!**

To reduce the risk of electric shock, unplug before cleaning or servicing.

- Do not pull or carry by cord, use cord as a handle, close a door on cord, or pull cord around sharp edges or corners.
- Keep cord away from heated surfaces.
- Do not run the vacuum over cord.
- Do not handle plug or vacuum with wet hands.
- Do not use without dust bag and/or filters in place.
- Do not allow vacuum to be used as a toy. Close attention is necessary when used near children.
- To reduce the risk of injury from accidental starting, unplug the power cord before changing or cleaning filter.
- Do not leave vacuum when plugged in. Unplug from outlet when not in use and before servicing.
- Turn off all controls before unplugging.
- Unplug before connecting or disconnecting hose or any other accessories.
- Do not put any object into openings. Do not use with any opening blocked; keep free of dust, lint, hair, and anything that may reduce airflow.
- Keep hair, loose clothing, fingers, and all parts of body away from openings and moving parts.
- Use extra care when cleaning on stairs.
- Use only as described in this manual. Use only manufacturer's recommended attachments.
- This vacuum is provided with double insulation. Use only identical replacement parts. See DOUBLE INSULATION INSTRUCTIONS.

When using as blower:

- Direct air discharge only at work area.
- Do not use wet/dry vacuum as a sprayer.
- Do not direct air at bystanders.
- Keep children away when blowing.
- Wear safety goggles.

SAVE THESE INSTRUCTIONS

For household use only.

 **DOUBLE INSULATED - GROUNDING NOT REQUIRED - WHEN SERVICING USE ONLY IDENTICAL REPLACEMENT PARTS.**



## WARNING!

TO REDUCE THE RISK OF ELECTRIC SHOCK, DO NOT EXPOSE TO RAIN. STORE INDOORS.

## DOUBLE INSULATION INSTRUCTIONS

This wet/dry vacuum is double-insulated, eliminating the need for a separate grounding system. Use only identical replacements parts. Read the instructions for Servicing of Double-Insulated Wet/Dry Vacuums before servicing. Use this vacuum as described in this manual. Observe the following warnings that appear on the motor housing of your vacuum.

### **WARNING!**

#### SERVICING OF DOUBLE-INSULATED WET/DRY VACUUMS

WITH A DOUBLE-INSULATED WET/DRY VACUUM, TWO SYSTEMS OF INSULATION ARE PROVIDED INSTEAD OF GROUNDING. NO GROUNDING MEANS IS PROVIDED ON A DOUBLE-INSULATED APPLIANCE, NOR SHOULD A MEANS FOR GROUNDING BE ADDED. SERVICING A DOUBLE INSULATED WET/DRY VACUUM REQUIRES EXTREME CARE AND KNOWLEDGE OF THE SYSTEM, AND SHOULD BE DONE ONLY BY QUALIFIED SERVICE PERSONNEL. REPLACEMENT PARTS FOR A DOUBLE-INSULATED WET/DRY VACUUM MUST BE IDENTICAL TO THE PARTS THEY REPLACE. YOUR DOUBLE-INSULATED WET/DRY VAC IS MARKED WITH THE WORDS 'DOUBLE INSULATED' AND THE SYMBOL  (SQUARE WITHIN A SQUARE) MAY ALSO BE MARKED ON THE APPLIANCE.

#### EXTENSION CORDS



When using an extension cord with your wet/dry vacuum, refer to the following table to determine the required A.W.G. wire size. Before using the vacuum, make sure the power cord and extension cord are in good working condition. Make repairs or replacements before using the vacuum cleaner. Only use extension cords that are rated for outdoor use.

		Length of Extension Cord			
120V		7.6 m (25')	15.2 m (50')	30.5 m (150')	45.7 m (150')
Ampere rating		A.W.G. Wire Size			
More than	Not more than				
0	6	18	1c	16	14
6	10	18	16	14	12
10	12	16	16	14	12
12	16	14	12	Not recommended	

### **WARNING!**

FOR YOUR OWN SAFETY, READ AND UNDERSTAND THE OPERATOR'S MANUAL. DO NOT RUN UNATTENDED. DO NOT PICK UP HOT ASHES, COALS, TOXIC, OR FLAMMABLE MATERIALS. DO NOT USE AROUND EXPLOSIVE LIQUIDS OR VAPOURS.

The following signal words and meanings are intended to explain the levels of risk associated with this product.

SYMBOL	SIGNAL	MEANING
	<b>DANGER</b>	Indicates an imminently hazardous situation, which, if not avoided, will result in death or serious injury.
	<b>WARNING</b>	Indicates a potentially hazardous situation, which, if not avoided, could result in death or serious injury.
	<b>CAUTION</b>	Indicates a potentially hazardous situation, which, if not avoided, may result in minor or moderate injury.
	<b>NOTICE</b>	(Without Safety Alert Symbol) Indicates a situation that may result in property damage.

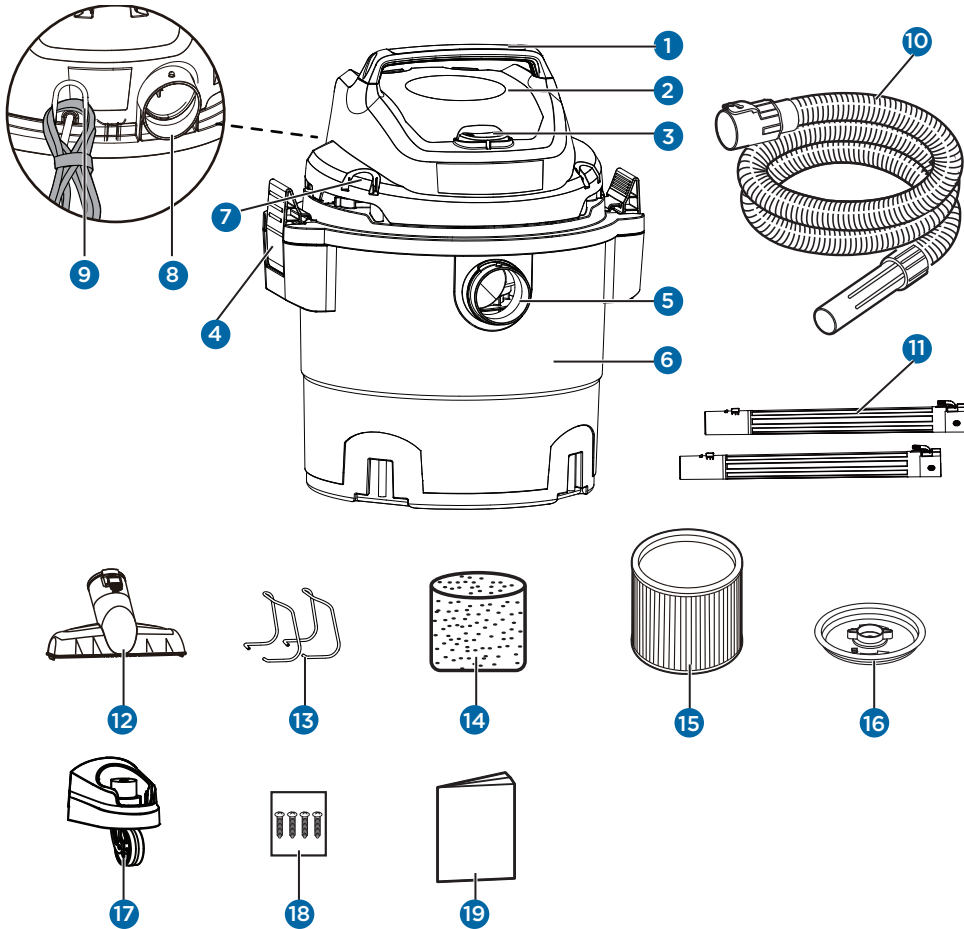

No.	Description	No.	Description
1	Handle	11	Locking Extension Wand x2
2	Powerhead	12	Locking Utility Nozzle
3	On/Off Switch	13	Hose Storage Rack x2
4	Latch x2	14	Foam Sleeve/Wet Filter
5	Vacuum Port	15	Cartridge Filter
6	Collection Tank	16	Filter Retainer
7	Accessory Storage	17	Castor Foot Assembly x4
8	Blower Port	18	Castor Assembly Screw x4
9	Power Cord Hook	19	Operator's Manual
10	Hose		

UNPACKING YOUR WET/DRY VACUUM AND GENERAL ASSEMBLY

A cross-head screwdriver is required. 

- 1 Verify that the power cord is disconnected from the outlet.

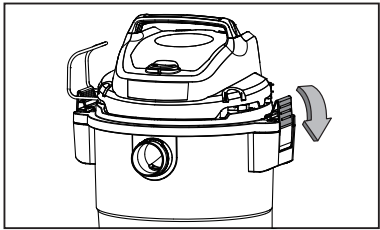
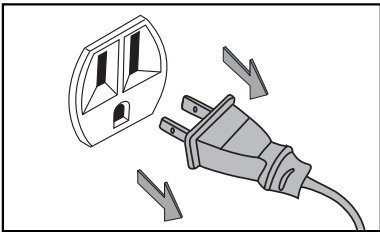

- 2 Undo the latches.

- 3 Lift the powerhead off the collection tank.

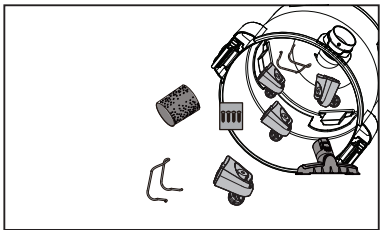
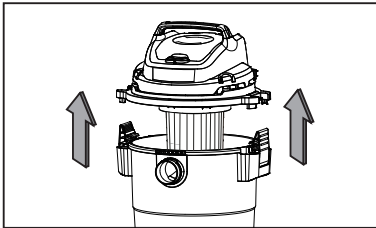

- 4 Remove the contents from inside the collection tank; make sure you have all contents as listed on page 9.



**WARNING!**

Do not plug the power cord into a power outlet. Make sure the plug is disconnected before assembling the wet/dry vacuum. To reduce the risk of electric shock, do not expose to rain.

- 5 Turn the collection tank on its side and insert the four castor feet into the slots on the collection tank and tighten with supplied screws. Verify that the castor feet are mounted correctly. Do not over-tighten screws.

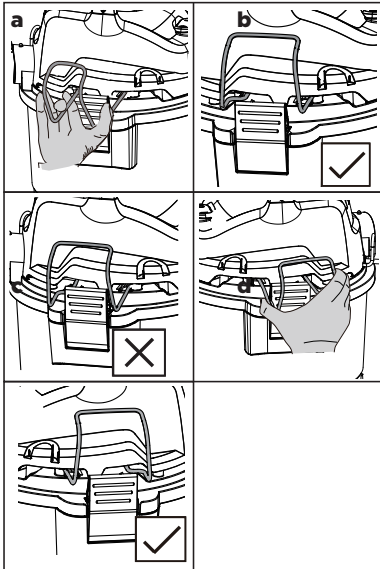
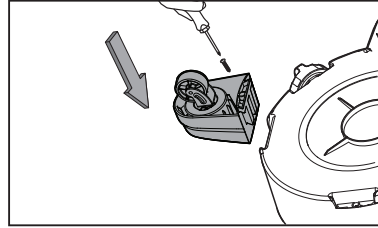

- 6 Position the left hose storage rack on the front side of the powerhead, just above the top edge of the tank, as illustrated. Squeeze the open sides of the left hose storage rack inward and insert the open ends into the allocated slot. Verify that the rack is secured in place. Install the right hose storage rack in the same way on the other side of the powerhead, ensuring it is secured.

**NOTE:** Hose storage rack may come pre-installed on some models.

- 7 Your vacuum comes ready for dry vacuum cleaning. If the cartridge filter is not installed, refer to page 22 for installation instructions.

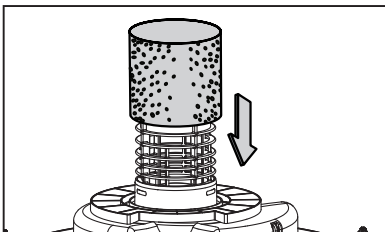
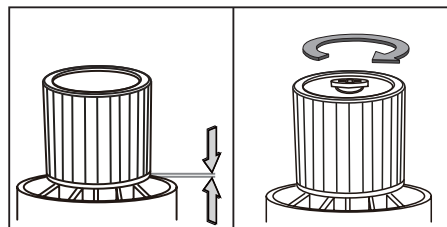

- 8 For wet vacuum cleaning, remove the cartridge filter, and install the supplied foam wet filter. See page 24 for the foam wet filter installation instructions.

- 9 Place the powerhead back on the collection tank and secure into place using the latches.

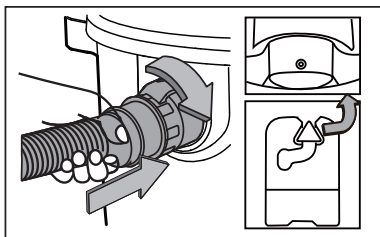
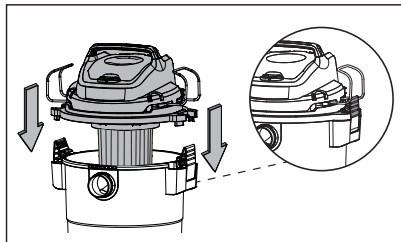

- 10 Insert the locking end of the hose into the port on the collection tank and turn to lock into place.

- 11 The included accessories lock together to prevent them from detaching during use. Connect the desired accessory onto the end of the hose or extension wand by aligning the tabs and push together until they lock into place. To remove the accessory, press down on the locking tab and slide it off.

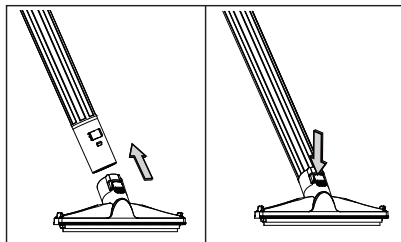

### POLARIZED PLUG

To reduce the risk of electric shock, this appliance has a polarized plug (one blade wider than the other). This plug will fit in a polarized outlet only one way. If the plug does not fit fully in the outlet, reverse the plug. If it still does not fit, contact a qualified electrician to install the proper outlet. Do not change the plug in any way. Double insulation ☐ eliminates the need for the three-wire grounded power cord and grounded power supply system.



## DRY VACUUM OPERATION

- 1 Verify that the power cord is disconnected from the outlet.

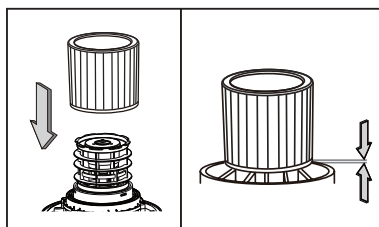
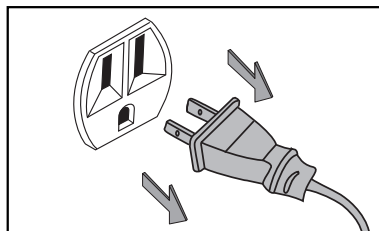

- 2 In order to prepare your vacuum for dry vacuuming, make sure the cartridge filter completely covers the filter cage against the powerhead. For installation instructions, see page 23.



### WARNING!

Be sure to read, understand, and apply information entitled "Safety Guidelines". Do not vacuum in areas with flammable gases, vapours, or explosive dust in the air. Flammable gases or vapours include but are not limited to: lighter fluid, solvent type cleaners, oil-based paints, gasoline, alcohol, or aerosol sprays. Explosive dusts include but are not limited to: coal, magnesium, grain, or gun powder. To reduce the risk of health hazards from vapours or dust, do not vacuum toxic materials.



### WARNING!

Do not plug the power cord into a power outlet. Make sure the plug is disconnected before changing the filters.



### CAUTION!

Do not vacuum drywall dust, fireplace soot, or ash with standard wet/dry filter. This is a very fine dust which will not be captured by the filter and may cause damage to the motor. When vacuuming fine dust use a fine dust filter (sold separately).

- 3 Place the filter retainer on the top of the cartridge filter and tighten down by turning the retainer handle clockwise.

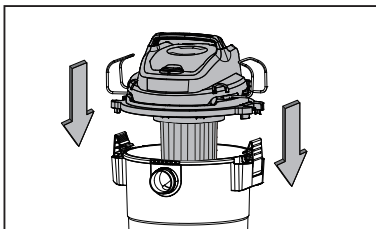
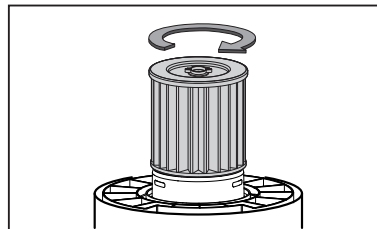

- 4 Place the powerhead back on the collection tank and secure it in place using the latches.

- 5 Insert the locking end of the hose into the vacuum port on the collection tank and turn clockwise to lock into place.

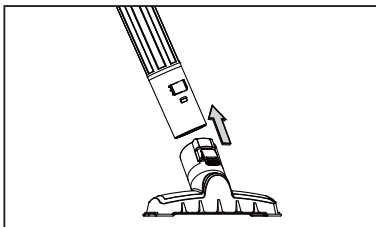
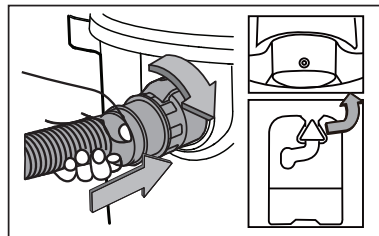

- 6 The included accessories lock together to prevent them from detaching during use. Connect the desired accessory onto the end of the hose or extension wand by aligning the tabs and push together until they lock into place.

- 7 Verify that the switch is in the 'O' OFF position before plugging the power cord into the power outlet. Plug the power cord into the outlet.

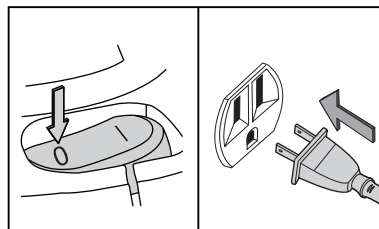

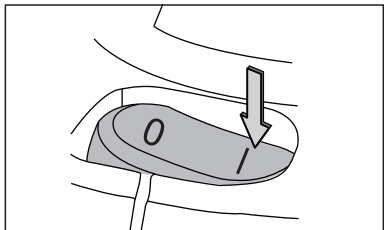

- 8 Turn the vacuum on by flipping the switch to the 'I' ON position and begin vacuuming.

- 9 Once you have finished vacuuming, flip the switch to the "O" position and unplug the power cord from the power outlet.

O = OFF    I = ON

**DO NOT USE THE CARTRIDGE FILTER FOR LIQUID VACUUMING.**

**WET VACUUM OPERATION**

- 1 Verify that the power cord is disconnected from the outlet. Make sure that the collection tank is clean and free of dust and dirt.

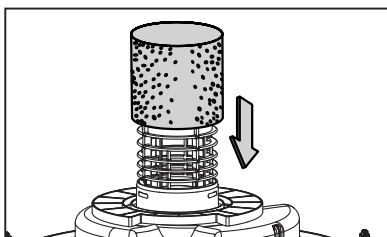
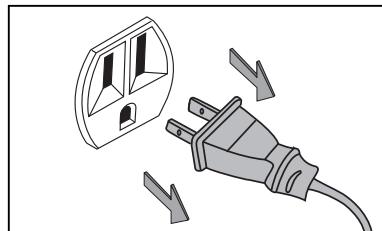

- 2 Remove the cartridge filter, then carefully install the foam wet filter over the filter cage and place the powerhead back on the collection tank. For foam wet filter installation instructions, see page 24.

**DO NOT USE THE CARTRIDGE FILTER FOR LIQUID VACUUMING.**

- 3 The included accessories lock together to prevent them from detaching during use. Connect the desired accessory onto the end of the hose or extension wand by aligning the tabs and push together until they lock into place.

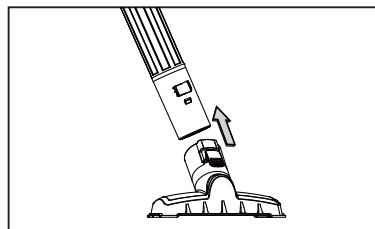
**WARNING!**

Be sure to read, understand, and apply information entitled "Safety Guidelines". Do not vacuum in areas with flammable gases, vapours, or explosive dust in the air. Flammable gases or vapours include but are not limited to: lighter fluid, solvent type cleaners, oil-based paints, gasoline, alcohol, or aerosol sprays. Explosive dusts include but are not limited to: coal, magnesium, grain, or gun powder. To reduce the risk of health hazards from vapours or dust, do not vacuum toxic materials.

**WARNING!**

Do not plug the power cord into a power outlet. Make sure the plug is disconnected before changing the filters.

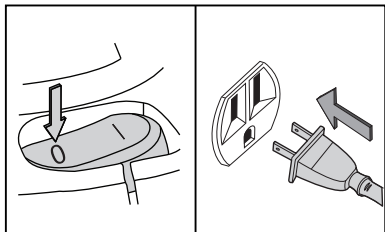

- 4 Verify that the switch is in the 'O' OFF position before plugging the power cord into the power outlet. Plug the power cord into the outlet.

- 5 Turn the vacuum on by flipping the switch to the 'I' ON position and begin vacuuming.

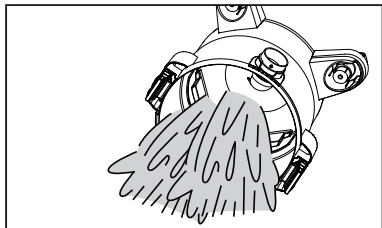
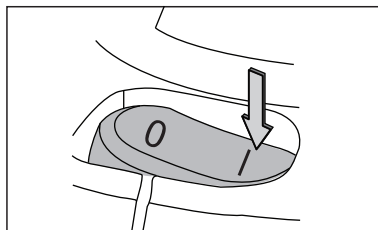

- 6 Once you have completed vacuuming, flip the switch to the 'O' OFF position and unplug the power cord from the outlet. After use, empty the collection tank, clean and dry the inside and outside of the collection tank.

## IMPORTANT!

When vacuuming large quantities of liquids, do not immerse the nozzle completely in the liquid; leave a gap at the tip of the nozzle opening to allow air inflow. The machine is fitted with a float valve that stops the suction action when the collection tank reaches its maximum capacity. You will notice an increase in motor speed. When this happens, turn off the machine, disconnect from power supply, and drain the liquid into a suitable receptacle or drain. To continue vacuuming, refit the powerhead to the collection tank. After wet vacuuming, turn the machine off and remove plug from the power supply. Empty the collection tank, clean and dry the inside and outside before storage.

## REMEMBER!

The foam wet filter must be removed after wet vacuuming and the cartridge filter must be installed before dry vacuuming again.

## BLOWER OPERATION

This wet/dry vacuum has blowing capabilities. To use the blower feature, follow the instructions listed below.

- 1 Verify that the power cord is disconnected from the outlet.

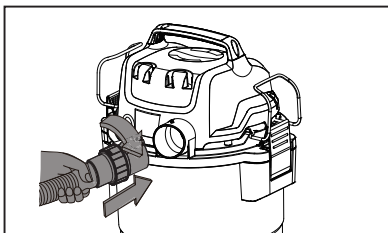
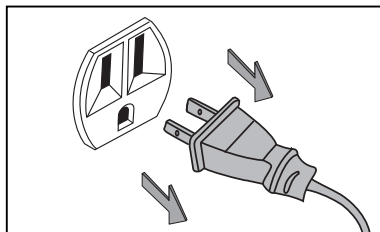

- 2 Make sure the collection tank is empty before using it as a blower. Clear all dirt and debris from the hose and collection tank. Remove the hose from the vacuum port. Insert the locking end of the hose into the blower port on the back of the powerhead and lock it into place.

- 3 The included accessories lock together to prevent them from detaching during use. Connect the desired accessory onto the end of the hose or extension wand by aligning the tabs and push together until they lock into place.

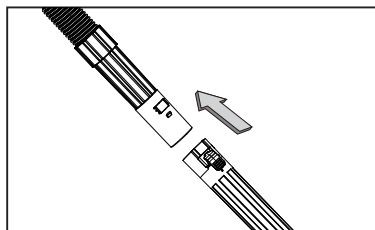

### WARNING!

Keep bystanders clear from blowing debris. Wear a dust mask and safety goggles if blowing creates dust that might be inhaled.

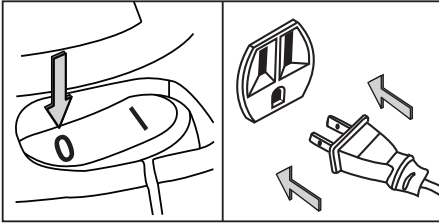

- 4 Verify that the switch is in the 'O' OFF position before plugging the power cord into the power outlet. Plug the power cord into the outlet.

- 5 Before turning on the vacuum, firmly hold the loose end of the hose. Turn the vacuum on by flipping the switch to the 'I' ON position.

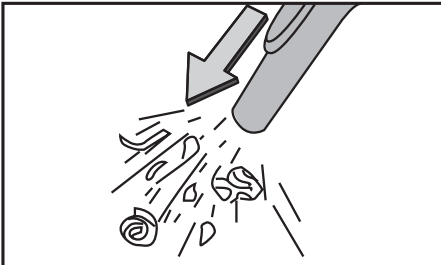
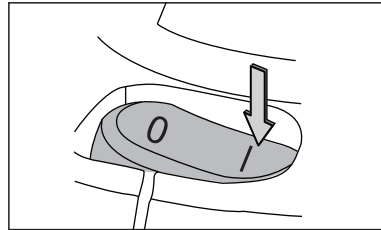

- 6 The unit will now blow through the vacuum hose and can be used to clear obstructions within the hose.

- 7 Once you have completed blowing, flip the on/off switch to the 'O' OFF position and unplug the power cord from the outlet.

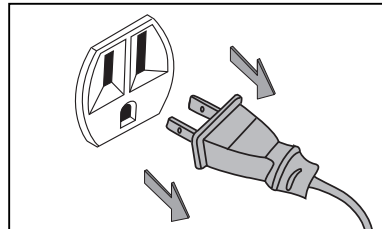

### WARNING!

If after a few seconds the hose continues to be blocked, turn off the unit and clear the hose manually.

## EMPTYING THE COLLECTION TANK

- 1 Verify that the power cord is disconnected from the outlet.

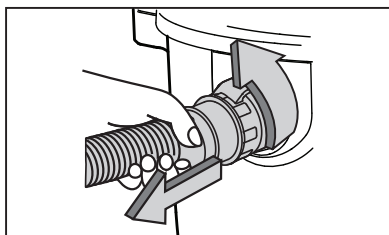
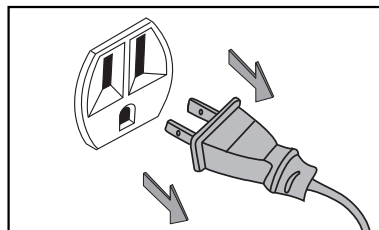

- 2 Disconnect the hose from the vacuum.

- 3 Undo the latches and remove the powerhead from the collection tank. Place powerhead on a soft, clean surface upside down.

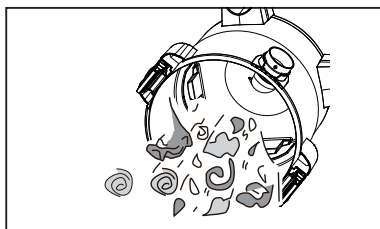
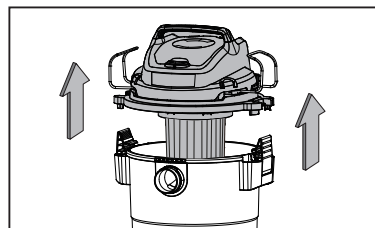

- 4 Clear all dirt or debris from the collection tank and hose into a proper waste container.



### WARNING!

Always disconnect the plug from a power outlet before removing the power head from collection tank.



- 5 Clean or replace the filters.
- 6 Check the hose, accessories, and power cord to ensure that they have not been damaged.
- 7 Place the powerhead back onto the collection tank and secure latches.

## STORAGE

Before storing your vacuum, the collection tank should be emptied and cleaned. The accessories should be cleaned and stored so they can be readily available when needed. Store the wet/dry vacuum indoors.

## REPAIRS

Repairs for this wet/dry vacuum should be performed only by qualified service personnel using only identical replacement parts.

## IMPORTANT!

Clean or change the filter regularly for the best performance. **ALWAYS USE THE CARTRIDGE FILTER FOR DRY VACUUMING.** If the machine is used without the cartridge filter, the motor will burn out and the warranty will be void. Always keep spare filters on hand.

**NOTICE!** The filters included are made of high-quality materials designed to stop small dust particles. The cartridge filter should be used for dry pick-up only. A dry cartridge filter is necessary to pick up dust. If the cartridge filter is wet, it will clog quickly and be very difficult to clean. Handle the filter carefully when removing it for cleaning and replacing it. Check the filters for tears or small holes. A small hole can let dust pass through and out of the filter. Do not use a filter with holes or tears; replace it immediately.

## INSTALLING CARTRIDGE FILTER

- 1 Verify that the power cord is disconnected from the outlet.

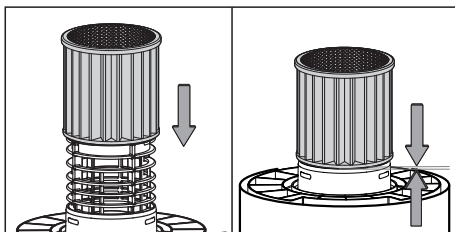
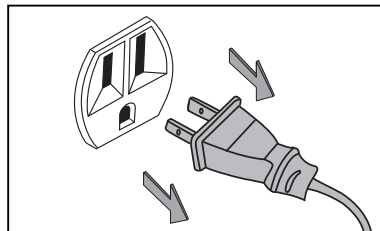

- 2 Remove the powerhead and place in an upside-down position. Install the cartridge filter over the filter cage making sure the cage is completely covered.

- 3 Place the filter retainer on the top of the cartridge filter over the raised lip and tighten down by turning the retainer clockwise; do not over-tighten.

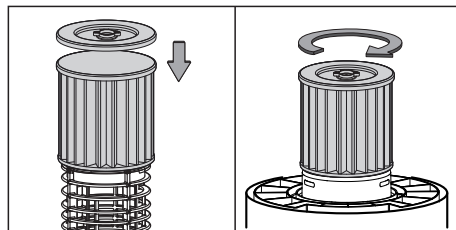

- 4 Place the powerhead back onto the collection tank.

## REMOVING AND CLEANING CARTRIDGE FILTER

- 1 Unlock and remove the filter retainer by turning the retainer handle counter-clockwise.

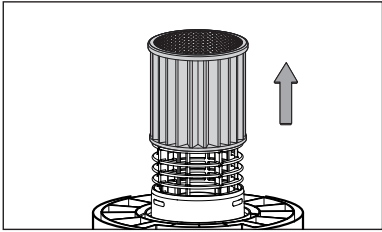
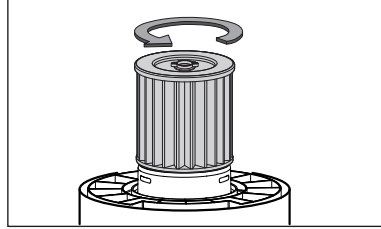

- 2 With the removed powerhead in an upside-down position, carefully remove the cartridge filter from the filter cage.

- 3 Clean the cartridge filter by gently tapping or brushing dirt off. Cleaning should not be done indoors in living areas. For optimal performance, a new filter is recommended.

- 4 Install the cleaned or new filters as above in steps 2-4 of Installing Cartridge Filter.

## INSTALLING FOAM WET FILTER

- 1 Verify that the power cord is disconnected from the outlet.

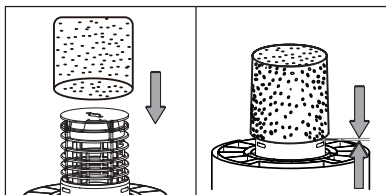
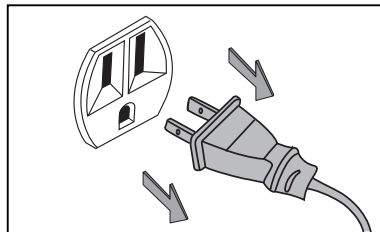

- 2 Remove the powerhead and place in an upside-down position. Follow instructions to remove the cartridge filter on page 23. Carefully slide the foam wet filter down over the filter cage making sure the cage is completely covered

- 3 Place the powerhead onto the collection tank.

## REMOVING AND CLEANING FOAM WET FILTER

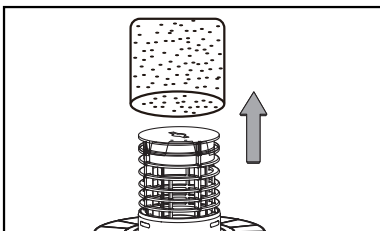

- 1 With the removed powerhead in an upside-down position, carefully remove the foam wet filter.

- 2 Use a mild soap and water solution to wash the foam wet filter and rinse with clean water.

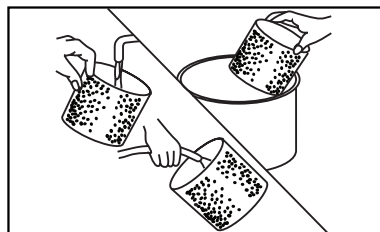

- 3 Allow the wet filter to air dry completely before storing or installing onto the filter cage.

Problem	Possible Causes	Solution
The wet/dry vacuum will not operate.	No power supply.	Check the power supply, cord, breakers, and fuses.
	Faulty power cord.	Unplug and check the power cord. If damaged, have it repaired by a professional.
	Collection tank is full.	Empty the collection tank.
	Switch in the wrong position.	Press the ON 'I' button on the powerhead.
Motor cover emits dust.	The cartridge filter is missing or damaged.	Attach or replace the cartridge filter.
	Vacuum has been used to collect fine dust, such as dry wall dust, fireplace soot, or ash, without a fine dust filter.	Remove the standard cartridge filter and install the appropriate fine dust filter (available separately).
Reduced efficiency and motor/speed vibration.	There are blockages in the nozzle, hose, or the collection tank inlets.	Unplug and check nozzle, hose and collection tank inlets for blockages.
	The cartridge filter is clogged by fine dust.	Take off the filter and clean it or install a new cartridge filter.

**WARNING!**

To reduce the risk of electric shock, unplug before troubleshooting.

Additional accessories for your MAXIMUM® Wet/Dry Vacuum are available.

#### Consumables

054-0148-2	Dry Reusable Filter
054-0035-0	Foam Sleeve / Wet Filter
054-0212-8	Fine Dust High-Efficiency Collector Bag
054-0255-6	Fine Dust Cartridge Filter

#### 1 7/8" (4.8 cm) Accessories

054-0270-8	Utility Nozzle
054-0271-6	Floor Squeegee Nozzle
054-0273-2	Dust Brush
054-0274-0	Crevice Tool
054-0275-8	Extension Wand
	Locking Utility Nozzle
	Locking Floor Brush/Squeegee Nozzle
	Locking Crevice Tool
	Locking Extension Wand

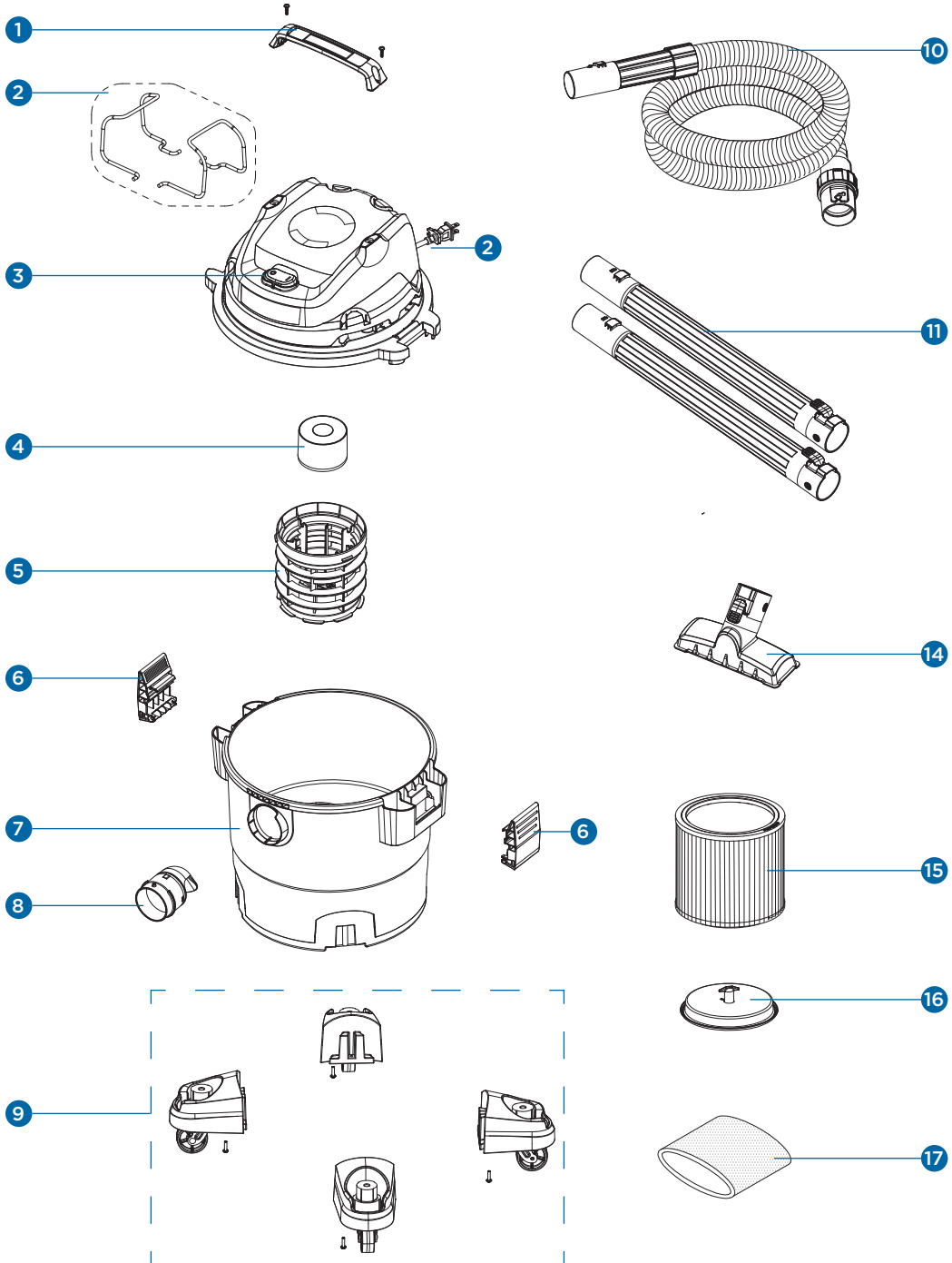

No.	Description
1	Powerhead Assembly
2	Hose Storage Rack x2
3	Switch
4	Float
5	Filter Cage
6	Latch
7	Tank
8	Vacuum Port Assembly
9	Castor Foot Assembly x 4
10	Hose
11	Locking Extension Wand x2
12	Hose
13	Extension Wand x 2
14	Locking Utility Nozzle
15	Cartridge Filter
16	Filter Retainer
17	Foam Sleeve/Wet Filter

If any parts are missing or damaged, or if you have any questions, please call the toll-free helpline at 1-888-670-6682.



### 3-Year Limited Warranty

This MAXIMUM product is guaranteed for a period of three (3) years from the date of original retail purchase against defects in workmanship and materials.

Subject to the conditions and limitations described below, this product, if returned to us with proof of purchase within the stated warranty period and if covered under this warranty, will be repaired or replaced (with the same model, or one of equal value or specification), at the sole discretion of the MAXIMUM Canada authorised repair centre ("Service Provider"). We will bear the cost of any repair or replacement and any costs of labour relating thereto.

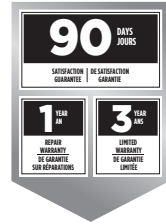

**These warranties are subject to the following conditions and limitations:\***

- a) A bill of sale verifying the purchase and purchase date must be provided;
- b) Defects in workmanship and material to be assessed and determined by the Service Provider;
- c) This warranty will not apply to any product or part thereof which is worn or broken or which has become inoperative due to abuse, misuse, accidental damage, neglect or lack of proper installation, operation or maintenance (as outlined in the applicable owner's manual or operating instructions);
- d) This warranty does not apply to normal wear and tear or to expendable parts or accessories (including hose attachments and filters) that may be supplied with the product that by their nature have a limited life span and are expected to become inoperative or unusable after a reasonable period of use;
- e) This warranty will not apply to routine maintenance and consumable items such as, but not limited to, fuel, lubricants, vacuum bags, blades, belts, sandpaper, bits, fluids, rubber O-rings, tune-ups or adjustments;
- f) This warranty excludes the following components that may accompany your product:
  - (1) The carrying case, which is only warranted for a period of one (1) year from the date of original retail purchase against defects in workmanship and materials.
  - (2) Accessories, including hose attachments and filters, which do not carry a warranty of any kind.
- g) This warranty will not apply where damage is caused by repairs made or attempted by others (i.e., persons not authorized by the manufacturer), and any such unauthorized repairs or attempted repairs shall void this warranty in its entirety;
- h) This warranty will not apply to any parts other than original parts, except to the extent that the retailer or manufacturer or persons authorized by either of them have repaired or replaced them;
- i) This warranty will not apply to any product that was sold to the original purchaser as a reconditioned or refurbished product (unless otherwise specified in writing);
- j) This warranty will not apply to any product or part thereof if any part from another manufacturer is installed therein or any repairs or alterations have been made or attempted by unauthorized persons;
- k) This warranty will not apply to normal deterioration of the exterior finish, such as,

but not limited to, scratches, dents, paint chips, or to any corrosion or discolouring by heat, abrasive and chemical cleaners;

- l) This warranty will not apply to component parts sold by and identified as the product of another company, which shall be covered under that product manufacturer's warranty, if any;
- m) Any product replaced by the retailer in attempt to fulfill warranty obligations is subject to the original product warranty conditions and related time period as initiated by the original date of purchase; if product is purchased in Quebec, the warranty term will be extended for a period equal to the time during which the Quebec retailer possesses the product in an attempt to fulfill warranty obligations; replaced product will not default to new product warranty conditions; and
- n) The retailer and manufacturer's sole obligation and the purchaser's sole remedy under this warranty shall be as set out herein. The warranties contained herein are not transferable and are given only to the purchaser. FURTHER, THE WARRANTIES SET OUT HEREIN ARE IN LIEU OF ALL OTHER WARRANTIES OR CONDITIONS, WHETHER EXPRESS, IMPLIED OR STATUTORY (INCLUDING SUCH AS ARISE UNDER THE SALE OF GOODS ACT OR THE INTERNATIONAL SALE OF GOODS ACT), ARISING OUT OF A COURSE OF DEALING OR USAGE OF TRADE OR OTHERWISE, INCLUDING, SUBJECT TO APPLICABLE LAW, ANY IMPLIED WARRANTIES OR CONDITIONS OF MERCHANTABILITY, MERCHANTABLE QUALITY, FITNESS OR ADEQUACY FOR A PARTICULAR PURPOSE OR USE, AND ALL OTHER SUCH WARRANTIES ARE EXPRESSLY DISCLAIMED BY THE RETAILER AND MANUFACTURER.

### **Additional Limitations**

This warranty applies only to the original purchaser and may not be transferred.

This warranty applies for a period of three (3) years from the date of original retail purchase, as indicated on the bill of sale.

Neither the retailer, MAXIMUM Canada, nor the manufacturer shall be liable for any other expense, loss or damage, including, without limitation, any indirect, incidental, consequential or exemplary damages arising in connection with the sale, use or inability to use this product.

Under no circumstances shall the retailer, MAXIMUM Canada, or manufacturer be liable to the purchaser for any claim for (a) indirect, special, punitive, incidental, exemplary, or consequential damages; (b) compensation for loss of profits, anticipated revenue, savings or goodwill, or other economic loss of the purchaser; (c) exemplary, aggravated or punitive damages howsoever incurred; (d) contribution or set-off in respect of any claims against the purchaser; (e) any damages whatsoever relating to third party products or services or the purchaser's materials; or (f) any damages whatsoever relating to interruption, delays, errors or omissions; in each case under any theory of law or equity, arising out of or in any way related to this warranty, even if advised of the possibility thereof. Notwithstanding any provision herein or entitlement of the purchaser at law, in equity or otherwise, in no event shall the liability of the retailer or manufacturer under this warranty, whether in contract, tort, product liability or otherwise, exceed, in the aggregate, the amount paid by the

purchaser to the retailer for the product to which this warranty applies.

**\*Notice to consumer**

This warranty gives you specific legal rights, and you may have other rights, which may vary from province to province. The provisions contained in this warranty are not intended to limit, modify, take away from, disclaim or exclude any statutory warranties set forth in any applicable provincial or federal legislation.

In addition to the 3-Year Limited Warranty, this MAXIMUM product is covered by our:

**1-Year Repair Warranty**

MAXIMUM Canada will maintain this product and replace critical parts which have worn beyond reasonable expectations through normal use of such product, any time during the first year after purchase.

The following are excluded from this 1-Year Repair Warranty:

- a) Missing or damaged parts or components that are a result of abuse or misuse; and
- b) Any wear and tear to non-critical parts or accessories that do not affect the core function of the product.

**90-Day Satisfaction Guarantee**

If you are not completely satisfied with the performance of your MAXIMUM product for any reason, you can return it within 90 days from the date of purchase with proof of purchase for exchange or a full refund.

Made in China

Imported by

MAXIMUM Canada Toronto, Canada M4S 2B8