

MASTERCRAFT™/MC

**CORDLESS
8" (20 CM) POLE SAW
054-0370-0**

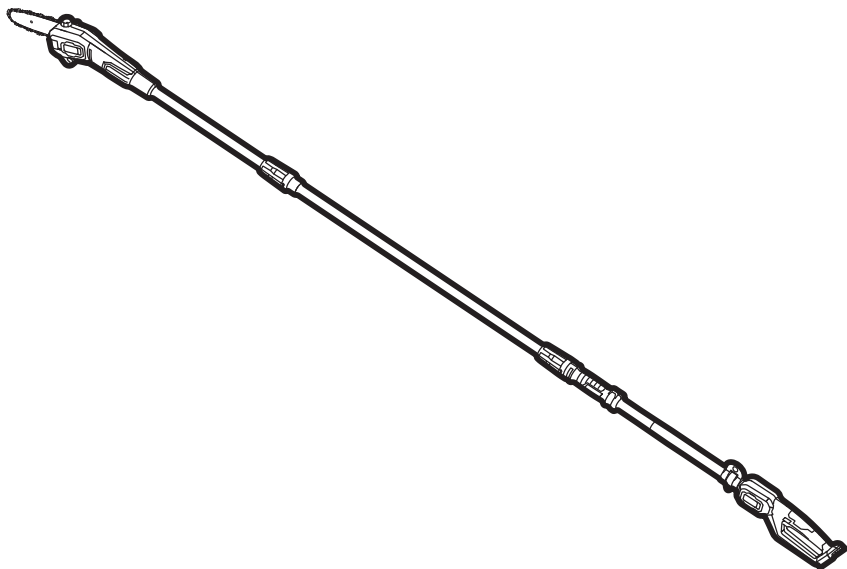

IMPORTANT:

Read and understand this instruction manual thoroughly before using the product.

**INSTRUCTION
MANUAL**

TABLE OF CONTENTS

Technical Specifications	4
Safety Guidelines	5
Key Parts Diagram	9
Operating Instructions	11
Maintenance	18
Troubleshooting	22
Parts List	23
Warranty	26

NOTE:

If any parts are missing or damaged, or if you have any questions, please call our toll-free helpline at 1-800-689-9928.



SAVE THESE INSTRUCTIONS

- This manual contains important safety and operating instructions. Read all instructions and follow them with use of this product.

TECHNICAL SPECIFICATIONS

Rated Voltage	20 V d.c. max*
Guide Bar Length	8" (20 cm)
Chain spec	3/8" (9.5 mm) Low-profile pitch, 0.043" (1.1 mm) Gauge, 33 Drive links

*Maximum battery voltage without workload; with workload nominal voltage is 18 V.

SAFETY GUIDELINES:



WARNING!

Safety symbols in this Instruction Manual are used to flag possible dangers. The safety symbols and their explanations require your full understanding. The safety warnings do not, by themselves, eliminate any danger, nor are they substitutes for proper accident prevention measures.



WARNING!

This Safety Alert Symbol indicates caution, warning, or danger. Failure to obey a safety warning can result in serious injury to yourself or others. To reduce the risk of injury, fire, or electric shock, always follow the safety precautions.

KNOW YOUR TOOL

To operate this tool, carefully read this Instruction Manual and all labels affixed to the pole saw before using. Keep this instruction manual available for future reference.

IMPORTANT

This tool should only be serviced by a qualified service technician. For more information, call the toll-free helpline at 1-800-689-9928.

GENERAL POWER TOOL SAFETY WARNINGS

INSTRUCTIONS PERTAINING TO A RISK OF FIRE, ELECTRIC SHOCK, OR INJURY TO PERSONS



WARNING!

When using electric gardening appliances, basic safety precautions should always be followed to reduce the risk of fire, electric shock, and personal injury.

READ ALL INSTRUCTIONS THOROUGHLY.



WARNING!

Do not operate near electrical power lines. The unit has not been designed to provide protection from electric shock in the event of contact with overhead electric lines. Consult local regulations for safe distances from overhead electric power lines and ensure that the operating position is safe and secure before operating the pole saw.



WARNING!

Wear appropriate personal hearing protection during use. Under some conditions and durations of use, noise from this product may contribute to hearing loss.

- **Avoid dangerous environments.** Don't use appliances in damp or wet locations.
- **Don't use in rain.**

- **Keep children away.** All visitors should be kept at a distance away from work area.
- **Dress properly.** Do not wear loose clothing or jewellery. They can be caught in moving parts. Use of rubber gloves and substantial footwear is recommended when working outdoors. Wear protective hair covering to contain long hair.
- **Use safety glasses.** Always use face or dust mask if operation is dusty.
- **Use right appliance.** Do not use appliance for any job except that for which it is intended.
- **Don't grasp the exposed cutting blades or cutting edges when picking up or holding the appliance.**
- **Don't force appliance.** It will do the job better and with less likelihood of a risk of injury at the rate for which it was designed.
- **Don't overreach.** Keep proper footing and balance at all times.
- **Stay alert.** Watch what you are doing. Use common sense. Do not operate appliance when you are tired.
- **Keep all parts of the body away from the saw chain.** Do not remove cut material or hold material to be cut when blades are moving. Make sure the switch is off when clearing jammed material. Saw chain continues to move after the switch is turned off. A moment of inattention while operating the pole saw may result in serious personal injury.
- **Carry the pole saw by the handle with the saw chain stopped.** When transporting or storing the pole saw, always fit the saw chain device cover. Proper handling of the pole saw will reduce possible personal injury from the saw chain.
- **Hold the pole saw by insulated gripping surfaces only because the saw chain may contact hidden wiring.** A saw chain contacting a "live" wire may make exposed metal parts of the pole saw "live" and could give the operator an electric shock.
- **Do not use the pole saw in bad weather conditions, especially when there is a risk of lightning.** This decreases the risk of being struck by lightning.
- **To reduce the risk of electrocution, never use near any electrical power lines.** Contact with or use near power lines may cause serious injury or electric shock resulting in death.
- **Always use two hands when operating the pole saw.** Hold the pole saw with both hands to avoid loss of control.
- **Always use head protection when operating the pole saw overhead.** Falling debris can result in serious personal injury.
- **Store idle appliances indoors.** When not in use, appliances should be stored indoors in a dry and high or locked-up place with the battery pack removed—out of reach of children.
- **Maintain appliance with care.** Keep cutting edge sharp and clean for best performance and to reduce the risk of injury. Follow instructions for lubricating and changing accessories. Keep handles dry, clean, and free from oil and grease.

- **Check damaged parts.** Before further use of the product, a guard or other part that is damaged should be carefully checked to determine that it will operate properly and perform its intended function. Check for alignment of moving parts, binding of moving parts, breakage of parts, mounting, and any other condition that may affect the tool's operation. A guard or other part that is damaged should be properly repaired or replaced by an authorized service centre unless indicated elsewhere in this manual.
- **Prevent unintentional starting.** Ensure the switch is in the off-position before connecting to battery pack, picking up or carrying the appliance. Carrying the appliance with your finger on the switch or energizing appliances that have the switch on invites accidents.
- **Disconnect the battery pack from the appliance before making any adjustments, changing accessories, or storing appliance.** Such preventive safety measures reduce the risk of starting the appliance accidentally.
- **Recharge only with the charger specified by the manufacturer.** A charger that is suitable for one type of battery pack may create a risk of fire when used with another battery pack.
- **Use appliances only with specifically designated battery packs.** Use of any other battery packs may create a risk of injury and fire.
- When battery pack is not in use, keep it away from other metal objects, like paper clips, coins, keys, nails, screws or other small metal objects, that can make a connection from one terminal to another. Shorting the battery terminals together may cause burns or a fire.
- Under abusive conditions, liquid may be ejected from the battery; avoid contact. If contact accidentally occurs, flush with water. If liquid contacts eyes, additionally seek medical help.
- Liquid ejected from the battery may cause irritation or burns.
- Do not use a battery pack or appliance that is damaged or modified. Damaged or modified batteries may exhibit unpredictable behavior resulting in fire, explosion or risk of injury.
- Do not expose a battery pack or appliance to fire or excessive temperature. Exposure to fire or temperature above 130°C (265°F) may cause an explosion.
- Follow all charging instructions and do not charge the battery pack or appliance outside of the temperature range specified in the instructions. Charging improperly or at temperatures outside of the specified range may damage the battery and increase the risk of fire.
- Have servicing performed by a qualified repair person using only identical replacement parts. This will ensure that the safety of the product is maintained.
- Do not modify or attempt to repair the appliance or the battery pack (as applicable) except as indicated in the instructions for use and care.

SAVE THESE INSTRUCTIONS.

ADDITIONAL SAFETY GUIDELINES

- The label on your tool may include the following symbols. The symbols and their definitions are as follows:

V Volts

A Amperes

min Minutes

— or d.c. Direct current

n_0 No-load speed

.../min or ...min⁻¹ Revolutions or reciprocations per minute



..... The logo of UL certification.



..... WARNING—To reduce the risk of injury, user must read instruction manual.



..... WARNING—To reduce the risk of injury, always wear eye protection.



..... WARNING—To reduce the risk of injury, always wear ear protection.



..... WARNING—Wear head protection.



..... WARNING—Keep sufficient distance away from electrical power lines.



..... WARNING—Wear protective gloves.



..... WARNING—Wear safety footwear.

**WARNING!**

To reduce the risk of electric shock or damage to the charger and battery, use only the Mastercraft® and PWR POD™ batteries and chargers listed.

BATTERY PACK	CHARGER
Mastercraft®: 054-3124-0, 054-7553-4, 054-7557-6, 054-2434-8	Mastercraft®: 054-3126-6, 054-7559-2, 054-8299-4
PWR POD™: 054-7563-0, 054-7564-8, 054-7558-4	PWR POD™: 054-3126-6, 054-7565-6, 054-7567-2

- For best results, your battery and tool should be charged, stored and used in a location where the temperature is more than 5°C (41°F) but less than 40°C (104°F).** Do not store outside or in vehicles.

PACKAGE CONTENTS:

Pole saw, saw chain, guide bar, strap, chain sheath, wrench and instruction manual

KEY PARTS DIAGRAM

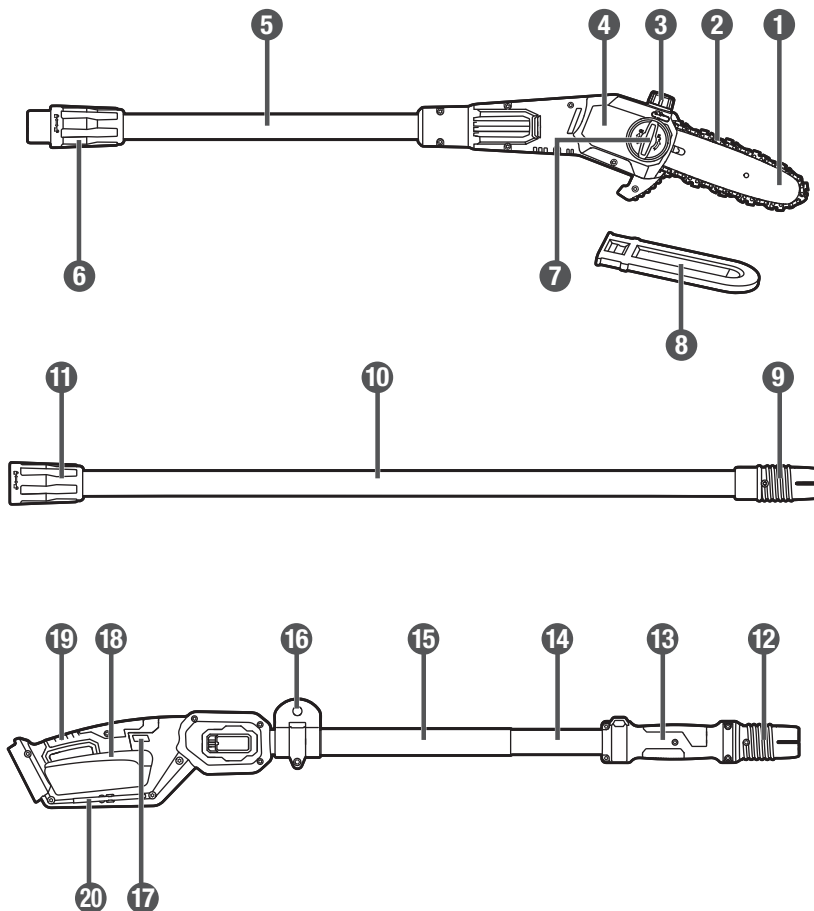

No.	Description
1	Guide bar
2	Saw chain
3	Oil tank cap
4	Side cover
5	Front pole
6	Threaded sleeve
7	Side-cover knob
8	Chain sheath
9	Threaded connection
10	Extension pole

No.	Description
11	Threaded sleeve
12	Threaded connection
13	Screw sleeve
14	Rear pole
15	Foam handle
16	Strap hole
17	Lock-off button
18	Trigger switch
19	Rear handle
20	On-board wrench

**WARNING!**

- Remove the pole saw from the package and examine it carefully. Do not discard the carton or any packaging material until all parts have been examined.
- If any part of the pole saw is missing or damaged, do not attach the tool to a power source or use the tool until the part has been repaired or replaced. Failure to heed this warning could result in serious injury.
- Do not allow familiarity with the pole saw to cause a lack of alertness. A fraction of a second of carelessness is enough to cause severe injury.

OPERATING INSTRUCTIONS

INSTALL THE GUIDE BAR AND CHAIN (fig. 1)

1. Rotate the side-cover knob counter-clockwise and then remove the side cover (**fig. 1a**).
2. Lay the new saw chain in a loop on a flat surface and straighten any kinks. The cutter should face in the direction of chain rotation; if they face backwards, turn the loop over (**fig. 1b**). The direction of the cutter should be consistent with the directions marked on the guide bar and the enclosure.
3. Place the chain drive links into the guide bar groove. Position the chain so there is a loop at the back of the guide bar (**fig. 1c**).
4. Hold the chain in position on the bar and place the loop around the sprocket. Fit the bar against the mounting surface so that the bar stud is in the long slot of the bar and the adjusting pin is in the chain-tension pin hole (**fig. 1d**).

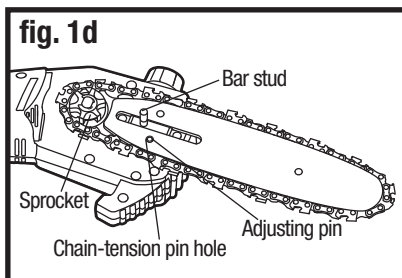
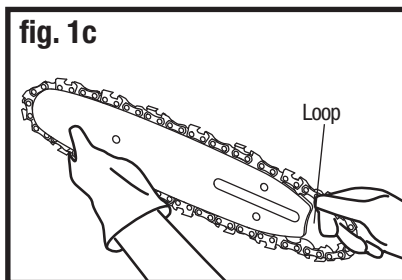
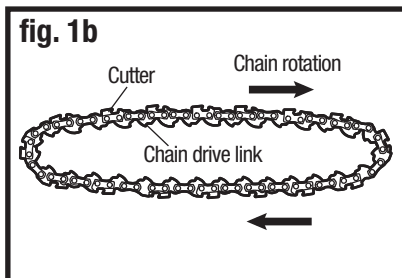
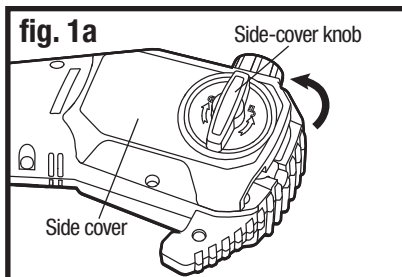

5. Replace the side cover onto the saw head. Rotate the side-cover knob clockwise to slightly tighten the side cover, but leave the bar free to move for tension adjustment (**fig. 1e**).
6. Rotate the side-cover knob clockwise to completely tighten the side cover.

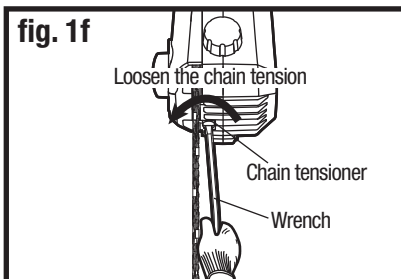
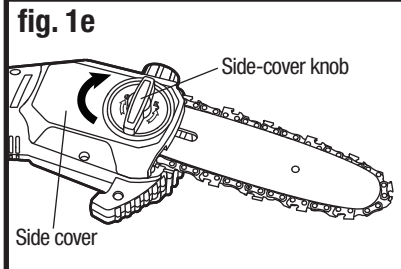

NOTICE:

- When you first purchase your pole saw, the chain and bar will not be attached to the saw.
- The chain is correctly tensioned when there is no sag on the underside of the guide bar; the chain is snug, but can be rotated by hand without binding. For more information on chain tensioning, see the maintenance section.
- If the chain is too tight, it will not rotate. Loosen the side cover slightly and turn the chain tensioner 1/4 turn counter-clockwise (**fig. 1f**). Lift the tip of the guide bar up and retighten the side cover. Ensure that the chain can be rotated by hand without binding.



WARNING!

- Always wear protective gloves when handling the bar and chain; these components are sharp and may contain burrs.

CONNECT THE POLES (fig. 2)

ATTACH WITHOUT THE EXTENSION POLE (fig. 2a)

1. Remove the battery pack.
2. Align the rib on the front pole with the arrow slot on the rear pole and push the front pole into the rear pole.
3. Rotate the threaded sleeve to the thread on the threaded connection securely.
4. Pull on the front pole to verify that it is securely locked in place.

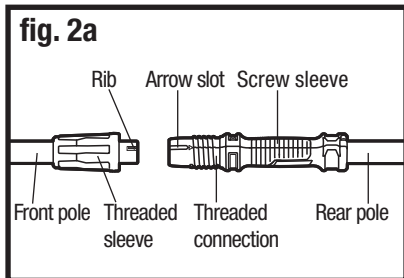

ATTACH WITH THE EXTENSION POLE (fig. 2b)

The extension pole extends the cutting range. It should be connected between the front pole and the rear pole.

Follow the previous instructions to connect the front pole to one end of the extension pole, and then connect the rear pole to the other end of the extension pole the same way.

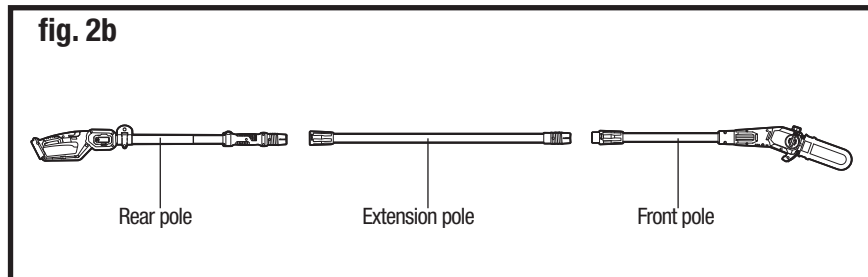

NOTICE:

- Do not grasp the screw sleeve during operation.



WARNING!

- Never attach or adjust the pole assembly with the battery installed. Failure to stop the motor and remove the battery may cause serious personal injury. It's also recommended to attach the chain sheath when handling the pole assembly.
- Be certain that the threaded sleeve is fully tightened before operating the tool; check it periodically for tightness during use to avoid serious personal injury.

ATTACH THE SHOULDER STRAP (fig. 3)

1. If needed, attach the shoulder strap to the bracket on the rear pole with the carabiner hook.
2. Adjust the length of the strap to attain a comfortable working position.

FILLING OIL TANK WITH BAR AND CHAIN LUBRICANT (fig. 4)

The pole saw is not filled with oil at the time of purchase. It is essential to fill the tank with oil before use. Operating the pole saw without chain oil or when the oil level is below the minimum mark will result in damage to the saw. Chain life and cutting capacity depend on optimum lubrication. The chain is automatically lubricated with chain oil from the tank during operation.

1. Remove the battery pack from the pole saw.
2. Clean the oil tank cap and the area around it to ensure that no dirt falls into the oil tank.
3. Position the pole saw on its side on a firm, flat surface, so that the oil tank cap is facing upwards. Rotate the oil tank cap counter-clockwise to remove it.
4. Carefully pour the oil into the tank. Fill to the bottom of the fill neck. Wipe off any excess oil.
5. Replace the cap, place the saw upright, and view the level through the oil inspection window. Oil should fill the window.

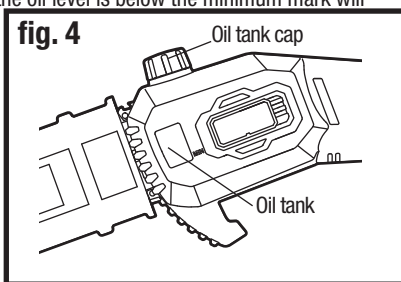
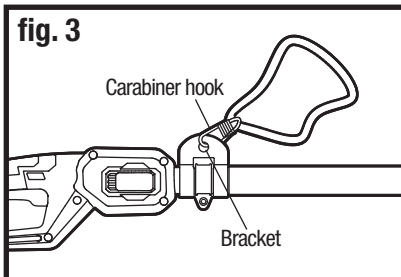
**NOTICE:**

- Never use oil or other lubricants not specifically designed for use on the bar and chain. This can lead to a clogged oil system, which may cause premature wear of the bar and chain.
- Check the oil level frequently and fill when the oil level falls below the minimum line. Never operate the pole saw if the oil is not visible.
- Do not use dirty, used, or otherwise contaminated oil. Damage may occur to the bar or chain.
- It is normal for oil to seep from the saw when it is not in use. To prevent seepage, empty the oil tank after each use, and then run the saw for one minute. When storing the tool for a long period of time, be sure the chain is lightly lubricated; this will prevent rust on the chain and bar sprocket.

WARNING!

- Do not smoke or bring any fire or flame near the oil or the saw. Oil may spill and cause a fire.



TO ATTACH THE BATTERY (fig. 5)

1. Make sure that the sander is switched off.
2. Align the raised rib on the battery pack with the grooves on the pole saw, and then slide the battery pack onto the pole saw.

TO DETACH THE BATTERY (fig. 5)

1. Make sure that the pole saw is switched off.
2. Depress the battery-release button located on the front of the battery pack to release the battery pack.
3. Pull the battery pack out and remove it from the pole saw.

START/STOP THE TOOL (fig. 6)

1. To turn the saw on, grasp the foam and rear handles firmly, using both hands.
2. Press the lock-off button, and then squeeze the trigger switch.
3. To turn the saw off, release the trigger switch and allow the chain to come to a complete stop.

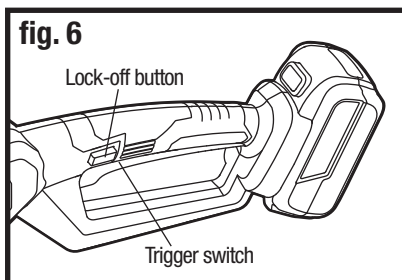
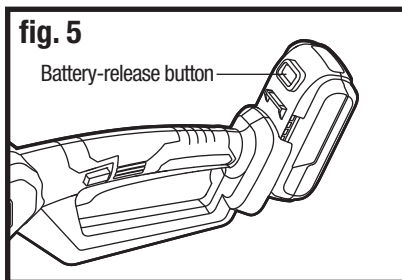

WARNING!

- Make sure that no objects or obstructions are in the immediate vicinity and could come in contact with the bar and chain.

BASIC CUTTING (fig. 7)

1. Take the proper stance in front of the tree with the saw off. The most typical cutting application is to position the unit at an angle of 60° or less depending on the specific situation. As the angle of the pole saw shaft to the ground increases, the difficulty of making the first cut increases.
2. Start the tool to make a shallow first cut (1/4 of the limb diameter) on the underside of the limb, close to the main limb or trunk.
3. Make a second cut from the top side of the limb, outboard from the first cut. Continue the cut through the limb until the limb separates from the tree. Be prepared to balance the weight of the tool when the limb falls.
4. Make a final cut close to trunk.
5. Release the trigger switch as soon as the cut is completed.

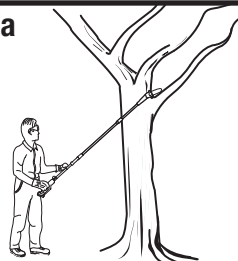
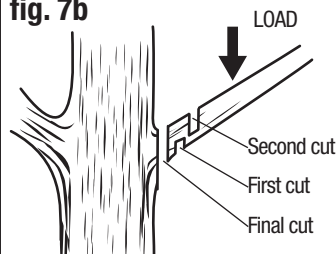
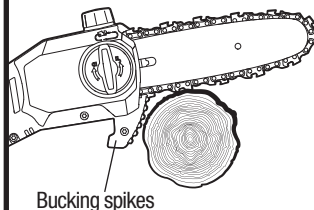
fig. 7a**fig. 7b****fig. 7c****NOTICE:**

- Practice cutting a few small logs to get the "feel" of using your saw before you begin a major sawing operation.
- For second and final cuts (from the top of the limb or branch), hold the bucking spikes against the limb being cut (**fig. 7c**). This will help to steady the limb and make it easier to cut. Allow the chain to cut for you; exert only light, downward pressure. If you force the cut, damage to the bar, chain, or motor can result.



- Never cut near power lines, electric cords, or other electric sources. If the bar and chain jams on any electrical cord or line, **DO NOT TOUCH THE BAR, CHAIN OR THE ALUMINUM POLE! THEY CAN BECOME ELECTRICALLY LIVE AND MAY BE VERY DANGEROUS.** Continue to hold the pole saw by the insulated rear handle or lay it down and away from you in a safe manner. Disconnect the electrical service to the damaged line or cord before attempting to free the bar and chain from the line or cord. Contact with the bar, chain, other conductive parts of the pole saw, or live electric cords or lines will result in death by electrocution or serious injury.

LIMBING AND PRUNING (fig. 8)

This pole saw is designed for trimming small branches and limbs up to 8" (20 cm) in diameter. For best results, observe the following precautions.

1. Plan the cut carefully. Be aware of the direction in which the branch will fall.
2. Remove long branches in several stages.
3. Cut lower branches first to allow the top branches more room to fall.
4. Work slowly, keeping both hands on the saw with a firm grip. Maintain secure footing and balance.
5. Keep the tree between you and the chain while limbing. Cut from the side of the tree opposite the branch you are cutting.
6. Do not make a flush cut next to the main limb or trunk until you have cut off much of limb to reduce the weight.
7. To prevent electrocution, do not operate within 50' (15 m) of overhead electrical lines.
8. Keep bystanders at least 50' (15 m) away.

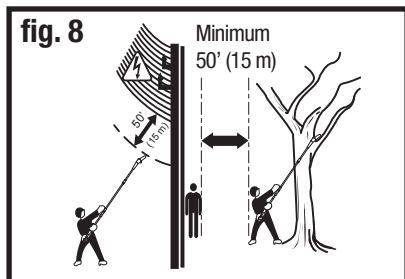

MAINTENANCE

CLEANING

1. After each use, clean debris from the chain and guide bar with a soft brush. Wipe the pole saw surface with a clean cloth moistened with a mild soap solution.
2. Remove the side cover, and then use a soft brush to remove debris from the guide bar, saw chain, sprocket and side cover.
3. Always clean out wood chips, saw dust, and dirt from the guide-bar groove when replacing the saw chain.

ADJUST THE CHAIN TENSION (*fig. 9*)

1. Stop the saw and remove the battery pack before adjusting the chain tension.
2. Loosen the side-cover knob, insert the wrench into the chain tensioner to adjust the guide bar and retighten the side-cover knob securely. Ensure that the chain will rotate without binding.
 - During normal saw operation, the temperature of the chain will increase. The drive links of a correctly tensioned warm chain will hang approximately 3/64" (1.3 mm) out of the bar groove.
 - A cold chain is correctly tensioned when there is no slack on the underside of the guide bar and the chain is snug, but it can be turned by hand without binding. The chain must be re-tensioned whenever the flats on the drive links do not sit in the bar groove.

fig. 9a

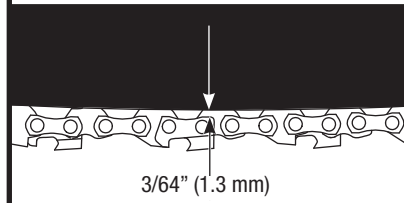
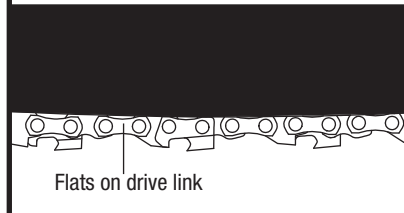

fig. 9b



NOTICE:

- New chains tend to stretch; check chain tension frequently.
- A chain tensioned while it is warm may be too tight upon cooling. Check the cold tension before next use.

CHAIN MAINTENANCE

SHARPEN THE CUTTERS

(fig. 10a–fig. 10d)

Be careful to file all cutters (**fig. 10a**) to the specified angles and to the same length, as fast cutting can be obtained only when all cutters are uniform.

1. Remove the battery pack. Wear gloves for protection.
2. Use a $5/32"$ (4.0 mm) diameter round file and holder (available separately). Do all of your filing at the middle position of the guide bar.
3. Keep the file level with the top plate of the tooth. Do not let the file dip or rock.
4. Keep a correct sharpening angle of 30° between the file and the saw chain; see **figures 10b and 10c**. Always use a file holder (available separately) when sharpening saw chains by hand. File holders have markings for the sharpening angle.
5. Using light but firm pressure, stroke towards the front corner of the tooth. Lift the file away from the steel on each return stroke.
6. Make a few firm strokes on every tooth. File all left-hand cutters in one direction. Then move to the other side and file the right-hand cutters in the opposite direction. Occasionally remove filings from the file with a wire brush (**fig. 10d**).

fig. 10a

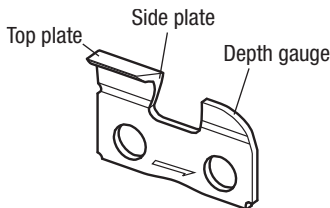

fig. 10b

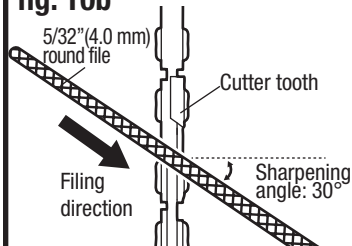

fig. 10c

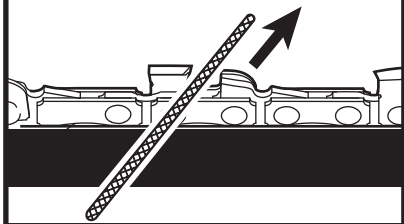
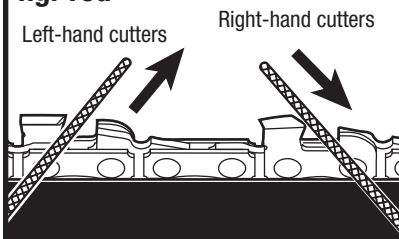

fig. 10d



WARNING!

- Improper chain sharpening increases the potential of kickback.
- Failure to replace or repair a damaged chain can cause serious injury.

TOP-PLATE SHARPENING ANGLES**(fig. 10e)**

CORRECT 30°— This optimal angle can be obtained only when the specified files and proper setting are used. File holders are marked with guide marks to align the file properly to produce the correct top-plate angle.

LESS THAN 30°— The tooth is too dull for cutting.

MORE THAN 30°— The edge of the cutting tooth is feathered and dulls quickly.

fig. 10e

Top-plate sharpening angles

Less than 30° More than 30°



Correct

Incorrect

Incorrect

SIDE-PLATE ANGLE (fig. 10f)

CORRECT 55°— The optimal angle can be produced automatically if the correct diameter file is used in the file holder.

HOOK— “Grabs” and dulls quickly. Increases potential of KICKBACK. Results from using a file with a diameter that is too small, or a file held too low.

BACKWARD SLOPE— Needs too much feed pressure, causes excessive wear to bar and chain. Results from using a file with a diameter too large, or a file held too high.

fig. 10f

Side-plate angle

Hook Backward Slope



Correct

Incorrect

Incorrect

DEPTH-GAUGE CLEARANCE**(fig. 10g–fig. 10h)**

1. The depth gauge should be maintained at a clearance of 1/32" (0.6 mm), as shown in **fig. 10g**. Use a depth-gauge tool (available separately) to check the depth-gauge clearances.
2. Check the depth-gauge clearance every time the chain is filed.

Use a flat file and a depth-gauge jointer (both available separately) to lower all gauges uniformly (**fig. 10h**). Use a 1/32" (0.6 mm) depth-gauge jointer.

Depth gauges must be adjusted with the flat file in the same direction that the adjoining cutter was filed with the round file. Use care not to contact the cutter face with the flat file when adjusting depth gauges.

fig. 10g

Depth-gauge clearance

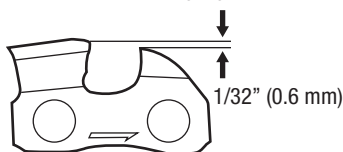

1/32" (0.6 mm)

fig. 10h

Depth-gauge jointer

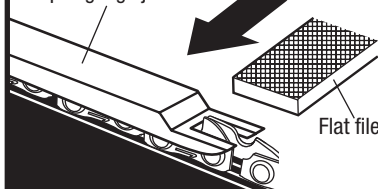

Flat file

GUIDE BAR MAINTENANCE (fig. 11)

The bar should be cleaned every day of use and checked for wear and damage. Feathering or burring of the bar rails is a normal process of bar wear. Such faults should be smoothed with a file as soon as they occur. A bar with any of the following faults should be replaced.

- Wear inside the bar rails that permits the chain to lay over sideways.
- Bent guide bar.
- Cracked or broken rails.
- Spread rails.

In addition, the guide bar has a sprocket at its tip. The sprocket must be lubricated weekly with a grease syringe to extend the guide bar life. Use a grease syringe to lubricate weekly with chain oil by means of the lubricating hole. Turn the guide bar and check that the lubrication holes and chain groove are free from impurities.

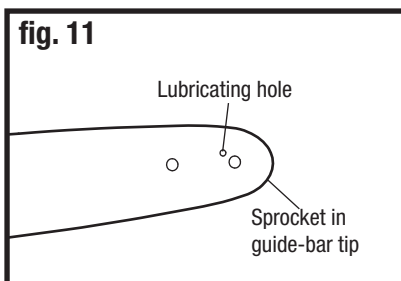

TRANSPORTING AND STORING

1. Do not store or transport the pole saw when it is running. Always remove the battery pack before storing or transporting.
2. Always place the chain sheath on the guide bar and chain before storing or transporting the pole saw. Use caution to avoid the sharp teeth of the chain.
3. Clean the pole saw thoroughly before storing. Store the pole saw indoors, in a dry place that is locked and/or inaccessible to children.
4. Keep away from corrosive agents such as garden chemicals and de-icing salts.



WARNING!

- Before cleaning or performing any maintenance, remove the battery pack.
- Do not let brake fluids, gasoline, petroleum-based products, penetrating oil, etc., come into contact with plastic parts. These substances contain chemicals that can damage, weaken, or destroy plastic.
- When servicing, use only identical replacement parts. The use of any other parts may create a hazard or cause damage to the product.
- Always wear safety goggles or safety glasses with side shields during power tool operation or when blowing dust. If the operation is dusty, also wear a dust mask.
- To ensure safety and reliability, all repairs should be performed by a qualified service technician.

TROUBLESHOOTING

Problem	Possible Causes	Solution
Pole saw does not work.	The battery pack is not properly attached to the tool.	Attach the battery pack to the tool.
	The battery pack is depleted.	Charge the battery pack.
	The battery pack is overheated.	Cool the battery and restart the tool.
Motor runs, but the chain does not rotate.	Chain does not engage drive sprocket.	Reinstall the chain, making sure that the drive links on the chain are fully seated on the sprocket.
	Chain tension is too tight.	Re-tension the chain.
Motor runs and the chain rotates but does not cut.	Dull chain.	Replace or sharpen the chain.
	Chain on backwards.	Reinstall the chain to reverse the direction of the chain.

If the problem remains unsolved after performing the checks described above, call the toll-free helpline at 1-800-689-9928.

EXPLODED VIEW

PARTS LIST

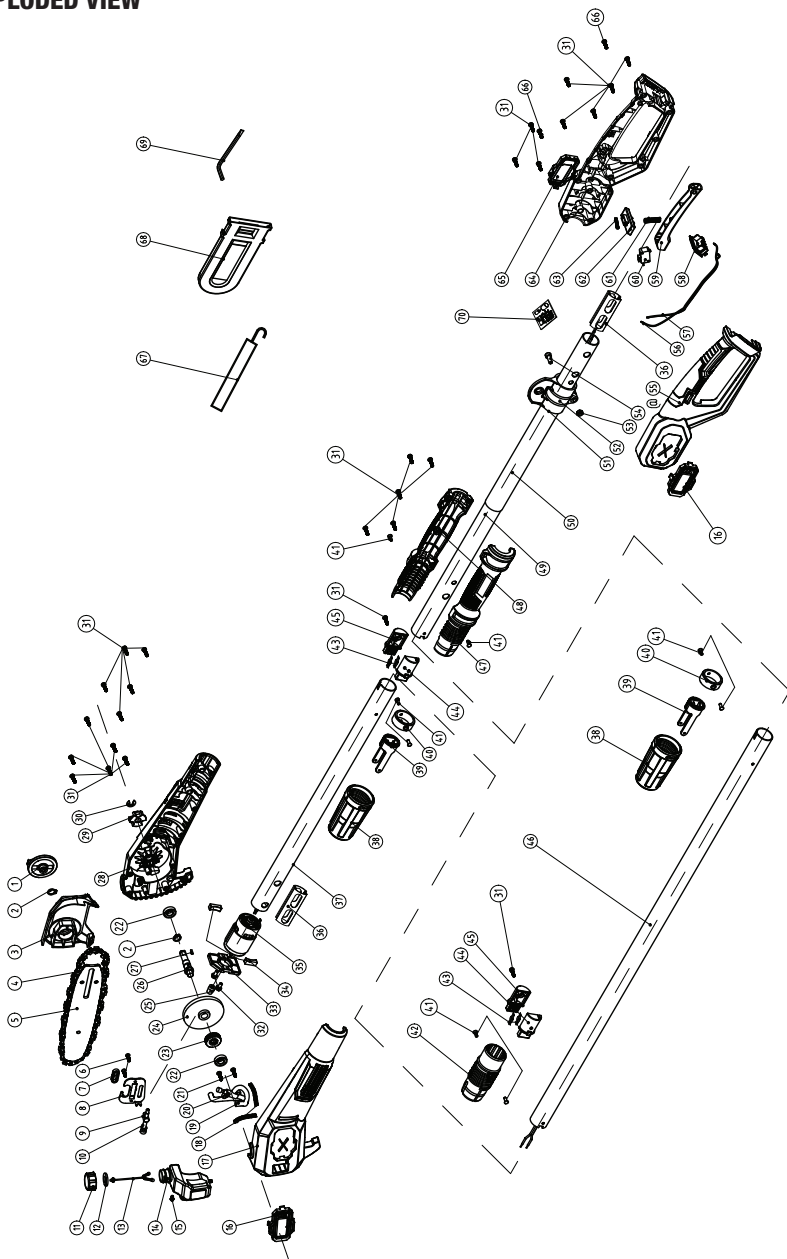

No.	Part No.	Description
1	0540370001	Lock Knob
2	0540370002	Circlips
3	0540370003	Side Cover
4	0540370004	Chain
5	0540370005	Guide
6	0540370006	Screw
7	0540370007	Sealing Ring
8	0540370008	Pressure Plate
9	0540370009	Adjustment Screw
10	0540370010	Adjustment Head
11	0540370011	Can Top
12	0540370012	Spare Seal Ring
13	0540370013	Oil Can Rope
14	0540370014	Oil Can
15	0540370015	Breather Valve
16	0540370016	Left Decorative Cover
17	0540370017	Left Casing
18	0540370018	Tubing Spring
19	0540370019	Tubing
20	0540370020	Oil Pump
21	0540370021	Screw
22	0540370022	Deep Groove Ball Bearing
23	0540370023	Oil Pump Turbine
24	0540370024	Large Bevel Gear
25	0540370025	Bevel Gear
26	0540370026	Output Shaft
27	0540370027	Woodruff Key
28	0540370028	Right Casing
29	0540370029	Sprocket
30	0540370030	Retainer
31	0540370031	Screw

No.	Part No.	Description
32	0540370032	Screws
33	0540370033	Centre Support
34	0540370034	Anti-Shock Pad
35	0540370035	Motor
36	0540370036	Retainer Sleeve
37	0540370037	Aluminum Tube
38	0540370038	Thread Lock Sleeve
39	0540370039	Card Connector
40	0540370040	Locating Sleeve
41	0540370041	Rivet
42	0540370042	Thread Lock Sleeve
43	0540370043	Power Plug-in
44	0540370044	Left Plug-in Socket
45	0540370045	Right Plug-in Socket
46	0540370046	Aluminum Tube
47	0540370047	Left Thread Sleeve
48	0540370048	Right Thread Sleeve
49	0540370049	Handle Aluminum Tube
50	0540370050	Sponge Casing
51	0540370051	Straps Hooks
52	0540370052	Clamp Ring
53	0540370053	Hex Nut
54	0540370054	Screw
55	0540370055	Left Handle
56	0540370056	Wires
57	0540370057	Wires
58	0540370058	Plug-in Socket Component
59	0540370059	Switch Trigger
60	0540370060	Micro Switch
61	0540370061	Spring
62	0540370062	Latching Switch

63	0540370063	Spring	67	0540370067	Straps
64	0540370064	Right Handle	68	0540370068	Blade Guard
65	0540370065	Right Decorative Cover	69	0540370069	Wrench
66	0540370066	Screw	70	0540370070	Electric Assembly

If any parts are missing or damaged, or if you have any questions, please call the toll-free helpline at 1-800-689-9928.

This Mastercraft® product is guaranteed for a period of **3 years from the date of original retail purchase** against defects in workmanship and materials, except for the following components:

- a) Component A: Batteries, chargers and carrying case, which are guaranteed for a period of 2 years from the date of original retail purchase against defects in workmanship and materials;
- b) Component B: Accessories, which are guaranteed for a period of 1 year from the date of original retail purchase against defects in workmanship and materials.

Subject to the conditions and limitations described below, this product, if returned to us with proof of purchase within the stated warranty period and if covered under this warranty, will be repaired or replaced (with the same model, or one of equal value or specification), at our option. We will bear the cost of any repair or replacement and any costs of labour relating thereto.

These warranties are subject to the following conditions and limitations:

- a) a bill of sale verifying the purchase and purchase date must be provided;
- b) this warranty will not apply to any product or part thereof which is worn or broken or which has become inoperative due to abuse, misuse, accidental damage, neglect or lack of proper installation, operation or maintenance (as outlined in the applicable owner's manual or operating instructions) or which is being used for industrial, professional, commercial or rental purposes;
- c) this warranty will not apply to normal wear and tear or to expendable parts or accessories that may be supplied with the product that are expected to become inoperative or unusable after a reasonable period of use;
- d) this warranty will not apply to routine maintenance and consumable items such as, but not limited to, fuel, lubricants, vacuum bags, blades, belts, sandpaper, bits, fluids, tune-ups or adjustments;
- e) this warranty will not apply where damage is caused by repairs made or attempted by others (i.e., persons not authorized by the manufacturer);
- f) this warranty will not apply to any product that was sold to the original purchaser as a reconditioned or refurbished product (unless otherwise specified in writing);
- g) this warranty will not apply to any product or part thereof if any part from another manufacturer is installed therein or any repairs or alterations have been made or attempted by unauthorized persons;
- h) this warranty will not apply to normal deterioration of the exterior finish, such as, but not limited to, scratches, dents, paint chips, or to any corrosion or discolouring by heat, abrasive and chemical cleaners; and
- i) this warranty will not apply to component parts sold by and identified as the product of another company, which shall be covered under the product manufacturer's warranty, if any.

Additional Limitations

This warranty applies only to the original purchaser and may not be transferred. Neither the retailer nor the manufacturer shall be liable for any other expense, loss or damage, including, without limitation, any indirect, incidental, consequential or exemplary damages arising in connection with the sale, use or inability to use this product.

Notice to Consumer

This warranty gives you specific legal rights, and you may have other rights, which may vary from province to province. The provisions contained in this warranty are not intended to limit, modify, take away from, disclaim or exclude any statutory warranties set forth in any applicable provincial or federal legislation.

Made in China

Imported by

Mastercraft Canada Toronto, Canada M4S 2B8

WARRANTY

